



Steel City®

Non-Metallic Sheathed Cable Fittings

Steel City® Fittings

All Plastic Connector for NM Cable and Flexible Cord



Snap captive locking wedge into connector's cavity.



Press locking wedge into cavity that locks onto cable.

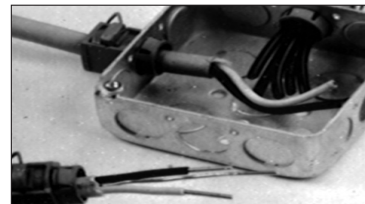

Cat. No. 3201 is ideal for multiple flexible cords and cable.

- High-impact thermoplastic: UL 94-V1
- Features push-in design
- Captive locking wedge secures cable with single squeeze of standard electrician's pliers
- Provides excellent insulation, strain-relief and high pull-out value

Size Range



CAT. NO.	DESCRIPTION
3300	For use with 10-2, 12-2 and 14-2 NM cables; 18-2 and 18-3 SJ and SJO cords and 18-2 SV, SVO, SJT and SJTO cords, single or multiple; cord capacity .125-.300 diameter
3201-TB	For use with 10-3, 12-3, 14-3, 10-2, 12-2, 4-2 NM cables; multiple (2) 12-2 and 14-2 N M cables; single and multiple flexible cords in wire range .300 in. to .600 in.
3202	For use with 8-3 and 6-3 NM cables; (2) 14-3, 14-2, 12-2 and 10-2 NM cables; single and multiple flexible cords in wire range .500 in. to .850 in.

Temperature Rating: 105° C
CSA File Nos. 584 and 2884
UL File No. E-17583

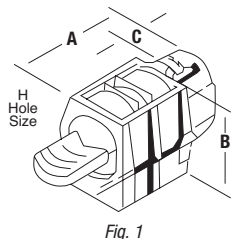

Fig. 1

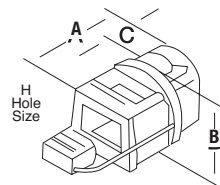
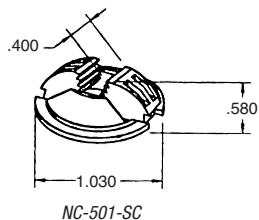

Fig. 2

CAT. NO.	KO SIZE	FIG.	A	B	C	D	E	MAX THK. ENCLOSURE	H	STD. CTN.
3300	1/2"	2	1 1/32	1 1/16	3/8	.880	.795	.080	5/16 X 9/16	500
3201-TB	1/2"	1	1 1/32	1	7/16	.880	.795	.080	2 1/32 dia.	500
3202	3/4"	1	1 1/2	1 1/16	7/16	1.100	1.005	.090	7/8 dia.	250

Temperature Rating: 105° C
CSA File Nos. 584 and 2884
UL File No. E-17583



NC-501-SC

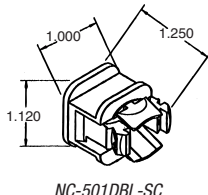

NC-501DBL-SC

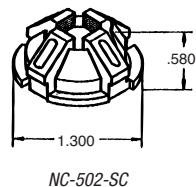

NC-502-SC

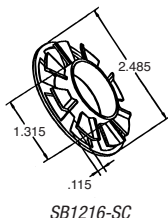

SB1216-SC

Hit Lock® Connectors



CAT. NO.	DESCRIPTION	STD. CTN.
NC-501SC	1/2" Hit Lock® Connector	500
NC-501DBL-SC	1/2" Double Hit Lock® Connector	500
NC-502SC	3/4" Hit Lock® Connector	100
SB1216-SC	Twist It Bushing For Metal Studs	50

UL File No. E-17583