



SNAP²IT[®] Non-Metallic Connectors

For use with non-metallic liquid-tight conduit, type B only. Push on installation. Produced from UV rated plastic for long outdoor life.



**PUSHES ONTO
CONDUIT...NO TOOLS!**

CATALOG NUMBER	UPC/DCI/NAED MFG #01 8997	TRADE SIZE	KO SIZE	UNIT PKG	STD PKG	DIM A	DIM B	DIM C
NMLT5	54576	1/2	1/2	25	100	2.376	.619	1.420
NMLT7	54577	3/4	3/4	10	50	2.425	.670	1.664
NMLT10	54102	1	1	5	25	2.530	.708	1.856

Add suffix "BL" to Catalog # when ordering in black, for example NMLT5BL. Factory order only. Minimum quantities required. PATENTED. ADDITIONAL PATENTS PENDING.



E60812 LR49636

- **Competitively priced**
- **Fast and easy installation**
- **Provides a super-secure, liquid-tight seal**
- **Removable and reusable!**

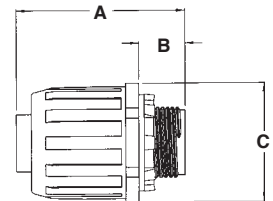

Installation Instructions

To install, simply **PUSH ON** to conduit. That's it!



For a video installation demonstration visit our website @aifittings.com



90° SNAP²IT[®] Non-Metallic Connectors

For use with non-metallic liquid-tight conduit, type B only. Push on installation. Produced from UV rated plastic for long outdoor life.



CATALOG NUMBER	UPC/DCI/NAED MFG #01 8997	TRADE SIZE	KO SIZE	UNIT PKG	STD PKG	DIM A	DIM B	DIM C
NMLT905	54578	1/2	1/2	10	50	2.331	.605	3.389
NMLT907	54579	3/4	3/4	10	50	2.682	.670	3.645
NMLT9010	54104	1	1	5	25	2.874	.708	4.107

Add suffix "BL" to Catalog # when ordering in black, for example NMLT905BL. Factory order only. Minimum quantities required. PATENTED. ADDITIONAL PATENTS PENDING.



E60812 LR49636

Fast and easy installation (see above)

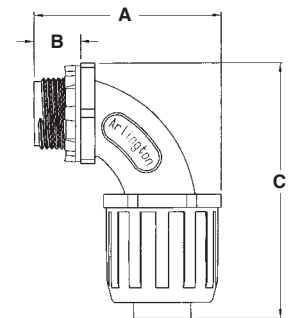



SNAP²IT[®] Zinc Connectors

For use with metallic and non-metallic liquid-tight conduit, type B. Push on installation.



LT5



LT5A

Fast and easy installation
(see page A-1)  aifittings.com

CATALOG NUMBER	UPC/DCI/NAED MFG #01 8997	TRADE SIZE	KO SIZE	UNIT PKG	STD PKG	DIM A	DIM B	DIM C
LT5	32502	1/2	1/2	25	100	2.376	.619	1.420
LT7	32503	3/4	3/4	10	50	2.425	.670	1.664
LT10	32102	1	1	5	25	2.495	.708	1.890

PATENTED. ADDITIONAL PATENTS PENDING.



E60812 LR49636

New! With Insulated Throat

CATALOG NUMBER	UPC/DCI/NAED MFG #01 8997	TRADE SIZE	KO SIZE	UNIT PKG	STD PKG	DIM A	DIM B	DIM C
LT5A	35085	1/2	1/2	25	100	2.454	.697	1.420
LT7A	35086	3/4	3/4	10	50	2.515	.760	1.664
LT10A	35087	1	1	5	25	2.620	.798	1.890

PATENTED.
ADDITIONAL PATENTS PENDING.



E60812 LR49636

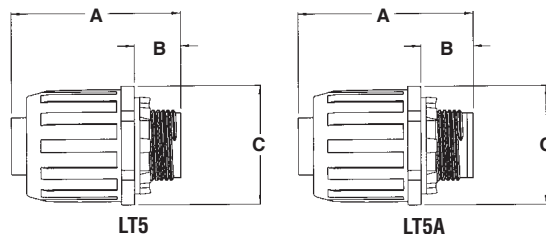

90° SNAP²IT[®] Zinc Connectors

For use with metallic and non-metallic liquid-tight conduit, type B. Push on installation.



LT905



LT905A

Fast and easy installation
(see page A-1)  aifittings.com

CATALOG NUMBER	UPC/DCI/NAED MFG #01 8997	TRADE SIZE	KO SIZE	UNIT PKG	STD PKG	DIM A	DIM B	DIM C
LT905	32504	1/2	1/2	10	50	2.331	.605	3.389
LT907	32505	3/4	3/4	10	50	2.682	.670	3.645
LT9010	32104	1	1	5	25	2.874	.708	4.107

PATENTED. ADDITIONAL PATENTS PENDING.



E60812 LR49636

New! With Insulated Throat

CATALOG NUMBER	UPC/DCI/NAED MFG #01 8997	TRADE SIZE	KO SIZE	UNIT PKG	STD PKG	DIM A	DIM B	DIM C
LT905A	24233	1/2	1/2	10	50	2.409	.683	3.389
LT907A	35089	3/4	3/4	10	50	2.772	.760	3.645
LT9010A	35090	1	1	5	25	2.964	.798	4.107

PATENTED.
ADDITIONAL PATENTS PENDING.



E60812 LR49636

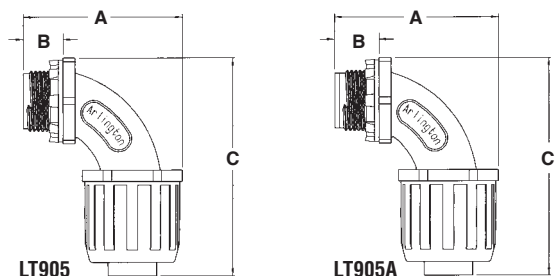



SNAP²IT[®] Zero to 90[™] Non-Metallic Connectors

For use with non-metallic liquid-tight conduit, type B only.
Push on installation.
Produced from UV rated plastic for long outdoor life.



CATALOG NUMBER	UPC/DCI/NAED MFG #01 8997	TRADE SIZE	KO SIZE	UNIT PKG	STD PKG	DIM A	DIM B	DIM C	DIM D
NMLT590	03900	1/2	1/2	10	50	3.165	2.435	3.594	2.007
NMLT790	03902	3/4	3/4	10	50	3.875	2.900	4.200	2.623

Add suffix "BL" to Catalog # when ordering in black, for example NMLT590BL. Factory order only. Minimum quantities required.

PATENT PENDING.



E60812 LR49636

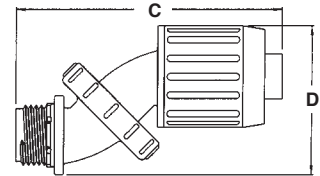
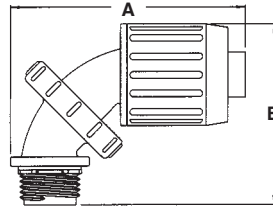

PUSHES ONTO CONDUIT...NO TOOLS!

Adjusts for ALL ANGLES... from 0° to 90°!
To adjust the angle simply loosen the center nut, twist to the correct angle, and retighten.

One-Piece Screw-In Liquid Tight Connectors

For use with metallic and non-metallic liquid-tight conduit, type B only.



CATALOG NUMBER	UPC/DCI/NAED MFG #01 8997	TRADE SIZE	KO SIZE	UNIT PKG	STD PKG	DIM A	DIM B
LTSC50	35405	1/2	1/2	25	100	.525	1.535
LTSC75	35408	3/4	3/4	25	100	.525	1.535

PATENTED.



E60812 LR49636

- Costs 20% less than multi-piece fittings
- Fast and easy screw-on installation
- One-piece, low profile construction
- Built-in gasket maintains liquid-tight seal

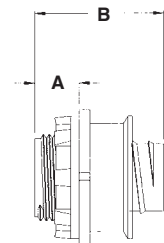



Zero to 90™ Connectors

For use with non-metallic liquid-tight conduit, type B only. Produced from UV rated plastic for long outdoor life.



zero to 90™

CATALOG NUMBER	UPC/DCI/NAED MFG #01 8997	TRADE SIZE	UNIT PKG	STD PKG	DIM A	DIM B	DIM C	DIM D
NMLT5090	06240	1/2	10	50	2.765	1.945	2.324	2.387
NMLT7590	06260	3/4	10	50	3.540	2.590	3.250	2.820

PATENTED. ADDITIONAL PATENTS PENDING.

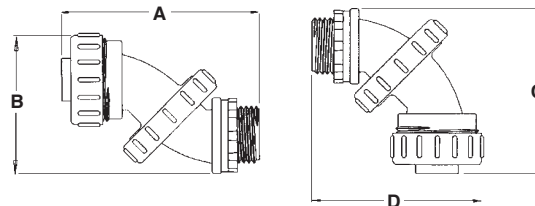

COSTS THE SAME AS OUR "REGULAR" 90° FITTING!

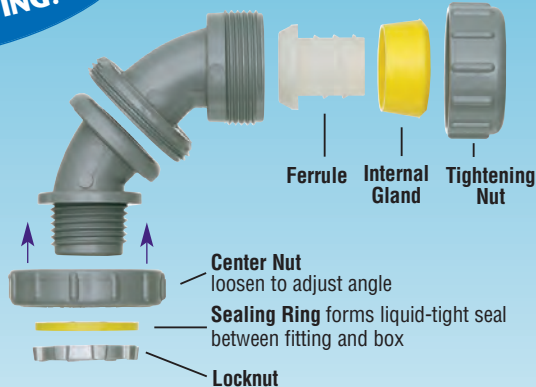

Installation Instructions

Arlington's no-spin ferrule allows the **Zero to 90** connector to be secured to the conduit while fully assembled. To install, simply loosen the tightening nut and screw onto conduit. A positive liquid-tight seal is formed by the pressure sensitive internal gland as the nut is tightened. The sealing ring assures a liquid-tight seal between the fitting and box.

Adjusts for ALL ANGLES... from 0° to 90°!

To adjust the angle simply loosen the center nut, twist to the correct angle, and retighten.





Screw-On Straight Non-Metallic Connectors

For use with non-metallic liquid-tight conduit, type B only. Produced from UV rated plastic for long outdoor life.



CATALOG NUMBER	UPC/DCI/NAED MFG #01 8997	TRADE SIZE	KO SIZE	UNIT PKG	STD PKG	DIM A	DIM B	DIM C
NMSC38	21005	3/8	1/2	25	100	1.350	.535	1.241
NMSC50	21000	1/2	1/2	25	100	1.440	.535	1.234
NMSC75	21010	3/4	3/4	25	100	1.515	.535	1.520

Add suffix "BL" to Catalog # when ordering in black, for example NMSC50BL.

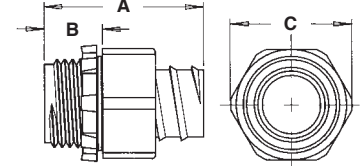
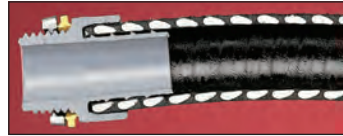
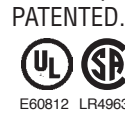

Conduit threads onto ferrule and up inside the outer body. The inside taper squeezes down on the outside of conduit for a superior liquid-tight seal. The cut portion of the conduit does not show, giving a more attractive finished appearance. Also for use with flexible non-metallic tubing. These connectors screw on easily by hand and are removable with pliers.

Screw-On 90° Non-Metallic Connectors

For use with non-metallic liquid-tight conduit, type B only. Produced from UV rated plastic for long outdoor life.



CATALOG NUMBER	UPC/DCI/NAED MFG #01 8997	TRADE SIZE	KO SIZE	UNIT PKG	STD PKG	DIM A	DIM B	DIM C
NMSC9038	21003	3/8	1/2	25	100	2.100	.535	2.442
NMSC9050	21007	1/2	1/2	25	100	2.100	.535	2.504
NMSC9075	21009	3/4	3/4	20	100	2.455	.535	2.831

Add suffix "BL" to Catalog # when ordering in black, for example NMSC9050BL.



Note: Screw connector onto the conduit until it stops. If the fitting is not in alignment with the knockout, you may unscrew the fitting up to one full turn for adjustment.

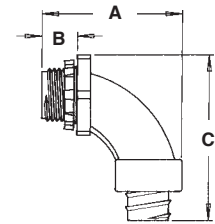

Conduit threads onto ferrule and up inside the outer body. The inside taper squeezes down on the outside of conduit for a superior liquid-tight seal. The cut portion of the conduit does not show, giving a more attractive finished appearance. Also for use with flexible non-metallic tubing. These connectors screw on easily by hand and are removable with pliers.

Straight Non-Metallic Connectors

For use with non-metallic liquid-tight conduit, type B only. Produced from UV rated plastic for long outdoor life.



CATALOG NUMBER	UPC/DCI/NAED MFG #01 8997	TRADE SIZE	KO SIZE	UNIT PKG	STD PKG	DIM A	DIM B	DIM C
NMLT38	54380	3/8	1/2	25	100	1.425	.535	1.421
NMLT50	54500	1/2	1/2	25	100	1.425	.535	1.421
NMLT75	54750	3/4	3/4	10	50	1.475	.550	1.583
NMLT100	54100	1	1	5	25	1.950	.670	1.925
NMLT125	04223	1-1/4	1-1/4	5	25	2.217	.645	2.418
NMLT150	04222	1-1/2	1-1/2	2	10	2.155	.660	2.700
NMLT200	04221	2	2	2	10	2.400	.670	3.360

Add suffix "BL" to Catalog # when ordering in black, for example NMLT50BL.



Installation Instructions

Arlington's reusable Liquid-Tight Fittings may be secured to conduit while fully assembled because of our no-spin ferrule. Simply loosen nut, and screw onto conduit. A positive liquid-tight seal is provided by our pressure sensitive internal gland when the nut is tightened. A liquid-tight seal is also assured between the fitting and box by a sealing ring.

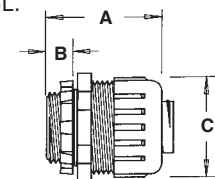



90° Non-Metallic Connectors

For use with non-metallic liquid-tight conduit, type B only. 90° connector provides a smooth, gradual radius bend. Wiring is easily pulled or pushed through fitting and there are no sharp edges to strip wire. Produced from UV rated plastic for long outdoor life.



CATALOG NUMBER	UPC/DCI/NAED MFG #01 8997	TRADE SIZE	KO SIZE	UNIT PKG	STD PKG	DIM A	DIM B	DIM C
NMLT9038	54903	3/8	1/2	10	50	2.325	.562	2.440
NMLT9050	54905	1/2	1/2	10	50	2.325	.562	2.440
NMLT9075	54907	3/4	3/4	10	50	2.550	.545	2.840
NMLT90100	54901	1	1	5	25	3.150	.630	3.922
NMLT90125	54912	1-1/4	1-1/4	5	25	4.440	.645	4.650
NMLT90150	54915	1-1/2	1-1/2	2	10	4.510	.660	4.810
NMLT90200	54920	2	2	2	10	5.062	.670	5.320

Add suffix "BL" to Catalog # when ordering in black, for example NMLT9050BL.



E60812 LR49636

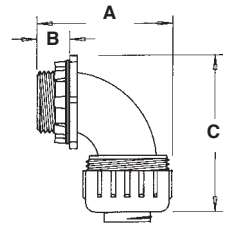

45° Non-Metallic Connectors

For use with non-metallic liquid-tight conduit, type B only. 45° connector provides a smooth, gradual radius bend. Wiring is easily pulled or pushed through fitting and there are no sharp edges to strip wire. Produced from UV rated plastic for long outdoor life.



CATALOG NUMBER	UPC/DCI/NAED MFG #01 8997	TRADE SIZE	KO SIZE	UNIT PKG	STD PKG	DIM A	DIM B	DIM C
NMLT4538	54538	3/8	1/2	10	50	1.550	.562	1.862
NMLT4550	54550	1/2	1/2	10	50	1.596	.562	1.975
NMLT4575	54575	3/4	3/4	10	50	1.820	.545	2.237
NMLT45100	54110	1	1	5	25	2.200	.630	2.990
NMLT45125	54125	1-1/4	1-1/4	5	25	2.710	.645	3.420
NMLT45150	54150	1-1/2	1-1/2	2	10	2.960	.660	3.675
NMLT45200	54200	2	2	2	10	3.500	.670	4.060

Add suffix "BL" to Catalog # when ordering in black, for example NMLT4550BL.



E60812 LR49636

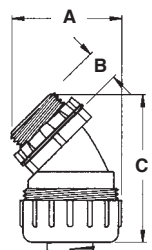



Straight Zinc Die-Cast Connectors

For use with metallic and non-metallic liquid-tight conduit, type B only.



LT50



LT250



LT50A

CATALOG NUMBER	UPC/DCI/NAED MFG #01 8997	TRADE SIZE	KO SIZE	UNIT PKG	STD PKG	DIM A	DIM B	DIM C
LT38	32380	3/8	1/2	25	100	1.440	.510	1.260
LT50	32500	1/2	1/2	25	100	1.440	.520	1.385
LT75	32750	3/4	3/4	10	50	1.562	.500	1.720
LT100	32100	1	1	5	25	1.825	.593	1.900
LT125	32125	1-1/4	1-1/4	5	25	2.068	.625	2.176
LT150	32150	1-1/2	1-1/2	2	10	2.008	.625	2.507
LT200	32200	2	2	2	10	2.103	.593	3.178
LT250*	32250	2-1/2	2-1/2	1	1	3.269	.980	4.218
LT300*	32300	3	3	1	1	4.060	1.070	4.919
LT350*	32350	3-1/2	3-1/2	1	1	4.115	1.065	5.520
LT400*	32400	4	4	1	1	4.323	1.139	5.948

*Provided with insulated throat.



E60812 LR49636

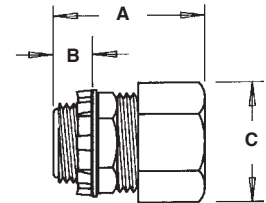

With Insulated Throat

CATALOG NUMBER	UPC/DCI/NAED MFG #01 8997	TRADE SIZE	KO SIZE	UNIT PKG	STD PKG	DIM A	DIM B	DIM C
LT38A	32381	3/8	1/2	25	100	1.533	.493	1.260
LT50A	32501	1/2	1/2	25	100	1.593	.613	1.385
LT75A	32751	3/4	3/4	10	50	1.656	.593	1.720
LT100A	32101	1	1	5	25	1.935	.686	1.900
LT125A	32121	1-1/4	1-1/4	5	25	2.168	.639	2.290
LT150A	32151	1-1/2	1-1/2	2	10	2.101	.680	2.633
LT200A	32201	2	2	2	10	2.196	.686	3.156
LT250	32250	2-1/2	2-1/2	1	1	3.269	.980	4.218
LT300	32300	3	3	1	1	4.060	1.070	4.919
LT350	32350	3-1/2	3-1/2	1	1	4.115	1.065	5.520
LT400	32400	4	4	1	1	4.323	1.139	5.948



E60812 LR49636

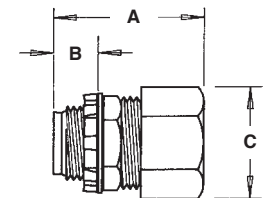



90° Zinc Die-Cast Connectors

For use with metallic and non-metallic liquid-tight conduit, type B only.



LT9050



LT90150



LT9050A



LT90150A

CATALOG NUMBER	UPC/DCI/NAED MFG #01 8997	TRADE SIZE	KO SIZE	UNIT PKG	STD PKG	DIM A	DIM B	DIM C
LT9038	32938	3/8	1/2	10	50	2.062	.520	2.340
LT9050	32950	1/2	1/2	10	50	2.128	.525	2.312
LT9075	32970	3/4	3/4	10	50	2.515	.510	2.664
LT90100	32910	1	1	5	25	2.758	.675	3.640
LT90125	32913	1-1/4	1-1/4	2	10	3.362	.700	3.912
LT90150	32915	1-1/2	1-1/2	2	10	3.500	.604	4.368
LT90200	32920	2	2	2	10	4.106	.680	4.865
LT90250*	32925	2-1/2	2-1/2	1	1	5.500	.870	6.225
LT90300*	32930	3	3	1	1	6.000	.950	6.720
LT90350*	32935	3-1/2	3-1/2	1	1	6.625	.950	7.450
LT90400*	32940	4	4	1	1	7.000	.950	8.000

*Provided with insulated throat.



E60812 LR49636

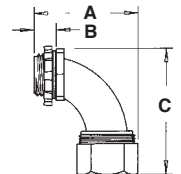

With Insulated Throat

CATALOG NUMBER	UPC/DCI/NAED MFG #01 8997	TRADE SIZE	KO SIZE	UNIT PKG	STD PKG	DIM A	DIM B	DIM C
LT9038A	32931	3/8	1/2	10	50	2.137	.595	2.340
LT9050A	32951	1/2	1/2	10	50	2.203	.595	2.312
LT9075A	32971	3/4	3/4	10	50	2.590	.585	2.664
LT90100A	32911	1	1	5	25	2.906	.750	3.640
LT90125A	32912	1-1/4	1-1/4	2	10	3.473	.775	3.912
LT90150A	32955	1-1/2	1-1/2	2	10	3.575	.679	4.368
LT90200A	32921	2	2	2	10	4.206	.755	4.865
LT90250	32925	2-1/2	2-1/2	1	1	5.000	.945	6.225
LT90300	32930	3	3	1	1	6.000	1.025	6.720
LT90350	32935	3-1/2	3-1/2	1	1	6.625	1.025	7.450
LT90400	32940	4	4	1	1	7.000	1.025	8.000



E60812 LR49636

