

Safety Switches Heavy Duty, Type TH

Spec-Setter™ Safety Switches

30-1200 Amperes

240 Volts AC

250 Volts DC

Section 2

Fusible, Three-pole, 240 Volts AC

Ampere Rating	Enclosure Type	HP, 240 Vac, NEC Std, 1-ph	HP, 240 Vac, NEC Std, 3-ph	HP, 240 Vac, Time Delay, 1-ph	HP, 240 Vac, Time Delay, 3-ph	HP, 125 Vdc	HP, 250 Vdc	Product Number	List Price GO-131
30A	NEMA Type 1	1 1/2	3	3	7 1/2	-	5	TH4321	\$203.00
60A	NEMA Type 1	3	7 1/2	10	15	5	10	TH4322	\$344.00
100A	NEMA Type 1	7 1/2	15	15	30	-	20	TH4323	\$542.00
200A	NEMA Type 1	15	25	-	60	-	40	TH4324	\$932.00
400A	NEMA Type 1	-	50	-	125	-	50	TH3325	\$2157.00
600A	NEMA Type 1	-	75	-	200	-	50	TH3326	\$3889.00
800A	NEMA Type 1	-	-	-	-	-	-	TC72367 ^{1,3}	\$9661.00
1200A	NEMA Type 1	-	-	-	-	-	-	TC72368 ^{1,3}	\$12688.00
30A	NEMA Type 3R	1 1/2	3	3	7 1/2	-	5	TH4321R	\$364.00
60A	NEMA Type 3R	3	7 1/2	10	15	5	10	TH4322R	\$573.00
100A	NEMA Type 3R	7 1/2	15	15	30	-	20	TH4323R	\$821.00
200A	NEMA Type 3R	15	25	-	60	-	40	TH4324R	\$1130.00
400A	NEMA Type 3R	-	50	-	125	-	50	TH3325R	\$2501.00
600A	NEMA Type 3R	-	75	-	200	-	50	TH3326R	\$5235.00
800A	NEMA Type 3R	-	-	-	-	-	-	TC72367R ^{2,3}	\$11966.00
1200A	NEMA Type 3R	-	-	-	-	-	-	TC72368R ^{2,3}	\$15546.00
30A	NEMA Type 4/4X	1 1/2	3	3	7 1/2	-	5	TH3321SS	\$1294.00
60A	NEMA Type 4/4X	3	7 1/2	10	15	5	10	TH3322SS	\$1597.00
100A	NEMA Type 4/4X	7 1/2	15	15	30	-	20	TH4323SS	\$3380.00
200A	NEMA Type 4/4X	15	25	-	60	-	40	TH4324SS	\$4733.00
400A	NEMA Type 4/4X	-	50	-	125	-	50	TH4325SS	\$9542.00
600A	NEMA Type 4/4X	-	75	-	200	-	50	TH4326SS	\$13570.00
30A	NEMA Type 5, 12	1 1/2	3	3	7 1/2	-	5	TH3321J	\$391.00
60A	NEMA Type 5, 12	3	7 1/2	10	15	5	10	TH3322J	\$551.00
100A	NEMA Type 5, 12	7 1/2	15	15	30	-	20	TH4323J	\$881.00
200A	NEMA Type 5, 12	15	25	-	60	-	40	TH4324J	\$1262.00
400A	NEMA Type 5, 12	-	50	-	125	-	50	TH4325J	\$2896.00
600A	NEMA Type 5, 12	-	75	-	200	-	50	TH4326J	\$4657.00

Fusible, Four-wire SN, 208/120 and 240 Volts AC

Ampere Rating	Enclosure Type	HP, 240 Vac, NEC Std, 1-ph	HP, 240 Vac, NEC Std, 3-ph	HP, 240 Vac, Time Delay, 1-ph	HP, 240 Vac, Time Delay, 3-ph	HP, 125 Vdc	HP, 250 Vdc	Product Number	List Price GO-131
30A	NEMA Type 1	1 1/2	3	3	7 1/2	-	5	TH4321	\$203.00
60A	NEMA Type 1	3	7 1/2	10	15	5	10	TH4322	\$344.00
100A	NEMA Type 1	7 1/2	15	15	30	-	20	TH4323	\$542.00
200A	NEMA Type 1	15	25	-	60	-	40	TH4324	\$932.00
400A	NEMA Type 1	-	50	-	125	-	50	TH4325	\$2391.00
600A	NEMA Type 1	-	75	-	200	-	50	TH4326	\$4116.00
800A	NEMA Type 1	-	-	-	-	-	-	TC72367 ^{1,3}	\$9661.00
								TNI67	\$490.00
1200A	NEMA Type 1	-	-	-	-	-	-	TC72368 ^{1,3}	\$12688.00
								TNI68A	\$675.00
30A	NEMA Type 3R	1 1/2	3	3	7 1/2	-	5	TH4321R	\$364.00
60A	NEMA Type 3R	3	7 1/2	10	15	5	10	TH4322R	\$573.00
100A	NEMA Type 3R	7 1/2	15	15	30	-	20	TH4323R	\$821.00
200A	NEMA Type 3R	15	25	-	60	-	40	TH4324R	\$1130.00
400A	NEMA Type 3R	-	50	-	125	-	50	TH3325R	\$2501.00
600A	NEMA Type 3R	-	75	-	200	-	50	TH3326R	\$5235.00
800A	NEMA Type 3R	-	-	-	-	-	-	TC72367R ^{2,3}	\$11966.00
								TNI67	\$490.00
1200A	NEMA Type 3R	-	-	-	-	-	-	TC72368R ^{2,3}	\$15546.00
								TNI68A	\$675.00
30A	NEMA Type 4/4X	1 1/2	3	3	7 1/2	-	5	TH4321SS	\$1355.00
60A	NEMA Type 4/4X	3	7 1/2	10	15	5	10	TH4322SS	\$1654.00
100A	NEMA Type 4/4X	7 1/2	15	15	30	-	20	TH4323SS	\$3380.00
200A	NEMA Type 4/4X	15	25	-	60	-	40	TH4324SS	\$4733.00
400A	NEMA Type 4/4X	-	50	-	125	-	50	TH4325SS	\$9542.00
600A	NEMA Type 4/4X	-	75	-	200	-	50	TH4326SS	\$13570.00
30A	NEMA Type 5, 12	1 1/2	3	3	7 1/2	-	5	TH4321J	\$445.00
60A	NEMA Type 5, 12	3	7 1/2	10	15	5	10	TH4322J	\$599.00
100A	NEMA Type 5, 12	7 1/2	15	15	30	-	20	TH4323J	\$881.00
200A	NEMA Type 5, 12	15	25	-	60	-	40	TH4324J	\$1262.00
400A	NEMA Type 5, 12	-	50	-	125	-	50	TH4325J	\$2896.00
600A	NEMA Type 5, 12	-	75	-	200	-	50	TH4326J	\$4657.00

240 Volts - No fuse or Four-pole, 240 Volts AC, Use 600-Volt switches on page 2-9 through 2-12.

For Type 1 Enclosure: 200-600 amp devices available factory reversed for bottom feed. Add "B" suffix to product number (e.g., TH3224B) List Price Adder \$44.00, GO-131A. UL Listed.

For Type 3R Enclosure: 30-200 amp devices have removable closing cap. Order hubs for these devices separately on page 2-28. Larger amp devices require field cut openings and customer-supplied hub.

¹Class L fuses are only applicable when used with 800 and 1200A Type TC Safety Switches (e.g. TC72367).

²Not CSA certified.

³Order switch and neutral separately



Safety Switches Enclosure Dimensions

Spec-Setter™ Safety Switches

TC, TDT, TPF and TPN

NEMA Type 1 and 3R Enclosures

Section 2

NEMA Type 1 TC Plug Fuse Approximate Dimensions in Inches Figure 1

Product Number	Dimension W	Dimension H	Dimension D	Dimension W2	KO Figure Number ¹
TPF130	4 3/8	7 5/8	2 1/2	4 3/8	17
TPF230	4 3/8	7 5/8	2 1/2	4 3/8	17

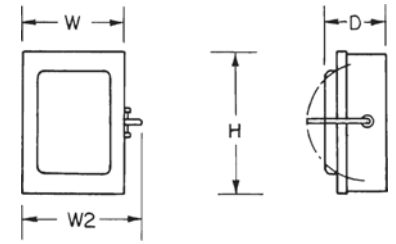

Figure 1

NEMA Type 1 TC Double Throw Approximate Dimensions in Inches Figure 1

Product Number	Dimension W	Dimension H	Dimension D	Dimension W2	KO Figure Number ¹
TC35321	10.37	15.81	5.33	12.04	7
TC35322	11.37	18.75	6.43	13.10	7
TC35323	14.37	22.37	8.06	16.12	9
TC35324	17.87	30.12	9.15	19.88	10
TC35325	24.40	34.31	10.52	26.94	10
TC35326	23.50	44.38	9.25	26.00	12
TC35362	11.37	18.75	6.43	13.10	7
TC35363	14.37	22.37	8.06	16.12	9
TC35364	17.87	30.12	9.15	19.88	10
TC35365	20.44	34.31	8.25	22.90	10
TC35366	23.50	44.38	9.25	26.00	12

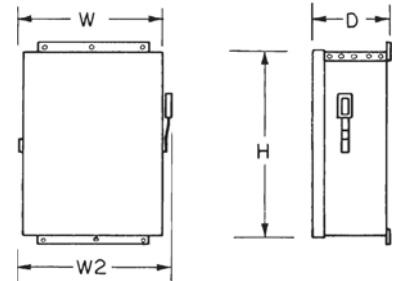

Figure 2

NEMA Type 3R TC Double Throw Approximate Dimensions in Inches Figure 1

Product Number	Dimension W	Dimension H	Dimension D	Dimension W2	KO Figure Number ¹
TC35321R	10.88	19.75	5.33	11.98	No KO
TC35322R	11.88	20.80	6.43	12.98	No KO
TC35323R	14.88	22.91	8.06	16.38	No KO
TC35324R	17.87	30.63	9.15	19.88	No KO
TC35325R	24.40	34.83	10.52	26.94	No KO
TC35362R	11.88	20.80	6.43	12.98	No KO
TC35363R	14.88	22.91	8.06	16.38	No KO
TC35364R	17.87	30.63	9.15	19.88	No KO

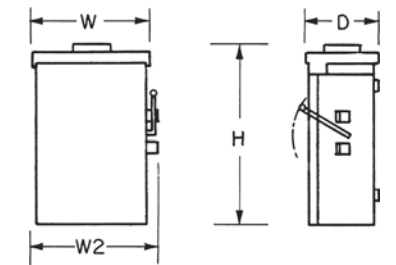

Figure 3

NEMA Type 1 TDT Fusible Double Throw Approximate Dimensions in Inches Figure 5

Product Number	Dimension W	Dimension H	Dimension D	Dimension W2	KO Figure Number ¹
TDT3321	-	37	9 7/8	12 3/4	No KO
TDT3322	-	37	9 7/8	12 3/4	No KO
TDT3323	-	37	9 7/8	12 3/4	No KO
TDT3324	-	51 3/8	11 1/4	20 3/8	No KO
TDT3325	-	74 3/4	14 1/8	26 1/8	No KO
TDT3326	-	86 1/8	14 1/8	28 1/4	No KO
TDT3361	-	37	9 7/8	12 3/4	No KO
TDT3362	-	37	9 7/8	12 3/4	No KO
TDT3363	-	37	9 7/8	12 3/4	No KO
TDT3364	-	51 3/8	11 1/4	20 3/8	No KO
TDT3365	-	74 3/4	14 1/8	26 1/8	No KO

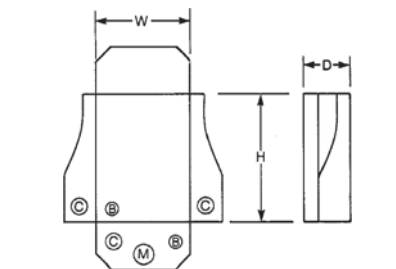

Figure 4

NEMA Type 1 TC 800 and 1200 Amp Approximate Dimensions in Inches Figure 2

Product Number	Dimension W	Dimension H	Dimension D	Dimension W2	KO Figure Number ¹
TC36367	32 1/4	52 1/2	12 1/2	34	No KO
TC36368	37 1/2	65 1/2	13 1/2	39 1/4	No KO
TC72267	41 3/4	62	12 1/2	43 1/2	No KO
TC72268	47 1/2	77	13 1/2	49 1/4	No KO
TC72367	41 3/4	62	12 1/2	43 1/2	No KO
TC72368	47 1/2	77	13 1/2	49 1/4	No KO

NEMA Type 3R TC Double Throw Approximate Dimensions in Inches Figure 3

Product Number	Dimension W	Dimension H	Dimension D	Dimension W2	KO Figure Number ¹
TC10323R	7 3/8	15 1/8	4	8 1/16	15
TC10324R	13 9/16	30	6 1/4	15 5/8	13
TC10424R	13 9/16	30	6 1/4	15 5/8	13

NEMA Type 3R TDT Fusible Double Throw Approximate Dimensions in Inches Figure 5

Product Number	Dimension W	Dimension H	Dimension D	Dimension W2	KO Figure Number ¹
TDT3321R	-	37	9 7/8	12 3/4	No KO
TDT3322R	-	37	9 7/8	12 3/4	No KO
TDT3323R	-	37	9 7/8	12 3/4	No KO
TDT3324R	-	51 3/8	11 1/4	20 3/8	No KO
TDT3363R	-	37	9 7/8	12 3/4	No KO
TDT3364R	-	51 3/8	11 1/4	20 3/8	No KO

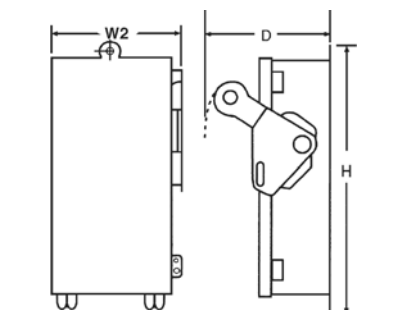

Figure 5

¹See page 2-37.



Publications and Reference: See Section 22 for a complete list of additional product-related publications