

Red•Dot® universal device covers



S310E-R



CCD / WR81-CN

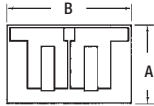

S305 / CCG / CCG-L / DCCG-BR / DCCG-WH

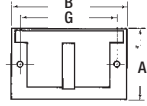

CCS / CCS-L

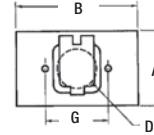

| Cat. No. | Description | A (in.) | B (in.) | D (in.) | G (in.) |
|------------------------------------------------------------|-----------------------------------------------------------|---------|---------|---------|---------|
| Single Gang Device Mount Covers – Horizontal (zinc) | | | | | |
| S310BRE | For duplex receptacle – Bronze | 2-27/32 | 4-9/16 | – | – |
| S310E-R | For duplex receptacle – Silver | 2-27/32 | 4-9/16 | – | – |
| S310WHE | For duplex receptacle – White | 2-27/32 | 4-9/16 | – | – |
| CCD-L | For duplex receptacle with lock option | 2-27/32 | 4-9/16 | – | – |
| WR81-CN | Natural cover with stay open lid | 2-27/32 | 4-9/16 | – | – |
| WRMB-87 | Cover, motor base with device | 2-27/32 | 4-9/16 | – | – |
| DCCDSO | For duplex receptacle with lock option stay open – Silver | 2-27/32 | 4-9/16 | – | – |
| S305BRE | For GFCI receptacle – Bronze | 2-27/32 | 4-9/16 | – | 3-13/16 |
| S305E | For GFCI receptacle – Silver | 2-27/32 | 4-9/16 | – | 3-13/16 |
| S305WHE | For GFCI receptacle – White | 2-27/32 | 4-9/16 | – | 3-13/16 |
| CCG | GFCI receptacle box cover | 2-27/32 | 4-9/16 | – | 3-13/16 |
| CCG-L | GFCI receptacle box cover with lock option | 2-27/32 | 4-9/16 | – | 3-13/16 |
| CCS | For single receptacle, horizontal | 2-13/16 | 4-9/16 | 1-1/2 | 2-3/8 |
| CCS-L | For single receptacle, horizontal with lock option | 2-13/16 | 4-9/16 | 1-1/2 | 2-3/8 |
| DCCG-BR | GFCI receptacle, horizontal – Bronze | 2-27/32 | 4-9/16 | – | 3-13/16 |
| DCCG-WH | GFCI receptacle, horizontal – White | 2-27/32 | 4-9/16 | – | 3-13/16 |



S309 / CCDV-L



S306 / CCGV-L / CCGV

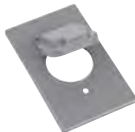
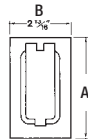

CCSV / CCSV-L

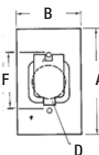

| Cat. No. | Description | A (in.) | B (in.) | D (in.) | F (in.) |
|----------------------------------------------------------|----------------------------------------|---------|---------|---------|---------|
| Single Gang Device Mount Covers – Vertical (zinc) | | | | | |
| S309BRE | For duplex receptacle – Bronze | 4-9/16 | 2-13/16 | – | – |
| S309E | For duplex receptacle – Silver | 4-9/16 | 2-13/16 | – | – |
| S309WHE | For duplex receptacle – White | 4-9/16 | 2-13/16 | – | – |
| CCDV-L | For duplex receptacle with lock option | 4-9/16 | 2-13/16 | – | – |
| S306BRE | For GFCI receptacle – Bronze | 4-9/16 | 2-13/16 | – | – |
| S306E | For GFCI receptacle – Silver | 4-9/16 | 2-13/16 | – | – |
| S306WHE | For GFCI receptacle – White | 4-9/16 | 2-13/16 | – | – |
| CCGV | GFCI Receptacle Box Cover – Silver | 4-9/16 | 2-13/16 | – | – |
| CCGV-L | For GFCI receptacle with lock option | 4-9/16 | 2-13/16 | – | – |
| CCSV | For single receptacle | 4-9/16 | 2-13/16 | 1-1/2 | 2-3/8 |
| CCSV-L | For single receptacle with lock option | 4-9/16 | 2-13/16 | 1-1/2 | 2-3/8 |

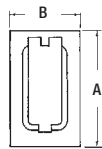

| Cat. No. | Description | A (in.) | B (in.) |
|------------------------------------------------------------------------|----------------------------------------------------------------------------------------------------------------------------|---------|---------|
| Single Gang Device Mount Cover – Horizontal and Vertical (zinc) | | | |
| DCCU† | Flip-lid cover - for GFCI, single, duplex or switch configuration supplied with 2 adapters and 2 screws, lockable – Silver | 4-9/16 | 2-13/16 |
| DCCU-BR† | Flip-lid cover - for GFCI, single, duplex or switch configuration supplied with 2 adapters and 2 screws, lockable – Bronze | 4-9/16 | 2-13/16 |
| DCCU-WH† | Flip-lid cover - for GFCI, single, duplex or switch configuration supplied with 2 adapters and 2 screws, lockable – White | 4-9/16 | 2-13/16 |

Raintight with cover closed and when used with appropriate Red Dot® boxes. † Lock not included.

Red•Dot® universal device covers

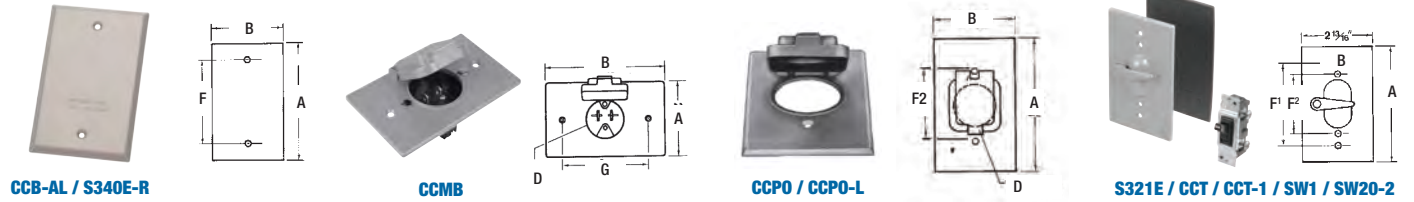

| Cat. No. | Description | A (in.) | B (in.) | F (in.) |
|----------------------------------------|------------------------------------------|---------|---------|---------|
| Single Gang Device Mount Covers | | | | |
| S340E-R | Blank cover (painted steel) – Silver | 4-9/16 | 2-13/16 | 3-9/32 |
| S340BRE-R-CN | Blank cover (painted steel) – Bronze | 4-9/16 | 2-13/16 | 3-9/32 |
| S340WHE-R-CN | Blank cover (painted steel) – White | 4-9/16 | 2-13/16 | 3-9/32 |
| CCB-AL | Blank cover (stamped aluminum) | 4-9/16 | 2-13/16 | 3-9/32 |
| DCCB-AL | Blank cover (stamped aluminum) – Propack | 4-9/16 | 2-13/16 | 3-9/32 |



| Cat. No. | Description | A (in.) | B (in.) | D (in.) | F1 (in.) | F2 (in.) | G (in.) |
|---------------------------------------------------------------|------------------------------------------------------------------------------------------|---------|---------|---------|----------|----------|---------|
| Couvercles un groupe pour montage sur appareils (zinc) | | | | | | | |
| CCMB | Motor base cover with 15 A, 125 V plug | 2-3/8 | 4-9/16 | 1-35/64 | - | - | 3-9/32 |
| CCPO | Power outlet cover for 30 A and 50 A receptacles box mount | 4-9/16 | 2-13/16 | 2-5/32 | - | 2-3/8 | - |
| CCPO-L | Power outlet cover for 30 A and 50 A receptacles box mount with lock option | 4-9/16 | 2-13/16 | 2-5/32 | - | 2-3/8 | - |
| S321E | For switch packed with spacers | 4-9/16 | 2-13/16 | 2-5/32 | 3-9/32 | 2-3/8 | - |
| CCT | Switch receptacle cover | 4-9/16 | 2-13/16 | 2-5/32 | 3-9/32 | 2-3/8 | - |
| CCT-1 | Switch cover with single pole switch 15 A, 125 V AC | 4-9/16 | 2-13/16 | 2-5/32 | 3-9/32 | 2-3/8 | - |
| CCT-1-20 | Switch cover with single pole 20A switch, 120 V, 277 V AC | 4-9/16 | 2-13/16 | 2-5/32 | 3-9/32 | 2-3/8 | - |
| SW1 | Switch box cover with lever switch. Single pole. 10 A 125 V | 4-9/16 | 2-13/16 | 2-5/32 | 3-9/32 | 2-3/8 | - |
| SW20-2 | Switch cover with double pole 20 A switch, 120 V, 277 V AC (all with spacers and screws) | 4-9/16 | 2-13/16 | 2-5/32 | 3-9/32 | 2-3/8 | - |

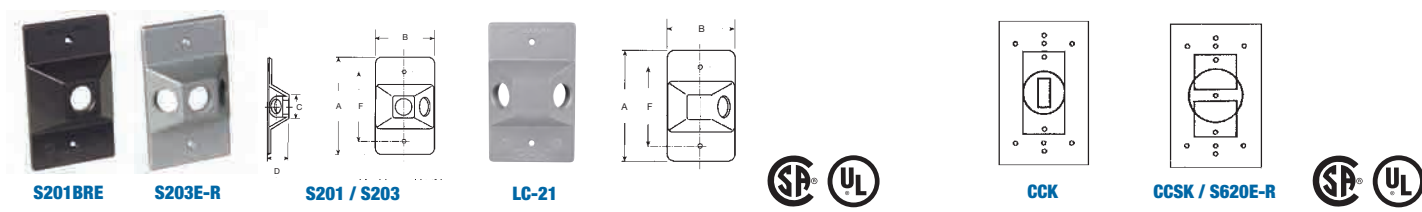

| Cat. No. | Description | A (in.) | B (in.) | C (in.) | D (in.) | F (in.) |
|---------------------------------------------|------------------------------------|---------|---------|---------|---------|---------|
| Lampholder Rectangular Covers (zinc) | | | | | | |
| S201E | One 1/2 in. tapped hole, grey | 4-9/16 | 2-13/16 | 1-5/32 | 1 | - |
| S201BRE | One 1/2 in. tapped hole, bronze | 4-9/16 | 2-13/16 | 1-5/32 | 1 | - |
| S201WHE | One 1/2 in. tapped hole, white | 4-9/16 | 2-13/16 | 1-5/32 | 1 | - |
| LC-21 | Two 1/2 in. tapped holes | 4-9/16 | 2-13/16 | 1-5/32 | 1 | 3-9/32 |
| S203E-R | Three 1/2 in. tapped holes, grey | 4-9/16 | 2-13/16 | 1-5/32 | 1 | 3-9/32 |
| S203BRE | Three 1/2 in. tapped holes, bronze | 4-9/16 | 2-13/16 | 1-5/32 | 1 | 3-9/32 |
| S203WHE | Three 1/2 in. tapped holes, white | 4-9/16 | 2-13/16 | 1-5/32 | 1 | 3-9/32 |

| Cat. No. | Description |
|----------------------------|-----------------|
| Single Gang Gaskets | |
| CCK | Neoprene gasket |
| CCSK | Neoprene gasket |
| S620E-R | Neoprene gasket |

Red•Dot® universal device covers



S410E / 2CCD / 2CCD-L

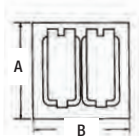

2CCS

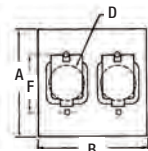

2CCSD



2CCSG / WR74-81C

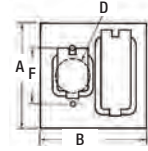

2CCT / 2CCT-1

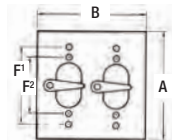

| Cat. No. | Description | A (in.) | B (in.) | D (in.) | F (in.) | F1 (in.) | F2 (in.) |
|--------------------------------------------|-----------------------------------------------------------------|---------|---------|---------|---------|----------|----------|
| Two Gang Device Mount Covers (zinc) | | | | | | | |
| S410E* | For two duplex receptacles | 4-9/16 | 4-5/8 | - | - | - | - |
| 2CCD | 2-duplex receptacle box cover | 4-9/16 | 4-5/8 | - | - | - | - |
| 2CCD-L* | For two duplex receptacles with lock option (lock not included) | 4-9/16 | 4-5/8 | - | - | - | - |
| 2CCS* | For two single receptacles | 4-9/16 | 4-5/8 | 1-31/64 | 2-3/8 | - | - |
| 2CCSD* | For single and duplex receptacles | 4-9/16 | 4-5/8 | 1-31/64 | 2-3/8 | - | - |
| 2CCSG* | For single and GFCI receptacles | 4-9/16 | 4-5/8 | 1-31/64 | 2-3/8 | - | - |
| WR74-81C | Cover, self-closing lids for single GFCI | 4-9/16 | 4-5/8 | - | - | - | - |
| 2CCT | Switch receptacle cover | 4-9/16 | 4-5/8 | - | - | 2-3/8 | 3-9/32 |
| 2CCT-1* | Switch cover with two single pole switches 15A, 125V AC | 4-9/16 | 4-5/8 | - | - | 2-3/8 | 3-9/32 |
| 2CCTD | Switch and one duplex receptacle cover | 4-9/16 | 4-5/8 | - | - | - | - |
| 2CCTD-1 | Switch and one duplex receptacle cover 15 A, 125 V | 4-9/16 | 4-5/8 | - | - | - | - |
| 2CCDG | One duplex and one GFCI receptacle | 3-11/16 | 3-3/4 | - | - | - | - |
| 2CCG | GFCI receptacle box cover-horizontal | 3-11/16 | 3-3/4 | - | - | - | - |
| WR281-CBR | Bronze cover self-closing lids | 4-9/16 | 4-5/8 | - | - | - | - |
| WR281-C-WH | White cover self-closing lids | 4-9/16 | 4-5/8 | - | - | - | - |
| R104 | Two Gang gasket | 4-9/16 | 4-5/8 | - | - | - | - |

*Raintight with cover closed and when used with appropriate Red Dot® boxes

Red•Dot® universal device covers

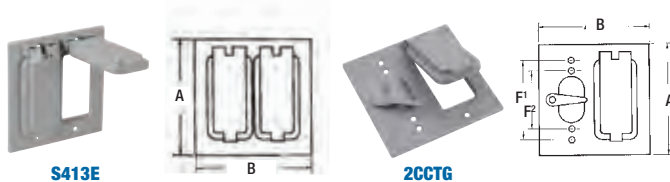

| Cat. No. | Description | A (in.) | B (in.) | F1 (in.) | F2 (in.) |
|------------------------------------------------------|---------------------------------------------|---------|---------|----------|----------|
| Two and Three Gang Device Mount Covers (zinc) | | | | | |
| S413E* | For two GFCI receptacles | 4-9/16 | 4-5/8 | – | – |
| 2CCTG* | For switch and GFCI receptacle with spacers | 4-9/16 | 4-5/8 | 3-9/32 | 2-3/8 |

*Raintight with cover closed and when used with appropriate Red Dot® boxes

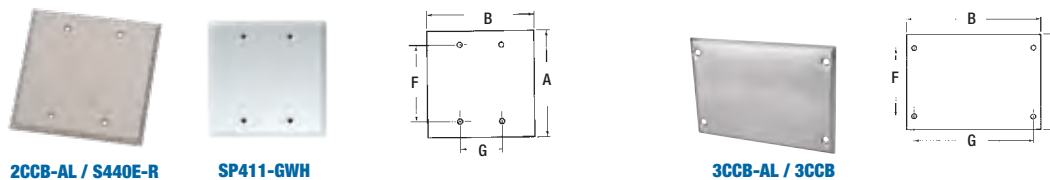

| Cat. No. | Description | A (in.) | B (in.) | F (in.) | G (in.) |
|------------------------------------------------------------------|---------------------------------------------------------------------|---------|---------|---------|---------|
| Two and Three Gang Device Mount Covers (Stamped Aluminum) | | | | | |
| S440E-R | Blank cover, two gang (stamped aluminum) – Grey | 4-9/16 | 4-5/8 | 3-9/32 | 1-13/16 |
| SP411-GWH | Blank cover, two gang (stamped aluminum) – White | 4-1/2 | 6-3/8 | 3-1/4 | 5-5/8 |
| 3CCB | Blank cover, three gang | 4-9/16 | 4-5/8 | 3-9/32 | 1-13/16 |
| 2CCB-AL | Blank cover, two gang (stamped aluminum) – with gasket and screws | 4-9/16 | 4-5/8 | 3-9/32 | 5-5/8 |
| 3CCB-AL | Blank cover, three gang (stamped aluminum) – with gasket and screws | 4-9/16 | 6-3/8 | 3-1/4 | 5-5/8 |

*Raintight with cover closed and when used with appropriate Red Dot® boxes

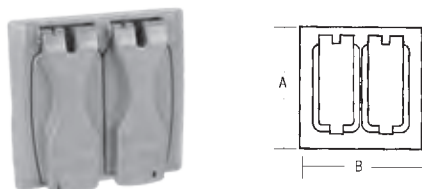

| Cat. No. | Colour | Description | A (in.) | B (in.) |
|-------------------------------|--------|------------------------------------------------------------------------------------------------------------------------------------|---------|---------|
| Two Gang Covers (zinc) | | | | |
| 2CCU | Silver | Flip-lid cover for GFCI, duplex or single switch configurations supplied with 4 adapters and 4 screws lockable (lock not included) | 4-9/16 | 4-5/8 |
| 2CCU-BR | Bronze | Flip-lid cover for GFCI, duplex or single switch configurations supplied with 4 adapters and 4 screws lockable (lock not included) | 4-9/16 | 4-5/8 |
| 2CCU-WH | White | Flip-lid cover for GFCI, duplex or single switch configurations supplied with 4 adapters and 4 screws lockable (lock not included) | 4-9/16 | 4-5/8 |