



Landscape Lighting

LED Product Supplement



PHILIPS
HADCO

Finishes and Materials

The Proper Fit and Finish

Some lighting fixtures should be statements unto themselves; others should blend into the environment they serve. A fixture that improperly stands out from its surroundings will distract from the artistry of the application. That's why choosing the right material and finish is just as important as choosing the right lamp.

To maximize your choices, Philips Hadco offers an assortment of materials in a spectrum of finishes, each painstakingly developed to harmonize and endure in naturally occurring environments.

Our ULTEM® High-Performance Polymer is a composite material that resists chipping, flaking and fading. Perfect for harsh environments, these composite fixtures are available in Black, Bronze and Verde ... ready to blend into common varieties of soil, mulch or vegetation.

Our die cast aluminum fixtures feature thermoset powdercoat finishes for lasting beauty and durability. In addition to Black, Bronze, Verde and White, other finishes are available for a variety of applications. Garden Green blends into darker vegetation and Speckled Stone takes its cues from the color palette of the desert. Each finish makes its own statement of style.

Designed to resemble concrete, our Limestone and Sand Stone finishes are developed with actual aggregate, which is bonded to cast aluminum and sanded for unmatched beauty and durability.

Our spun copper fixtures and cast brass fixtures are natural and will patina over time; or you can choose them pre-aged with oxidized finishes like Antique Copper or Oiled Brass. And for a natural finish that never loses its shine, we offer Stainless Steel.

Don't see your finish here? Don't worry. We have hundreds more standard colors ... plus color matching. Contact your Philips Hadco representative for more details.

ULTEM® is a registered trademark of General Electric Company.

*Standard options shown. Not available for all products.
Please consult ordering guide for details.

Brass



OB = Oiled Brass

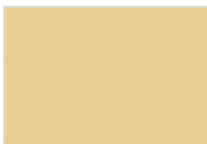

N = Natural Brass

Copper



Copper



AC = Antique Copper

Aluminum



A = Black

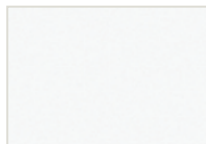

B = White



G = Verde



H = Bronze



I = Grey



K = Garden Green

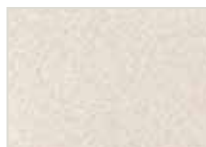

T = Speckled Stone

Composite



A = Black



G = Verde



H = Bronze



Philips Hadco LED Lighting

What is an LED?

Simply put, an LED, or Light Emitting Diode, is a diode that is chip-mounted in a reflector cup and held in place by a milled steel frame connected to a pair of electrical wires.

When current flows across the junction of the two different materials, light is produced from within the solid crystal chip.

Philips Hadco uses bright white LEDs as standard, which are developed by coating a blue LED with a phosphor, and thereby generating a white color.

Why use LED?

- LEDs provide a longevity that is up to 20 times that of standard incandescent lamps, translating to low maintenance.
- LEDs are solid-state devices, meaning no moving parts, glass or filaments to break.
- LEDs are small in size and resistant to vibration or shock.
- LEDs contain no mercury and are environmentally friendly.
- LEDs are more efficient, using up to 90% less energy than other light sources based on watts.



1020-H ALUMINUM BULLYTE

- 120 Volt
- PAR38 LED Lamp
- 1/2" NPS fitter

HOUSING – Cast aluminum construction with fully adjustable swivel arm with vibration-proof locking teeth.

FINISH – Bronze thermoset powdercoat finish.

LED – 18W lamp with 25° beam spread, 25,000 hours life. Color temperature (CCT): warm white (3,000K nominal). No Mercury.

(lamp only sold integral to 1020-H fixture)

SOCKET – Porcelain medium base.

WIRING – Pre-wired with high temperature #18 wire.

ETL, cETL listed.

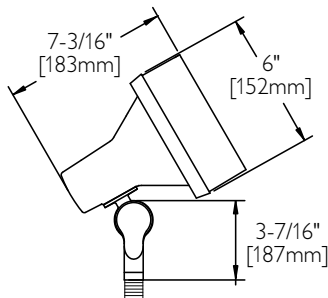

Catalog Number:	Finish: (H) Bronze	Lamp:	Optics: (NF) Narrow Flood	CCT: (W) Warm
1020	H	LED18	NF	W

* Lamp will be shipped with fixture, but not installed. Lamp not sold separately.



AAL1D ALUMINUM WALL WASHER

- 12 Volt
- 3.8 total watts (high power)
- 2.4 total watts (low power)
- 1/2" NPS fitter

HOUSING – Cast aluminum construction with fully-adjustable swivel arm with vibration-proof locking teeth.

FINISH – Black thermoset, hand-rubbed verde antiqued over black thermoset powdercoat.

LED – 3,000K or 4,000K color temperature (CCT). Approximately 50,000 hours of operation life (at 25°C ambient temp. and 70% lumen maintenance).

ELECTRICAL – Input voltage range (VAC): 10.8 - 13.2, regulated to 12V DC.

WIRING – Pre-wired with a 3-ft. pigtail and a quick connector for easy hookup to the low voltage supply cable.

IP RATING – LED module is IP66 dust tight and sealed against direct jets of water.

ETL and cETL listed.

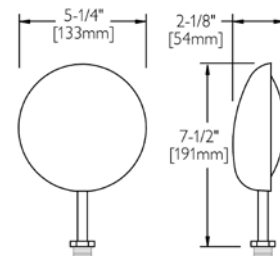

Catalog Number:	Lens: (C3) Cool High Power (C2) Cool Low Power (W3) Warm High Power (W2) Warm Low Power	Finish: (A) Black (G) Verde	Mount:
AAL1D	()	()	S7



AUL1D COMPOSITE WALL WASHER

- 12 Volt
- 3.8 total watts (high power)
- 2.4 total watts (low power)
- 1/2" NPS fitter

HOUSING – Injection molded ULTEM® High Performance Polymer composite with adjustable swivel arm with vibration-proof locking teeth.

FINISH – Color impregnated material in black, hand-rubbed verde antiqued over black.

LED – 3,000K or 4,000K color temperature (CCT). Approximately 50,000 hours of operation life (at 25°C ambient temp. and 70% lumen maintenance).

ELECTRICAL – Input voltage range (VAC): 10.8 - 13.2, regulated to 12V DC.

WIRING – Pre-wired with a 3-ft. pigtail and a quick connector for easy hookup to the low voltage supply cable.

IP RATING – LED module is IP66 dust tight and sealed against direct jets of water.

ETL and cETL listed.

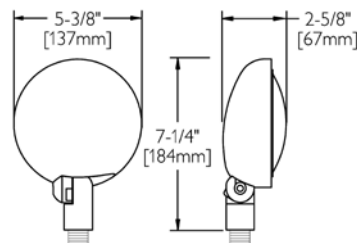

Catalog Number:	Lens:		Finish:	Mount:
	(C3) Cool High Power	(C2) Cool Low Power		
	(W3) Warm High Power	(W2) Warm Low Power	(A) Black	
			(G) Verde	
AUL1D	()		()	S7



B1 ALUMINUM BULLYTE

- 120 Volt
- PAR20 LED Lamp
- Shroud required
- 1/2" NPS fitter

HOUSING – Die-cast aluminum with fully-adjustable swivel arm with vibration-proof locking teeth.

SHROUDS – Die-cast aluminum, provided with lens and silicone O-ring. Either long or short shroud is required.

FINISH – Black or bronze thermoset powdercoat or hand-rubbed verde antiqued over black thermoset powdercoat.

LENS – Provided with optional shrouds only.

LED – 7W lamp with 25° beam spread, 25,000 hours life. Color temperature (CCT): cool white (4,000K nominal) or warm white (2,700K nominal). No Mercury.

(lamp only sold integral to B1 fixture)

SOCKET – High temperature porcelain medium base.

WIRING – Pre-wired with high temperature #18 wire.

ETL, cETL listed.

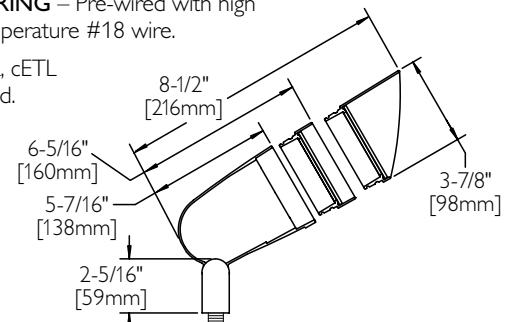

Catalog Number:	Finish:		Optics:	CCT:	Shroud:
	(A) Black	(G) Verde			
	(H) Bronze	Lamp:	(NF) Narrow Flood	(W) Warm	(S) Short
					(L) Long
B1	()	LED7	NF	()	()

* Lamp will be shipped with fixture, but not installed. Lamp not sold separately.



B4 ALUMINUM BULLYTE

- 120 Volt
- 1/2" NPS fitter
- PAR38 LED Lamp

HOUSING – Die-cast aluminum with fully-adjustable swivel arm and vibration-proof locking teeth.

SHROUDS – Die-cast aluminum, provided with lens and silicone O-ring. Either long or short shroud is required.

FINISH – Black thermoset, hand-rubbed verde antiqued over black thermoset powdercoat, or bronze thermoset powdercoat.

LENS – Clear flat tempered glass included with shroud.

LED – 18W lamp with 25° beam spread, 25,000 hours life. Color temperature (CCT): warm white (3,000K nominal). No Mercury.

(lamp only sold integral to B4 fixture)

ETL and cETL listed.

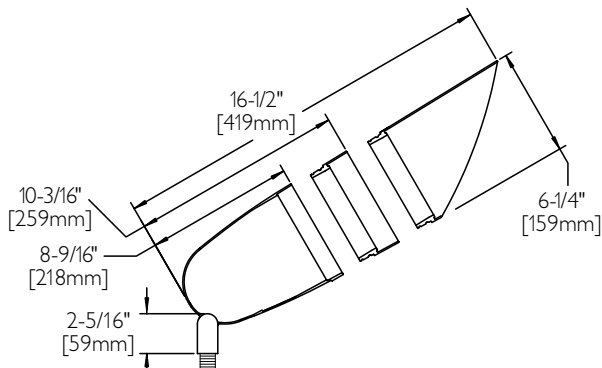

Catalog Number:	Finish: (A) Black (G) Verde (H) Bronze	Lamp:	Optics: (NF) Narrow Flood	CCT: (W) Warm	Shroud: (S) Short (L) Long
B4	()	LED18	NF	()	()

* Lamp will be shipped with fixture, but not installed. Lamp not sold separately.



B4 (LONG SHROUD) ALUMINUM BULLYTE

- 120 Volt
- 1/2" NPS fitter

HOUSING – Die-cast aluminum with fully-adjustable swivel arm and vibration-proof locking teeth.

FINISH – Black thermoset, hand-rubbed verde antiqued over black thermoset powdercoat, or bronze thermoset powdercoat.

LENS – Clear flat tempered glass included with shroud.

LED MODULE – 4,000K CCT or 3,000K CCT.

Approximately 50,000 hours of operational life (at 25C ambient temperature and 70% lumen maintenance). >80CRI.

ELECTRICAL MODULE – 13.7 watts consumed (total fixture consumption). Integral SmartSelect™ electronic driver 120-277 VAC 50-60hz auto sensing. Integral over-voltage, over-current and short circuit protection (auto-recovery).

OPTICS – Narrow, medium or wide optics.

IP RATING – IP66 Dust tight and sealed against direct jets of water.

LEDADP – Internal Accessory Adaptor Ring for B4 LED.

** Must order this adaptor ring if you order an internal accessory. See page 151 in the full Specification Guide for all available accessories.*

ETL and cETL listed.

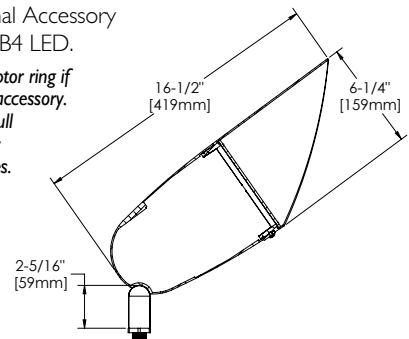

Catalog Number:	Optics: (M) Medium (N) Narrow (W) Wide	Size: (4)	CCT: (C) Cool (W) Warm	Accessories: (B) IBLR Iced Blue Lens (S) IBSLR Multidirect Spread Lens (L) ILSLR Linear Spread Lens (H) ICGR Honeycomb Louver (N) None	Finish: (A) Black (G) Verde (H) Bronze	Shroud: (L) Long
B	M	4	()	()	()	L
B	N	4	()	()	()	L
B	W	4	()	()	()	L



BL5016 ALUMINUM BULLYTE

- 12 Volt
- MR16 LED Lamp
- 1/2" NPS fitter

HOUSING – Die-cast marine grade aluminum alloy with fully-adjustable swivel arm with vibration-proof locking teeth.

SHROUD – Fully-rotatable, double gasketed, die-cast marine grade aluminum alloy.

FINISH – Black thermoset, hand-rubbed verde antiqued over black, bronze or speckled stone thermoset powdercoat.

LED – 5.5W lamp with 24° beam spread. Color temperature (CCT): warm white (2,700K nominal) 25,000 hours life.

7W lamp with 15°, 24° or 36° beam spread. Color temperature (CCT): cool white (4,000K nominal) or warm white (2,700K nominal) 25,000 hours life. No Mercury.

(lamp only sold integral to BL5016 fixture)

LENS – Clear tempered glass, affixed at 10° angle for natural cleaning.

WIRING – Pre-wired with a 3-ft. pigtail and a quick connector for easy hookup to the supply cable.

SOCKET – Bi-pin type (GU5.3).

ETL and cETL listed.

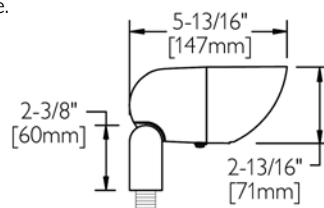

Catalog Number:	Finish: (A) Black (G) Verde (H) Bronze (T) Speckle Stone	Mount: (S7)	Lamp: LED7 LED4	Optics: (SP) Spot (NF) Narrow Flood (FL) Flood	CCT: (W) Warm (C) Cool
BL5016	()	S7	LED4	NF	W
BL5016	()	S7	LED7	()	W
BL5016	()	S7	LED7	FL	C

* Fixture will be shipped with lamp installed. Lamp not sold separately.



BL616 ALUMINUM BULLYTE

- 12 Volt
- MR16 LED Lamp
- 1/2" NPS fitter

HOUSING – Die-cast aluminum with fully-adjustable swivel arm with vibration-proof locking teeth.

SHROUD – Gasketed, cast aluminum.

FINISH – Black thermoset, hand-rubbed verde antiqued over black thermoset powdercoat or bronze, thermoset powdercoat.

LENS – Clear tempered glass.

LED – 5.5W lamp with 24° beam spread. Color temperature (CCT): warm white (2,700K nominal) 25,000 hours life.

7W lamp with 15°, 24° or 36° beam spread. Color temperature (CCT): cool white (4,000K nominal) or warm white (2,700K nominal) 25,000 hours life. No Mercury.

(lamp only sold integral to BL616 fixture)

WIRING – Prewired with a 3-ft. pigtail and a quick connector for easy hookup to the supply cable.

SOCKET – Bi-pin type (GU5.3).

ETL and cETL listed.

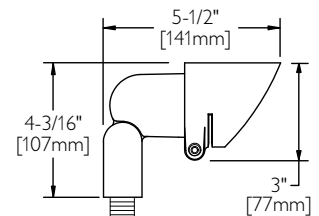

Catalog Number:	Finish: (A) Black (G) Verde (H) Bronze	Mount: (S7)	Lamp: LED7 LED4	Optics: (SP) Spot (NF) Narrow Flood (FL) Flood	CCT: (W) Warm (C) Cool
BL616	()	S7	LED4	NF	W
BL616	()	S7	LED7	()	W
BL616	()	S7	LED7	FL	C

* Fixture will be shipped with lamp installed. Lamp not sold separately.



BL7D1 ALUMINUM BULLYTE

- 12 Volt
- 1/2" NPS fitter
- 2.5 total watts

HOUSING – Die-cast aluminum with fully-adjustable swivel arm with vibration-proof locking teeth.

SHROUD – Fully-rotatable, gasketed, cast aluminum.

FINISH – Black thermoset, hand-rubbed verde antiqued over black thermoset powdercoat, or bronze thermoset powdercoat.

LENS – Clear or Frosted tempered glass.

LED – Color temperature (CCT): cool 6000K or warm 3000K. High Output LED, powered 350mA DC to operate for 50,000 hours.

ELECTRICAL – Input voltage range (VAC): 10.8-17.5, regulated to 12V DC. Integral surge protector. (Magnetic low voltage transformer required)

WIRING – Pre-wired with a 3-ft. pigtail and a quick connector for easy hookup to the supply cable.

ETL and cETL listed.

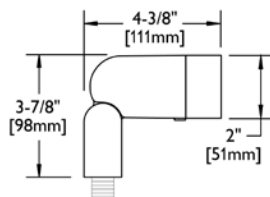

Catalog Number:	Lens: (C) Clear Lens (F) Frosted Lens	CCT: (W) Warm (C) Cool	Finish: (A) Black (G) Verde (H) Bronze	Mount:
BL7D1	()	()	()	S7



BT1 ALUMINUM BULLYTE

- 120 Volt
- MR16 LED Lamp
- 1/2" NPS fitter
- Integral stepdown transformer

HOUSING – Die-cast aluminum with fully-adjustable swivel arm, with vibration-proof locking teeth.

SHROUD – Fully-rotatable, gasketed, cast aluminum.

FINISH – Black or bronze thermoset powdercoat.

LENS – Clear, tempered glass.

LED – 5.5W lamp with 24° beam spread. Color temperature (CCT): warm white (2,700K nominal). 7W lamp with 15°, 24° or 36° beam spread, 25,000 hours life. Color temperature (CCT): cool white (4,000K nominal) or warm white (2,700K nominal). No Mercury.

(lamp only sold integral to BT1 fixture)

SOCKET – Ceramic bi-pin (GU5.3).

ELECTRICAL – Stepdown transformer reduces line voltage to 12 volts. Transformer is potted/encapsulated and features thermal overload protection. Can be used with energy-efficient halogen lamp.

WIRING – Pre-wired with #18 AWG black, white and ground.

ETL and cETL listed.

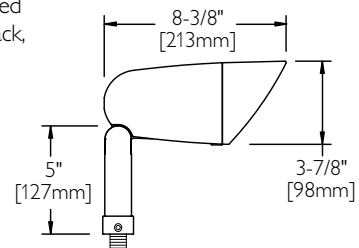

Catalog Number:	Finish: (A) Black (H) Bronze	Lamp: LED7 LED4	Optics: (SP) Spot (NF) Narrow Flood (FL) Flood	CCT: (W) Warm (C) Cool	Shroud (L) Long (S) Short
BT1	()	LED4	NF	W	()
BT1	()	LED7	()	W	()
BT1	()	LED7	FL	C	()

* Fixture will be shipped with lamp installed. Lamp not sold separately.



BT5016 ALUMINUM

- 120 Volt
- MR16 LED Lamp
- 1/2" NPS fitter
- Integral stepdown transformer

HOUSING – Die-cast marine-grade aluminum with fully-adjustable swivel arm and vibration-proof locking teeth.

SHROUD – Fully-rotatable, gasketed, cast marine-grade aluminum.

FINISH – Black thermoset, hand-rubbed verde antiqued over black thermoset powdercoat, or bronze thermoset powdercoat.

LENS – Clear tempered glass affixed at 10° angle for natural cleaning.

LED – 5.5W lamp with 24° beam spread. Color temperature (CCT): warm white (2,700K nominal). 7W lamp with 15°, 24° or 36° beam spread, 25,000 hours life. Color temperature (CCT): cool white (4,000K nominal) or warm white (2,700K nominal). No Mercury.

(lamp only sold integral to BT5016 fixture)

SOCKET – Ceramic bi-pin (GU5.3).

ELECTRICAL – Stepdown transformer reduces line voltage to 12 volts. Transformer is potted/encapsulated and features thermal overload protection. Can be used with energy-efficient halogen lamp.

WIRING – Pre-wired with #18 AWG black, white and ground.

ETL and cETL listed.

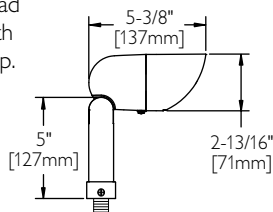

Catalog Number:	Finish: (A) Black (H) Bronze	Lamp: LED7 LED4	Optics: (SP) Spot (NF) Narrow Flood (FL) Flood	CCT: (W) Warm (C) Cool
BT5016	()	LED4	NF	W
BT5016	()	LED7	()	W
BT5016	()	LED7	FL	C

* Fixture will be shipped with lamp installed. Lamp not sold separately.



B3 ALUMINUM

- 120 Volt
- 1/2" NPS fitter
- PAR30 LED Lamp
- Long shroud included

HOUSING – One-piece injection molded Ultem® High Performance Polymer with fully-adjustable swivel arm with vibration-proof locking teeth.

FINISH – Color impregnated material in black or bronze, hand-rubbed verde antiqued over black.

LENS – Provided with optional shrouds only.

LED – 12W lamp with 15° or 22° beam spread, 25,000 hours life. Color temperature (CCT): cool white (4,000K nominal) or warm white (2,700K nominal). No Mercury.

or

13W lamp with 25° beam spread, 25,000 hours life. Color temperature (CCT): warm white (2,700K nominal). No Mercury.

(lamp only sold integral to B3 fixture)

SOCKET – High temperature porcelain medium base.

WIRING – Pre-wired with high temperature #18 wire.

ETL and cETL listed.

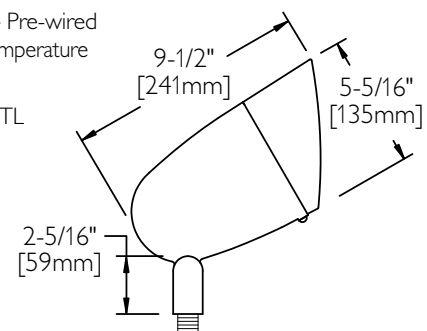

Catalog Number:	Finish: (A) Black (G) Verde (H) Bronze	Lamp: LED12 LED13	Optics: (SP) Spot (NF) Narrow Flood (FL) Flood	CCT: (W) Warm (C) Cool
B3	()	LED12	FL	C
B3	()	LED12	(SP, NF)	W
B3	()	LED13	NF	W

* Lamp will be shipped with fixture, but not installed. Lamp not sold separately.



BU3 COMPOSITE

- 120 Volt
- PAR30 LED Lamp
- 1/2" NPS fitter
- Long shroud included

HOUSING – One-piece injection molded Ultem® High Performance Polymer with fully-adjustable swivel arm with vibration-proof locking teeth.

FINISH – Color impregnated material in black or bronze, hand-rubbed verde antiqued over black.

LENS – Provided with optional shrouds only.

LED – 12W lamp with 15° or 22° beam spread, 25,000 hours life. Color temperature (CCT): cool white (4,000K nominal) or warm white (2,700K nominal). No Mercury. Or 13W lamp with 25° beam spread, 25,000 hours life. Color temperature (CCT): warm white (2,700K nominal). No Mercury.

(lamp only sold integral to BU3 fixture)

SOCKET – High temperature porcelain medium base.

WIRING – Pre-wired with high temperature #18 wire.

ETL and cETL listed.

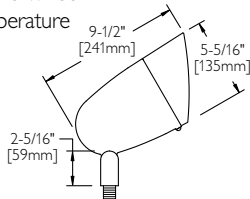

Catalog Number:	Finish: (A) Black (G) Verde (H) Bronze	Lamp: LED12 LED13	Optics: (SP) Spot (NF) Narrow Flood (FL) Flood	CCT: (W) Warm (C) Cool
BU3	()	LED12	FL	C
BU3	()	LED12	(SP, NF)	W
BU3	()	LED13	NF	W

* Lamp will be shipped with fixture, but not installed. Lamp not sold separately.



BUL16 COMPOSITE

- 12 Volt
- MR16 LED Lamp
- 1/2" NPS fitter
- Clear Tempered Lens

HOUSING – One-piece injection molded ULTEM® High Performance Polymer with fully-adjustable swivel arm with vibration-proof locking teeth.

SHROUD – Fully-rotatable, gasketed, ULTEM® High Performance Polymer composite.

FINISH – Color impregnated material in black, bronze, or hand-rubbed verde antiqued over black.

LENS – Clear tempered glass affixed at 10° angle for natural cleaning.

LED – 5.5W lamp with 24° beam spread, 25,000 hours life. Color temperature (CCT): warm white (2,700K nominal). No Mercury.

(lamp only sold integral to BUL16 fixture)

WIRING – Pre-wired with a 3-ft. pigtail and a quick connector for easy hookup to the supply cable.

SOCKET – Bi-pin type (GU5.3).

ETL and cETL listed.

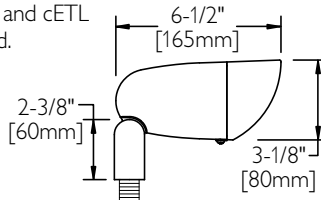

Catalog Number:	Finish: (A) Black (G) Verde (H) Bronze	Mount: (S7)	Lamp:	Optics: (NF) Narrow Flood	CCT: (W) Warm
BUL16	()	S7	LED4	NF	W

* Fixture will be shipped with lamp installed. Lamp not sold separately.



CUL16 COPPER

- 12 Volt
- MR16 LED Lamp
- 1/2" NPS fitter

HOUSING/MATERIAL – Machined solid copper with fully-adjustable natural brass swivel arm and brass fastener.

FINISH – Natural copper will age to a fine patina.

LENS – Clear tempered glass.

LED – 5.5W lamp with 24° beam spread, 25,000 hours life. Color temperature (CCT): warm white (2,700K nominal). No Mercury.

(lamp only sold integral to CUL16 fixture)

WIRING – Prewired with a 3-ft. pigtail and a quick connector for easy hookup to the supply cable.

SOCKET – Bi-pin type (G4)

ETL and cETL listed.

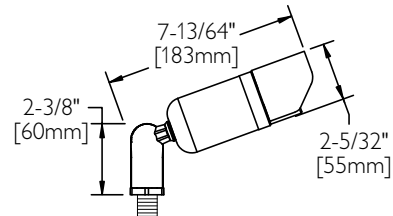

Catalog Number:	Mount:	Lamp:	Optics: (NF) Narrow Flood	CCT: (W) Warm
CUL16	S7	LED4	NF	W

* Fixture will be shipped with lamp installed. Lamp not sold separately.



MA3

ALUMINUM PATHLYTE

- 120 Volt
- 6.4 total watts
- 1/2" NPS fitter

HOUSING – Precision machined aluminum from 6061-T6 material. Stainless Steel fasteners.

FINISH – Black or Bronze thermoset powdercoat.

LED – 3000K or 4000K color temperature (CCT). Approximately 35,000 hours of operational life (at 30°C ambient temperature and 70% lumen maintenance).

OPTICS – Two beam spreads (spot - 20°, flood - 40°).

WIRING – Pre-wired with high temperature #18 wire. Input voltage range (VAC) 120-277.

IP RATING – IP65 Completely dust-tight & sealed to withstand low pressure jets of water from any direction.

ETL, cETL listed.

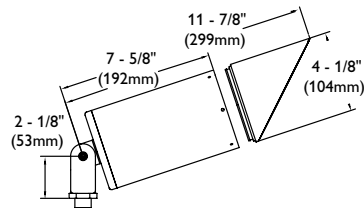

MA5

ALUMINUM PATHLYTE

- 12 Volt
- 6.2 total watts (high power)
- 5.1 total watts (low power)
- 1/2" NPS fitter

HOUSING – Precision machined aluminum from 6061-T6 material. Stainless Steel fasteners.

FINISH – Black or Bronze thermoset powdercoat.

LED – 3000K or 4000K color temperature (CCT). Approximately 35,000 hours of operational life (at 30°C ambient temperature and 70% lumen maintenance).

OPTICS – Three beam spreads. (spot - 23° degree, medium - 30°, flood - 54°)

ELECTRICAL – Input voltage range (VAC): 10 - 14, regulated to 12V DC.

WIRING – Pre-wired with a 3-ft. pigtail and a quick connector for easy hookup to the low voltage supply cable.

IP RATING – IP65 Completely dust-tight & sealed to withstand low pressure jets of water from any direction.

ETL, cETL listed.

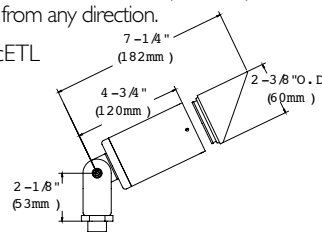

MA7

ALUMINUM PATHLYTE

- 12 Volt
- 1.6 total watts
- 1/2" NPS fitter

HOUSING – Precision machined aluminum from 6061-T6 material. Stainless Steel fasteners.

FINISH – Black or Bronze thermoset powdercoat.

LED – 3000K or 4000K color temperature (CCT). Approximately 35,000 hours of operational life (at 30°C ambient temperature and 70% lumen maintenance).

OPTICS – Module features dome lens and intergrated 100° beam pattern optics.

ELECTRICAL – Input voltage range (VAC): 10 - 14, regulated to 12V DC.

WIRING – Pre-wired with a 3-ft. pigtail and a quick connector for easy hookup to the low voltage supply cable.

IP RATING – IP65 Completely dust-tight & sealed to withstand low pressure jets of water from any direction.

ETL, cETL listed.

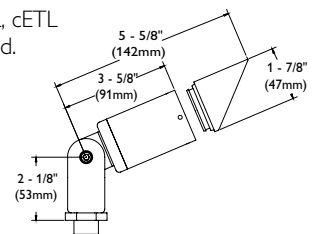

Catalog Number:	Optics: (SP) Spot (NF) Narrow Flood (FL) Flood	Source: (D) LED (DL) low-output (DH) high-output	CCT: (W) Warm - 3000K (C) Cool - 4000K	Finish: (A) Black (H) Bronze	Shroud (optional): (L) Long-45°	Stake: (S7)
MA3	(SP, FL)	D	()	()	L	-
MA5	()	(DL, DH)	()	()	L	S7
MA7	-	D	()	()	L	S7



DL1D ALUMINUM DOWNLYTE

- 12 Volt
- 3.8 total watts (high power)
- 2.4 total watts (low power)

HOUSING – Cast aluminum top cap with aluminum body and 5-ft. stainless suspension cable.

FINISH – Black thermoset powdercoat or hand-rubbed verde antiqued over black thermoset powdercoat.

LED – 3,000K or 4,000K color temperature (CCT). Approximately 50,000 hours of operation life (at 25°C ambient temp. and 70% lumen maintenance).

WIRING – Pre-wired with a 8-ft. pigtail and a quick connector for easy hookup to the low voltage supply cable.

IP RATING – IP66 Dust tight and sealed against direct jets of water.

ELECTRICAL – Input voltage range (VAC): 10.8 - 13.2, regulated to 12V DC.

ETL and cETL listed.

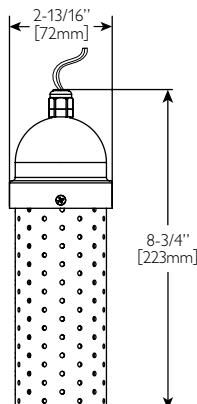

Catalog Number:	LED: (C3) Cool 6.4 Watt (W3) Warm 6.4 Watt (C2) Cool 3.7 Watt (W2) Warm 3.7 Watt	Finish: (A) Black (G) Verde
DL1D	()	()



DRL1 ALUMINUM DOWNLYTE

- 12 Volt
- MR16 LED Lamp

HOUSING – Cast aluminum top cap with aluminum body and 5-ft. stainless suspension cable.

FINISH – Black thermoset powdercoat or hand-rubbed verde antiqued over black thermoset powdercoat.

LED – 5.5W lamp with 24° beam spread. Color temperature (CCT): warm white (2,700K nominal). 7W lamp with 15°, 24° or 36° beam spread, 25,000 hours life. Color temperature (CCT): cool white (4,000K nominal) or warm white (2,700K nominal). No Mercury.

(lamp only sold integral to DRL1 fixture)

LENS – Clear tempered glass.

SOCKET – Bi-pin type (GU5.3).

WIRING – Pre-wired with 8-ft. pigtail and a quick connector for easy hookup to the low voltage supply cable.

ETL and cETL listed.

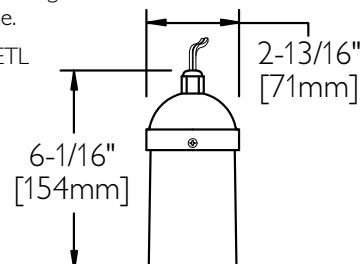

Catalog Number:	Finish: (A) Black (G) Verde	Lamp:	Optics: (SP) Spot (NF) Narrow Flood (FL) Flood	CCT: (W) Warm (C) Cool
DRL1	()	LED4	NF	W
DRL1	()	LED7	()	W
DRL1	()	LED7	FL	C

* Fixture will be shipped with lamp installed. Lamp not sold separately.



DRL1D ALUMINUM DOWNLYTE

- 12 Volt
- 3.8 total watts (high power)
- 2.4 total watts (low power)

HOUSING – Cast aluminum top cap with aluminum body and 5-ft. stainless suspension cable.

FINISH – Black thermoset powdercoat or hand-rubbed verde antiqued over black thermoset powdercoat.

LED – 3,000K or 4,000K color temperature (CCT). Approximately 50,000 hours of operation life (at 25°C ambient temp. and 70% lumen maintenance).

WIRING – Pre-wired with a 8-ft. pigtail and a quick connector for easy hookup to the low voltage supply cable.

IP RATING – IP66 Dust tight and sealed against direct jets of water.

ELECTRICAL – Input voltage range (VAC): 10.8 - 13.2, regulated to 12V DC.

ETL and cETL listed.

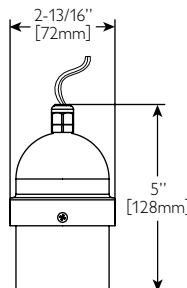

Catalog Number:	LED: (C3) Cool 6.4 Watt (W3) Warm 6.4 Watt (C2) Cool 3.7 Watt (W2) Warm 3.7 Watt	Finish: (A) Black (G) Verde
DRL1D	()	()



DRL2 ALUMINUM DOWNLYTE

- 12 Volt
- MR16 LED Lamp

HOUSING – Cast aluminum top cap with aluminum body and adjustable mounting yoke.

FINISH – Black thermoset powdercoat or hand-rubbed verde antiqued over black thermoset powdercoat.

LENS – Clear tempered glass.

LED – 5.5W lamp with 24° beam spread. Color temperature (CCT): warm white (2,700K nominal). 7W lamp with 15°, 24° or 36° beam spread, 25,000 hours life. Color temperature (CCT): cool white (4,000K nominal) or warm white (2,700K nominal). No Mercury.

(lamp only sold integral to DRL2 fixture)

SOCKET – Bi-pin type (GU5.3).

WIRING – Pre-wired with 3-ft. pigtail and a quick connector for easy hookup to the supply cable.

ETL and cETL listed.

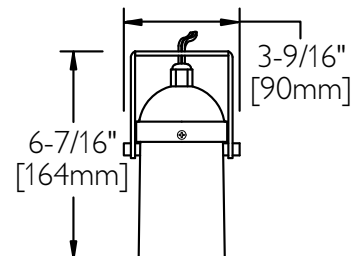

Catalog Number:	Finish: (A) Black (G) Verde	Lamp:	Optics: (SP) Spot (NF) Narrow Flood (FL) Flood	CCT: (W) Warm (C) Cool
DRL2	()	LED4	NF	W
DRL2	()	LED7	()	W
DRL2	()	LED7	FL	C

* Fixture will be shipped with lamp installed. Lamp not sold separately.



i1.5 COMPOSITE INGROUND BRONZE or STAINLESS STEEL TRIM RING

- 120 Volt
- 17 total watts consumed
- MR16 LED Lamp
- PAR30S LED Lamp

HOUSING – Single-piece compression molded, fiberglass reinforced polyester composite housing. Separate sealed compartments. Potted factory seal with anti-wicking wiring. Hinged lens ring with captive lens and fasteners. Only two fasteners required to secure lens ring. UL Listed silicone-filled wire nuts provided—no encapsulant required.

TRIM RING – Natural cast bronze or cast stainless steel. Secured with stainless steel screws. *(Supplied Standard)*

ROCK GUARD – Natural cast bronze or cast stainless steel. Secured with stainless steel screws. *(Sold Separately)*

HALF DOME – Field adjustable for directional glare control. Natural cast bronze or cast stainless steel. Secured with stainless steel screws. *(Sold Separately)*

LENS – Clear convex, tempered borosilicate for high-impact resistance. 3,000 lb live-load rated, drive-over.

LED LAMP

10W lamp with 15° or 36° beam spread. Color temp. (CCT): cool white (4,000K nominal) or warm white (2,700 nominal). 25,000 hours life. No Mercury.

13W lamp with 10° beam spread. Color temp. (CCT): warm white (2,700K nominal). 25,000 hours life. No Mercury.

12W lamp with 22° or 25° beam spread. Color temp. (CCT): cool white (4,000K nominal) or warm white (2,700K nominal). 25,000 hours life. No Mercury.

(lamp only sold integral to i1.5 fixture)

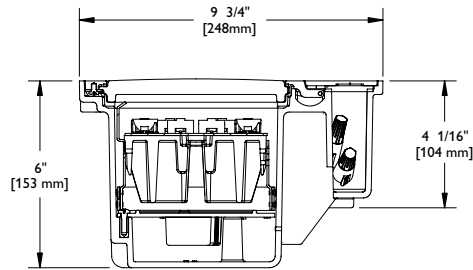

GASKET – Gasket for lens assembly is a single-piece wrap around molded 100% silicone. Gasket for junction box cover is single-piece die-cut neoprene.

SOCKET – Incandescent MR16: Bi-pin. Incandescent PAR30 Short EnduraLED: Medium Base.

OPTICS – LED module is available with spot, narrow flood or flood beam pattern. EnduraLED lamps: spot or flood beam pattern.

ELECTRICAL – LED module is a key-slotted ballast assembly with quick disconnects mounted to cast aluminum bracket for easy maintenance. e-Vision® electronic ballasts automatically detect 120-277 volts, 50/60 Hz, HPF. Ballasts provide ± 5% lamp power regulation with ± 10% input voltage regulation. Incandescent (MR16) - utilizes stepdown transformer.

AIMING – 15° either side of vertical and full 360° rotation. Angle degree marks for precise vertical aiming with tool-less aim.

ADA COMPLIANT – Compliant when used in concrete and flush-mounted with CPS15.

IP RATING – IP66/68 to 1M (3.28FT): Dust-tight and dual rated—sealed against direct jets of water and against continuous immersion up to a depth of 1 meter (3.28 feet).

ETL and cETL listed.

Catalog Number:	Finish: (N) Cast Bronze (SS) Stainless Steel	Optics: (SP) Spot (NF) Narrow Flood (FL) Flood	CCT: (W) Warm (C) Cool
i1.5	()	SP	()
i1.5	()	NF	()
i1.5	()	FL	()

* NOTE: Must order LEDADP, Adaptor Ring if ordering an internal accessory.

Catalog Number:	Finish: (N) Cast Bronze (SS) Stainless Steel	Output: (SP) Spot (FL) Flood	CCT: (W) Warm (C) Cool	Voltage:	Watt/Lamp:
i1.5-NLED13	N	SP	W	120	13W/LED PAR30 Short
i1.5-SSLED13	SS	SP	W	120	13W/LED PAR30 Short
i1.5-NLED13	N	FL	(C, W)	120	13W/LED PAR30 Short
i1.5-SSLED13	SS	FL	(C, W)	120	13W/LED PAR30 Short
i1.5-NLED10	N	SP	W	(120, 277)	10W/LED MR16, BI-PIN
i1.5-SSLED10	SS	SP	W	(120, 277)	10W/LED MR16, BI-PIN
i1.5-NLED10	N	FL	(C, W)	(120, 277)	10W/LED MR16, BI-PIN
i1.5-SSLED10	SS	FL	(C, W)	(120, 277)	10W/LED MR16, BI-PIN

Fixtures with PAR30 LED lamp will be shipped with fixture loose, not installed.
Fixtures with MR16 lamp will be shipped with lamp installed. Lamps not sold separately.

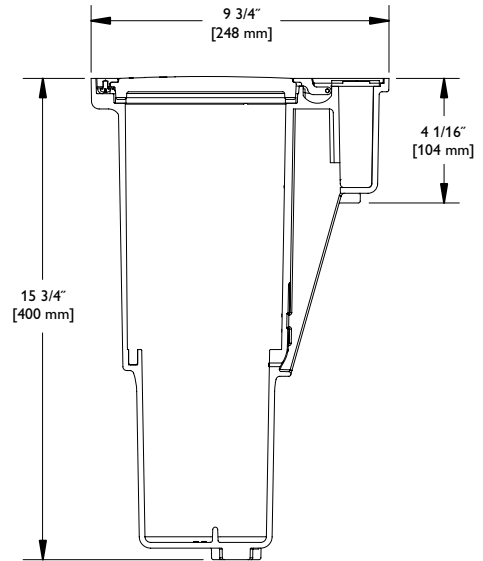

i2.5 COMPOSITE INGROUND BRONZE or STAINLESS STEEL TRIM RING

- 120 Volt • 17 total watts consumed
- PAR30L LED Lamp

HOUSING – Single-piece compression molded, fiberglass reinforced polyester composite housing. Separate sealed compartments. Potted factory seal with anti-wicking wiring. Hinged lens ring with captive lens and fasteners. Only two fasteners required to secure lens ring. UL Listed silicone-filled wire nuts provided – no encapsulant required.

TRIM RING – Natural cast bronze or cast stainless steel. Secured with stainless steel screws. *(Supplied Standard)*

ROCK GUARD – Natural cast bronze or cast stainless steel. Secured with stainless steel screws. *(Sold Separately)*

HALF DOME – Field adjustable for directional glare control. Natural cast bronze or cast stainless steel. Secured with stainless steel screws. *(Sold Separately)*

LENS – Clear convex, tempered borosilicate for high-impact resistance. 3,000 lb live-load rated, drive-over.

LED LAMP – 12W lamp with 15° or 22° beam spread, 25,000 hours life. Color temperature (CCT): cool white (4,000K nominal) or warm white (2,700 nominal). No Mercury. 13W lamp with 25° beam spread, 25,000 hours life. Color temperature (CCT): warm white (2,700K nominal). No Mercury.

(lamp only sold integral to i2.5 fixture)

LED MODULE – 4,000K CCT or 3,000K CCT. Approximately 50,000 hours of operational life (at 25C ambient temperature and 70% lumen maintenance). >80CRI.

GASKET – Gasket for lens assembly is a single-piece wrap around molded 100% silicone. Gasket for junction box cover is single-piece die-cut neoprene.

SOCKET – Incandescent PAR30 Long EnduraLED: Medium Base.

OPTICS – LED module is available with spot, narrow flood or flood beam pattern. EnduraLED lamps: spot or flood beam pattern.

ELECTRICAL – LED module is a key-slotted ballast assembly with quick disconnects mounted to cast aluminum bracket for easy maintenance. e-Vision® electronic ballasts automatically detect 120-277 volts, 50/60 Hz, HPF. Ballasts provide ± 5% lamp power regulation with ± 10% input voltage regulation. Incandescent (MR16) - utilizes stepdown transformer.

AIMING – 15° either side of vertical and full 360° rotation. Angle degree marks for precise vertical aiming with tool-less aim.

ADA COMPLIANT – Compliant when used in concrete and flush-mounted with CPS15.

IP RATING – IP66/68 to 1M (3.28FT): Dust-tight and dual rated – sealed against direct jets of water and against continuous immersion up to a depth of 1 meter (3.28 feet).

ETL and cETL listed.

Catalog Number:	Finish: (N) Cast Bronze (SS) Stainless Steel	Lamp:	Optics: (SP) Spot (NF) Narrow Flood (FL) Flood	CCT: (W) Warm (C) Cool
i2.5	()	–	SP	()*
i2.5	()	–	NF	()*
i2.5	()	–	FL	()*
i2.5	()	LED12	SP	W
i2.5	()	LED12	NF	C
i2.5	()	LED13	NF	W

* NOTE: Must order LEDADP, Adaptor Ring if ordering an internal accessory.
Fixtures with PAR30 LED lamp will be shipped with fixture loose, not installed. Lamps not sold separately.



i3.5 COMPOSITE INGROUND BRONZE TRIM RING

- 120 Volt
- PAR38 LED Lamp

HOUSING – Single-piece compression molded, fiberglass reinforced polyester composite housing. Separate sealed compartments. Potted factory seal with anti-wicking wiring. Hinged lens ring with captive lens and fasteners. UL Listed silicone-filled wire nuts provided—no encapsulant required.

TRIM RING – Natural cast bronze. Secured with stainless steel screws. *(Supplied Standard)*

ROCK GUARD – Natural cast bronze. Secured with stainless steel screws. *(Sold Separately)*

LENS – Clear convex, tempered borosilicate for high-impact resistance. 3,000 lb live-load rated, drive-over.

LED LAMP – 18W lamp with 25° beam spread. Color temp.(CCT): warm white (3,000K nominal) 25,000 hours life. No Mercury.

(lamp only sold integral to i3.5 fixture)

LED MODULE – 4,000K CCT or 3,000K CCT. Approximately 50,000 hours of operational life (at 25°C ambient temperature and 70% lumen maintenance). >80CRI.

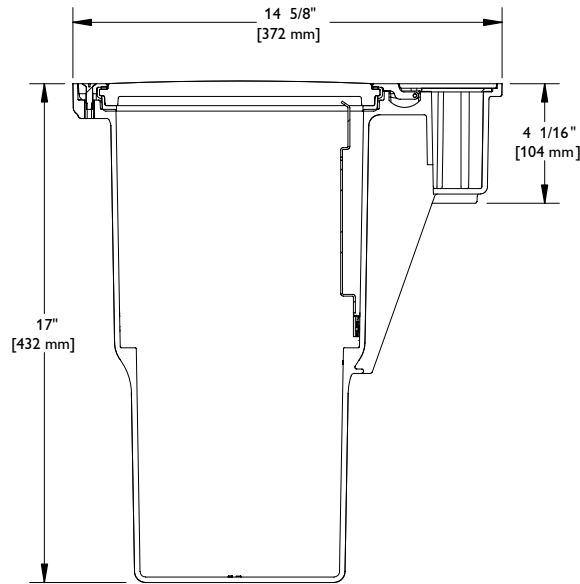

GASKET – Gasket for lens, junction box and ballast assembly are single-piece molded 100% silicone.

SOCKET – Incandescent, PAR38 and MH E-17: 4kv rated medium base porcelain socket.

OPTICS – LED module is available with spot, narrow flood or flood beam pattern. EnduraLED lamps: spot or flood beam pattern.

ELECTRICAL – LED module is a key-slotted ballast assembly with quick disconnects mounted to cast aluminum bracket for easy maintenance. e-Vision® electronic ballasts automatically detect 120-277 volts, 50/60 Hz, HPF. Ballasts provide ± 5% lamp power regulation with ± 10% input voltage regulation.

AIMING – 15° either side of vertical and full 360° rotation. Angle degree marks for precise vertical aiming with tool-less aiming.

ADA COMPLIANT – Compliant when used in concrete and flush-mounted with CPS35.

IP RATING – IP66/68 to 1M (3.28FT): Dust-tight and dual rated—sealed against direct jets of water and against continuous immersion up to a depth of 1 meter (3.28 feet).

ETL and cETL listed.

Catalog Number:	Finish: (N) Cast Bronze	Lamp:	Optics: (SP) Spot (NF) Narrow Flood (FL) Flood	CCT: (W) Warm (C) Cool
i3.5	N	—	(SP)	()
i3.5	N	—	(NF)	()
i3.5	N	—	(FL)	()
i3.5	N	LED18	(NF)	W

Fixtures with PAR38 LED lamp will be shipped with fixture loose, not installed. Lamps not sold separately.



iT216 COMPOSITE INGROUND
COMPOSITE, BRONZE or STAINLESS STEEL TRIM RING

- 120 Volt
- MR16 LED Lamp

HOUSING – Single-piece compression molded, fiberglass reinforced polyester composite housing.

TRIM RING – Compression molded polyester, or die-cast stainless steel or natural cast bronze.

ROCK GUARD – Directional for glare control. Compression molded polyester or natural cast bronze.

LENS – Clear convex, tempered soda-lime glass for high impact resistance. 2,200-pound live-load rated, standard walkover.

LED – 5.5W lamp with 24° beam spread. Color temperature (CCT): warm white (2,700K nominal). 7W lamp with 15°, 24° or 36° beam spread, 25,000 hours life. Color temperature (CCT): cool white (4,000K nominal) or warm white (2,700K nominal). No Mercury.

(lamp only sold integral to iT216 fixture)

ELECTRICAL – integral electronic transformer converts 120v to 12v.

AIMING – 15° either side of vertical and full 360° rotation. Angle degree marks for precise vertical aiming.

ETL and cETL listed.

Catalog Number:	Rock Guard: (G)	Finish: (N) Natural Cast Bronze (SS) Stainless Steel (H) Bronze	Lamp:	Optics: (SP) Spot (NF) Narrow Flood (FL) Flood	CCT: (W) Warm (C) Cool
iT216	(-)	()	LED4	NF	W
iT216	(-)	()	LED7	()	W
iT216	(-)	()	LED7	FL	C
iT216	G	(H, N)	LED4	NF	W
iT216	G	(H, N)	LED7	()	()
iT216	G	(H, N)	LED7	FL	C

* Fixture will be shipped with lamp installed. Lamp not sold separately.



i3 COMPOSITE INGROUND
COMPOSITE TRIM RING

- 120 Volt
- PAR20 LED Lamp

HOUSING – Single-piece compression molded, fiberglass reinforced polyester composite housing.

TRIM RING – Compression molded polyester, or die-cast stainless steel or natural cast bronze. All trim rings are secured with stainless steel screws.

ROCK GUARD – Directional for glare control. Compression molded polyester or natural cast bronze.

LENS – Clear convex, tempered soda-lime glass for high impact resistance. 2,200-pound live-load rated, standard walkover.

LED – 7W lamp with 25° beam spread, 25,000 hours life. Color temperature (CCT): cool white (4,000K nominal) or warm white (2,700K nominal). No Mercury.

(lamp only sold integral to i3 fixture)

ELECTRICAL – Standard quad-volt core and coil mounted on key-slotted removable tray with quick connect harness.

AIMING – 15° either side of vertical and full 360° rotation. Angle degree marks for precise vertical aiming with tool-less LOC-AIM®.

IP RATING – IP66/68 to 1M.

ETL and cETL listed.

* *Must order this adaptor ring if you order an internal accessory. See page 151 in the full Specification Guide for all available accessories.*

Catalog Number:	Rock Guard: (G)	Finish: (N) Natural Cast Bronze (SS) Stainless Steel (H) Bronze	Lamp: LED7	Optics: (NF) Narrow Flood	CCT: (W) Warm (C) Cool
i3	(-)	()	LED7	NF	()
i3	G	(H, N)	LED7	NF	()

* Fixture will be shipped with lamp installed. Lamp not sold separately.



iL116 COMPOSITE INGROUND

COMPOSITE, BRONZE or STAINLESS STEEL TRIM RING

- 12 Volt
- MR16 LED Lamp

HOUSING – Single-piece compression molded, fiberglass reinforced polyester composite housing.

TRIM RING – Compression molded polyester, or die-cast stainless steel or natural cast bronze.

ROCK GUARD – Directional for glare control. Compression molded polyester or natural cast bronze.

LENS – Clear convex, tempered soda-lime glass for high impact resistance. 2,200-pound live-load rated, standard walkover.

LED – 5.5W lamp with 24° beam spread. Color temperature (CCT): warm white (2,700 nominal). 7W lamp with 15°, 24° or 36° beam spread, 25,000 hours life. Color temperature (CCT): cool white (4,000K nominal) or warm white (2,700K nominal). No Mercury.

(lamp only sold integral to iL116 fixture)

AIMING – 15° either side of vertical and full 360° rotation. Angle degree marks for precise vertical aiming.

IP RATING – IP66/68 to 1M.

ETL and cETL listed.

Catalog Number:	Rock Guard: (G)	Finish: (N) Natural Cast Bronze (SS) Stainless Steel (H) Bronze	Lamp:	Optics: (SP) Spot (NF) Narrow Flood (FL) Flood	CCT: (W) Warm (C) Cool
iL116	()	()	LED4	NF	W
iL116	()	()	LED7	()	W
iL116	()	()	LED7	FL	C
iL116	G	(H, N)	LED4	NF	W
iL116	G	(H, N)	LED7	()	W
iL116	G	(H, N)	LED7	FL	C

* Fixture will be shipped with lamp installed. Lamp not sold separately.



iUL516 COMPOSITE INGROUND

iUL516-H Bronze

- 12 Volt
- MR16 LED Lamp

HOUSING – Single-piece injection molded fiberglass reinforced ULTEM® High Performance Polymer.

LENS RING – Single-piece injection molded ULTEM® High Performance Polymer with gasketed lens. Twist-off operation for ease of maintenance.

FINISH – Color impregnated bronze composite.

LED – 5.5W lamp with 24° beam spread, 25,000 hours life. Color temperature (CCT): warm white (2,700K nominal). No Mercury.

(lamp only sold integral to iUL516 fixture)

LENS – Convex lens is clear, high temperature tempered glass furnished with silicone O-ring for watertight seal.

SOCKET – Bi-pin type (GU5.3).

WIRING – Pre-wired with a 3-ft. pigtail and a quick connector for easy hook-up to the supply cable.

ETL and cETL listed.

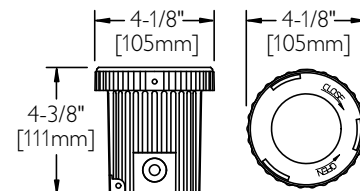

Catalog Number:	Finish: (H) Bronze	Lamp:	Optics: (NF) Narrow Flood	CCT: (W) Warm
iUL516	H	LED4	NF	W

* Fixture will be shipped with lamp installed. Lamp not sold separately.



UWL1075 CAST BRONZE UNDERWATER

- 12 Volt
- MR16 LED Lamp

HOUSING – Cast nickel bronze guard, spun stainless steel housing, stainless steel fasteners.

BASE – Cast nickel bronze swivel base.

FINISH – Natural finish.

LENS – Tempered clear convex glass (see below for optional colored lenses).

LED – 5.5W lamp with 24° beam spread, 25,000 hours life. Color temperature (CCT): warm white (2,700K nominal). No Mercury.
7W lamp with 15°, 24° or 36° beam spread, 25,000 hours life. Color temperature (CCT): cool white (4,000K nominal) or warm white (2,700K nominal). No Mercury.

(lamp only sold integral to UWL1075 fixture)

SOCKET – UWL1075 Bi-Pin (GY6.5).

WIRING – 10-ft. SVO cord for hard wiring to low voltage supply cable.

NOTE: Underwater fixtures are not for use in swimming pools or spas due to exposed wiring.

ETL, cETL listed.

* Consult factory for pool and spa rated transformers.

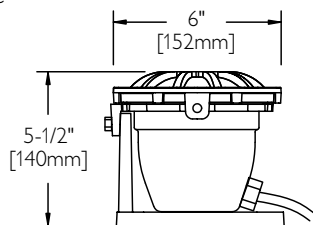

Catalog Number:	Finish: (N) Cast Bronze	Lamp:	Optics: (SP) Spot (NF) Narrow Flood (FL) Flood	CCT: (W) Warm (C) Cool
UWL1075	N	LED4	NF	W
UWL1075	N	LED7	()	W
UWL1075	N	LED7	FL	C

* Fixture will be shipped with lamp installed. Lamp not sold separately.



UWUL516 COMPOSITE UNDERWATER

- 12 Volt
- MR16 LED Lamp

HOUSING – Injection molded fiberglass reinforced ULTEM® High Performance Polymer.

LENS RING – Single-piece injection molded ULTEM® High Performance Polymer with gasketed lens. Twist-off operation for ease of maintenance.

BASE – Weighted concrete with swivel to allow up to 90° aiming.

FINISH – Color impregnated bronze.

LENS – Tempered clear glass with high impact polycarbonate clear lens guard.

LED – 5.5W lamp with 24° beam spread, 25,000 hours life. Color temperature (CCT): warm white (2,700K nominal). No Mercury.

(lamp only sold integral to UWUL516 fixture)

SOCKET – Bi-pin (GU5.3).

WIRING – 10-ft. STWA cord for hard wiring to low voltage supply cable.

NOTE: Underwater fixtures are not for use in swimming pools or spas due to exposed wiring.

ETL, cETL listed.

* Consult factory for pool and spa rated transformers.

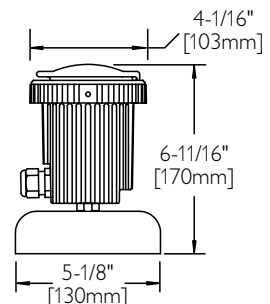

Catalog Number:	Finish: (H) Bronze	Lamp:	Optics: (NF) Narrow Flood	CCT: (W) Warm
UWUL516	H	LED4	NF	W

* Fixture will be shipped with lamp installed. Lamp not sold separately.



DAL1D

ALUMINUM DECKLYTE

- 12 Volt
- 1.7 total Watts

HOUSING – Cast aluminum construction with stainless steel set screws.

FINISH – Black thermoset, white thermoset, hand-rubbed verde antiqued over black thermoset powdercoat, bronze, speckled stone, or sienna thermoset powdercoat.

LENS – Frosted annealed glass.

LED – Color temperature (CCT): cool white (4,000K nominal) or warm white (3,000K nominal). Approximately 50,000 hours of operational life (at 25°C ambient temp. and 70% lumen maintenance). >80 CRI.

ELECTRICAL – Input voltage range (VAC): 11 - 15, (Magnetic low voltage transformer required).

IP RATING – IP67 Dust tight and sealed against direct jets of water

WIRING – Pre-wired with 6-ft. pigtail and a quick connector for easy hookup to low voltage supply cable.

ETL, cETL listed.



DAL1D-SS

STAINLESS STEEL DECKLYTE

- 12 Volt
- 1.7 total Watts

HOUSING – Stainless steel housing with stainless steel set screws.

FINISH – Stainless steel brushed matte finish

LENS – Frosted annealed glass.

LED – Color temperature (CCT): cool white (4,000K nominal) or warm white (3,000K nominal). Approximately 50,000 hours of operational life (at 25°C ambient temp. and 70% lumen maintenance). >80 CRI.

ELECTRICAL – Input voltage range (VAC): 11 - 15, (Magnetic low voltage transformer required).

IP RATING – IP67 Dust tight and sealed against direct jets of water

WIRING – Pre-wired with 6-ft. pigtail and a quick connector for easy hookup to low voltage supply cable.

ETL, cETL listed.



DCL1D

BRASS DECKLYTE

- 12 Volt
- 1.7 total Watts

HOUSING – Solid die-cast brass housing and backplate with stainless steel set screws.

FINISH – Natural brass finish.

LENS – Frosted annealed glass.

LED – Color temperature (CCT): cool white (4,000K nominal) or warm white (3,000K nominal). Approximately 50,000 hours of operational life (at 25°C ambient temp. and 70% lumen maintenance). >80 CRI.

ELECTRICAL – Input voltage range (VAC): 11 - 15, (Magnetic low voltage transformer required).

IP RATING – IP67 Dust tight and sealed against direct jets of water

WIRING – Pre-wired with 6-ft. pigtail and a quick connector for easy hookup to low voltage supply cable.

ETL, cETL listed.



DUL1D

COMPOSITE DECKLYTE

- 12 Volt
- 1.7 total Watts

HOUSING – Injection fiberglass reinforced molded ULTEM® High Performance Polymer housing with stainless steel set screws.

FINISH – Color impregnated black, bronze, or hand-rubbed verde antiqued over black.

LENS – Frosted annealed glass.

LED – Color temperature (CCT): cool white (4,000K nominal) or warm white (3,000K nominal). Approximately 50,000 hours of operational life (at 25°C ambient temp. and 70% lumen maintenance). >80 CRI.

ELECTRICAL – Input voltage range (VAC): 11 - 15, (Magnetic low voltage transformer required).

IP RATING – IP67 Dust tight and sealed against direct jets of water

WIRING – Pre-wired with 6-ft. pigtail and a quick connector for easy hookup to low voltage supply cable.

ETL, cETL listed.

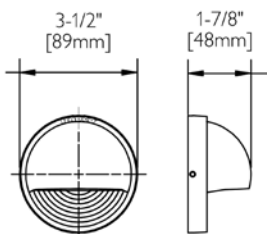

Catalog Number:	CCT: (W) Warm (C) Cool	Finish: (A) Black (B) White (G) Verde (H) Bronze (T) Speckled Stone (SS) Stainless Steel
DAL1D	()	()

Catalog Number:	CCT: (W) Warm (C) Cool	Finish: (N) Brass
DCL1D	()	()

Catalog Number:	CCT: (W) Warm (C) Cool	Finish: (A) Black (G) Verde (H) Bronze
DUL1D	()	()



RSC2 (line voltage)
ALUMINUM STEPLYTE



RSF2 (line voltage)
POLYCARBONATE STEPLYTE



RSS2 (line voltage)
POLYCARBONATE STEPLYTE



RSV2 (line voltage)
ALUMINUM STEPLYTE



RSC2 (line voltage)
CAST BRONZE STEPLYTE



RSV2 (line voltage)
CAST BRONZE STEPLYTE

HOUSING – Die-cast aluminum back box contains less than 0.3% copper to prevent corrosion in concrete or masonry applications.

TRIM RING – Die-cast aluminum trim contains less than 0.3% copper to resist corrosion. Cast bronze fixture has polycarbonate, color-impregnated, dark bronze finish (RSC2 and RSV2 only).

FINISH – Aluminum parts have zinc-rich primer and thermoset powdercoat for durability. Cast bronze has natural finish (RSC2 and RSV2 only).

CAST LOUVER FACEPLATE – Die-cast copper-free aluminum with 45° cutoff, with frosted tempered glass. Cast bronze louver is natural cast bronze with frosted tempered glass (RSC2 and RSV2 only). Amber Lens option (3000K)

OPAL FACEPLATE – Opal UV stabilized injection molded polycarbonate with frosted glass siliconed on inside for durability.

LOUVER SCREEN FACEPLATE – Clear UV stabilized injection molded polycarbonate with 45° louvered screen insert.

LED – Deliver 70% lumen maintenance at 50,000 hours. Cool white (6,300K nominal). Amber lens option (3,000K). 3 LED: 4w total watts. 5 LED: 6w total watts.

REFLECTOR – Specular aluminum formed reflector.

ELECTRICAL – Integral Advance™ electronic LED driver with integral surge protector. UL Class 2. -40° C/F minimum starting temperature. Pre-wired with #18 AWG wire. Electrical components are mounted on a removable tray for easy installation after housing is installed.

WIRING – Supply wires connect directly to the quick connect on the integral power supply.

ADA COMPLIANT – Compliant when used in indoor and outdoor wall applications.

IP RATING – IP66 Dust tight and sealed against direct jets of water.

ETL, cETL listed.

ACCESSORIES

Catalog Number:	Description:
MAKM	Masonry Construction Mounting Kit
MAKNS	New Stud Wall Construction Mounting Kit
MAKES	Existing Stud Wall Construction Mounting Kit

Note: All units supplied with mounting hardware for concrete pour installation. If other mounting kits are required, order accessory above.

ORDERING GUIDE

Catalog Number:	Finish: (A) Black (B) White (H) Bronze (N) Natural Cast Bronze	Sym Optics: K5 or L5	Lamping: D3 (3 1w LEDs) D5 (5 1w LEDs)	Warm: Amber Lens (W)	Voltage: (E) 120
RSC2	(Specify)	K5	(Specify)	(W)	E
RSF2	(A,H)	L5	(Specify)	(W)	E
RSS2	(A,H)	K5	(Specify)		E
RSV2	(Specify)	K5	(Specify)	(W)	E
RS2-AHO*	Black	Housing Only for Pre-Shipment			
RS2-BHO*	White	Housing Only for Pre-Shipment			
RS2-HHO*	Bronze	Housing Only for Pre-Shipment			
RS2-NHO*	Natural Cast Bronze	Housing Only for Pre-Shipment			

*When housing only is ordered for pre-shipment, add suffix "LH" (Less Housing) to complete catalog number to order fixture without housing.

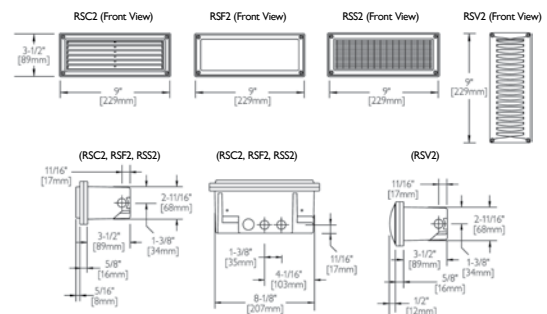
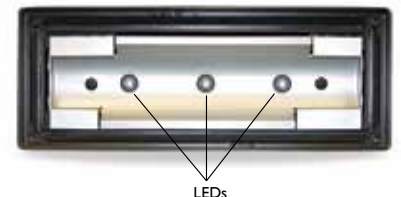

PHOTOMETRIC INFORMATION

5-1w LEDs 2 Foot Mounting Height

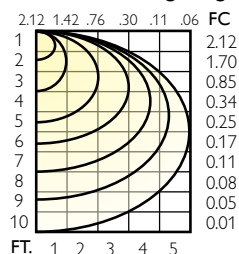

3-1w LEDs 2 Foot Mounting Height

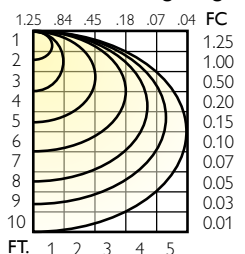



AL41D(W)*3 ALUMINUM PATHLYTE

- 12 Volt
- 3.8 total watts
- 1/2" NPS fitter

HOUSING – Cast aluminum with stainless steel fasteners.

FINISH – Black or bronze thermoset powdercoat, verde hand-rubbed over black powdercoat.

LED – Deliver 70% lumen maintenance at 50,000 hours. Color temperature (CCT): cool white (4,000K nominal) or warm white (3,000K nominal).

ELECTRICAL – Input voltage range (VAC): 10.8 - 13.2, regulated to 12V DC. Integral surge protector. (Magnetic low voltage transformer required)

WIRING – Pre-wired with a 3-ft. pigtail and a quick connector for easy hookup to the supply cable.

IP RATING – LED module is IP66 Dust tight and sealed against direct jets of water.

ETL, cETL listed.

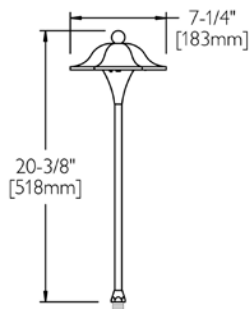

Catalog Number:	Voltage:	Wattage:	Finish:
AL41D(W)*3-AS7	12V	6.4W	Black
AL41D(W)*3-GS7	12V	6.4W	Verde
AL41D(W)*3-HS7	12V	6.4W	Bronze

*(W) warm option



AL4D(W)*3 ALUMINUM PATHLYTE

- 12 Volt
- 3.8 total watts
- 1/2" NPS fitter

HOUSING – Cast aluminum with stainless steel fasteners.

FINISH – Black or bronze thermoset powdercoat, verde hand-rubbed over black powdercoat.

LED – Deliver 70% lumen maintenance at 50,000 hours. Color temperature (CCT): cool white (4,000K nominal) or warm white (3,000K nominal).

ELECTRICAL – Input voltage range (VAC): 10.8-13.2, regulated to 12V DC. Integral surge protector. (Magnetic low voltage transformer required)

WIRING – Pre-wired with a 3-ft. pigtail and a quick connector for easy hookup to the supply cable.

IP RATING – LED module is IP66 Dust tight and sealed against direct jets of water.

ETL, cETL listed.

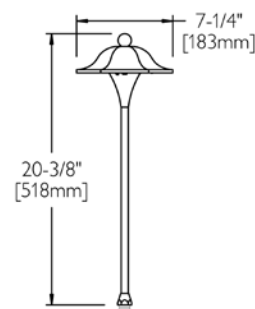

Catalog Number:	Voltage:	Wattage:	Finish:
AL4D(W)*3-AS7	12V	6.4W	Black
AL4D(W)*3-GS7	12V	6.4W	Verde
AL4D(W)*3-HS7	12V	6.4W	Bronze

*(W) warm option



CL2D2(W)*3 ALUMINUM PATHLYTE

- 12 Volt
- 3.8 total watts
- 1/2" NPS fitter

HOUSING – Cast aluminum with stainless steel fasteners.

FINISH – Black or bronze thermoset powdercoat.

LENS – Clear tempered flat glass lens.

LED – Deliver 70% lumen maintenance at 50,000 hours. Cool white (4,000K nominal). Warm white (3,000K nominal).

ELECTRICAL – Input voltage range (VAC): 10.8 - 13.2, regulated to 12V DC. Integral surge protector. (Magnetic low voltage transformer required)

WIRING – Pre-wired with a 3-ft. pigtail and a quick connector for easy hookup to the supply cable.

IP RATING – LED module is IP66 Dust tight and sealed against direct jets of water.

ETL, cETL listed.

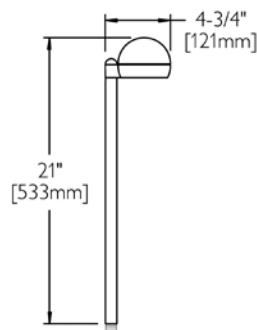

Catalog Number:	Voltage:	Wattage:	Finish:
CL2D(W)*2-AS7	12V	6.4W	Black
CL2D(W)*2-HS7	12V	6.4W	Bronze

*(W) warm option



CUL2D COPPER PATHLYTE

- 12 Volt
- 4.2 total Watts
- 1/2" NPS fitter
- Includes stem

HOUSING – Spun solid copper roof and solid copper stem. Machined copper or brass threaded adapter for tool-less relamping.

FINISH – Natural copper will patina with age. Reflective white powdercoat on underside of roof.

LED – Deliver 70% lumen maintenance at 50,000 hours (at 25°C ambient temp.). Color temperature (CCT): cool white (4,000K nominal) or warm white (3,000K nominal). >80 CRI.

ELECTRICAL – Input voltage range (VAC): 11 - 15, (Magnetic low voltage transformer required).

IP RATING – IP67 Dust tight and sealed against direct jets of water.

WIRING – Pre-wired with 6-ft. pigtail and a quick connector for easy hookup to low voltage supply cable.

LENS – Frosted borosilicate glass.

ETL, cETL listed.

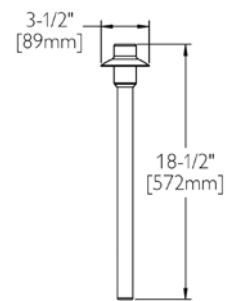

Catalog Number:	CCT: (C) Cool (W) Warm	Mount:
CUL2D	()	S7



CUL7D COPPER/STAINLESS PATHLYTE

- 12 Volt
- 1/2" NPS fitter
- 4.2 total Watts
- Includes stem

HOUSING – Spun solid copper or stainless steel roof and solid copper stem. Machined copper or brass threaded adapter for tool-less relamping.

FINISH – Natural copper will patina with age. Reflective white powdercoat on underside of roof.

LED – Deliver 70% lumen maintenance at 50,000 hours (at 25°C ambient temp.). Color temperature (CCT): cool white (4,000K nominal) or warm white (3,000K nominal). >80 CRI.

ELECTRICAL – Input voltage range (VAC): 11 - 15, (Magnetic low voltage transformer required).

IP RATING – IP67 Dust tight and sealed against direct jets of water.

WIRING – Pre-wired with 6-ft. pigtail and a quick connector for easy hookup to low voltage supply cable.

LENS – Frosted borosilicate glass.

ETL, cETL listed.

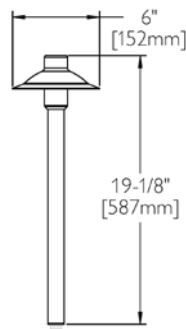

Catalog Number:	CCT: (C) Cool (W) Warm	Mount:
CUL7D	()	S7



CUL9D COPPER PATHLYTE

- 12 Volt
- 1/2" NPS fitter
- 4.2 total Watts
- Includes stem

HOUSING – Spun solid copper roof and solid copper stem. Machined copper or brass threaded adapter for tool-less relamping.

FINISH – Natural copper will patina with age. Reflective white powdercoat on underside of roof.

LED – Deliver 70% lumen maintenance at 50,000 hours (at 25°C ambient temp.). Color temperature (CCT): cool white (4,000K nominal) or warm white (3,000K nominal). >80 CRI.

ELECTRICAL – Input voltage range (VAC): 11 - 15, (Magnetic low voltage transformer required).

IP RATING – IP67 Dust tight and sealed against direct jets of water.

WIRING – Pre-wired with 6-ft. pigtail and a quick connector for easy hookup to low voltage supply cable.

LENS – Clear/frosted borosilicate glass.

ETL, cETL listed.

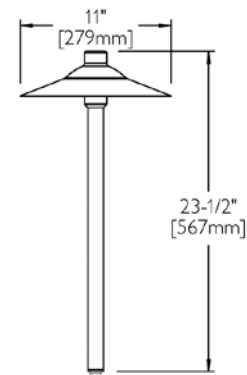

Catalog Number:	CCT: (C) Cool (W) Warm	Mount:
CUL9D	()	S7



CUL10D COPPER PATHLYTE

- 12 Volt
- 4.2 total Watts
- 1/2" NPS fitter
- Includes stem

HOUSING – Spun solid copper roof and solid copper stem. Machined copper or brass threaded adapter for tool-less relamping.

FINISH – Natural copper will patina with age. Reflective white powdercoat on underside of roof.

LED – Deliver 70% lumen maintenance at 50,000 hours (at 25°C ambient temp.). Color temperature (CCT): cool white (4,000K nominal) or warm white (3,000K nominal). >80 CRI.

ELECTRICAL – Input voltage range (VAC): 11 - 15, (Magnetic low voltage transformer required).

IP RATING – IP67 Dust tight and sealed against direct jets of water.

WIRING – Pre-wired with 6-ft. pigtail and a quick connector for easy hookup to low voltage supply cable.

LENS – Clear/frosted borosilicate glass.

ETL, cETL listed.

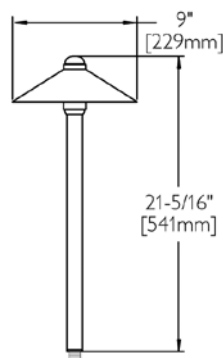

Catalog Number:	CCT: (C) Cool (W) Warm	Mount:
CUL10D	()	S7



CUL14D COPPER PATHLYTE

- 12 Volt
- 4.2 total Watts
- 1/2" NPS fitter
- Includes stem

HOUSING – Spun solid copper with solid copper stem. Machined brass threaded adapter for tool-less relamping.

FINISH – Natural copper will patina with age. Reflective white powdercoat on underside of roof.

LED – Deliver 70% lumen maintenance at 50,000 hours (at 25°C ambient temp.). Color temperature (CCT): cool white (4,000K nominal) or warm white (3,000K nominal). >80 CRI.

ELECTRICAL – Input voltage range (VAC): 11 - 15, (Magnetic low voltage transformer required).

IP RATING – IP67 Dust tight and sealed against direct jets of water.

WIRING – Pre-wired with 6-ft. pigtail and a quick connector for easy hookup to low voltage supply cable.

LENS – Frosted borosilicate glass.

ETL, cETL listed.

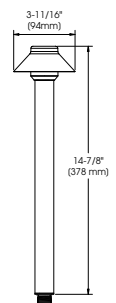

Catalog Number:	CCT: (C) Cool (W) Warm	Mount:
CUL14D	()	S7



ML4D(W)*3 ALUMINUM PATHLYTE

- 12 Volt
- 3.8 total Watts
- 1/2" NPS fitter

HOUSING – Cast aluminum with stainless steel fasteners.

FINISH – Black or bronze thermoset powdercoat, verde hand-rubbed over black powdercoat.

LED – Deliver 70% lumen maintenance at 50,000 hours. Cool white (4,000K nominal). Warm white (3,000K nominal).

ELECTRICAL – Input voltage range (VAC): 10.8 - 13.2, regulated to 12V DC. Integral surge protector. (Magnetic low voltage transformer required)

IP RATING – LED module is IP66 Dust tight and sealed against direct jets of water.

WIRING – Pre-wired with a 3-ft. pigtail and a quick connector for easy hookup to the supply cable.

ETL, cETL listed.

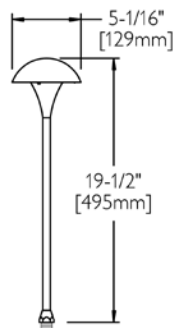

Catalog Number:	Voltage:	Wattage:	Finish:
ML4D(W)*3-AS7	12V	6.4W	Black
ML4D(W)*3-GS7	12V	6.4W	Verde
ML4D(W)*3-HS7	12V	6.4W	Bronze

*(W) warm option



RL4D(W)*3 ALUMINUM PATHLYTE

- 12 Volt
- 3.8 total Watts
- 1/2" NPS fitter

HOUSING – Cast aluminum construction.

FINISH – Black and bronze thermoset powdercoat.

LED – Deliver 70% lumen maintenance at 50,000 hours. Color white (4,000K nominal). Warm white (3,000K nominal).

ELECTRICAL – Input voltage range (VAC): 10.8 - 13.2, regulated to 12V DC. Integral surge protector. (Magnetic low voltage transformer required)

IP RATING – LED module is IP66 Dust tight and sealed against direct jets of water.

WIRING – Pre-wired with a 3-ft. pigtail and a quick connector for easy hookup to the supply cable.

LENS – Frosted tempered glass.

ETL, cETL listed.

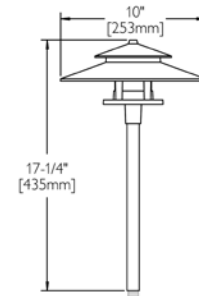

Catalog Number:	Voltage:	Wattage:	Finish:
RL4D(W)*3-AS7	12V	6.4W	Black
RL4D(W)*3-HS7	12V	6.4W	Bronze

*(W) warm option



RL9D ALUMINUM PATHLYTE

- 12 Volt
- 1/2" NPS fitter
- 3.8 total Watts

HOUSING – Cast aluminum with stainless steel fasteners.

FINISH – Black or bronze matte thermoset powdercoat.

LED – Deliver 70% lumen maintenance at 50,000 hours (at 25°C ambient temp.). Color temperature (CCT): cool white (4,000K nominal) or warm white (3,000K nominal). >80 CRI.

ELECTRICAL – Input voltage range (VAC): 11 - 15, (Magnetic low voltage transformer required).

IP RATING – IP67 Dust tight and sealed against direct jets of water.

WIRING – Pre-wired with 3-ft. pigtail and a quick connector for easy hookup to low voltage supply cable.

ETL, cETL listed.

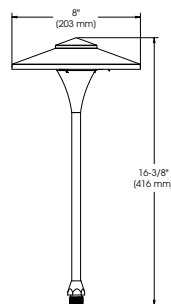

Catalog Number:	CCT:	Finish: (A) Black (H) Bronze (T) Speckled Stone	Mount:
RL9D3	Cool	()	S7
RL9DW3	Warm	()	S7



TRL4D(W)*3 ALUMINUM PATHLYTE

- 12 Volt
- 1/2" NPS fitter
- 3.8 total Watts

HOUSING – Cast aluminum with stainless steel fasteners.

FINISH – Verde hand-rubbed over black thermoset powdercoat.

LED – Deliver 70% lumen maintenance at 50,000 hours. Color temperature (CCT): cool white (4,000K nominal) or warm white (3,000K nominal).

ELECTRICAL – Input voltage range (VAC): 10.8 - 13.2, regulated to 12V DC. Integral surge protector. (Magnetic low voltage transformer required)

IP RATING – LED module is IP66 Dust tight and sealed against direct jets of water.

WIRING – Pre-wired with a 3-ft. pigtail and a quick connector for easy hookup to the supply cable.

LENS – Frosted borosilicate glass.

ETL, cETL listed.

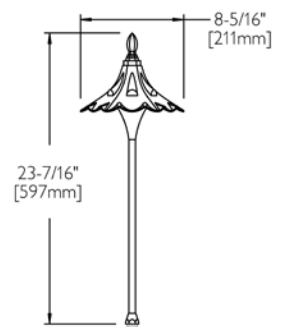

Catalog Number:	Voltage:	Wattage:	Finish:
TRL4D(W)*3-GS7	12V	6.4W	Verde

*(W) warm option



WAM1/WBM1 (line voltage)

LED ALUMINUM FLOODLYTE

- 120 Volt
- 1/2" NPS fitter
- 12 total watts consumed

HOUSING – Die-cast aluminum with fully-adjustable swivel arm with vibration-proof locking teeth.

FINISH – Black thermoset, white, hand-rubbed verde antiqued over black thermoset powdercoat, or bronze thermoset powdercoat.

LENS – Clear or frosted tempered glass.

LED – 4000K color temperature (CCT) or 3000K tempered glass lens. Approximately 50,000 hours of operational life (at 25 C ambient temperature and 70% lumen maintenance). >80 CRI.

ELECTRICAL – Fixture is pre-wired with 18AWG black, white and ground wires. Smart Select Electronic Driver 120 to 277 VAC input; 50-60Hz; auto-sensing. 12 total watts consumed.

WIRING – Pre-wired with a 3-ft. pigtail.

OPTICS – 150° LED spread (equivalent to wide flood.)

IP RATING – IP66
Dust tight and sealed against direct jets of water.

ETL and cETL listed.

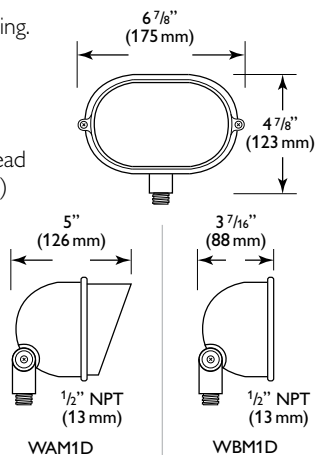

Catalog Number:	CCT: (W) Warm (C) Cool	Frosted Lens: (F) Frosted Lens* (-) Clear Lens	Finish: (A) Black (B) White (G) Verde (H) Bronze
WAM1D	()	()	()
WBM1D	()	()	()



WAML1/WBML1

LED ALUMINUM SPOTLYTE

- 12 Volt
- 1/2" NPS fitter
- 3.8 total watts (high power) 2.4 total watts (low power)

HOUSING – Die-cast aluminum with fully-adjustable swivel arm, with vibration-proof locking teeth.

FINISH – Black thermoset, white, hand-rubbed verde antiqued over black thermoset powdercoat, or bronze thermoset powdercoat.

LENS – Clear or frosted tempered glass.

LED – 4000K (cool) color temperature (CCT) or 3000K (warm) tempered glass lens. Approximately 50,000 hours of operational life (at 25 C ambient temperature and 70% lumen maintenance). >80 CRI.

ELECTRICAL – Input voltage range (VAC): 10.8 - 13.2, regulated to 12V DC. Integral surge protector. (Magnetic low voltage transformer required)

WIRING – Pre-wired with a 3-ft. pigtail and a quick connector for easy hookup to the supply cable.

OPTICS – 150° LED spread (equivalent to wide flood.)

IP RATING – IP66
Dust tight and sealed against direct jets of water.

ETL and cETL listed.

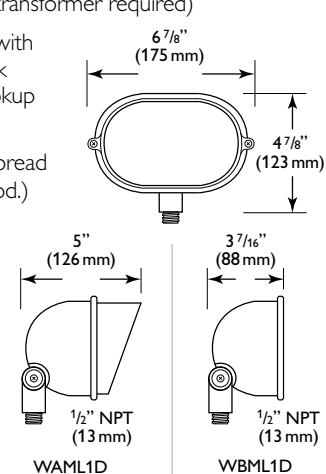

Catalog Number:	CCT: (C3) Cool High Power (C2) Cool Low Power (W3) Warm High Power (W2) Warm Low Power	Lens: (F) Frosted Lens (-) Clear Lens	Finish: (A) Black (B) White (G) Verde (H) Bronze	Mount:
WAML1D	()	()	()	S7
WBML1D	()	()	()	S7



MA3

ALUMINUM PATHLYTE

- 120 Volt
- 1/2" NPS fitter

HOUSING – Precision machined aluminum from 6061-T6 material. Stainless Steel fasteners.

FINISH – Black or Bronze thermoset powdercoat.

LAMPING – 75W PAR 30 maxium medium base lamp. 39W T4 MH (9° Narrow, 47° Wide optics). Lower wattage lamps are acceptable.

WIRING – Pre-wired with 18-ft. out-wires. Input voltage range (VAC) 120-277.

IP RATING – IP65 Completely dust-tight & sealed to withstand low pressure jets of water from any direction.

ETL, cETL listed.

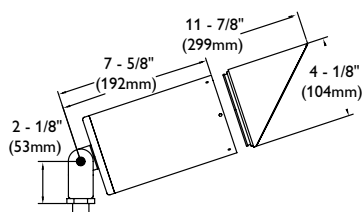

MA5

ALUMINUM PATHLYTE

- 12 Volt
- 1/2" NPS fitter

HOUSING – Precision machined aluminum from 6061-T6 material. Stainless Steel fasteners.

FINISH – Black or Bronze thermoset powdercoat.

LAMPING – 35W MR16, must use shroud (US & Canada). 20W MR16, shroud is optional (US & Canada). Lower wattage lamps are acceptable.

ELECTRICAL – Bi-pin socket type (GX5.3) with 250° Celsius high temperature teflon coated wire leads. Stainless steel retention clip affixed to socket to securely hold lamp in place.

WIRING – Pre-wired with a 3-ft. pigtail and a quick connector for easy hookup to the low voltage supply cable.

IP RATING – IP65 Completely dust-tight & sealed to withstand low pressure jets of water from any direction.

ETL, cETL listed.

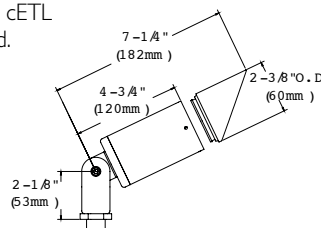

MA7

ALUMINUM PATHLYTE

- 12 Volt
- 1/2" NPS fitter

HOUSING – Precision machined aluminum from 6061-T6 material. Stainless Steel fasteners.

FINISH – Black or Bronze thermoset powdercoat.

LAMPING – Lower wattage lamps are acceptable. 20W MR11, must use shroud. 20W T3 (US only). 10W T3 (US & Canada only).

ELECTRICAL – Bi-pin socket type (G4) with 200° Celsius high temperature teflon coated wire leads.

WIRING – Pre-wired with a 3-ft. pigtail and a quick connector for easy hookup to the low voltage supply cable.

IP RATING – IP65 Completely dust-tight & sealed to withstand low pressure jets of water from any direction.

ETL, cETL listed.

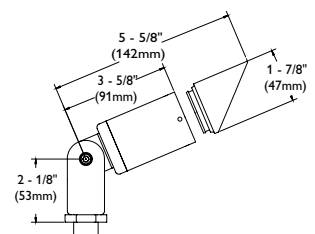

Catalog Number:	Optics: (W) Wide (N) Narrow	Source: (MH) Metal Halide (PA) PAR	Finish: (A) Black (H) Bronze	Shroud (optional): (L) Long-45°	Stake: (S7)	Lamp (optional): (BAB) 20W MR16 (20T3) 20W T3
MA3	()	()	()	()	-	-
MA5	-	-	()	()	S7	BAB
MA7	-	-	()	()	S7	20T3

Accent Lighting

					
Model	BL5016	EL1	BL711	BL616	BUL16
Finish	A, G, H, T	N	A, H	A, G, H	A, G, H
Watts/Lamp	50w MR16	10w T3*	35w MR11 20w T3	50w MR16	35w MR16
Material	Aluminum	Brass	Aluminum	Aluminum	Composite
					
Model	BL16	BPL36	BL1	BL1	BUL1
Finish	N, OB	A, G, H	A, H	N, OB	A, G, H
Watts/Lamp	50w MR16	50w PAR36	75w MR16	75w MR16	75w MR16
Material	Brass	Composite	Aluminum <i>Available with Long (L) or Short (S) shroud</i>	Brass	Composite <i>Available with Long (L) or Short (S) shroud</i>
					
Model	GABL16	CUL16	MA5	MA7	
Finish	AC	Copper	A, H	A, H	
Watts/Lamp	35w MR16	20w MR16*	35w MR16	20w T3	
Material	Copper	Copper	Aluminum	Aluminum	
					
Model	WAML14	WBML14	AAL1	AUL1	
Finish	A, B, G, H	A, B, G, H	A, G	A, G	
Watts/Lamp	50w T4 halogen*	50w T4 halogen*	27w 1156*	20w T3*	
Material	Aluminum	Aluminum	Aluminum	Composite	
					
Model	GAHL1	DL1	DSL2	DRL2	
Finish	AC	A, G	A, B	A, G	
Watts/Lamp	27w 1156*	27w 1156*	18w 1141*	35w MR16	
Material	Copper	Aluminum	Aluminum	Aluminum	

* Lamp included

Step and Deck Lighting

						
Model	DL4	GADL4	GADL1	GADL2	SRL4	CUL20
Finish	N	AC	AC	AC	A, B, G, H	Copper
Watts/Lamp	10w T3*	10w T3*	10w Xenon*	10w Xenon*	10w Xenon*	10w Xenon*
Material	Brass	Copper	Copper	Copper	Aluminum	Copper

							
Model	DAL1	DCL1	DUL1	DAL1	GACL2	DSL1	SRL3
Finish	A, B, G, H, T,	N	A, G, H	SS	AC	A, B	A, H
Watts/Lamp	10w T3*	10w T3*	10w T3*	10w T3*	10w T3*	18w 1141*	18w 1141*
Material	Aluminum	Brass	Composite	Stainless Steel	Copper	Aluminum	Aluminum















					
Model	LLL Series	RFL1	RLL1	RLL2	RL13
Finish	Copper;	A	A	Copper; SS	A
Watts/Lamp	10w Xenon*	12w 93*	12w 93*	12w 93*	10w T3*
Material	Copper; Stainless Steel	Aluminum	Aluminum	Copper or Stainless Steel	Composite

				
Model	RSCL2	RSBL2	RSFL2	CB100
Finish	A, B, H	A, H	A, H	A, H
Watts/Lamp	18w 1141* (two each)	20w T3	18w 1141* (two each)	18w 1141* (two each)
Material	Aluminum	Polycarbonate	Polycarbonate	Composite

				
Model	RRBL1	RRFL1	RRCL1	RRCBL1
Finish	A, H	A, H	A, B, H	A, B, H
Watts/Lamp	10w T3*	10w T3*	10w T3*	50w MR16
Material	Polycarbonate	Polycarbonate	Aluminum	Aluminum

* Lamp included

Walkway Lighting

						
Model	MSL12	MSL18	CPL12	CPL21	MUL4	MUL5
Finish	A, G, H	A, G, H	A, H	A, H	A, G, H, N, OB	A, G, H, N
Watts/Lamp	27w 1156*	27w 1156*	20w T3*	20w T3*	20w T3*	35w T3*
Material	Aluminum	Aluminum	Aluminum	Aluminum	Brass or Aluminum	Brass or Aluminum
						
Model	AL41	TL19	TRL4	AL42	AL43	
Finish	A, G, H	G	G	G	G	
Watts/Lamp	20w T3*	20w Xenon*	20w T3*	20w T3*	20w T3*	
Material	Aluminum	Aluminum	Aluminum	Aluminum	Aluminum	
						
Model	SPL18	SPL1	FUL1	SPL5		
Finish	A, G	A, G	G	N		
Watts/Lamp	27w 1156*	27w 1156*	27w 1156*	20w T3*		
Material	Aluminum	Aluminum	Aluminum	Brass		

* Lamp included

Walkway Lighting continued

					
Model	PL3	PL39	RL3	RL4	RL9
Finish	G	K	G	A, H	A, G, T
Watts/Lamp	27w 1156*	27w 1156*	27w 1156*	20w T3*	20w T3*
Material	Aluminum	Aluminum	Aluminum	Aluminum	Aluminum

Stem NOT included.

Low Voltage Lighting

Inground and Underwater Lighting

				
Model	IL116	IL136	IL336	IUL516
Finish	H	H	A, AL	H
Watts/Lamp	75w MR16	75w PAR36 or 75w AR111	18w PAR36*	50w MR16
Material	Composite	Composite	Composite	Composite

					
Model	DWCL2	DWCL1	UWL2100	UWUL516	UWL1
Finish	A	A	N	H	A
Watts/Lamp	20w T3 halogen*	20w T3 halogen*	100w T3*	50w MR16	10w T3*
Material	Composite	Composite	Cast Bronze	Composite	Composite

* Lamp included

Copper Walkway Lighting

					
Model	GAML4	GAML5	GASL4	GASL5	
Finish	AC	AC	AC	AC	
Watts/Lamp	10w T3*	20w T3*	27w 1156*	20w T3*	
Material	Copper	Copper	Copper	Copper	
					
Model	CUL2	CUL4	CUL6	CUL7	CUL9
Finish	Copper	Copper	Copper	Copper	Copper
Watts/Lamp	20w T3*	20w T3*	20w T3*	20w T3*	20w T3*
Material	Copper	Copper	Copper	Copper	Copper
					
Model	CUL10	CUL14	GAML1	GAML2	GAML3
Finish	Copper	Copper	AC	AC	AC
Watts/Lamp	20w T3*	20w T3*	20w T3*	20w T3*	20w T3*
Material	Copper	Copper	Copper	Copper	Copper

* Lamp included

Transformers

Transformers Accessory Compatibility*

Catalog Number	Description	Height	Width	Depth	PC3	PC15	T5	T6
TC152-12	150VA, 12V TAP, Painted	11-1/2"	3-1/4"	3-1/4"				
TC152-12TP	150VA, 12V TAP, Painted, W/Timer, PC (not pictured)	11-1/2"	3-1/4"	3-1/4"				
TC354-15	300VA Multitap, Painted, Hinged Door	11-3/8"	6-3/8"	5-5/8"	✓	✓	✓	✓
TC654-15	600VA Multitap, Painted, Hinged Door	12-5/8"	7-1/2"	6"	✓	✓	✓	✓
TC954-15	900VA Multitap, Painted, Hinged Door	14"	8-7/8"	7"	✓	✓	✓	✓
TSS354-15	300VA Multitap, Stainless, Hinged Door	11-3/8"	6-3/8"	5-5/8"	✓	✓	✓	✓
TSS654-15	600VA Multitap, Stainless, Hinged Door	12-5/8"	7-1/2"	6"	✓	✓	✓	✓
TSS954-15	900VA Multitap, Stainless, Hinged Door	14"	8-7/8"	7"	✓	✓	✓	✓

*Accessory compatibility is model specific. Please see accessory descriptions below.



TC152-12



TC ___ -15



TSS ___ -15

Transformer Accessories:



T5

Plug-in analog transformer time clock.



T6

Plug-in digital transformer time clock with battery back-up.



PC3

Plug-in photo cell, 3" (78mm) lead for direct mount to transformer housing.



PC15

Plug-in photo cell, 15-ft. (46.8m) lead for remote mount.

Mounting Stakes and Low Voltage Cable:



S3

Mounting stake suitable for wet locations. Heavy wall, impact-resistant PVC. Threaded 1/2" NPT [13mm] hub with ground wire.



S7

Two-piece low voltage mounting stake. PVC stake 1-3/8" [35mm] O.D. x 9-1/2" [241mm] long with integral 1/2" [13mm] NPS fitter.



SCW500-10

Low Voltage Cable – Single Circuit 12V, 2 conductor, 10 gauge, 500-ft.



SCW500-12

Low Voltage Cable – Single Circuit 12V, 2 conductor, 12 gauge, 500-ft.



ISO 9001
REGISTERED

PHILIPS
HADCO



© 2013 Philips Group

All rights reserved. Certain products illustrated in this catalog may be protected by applicable patents and patent pending. Philips Hadco will aggressively defend all of its intellectual property. We reserve the right to change details of design, materials and finishes in any way that will not alter installed appearance or reduce function and performance.

www.philips.com/hadco

100 Craftway Drive, P.O. Box 128, Littlestown, PA 17340

Phone: 1-866-423-2658 • Fax: 717-359-0618

Printed in U.S.A. PH-OL-1000BRO 4/13