



Friendly Service ... Powerful Solutions

Topaz Specification Sheet

Description: Conduit Hangers

Standard Material: Steel/Zinc Plated

Features: Assembled with nut and bolt

Application: Indoors or Outdoors. Use to secure and suspend conduit from overhead supports.

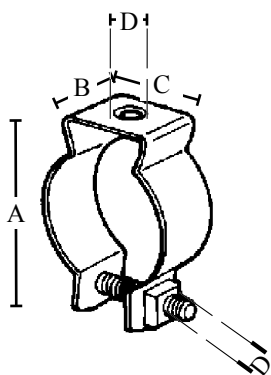

TOPAZ CAT #	A	B	C	D
601	1.875	.750	.725	.25
602	2.125	.750	.850	.25
603	2.437	.875	.975	.25
604	2.75	.875	.975	.25
604A	2.875	.875	1.050	.25
605	3.125	1.000	1.125	.25
606	3.875	1.000	1.145	.25
607	4.625	1.250	1.225	.3125
608	5.500	1.250	1.275	.3125
609	5.750	1.250	1.275	.3125
610	6.250	1.250	1.275	.3125

TOPAZ CAT #	UPC#	TRADE SIZE	FOR RIGID	FOR EMT	BOLT SIZE	SHIP CASE	WT/ CASE
601	15830	0	3/8"-1/2"	1/2"	1/4-20	100	6
602	15840	1	3/4"	3/4"	1/4-20	100	8
603	15850	2	1"	1"	1/4-20	100	8
604	15860	3	1 1/4"	1 1/2"	1/4-20	100	10
604A	15870	2 1/2	---	1 1/4"	1/2-20	100	10
605	15880	4	1 1/2"	---	1/2-20	100	18
606	15890	5	2"	2"	1/2-20	50	10
607	15900	6	2 1/2"	2 1/2"	5/16-18	50	11
608	15910	7	3"	3"	5/16-18	25	6
609	15920	8	3 1/2"	3 1/2"	5/16-18	25	8
610	15930	9	4"	4"	5/16-18	25	12

Approved by Quality Control: John Cavalieri



NEW YORK
925 Waverly Avenue
Holtsville, NY 11742
800-666-2852
Fax: 800-333-3488

CALIFORNIA
225 Parkside Drive
San Fernando, CA 91340
888-551-2852
Fax: 888-690-2852

FLORIDA
2020 West 26th Street
Jacksonville, FL 32209
800-666-2852
Fax: 800-333-3488