



Commercial Grade Back and Side Wired 15 and 20 Ampere Duplex Straight Blade Receptacles 2-Pole, 3-Wire Grounding

APPLICATION

In accordance with the NEC, these devices are suitable for use in all 15 or 20 ampere branch circuits of 125 volts in commercial installations where UL 498 standards of mechanical and electrical life are specified.

MATERIALS

Cover	Thermoplastic
Base	Thermoplastic
Mounting Strap	Steel multipiece with brass ground contacts
Power Contacts	Copper Alloy
Terminal Screws	Triple combination head screws, #10-32 steel
Terminal Clamps	Galvanized steel
Grounding Clip	Brass
Grounding Screw	Triple combination head screws, steel
Bushing	Die cast
Mounting Screws	Triple combination head screws, steel
Wiring	Back and side wire (eight hole feed-thru)
Certifications	WD-1&6, 498, CSA C22.2 No. 42

Description	Color	15A-125V NEMA 5-15R 	20A-125V NEMA 5-20R 
Duplex Receptacles	Brown	BR15	BR20
	Ivory	BR15-I	BR20-I
	White	BR15-W	BR20-W
	Gray	BR15-GY	BR20-GY
	Black	BR15-E	BR20-E
	Almond	BR15-A	BR20-A

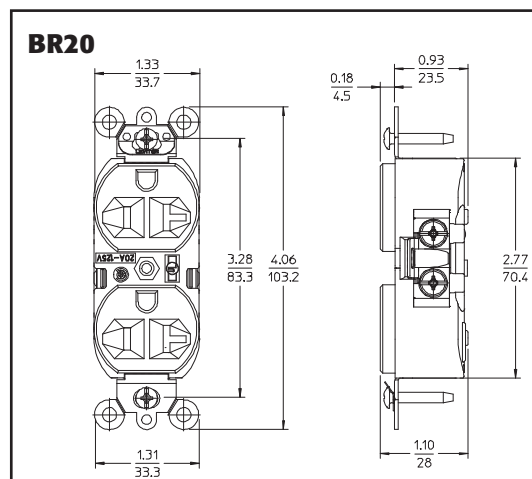
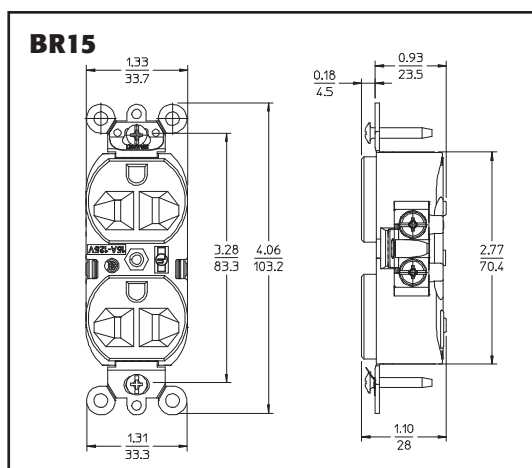

BR15, BR20

SPECIFICATIONS

Straight Blade 15 Amp and 20 Ampere 2-pole, 3-wire grounding duplex receptacles shall be Leviton Underwriters Laboratories Listed and CSA Certified with two drive pin assembly and center bushing. Ratings and colors as scheduled on plan.

FEATURES AND BENEFITS

- Constructed with impact-resistant thermoplastic cover and body
- Automatic ground connection when mounted in a properly grounded metal wall box
- Dual drive pins and center bushing for sturdy assembly
- Large, triple-wipe brass "T" contacts for superior contact pressure, outstanding conductivity
- Triple Combination No. 10-32 high-performance steel terminal screws with undercut annular binder-head design to reduce oxidation on conductors for superior continuity. Designed torque capability of 20+ inch pounds
- Exclusive V-shaped, serrated back wiring clamps that provide three-point contact for superior conductivity
- Convenient break-off tabs allow easy two-circuit conversion
- Back and side wiring options with eight deep-funnel, back-wiring holes that accept No. 14 to 10 AWG solid and stranded wire

PERFORMANCE SPECIFICATIONS

Electrical	
Dielectric Voltage Withstand:	2000V minimum
Maximum Working Voltage:	125V as rated
Current Interrupting:	Certified for current interrupting at full-rated current
Temperature Rise:	Maximum 30°C temperature rise at full-rated current after 50 cycles of overload at 150% of rated current
Mechanical	
Terminal Identification:	Terminals identified in accordance with UL 498 (brass, white & green)
Terminal Accommodation:	#14 gauge through #10 gauge copper and copper clad
Product Identification:	Ratings are a permanent part of device housing
Environmental	
Flammability:	Rated V2
Operating Temperature:	From -40°C (without impact) to 60° maximum continuous

TESTING AND CODE COMPLIANCE

The receptacles listed herein meet UL 498 (UL file #E13399) Listing and CSA C22.2 No. 42 Certification (CSA file #152105), and meet Mexican NOM standards. They meet or exceed NEMA WD 1 and 6, and ANSI standards. These receptacles are suitable for use in accordance with federal, state, county, municipal and local codes.

