

EMT FITTINGS

RAINTIGHT - STEEL - COMPRESSION FITTINGS

Applications

- For use in wet locations to bond and secure EMT conduit to a box or enclosure
- RACO® Raintight Steel EMT Compression Fittings have been designed to comply with the new U.L. Raintight test requirements and to comply with the requirements of the 2008 NEC 358.42 and 314.15

Product Features

- All steel construction insures mechanical protection for the raceway
- Fittings are available in 1/2" to 4" trade sizes.
- Zinc electroplate finish
- All fittings are marked "Wet Locations". Allows inspecting authorities to immediately determine that the installation is up to code
- All connectors are supplied with a factory installed knockout seal. No need to add the expense of buying a gasket separately
- No need to disassemble the fitting prior to installation. RACO Raintight Steel EMT Compression Fittings are designed so that when they come out of the carton they can be installed directly on the conduit. No need to waste time loosening compression nuts
- No need for special tools to install properly. Install these fittings like any other Steel EMT Compression Fitting. No need for a torque wrench to insure proper installation

Compliances

-  - Standard 514B
- C22.2 #18

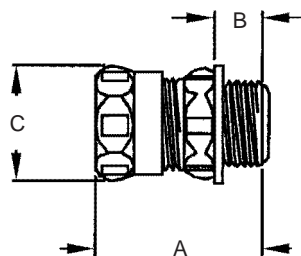

Uninsulated Connectors
Steel



Insulated Connectors
Steel

RACO COMMERCIAL FITTINGS

ORDERING INFORMATION - DIMENSIONS

COMPRESSION FITTINGS - UNINSULATED CONNECTORS				
CATALOG NUMBER	TRADE SIZE	UNIT CTN. QTY.	SHIP CTN. QTY.	UPC BAR CODE
2902RT	1/2"	50	250	—
2903RT	3/4"	25	125	—
2904RT	1"	15	75	—
2905RT	1-1/4"	—	20	—
2906RT	1-1/2"	—	10	—
2908RT	2"	—	10	—
2940RT	2-1/2"	—	1	—
2942RT	3"	—	1	—
2944RT	3-1/2"	—	1	—
2946RT	4"	—	1	—

COMPRESSION FITTINGS - INSULATED CONNECTORS				
CATALOG NUMBER	TRADE SIZE	UNIT CTN. QTY.	SHIP CTN. QTY.	UPC BAR CODE
2912RT	1/2"	50	250	—
2913RT	3/4"	25	125	—
2914RT	1"	15	75	—
2915RT	1-1/4"	—	20	—
2916RT	1-1/2"	—	10	—
2918RT	2"	—	10	—
2960RT	2-1/2"	—	1	—
2962RT	3"	—	1	—
2964RT	3-1/2"	—	1	—
2966RT	4"	—	1	—

DIMENSIONS				
INSULATED CONNECTOR	UNINSULATED CONNECTOR	A	B	C
2912RT	2902RT	1.58	0.46	1.16
2913RT	2903RT	1.79	0.45	1.38
2914RT	2904RT	1.90	0.56	1.64
2915RT	2905RT	2.10	0.65	2.04
2916RT	2906RT	2.25	0.70	2.27
2918RT	2908RT	2.40	0.66	2.74
2960RT	2940RT	2.50	0.81	3.62
2962RT	2942RT	2.62	0.94	4.25
2964RT	2944RT	2.81	1.00	4.68
2966RT	2946RT	2.81	1.00	5.18

