

Single Pole Devices

**Temporary Power Connectors for the
Most Demanding Environments**





Single Pole Devices

Temporary Power Connectors for the Most Demanding Environments

Hubbell Wiring Device-Kellems products have long set the standard for innovation, performance, safety and reliability. Our continuing success is born from the philosophy of never leaving well enough alone. We believe we can always make our products better – and the record shows we have.

Temporary power installations are unique and unpredictable and therefore are very demanding. The most critical mission is to keep the equipment running. Hubbell devices have the proven reliability to deliver secure connections allowing you to focus attention on what matters most.

Hubbell Single Pole devices are extremely durable. The double cam contact design can stand up to repeated mating and un-mating. The added protection of UL Type 4X, 12 environmental rating stands up to the most abusive environments. The engineered body design makes installation simple with no need for additional tools and the non-metallic retaining screw helps to make operation safe for all involved.

Male Plug

Insulgrip® Style Housing for Superior Gripping conforms to the user's hand making it easy to connect and disconnect, even with gloves on.

Rounded Corners reduce the possibility of catching or snagging on structures or equipment.

UL Enclosure Types 3R, 4X and 12 Rating
Suitable for use in almost any environment.

Non-Conductive Retaining Screw locks contacts in place and allows for easy installation. Prevents contact movement within housing. Special screw thread requires fewer turns than most competitors and reduces the risk of a conductive screw being substituted.

Large Raised Alignment Arrow aids in the mating of devices and provides a visual indication that the devices are properly connected.

Double Cam Design provides high contact pressure and vibration resistant connection, which helps reduce operating temperatures and extends life.



Female Plug

Turn and Lock Symbol aids in the mating of devices and provides a clear indication that the devices are properly connected.

High Conductivity Brass Contact provides improved performance by helping to reduce operating temperatures and extends life.

Extra Long non-conductive inner sleeve reduces force required to install housing over contacts. Easier to rotate contact in body for installing retaining screw.

Easily Identifiable Cable with cut off points for secure fit allows you to easily customize the housing to the required cable size. Makes cutting to the correct cable size very easy. Accommodates wide range of cables.

Strip Gauge molded into every plug and receptacle housing. Simplifies installation and saves time.





Single Pole Devices

Series 15 - 150 Ampere, 600V AC/250V DC

Features and Benefits

- Enclosure Types 3R, 4X, 12
- Combo Head, Non-Metallic Safety Retaining Screw
- Insulgrip Body Design
- Accepts #8 AWG - #2 AWG Wire
- Insulgrip Body Design
- UL and cUL Listed



Plugs, Male

Description	Color	Male Plug
150 amp, thermoplastic elastomer, cable size #8 - #2 AWG.	Black	HBL15MBK
	White	HBL15MW
	Green	HBL15MGN
	Red	HBL15MR
	Blue	HBL15MBL



Plugs, Female

Description	Color	Female Plug
150 amp, thermoplastic elastomer, cable size #8 - #2 AWG.	Black	HBL15FBK
	White	HBL15FW
	Green	HBL15FGN
	Red	HBL15FR
	Blue	HBL15FBL

Receptacles, Stud Type $1\frac{1}{16}" \times \frac{3}{4}"$



Description	Color	Female Receptacles	Male Receptacles
150 amp Panel Mount, thermoplastic.	Black	HBL15FRSBK	HBL15MRSBK
	White	HBL15FRSW	HBL15MRSW
	Green	HBL15FRSGN	HBL15MRSGN
	Red	HBL15FRSR	HBL15MRSR
	Blue	HBL15FRSBL	HBL15MRSBL



Receptacles, Double Set Screw

Description	Female Receptacles	Male Receptacles
150 amp Panel Mount, thermoplastic, cable size #8 - #2 AWG.	HBL15FRBK	HBL15MRBK
	HBL15FRW	HBL15MRW
	HBL15FRGN	HBL15MRGN
	HBL15FRR	HBL15MRR
	HBL15FRBL	HBL15MRBL



Protective Caps

Description	Color	Fits Male Devices	Fits Female Devices
Fits 150 amp plugs and receptacles.	Black	HBL15MCAPBK	HBL15FCAPBK
	White	HBL15MCAPW	HBL15FCAPW
	Green	HBL15MCAPGN	HBL15FCAPGN
	Red	HBL15MCAPR	HBL15FCAPR
	Blue	HBL15MCAPBL	HBL15FCAPBL



Weather Protective Covers

Description	Color	Catalog Number
Use with stud type or double set screw receptacles.	Black	HBL15NCBK
	White	HBL15NCW
	Green	HBL15NCGN
	Red	HBL15NCR
	Blue	HBL15NCBL

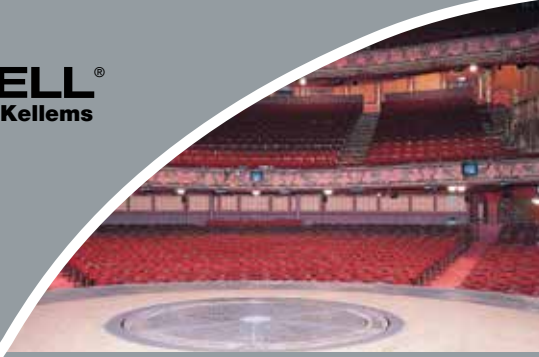

Single Pole Devices

Series 15 - 150 Ampere, 600V AC/250V DC

Tees



Color	Tapping Tee (Female-Female-Male)	Paralleling Tee (Female-Male-Male)
Black	HBL15TBK	HBL15PTBK
White	HBL15TW	HBL15PTW
Green	HBL15TGN	HBL15PTGN
Red	HBL15TR	HBL15PTR
Blue	HBL15TBL	HBL15PTBL

Note: *Not UL listed, consult factory for availability.

Gender Reversing Devices



Color	Double Male (Male-Male)	Double Female (Female-Female)
Black	HBL15DMBK*	HBL15DFBK*
White	HBL15DMW	HBL15DFW
Green	HBL15DMGN	HBL15DFGN
Red	HBL15DMR*	HBL15DFR*
Blue	HBL15DMBL*	HBL15DFBL*

Replacement Bodies (25 Pack)



Color	Male Body	Female Body
Black	HBL15MBBK	HBL15FBBK
White	HBL15MBW	HBL15FBW
Green	HBL15MBGN	HBL15FBGN
Red	HBL15MBR	HBL15FBR
Blue	HBL15MBBL	HBL15FBBL

Replacement Contacts (25 Pack)



Description	Male Pin	Female Sleeve
Contact, 150 amp	HBL15RCM	HBL15RCF

Accessories

Description	Catalog Number
Accessory Kit, retaining screw, copper foil, terminal screws and brass wire.	HBL15PK
Replacement retaining screw (100 pack).	HBL15RS
Copper foil (100 pack).	HBL15CF
Brass wire (100 pack).	HBL15BW
Terminal screw - inline (100 pack).	HBL15TS25
Terminal screw - panel mount (100 pack).	HBL15TS375
Ferrule #2 AWG (100 pack).	HBL15F2
Ferrule #4 AWG (100 pack).	HBL15F4



HBL15PK



HBL15RS



HBL15CF



HBL15BW



HBL15TS25



HBL15TS375



**HBL15F2
HBL15F4**



Single Pole Devices

Series 16 - 300 and 400 Ampere, 600V AC/250V DC

Features and Benefits

- Enclosure Types 3R, 4X, 12
- Non-Metallic Safety Retaining Screw
- Insulgrip Body Design
- Accepts #6 AWG - 4/0 Wire
- UL and cUL Listed



Plugs



Description	Color	Male Plug	Female Plug
300 amp, thermoplastic elastomer, cable size #6 - 2/0 AWG.	Black	HBL300MBK	HBL300FBK
	White	HBL300MW	HBL300FW
	Green	HBL300MGN	HBL300FGN
	Red	HBL300MR	HBL300FR
	Blue	HBL300MBL	HBL300FBL
	Brown	HBL300MBN	HBL300FBN
	Orange	HBL300MO	HBL300FO
	Yellow	HBL300MY	HBL300FY



Description	Color	Male Plug	Female Plug
400 amp, thermoplastic elastomer, cable size 2/0 - 4/0 AWG.	Black	HBL400MBK	HBL400FBK
	White	HBL400MW	HBL400FW
	Green	HBL400MGN	HBL400FGN
	Red	HBL400MR	HBL400FR
	Blue	HBL400MBL	HBL400FBL
	Brown	HBL400MBN	HBL400FBN
	Orange	HBL400MO	HBL400FO
	Yellow	HBL400MY	HBL400FY

Receptacles, Female Stud Type



Description	Color	Through Hole Mounting	Threaded Mounting Holes
400 amp Panel Mount, thermoplastic elastomer, mates with 300 and 400 amp plugs.	Black	HBLFRSBK	HBLFRSCBK
	White	HBLFRSW	HBLFRSCW
	Green	HBLFRSGN	HBLFRSCGN
	Red	HBLFRSR	HBLFRSCR
	Blue	HBLFRSBL	HBLFRSCBL
	Brown	HBLFRSBN	HBLFRSCBN
	Orange	HBLFRSO	HBLFRSCO
	Yellow	HBLFRSY	HBLFRSCY

Receptacles, Male Stud Type



Description	Color	Through Hole Mounting	Threaded Mounting Holes
400 amp Panel Mount, thermoplastic elastomer, mates with 300 and 400 amp plugs.	Black	HBLMRSBK	HBLMRSCBK
	White	HBLMRSW	HBLMRSCW
	Green	HBLMRSGN	HBLMRSCGN
	Red	HBLMRSR	HBLMRSCR
	Blue	HBLMRSBL	HBLMRSCBL
	Brown	HBLMRSBN	HBLMRSCBN
	Orange	HBLMRSO	HBLMRSCO
	Yellow	HBLMRSY	HBLMRSCY

Receptacles, Double Set Screw



Description	Color	Female Receptacles Threaded Mounting Holes	Male Receptacles Threaded Mounting Holes
400 amp Panel Mount, thermoplastic elastomer, cable size #4 - 4/0 AWG, mates with 300 and 400 amp plugs.	Black	HBLFRBK	HBLMRBK
	White	HBLFRW	HBLMRW
	Green	HBLFRGN	HBLMRGN
	Red	HBLFRR	HBLMRR
	Blue	HBLFRBL	HBLMRBL
	Brown	HBLFRBN	HBLMRBN
	Orange	HBLFRO	HBLMRO
	Yellow	HBLFRY	HBLMRY

Receptacles, Bus Bar Mount



Description	Color	Female Receptacles Threaded Mounting Holes	Male Receptacles Threaded Mounting Holes
400 amp Mount, thermoplastic elastomer, mates with 300 and 400 amp plugs.	Black	HBLFRBBK	HBLMRBBK
	White	HBLFRBW	HBLMRBW
	Green	HBLFRBGN	HBLMRBGN
	Red	HBLFRBR	HBLMRBR
	Blue	HBLFRBBL	HBLMRBBL
	Brown	HBLFRBBN	HBLMRBBN
	Orange	HBLFRBO	HBLMRBO
	Yellow	HBLFRBY	HBLMRBY



Single Pole Devices

Series 16 - 300 and 400 Ampere, 600V AC/250V DC



Tees and 3-Fers

Color	Tapping Tee (Female-Female-Male)	Paralleling Tee (Female-Male-Male)	3-Fer (Male-Female- Female-Female)	3-Fer (Female-Male- Male-Male)	Soft 3-Fer (Male-Female- Female-Female)	Soft 3-Fer (Female- Male-Male-Male)
Black	HBLTBK	HBLPTBK	HBLM3FBK	HBLF3MBK	HBLM3FSBK	—
White	HBLTW	HBLPTW	HBLM3FW	HBLF3MW	—	—
Green	HBLTGN	HBLPTGN	HBLM3FGN	HBLF3MGN	—	HBLF3FSGN
Red	HBLTR	HBLPTR	HBLM3FR	HBLF3MR	—	—
Blue	HBLTBL	HBLPTBL	HBLM3FBL	HBLF3MBL	—	—
Brown	HBLTBN	HBLPTBN	HBLM3FBN	HBLF3MBN	—	—
Orange	HBLTO	HBLPTO	HBLM3FO	HBLF3MO	—	—
Yellow	HBLTY	HBLPTY	HBLM3FY	HBLF3MY	—	—

Gender Reversing Devices



Color	Double Male (Male-Male)	Double Female (Female-Female)
Black	HBLDMBK	HBLDFBK
White	HBLDMW	HBLDFW
Green	HBLDMGN	HBLDFGN
Red	HBLDMR	HBLDFR
Blue	HBLDMBL	HBLDFBL
Brown	HBLDMBN	HBLDFBN
Orange	HBLDMO	HBLDFO
Yellow	HBLDMY	HBLDFY

Distribution Block

(1-Male, 6-Females)



Color	Catalog Number
Black	HBL7DBBK
White	HBL7DBW
Green	HBL7DBGN
Red	HBL7DBR
Blue	HBL7DBBL
Brown	HBL7DBBN
Orange	HBL7DBO
Yellow	HBL7DBY

Weather Protective Covers



Color	Catalog Number
Black	HBLNCBK
White	HBLNCW
Green	HBLNCGN
Red	HBLNCR
Blue	HBLNCBL
Brown	HBLNCBN
Orange	HBLNCO
Yellow	HBLNCY

Protective Caps



Color	Fits Male Devices	Fits Female Devices
Black	HBLMCAPBK	HBLFCAPBK
White	HBLMCAPW	HBLFCAPW
Green	HBLMCAPGN	HBLFCAPGN
Red	HBLMCAPR	HBLFCAPR
Blue	HBLMCAPBL	HBLFCAPBL
Brown	HBLMCAPBN	HBLFCAPBN
Orange	HBLMCAPO	HBLFCAPO
Yellow	HBLMCAPY	HBLFCAPY

Note: *3R only.

Replacement Bodies (100 Pack)



Color	Male Body	Female Body
Black	HBLMBBK	HBLFBBK
White	HBLMBW	HBLFBW
Green	HBLMBGN	HBLFBGN
Red	HBLMBR	HBLFBR
Blue	HBLMBBL	HBLFBBL
Brown	HBLMBBN	HBLFBBN
Orange	HBLMBO	HBLFBO
Yellow	HBLMBY	HBLFBY

Accessories

Description	Catalog Number
Accessory Kit, retaining screw, copper foil, terminal screws and brass wire	HBLPK
Replacement retaining screw (500 pack)	HBLRS
Copper foil (500 pack)	HBLCF

Snap Back Covers

Color	Through Hole Mounting	Threaded Mounting Holes
Black	HBLSCBK*	HBLSCCBK*
White	HBLSCW*	HBLSCCW*
Green	HBLSCGN*	HBLSCCGN*
Red	HBLSCR*	HBLSCCR*
Blue	HBLSCBL*	HBLSCCBL*
Brown	HBLSCBN*	HBLSCCBN*
Orange	HBLSCO*	HBLSCCO*
Yellow	HBLSCY*	HBLSCCY*



Replacement Contacts (20 Pack)



Description	Male Pin	Female Sleeve
Contact, 300 amp	HBL300RCM	HBL300RCF
Contact, 400 amp	HBL400RCM	HBL400RCF

Accessories

Description	Catalog Number
Brass wire (500 pack)	HBLBW
Terminal screw - panel mount (500 pack)	HBLTSR
Terminal screw - inline (500 pack)	HBLTS



Single Pole Devices

Series 15 and 16 Specifications and Dimensions

Specifications

Electrical	Series 15	Series 16
Voltage Ratings	600V AC Maximum 250V DC Maximum	600V AC Maximum 250V DC Maximum
Amperage Rating	150A Maximum	400A Maximum

Mechanical	Series 15	Series 16-300A	Series 16-400A
Terminal Accommodation	Plug: #2 AWG to #8 AWG Recept.: #2 AWG to #8 AWG	Plug: #6 to 2/0	Plug: 2/0 to 4/0 Recept.: #4 to 4/0
Product ID	Ratings are a permanent part of device		
Base Compound	Thermoplastic Elastomer (TPE)		
Contact Material	Brass		
Retaining Screw Material	Nylon		

Certification / Environmental

Series 15 and 16
UL and cUL Listed.
UL Enclosure Types 3R, 4X, 12.
UL 1691 standard for single pole locking-type separable connectors (Series 16 Pending).
National Electric Code (NEC), ANSI/NFPA 70.
Flammability: HB per UL94 or CSA 22.2. 0.17.

Conductor Ampacity Chart (Type SC/PPC Wire)

Cable Size	Ampacity*	Cable Size	Ampacity*
#6	105	2/0	300
#4	140	4/0	405
#2	190		

Note: *90°C column NEC Table 400.5(A)(2).

Dimensions Inches (mm)

Panel Mount Receptacles

Series 15	Threaded Stud	A	B	C	D	E	F	G	Mounting Hole	Termination
	Male	1.86" (47.2)	1.37" (34.8)	N/A	2.82" (71.6)	.86" (22.0)	.80" (20.4)	1.20" (30.5)	Through 3x Ø .20"	5/16-18 Threaded Stud
	Female	1.86" (47.2)	1.37" (34.8)	N/A	2.88" (73.1)	.86" (22.0)	.80" (20.4)	1.26" (32.0)	Through 3x Ø .20"	5/16-18 Threaded Stud
	Double Set Screw	A	B	C	D	E	F	G	Mounting Hole	Termination
Series 16	Male	1.86" (47.2)	1.37" (34.8)	N/A	2.90" (73.6)	.86" (22.0)	.88" (22.2)	1.20" (30.5)	Through 3x Ø .20"	(2) 5/32 Socket Head Set Screws
	Female	1.86" (47.2)	1.37" (34.8)	N/A	2.95" (74.9)	.86" (22.0)	.87" (22.2)	1.26" (32.0)	Through 3x Ø .20"	(2) 5/32 Socket Head Set Screws
	Threaded Stud	A	B	C	D	E	F	G	Mounting Hole	Termination
	Male & Female w/ through hole mounting	2.20" (55.9)	2.20" (55.9)	1.50" (38.1)	4.10" (104.3)	1.48" (47.4)	1.25" (31.7)	1.74" (44.2)	Through 4x Ø .20"	1/2-13 UNC-2A Threaded Stud
Series 16	Male & Female w/ threaded mounting holes	2.20" (55.9)	2.20" (55.9)	1.50" (38.1)	3.67" (93.2)	1.48" (47.4)	1.11" (28.2)	1.55" (39.4)	Threaded 4x #10-32	1/2-13 UNC-2A Threaded Stud
	Double Set Screw	A	B	C	D	E	F	G	Mounting Hole	Termination
	Male & Female w/ threaded mounting holes	2.20" (55.9)	2.20" (55.9)	1.50" (38.1)	4.10" (104.3)	1.48" (47.4)	1.36" (34.5)	1.74" (44.2)	Threaded 4x #10-32	(2) 7/32 Socket Head Set Screws
	Busbar Type	A	B	C	D	E	F	G	Mounting Hole	Termination
	Male & Female w/ threaded mounting holes	2.20" (55.9)	2.20" (55.9)	1.50" (38.1)	3.57" (90.7)	1.48" (37.6)	1.01" (25.7)	1.55" (39.4)	Threaded 4x #10-32	(1) 5/16-18 UNC-2B Threaded Hole

Series 15 Threaded Stud (Male Shown)

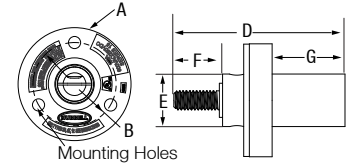

Series 16 Threaded Stud (Male Shown)

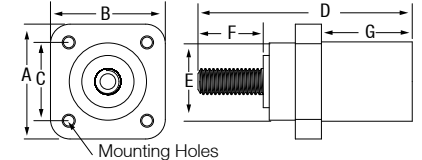

Series 16 Double Set Screw (Male Shown)

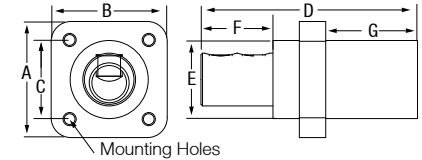

Series 16 Busbar Type (Male Shown)

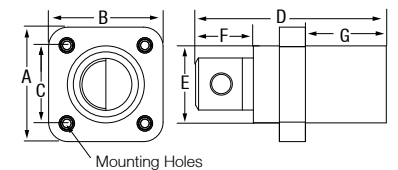

In Line Plugs

Series 15		A	B	C	D
	Male	4.54" (115-.3)	1.04" (26.4)	.86" (21.8)	3.22" (81.7)
	Female	4.60" (116.8)	1.11" (28.2)	.68" (17.3)	3.28" (83.2)

In Line Plugs

Series 16		A	B	C	D
	Male	7.01" (178.0)	1.38" (35.1)	1.48" (37.6)	4.78" (121.4)
	Female	7.10" (180.5)	1.44" (36.6)	1.06" (27.0)	4.90" (121.3)

Inline Plug (Male shown)

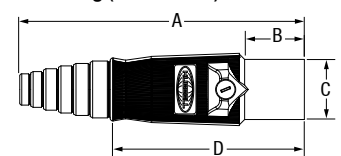

Weatherproof Cover

Series 15-16		A	B	C
	Series 15	2.03" (51.5)	1.14" (29.0)	1.49" (37.9)
	Series 16	2.20" (55.88)	1.16" (29.44)	2.03" (51.5)

Snap Back Cover

Series 16	For Use With	A	B
	Through Hole Receptacles	2.26" (57.4)	2.37" (60.2)
	Threaded Hole Receptacles	2.26" (57.4)	2.37" (60.2)

Series 15 Weatherproof Cover

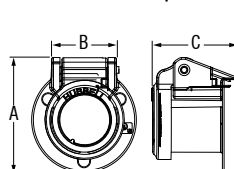

Series 16 Weatherproof Cover

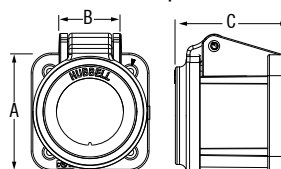

Series 16 Snap Back Cover

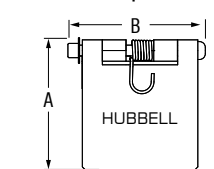

Single Pole Devices

**Temporary Power Designed for the
Most Demanding Environments**

More Industry Products from Hubbell

STRAIGHT BLADE DEVICES



Insulgrip® Plugs, Connectors, Receptacles and Inlets - the widest range of singularly rated NEMA devices available. Insulgrip products are synonymous with Hubbell's ongoing commitment to producing high quality electric products.

TWIST-LOCK® DEVICES



Twist-Lock Insulgrip® Plugs, Connectors, Receptacles and Inlets - the widest range of singularly rated NEMA devices available. Designed to last from engineered thermoplastic materials and high performing alloys.

IEC PIN & SLEEVE DEVICES



IEC Watertight Devices provide safe and dependable performance in the most demanding environments. Heavy duty non-conductive nylon construction provides impact and corrosion protection.

Available Literature

Hubbell offers an extensive literature library for product support. Downloadable PDFs are available online at www.hubbell-wiring.com.

Hubbell Safety Brochure



Hubbell Safety Evaluation Brochure

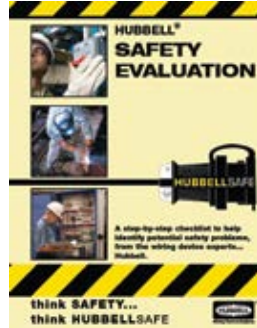

Insulgrip® Wiring Devices Application Guide

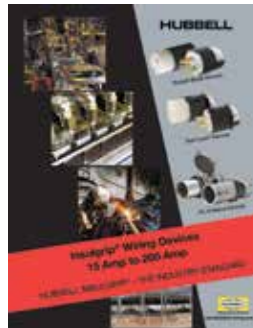

Hubbell Slide Charts



Twist-Lock®
Devices



Kellems®
Mesh Grips

Website Support

The Hubbell Wiring Systems website offers fast convenient information with our online virtual catalog, technical support, literature support and more. The website also offers landing pages for vertical markets and sustainable building. Visit www.hubbell-wiring.com.

