



#### Application

- For use with a conduit coupling to connect conduit to a box or, with a locknut to connect two boxes

#### Product Feature

- Rugged metallic construction

#### Compliance

-  – Standard 514B
-  – C22.2 #18



Uninsulated Nipples  
Die Cast Zinc

### ORDERING INFORMATION - DIMENSIONS

UNINSULATED NIPPLES - DIE CAST ZINC				
CATALOG NUMBER	TRADE SIZE	UNIT CTN. QTY.	SHIP CTN. QTY.	UPC BAR CODE
1662	1/2"	100	1000	—
1663	3/4"	50	500	—
1664	1"	25	250	—
1665	1-1/4"	25	250	—
1666	1-1/2"	25	100	—
1668	2"	10	40	—
1670	2-1/2"	10	40	—
1672	3"	10	40	—
1674	3-1/2"	10	40	—
1676	4"	5	20	—

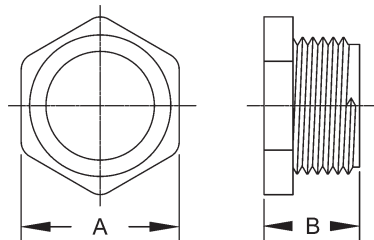

A = Across flats  
B = Length

DIMENSIONS			
CATALOG NUMBER	TRADE SIZE	A	B
1662	1/2"	15/16"	19/32"
1663	3/4"	1-3/16"	23/32"
1664	1"	1-3/8"	55/64"
1665	1-1/4"	1-47/64"	7/8"
1666	1-1/2"	2-1/8"	29/32"
1668	2"	2-35/64"	1-5/32"
1670	2-1/2"	3-7/32"	1-7/16"
1672	3"	3-51/64"	1-7/16"
1674	3-1/2"	4-17/64"	1-7/16"
1676	4"	4-51/64"	1-7/16"