

## LIQUIDTIGHT CONDUIT AND CORD CONNECTORS

### STEEL/MALLEABLE IRON - STRAIGHT CONNECTORS, GROUNDING TYPE

#### Applications

- For use in outdoor or indoor locations on flexible metallic liquidtight conduit, when installation of a copper or aluminum external bonding jumper is required
- RACO® grounding liquidtight connectors are suitable for use in Class 1, Division 2; Class 2, Division 1 and 2; and Class 3, Division 1 and 2 hazardous locations

#### Product Features

- Patented split gland-ring is designed to slip onto the conduit quickly and to grip the jacket of the conduit, speeding installation, assuring a perfect seal, and preventing pullouts
- All components are reusable — RACO® liquidtight connectors may be easily disassembled and reused after years of service
- Sealing washer (included) provides a liquidtight seal when terminating the connector in a threadless opening
- Heavy duty locknut included with every RACO® liquidtight connector assures continuity of ground
- All metallic components are zinc electro plated for added corrosion protection
- **Bodies** - 3/8" to 1" Steel  
1-1/4" to 4" Malleable Iron
- **Nuts** - 3/8" to 1" Steel  
1-1/4" to 4" Malleable Iron

#### Compliances

-  - Standard 514B
-  - C22.2 #18



Straight - Insulated  
With Ground Lug  
Steel/Malleable Iron

RACO COMMERCIAL  
FITTINGS

### ORDERING INFORMATION - DIMENSIONS

STRAIGHT - INSULATED WITH GROUND LUG STEEL/MALLEABLE IRON						
CATALOG NUMBER	TRADE SIZE	UNIT. CTN. QTY.	SHIP CTN. QTY.	GROUNDING WIRE CAPACITY		UPC BAR CODE
				MIN.	MAX.	
3511-3*	3/8"	—	25	#14 SOL.	#4 STR.	—
3512-3	1/2"	—	25	#14 SOL.	#4 STR.	—
3513-3	3/4"	—	25	#14 SOL.	#4 STR.	—
3514-3	1"	—	10	#14 SOL.	#4 STR.	—
3515-3	1-1/4"	—	10	#14 SOL.	#4 STR.	—
3516-3	1-1/2"	—	5	#14 SOL.	#4 STR.	—
3518-3	2"	—	5	#14 SOL.	#4 STR.	—
3520-3	2-1/2"	—	1	#14 SOL.	#1/0 STR.	—
3522-3	3"	—	1	#14 SOL.	#1/0 STR.	—
3524-3	3-1/2"	—	1	#6 STR.	#250 MCM	—
3526-3	4"	—	1	#6 STR.	#250 MCM	—

\*1/2" Trade size hub

DIMENSIONS					
TRADE SIZE	A	B	THD. SPEC.	C	D
3/8"	1-1/16"	1/2"	1/2"-14 NPT	1-29/64"	25/32"
1/2"	1-3/16"	1/2"	1/2"-14 NPT	1-15/32"	25/32"
3/4"	1-13/32"	9/16"	3/4"-14 NPT	1-31/64"	25/32"
1"	1-45/64"	19/32"	1"-11-1/2 NPT	1-51/64"	25/32"
1-1/4"	2-3/16"	43/64"	1-1/4"-11-1/2 NPT	1-7/8"	25/32"
1-1/2"	2-13/32"	47/64"	1-1/2"-11-1/2 NPT	2-11/64"	25/32"
2"	3-1/32"	21/32"	2"-11-1/2 NPT	2-9/32"	25/32"
2-1/2"	3-5/8"	1"	2-1/2"- 8 NPT	3-5/16"	1-11/64"
3"	3-3/8"	1-3/64"	3"- 8 NPT	3-1/2"	1-11/64"
3-1/2"	3-31/32"	1-1/8"	3-1/2"- 8 NPT	3-5/8"	1-13/16"
4"	5-35/64"	1-5/32"	4"- 8 NPT	3-5/8"	1-13/16"

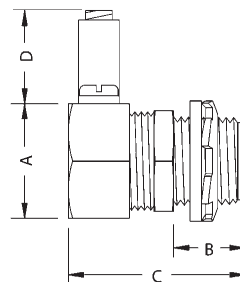

A = Nut Flats  
B = Thread length and thread spec.  
C = Overall length  
D = Lug height

