

1/2" to 4"
Made in the USA
Solid Steel or Aluminum

AMFITCO

The Next Generation of Greenfield Connectors

SPEC-flex connectors™

Our *flex* System is Your Solution for Electrical Runs

GUARANTEED to
Save Time On Every
Connection You Make.



Patent Pending

Straight Connectors for Enclosures or
Use Our Adapters to Transition Your Conduit & Cable

TURN IT ON with SPEC-flex connectors™



Full *flex* Connector System
Straight Connectors, 45° & 90°
FMC to Liquid Tight, Flexible Cord,
EMT & Rigid Conduit



AMERICAN FITTINGS
Corporation

800.221.5268
amftgs.com

Fair Lawn, New Jersey

Saves Labor on Every Connection
No Screw or Crimp Required to Install
Simply, Turn It On Your FMC
Exceeds UL Pullout Requirements by 300%
No Screws to Pinch or Pierce Conduit
Maintains Full Integrity of the Conduit
Count On a Safe Burr-less Wire Pull
Fully-Machined Solid Steel or Aluminum
Furnished with Industrial Grade Steel Locknut

Made in the USA

© 2015 AMERICAN FITTINGS

Since 1946



SPECflex™ Connector System

Easily Transition Greenfield into Your Electrical Runs
When You Turn On with **SPECflex**



Straight Connector
1/2" - 4"
FMC to Enclosure

Avoid the Issues with Inferior Die Cast Fittings

Patent Pending, Uniquely Engineered for Industrial Projects and OEM Product Performance and Reliability

- Superior Performance for Secure Connectors and Fast Disconnect
- GripsTight, Grips Right on Every Connection
- Fittings are FULLY Reuseable, No Need to Crimp or Pinch
- 90° and 45° Adapters Used to Connect FMC to a Box or Enclosure



Sizes Available 1/2" - 2" * Trade Sizes, in Steel or Aluminum
Solid Steel Fully Machined FMC SPEC-flex Connectors
Made in the USA



90° Adapter
FMC to Enclosure



45° Adapter
FMC to Enclosure

Furnished with Industrial Grade Locknut, Sealing Washer and Insulated Throat

SPECflex™ ADAPTERS

The Most Secure Connection in the Market.

Our flex-System is Your Industrial Solution

SPEC-flex Adapters Convert Greenfield - FMC to Pipe, LT or Cord
Industrial Products for Demanding Conditions

Adapters Used to Easily
Transition FMC to EMT, Rigid Conduit, Portable Cord, or Liquid Tight Cable
and Conform to UL specifications, Made in the USA

Sizes Available 1/2" - 2" * Consult factory for larger trade sizes

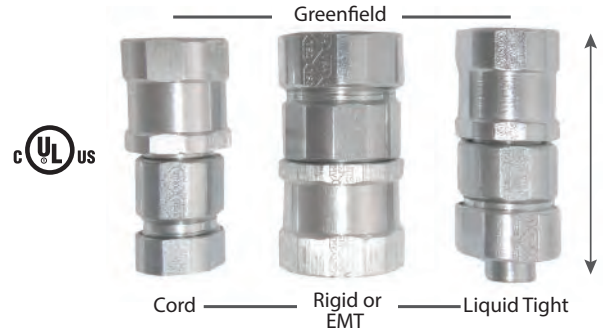

Products Guaranteed for Life

Greenfield to Conduit
Available Set Screw & Compression EMT or Rigid Conduit

Note:
SPECflex connectors are designed to work and interface with UL listed, Made in USA FMC / Greenfield conduit. We cannot guarantee fit, form, or function with non-UL off-shore conduit. Request a sample from factory to ensure capatibility.



Greenfield to LT or
Portable Cord

AMERICAN FITTINGS Corporation



SPECflex™
FMC Connector Fittings
1/2" to 4"

SPECflex™

*Installs On Greenfield with a
Few Easy Turns
No Tools Required*

Solid Alloy Steel Fully Machined SPECflex Connector™
Industrial Grade Greenfield to Enclosure Connector
Made in the USA
Alloy Steel Zinc Electro Plated or Aluminum

Patent Pending
Uniquely Engineered for Industrial Projects and
OEM Product Performance
Secure Connection and Fast Disconnect
No Tools Required to Install on FMC
Exceeds UL Pull-Out Requirements by 300%

*FULL Connector System Available for Transitions
from Greenfield to EMT, Rigid, LT, & Flexible Cord
90° and 45° Connectors Available*



Unique industrial grade locknut bites into any box or enclosure for full bonding and an Insulated UL Listed Throat Bushing are standard.

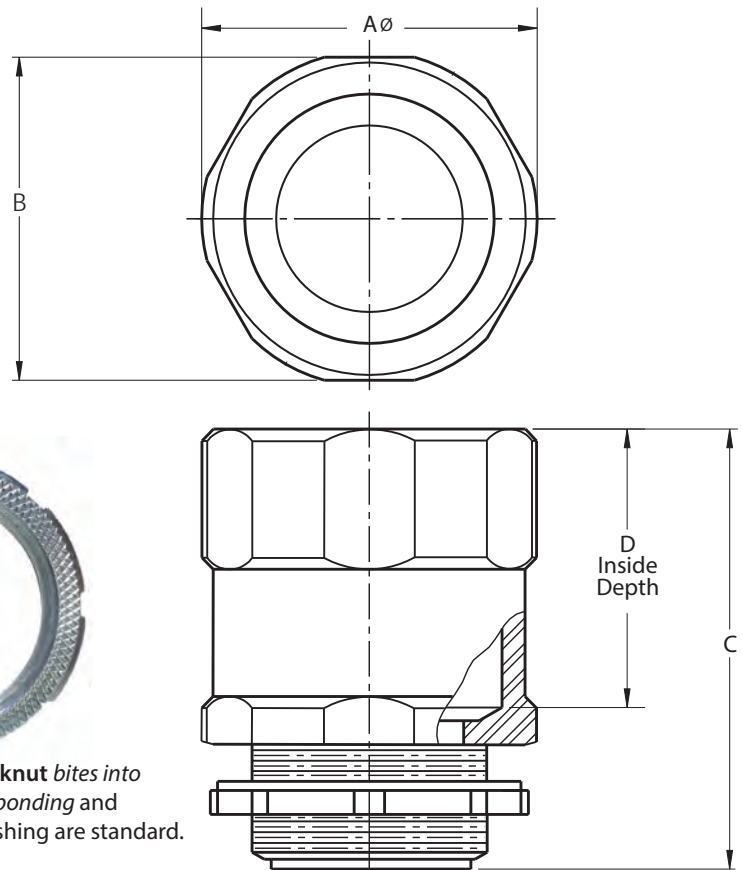

SPECflex Connectors

Cat #	Trade Size	Mat'l *	A	B hex	C Ø	D
FLX50B	1/2"	Alloy Steel	1-5/32"	1-1/8"	1-9/16"	1-1/16"
FLX75B	3/4"	Alloy Steel	1-7/16"	1-3/8"	1-9/16"	1-1/16"
FLX100B	1"	Alloy Steel	1-11/16"	1-5/8"	1-5/8"	1-1/16"
FLX125B	1-1/4"	Alloy Steel	2-1/32"	1-31/32"	1-5/8"	1-1/16"
FLX150B	1-1/2"	Alloy Steel	2-9/32"	2-3/16"	1-29/32"	1-1/4"
FLX200B	2"	Alloy Steel	2-29/32"	2-29/32"	2"	1-9/32"
FLX250B	2 - 1/2"	Alloy Steel	3-13/32"	2-3/4"	2-1/2"	1-9/32"
FLX300B	3"	Alloy Steel	4"	3-29/32"	2-9/16"	1-5/16"
FLX350B	3 1/2"	Alloy Steel	4-9/16"	4-13/32"	2-9/16"	1-5/16"
FLX400B	4"	Alloy Steel	5-3/32"	4-29/32"	2-9/16"	1-5/16"

* ALUMINIUM Material - ADD suffix AL to the Cat # for Aluminum in sizes 1/2" - 2"
Consult with factory for fittings without insulated throat or sizes not shown.

Saves Labor on Every Connection
No Screws to Pinch or Pierce Conduit
Alloy Steel Construction* NOT a Thin Wall Die Cast Fitting
Maintains Full Integrity of Conduit ID & OD
Allows More Room Inside Conduit For Wire
You Can Count-On a Safe Burr-less Wire Pull

Note:
SPECflex connectors are designed to work and interface with UL listed, Made in USA FMC / Greenfield conduit. We cannot guarantee fit, form, or function with non-UL off-shore conduit. Request a sample from factory to ensure compatibility.

* Steel is Zinc Electro Plated for Full Corrosion Resistance

FLX-AM2296B

AMERICAN FITTINGS Corporation



Made in the USA Since 1946

Industrial SPEC-flex™
FMC to Enclosure
90° Conduit Adapters
1/2" to 2"

SPECflex™ Connector System

FLEX Series Industrial Flexible Metal Conduit Connectors

Solid Steel Fully Machined FMC SPEC-flex Connectors

Made in the USA

90° Adapter Used to Connect FMC to a Box or Enclosure

Patent Pending Uniquely Engineered for Industrial Projects and OEM Product Performance

Superior Performance for Secure Connectors and Fast Disconnect
GripsTight, Grips Right on Every Connection

Furnished with Our Industrial Grade Locknut and Sealing Washer with an Optional UL Component Temperature Rated 150°C Insulated Throat

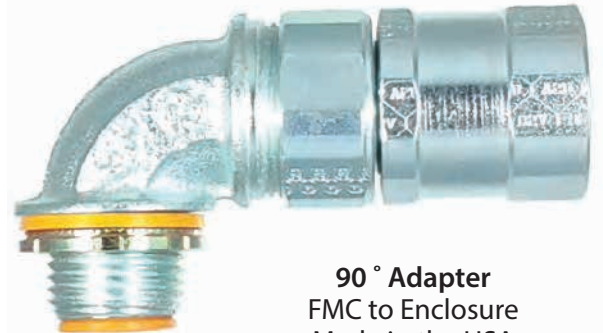

90° Adapter
FMC to Enclosure
Made in the USA

Save Time on Every Connection!

Note:

SPECflex connectors are designed to work and interface with UL listed, Made in USA FMC / Greenfield conduit. We cannot guarantee fit, form, or function with non-UL off-shore conduit. Request a sample from factory to ensure capability.

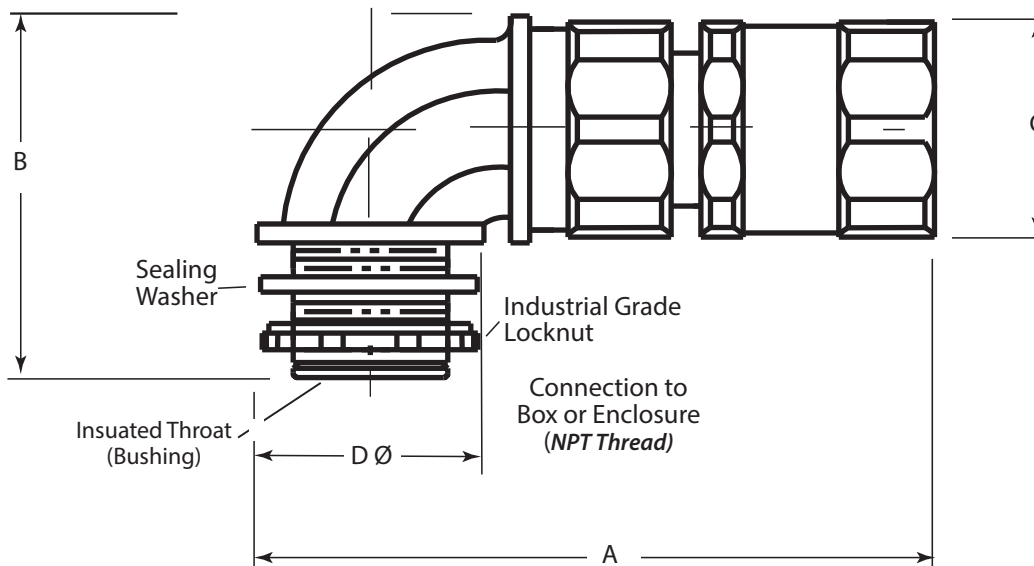

SPECflex Industrial Grade FMC Connectors 90° Adapters

Cat #	Trade Size	A	B	C hex	E
FLX5090B	1/2"	3-3/8"	1-15/16"	1-1/8"	1-3/16"
FLX7590B	3/4"	3-19/32"	2-5/32"	1-3/8"	1-11/32"
FLX10090B	1"	4"	2-11/16"	1-5/8"	1-11/16"
FLX12590B	1 1/4"	4-5/16"	2-15/16"	1-31/32"	2"
FLX15090B	1 1/2"	5-1/16"	3-3/16"	2-3/16"	2-1/4"
FLX20090B	2"	5-21/32"	3-23/32"	2-25/32"	2-3/4"

Consult with factory for fittings without insulated throat.

FLX-Adapt AM1197.B

AMERICAN FITTINGS Corporation



Made in the USA Since 1946

Industrial SPEC-flex™
FMC to Enclosure
45° Conduit Adapters
1/2" to 2"

SPECflex™ Connector System

FLEX Series Industrial Flexible Metal Conduit Connectors

Solid Steel Fully Machined FMC SPEC-flex Connectors
Made in the USA

45° Adapter Used to Connect FMC to a Box or Enclosure

Patent Pending Uniquely Engineered for Industrial Projects and OEM Product Performance

Superior Performance for Secure Connectors and Fast Disconnect
GripsTight, Grips Right on Every Connection

Furnished with Our Industrial Grade Locknut and Sealing Washer with an Optional UL Component Temperature Rated 150°C Insulated Throat

Save Time on Every Connection!

Note:

SPECflex connectors are designed to work and interface with UL listed, Made in USA FMC / Greenfield conduit. We cannot guarantee fit, form, or function with non-UL off-shore conduit. Request a sample from factory to ensure capability.



45° Adapter
FMC to Enclosure
Made in the USA

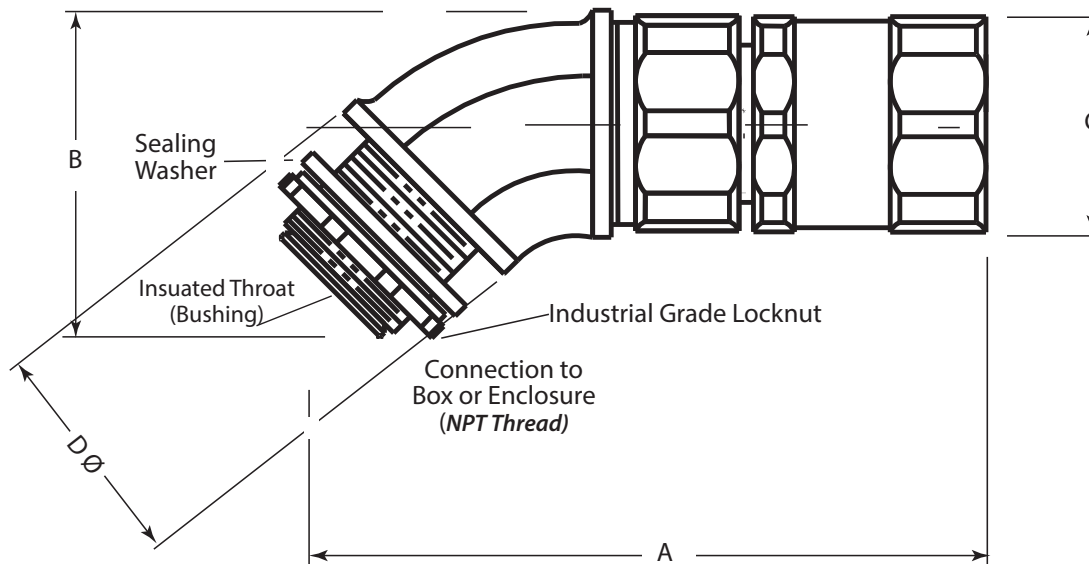

SPECflex Industrial Grade FMC Connectors 45° Adapters

Cat #	Trade Size	A	B	C hex	E
FLX5045B	1/2"	3-21/32"	1-21/32"	1-1/8"	1-3/16"
FLX7545B	3/4"	3-25/32"	1-15/16"	1-3/8"	1-11/32"
FLX10045B	1"	4"	2-5/32"	1-5/8"	1-11/16"
FLX12545B	1 1/4"	4-1/4"	2-15/32"	1-31/32"	2"
FLX15045B	1 1/2"	5"	2-25/32"	2-3/16"	2-1/4"
FLX20045B	2"	5-1/2"	3-5/16"	2-25/32"	2-3/4"

Consult with factory for fittings without insulated throat.

FLX-Adapt AM1198.B

AMERICAN FITTINGS Corporation

Made in the USA Since 1946



Industrial SPEC-flex Adapter
FMC to Flexible Cord
1/2" - 2"

SPECflex Connector System

FLEX Series Industrial Flexible Metal Conduit Adapter
Transitions FMC (Greenfield) to Flexible Non-Metallic Cord
Made in the USA

Solid Steel Fully Machined SPECflex Connector with
AMFICO Industrial Grade Flexible Cord & Cable Connector

Patent Pending Uniquely Engineered for Industrial Projects and
OEM Product Performance

Superior Performance for Secure Connection and Fast Disconnect
No Tools Required to Install Connector on FMC Conduit



Greenfield to Flexible Cord

Save Time on Every Connection!



FMC (Greenfield)



Flexible Cord or Cable

Grips Tight and Right on Every Connection

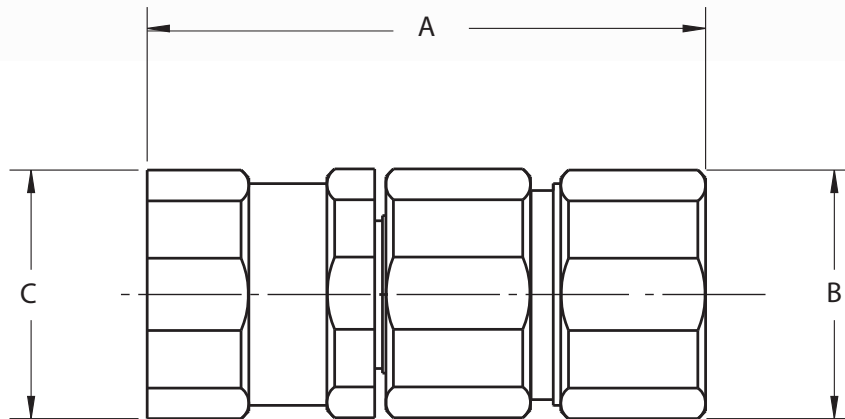

Note:

SPECflex connectors are designed to work and interface with UL listed, Made in USA FMC / Greenfield conduit. We cannot guarantee fit, form, or function with non-UL off-shore conduit. Request a sample from factory to ensure capatibility.

SPECflex Flexible Cord Adapters

Cat #	Trade Size	A	B hex	C hex
FLXCG50	1/2"	1-5/32"	1-1/32"	1-1/8"
FLXCG75	3/4"	1-7/16"	1-9/32"	1-3/8"
FLXCG100	1"	1-11/16"	1-9/16"	1-5/8"
FLXCG125	1-1/4"	2-1/32"	1-15/16"	1-31/32"
FLXCG150	1-1/2"	2-9/32"	2-9/32"	2-3/16"
FLXCG200	2"	2-7/8"	2-25/32"	2-25/32"

FXCG-AM1194-C



**FLEX Series Industrial Flexible Metal Conduit Adapter
Transitions FMC (Greenfield) to Liquid Tight Conduit
Made in the USA**

Solid Steel Fully Machined **SPECflex** Connector with
AMFICO Industrial Grade Liquid Tight Conduit Connector

Patent Pending Uniquely Engineered for Industrial Projects and
OEM Product Performance

**Superior Performance for Secure Connection and Fast Disconnect
No Tools Required to Install Conduit**

SPECflex Connector System



Greenfield to Liquid Tight

Save Time on Every Connection!



FMC Greenfield



Liquid Tight
Conduit

Grips Tight and Right on Every Connection

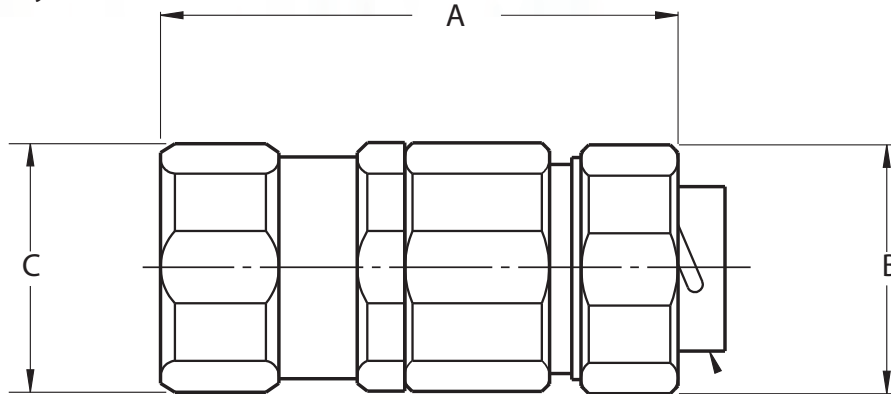

Note:
SPECflex connectors are designed to work and interface
with UL listed, Made in USA FMC / Greenfield conduit.
We cannot guarantee fit, form, or function with non-UL
off-shore conduit.
Request a sample from factory to ensure capatibility.

SPECflex Liquid Tight Adapters

Cat #	Trade Size	A	B hex	C hex
FLXLT50	1/2"	2-7/16"	1-1/8"	1-1/8"
FLXLT75	3/4"	2-1/2"	1-3/8"	1-3/8"
FLXLT100	1"	2-9/16"	1-11/16"	1-5/8"
FLXLT125	1-1/4"	2-31/32"	2-1/16"	1-21/32"
FLXLT150	1-1/2"	3-3/8"	2-9/32"	2-3/16"
FLXLT200	2"	3-9/16"	2-25/32"	2-25/32"

FKXLT.AM1193.D



SPECflex Connector System

FLEX Series Industrial Flexible Metal Conduit Adapter
Transitions FMC (Greenfield) to EMT
Made in the USA

Solid Steel Fully Machined **SPECflex** Connector with
AMFICO Industrial EMT Set Screw Fitting
Fittings are Solid Steel Zinc Plated

Patent Pending Uniquely Engineered for Industrial Projects and
OEM Product Performance
Superior Performance for Secure Connection and Fast Disconnect
No Tools Required to Install Connector on Flex Conduit



Greenfield to EMT Set Screw

Save Time on Every Connection!



Greenfield
FMC



EMT

Grips Tight and Right on Every Connection

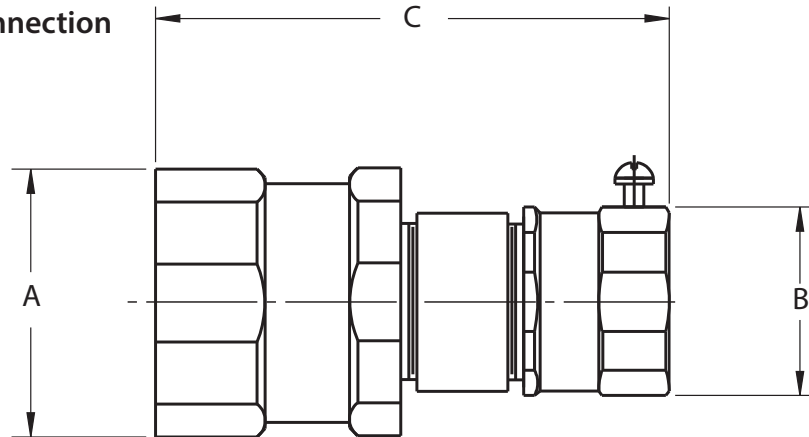

Note:
SPECflex connectors are designed to work and interface
with UL listed, Made in USA FMC / Greenfield conduit.
We cannot guarantee fit, form, or function with non-UL
off-shore conduit.
Request a sample from factory to ensure capatibility.

SPECflex EMT SET SCREW Adapters

Cat #	Trade Size	A	B hex	C hex
FLXSS 50	1/2"	2-5/8"	15/16"	1-1/8"
FLXSS 75	3/4"	2-21/32"	1-3/16"	1-3/8"
FLXSS 100	1"	2-31/32"	1-7/16"	1-5/8"
FLXSS 125	1-1/4"	3-7/32"	1-13/16"	1-31/32"
FLXSS 150	1-1/2"	3-23/32"	2-1/16"	2-13/16"
FLXSS 200	2"	3-23-32"	2-9/16"	2-25/32"

Note:
Also available in
Compression EMT
Liquid Tight
Cord Connectors

FLXEMT.SS.AM1575.B

AMERICAN FITTINGS Corporation

Made in the USA Since 1946



Industrial SPECflex Adapter
FMC to EMT Compression
1/2" - 2"

**FLEX Series Industrial Flexible Metal Conduit Adapter
Transitions FMC (Greenfield) to EMT
Made in the USA**

Solid Steel Fully Machined **SPECflex** Connector with
AMFICO Industrial EMT Compression Coupling
Fittings are Solid Steel Zinc Plated

Patent Pending Uniquely Engineered for Industrial Projects and
OEM Product Performance
**Superior Performance for Secure Connection and Fast Disconnect
No Tools Required to Install Connector on Flex Conduit**

SPECflex Connector System

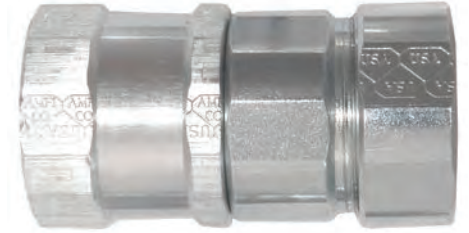

Greenfield to EMT Compression

Save Time on Every Connection!



Grips Tight and Right on Every Connection

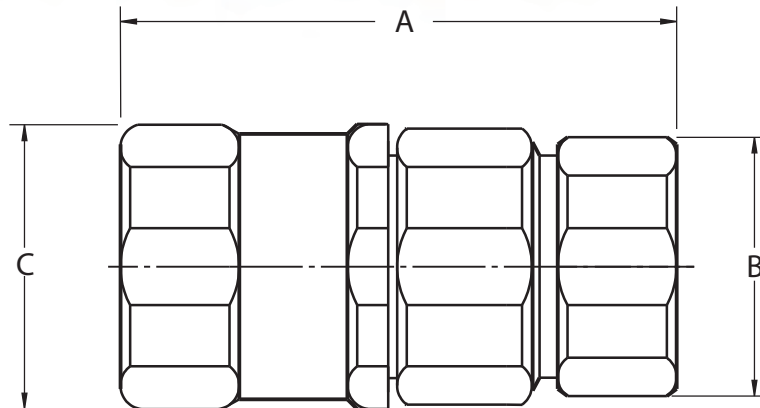

Note:
SPECflex connectors are designed to work and interface
with UL listed, Made in USA FMC / Greenfield conduit.
We cannot guarantee fit, form, or function with non-UL
off-shore conduit.
Request a sample from factory to ensure compatibility.

SPECflex EMT Compression Adapters

Cat #	Trade Size	A	B hex	C hex
FLXEMT50	1/2"	2-7/16"	15/16"	1-1/8"
FLXEMT75	3/4"	2-15/32"	1-3/16"	1-3/8"
FLXEMT100	1"	2-17/32"	1-7/16"	1-5/8"
FLXEMT125	1-1/4"	2-11/16"	1-13/16"	1-31/32"
FLXEMT150	1-1/2"	3-5/32"	2-1/16"	2-3/16"
FLXEMT200	2"	3-5/16"	2-9/16"	2-25/32"

FLXEMT-AM1195.B

AMFTGS.com

t: 800.221.5268

e:info@amftgs.com



SPECflex Connector System

FLEX Series Industrial Flexible Metal Conduit Adapter
Transitions FMC (Greenfield) to Rigid / IMC Conduit
Made in the USA

Solid Steel Fully Machined SPECflex Connector with
AMFICO Industrial Rigid Conduit Set Screw Fitting
Fittings are Solid Steel Zinc Plated

Patent Pending Uniquely Engineered for Industrial Projects and
OEM Product Performance
Superior Performance for Secure Connection and Fast Disconnect
No Tools Required to Install Connector on Flex Conduit

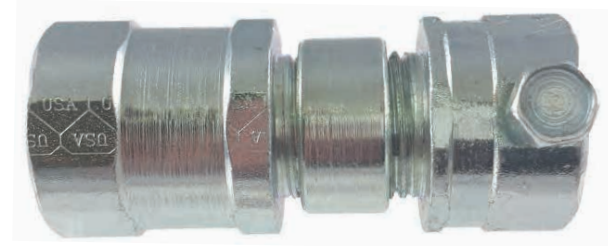

Greenfield to Rigid Conduit Set Screw
Save Time on Every Connection!



Greenfield
FMC



Rigid / IMC
Conduit

Grips Tight and Right on Every Connection

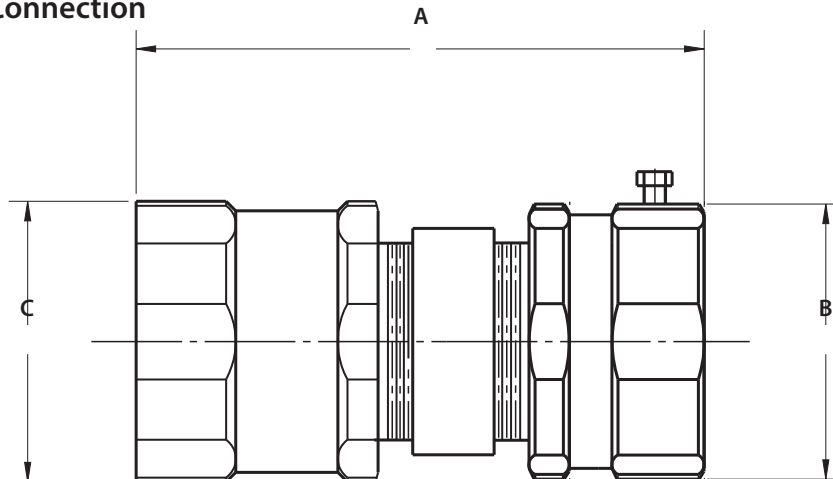

Note:
SPECflex connectors are designed to work and interface
with UL listed, Made in USA FMC / Greenfield conduit.
We cannot guarantee fit, form, or function with non-UL
off-shore conduit.
Request a sample from factory to ensure compatibility.

SPECflex to RIGID Conduit SET SCREW Adapters

Cat #	Trade Size	A	B hex	C hex
FLXSNT 50	1/2"	2-3/4"	1-1/8"	1-1/8"
FLXSNT 75	3/4"	3-25/32"	1-11/32"	1-3/8"
FLXSNT 100	1"	3-1/8"	1-5/8"	1-5/8"
FLXSNT 125	1-1/4"	3-5/16"	2-1/32"	1-31/32"
FLXSNT 150	1-1/2"	3-13/16"	2-9/32"	2-13/16"
FLXSNT 200	2"	4-1/32"	2-25/32"	2-25/32"

FLXSNT.AM11662.A

AMERICAN FITTINGS Corporation

Made in the USA Since 1946



Industrial SPEC-flex Adapter
FMC to Rigid Conduit Compression
1/2" - 2"

**FLEX Series Industrial Flexible Metal Conduit Adapter
Transitions FMC (Greenfield) to Rigid / IMC Conduit
Made in the USA**

Solid Steel Fully Machined **SPECflex** Connector with
AMFICO Industrial Rigid Conduit NT Compression Fitting
Fittings are Solid Steel Zinc Plated

Patent Pending Uniquely Engineered for Industrial Projects and
OEM Product Performance
**Superior Performance for Secure Connection and Fast Disconnect
No Tools Required to Install Flex Conduit**

SPECflex Connector System



Greenfield to Rigid Conduit NT Compression
Save Time on Every Connection!



Greenfield
FMC



Rigid / IMC
Conduit

Grips Tight and Right on Every Connection

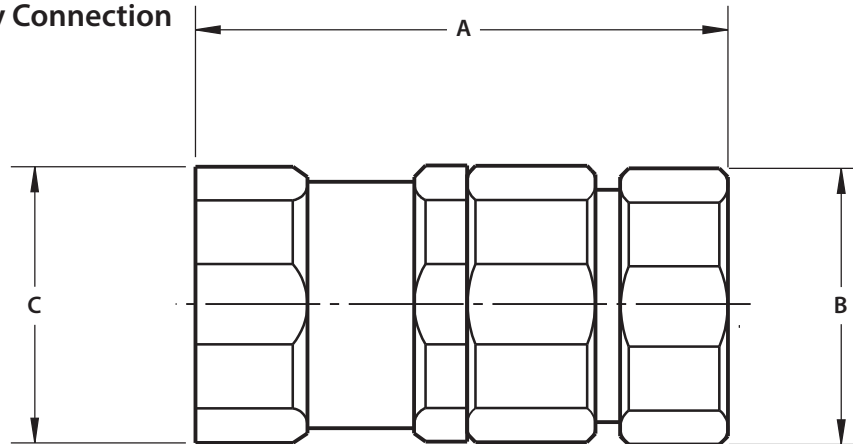

Note:
SPECflex connectors are designed to work and interface
with UL listed, Made in USA FMC / Greenfield conduit.
We cannot guarantee fit, form, or function with non-UL
off-shore conduit.
Request a sample from factory to ensure compatibility.

SPECflex to RIGID Conduit Compression NT Adapters

Cat #	Trade Size	A	B hex	C hex
FLXNT 50	1/2"	2-3/4"	1-1/8"	1-1/8"
FLXNT 75	3/4"	3-25/32"	1-11/32"	1-3/8"
FLXNT 100	1"	3-1/8"	1-5/8"	1-5/8"
FLXNT 125	1-1/4"	3-5/16"	2-1/32"	1-31/32"
FLXNT 150	1-1/2"	3-13/16"	2-9/32"	2-13/16"
FLXNT 200	2"	4-1/32"	2-25/32"	2-25/32"

FLXSNT-AM1732-A

AMFTGS.com

t: 800.221.5268

e: info@amftgs.com

Fully Machined Solid Steel Construction
Manufactured in the USA

EMT & Rigid Conduit Fittings
Liquid Tight Fittings
Cord & Cable Connectors
FMC Connectors
Greenfield Connectors
Ground Bushings
AMFICO Hubs
Reducing Bushings
Chase Nipples
MTO Specials
Aluminum & Stainless Steel



The Perfect Connection for

Agriculture
Alternative Energy
Federal & State Projects
Food Processing & Production
Industrial Applications
Military Bases
OEM Equipment
Oil & Gas Projects
Paper & Pulp
Transportation
Waste Water Treatment

Our Benefits to You

FULL-LINE Manufacturer, Enabling One Source Specs & Purchase
SAVE On Installation Time & Costs
RELIABILITY Since 1946 Consistency, Durability, & Strength
VALUE Eliminate Scrapping Cracked & Stripped Fittings
SUPERIOR On Time Delivery & Personalized Services
ALWAYS Meet Job Specifications, with Our Fittings - Guaranteed
NEVER Camouflaged Off-Shore Parts Sold in 'Brand Name' Boxes

NO SURPRISES, You Will Always Get What You Ordered. . .
When You Open Our Box You Will ALWAYS Find an AMERICAN Made Fitting. Full Traceability, & Material Certs are Always Available.

All Products Carry a 100% Product Performance Guarantee

AMFICO™

Made in the USA Since 1946

Sold Exclusively Through
Authorized Electrical Distributors



AMERICAN FITTINGS Corporation
17-10 Willow Street Fair Lawn, NJ 07410
t: 800.221.5268 | f: 201.664.1175

Online: amftgs.com e: info@amftgs.com
Product Cut Sheets Are Available Online

SPEC-grade™

Made in the USA

Cord GRIP Connectors 



Liquid-TIGHT Fittings 



EMT & Rigid Conduit Fittings 

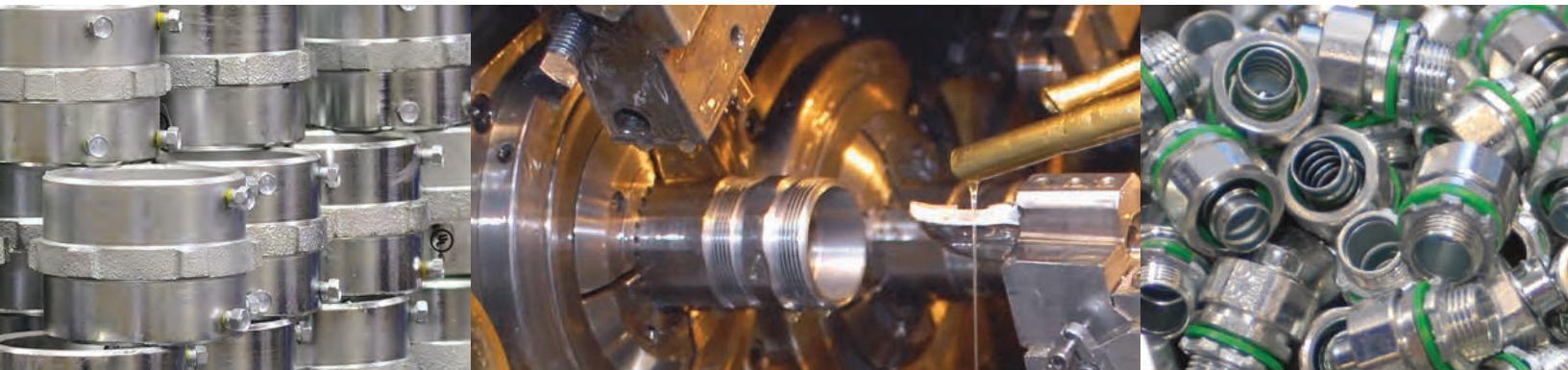

Quality has one name, AMERICAN™

amftgs.com