

PRODUCT INFORMATION

SSS

Square Straight Steel



Intended Use
Square straight steel general purpose pole for up to 39-foot mounting heights.

Construction
Shaft: Weldable grade, hot-rolled, commercial-quality carbon steel tubing with a minimum yield of 55,000 psi (11-gauge) or 50,000 psi (7-gauge). Uniform wall thickness of .125" or .188". Shaft is one piece with a full-length longitudinal high-frequency electric resistance weld. Uniformly square

in cross-section with flat sides, small corner radii and excellent torsional qualities. Available shaft widths are 4, 5 and 6 inches.

Anchor base: Fabricated from hot-rolled carbon steel plate conforming to ASTM A36 that meets or exceeds a minimum-yield strength of 36,000 psi. Base plate and shaft are circumferentially welded top and bottom.

Anchor bolts: Fabricated from carbon steel bar with minimum-yield strength of

55,000 psi. Bolts have an "L" bend on lower end and are galvanized a minimum of 12 inches on the threaded end per ASTM A-153. Each anchor bolt is furnished with two hex nuts and two flat washers.

Grounding: Provision located inside hand hole rim. Grounding hardware is not included (provided by others).

Hand hole: Reinforced hand-hole rim having nominal dimensions of 3" x 5" for all shafts. Includes steel cover with attachment screws.

Hardware: All fasteners are high-strength, galvanized or zinc-plated or stainless steel.
Top cap: Removable top cap provided with drill-mount poles.

Base cover: Includes full-base cover finished to match pole.

Finish: Must specify finish.



ADDITIONAL INFORMATION

For ordering information, see page 588. For additional product information, visit www.lithonia.com.

TECHNICAL INFORMATION - EPA (FT²) WITH 1.3 GUST													
CATALOG NUMBER	NOM. MOUNT. HT. (FT.)	POLE SHAFT SIZE (IN. X FT.)	WALL THICK. (IN.)	GAUGE	80 MPH	MAX. WT.	90 MPH	MAX. WT.	100 MPH	MAX. WT.	BOLT CIRCLE (IN.)	BOLT SIZE (IN. X IN. X IN.)	APPROX. SHIP WT. (LBS.)
SSS 10 4C	10	4 x 10	0.125	11	30.6	765	23.8	595	18.9	473	8 - 9	3/4 x 18 x 3	75
SSS 12 4C	12	4 x 12	0.125	11	24.4	610	18.8	470	14.8	370	8 - 9	3/4 x 18 x 3	90
SSS 14 4C	14	4 x 14	0.125	11	19.9	498	15.1	378	11.7	293	8 - 9	3/4 x 18 x 3	100
SSS 16 4C	16	4 x 16	0.125	11	15.9	398	11.8	295	8.9	223	8 - 9	3/4 x 18 x 3	115
SSS 18 4C	18	4 x 18	0.125	11	12.6	315	9.2	230	6.7	168	8 - 9	3/4 x 18 x 3	125
SSS 20 4C	20	4 x 20	0.125	11	9.6	240	6.7	167	4.5	150	8 - 9	3/4 x 18 x 3	140
SSS 20 4G	20	4 x 20	0.188	7	14.0	350	11.0	275	8.0	200	8 - 9	3/4 x 30 x 3	198
SSS 20 5C	20	5 x 20	0.125	11	17.7	443	12.7	343	9.4	235	10 - 12	1 x 36 x 4	185
SSS 20 5G	20	5 x 20	0.188	7	28.1	703	21.4	535	16.2	405	10 - 12	1 x 36 x 4	265
SSS 25 4C	25	4 x 25	0.125	11	4.8	150	2.6	100	1.0	50	8 - 9	3/4 x 18 x 3	170
SSS 25 4G	25	4 x 25	0.188	7	10.8	270	7.7	188	5.4	135	8 - 9	3/4 x 30 x 3	245
SSS 25 5C	25	5 x 25	0.125	11	9.8	245	6.3	157	3.7	150	10 - 12	1 x 36 x 4	225
SSS 25 5G	25	5 x 25	0.188	7	18.5	463	13.3	333	9.5	238	10 - 12	1 x 36 x 4	360
SSS 30 4G	30	4 x 30	0.188	7	6.0	150	4.0	100	2.5	75	8 - 9	3/4 x 30 x 3	295
SSS 30 5C	30	5 x 30	0.125	11	4.7	150	2.0	50	-	-	10 - 12	1 x 36 x 4	265
SSS 30 5G	30	5 x 30	0.188	7	10.7	267	6.7	167	3.9	100	10 - 12	1 x 36 x 4	380
SSS 30 6G	30	6 x 30	0.188	7	19.0	475	13.2	330	9.0	225	11 - 13	1 x 36 x 4	520
SSS 35 5G	35	5 x 35	0.188	7	5.9	150	2.5	100	-	-	10 - 12	1 x 36 x 4	440
SSS 35 6G	35	6 x 35	0.188	7	12.4	310	7.6	190	4.2	105	11 - 13	1 x 36 x 4	540
SSS 39 6G	39	6 x 39	0.188	7	7.2	180	3.0	75	-	-	11 - 13	1 x 36 x 4	605

POLE DATA						
SHAFT BASE SIZE	BOLT CIRCLE A	BOLT PROJECTION B	BASE SQUARE C	TEMPLATE DESCRIPTION	ANCHOR BOLT DESCRIPTION	ANCHOR BOLT AND TEMPLATE DESCRIPTION
4"C	8.5"	2.75" - 4.00"	8"	ABTEMPLATE PJ50004	AB18-0	ABSSS-4C
4"G	8.5"	2.75" - 4.00"	8"	ABTEMPLATE PJ50004	AB30-0	ABSSS-4G
5"	10" - 12"	3.375" - 4.00"	11"	ABTEMPLATE PJ50010	AB36-0	ABSSS-5
6"	11" - 13"	3.375" - 4.00"	12.5"	ABTEMPLATE PJ50011	AB36-0	NA

INSTALLATION NOTES: Factory-supplied templates must be used when setting anchor bolts. Lithonia Lighting will not accept claim for incorrect anchorage placement due to failure to use Lithonia Lighting factory templates. Do not erect poles without having fixtures installed. If poles are stored outside, all protective wrapping must be removed immediately upon delivery to prevent finish damage.

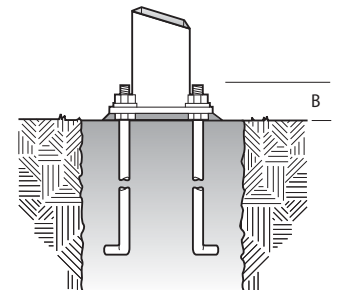
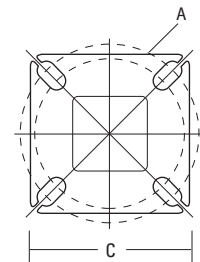
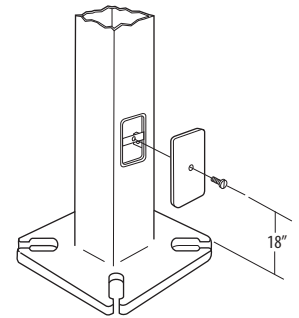

Notes

- Mounting arrangement: (PT) open top or (Tix) tenon and/or (DMxx) side drilling.
- Options, see pages 612-613.
- Brackets, see page 615.
- Bolt lengths are nominal; actual bolt lengths may vary.
- Fully galvanized anchor bolts available, consult factory.
- Direct burial option available, consult factory.
- Consult factory if product must meet "Buy American" specifications.