

Distributed by

  
**Graybar®**

# Single Pole Devices

**Temporary Power Connectors for the  
Most Demanding Environments**





## Single Pole Devices

### Temporary Power Connectors for the Most Demanding Environments

Hubbell Wiring Device-Kellems products have long set the standard for innovation, performance, safety and reliability. Our continuing success is born from the philosophy of never leaving well enough alone. We believe we can always make our products better – and the record shows we have.

Temporary power installations are unique and unpredictable and therefore are very demanding. The most critical mission is to keep the equipment running. Hubbell devices have the proven reliability to deliver secure connections allowing you to focus attention on what matters most.

Hubbell Single Pole devices are extremely durable. The double cam contact design can stand up to repeated mating and un-mating. The added protection of UL Type 4X, 12 environmental rating stands up to the most abusive environments. The engineered body design makes installation simple with no need for additional tools and the non-metallic retaining screw helps to make operation safe for all involved.

#### Male Plug

Insulgrip® Style Housing for Superior Gripping conforms to the user's hand making it easy to connect and disconnect, even with gloves on.

Rounded Corners reduce the possibility of catching or snagging on structures or equipment.

UL Enclosure Types 3R, 4X and 12 Rating  
Suitable for use in almost any environment.

Non-Conductive Retaining Screw locks contacts in place and allows for easy installation. Prevents contact movement within housing. Special screw thread requires fewer turns than most competitors and reduces the risk of a conductive screw being substituted.

Large Raised Alignment Arrow aids in the mating of devices and provides a visual indication that the devices are properly connected.

Double Cam Design provides high contact pressure and vibration resistant connection, which helps reduce operating temperatures and extends life.



#### Female Plug

Turn and Lock Symbol aids in the mating of devices and provides a clear indication that the devices are properly connected.

High Conductivity Brass Contact provides improved performance by helping to reduce operating temperatures and extends life.

Extra Long non-conductive inner sleeve reduces force required to install housing over contacts. Easier to rotate contact in body for installing retaining screw.

Easily Identifiable Cable with cut off points for secure fit allows you to easily customize the housing to the required cable size. Makes cutting to the correct cable size very easy. Accommodates wide range of cables.

Strip Gauge molded into every plug and receptacle housing. Simplifies installation and saves time.





## Single Pole Devices

### Series 15 - 150 Ampere, 600V AC/250V DC

#### Features and Benefits

- Enclosure Types 3R, 4X, 12
- Combo Head, Non-Metallic Safety Retaining Screw
- Insulgrip Body Design
- Accepts #8 AWG - #2 AWG Wire
- Insulgrip Body Design
- UL and cUL Listed



#### Plugs, Male

Description	Color	Male Plug
150 amp, thermoplastic elastomer, cable size #8 - #2 AWG.	Black	<b>HBL15MBK</b>
	White	<b>HBL15MW</b>
	Green	<b>HBL15MGN</b>
	Red	<b>HBL15MR</b>
	Blue	<b>HBL15MBL</b>

#### Plugs, Female

Description	Color	Female Plug
150 amp, thermoplastic elastomer, cable size #8 - #2 AWG.	Black	<b>HBL15FBK</b>
	White	<b>HBL15FW</b>
	Green	<b>HBL15FGN</b>
	Red	<b>HBL15FR</b>
	Blue	<b>HBL15FBL</b>

#### Receptacles, Stud Type $1\frac{1}{16}" \times \frac{3}{4}"$



Description	Color	Female Receptacles	Male Receptacles
150 amp Panel Mount, thermoplastic.	Black	<b>HBL15FRSBK</b>	<b>HBL15MRSBK</b>
	White	<b>HBL15FRSW</b>	<b>HBL15MRSW</b>
	Green	<b>HBL15FRSGN</b>	<b>HBL15MRSGN</b>
	Red	<b>HBL15FRSR</b>	<b>HBL15MRSR</b>
	Blue	<b>HBL15FRSBL</b>	<b>HBL15MRSBL</b>

#### Receptacles, Double Set Screw



Description	Female Receptacles	Male Receptacles
150 amp Panel Mount, thermoplastic, cable size #8 - #2 AWG.	<b>HBL15FRBK</b>	<b>HBL15MRBK</b>
	<b>HBL15FRW</b>	<b>HBL15MRW</b>
	<b>HBL15FRGN</b>	<b>HBL15MRGN</b>
	<b>HBL15FRR</b>	<b>HBL15MRR</b>
	<b>HBL15FRBL</b>	<b>HBL15MRBL</b>



#### Protective Caps

Description	Color	Fits Male Devices	Fits Female Devices
Fits 150 amp plugs and receptacles.	Black	<b>HBL15MCAPBK</b>	<b>HBL15FCAPBK</b>
	White	<b>HBL15MCAPW</b>	<b>HBL15FCAPW</b>
	Green	<b>HBL15MCAPGN</b>	<b>HBL15FCAPGN</b>
	Red	<b>HBL15MCAPR</b>	<b>HBL15FCAPR</b>
	Blue	<b>HBL15MCAPBL</b>	<b>HBL15FCAPBL</b>

#### Weather Protective Covers



Description	Color	Catalog Number
Use with stud type or double set screw receptacles.	Black	<b>HBL15NCBK</b>
	White	<b>HBL15NCW</b>
	Green	<b>HBL15NCGN</b>
	Red	<b>HBL15NCR</b>
	Blue	<b>HBL15NCBL</b>



## Single Pole Devices

Series 15 - 150 Ampere, 600V AC/250V DC

### Tees



Color	Tapping Tee (Female-Female-Male)	Paralleling Tee (Female-Male-Male)
Black	<b>HBL15TBK</b>	<b>HBL15PTBK</b>
White	<b>HBL15TW</b>	<b>HBL15PTW</b>
Green	<b>HBL15TGN</b>	<b>HBL15PTGN</b>
Red	<b>HBL15TR</b>	<b>HBL15PTR</b>
Blue	<b>HBL15TBL</b>	<b>HBL15PTBL</b>

Note: \*Not UL listed, consult factory for availability.

### Replacement Bodies (25 Pack)



Color	Male Body	Female Body
Black	<b>HBL15MBBK</b>	<b>HBL15FBBK</b>
White	<b>HBL15MBW</b>	<b>HBL15FBW</b>
Green	<b>HBL15MBGN</b>	<b>HBL15FBGN</b>
Red	<b>HBL15MBR</b>	<b>HBL15FBR</b>
Blue	<b>HBL15MBBL</b>	<b>HBL15FBBL</b>

### Accessories

Description	Catalog Number
Accessory Kit, retaining screw, copper foil, terminal screws and brass wire.	<b>HBL15PK</b>
Replacement retaining screw (100 pack).	<b>HBL15RS</b>
Copper foil (100 pack).	<b>HBL15CF</b>
Brass wire (100 pack).	<b>HBL15BW</b>
Terminal screw - inline (100 pack).	<b>HBL15TS25</b>
Terminal screw - panel mount (100 pack).	<b>HBL15TS375</b>
Ferrule #2 AWG (100 pack).	<b>HBL15F2</b>
Ferrule #4 AWG (100 pack).	<b>HBL15F4</b>

### Gender Reversing Devices



Color	Double Male (Male-Male)	Double Female (Female-Female)
Black	<b>HBL15DMBK*</b>	<b>HBL15DFBK*</b>
White	<b>HBL15DMW</b>	<b>HBL15DFW</b>
Green	<b>HBL15DMGN</b>	<b>HBL15DFGN</b>
Red	<b>HBL15DMR*</b>	<b>HBL15DFR*</b>
Blue	<b>HBL15DMBL*</b>	<b>HBL15DFBL*</b>

### Replacement Contacts (25 Pack)



Description	Male Pin	Female Sleeve
Contact, 150 amp	<b>HBL15RCM</b>	<b>HBL15RCF</b>



**HBL15PK**



**HBL15RS**



**HBL15CF**



**HBL15BW**



**HBL15TS25**



**HBL15TS375**



**HBL15F2  
HBL15F4**



## Single Pole Devices

### Series 16 - 300 and 400 Ampere, 600V AC/250V DC

#### Features and Benefits

- Enclosure Types 3R, 4X, 12
- Non-Metallic Safety Retaining Screw
- Insulgrip Body Design
- Accepts #6 AWG - 4/0 Wire
- UL and cUL Listed



#### Plugs



Description	Color	Male Plug	Female Plug
300 amp, thermoplastic elastomer, cable size #6 - 2/0 AWG.	Black	<b>HBL300MBK</b>	<b>HBL300FBK</b>
	White	<b>HBL300MW</b>	<b>HBL300FW</b>
	Green	<b>HBL300MGN</b>	<b>HBL300FGN</b>
	Red	<b>HBL300MR</b>	<b>HBL300FR</b>
	Blue	<b>HBL300MBL</b>	<b>HBL300FBL</b>
	Brown	<b>HBL300MBN</b>	<b>HBL300FBN</b>
	Orange	<b>HBL300MO</b>	<b>HBL300FO</b>
	Yellow	<b>HBL300MY</b>	<b>HBL300FY</b>



Description	Color	Male Plug	Female Plug
400 amp, thermoplastic elastomer, cable size 2/0 - 4/0 AWG.	Black	<b>HBL400MBK</b>	<b>HBL400FBK</b>
	White	<b>HBL400MW</b>	<b>HBL400FW</b>
	Green	<b>HBL400MGN</b>	<b>HBL400FGN</b>
	Red	<b>HBL400MR</b>	<b>HBL400FR</b>
	Blue	<b>HBL400MBL</b>	<b>HBL400FBL</b>
	Brown	<b>HBL400MBN</b>	<b>HBL400FBN</b>
	Orange	<b>HBL400MO</b>	<b>HBL400FO</b>
	Yellow	<b>HBL400MY</b>	<b>HBL400FY</b>

#### Receptacles, Female Stud Type



Description	Color	Through Hole Mounting	Threaded Mounting Holes
400 amp Panel Mount, thermoplastic elastomer, mates with 300 and 400 amp plugs.	Black	<b>HBLFRSBK</b>	<b>HBLFRSCBK</b>
	White	<b>HBLFRSW</b>	<b>HBLFRSCW</b>
	Green	<b>HBLFRSGN</b>	<b>HBLFRSCGN</b>
	Red	<b>HBLFRSR</b>	<b>HBLFRSCR</b>
	Blue	<b>HBLFRSBL</b>	<b>HBLFRSCBL</b>
	Brown	<b>HBLFRSBN</b>	<b>HBLFRSCBN</b>
	Orange	<b>HBLFRSO</b>	<b>HBLFRSCO</b>
	Yellow	<b>HBLFRSY</b>	<b>HBLFRSCY</b>

#### Receptacles, Male Stud Type



Description	Color	Through Hole Mounting	Threaded Mounting Holes
400 amp Panel Mount, thermoplastic elastomer, mates with 300 and 400 amp plugs.	Black	<b>HBLMRSBK</b>	<b>HBLMRSCBK</b>
	White	<b>HBLMRSW</b>	<b>HBLMRSCW</b>
	Green	<b>HBLMRSGN</b>	<b>HBLMRSCGN</b>
	Red	<b>HBLMRSR</b>	<b>HBLMRSCR</b>
	Blue	<b>HBLMRSBL</b>	<b>HBLMRSCBL</b>
	Brown	<b>HBLMRSBN</b>	<b>HBLMRSCBN</b>
	Orange	<b>HBLMRSO</b>	<b>HBLMRSCO</b>
	Yellow	<b>HBLMRSY</b>	<b>HBLMRSCY</b>

#### Receptacles, Double Set Screw



Description	Color	Female Receptacles Threaded Mounting Holes	Male Receptacles Threaded Mounting Holes
400 amp Panel Mount, thermoplastic elastomer, cable size #4 - 4/0 AWG, mates with 300 and 400 amp plugs.	Black	<b>HBLFRBK</b>	<b>HBLMRBK</b>
	White	<b>HBLFRW</b>	<b>HBLMRW</b>
	Green	<b>HBLFRGN</b>	<b>HBLMRGN</b>
	Red	<b>HBLFRR</b>	<b>HBLMRR</b>
	Blue	<b>HBLFRBL</b>	<b>HBLMRBL</b>
	Brown	<b>HBLFRBN</b>	<b>HBLMRBN</b>
	Orange	<b>HBLFRO</b>	<b>HBLMRO</b>
	Yellow	<b>HBLFRY</b>	<b>HBLMRY</b>

#### Receptacles, Bus Bar Mount



Description	Color	Female Receptacles Threaded Mounting Holes	Male Receptacles Threaded Mounting Holes
400 amp Mount, thermoplastic elastomer, mates with 300 and 400 amp plugs.	Black	<b>HBLFRBBK</b>	<b>HBLMRBBK</b>
	White	<b>HBLFRBW</b>	<b>HBLMRBW</b>
	Green	<b>HBLFRBGN</b>	<b>HBLMRBGN</b>
	Red	<b>HBLFRBR</b>	<b>HBLMRBR</b>
	Blue	<b>HBLFRBBL</b>	<b>HBLMRBBL</b>
	Brown	<b>HBLFRBBN</b>	<b>HBLMRBBN</b>
	Orange	<b>HBLFRBO</b>	<b>HBLMRBO</b>
	Yellow	<b>HBLFRBY</b>	<b>HBLMRBY</b>

## Single Pole Devices

Series 16 - 300 and 400 Ampere, 600V AC/250V DC



### Tees and 3-Fers

Color	Tapping Tee (Female-Female-Male)	Paralleling Tee (Female-Male-Male)	3-Fer (Male-Female- Female-Female)	3-Fer (Female-Male- Male-Male)	Soft 3-Fer (Male-Female- Female-Female)	Soft 3-Fer (Female- Male-Male-Male)
Black	<b>HBLTBK</b>	<b>HBLPTBK</b>	<b>HBLM3FBK</b>	<b>HBLF3MBK</b>	<b>HBLM3FSBK</b>	—
White	<b>HBLTW</b>	<b>HBLPTW</b>	<b>HBLM3FW</b>	<b>HBLF3MW</b>	—	—
Green	<b>HBLTGN</b>	<b>HBLPTGN</b>	<b>HBLM3FGN</b>	<b>HBLF3MGN</b>	—	<b>HBLF3FSGN</b>
Red	<b>HBLTR</b>	<b>HBLPTR</b>	<b>HBLM3FR</b>	<b>HBLF3MR</b>	—	—
Blue	<b>HBLTBL</b>	<b>HBLPTBL</b>	<b>HBLM3FBL</b>	<b>HBLF3MBL</b>	—	—
Brown	<b>HBLTBN</b>	<b>HBLPTBN</b>	<b>HBLM3FBN</b>	<b>HBLF3MBN</b>	—	—
Orange	<b>HBLTO</b>	<b>HBLPTO</b>	<b>HBLM3FO</b>	<b>HBLF3MO</b>	—	—
Yellow	<b>HBLTY</b>	<b>HBLPTY</b>	<b>HBLM3FY</b>	<b>HBLF3MY</b>	—	—

### Gender Reversing Devices



Color	Double Male (Male-Male)	Double Female (Female-Female)
Black	<b>HBLDMBK</b>	<b>HBLDFBK</b>
White	<b>HBLDMW</b>	<b>HBLDFW</b>
Green	<b>HBLDMGN</b>	<b>HBLDFGN</b>
Red	<b>HBLDMR</b>	<b>HBLDFR</b>
Blue	<b>HBLDMBL</b>	<b>HBLDFBL</b>
Brown	<b>HBLDMBN</b>	<b>HBLDFBN</b>
Orange	<b>HBLDMO</b>	<b>HBLDFO</b>
Yellow	<b>HBLDMY</b>	<b>HBLDFY</b>

### Distribution Block

(1-Male, 6-Females)



Color	Catalog Number
Black	<b>HBL7DBBK</b>
White	<b>HBL7DBW</b>
Green	<b>HBL7DBGN</b>
Red	<b>HBL7DBR</b>
Blue	<b>HBL7DBBL</b>
Brown	<b>HBL7DBBN</b>
Orange	<b>HBL7DBO</b>
Yellow	<b>HBL7DBY</b>

### Weather Protective Covers



Color	Catalog Number
Black	<b>HBLNCBK</b>
White	<b>HBLNCW</b>
Green	<b>HBLNCGN</b>
Red	<b>HBLNCR</b>
Blue	<b>HBLNCBL</b>
Brown	<b>HBLNCBN</b>
Orange	<b>HBLNCO</b>
Yellow	<b>HBLNCY</b>

### Protective Caps



Color	Fits Male Devices	Fits Female Devices
Black	<b>HBLMCAPBK</b>	<b>HBLFCAPBK</b>
White	<b>HBLMCAPW</b>	<b>HBLFCAPW</b>
Green	<b>HBLMCAPGN</b>	<b>HBLFCAPGN</b>
Red	<b>HBLMCAPR</b>	<b>HBLFCAPR</b>
Blue	<b>HBLMCAPBL</b>	<b>HBLFCAPBL</b>
Brown	<b>HBLMCAPBN</b>	<b>HBLFCAPBN</b>
Orange	<b>HBLMCAPO</b>	<b>HBLFCAPO</b>
Yellow	<b>HBLMCAPY</b>	<b>HBLFCAPY</b>

Note: \*3R only.

### Replacement Bodies (100 Pack)



Color	Male Body	Female Body
Black	<b>HBLMBBK</b>	<b>HBLFBBK</b>
White	<b>HBLMBW</b>	<b>HBLFBW</b>
Green	<b>HBLMBGN</b>	<b>HBLFBGN</b>
Red	<b>HBLMBR</b>	<b>HBLFBR</b>
Blue	<b>HBLMBBL</b>	<b>HBLFBBL</b>
Brown	<b>HBLMBBN</b>	<b>HBLFBBN</b>
Orange	<b>HBLMBO</b>	<b>HBLFBO</b>
Yellow	<b>HBLMBY</b>	<b>HBLFBY</b>

### Accessories

Description	Catalog Number
Accessory Kit, retaining screw, copper foil, terminal screws and brass wire	<b>HBLPK</b>
Replacement retaining screw (500 pack)	<b>HBLRS</b>
Copper foil (500 pack)	<b>HBLCF</b>

### Snap Back Covers

Color	Through Hole Mounting	Threaded Mounting Holes
Black	<b>HBLSCBK*</b>	<b>HBLSCCBK*</b>
White	<b>HBLSCW*</b>	<b>HBLSCCW*</b>
Green	<b>HBLSCGN*</b>	<b>HBLSCCGN*</b>
Red	<b>HBLSCR*</b>	<b>HBLSCCR*</b>
Blue	<b>HBLSCBL*</b>	<b>HBLSCCBL*</b>
Brown	<b>HBLSCBN*</b>	<b>HBLSCCBN*</b>
Orange	<b>HBLSCO*</b>	<b>HBLSCCO*</b>
Yellow	<b>HBLSCY*</b>	<b>HBLSCCY*</b>



### Replacement Contacts (20 Pack)



Description	Male Pin	Female Sleeve
Contact, 300 amp	<b>HBL300RCM</b>	<b>HBL300RCF</b>
Contact, 400 amp	<b>HBL400RCM</b>	<b>HBL400RCF</b>

### Accessories

Description	Catalog Number
Brass wire (500 pack)	<b>HBLBW</b>
Terminal screw - panel mount (500 pack)	<b>HBLTSR</b>
Terminal screw - inline (500 pack)	<b>HBLTS</b>



# Single Pole Devices

## Series 15 and 16 Specifications and Dimensions

**HUBBELL®**  
Wiring Device-Kellems

### Specifications

Electrical	Series 15	Series 16
Voltage Ratings	600V AC Maximum 250V DC Maximum	600V AC Maximum 250V DC Maximum
Amperage Rating	150A Maximum	400A Maximum

Mechanical	Series 15	Series 16-300A	Series 16-400A
Terminal Accommodation	Plug: #2 AWG to #8 AWG Recept.: #2 AWG to #8 AWG	Plug: #6 to 2/0	Plug: 2/0 to 4/0 Recept.: #4 to 4/0
Product ID	Ratings are a permanent part of device		
Base Compound	Thermoplastic Elastomer (TPE)		
Contact Material	Brass		
Retaining Screw Material	Nylon		

### Certification / Environmental

Series 15 and 16
UL and cUL Listed.
UL Enclosure Types 3R, 4X, 12.
UL 1691 standard for single pole locking-type separable connectors (Series 16 Pending).
National Electric Code (NEC), ANSI/NFPA 70.
Flammability: HB per UL94 or CSA 22.2. 0.17.

### Conductor Ampacity Chart (Type SC/PPC Wire)

Cable Size	Ampacity*	Cable Size	Ampacity*
#6	105	2/0	300
#4	140	4/0	405
#2	190		

Note: \*90°C column NEC Table 400.5(A)(2).

### Dimensions Inches (mm)

#### Panel Mount Receptacles

Series 15	Threaded Stud	A	B	C	D	E	F	G	Mounting Hole	Termination
	Male	1.86" (47.2)	1.37" (34.8)	N/A	2.82" (71.6)	.86" (22.0)	.80" (20.4)	1.20" (30.5)	Through 3x Ø .20"	5/16-18 Threaded Stud
	Female	1.86" (47.2)	1.37" (34.8)	N/A	2.88" (73.1)	.86" (22.0)	.80" (20.4)	1.26" (32.0)	Through 3x Ø .20"	5/16-18 Threaded Stud
	Double Set Screw	A	B	C	D	E	F	G	Mounting Hole	Termination
Series 15	Male	1.86" (47.2)	1.37" (34.8)	N/A	2.90" (73.6)	.86" (22.0)	.88" (22.2)	1.20" (30.5)	Through 3x Ø .20"	(2) 5/32 Socket Head Set Screws
	Female	1.86" (47.2)	1.37" (34.8)	N/A	2.95" (74.9)	.86" (22.0)	.87" (22.2)	1.26" (32.0)	Through 3x Ø .20"	(2) 5/32 Socket Head Set Screws

Series 16	Threaded Stud	A	B	C	D	E	F	G	Mounting Hole	Termination
	Male & Female w/ through hole mounting	2.20" (55.9)	2.20" (55.9)	1.50" (38.1)	4.10" (104.3)	1.48" (47.4)	1.25" (31.7)	1.74" (44.2)	Through 4x Ø .20"	1/2-13 UNC-2A Threaded Stud
	Male & Female w/ threaded mounting holes	2.20" (55.9)	2.20" (55.9)	1.50" (38.1)	3.67" (93.2)	1.48" (47.4)	1.11" (28.2)	1.55" (39.4)	Threaded 4x #10-32	1/2-13 UNC-2A Threaded Stud
	Double Set Screw	A	B	C	D	E	F	G	Mounting Hole	Termination
Series 16	Male & Female w/ threaded mounting holes	2.20" (55.9)	2.20" (55.9)	1.50" (38.1)	4.10" (104.3)	1.48" (47.4)	1.36" (34.5)	1.74" (44.2)	Threaded 4x #10-32	(2) 7/32 Socket Head Set Screws
	Busbar Type	A	B	C	D	E	F	G	Mounting Hole	Termination
Series 16	Male & Female w/ threaded mounting holes	2.20" (55.9)	2.20" (55.9)	1.50" (38.1)	3.57" (90.7)	1.48" (37.6)	1.01" (25.7)	1.55" (39.4)	Threaded 4x #10-32	(1) 5/16-18 UNC-2B Threaded Hole

#### Series 15 Threaded Stud (Male Shown)

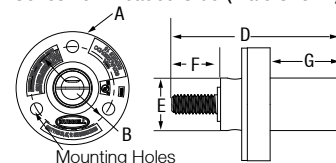

#### Series 16 Threaded Stud (Male Shown)

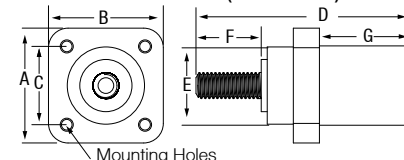

#### Series 16 Double Set Screw (Male Shown)

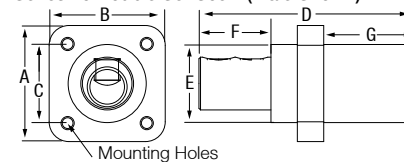

#### Series 16 Busbar Type (Male Shown)

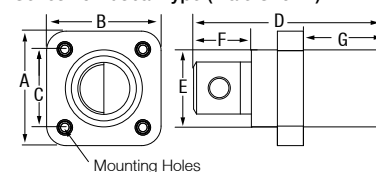

### In Line Plugs

Series 15		A	B	C	D
	Male	4.54" (115-.3)	1.04" (26.4)	.86" (21.8)	3.22" (81.7)
Series 15	Female	4.60" (116.8)	1.11" (28.2)	.68" (17.3)	3.28" (83.2)

### In Line Plugs

Series 16		A	B	C	D
	Male	7.01" (178.0)	1.38" (35.1)	1.48" (37.6)	4.78" (121.4)
Series 16	Female	7.10" (180.5)	1.44" (36.6)	1.06" (27.0)	4.90" (121.3)

#### Inline Plug (Male shown)

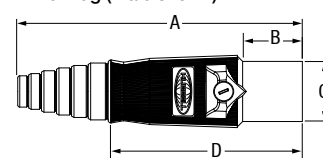

### Weatherproof Cover

Series 15-16		A	B	C
	Series 15	2.03" (51.5)	1.14" (29.0)	1.49" (37.9)
	Series 16	2.20" (55.88)	1.16" (29.44)	2.03" (51.5)

### Snap Back Cover

Series 16	For Use With	A	B
	Through Hole Receptacles	2.26" (57.4)	2.37" (60.2)
	Threaded Hole Receptacles	2.26" (57.4)	2.37" (60.2)

#### Series 15 Weatherproof Cover

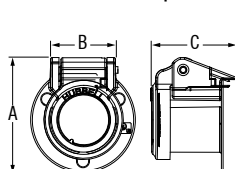

#### Series 16 Weatherproof Cover

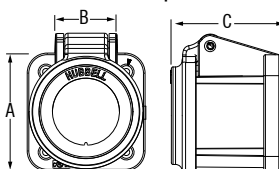

#### Series 16 Snap Back Cover

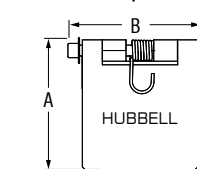



# Single Pole Devices

**Temporary Power Designed for the  
Most Demanding Environments**

## More Industry Products from Hubbell

### STRAIGHT BLADE DEVICES



Insulgrip® Plugs, Connectors, Receptacles and Inlets - the widest range of singularly rated NEMA devices available. Insulgrip products are synonymous with Hubbell's ongoing commitment to producing high quality electric products.

### TWIST-LOCK® DEVICES



Twist-Lock Insulgrip® Plugs, Connectors, Receptacles and Inlets - the widest range of singularly rated NEMA devices available. Designed to last from engineered thermoplastic materials and high performing alloys.

### IEC PIN & SLEEVE DEVICES



IEC Watertight Devices provide safe and dependable performance in the most demanding environments. Heavy duty non-conductive nylon construction provides impact and corrosion protection.

## Available Literature

Hubbell offers an extensive literature library for product support. Downloadable PDFs are available online at [www.hubbell-wiring.com](http://www.hubbell-wiring.com).

Hubbell Safety  
Brochure



Hubbell Safety Evaluation  
Brochure



Insulgrip® Wiring Devices  
Application Guide

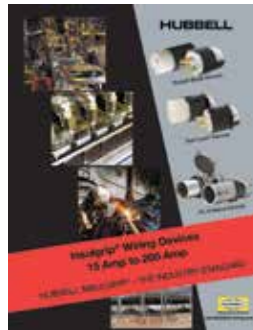

Hubbell Slide Charts



Twist-Lock®  
Devices



Kellems®  
Mesh Grips

## Website Support

The Hubbell Wiring Systems website offers fast convenient information with our online virtual catalog, technical support, literature support and more. The website also offers landing pages for vertical markets and sustainable building. Visit [www.hubbell-wiring.com](http://www.hubbell-wiring.com).

