

Industrial Grade  
Made in USA

1/2" to 2"  
Greenfield Connectors

## The NEXT Generation of Greenfield Connectors

# SPEC-*flex* connector system™



Patent Pending

*Does NOT Restrict and Reduce Conduit ID Like "Screw In" Styles*

**The Only Connector that *Easily Installs ON FMC WITHOUT a TOOL !***

**TURN IT ON** with  
**SPEC-*flex*** connectors

Now Available 1/2" to 2" Trade Sizes  
Available in Aluminum or Zinc Plated Steel



Since 1946

**AMERICAN FITTINGS**  
Corporation

800.221.5268  
amftgs.com

Fair Lawn, New Jersey

Saves Labor on Every Connection  
No Screw or Crimp Required to Install  
Simply, Turn It On Your FMC  
No Screws to Pinch or Pierce Conduit  
Maintains Full Integrity of the Conduit  
**Exceeds UL Pullout Requirements by 300%**  
Fully-Machined Solid Steel or Aluminum  
Count-On a Safe Burr-less Wire Pull  
Connects to Box with Furnished Locknut  
Available With & Without Insulated Throat  
Adapters Available for FMC to Rigid, EMT, LT, & Cord

**Made in the USA**

© 2014 AMERICAN FITTINGS



# Innovation has one name, AMERICAN.

Page 2

**Installs On FMC with a  
Few Easy Turns  
No Tools Required**

## SPECflex™

### Industrial Specification Grade Connector Fittings for Flexible Metal Conduit



Saves Labor on Every Connection  
No Screw or Crimp Required to Install  
No Screws to Pinch or Pierce Conduit  
**NOT** a Thin Wall Die Cast Fitting  
Maintains Full Integrity of Conduit ID & OD  
Count-On a Safe Burr-less Wire Pull  
Allows More Room Inside Conduit For Wire  
Exceeds UL Pullout Requirements by 300 %  
Fully-Machined Solid Steel or Aluminum  
Adapters Available to Connect  
FMC to Rigid Pipe or EMT

Full USA Material Certs for  
ARRA and Buy American Act

Industrial Grade Locknut Furnished With  
Knurled Face for Full Bonding to Enclosure

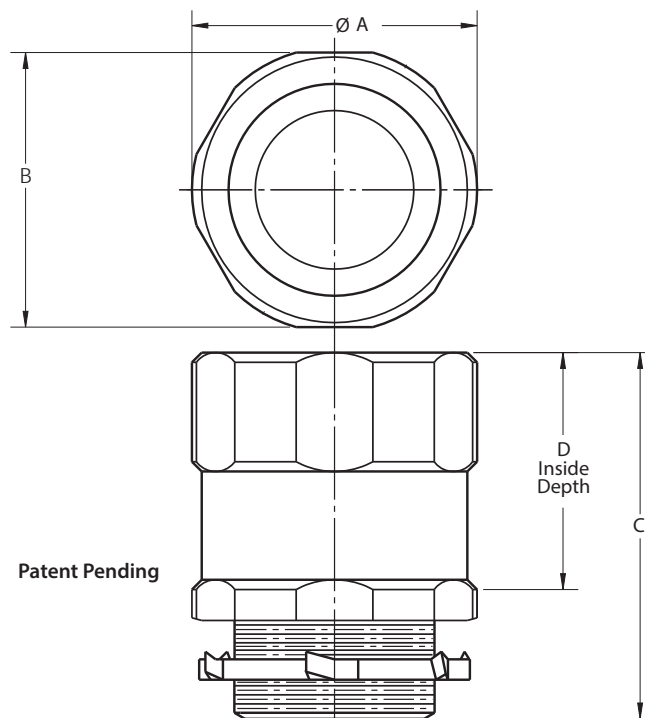

Patent Pending



Furnished with N.P.S Threads  
and Industrial Grade Locknut, and  
Insulated Throat Bushing

Cat # **	Trade Size	Material *	A Ø	B	C	D
FLX50B	1/2"	STEEL	1-5/32"	1-1/8"	1-9/16"	1-1/16"
FLX50BAL	1/2"	ALUMINUM	1-5/32"	1-1/8"	1-9/16"	1-1/16"
FLX75B	3/4"	STEEL	1-7/16"	1-3/8"	1-9/16"	1-1/16"
FLX75BAL	3/4"	ALUMINUM	1-7/16"	1-3/8"	1-9/16"	1-1/16"
FLX100B	1"	STEEL	1-11/16"	1-5/8"	1-5/8"	1-1/16"
FLX100BAL	1"	ALUMINUM	1-11/16"	1-5/8"	1-5/8"	1-1/16"
FLX125B	1-1/4"	STEEL	2-1/32"	1-61/64"	1-5/8"	1-1/16"
FLX125BAL	1-1/4"	ALUMINUM	2-1/8"	2"	1-5/8"	1-1/16"
FLX150B	1-1/2"	STEEL	2-9/32"	2-3/16"	1-29/32"	1-1/4"
FLX150BAL	1-1/2"	ALUMINUM	2-9/32"	2-3/16"	1-29/32"	1-1/4"
FLX200B	2"	STEEL	2-57/64"	2-25/32"	2"	1-9/32"
FLX200BAL	2"	ALUMINUM	2-57/64"	2-25/32"	2"	1-9/32"

Note: SPECflex is manufactured and designed  
to work with all brands of UL FMC manufactured  
in the USA. Due to the non-consistency of manufacture,  
we cannot guarantee compliance with offshore cables.  
If in doubt, request a free product sample.

\* Solid Steel Fully Zinc Plated for Corrosion Resistance  
Aluminum is Aircraft Grade Aluminum

\*\* Consult factory for non-insulated throat parts.

800.221.5288  
info@amftgs.com

# AMFICO

Spec Sheets & Videos Online at AMFTGS.com  
Made in the USA Since 1946

AMERICAN FITTINGS  
Corporation  
17-10 Willow Street  
Fair Lawn, New Jersey 07410



# SPECflex™ Connector System

## FLEX Series Industrial Flexible Metal Conduit Connectors

Patent Pending, Uniquely Engineered for Industrial Projects and OEM Product Performance and Reliability

Superior Performance for Secure Connectors and Fast Disconnect  
GripsTight, Grips Right on Every Connection

90° and 45° Adapters Used to Connect FMC to a Box or Enclosure

Sizes Available 1/2" - 2" Trade Size  
Solid Steel Fully Machined FMC SPEC-flex Connectors  
Made in the USA



90° Adapter  
FMC to Enclosure

Furnished with Industrial Grade Locknut, Sealing Washer and Insulated Throat



45° Adapter  
FMC to Enclosure

## SPECflex™ ADAPTERS

*Now You Can Transition Flexible Metal Conduit to Pipe, Cord or LT*

SPEC-flex Adapters Convert Greenfield / FMC to Pipe or Cord

Adapters Used to Easily  
Transition FMC to EMT, Rigid Conduit, Cord, or Liquid Tight Cable  
and Conform to UL specifications

Sizes Available 1/2" - 2" Trade Size

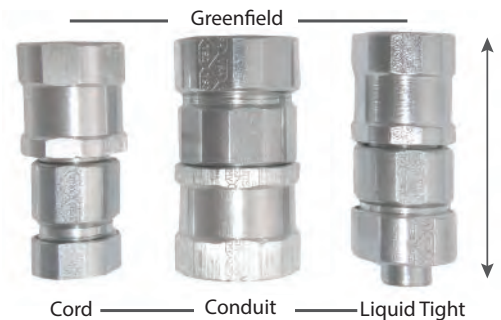

**Our SPECflex Adapter System is Your Solution**



Greenfield to Conduit

Available Set Screw & Compression EMT or Rigid Conduit



Greenfield to LT or Cord

*Please Consult with Factory for Part Number 800.221.5268 or to Request Samples*





# Innovation has one name, AMERICAN.

Page 2

**Installs On FMC with a  
Few Easy Turns  
No Tools Required**

## SPECflex™

### Industrial Specification Grade Connector Fittings for Flexible Metal Conduit



Saves Labor on Every Connection  
No Screw or Crimp Required to Install  
No Screws to Pinch or Pierce Conduit  
**NOT** a Thin Wall Die Cast Fitting  
Maintains Full Integrity of Conduit ID & OD  
Count-On a Safe Burr-less Wire Pull  
Allows More Room Inside Conduit For Wire  
Exceeds UL Pullout Requirements by 300 %  
Fully-Machined Solid Steel or Aluminum  
Adapters Available to Connect  
FMC to Rigid Pipe or EMT

Full USA Material Certs for  
ARRA and Buy American Act

Industrial Grade Locknut Furnished With  
Knurled Face for Full Bonding to Enclosure

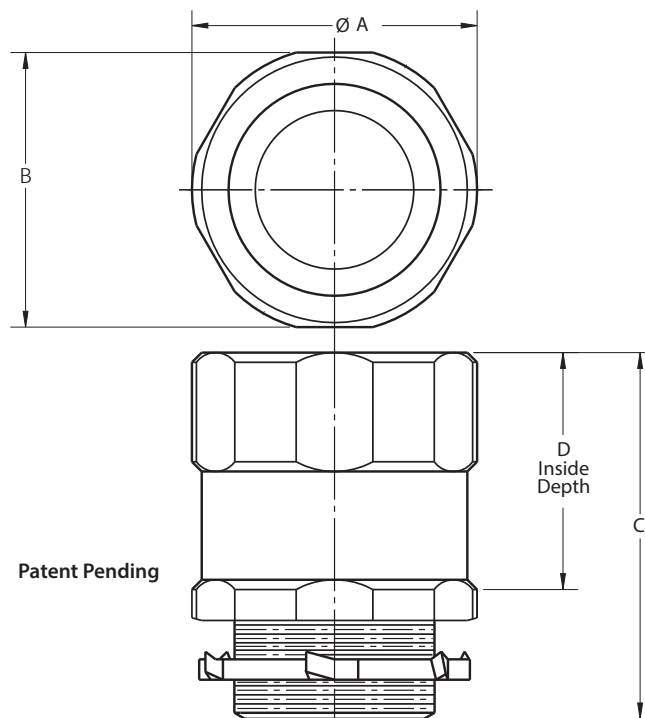

Patent Pending



Furnished with N.P.S Threads  
and Industrial Grade Locknut, and  
Insulated Throat Bushing

Cat # **	Trade Size	Material *	A Ø	B	C	D
FLX50B	1/2"	STEEL	1-5/32"	1-1/8"	1-9/16"	1-1/16"
FLX50BAL	1/2"	ALUMINUM	1-5/32"	1-1/8"	1-9/16"	1-1/16"
FLX75B	3/4"	STEEL	1-7/16"	1-3/8"	1-9/16"	1-1/16"
FLX75BAL	3/4"	ALUMINUM	1-7/16"	1-3/8"	1-9/16"	1-1/16"
FLX100B	1"	STEEL	1-11/16"	1-5/8"	1-5/8"	1-1/16"
FLX100BAL	1"	ALUMINUM	1-11/16"	1-5/8"	1-5/8"	1-1/16"
FLX125B	1-1/4"	STEEL	2-1/32"	1-61/64"	1-5/8"	1-1/16"
FLX125BAL	1-1/4"	ALUMINUM	2-1/8"	2"	1-5/8"	1-1/16"
FLX150B	1-1/2"	STEEL	2-9/32"	2-3/16"	1-29/32"	1-1/4"
FLX150BAL	1-1/2"	ALUMINUM	2-9/32"	2-3/16"	1-29/32"	1-1/4"
FLX200B	2"	STEEL	2-57/64"	2-25/32"	2"	1-9/32"
FLX200BAL	2"	ALUMINUM	2-57/64"	2-25/32"	2"	1-9/32"

Note: SPECflex is manufactured and designed  
to work with all brands of UL FMC manufactured  
in the USA. Due to the non-consistency of manufacture,  
we cannot guarantee compliance with offshore cables.  
If in doubt, request a free product sample.

\* Solid Steel Fully Zinc Plated for Corrosion Resistance  
Aluminum is Aircraft Grade Aluminum

\*\* Consult factory for non-insulated throat parts.

800.221.5288  
info@amftgs.com

# AMFICO

Spec Sheets & Videos Online at AMFTGS.com  
Made in the USA Since 1946

AMERICAN FITTINGS  
Corporation  
17-10 Willow Street  
Fair Lawn, New Jersey 07410



# SPECflex™ Connector System

## FLEX Series Industrial Flexible Metal Conduit Connectors

Patent Pending, Uniquely Engineered for Industrial Projects and OEM Product Performance and Reliability

Superior Performance for Secure Connectors and Fast Disconnect  
GripsTight, Grips Right on Every Connection

90° and 45° Adapters Used to Connect FMC to a Box or Enclosure

Sizes Available 1/2" - 2" Trade Size  
Solid Steel Fully Machined FMC SPEC-flex Connectors  
Made in the USA



90° Adapter  
FMC to Enclosure

Furnished with Industrial Grade Locknut, Sealing Washer and Insulated Throat



45° Adapter  
FMC to Enclosure

## SPECflex™ ADAPTERS

*Now You Can Transition Flexible Metal Conduit to Pipe, Cord or LT*

SPEC-flex Adapters Convert Greenfield / FMC to Pipe or Cord

Adapters Used to Easily  
Transition FMC to EMT, Rigid Conduit, Cord, or Liquid Tight Cable  
and Conform to UL specifications

Sizes Available 1/2" - 2" Trade Size



Cord ——— Conduit ——— Liquid Tight

**Our SPECflex Adapter System is Your Solution**



Greenfield to Conduit

Available Set Screw & Compression EMT or Rigid Conduit



Greenfield to LT or Cord

*Please Consult with Factory for Part Number 800.221.5268 or to Request Samples*



# AMERICAN FITTINGS Corporation

Made in the USA Since 1946

Industrial SPEC-flex™  
FMC to Enclosure  
90° Conduit Adapters  
1/2" to 1-1/4"

## FLEX Series Industrial Flexible Metal Conduit Connectors

Solid Steel Fully Machined FMC SPEC-flex Connectors  
Made in the USA

90° Adapter Used to Connect FMC to a Box or Enclosure

Patent Pending Uniquely Engineered for Industrial Projects and  
OEM Product Performance

Superior Performance for Secure Connectors and Fast Disconnect  
GripsTight, Grips Right on Every Connection

Furnished with Our Industrial Grade Locknut and Sealing Washer with an  
Optional UL Component Temperature Rated 150°C Insulated Throat

**Save Time on Every Connection!**

## SPECflex™ Connector System



90° Adapter  
FMC to Enclosure  
Made in the USA

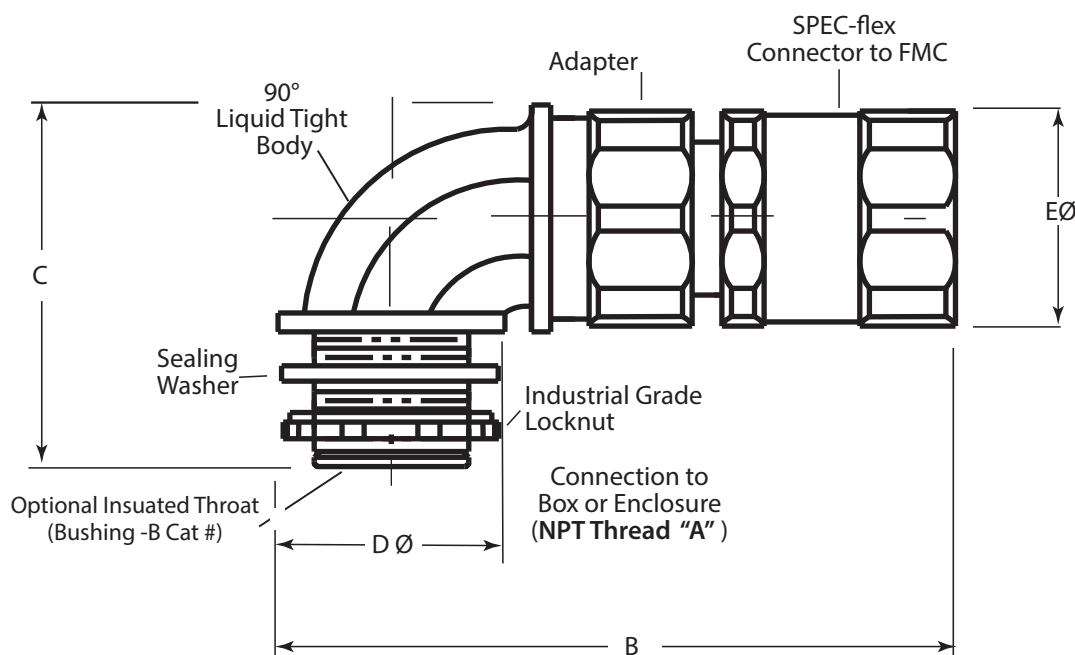

**SPECflex Industrial Grade FMC Connectors 90° Adapters**

Cat #	Trade Size	A	B	C	D Ø	E Ø
FLX5090 *	1/2"	1/2" - 14NPT	3.35	1.84	1.18	1.19
FLX7590 *	3/4"	3/4" - 14NPT	3.59	2.33	1.35	1.44
FLX10090 *	1"	1" - 11.5NPT	4.00	2.74	1.67	1.75
FLX12590 *	1 1/4"	1 1/4" - 11.5NPT	4.32	2.97	2.00	2.12
FLX15090 *	1 1/2"	1 1/2" - 11.5NPT	5.05	3.28	2.25	2.37
FLX20090 *	2"	2" - 11.5NPT	5.66	3.82	2.75	2.89

\*Add "B" Suffix to Cat # for Insulated Throat Option i.e. FLX5090B

FLX-Adapt. 1213.1

amftgs.com

t: 800.221.5268

e: info@amftgs.com



# AMERICAN FITTINGS Corporation

Made in the USA Since 1946

Industrial SPEC-flex™  
FMC to Enclosure  
45 Conduit Adapters  
1/2" to 1-1/4"

## FLEX Series Industrial Flexible Metal Conduit Connectors

Solid Steel Fully Machined FMC SPEC-flex Connectors

Made in the USA

45° Adapter Used to Connect FMC to a Box or Enclosure

Patent Pending Uniquely Engineered for Industrial Projects and  
OEM Product Performance

Superior Performance for Secure Connectors and Fast Disconnect  
GripsTight, Grips Right on Every Connection

Furnished with Our Industrial Grade Locknut and Sealing Washer with an  
Optional UL Component Temperature Rated 150°C Insulated Throat

**Save Time on Every Connection!**

## SPECflex™ Connector System



45° Adapter  
FMC to Enclosure  
Made in the USA

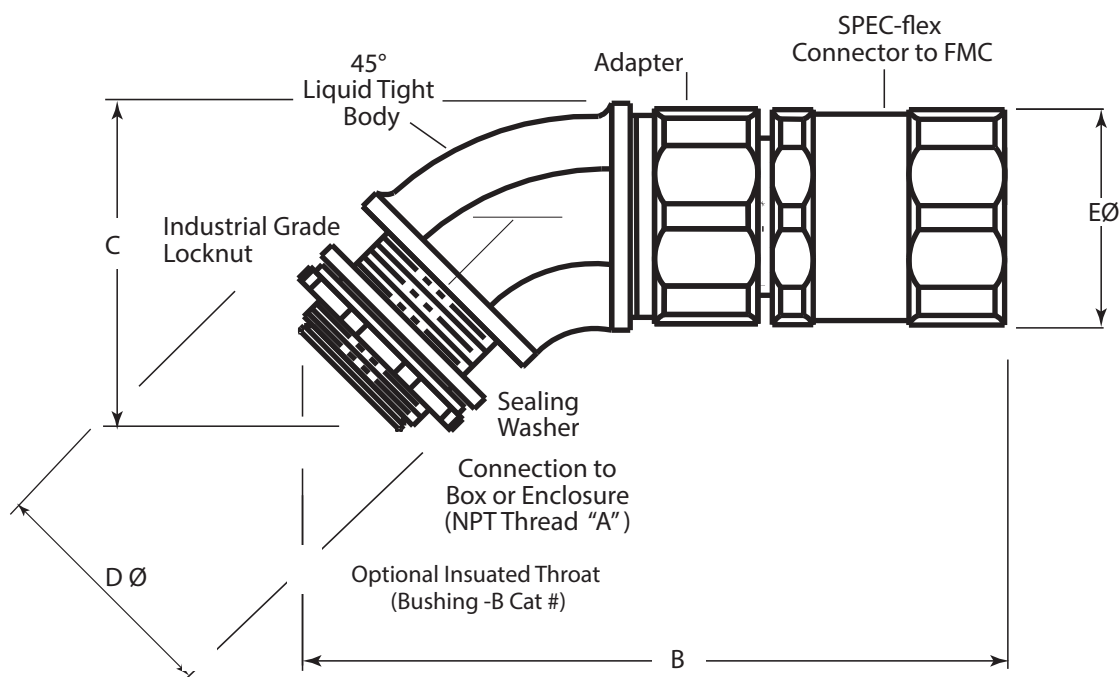

**SPECflex Industrial Grade FMC Connectors 45° Adapters**

Cat #	Trade Size	A	B	C	D Ø	E Ø
FLX5045 *	1/2"	1/2" - 14NPT	3.66	1.67	1.18	1.19
FLX7545 *	3/4"	3/4" - 14NPT	3.79	1.95	1.35	1.44
FLX10045 *	1"	1" - 11.5NPT	3.99	2.15	1.67	1.75
FLX12545 *	1 1/4"	1 1/4" - 11.5NPT	4.25	2.46	2.00	2.12
FLX15045 *	1 1/2"	1 1/2" - 11.5NPT	4.99	2.79	2.25	2.37
FLX20045 *	2"	2" - 11.5NPT	5.50	3.32	2.75	2.89

\*Add "B" Suffix to Cat # for Insulated Throat Option i.e. FLX5045B

FLX-Adapt. 1213.1

amftgs.com

t: 800.221.5268

e: info@amftgs.com



# AMERICAN FITTINGS Corporation



Made in the USA Since 1946

Industrial SPEC-flex Adapter  
FMC to Liquid Tight  
1/2" - 2"

**FLEX Series Industrial Flexible Metal Conduit Adapter  
Transitions FMC (Greenfield) to Liquid Tight Cord & Cable  
Made in the USA**

Solid Steel Fully Machined SPECflex Connector with  
AMFICO Industrial Grade Liquid Tight Cord & Cable Connector

Patent Pending Uniquely Engineered for Industrial Projects and  
OEM Product Performance

**Superior Performance for Secure Connection and Fast Disconnect  
No Tools Required to Install Conduit**

## SPECflex Connector System



Greenfield to Liquid Tight

**Save Time on Every Connection!**



**Grips Tight and Right on Every Connection**

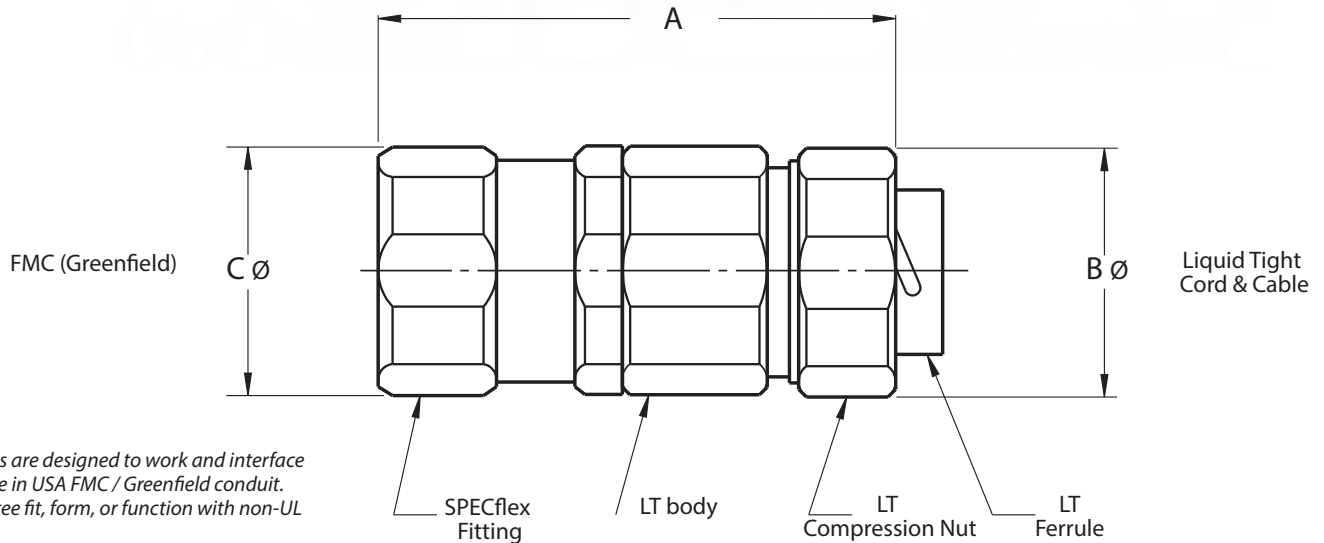

Liquid Tight  
Cord & Cable

**Note:**  
SPECflex connectors are designed to work and interface  
with UL listed, Made in USA FMC / Greenfield conduit.  
We cannot guarantee fit, form, or function with non-UL  
off-shore conduit.  
Request a sample from factory to ensure capability.

**SPECflex Liquid Tight Adapters**

Cat #	Trade Size	A	B Ø	C Ø
FLXLT50	1/2"	2.53	1.19	1.16
FLXLT75	3/4"	2.61	1.43	1.44
FLXLT100	1"	2.76	1.75	1.69
FLXLT125	1-1/4"	2.97	2.16	2.03
FLXLT150	1-1/2"	3.38	2.38	2.28
FLXLT200	2"	3.54	2.88	2.89

FKXLT. 092014.1t



# AMERICAN FITTINGS Corporation



Made in the USA Since 1946

Industrial SPEC-flex Adapter  
FMC to EMT Set Screw  
1/2" - 2"

**FLEX Series Industrial Flexible Metal Conduit Adapter  
Transitions FMC (Greenfield) to EMT  
Made in the USA**

Solid Steel Fully Machined SPECflex Connector with  
AMFICO Industrial EMT Set Screw Fitting  
Fittings are Solid Steel Zinc Plated

Patent Pending Uniquely Engineered for Industrial Projects and  
OEM Product Performance  
**Superior Performance for Secure Connection and Fast Disconnect**  
**No Tools Required to Install Flex Conduit**

## SPECflex Connector System



Greenfield to EMT Set Screw

**Save Time on Every Connection!**



**Grips Tight and Right on Every Connection**

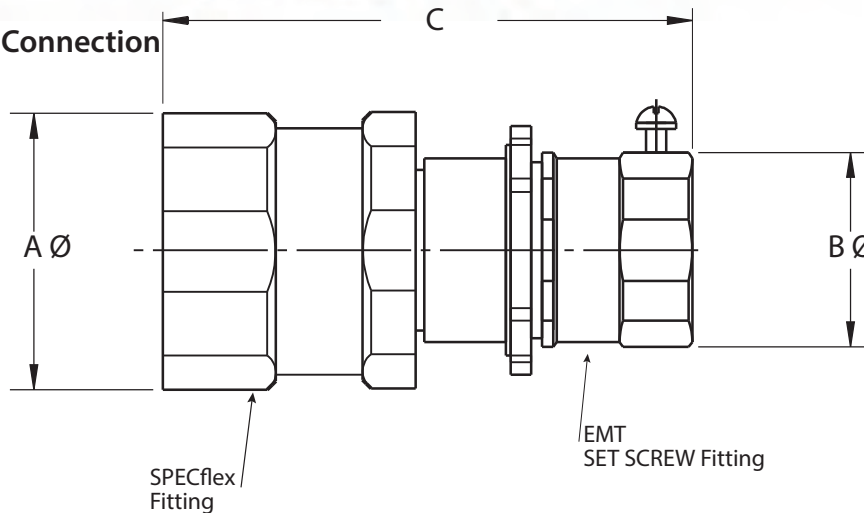

**Note:**

SPECflex connectors are designed to work and interface  
with UL listed, Made in USA FMC / Greenfield conduit.  
We cannot guarantee fit, form, or function with non-UL  
off-shore conduit.  
Request a sample from factory to ensure capability.

**Note:**

Also available in  
Compression EMT  
Liquid Tight  
Cord Connectors

**SPECflex EMT SET SCREW Adapters**

Cat #	Trade Size	A	B Ø	C Ø
FLXSS50	1/2"	1-5/32	.975	2.64
FLXSS75	3/4"	1-7/16	1.219	2.66
FLXSS100	1"	1-11/16	1.495	2.96
FLXSS125	1-1/4"	2-1/32	1.885	3.21
FLXSS150	1-1/2"	2-9/32	2.145	3.70
FLXSS200	2"	3-25/32	2.665	3.71

FLXEMT-SS 110314.1t

AMFTGS.com

t: 800.221.2568

e:info@amftgs.com

# AMERICAN FITTINGS Corporation



Made in the USA Since 1946

Industrial SPEC-flex Adapter  
FMC to EMT Compression  
1/2" - 2"

**FLEX Series Industrial Flexible Metal Conduit Adapter**  
Transitions FMC (Greenfield) to EMT  
Made in the USA

Solid Steel Fully Machined SPECflex Connector with  
AMFICO Industrial EMT Compression Coupling  
Fittings are Solid Steel Zinc Plated

Patent Pending Uniquely Engineered for Industrial Projects and  
OEM Product Performance  
**Superior Performance for Secure Connection and Fast Disconnect**  
**No Tools Required to Install Conduit**

## SPECflex Connector System



Greenfield to EMT Compression

**Save Time on Every Connection!**



**Grips Tight and Right on Every Connection**

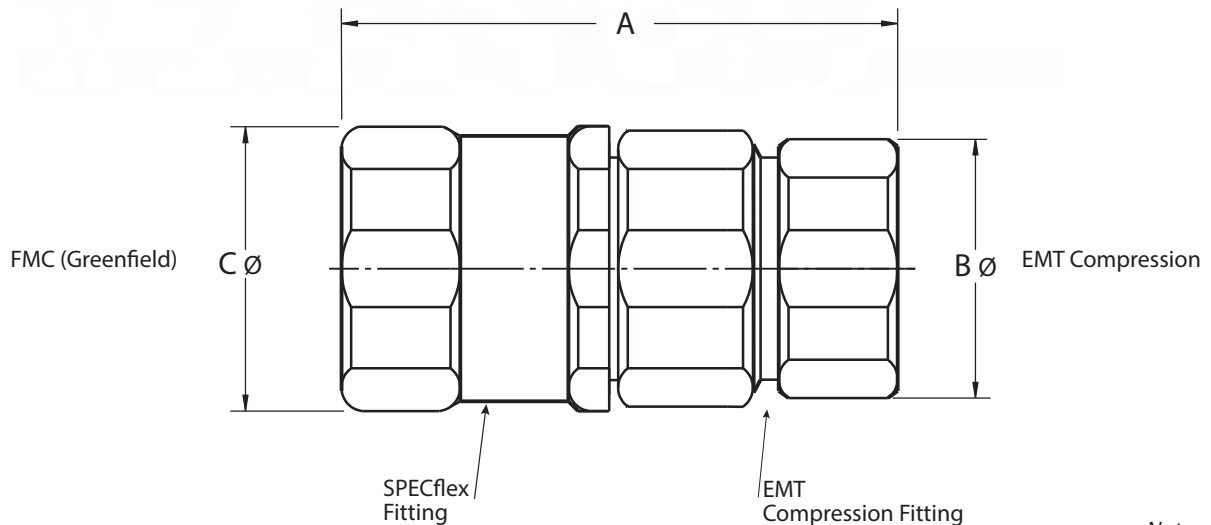

**Note:**

SPECflex connectors are designed to work and interface  
with UL listed, Made in USA FMC / Greenfield conduit.  
We cannot guarantee fit, form, or function with non-UL  
off-shore conduit.  
Request a sample from factory to ensure capability.

**Note:**

Also available in  
Set Screw EMT

### SPECflex EMT Adapters

Cat #	Trade Size	A	B Ø	C Ø
FLXEMT 50	1/2"	2.43	.97	1.19
FLXEMT 75	3/4"	2.46	1.22	1.43
FLXEMT 100	1"	2.58	1.49	1.75
FLXEMT 125	1-1/4"	2.69	1.88	2.16
FLXEMT 150	1-1/2"	3.16	2.14	2.38
FLXEMT 200	2"	3.29	2.69	2.88

FLXEMT. 092014.1t

AMFTGS.com

t: 800.221.2568

e:info@amftgs.com