



LED LUMINAIRES

ProLED[®] ECO Downlights

5 YR
WARRANTY
5-Year Warranty



ProLED 4" and 6" downlights are high in performance at a low cost



Reliable Performance in a Budget-Friendly Design

Replaces up to 65 Watt Incandescent (86% Energy Savings)

Dimmable

5-Year Limited Warranty

ENERGY STAR[®] Certified

Applications:

Homes
Education
Healthcare
Hospitality
Office

Markets:

Residential
Commercial

Halco
LIGHTING TECHNOLOGIES

Contact Your Customer Care Specialist
For Pricing, Orders And Technical Support.

800.677.3334 www.halcolighting.com

ProLED[®]

ECO Downlights

Product #: _____ Type: _____

Project: _____ Date: _____

Comments: _____ Initials: _____

Specifications

- 35,000 hour life results in lower maintenance costs over time
- Acceptable for use in insulated contact airtight (ICAT) rated luminaires
- Spun aluminum housing and thermoplastic trim ring
- Die-cast aluminum housing
- Dimmable to 10%
- ENERGY STAR[®] Certified
- 4" Luminaire is UL approved for damp locations
- 6" Luminaire is UL approved for wet locations
- RoHS Compliant

Standard with both models:
Title 24 compliant quick plug
connector plugs directly into
dedicated LED recessed housings

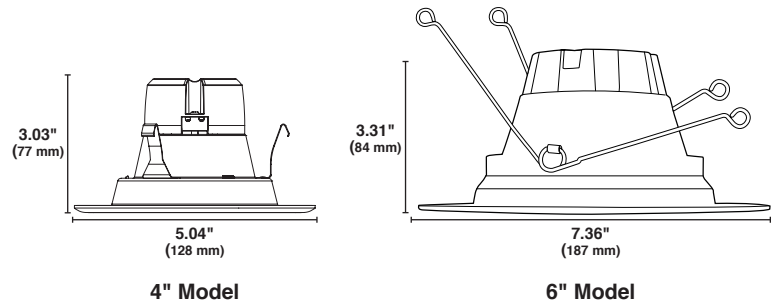

4" Model

6" Model

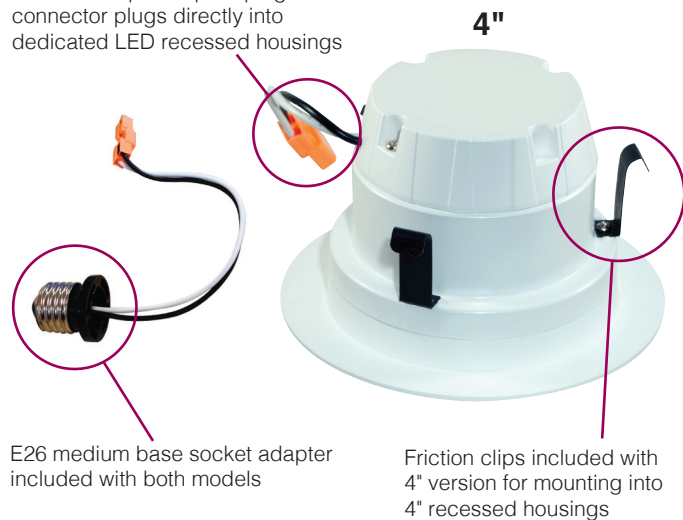

E26 medium base socket adapter
included with both models

Friction clips included with
4" version for mounting into
4" recessed housings



Torsion springs are included with the
6" version. They can be mounted into
5" or 6" recessed housings

Available GU24 socket base
adapter sold separately

Ordering Information



| | Watt | Product # | Product Code | Volts | Color Temp. | CRI | Lumens | Useful Life* | Dimmable | Pkg. Qty. | Fixture Size | Beam Spread | Equivalent Wattage |
|---|-------|-----------------|---------------------|-------|-------------|-----|--------|--------------|----------|-----------|--------------|-------------|--------------------|
| | 9 | 83058 | DL4FR9/827/ECO/LED | 120 | 2700 | 82 | 650 | 35,000 | Yes | 1/12 | 4" | 90° | 50 |
| | 9 | 83059 | DL4FR9/830/ECO/LED | 120 | 3000 | 82 | 650 | 35,000 | Yes | 1/12 | 4" | 90° | 50 |
| | 9 | 83060 | DL4FR9/840/ECO/LED | 120 | 4000 | 82 | 650 | 35,000 | Yes | 1/12 | 4" | 90° | 50 |
| | 9 | 83061 | DL4FR9/850/ECO/LED | 120 | 5000 | 82 | 650 | 35,000 | Yes | 1/12 | 4" | 90° | 50 |
| | 9 | 83054 | DL6FR9/827/ECO/LED | 120 | 2700 | 82 | 650 | 35,000 | Yes | 1/6 | 6" | 90° | 65 |
| | 9 | 83055 | DL6FR9/830/ECO/LED | 120 | 3000 | 82 | 650 | 35,000 | Yes | 1/6 | 6" | 90° | 65 |
| | 9 | 83056 | DL6FR9/840/ECO/LED | 120 | 4000 | 82 | 650 | 35,000 | Yes | 1/6 | 6" | 90° | 65 |
| | 9 | 83057 | DL6FR9/850/ECO/LED | 120 | 5000 | 82 | 650 | 35,000 | Yes | 1/6 | 6" | 90° | 65 |
| ⊛ | 12 | 83094 | DL6FR12/927/ECO/LED | 120 | 2700 | 90 | 800 | 35,000 | Yes | 1/6 | 6" | 90° | 65 |
| ⊛ | 12 | 83095 | DL6FR12/930/ECO/LED | 120 | 3000 | 90 | 800 | 35,000 | Yes | 1/6 | 6" | 90° | 65 |
| ⊛ | 12 | 83096 | DL6FR12/940/ECO/LED | 120 | 4000 | 90 | 800 | 35,000 | Yes | 1/6 | 6" | 90° | 65 |
| ⊛ | 12 | 83097 | DL6FR12/950/ECO/LED | 120 | 5000 | 90 | 800 | 35,000 | Yes | 1/6 | 6" | 90° | 65 |
| | 91003 | ADP/DL/GU24/LED | GU24 Socket Adapter | | | | | | | | | | |

⊛ NEW ITEM

Represents lamps that are ENERGY STAR[®] certified.

* Useful Life is defined as the point in time at which the LED will maintain at least 70% of its initial lumens. The LED will continue to burn past this point, but at decreased light levels.

Warranty – Commercial / Industrial: This product is warranted for 5 years from the date of purchase.

May not be compatible with all dimming systems, dimming performance may vary by system, please check the website www.halcolighting.com/ProLEDdim for up-to-date dimmer compatibility information.

Use on incompatible dimming systems may shorten lamp life.