

DESCRIPTION

Frosted dome lens with reflector in the 6" trim family for use in recessed downlighting.

Catalog #		Type
Project		
Comments		Date
Prepared by		

SPECIFICATION FEATURES

White trim with frosted glass dome and reflector. Wet location listed for use in showers. Non-conductive, non-corrosive polymer trim ring. Uses torsion spring retention and available in a white.

Lamp Listings - GU24

H724ICAT	CF15/R30/GU24
H724ICATL	
H724RICAT	CF13/GU24 (spiral)
H724RICATL	

Lamp Listings - CFL (4-Pin)

H280E	18W TTT/18W DTT
H280EEM	
H280EICAT	
H280EL	
H280ELICAT	
H283E	
H283EL	26W TTT/26W DTT
H285E	
H285EEM	
H285EEML	
H285EICAT	
H285EL	
H285ELICAT	
H287E	
H287EL	

H274E	13W TTT/13W DTT
H276E	

H270ICAT	13W DTT/13W TTT
H270RICAT	
H271ICAT	18W DTT/18W TTT
H271RICAT	
H272ICAT	26W DTT/26W TTT
H272RICAT	
H273ICAT1D	26W DTT/26W TTT, 32W TTT
H273RICAT1D	

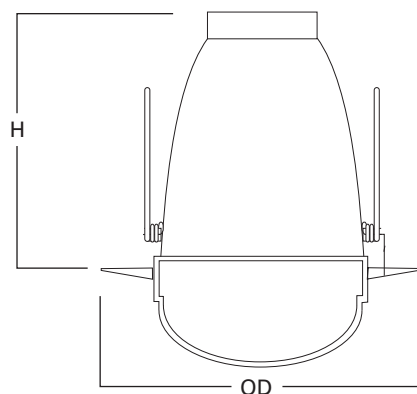

Height: 5-1/2" [140mm]
Outside Diameter: 7-3/4" [197mm]

ORDERING INFORMATION

Trim	Finish
272 = 6" Frosted dome lens with reflector	PS = White trim ring, dome lens with reflector, wet location listed



272PS

White Trim, Dome Lens
with Reflector

272

**6-Inch Frosted Glass
Dome with Reflector,
Wet Location Listed**

**"Dead Front"
Non-Conductive
trim ring and glass lens**