

# Lampholders

## INDEX

Overview .....	S2
<b>Incandescent Lampholders</b>	
Outlet Box, Keyless and Pull Chain .....	S3, S4
Metal Shell and Interiors .....	S5
Phenolic Cap and Shell .....	S5
Multi-Lampholder Clusters .....	S6
Porcelain Par Connectors .....	S6
Bayonet Socket-Single Contact .....	S6
Porcelain Mogul Base .....	S7
Socket Extensions .....	S8
Appliance Heating Receptacle .....	S8
Porcelain and Phenolic .....	S8
Porcelain Snap-In .....	S9
Porcelain Keyless-Commercial Units .....	S9
Porcelain Keyless Fixture	
Single Circuit-Medium Base .....	S9
Porcelain Keyless Medium Base-Side Angle Mounted .....	S10
Phenolic Keyless Fixture-Medium Base .....	S10
Lampholders for Recessed Single Contact Lamps .....	S10
Lampholders for Metal Halide and Quartz Halogen Lamps .....	S10
Candle Sockets .....	S10-S12
<b>Fluorescent Lampholders</b>	
Compact Fluorescent Ceiling Lampholder .....	S4
Linear Fluorescent .....	S13-S17
Medium Bi-Pin .....	S13-S15
High Output .....	S13, S14
Slimline .....	S13, S14
Miniature .....	S16
T-8 to T-5 Adapter .....	S16
4-Pin Long Twin Tube with 2G11 Base .....	S17
Lamp Support Clips for Long Twin Tube .....	S18
Compact Fluorescent Lampholders (CFL's) .....	S19-S22

*For a complete listing of OEM products, see the OEM-100 Catalog.*



## LAMPHOLDERS

### A VARIETY OF INCANDESCENT AND FLUORESCENT STYLES IN A RANGE OF RATINGS AND MATERIALS

Leviton offers a complete selection of outlet box, incandescent, fluorescent and specialty lampholders, in various ratings and materials. The following pages offer a variety of types and styles.

#### PORCELAIN MEDIUM BASE LAMPHOLDER

With a choice of mounting and wiring options, these lampholders are ideal for a wide range of commercial and residential incandescent fixtures.

Cat. No. 8101 shown



#### FLUORESCENT LAMPHOLDER FOR MEDIUM BI-PIN LAMPS

Features Lamp-Lock design for quick relamping. Models dedicated for energy-efficient T-8 lamps available.

Cat. No. 13653-WP shown



#### COMPACT FLUORESCENT LAMPHOLDERS

Available for all popular 2-pin and 4-pin lamp bases, with a variety of mounting options. Color-coded for easy wattage identification.

Cat. No. 26725-426 shown



#### OUTLET BOX LAMPHOLDER

Available in keyless, pull chain and outlet models, all featuring easy twist-lock mounting.

Cat. No. 8827-CW4 shown



#### LONG TWIN-TUBE 2G11 BASE LAMPHOLDERS

Choice of mounting and wiring options to reduce fixture assembly time.

Cat. No. 13453 shown



#### CANDELABRA BASE LAMPHOLDER

Keyless lampholders for chandeliers and other fixtures, featuring various hickeys or double snap-in spring clips.

Cat. No. 10014-800 shown



#### PORCELAIN MOGUL BASE LAMPHOLDER

A complete selection of high-quality porcelain moguls with leads or screw terminals.

Pulse-rated models available. Cat. No. 8756 shown



#### METAL SHELL LAMPHOLDER

Medium base, electrolite lampholders available in a variety of attractive finishes.

Cat. No. 9346-PG shown



## Medium Base Incandescent Lampholders



## Outlet Box Lampholders

660 WATT 600V One-Piece Keyless Top Wired  

DESCRIPTION/ TERMINALS	WHITE UREA CAT. NO.	OD	FITS BOX SIZE
2 Terminal Screws	8829-CW1	4 1/2"	3 1/4" or 4"
6" Pigtail Leads	8829-CW2	4 1/2"	3 1/4" or 4"
4 Terminal Screws	8829-CW4	4 1/2"	3 1/4" or 4"

660 WATT 250V One-Piece Pull Chain Top Wired  

DESCRIPTION/ TERMINALS	WHITE UREA CAT. NO.	OD	FITS BOX SIZE
2 Terminal Screws	8827-CW1	4 1/2"	3 1/4" or 4"
6" Pigtail Leads	8827-CW2	4 1/2"	3 1/4" or 4"
2 Terminal Screws with Captive Clamps	8827-CW4	4 1/2"	3 1/4" or 4"

660 WATT 250V One-Piece Keyless Top Wired  

DESCRIPTION/ TERMINALS	PORCELAIN CAT. NO.	OD	FITS BOX SIZE
2 Screws★	9874	3 3/4"	3 1/4"
2 Screws, no cage lip	9875	4 1/2"	3 1/4" or 4"
6" Pigtail Leads, no cage lip	9875-2	4 1/2"	3 1/4" or 4"
4 Screws	49875	4 1/2"	3 1/4" or 4"
4 Quickwire Push-In★	9883	4 1/2"	3 1/4" or 4"

660 WATT 250V One-Piece Pull Chain Top Wired  

DESCRIPTION/ TERMINALS	PORCELAIN CAT. NO.	OD	FITS BOX SIZE
2 Screws	29816-C	4 1/2"	3 1/4" or 4"
6" Pigtail Leads	29816-C2	4 1/2"	3 1/4" or 4"
2 Screws w/Captive Clamps for 4-Wire Terminals	49816-C	4 1/2"	3 1/4" or 4"
Interior Mechanism for 2-Piece Outlet Box Lampholders★	29816-CM*		

\*When existing stock is depleted, this item will be DISCONTINUED.

CSA Certified except where indicated by★



8827-CW2



9875-2



29816-C

## SPECIFICATIONS AND FEATURES

- Twist-lock mounting
- Pull chain models have bell at end of chain on 3 foot cord
- Medium base

## TESTING AND CODE COMPLIANCE

- UL Listed (File #E-3810)
- CSA Certified (File #LR-1863)



660W 125V — 15 AMP-125V • 120W 250V

## Medium Base Incandescent and GU24 Base Fluorescent Lampholders



9716-C



9726-C



9860

### Outlet Box Lampholders

#### 660 WATT 125V Lampholder Outlet 15 AMP-125V One-Piece Pull Chain Side Wired

DESCRIPTION/ TERMINALS	PORCELAIN	OD	FITS BOX SIZE	NEMA CONFIG.
2 Screws★	9716-C	4 1/2"	3 1/4" or 4"	1-15R 

#### 660 WATT 125V Lampholder Outlet 15 AMP-125V One-Piece Pull Chain Top Wired

DESCRIPTION/ TERMINALS	PORCELAIN	OD	FITS BOX SIZE	NEMA CONFIG.
2 Screws	9726-C	4 1/2"	3 1/4" or 4"	5-15R 

### Ball and Chain Accessories

DESCRIPTION	BRASS FINISH	NICKEL FINISH
No. 6 Chain; 1/8" Dia. Balls	18302-1	18302-1N



18302-1N

Connector for No. 6 Chain	9820	9820-N
---------------------------	------	--------



9820

Chain, 3 feet long, End Bell and Connector; use as extension or replacement; 1/25" Dia. Balls	6	6-N
---	---	-----



6

DESCRIPTION	BROWN	WHITE
Insulating Link; Thermoplastic 1 3/4" Total Length	9839	9839-I



9839-I

CSA Certified except where indicated by★

### GU24 Base Fluorescent Lampholder

#### Energy-Saving Keyless Bi-Pin Compact Fluorescent Ceiling Lampholder for Closets and Closed Spaces 120 WATT 250V AC

DESCRIPTION	CAT. NO.
Lampholder with pigtail leads and knockout holes for multiple configurations	9860
Lampholder with pigtail leads and knockout holes for multiple configurations; with 13W Bulb	9860-B
Lampholder with pigtail leads and knockout holes for multiple configurations; with 13W Bulb and Lamp Guard	9860-BL
Lamp Guard	9860-L
13W Replacement Lamp	9865

Note: Not intended for use with incandescent lamps, dimmers or occupancy sensors.

#### SPECIFICATIONS AND FEATURES

##### Outlet Box Incandescent Lampholders

- 2-Pole, 2-Wire Outlet; 2-Pole, 3-Wire Outlet
- Twist-lock mounting
- Pull chain models have bell at end of chain on 3 foot cord

##### Fluorescent Ceiling Lampholder\*

- Installs indoors in closets, garages, basements, utility rooms and attics
- Reduces risk of fire in closets and closed spaces
- Built of tough thermoplastic
- Use with a standard wall switch
- Pigtail leads provide easy installation

- Knockout holes on box enable multiple configurations
- \* Patent pending

#### TESTING AND CODE COMPLIANCE

##### Outlet Box Incandescent Lampholders

- UL Listed (File #E-3810; E-7516)
- CSA Certified (File #LR-1863)

##### Fluorescent Ceiling Lampholder

- cULus Listed
- Meets NFPA 70, NEC Section 410.8B Requirements and Canadian Electric Code Requirements for use in closets with lamp guard
- Backed by a Limited Two-Year Warranty

## Medium Base Incandescent Lampholders



## Metal Shell Lampholders

Medium Base, Choice of Finishes\*

DESCRIPTION	CAT. NO.	RATING
Key—Electrolier; Single Circuit; 1/8 IPS Tapped Bushing w/Set Screw	9346	250W 250V
Removable Turn Knob—Electrolier; Single Circuit; 1/8 IPS Tapped Bushing w/Set Screw	10083-16	250W 250V
Removable Turn Knob—Electrolier; 2-Circuit; 3 Terminal; 1/8 IPS Tapped Bushing less Set Screw	7070	250W 250V
Removable Turn Knob—Electrolier; 2-Circuit; 1/8 IPS Tapped Bushing	7090	250W 250V
Pull Chain—Electrolier; Single Circuit; 1/8 IPS Tapped Bushing w/Set Screws	19980	660W 250V
Push Through—Electrolier; Single Circuit; 1/8 IPS Tapped Bushing w/Set Screw	7080	660W 250V
Keyless—Electrolier; Single Circuit; 1/8 IPS Tapped Bushing w/Set Screw	8004	660W 250V
Keyless—Short Electrolier; Single Circuit; 1/8 IPS Tapped Bushing w/Set Screw	9347	660W 250V

## Metal Shell Lampholders

Interiors — Medium Base, Phenolic Body, Aluminum Screw Shell†

LAMPHOLDER	CAT. NO. INTERIOR
19980	19980-M†
10083-16	10083-M†
7070	7070-M†
7090	7090-M†
9346	9346-M†
6098	7080-M†
8004	8004-M†

## Brown Phenolic Cap and Shell Lampholders

Two-Piece, Medium Base Electrolier Interiors

DESCRIPTION	CAT. NO.	RATING	INTERIORS†
Pull Cord (nylon); 2-Circuit, 1/8 IPS Threaded Cap w/Set Screw	97092	250W 250V	7092-2M†
Push-Through; 1/8 IPS Threaded Cap w/Set Screw	95110	660W 250V	7080-M†
Keyless; 1/8 IPS Threaded Cap w/Set Screw	95080	660W 250V	8004-M†

†UL Recognized component.

NOM Certified except where indicated by†.

## SPECIFICATIONS AND FEATURES

- Phenolic interior with aluminum screwshell
- 2-Circuit lampholders operate dual-filament lamps in sequence of Low-Medium-High-Off
- Cat. No. 7070 (2-Circuit, 3-Terminal) is wired in series with keyless lampholder

## TESTING AND CODE COMPLIANCE

- UL Listed (File #E-3810)
- CSA Certified (File #LR-1863)
- NOM Certified (File #057), except interiors

## \*FINISH

A suffix must be added to each basic catalog number to indicate the finish desired. For Polished Gilt/Brass finish, add -PG; for Unfinished Aluminum, add -AL; for Polished Aluminum, add -NI (finishes on aluminum). For bright dip/Brass, add -BR (finish on brass). CONSULT LEVITON REPRESENTATIVE FOR AVAILABILITY OF FINISHES.

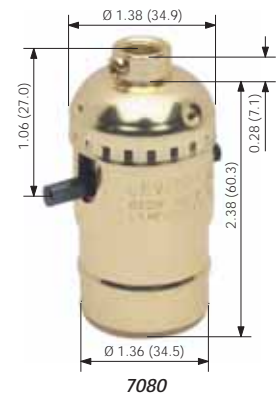
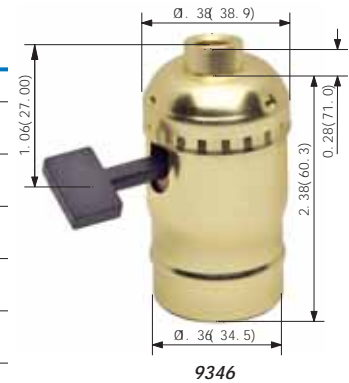



660W 250V

## Medium, Candelabra Base, Par Connectors—Incandescent Lampholders

### Medium Base Multi-Lampholder Clusters

Treated Aluminum Screw Shell  

DESCRIPTION	CAT. NO.	RATING	T	TA	B	BA	OAH T+B
2-Light Twin 1/8 IPS Male Top Bracket Only	4020-A3A	660W 250V	1 <sup>5</sup> / <sub>16</sub>	5/16	—	—	—
2-Light Twin 1/8 IPS Male (top & bottom)	4015-D4F	660W 250V	1 <sup>11</sup> / <sub>16</sub>	5/16	1 <sup>11</sup> / <sub>16</sub>	7/16	3 <sup>3</sup> / <sub>8</sub>
2-Light Offset 1/8 IPS Male (top & bottom)	4032-E5F	660W 250V	1 <sup>3</sup> / <sub>4</sub>	5/16	1 <sup>3</sup> / <sub>4</sub>	7/16	3 <sup>11</sup> / <sub>16</sub>
3-Light 1/8 IPS Male (top & bottom)†	341-D4U	660W 250V	1 <sup>3</sup> / <sub>4</sub>	1/2	1 <sup>3</sup> / <sub>4</sub>	7/16	3 <sup>1</sup> / <sub>2</sub>
2-Light Offset 1/8 IPS Male (top); Pullchain Switch (bottom) with 1/2" usable shank★	4034-F5A	660W 250V 1A 125V T	1 <sup>3</sup> / <sub>4</sub>	5/16	1 <sup>15</sup> / <sub>16</sub>	1/2	3 <sup>3</sup> / <sub>4</sub> †
2-Light Twin 1/8 IPS Male (top); Pullchain Switch (bottom) 3/8" usable shank★	4017-D2F	660W 250V 1A 125V T	1 <sup>1</sup> / <sub>16</sub>	5/16	1 <sup>11</sup> / <sub>16</sub>	3/8	2 <sup>13</sup> / <sub>16</sub> †

+Includes nut.

Leads are No. 18 AWG 105°C plastic; 9" long, stripped 3/4"; untinned and pulled through top bracket.

### Porcelain Par Connectors

DESCRIPTION	CAT. NO.	RATING
Medium Base for PAR #46 and #38 lamps. Leads are No. 14 AWG 200°C SEW-2 Silicone Rubber Insulated; 18" Long, Stripped 3/4". Others available on inquiry†	368-1	660W 125V
Mogul Base for PAR #56 and #64 lamps. Leads are No. 14 150°C SEWF-2; 18" Long, Stripped 3/4". Others available upon request	357-8	1000W 125V

### Bayonet Socket — Single Contact

#### Candelabra Base

DESCRIPTION	CAT. NO.	RATING
Flat Bracket. Leads are No. 18 AWG, 105°C Plastic; 6" Long, Stripped 3/4" (one black, one white)★†	905	Low Voltage

All devices are UL Listed except Cat. No. 905. Also CSA Certified except where indicated by★, and NOM Certified except where indicated by†.



4034-F5A



341-D4U



4032-E5F

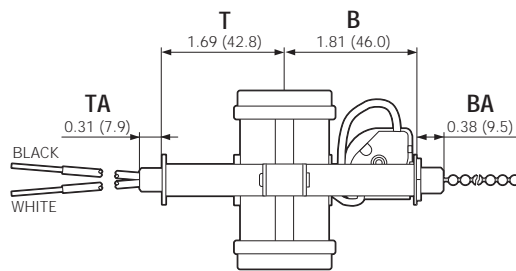

4017-D2F

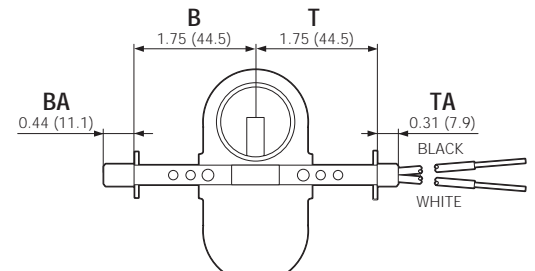

4032-E5F

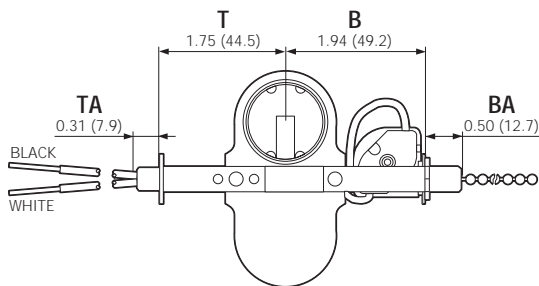

4034-F5A

#### SPECIFICATIONS AND FEATURES

- Pull chain models have bell at end of chain on 3 foot cord
- Medium and Candelabra bases
- Par connectors have white, unglazed porcelain body

#### TESTING AND CODE COMPLIANCE

- UL Listed (File #E-13405, E-3810)
- CSA Certified (File #LR-5863, LR-1863)
- NOM Certified (File #057)



## Porcelain Mogul Base Lampholders

With Leads\*  

DESCRIPTION	CAT. NO.	RATING	OD	OH
Keyless, Single Circuit. For high pressure sodium lamps up to 1000 watts. 8-32 Mounting Screws on 1 $\frac{3}{8}$ " Centers	<b>8746</b>	1500W 600V 5KV Pulse-rated	2 $\frac{1}{8}$	3 $\frac{1}{64}$
Keyless, Single Circuit. Positon-oriented. For Super Metalarc HID lamps. 8-32 Mounting Screws on 1 $\frac{3}{8}$ " Centers	<b>8750</b>	1500W 600V	2 $\frac{5}{32}$	2 $\frac{39}{64}$
Keyless, Single Circuit. For high-pressure sodium lamps up to 400 watts. 8-32 Mounting Screws on 1 $\frac{3}{8}$ " Centers	<b>8756</b>	1500W 600V 4KV Pulse-rated	2 $\frac{5}{32}$	2 $\frac{39}{64}$
Low Pressure Sodium. For use with all single-end bayonet base low pressure sodium lamps★‡	<b>8806</b>	660W 1000V	1 $\frac{3}{8}$	1 $\frac{5}{8}$
Designed for Open-Fixture Shielded Metal Halide Lamps. Complies with NFPA 70-2005 for Open-Rated Fixtures. 8-32 Mounting Screws on 1 $\frac{3}{8}$ " Centers	<b>8751</b>	1500W 600V, 4KV Pulse Rated	2 $\frac{5}{32}$	2 $\frac{39}{64}$

\*Leads types, lengths and ratings vary with the end use applications. Standard leads as well as variations available on inquiry.

## Screw Terminals

DESCRIPTION	CAT. NO.	RATING	OD	OH
Keyless; 2-Piece; Single-Pole★	<b>8765</b>	1500W 600V	2 $\frac{5}{16}$	2 $\frac{23}{64}$
Keyless; . Single Circuit with 8-32 Lock Nuts on 1 $\frac{3}{8}$ " Centers. Die-cast caps available upon request	<b>8694</b>	1500W 600V	2 $\frac{5}{32}$	2 $\frac{39}{64}$

CSA Certified except where indicated by★, and NOM Certified except where indicated by‡.



**8746**



**8750**



**8694**

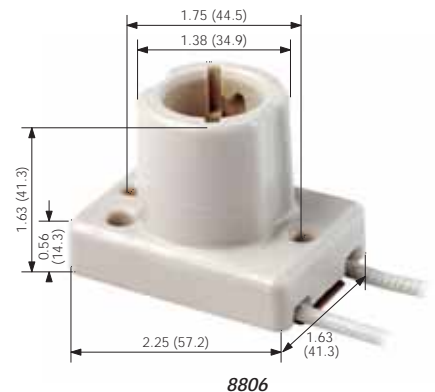

**8806**

### SPECIFICATIONS AND FEATURES

- Cat. No. 8746 – Porcelain body gray glazed with ceramic arc shield; Cat. No. 8750 – Porcelain body yellow glazed; Cat. No. 8751 – Porcelain body pink glazed
- All other moguls listed have white glazed porcelain body
- Copper-alloy nickel-plated screw shell

### TESTING AND CODE COMPLIANCE

- UL Listed (File #E-13402)
- CSA Certified (File #LR-1863)
- NOM Certified (File #057)
- Cat. No. 8751 complies with NFPA 70-2005 requirements for open-rated fixtures



660W 250V • 1500W 600V

## Medium, Mogul and Candelabra Base Incandescent Lampholders

### Socket Extensions — Single Circuit

#### Medium-Medium

DESCRIPTION	CAT. NO.	RATING
2-Piece Porcelain; Mounting Hole 1 3/8" Dia. Extension 1 1/4"*	2004	660W 250V
1-Piece Porcelain; Slotted Mounting Hole 1 3/8" Dia. Extension 1 1/4"*	2005	660W 250V
1-Piece Phenolic. Extension 1 3/16"***	2006	660W 250V

\*To be used with porcelain sockets only

\*\*To be used with phenolic sockets only

#### Mogul-Mogul

DESCRIPTION	CAT. NO.	RATING
1-Piece Porcelain. Extension 2 3/8"†	8647	1500W 600V

### Socket Adapter

#### Mogul-To-Porcelain Medium

DESCRIPTION	CAT. NO.	RATING
1-piece. Meets Fed. Spec. W-L-142a†	8681	660W 250V
Same as above, except 4 KV Pulse-Rated†	8681-400	660W 250V 4 KV Pulse-Rated

### Appliance Heating Receptacle

#### Porcelain Two-Piece

DESCRIPTION	CAT. NO.	RATING
2-piece Heating Receptacle. Gasket Furnished†	8110	660W 250V

### Porcelain and Phenolic Lampholders

#### Pony Cleat Type

DESCRIPTION	CAT. NO.	RATING	OD	OH	C
Candelabra Base; Plastic. Not UL Listed★†	10028	75W 125V	1 7/16	7/8	1 1/8
Miniature Base; Plastic. Not UL Listed★†	10020	75W 125V	1 5/16	7/8	31/32
Medium Base; Phenolic	9063	660W 250V	1 7/8	1 1/2	1 15/16
Medium Base; Porcelain	19062	660W 250V	1 7/8	1 1/2	1 15/16

#### Surface Type

DESCRIPTION	CAT. NO.	RATING	OD	OH	C
Medium Base; Porcelain; Low 2-Piece	9880	660W 250V	2 5/16	1 1/2	1 3/8
Medium Base; Porcelain; High 2-Piece★†	9882	660W 250V	2 5/16	1 7/8	1 3/8

CSA Certified except where indicated by★, and NOM Certified except where indicated by†.

#### SPECIFICATIONS AND FEATURES

- Medium-to-Medium Extenders available in phenolic and porcelain
- Pony Cleat Receptacles have open wiring terminals
- Two-piece surface-type lampholders have concealed wiring terminals with wireways for top and continuous wiring

#### TESTING AND CODE COMPLIANCE

- UL Listed (File #E-3810; E-13396)
- CSA Certified (File #LR-1863)
- NOM Certified (File #057)



2005



19062



9880



## Medium Base Incandescent Lampholders

### Porcelain Snap-In Lampholders — Medium Base

#### Screw Terminals

DESCRIPTION	CAT. NO.	RATING	OD	OH
1-Piece, Front Mounted. 1/4" Shoulder. Panel Thickness: .025 – .062"	<b>8880</b>	660W 250V	1 11/16	1 1/2
1-Piece, Front Mounted. Shallow Back. Panel Thickness: .030 – .062"	<b>8875</b>	660W 250V	1 11/16	1 11/16

### Porcelain Keyless Lampholders Commercial Units — Medium Base

#### Single Circuit Screw Terminals

DESCRIPTION	CAT. NO.	RATING	OD	OH
Straight Body with Cap. Screw Terminals.	<b>10045</b>	660W 250V	1 1/2	2 1/8
Beaded Body for 1 1/2" Clamp Style Shadeholder with Cap. Screw Terminals.	<b>10065</b>	660W 250V	Body 1 1/2	2 1/8
Adjustable Glass Retaining Ring with Cap and Ring Nut. Screw Terminals.	<b>20070</b>	660W 250V	2 1/4 ringnut	—
Straight Body with Leads. No. 18 AWG 105°C Plastic; 9" Long, Stripped 3/4" with Two 6/32 Mounting Screws	<b>10085</b>	660W 250V	1 1/2	1 11/16

### Porcelain Keyless Fixture Single Circuit — Medium Base

#### Screw Terminals

DESCRIPTION	CAT. NO.	RATING	OD	OH
1-Piece, Front Mounted for Fixture or Sign Use. Tapped 8-32 Bushings, Mounting Centers 1 13/16".	<b>9885</b>	660W 600V	1 5/8	1 7/16
2-Piece, Ring Type	<b>9350</b>	660W 250V	1 3/4	1 3/8
1-Piece with Removable Strap★	<b>8871</b>	660W 250V	1 11/16	1 9/16
Fixture Pan Lampholder with 1/8" IPS Hickey	<b>3152-8</b>	660W 250V	1 3/8	1 7/16

#### Leads

DESCRIPTION	CAT. NO.	RATING	OD	OH
2-Piece Ring Type with Leads: No. 18 AWG, 105°C Plastic; 9" Long, Stripped 3/4"	<b>8101</b>	660W 250V	1 3/4	1 3/8
Angle Pan with Leads: No. 18 AWG Type AF 150°C Plastic; 9" Long, Stripped 3/4"	<b>18315</b>	660W 250V	—	—
Removable Bracket with Leads	<b>8052-1</b>	660W 250V	1 3/8	1 7/16
Screw-Mount Pulse-Rated Lampholder with Leads for Open-Fixture Lamps; 18 AWG 200°C 600V SEW-2 (SF-2) wire; 9" Long, Stripped 1/2"	<b>70052-100</b>	660W 600V, 4KV Pulse Rated	1 45/64	2 9/32

#### Two-Piece Pull Chain

DESCRIPTION	CAT. NO.	RATING	OD	OH
Ring Type; Screw Terminals; Gasket Furnished★†	<b>9814</b>	250W 250V	1 13/16	1 13/16

CSA Certified except where indicated by★, and NOM Certified except where indicated by†.

#### SPECIFICATIONS AND FEATURES

- Suitable for a wide variety of fixtures, signs and displays
- Unglazed base and ring on two-piece lampholders
- Gasket supplied with two-piece ring type rated at 90°C dry maximum

#### TESTING AND CODE COMPLIANCE

- UL Listed (File #E-3810)
- CSA Certified (File #LR-1863)
- NOM Certified (File #057)



8880

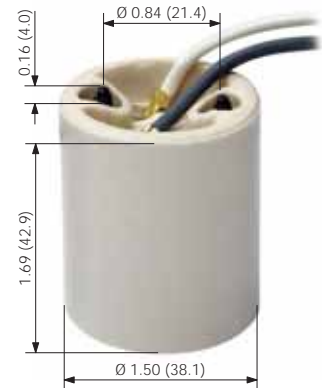

10085



3152



8101



660W 600V • 660W 250V • 250W 250V • 3000W 600V

## Medium Base, Metal Halide and Quartz Halogen Incandescent Lampholders



3352-1



4005

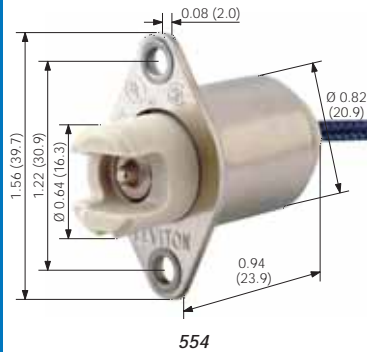

554

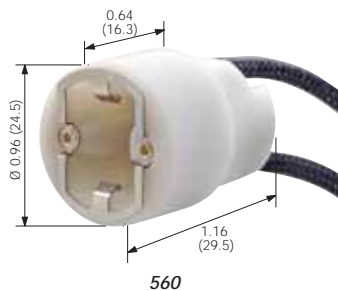

560

### Phenolic Keyless Fixture — Medium Base

#### Screw Terminals

DESCRIPTION	CAT. NO.	RATING
Permanent Bracket. Terminal Screws Backed Out and Staked	3352-1	660W 250V
Same as 3352-1, with Shorter Bracket	3352-F	660W 250V
Removable Hickey. Terminal Screws Backed Out and Staked	3352-8	660W 250V

Hickeys and brackets are available in various types and sizes. Consult a Leviton representative for more information.

### Porcelain Keyless, Side-Mounted — Medium Base

#### Screw Terminals

DESCRIPTION	CAT. NO.	RATING
Single Lampholder w/Side Outlet Bushing—1/8 IPS	10091	660W 250V
Twin Lampholder w/Bushed Flange—1/8 IPS	4010	660W 250V
Twin Lampholder w/Single Outlet Bushing—1/8 IPS	4005	660W 250V
Same as 4005 with 3/8 IPS Bushing	4006	660W 250V

All bushings are tapped and have set screw

### Candle Sockets, Bottom Turn Knob — Medium Base

#### Screw Terminals

DESCRIPTION	CAT. NO.	RATING
Three-light, two-piece phenolic husk. Lighting sequence: LO-MED-HI-OFF★	4063	250W 250V

### Lampholders for Recessed Single Contact Lamps

DESCRIPTION	CAT. NO.	RATING
Front Flange Mount. Standard Leads are No. 18 AWG, Type SEW-2, 200°C, 18" Long, Stripped 3/4"†	554	3000W 600V
Rear Flange Mount. Same Leads and Specs as No. 554†	555	3000W 600V

### Lampholders for Metal Halide and Quartz Halogen Lamps

DESCRIPTION	CAT. NO.	RATING
Single-Ended Metal Halide for Lamps with a G8.5 Base. Lead-In Edge on Body Ensures Proper Lamping. Standard Leads (2) are Black No. 18 AWG, Type SEW-2, 200°C 600V Wire, 9" Long, Stripped .325"†	560	660W 600V, 5KV Pulse Rated
Single-Ended Metal Halide for Lamps with a GX8.5 Base, such as Philips CDM-R11, rated up to 150W. Standard Leads (2) are Black No. 18 AWG, SEW-2, 200°C 600V Wire, 12" Long, Stripped 1/2"†	565	660W 600V, 5KV Pulse Rated
Twist-In Single-Ended Quartz Halogen for Lamps with a GU10 Base, rated up to 150W. Fully Dimmable; Standard Leads (2) are White, No. 20 AWG Teflon® wire, rated 250°C 600V, 6" Long, Stripped 1/2"†	570	660W 600V

CSA Certified except where indicated by ★, and NOM Certified except where indicated by †.

#### SPECIFICATIONS AND FEATURES

- Cat. No. 3352 lampholder bodies have wireways
- Side-Mounted lampholders are white glazed porcelain with copper-alloy screwshell
- Recessed Single-Contact lampholders have porcelain body with nickel-plated steel housing
- Cat. No. 560 has a metal lamp-positioning clip (patent pending) that maintains lamp seating position
- Cat. No. 565 is designed for energy-efficient CDM lamps
- Cat. No. 570 twists in and is fully dimmable

#### TESTING AND CODE COMPLIANCE

- UL Listed (File #E-3810) Cat. Nos. 560, 565 and 570: cULus (File #E-13405)
- CSA Certified (File #LR-1863)
- NOM Certified (File #057)



## Candelabra and Medium Base Incandescent Lampholders

### Candle Sockets, Bottom Turn Knob — Medium Base

#### Screw Terminals

DESCRIPTION	CAT. NO.	RATING
1-Piece Phenolic Body; 2 Leg Bracket; Single Light; Removable Interior; Knurl Nut and Lock Nut	4155	660W 250V
2-Piece Phenolic Husk & Removable Interior Husk; Single Light; Knurl Nut	4158	660W 250V

### Candle Sockets, Keyless\* — Medium Base

#### Fiber-Disc Body, Screw Terminals

DESCRIPTION	CAT. NO.	RATING
Solid Hickey, 2" Overall Height†	8684	660W 250V
Adjustable Hickey, Overall Height: 4–5¾"	9800	660W 250

\*Insulating paper liner pushes down against hickey projections.

NOTE: These items are designed for use with standard socket candle tubes (1<sup>5</sup>/<sub>16</sub>" dia.) and require a minimum of 1<sup>3</sup>/<sub>16</sub>" dia. flat bottom of candle cup for clearance.

### Candle Sockets, Phenolic — Medium Base

#### With Removable Turn Knob, Screw Terminals

DESCRIPTION	CAT. NO.	RATING
Removable Knob (Short Type), Adjustable Hickey. Overall Height: 4–5½"	9805*	250W 250V
Removable Knob, Removable 1-Leg Hickey. Overall Height: 27/16"	9805-A*	250W 250V

NOTE: These items are designed for use with standard socket candle tubes (1<sup>5</sup>/<sub>16</sub>" dia.) and require a minimum of 1<sup>3</sup>/<sub>16</sub>" dia. flat at bottom of candle for clearance.

### Candelabra Base, Keyless\*

DESCRIPTION	CAT. NO.	RATING
Screw Terminals; Solid Hickey. Overall Height: 2"	10025	75W 125V
Screw Terminals; Solid Hickey. Overall Height: 1½"	10027	75W 125V
Screw Terminals; Adjustable Hickey: 3¼–4¾"	10026	75W 125V
Double Snap-In Spring Clips. Height of socket from panel is 1". Leads are No. 18 AWG 105°C plastic, 24" long, stripped ½"	10014-800	75W 125V

\*7/8" candle tube. All hickey taps 1/8" IPS.

NOM Certified except where indicated by†

#### SPECIFICATIONS AND FEATURES

- Candle sockets for single-light applications
- Fiber Disc Body for use with standard candle tubes
- Spring-tempered steel clip holds Cat. No. 10014-800 socket rigidly in place

#### TESTING AND CODE COMPLIANCE

- UL Listed (File #E-3810; E-13400)
- CSA Certified (File #LR-1863)
- NOM Certified (File #057)



4155



9805



10025



10014-800



75W 125V • 660W 250V

## Candelabra and Medium Base Incandescent Lampholders



20025



267



167



55

### Candle Sockets — Porcelain

#### Candelabra Base Screw Terminals

DESCRIPTION	CAT. NO.	RATING
Solid Hickey.* Overall Height: 2 <sup>3</sup> / <sub>32</sub> "★†	20025	75W 125V

\*Other hickey sizes available

### Keyless Heavy Duty Phenolic Single Circuit Lampholders

#### Two-Piece Pin Type

DESCRIPTION	CAT. NO.	RATING
Candelabra Base, Detachable Zinc-Plated Wire Hook. Accepts No. 20 – No. 18 Stranded Insulated Wire	267**	75W 125V
Medium Base, Detachable Zinc-Plated Wire Hook. Accepts No. 14 – No. 12 Stranded Insulated Wire	167**	660W 250V

Note: Linings assembled.

\*\*For temporary lighting — not waterproof.

#### Pigtail Type Medium Base with Leads

DESCRIPTION	CAT. NO.	RATING
Vinyl, Phenolic Interior & Screw Shell, Brass Shell Contact. Leads are No. 14 AWG, 6" Long, Stripped 3/4", Molded into Boots†	55**	660W 250V
Phenolic with Brass Screw Shell. Leads Soldered and Hot Waxed in Deep Well are No. 14 AWG 6" Long	157**	660W 250V
Same as 157 above, with Left-Hand Screw Shell	157-X**	660W 250V
Rubber, Aluminum Screwshell. Leads are No. 16 AWG, 6" Long, Soldered to Terminals and Sealed in Rubber Boot★	124-D	660W 250V

\*\*For temporary lighting—not waterproof.

All devices are UL Listed except Cat.No. 124-D. Also CSA Certified except where indicated by ★, and NOM Certified except where indicated by †

Note: The listed products may be used at construction sites provided that bulb cages are used and suitable splices are made. The listing for the products meets the OSHA requirement and is made for open wiring without a separate outlet box.

#### SPECIFICATIONS AND FEATURES

- Candle socket has white unglazed porcelain body with aluminum screw shell
- Choice of Pin-Type or Pigtail Type for temporary lighting applications
- Two-Piece Pin Type automatically pierces wire leads

#### TESTING AND CODE COMPLIANCE

- UL Listed (File #E-13400) 267\*\*
- UL Listed (File #E-3810) 55\*\*, 157\*\*, 157-X\*\* and 167\*\*
- CSA Certified (File #LR-1863)
- NOM Certified (File #057)



## Medium, High Output and Slimline—Linear Fluorescent Lampholders

### For High Output Lamps — Recessed Double Contact, Pedestal Type

DESCRIPTION	CAT. NO. PLUNGER	CAT. NO. FIXED	RATING
Screw Mount, Push-in wiring.*	13464	13465	660W 600V
Same as 13464/13465 except with Internal Shunt Connection for Electronic Ballasts*	23464	23465	660W 600V
Slide-on, Shallow Base, Quickwire Terminals*	13550	13551	660W 600V
Slide-on, Shallow Base for Power Groove and Jacketed Lamps, Quickwire Terminals*	13556	13557	660W 600V

### For Slimline, Single Pin Lamps

DESCRIPTION	CAT. NO. PLUNGER	CAT. NO. FIXED	RATING
Butt-On Surface Mounting, 12" Leads†	452	453	660W 1000V 660W 600V
Pedestal Base, Slide-On	466	467	660W 1000V 660W 600V
Shallow Base, Slide-On or Lock-On Mounting, Quickwire Terminals*	2536	2537	660W 1000V 660W 600V

### For Medium Bi-Pin Lamps

DESCRIPTION	CAT. NO. WHITE	RATING
Thin Body, Quickwire Terminals Accommodate Rapid-Start Circuits	431-W	660W 600V
Pedestal type, Straight-in Wiring Through Wireways or Screw Terminals‡	390-1W	660W 600V
Same as above, with Starter Base‡	391-1W	660W 600V

### Starter Bases

#### For Medium Bi-Pin Lamps

DESCRIPTION	CAT. NO.	RATING
Starter Base; Screw Terminals, Black‡	380	660W 250V
Starter Base; with Leads, Black‡	396	660W 250V

NOM Certified except where indicated by†

\*Suitable for outdoor applications when properly enclosed

#### SPECIFICATIONS AND FEATURES

- Silver-plated copper alloy contacts
- Quickwire terminals accept No. 18 AWG twisted and tinned, solder-dipped or solid leads
- Lampholders are white, starter bases are black

#### TESTING AND CODE COMPLIANCE

- UL Listed (File #E-5833)
- CSA Certified (File #LR-1863; LR-5863; LR-2200)
- NOM Certified (#057)

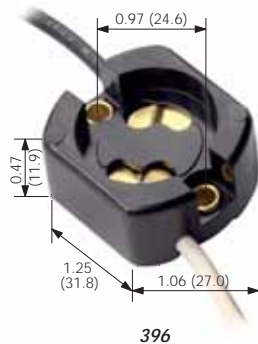
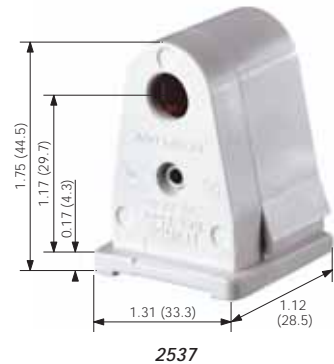
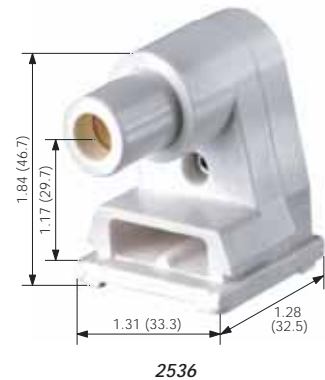
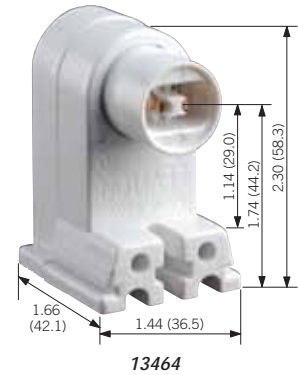



660W 600V • 660W 1000V • 75W 250V

## Medium and Miniature Bi-Pin Lamps—Linear Fluorescent Lampholders

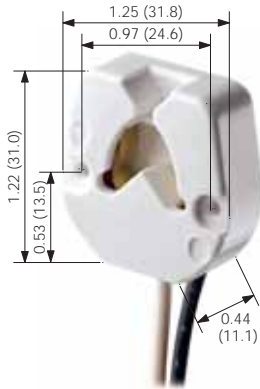

395-W

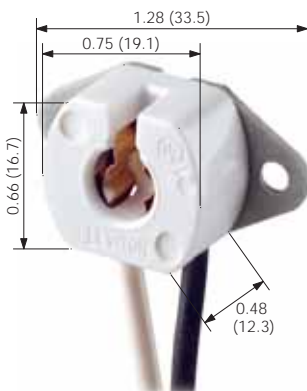

420-W



13518 — see diagram right

### For Medium and Miniature Bi-Pin Lamps — Surface Mount with Leads\*

DESCRIPTION	CAT. NO. WHITE	RATING
Rapid-Start Medium Bi-Pin, 9" leads	395-W	660W 600V
Rapid-Start Medium Bi-Pin, Disconnect (paired with Cat. No. 395-W), 9" leads	389-W	660W 600V
Miniature Bi-Pin for T5 Lamp, 6" leads	420-W	75W 250V

\*Leads are No. 18 AWG, 105°C plastic insulated wire

### For Slimline, Medium Bi-Pin, High Output Lamps — Snap-In with Quickwire

DESCRIPTION	CAT. NO. PLUNGER	CAT. NO. FIXED	RATING
Slimline†	516	517	660W 1000V 660W 600V
Medium Bi-Pin, Stainless Steel Coverplate & Clip	13518	13519	660W 600V 660W 600V
Medium Bi-Pin, Same as above, with Internal Shunt for Use with Electronic Ballasts	23518	23519	660W 600V 660W 600V
High Output 800mA and 1500mA ‡	523	524	660W 600V 660W 600V

NOM Certified except where indicated by ‡

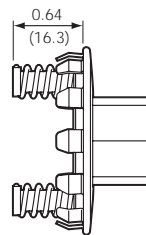

13518  
PLUNGER STYLE

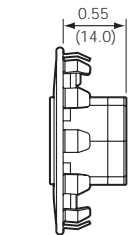
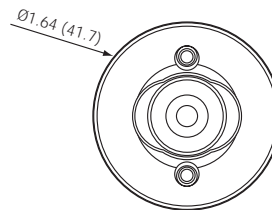

13519  
STATIONARY STYLE

47.75 (1212.9) FOR 48" LAMPS

Medium Bi-Pin Spacing

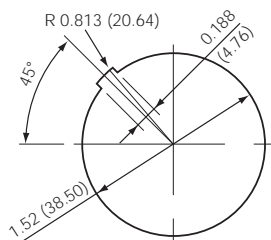

PANEL OPENING FOR 13518/13519  
PANEL THICKNESS 0.035-0.050 (0.89-1.27)

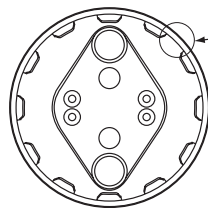

KEY for  
13518/13519

### SPECIFICATIONS AND FEATURES

- Versatile snap-in mounting reduces fixture assembly time
- Quickwire terminals accept either No. 18 AWG (stranded, twisted or tinned), No. 18 AWG solid or No. 16 AWG solid.
- Internal Shunt versions stamped "S" on back for easy identification

### TESTING AND CODE COMPLIANCE

- UL Listed (File #E-5833)
- CSA Certified (File #LR-5863; LR-1863)
- NOM Certified (#057)



## Medium Bi-Pin Lamps—Linear Fluorescent Lampholders

### For Medium Bi-Pin Lamps — Turn-Type

DESCRIPTION	CAT. NO.	RATING
Low Profile, Slide-On, with Captive Nut	13353-N	660W 600V
Tall Profile, Slide-On, with Captive Nut	13357-N	660W 600V
Tall Profile without Side Grooves, Slide-On, with Captive Nut	13359-N	660W 600V
Low Profile Disconnect, Slide-On	13351-D	660W 600V
Tall Profile Disconnect, Slide-On	13354-D	660W 600V
Low-Profile; Shunted, Slide-On	23351	660W 600V

### For Medium Bi-Pin Lamps — Straight-In

DESCRIPTION	CAT. NO.	RATING
Low Profile, Slide-On	13150-UR5	660W 600V
Self-Locking; Slide-In, with Captive Nut. For use with T-8 Lamps	13451-N	660W 600V

### For Medium Bi-Pin Lamps — Snap-In/Slide-On Design and Lamp-Lock

DESCRIPTION	CAT. NO.	RATING
Snap-In or Slide-On Mounting Featuring Lamp-Lock, with Panel Locator Post. For T-8 and T-12 Lamps	13653-WP	660W 600V
Same as Above, Less Locator Post	13653-NP	660W 600V
Same as 13653-WP, Except with Internal Shunt Connection for Electronic Ballasts	23653-WP	660W 600V
Same as Above, Less Locator Post	23653-NP	660W 600V
Snap-In or Slide-On Mounting Featuring Lamp-Lock, Optional Panel Locator Post. Dedicated for Energy-Efficient T-8 Lamps Only	13652-WP	660W 600V
Same as 13652, Except with Internal Shunt Connection for Electronic Ballasts	23652-WP	660W 600V
Snap-In or Slide-On Mounting Featuring Lamp-Lock, for Energy-Efficient T-8 Lamps Only. Wide-Wing Design	13652-WWP	600W 600V
Same as Above, Less Locator Post	13652-WNP	600W 600V
Same as 13652-WWP, Except with Internal Shunt Connection for Electronic Ballasts	23652-WWP	600W 600V
Same as Above, Less Locator Post	23652-WNP	600W 600V
Snap-In or Slide-On Mounting Featuring Lamp-Lock, for T-8 and T-12 Lamps. Wide-Wing Design	13653-WWP	600W 600V
Same as Above, Less Locator Post	13653-WNP	600W 600V
Same as 13653-WWP, Except with Internal Shunt Connection for Electronic Ballasts	23653-WWP	600W 600V
Same as Above, Less Locator Post	23653-WNP	600W 600V

NOTE: Also available with bottom push-in wiring. Contact your Leviton representative for further details.

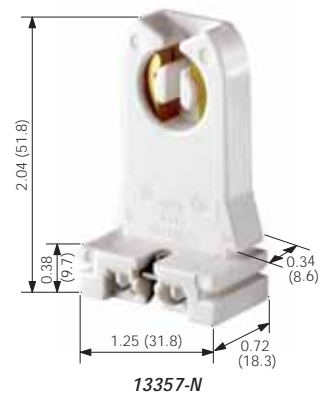
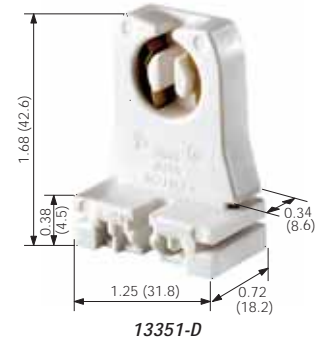

#### SPECIFICATIONS AND FEATURES

##### Lamp-Lock

- Four-position lamp-lock socket rotates 90°, forward and back, for quick relamping
- Lamp-Lock models have slim, low profile silhouette that fits 22 to 25 gauge panels
- Chemical-resistant white thermo-plastic body

#### TESTING AND CODE COMPLIANCE

- UL Listed (File #E-5833)
- CSA Certified (File #LR-1863; LR-5863; LR-2200)
- NOM Certified (#057)
- Medium Bi-Pin lamps with Snap-In/Slide-On Design and Lamp-Lock are VDE Certified to IEC

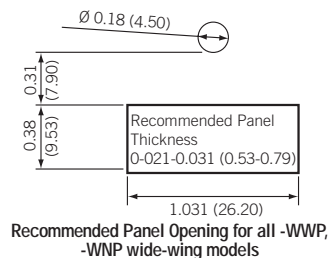
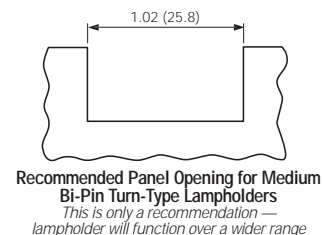
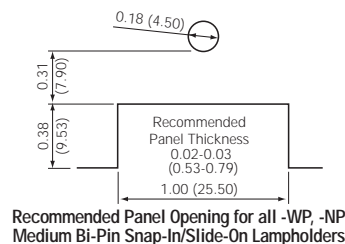



120W 600V • 660W 600V

## Medium and Miniature Bi-Pin Lamps—Linear Fluorescent Lampholders

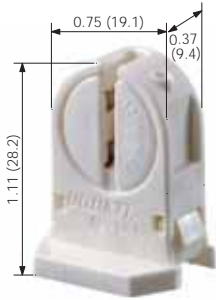

13654-SNP

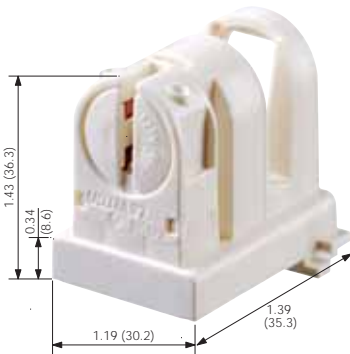

13654-EXL

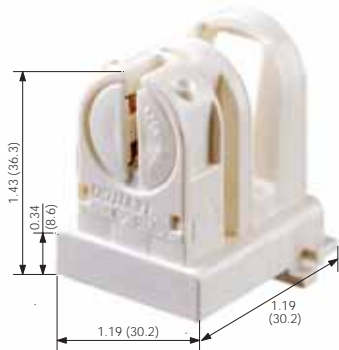

13654-EXS

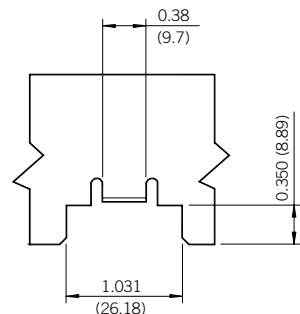

Recommended Panel Opening for Medium Bi-Pin Slide-On Lampholders

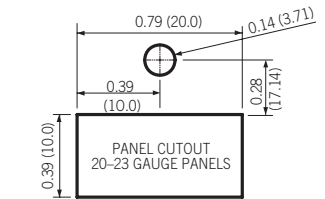

Recommended Panel Opening for Miniature Bi-Pin Snap-In/Slide-On Lampholders

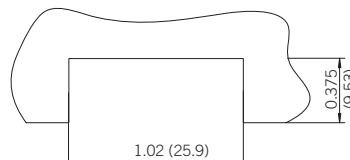

Recommended Panel Opening for T-8 to T-5 Adapter

### For Medium Bi-Pin Lamps — Slide-On Design and Lamp-Lock®

DESCRIPTION	CAT. NO.	RATING
Medium Profile 0.91 (23.0) Lamp Center. Slide-On Mounting Featuring Lamp Lock. For T-8 and T-12 Lamps	13661	660W-600V
Same as 13661, Except with Internal Shunt Connection for Electronic Ballasts	23661	660W-600V
Tall Profile 1.18 (30.0) Lamp Center. Slide-On Mounting Featuring Lamp Lock. For T-8 and T-12 Lamps	13660	660W-600V
Same as 13660, Except with Internal Shunt Connection for Electronic Ballasts	23660	660W-600V

### For Miniature Bi-Pin Lamps — Snap-In/Slide-On Design and Lamp-Lock®

DESCRIPTION	CAT. NO.	RATING
Low Profile 0.62 (15.7) Lamp Center, Snap-In or Slide-On Mounting Featuring Lamp-Lock, with Panel Locator Post. For T-5 Lamps	13654-SWP	120W 600V
Same as Above, Less Locator Post	13654-SNP	120W 600V
Tall Profile 0.98 (24.9) Lamp Center, Snap-In or Slide-On Mounting Featuring Lamp-Lock, with Panel Locator Post. For T-5 Lamps	13654-TWP	120W 600V
Same as Above, Less Locator Post	13654-TNP	120W 600V
Low Profile 0.62 (15.7) Lamp Center, Snap-In or Slide-On Mounting Featuring Lamp-Lock, with Panel Locator Post. For T-5 Lamps. Internal Shunt Connection for Electronic Ballasts	23654-SWP	120W 600V
Same as Above, Less Locator Post	23654-SNP	120W 600V
Tall Profile 0.98 (24.9) Lamp Center, Snap-In or Slide-On Mounting Featuring Lamp-Lock, with Panel Locator Post. For T-5 Lamps. Internal Shunt Connection for Electronic Ballasts.	23654-TWP	120W 600V
Same as above, Less Locator Post	23654-TNP	120W 600V

### T-8 to T-5 Adapter

Long T-8 to T-5 Adapter, converts existing T-8 fixtures to accept energy-efficient T-5 lamps; with Lamp Lock. <i>Specify lamp length for proper ordering</i>	13654-EXL	120W 600V
Short T-8 to T-5 Adapter, converts existing T-8 fixtures to accept energy-efficient T-5 lamps; with Lamp-Lock. <i>Specify lamp length for proper ordering</i>	13654-EXS	120W-600V

#### SPECIFICATIONS AND FEATURES

##### Lamp-Lock

- Four-position lamp-lock socket rotates 90°, forward and back, for quick relamping
- Lamp-Lock models have slim, low profile silhouette that fits 22 to 25 gauge panels
- Chemical-resistant white thermoplastic body

##### T-8 to T-5 Adapter

- Cost-effective solution to incorporate miniature bi-pin T-5 lamps into existing T-8 configurations

#### TESTING AND CODE COMPLIANCE

- UL Listed (File #E-5833)
- CSA Certified (File #LR-1863; LR-5863; LR-2200)
- NOM Certified (#057)
- Medium Bi-Pin Lamps with Slide-On Design and Lamp-Lock are VDE Certified to IEC



## Long Twin Tube with 2G11 Base—Compact Fluorescent Lampholders

### 4-Pin Long Twin-Tube with 2G11 Base — Slide-In Mounting

DESCRIPTION	CAT. NO.	RATING
Slide-In for 18-20 Ga. Panels, Quickwire Terminals	13452	660W 600V

### 4-Pin Long Twin-Tube with 2G11 Base — Bottom or Back Mounting

DESCRIPTION	CAT. NO.	RATING
Vertical Snap-In Mounting, Side Push-In Wiring	13453	660W 600V
Same as above, with Internal Shunt Connection for Electronic Ballasts	23453	660W 600V
Horizontal Snap-In Mounting, Bottom Push-In Wiring	13454	660W 600V
Same as above, with Internal Shunt Connection for Electronic Ballasts	23454	660W 600V
Horizontal Screw-Mount, Bottom Push-In Wiring	13455	660W 600V
Same as above, with Internal Shunt Connection for Electronic Ballasts	23455	660W 600V

Note: See page S18 for Lamp Support Clips



13453



13454

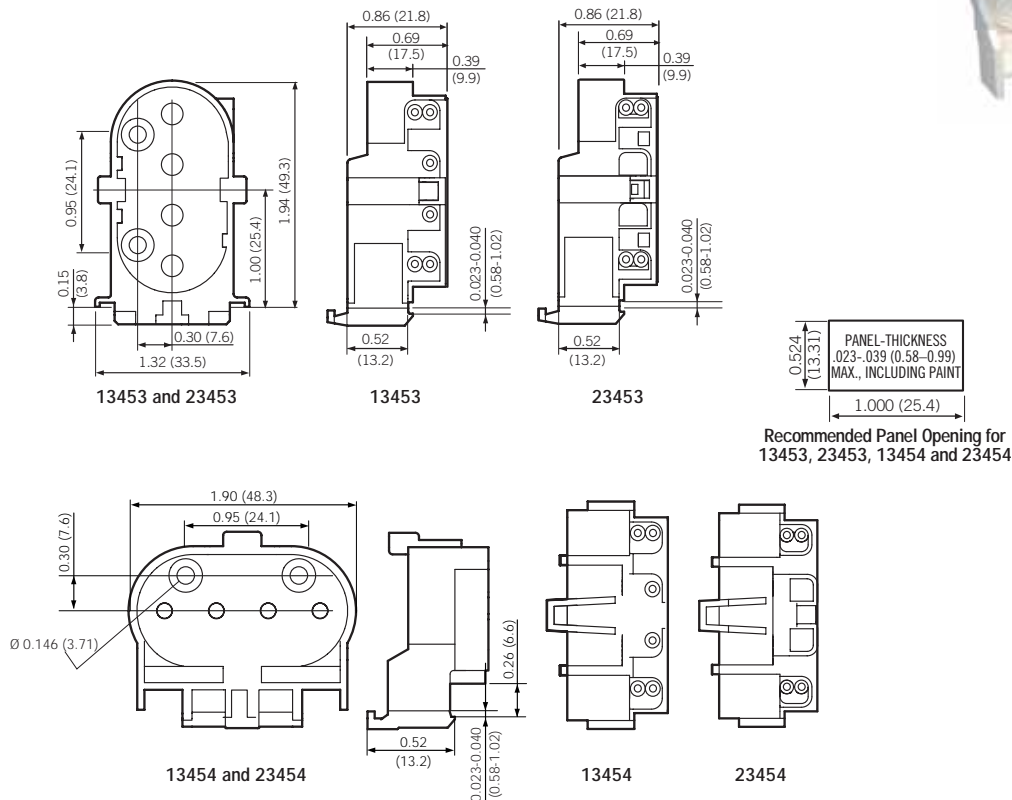

#### SPECIFICATIONS AND FEATURES

- Vertical Snap-In model allows wires to be routed on either top or bottom of panel
- Two wiring ports per contact speed harness wiring
- Internal Shunt models eliminate need for extra jumper wire in fixtures designed for electronic ballasts
- Low-profile design for smaller, more compact fixtures
- Superior metal-spring lamp retainer clips

#### TESTING AND CODE COMPLIANCE

- UL Listed (File #E-5833)
- CSA Certified (File #LR-1863)
- NOM Certified (File #057)

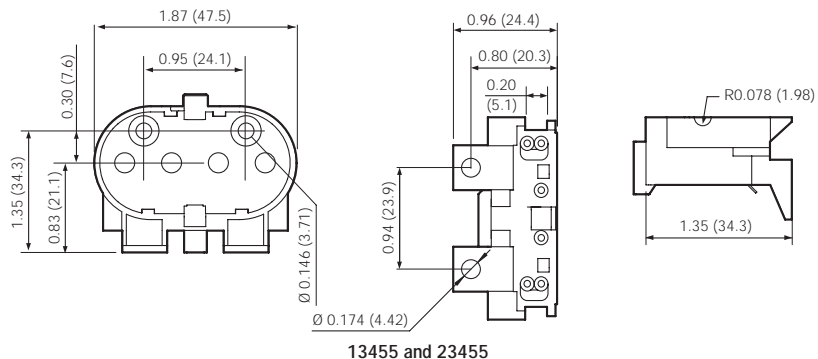



## LAMP SUPPORT CLIPS

### Lamp Support Clips for Long Twin Tube 2G11 Base Fluorescent Lampholders



23452-H



23452-V



23452-MTS



23452-MTL

#### Plastic and Stainless Steel Lamp Support Clips

DESCRIPTION	CAT. NO.
Plastic Lamp Support Clip, Slide-On	23452-A*
Plastic Lamp Support Clip, Screw Mount	23452-B*
Horizontal Snap-In Lamp Support Clip for 13454, 23454, 13455 and 23455. UV-Stable, Clear Polycarbonate	23452-H*
Vertical Snap-In Lamp Support Clip for 13453 and 23453. UV-Stable, Clear Polycarbonate	23452-V*
Stainless Steel Horizontal Lamp Support Clip, Short Version	23452-MTS
Stainless Steel Horizontal Lamp Support Clip, Tall Version	23452-MTL

\*Note: Leviton strongly recommends replacing support clips 23452-A, 23452-B, 23452-V and 23452-H during lamp replacement.

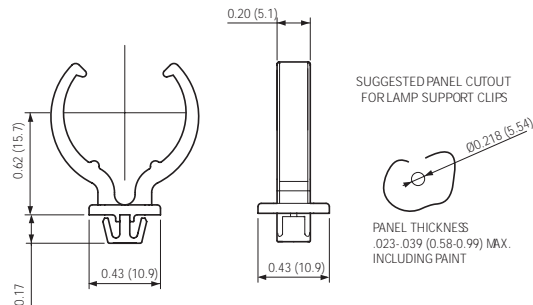

Vertical Lamp Support Clip—23452-V

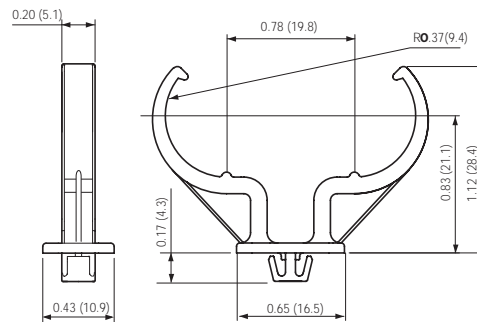

Horizontal Lamp Support Clip—23452-H

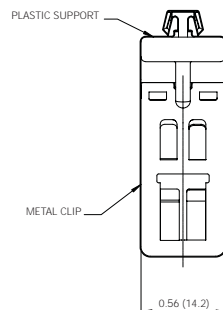

Horizontal Lamp Support Clips  
23452-MTS, 23452-MTL

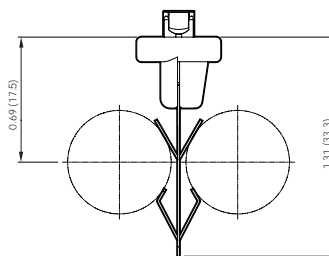

Horizontal Lamp Support Clip, Short  
23452-MTS

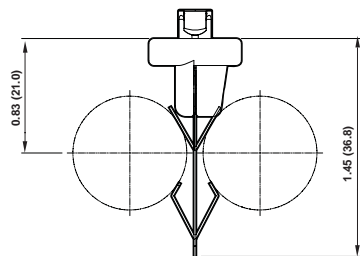

Horizontal Lamp Support Clip, Tall  
23452-MTL

#### SPECIFICATIONS AND FEATURES

- Choice of quality lamp support clips in a variety of configurations for long twin tube lamps with 2G11 base
- UV stable clear polycarbonate clips for vertical or horizontal mounting
- Stainless steel clips with UV stable clear polycarbonate base for horizontal mounting only; short or tall versions
- Plastic clips for slide-on or screw-mount



## 10mm Compact Fluorescent Lampholders

For G23 and G23-2 Lamp Bases — Rating: 75 WATT 600V

MOUNTING	CAT. NO.	COLOR	LAMP BASE	PHILIPS	OSRAM SYLVANIA	GE LIGHTING
Horizontal Snap-In	26719-100	White	G23, G23-2			
Horizontal Screw-Down	26719-200	White	G23, G23-2	PL-S 5W, 7W 9W	DULUX S 5W, 7W, 9W DULUX D 9W	BIAX 5W, 7W 9W DOUBLE BIAX 9W
Vertical Top Snap-In	26719-300*	White	G23			
4-Hole Vertical Screw-Down	26719-400	White	G23, G23-2			
Vertical Bottom Snap-In	26719-500	White	G23, G23-2			

\*Not compatible with 9-watt DTT lamps

For GX23 and GX23-2 Lamp Bases — Rating: 75 WATT 600V

MOUNTING	CAT. NO.	COLOR	LAMP BASE	PHILIPS	OSRAM SYLVANIA	GE LIGHTING
Horizontal Snap-In	26720-100	White w/Black	GX23, GX23-2			
Horizontal Screw-Down	26720-200	White w/Black	GX23, GX23-2	PL-S 13W PL-C 13W	DULUX S 13W DULUX D 13W	BIAX 13W DOUBLE BIAX 13W
Vertical Top Snap-In	26720-300*	White w/Black	GX23			
4-Hole Vertical Screw-Down	26720-400	White w/Black	GX23, GX23-2			
Vertical Bottom Snap-In	26720-500	White w/Black	GX23, GX23-2			

\*Not compatible with 13-watt DTT lamps



26719-100



26719-200



26720-300



26720-400

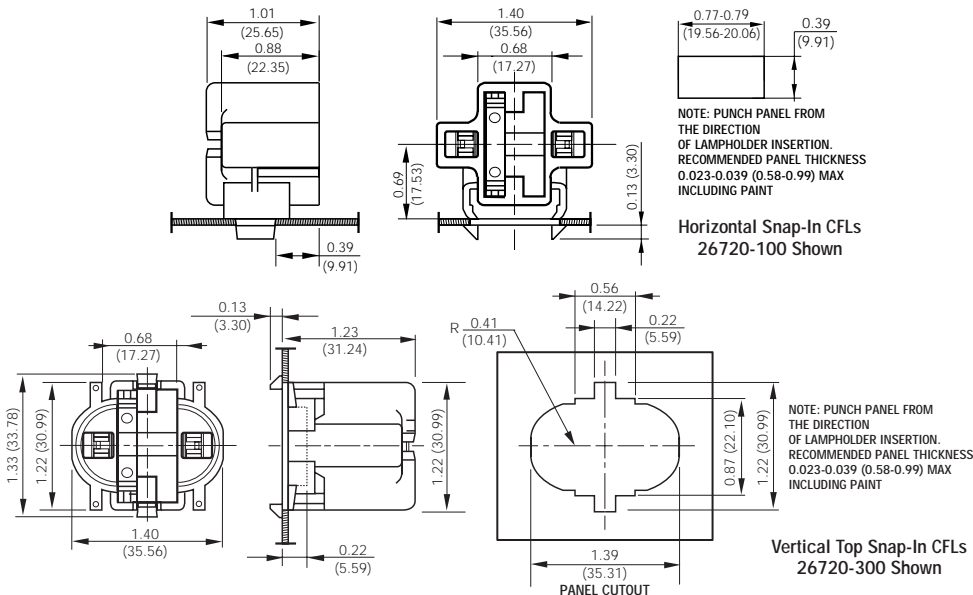

### SPECIFICATIONS AND FEATURES

- "Smart" CFL Lampholders are color-coded for easy wattage identification
- Bottom Snap-In versions for easier panel assembly
- Snap-In versions designed for 16 Ga. panels
- Metal-spring lamp-retainer clip provides positive lamp retention and is more durable than plastic clips
- Two wiring ports per contact speed harness wiring

- Four screw holes for greater mounting flexibility
- Wire-routing options for top or bottom side of mounting panel for easier assembly
- White thermoplastic body

### TESTING AND CODE COMPLIANCE

- UL Listed (File #E-5833)
- UL Listed for indoor and outdoor applications when properly enclosed
- CSA Certified (File #LR-1863)
- NOM Certified (File #057)

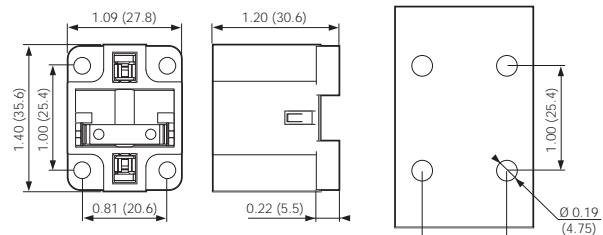





75W 600V

## Compact Fluorescent Lampholders (CFLs)

### 10mm Compact Fluorescent Lampholders

For G24d Lamp Bases 2-Pin — Rating: 75 WATT 600V  



26725-213



26725-419

#### SPECIFICATIONS AND FEATURES

- “Smart” CFL Lampholders are color-coded for easy wattage identification
- Bottom snap-in versions for easier panel assembly available for 16 Ga. and 18–20 Ga. panels
- All 4-pin lampholders have internal rejection feature that prevents insertion of 2-pin lamps
- Metal-spring lamp-retainer clip provides positive lamp retention and is more durable than plastic clips
- Two wiring ports per contact speed harness wiring
- Four screw holes for greater mounting flexibility
- Wire-routing options for top or bottom side of mounting panel for easier assembly
- White thermoplastic body

#### TESTING AND CODE COMPLIANCE

- UL Listed (File #E-5833)
- UL Listed for indoor and outdoor applications when properly enclosed
- CSA Certified (File #LR-1863)
- NOM Certified (File #057)

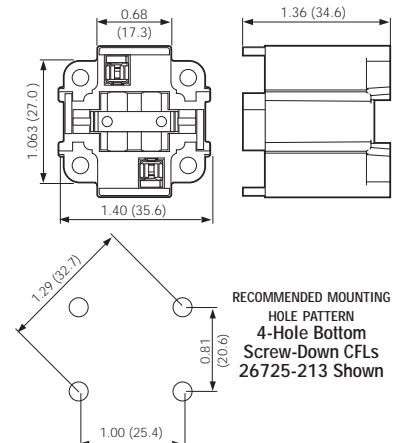
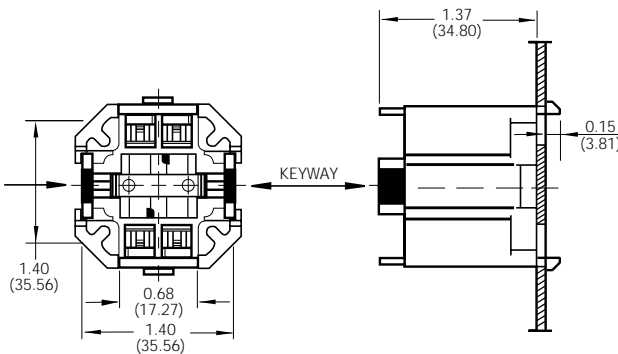
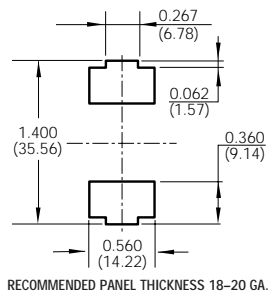

MOUNTING	CAT. NO.	COLOR	LAMP BASE	PHILIPS	OSRAM SYLVANIA	GE LIGHTING
<b>Bottom Snap-In</b>						
For 16 Ga. Panels	26725-201	White	G24d-1	PL-C	DULUX D	DOUBLE
For 18-20 Ga. Panels	26725-221	w/Black		10W, 13W	10W, 13W	BIAX 10W, 13W
For 16 Ga. Panels	26725-202	Green	G24d-2	PL-C	DULUX D	DOUBLE
For 18-20 Ga. Panels	26725-222			18-W	18W	BIAX 18W
For 16 Ga. Panels	26725-203	Orange	G24d-3	PL-C	DULUX D	DOUBLE
For 18-20 Ga. Panels	26725-223			26W	26W	BIAX 26W
<b>Bottom Screw-Down</b>						
4-Hole	26725-211	White	G24d-1	PL-C	DULUX D	DOUBLE
		w/Black		10W, 13W	10W, 13W	BIAX
4-Hole	26725-212	Green	G24d-2	PL-C	DULUX D	DOUBLE
				18W	18W	BIAX 18W
4-Hole	26725-213	Orange	G24d-3	PL-C	DULUX D 26W	DOUBLE
					DULUX T 26W	BIAX 26W

For G24q and GX24q Lamp Bases 4-Pin — Rating: 75 WATT 600V

Suitable for Dimming or Electronic Ballasts  

MOUNTING	CAT. NO.	COLOR	LAMP BASE	PHILIPS	OSRAM SYLVANIA	GE LIGHTING
<b>Bottom Snap-In</b>						
For 16 Ga. Panels	26725-401	White	G24q-1	PL-C	DULUX D/E	DOUBLE
For 18-20 Ga. Panels	26725-421	w/Black		10W, 13W	10W, 13W	BIAX 10W, 13W
For 16 Ga. Panels	26725-402	Green	G24q-2	PL-C	DULUX D/E	DOUBLE
For 18-20 Ga. Panels	26725-422			18W	18W	BIAX 18W
For 16 Ga. Panels	26725-403	Orange	G24q-3,	PL-C 26W	DULUX D/E	DOUBLE
For 18-20 Ga. Panels	26725-423		GX24q-3	PL-T	DULUX T/E	BIAX
			26W, 32W	26W, 32W	26W	
For 16 Ga. Panels	26725-404	Yellow	GX24q-4	PL-T 42W	DULUX T/E	PERFORMANCE
For 18-20 Ga. Panels	26725-424				42W	BIAX 42W
For Universal ballast only,	26725-429	White	G24q-3	PL-T 26W,	DULUX T/E	TRIPLE BIAX
18-20 Ga. Panels			GX24q-4	32W, 42W	26W, 32W,	26W, 32W,
					42W	42W
<b>Bottom Screw-Down</b>						
4-Hole	26725-411	White	G24q-1	PL-C	DULUX D/E	DOUBLE
		w/Black		10W, 13W	10W, 13W	BIAX 10W, 13W
4-Hole	26725-412	Green	G24q-2	PL-C 18W	DULUX D/E	DOUBLE
					18W	BIAX 18W
4-Hole	26725-413	Orange	G24q-3,	PL-C 26W	DULUX D/E	DOUBLE
			GX24q-3	PL-T	DULUX T/E	BIAX
				26W, 32W	26W, 32W	26W
4-Hole	26725-414	Yellow	GX24q-4	PL-T 42W	DULUX T/E	PERFORMANCE
					42W	BIAX 42W
4-Hole	26725-419	White	G24q-3	PL-T 26W,	DULUX T/E	TRIPLE BIAX
for Universal ballast only			GX24q-4	26W, 32W,	26W, 32W,	26W, 32W,
				42W	42W	42W

Note: Lamp names are trademarked by manufacturers



## 10mm Compact Fluorescent Lampholders for High-Wattage Lamps

For GX24q Lamp Bases, 4-Pin — Rating: 75 WATT 600V

Suitable for Dimming or Electronic Ballasts

MOUNTING	CAT. NO.	COLOR	LAMP BASE	OSRAM SYLVANIA	GE LIGHTING
Bottom Snap-In for 16 Ga. Panels	26725-405	Blue	GX24q-5	DULUX T/E 57W	BIAX Q/E 57W
4-Hole Bottom Screw-Down	26725-415	Blue	GX24q-5	DULUX T/E 57W	BIAX Q/E 57W
2-Hole Bottom Screw-Down, Round Body	26725-4A5	Blue	GX24q-5	DULUX T/E 57W	BIAX Q/E 57W
Bottom Snap-In for 18–20 Ga. Panels	26725-425	Blue	GX24q-5	DULUX T/E 57W	BIAX Q/E 57W
Bottom Snap-In for 16 Ga. Panels	26725-406	Red	GX24q-6	—	BIAX Q/E 70W
4-Hole Bottom Screw-Down	26725-416	Red	GX24q-6	—	BIAX Q/E 70W
2-Hole Bottom Screw-Down, Round Body	26725-4A6	Red	GX24q-6	—	BIAX Q/E 70W
Bottom Snap-In for 18–20 Ga. Panels	26725-426	Red	GX24q-6	—	BIAX Q/E 70W



26725-405



26725-425



26725-416

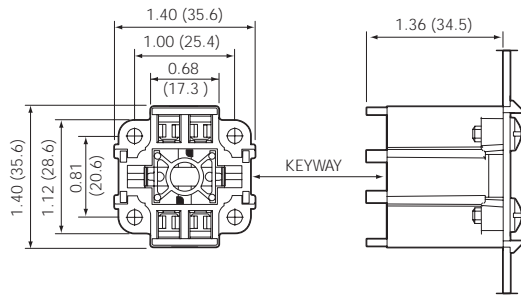

RECOMMENDED MOUNTING SCREW #8 SELF-CUTTING

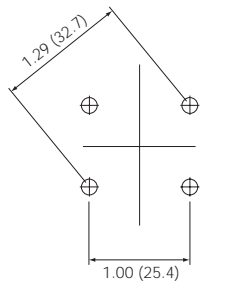

RECOMMENDED HOLE PATTERN

4-Hole Bottom Screw-Down CFLs  
26725-415 Shown

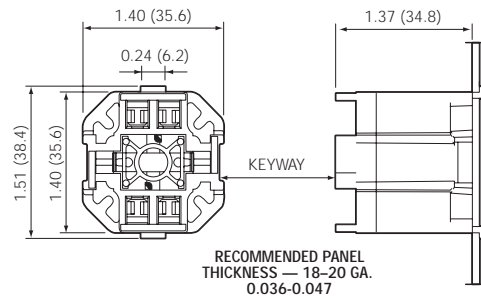

Bottom Snap-In CFLs for 18–20 Ga Panels  
26725-426 Shown

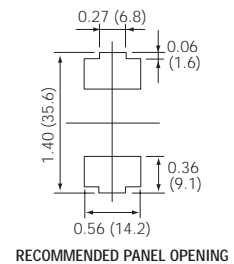

RECOMMENDED PANEL OPENING

### SPECIFICATIONS AND FEATURES

- “Smart” CFL Lampholders are color-coded for easy wattage identification
- Bottom Snap-In versions for easier panel assembly available for 16 Ga. and 18–20 Ga. panels
- All 4-pin lampholders have internal rejection feature that prevents insertion of 2-pin lamps
- Metal-spring lamp-retainer clip provides positive lamp retention
- Two wiring ports per contact speed harness wiring
- Wire-routing options for top or bottom side of mounting panel for easier assembly
- Bodies are white thermoplastic (with color-coding as indicated)
- Quick-connect push-in wiring terminals accept No. 18 AWG solid or twisted-and-overtinned leads, stripped 3/8 inch

### TESTING AND CODE COMPLIANCE

- UL Listed (File #E-5833)
- UL Listed for indoor and outdoor applications when properly enclosed
- CSA Certified (File #LR-1863)
- NOM Certified (#057)

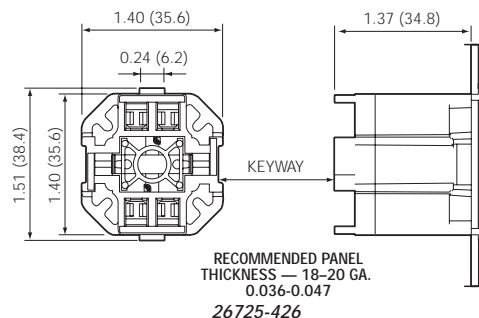

RECOMMENDED PANEL THICKNESS — 18–20 GA.  
0.036–0.047  
26725-426



75W 600V

## Compact Fluorescent Lampholders (CFLs)

### 10mm Compact Fluorescent Lampholders with Round Bodies

For G24d Lamp Bases, 2-Pin — Rating: 75 WATT 600V  
Bottom Screw-Down Mounting  



26725-4A2

CAT. NO.	COLOR	LAMP BASE	PHILIPS	OSRAM SYLVANIA	GE LIGHTING
26725-2A1	Black	G24d-1	PL-C 10W, 13W	DULUX D 10W, 13W	DOUBLE BIAX 10W, 13W
26725-2A2	Green	G24d-2	PL-C, 18W	DULUX D, 18W DULUX T, 18W	DOUBLE BIAX 18W
26725-2A3	Orange	G24d-3	PL-C, 26W	DULUX D, 26W DULUX T, 26W	DOUBLE BIAX 26W

For G24q and GX24q Lamp Bases, 4-Pin — Rating: 75 WATT 600V  
Bottom Screw-Down Mounting — Suitable for Dimming or Electronic Ballasts  



26725-4A3

CAT. NO.	COLOR	LAMP BASE	PHILIPS	OSRAM SYLVANIA	GE LIGHTING
26725-4A1	Black	G24q-1	PL-C 10W, 13W	DULUX-D 10W, 13W	DOUBLE BIAX 10W, 13W TRIPLE BIAX 13W
26725-4A2	Green	G24q-2	PL-C, 18W	DULUX D, 18W DULUX T/E, 18W	DOUBLE BIAX, 18W TRIPLE BIAX, 18W
26725-4A3	Orange	G24q-3	PL-C, 26W PL-T 26W, 32W	DULUX D, 26W DULUX T/E 26W, 32W	DOUBLE BIAX, 26W TRIPLE BIAX 26W, 32W
26725-4A4	Yellow	GX24q-4	PL-T, 42W	DULUX T/E, 42W	PERFORMANCE BIAX 42W
26725-4A5	Blue	GX24q-5	—	DULUX T/E, 57W	BIAX Q/E, 57W
26725-4A6	Red	GX24q-6	—	—	BIAX Q/E, 70W
26725-4A9 Universal*	No color code White body only	G24q-3 GX24q-4	PL-T 26W, 32W 42W	DULUX T/E 26W, 32W, 42W	TRIPLE BIAX 26W, 32W, 42W

\*For use with universal ballast only

Note: Lamp names are trademarked by manufacturers

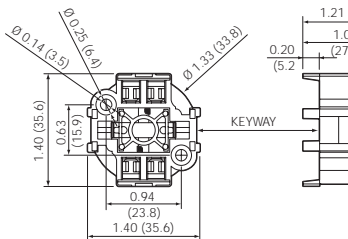

26725-4A5

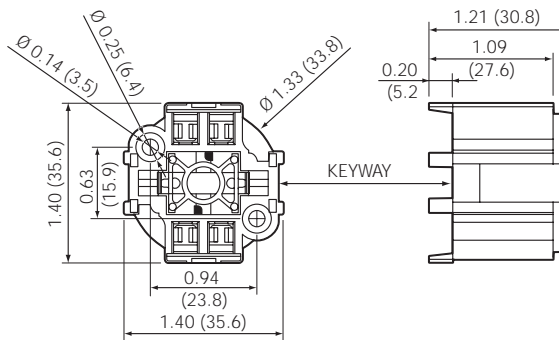

All Round-Body CFLs  
26725-4A5 Shown

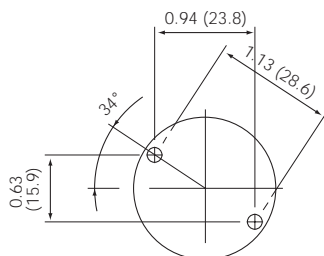

RECOMMENDED PANEL OPENING FOR ALL  
ROUND-BODY CFLs

#### SPECIFICATIONS AND FEATURES

- "Smart" CFL Lampholders are color-coded for easy wattage identification
- All 4-pin lampholders have internal rejection feature that prevents insertion of 2-pin lamps
- Metal-spring lamp-retainer clip provides positive lamp retention and is more durable than plastic clips
- Two wiring ports per contact speed harness wiring
- Wire-routing options for top or bottom side of mounting panel for easier assembly
- Bodies are white thermoplastic (with color-coding as indicated)
- Quick-connect push-in wiring terminals accept No. 18 AWG solid or twisted-and-overtinned leads, stripped 3/8 inch

#### TESTING AND CODE COMPLIANCE

- UL Listed (File #E-5833)
- UL Listed for indoor and outdoor applications when properly enclosed
- CSA Certified (File #LR-1863)
- NOM Certified (#057)