

Thin Wall Conduit Fittings (for EMT Conduit)

Set Screw Type Fittings – Space-Saver

SPACE-SAVER EMT SET SCREW CONNECTORS – STEEL

Applications:

- Used to join EMT conduit to box or enclosure

Features:

- Male threads on locknut allow for more room inside the box
- Smooth pulling surface won't strip cable – no bushing or insulated throat required
- Angled teeth on locknut bite into enclosure, preventing loosening from vibration and creating positive ground continuity
- Knurled wrenching surface for easy tightening
- Zinc electroplated for corrosion resistance

SET SCREW CONNECTOR

- Tri-head set screw may be installed using a slotted, Phillips or Robertson head screwdriver

Certifications and Compliances:

- UL and cUL Listed, File No. E-22132
- UL Standard 514B
- Certified by UL to CSA Standard C22.2 No. 18
- Concrete tight when taped

UL File No. E22132

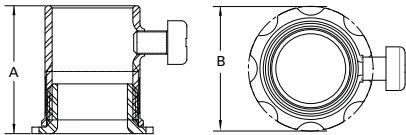

| Cat. # | Size | Unit Qty. | Wt. Lbs. Per 100 | A | B |
|---------|------|-----------|------------------|------|------|
| SSBC50 | 1/2" | 100 | 8 | 1.17 | 1.14 |
| SSBC75 | 3/4" | 50 | 12 | 1.47 | 1.36 |
| SSBC100 | 1" | 25 | 12 | 1.57 | 1.76 |

Standard Material:

- Body and nut – steel

Standard Finish:

- Steel – zinc electroplate

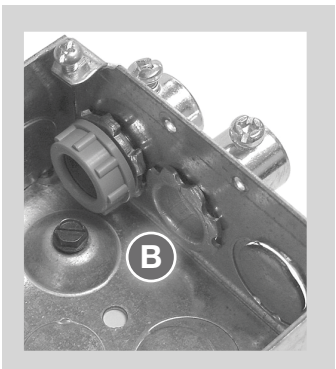

A

Male threads on locknuts thread into the body for a low profile, secure fit – consuming minimal space on the inside of the box or enclosure

B

Smooth pulling surface on locknuts eliminates the need for plastic bushings and ensures the integrity of wiring during pulling

C

Angled teeth on locknuts bite into the enclosure, preventing loosening from vibration and creating positive ground continuity