

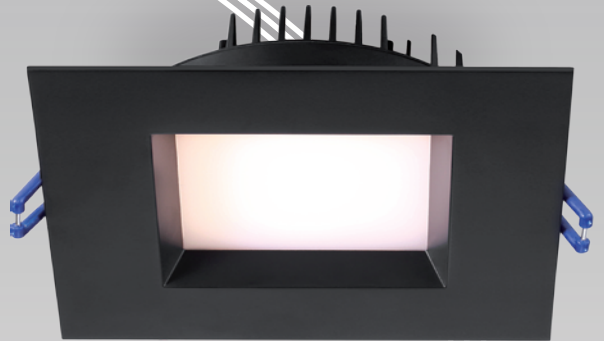

Lotus  
LED  
Lights

# Slim Recessed LED Lighting

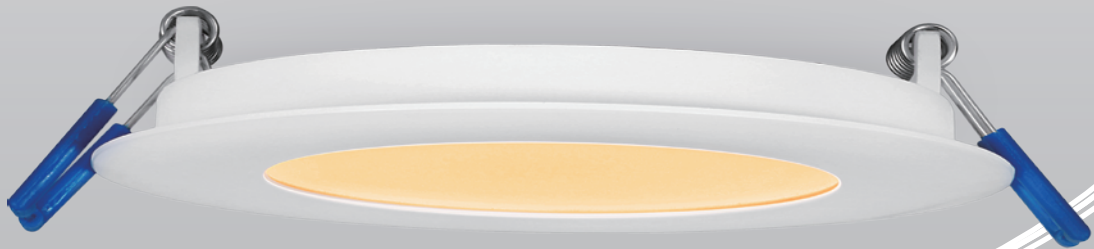

THE ORIGINAL IN NORTH AMERICA

Revision August 2017





Lotus LED Lights Inc has specialized in Slim Recessed LED Lighting Solutions since 2008. The products are sold through its subsidiaries in Canada and the USA.

The high quality and unique features of our lights have established Lotus LED as the North American Lighting Industry Leader for Limited Space Applications.

All current Lotus products and future innovations are designed and developed by our North American Design Team, in order to comply with the relevant National and Regional Building Codes. Lotus holds the design patent for the revolutionary driver-enclosed connection box for LED fixtures.

The production is based in Lotus LED Lights' factory in Shenzhen, China. The management system governing the manufacture of our products is ISO 9001:2000 and ISO 14001:2004 certified.

Lotus is proud that its distribution network includes the major electrical wholesale chains in North America, as well as numerous independent electrical and lighting wholesalers.

Lotus LED Lights is headquartered in Greater Vancouver, BC, where its Western Canada Distribution Center is located. The Eastern Canada market is served by our Toronto Office and Distribution Center.

The USA markets are served by our warehouses in Naples FL, Las Vegas NV, Philadelphia PA, Dallas TX and Seattle WA.

Lotus has gained a continent-wide reputation for quality and reliability in its products. We are also known for responsive customer service; our warehouse network is designed to provide quick and economical delivery.

We are committed to excellence in all ways.

Give us a call and we will be there for you!

# LL2G / LL3G / LL4G

2", 3" and 4" Gimbal Recessed LED

## Type IC & Air-Tight



### DESCRIPTION

Recessed Gimbal Round LED With Integral Driver In Connection Box.

Fits Where No Other Recessed Fixture Can.

Unique Design: Gimbal with 20° tilt Yet Air-Tight Without Housing Needed.

Directional Beam - Great for Sloped Ceilings and Highlighting Artwork

### FEATURES & BENEFITS

1 3/4" Ceiling Space required for installation

Type IC Rated - No Housing Required

Fast & Easy To Install - Save On Labour

4th Gen Driver Inside Lotus Designed Connection Box - No Junction Box Needed

Saves time for contractors and solves limited space constraints.

SPECIFICATIONS			
Models	LL2G	LL3G	LL4G
Applications	Sloped Ceilings, Highlighting Artwork		
Energy Used (W)	5	7.5	11.4
Colour Temperature (K)	2700 / 3000 / 4100		
Light Output (lm)	380 / 400 / 430	580 / 600 / 630	960 / 1000 / 1050
Halogen Equivalent (W)	35	60	100
Beam Angle	24° Beam with 20° tilt and 360° rotation	38° Beam with 20° tilt and 360° rotation	
CRI	94		
Driver Input	120V AC	120V AC or 277V-347V AC	
Power Factor	0.98		
Dimming	TRIAC Dimmers 5% - 100%		
Approved Location	Insulated Ceiling & Damp Location IP40		
Air Tight	Yes		
Ambient Temperature	-40°F (-40°C) to +104°F (+40°C)		
Projected Life	70% Light Output at 50,000 Hours		
Certification	cULus, Energy Star, T24		
Warranty	10 Year on Residential 5 Year on Commercial Applications		

### ORDERING GUIDE



Example: LL3G-30K-WH

Model:	Light Colour:	Trim Finish:
LL2G	27K:2700K	WH : White
LL3G	30K: 3000K	BK : Black
LL4G	41K: 4100K	BN : Brushed Nickel

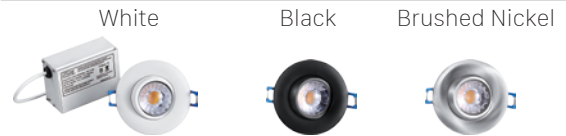
### Available Trims:



### ACCESSORIES

-  Low Voltage Extension Cables  
6ft - cat # EXC6, 20ft - cat # EXC20
-  Rough-In Plates – RIP3 / RIP4
-  Goof Ring White – GR3 / GR4

### 277V - 347V Optional Driver

for model LL3G: cat # LLL-LD0716H

for model LL4G: cat # LLL-LD1025H

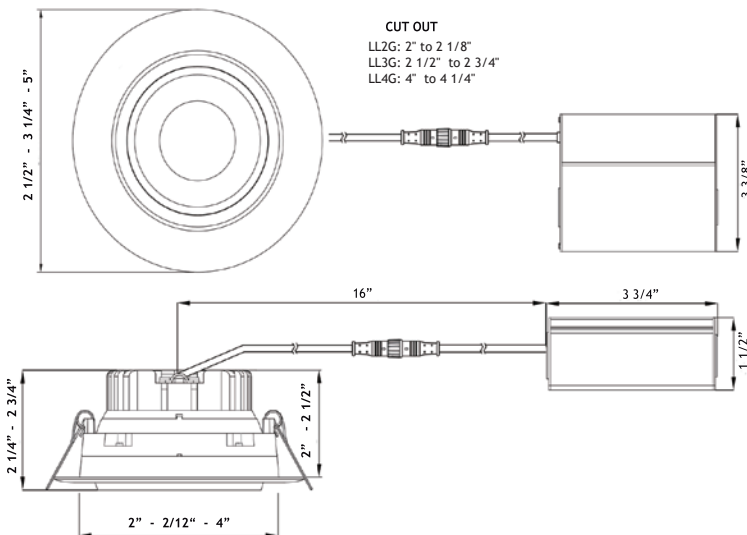

# LL4RRG / LL6RRG

4" and 6" Round Regressed LED - Open Plenum Rated



## Type IC, Air-Tight & Plenum Rated



### DESCRIPTION

Regressed LED fixtures with integral LEDs and built-in driver.  
Commercial Grade Quality With Architectural Design.

### FEATURES & BENEFITS

- 2" Thin - Fits In Tight Ceiling Spaces
- CRI 92 - True Colour Rendering
- Type IC Rated - No Housing Required
- Open Plenum Rated - Suitable For Commercial Installations
- Fast & Easy To Install - Save On Labour
- Junction Box Included - No Additional Hardware Needed

### MOUNTING

Cut Hole In Ceiling And Snap Fixture In Opening With the Spring Clips.  
2" Above Ceiling Clearance Required. Quick connectors Included.

SPECIFICATIONS		
Model	LL4RRG	LL6RRG
Applications	Recessed Ceiling Mount	
Energy Used (W)	14.5	17
Colour Temperature (K)	2700 / 4100	
Light Output (lm)	850 / 900	1000 / 1050
Halogen Equivalent (W)	75	100
Beam Angle	92°	
CRI	92	
Input Voltage	120V AC	
Power Factor	0.99	
Dimming	TRIAC Dimmers 5% - 100%	
Approved Location	Insulated Ceiling & Damp Location IP40	
Air Tight	Yes	
Ambient Temperature	-40°F (-40°C) to +104°F (+40°C)	
Projected Life	70% Light Output at 50,000 Hours	
Certification	cULus, Energy Star, T24	
Warranty	10 Year on Residential 5 Year on Commercial Applications	

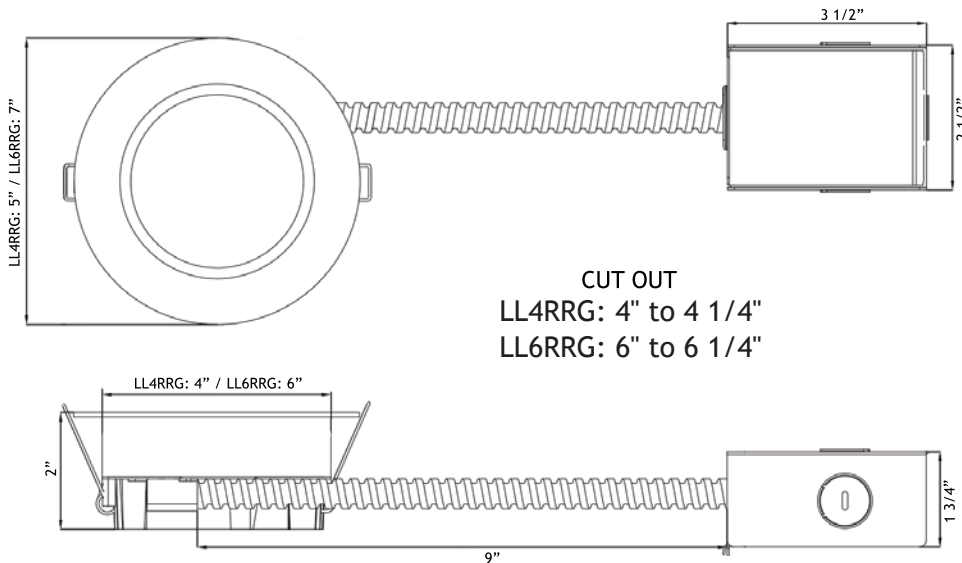

CUT OUT  
LL4RRG: 4" to 4 1/4"  
LL6RRG: 6" to 6 1/4"

### Available Trims:

White

Black



### ORDERING GUIDE

Example: LL4RRG - 27K - WH

Model:	Light Colour:	Trim Finish
LL4RRG	27K : 2700K	WH : White
LL6RRG	41K : 4100K	BK : Black

### ACCESSORIES



Rough-In Plates - cat # RIP4 / RIP6



Goof Rings - cat # GR4 / GR6



# LL4SRG / LL6SRG

4" and 6" Square Regressed LED - Open Plenum Rated

## Type IC, Air-Tight & Plenum Rated

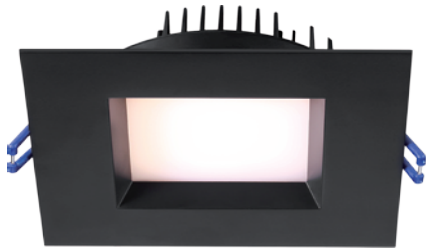

### DESCRIPTION

Regressed LED fixtures with integral LEDs and built-in driver.  
Commercial Grade Quality With Architectural Design.

### FEATURES & BENEFITS

- 2 1/4" Thin - Fits In Tight Ceiling Spaces
- CRI 93 - True Colour Rendering
- Type IC Rated - No Housing Required
- Open Plenum Rated - Suitable For Commercial Installations
- Fast & Easy To Install - Save On Labour
- Junction Box Included - No Additional Hardware Needed

### MOUNTING

Cut Hole In Ceiling And Snap Fixture In Opening With Spring Clips.  
2 1/4" Above Ceiling Clearance Required. Quick connectors Included.

SPECIFICATIONS		
Model	LL4SRG	LL6SRG
Applications	Recessed Ceiling Mount	
Energy Used (W)	14.5	18
Colour Temperature (K)	2700 / 4100	
Light Output (lm)	850 / 900	1000 / 1050
Halogen Equivalent (W)	75	100
Beam Angle	95°	
CRI	93	
Input Voltage	120V AC	
Power Factor	0.99	
Dimming	TRIAC Dimmers 5% - 100%	
Approved Location	Insulated Ceiling & Damp Location IP40	
Air Tight	Yes	
Ambient Temperature	-40°F (-40°C) to +104°F (+40°C)	
Projected Life	70% Light Output at 50,000 Hours	
Certification	cULus, Energy Star, T24	
Warranty	10 Year on Residential 5 Year on Commercial Applications	

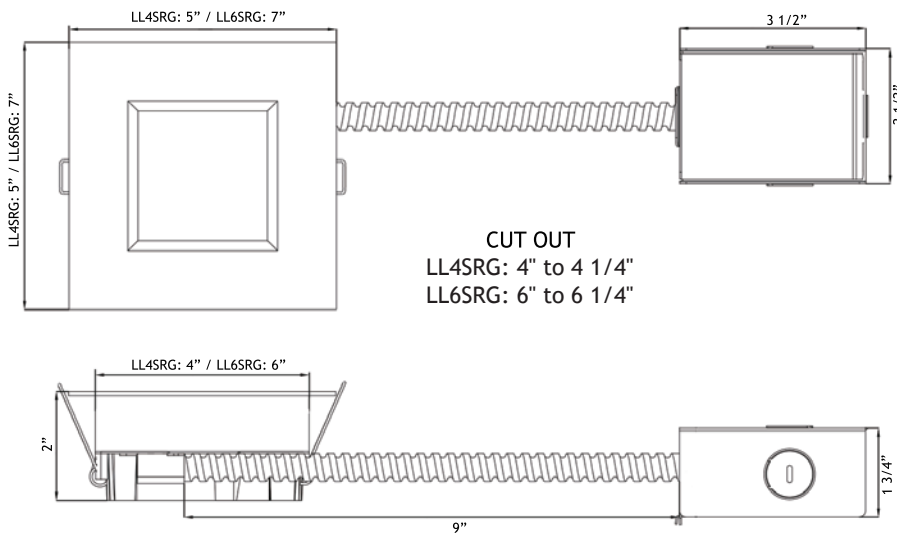

### Available Trims:

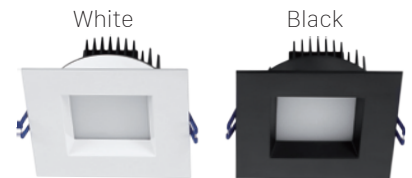

### ORDERING GUIDE

Model:	Light Colour:	Trim Finish:
LL4SRG	27K : 2700 K	WH : White
LL6SRG	41K : 4100 K	BK : Black

Example: LL4SRG - 27K - WH

### ACCESSORIES



Rough-In Plates - cat # RIP6

# LY4RCS / LY6RCS

4" and 6" Round Super Thin Recessed LED



## Type IC & Air-Tight



### DESCRIPTION

Recessed 4" and 6" Super Thin Round LED With Integral Driver In Connection Box.

Fits Where No Other Recessed Fixture Can.

### FEATURES & BENEFITS

1/2" Thin - Install Directly Under Joists, Maximum Layout Flexibility

Type IC Rated - No Housing Required

Fast & Easy To Install - Save On Labour

Driver Inside Connection Box - No Junction Box Needed

### MOUNTING

Cut Hole In Ceiling And Snap Fixture In Opening With Attached Spring Clips.

2" Above Ceiling Clearance Required When Driver Is Installed Next To Fixture.

SPECIFICATIONS		
Models	LY4RCS	LY6RCS
Applications	Recessed Ceiling Mount	
Energy Used(W)	9	12
Colour Temperature(K)	3000 / 4100	
Light Output(lm)	550 / 600	700 / 800
Halogen Equivalent(W)	50	65
Beam Angle	110°	
CRI	84	
Driver Input	120V AC or 277V-347V AC 50/60 Hz	
Power Factor	0.98	
Dimming	TRIAC Dimmers 10% - 100%	
Approved Location	Insulated Ceiling & Damp Location IP40	
Air Tight	Yes	
Ambient Temperature	-40°F (-40°C) to +104°F (+40°C)	
Projected Life	70% Light Output at 50,000 Hours	
Certification	cULus, Energy Star	
Warranty	10 Year on Residential 5 Year on Commercial Applications	

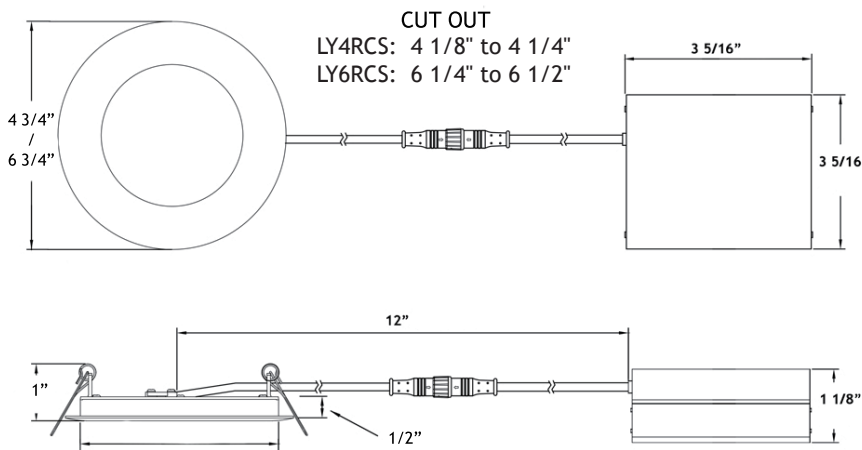

120V Input Driver Included



Order 277V - 347V Optional Driver Separately As cat # LLL-LD1535H

### Available Trims:



### ORDERING GUIDE

Example: LY4RCS / 30K / WH

Model:  
LY4RCS  
LY6RCS

Light Colour:  
30K: 3000K  
41K: 4100K

Trim Finish:  
WH : White  
BK : Black  
BN : Brushed Nickel

### ACCESSORIES



Low Voltage Extension Cables  
6ft - EXC6, 20ft - EXC20



Rough-In Plates - RIP4 / RIP6



Goof Ring White - GR4 / GR6



# LY41RCD / LY61RCD / LY82RCD

4", 6" and 8" Round Slim Recessed LED

## Type IC & Air-Tight



### DESCRIPTION

Recessed 4", 6" and 8" Slim Round LED With Integral Driver In Connection Box.

More Light and Wider Trim than the 1/2" models

### FEATURES & BENEFITS

Type IC Rated - No Housing Required

Fast & Easy To Install - Save On Labour

Driver Inside Connection Box - No Junction Box Needed

### MOUNTING

Cut Hole In Ceiling And Snap Fixture In Opening With Attached Spring Clips.

2" Above Ceiling Clearance Required For Driver.

### SPECIFICATIONS

Models	LY41RCD	LY61RCD	LY82RCD
Applications	Recessed Ceiling Mount		
Energy Used (W)	12	15	33
Colour Temperature (K)	3000 / 4100		
Light Output (lm)	700 / 800	900 / 950	2200 / 2400
Halogen Equivalent (W)	65	75	200
Beam Angle	110°		
CRI	84		
Driver Input	120V AC or 277V-347V		
Power Factor	0.98		
Dimming	TRIAC Dimmers 10% - 100%		
Approved Location	Insulated Ceiling & Damp Location IP40		
Air Tight	Yes		
Ambient Temperature	-40°F (-40°C) to +104°F (+40°C)		
Projected Life	70% Light Output at 50,000 Hours		
Certification	cULus, Energy Star, T24		
Warranty	10 Year on Residential 5 Year on Commercial Applications		

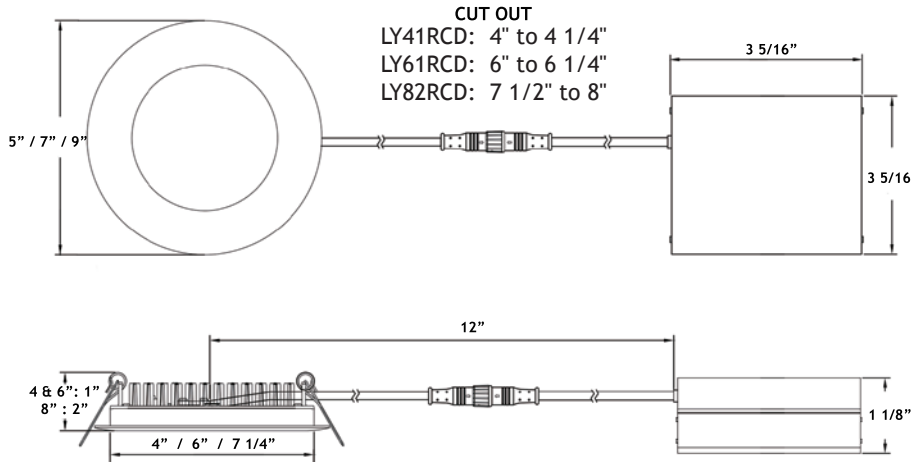

### 120V Input Driver Included



Optional 277-347V Input Driver  
 for model LY41RCD & LY61RCD - cat # LLL-LD1535H  
 for model LY82RCD - cat # LLL-LD3580H

### Available Trims:

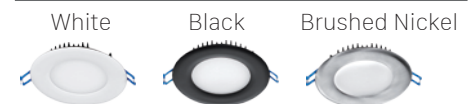

### ORDERING GUIDE



Example: LY41RCD / 30K / WH

Model:  
 LY41RCD  
 LY61RCD  
 LY82RCD  
 WH and BK Trim Only

Light Colour:  
 30K : 3000K  
 41K : 4100K

Trim Finish:  
 WH : White  
 BK : Black  
 BN : Brushed Nickel

### ACCESSORIES

-  Low Voltage Extension Cables  
6ft - cat # EXC6, 20ft - cat # EXC20
-  Rough-In Plates – RIP4 / RIP6 / RIP8
-  Goof Ring – GR4 / GR6 / GR8



# LY4S / LY6S

4" and 6" Square Slim Recessed LED



## Type IC & Air-Tight



### DESCRIPTION

Recessed Square LED With Integral Driver In Connection Box.  
Round back side for easy mounting and alignment.

### FEATURES & BENEFITS

- 1 3/8" Thin - Fits Where No Other Recessed Fixture Can.
- Type IC Rated - No Housing Required
- Fast & Easy To Install - Save On Labour
- Driver Inside Connection Box - No Junction Box Needed

### MOUNTING

Cut Hole In Ceiling And Snap Fixture In Opening With Attached Spring Clips.  
2" Above Ceiling Clearance Required For Driver.

### SPECIFICATIONS

Model	LY4S	LY6S
Applications	Recessed Ceiling Mount	
Energy Used (W)	11	14
Colour Temperature	3000 K / 4100 K	
Light Output (lm)	700 / 800	900 / 950
Halogen Equivalent (W)	65	75
Beam Angle	90°	
CRI	84	
Driver Input	120V AC or 277V-347V AC	
Power Factor	0.98	
Dimming	TRIAC Dimmers 10% - 100% (120V only)	
Approved Location	Insulated Ceiling & Damp Location IP40	
Air Tight	Yes	
Ambient Temperature	-40°F (-40°C) to +104°F (+40°C)	
Projected Life	70% Light Output at 50,000 Hours	
Certification	cULus, Energy Star	
Warranty	10 Year on Residential 5 Year on Commercial Applications	

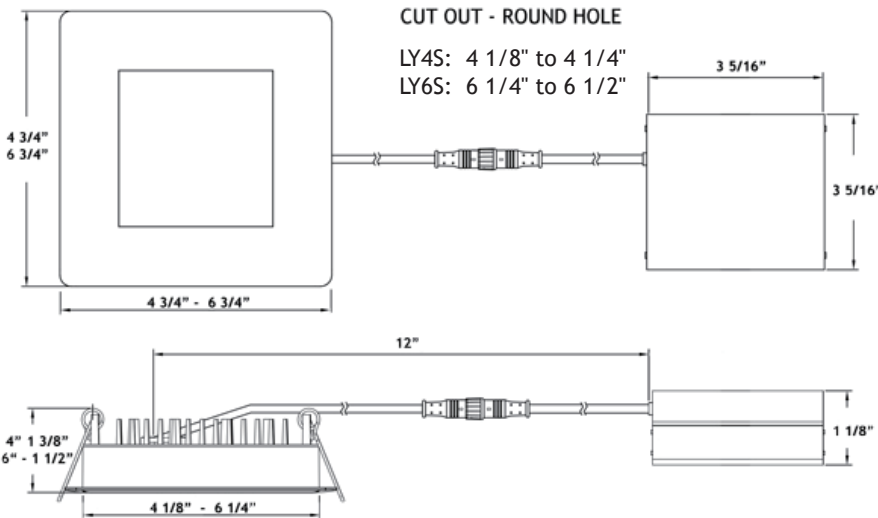

120V Input Driver Included



Order 277V - 347V Optional Driver Separately As cat # LLL-LD1535H

### Available Trims:

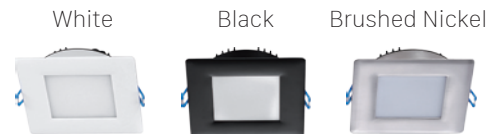

### ORDERING GUIDE

Example: LY4S / 30K / WH

Model:	Light Colour:	Trim Finish:
LY4S	30K: 3000K	WH : White
LY6S	41K: 4100K	BK : Black
WH and BK Trim Only		BN : Brushed Nickel

### ACCESSORIES



Low Voltage Extension Cables  
6ft - cat # EXC6, 20ft - cat # EXC20

Rough-In Plates - cat # RIP4 / RIP6



# LY41RCD-WET / LY61RCD-WET

4" and 6" WET Location Round Slim Recessed LED

## WET Location, Type IC & Air-Tight



### DESCRIPTION

Recessed 4" and 6" Slim Round LED With Integral Driver In Connection Box.

Fits Where No Other Recessed Fixture Can.

### FEATURES & BENEFITS

IP 44 Rated for Shower installations.

Type IC Rated - No Housing Required

Fast & Easy To Install - Save On Labour

Driver Inside Connection Box - No Junction Box Needed

### MOUNTING

Cut Hole In Ceiling And Snap Fixture In Opening With Attached Spring Clips.

2" Above Ceiling Clearance Required For Driver.

SPECIFICATIONS		
Models	LY41RCD-WET	LY61RCD-WET
Applications	Showers – Recessed Ceiling Mount	
Energy Used (W)	12	15
Colour Temperature (K)	3000 / 4100	
Light Output (lm)	700 / 800	900 / 950
Halogen Equivalent (W)	65	75
Beam Angle	110°	
CRI	84	
Driver Input	120V AC	
Power Factor	0.98	
Dimming	TRIAC Dimmers 10% - 100%	
Approved Location	Insulated Ceiling, Damp IP40 & Wet IP44	
Air Tight	Yes	
Ambient Temperature	-40°F (-40°C) to +104°F (+40°C)	
Projected Life	70% Light Output at 50,000 Hours	
Certification	cETLus, Energy Star, T24	
Warranty	10 Year on Residential 5 Year on Commercial Applications	

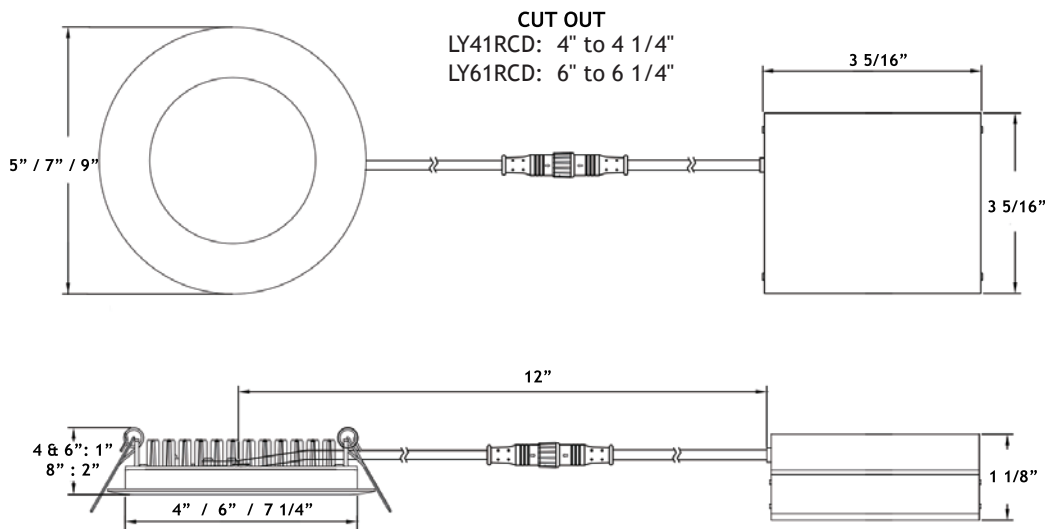

120V Input Driver Included



### ORDERING GUIDE

Example: LY41RCD / 30K / WH

### ACCESSORIES

Model:  
LY41RCD-WET  
LY61RCD-WET

Light Colour:  
30K: 3000K  
41K: 4100K

Trim Finish:  
WH : White

Special Features:  
WET Location



Low Voltage Extension Cables  
6ft - cat # EXC6, 20ft - cat # EXC20



Rough-In Plates – RIP4 / RIP6



Goof Ring White – GR4 / GR6

# LB4R / LB6R / LB8R



Economy Line 4", 6" and 8" Super Thin Recessed LED

## Type IC & Air-Tight



### DESCRIPTION

Recessed Super Thin Round LED With Integral Driver In Connection Box.

Fits Where No Other Recessed Fixture Can.

### FEATURES & BENEFITS

1/2" Thin - Install Directly Under Joists, Maximum Layout Flexibility

Type IC Rated - No Housing Required

Fast & Easy To Install - Save On Labour

Driver Inside Connection Box - No Junction Box Needed

### MOUNTING

Cut Hole In Ceiling And Snap Fixture In Opening With Attached Spring Clips.

2" Above Ceiling Clearance Required For Driver.

SPECIFICATIONS			
Models	LB4R	LB6R	LB8R
Applications	Recessed Ceiling Mount		
Energy Used (W)	11	14	18
Colour Temperature	3000K / 4100K		
Light Output (lm)	700 / 730	900 / 930	1200 / 1260
Halogen Equivalent (W)	65	75	120
Beam Angle	110°		
CRI	82		
Driver Input	120V AC 60 Hz		
Power Factor	0.98		
Dimming	TRIAC Dimmers 5% - 100%		
Approved Location	Insulated Ceiling & Damp Location IP40		
Air Tight	Yes		
Ambient Temperature	-40°F (-40°C) to +104°F (+40°C)		
Projected Life	70% Light Output at 36,000 Hours		
Certification	cULus, Energy Star		
Warranty	5 Year		

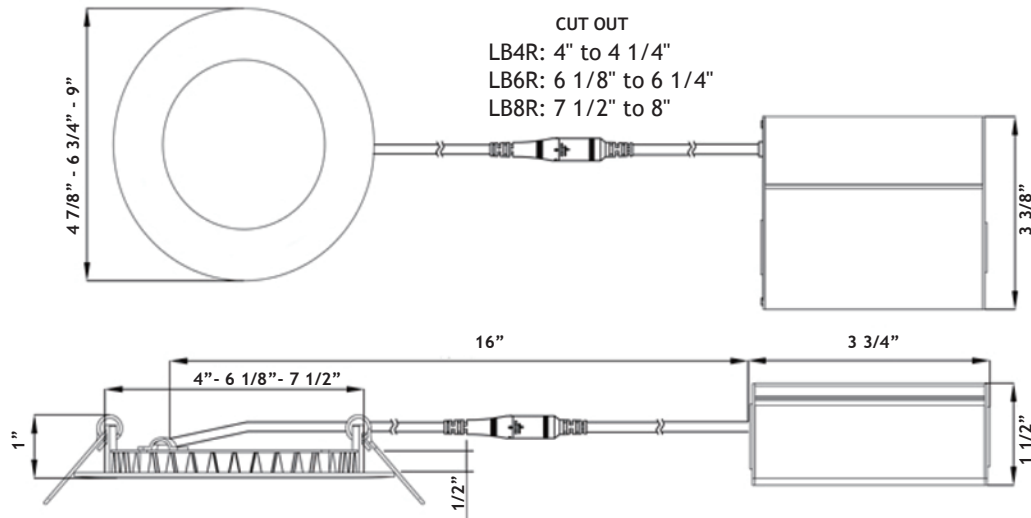

Driver Included With Every Fixture



### ORDERING GUIDE

Example: LB4R/30K/WH

Model: LB4R LB6R LB8R	Light Colour: 30K: 3000 K 41K: 4100 K	Trim Finish: WH: White
--------------------------------	---	---------------------------

### ACCESSORIES

- Low Voltage Extension Cable 10ft
- Rough-In Plates - New Construction
- Goof Ring White

### Cat #

- EXC10
- RIP4 / RIP6 / RIP8
- GR4 / GR6 / GR8



## Air-Tight & Wet Location



### DESCRIPTION

J-Box Mount LED fixtures with integral LEDs and built-in driver.  
Twist & Lock Cover.

### FEATURES & BENEFITS

1" Thin - Fits in 1 1/2" Deep J-Box  
CRI 93 - True Colour Rendering  
IP44 Wet Location Rated - Suitable For Showers & Soffits

### MOUNTING

Connect The Wires In The Previously Installed Junction Box.  
Quick Connectors Included.  
Screw The Fixture Into The J-Box.  
Push The Face Plate Against The Fixture By Placing The Hooks  
Into The Four Openings, Then Turn Clockwise To Tighten And  
Lock In Place.

SPECIFICATIONS	
Applications	J-Box Ceiling Mount
Energy Used (W)	11
Colour Temperature (K)	2700 / 4100
Light Output (lm)	620 / 650
Halogen Equivalent (W)	60
Available Trims	White, Black & Brushed Nickel
Beam Angle	110°
CRI	93
Input Voltage	120V AC
Power Factor	0.98
Dimming	TRIAC Dimmers 5% - 100%
Approved Location	Insulated Ceiling, Damp IP40 & Wet IP44
Air Tight	Yes
Ambient Temperature	-40°F (-40°C) to +104°F (+40°C)
Projected Life	70% Light Output at 50,000 Hours
Certification	cULus, Energy Star, T24
Warranty	10 Year on Residential 5 Year on Commercial Applications

### COVER

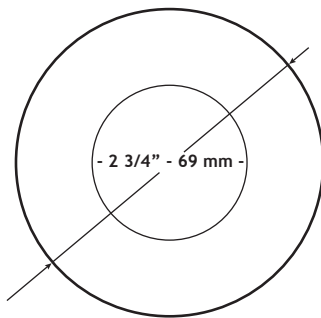

5 1/2" - 140mm

### FIXTURE

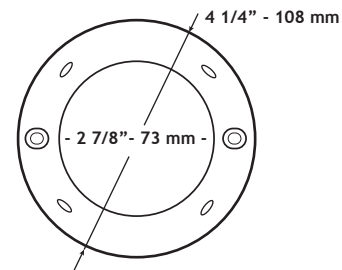
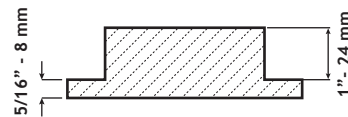

### ORDERING GUIDE

Example: LL4RBX - 27K - WH

Model:  
LL4RBX

Light Colour:  
27K: 2700K  
41K: 4100K



Trim Finish:  
WH : White  
BK : Black  
BN : Brushed Nickel

### Available Trims:













## Accessories for Lotus Recessed LED

Goof Rings	Goof Rings for Covering Wider Holes - from Metal and White Color Only	
	GR3	Goof Ring for 3" Models Outside Diameter 4 1/2"
	GR4	Goof Ring for 4" Models Outside Diameter 5 3/4"
	GR6	Goof Ring for 6" Models Outside Diameter 7 5/8"
	GR8	Goof Ring for 8" Models Outside Diameter 9 1/2"

Jumper Cables	Extension Cables Between the Drivers and the Fixtures - Interconnectable - Max Run 40 ft	
	EXC6	6 Feet Extension cable - for the Original models
	EXC20	20 Feet Extension cable - for the Original models
	EXC10	10 Feet Extension cable - for the Builder Grade models

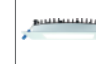
26" Long Plates	New Construction Rough-In Plates. Fit Both The Original and The Builder Grade Models	
	RIP3	Rough-in Plate for 3" Models
	RIP4	Rough-in Plate for 4" Models
	RIP6	Rough-in Plate for 6" Models
	RIP8	Rough-in Plate for 8" Models

277V-347V Drivers	277V-347V Input Driver Option - Not Dimmable. NOT SOLD SEPARATELY, ONLY INSTEAD OF 120V	
	LLL-LD0716H	Adder for 277V-347V Driver for 3" Gimbal Model
	LLL-LD1025H	Adder for 277V-347V Driver for 4" Gimbal Model
	LLL-LD1535H	Adder for 277V-347V - All 4" & 6" Models Except Builder Grade
	LLL-LD3580H	Adder for 277V -347V Driver for Model LY82RCD

<b>Lotus LED Lights – Condensed Specification Sheet – All Models</b>											
Gimbal Models			4" Recessed				6" Recessed				
2"	3"	4"	Round		Square		Round		Square		
LL2G	LL3G	LL4G	LY4RCS	LY41RCD	– WET	LY4S	LY6RCS	LY61RCD	– WET	LY6S	
											
Driver Input (Dimmable)		120 V AC									
Optional 277V (Not Dim)		N/A									
Driver type		External Class 2, Inside Connection Box. One driver per fixture required and included. Do not use any other drivers									
Energy Used (W)		5	7.5	11.4	9	12	11	12	15	14	
Power Factor		> 0.96									
Light Color Quality CRI		> 92			> 80						
Beam Angle		24°	38°		110°						
Light Output (Lumens)	Warm 2700K	380	580	960	N/A						
	Soft 3000K	400	600	1000	550	700		900			
	Neutral 4100K	430	630	1050	600	800		950			
Halogen Equivalent (W)		35	60	100	50	65		75			
Available trims		WH, BK, BN				WH	WH, BK, BN	WH, BN	WH	WH, BK	
Rated Life / Warranty		50,000 Hours / 10 Year Residential, 5 Year Commercial									
Certifications		cULus, Energy Star				cETLus	cULus, Energy Star		cETLus	cULus, Energy Star	
T24 Option Available		YES									
Type IC Rated		YES									
Open Plenum Rated		NO									
Max Fixtures/150W Dimmer		30	20	13	16	12	13	12	10		
Fixture IP grade		Damp Location IP40				Wet IP44	Damp Location IP40		Wet IP44	Damp Location IP40	
Ambient Temperature °F		-40°F to +104°F									
Dimensions	ID	2"	2 1/2"	4"	4 1/8"	4"	4 1/8"	6 1/4"	6"	6 1/4"	
	OD	2 1/2"	3 1/4"	5"	4 3/4"	5"	4 3/4" sq	6 3/4"	7"	6 3/4" sq	
Cut out		2" to	2 1/2" to	4" to	4 1/8" to	4" to	4 1/8" to	6 1/4" to	6" to	6 1/4" to	
round hole for all		2 1/8"	2 3/4"	4 1/4"	4 1/4"	4 1/4"	4 1/4"	6 1/2"	6 1/4"	6 1/2"	
Rough-in plate model		N/A	RIP3	RIP4			RIP6				
Goof Ring* model – OD		N/A	GR3 4 1/2"	GR4 – 5 3/4"			N/A	GR6 – 7 5/8"		N/A	
Fixture Thickness		1 1/2"	1 3/4"	2 1/4"	1/2"	1"	1 3/8"	1/2"	1"	1 1/2"	
Ceiling space for Fixture**		1"	1 1/2"	1 3/4"	NONE***	1/2"	7/8"	NONE***	1/2"	1"	
Ceiling space for Driver		5"	3 1/2"				1 1/2"				
Jumper Cables****		EXC6 / 6 feet & EXC20 / 20 feet									

\* Goof Rings available in White Only

\*\* Ceiling space needed if 1/2" drywall is used.









\*\*\* Can be installed directly under joists

\*\*\*\* Interconnectable. Maximum Extension Between Driver and Fixture - 40 feet.

The management system governing the manufacture of these products is ISO 9001:2000 and ISO 14001:2004 certified.

Lotus LED Lights tel. 1-844-24-LOTUS (1-844-245-6887), 6 am to 4 pm Pacific Time on Weekdays. e-mail: support@lotusledlights.com

**Lotus LED Lights – Condensed Specification Sheet – All Models**

8"	Builder Grade – Round Models			Regressed Models with Built-in Driver				J-Box Mount
Round	4"	6"	8"	4" Round	4" Square	6" Round	6" Square	4" Round
LY82RCD	LB4R	LB6R	LB8R	LL4RRG	LL4SRG	LL6RRG	LL6SRG	LL4RBX
								
120 V AC								
YES	N/A							
or connect multiple fixtures to one driver.				Built-In				
33	11	14	18	14.5	17	18	11	
> 0.96								
> 80				> 92				
110°				95°				110°
N/A				850	1000		620	
2200	700	900	1200	N/A				
2400	730	930	1260	900	1050		650	
200	65	75	120	75	100		60	
WH, BK	WH			WH, BK				WH, BK, BN
36,000 Hours / 5 Year				50,000 Hours / 10 Year Residential, 5 Year Commercial				
cULus, Energy Star								
NO				YES				
YES							N/A	
NO				YES				N/A
3	13	10	8	10	8		13	
Damp Location IP40								Wet IP44
-40°F to +104°F								
7 1/4"	4"	6 1/8"	7 1/2"	4"	4"	6"	6"	4 1/4"
9"	4 7/8"	6 3/4"	9"	5"	5" square	7"	7" square	5 1/2"
7 1/2" to	4" to	6 1/8" to	7 1/2" to	4" to	4" to	6" to	6" to	4" to
8"	4 1/4"	6 1/4"	8"	4 1/4"	4 1/4"	6 1/4"	6 1/4"	4 1/2"
RIP8	RIP4	RIP6	RIP8	RIP4		RIP6		N/A
GR8 9 1/2"	GR4 5 3/4"	GR6 7 5/8"	GR8 9 1/2"	GR4 5 3/4"	N/A	GR6 7 5/8"	N/A	N/A
1 3/4"	1/2"	1/2"	1/2"	2"		2 1/4"		1"
1 1/2"	NONE***			1 1/2"		1 3/4"		1 1/2" J-box
1 3/4"	2 1/2"	1 1/2"		N/A				
EXC10 / 10 feet				N/A				

# Lotus LED Lights is closer than you think!

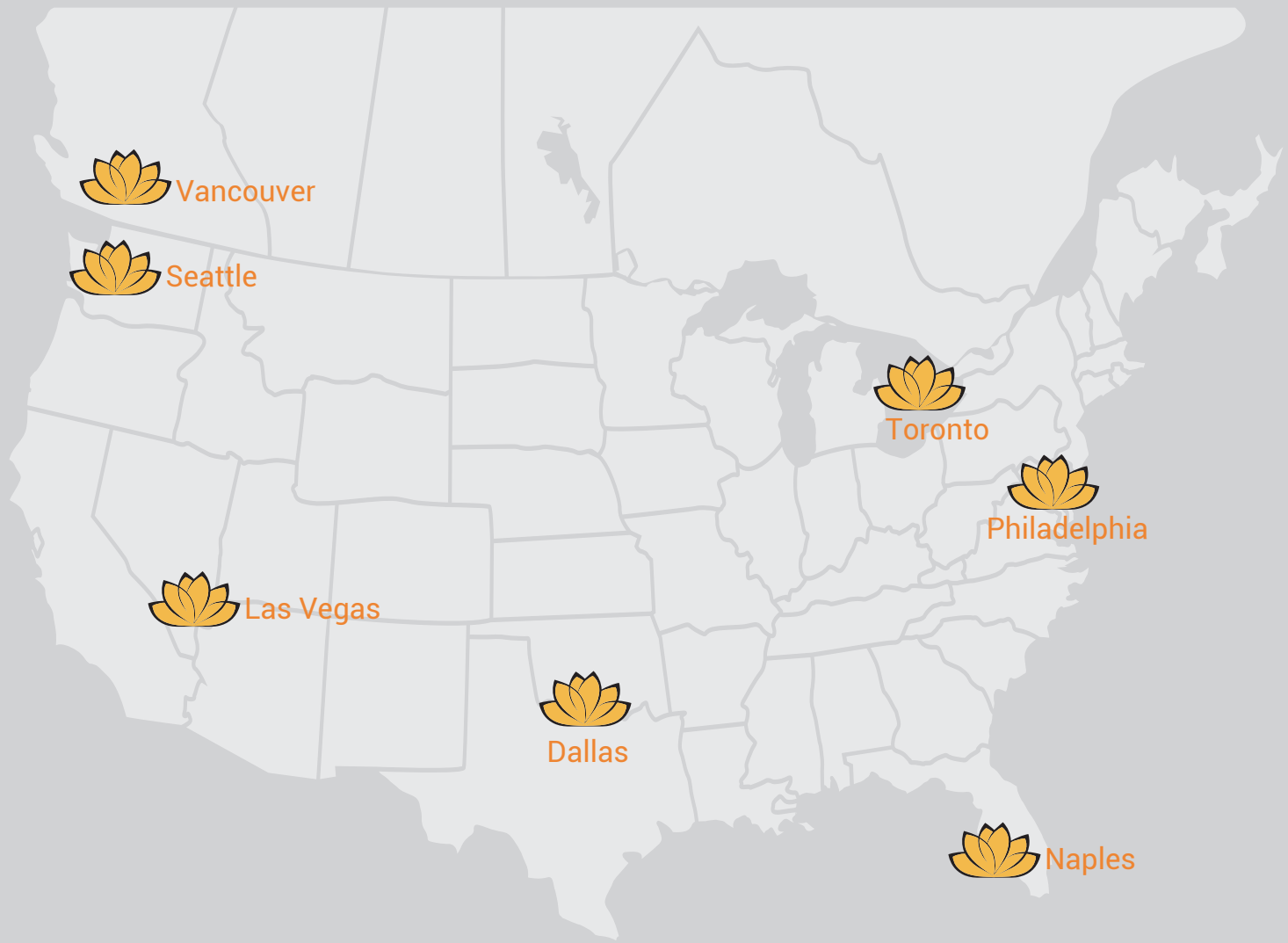

For any Technical Questions call Monday to Friday 9 am to 7 pm Eastern Time / 6 am to 4 pm Pacific Time:

Canada: 604-538-3090

USA: 360-200-5500

Toll Free: 1-844-24-LOTUS (1-844-245-6887)

Fax: 1-877-561-6306

---

**e-mail:**

Technical Support: [support@lotusledlights.com](mailto:support@lotusledlights.com)

Administration: [office@lotusledlights.com](mailto:office@lotusledlights.com)

Warranty: [warranty@lotusledlights.com](mailto:warranty@lotusledlights.com)

Orders: [orders@lotusledlights.com](mailto:orders@lotusledlights.com)

**Canada:**

Lotus LED Lights

800 — 15355 24th Ave, Box 200

Surrey, BC V4A 2H9, Canada

Warehouses: Vancouver BC, Toronto ON

**USA:**

Lotus LED Lights

250 H Street # 301

Blaine, WA 98230, USA

Warehouses: Seattle WA, Las Vegas NV,  
Dallas TX, Naples FL, Philadelphia PA