

Cable Connectors

Zinc die-cast.

For MCI-A • MC/HCF steel and aluminum cable • AC/HCF steel and aluminum cable • Flexible metal conduit steel and aluminum (regular and reduced wall) • MCI cable continuous corrugated aluminum • AC90 • TECK90.

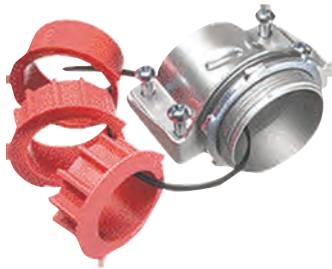

CATALOG NUMBER	UPC/DCI/NAED MFG #018997	TRADE SIZE	KO SIZE	UNIT PKG	STD PKG	DIM A	DIM B	DIM C
8412	08412	1	1	20	20	1.756	.541	2.144
8413	08413	1-1/4	1-1/4	20	20	2.156	.683	2.568
8414	08414	1-1/2	1-1/2	10	10	2.466	.790	3.086
8415	00583	2	2	10	10	2.899	.792	3.696
8416	08416	2-1/2	2-1/2	5	5	3.218	.906	4.250
8417	08417	3	3	5	5	3.281	.972	5.000

Refer to chart on page E-22 for a list of cable types.
Concrete tight when taped.

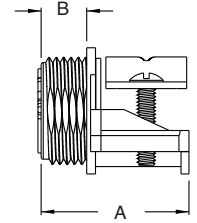
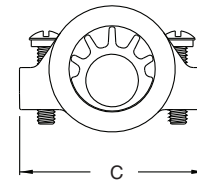

Catalog Number	Cable Outer Diameter		Wire Bundle Outer Diameter		Throat Diameter Fitting/Bushings (A,B,C)			Conductor Size # of Conductors* (AWG/KCMIL)	
	Min.	Max.	Min.	Max.	A	B	C		
8412	.780	1.120	.660	1.000	1.018	.625	.750	.870	6/3, 6/4, 4-3, 4-4, 2-3, 2-4, 1-3
8413	1.000	1.460	.870	1.370	1.361	.782	1.032	1.132	2-3, 2-4, 1-3, 1-4, 1/0-3, 1/0-4, 2/0-3, 2/0-4, 3/0-3
8414	1.360	1.770	1.250	1.590	1.587	1.175	1.277	1.382	2/0-4, 3/0-3, 3/0-4, 4/0-3, 4/0-4, 250-3, 250-4
8415	1.700	2.200	1.550	2.050	2.060	1.562	1.750	1.875	250-4, 300-4, 350-3, 350-4, 500-3
8416	2.100	2.700	1.950	2.400	2.462	1.979	2.194	-	500-3, 500-4, 600-3, 600-4, 750-3
8417	2.500	3.300	2.350	3.000	3.081	2.404	2.662	-	600-4, 750-3, 750-4

* Examples of 3- and 4-conductor cables. Cable dimensions vary dramatically between manufacturers. It is recommended that cable O.D. (outer diameter) be measured to ensure proper cable-to-fitting installation.

Each fitting has an end stop, but comes with additional end stop bushings to accommodate several cable sizes!

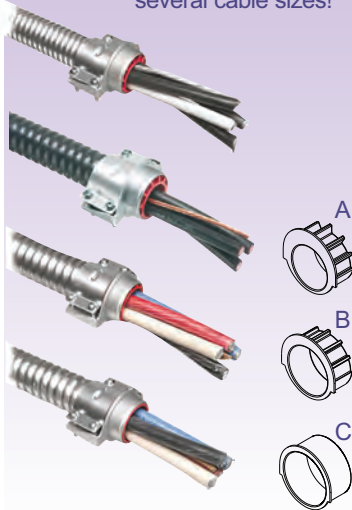

Features and Benefits

- Low cost – saves time and money!
- Fast and Easy to install. There's no need to remove the strap...just loosen the screws and insert the bushing that works best with the cables you're installing.
- Our zinc die-cast fittings cost much less than steel or malleable iron fittings
- Reduces inventory – comes with additional end stop bushings!
- Built-in end stop in fitting

Installation Instructions

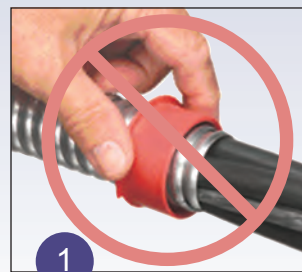

1
If you are using an end stop bushing, determine which one to use by sizing it to the cable bundle (not the metal jacket). **Incorrect size shown above.** The metal jacket should never go through the end stop.



2
Insert the appropriate end stop bushing, making sure that the half-moon shape is positioned at the top of the connector.

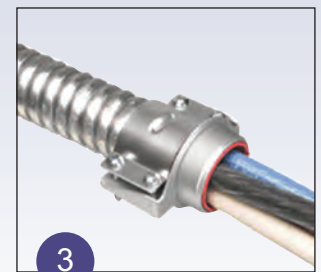

3
No need to remove strap – simply loosen the screws and insert end stop bushing, if necessary. Slip connector onto MC cable. Retighten screws on strap.



Squeeze Connectors

For Flex • AC • MCI cable.
Zinc die-cast.



L42



L421



L427

CATALOG NUMBER	UPC/DCI/NAED MFG #018997	TRADE SIZE	KO SIZE	UNIT PKG	STD PKG	DIM A	DIM B	DIM C	CABLE RANGE	END STOP DIAMETER
L42	34200	3/8	1/2	50	500	.937	.460	1.155	.530-.620	.400
L420*	34021	3/8	1/2	50	500	1.032	.460	1.155	.530-.620	.400 x .580
L421	34210	1/2	1/2	25	250	1.439	.420	1.420	.850-.910	.620
L422	34220	3/4	3/4	25	250	1.555	.440	1.570	1.100-1.135	.820
L423	34230	1	1	10	100	1.770	.560	1.860	1.255-1.375	.940
L424	34240	1-1/4	1-1/4	5	50	1.910	.630	2.240	1.550-1.610	1.240
L425	34250	1-1/2	1-1/2	5	50	2.125	.610	2.640	1.810-1.895	1.460
L426	34260	2	2	5	30	2.550	.690	3.155	2.260-2.485	1.935
L427	34270	2-1/2	2-1/2	5	5	2.890	.890	3.810	2.770-2.950	2.440
L428	34280	3	3	1	6	3.870	.985	4.320	3.170-3.560	2.980
L429	34290	3-1/2	3-1/2	1	6	4.265	1.000	4.860	3.630-4.155	3.478
L4210	34211	4	4	1	6	4.560	1.000	5.415	4.030-4.635	3.977

*L420 not listed for flexible metal conduit.
Refer to chart on page E-24 for a list of cable types.
Concrete tight when taped.
Refer to E-8 for new MC cable connectors with our largest cable ranges.



E60812 LR49636

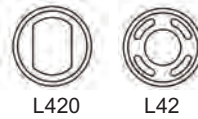

L420

L42

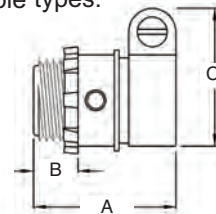

Sizes 3/8" - 2" are manufactured as shown above.

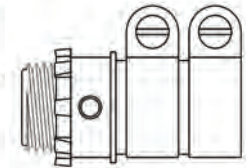

Sizes 2-1/2" - 4" are manufactured as shown above.

Squeeze Connectors with Insulated Throat

For Flex • AC • MCI cable.
Zinc die-cast.



CATALOG NUMBER	UPC/DCI/NAED MFG #018997	TRADE SIZE	KO SIZE	UNIT PKG	STD PKG	DIM A	DIM B	DIM C	CABLE RANGE	END STOP DIAMETER
L421A	34212	1/2	1/2	25	250	1.500	.451	1.420	.850-.910	.620
L422A	34213	3/4	3/4	25	250	1.586	.471	1.570	1.100-1.135	.820
L423A	34214	1	1	10	100	1.800	.591	1.860	1.255-1.375	.940
L424A	34215	1-1/4	1-1/4	5	50	1.972	.692	2.240	1.550-1.610	1.240
L425A	34216	1-1/2	1-1/2	5	50	2.187	.672	2.640	1.810-1.895	1.460
L426A	34217	2	2	5	30	2.612	.752	3.155	2.260-2.485	1.935
L427A	42700	2-1/2	2-1/2	5	5	2.983	.983	3.810	2.770-2.950	2.440
L42A8	42800	3	3	1	6	3.963	1.078	4.320	3.170-3.560	2.980
L429A	42900	3-1/2	3-1/2	1	6	4.358	1.093	4.860	3.630-4.155	3.478
L4210A	42100	4	4	1	6	4.653	1.093	5.415	4.030-4.635	3.977

Refer to chart on page E-24 for a list of cable types.
Concrete tight when taped.



E60812 LR49636

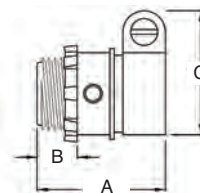

Sizes 3/8" - 2" are manufactured as shown above.

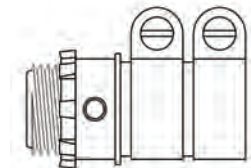

Sizes 2-1/2" - 4" are manufactured as shown above.

Duplex Connector

Zinc die-cast. Single screw for Flex • AC • MCI • MCI-A • NM cable.



CATALOG NUMBER	UPC/DCI/NAE MFG #018997	TRADE SIZE	KO SIZE	UNIT PKG	STD PKG	DIM A	DIM B	DIM C	DIM D	CABLE RANGE
846	00846	3/8	1/2	25	250	1.542	.437	.888	1.672	.150-.612

Refer to chart on page E-22 for a list of cable types.

Refer to chart on page E-25 for MCI-A cable ranges.

Concrete tight when taped.



E60812 LR49636

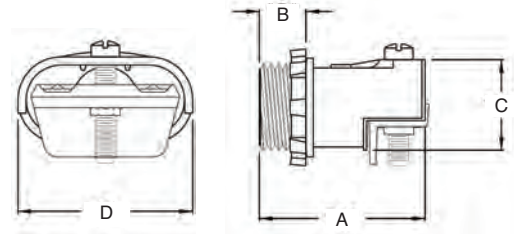

Duplex SNAP-TITE® Connectors

Zinc die-cast. Single screw for Flex • AC • MCI • MCI-A • NM cable.



CATALOG NUMBER	UPC/DCI/NAE MFG #018997	TRADE SIZE	KO SIZE	UNIT PKG	STD PKG	DIM A	DIM B	DIM C	DIM D	CABLE RANGE
846ST‡	80050	3/8	1/2	25	250	1.635	.510	.888	1.654	.150-.612
846AST*	80052	3/8	1/2	25	250	1.728	.603	.888	1.654	.150-.612

*Provided with insulated throat.

‡Also for MCI-A cable.

Refer to page E-27 for cable ranges.

Refer to chart on page E-24 for a list of cable types.

SNAP-TITE® products have been tested and listed by UL in accordance with UL's ground fault requirements. For additional information see page 6.

Concrete tight when taped.



E60812 LR49636

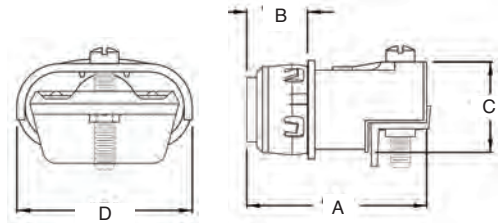

Duplex Connector

Twin screw with steel strap.
Zinc die-cast.
For Flex • NM • AC • MCI steel and aluminum jacketed cables.



CATALOG NUMBER	UPC/DCI/NAE MFG #018997	TRADE SIZE	KO SIZE	UNIT PKG	STD PKG	DIM A	DIM B	DIM C	DIM D	CABLE RANGE
846SS	80054	3/8	1/2	25	250	1.562	.437	.888	2.200	.210-.612

Refer to chart on page E-22 for a list of cable types.

Concrete tight when taped.



E60812 LR49636

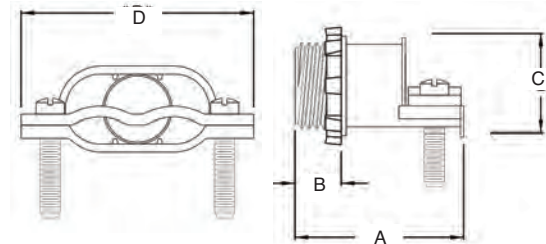



90° Duplex Connector

Zinc die-cast. Twin screw for Flex • NM • AC • MCI steel and aluminum jacketed cables • MCI-A cable.



CATALOG NUMBER	UPC/DCI/NAE MFG #018997	TRADE SIZE	KO SIZE	UNIT PKG	STD PKG	DIM A	DIM B	DIM C	DIM D	CABLE RANGE
84690	00090	3/8	1/2	10	100	1.087	1.707	1.965	.379	.512-.612

Refer to chart on page E-22 for a list of cable types.
Refer to chart on page E-25 for MCI-A cable ranges.
Concrete tight when taped.



E60812 LR49636

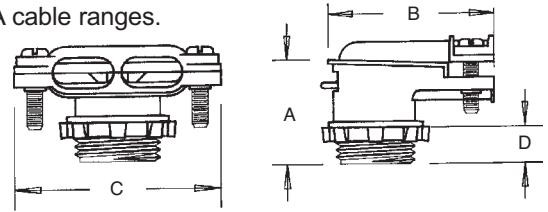

90° Duplex SNAP-TITE® Connector

Zinc die-cast. Twin screw for NM • Flex • AC • MCI steel and aluminum jacketed cables • MCI-A cable.



CATALOG NUMBER	UPC/DCI/NAE MFG #018997	TRADE SIZE	KO SIZE	UNIT PKG	STD PKG	DIM A	DIM B	DIM C	DIM D	CABLE RANGE
846ST	58230	3/8	1/2	10	100	1.087	1.707	1.965	.458	.512-.612

Refer to chart on page E-22 for a list of cable types.
Refer to chart on page E-25 for MCI-A cable ranges.
SNAP-TITE® products have been tested and listed by UL in accordance with UL's ground fault requirements. For additional information see page 6.
Concrete tight when taped.



E20643 LR49636

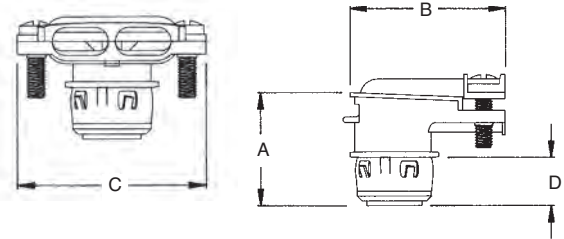

Set-Screw Connectors

For Flex • AC • MCI cable.
Zinc die-cast. Not for use with aluminum jacketed cables.



CATALOG NUMBER	UPC/DCI/NAE MFG #018997	TRADE SIZE	KO SIZE	UNIT PKG	STD PKG	DIM A	DIM B	DIM C	CABLE RANGE	END STOP DIAMETER
L48	34800	1/2	1/2	25	250	1.470	.450	1.260	.625-.915	.620
L49	34900	3/4	3/4	20	200	1.540	.450	1.500	.820-.910	.815

Refer to chart on page E-23 for a list of cable types.
Concrete tight when taped.



E60812 LR49636

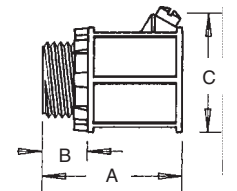

Duplex SADDLEGRIP® SNAP-TITE® Connectors

Zinc die-cast.
For aluminum and steel
Flex • AC • AC90 • MCI • MCI-A
cable.



CATALOG NUMBER	UPC/DCI/NAED MFG #018997	TRADE SIZE	KO SIZE	UNIT PKG	STD PKG	DIM A	DIM B	DIM C	CABLE RANGE
SG3838ST	80152	3/8	1/2	25	100	.455	1.610	.780	(2) .445-.612
SG3838AST*	36210	3/8	1/2	25	100	.605	1.560	.780	(2) .445-.612

*Provided with insulated throat.

With independent securing of the cables, you can use two different size cables.
SNAP-TITE® products have been tested and listed by UL in accordance with UL's ground fault requirements. For additional information see page 6.

Refer to chart on page E-23 for a list of cable types.

Refer to chart on page E-25 for MCI-A cable ranges.

Concrete tight when taped.

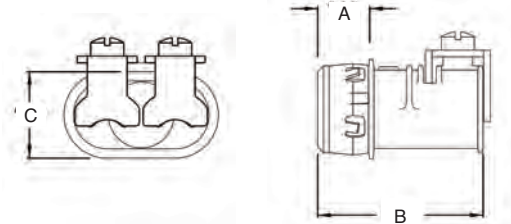

Duplex SADDLEGRIP® Connectors

Zinc die-cast.
For aluminum and steel
Flex • AC • AC90 • MCI • MCI-A
cable.



CATALOG NUMBER	UPC/DCI/NAED MFG #018997	TRADE SIZE	KO SIZE	UNIT PKG	STD PKG	DIM A	DIM B	DIM C	CABLE RANGE
SG3838	17383	3/8	1/2	25	100	.452	1.526	.780	(2) .445-.612
SG3838A*	36205	3/8	1/2	25	100	.512	1.586	.780	(2) .445-.612

*Provided with insulated throat.

Refer to chart on page E-23 for a list of cable types.

Refer to chart on page E-25 for MCI-A cable ranges.

Concrete tight when taped.

With independent securing of the cables, you can use two different size cables.

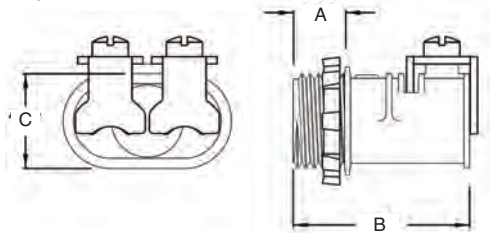

“Take All” Connectors

Single screw saddle type.
For NM • Flex • AC • AC90 • MCI
steel and aluminum jacketed
cables • ACG90 • Teck90.
Zinc die-cast.



L15A

CATALOG NUMBER	UPC/DCI/NAED MFG #018997	TRADE SIZE	KO SIZE	UNIT PKG	STD PKG	DIM A	DIM B	DIM C	CABLE RANGE	END STOP DIAMETER
L15A*	80040	3/8	1/2	50	500	.984	.420	1.032	.460 - .585	.340 x .430
L16†‡	80060	3/8	1/2	50	500	.923	.375	1.208	.405 - .650	.400 x .580
L160‡	02416	3/8	1/2	50	500	.954	.412	1.092	.370 - .690	.312
L17	34278	1/2	1/2	50	250	1.500	.462	1.416	.630 - .890	.620
L18	34282	3/4	3/4	25	125	1.400	.390	1.750	.820 - 1.040	.818
L19	34287	1	1	25	125	1.640	.443	2.048	1.100 - 1.400	1.030

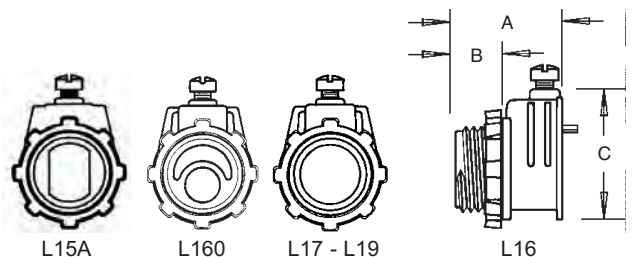

*Provided with insulated throat.

†Listed for flexible cord.

‡Also for MCI-A cable. Refer to page E-25 for cable ranges.

Refer to chart on page E-22 for a list of cable types.

Concrete tight when taped.



SADDLEGRIP® SNAP-TITE® Connectors

For aluminum and steel
Flex • AC • AC90 • MCI • MCI-A
cable. Zinc die-cast.



SG38AST



SG380AST

CATALOG NUMBER	UPC/DCI/NAED MFG #018997	TRADE SIZE	KO SIZE	UNIT PKG	STD PKG	DIM A	DIM B	DIM C	CABLE RANGE	END STOP DIAMETER
SG38AST*‡	80144	3/8	1/2	50	500	1.203	.555	1.077	.405-.612	.400
SG380AST*‡	80148	3/8	1/2	50	500	1.145	.555	1.077	.405-.612	.400 x .580
SG50ST‡	80150	1/2	1/2	50	500	1.458	.510	1.235	.710-.910	.620
SG50AST*‡	17501	1/2	1/2	50	500	1.145	.555	1.277	.710-.910	.620
SG75ST	18080	3/4	3/4	20	200	1.495	.510	1.570	.840-1.110	.820
SG75AST*	17755	3/4	3/4	20	200	1.540	.55	1.570	.840-1.110	.820

*Provided with insulated throat.

‡Also for MCI-A cable. Refer to page E-25 for cable ranges.

Refer to chart on page E-23 for a list of cable types.

For cables smaller than .405" see L16 and L16ST on page E-5.

SNAP-TITE® products have been tested and listed by UL in accordance with UL's ground fault requirements. For additional information see page 6.

Concrete tight when taped.

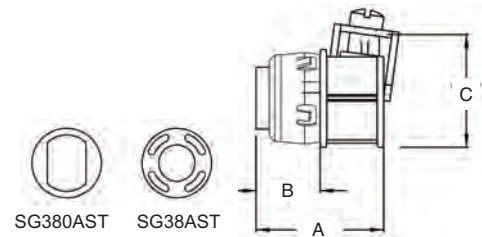

SADDLEGRIP® Connectors

For aluminum and steel
Flex • AC • AC90 • MCI • MCI-A
cable. Zinc die-cast.



CATALOG NUMBER	UPC/DCI/NAED MFG #018997	TRADE SIZE	KO SIZE	UNIT PKG	STD PKG	DIM A	DIM B	DIM C	CABLE RANGE	END STOP DIAMETER
SG38‡	18065	3/8	1/2	50	500	1.000	.400	1.077	.405-.612	.400
SG38A*‡	80138	3/8	1/2	50	500	1.090	.490	1.077	.405-.612	.400
SG380‡	18060	3/8	1/2	50	500	1.000	.400	1.077	.405-.612	.400 x .580
SG380A*‡	80140	3/8	1/2	50	500	1.090	.490	1.077	.405-.612	.400 x .580
SG40‡	01740	7/16	1/2	50	500	1.480	.480	1.125	.530-.790	.620
SG50‡	07500	1/2	1/2	50	500	1.480	.480	1.277	.710-.910	.620
SG50A*‡	37501	1/2	1/2	50	500	1.511	.511	1.277	.710-.910	.620
SG75	18075	3/4	3/4	20	200	1.435	.450	1.470	.840-1.110	.820
SG75A*	17751	3/4	3/4	20	200	1.466	.481	1.470	.840-1.110	.820

*Provided with insulated throat.

‡Also for MCI-A cable. Refer to page E-25 for cable ranges.

Refer to chart on page E-23 for a list of cable types.

Concrete tight when taped.

For cables smaller than .405" see L16 and L16ST on page E-5.

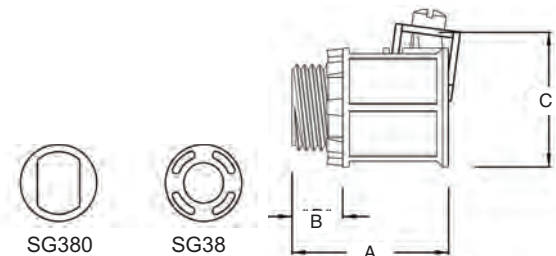

45° Connectors

Zinc die-cast.

For aluminum and steel
Flex • AC • MCI cable.



CATALOG NUMBER	UPC/DCI/NAED MFG #018997	TRADE SIZE	KO SIZE	UNIT PKG	STD PKG	DIM A	DIM B	DIM C	CABLE RANGE	END STOP DIAMETER
4501	04501	3/8	1/2	50	500	.382	1.132	1.588	.445-.612	.620
4502	04502	1/2	1/2	25	250	.382	1.150	1.775	.620-.895	.635

Refer to chart on page E-23 for a list of cable types.

Concrete tight when taped.



E60812 LR49636

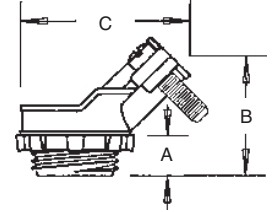

45° SNAP-TITE® Connectors

Zinc die-cast.

With spring steel clip.

For aluminum and steel
Flex • AC • MCI cable.



CATALOG NUMBER	UPC/DCI/NAED MFG #018997	TRADE SIZE	KO SIZE	UNIT PKG	STD PKG	DIM A	DIM B	DIM C	CABLE RANGE	END STOP DIAMETER
4501ST	06002	3/8	1/2	50	500	.382	1.132	1.588	.445-.612	.620
4502ST	06004	1/2	1/2	25	250	.382	1.150	1.775	.620-.895	.635

Refer to chart on page E-23 for a list of cable types.

SNAP-TITE® products have been tested and listed by UL in accordance with UL's ground fault requirements. For additional information see page 6.

Concrete tight when taped.



E60812 LR49636

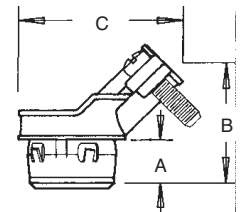

90° SNAP-TITE® Connectors

Zinc die-cast.

With spring steel clip.

For aluminum and steel
Flex • AC • AC90 • MCI cable.



CATALOG NUMBER	UPC/DCI/NAED MFG #018997	TRADE SIZE	KO SIZE	UNIT PKG	STD PKG	DIM A	DIM B	DIM C	CABLE RANGE
850ST	80154	3/8	1/2	50	500	1.540	.430	1.800	.440-.750
850AST*	80156	3/8	1/2	50	500	1.600	.490	1.775	.440-.750
851ST‡	80158	1/2	1/2	25	250	1.600	.430	2.140	.642-1.075
851AST*‡	80160	1/2	1/2	25	250	1.651	.490	2.145	.648-1.081

*Provided with insulated throat.

‡Also for MCI-A cable. Refer to page E-25 for cable ranges.

Refer to chart on page E-24 for a list of cable types.

SNAP-TITE® products have been tested and listed by UL in accordance with UL's ground fault requirements. For additional information see page 6.

Concrete tight when taped.



372D LR49636

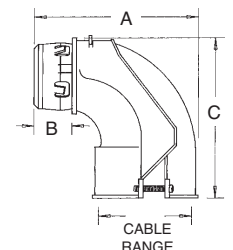



90° Connectors

Zinc die-cast.

For aluminum and steel
Flex • AC • AC90 • MCI • MCI-A
cable.



CATALOG NUMBER	UPC/DCI/NAED MFG #018997	TRADE SIZE	KO SIZE	UNIT PKG	STD PKG	DIM A	DIM B	DIM C	CABLE RANGE
85‡	00893	3/8	1/2	50	500	1.370	.340	1.800	.370-.510
85A*	12510	3/8	1/2	50	500	1.432	.400	1.800	.370-.510

*Provided with insulated throat.

‡Also for MCI-A cable. Refer to page E-25 for cable ranges.

Refer to chart on page E-24 for a list of cable types.

Concrete tight when taped.

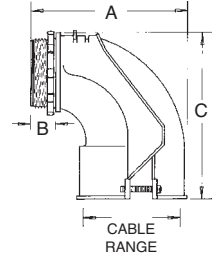

90° SNAP-TITE® Connectors

Zinc die-cast.

With spring steel clip.
For aluminum and steel
Flex • AC • AC90 • MCI • MCI-A
cable.



CATALOG NUMBER	UPC/DCI/NAED MFG #018997	TRADE SIZE	KO SIZE	UNIT PKG	STD PKG	DIM A	DIM B	DIM C	CABLE RANGE
85ST‡	00894	3/8	1/2	50	500	1.540	.430	1.800	.370-.510
85AST*	12511	3/8	1/2	50	500	1.600	.490	1.800	.370-.510

*Provided with insulated throat.

‡Also for MCI-A cable. Refer to page E-25 for cable ranges.

Refer to chart on page E-24 for a list of cable types.

SNAP-TITE® products have been tested and listed by UL in accordance with UL's ground fault requirements. For additional information see page 6.

Concrete tight when taped.

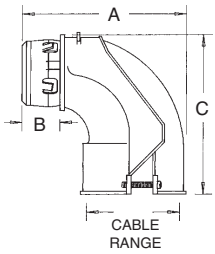

Screw-On Snap-In Connectors

Spring steel clip with non-metallic body. Screws onto 3/8" Flex.



CATALOG NUMBER	UPC/DCI/NAED MFG #018997	TRADE SIZE	KO SIZE	UNIT PKG	STD PKG	DIM A	DIM B
GFSC38	20737	3/8	1/2	50	500	1.005	.785
GFSC38B	20739	3/8	1/2	-	1000	1.005	.785

For flexible metal conduit only.

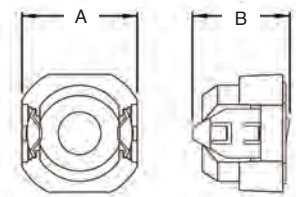

Snaps into KO with 50% less force!

90° Connectors

Zinc die-cast.

For aluminum and steel
Flex • AC • AC90 • MCI • MCI-A
cable.



CATALOG NUMBER	UPC/DCI/NAED MFG #018997	TRADE SIZE	KO SIZE	UNIT PKG	STD PKG	DIM A	DIM B	DIM C	CABLE RANGE
850‡	00850	3/8	1/2	50	500	1.370	.340	1.800	.440-.750
851‡	00851	1/2	1/2	25	250	1.780	.410	2.140	.635-1.085
852	00852	3/4	3/4	15	150	2.065	.500	2.346	.830-1.085
853	00853	1	1	10	50	2.560	.500	2.896	1.330-1.570
854	00854	1-1/4	1-1/4	5	25	2.812	.500	3.080	1.625-1.940
855	00855	1-1/2	1-1/2	1	10	4.875	.750	6.050	1.400-2.400
856	00856	2	2	1	10	4.875	.750	6.050	1.400-2.400
857†	00857	2-1/2	2-1/2	1	1	6.125	.875	7.187	2.600-3.100
858†	00858	3	3	1	1	6.700	1.031	7.875	3.100-3.640
859†	00859	3-1/2	3-1/2	1	1	7.500	1.031	9.400	3.380-4.220
8510†	08510	4	4	1	1	8.700	1.031	10.200	3.730-4.550

†Malleable.

‡Also for MCI-A cable. Refer to page E-25 for cable ranges.

Refer to chart on page E-24 for a list of cable types.

Concrete tight when taped.

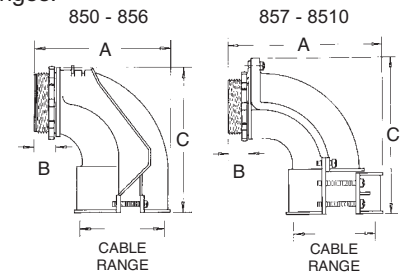

90° Connectors with Insulated Throat

Zinc die-cast.

For aluminum and steel
Flex • AC • AC90 • MC • MCI-A
cable.



CATALOG NUMBER	UPC/DCI/NAED MFG #018997	TRADE SIZE	KO SIZE	UNIT PKG	STD PKG	DIM A	DIM B	DIM C	CABLE RANGE
850A‡	85010	3/8	1/2	50	500	1.432	.400	1.800	.440-.750
851A‡	85110	1/2	1/2	25	250	1.510	.400	2.260	.635-1.085
852A	85210	3/4	3/4	15	150	2.096	.531	2.380	.830-1.085
853A	85310	1	1	10	50	2.622	.687	2.080	1.330-1.570
854A	85410	1-1/4	1-1/4	5	25	3.222	.687	3.080	1.625-1.940
855A	85510	1-1/2	1-1/2	1	10	4.968	.843	6.050	1.400-2.400
856A	85610	2	2	1	10	4.968	.843	6.050	1.400-2.400
857A†	08571	2-1/2	2-1/2	1	1	6.218	.968	7.187	2.600-3.100
858A†	08581	3	3	1	1	6.793	1.125	7.875	3.100-3.640
859A†	08591	3-1/2	3-1/2	1	1	8.810	1.125	9.400	3.380-4.220
8510A†	85101	4	4	1	1	8.793	1.125	10.200	3.730-4.550

†Malleable.

‡Also for MCI-A cable. Refer to page E-25 for cable ranges.

Refer to chart on page E-24 for a list of cable types.

Concrete tight when taped.

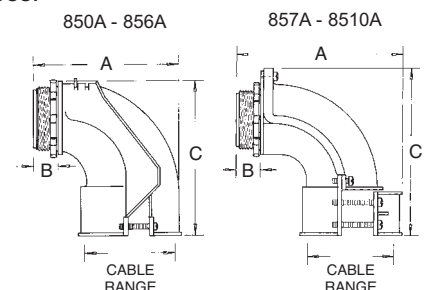



Screw-In Connectors

For flexible metal conduit.
Zinc die-cast.



CATALOG NUMBER	UPC/DCI/NAED MFG #018997	TRADE SIZE	KO SIZE	UNIT PKG	STD PKG	DIM A	DIM B	DIM C
GF38	76380	3/8	1/2	50	500	1.340	.470	1.140
GF50	76500	1/2	1/2	50	250	1.340	.710	1.140
GF75	76750	3/4	3/4	25	250	1.565	.930	1.390
GF100	76100	1	1	25	100	1.700	1.125	1.580
GF125	76125	1-1/4	1-1/4	10	40	2.120	1.410	2.115
GF150	76150	1-1/2	1-1/2	10	40	2.406	1.695	2.370
GF200	76200	2	2	5	20	2.570	2.190	2.890



E60812 LR49636

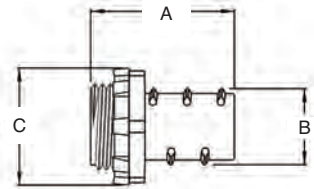

Screw-In Coupling

For flexible metal conduit.
Zinc die-cast.



CATALOG NUMBER	UPC/DCI/NAED MFG #018997	TRADE SIZE	UNIT PKG	STD PKG	DIM A	DIM B
GFC50	76350	1/2	25	250	2.200	1.160
GFC75	76375	3/4	25	250	2.200	2.200
GFC100	76340	1	10	100	2.312	1.406
GFC125	76360	1-1/4	10	100	3.125	2.125
GFC150	76370	1-1/2	5	50	3.186	2.375
GFC200	76372	2	3	30	4.125	2.937



E60812 LR49636

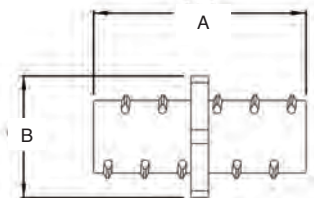

Screw-In Connectors with Insulated Throat

For flexible metal conduit.
Zinc die-cast.



CATALOG NUMBER	UPC/DCI/NAED MFG #018997	TRADE SIZE	KO SIZE	UNIT PKG	STD PKG	DIM A	DIM B	DIM C
GF38A	76381	3/8	1/2	50	500	1.371	.470	1.140
GF50A	76501	1/2	1/2	50	250	1.450	.710	1.140
GF75A	76751	3/4	3/4	25	250	1.596	.930	1.390
GF100A	76101	1	1	25	100	1.992	1.125	1.685
GF125A	76251	1-1/4	1-1/4	10	40	2.182	1.410	2.115
GF150A	76151	1-1/2	1-1/2	10	40	2.372	1.695	2.370
GF200A	76201	2	2	5	20	2.663	2.190	2.890



E60812 LR49636

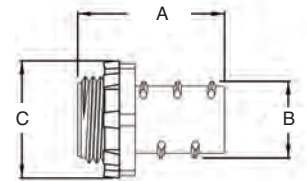

Screw-In SNAP-TITE® Connectors

With spring steel clip.
For flexible metal conduit.
Zinc die-cast.



CATALOG NUMBER	UPC/DCI/NAED MFG #018997	TRADE SIZE	KO SIZE	UNIT PKG	STD PKG	DIM A	DIM B	DIM C
GF38ST	80162	3/8	1/2	50	500	1.470	.475	1.055
GF50ST	80166	1/2	1/2	50	250	1.468	.720	1.055
GF75ST	80170	3/4	3/4	25	250	1.694	.940	1.350

SNAP-TITE® products have been tested and listed by UL in accordance with UL's ground fault requirements. For additional information see page 6.



E60812 LR49636

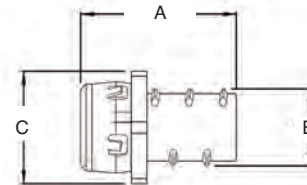

Screw-In SNAP-TITE® Connectors with Insulated Throat

With spring steel clip.
For flexible metal conduit.
Zinc die-cast.



CATALOG NUMBER	UPC/DCI/NAED MFG #018997	TRADE SIZE	KO SIZE	UNIT PKG	STD PKG	DIM A	DIM B	DIM C
GF38AST	80164	3/8	1/2	50	500	1.456	.480	1.045
GF50AST	80168	1/2	1/2	50	250	1.456	.727	1.045

SNAP-TITE® products have been tested and listed by UL in accordance with UL's ground fault requirements. For additional information see page 6.



E60812 LR49636

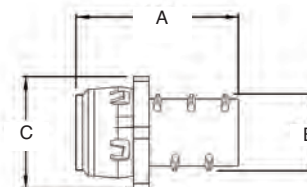



Combination Coupling

EMT set-screw to Flex.
Zinc die-cast.



CATALOG NUMBER	UPC/DCI/NAED MFG #018997	TRADE SIZE	KO SIZE	UNIT PKG	STD PKG	DIM A	DIM B	CABLE RANGE
860*	00860	1/2	3/8	50	500	1.280	1.140	.530-.620
861	00861	1/2	1/2	25	250	1.645	1.340	.850-.910
862	00862	3/4	3/4	25	100	1.975	1.535	1.100-1.130

*CSA only.



E60812 LR49636

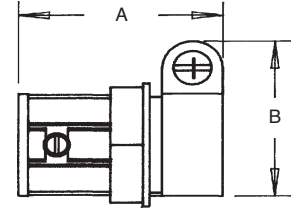

Combination Coupling

EMT set-screw to Flex.
Zinc die-cast.



CATALOG NUMBER	UPC/DCI/NAED MFG #018997	TRADE SIZE	KO SIZE	UNIT PKG	STD PKG	DIM A	DIM B	CABLE RANGE
8610	08610	1/2	1/2	50	500	1.736	1.242	.850-.910
8620	08620	3/4	3/4	25	100	1.934	1.242	1.100-1.135
8630	08630	1	1	10	40	2.285	1.700	1.255-1.375



E60812 LR49636

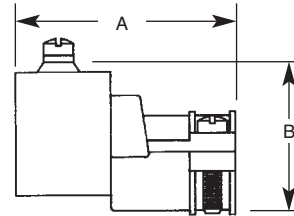

Combination Coupling

EMT compression to flexible metal conduit. Zinc die-cast.



CATALOG NUMBER	UPC/DCI/NAED MFG #018997	TRADE SIZE	KO SIZE	UNIT PKG	STD PKG	DIM A	DIM B	DIM C	DIM D
GF860	76860	1/2	3/8	25	100	1.535	.445	.725	1.060
GF861	76861	1/2	1/2	25	250	1.345	.715	.725	1.060
GF862	76862	3/4	3/4	25	250	1.700	.935	.935	1.305
GF863	80173	1	1	25	100	1.895	1.125	1.070	1.625



E60812 LR49636

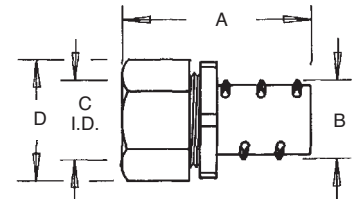

Flex • AC • MC

Anti-Short Bushings

Plastic.

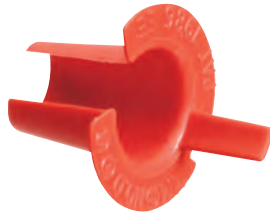

CATALOG NUMBER	UPC/DCI/NAED MFG #018997	TRADE SIZE	CABLE SIZES	STD PKG	DIM A	DIM B
AS0	10500	5/16"	14/2, 14/3, 12/2	100/BAG	.590	.680
AS1	10510	3/8"	14/4, 12/3, 6/1, 4/1	100/BAG	.630	.758
AS2	10520	7/16"	12/4, 10/2, 10/3, 2/1	50/BAG	.680	.920
AS3	10530	1/2"	10/4, 8/2, 8/3, 1/1	50/BAG	.770	1.130
AS4	10540	3/4"	8/4, 6/2, 6/3, 6/4, 4/2, 4/3	50/BAG	.880	1.340
AS5	06052	1"	3-1, 2-1, 2-1/10, 1-300MCM, 1-50MCM, 1-400MCM, 1-450MCM, 1-500MCM	25/BAG	1.038	1.460
AS6	06054	1-1/4"	4-1, 4-1/10, 4-2/0, 3-1/0, 3-2/0, 3-3/0, 2-2/0, 2-3/0, 2-4/0, 1-600MCM, 1-650MCM, 1-700MCM, 1-750MCM, 1-800MCM, 1-900MCM	10/BAG	1.100	1.720
AS7	06056	1-1/2"	4-3/0, 4-4/0, 3-4/0, 3-250MCM, 3-300MCM, 2-250MCM, 2-300MCM, 2-350MCM, 1-1000MCM	10/BAG	1.162	2.175
AS8	06058	2 TO 2-1/2"	4-250MCM, 4-300MCM, 4-350MCM, 4-400MCM, 4-450MCM, 4-500MCM, 3-350MCM, 3-400MCM, 3-450MCM, 3-500MCM, 2-400MCM, 2-450MCM, 2-500MCM	10/BAG	1.330	2.625

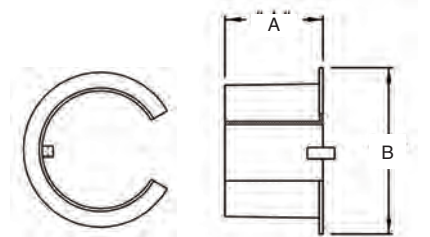

1-Hole AC/MC Strap

Plated steel.



310



311

CATALOG NUMBER	UPC/DCI/NAED MFG #018997	CABLE RANGE	CABLE SIZES	UNIT PKG	STD PKG	DIM A	DIM B	DIM C
310	00310	.503-.580	14/4, 14/3, 12/4, 12/3, 10/3, 10/2, 12/2	100	1000	1.285	.550	.750
311	84174	.200-.320	#4 and #2 bare copper	100	1000	1.125	.210	.500

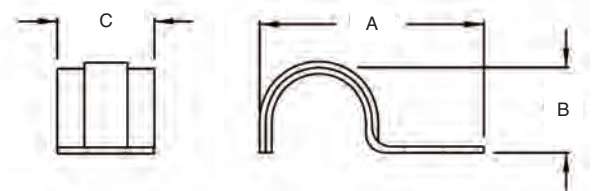



90° Connectors

For flexible metal conduit. Screw in type with sliding cover. Zinc die-cast.



CATALOG NUMBER	UPC/DCI/NAED MFG #018997	TRADE SIZE	KO SIZE	UNIT PKG	STD PKG	DIM A	DIM B
GF850	85000	1/2	1/2	25	100	1.975	1.820

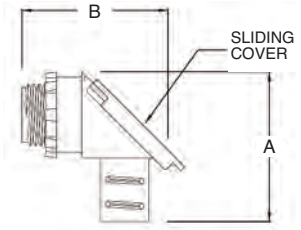

90° SNAP-TITE® Connectors

With spring steel clip. For flexible metal conduit. Screw-in type with sliding cover. Zinc die-cast.



CATALOG NUMBER	UPC/DCI/NAED MFG #018997	TRADE SIZE	KO SIZE	UNIT PKG	STD PKG	DIM A	DIM B
GF850ST	84850	1/2	1/2	25	100	1.969	1.969

SNAP-TITE® products have been tested and listed by UL in accordance with UL's ground fault requirements. For additional information see page 6.

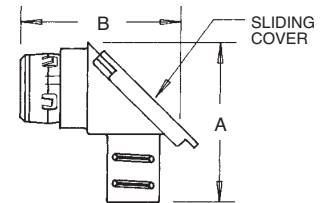

Stackable AC/MC/ Flex Cable Strap

Holds AC • MCI • Flex cable securely centered on wood or metal studs...14/2, 14/3, 14/4, 12/2, 12/3, 12/4, 10/2, 10/3.



Listed for support, not just positioning!

CATALOG NUMBER	UPC/DCI/NAED MFG #018997	UNIT PKG	STD PKG	DIM A	DIM B	DIM C	CABLE RANGE
NM310	54010	100	1000	1.345	1.224	.750	.420-.600



Screw to the stud, then add as many as you need!

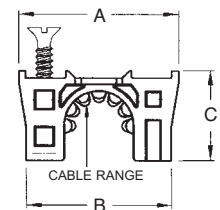

The easy to use 'Stackable' Cable Strap holds up to 5 runs of cable!

- Meets 2011 NEC Codes 320.30, 330.30, and 348.30
- Meets requirements of proposed UL standard 2239 for support of conduit and cable
- Includes screw for attaching to wood or metal studs
- Listed for use in environmental air handling spaces per 2011 NEC code requirement 300-22(c).



Cable Types and Ranges

Style	Part Number (ST = Snap-Tite®)	Knock-Out Size	ACG90	AC90	TECK90	Outer Armor Diameter Flex • A/C • M/C	Throat Diameter	Number of Cables	Insulated Throat	Flexible Metal Conduit (FMC)				Armored Cable (A/C)		Metal Clad Cable (M/C)		A/C M/C
										Steel	Aluminum	Reduced Wall Steel	Reduced Wall Aluminum	Steel	Aluminum	Steel	Aluminum Corrugated	
Straight SADDLEGRIP® Connectors	SG38	1/2		0.450 - 0.550		0.430 - 0.612	0.395	1		•	•	•	•	•	•	•	•	•
	SG38A	1/2		0.450 - 0.550		0.430 - 0.612	0.400	1	•	•	•	•	•	•	•	•	•	•
	SG38AST	1/2		0.450 - 0.550		0.430 - 0.612	0.400	1	•	•	•	•	•	•	•	•	•	•
	SG380	1/2				0.430 - 0.612	0.400 x 0.580	1		•	•	•	•	•	•	•	•	•
	SG380A	1/2				0.430 - 0.612	0.340 x 0.510	1	•	•	•	•	•	•	•	•	•	•
	SG380AST	1/2				0.430 - 0.612	0.340 x 0.510	1	•	•	•	•	•	•	•	•	•	•
	SG40	1/2				0.530 - 0.790	0.630	1		•	•	•	•	•	•	•	•	•
	SG50	1/2		0.850		0.710 - 0.910	0.630	1		•	•	•	•	•	•	•	•	•
	SG50A	1/2		0.850		0.710 - 0.910	0.560	1	•	•	•	•	•	•	•	•	•	•
	SG50ST	1/2		0.850		0.710 - 0.910	0.630	1		•	•	•	•	•	•	•	•	•
	SG50AST	1/2		0.850		0.710 - 0.910	0.560	1	•	•	•	•	•	•	•	•	•	•
	SG75	3/4		0.900 - 0.970		0.840 - 1.110	0.845	1		•	•	•	•	•	•	•	•	•
	SG75A	3/4		0.900 - 0.970		0.840 - 1.110	0.845	1	•	•	•	•	•	•	•	•	•	•
	SG75ST	3/4		0.900 - 0.970		0.840 - 1.110	0.845	1		•	•	•	•	•	•	•	•	•
SG75AST	3/4		0.900 - 0.970		0.840 - 1.110	0.765	1	•	•	•	•	•	•	•	•	•	•	
Duplex SADDLEGRIP® Connectors	SG3838	1/2		0.450 - 0.550		0.430 - 0.612	0.630	2		•	•	•	•	•	•	•	•	•
	SG3838A	1/2		0.450 - 0.550		0.430 - 0.612	0.620	2	•	•	•	•	•	•	•	•	•	•
	SG3838ST	1/2		0.450 - 0.550		0.430 - 0.612	0.620	2		•	•	•	•	•	•	•	•	•
	SG3838AST	1/2		0.450 - 0.550		0.430 - 0.612	0.620	2	•	•	•	•	•	•	•	•	•	•
Two Screw Clamp Type Connectors	4200	1/4				0.370 - 0.612	0.380	1		•	•	•	•	•	•	•	•	•
	4201	1/2				0.630 - 0.810	0.615	1		•	•	•	•	•	•	•	•	•
	4202	3/4				0.830 - 1.090	0.820	1		•	•	•	•	•	•	•	•	•
	4203	1				1.000 - 1.365	0.985	1		•	•	•	•	•	•	•	•	•
	4204	1-1/4				1.385 - 1.640	1.365	1		•	•	•	•	•	•	•	•	•
	4501	1/2				0.445 - 0.612	0.620	1		•	•	•	•	•	•	•	•	•
	4501ST	1/2				0.445 - 0.612	0.620	1		•	•	•	•	•	•	•	•	•
	4502	1/2				0.620 - 0.895	0.635	1		•	•	•	•	•	•	•	•	•
	4502ST	1/2				0.620 - 0.895	0.635	1		•	•	•	•	•	•	•	•	•
	840	1/2				0.370 - 0.612	0.400 x 0.580	1		•	•	•	•	•	•	•	•	•
	840ST	1/2				0.370 - 0.612	0.400 x 0.580	1		•	•	•	•	•	•	•	•	•
	8400	1/2				0.370 - 0.612	0.400	1		•	•	•	•	•	•	•	•	•
	8400ST	1/2				0.370 - 0.612	0.375	1		•	•	•	•	•	•	•	•	•
	8401	1/2				0.410 - 0.612	0.375	1		•	•	•	•	•	•	•	•	•
	8402	3/4				0.525 - 0.780	0.620	1		•	•	•	•	•	•	•	•	•
	8403	1				0.790 - 0.980	0.840	1										
	8404	1-1/4				1.050 - 1.345	1.030	1										
	8405	1-1/2				1.410 - 1.633	1.390	1										
8407	2				1.640 - 2.040	1.610	1											
84075	2				1.640 - 2.040	1.743	1											
8408	2-1/2				1.950 - 2.480	1.924	1											
8409	3				2.420 - 3.070	2.390	1											
8410	3-1/2				2.860 - 3.600	2.830	1											
Off Center Set Screw Type	845	1/2				0.445 - 0.630	0.400 x 0.580	1										
	845R	1/2				0.445 - 0.630	0.400 x 0.580	1										
	845ST	1/2				0.445 - 0.630	0.375	1		•	•	•	•	•	•	•	•	
Set Screw	L48	1/2				0.625 - 0.915	0.630	1		•	•	•	•	•	•	•	•	•
	L49	3/4				0.820 - 0.910	0.845	1		•	•	•	•	•	•	•	•	•

Flex • AC • MC



Cable Types and Ranges

Style	Part Number (ST = Snap-Tite®)	Knock-Out Size	ACG90	AC90	TECK90	Outer Armor Diameter Flex • A/C • M/C	Throat Diameter	Number of Cables	Insulated Throat	Flexible Metal Conduit (FMC)				Armored Cable (A/C)		Metal Clad Cable (M/C)		A/C M/C
										Steel	Aluminum	Reduced Wall Steel	Reduced Wall Aluminum	Steel	Aluminum	Steel	Aluminum Corrugated	
90° Two Screw Clamp Type Connectors	85	1/2				0.370 - 0.510	0.620	1										
	85A	1/2				0.370 - 0.510	0.620	1										
	85ST	1/2				0.370 - 0.510	0.560	1										
	85AST	1/2				0.370 - 0.510	0.560	1										
	850	1/2		0.480 - 0.650		0.440 - 0.750	0.620	1										
	850A	1/2		0.480 - 0.650		0.440 - 0.750	0.560	1										
	850ST	1/2		0.480 - 0.650		0.440 - 0.750	0.620	1										
	850AST	1/2		0.480 - 0.650		0.440 - 0.750	0.560	1										
	851	1/2		0.650 - 0.850		0.635 - 1.085	0.620	1										
	851A	1/2		0.650 - 0.850		0.635 - 1.085	0.560	1										
	851ST	1/2		0.650 - 0.850		0.635 - 1.085	0.620	1										
	851AST	1/2		0.650 - 0.850		0.635 - 1.085	0.560	1										
	852	3/4				0.830 - 1.380	0.825	1										
	852A	3/4				0.830 - 1.380	0.765	1										
	853	1				1.330 - 1.570	1.025	1										
	853A	1				1.330 - 1.570	0.974	1										
	854	1-1/4				1.625 - 1.940	1.375	1										
	854A	1-1/4				1.625 - 1.940	1.294	1										
	855	1-1/2				1.400 - 2.400	1.575	1										
	855A	1-1/2				1.400 - 2.400	1.532	1										
	856	2				1.400 - 2.400	2.030	1										
	856A	2				1.400 - 2.400	2.007	1										
	857	2-1/2				2.600 - 3.100	2.450	1										
	857A	2-1/2				2.600 - 3.100	2.425	1										
	858	3				3.100 - 3.640	3.140	1										
	858A	3				3.100 - 3.640	3.050	1										
859	3-1/2				3.380 - 4.220	3.540	1											
859A	3-1/2				3.380 - 4.220	3.960	1											
8510	4				3.730 - 3.730	3.540	1											
8510A	4				3.730 - 3.730	3.960	1											
Squeeze Connectors	L42	1/2				0.530 - 0.620	0.400	1										
	L420	1/2				0.530 - 0.620	0.400 x 0.580	1										
	L421	1/2				0.850 - 0.910	0.620	1										
	L421A	1/2				0.850 - 0.910	0.620	1										
	L422	3/4				1.100 - 1.135	0.820	1										
	L422A	3/4				1.100 - 1.135	0.820	1										
	L423	1				1.255 - 1.375	0.940	1										
	L423A	1				1.255 - 1.375	0.940	1										
	L424	1-1/4				1.550 - 1.610	1.240	1										
	L424A	1-1/4				1.550 - 1.610	1.240	1										
	L425	1-1/2				1.810 - 1.895	1.460	1										
	L425A	1-1/2				1.810 - 1.895	1.460	1										
	L426	2				2.260 - 2.485	1.935	1										
	L426A	2				2.260 - 2.485	1.935	1										
	L427	2-1/2				2.770 - 2.950	2.440	1										
	L427A	2-1/2				2.770 - 2.950	2.440	1										
	L428	3				3.170 - 3.560	2.980	1										
	L428A	3				3.170 - 3.560	2.980	1										
L429	3-1/2				3.630 - 4.155	3.478	11											
L429A	3-1/2				3.630 - 4.155	3.478	1											
L4210	4				4.030 - 4.635	3.977	1											
L4210A	4				4.030 - 4.635	3.977	1											

Flex • AC • MC



MCI-A Cable Ranges

Style	Part Number (ST = Snap-Tite®)	Knock-Out Size	Cable Range (Aluminum)	Cable Range (Steel)	End Stop Diameter	Number of Cables	Insulated Throat	Aluminum	Steel	Healthcare Facilities
Snap2IT® Connectors (Push-In Type)	38A	1/2	0.440 - 0.550			1	•	•		•
	38AST	1/2	0.440 - 0.550			1	•	•		•
	380AST	1/2	0.440 - 0.550			1	•	•		•
	3810AST	1/2	0.370 - 0.510		0.310	1	•	•		•
	3838AST	1/2	0.440 - 0.550			2	•	•		•
	383810AST	1/2	0.370 - 0.510		0.310	2	•	•		•
	40AST	1/2	0.440 - 0.550			1	•	•		•
	400AST	1/2	0.440 - 0.550			1	•	•		•
	4010AST	1/2	0.405 - 0.580		0.400	1	•	•		•
	4040AST	1/2	0.440 - 0.550			2	•	•		•
	404010AST	1/2	0.405 - 0.580		0.400	2	•	•		•
	5010AST	1/2	0.610 - 0.780		0.540	1	•	•		•
	505010AST	3/4	0.590 - 0.820		0.540	2	•	•		•
	7510AST	3/4	0.895 - 1.110		0.776	1	•	•		•
SG38	1/2	0.430 - 0.580		0.400	1		•		•	
SADDLEGRIP® Connectors (Straight and Duplex)	SG38A	1/2	0.430 - 0.580		0.400	1	•	•		•
	SG38AST	1/2	0.430 - 0.580		0.400	1	•	•		•
	SG380	1/2	0.430 - 0.580		0.400	1		•		•
	SG380A	1/2	0.430 - 0.580		0.400	1	•	•		•
	SG380AST	1/2	0.430 - 0.580		0.400	1	•	•		•
	SG3838	1/2	0.430 - 0.510			2		•		•
	SG3838A	1/2	0.430 - 0.510			2	•	•		•
	SG3838ST	1/2	0.430 - 0.510			2		•		•
	SG3838AST	1/2	0.430 - 0.510			2	•	•		•
	SG40	1/2	0.630 - 0.770		0.600	1		•		•
	SG50	1/2	0.680 - 0.850		0.620	1		•		•
	SG50A	1/2	0.680 - 0.850		0.620	1	•	•		•
	SG50ST	1/2	0.680 - 0.850		0.620	1		•		•
	SG50AST	1/2	0.680 - 0.850		0.620	1	•	•		•
Two Screw Clamp Type Connectors	840	1/2	0.440 - 0.520		0.400	1		•		•
	840ST	1/2	0.440 - 0.520		0.400	1		•		•
	8400	1/2	0.440 - 0.520		0.400	1		•		•
	8400ST	1/2	0.440 - 0.520		0.400	1		•		•
90° Two Screw Clamp Type Connectors	85	1/2	0.370 - 0.510			1		•		•
	85ST	1/2	0.370 - 0.510			1		•		•
	850	1/2	0.440 - 0.595			1		•		•
	850A	1/2	0.440 - 0.595			1	•	•		•
	850ST	1/2	0.440 - 0.595			1		•		•
	850AST	1/2	0.440 - 0.595			1	•	•		•
	851	1/2	0.680 - 0.770			1		•		•
	851A	1/2	0.680 - 0.770			1	•	•		•
	851ST	1/2	0.680 - 0.770			1		•		•
851AST	1/2	0.680 - 0.770			1	•	•		•	
Clamp Type Two Cable Connectors	846	1/2	0.370 - 0.580	0.370 - 0.580		2		•	•	•
	846A	1/2	0.370 - 0.580	0.370 - 0.580		2	•	•	•	•
	846ST	1/2	0.370 - 0.580	0.370 - 0.580		2		•	•	•
	846AST	1/2	0.370 - 0.580	0.370 - 0.580		2	•	•	•	•
	84690	1/2	0.370 - 0.580	0.370 - 0.580		2		•	•	•
	84690ST	1/2	0.370 - 0.580	0.370 - 0.580		2		•	•	•
Single Screw Clamp Type Connectors	L15AST	1/2	0.405 - 0.580	0.405 - 0.580		1	•	•	•	•
	L16	1/2	0.405 - 0.650	0.405 - 0.650	0.400	1		•	•	•
	L16ST	1/2	0.405 - 0.650	0.405 - 0.650	0.400	1		•	•	•
	L160	1/2	0.370 - 0.510	0.405 - 0.690	0.305	1		•	•	•
	L160ST	1/2	0.370 - 0.510	0.405 - 0.690	0.305	1		•	•	•



PVC Entrance Caps

For rigid • IMC • EMT • Rigid PVC. Sizes 1/2" - 4" include adapter sleeve for EMT. *New!*

CATALOG NUMBER	UPC/DCI/NAED MFG #018997	TRADE SIZE	MAST SIZE	STD PKG	DIM A	DIM B
PVC1020*	73146	1/2,3/4,1	1/2,3/4,1	20	3.575	3.438
PVC1040*	73147	1-1/4,1-1/2	1-1/4,1-1/2	10	5.900	5.069
PVC105	73105	2	2	5	7.790	6.660
PVC129	73129	2	2-1/2	1	7.750	6.660
PVC106	12512	2-1/2	2-1/2	1	9.790	7.620
PVC109*	12513	4	3, 3-1/2, 4	1	12.650	9.070

*Includes adapters for multiple sizes.

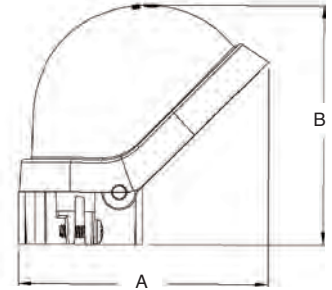

PVC1020



PVC1040

5 SKU'S REPLACE 10

Features and Benefits

- PVC1020 priced as 1/2" trade size
- PVC1040 priced as 1-1/4" trade size
- PVC109 priced as 3" trade size

Mast Parts



PVC105, PVC106, & PVC129



PVC109

For 3" conduit use both sleeves. For 3-1/2" conduit use the larger adapter sleeve.

Installation Shots



PVC1040



PVC1020

Scan For Video



Service Entrance Cable Caps

Zinc die-cast.

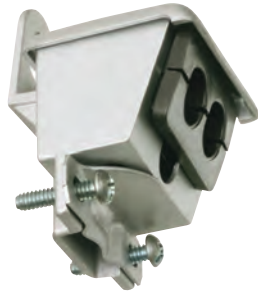

CATALOG NUMBER	UPC/DCI/NAED MFG #018997	WIRE SIZE	STD PKG	DIM A	DIM B	DIM C	HOLE SIZES
660	00660	7/8" Diam. Max.	50	2.060	2.970	2.260	(2).58
662	00662	1/0 to 4/0	10	3.180	4.520	3.600	(2).80



E66990

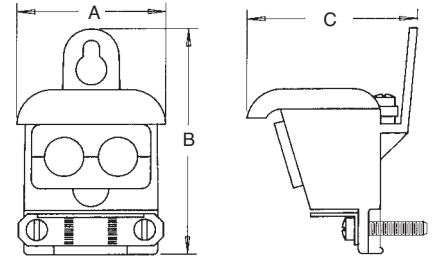

PVC Entrance Caps

With galvanized steel strap.



CATALOG NUMBER	UPC/DCI/NAED MFG #018997	WIRE SIZE	STD PKG	DIM A	DIM B	HOLE SIZES
PVC660	73660	(2) 3, 6, 4, 2	50	2.700	2.520	(2).53
PVC662	73662	(2) 1/0 to (2) 4/0	10	4.125	3.750	(2).69



E66990

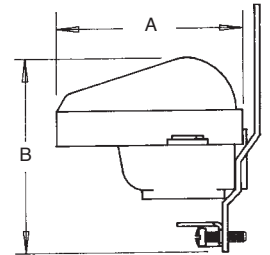

Mast Reducer Entrance Caps

Set-screw type.



CATALOG NUMBER	UPC/DCI/NAED MFG #018997	MAST SIZE	CAP SIZE	UNIT PKG	STD PKG	DIM A	DIM B	HOLE SIZES
128	00128	2	1-1/4	1	6	4.020	4.842	(2).43, (3).63
129	00129	2-1/2	2	1	6	5.236	6.506	(1).53, (2).75, (3)1.00



E105706

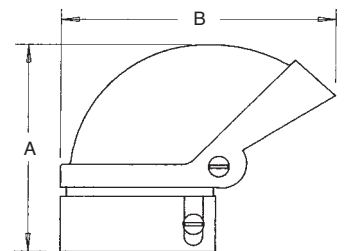



Service Entrance Hoods

Non-metallic.



CATALOG NUMBER	UPC/DCI/NAED MFG #018997	CABLE SIZES	STD PKG	DIM A	DIM B	DIM C
EH200	58201	(3) 1/0 to (3) 2/0	1	4.250	6.000	2.000
EH201	43630	(3) 1/0 to (3) 4/0	1	6.000	6.187	2.500

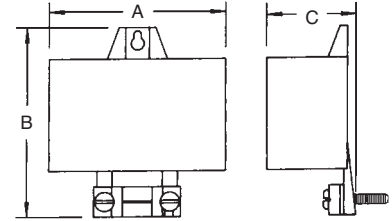

Entrance Caps Clamp-On Type

For rigid • IMC • EMT.



CATALOG NUMBER	UPC/DCI/NAED MFG #018997	TRADE SIZE	UNIT PKG	STD PKG	DIM A	DIM B	HOLE SIZES
140	00140	1/2	10	10	2.60	2.68	(4) .30
141	00141	3/4	10	10	2.72	3.80	(2) .38 (3) .40
142	00142	1	10	10	3.11	3.32	(2) .44 (3) .50
143	00143	1-1/4	5	25	3.20	4.46	(2) .42 (3) .63
144	00144	1-1/2	3	15	4.34	4.85	(2) .60 (3) .75
145	00145	2	10	10	4.55	6.62	(2) .75 (3) 1.00 (1) .53
146	00146	2-1/2	1	1	7.80	9.74	(2) 1.31 (3) .87 (1) .99
147	00147	3	1	1	8.00	10.50	(3) 1.73 (4) 1.10
148	00148	3-1/2	1	1	9.25	12.50	(3) 1.73 (4) 1.10
149	00149	4	1	1	9.25	12.50	(3) 1.73 (4) 1.10

See Page F-1 for PVC alternatives.



E105706 LR49636

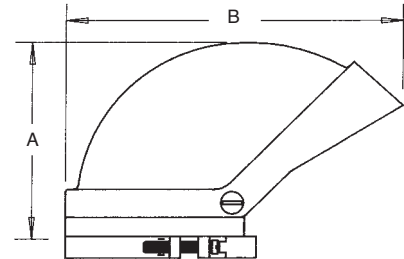

Mast Parts

Sill Plates

With screws and compound.
Cast aluminum.



CATALOG NUMBER	UPC/DCI/NAED MFG #018997	WIRE SIZE	STD PKG	DIM A	DIM B	DIM C	DIM D
663	00663	(3) #4 to (3) #2	10	.875	1.200	2.750	2.965
664	00664	(3) 3/0 to (3) 4/0	10	2.475	1.850	6.250	3.725

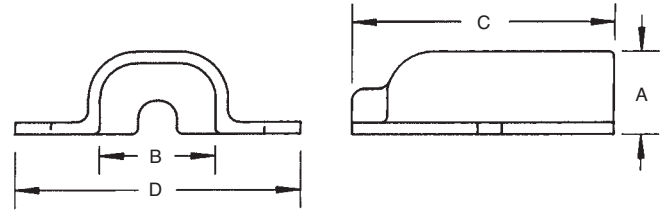

Sill Plates with Duct Seal and Wood Screws

Zinc die-cast. For EMT • SEU cable.



CATALOG NUMBER	UPC/DCI/NAED MFG #018997	WIRE SIZE	STD PKG	DIM A	DIM B	DIM C	DIM D
SP360	17360	1/2 EMT & 3/4 EMT	10	.812	2.593	2.421	.218
SP362	17361	1 EMT & 3/3 SEU	10	1.250	3.000	2.500	.218
SP363	17362	1-1/4 EMT & 2/3 SEU	10	1.650	3.812	2.625	.218
SP364	17363	1-1/2 EMT & 4/0 SEU	10	1.750	3.562	3.750	.281
SP365	17364	2 EMT	10	2.312	4.093	4.125	.281

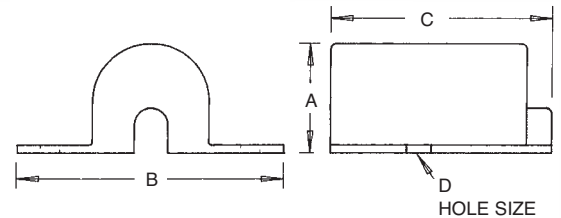

PVC Sill Plates

With screws and compound.



CATALOG NUMBER	UPC/DCI/NAED MFG #018997	WIRE SIZE	UNIT PKG	STD PKG	DIM A	DIM B	DIM C	DIM D
PVC85	00085	(3) #4 TO (3) #0	10	100	1.188	1.093	3.093	2.970

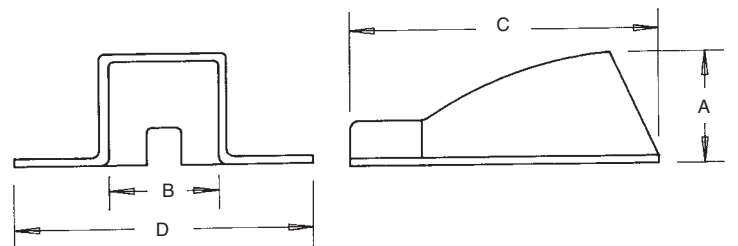



Porcelain Wire Holder

With solid rivet through head. Porcelain and galvanized steel.



612



613



616



617

CATALOG NUMBER	UPC/DCI/NAED MFG #018997	SCREW SIZE	STD PKG	DIM A	DIM B	DIM C
612	00612	2-1/4	5	4.750	2.750	2.250
613	00613	3/8 x 1/2 Match Screw	5	3.350	2.750	2.250
616	00616	2-1/4 Lag	5	5.615	3.200	1.750
617	00617	3/8 x 1/2 Match Screw	5	3.775	3.200	1.750

UL/CSA NOT APPLICABLE

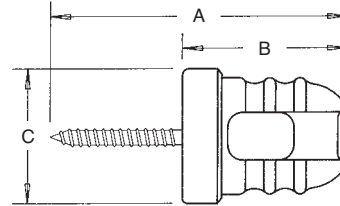

612

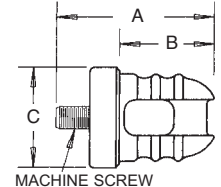

613

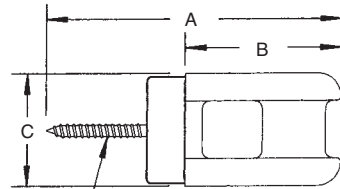

LAG SCREW

616

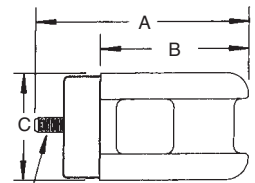

MACHINE SCREW

617

Mast Parts

Porcelain Wire Holder

With steel clip. Fits 1-1/4" to 3" pipe.



CATALOG NUMBER	UPC/DCI/NAED MFG #018997	WIRE SIZE	STD PKG	DIM A	DIM B	MIN	MAX
610	00610	1-1/4 to 3	5	1.875	7.625	1.620	3.930

UL/CSA NOT APPLICABLE

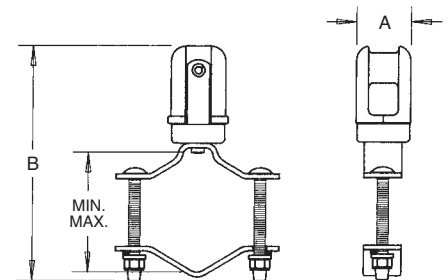

Porcelain Wire Holder

With hanger. Fits 2" rigid or 2" EMT.



CATALOG NUMBER	UPC/DCI/NAED MFG #018997	CONDUIT SIZE	STD PKG	DIM A	DIM B	DIM C
645	00645	2	5	7.062	2.450	1.750

UL/CSA NOT APPLICABLE

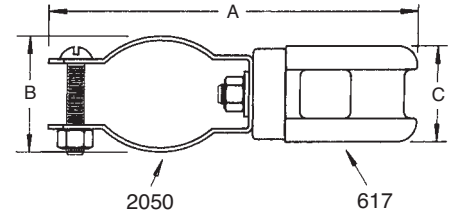

Channel Bar

11" long galvanized.



CATALOG NUMBER	UPC/DCI/NAED MFG #018997	DESCRIPTION	STD PKG	DIM A	DIM B	DIM C
611	00611	For two or three 617's or 613's	5	11.000	.525	1.750

UL/CSA NOT APPLICABLE

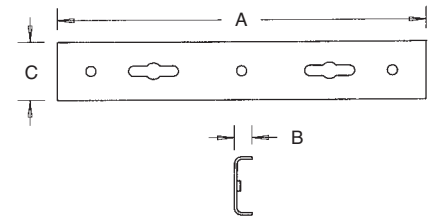

Universal Pipe Support

10" bolt.



CATALOG NUMBER	UPC/DCI/NAED MFG #018997	MAST SIZE	STD PKG
615	00615	1-1/4 to 3	5

UL/CSA NOT APPLICABLE

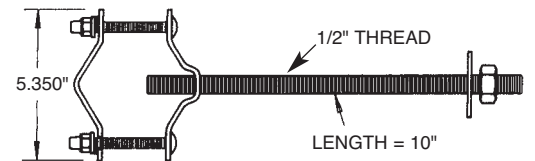

Universal Pipe Support

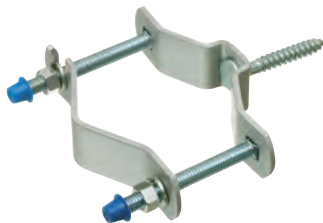

CATALOG NUMBER	UPC/DCI/NAED MFG #018997	MAST SIZE	STD PKG
620	00620	1-1/4 to 3	5

UL/CSA NOT APPLICABLE

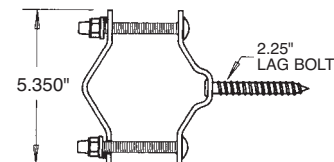



Universal Pipe Support

10" bolt. Sand cast aluminum with steel screw.



CATALOG NUMBER	UPC/DCI/NAED MFG #018997	MAST SIZE	STD PKG
2350	02350	2	5
2850	28550	2-1/2	5

UL/CSA NOT APPLICABLE

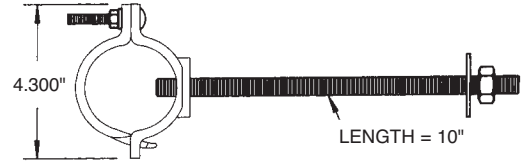

Roof Flashing

Galvanized steel with neoprene seal. 10-3/4" x 14-1/2" x 22 gauge.

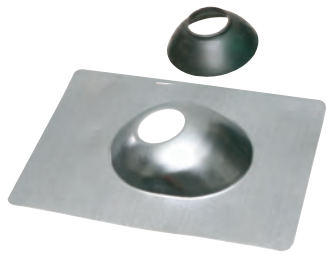

CATALOG NUMBER	UPC/DCI/NAED MFG #018997	TRADE SIZE	STD PKG	DIM A	DIM B
624	00624	1-1/4 to 1-1/2	10	10.750	12.500
625	00625	2	10	10.750	14.500
626	00626	2-1/2	10	10.750	14.500

UL/CSA NOT APPLICABLE

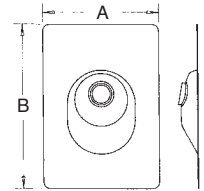

Roof Flashing

All neoprene. Black, one-piece design.



CATALOG NUMBER	UPC/DCI/NAED MFG #018997	TRADE SIZE	STD PKG	DIM A	DIM B
634	00634	1-1/4 to 1-1/2	12	9.000	11.500
635	00635	2	12	9.000	11.500
636	00636	2-1/2	12	9.000	11.500
637	00637	3	12	10.000	13.500
639	00639	4	12	11.500	14.000

UL/CSA NOT APPLICABLE

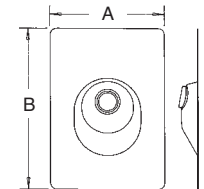

Mast Parts

Roof Flashing

Cast aluminum. Includes set-screw(s) to secure pipe and compound.



723



726

CATALOG NUMBER	UPC/DCI/NAED MFG #018997	TRADE SIZE	STD PKG	DIM A	DIM B
723	00723	1-1/4	10	7.250	9.500
724	00724	1-1/2	10	9.000	11.000
725	00725	2	5	9.000	11.000
726	00726	1-1/4 to 2	10	7.750	15.000

UL/CSA NOT APPLICABLE

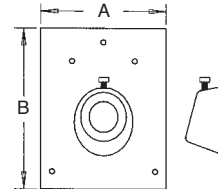

723

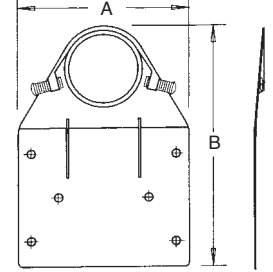

726

Mast Kits

Service entrance mast kits provide an assortment of S.E. mast components for installing overhead service drops in residential or commercial buildings using conduit.



MK200WH

CATALOG NUMBER	UPC/DCI/NAED MFG #018997	TRADE SIZE	STD PKG	ENTRANCE CAP	ROOF FLASHING	WIRE HOLDER	STRAP S	LAG BOLTS	BOTTOM REDUCER	AMPERE SERVICE
MK200	42200	2	1	145	625	-	(2) 345	(2) 3/8 X 3	650	125-150-200
MK200WH	42205	2	1	145	625	645	(2) 355	-	-	125-150-200
MK200ASF	42210	2	1	145	625	-	(2) 345	(2) 3/8 X 3	-	125-150-200
MK200PS	32044	2	1	145	625	(1) 610, (1) 620	-	-	-	125-150-200
MK250ASF	42250	2-1/2	1	129	625	-	(2) 346	(2) 1/2 X 4	651	125-150-200
MK250ASFX	42255	2-1/2	1	129	625	(2) 615, (1) 610	-	-	-	125-150-200
MK250A	32027	2-1/2	1	129	625	-	(2) 356	-	-	125-150-200



Intersystem Grounding Bridges

Available in zinc or bronze. Provides reliable intersystem bonding between power and communication grounding systems. Comes with textured, paintable, white cover. Cover is UV rated plastic for long outdoor life.

CATALOG NUMBER	UPC/DCI/NAED MFG #018997	MATERIAL	UNIT	STD PKG	DIM A	DIM B	DIM C	DIM D	DIM E	DIM F
GB5	76095	Zinc	1	10	3.383	1.409	.872	4.398	1.836	1.497
GBB5	76096	Bronze	1	10	3.383	1.409	.872	4.398	1.836	1.497
GBB50	09726	Bronze	1	10	3.383	1.409	.872	4.398	1.836	1.497



E75814 LR49636

Features and Benefits

- Meets 2011 NEC Ground Requirements
- GB5 has four termination points one more than required by 250.94 of the 2011 NEC
- Available in Zinc and Bronze
- Handles multiple hookups of communications systems – such as a phone, cable TV, or satellite dish
- Fast, simple installation on grounding conductor
- Plastic cover is textured and paintable for good looks

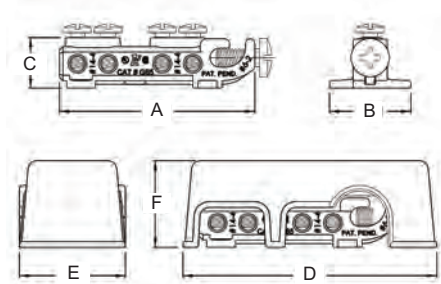

Cable Range

- Four termination points for #4-#14 (solid or stranded)
- Attaches to conductor with “Lay in” style lug with cable range of #6-#2
- GBB50 has larger cable range of #6-#1/0



GB5



GBB5

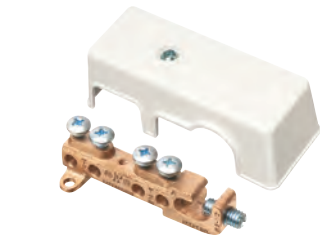

GBB50

Installation Instructions



1 Attach bridge to substrate. (Mounting screws not provided.)



2 Insert grounding electrode conductor into the lay in lug. Tighten screw.

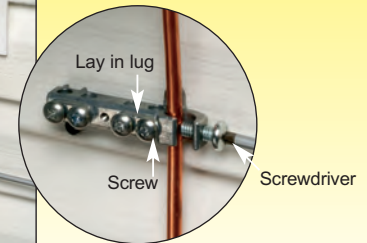

3 Finish by attaching the cover. Good looks, a great finish.



Grounding

Scan For Video



Intersystem Grounding Bridges with PVC Adapter

Available in zinc or bronze. Provides reliable intersystem bonding between power and communication grounding systems. Comes with a PVC adapter for 1/2" PVC pipe. Cover is UV rated plastic for long outdoor life.

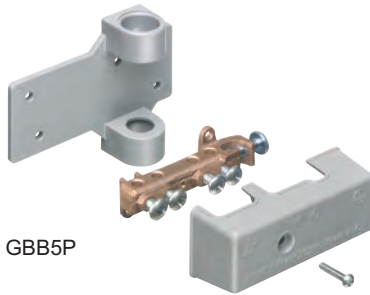

GBB5P

Features and Benefits

- Meets 2011 NEC Ground Requirements
- GB5P has four termination points – one more than required by 250.94 of the 2011 NEC
- Available in Zinc and Bronze
- Handles multiple hookups of communications systems – for instance phone, cable TV, or a satellite dish
- Fast, simple installation on grounding conductor
- Plastic cover is textured and paintable for good looks

CATALOG NUMBER	UPC/DCI/NAED MFG #018997	MATERIAL	UNIT PKG	STD PKG	DIM A	DIM B	DIM C	DIM D	DIM E	DIM F
GB5P	09720	Zinc	1	10	3.383	1.409	.872	1.653	4.575	3.461
GBB5P	09721	Bronze	1	10	3.383	1.409	.872	1.653	4.575	3.461
GBB50P	09726	Bronze	1	10	3.383	1.409	.872	1.653	4.575	3.461

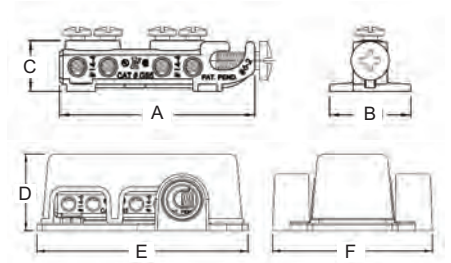

Cable Range

- Four termination points for #4-#14 (solid or stranded)
- Attaches to conductor with "Lay in" style lug with cable range of #6-#2
- GBB50P has larger cable range of #6-#1/0

Installation Instructions



1 Mount conduit adapter plate in desired location using three screws (not provided)



2 Insert grounding electrode conductor into the lay in lug. Tighten screw.

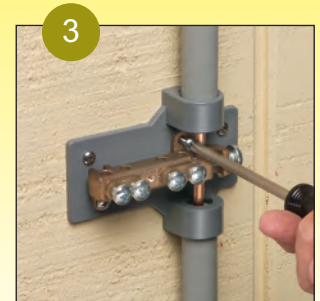

3 Insert grounding electrode conductor into the lay in lug. Tighten screw.



4 Finish by attaching the cover. Good looks, a great finish.

Scan For Video





Insulated Metal Grounding Bushings

Threaded. With dual rated CU-AL C-clamp grounding lug. Zinc die-cast. 150° C rated.



CATALOG NUMBER	UPC/DCI/NAED MFG #018997	TRADE SIZE	GROUND MIN	WIRE MAX	UNIT PKG	STD PKG	DIM A	DIM B	THREADS INCH
450	00450	1/2	14	4	25	100	1.896	.475	14
451	00451	3/4	14	4	25	100	2.082	.520	14
452	00452	1	14	4	25	100	2.364	.575	11-1/2
453	00453	1-1/4	14	4	20	80	2.702	.635	11-1/2
453100	01453	1-1/4	14	1/0	20	20	2.702	.635	11-1/2
454	00454	1-1/2	14	2	20	80	3.120	.760	11-1/2
454100	01454	1-1/2	14	1/0	20	20	3.120	.760	11-1/2
455	00455	2	14	2	10	50	3.650	.755	11-1/2
455100	01455	2	14	1/0	10	10	3.650	.755	11-1/2
456	00456	2-1/2	14	2/0	5	20	4.705	.960	8
456250	01456	2-1/2	6	250MCM	10	10	4.705	.960	8
457	00457	3	14	2/0	5	20	5.275	.920	8
457250	01457	3	6	250MCM	10	10	5.275	.920	8
458	00458	3-1/2	14	2/0	5	20	6.266	.930	8
458250	01458	3-1/2	6	250MCM	5	5	6.266	.930	8
459	00459	4	14	2/0	5	20	6.268	.950	8
459250	01459	4	6	250MCM	5	5	6.268	.950	8
4591	04591	5	8	2/0	5	5	7.050	.990	8
4591250	45912	5	2	250MCM	5	5	7.050	.990	8
4592	04592	6	8	2/0	5	5	8.125	.975	8
4592250	45922	6	2	250MCM	5	5	8.125	.975	8



E75814 LR49636

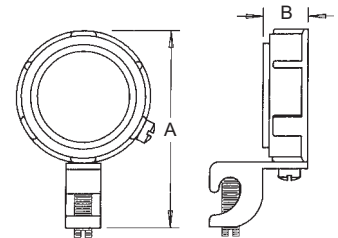

Grounding

Ground Rod Clamps

Conductor range 8 solid - 2 stranded. Approved for direct burial. Solid brass alloy with bronze screw.



CATALOG NUMBER	UPC/DCI/NAED MFG #018997	ROD SIZE	UNIT PKG	STD PKG	DIM A	DIM B
780	00780	1/2	25	25	1.250	.875
781	00781	5/8	25	100	1.275	.593
782	00782	3/4	25	25	1.445	1.030



E75814 LR49636

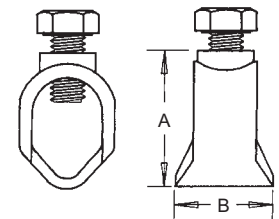

Grounding Locknuts

For rigid conduit. Zinc die-cast.



CATALOG NUMBER	UPC/DCI/NAED MFG #018997	TRADE SIZE	STD PKG	DIM A	DIM B
GL50	77050	1/2	50	.220	1.250
GL75	77075	3/4	25	.255	1.450
GL100	77100	1	50	.255	1.720
GL125	77125	1-1/4	50	.255	2.020
GL150	77150	1-1/2	50	.250	2.535
GL200	77200	2	25	.250	2.950
GL250	77250	2-1/2	10	.280	3.530
GL300	77300	3	10	.295	4.330
GL350	77350	3-1/2	5	.300	4.490
GL400	77400	4	5	.300	5.395



GROUNDING SCREW

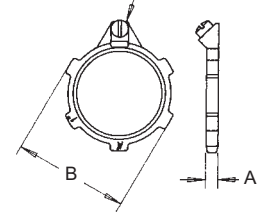

Ground Clamp

With solid brass hubs.
For rigid conduit.



CATALOG NUMBER	UPC/DCI/NAED MFG #018997	PIPE SIZE	HUB SIZE	UNIT PKG	STD PKG	DIM A	MIN	MAX
730B	73020	1/2 to 1	1/2"	5	50	2.250	.550	1.795

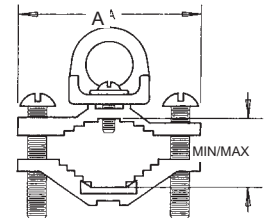

Bare Wire Ground Clamp

Zinc die-cast.
Brass color plated.

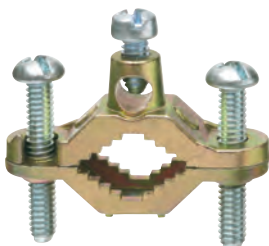

CATALOG NUMBER	UPC/DCI/NAED MFG #018997	PIPE SIZE	WIRE RANGE	UNIT PKG	STD PKG	DIM A	DIM B	MIN	MAX
720S	72010	1/2 to 1	8-2	25	250	2.225	.310	.550	1.575

Note: Zinc grounding and bonding products with color plated brass are not UL or CSA listed.

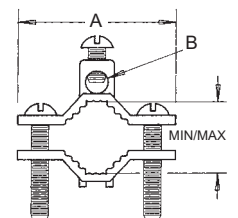



Bare Wire Ground Clamp

Zinc die-cast.

CATALOG NUMBER	UPC/DCI/NAED MFG #018997	PIPE SIZE	WIRE RANGE	UNIT PKG	STD PKG	DIM A	DIM B	MIN	MAX
720Z	72080	1/2 to 1	8-2	25	250	2.225	.550	.545	1.575



E75814 LR49636

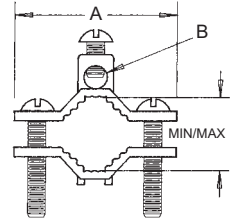

Bare Wire Ground Clamps

Solid brass with steel screws.

CATALOG NUMBER	UPC/DCI/NAED MFG #018997	PIPE SIZE	WIRE RANGE	UNIT PKG	STD PKG	DIM A	DIM B	MIN	MAX
720B	72020	1/2 to 1	10-2	25	250	2.430	.310	.500	1.380
721B	00722	1-1/4 to 2	10-2	5	20	3.600	.310	1.390	3.000
722B	07222	2-1/2 to 4	10-2	1	1	6.350	.310	2.700	5.900
723B	07232	4-1/2 to 6	10-2	1	1	8.500	.310	4.500	8.400



E75814 LR49636

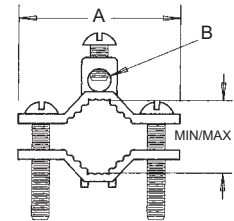

Bare Wire Ground Clamp

Solid brass with brass screws.

CATALOG NUMBER	UPC/DCI/NAED MFG #018997	PIPE SIZE	WIRE RANGE	UNIT PKG	STD PKG	DIM A	DIM B	MIN	MAX
720BBS	72022	1/2 to 1	10-2	25	250	2.430	.310	.500	1.380



E75814 LR49636

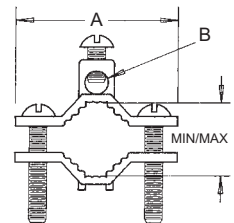

Grounding

Bare Wire Ground Clamp

Solid bronze with bronze screws. Approved for direct burial.



CATALOG NUMBER	UPC/DCI/NAED MFG #018997	PIPE SIZE	WIRE RANGE	UNIT PKG	STD PKG	DIM A	DIM B	MIN	MAX
720DB	00721	1/2 to 1	10-2	25	250	2.275	.312	.675	1.850

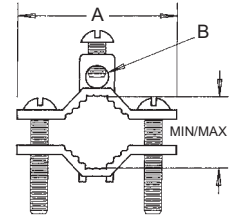

Bare Wire Ground Clamp with Closed Lug

Solid bronze with stainless steel screws. Approved for direct burial on rebar, pipe, tubing, and rod.



CATALOG NUMBER	UPC/DCI/NAED MFG #018997	PIPE SIZE	WIRE RANGE	UNIT PKG	STD PKG	DIM A	DIM B	MIN	MAX
718DB	72000	3/8 to 1	8-4/0	10	10	2.350	.620	.330	1.500

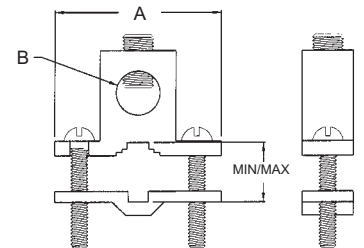

Bare Wire Ground Clamp with Open Lug

Solid bronze with stainless steel screws. Approved for direct burial on rebar, pipe, tubing, and rod.



CATALOG NUMBER	UPC/DCI/NAED MFG #018997	PIPE SIZE	WIRE RANGE	UNIT PKG	STD PKG	DIM A	MIN	MAX
719DB	72001	3/8 to 1	8-4/0	10	10	2.588	.360	1.125

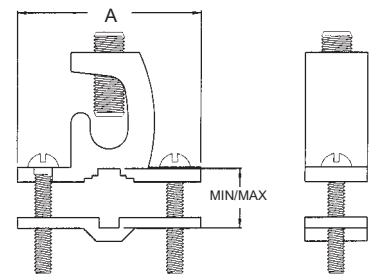



Bare Wire Ground Clamp with Open Lug

Solid bronze with stainless steel screws. Approved for direct burial on rebar, pipe, tubing, and rod.

CATALOG NUMBER	UPC/DCI/NAED MFG #018997	PIPE SIZE	WIRE RANGE	UNIT PKG	STD PKG	DIM A	MIN	MAX
717DB	12514	3/8 to 1	10-2	25	250	2.230	.275	1.500

E198108

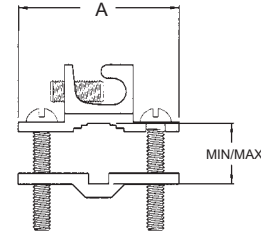

Compression Connectors for Terminating Grounding Electrodes

Compression connector for terminating grounding connectors to metal enclosures.

CATALOG NUMBER	UPC/DCI/NAED MFG #018997	STD PKG	DIM A	DIM B	DIM C	DIM D	DIM E
KC4	83665	10	1.806	.520	1.208	.198	.160
KC6	83667	10	1.740	.500	1.213	.154	.130



E225971



KC4



KC6

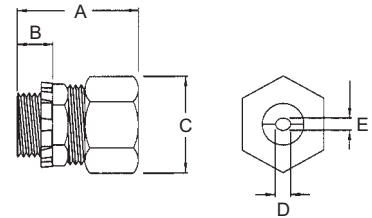

Features and Benefits

- A new alternative for bonding and grounding separately derived systems, panelboards, and enclosures
- Eliminates the need for installing lugs on the frames of load centers
- Provides adequate strain relief for grounding electrode conductors



AnyBODY™ Conduit Bodies

Copper-free aluminum die-cast. Five conduit bodies in one! Ships as an LB, but converts to a T, LL, LR, or C. Switch covers and threaded flanges as needed to create the style you need.



930 ships as LB

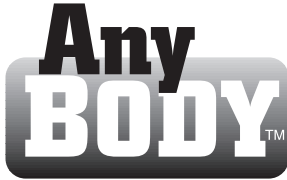

Converts to a...



C



LL



LR



T

Scan For Video



Combination threaded IMC or rigid and set-screw EMT.

CATALOG NUMBER	UPC/DCI/NAED MFG #018997	TRADE SIZE	CUBIC INCHES	UNIT PKG	STD PKG	DIM A	DIM B	DIM C
930	17900	1/2	4.80	10	10	5.111	2.520	1.670
931	17901	3/4	7.80	10	10	5.640	2.770	2.020
932	17902	1	11.50	5	5	6.530	3.280	2.160
933	17903	1-1/4	32.30	2	10	8.550	4.020	2.980
934	17904	1-1/2	32.30	2	10	8.550	4.020	2.980
935	17905	2	69.50	1	5	10.730	4.670	3.500

Refer to page H-2 for flange illustration.



E48106 LR49636

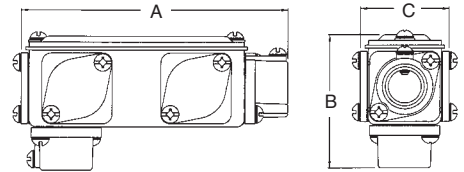

Threaded only for IMC or rigid.

CATALOG NUMBER	UPC/DCI/NAED MFG #018997	TRADE SIZE	CUBIC INCHES	UNIT PKG	STD PKG	DIM A	DIM B	DIM C
936	17906	2-1/2	175.50	1	1	13.900	5.970	4.800
937	17907	3	175.50	1	1	14.340	6.400	4.800
938	17908	3-1/2	334.00	1	1	16.840	7.330	5.840
939	17909	4	334.00	1	1	16.840	7.330	5.840



E48106 LR49636

COMPETITIVELY PRICED WITH LBS & NO EXTRA COST FOR Ts

930
1/2" AnyBODY
Showing
Conversion to LR

Labels: Threaded Flange, Cover Plate, Screwdriver

1. Remove cover plate.
2. Remove threaded flange.
3. Reinstall cover plate and flange in the appropriate opening to convert AnyBODY to the desired configuration.

Features and Benefits

- Meets NEC 2011 Section 314.16 Paragraph (C) (2) for conduit bodies with splices, taps, or devices
- Convenient and easy to use
- Saves the time, space, and cost of stocking five different conduit bodies (LB, T, LL, LR, C)
- 1/2" to 2" sizes are combination EMT/rigid — they're threaded for rigid, but also have a set-screw for use with EMT
- Includes threaded flanges for three openings
- Volume and wire fill marked inside bodies
- Recessed O-rings under covers and flanges

Recessed O-Ring Illustration

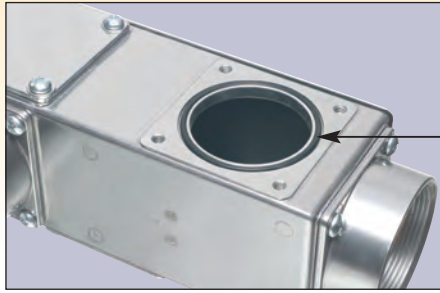

(Note: cover removed)
Seated O-rings on all Metallic AnyBODY™ Conduit Bodies maintain liquid-tight seal!

Flange Illustration

Combination Threaded and Set-Screw Conduit Bodies

AnyBODY™ conduit bodies, #'s 930 through 935, whether in T, LB, C, LR, or LL configurations have combination flanges which are threaded for rigid and include set-screws for EMT.

The set-screws may be used for rigid, but are not necessary. They are listed raintight with rigid and concrete-tight for EMT. These products can also be used for EMT to rigid.



Shown with Rigid

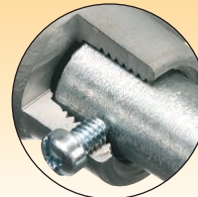

Shown with EMT

AnyBODY™ Cover and Gasket Kits

Replacement kits for the AnyBODY Series. Includes aluminum cover, neoprene gasket, and two combination screws.



CATALOG NUMBER	UPC/DCI/NAED MFG #018997	TRADE SIZE	UNIT PKG	STD PKG	DIM A	DIM B
930CG	16500	1/2	1	1	4.140	1.380
931CG	16501	3/4	1	1	4.600	1.720
932CG	16502	1	1	1	5.250	1.860
933CG	16503	1-1/4	1	1	7.200	2.600
934CG	16504	1-1/2	1	1	7.200	2.600
935CG	16505	2	1	1	9.440	3.130
936CG	93605	2-1/2	1	1	12.500	4.360
937CG	93705	3	1	1	12.500	4.360
938CG	93805	3-1/2	1	1	15.000	5.400
939CG	93905	4	1	1	15.000	5.400

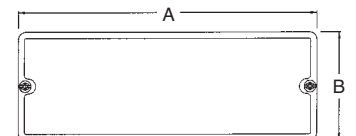



Set-Screw AnyBODY™ Conduit Bodies for EMT or Rigid

Copper-free aluminum die-cast. Five conduit bodies in one! Ships as an LB, but converts to a T, LL, LR, or C. Switch covers and flanges as needed to create the style you need.

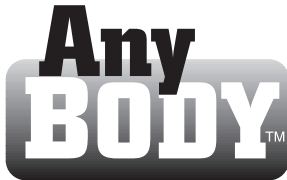

COMPETITIVELY
PRICED WITH LBS
& NO
EXTRA COST
FOR TS

For set-screw sizes 1/2" - 2" see page H-1.

CATALOG NUMBER	UPC/DCI/NAED MFG #018997	TRADE SIZE	CUBIC INCHES	UNIT PKG	STD PKG	DIM A	DIM B	DIM C
16	16400	2-1/2	175.50	1	1	14.340	6.390	4.800
17	16401	3	175.50	1	1	14.340	6.400	4.800
18	16402	3-1/2	334.00	1	1	16.840	7.330	5.840
19	16403	4	334.00	1	1	16.840	7.330	5.840

Refer to page H-2 for flange illustration.



E48106 LR49636

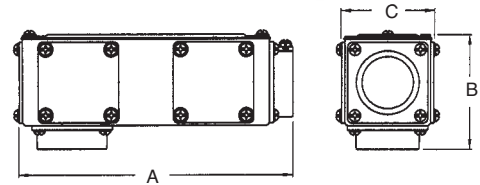

16
2-1/2" AnyBODY
Converted from LB
to LR

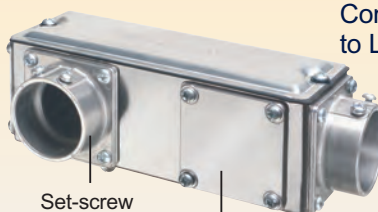

Set-screw Flange Cover Plate

1. Remove cover plate.
2. Remove set-screw flange.
3. Reinstall cover plate and flange in the appropriate opening to convert AnyBODY to the desired configuration.

Features and Benefits

- Meets NEC 2011 Section 314.16 Paragraph (C) (2) for conduit bodies with splices, taps, or devices
- Convenient and easy to use
- Saves the time, space, and cost of stocking five different conduit bodies (LB, T, LL, LR, C)
- Includes flanges for three openings
- Volume and wire fill marked inside bodies
- Recessed O-rings under covers and flanges

Service Entrance SLB Conduit Bodies

With aluminum cover and velumoid gasket. Copper-free aluminum die-cast.



Threaded for IMC or rigid.

CATALOG NUMBER	UPC/DCI/NAED MFG #018997	TRADE SIZE	UNIT PKG	STD PKG	DIM A	DIM B	DIM C
920SLB	92013	1/2	10	10	3.155	1.450	1.178
921SLB	92113	3/4	10	10	3.470	1.650	1.360
922SLB	92213	1	5	5	4.180	1.915	1.723
923SLB	92313	1-1/4	5	5	5.515	2.320	2.164
924SLB	92413	1-1/2	2	2	6.095	2.410	2.420
925SLB	92513	2	2	10	6.595	2.975	2.835

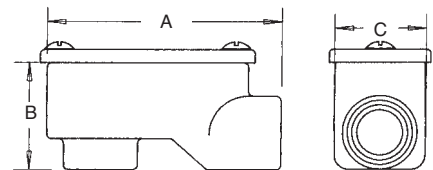

Non-Metallic AnyBODY™

Conduit Bodies

Non-metallic. Five conduit bodies in one! Ships as an LB, but converts to a T, LL, LR, or C. Switch covers and flanges as needed to create the style you need. Includes cover, foam gaskets, and screws.



935NM ships as LB

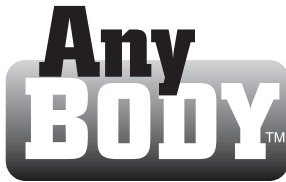

Converts to a...



C



LL



LR



T

CATALOG NUMBER	UPC/DCI/NAED MFG #018997	TRADE SIZE	CUBIC INCHES	UNIT PKG	STD PKG	DIM A	DIM B	DIM C
930NM	12500	1/2	4.50	10	10	5.150	2.560	1.750
931NM	12501	3/4	8.50	10	10	5.670	2.800	2.100
932NM	12502	1	12.00	5	5	6.560	3.260	2.240
933NM	12503	1-1/4	33.50	2	10	8.510	3.910	3.000
934NM	12504	1-1/2	33.50	2	10	8.510	3.910	3.000
935NM	12505	2	65.30	1	5	10.840	4.710	3.630
936NM	12506	2-1/2	194.00	1	1	14.440	6.470	4.980
937NM	12507	3	194.00	1	1	14.560	6.600	4.980
938NM	12508	3-1/2	369.00	1	1	17.170	7.610	6.090
939NM	12509	4	369.00	1	1	17.250	7.690	6.090

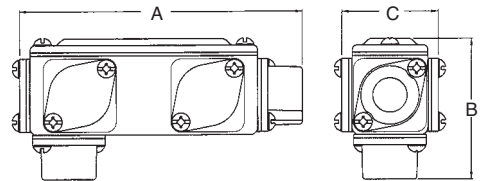

930NM shown

935NM
2" AnyBODY
Showing
Conversion to LR

1. Remove cover plate.
2. Remove flange.
3. Reinstall cover plate and flange in the appropriate opening to convert AnyBODY to the desired configuration.

Features and Benefits

- Meets NEC 2011 Section 314.16 Paragraph (C) (2) for conduit bodies with splices, taps, or devices
- Convenient and easy to use
- Saves the time, space, and cost of stocking five different conduit bodies (LB, T, LL, LR, C)
- Includes flanges for three openings
- Volume and wire fill marked inside bodies
- Using standard PVC cement, AnyBODY glues onto pipe for easy installation
- AnyBODY NM Cover and Gasket Kits available soon
- All gaskets are secured and maintain a rain-tight seal

**COMPETITIVELY
PRICED WITH LBS
& NO
EXTRA COST
FOR Ts**



Insulating Bushings

For Rigid • IMC. Press fit.
Holds firmly in place while pulling cables.



Example:
Telephone cable
protected by Rigid
insulating bushing.

Meets 2011 NEC code requirements for 300-15(c) protection. Listed for use in environmental air handling spaces per 2011 NEC code requirements 300-22(c).

CATALOG NUMBER	UPC/DCI/NAED MFG #018997	TRADE SIZE	UNIT PKG	STD PKG	DIM A	DIM B
RGD50	51930	1/2	100	1000	.531	.989
RGD75	51932	3/4	100	1000	.531	1.185
RGD100	51933	1	100	100	.625	1.542
RGD125	51934	1-1/4	100	100	.625	1.891
RGD150	51935	1-1/2	100	100	.625	2.062
RGD200	51936	2	50	50	.625	2.655
EMT250†	12240	2-1/2	25	25	1.225	3.062
EMT300†	12245	3	25	25	1.225	3.690
EMT350†	12250	3-1/2	25	25	1.231	4.187
EMT400†	12255	4	25	25	1.233	4.815

See page B-1 for EMT Insulating Bushings size 1/2" through 4".
† Can also be used for EMT.



E105706 LR49636

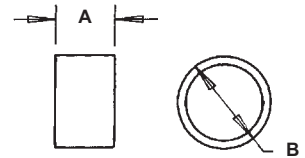

Arlington's Rigid Insulating Bushings protect cables from abrasion by rigid. Examples: Power, Cable TV, computer datalines, telephone/modem, a/v cables, alarm systems, security systems. Rigid is often used to protect cables where damage could occur in a house or building.

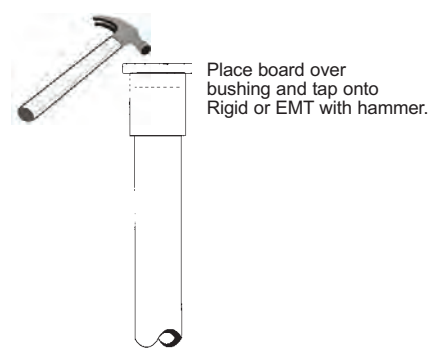
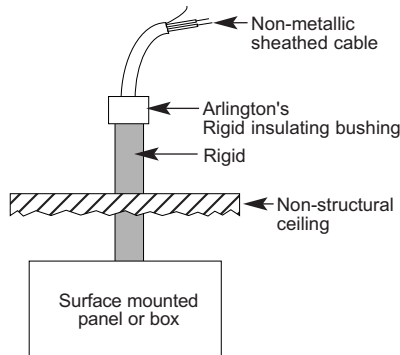

Place board over bushing and tap onto Rigid or EMT with hammer.

Zinc Combination Couplings EMT to Rigid

EMT compression to screw-in flexible metal conduit.
Zinc die-cast.



2400

CATALOG NUMBER	UPC/DCI/NAED MFG #018997	TRADE SIZE	UNIT PKG	STD PKG	DIM A	DIM B	DIM C
2400	06920	1/2"	50	50	1.000	1.267	.946
2410	06921	3/4"	50	50	1.000	1.412	1.200
2411	06922	3/4"	50	50	1.210	1.475	1.200

Use with any listed fitting.

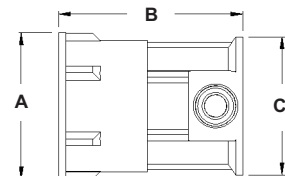

Conduit Caps

Conduit cap and insulating bushing.



RGD200C

CATALOG NUMBER	UPC/DCI/NAED MFG #018997	TRADE SIZE	UNIT PKG	STD PKG	DIM A	DIM B
RGD50C	51937	1/2	100	1000	.531	.840
RGD75C	51938	3/4	100	1000	.531	1.056
RGD100C	51939	1	100	100	.625	1.280
RGD125C	51940	1-1/4	100	100	.625	1.660
RGD150C	51941	1-1/2	100	100	.625	1.915
RGD200C	51942	2	50	50	.625	2.377
EMT250C†	12215	2-1/2	25	25	1.225	3.062
EMT300C†	12217	3	25	25	1.225	3.690
EMT350C†	12219	3-1/2	25	25	1.231	4.187
EMT400C†	12221	4	25	25	1.233	4.815

See page B-1 for EMT Insulating Bushings size 1/2" through 4".

† Can also be used for EMT.

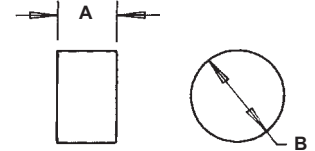

Use this capped version to seal off conduit during concrete pours. Then remove cap/seal with razor knife or use screwdriver to punch hole in cap. (EMT300C)

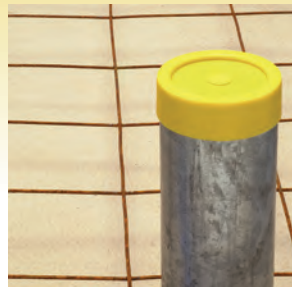

String can be used to aid removal.

Long Conduit Nipples

Zinc die-cast.



CATALOG NUMBER	UPC/DCI/NAED MFG #018997	TRADE SIZE	UNIT PKG	STD PKG	DIM A	DIM B	DIM C
501L	50130	1/2	100	1000	.900	.800	1.055
502L	50230	3/4	50	500	.900	.800	1.300
503L	50330	1	25	100	.900	.770	1.670

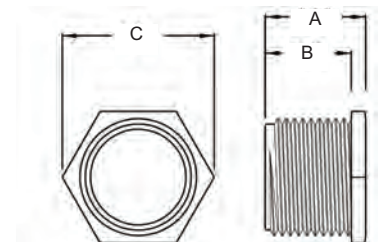



Conduit Nipples

Zinc die-cast.



CATALOG NUMBER	UPC/DCI/NAED MFG #018997	TRADE SIZE	UNIT PKG	STD PKG	DIM A	DIM B	DIM C
501	00501	1/2	100	1000	.585	.425	1.050
502	00502	3/4	50	500	.614	.514	1.310
503	00503	1	25	100	.654	.518	1.616
504	00504	1-1/4	10	100	.810	.578	1.978
505	00505	1-1/2	10	100	.835	.613	2.410
506	00506	2	10	50	.888	.676	2.945
507	00507	2-1/2	10	30	1.200	.876	3.555
508	00508	3	10	10	1.375	1.008	4.390
509	00509	3-1/2	10	10	1.375	1.008	4.925
510	00510	4	5	5	1.375	1.011	5.420
511†	00511	5	1	1	1.700	1.232	5.812
512†	00512	6	1	1	1.500	1.500	7.000

† Malleable.



E60812 LR49636

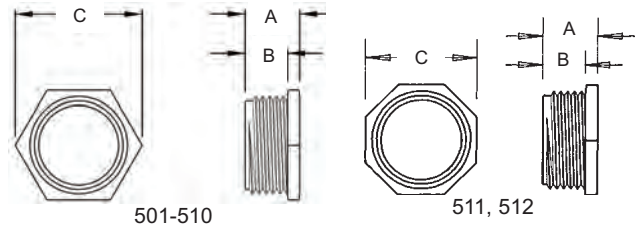

Conduit Nipples

Non-metallic.



CATALOG NUMBER	UPC/DCI/NAED MFG #018997	TRADE SIZE	UNIT PKG	STD PKG	DIM A	DIM B	DIM C
NM501	54501	1/2	100	1000	.754	.654	1.047
NM501EL	54584	1/2	100	1000	1.884	1.784	.946
NM502	54502	3/4	50	500	.779	.534	1.300
NM503	54503	1	25	100	.900	.575	1.592
NM504	54504	1-1/4	10	100	.900	.575	2.415
NM505	54505	1-1/2	10	100	.912	.662	2.623
NM506	54506	2	10	50	.975	.570	3.096



E60812 LR49636

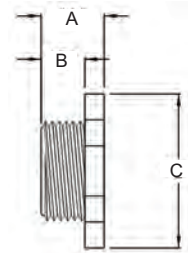

Rigid • IMC Fittings

3-Piece Coupling Rigid • IMC

Zinc die-cast.



CATALOG NUMBER	UPC/DCI/NAED MFG #018997	TRADE SIZE	STD PKG	DIM A	DIM B	DIM C
200	00200	1/2	50	1.430	1.310	1.250
201	00201	3/4	50	1.520	1.610	1.560
202	00202	1	25	1.700	2.125	2.100
203	00203	1-1/4	25	2.125	2.400	2.415
204	00204	1-1/2	25	2.125	2.890	2.940
205	00205	2	20	2.360	3.400	3.500
206	00206	2-1/2	10	2.520	4.030	4.390
207	00207	3	5	2.580	4.620	4.930
208	00208	3-1/2	5	2.645	5.350	5.425
209	00209	4	2	3.420	5.870	5.780
210†	00210	5	1	4.375	7.000	7.000
211†	00211	6	1	4.375	8.250	8.250

† Malleable.

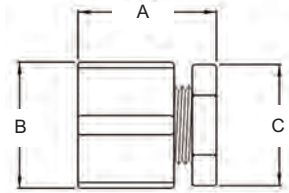

3/4" Offset Nipples

Zinc die-cast.



CATALOG NUMBER	UPC/DCI/NAED MFG #018997	TRADE SIZE	KO SIZE	UNIT PKG	STD PKG	DIM A	DIM B
6A2	61200	1/2	1/2	20	200	2.460	1.000
6A3	61300	3/4	3/4	10	100	2.560	1.220
6A4	61400	1	1	10	100	2.535	1.525
6A5	61500	1-1/4	1-1/4	10	40	2.937	1.910
6A6	61600	1-1/2	1-1/2	10	40	3.080	2.125
6A7	61700	2	2	10	10	3.145	2.665
6A8†	61800	2-1/2	2-1/2	2	2	3.970	3.280
6A9†	61900	3	3	1	1	4.420	3.795
6A10†	64000	3-1/2	3-1/2	1	1	5.000	4.477
6A11†	64002	4	4	1	1	5.000	4.960

† Malleable.

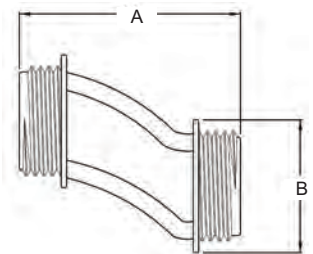



Conduit Locknuts

Plated steel.



CATALOG NUMBER	UPC/DCI/NAED MFG #018997	TRADE SIZE	UNIT PKG	STD PKG	DIM A	DIM B
401	00401	1/2	200	2000	1.125	.130
402	00402	3/4	100	1000	1.383	.140
403	00403	1	100	1000	1.730	.160
404	00404	1-1/4	50	250	2.080	.187
405	00405	1-1/2	50	250	2.376	.187
406	00406	2	25	250	2.890	.250
407	00407	2-1/2	30	30	3.470	.250
408	00408	3	25	25	4.165	.250
409	00409	3-1/2	25	25	4.700	.275
410	00410	4	25	25	5.320	.275
411	00411	5	10	10	6.487	.450
412	00412	6	10	10	7.830	.450

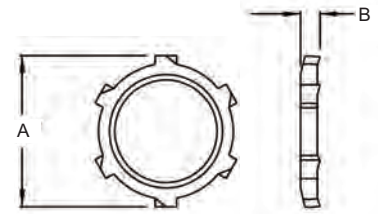

Plastic Insulating Bushings

105° C rated.



CATALOG NUMBER	UPC/DCI/NAED MFG #018997	TRADE SIZE	UNIT PKG	STD PKG	DIM A	DIM B
440	00440	1/2	100	1000	1.050	.365
441	00441	3/4	100	1000	1.280	.390
442	00442	1	50	500	1.632	.490
443	00443	1-1/4	25	250	1.986	.535
444	00444	1-1/2	25	250	2.160	.550
445	00445	2	25	125	2.680	.600
446	00446	2-1/2	10	100	3.150	.635
447	00447	3	10	50	3.800	.725
448	00448	3-1/2	10	50	4.275	.725
449	00449	4	10	50	4.775	.750
4491	04491	5	5	5	6.350	.975
4492	04492	6	5	5	7.475	.975

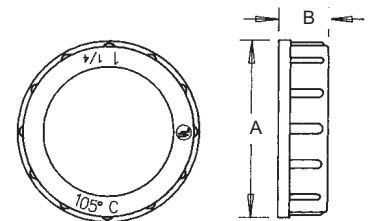

Rigid • IMC Fittings

Combination Threaded Rigid and Set-Screw EMT to Box

90° pulling elbows with cover and gasket. Zinc die-cast.



CATALOG NUMBER	UPC/DCI/NAED MFG #018997	TRADE SIZE	UNIT PKG	STD PKG	DIM A	DIM B
9100	91005	1/2	5	50	2.030	1.945
9110	91100	3/4	5	50	2.260	2.140
9120	50165	1	5	25	2.610	2.610
9130	50167	1-1/4	2	10	3.037	3.037

See hub illustration on page B-7.

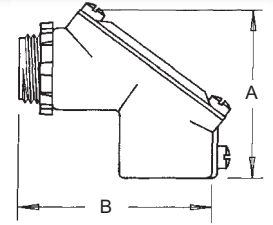

Combination Threaded Rigid and Set-Screw EMT 90° Pulling Elbow

90° pulling elbows with cover and gasket. Zinc die-cast.



CATALOG NUMBER	UPC/DCI/NAED MFG #018997	TRADE SIZE	UNIT PKG	STD PKG	DIM A	DIM B
HL5000	83105	1/2	10	100	2.120	2.120
HL7500	83175	3/4	5	50	2.380	2.380
HL100	50171	1	5	25	3.040	3.040
HL125	50173	1-1/4	2	10	3.900	3.900

See hub illustration on page B-7.

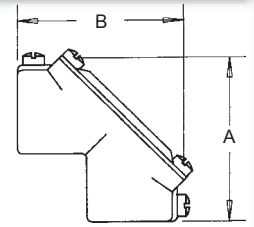

Watertight Conduit Hubs

For rigid • IMC conduit. With insulated throat. Zinc die-cast.



CATALOG NUMBER	UPC/DCI/NAED MFG #018997	TRADE SIZE	STD PKG	DIM A	DIM B
WH1	58100	1/2	10	1.325	1.325
WH2	58200	3/4	10	1.450	1.512
WH3	58300	1	10	1.450	1.790
WH4	58400	1-1/4	5	1.575	2.295
WH5	58500	1-1/2	2	1.700	2.450
WH6	58600	2	2	1.700	2.875
WH7	58700	2-1/2	1	2.045	3.325
WH8	58800	3	1	2.150	4.040
WH9	58900	3-1/2	1	2.420	4.550
WH10	58101	4	1	2.420	5.030
WH11†	58103	5	1	3.000	6.750
WH12†	58105	6	1	3.085	7.600

† Malleable.

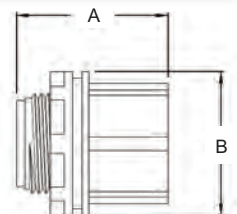



Steel Sealing Locknut

With PVC molded seal.



CATALOG NUMBER	UPC/DCI/NAED MFG #018997	TRADE SIZE	STD PKG	DIM A	DIM B
SL50	13500	1/2	50	1.125	.230
SL75	13750	3/4	50	1.375	.240
SL100	13100	1	25	1.715	.260
SL125	13125	1-1/4	25	2.065	.300
SL150	13150	1-1/2	25	2.375	.300
SL200	13200	2	25	2.885	.350
SL250	13250	2-1/2	10	3.450	.350
SL300	13300	3	10	4.125	.350
SL350	13350	3-1/2	10	4.675	.375
SL400	13400	4	10	5.225	.375
SL500	13501	5	10	6.487	.550
SL600	13600	6	10	7.830	.550



E60812 LR49636

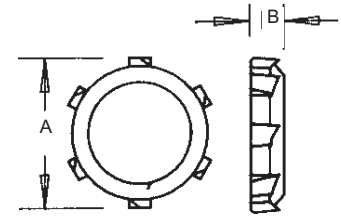

Die-Cast Locknuts

Cast thread. Zinc die-cast.



CATALOG NUMBER	UPC/DCI/NAED MFG #018997	TRADE SIZE	UNIT PKG	STD PKG	DIM A	DIM B
DLN1	43510	1/2	200	2000	1.100	.160
DLN2	43520	3/4	100	1000	1.387	.160
DLN3	43530	1	100	500	1.685	.190
DLN4	43540	1-1/4	50	250	2.115	.190
DLN5	43450	1-1/2	50	250	2.370	.190
DLN6	43560	2	25	250	2.885	.190
DLN7	43570	2-1/2	60	60	3.450	.250
DLN8	43580	3	50	50	4.190	.250
DLN9	43590	3-1/2	50	50	4.700	.250
DLN10	43511	4	30	30	5.300	.250



E60812 LR49636

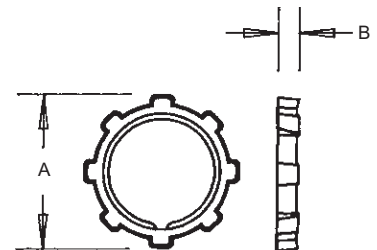

Rigid • IMC Fittings

Reducing Washers

Plated steel.

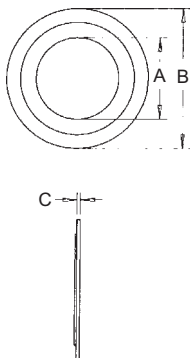

CATALOG NUMBER	UPC/DCI/NAED MFG #018997	SIZE	UNIT PKG	STD PKG	DIM A	DIM B	DIM C
RW1	95100	3/4 x 1/2	250	1000	.870	1.420	.035
RW2	95200	1 x 1/2	100	400	.870	1.710	.035
RW3	95300	1 x 3/4	100	400	1.060	1.710	.035
RW4	95400	1-1/4 x 1/2	200	200	.870	2.080	.035
RW5	95500	1-1/4 x 3/4	200	200	1.060	2.080	.035
RW6	95600	1-1/4 x 1	200	200	1.380	2.080	.035
RW7	95700	1-1/2 x 1/2	100	100	.870	2.635	.035
RW8	95800	1-1/2 x 3/4	100	100	1.060	2.635	.035
RW9	95900	1-1/2 x 1	100	100	1.335	2.635	.035
RW10	95101	1-1/2 x 1-1/4	100	100	1.690	2.635	.035
RW11	95110	2 x 1/2	50	50	.870	3.265	.035
RW12	95120	2 x 3/4	50	50	1.060	3.265	.035
RW13	95130	2 x 1	50	50	1.335	3.265	.035
RW14	95140	2 x 1-1/4	50	50	1.690	3.265	.035
RW15	95150	2 x 1-1/2	50	50	1.935	3.265	.035
RW16	95160	2-1/2 x 1/2	50	50	.870	3.265	.035
RW17	95170	2-1/2 x 3/4	50	50	1.060	3.265	.035
RW18	95180	2-1/2 x 1	50	50	1.370	3.265	.035
RW19	95190	2-1/2 x 1-1/4	50	50	1.750	3.265	.035
RW20	95201	2-1/2 x 1-1/2	50	50	1.935	3.265	.035
RW21	95210	2-1/2 x 2	50	50	2.425	3.265	.035
RW22	95220	3 x 1/2	25	25	.870	4.490	.040
RW23	95230	3 x 3/4	25	25	1.060	4.490	.040
RW24	95240	3 x 1	25	25	1.360	4.490	.045
RW25	95250	3 x 1-1/4	25	25	1.750	4.490	.040
RW26	95260	3 x 1-1/2	25	25	1.935	4.490	.040
RW27	95270	3 x 2	25	25	2.424	4.490	.040
RW28	95280	3 x 2-1/2	25	25	2.940	4.490	.040
RW29	95290	3-1/2 x 1/2	10	10	.870	5.000	.060
RW30	95301	3-1/2 x 3/4	10	10	1.060	5.000	.060
RW31	95310	3-1/2 x 1	10	10	1.360	5.000	.060
RW32	95320	3-1/2 x 1-1/4	10	10	1.750	5.000	.060
RW33	95330	3-1/2 x 1-1/2	10	10	1.935	5.000	.060
RW34	95340	3-1/2 x 2	10	10	2.425	5.000	.060
RW35	95350	3-1/2 x 2-1/2	10	10	2.920	5.000	.060
RW36	95360	3-1/2 x 3	10	10	3.560	5.000	.060
RW37	95370	4 x 1/2	10	10	.870	5.500	.065
RW38	95380	4 x 3/4	10	10	1.060	5.500	.065
RW39	95390	4 x 1	10	10	1.360	5.500	.065
RW40	95401	4 x 1-1/4	10	10	1.715	5.500	.065
RW41	95410	4 x 1-1/2	10	10	1.970	5.500	.065
RW42	95420	4 x 2	10	10	2.435	5.500	.065
RW43	95430	4 x 2-1/2	10	10	2.920	5.500	.065
RW44	95440	4 x 3	10	10	3.560	5.500	.065
RW45	95450	4 x 3-1/2	10	10	4.050	5.500	.065



E181788 LR104691



Pipe Hangers *New!*

One-piece.
Non-metallic. UV rated.



NM1000



NM2000



NM2080

CATALOG NUMBER	UPC #018997 MFG #	DCI SIZE*	NAE SIZE	RIGID SIZE	EMT SIZE	LT SIZE	FLEX SIZE	ENT SIZE	COPPER TUBING	COPPER PIPE	STD PKG	DIM A	DIM B	DIM C
NM1000	54615	-	-	-	-	-	-	-	-	-	100	1.563	.777	1.563
NM1900	54514	-	-	-	5/16	-	-	-	1/2	-	100	.844	.668	1.270
NM2000	54515	-	-	1/2	3/8	-	-	-	3/8	-	100	.922	.795	1.412
NM2005	54525	1/2	1/2	-	1/2	1/2	-	-	1/2	-	100	1.077	.795	1.588
NM2010	54516	-	-	3/4	-	-	-	-	3/4	-	100	1.178	.800	1.667
NM2015	54526	3/4	3/4	-	3/4	3/4	-	-	3/4	-	100	1.277	.800	1.826
NM2020	54517	-	-	1	-	-	-	-	1	-	100	1.377	.790	1.983
NM2025	54518	1	1	-	1	1	-	-	1	-	100	1.582	.830	2.180
NM2030	54528	-	-	1-1/4	-	-	-	-	1-1/4	-	100	1.700	.820	2.346
NM2040	54519	1-1/4	1-1/4	1-1/2	-	-	-	-	1-1/2	1-1/4	100	1.830	.830	2.523
NM2045	54544	1-1/2	1-1/2	-	1-1/2	-	-	-	1-1/2	-	100	2.212	.860	2.846
NM2150	54547	-	-	-	-	-	-	-	2	-	50	2.640	.910	3.100
NM2050	54520	2	2	2	2	-	-	-	2	-	50	3.020	.910	3.470
NM2060	54521	2-1/2	2-1/2	2-1/2	2-1/2	-	-	-	-	-	50	3.460	1.115	5.095
NM2070	54522	3	3	3	3	-	-	-	-	-	25	4.224	1.362	6.153
NM2080	54523	3-1/2	3-1/2	3-1/2	3-1/2	-	-	-	-	-	25	4.720	1.548	7.000
NM2090	54524	4	4	4	4	-	-	-	-	-	10	5.365	1.743	7.850



E161207 LR49636

* Rigid sizes also same for IMC and PVC.
For additional information on QuickLATCH plumbing applications, call or visit our website.

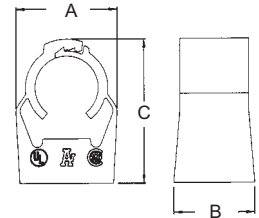

Features and Benefits

- Saves 25 seconds per installation...over 20¢ at \$30.00 per hour labor rate
- Costs the same as a steel pipe hanger with bolt and nut
- Conduit snaps into place, locking automatically
- Accommodates thinwall, rigid conduit, PVC conduit, or copper
- Mounts horizontally or vertically
- UV rated for outdoor application
- Corrosion resistant
- Listed for use in environmental air handling spaces per 2011 NEC code requirement 300-22(c)
- 2-1/2" to 4" hangers feature tabs with openings for the optional securing of a cable tie

QuickLATCH™

Use it anywhere you would use a pipe hanger!

Installation Instructions

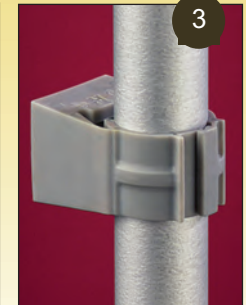
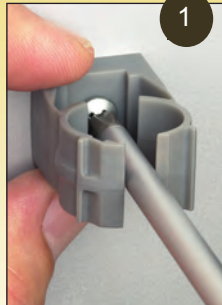
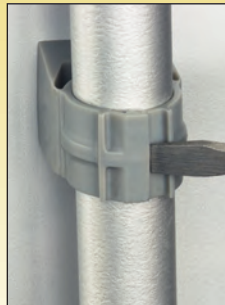

To Remove

Use a screwdriver to lift tab.

1. Mount to wall, strut, stud, or threaded rod up to 1/4-20
2. Press pipe down firmly into QuickLATCH to lock it in place
3. That's it!

Scan For Video



Rigid • IMC Fittings

Pipe Hangers

Plated steel.
With nut and bolt.



CATALOG NUMBER	UPC/DCI/NAED MFG #018997	TRADE SIZE	RIGID SIZE	EMT SIZE	STD PKG	DIM A	DIM B	DIM C
2000	02000	0	3/8 x 1/2	1/2	100	1.875	.990	.750
2010	02010	1	3/4	3/4	100	2.175	1.260	.875
2020	02020	2	1	1	100	2.370	1.295	.875
2025	02025	2-1/2 to 3	1-1/4	1-1/4 to 1-1/2	100	3.175	1.965	.875
2040	02040	4	1-1/2	-	100	3.780	2.220	1.065
2050	02050	5	2	2	50	4.100	2.450	1.210
2060	02060	6	2-1/2	2-1/2	50	4.800	3.180	1.240
2070	02070	7	3	3	25	5.375	3.750	1.250
2080	02080	8	3-1/2	3-1/2	25	6.187	4.187	1.270
2090	02090	9	4	4	10	6.240	4.430	1.270

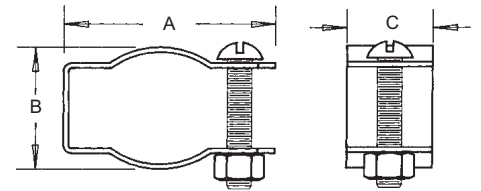

Pipe Hangers

With formed thread in one end of the hanger, nut not required. Plated steel.



CATALOG NUMBER	UPC/DCI/NAED MFG #018997	TRADE SIZE	RIGID SIZE	EMT SIZE	STD PKG	DIM A	DIM B	DIM C
2200	22000	0	3/8 x 1/2	1/2	100	1.875	.990	.750
2210	22100	1	3/4	3/4	100	2.175	1.260	.875
2220	22200	2	1	1	100	2.370	1.295	.875
2225	22250	2-1/2	-	1-1/4	100	3.175	1.965	.875
2230	22300	3	1-1/4	1-1/2	100	3.255	1.875	.875
2240	22400	4	1-1/2	-	100	3.780	2.220	1.065
2250	22500	5	2	2	50	4.100	2.450	1.210

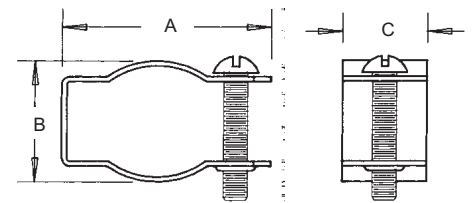



Reducing Bushings

Zinc die-cast.



CATALOG NUMBER	UPC/DCI/NAED MFG #018997	TRADE SIZE	UNIT PKG	STD PKG	DIM A	DIM B
522	00522	3/4 x 1/2	50	500	.650	.920
523	00523	1 x 1/2	25	100	.715	1.125
524	00524	1 x 3/4	25	100	.715	1.125
525	00525	1-1/4 x 1/2	25	25	.820	1.470
526	00526	1-1/4 x 3/4	25	25	.820	1.470
527	00527	1-1/4 x 1	25	25	.820	1.470
528	00528	1-1/2 x 1/2	25	25	.850	1.700
529	00529	1-1/2 x 3/4	25	25	.850	1.700
530	00530	1-1/2 x 1	25	25	.850	1.700
531	00531	1-1/2 x 1-1/4	25	25	.850	1.700
532	00532	2 x 1/2	10	10	.970	2.230
533	00533	2 x 3/4	10	10	.970	2.230
534	00534	2 x 1	10	10	.970	2.230
535	00535	2 x 1-1/4	10	10	.970	2.230
536	00536	2 x 1-1/2	10	10	.970	2.230



E60812 LR49636

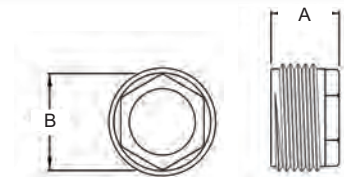

Larger Reducing Bushings

Zinc die-cast.



CATALOG NUMBER	UPC/DCI/NAED MFG #018997	TRADE SIZE	UNIT PKG	STD PKG	DIM A	DIM B	DIM C
1274	01274	2-1/2 x 1-1/4	5	5	2.090	.430	2.845
1275	01275	2-1/2 x 1-1/2	5	5	1.125	.430	2.820
1276	01276	2-1/2 x 2	5	5	1.200	.300	3.485
1283	01283	3 x 1	5	5	1.785	.500	4.075
1284	01284	3 x 1-1/4	5	5	2.100	.410	3.445
1285	01285	3 x 1-1/2	5	5	2.020	.440	3.460
1286	01286	3 x 2	5	5	2.000	.400	3.380
1287	01287	3 x 2-1/2	5	5	1.390	.375	4.395
1296	01296	3-1/2 x 2	2	2	1.905	.565	4.575
1297	01297	3-1/2 x 2-1/2	2	2	2.020	.450	3.945
1298	01298	3-1/2 x 3	2	2	1.385	.380	4.920
1307	01307	4 x 2-1/2	2	2	2.070	.570	5.250
1308	01308	4 x 3	2	2	1.775	.500	5.250
1309	01309	4 x 3-1/2	2	2	1.400	.375	5.420



E60812 LR49636

Reducing bushings are rain tight in threaded hubs. Also, reducing bushings, unlike reducing washers, maintain grounding path and are able to pass UL high current testing.

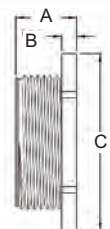

Rigid • IMC Fittings

1-Hole Rigid Straps

Snap-on type. Plated steel.



CATALOG NUMBER	UPC/DCI/NAED MFG #018997	TRADE SIZE	UNIT PKG	STD PKG	DIM A	DIM B	DIM C	DIM D
340	00340	1/2	50	500	1.915	.875	.625	.250
341	00341	3/4	50	500	2.230	1.050	.750	.250
342	00342	1	25	250	2.615	1.295	.875	.312
343	00343	1-1/4	25	100	2.975	1.630	.875	.375
344	00344	1-1/2	25	100	3.660	1.860	1.000	.437
345	00345	2	25	100	4.150	2.240	1.125	.562
346	00346	2-1/2	25	25	4.927	2.958	1.245	.550
347	00347	3	25	25	5.560	3.441	1.250	.550
348	00348	3-1/2	10	10	6.337	3.951	1.250	.575
349	00349	4	10	10	6.811	4.441	1.240	.575

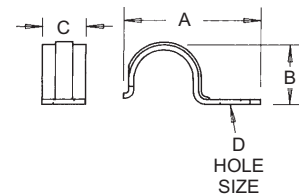

2-Hole Rigid Straps

Snap-on type. Plated steel.



CATALOG NUMBER	UPC/DCI/NAED MFG #018997	TRADE SIZE	UNIT PKG	STD PKG	DIM A	DIM B	DIM C	DIM D
350	00350	1/2	50	500	2.440	.900	.620	.200
351	00351	3/4	50	500	2.810	1.060	.690	.200
352	00352	1	25	250	3.350	1.365	.750	.275
353	00353	1-1/4	25	100	4.110	1.700	.865	.275
354	00354	1-1/2	25	100	4.450	1.960	.940	.275
355	00355	2	25	150	5.350	2.240	.995	.325
356	00356	2-1/2	25	25	6.025	2.855	.985	.345
357	00357	3	25	25	6.460	3.425	.995	.345
358	00358	3-1/2	10	10	7.300	3.925	.990	.345
359	00359	4	10	10	7.895	4.435	.995	.345

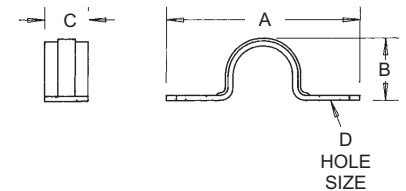



1-Hole Straps

For rigid conduit. Malleable.



CATALOG NUMBER	UPC/DCI/NAED MFG #018997	TRADE SIZE	UNIT PKG	STD PKG	DIM A	DIM B	DIM C
3100	03100	1/2	50	500	1.437	.625	.312
3101	03101	3/4	50	500	1.750	.750	.312
3102	03102	1	25	500	2.125	.937	.312
3103	03103	1-1/4	25	250	2.375	1.062	.437
3104	03104	1-1/2	25	250	2.750	1.062	.500
3105	03105	2	25	150	3.937	1.250	.562
3106	03106	2-1/2	25	25	3.937	1.250	.562
3107	03107	3	25	25	5.187	1.750	.562
3108	03108	3-1/2	10	10	5.562	2.125	.750
3109	03109	4	10	10	6.500	2.250	.750

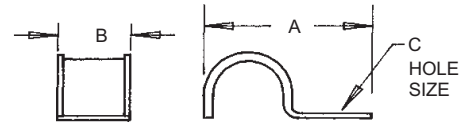

Clamp Back Spacer

Malleable.



CATALOG NUMBER	UPC/DCI/NAED MFG #018997	TRADE SIZE	UNIT PKG	STD PKG	DIM A	DIM B	DIM C
CB1	30100	1/2	50	500	2.062	1.000	.500
CB2	30105	3/4	50	500	2.375	1.062	.500
CB3	30110	1	25	500	3.000	1.250	.562
CB4	30115	1-1/4	25	250	3.500	1.500	.653
CB5	30120	1-1/2	25	250	4.000	1.600	.812
CB6	30125	2	25	150	4.750	2.000	.986
CB7	30130	2-1/2	25	25	5.800	2.437	.812
CB8	30135	3	25	25	6.687	2.625	.875
CB9	30140	3-1/2	10	10	7.125	2.875	1.062
CB10	30145	4	10	10	8.875	3.062	1.062

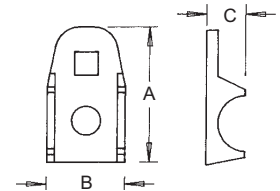

Rigid • IMC Fittings



19.5" & 26" Supports for Outdoor Light Fixtures

For installing a light fixture and/or GFCI devices outdoors. UV rated plastic for long outdoor life. Four non-chipping colors.

CATALOG NUMBER	UPC/DCI/NAED MFG #018997	DESCRIPTION	UNIT PKG	STD PKG	DIM A	DIM B	DIM C
GP19B	77086	Black	1	6	8.110	3.361	19.500
GP19BR	77087	Bronze	1	6	8.110	3.361	19.500
GP19G	77088	Green	1	6	8.110	3.361	19.500
GP19W	77089	White	1	6	8.110	3.361	19.500
GP26B	77090	Black	1	6	8.110	3.361	26.000
GP26BR	77092	Bronze	1	6	8.110	3.361	26.000
GP26G	77094	Green	1	6	8.110	3.361	26.000
GP26W	77096	White	1	6	8.110	3.361	26.000

Add suffix "GC" to Catalog # when ordering in Canada, for example GP19BGC.



CSA listed with grounding lug.

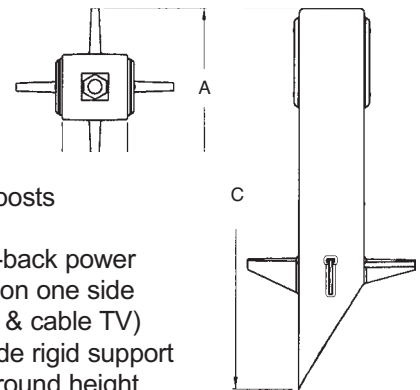

GARD-N-POST



GP19B



GP26G

Features and Benefits

- Molded-in color is permanent – unlike painted posts where lawn equipment chips the color off
- Openings on both sides of the post for back-to-back power
- Low voltage separator provided for Power use on one side and Low Voltage on the other (phone, security, & cable TV)
- Built-in stabilizers need no assembly and provide rigid support
- GP19's stabilizers offer greater use of above ground height
- GP26's taller design provides additional height for wiring devices and increased burial depth
- Angle cut post for easy access to underground wiring
- (2) 1/2" KO's for a UL Listed enclosure

OPENINGS ON BOTH SIDES!



Install one or two GFCI Wiring Devices with Weatherproof Cover...

Or add the Low Voltage Separator and run Low Voltage on one side and Power on the other!

Comes complete with...

Installed 3/4" x 1/2" NPT metal reducing bushing, locknut with copper ground wire for fixture installation, (2) blank device plates, gaskets & screws, plug for top hole (when fixture is not installed), low voltage separator, and removable KO plate.

19.5" Low-Profile Enclosure with Built-in Cover

For use with a GFCI device. Features clear, weatherproof-in-use cover. UV rated plastic for long outdoor life. Four non-chipping colors.



CATALOG NUMBER	UPC/DCI/NAED MFG #018997	DESCRIPTION	UNIT PKG	STD PKG	DIM A	DIM B	DIM C	DIM D
GPD19B	77020	Black	1	6	7.761	6.269	8.177	19.500
GPD19BR	77021	Bronze	1	6	7.761	6.269	8.177	19.500
GPD19G	77022	Green	1	6	7.761	6.269	8.177	19.500
GPD19W	77023	White	1	6	7.761	6.269	8.177	19.500

Add suffix "GC" to Catalog # when ordering in Canada, for example GPD19BGC. Refer to K-18 for replacement cover DBPV1C.



CSA listed with grounding lug.

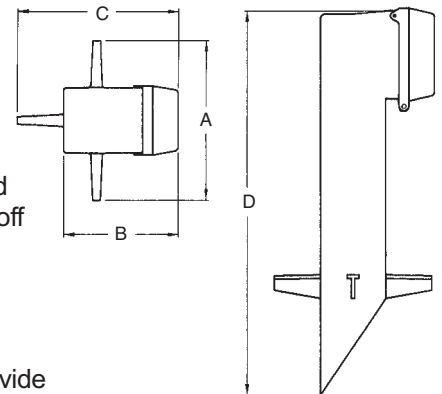

Features and Benefits

- Molded-in color is permanent – unlike painted posts where lawn equipment chips the color off
- Includes clear cover for weatherproof while-in-use, GFCI and duplex wall plates
- Installed cover, no gasket necessary
- Meets NEC box support requirements
- Built-in stabilizers need no assembly and provide rigid support
- Code approved installation
- No chipping...colorant runs throughout the product
- Extra Duty Rated

Meets 2011 NEC code requirements for 406.9 (B) (1) When "extra-duty" is required.

Compare!



Why Install Boxes This Way...



When You Can Have a Great Looking, Long-Lasting Job Like This!

Comes with...
Built-in weatherproof-while-in-use cover, standard duplex & GFCI cover plates, and removable KO plate.

GARD-N-POST



35" GARD-N-POST™ Bollard Kit

GARD-N-POST with pagoda-style light fixture included. Post is UV rated plastic for long outdoor life. Two non-chipping colors.

CATALOG NUMBER	UPC/DCI/NAED MFG #018997	DESCRIPTION	UNIT PKG	STD PKG	DIM A	DIM B	DIM C	DIM D	DIM E
GPBK28B	76090	Black	1	1	6.070	6.070	-	28.500	5.000
GPBK35B	77040	Black	1	1	6.070	6.070	35.000	27.000	3.500
GPBK35BR	77041	Bronze	1	1	6.070	6.070	35.000	27.000	3.500

Add suffix "GC" to Catalog # when ordering in Canada, for example GPBK35BGC.



CSA listed with grounding lug.

E170558 LR49636

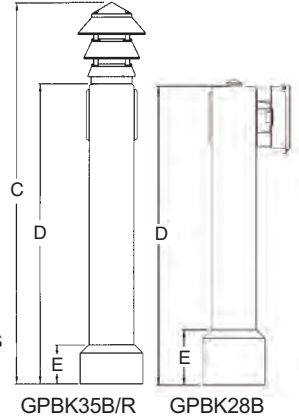
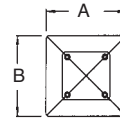

Features and Benefits

- Molded-in color is permanent – unlike painted posts where lawn equipment chips the color off
- Openings on both sides of the post for back-to-back power
- Low voltage separator provided for Power use on one side and Low Voltage on the other (phone, security, & cable TV)
- Perfect for wood decks, boat docks, and concrete walkways
- Makes a very low cost bollard
- Kit includes everything needed for installation, except anchor bolts, caulking, and bulb.
- Includes Arlington's Large Louvered Pagoda Light Fixture
- (2) combination KOs for a UL Listed enclosure



GPBK35B/R

GPBK28B

GARD-N-POST

Kit comes with... GARD-N-POST & metal stabilizer, boot, (pagoda light fixture & decorative spacer or IN-AND-OUT™ cover), (2) blank device plates with gaskets & screws, low voltage separator, and removable KO plate with screws.

Recommended anchors (not included)...
Concrete: (4) 3/8" x 2-1/2 Tapcons®
Cast-In-Place Concrete: (4) 3/8" anchor bolts
Wood Deck: (4) 3/8" bolts with nuts and washers

Tapcons® is a registered trademark of ITW Buildex.

Installation Instructions



1 Metal support post attaches easily to surface.



2 The non-metallic GARD-N-POST slides over the support post.



3 Both posts are held firmly in place with the supplied screws.



4 Place decorative curb over GARD-N-POST. Slide it down to cover the installation.



5 Press fit spacer to base of lamp.



6 Install pagoda light to post with locknut inside the top of the post. Wire fixture.

37" GARD-N-POST™ Support for Outdoor Light Fixtures

Two-piece, super tall GARD-N-POST™. Supports most light fixtures and/or GFCI wiring devices. UV rated plastic for long outdoor life. Four non-chipping colors.

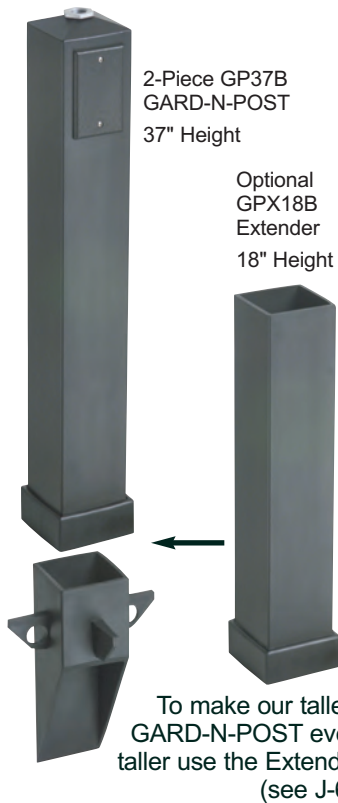

Add the Low Voltage Separator to run Low Voltage on one side and Power on the other!

CATALOG NUMBER	UPC/DCI/NAED MFG #018997	DESCRIPTION	UNIT PKG	STD PKG	DIM A	DIM B	DIM C	DIM D
GP37B	76153	Black	1	4	9.000	4.000	25.000	12.000
GP37BR	76154	Bronze	1	4	9.000	4.000	25.000	12.000
GP37G	76156	Green	1	4	9.000	4.000	25.000	12.000
GP37W	76155	White	1	4	9.000	4.000	25.000	12.000

Add suffix "GC" to Catalog # when ordering in Canada, for example GP37BGC.

See GPX18 Extender (optional) on page J-6.



CSA listed with grounding lug.

E170558 LR49636

2-Piece SUPER TALL GARD-N-POST

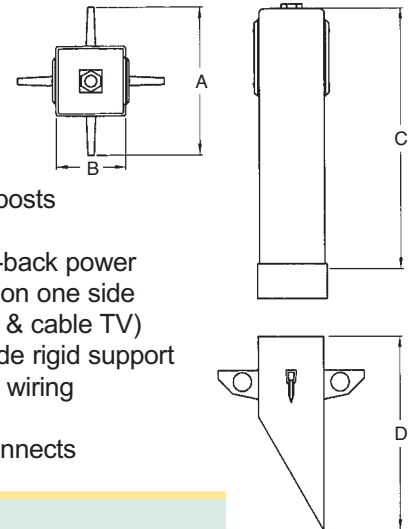

Features and Benefits

- Molded-in color is permanent – unlike painted posts where lawn equipment chips the color off
- Openings on both sides of the post for back-to-back power
- Low voltage separator provided for Power use on one side and Low Voltage on the other (phone, security, & cable TV)
- Built-in stabilizers need no assembly and provide rigid support
- Angle cut post for easy access to underground wiring
- (2) combination KOs for a UL Listed enclosure
- May be field modified for time clocks and disconnects



To assemble (with or without the Extender) use standard PVC cement.



Comes complete with...

Installed 3/4" x 1/2" NPT metal reducing bushing, locknut with copper ground wire for fixture installation, (2) blank device plates, gaskets & screws, plug for top hole (when fixture is not installed), low voltage separator, and removable KO plate.



9" Post/Deck Mount Support for Outdoor Light Fixtures

Two-piece. Mounts most light fixtures and/or a GFCI wiring device on a 4x4 post or deck. UV rated plastic for long outdoor life. Four non-chipping colors.



CATALOG NUMBER	UPC/DCI/NAED MFG #018997	DESCRIPTION	UNIT PKG	STD PKG	DIM A	DIM B	DIM C	DIM D
GPD9B	76161	Black	1	6	3.375	3.375	9.000	.250
GPD9BR	76162	Bronze	1	6	3.375	3.375	9.000	.250
GPD9G	76164	Green	1	6	3.375	3.375	9.000	.250
GPD9W	76163	White	1	6	3.375	3.375	9.000	.250

Add suffix "GC" to Catalog # when ordering in Canada, for example GPD9BGC.



CSA listed with grounding lug.

E170558 LR49636

Features and Benefits

- Molded-in color is permanent – unlike painted posts where lawn equipment chips the color off
- (2) 1/2" KOs for a UL Listed enclosure
- Metal grounding bushing assembly included

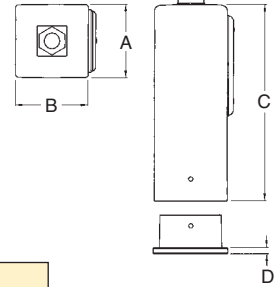

Comes complete with...

Installed 3/4" x 1/2" NPT metal reducing bushing, locknut with copper ground wire for fixture installation, blank device plate, gasket & screws, plug for top hole (when fixture is not installed), removable KO plate, and mounting base.

GARD-N-POST



Install on a 4x4 post...or a dock!



GPD9B shown with light fixture

Optional 18" Extender for 37"/40" Support

Add to GP37 in 18" increments for even more height...up to 73".



CATALOG NUMBER	UPC/DCI/NAED MFG #018997	DESCRIPTION	UNIT PKG	STD PKG	DIM A	DIM B
GPX18B	76157	Black	1	4	18.000	4.000
GPX18BR	76158	Bronze	1	4	18.000	4.000
BPX18G	76160	Green	1	4	18.000	4.000
GPX18W	76159	White	1	4	18.000	4.000

Use with GP37 on page J-4.



E170558 LR49636



Use the Extender to make the 37"/40" GARD-N-POST even taller: add *one* 18" Extender for a 55" height; add a *second* Extender for 73"! For even more options, the GPX18 may be cut (top end only) to *any* desired height!

When assembling the Extender with GP37 (see J-5) use standard PVC cement.

19.5" Low-Profile Support Just for Outdoor Light Fixtures

For use with light fixtures exclusively. Accommodates most fixture styles. UV rated plastic for long outdoor life. Four non-chipping colors.



CATALOG NUMBER	UPC/DCI/NAED MFG #018997	DESCRIPTION	UNIT PKG	STD PKG	DIM A	DIM B	DIM C
GPL19B	77000	Black	1	6	7.125	2.250	19.500
GPL19BR	77001	Bronze	1	6	7.125	2.250	19.500
GPL19G	77002	Green	1	6	7.125	2.250	19.500
GPL19W	77003	White	1	6	7.125	2.250	19.500



E170558 LR49636

Features and Benefits

- Molded-in color is permanent – unlike painted posts where lawn equipment chips the color off
- Streamline design...one of our most competitively priced 19.5" GARD-N-POSTs
- Removable 1/2" KO in cover for photocell installation
- Metal bushing with ground wire for 2- or 3-wire fixtures
- Resists damage from lawn equipment

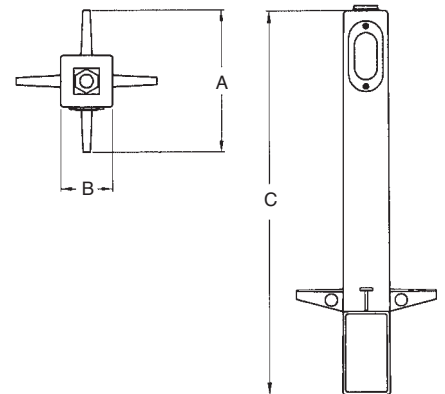

Comes complete with... Access panel cover, gasket, installed 3/4" x 1/2" NPT metal grounding bushing and locknut with copper ground wire for fixture installation.



19.5" Low-Profile Support Just for 3-Wire Outdoor Light Fixtures

Non-metallic bushing exclusively for 3-wire light fixtures. UV rated plastic for long outdoor life.



CATALOG NUMBER	UPC/DCI/NAED MFG #018997	DESCRIPTION	UNIT PKG	STD PKG	DIM A	DIM B	DIM C
GPLN19B	69108	Black	1	6	7.125	2.250	19.500
GPLN19BR	76192	Bronze	1	6	7.125	2.250	19.500



Features and Benefits

- Molded-in color is permanent – unlike painted posts where lawn equipment chips the color off
- Streamline design...one of our most competitively priced 19.5" GARD-N-POSTs
- Designed for 3-wire light fixtures
- Comes with a 3/4" NPT threaded opening and an installed 3/4" x 1/2" non-metallic reducing bushing for use with 1/2" or 3/4" NPT fixtures.
- Installed cover

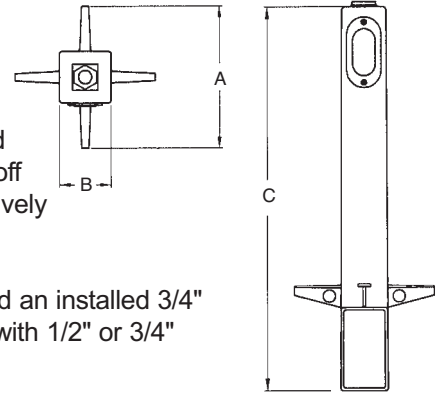

Comes complete with...

Access panel cover, gasket, installed 3/4" x 1/2" NPT non-metallic bushing for fixture installation.

GPLN19B shown with light fixture



GARD-N-POST

15" Low-Profile Support Just for 3-Wire Outdoor Light Fixtures

Non-metallic bushing exclusively for 3-wire light fixtures. UV rated plastic for long outdoor life.



CATALOG NUMBER	UPC/DCI/NAED MFG #018997	DESCRIPTION	STD PKG	DIM A	DIM B	DIM C
GPLN15B	76205	Black	10	2.250	2.250	15.000
GPLN15GR	76181	Gray	10	2.250	2.250	15.000



Features and Benefits

- Streamline design...our most competitively priced GARD-N-POST
- Designed for 3-wire light fixtures
- Comes with a 3/4" NPT threaded opening, and an installed 3/4" x 1/2" non-metallic reducing bushing for use with 1/2" or 3/4" NPT fixtures.
- Installed cover
- Molded-in color is permanent – unlike painted posts where lawn equipment chips the color off

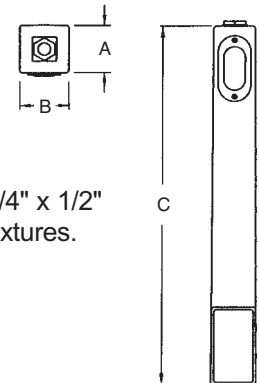

Comes complete with...

Access panel cover, gasket, installed 3/4" x 1/2" NPT non-metallic bushing for fixture installation.



Low Profile IN BOX™ for New Brick Construction

Recessed electrical box with weatherproof-in-use cover for new brick construction. Non-metallic cover and base. Accepts most single gang wiring devices and uses standard indoor wall plates or a FGCI cover plate. Box and white cover are textured/paintable. UV rated plastic for long outdoor life.



DBHB1C

Features and Benefits

- IN BOX's one-piece assembly replaces the installation of an electrical box, siding block, and bubble cover assembly
- Built-in anchor tabs seat IN BOX sleeve into mortar for a super secure installation
- Installs in the wall, so less of it shows outside
- Installed, disposable, mud cover extends all the way over the flange, providing maximum protection during construction
- Install option: Cover is removable for easier device installation
- No gaskets required



Bug Plugs ship installed in all IN BOX styles to seal unused cord hole openings.

CATALOG NUMBER	UPC/DCI/NAED MFG #018997	ORIENTATION/COVER COLOR	UNIT	STD	DIM A	DIM B	DIM C	DIM D	DIM E
DBHB1C	77628	Horizontal/Clear	1	4	4.934	7.186	5.160	1.313	3.847
DBHB1W	77630	Horizontal/White	1	4	4.934	7.186	5.160	1.313	3.847

Replacement covers available on page K-17.



WEATHERPROOF-IN-USE

IN BOX for new brick includes...

Box with weatherproof-in-use cover, installed bug plugs, (1) standard duplex, (1) standard GFCI face plate, installation screws, (1) NM cable connector, and an in-place, disposable mud cover.

22 cu. in.

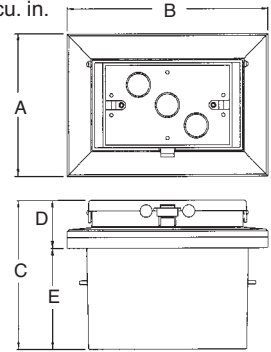

Installed Shots



Oversized, installed mud cover offers maximum protection because it extends over the entire flange.



Completed installation with weatherproof-in-use cover. DBHB1C shown.

Note: Meets 2011 NEC Section 406-9; for the protection of exterior outlets which require DBHB1BRC. The use of a weatherproof while-in-use cover for all outdoor 15 or 20 AMP receptacles.

Low Profile IN BOX™ for New Vinyl Siding Construction

One-piece, recessed electrical box with weatherproof-in-use cover for new siding applications. Non-metallic cover and base. Accepts most single gang wiring devices and uses standard indoor wall plates or a GFCI cover plate. Box and white cover are textured/paintable. UV rated plastic for long outdoor life.



See page K-8 for our NEW 2-Gang style!

DBVS1C

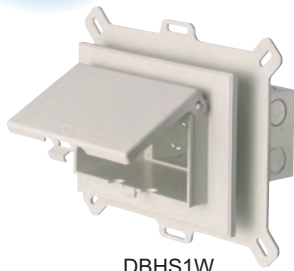

DBHS1W

Features and Benefits

- IN BOX's one-piece assembly replaces the installation of an electrical box, siding block, and bubble cover assembly
- Installs in the wall, so less of it shows outside
- Outer flange covers cut ends of siding
- Install option: Cover is removable for easier device installation
- No gaskets required



Bug Plugs ship installed in all IN BOX styles to seal unused cord hole openings.

CATALOG NUMBER	UPC/DCI/NAED MFG #018997	ORIENTATION/ COVER COLOR	SIDING TYPE	UNIT PKG	STD PKG	DIM A	DIM B	DIM C	DIM D	DIM E
DBVS1C	14317	Vertical/Clear	All Types	1	4	9.058	7.012	5.160	1.313	2.879
DBVS1W	14318	Vertical/White	All Types	1	4	9.058	7.012	5.160	1.313	2.879
DBHS1C	77600	Horizontal/Clear	All Types	1	4	7.012	9.058	5.160	1.313	2.879
DBHS1W	77602	Horizontal/White	All Types	1	4	7.012	9.058	5.160	1.313	2.879

Add suffix "GC" to Catalog # when ordering in Canada, for example DBVS1CGC.

Replacement covers available on page K-17.

2-Gang style available on page K-8.



WEATHERPROOF-IN-USE

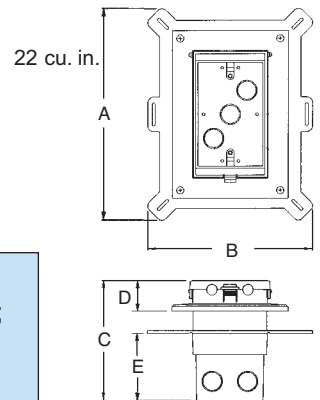

IN BOX for new siding includes...

Box with weatherproof-in-use cover; installed bug plugs; (1) standard duplex and (1) standard GFCI face plate; installation screws; and (1) NM cable connector.

Installation Instructions



1 Cut a 3-1/4" x 5-1/2" hole in substrate. Pull wiring.

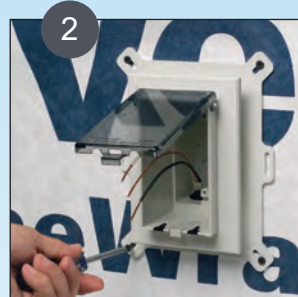

2 Install NM cable connector and wire, attach IN BOX to substrate.

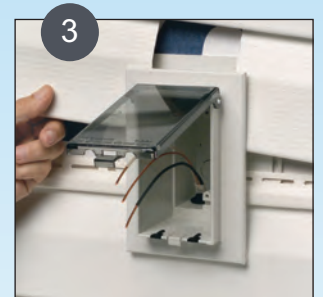

3 Install siding, inserting the cut ends of the siding under the outer flange of the IN BOX.



4 Install wiring device per manufacturer's instructions, Local and National Electrical Codes.



Accepts most single gang wiring devices and uses a standard indoor wall plate.



Completed installation with weatherproof-in-use cover. DBVS1C shown.

Note: Meets 2011 NEC Section 406-9; for the protection of exterior outlets which require the use of a weatherproof while-in-use cover for all outdoor 15 or 20 AMP receptacles.

Scan For Video





Low Profile IN BOX™ for New Construction Stucco, Textured Surfaces, and Rigid Siding

One-piece, recessed electrical box with weatherproof-in-use cover for stucco over masonry or wood construction. Also for cementitious/fiber rigid lap siding. Non-metallic cover and base. Accepts most single gang wiring devices and uses standard indoor wall plates or a GFCI cover plate. Box and white cover are textured/paintable. UV rated plastic for long outdoor life.

See page K-8 for our NEW 2-Gang style!

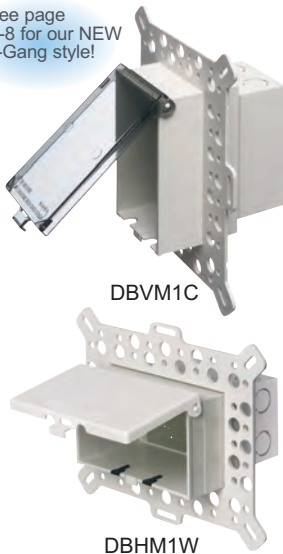

Features and Benefits

- One-piece assembly replaces the installation of an electrical box and bubble cover assembly
- Installs in the wall, so less of it shows outside
- Holes in flange allow stucco to bond firmly
- Install option: Cover is removable for easier device installation

CATALOG NUMBER	UPC/DCI/NAED MFG #018997	ORIENTATION/COVER COLOR	UNIT PKG	STD PKG	DIM A	DIM B	DIM C	DIM D	DIM E
DBVM1C	14315	Vertical/Clear	1	4	9.058	7.012	5.160	1.805	3.222
DBVM1W	14316	Vertical/White	1	4	9.058	7.012	5.160	1.805	3.222
DBHM1C	77608	Horizontal/Clear	1	4	7.012	9.058	5.160	1.805	3.222
DBHM1W	77610	Horizontal/White	1	4	7.012	9.058	5.160	1.805	3.222

Add suffix "GC" to Catalog # when ordering in Canada, for example DBVM1CGC.

Replacement covers available on page K-17.
2-Gang style available on page K-8.



WEATHERPROOF-IN-USE



Bug Plugs ship installed in all IN BOX styles to seal unused cord hole openings.

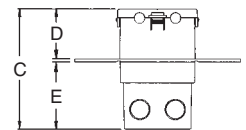
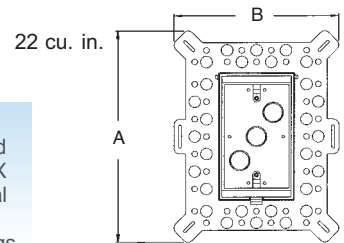

IN BOX for new stucco, textured surfaces, and rigid siding includes...Box with weatherproof-in-use cover; installed bug plugs; (1) standard duplex and (1) standard GFCI face plate; (1) NM cable connector; block bushing with washer; and an in-place, disposable mud cover.

Note: Additional Installation Methods shown on page J-13.

Installation Instructions for New Masonry Construction

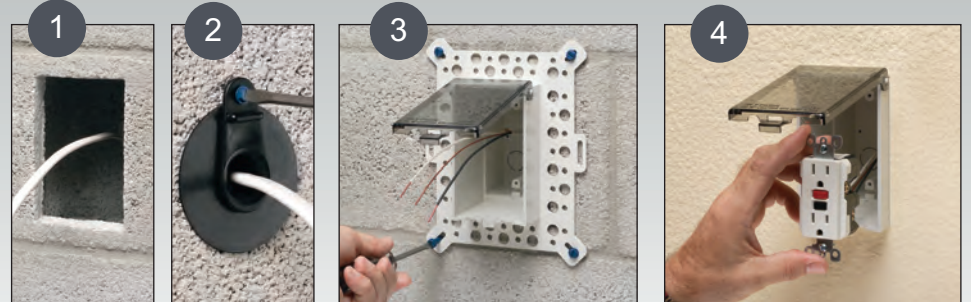

1. Make a 3-1/4" x 5-1/2" hole in block. Pull wiring through plastic block bushing and opening in block. Block bushing mounts to interior side of block.

3. Install NM cable connector and wire. Attach recessed IN BOX to block. Holes in flange allow stucco to bond firmly.

4. Install wiring device per manufacturer's instructions, Local, and National Electrical Codes. Accepts most devices and a standard indoor wall plate.



Completed installation with weatherproof-in-use cover. DBVM1C shown.

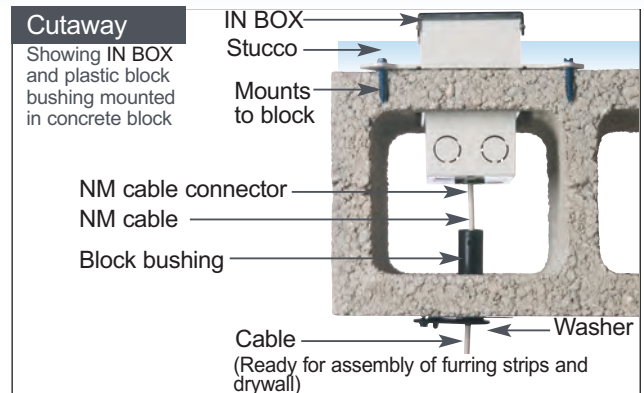

Note: Meets 2011 NEC Section 406-9; for the protection of exterior outlets which require the use of a weatherproof while-in-use cover for all outdoor 15 or 20 AMP receptacles.

IN BOX

Scan For Video



Additional **New Construction** Installation Methods for the DBVM1 & DBHM1 series.

Installation Instructions for **Wood Substrate Stucco**

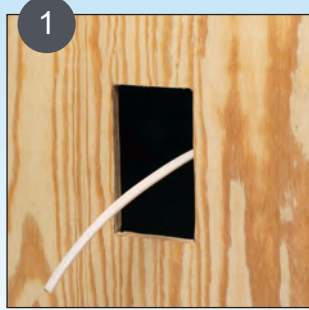

1
Make a 3-1/4" x 5-1/2" hole in plywood. Pull wiring through opening.

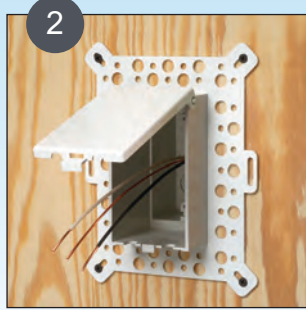

2
Install NM cable connector and wire. Attach recessed IN BOX to plywood.



3
IN BOX is ready for stucco.



4
Install wiring device per manufacturer's instructions, Local, and National Electrical Codes. Accepts most devices and a standard indoor wall plate. DBVM1W shown.

Installation Instructions for **New Rigid Siding - Method 1**

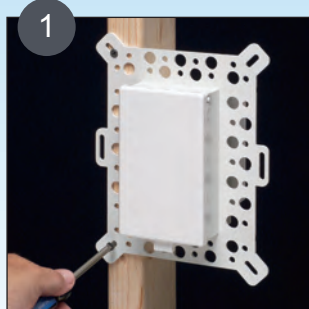

1
Install NM cable connector and wire. Attach IN BOX to stud.



2
Install moisture barrier around IN BOX per manufacturer's instructions.

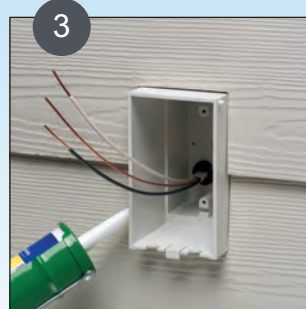

3
Cut rigid siding to fit around IN BOX. Caulk around box.



4
Install wiring device per manufacturer's instructions, Local, and National Electrical Codes. Accepts most devices and a standard indoor wall plate. DBVM1W shown.

Installation Instructions for **New Rigid Siding - Method 2**

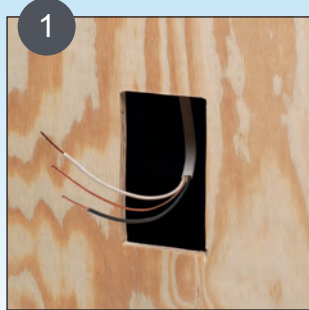

1
Make a 3-1/4" x 5-1/2" hole in plywood. Pull wiring through opening.

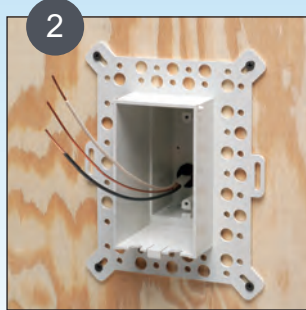

2
Install NM cable connector and wire. Attach recessed IN BOX to substrate, then install moisture barrier around box as shown above in Method 1.

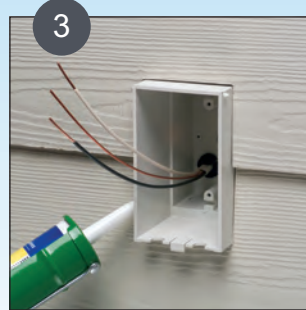

3
Cut rigid siding to fit around IN BOX. Caulk around box.



4
Install wiring device per manufacturer's instructions, Local, and National Electrical Codes. Accepts most devices and a standard indoor wall plate. DBVM1W shown.



Low Profile IN BOX™ for Retrofit Siding Construction

Recessed electrical box with weatherproof-in-use cover for existing siding construction. Non-metallic cover and base. Accepts most single gang wiring devices and uses standard indoor wall plates or a GFCI cover plate. Box and white cover are textured/paintable. UV rated plastic for long outdoor life.



DBVR131C

Features and Benefits

- IN BOX's one-piece assembly replaces the installation of an electrical box, siding block, and bubble cover assembly
- Installs in the wall, so less of it shows outside
- Install option: Cover is removable for easier device installation
- No gaskets required

Siding Profiles

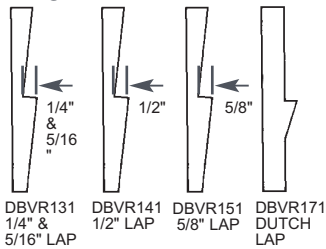

Bug Plugs ship installed in all IN BOX styles to seal unused cord hole openings.

CATALOG NUMBER	UPC/DCI/NAED MFG #018997	ORIENTATION/COVER COLOR	SIDING LAP SIZE	UNIT PKG	STD PKG	DIM A	DIM B	DIM C	DIM D	DIM E
DBVR131C	14370	Vertical/Clear	1/4" or 5/16"	1	4	7.186	4.934	5.160	1.567	3.539
DBVR131W	14375	Vertical/White	1/4" or 5/16"	1	4	7.186	4.934	5.160	1.567	3.539
DBVR141C	14371	Horizontal/Clear	1/2"	1	4	7.186	4.934	5.160	1.567	3.539
DBVR141W	14376	Horizontal/White	1/2"	1	4	7.186	4.934	5.160	1.567	3.539
DBVR151C	14372	Vertical/Clear	5/8"	1	4	7.186	4.934	5.160	1.567	3.539
DBVR151W	14377	Vertical/White	5/8"	1	4	7.186	4.934	5.160	1.567	3.539
DBVR171C	14373	Horizontal/Clear	Dutch	1	4	7.186	4.934	5.160	1.567	3.539
DBVR171W	14378	Horizontal/White	Dutch	1	4	7.186	4.934	5.160	1.567	3.539

*Add suffix "GC" to Catalog # when ordering in Canada, for example DBVR131CGC. Replacement covers available on page K-17.



E170558 LR49636

WEATHERPROOF-IN-USE

22 cu. in.

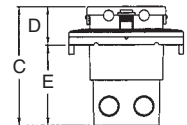
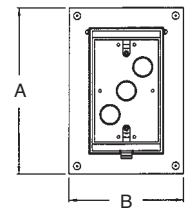

IN BOX for retrofit siding includes...

Box with weatherproof-in-use cover, installed bug plugs, siding profile adapter plate, (1) standard duplex and (1) standard GFCI face plate, (2) sets installation screws, (1) NM cable connector, and (2) rolls of caulk.

Installation Instructions for Existing Siding



Using the siding profile adapter plate as a template, cut hole in existing siding. Pull wiring.

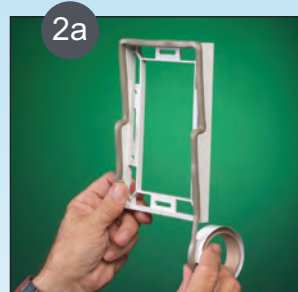

Apply caulk around edges of back of adapter. Press onto siding.

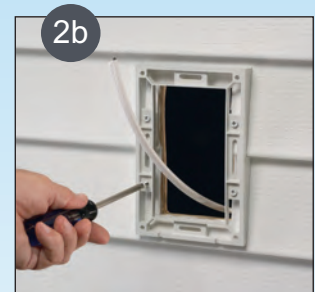

Attach adapter to siding with provided short screws. Trim excess caulk as needed.

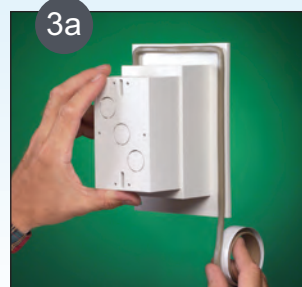

Apply caulk to reverse side of IN BOX flange.



Install NM cable connector and wire, then attach with provided long screws. Trim excess caulk as needed. Install wiring device per manufacturer's instructions, Local and National Electrical Codes.

Note: Meets 2011 NEC Section 406-9; for the protection of exterior outlets which require the use of a weatherproof while-in-use cover for all outdoor 15 or 20 AMP receptacles.

Low Profile IN BOX™ for Retrofit Siding Construction

Recessed electrical box with weatherproof-in-use cover for existing siding construction. Non-metallic cover and base. Accepts most single gang wiring devices and uses standard indoor wall plates or a GFCI cover plate. Box and white cover are textured/paintable. UV rated plastic for long outdoor life.



DBHR131W

Features and Benefits

- IN BOX's one-piece assembly replaces the installation of an electrical box, siding block, and bubble cover assembly
- Installs in the wall, so less of it shows outside
- Install option: Cover is removable for easier device installation
- No gaskets required

Siding Profiles

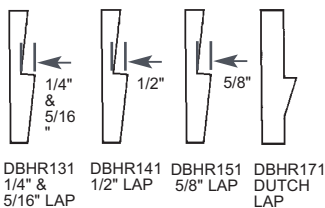

Bug Plugs ship installed in all IN BOX styles to seal unused cord hole openings.

CATALOG NUMBER	UPC/DCI/NAED MFG #018997	ORIENTATION/COVER COLOR	SIDING LAP SIZE	UNIT PKG	STD PKG	DIM A	DIM B	DIM C	DIM D	DIM E
DBHR131C	77612	Vertical/Clear	1/4" or 5/16"	1	4	4.934	7.186	5.160	1.567	3.539
DBHR131W	77614	Vertical/White	1/4" or 5/16"	1	4	4.934	7.186	5.160	1.567	3.539
DBHR141C	77616	Horizontal/Clear	1/2"	1	4	4.934	7.186	5.160	1.567	3.539
DBHR141W	77618	Horizontal/White	1/2"	1	4	4.934	7.186	5.160	1.567	3.539
DBHR151C	77620	Vertical/Clear	5/8"	1	4	4.934	7.186	5.160	1.567	3.539
DBHR151W	77622	Vertical/White	5/8"	1	4	4.934	7.186	5.160	1.567	3.539
DBHR171C	77624	Horizontal/Clear	Dutch	1	4	4.934	7.186	5.160	1.567	3.539
DBHR171W	77626	Horizontal/White	Dutch	1	4	4.934	7.186	5.160	1.567	3.539

*Add suffix "GC" to Catalog # when ordering in Canada, for example DBHR131WGC. Replacement covers available on page K-17.



E170558 LR49636

WEATHERPROOF-IN-USE

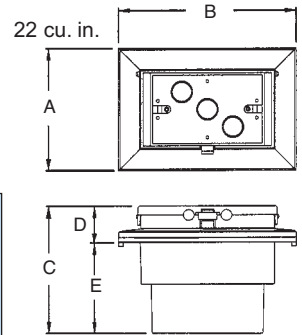

IN BOX for retrofit siding includes...

Box with weatherproof-in-use cover, installed bug plugs, siding profile adapter plate, (1) standard duplex and (1) standard GFCI face plate, (2) sets installation screws, (1) NM cable connector, and (2) rolls of caulk.

Installation Instructions for Existing Siding



Using the siding profile adapter plate as a template, cut hole in existing siding. Pull wiring.

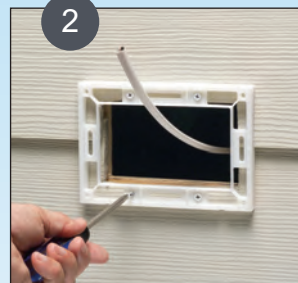

Apply caulk around edges of back of adapter (see page J-14, step 2a). Press onto siding. Attach adapter to siding with provided short screws. Trim excess caulk as needed.



Apply caulk to reverse side of IN BOX flange (see page J-14, step 3a). Install NM cable connector and wire, then attach with provided long screws. Trim excess caulk as needed.



Install wiring device per manufacturer's instructions, Local and National Electrical Codes. Completed installation with weatherproof-in-use cover. DBHR131W shown.

Note: Meets 2011 NEC Section 406-9; for the protection of exterior outlets which require the use of a weatherproof while-in-use cover for all outdoor 15 or 20 AMP receptacles.



Low Profile IN BOX™ for Flat Surface Retrofit Construction

One-piece, recessed electrical box with weatherproof-in-use cover for flat surfaces in existing construction. Non-metallic cover and base. Accepts most single gang wiring devices and uses standard indoor wall plates or a GFCI cover plate. Box and white cover are textured/paintable. UV rated plastic for long outdoor life.

See page K-8 for our NEW 2-Gang style!



DBVR1C



DBHR1W

Features and Benefits

- IN BOX's one-piece assembly replaces the installation of an electrical box and bubble cover assembly
- Installs in the wall, so less of it shows outside
- Use the retrofit IN BOX on plywood, T-111, and other flat surfaces.
- Install option: Cover is removable for easier device installation
- No gaskets required

CATALOG NUMBER	UPC/DCI/NAED MFG #018997	ORIENTATION/COVER COLOR	UNIT PKG	STD PKG	DIM A	DIM B	DIM C	DIM D	DIM E
DBVR1C	14313	Vertical/Clear	1	4	7.186	4.934	5.160	1.313	3.847
DBVR1W	14314	Vertical/White	1	4	7.186	4.934	5.160	1.313	3.847
DBHR1C	77604	Horizontal/Clear	1	4	4.934	7.186	5.160	1.313	3.847
DBHR1W	77606	Horizontal/White	1	4	4.934	7.186	5.160	1.313	3.847

Add suffix "GC" to Catalog # when ordering in Canada, for example DBVR1CGC. Replacement covers and siding profiles to convert for use on existing siding available on page K-17. 2-Gang style available on page K-17.



E170558 LR49636

WEATHERPROOF-IN-USE



Bug Plugs ship installed in all IN BOX styles to seal unused cord hole openings.

22 cu. in.

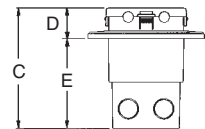
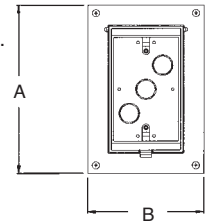

IN BOX for retrofit, flat surfaces includes...
Box with weatherproof-in-use cover; installed bug plugs; (1) standard duplex and (1) standard GFCI face plate; (1) set installation screws; (1) NM cable connector; and (1) roll of caulk.

Installation Instructions

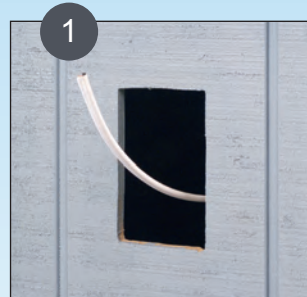

1 Cut a 3-1/4" x 5-1/2" hole in substrate. Pull wiring.



2 Apply the supplied caulk around back edges of flange. Install NM cable connector and wire, then press onto surface.



3 Attach IN BOX with stainless steel screws (provided).



4 Install wiring device per manufacturer's instructions, Local and National Electrical Codes.



Accepts most single gang wiring devices, and uses a standard indoor wall plate. DBVR1C shown.



DBVR1W shown. *IN BOX Saves Time. Looks Great!*

Note: Meets 2011 NEC Section 406-9; for the protection of exterior outlets Which require the use of a weatherproof while-in-use cover for all outdoor 15 or 20 AMP receptacles.

Scan For Video



Two-Gang, Low Profile IN BOX™

Two-gang, recessed electrical box with weatherproof-in-use cover for flat surfaces, masonry, retrofit, and siding construction (see below for product use). Non-metallic cover and base. Installs two outlets or combo devices. Box and white cover are textured/ paintable. UV rated plastic for long outdoor life.

See pages K-3 for more information.

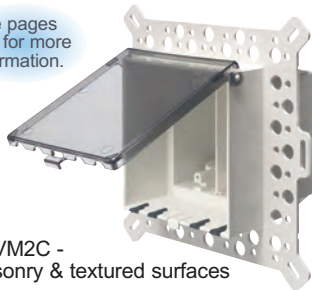

DBVM2C - Masonry & textured surfaces

See page K-7 for more information.



DBVR2W - Flat surfaces

See page K-2 for more information.



DBVS2C - Vinyl siding



Bug Plugs ship installed in all IN BOX styles to seal unused cord hole openings.

CATALOG NUMBER	UPC/DCI/NAED MFG #018997	DESCRIPTION/ COVER COLOR	UNIT	STD PKG	DIM A	DIM B	DIM C	DIM D	DIM E
DBVM2C	03962	2-Gang, Vertical/Clear	1	4	9.0588	8.9925	1.142	1.805	3.222
DBVM2W	03963	2-Gang, Vertical/White	1	4	9.0588	8.9925	1.142	1.805	3.222
DBVR2C	03964	2-Gang, Vertical/Clear	1	4	7.1596	8.8885	1.142	1.295	3.847
DBVR2W	03965	2-Gang, Vertical/White	1	4	7.1596	8.8885	1.142	1.295	3.847
DBVS2C	03960	2-Gang, Vertical/Clear	1	4	9.0588	8.9925	1.142	1.313	2.879
DBVS2W	03961	2-Gang, Vertical/White	1	4	9.0588	8.9925	1.142	1.313	2.879

Add suffix "GC" to Catalog # when ordering in Canada, for example DBVM2CGC.
2-Gang, replacement covers available on page K-17.



E170558 LR49636

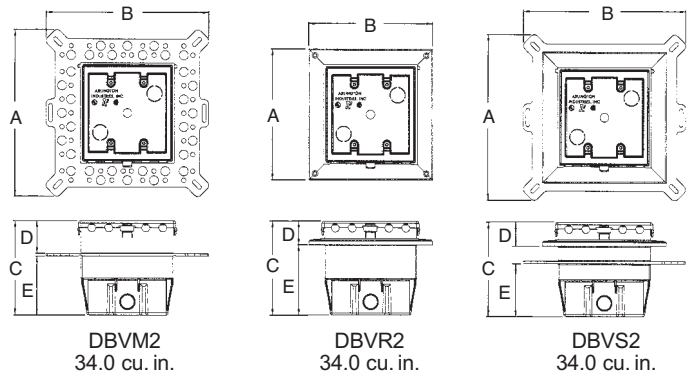

WEATHERPROOF-IN-USE

Two-Gang IN BOX includes...

Box with weatherproof-in-use cover; installed bug plugs; (1) decorator wall plate; and (2) NM cable connectors. DBVM2 also includes a block bushing with washer; and an in-place, disposable mud cover. DBVR2 also includes (1) set installation screws; and (1) roll of caulk. DBVS2 also includes (1) set installation screws.



Completed installation, DBVS2C shown.

Features and Benefits

- IN BOX's one-piece assembly replaces the installation of an electrical box and bubble cover assembly
- Installs in the wall, so less of it shows outside
- No gaskets required
- For flat surfaces, vinyl siding, stucco over masonry or wood (with or without lath), and retrofit
- Install an outlet and a switch, or two switches in one location
- Includes 1/2" and 3/4" NM cable connectors and a two-gang rectangular device plate

Note: Meets 2011 NEC Section 406-9; for the protection of exterior outlets which require the use of a weatherproof while-in-use cover for all outdoor 15 or 20 AMP receptacles.

Scan For Video





Low Profile IN BOX™ with Adapter Sleeve or New Brick Construction

Recessed electrical box with weatherproof-in-use cover for new brick construction. Includes a protective adapter sleeve that keeps mortar out. Non-metallic cover and base. Accepts most single gang wiring devices and uses standard indoor wall plates or a GFCI cover plate. White box and cover are textured/paintable. UV rated plastic for long outdoor life.



DHB1BRC

Features and Benefits

- IN BOX's one-piece assembly replaces the installation of an electrical box and bubble cover assembly
- Adapter sleeve, with loops in back for tying off cable, keeps mortar out of the box while brick mason works
- The clean IN BOX slips into the sleeve for easy installation!
- Built-in anchor tabs seat IN BOX sleeve into mortar for a super secure installation
- Installs in the wall, so less of it shows outside
- Install option: Cover is removable for easier device installation
- No gaskets required



Bug Plugs ship installed in all IN BOX styles to seal unused cord hole openings.

CATALOG NUMBER	UPC/DCI/NAED MFG #018997	DESCRIPTION/COVER COLOR	UNIT	STD	DIM A	DIM B	DIM C	DIM D	DIM E
DHB1C	54880	Horiz./Clear Cover/White Box	1	4	4.934	7.186	5.283	1.658	3.625
DHB1W	54882	Horiz./White Cover/White Box	1	4	4.934	7.186	5.283	1.658	3.625
DHB1BRC	54881	Horiz./Clear Cover/Brown Box	1	4	4.934	7.186	5.283	1.658	3.625
DHB1BR	54875	Horiz./Brown Cover/Brown Box	1	4	4.934	7.186	5.283	1.658	3.625
DVB1C	43609	Vertical/Clear Cover/White Box	1	4	7.186	4.934	5.283	1.658	3.625
DVB1W	43620	Vertical/White Cover/White Box	1	4	7.186	4.934	5.283	1.658	3.625
DVB1BRC	43608	Vertical/Clear Cover/Brown Box	1	4	7.186	4.934	5.283	1.658	3.625
DVB1BR	43595	Vertical/Brown Cover/Brown Box	1	4	7.186	4.934	5.283	1.658	3.625

Add suffix "GC" to Catalog # when ordering in Canada, for example DHB1CGC.
Replacement covers available on page K-17.



WEATHERPROOF-IN-USE

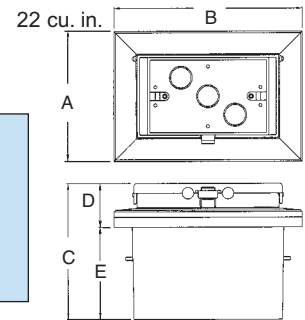

IN BOX for new brick includes...

Box with weatherproof-in-use cover, adapter sleeve, installed bug plugs, (1) standard duplex and (1) standard GFCI face plate, installation screws, (1) NM cable connector, and (1) roll of caulk, disposable mud cover.

Installation Instructions



Mortar in adapter sleeve. Pull wire and tie off to loop in adapter sleeve.



When ready to complete... apply supplied caulk as shown and press around edges of adapter sleeve.



Install the supplied NM cable connector and wire. Insert the clean IN BOX into the sleeve.



Attach IN BOX with screws provided. Install wiring device per manufacturer's instructions, Local and National Electrical Codes.



Accepts most single gang wiring devices, and uses a standard indoor wall plate. DHB1C shown.



Weatherproof-in-use. DHB1BRC shown. *IN BOX Saves Time. Looks Great!*

Note: Meets 2011 NEC Section 406-9; for the protection of exterior outlets which require the use of a weatherproof while-in-use cover for all outdoor 15 or 20 AMP receptacles.

Low Profile IN BOX™ with Metal Box for Flat Surface Retrofit Construction

Recessed, metallic electrical box with non-metallic, weatherproof-in-use cover for flat surfaces in existing construction. Accepts most single gang wiring devices and uses standard indoor wall plates or a GFCI cover plate. Non-metallic portion and covers are UV rated plastic for long outdoor life.

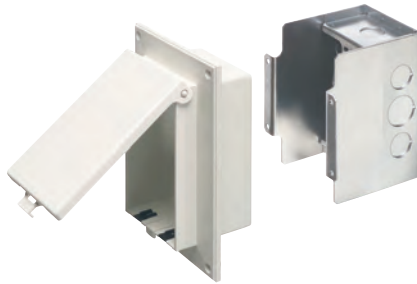

Bug Plugs ship installed in all IN BOX styles to seal unused cord hole openings.

CATALOG NUMBER	UPC/DCI/NAED MFG #018997	ORIENTATION/COVER COLOR	UNIT	STD PKG	DIM A	DIM B	DIM C	DIM D	DIM E
DSBVR1C	09654	Vertical/Clear	1	4	7.196	4.937	5.129	1.283	3.846
DSBVR1W	09655	Vertical/White	1	4	7.196	4.937	5.129	1.283	3.846
DSBHR1C	09656	Horizontal/Clear	1	4	4.937	7.196	5.129	1.283	3.846
DSBHR1W	09657	Horizontal/white	1	4	4.937	7.196	5.129	1.283	3.846

Replacement covers and siding profiles to convert for use on existing siding available on page K-17.



WEATHERPROOF-IN-USE

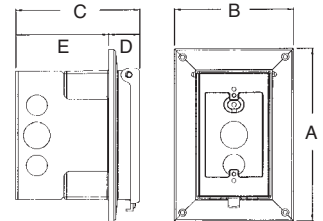

25.0 cu. in.

Note: Meets 2011 NEC Section 406-9; for the protection of exterior outlets which require the use of a weatherproof while-in-use cover for all outdoor 15 or 20 AMP receptacles.

IN BOX for retrofit, flat surfaces includes...

Metallic box with non-metallic, weatherproof-in-use cover; installed bug plugs; (1) standard duplex and (1) standard GFCI face plate; (1) set installation screws; and (1) roll of caulk.

Features and Benefits

- IN BOX replaces the installation of an electrical box and bubble cover assembly
- Installs in the wall, so less of it shows outside
- No gaskets required
- Use the retrofit IN BOX on plywood, T-111, and other flat surfaces
- Install option: Cover is removable for easier device installation
- White, non-metallic portion and white cover are textured/paintable
- Grounding wire provided
- For use with metal raceway systems



Low Profile IN BOX™ with Metal Box for New Vinyl Siding Construction

Recessed, metallic electrical box with non-metallic, weatherproof-in-use cover for new siding applications. Accepts most single gang wiring devices and uses standard indoor wall plates or a GFCI cover plate. Non-metallic portion and covers are UV rated plastic for long outdoor life.

CATALOG NUMBER	UPC/DCI/NAED MFG #018997	ORIENTATION/COVER COLOR	SIDING TYPE	UNIT PKG	STD PKG	DIM A	DIM B	DIM C	DIM D	DIM E
DSBVS1C	09650	Vertical/Clear	All Types	1	4	9.058	7.012	5.129	1.775	3.221
DSBVS1W	09651	Vertical/White	All Types	1	4	9.058	7.012	5.129	1.775	3.221
DSBHS1C	09652	Horizontal/Clear	All Types	1	4	7.012	9.058	5.129	1.775	3.221
DSBHS1W	09653	Horizontal/white	All Types	1	4	7.012	9.058	5.129	1.775	3.221

Replacement covers available on page K-17.



WEATHERPROOF-IN-USE

E48106 LR49636

Note: Meets 2011 NEC Section 406-9; for the protection of exterior outlets which require the use of a weatherproof while-in-use cover for all outdoor 15 or 20 AMP receptacles.

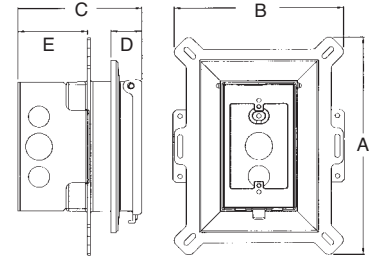

25.0 cu. in.



DSBHS1C

IN BOX for new siding includes...
Metallic box with non-metallic, weatherproof-in-use cover; installed bug plugs; (1) standard duplex and (1) standard GFCI face plate; and (1) set installation screws.

Features and Benefits

- IN BOX replaces the installation of an electrical box, siding block, and bubble cover assembly
- Installs in the wall, so less of it shows outside
- Outer flange covers cut ends of siding
- Install option: Cover is removable for easier device installation
- White, non-metallic portion and white cover are textured/paintable
- Grounding wire provided
- For use with metal raceway systems



Bug Plugs ship installed in all IN BOX styles to seal unused cord hole openings.

Low Profile IN BOX™ with Metal Box for New Construction Stucco, Textured Surfaces, and Rigid Siding

Recessed, metallic electrical box with non-metallic, weatherproof-in-use cover for stucco over masonry or wood construction. Also for cementitious/fiber rigid lap siding. Accepts most single gang wiring devices and uses standard indoor wall plates or a GFCI cover plate. Non-metallic portion and covers are UV rated plastic for long outdoor life.

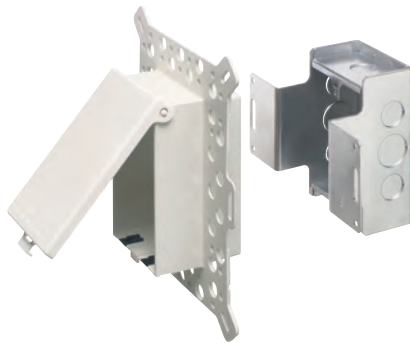

DSBVM1W



Bug Plugs ship installed in all IN BOX styles to seal unused cord hole openings.

CATALOG NUMBER	UPC/DCI/NAED MFG #018997	ORIENTATION/COVER COLOR	UNIT	STD PKG	DIM A	DIM B	DIM C	DIM D	DIM E
DSBVM1C	09642	Vertical/Clear	1	4	9.058	7.012	5.129	1.775	3.221
DSBVM1W	09646	Vertical/White	1	4	9.058	7.012	5.129	1.775	3.221
DSBHM1C	09643	Horizontal/Clear	1	4	7.012	9.058	5.129	1.775	3.221
DSBHM1W	09648	Horizontal/white	1	4	7.012	9.058	5.129	1.775	3.221

Replacement covers available on page K-17.



WEATHERPROOF-IN-USE

Note: Meets 2011 NEC Section 406-9; for the protection of exterior outlets which require the use of a weatherproof while-in-use cover for all outdoor 15 or 20 AMP receptacles.

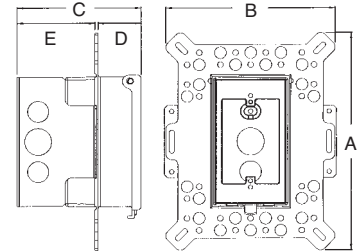

25.0 cu. in.

IN BOX for new stucco, textured surfaces, and rigid siding includes...Metallic box with non-metallic, weatherproof-in-use cover; installed bug plugs; (1) standard duplex and (1) standard GFCI face plate; block bushing with washer; and an in-place, disposable mud cover.

Features and Benefits

- IN BOX replaces the installation of an electrical box and bubble cover assembly
- Installs in the wall, so less of it shows outside
- No gaskets required
- Holes in flange allow stucco to bond firmly
- Install option: Cover is removable for easier device installation
- White, non-metallic portion and white cover are textured/paintable
- Grounding wire provided
- For use with metal raceway systems



Low Profile IN BOX™ with Metal Box and Adapter Sleeve for New Brick Construction

Recessed, metallic electrical box with non-metallic, weatherproof-in-use cover for new brick. Includes a protective adapter sleeve that keeps mortar out. Accepts most single gang wiring devices and uses standard indoor wall plates or a GFCI cover plate. Non-metallic portion and covers are UV rated plastic for long outdoor life.

CATALOG NUMBER	UPC/DCI/NAED MFG #018997	ORIENTATION/ COVER COLOR	UNIT	STD PKG	DIM A	DIM B	DIM C	DIM D	DIM E
DSHB1C	43610	Horiz./Clear Cover/White Box	1	4	4.937	7.196	5.283	1.283	4.000
DSHB1W	43611	Horiz./Clear Cover/White Box	1	4	4.937	7.196	5.283	1.283	4.000
DSHB1BRC	43612	Horiz./Clear Cover/Brown Box	1	4	4.937	7.196	5.283	1.283	4.000
DSHB1BR	43613	Horiz./Brown Cover/Brown Box	1	4	4.937	7.196	5.283	1.283	4.000

Replacement covers available on page K-17.



WEATHERPROOF-IN-USE

E84106 LR49636

Note: Meets 2011 NEC Section 406-9; for the protection of exterior outlets which require the use of a weatherproof while-in-use cover for all outdoor 15 or 20 AMP receptacles.

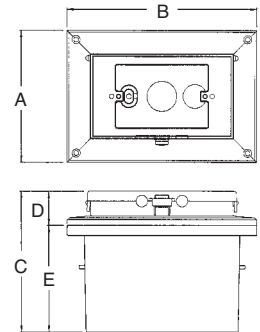

25.0 cu. in.



DSHB1C

Features and Benefits

- IN BOX replaces the installation of an electrical box and bubble cover assembly
- Installs in the wall, so less of it shows outside
- No gaskets required
- Install option: Cover is removable for easier device installation
- White, non-metallic portion and white cover are textured/paintable
- Grounding wire provided
- For use with metal raceway systems



Weatherproof-in-use.
DSHB1BRC shown.

IN BOX Saves Time. Looks Great!

IN BOX for new brick includes...

Metallic box with non-metallic, weatherproof-in-use cover; installed bug plugs; adapter sleeve; (1) standard duplex and (1) standard GFCI face plate; (1) set installation screws; (1) NM cable connector; an in-place, disposable mud cover; and (1) roll of caulk.



Bug Plugs ship installed in all IN BOX styles to seal unused cord hole openings.

Low Profile IN BOX™ for 1-1/2" Wall Systems

Recessed electrical box with weatherproof-in-use cover for 1-1/2" wall systems, including foam. Non-metallic cover and base. Accepts most single gang wiring devices and uses standard indoor wall plates or a GFCI cover plate. Box and white cover are textured/ paintable. UV rated plastic for long outdoor life.



DBVME1W

Features and Benefits

- IN BOX's one-piece assembly replaces the installation of an electrical box and bubble cover assembly
- Fewer parts to handle – save on materials and labor.
- Installs in the wall, so less of it shows outside
- Features a fixed, built-in flange, large enough to eliminate the need for a separate flashing.
- Install option: Cover is removable for easier device installation
- No gaskets required



Bug Plugs ship installed in all IN BOX styles to seal unused cord hole openings.

CATALOG NUMBER	UPC/DCI/NAED MFG #018997	ORIENTATION/ COVER COLOR	UNIT	STD	DIM A	DIM B	DIM C	DIM D	DIM E
DBVME1C	77645	Vertical/Clear	1	4	8.000	5.750	4.950	2.461	2.567
DBVME1W	77646	Vertical/White	1	4	8.000	5.750	4.950	2.461	2.567

Add suffix "GC" to Catalog # when ordering in Canada, for example DVBME1CGC. Replacement covers available on page K-17.



E170558 LR49636

WEATHERPROOF-IN-USE

22 cu. in.

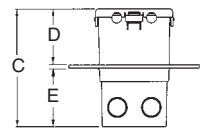
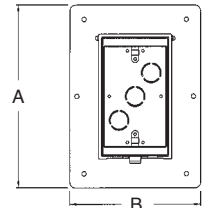

IN BOX for 1-1/2" wall systems includes...

Box with weatherproof-in-use cover, installed bug plugs, (1) standard duplex and (1) standard GFCI face plate, (1) NM cable connector, and disposable mud cover.

Saves Time – Looks Great!



Cover ships with disposable mud cover



Low profile IN BOX for a neat, clean look



Note: Meets 2011 NEC Section 406-9; for the protection of exterior outlets which require the use of a weatherproof while-in-use cover for all outdoor 15 or 20 AMP receptacles.



Low Profile IN BOX™ for Foam Wall Systems

Recessed electrical box with weatherproof-in-use cover. Adjustable to fit any foam board thickness. Non-metallic cover and base. Accepts most single gang wiring devices and uses standard indoor wall plates or a GFCI cover plate. Box and white cover are textured/ paintable. UV rated plastic for long outdoor life.

CATALOG NUMBER	UPC/DCI/NAED MFG #018997	ORIENTATION/COVER COLOR	UNIT	STD PKG	DIM A	DIM B	DIM C	DIM D MIN / MAX
DBVMA1C	77632	Vertical/Clear	1	4	9.058	7.012	5.160	.250-5.000
DBVMA1W	77634	Vertical/White	1	4	9.058	7.012	5.160	.250-5.000

Add suffix "GC" to Catalog # when ordering in Canada, for example DBVMA1CGC.

Replacement covers available on page K-17.



E170558 LR49636

WEATHERPROOF-IN-USE

IN BOX for foam wall systems includes...

Box with weatherproof-in-use cover, installed bug plugs, (1) standard duplex and (1) standard GFCI face plate, (4) installation screws, (1) NM cable connector, and an in-place, disposable mud cover.

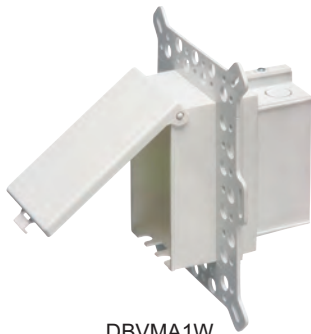
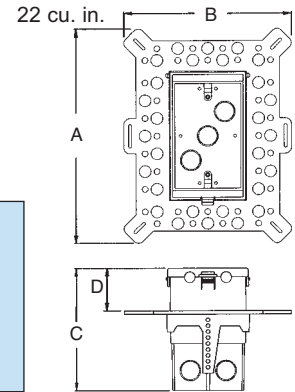

DBVMA1W

Features and Benefits

- IN BOX's one-piece assembly replaces the installation of an electrical box and bubble cover assembly
- Adjustable flange depth fits any foam board thickness or custom finish in concrete block and stucco applications
- Installs in the wall, so less of it shows outside
- Adjusts for finishes from 1/4" to 2-1/2" thick – in walls, from 2-3/4" to 5" deep
- Install option: Cover is removable for easier device installation
- No gaskets required

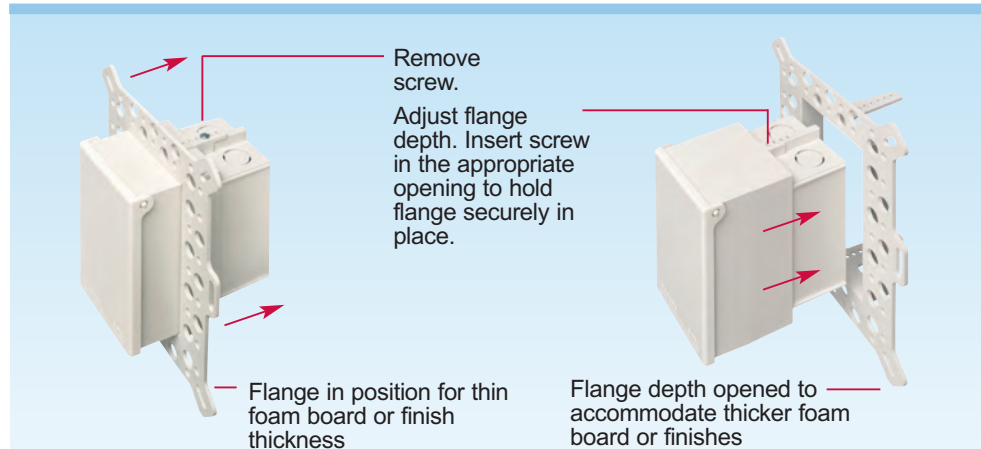

The flange depth adjusts to fit any foam thickness!



Bug Plugs ship installed in all IN BOX styles to seal unused cord hole openings.

Note: Meets 2011 NEC Section 406-9; for the protection of exterior outlets which require the use of a weatherproof while-in-use cover for all outdoor 15 or 20 AMP receptacles.

Low Profile IN-AND-OUT™ COVERS for New or Existing Construction

Low profile when not in use and a deeper, weatherproof-in-use cover when cord is plugged in. Non-metallic cover and base. Comes in clear or textured/paintable white. UV rated plastic for long outdoor life.



60VC

Features and Benefits

- Low profile when not in use – weatherproof-while-in-use
- IN position provides a sealed box to keep bugs out
- Extends quickly and easily into the OUT position to accommodate a plug
- Fits over all boxes or openings in new or existing projects
- The 61 Series has an installed, oversized base for large openings or a 3.5" round outlet box
- Installed gaskets
- Install option: Cover is removable for easier device installation
- Vertical and horizontal styles

Note: Meets 2011 NEC Section 406-9; for the protection of exterior outlets which require the use of a weatherproof while-in-use cover for all outdoor 15 or 20 AMP receptacles.

CATALOG NUMBER	UPC/DCI/MFG #018997	NAED COVER COLOR	ORIENTATION	UNIT PKG	STD PKG	DIM A	DIM B	DIM C IN	DIM C OUT	DIM D	DIM E
60VC	00682	Vertical/Clear	1	4	6.2743.7521.6703.005	-	-	-	-	-	-
60VW	00680	Vertical/White	1	4	6.2743.7521.6703.005	-	-	-	-	-	-
61VC	00683	Vertical/Clear	1	4	6.2743.7521.6703.0055.561	4.250	5.561	4.250	5.561	4.250	5.561
61VW	00681	Vertical/White	1	4	6.2743.7521.6703.0055.561	4.250	5.561	4.250	5.561	4.250	5.561
60HC	00686	Horizontal/Clear	1	4	4.1925.8361.6703.005	-	-	-	-	-	-
60HW	00684	Horizontal/white	1	4	4.1925.8361.6703.005	-	-	-	-	-	-
61HC	00687	Horizontal/Clear	1	4	4.1925.8361.6703.0054.250	5.561	4.250	5.561	4.250	5.561	5.561
61HW	00685	Horizontal/white	1	4	4.1925.8361.6703.0054.250	5.561	4.250	5.561	4.250	5.561	5.561



E170558 LR49636

WEATHERPROOF-IN-USE

IN AND OUT COVER includes...
Low profile cover, (1) standard duplex and (1) standard GFCI face plate, installation screws, and installed gaskets.

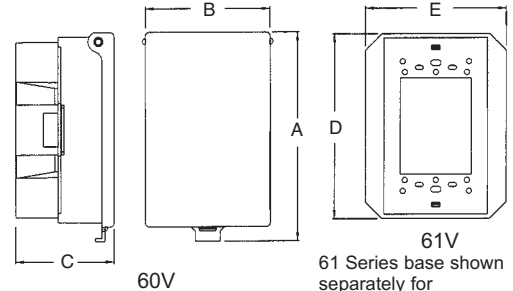

61V
61 Series base shown separately for dimensional purposes only.

Installation Instructions

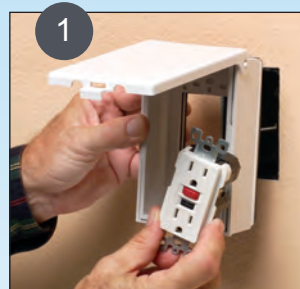

1 Feed device through opening (cover is removable for easier access).



2 Install wiring device per manufacturer's instructions, Local and National Electrical Codes using the pre-drilled holes in base.



3 Install plate and the installation is done!



IN for **GOOD LOOKS** and to stay bug free... (60VW shown)



OUT to **PLUG IN** for weatherproof-in-use! (61HW shown)



To close: Bow out sides of extended cover and push in.