

Calbond™

A division of

CALPIPE INDUSTRIES™
Incorporated

PVC Coated Conduit and Fittings

2015 Product Catalog



Calbond offers a complete line of PVC coated conduit, fittings and accessories for the protection of electrical conduit systems in highly corrosive environments.

Our quality couplings and fittings are double-coated both inside and out with a 2 mil coating of urethane. The exterior is then coated again with a 40 mil PVC coating on top of the urethane. All fittings incorporate our flexible overlapping sleeves ensuring a tight seal at every connection. Our conduit comes standard with a 40 mil PVC coating over the outside of the conduit and a 2 mil urethane coating on the interior of the conduit and on the threads.

With over 40 years in the PVC coating industry, when you partner with Calbond, you can count on:

- Expertise in conduit systems
- A broad product offering, inclusive of the tools needed to properly install PVC coated conduit systems
- Responsive customer service
- Industry's newest PVC coated factory utilizing the most modern manufacturing systems and processes
- PVC coating offered on steel and aluminum conduit

Easy to do Business With

Calbond is committed to providing quality products with the shortest lead times, combined with friendly, personal, and reliable service.

- Rapid quotation response time
- Timely shipments
- Dedicated staff committed to earning your business
- Competitive prices

Superior Corrosion Protection

Our quality assurance program complies with industry standards established by Underwriters Laboratories UL® and NEMA. All Calbond products are:

- UL® Listed and NEMA RN-1 compliant with no exceptions
- UL6 Listed with both the zinc coating and PVC coating as primary coatings
- UL® PVC adhesion performance tested (DYJC.E226472) where conduit is sequentially subjected to air oven conditioning and

exposure test, resistance to salt spray (fog) and adhesion test of ANSI/UL6

- Made in the USA

Calbond – Product Enhancements

- Specially formulated PVC provides superior protection to the conduit systems
- Specially formulated urethane internal coating provides the longest available product life cycle
- Sealing sleeves are provided on all female threads and fit tightly over coated conduit
- Encapsulated stainless steel screws are provided on all fittings
- Calseal is provided on all Form 8 fittings
- Ground continuity of the conduit system is maintained across assembled joints

Corrosion Can Cause Severe Damage to Most Industrial Installations

Calbond PVC coated conduit provides superior corrosion protection to the following industries:



- Food, Dairy & Beverage
- Water & Wastewater Treatment Facilities
- Mining
- Marine & Coastal Facilities
- Chemical Plants
- Petrochemical
- Steel Mills
- Offshore Platforms
- Breweries
- Cooling Towers
- Transportation & Infrastructure
- Pharmaceuticals
- Power Plants
- Solar Farms
- Pulp & Paper Mills
- Fertilizer Plants
- Other corrosive & harsh environments

Calbond is a division of Calpipe Industries, Inc. Experts in the corrosion protection industry, Calpipe has been supplying complete systems of stainless steel and PVC coated conduit and fittings since 1998.

TABLE OF CONTENTS

PVC COATED CONDUIT

Rigid Conduits	4
--------------------------	---

PVC COATED COUPLINGS

Rigid Couplings	4
---------------------------	---

PVC COATED ELBOWS

90° Standard Elbows	4
Sweeps	5

PVC COATED FORM FITTINGS

Form 8 Fittings	6-8
Form 8 & 7 Covers	8
Form 7 Fittings	8-10

PVC COATED CONDUIT HUBS

Conduit Hubs	11
------------------------	----

PVC COATED LIQUIDTIGHT CONNECTORS

Liquidtight Connectors	12-13
----------------------------------	-------

PVC COATED DEVICE BOXES

FS Device Boxes	14
FD Device Boxes	14
Device Box Covers	15-16

PVC COATED ACCESSORIES

Right Angle Clamps	17
Parallel Clamps	17
J-Hanger Pipe Straps	17
Edge Clamps	17
Clamp Back Spacers	17
1 & 2 Hole Straps	17
Mini Hangers	18
U-Bolts	18
Grounding Bushings	18

PVC COATED GUA JUNCTION BOXES

GUA Boxes	18-20
---------------------	-------

PVC COATED UNIONS

UNF Female-Female	20
UNY Female-Male	20

PVC COATED SEALING FITTINGS

EYS Female Hubs	21
EYS Male-Female Hubs	21-22
EYD Male-Female Hubs	22

PVC COATED SEALING FITTINGS (cont.)

EZS Female Hubs	23
EZS Male-Female Hubs	23
EZD Female Hubs	23

PVC COATED PULLING ELBOWS

LBD Fittings	23
------------------------	----

PVC COATED MOGUL FITTINGS

BUB	24
BLB	24
BT	24
BC	24
Mogul Fittings Covers	25

PVC COATED MALLEABLE FITTINGS

90° Female-Female	25
90° Male-Male	25
90° Male-Female	25

PVC COATED SERVICE ENTRANCE ELBOWS

LBY	25
---------------	----

PVC COATED SPLIT & REDUCING COUPLINGS

Split Couplings	26
Reducing Couplings	26

PVC COATED & CALSTRUT STAINLESS STEEL STRUT CHANNELS & STRAPS

Strut Channels & Straps	27
-----------------------------------	----

PVC COATED NIPPLES

Nipples	28-29
-------------------	-------

PVC COATED YARD ELLS

Rigid Yard Ells	29
---------------------------	----

TOOLS

Touch Up Compounds	29
Installation Tools	30-31

MISCELLANEOUS

Chemical Resistance Charts	32-33
Product Specifications	34-35
FAQs	36-37
Terms and Conditions	38
PVC Coated Aluminum Sales Sheet	39

PVC COATED RIGID CONDUIT

Item Number	Trade Size	Size Metric (mm)	Wall Thickness (in.)	Outside Dia. w/ Coating	Inside Diameter	Weight Per 100 Feet	Feet Per Bundle	Aluminum Item Number
PV0510CT00	1/2"	16	0.104	0.920	0.632	90	1000	PA0510CT00
PV0710CT00	3/4"	21	0.107	1.130	0.836	119	900	PA0710CT00
PV1010CT00	1"	27	0.126	1.395	1.063	175	750	PA1010CT00
PV1210CT00	1-1/4"	35	0.133	1.740	1.394	237	420	PA1210CT00
PV1510CT00	1-1/2"	41	0.138	1.980	1.624	281	380	PA1510CT00
PV2010CT00	2"	53	0.146	2.455	2.083	376	300	PA2010CT00
PV2510CT00	2-1/2"	63	0.193	2.955	2.489	593	170	PA2510CT00
PV3010CT00	3"	78	0.205	3.580	3.090	772	140	PA3010CT00
PV3510CT00	3-1/2"	91	0.215	4.080	3.570	922	110	PA3510CT00
PV4010CT00	4"	103	0.225	4.580	4.050	1089	110	PA4010CT00
PV5010CT00	5"	129	0.245	5.643	5.073	1488	80	PA5010CT00
PV6010CT00	6"	155	0.266	6.705	6.093	1998	50	PA6010CT00

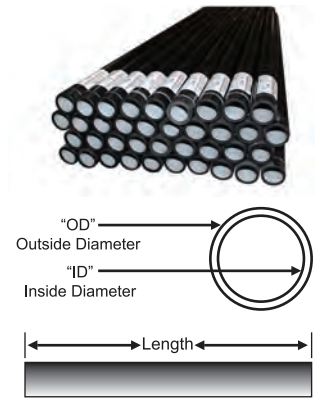

All weights are based on rigid steel conduit & fittings.
Aluminum weights available by request.

PVC COATED RIGID COUPLINGS

Item Number	Trade Size	Size Metric (mm)	Length of Metal	Threads Per Inch	Weight Per 100 (lbs)	Box Qty	Aluminum Item Number
PV0500CP00	1/2"	16	1.500	14	19	100	PA0500CP00
PV0700CP00	3/4"	21	1.532	14	32	90	PA0700CP00
PV1000CP00	1"	27	1.906	11-1/2	40	75	PA1000CP00
PV1200CP00	1-1/4"	35	1.906	11-1/2	50	42	PA1200CP00
PV1500CP00	1-1/2"	41	1.906	11-1/2	69	38	PA1500CP00
PV2000CP00	2"	53	1.937	11-1/2	93	30	PA2000CP00
PV2500CP00	2-1/2"	63	2.878	8	123	17	PA2500CP00
PV3000CP00	3"	78	3.031	8	217	14	PA3000CP00
PV3500CP00	3-1/2"	91	3.094	8	422	11	PA3500CP00
PV4000CP00	4"	103	3.188	8	391	11	PA4000CP00
PV5000CP00	5"	129	3.374	8	550	8	PA5000CP00
PV6000CP00	6"	155	3.437	8	884	5	PA6000CP00

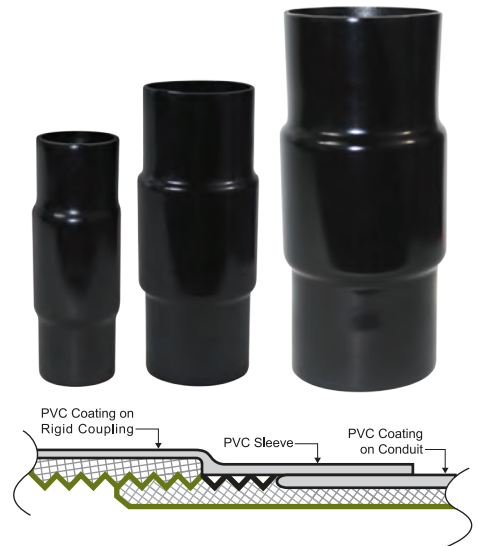

PVC COATED 90° STANDARD ELBOWS

Item Number	Trade Size	Size Metric (mm)	Weight Per 100 (lbs)	Standard Radius A	Offset B	Tangent T	Aluminum Item Number
PV0590EL00	1/2"	16	70	4.25	6.0	1.7	PA0590EL00
PV0790EL00	3/4"	21	100	4.50	6.7	2.2	PA0790EL00
PV1090EL00	1"	27	190	5.75	8.0	2.4	PA1090EL00
PV1290EL00	1-1/4"	35	310	7.25	9.6	2.8	PA1290EL00
PV1590EL00	1-1/2"	41	400	8.25	10.6	2.6	PA1590EL00
PV2090EL00	2"	53	640	9.50	12.0	3.5	PA2090EL00
PV2590EL00	2-1/2"	63	1210	10.50	14.8	4.7	PA2590EL00
PV3090EL00	3"	78	1950	13.00	17.0	5.3	PA3090EL00
PV3590EL00	3-1/2"	91	2630	15.00	20.9	6.1	PA3590EL00
PV4090EL00	4"	103	3280	16.00	21.0	6.5	PA4090EL00
PV5090EL00	5"	129	6750	24.00	32.0	11.2	PA5090EL00
PV6090EL00	6"	155	10510	30.00	41.0	12.1	PA6090EL00



PVC COATED SWEEPS

Special Radius Sweeps

Trade Size	RADIUS															
	12"			18"				24"				30"				
Item Number	B	T	WT	Item Number	B	T	WT	Item Number	B	T	WT	Item Number	B	T	WT	
1/2"	PV0512SW90	21	10	2.60	PV0518SW90	28	11	3.6	PV0524SW90	35	11	4.1	PV0530SW90	41	11	4.9
3/4"	PV0712SW90	21	10	3.50	PV0718SW90	28	11	4.7	PV0724SW90	35	11	5.5	PV0730SW90	41	11	6.5
1"	PV1012SW90	21	10	5.00	PV1018SW90	28	11	6.0	PV1024SW90	35	11	8.0	PV1030SW90	41	11	9.0
1-1/4"	PV1212SW90	21	10	6.00	PV1218SW90	28	11	9.0	PV1224SW90	35	11	11.0	PV1230SW90	41	11	12.0
1-1/2"	PV1512SW90	21	10	8.00	PV1518SW90	28	11	11.4	PV1524SW90	35	11	13.2	PV1530SW90	41	11	15.8
2"					PV2018SW90	28	11	15.2	PV2024SW90	35	11	17.5	PV2030SW90	41	11	21.0
2-1/2"					PV2518SW90	28	11	24.3	PV2524SW90	35	11	28.0	PV2530SW90	41	11	33.6
3"					PV3018SW90	28	11	32.9	PV3024SW90	35	11	38.0	PV3030SW90	41	11	45.6
3-1/2"									PV3524SW90	35	11	45.0	PV3530SW90	41	11	54.0
4"									PV4024SW90	35	11	52.5	PV4030SW90	41	11	63.0

Trade Size	RADIUS											
	36"			48"				60"				
Item Number	B	T	WT	Item Number	B	T	WT	Item Number	B	T	WT	
1/2"	PV0536SW90	47	11	5.5	PV0548SW90	60	12	6.9	PV0560SW90	72	12	8.3
3/4"	PV0736SW90	47	11	7.3	PV0748SW90	60	12	9.1	PV0760SW90	72	12	11.0
1"	PV1036SW90	47	11	10.0	PV1048SW90	60	12	13.0	PV1060SW90	72	12	15.0
1-1/4"	PV1236SW90	47	11	14.0	PV1248SW90	60	12	18.0	PV1260SW90	72	12	22.0
1-1/2"	PV1536SW90	47	11	17.5	PV1548SW90	60	12	21.9	PV1560SW90	72	12	25.0
2"	PV2036SW90	47	11	23.3	PV2048SW90	60	12	29.2	PV2060SW90	72	12	37.0
2-1/2"	PV2536SW90	47	11	37.3	PV2548SW90	60	12	46.7	PV2560SW90	72	12	56.0
3"	PV3036SW90	47	11	50.7	PV3048SW90	60	12	63.3	PV3060SW90	72	12	76.0
3-1/2"	PV3536SW90	47	11	60.0	PV3548SW90	60	12	75.0	PV3560SW90	72	12	90.0
4"	PV4036SW90	47	11	70.0	PV4048SW90	60	12	87.5	PV4060SW90	72	12	105.0
5"	PV5036SW90	47	11	93.3	PV5048SW90	60	12	116.7	PV5060SW90	72	12	140.0
6"	PV6036SW90	47	11	123.3	PV6048SW90	60	12	156.0	PV6060SW90	72	12	185.0

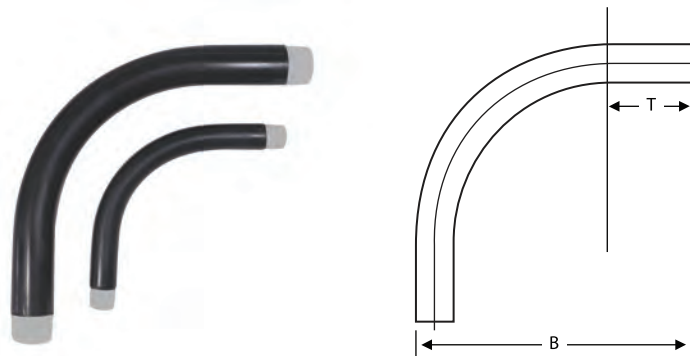

PVC COATED FORM 8 FITTINGS

C Form 8 (covers incl.)

Item Number	Trade Size	Size Metric (mm)	A	B	C	D	E	Weight Per 100 (lbs)	Aluminum Item Number
PV0500C18	1/2"	16	6.69	1.48	1.46	1.00	3.31	200	PA0500C19
PV0700C28	3/4"	21	7.78	1.73	1.27	1.19	3.94	230	PA0700C29
PV1000C38	1"	27	9.31	1.98	1.83	1.38	4.56	280	PA1000C39
PV1200C448	1-1/4"	35	11.00	2.42	2.27	1.75	5.31	450	PA1200C49
PV1500C58	1-1/2"	41	13.38	2.82	2.83	2.13	6.50	650	PA1500C59
PV2000C68	2"	53	14.25	3.60	3.83	3.00	8.56	1030	PA2000C69
PV2500C78	2-1/2"	63	17.63	4.48	5.08	14.25	10.88	1800	PA2500C789
PV3000C88	3"	78	17.63	4.85	5.08	4.25	10.88	2050	PA3000C889
PV3500C989	3-1/2"	91	20.75	5.73	6.33	5.44	13.44	1000	PA3500C989
PV4000C1089	4"	103	20.75	5.73	6.33	5.44	13.44	1200	PA4000C1089

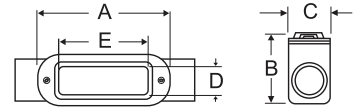

LB Form 8 (covers incl.)

Item Number	Trade Size	Size Metric (mm)	A	B	C	D	E	Weight Per 100 (lbs)	Aluminum Item Number
PV0500LB18	1/2"	16	5.48	2.26	1.42	1.00	3.31	150	PA0500LB19
PV0700LB28	3/4"	21	6.35	2.48	1.60	1.19	3.94	200	PA0700LB29
PV1000LB38	1"	27	7.51	2.85	1.79	1.38	4.56	290	PA1000LB39
PV1200LB448	1-1/4"	35	8.82	3.38	2.23	1.75	5.31	410	PA1200LB49
PV1500LB58	1-1/2"	41	10.67	4.07	2.79	2.13	6.50	650	PA1500LB59
PV2000LB68	2"	53	13.04	4.85	3.79	3.00	8.56	820	PA2000LB69
PV2500LB78	2-1/2"	63	15.98	6.17	5.04	4.25	10.88	1820	PA2500LB789
PV3000LB888	3"	78	15.98	6.54	5.04	4.25	10.88	2120	PA3000LB889
PV3500LB98	3-1/2"	91	14.73	7.60	6.29	5.44	13.44	3120	PA3500LB989
PV4000LB108	4"	103	14.73	7.85	6.29	5.44	13.44	3200	PA4000LB1089

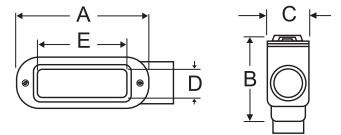

LL Form 8 (covers incl.)

Item Number	Trade Size	Size Metric (mm)	A	B	C	D	E	Weight Per 100 (lbs)	Aluminum Item Number
PV0500LL18	1/2"	16	5.48	1.48	2.20	1.00	3.31	140	PA0500LL19
PV0700LL28	3/4"	21	6.35	1.73	2.35	1.19	3.94	210	PA0700LL29
PV1000LL38	1"	27	7.51	1.98	2.67	1.38	4.56	260	PA1000LL39
PV1200LL48	1-1/4"	35	8.82	2.42	3.20	1.75	5.31	420	PA1200LL49
PV1500LL58	1-1/2"	41	10.67	2.82	4.04	2.13	6.50	620	PA1500LL59
PV2000LL68	2"	53	13.04	3.60	5.04	3.00	8.56	1050	PA2000LL69
PV2500LL78	2-1/2"	63	15.98	4.48	6.73	4.25	10.88	1900	PA2500LL789
PV3000LL88	3"	78	15.98	4.85	6.73	4.25	10.88	2150	PA3000LL889
PV3500LL98	3-1/2"	91	14.73	1.92	6.98	4.50	10.25	2150	PA3500LL989
PV4000LL108	4"	103	14.73	5.42	6.98	4.50	10.25	2450	PA4000LL1089

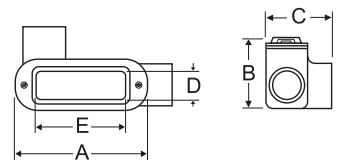

PVC COATED FORM 8 FITTINGS

LR Form 8 (covers incl.)

Item Number	Trade Size	Size Metric (mm)	A	B	C	D	E	Weight Per 100 (lbs)	Aluminum Item Number
PV0500LR18	1/2"	16	5.48	1.48	2.20	1.00	3.31	140	PA0500LR19
PV0700LR28	3/4"	21	6.35	1.73	2.35	1.19	3.94	210	PA0700LR29
PV1000LR38	1"	27	7.51	1.98	2.67	1.38	4.56	260	PA1000LR39
PV1200LR48	1-1/4"	35	8.82	2.42	3.20	1.75	5.31	450	PA1200LR49
PV1500LR58	1-1/2"	41	10.67	2.82	4.04	2.13	6.50	620	PA1500LR59
PV2000LR68	2"	53	13.04	3.60	5.04	3.00	8.56	1070	PA2000LR69
PV2500LR78	2-1/2"	63	15.98	4.48	6.73	4.25	10.88	1770	PA2500LR789
PV3000LR88	3"	78	15.98	4.85	6.73	4.25	10.88	1800	PA3000LR889
PV3500LR98	3-1/2"	91	14.73	4.92	6.98	4.50	10.25	2100	PA3500LR989
PV4000LR108	4"	103	14.73	5.42	6.98	4.50	10.25	2400	PA4000LR1089

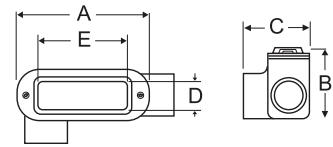

T Form 8 (covers incl.)

Item Number	Trade Size	Size Metric (mm)	A	B	C	D	E	Weight Per 100 (lbs)	Aluminum Item Number
PV0500T18	1/2"	16	6.69	1.79	2.20	1.00	3.31	180	PA0500T19
PV0700T28	3/4"	21	2.50	2.04	2.35	1.19	3.94	250	PA0700T29
PV1000T38	1"	27	3.30	2.29	2.67	1.38	4.56	330	PA1000T39
PV1200T48	1-1/4"	35	1.90	2.67	3.20	1.75	5.31	490	PA1200T49
PV1500T58	1-1/2"	41	7.50	2.82	4.04	2.13	6.50	750	PA1500T59
PV2000T68	2"	53	11.70	3.60	5.04	3.00	8.56	1170	PA2000T69
PV2500T78	2-1/2"	63	19.80	4.48	6.73	4.25	10.88	1980	PA2500T789
PV3000T88	3"	78	23.10	4.85	6.73	4.25	10.88	2100	PA3000T889
PV3500T98	3-1/2"	91	21.00	5.73	8.17	5.44	13.44	2350	PA3500T989
PV4000T108	4"	103	24.00	5.98	8.17	5.44	13.44	2400	PA4000T1089

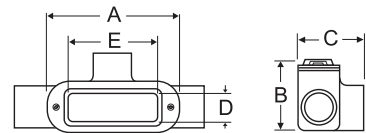

TB Form 8 (covers incl.)

Item Number	Trade Size	Size Metric (mm)	A	B	C	D	E	Weight Per 100 (lbs)	Aluminum Item Number
PV0500TB18	1/2"	16	6.69	3.57	1.46	1.00	3.31	200	PA0500TB19
PV0700TB28	3/4"	21	7.78	3.79	1.64	1.19	3.94	230	PA0700TB29
PV1000TB38	1"	27	9.31	4.17	1.83	1.38	4.56	310	PA1000TB39
PV1200TB48	1-1/4"	35	11.00	4.38	2.27	1.75	5.31	520	PA1200TB49
PV1500TB58	1-1/2"	41	13.38	5.08	2.83	2.13	6.50	700	PA1500TB59
PV2000TB68	2"	53	16.25	5.85	3.83	3.00	8.56	1100	PA2000TB69

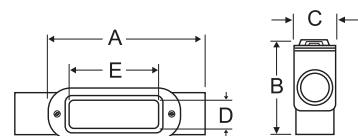

PVC COATED FORM 8 FITTINGS

X Form 8 (covers incl.)

Item Number	Trade Size	Size Metric (mm)	A	B	C	D	E	Weight Per 100 (lbs)	Aluminum Item Number
PV0500X18	1/2"	16	6.69	3.91	1.79	1.00	3.31	200	PA0500X19
PV0700X28	3/4"	21	7.89	4.56	2.04	1.19	3.94	260	PA0700X29
PV1000X38	1"	27	9.31	5.50	2.29	1.38	4.56	310	PA1000X39
PV1200X48	1-1/4"	35	11.00	6.63	2.67	1.75	5.31	520	
PV1500X58	1-1/2"	41	13.38	8.25	2.51	2.13	6.50	750	
PV2000X68	2"	53	16.25	10.25	3.60	3.00	8.56	1170	

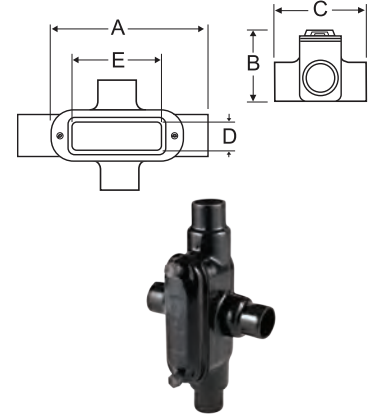

PVC COATED FORM COVERS

Form 8 Covers

Item Number	Trade Size
PV0500180F	1/2"
PV0700280F	3/4"
PV1000380F	1"
PV1200480F	1-1/4"
PV1500580F	1-1/2"
PV2000680F	2"
PV2530880F	2-1/2" - 3"
PV3540980F	3-1/2" - 4"

Form 7 Covers

Item Number	Trade Size
PV0500170F	1/2"
PV0700270F	3/4"
PV1000370F	1"
PV1200470F	1-1/4"
PV1500570F	1-1/2"
PV2000670F	2"
PV2530870F	2-1/2" - 3"
PV3540970F	3-1/2" - 4"



PVC COATED FORM 7 FITTINGS

C Form 7 (covers incl.)

Item Number	Trade Size	Size Metric (mm)	A	B	C	D	E	Weight Per 100 (lbs)	Aluminum Item Number
PV0500C17	1/2"	16	6.38	1.42	1.46	0.94	3.19	100	PA0500C17SA
PV0700C27	3/4"	21	7.50	1.67	1.64	1.13	3.81	140	PA0700C27SA
PV1000C37	1"	27	9.00	1.92	1.83	1.38	4.50	220	PA1000C37SA
PV1200C47	1-1/4"	35	9.94	2.35	2.27	1.75	5.00	270	PA1200C47SA
PV1500C57	1-1/2"	41	11.19	2.60	2.52	1.94	5.44	400	PA1500C57SA
PV2000C67	2"	53	11.19	3.17	3.08	2.44	6.38	550	PA2000C67SA
PV2500C77	2-1/2"	63	14.00	3.67	4.33	3.56	8.38	1000	PA2500C77SA
PV3000C87	3"	78	13.75	4.42	4.33	3.56	8.38	1180	PA3000C87SA

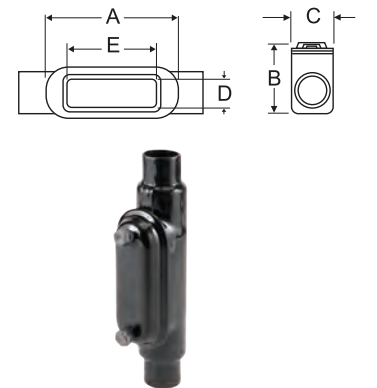

PVC COATED FORM 7 FITTINGS

LB Form 7 (covers incl.)

Item Number	Trade Size	Size Metric (mm)	A	B	C	D	E	Weight Per 100 (lbs)	Aluminum Item Number
PV0500LB17	1/2"	16	5.10	2.29	1.42	0.94	3.19	110	PA0500LB17SA
PV0700LB27	3/4"	21	5.98	2.54	1.60	1.13	3.81	170	PA0700LB27SA
PV1000LB37	1"	27	7.01	2.92	1.79	1.38	4.50	220	PA1000LB37SA
PV1200LB47	1-1/4"	35	7.79	3.35	2.23	1.75	5.00	310	PA1200LB47SA
PV1500LB57	1-1/2"	41	8.67	3.73	2.48	1.94	5.44	380	PA1500LB57SA
PV2000LB67	2"	53	10.17	4.29	3.04	2.44	6.38	520	PA2000LB67SA
PV2500LB777	2-1/2"	63	12.54	5.17	4.29	3.56	8.38	1000	PA2500LB777SA
PV3000LB87	3"	78	12.54	5.92	4.29	3.56	8.38	1300	PA3000LB87SA
PV3500LB97	3-1/2"	91	14.73	6.60	5.29	4.50	10.25	1900	PA3500LB97SA
PV4000LB107	4"	103	14.73	7.10	5.29	4.50	10.25	1850	PA4000LB107SA

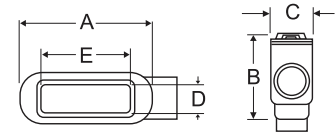

LL Form 7 (covers incl.)

Item Number	Trade Size	Size Metric (mm)	A	B	C	D	E	Weight Per 100 (lbs)	Aluminum Item Number
PV0500LL17	1/2"	16	5.10	1.42	2.29	0.94	3.19	120	PA0500LL17SA
PV0700LL27	3/4"	21	5.98	1.67	2.48	1.13	3.81	160	PA0700LL27SA
PV1000LL37	1"	27	7.04	1.92	2.79	1.38	4.50	210	PA1000LL37SA
PV1200LL47	1-1/4"	35	7.79	2.35	3.23	1.75	5.00	300	PA1200LL47SA
PV1500LL57	1-1/2"	41	8.67	2.60	3.60	1.94	5.44	410	PA1500LL57SA
PV2000LL67	2"	53	10.17	3.17	4.17	2.44	6.38	570	PA2000LL67SA
PV2500LL777	2-1/2"	63	12.54	3.67	5.79	3.56	8.38	1000	PA2500LL777SA
PV3000LL87	3"	78	12.54	4.42	5.79	3.56	8.38	1270	PA3000LL87SA
PV3500LL97	3-1/2"	91	14.73	4.92	6.98	4.50	10.25	1900	PA3500LL97SA
PV4000LL107	4"	103	14.73	5.42	6.98	4.50	10.25	1900	PA4000LL107SA

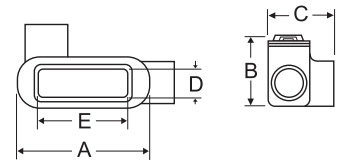

LR Form 7 (covers incl.)

Item Number	Trade Size	Size Metric (mm)	A	B	C	D	E	Weight Per 100 (lbs)	Aluminum Item Number
PV0500LR17	1/2"	16	5.10	1.42	2.29	0.94	3.19	120	PA0500LR17SA
PV0700LR27	3/4"	21	5.98	1.67	2.49	1.13	3.81	160	PA0700LR27SA
PV1000LR37	1"	27	7.04	1.92	2.79	1.38	4.50	210	PA1000LR37SA
PV1200LR47	1-1/4"	35	7.79	2.35	3.23	1.75	5.00	300	PA1200LR47SA
PV1500LR57	1-1/2"	41	8.67	2.60	3.60	1.94	5.44	410	PA1500LR57SA
PV2000LR67	2"	53	10.17	3.17	4.17	2.44	6.38	570	PA2000LR67SA
PV2500LR777	2-1/2"	63	12.54	3.67	5.79	3.56	8.38	1000	PA2500LR777SA
PV3000LR87	3"	78	12.54	4.42	5.79	3.56	8.38	1270	PA3000LR87SA
PV3500LR97	3-1/2"	91	14.73	4.42	6.98	4.50	10.25	1900	PA3500LR97SA
PV4000LR107	4"	103	14.73	5.42	6.98	4.50	10.25	1900	PA4000LR107SA

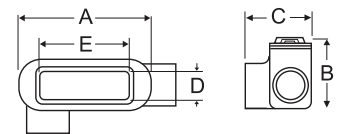

PVC COATED FORM 7 FITTINGS

T Form 7 (covers incl.)

Item Number	Trade Size	Size Metric (mm)	A	B	C	D	E	Weight Per 100 (lbs)	Aluminum Item Number
PV0500T17	1/2"	16	6.63	1.79	2.48	0.94	3.19	150	PA0500T17SA
PV0700T27	3/4"	21	7.75	2.04	2.67	1.13	3.81	210	PA0700T27SA
PV1000T37	1"	27	9.25	2.29	3.04	1.38	4.50	290	PA1000T37SA
PV1200T47	1-1/4"	35	9.94	2.35	3.23	1.75	5.00	360	PA1200T47SA
PV1500T57	1-1/2"	41	11.19	2.60	3.60	1.94	5.44	450	PA1500T57SA
PV2000T67	2"	53	13.19	3.17	4.17	2.44	6.38	650	PA2000T67SA
PV2500T77	2-1/2"	63	16.00	3.67	5.79	3.56	8.38	1070	PA2500T77SA
PV3000T87	3"	78	16.06	4.42	5.79	3.56	8.35	1540	PA3000T87SA
PV3500T97	3-1/2"	91	18.31	4.92	6.98	4.50	10.25	1900	PA3500T97SA
PV4000T107	4"	103	18.31	5.42	6.98	4.50	10.25	2100	PA4000T107SA

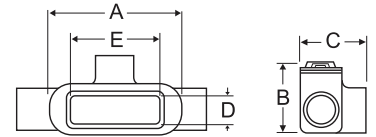

TB Form 7 (covers incl.)

Item Number	Trade Size	Size Metric (mm)	A	B	C	D	E	Weight Per 100 (lbs)	Aluminum Item Number
PV0500TB17	1/2"	16	6.63	2.67	1.64	0.94	3.19	160	PA0500TB17SA
PV0700TB27	3/4"	21	7.75	2.92	1.83	1.13	3.81	210	PA0700TB27SA
PV1000TB37	1"	27	9.25	3.29	2.08	1.38	4.50	270	PA1000TB37SA
PV1200TB47	1-1/4"	35	9.94	3.35	2.27	1.75	5.00	370	PA1200TB47SA
PV1500TB57	1-1/2"	41	11.19	5.04	2.52	1.94	5.44	470	PA1500TB57SA
PV2000TB67	2"	53	13.19	6.17	3.08	2.44	6.38	700	PA2000TB67SA

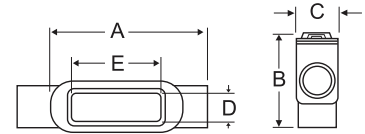

X Form 7 (covers incl.)

Item Number	Trade Size	Size Metric (mm)	A	B	C	D	E	Weight Per 100 (lbs)	Aluminum Item Number
PV0500X17	1/2"	16	6.63	3.35	1.79	0.94	3.19	170	PA0500X17SA
PV0700X27	3/4"	21	7.75	3.54	2.04	1.13	3.81	240	PA0700X27SA
PV1000X37	1"	27	9.25	4.04	2.29	1.38	4.50	270	PA1000X37SA
PV1200X47	1-1/4"	35	9.94	4.17	2.35	1.75	5.00	360	PA1200X47SA
PV1500X57	1-1/2"	41	11.19	4.67	2.60	1.94	5.44	500	PA1500X57SA
PV2000X67	2"	53	13.19	5.23	3.17	2.44	6.38	750	PA2000X67SA

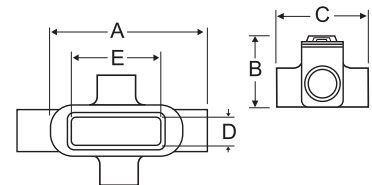

PVC COATED CONDUIT HUBS

ST

Item Number	Trade Size	Weight Per 100 (lbs)	A	B	C	Max Wall Thickness	Aluminum Item Number
PV0500ST1	1/2"	20	1.84	2.00	1.31	0.125	PA0500STA1
PV0700ST2	3/4"	30	2.22	2.25	1.66	0.125	PA0700STA2
PV1000ST3	1"	40	2.66	2.50	2.03	0.125	PA1000STA3
PV1200ST4	1-1/4"	40	2.94	3.25	2.28	0.125	PA1200STA4
PV1500ST5	1-1/2"	60	3.19	3.50	2.53	0.125	PA1500STA5
PV2000ST6	2"	120	3.75	4.25	3.09	0.125	PA2000STA6
PV2500ST7	2-1/2"	150	4.22	4.75	3.28	0.125	PA2500STA7
PV3000ST8	3"	210	4.31	5.25	3.38	0.125	PA3000STA8
PV3500ST9	3-1/2"	300	4.38	5.50	3.44	0.125	PA3500STA9
PV4000ST10	4"	350	4.44	6.25	3.50	0.125	PA4000STA10
PV5000ST11	5"	540	4.94	7.50	4.00	0.125	PA5000STA11
PV6000ST12	6"	690	5.00	8.50	4.00	0.125	PA6000STA12

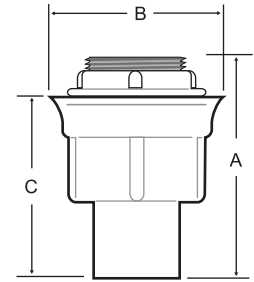

STG Grounding

Item Number	Trade Size	Weight Per 100 (lbs)	A	B	C	Max Wall Thickness	Aluminum Item Number
PV0500STG1	1/2"	20	1.84	2.00	1.31	0.125	PA0500STAG1
PV0700STG2	3/4"	30	2.22	2.25	1.66	0.125	PA0700STAG2
PV1000STG3	1"	40	2.66	2.50	2.03	0.125	PA1000STAG3
PV1200STG4	1-1/4"	40	2.94	3.25	2.28	0.125	PA1200STAG4
PV1500STG5	1-1/2"	60	3.19	3.50	2.53	0.125	PA1500STAG5
PV2000STG6	2"	120	3.75	4.25	3.09	0.125	PA2000STAG6
PV2500STG7	2-1/2"	150	4.22	4.75	3.28	0.125	PA2500STAG7
PV3000STG8	3"	210	4.31	5.25	3.38	0.125	PA3000STAG8
PV3500STG9	3-1/2"	300	4.38	5.50	3.44	0.125	PA3500STAG9
PV4000STG10	4"	350	4.44	6.25	3.50	0.125	PA4000STAG10
PV5000STG11	5"	540	4.94	7.50	4.00	0.125	PA5000STAG11
PV6000STG12	6"	690	5.00	8.50	4.00	0.125	PA6000STAG12

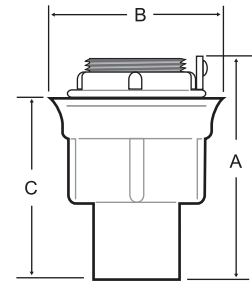

STTB

Item Number	Trade Size	Weight Per 100 (lbs)	Aluminum Item Number
PV0500STTB1	1/2"	50	PA0500STTB1
PV0700STTB2	3/4"	50	PA0700STTB2
PV1000STTB3	1"	70	PA1000STTB3
PV1200STTB4	1-1/4"	100	PA1200STTB4
PV1500STTB5	1-1/2"	120	PA1500STTB5
PV2000STTB6	2"	170	PA2000STTB6
PV2500STTB7	2-1/2"	250	PA2500STTB7
PV3000STTB8	3"	300	PA3000STTB8
PV3500STTB9	3-1/2"	420	
PV4000STTB10	4"	590	

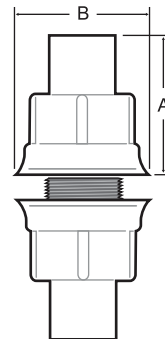

STTTB

Item Number	Trade Size	Weight Per 100 (lbs)	Aluminum Item Number
PV0500STTTB1	1/2"	100	PA0500STTTB1
PV0700STTTB2	3/4"	100	PA0700STTTB2
PV1000STTTB3	1"	140	PA1000STTTB3
PV1200STTTB4	1-1/4"	200	PA1200STTTB4
PV1500STTTB5	1-1/2"	240	PA1500STTTB5
PV2000STTTB6	2"	340	PA2000STTTB6

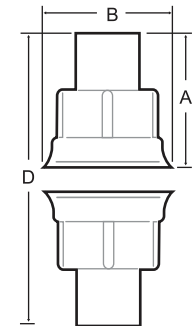

* Unlimited Wall thickness - determined by nipple used

PVC COATED LIQUIDTIGHT CONNECTORS

Straight

Item Number	Trade Size	A	B	C	Weight Per 100 (lbs)	Aluminum Item Number
PV0300LT38	3/8"	1.24	1.88	0.56	20	
PV0500LT50	1/2"	1.46	2.06	0.56	20	PA0500LT50SA
PV0700LT75	3/4"	1.74	2.38	0.56	30	PA0700LT75SA
PV1000LT100	1"	1.96	3.06	0.75	40	PA1000LT100SA
PV1200LT125	1-1/4"	2.36	3.75	0.81	80	PA1200LT125SA
PV1500LT150	1-1/2"	2.80	4.19	0.81	90	PA1500LT150SA
PV2000LT200	2"	3.33	5.06	0.88	170	PA2000LT200SA
PV2500LT250	2-1/2"	3.83	6.13	1.00	300	PA2500LT250SA
PV3000LT300	3"	4.58	6.25	1.00	420	PA3000LT300SA
PV4000LT400	4"	5.58	6.50	1.13	620	PA4000LT400SA

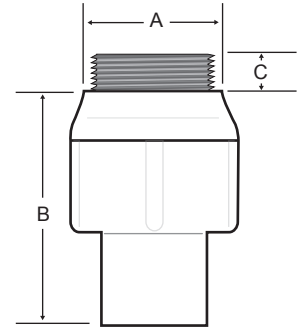

Straight w/ Ground

Item Number	Trade Size	A	B	C	Weight Per 100 (lbs)	Ground Wire	Aluminum Item Number
PV0300LT38G	3/8"	1.24	1.88	0.56	20	14-8	
PV0500LT50G	1/2"	1.46	2.06	0.56	20	14-8	PA0500LT50GSA
PV0700LT75G	3/4"	1.74	2.38	0.56	30	14-4	PA0700LT75GSA
PV1000LT100G	1"	1.96	3.06	0.75	40	14-4	PA1000LT100GSA
PV1200LT125G	1-1/4"	2.33	3.75	0.81	80	14-4	PA1200LT125GSA
PV1500LT150G	1-1/2"	3.33	4.19	0.81	90	14-4	PA1500LT150GSA
PV2000LT200G	2"	3.89	5.06	0.88	170	14-4	PA2000LT200GSA
PV2500LT250G	2-1/2"	4.52	6.13	1.00	300	1/0-8	PA2500LT250GSA
PV3000LT300G	3"	5.27	6.25	1.00	420	1/0-8	PA3000LT300GSA
PV4000LT400G	4"	6.21	6.50	1.13	620	3/0-6	PA4000LT400GSA

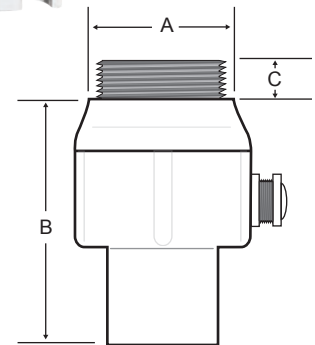

45°

Item Number	Trade Size	A	B	C	Weight Per 100 (lbs)
PV0300LT3845	3/8"	1.24	1.94	0.56	30
PV0500LT5045	1/2"	1.46	2.38	0.56	30
PV0700LT7545	3/4"	1.74	2.88	0.56	40
PV1000LT10045	1"	1.96	3.25	0.75	50
PV1200LT12545	1-1/4"	2.36	4.00	0.81	150
PV1500LT15045	1-1/2"	2.80	4.88	0.81	120
PV2000LT20045	2"	3.33	5.88	0.88	200
PV2500LT25045	2-1/2"	3.83	6.25	1.00	300
PV3000LT30045	3"	4.58	6.25	1.00	420
PV4000LT40045	4"	5.58	6.63	1.13	620

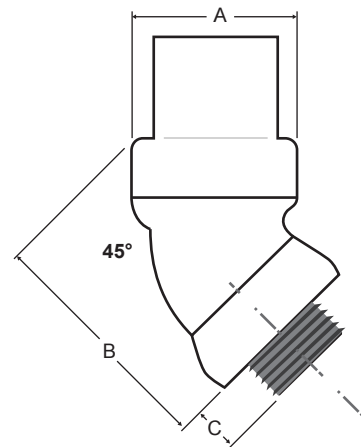

PVC COATED LIQUIDTIGHT CONNECTORS

45° w/ Ground

Item Number	Trade Size	A	B	C	Ground Wire	Weight Per 100 (lbs)
PV0300LT3845G	3/8"	1.24	1.94	0.56	14-8	30
PV0500LT5045G	1/2"	1.46	2.38	0.56	14-8	30
PV0700LT7545G	3/4"	1.74	2.88	0.56	14-4	40
PV1000LT10045G	1"	1.96	3.25	0.75	14-4	50
PV1200LT12545G	1-1/4"	3.33	4.63	0.81	14-4	150
PV1500LT15045G	1-1/2"	3.33	4.88	0.81	14-4	120
PV2000LT20045G	2"	3.89	5.88	0.88	14-4	200
PV2500LT25045G	2-1/2"	4.52	6.25	1.00	1/0-8	300
PV3000LT30045G	3"	5.27	6.25	1.00	1/0-8	420
PV4000LT40045G	4"	6.21	6.63	1.13	3/0-6	620

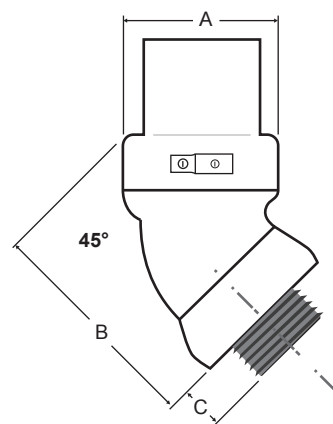

90°

Item Number	Trade Size	A	B	C	Weight Per 100 (lbs)	Aluminum Item Number
PV0300LT3890	3/8"	1.24	1.80	0.56	30	
PV0500LT5090	1/2"	1.46	2.10	0.56	30	PA0500LT5090SA
PV0700LT7590	3/4"	1.74	2.54	0.56	40	PA0700LT7590SA
PV1000LT10090	1"	1.96	3.23	0.75	60	PA1000LT10090SA
PV1200LT12590	1-1/4"	2.36	4.04	0.81	100	PA1200LT12590SA
PV1500LT15090	1-1/2"	2.80	4.48	0.81	170	PA1500LT15090SA
PV2000LT20090	2"	3.33	5.48	0.88	270	PA2000LT20090SA
PV2500LT25090	2-1/2"	3.83	10.92	1.00	380	
PV3000LT30090	3"	4.58	12.3	1.00	420	
PV4000LT40090	4"	5.58	14.7	1.13	620	

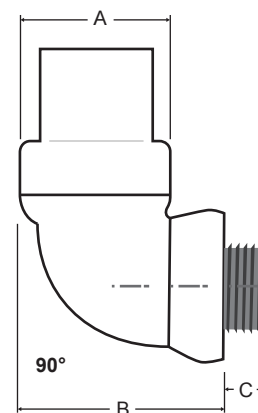

90° w/ Ground

Item Number	Trade Size	A	B	C	Weight Per 100 (lbs)	Aluminum Item Number
PV0300LT3890G	3/8"	1.10	1.55	0.56	30	
PV0500LT5090G	1/2"	1.46	1.98	0.56	30	PA0500LT5090GSA
PV0700LT7590G	3/4"	1.96	2.85	0.75	40	PA0700LT7590GSA
PV1000LT10090G	1"	1.96	3.10	0.75	60	PA1000LT10090GSA
PV1200LT12590G	1-1/4"	2.33	3.79	0.81	100	PA1200LT12590GSA
PV1500LT15090G	1-1/2"	3.33	4.48	0.81	170	PA1500LT15090GSA
PV2000LT20090G	2"	3.89	5.48	0.88	270	PA2000LT20090GSA
PV2500LT25090G	2-1/2"	4.52	10.92	1.00	380	
PV3000LT30090G	3"	5.27	12.3	1.00	420	
PV4000LT40090G	4"	6.21	14.7	1.13	620	

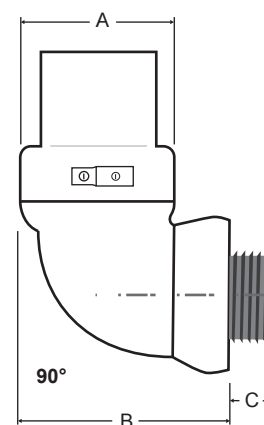

PVC COATED FS & FD BOXES

FS							
Item Number	Trade Size	Weight Per 100 (lbs)	A	B	C	D	Aluminum Item Number
Single gang							
PV0500FS1	1/2"	320	1.38	1.92	1.69	0.67	PA0500FS1SA
PV0700FS2	3/4"	330	1.63	1.92	1.69	0.79	PA0700FS2SA
PV1000FS3	1"	350	2.00	1.92	1.69	0.92	
Double gang							
PV0500FS12	1/2"	330	1.38	1.92	1.69	0.67	PA0500FS12SA
PV0700FS22	3/4"	340	1.63	1.92	1.69	0.79	PA0700FS22SA
PV1000FS32	1"	360	2.00	1.92	1.69	0.92	

FSC							
Item Number	Trade Size	Weight Per 100 (lbs)	A	B	C	D	Aluminum Item Number
Single gang							
PV0500FSC1	1/2"	220	1.38	1.92	1.69	0.67	PA0500FSC1SA
PV0700FSC2	3/4"	240	1.63	1.92	1.69	0.79	PA0700FSC2SA
PV1000FSC3	1"	270	2.00	1.92	1.69	0.92	PA1000FSC3SA
Double gang							
PV0500FSC12	1/2"	330	1.38	1.92	1.69	0.67	
PV0700FSC222	3/4"	360	1.63	1.92	1.69	0.79	
PV1000FSC32	1"	400	2.00	1.92	1.69	0.92	

FSCC							
Item Number	Trade Size	Weight Per 100 (lbs)	A	B	C	D	
PV0500FSCC1	1/2"	250	1.38	1.92	1.69	0.67	
PV0700FSCC2	3/4"	350	1.63	1.92	1.69	0.79	

FD							
Item Number	Trade Size	Weight Per 100 (lbs)	A	B	C	D	Aluminum Item Number
Single Gang							
PV0500FD1	1/2"	270	1.38	1.92	2.69	0.67	PA0500FD1SA
PV0700FD2	3/4"	280	1.63	1.92	2.69	0.79	PA0700FD2SA
PV1000FD3	1"	310	2.00	1.92	2.69	0.92	PA1000FD3SA
Double Gang							
PV0700FD22	3/4"	330	1.63	1.92	2.69	0.79	PA0700FD22SA

FDC							
Item Number	Trade Size	Weight Per 100 (lbs)	A	B	C	D	Aluminum Item Number
PV0500FDC1	1/2"	270	1.38	1.92	2.69	0.67	PA0500FDC1SA
PV0700FDC2	3/4"	280	1.63	1.92	2.69	0.79	PA0700FDC2SA
PV1000FDC3	1"	310	2.00	1.92	2.69	0.92	PA1000FDC3SA

FDCT							
Item Number	Trade Size	Weight Per 100 (lbs)	A	B	C	D	
PV0500FDCT1	1/2"	310	1.38	1.92	2.69	0.67	
PV0700FDCT2	3/4"	340	1.63	1.92	2.69	0.79	
PV1000FDCT3	1"	390	2.00	1.92	2.69	0.92	



PVC COATED DEVICE BOX COVERS - SINGLE GANG COVERS

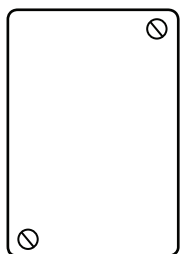

DS100

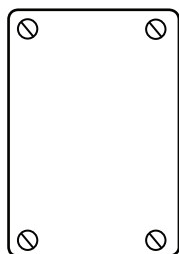

DS100G

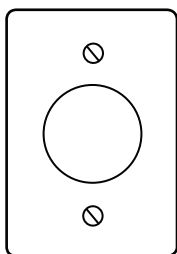

DS21

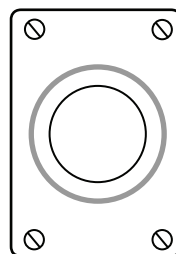

DS21G

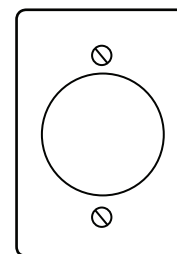

DS35

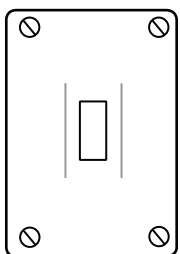

DS32G

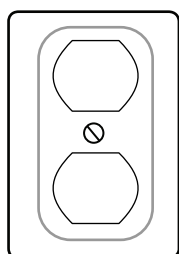

DS23

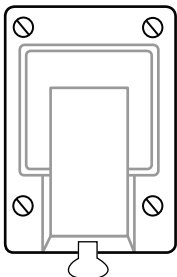

DS128

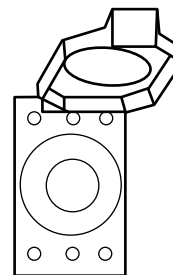

WLR1

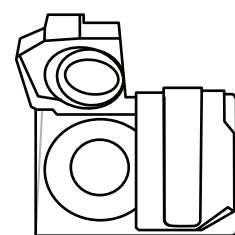

WLRD1

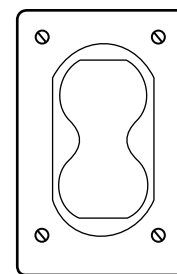

DS23GFI

FERROUS COVERS - SINGLE GANG

Item Number	Item Description	Weight Per 100 (lbs)
PV0000DS21G	3P 2W GROUNDING ROUND FLUSH RECEPTACLES (S,F)	30
PV0000DS23G	DUPLEX CONVENIENCE RECEPTACLE (S,F)	40
PV0000DS23GFI	DUPLEX GFI RECEPTACLE (S,F)	40
PV0000DS35	PLUG RECEPTACLE 1-5/8	40
PV0000DS32G	SQUARE HANDLE SNAP OR TOGGLE (S,F)	40
PV0000WLGf-FS	WLGf-FS HORZ SPRING DOOR COVER GFCI	
PV0000WLGf-FSV	WLGf-FSV VERT SPRING DOOR COVER GFCI	

ALUMINUM COVERS - SINGLE GANG

Item Number	Item Description	Weight Per 100 (lbs)
PA0000DS23SA	DS23SA FS/FD 1 GANG COVER-DUPLEX	10
PA0000DS100	BLANK COVER(S)	10
PA0000DS128	1 GANG COVER-SNAP SWITCH	50
PA0000DS100G	BLANK W/GASKET BLANK COVER CAST (S,F)	30
PA0000WLRD1	DUPLEX SPRING DOOR DUPLEX COVER 1-3/8" (F)	40
PA0000WLR1	SINGLE SPRING DOOR SINGLE COVER 1-3/8" (F)	30
PA0000WLR2	SINGLE SPRING DOOR SINGLE COVER 1-3/8" (F)	30

PVC COATED DEVICE BOX COVERS - DOUBLE GANG COVERS

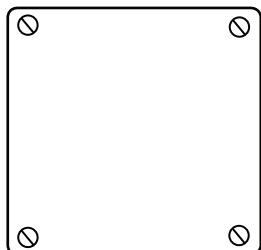

S1002

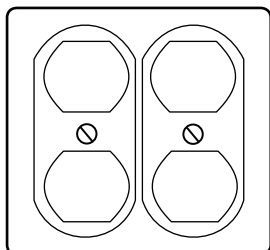

S232

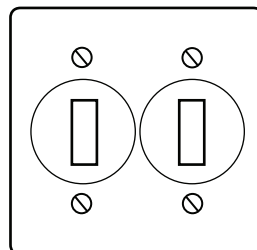

S322

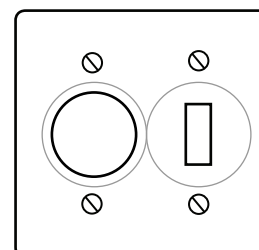

S32212

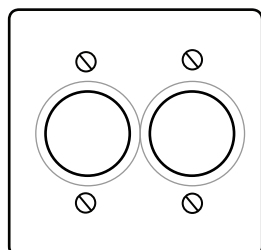

S212

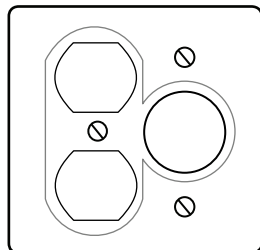

S21232

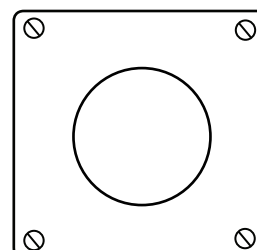

S612

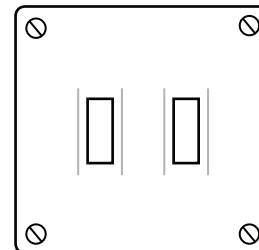

S322G

FERROUS COVERS - DOUBLE GANG

Item Number	Item Description	Weight Per 100 (lbs)
PV0000S1002	BLANK COVER SHEET STEEL (S)	100
PV0000S1002G	BLANK COVER IRON ALLOY (S,F)	100
PV0000S21232	ROUND RECEPTACLE - DUPLEX CONVENIENCE	120
PV0000S232	DUPLEX CONVENIENCE (S)	120
PV0000S322	SURFACE FLUSH - SNAP SWITCH (S)	100
PV0000S32212	SHEET STEEL - ROUND RECEPTACLE + SNAP SWITCH (S)	120
PV0000S212	SHEET STEEL ROUND FLUSH - TWO ROUND RECEPTACLES (S)	200
PV0000S612	SHEET STEEL - 2-POLE SURFACE - 20AMP, 250 V RECEPTACLES	120
PV0000S322G	SURFACE OR FLUSH - SNAP SWITCHES IRON ALLOY (S,F)	120

PVC COATED RIGHT ANGLE CLAMPS

Item Number	Trade Size	Weight Per 100 (lbs)
PV0500RAC50HD	1/2"	49
PV0700RAC75HD	3/4"	53
PV1000RAC100HD	1"	61
PV1200RAC125HD	1-1/4"	65
PV1500RAC150HD	1-1/2"	92
PV2000RAC200HD	2"	100
PV2500RAC250HD	2-1/2"	125
PV3000RAC300HD	3"	150
PV3500RAC350HD	3-1/2"	175
PV4000RAC400HD	4"	198



PVC COATED PARALLEL CLAMPS

Item Number	Trade Size	Weight Per 100 (lbs)
PV0500PARC50HD	1/2"	47
PV0700PARC75HD	3/4"	63
PV1000PARC100HD	1"	67
PV1200PARC125HD	1-1/4"	100
PV1500PARC150HD	1-1/2"	130
PV2000PARC200HD	2"	158
PV2500PARC250HD	2-1/2"	175
PV3000PARC300HD	3"	200
PV3500PARC350HD	3-1/2"	250
PV4000PARC400HD	4"	275



PVC COATED CONDUIT J-HANGER PIPE STRAPS

Item Number	Trade Size	Weight Per 100 (lbs)
PV0500B3690-1/2	1/2"	18
PV0700B3690-3/4	3/4"	21
PV1000B3690-1	1"	22
PV1200B3690-1-1/4	1-1/4"	25
PV1500B3690-1-1/2	1-1/2"	27
PV2000B3690-2	2"	29
PV2500B3690-2-1/2	2-1/2"	64
PV3000B3690-3	3"	72
PV3500B3690-3-1/2	3-1/2"	84
PV4000B3690-4	4"	138
PV5000B3690-5	5"	162



PVC COATED EDGE CLAMPS

Item Number	Trade Size	Weight Per 100 (lbs)
PV0500ETC50HD	1/2"	74
PV0700ETC75HD	3/4"	90
PV1000ETC100HD	1"	100



PVC COATED CLAMP BACK SPACERS

Item Number	Pipe Size	Weight Per 100 (lbs)
PV0500CB1	1/2"	10
PV0700CB2	3/4"	10
PV1000CB3	1"	10
PV1200CB4	1-1/4"	20
PV1500CB5	1-1/2"	20
PV2000CB6	2"	30
PV2500CB7	2-1/2"	100
PV3000CB8	3"	170
PV3500CB9	3-1/2"	190
PV4000CB10	4"	200



PVC COATED 1 & 2 HOLE MALLEABLE STRAPS

1 Hole		
Item Number	Trade Size	Weight Per 100 (lbs)
PV05001S00	1/2"	110
PV07001S00	3/4"	140
PV10001S00	1"	120
PV12001S00	1-1/4"	250
PV15001S00	1-1/2"	360
PV20001S00	2"	710
PV25001S00	2-1/2"	1110
PV30001S00	3"	1340
PV35001S00	3-1/2"	1660
PV40001S00	4"	2560



2 Hole		
Item Number	Trade Size	Weight Per 100 (lbs)
PV05002S00	1/2"	200
PV07002S00	3/4"	300
PV10002S00	1"	400
PV12002S00	1-1/4"	450
PV15002S00	1-1/2"	500
PV20002S00	2"	1000
PV25002S00	2-1/2"	1300
PV30002S00	3"	1700
PV35002S00	3-1/2"	2000
PV40002S00	4"	2500



PVC COATED MINI HANGERS



Item Number	Trade Size	Weight Per 100 (lbs)
PV0500MH00	1/2"	10
PV0700MH00	3/4"	10
PV1000MH00	1"	10
PV1200MH00	1-1/4"	10
PV1500MH00	1-1/2"	20
PV2000MH00	2"	30
PV2500MH00	2-1/2"	40
PV3000MH00	3"	50
PV3500MH00	3-1/2"	60
PV4000MH00	4"	70

PVC COATED U-BOLTS



Item Number	Trade Size	Weight Per 100 (lbs)
PV0500UB00	1/2"	17
PV0700UB00	3/4"	18
PV1000UB00	1"	20
PV1200UB00	1-1/4"	20
PV1500UB00	1-1/2"	31
PV2000UB00	2"	34
PV2500UB00	2-1/2"	39
PV3000UB00	3"	44
PV3500UB00	3-1/2"	45
PV4000UB00	4"	49
PV5000UB00	5"	100
PV6000UB00	6"	130

PVC COATED GROUNDING BUSHINGS



Item Number	Trade Size	Weight Per 100 (lbs)
PV0500GLL1	1/2"	10
PV0700GLL2	3/4"	10
PV1000GLL3	1"	10
PV1200GLL4	1-1/4"	20
PV1500GLL5	1-1/2"	20
PV2000GLL6	2"	30
PV2500GLL7	2-1/2"	50
PV3000GLL8	3"	70
PV3500GLL9	3-1/2"	100
PV4000GLL10	4"	110

PVC COATED GUA JUNCTION BOXES FOR HAZARDOUS LOCATIONS

GUAB								
Item Number	Trade Size	Cover Opening	Weight Per 100 (lbs)	A	B	C	D	Aluminum Item Number
PV0500GUAB14	1/2"	2"	200	2.58	2.29	2.38	0.67	
PV0500GUAB16	1/2"	3"	320	3.58	2.04	1.88	0.67	PA0500GUAB16SA
PV0700GUAB24	3/4"	2"	220	2.58	2.54	2.44	0.79	
PV0700GUAB26	3/4"	3"	330	2.58	2.04	1.88	0.79	PA0700GUAB26SA
PV1000GUAB36	1"	3"	380	3.58	2.35	2.19	0.92	PA1000GUAB36SA
PV1200GUAB47	1-1/4"	3 5/8"	500	4.33	2.73	2.75	1.13	PA1200GUAB47SA
PV1500GUAB59	1-1/2"	5"	810	5.83	3.85	3.75	1.32	PA1500GUAB59SA
PV2000GUAB69	2"	5"	910	5.83	4.10	4.00	1.60	PA2000GUAB69SA

GUAC								
Item Number	Trade Size	Cover Opening	Weight Per 100 (lbs)	A	B	C	D	Aluminum Item Number
PV0500GUAC14	1/2"	2"	350	2.58	2.29	2.19	0.67	
PV0500GUAC16	1/2"	3"	200	3.58	2.04	1.88	0.67	PA0500GUAC16SA
PV0700GUAC24	3/4"	2"	350	2.58	2.04	2.00	0.79	
PV0700GUAC26	3/4"	3"	200	3.58	2.04	1.88	0.79	PA0700GUAC26SA
PV1000GUAC36	1"	3"	390	3.58	2.35	2.19	0.92	PA1000GUAC36SA
PV1200GUAC47	1-1/4"	3-5/8"	520	4.33	2.73	2.75	1.13	PA1200GUAC47SA
PV1200GUAC49	1-1/4"	5"	950	5.83	3.85	3.75	1.20	
PV1500GUAC59	1-1/2"	5"	1100	5.83	3.85	3.75	1.32	PA1500GUAC59SA
PV2000GUAC69	2"	5"	1100	5.83	4.10	4.00	1.60	PA2000GUAC69SA

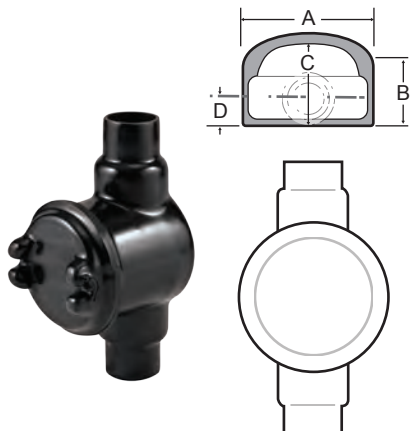
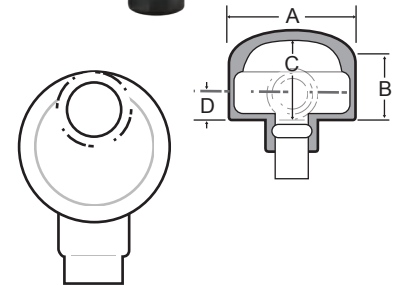

PVC COATED GUA JUNCTION BOXES FOR HAZARDOUS LOCATIONS

GUAL								
Item Number	Trade Size	Cover Opening	Weight Per 100 (lbs)	A	B	C	D	Aluminum Item Number
PV0500GUAL14	1/2"	2"	200	2.58	2.29	2.19	0.67	
PV0500GUAL16	1/2"	3"	210	3.58	2.04	1.88	0.67	PA0500GUAL16SA
PV0700GUAL24	3/4"	2"	320	2.58	2.54	2.44	0.79	
PV0700GUAL26	3/4"	3"	250	3.58	2.04	1.88	0.79	PA0700GUAL26SA
PV1000GUAL36	1"	3"	370	3.58	2.35	2.19	0.92	PA1000GUAL36SA
PV1200GUAL47	1-1/4"	3-5/8"	520	4.33	2.73	2.75	1.13	PA1200GUAL47SA
PV1200GUAL49	1-1/4"	5"	850	5.83	3.85	3.75	1.20	
PV1500GUAL59	1-1/2"	5"	1120	5.83	3.85	3.75	1.32	PA1500GUAL59SA
PV2000GUAL69	2"	5"	1250	5.83	4.10	4.00	1.60	PA2000GUAL69SA

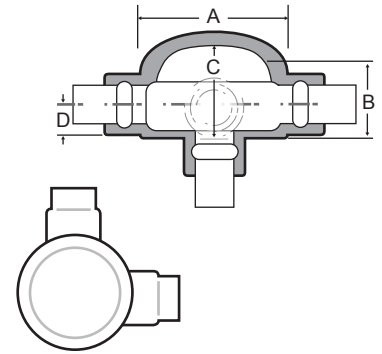

GUAT								
Item Number	Trade Size	Cover Opening	Weight Per 100 (lbs)	A	B	C	D	Aluminum Item Number
PV0500GUAT14	1/2"	2"	200	2.58	2.29	2.19	0.67	
PV0500GUAT16	1/2"	3"	280	3.58	2.04	1.88	0.67	PA0500GUAT16SA
PV0700GUAT24	3/4"	2"	220	2.58	2.04	2.00	0.79	
PV0700GUAT26	3/4"	3"	350	3.58	2.04	1.88	0.79	PA0700GUAT26SA
PV1000GUAT36	1"	3"	320	3.58	2.35	2.19	0.92	PA1000GUAT36SA
PV1200GUAT47	1-1/4"	3-5/8"	570	4.33	2.73	2.75	1.13	PA1200GUAT47SA
PV1500GUAT59	1-1/2"	5"	910	5.83	3.85	3.75	1.32	PA1500GUAT59SA
PV2000GUAT69	2"	5"	1000	5.83	4.10	4.00	1.60	PA2000GUAT69SA

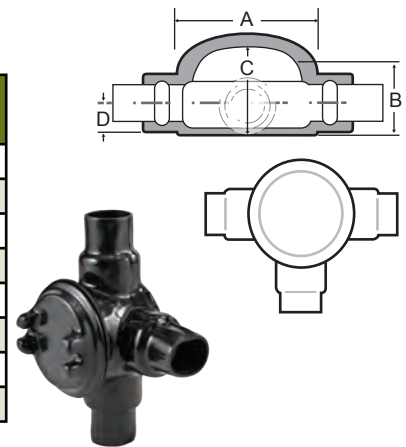

GUAX								
Item Number	Trade Size	Cover Opening	Weight Per 100 (lbs)	A	B	C	D	Aluminum Item Number
PV0500GUAX14	1/2"	2"	200	2.58	1.85	1.75	0.67	
PV0500GUAX16	1/2"	3"	380	3.58	2.04	1.88	0.67	PA0500GUAX16SA
PV0700GUAX24	3/4"	2"	250	2.58	2.04	2.00	0.79	
PV0700GUAX26	3/4"	3"	280	3.58	2.04	1.88	0.79	PA0700GUAX26SA
PV1000GUAX36	1"	3"	420	3.58	2.35	2.19	0.92	PA1000GUAX36SA
PV1200GUAX47	1-1/4"	3-5/8"	480	4.33	2.73	2.75	1.13	PA1200GUAX47SA
PV1500GUAX59	1-1/2"	5"	1170	5.83	3.85	3.75	1.32	PA1500GUAX59SA
PV2000GUAX69	2"	5"	1250	5.83	4.10	4.00	1.60	PA2000GUAX69SA

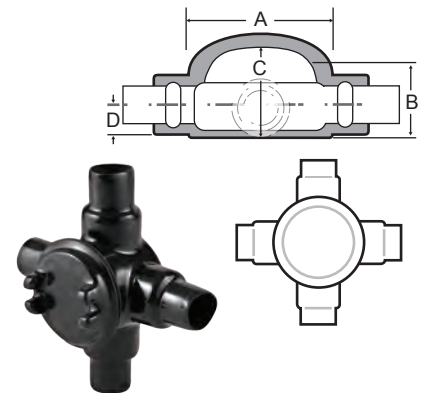

GUAN							
Item Number	Trade Size	Cover Opening	Weight Per 100 (lbs)	A	B	C	D
PV0500GUAN14	1/2"	2"	200	2.58	2.17	2.06	0.67
PV0500GUAN16	1/2"	3"	380	3.58	2.04	1.88	0.79
PV0700GUAN24	3/4"	2"	250	2.58	2.35	2.25	0.79
PV0700GUAN26	3/4"	3"	350	2.58	2.04	1.88	0.79
PV1000GUAN36	1"	3"	300	3.58	2.35	2.38	0.92
PV1200GUAN47	1-1/4"	3-5/8"	520	4.33	2.73	2.75	1.13
PV1500GUAN59	1-1/2"	5"	950	5.83	4.10	4.00	1.32
PV2000GUAN69	2"	5"	1200	5.83	4.10	4.00	1.60

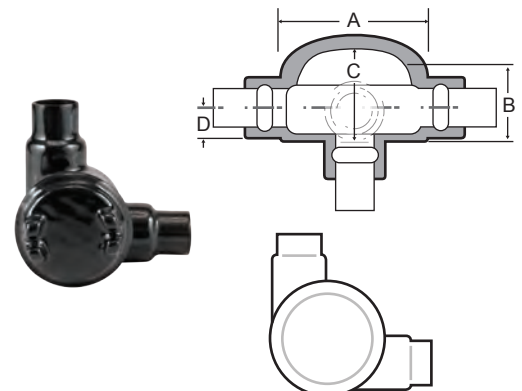

PVC COATED GUA JUNCTION BOXES FOR HAZARDOUS LOCATIONS

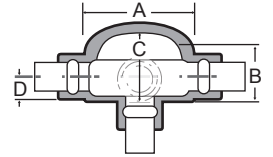
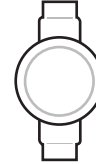
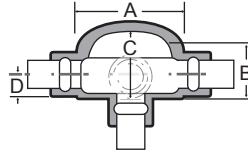
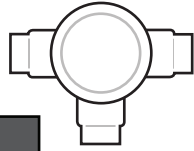

GUAW							
Item Number	Trade Size	Cover Opening	Weight Per 100 (lbs)	A	B	C	D
PV0500GUAW14	1/2"	2"	200	2.58	1.85	1.75	0.67
PV0500GUAW16	1/2"	3"	200	3.58	2.04	1.88	0.67
PV0700GUAW24	3/4"	2"	300	2.58	2.04	2.00	0.79
PV0700GUAW26	3/4"	3"	300	2.58	2.04	1.88	0.79

GUAD							
Item Number	Trade Size	Cover Opening	Weight Per 100 (lbs)	A	B	C	D
PV0500GUAD14	1/2"	2"	200	2.58	1.85	1.75	0.67
PV0500GUAD16	1/2"	3"	320	3.58	2.04	1.88	0.79
PV0700GUAD24	3/4"	2"	350	2.58	2.04	2.00	0.79
PV0700GUAD26	3/4"	3"	380	2.58	2.04	1.88	0.79
PV1000GUAD36	1"	3"	380	3.58	2.35	2.19	0.92
PV1200GUAD47	1-1/4"	5"	1090	5.83	3.85	3.75	1.13

PVC COATED UNIONS

UNF Female-Female

Item Number	Trade Size	Weight Per 100 (lbs)	Length	Max Diameter	Aluminum Item Number
PV0500UNF105	1/2"	30	2.81	1.58	PA0500UNF105SA
PV0700UNF205	3/4"	50	3.25	1.89	PA0700UNF205SA
PV0700UNF215	3/4" - 1/2"	60	3.00	1.89	
PV1000UNF305	1"	70	4.00	1.96	PA1000UNF305SA
PV1200UNF405	1-1/4"	150	4.75	2.83	PA1200UNF405SA
PV1500UNF505	1-1/2"	230	5.63	3.14	PA1500UNF505SA
PV2000UNF605	2"	360	6.56	3.89	PA2000UNF605SA
PV2500UNF705	2-1/2"	500	7.19	4.39	PA2500UNF705SA
PV3000UNF805	3"	650	7.44	5.14	PA3000UNF805SA
PV3500UNF905	3-1/2"	820	8.13	5.77	PA3500UNF905SA
PV4000UNF1005	4"	1000	8.13	6.27	PA4000UNF1005SA
PV5000UNF012	5"	1250	7.81	8.27	
PV6000UNF014	6"	1480	7.81	9.39	



UNY Female-Male

Item Number	Trade Size	Weight Per 100 (lbs)	Length	Max Diameter	Aluminum Item Number
PV0500UNY105	1/2"	40	3.38	1.58	PA0500UNY105SA
PV0700UNY205	3/4"	70	3.94	1.89	PA0700UNY205SA
PV0700UNY215	3/4" - 1/2"	80	3.69	1.89	
PV1000UNY305	1"	130	4.75	1.96	PA1000UNY305SA
PV1200UNY405	1-1/4"	260	5.69	2.83	PA1200UNY405SA
PV1500UNY505	1-1/2"	390	6.56	3.14	PA1500UNY505SA
PV2000UNY605	2"	420	7.75	3.89	PA2000UNY605SA
PV2500UNY705	2-1/2"	550	8.63	4.39	PA2500UNY705SA
PV3000UNY805	3"	750	9.00	5.14	PA3000UNY805SA
PV3500UNY905	3-1/2"	840	9.50	5.77	PA3500UNY905SA
PV4000UNY1005	4"	1050	9.63	6.27	PA4000UNY1005SA
PV5000UNY012	5"	1200	9.25	8.27	
PV6000UNY014	6"	1490	9.38	9.39	

PVC COATED SEALING FITTINGS

EYS Female Hubs

Item Number	Trade Size	Weight Per 100 (lbs)	A	B	Aluminum Item Number
For sealing in vertical positions only					
PV0500EYS1	1/2"	100	4.28	1.33	PA0500EYS1SA
PV0700EYS2	3/4"	150	5.25	1.58	PA0700EYS2SA
PV1000EYS3	1"	210	6.31	1.83	PA1000EYS3SA
For sealing in vertical or horizontal positions					
PV1200EYS4	1-1/4"	270	7.56	2.27	PA1200EYS4SA
PV1500EYS5	1-1/2"	370	8.50	2.52	PA1500EYS5SA
PV2000EYS6	2"	470	10.25	3.08	PA2000EYS6SA
PV2500EYS7	2-1/2"	1000	11.50	3.58	PA2500EYS7SA
PV3000EYS8	3"	1120	12.50	4.33	PA3000EYS8SA
PV3500EYS9	3-1/2"	1450	13.19	4.83	PA3500EYS9SA
PV4000EYS10	4"	1600	13.75	5.33	PA4000EYS10SA



EYS Female Hubs

Item Number	Trade Size	Weight Per 100 (lbs)	A	B	Aluminum Item Number
For sealing in vertical or horizontal positions					
PV0500EYS11	1/2"	130	4.69	1.33	PA0500EYS11SA
PV0700EYS21	3/4"	110	5.19	1.58	PA0700EYS21SA
PV1000EYS31	1"	220	6.31	1.83	PA1000EYS31SA
PV1200EYS41	1-1/4"	300	7.56	2.27	
PV1500EYS51	1-1/2"	380	8.50	2.52	
PV2000EYS61	2"	550	10.25	3.08	

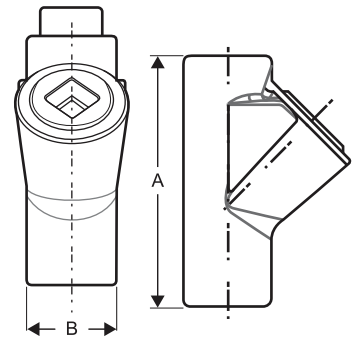

EYS Male-Female Hubs

Item Number	Trade Size	Weight Per 100 (lbs)	A	B	Turning Radius	Aluminum Item Number
For sealing in vertical or horizontal positions						
PV0500EYS116	1/2"	150	5.19	1.33	1.16	PA0500EYS116SA
PV0700EYS216	3/4"	120	5.19	1.58	1.25	PA0700EYS216SA
PV1000EYS316	1"	260	6.31	1.83	1.38	PA1000EYS316SA
PV1200EYS46	1-1/4"	280	4.56	2.27	1.72	
PV1500EYS56	1-1/2"	370	8.50	2.52	2.06	
PV2000EYS66	2"	560	10.25	3.08	2.31	
PV2500EYS76	2-1/2"	1320	11.50	3.58	2.69	
PV3000EYS86	3"	1120	12.50	4.33	3.31	
PV3500EYS96	3-1/2"	1450	13.19	4.83	3.44	
PV4000EYS106	4"	1500	13.75	5.33	3.69	



PVC COATED SEALING FITTINGS

EYS Male-Female Hubs

Item Number	Trade Size	Weight Per 100 (lbs)	A	B	Turning Radius	Aluminum Item Number
For sealing in vertical positions only						
PV0500EYS16	1/2"	150	4.78	1.33	1.63	PA0500EYS16SA
PV0700EYS26	3/4"	150	5.25	1.58	1.91	PA0700EYS26SA
PV1000EYS36	1"	230	6.31	1.83	2.38	PA1000EYS36SA



EYD Male-Female Hubs w/ Drain

Item Number	Trade Size	Weight Per 100 (lbs)	A	B	Aluminum Item Number
For sealing in vertical positions only					
PV0500EYD16	1/2"	270	4.28	1.58	PA0500EYD16SA
PV0700EYD26	3/4"	280	5.19	1.83	PA0700EYD26SA
PV1000EYD36	1"	290	6.31	2.27	PA1000EYD36SA
PV1200EYD46	1-1/4"	260	7.56	2.27	PA1200EYD46SA
PV1500EYD56	1-1/2"	370	8.50	2.52	PA1500EYD56SA
PV2000EYD66	2"	520	10.25	3.08	PA2000EYD66SA
PV2500EYD76	2-1/2"	950	11.50	3.58	PA2500EYD76SA
PV3000EYD86	3"	1130	12.50	4.33	PA3000EYD86SA
PV3500EYD96	3-1/2"	1250	13.19	4.83	PA3500EYD96SA
PV4000EYD106	4"	1670	13.75	5.33	PA4000EYD106SA

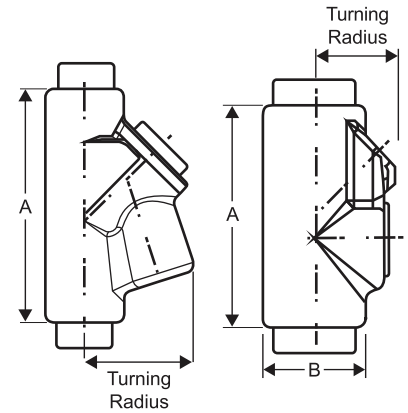

EYD Female Hubs w/ Drain

Item Number	Trade Size	Size Metric (mm)	A	B	Turning Radius	Aluminum Item Number
For sealing in vertical positions only						
PV0500EYD1	1/2"	140	4.28	1.58	1.63	PA0500EYD1SA
PV0500EYD2	3/4"	170	5.19	1.83	1.91	PA0700EYD2SA
PV0500EYD3	1"	230	6.31	2.27	2.38	PA1000EYD3SA
PV0500EYD4	1-1/4"	250	7.56	2.27	1.84	PA1200EYD4SA
PV0500EYD5	1-1/2"	400	8.50	2.52	2.06	PA1500EYD5SA
PV0500EYD6	2"	470	10.25	3.08	2.31	PA2000EYD6SA
PV0500EYD7	2-1/2"	900	11.50	3.58	2.69	PA2500EYD7SA
PV0500EYD8	3"	1020	12.50	4.33	3.31	PA3000EYD8SA
PV0500EYD9	3-1/2"	1050	13.19	4.83	3.44	PA3500EYD9SA
PV0500EYD10	4"	400	13.75	5.33	3.50	PA4000EYD10SA

PVC COATED SEALING FITTINGS

EZS Female Hubs

Item Number	Trade Size	Weight Per 100 (lbs)	A	B	C
For sealing in any position					
PV0500Ezs1	1/2"	200	5.19	3.71	2.58
PV0700Ezs2	3/4"	230	5.19	3.71	2.58
PV1000Ezs3	1"	270	5.94	4.05	3.08
PV1200Ezs4	1-1/4"	350	6.06	4.49	3.08
PV1500Ezs5	1-1/2"	400	6.19	4.64	3.33
PV2000Ezs6	2"	820	11.06	5.49	5.27
PV2500Ezs7	2-1/2"	850	11.94	5.92	5.27
PV3000Ezs8	3"	900	12.63	6.58	5.96



EZS Male-Female Hubs w/ Drain

Item Number	Trade Size	Weight Per 100 (lbs)	A	B	C
For sealing in any position					
PV0500Ezs16	1/2"	200	5.19	3.71	2.58
PV0700Ezs26	3/4"	240	5.69	3.71	2.58
PV1000Ezs36	1"	300	6.94	4.05	3.08
PV1200Ezs46	1-1/4"	400	7.56	4.49	3.08
PV1500Ezs56	1-1/2"	460	8.19	4.64	3.33
PV2000Ezs66	2"	690	11.06	5.49	5.27
PV2500Ezs76	2-1/2"	920	11.94	5.92	5.27
PV3000Ezs86	3"	870	12.63	6.58	5.96

EZD Female Hubs w/ Drain & Inspection Cover

Item Number	Trade Size	A	B	C
PV0500Ezd111	1/2"	5.19	3.08	3.46
PV0700Ezd211	3/4"	5.69	3.08	3.71
PV1000Ezd311	1"	6.94	3.58	3.96
PV1200Ezd411	1-1/4"	7.44	3.58	4.39
PV1500Ezd511	1-1/2"	8.19	3.58	4.64
PV2000Ezd611	2"	11.13	5.64	5.33

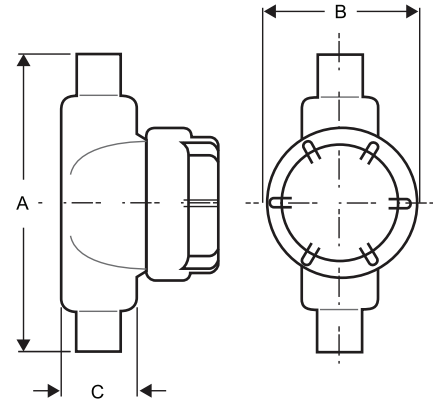

PVC COATED LBD FITTINGS (PULLING ELBOWS)

Item Number	Trade Size	Weight Per 100 (lbs)	Aluminum Item Number
PV0500Lbd1100	1/2"	120	PA0500Lbd1100SA
PV0700Lbd2200	3/4"	200	PA0700Lbd2200SA
PV1000Lbd3300	1"	250	PA1000Lbd3300SA
PV1200Lbd4400	1-1/4"	600	PA1200Lbd4400SA
PV1500Lbd5500	1-1/2"	1150	PA1500Lbd5500SA
PV2000Lbd6600	2"	1800	PA2000Lbd6600SA
PV2500Lbd7700	2-1/2"	2200	PA2500Lbd7700SA
PV3000Lbd8800	3"	3500	PA3000Lbd8800SA
PV3500Lbd9900	3-1/2"	6000	PA3500Lbd9900SA
PV4000Lbd10900	4"	7000	PA4000Lbd10900SA



PVC COATED MOGUL FITTINGS

BUB

Item Number	Trade Size	Weight Per 100 (lbs)	A	B	C	D	E	Aluminum Item Number
PV1000BUB3	1"	320	10.19	2.73	2.27	1.88	6	PA1000BUB3SA
PV1200BUB4	1-1/4"	400	11.06	3.23	2.27	1.88	6	PA1200BUB4SA
PV1500BUB5	1-1/2"	590	15.00	3.54	3.08	2.63	10	PA1500BUB5SA
PV2000BUB6	2"	780	15.50	4.17	3.08	2.63	10	PA2000BUB6SA
PV2500BUB7	2-1/2"	1250	19.75	4.85	4.33	3.81	15	PA2500BUB7SA
PV3000BUB8	3"	1700	19.88	6.57	4.33	3.81	15	PA3000BUB8SA
PV3500BUB9	3-1/2"	2500	25.38	6.42	5.33	4.75	20	PA3500BUB9SA
PV4000BUB10	4"	2800	25.25	6.85	5.33	4.75	20	PA4000BUB10SA

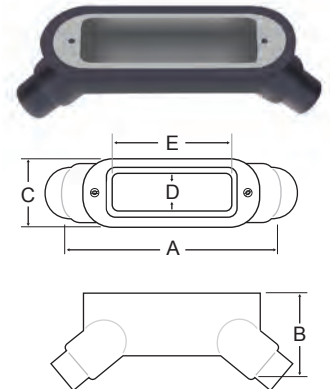

BLB

Item Number	Trade Size	Weight Per 100 (lbs)	A	B	C	D	E	Aluminum Item Number
PV1000BLB3	1"	320	9.63	2.88	2.27	1.88	6	PA1000BLB3SA
PV1200BLB4	1-1/4"	420	9.88	3.32	2.27	1.88	6	PA1200BLB4SA
PV1500BLB5	1-1/2"	600	14.23	3.67	3.08	2.63	10	PA1500BLB5SA
PV2000BLB6	2"	700	14.73	4.23	3.08	2.63	10	PA2000BLB6SA
PV2500BLB7	2-1/2"	1380	18.95	5.13	4.33	3.81	15	PA2500BLB7SA
PV3000BLB8	3"	1750	18.95	5.88	4.33	3.81	15	PA3000BLB8SA
PV3500BLB9	3-1/2"	2500	24.17	6.54	5.33	4.75	20	PA3500BLB9SA
PV4000BLB10	4"	2800	24.17	7.04	5.33	4.75	20	PA4000BLB10SA

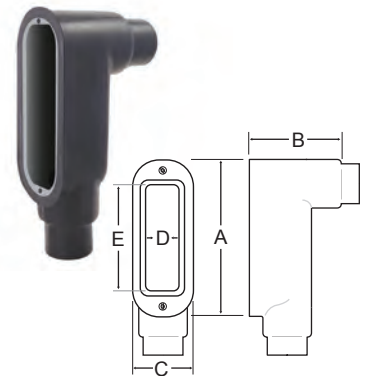

BT

Item Number	Trade Size	Weight Per 100 (lbs)	A	B	C	D	E	Aluminum Item Number
PV1000BT3	1"	320	11.56	1.92	4.20	1.88	6	PA1000BT3SA
PV1200BT4	1-1/4"	360	12.06	2.35	4.45	1.88	6	PA1200BT4SA
PV1500BT5	1-1/2"	750	16.75	2.60	5.60	2.63	10	PA1500BT5SA
PV2000BT6	2"	900	17.75	3.17	6.10	2.63	10	PA2000BT6SA
PV2500BT7	2-1/2"	1500	22.38	3.67	7.63	3.81	15	PA2500BT7SA
PV3000BT8	3"	1900	22.38	4.42	7.76	3.81	15	PA3000BT8SA
PV3500BT9	3-1/2"	2900	27.75	4.92	8.92	4.75	20	PA3500BT9SA
PV4000BT10	4"	3200	27.75	5.42	8.92	4.75	20	PA4000BT10SA

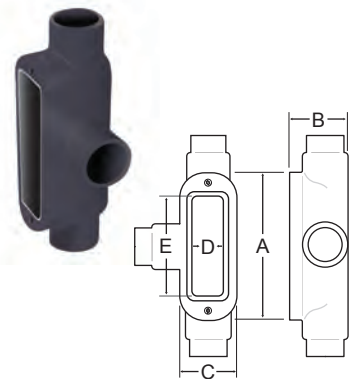

BC

Item Number	Trade Size	Weight Per 100 (lbs)	A	B	C	D	E	Aluminum Item Number
PV1000BC3	1"	320	7.31	1.92	2.27	1.88	6	PA1000BC3SA
PV1200BC4	1-1/4"	400	8.50	2.35	2.27	1.88	6	PA1200BC4SA
PV1500BC5	1-1/2"	590	10.38	2.60	3.08	2.63	10	PA1500BC5SA
PV2000BC6	2"	780	12.25	3.17	3.08	2.63	10	PA2000BC6SA
PV2500BC7	2-1/2"	1250	15.63	3.67	4.33	3.81	15	PA2500BC7SA
PV3000BC8	3"	1700	15.63	4.42	4.33	3.81	15	PA3000BC8SA
PV3500BC9	3-1/2"	2500	18.75	4.92	5.33	4.75	20	PA3500BC9SA
PV4000BC10	4"	2800	18.75	5.42	5.33	4.75	20	PA4000BC10SA

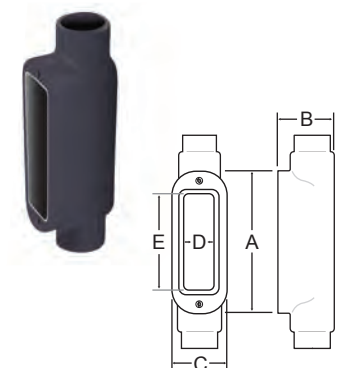

PVC COATED MOGUL FITTINGS COVERS

Item Number	Trade Size	Weight Per 100 (lbs)	Aluminum Item Number
PV1012BG48	1" - 1-1/4"	250	PA1012BG48SA
PV1520BG68	1-1/2" - 2"	320	PA1520BG68SA
PV2530BG88	2-1/2" - 3"	640	PA2530BG88SA
PV3540BG98	3-1/2" - 4"	980	PA3540BG98SA



PVC COATED MALLEABLE FITTINGS

90° Female-Female

Item Number	Trade Size	A	Weight Per 100 (lbs)	Aluminum Item Number
PV0500EL19	1/2"	2.03	70	PA0500EL19SA
PV0700EL29	3/4"	2.50	90	PA0700EL29SA
PV1000EL39	1"	3.00	120	PA1000EL39SA
PV1200EL49	1-1/4"	3.50	240	PA1200EL49SA
PV1500EL59	1-1/2"	5.50	300	PA1500EL59SA
PV2000EL69	2"	7.00	600	PA2000EL69SA
PV2500EL79	2-1/2"	8.44	790	PA2500EL79SA



90° Male-Male

Item Number	Trade Size	A	Weight Per 100 (lbs)
PV0500EL195	1/2"	1.44	30
PV0700EL295	3/4"	1.63	50
PV0700EL395	1"	1.88	70



90° Male-Female

Item Number	Trade Size	A	Weight Per 100 (lbs)	Aluminum Item Number
PV0500EL196	1/2"	2.03	30	PA0500EL196SA
PV0700EL296	3/4"	2.38	50	PA0700EL296SA
PV1000EL396	1"	2.88	120	PA1000EL396SA



PVC COATED SERVICE ENTRANCE ELBOWS

LBY

Item Number	Trade Size	A	B	Weight Per 100 (lbs)	Aluminum Item Number
PV0500LBY15	1/2"	3.10	2.08	100	PA0500LBY15SA
PV0700LBY25	3/4"	3.60	2.33	120	PA0700LBY25SA
PV1000LBY35	1"	4.13	2.58	170	PA1000LBY35SA
PV1200LBY45	1-1/4"	5.04	3.02	250	PA1200LBY45SA
PV1500LBY55	1-1/2"	5.79	3.46	270	PA1500LBY55SA



REDUCING COUPLINGS



Item Number	Trade Size	Weight Per 100 (lbs)	Aluminum Item Number
PV0700REC21	3/4" - 1/2"	20	PA0700REC21SA
PV1000REC31	1" - 1/2"	70	PA1000REC31SA
PV1000REC32	1" - 3/4"	50	PA1000REC32SA
PV1200REC42	1-1/4" - 3/4"	100	PA1200REC42SA
PV1200REC43	1-1/4" - 1"	80	PA1200REC43SA
PV1500REC52	1-1/2" - 3/4"	140	PA1500REC52SA
PV1500REC53	1-1/2" - 1"	120	PA1500REC53SA
PV1500REC54	1-1/2" - 1-1/4"	130	PA1500REC54SA
PV2000REC602	2" - 3/4"	150	PA2000REC602SA
PV2000REC603	2" - 1"	230	PA2000REC603SA
PV2000REC604	2" - 1-1/4"	260	PA2000REC604SA
PV2000REC605	2" - 1-1/2"	280	PA2000REC605SA
PV2500REC75	2-1/2" - 1-1/2"	320	
PV3000REC86	3" - 2"	370	PA3000REC86SA
PV3500REC97	3-1/2" - 2-1/2"	460	
PV4000REC108	4" - 3"	590	
PV5000REC01210	5" - 4"	740	

SPLIT COUPLINGS



Item Number	Trade Size	Weight Per 100 (lbs)
PV0500TCC1	1/2"	39
PV0700TCC2	3/4"	45
PV1000TCC3	1"	68
PV1200TCC4	1-1/4"	82
PV1500TCC5	1-1/2"	116
PV2000TCC6	2"	211
PV2500TCC7	2-1/2"	283
PV3000TCC8	3"	323
PV3500TCC9	3-1/2"	395
PV4000TCC10	4"	506
PV5000TCC12	5"	944
PV6000TCC14	6"	1218

PVC COATED STRUT CHANNELS



Item Number	Style	Trade Size	Weight Per 100 ft	Strut Thickness
PV0000B22	Standard	1-5/8" X 1-5/8"	200	12 ga.
PV0000B22A	Back To Back	1-5/8" X 3-1/4"	380	12 ga.
PV0000B22SH	Slotted Standard	1-5/8" X 1-5/8"	185	12 ga.
PV0000B52	Shallow	1-5/8" X 7/8"	135	12 ga.
PV0000B52SH	Slotted Shallow	1-5/8" X 7/8"	130	12 ga.

CALSTRUT™ STAINLESS STEEL STRUT

SLOTTED STRUT

Trade Size	Gauge	Type	Part Number
1-5/8" X 1-5/8"	12 ga	SS304	S45810ST58
1-5/8" X 7/8"	14 ga	SS304	S45810ST78
1-5/8" X 1-5/8"	12 ga	SS316	S65810ST58
1-5/8" X 7/8"	14 ga	SS316	S65810ST78

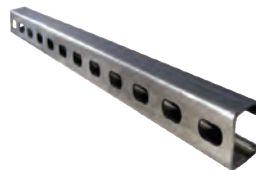

Available in other sizes, styles and gauges upon request. Available in 10' lengths.

BACK-TO-BACK STRUT

Trade Size	Gauge	Type	Item Number
1-5/8" X 1-5/8"	12 ga	SS304	S45810SB58
1-5/8" X 7/8"	14 ga	SS304	S45810SB78
1-5/8" X 1-5/8"	12 ga	SS316	S65810SB58
1-5/8" X 7/8"	14 ga	SS316	S65810SB78



SOLID STRUT

Trade Size	Gauge	Type	Item Number
1-5/8" X 1-5/8"	12 ga	SS304	S45810SL58
1-5/8" X 7/8"	14 ga	SS304	S45810SL78
1-5/8" X 1-5/8"	12 ga	SS316	S65810SL58
1-5/8" X 7/8"	14 ga	SS316	S65810SL78



PVC COATED STRUT STRAPS



Item Number	Trade Size	Gauge Metal	Weight per 100 (lbs)	Standard Pack
PV0500B2008	1/2"	14	13	100
PV0700B2009	3/4"	14	15	100
PV1000B2010	1"	14	17	100
PV1200B2011	1-1/4"	12	19.5	100
PV1500B2012	1-1/2"	12	28	100
PV2000B2013	2"	12	31	50
PV2500B2014	2-1/2"	12	36	50
PV3000B2015	3"	12	42	50
PV3500B2016	3-1/2"	11	56	25
PV4000B2017	4"	11	64	25
PV5000B2019	5"	10	76	25

STRUT CLAMPS

Trade Size	Part Number
1/2"	S60500SC00
3/4"	S60700SC00
1"	S61000SC00
1-1/4"	S61200SC00
1-1/2"	S61500SC00
2"	S62000SC00
2-1/2"	S62500SC00
3"	S63000SC00
3-1/2"	S63500SC00
4"	S64000SC00



(Also available in SS EMT)

STAINLESS STEEL CLAMPS (Type 316SS)

CLAMP BACKS

Trade Size	Part Number
1/2"	S60500CB00
3/4"	S60700CB00
1"	S61000CB00



PVC COATED NIPPLES



Item Number	Trade Size	Length	Wt./each
PV05CLCN00	1/2" X CL	1-1/8"	0.11
PV0520CN00	1/2" X 2"	2"	0.14
PV0525CN00	1/2" X 2-1/2"	2-1/2"	0.18
PV0530CN00	1/2" X 3"	3"	0.21
PV0535CN00	1/2" X 3-1/2"	3-1/2"	0.26
PV0540CN00	1/2" X 4"	4"	0.28
PV0550CN00	1/2" X 5"	5"	0.35
PV0560CN00	1/2" X 6"	6"	0.42
PV0580CN00	1/2" X 8"	8"	0.56
PV0510CN00	1/2" X 10"	10"	0.60
PV0512CN00	1/2" X 12"	12"	0.84
PV07CLCN00	3/4" X CL	1-3/8"	0.11
PV0720CN00	3/4" X 2"	2"	0.20
PV0725CN00	3/4" X 2-1/2"	2-1/2"	0.24
PV0730CN00	3/4" X 3"	3"	0.29
PV0735CN00	3/4" X 3-1/2"	3-1/2"	0.35
PV0740CN00	3/4" X 4"	4"	0.39
PV0750CN00	3/4" X 5"	5"	0.49
PV0760CN00	3/4" X 6"	6"	0.50
PV0780CN00	3/4" X 8"	8"	0.78
PV0710CN00	3/4" X 10"	10"	0.97
PV0712CN00	3/4" X 12"	12"	1.12
PV10CLCN00	1" X CL	1-1/2"	0.11
PV1020CN00	1" X 2"	2"	0.28
PV1025CN00	1" X 2-1/2"	2-1/2"	0.35
PV1030CN00	1" X 3"	3"	0.42
PV1035CN00	1" X 3-1/2"	3-1/2"	0.56
PV1040CN00	1" X 4"	4"	0.56
PV1050CN00	1" X 5"	5"	0.70
PV1060CN00	1" X 6"	6"	0.84
PV1080CN00	1" X 8"	8"	1.12
PV1010CN00	1" X 10"	10"	1.45
PV1012CN00	1" X 12"	12"	1.68
PV12CLCN00	1-1/4" X CL	1-5/8"	0.27
PV1220CN00	1-1/4" X 2"	2"	0.45
PV1225CN00	1-1/4" X 2-1/2"	2-1/2"	0.36
PV1230CN00	1-1/4" X 3"	3"	0.54
PV1235CN00	1-1/4" X 3-1/2"	3-1/2"	0.63
PV1240CN00	1-1/4" X 4"	4"	0.99
PV1250CN00	1-1/4" X 5"	5"	1.20
PV1260CN00	1-1/4" X 6"	6"	1.08
PV1280CN00	1-1/4" X 8"	8"	1.35
PV1210CN00	1-1/4" X 10"	10"	1.80
PV1212CN00	1-1/4" X 12"	12"	2.16

Item Number	Trade Size	Length	Wt./each
PV15CLCN00	1-1/2" X CL	1-3/4"	0.33
PV1520CN00	1-1/2" X 2"	2"	0.44
PV1525CN00	1-1/2" X 2-1/2"	2-1/2"	0.55
PV1530CN00	1-1/2" X 3"	3"	0.60
PV1535CN00	1-1/2" X 3-1/2"	3-1/2"	0.82
PV1540CN00	1-1/2" X 4"	4"	0.88
PV1550CN00	1-1/2" X 5"	5"	1.10
PV1560CN00	1-1/2" X 6"	6"	1.44
PV1580CN00	1-1/2" X 8"	8"	1.76
PV1510CN00	1-1/2" X 10"	10"	2.20
PV1512CN00	1-1/2" X 12"	12"	2.64
PV20CLCN00	2" X CL	2"	0.45
PV2025CN00	2" X 2-1/2"	2-1/2"	0.75
PV2030CN00	2" X 3"	3"	0.90
PV2035CN00	2" X 3-1/2"	3-1/2"	1.05
PV2040CN00	2" X 4"	4"	1.20
PV2050CN00	2" X 5"	5"	1.50
PV2060CN00	2" X 6"	6"	1.80
PV2080CN00	2" X 8"	8"	2.40
PV2010CN00	2" X 10"	10"	3.00
PV2012CN00	2" X 12"	12"	3.60
PV25CLCN00	2-1/2" X CL	2-1/2"	0.68
PV2535CN00	2-1/2" X 3-1/2"	3-1/2"	1.58
PV2540CN00	2-1/2" X 4"	4"	1.88
PV2550CN00	2-1/2" X 5"	5"	2.25
PV2560CN00	2-1/2" X 6"	6"	2.70
PV2580CN00	2-1/2" X 8"	8"	3.20
PV2510CN00	2-1/2" X 10"	10"	4.50
PV2512CN00	2-1/2" X 12"	12"	5.40
PV30CLCN00	3" X CL	2-5/8"	0.89
PV3035CN00	3" X 3-1/2"	3-1/2"	2.07
PV3040CN00	3" X 4"	4"	2.36
PV3050CN00	3" X 5"	5"	2.95
PV3060CN00	3" X 6"	6"	3.54
PV3080CN00	3" X 8"	8"	4.72
PV3010CN00	3" X 10"	10"	5.90
PV3012CN00	3" X 12"	12"	7.08

PVC COATED NIPPLES

Item Number	Trade Size	Length	Wt./each
PV35CLCN00	3-1/2" X CL	2-3/4"	1.02
PV3540CN00	3-1/2" X 4"	4"	3.00
PV3550CN00	3-1/2" X 5"	5"	3.55
PV3560CN00	3-1/2" X 6"	6"	4.88
PV3580CN00	3-1/2" X 8"	8"	5.68
PV3510CN00	3-1/2" X 10"	10"	7.10
PV3512CN00	3-1/2" X 12"	12"	8.52
PV40CLCN00	4" X CL	2-3/4"	1.50
PV4040CN00	4" X 4"	4"	4.00
PV4050CN00	4" X 5"	5"	5.00
PV4060CN00	4" X 6"	6"	6.00
PV4080CN00	4" X 8"	8"	8.00
PV4010CN00	4" X 10"	10"	10.00
PV4012CN00	4" X 12"	12"	12.00
PV50CLCN00	5" X CL	3"	1.82
PV5050CN00	5" X 5"	5"	6.30
PV5060CN00	5" X 6"	6"	8.60
PV5080CN00	5" X 8"	8"	10.80
PV5010CN00	5" X 10"	10"	12.50
PV5012CN00	5" X 12"	12"	15.12



Item Number	Trade Size	Length	Wt./each
PV60CLCN00	6" X CL	3-1/8"	2.10
PV6050CN00	6" X 5"	5"	7.10
PV6060CN00	6" X 6"	6"	9.20
PV6080CN00	6" X 8"	8"	11.30
PV6010CN00	6" X 10"	10"	13.90
PV6012CN00	6" X 12"	12"	16.80

PVC COATED RIGID YARD ELLS

Item Number	Trade Size	Weight Per 100 (lbs)	A	B	C	D	E	Aluminum Item Number
PV0590YL00	1/2" X 90°	140	4.00	18.00	6.19	2.19	14.00	PA0590YL00
PV0790YL00	3/4" X 90°	190	4.50	18.00	6.75	2.25	13.50	PA0790YL00
PV1090YL00	1" X 90°	300	5.75	18.00	8.63	2.88	12.25	PA1090YL00
PV1290YL00	1-1/4" X 90°	480	7.25	19.25	10.25	3.25	12.25	PA1290YL00
PV1590YL00	1-1/2" X 90°	630	8.25	20.50	11.63	3.38	12.25	PA1590YL00
PV2090YL00	2" X 90°	900	9.50	21.50	14.50	5.00	12.00	PA2090YL00
PV2590YL00	2-1/2" X 90°	1450	10.50	22.50	16.00	5.50	12.00	PA2590YL00
PV3090YL00	3" X 90°	2120	13.00	25.00	19.25	6.25	12.00	PA3090YL00
PV3590YL00	3-1/2" X 90°	2830	15.00	27.00	22.75	7.75	12.00	PA3590YL00
PV4090YL00	4" X 90°	3500	16.00	28.00	24.00	8.00	12.00	PA4090YL00

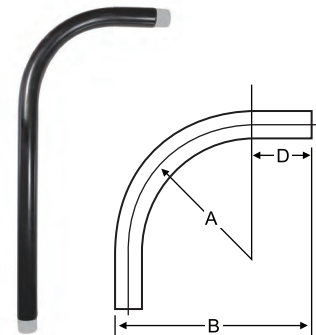

TOUCH UP COMPOUNDS

Item Number	Description	Size
PV-TOUCHUP-GRAY-PT	GRAY TOUCH-UP COMPOUND WITH BRUSH TOP	1 Pint
PV-TOUCHUP-SPRAY	12" OZ SPRAY EXTERIOR GRAY TOUCH UP COMPOUND	12 oz.
PV-THREAD-COMPOUND	CONDUCTIVE COMPOUND WITH BRUSH TOP	1 Pint

INSTALLATION TOOLS

Calbond PVC coated conduit should be installed without damage to the coating on the conduit and fittings. Damage free installation can be attained by using proper tools which have been designed specifically for PVC coated conduit and fittings. Installing Calbond PVC coated conduit using conventional tools may result in damaged coating, allowing for corrosion of the conduit system.

We recommend the installer obtain the proper tools from Calpipe Industries, Inc. or an authorized reseller of tools specially designed for PVC coated conduit and fittings.

BENDING

Hand Bending of Calbond conduit can be done using an EMT bender one size larger than the conduit. For example, to bend ¾" Calbond conduit, use a 1" EMT hand bender.



Ridgid Thin Wall Bender

¾" Model B-1678 Cat# 35215
1" Model B-1679 Cat# 35225



Greenlee 555 Electric Bender

PVC coated shoe group Cat# 12586
For sizes ½" – 2"



Greenlee 881CT Hydraulic Bender

For sizes 2 ½" – 4"

CUTTING

For Hand Cutting use standard cutting tools, either a roller cutter or portable band saw. Be sure to use a reamer on the interior lip after cutting.

Ridgid Hand Cutter Model 202 Cat#32895

Dewalt Hand Held Band Saw DWM120K

Rigid Hand Reamer Model 2 Cat# 34945



CLAMPING

Any conventional vise, either a yoke type or chain type, can be used when clamping Calbond PVC coated conduit. Special jaw adaptors must be used for the yoke type vise and half shell clamps must be used with a chain type vise.

Ridgid Tri-Pod Chain Type

Model 460-6 Cat# 36273

Calbond Half Shell Clamps

Ridgid Tri-Pod Yoke Type

Model 23 Cat# 40090

Model 40-A Cat# 40130

Jaw Adaptors

Cat# 41280



HALF SHELL CONDUIT CLAMP

Part Number	Description
PV0500HS-CLP1/2	1/2" HALF SHELL CLAMP
PV0700HS-CLP3/4	3/4" HALF SHELL CLAMP
PV1000HS-CLP1	1" HALF SHELL CLAMP
PV1200HS-CLP1-1/4	1-1/4" HALF SHELL CLAMP
PV1500HS-CLP1-1/2	1-1/2" HALF SHELL CLAMP
PV2000HS-CLP2	2" HALF SHELL CLAMP
PV2500HS-CLP2-1/2	2-1/2" HALF SHELL CLAMP
PV3000HS-CLP3	3" HALF SHELL CLAMP
PV3500HS-CLP3-1/2	3-1/2" HALF SHELL CLAMP
PV4000HS-CLP4	4" HALF SHELL CLAMP
PV5000HS-CLP4	5" HALF SHELL CLAMP
PV6000HS-CLP4	6" HALF SHELL CLAMP

INSTALLATION TOOLS (cont.)

THREADING

Threading Calbond conduit can be accomplished in several ways by a variety of tools available for rent or purchase from Calbond or an authorized reseller of tools specially designed for threading PVC coated conduit. For hand threading, Ridgid, www.ridgid.com, offers threading dies colored silver to distinguish them from the standard red colored dies. These dies are bored out to allow the throat of the die to go over the coated conduit.



Ridgid Model 12R Threader Set W/die heads for PVC conduit
Cat# 55207

Ridgid Model 700 Pony Threader
Cat# 41935

Ridgid Model 1224
Cat# 26092
Pipe Dies for PVC coated conduit
Cat# 31827
Jaw Set for PVC coated conduit
Cat# 26187

Rothenberger Collins Classic 22A
Cat# 00579
Jaw Set for PVC coated conduit
Cat# 20533



TIGHTENING

Calbond offers special pipe wrenches that will not cause damage to the coating.

Rothenberger	Cat#
10" Pipe Wrench	PV000070159C
14" Pipe Wrench	PV000070160C
18" Pipe Wrench	PV000070161C
24" Pipe Wrench	PV000070162C



PVC EXTERIOR COATING CHEMICAL RESISTANCE CHART

RECOMMENDED EXPOSURE

SOLUTIONS	CONC.	TEMP.	FUMES	SPLASH	IMMERSION
Acetic Acid 10%	120	NO	NO	NO	NO
Acid Copper Plating Sol.		160	YES	YES	YES
Alkaline Cleaners		160	YES	YES	YES
Aluminum Chloride	Sat'd	160	YES	YES	YES
Aluminum Sulfate	Sat'd	160	YES	YES	YES
Alums	Sat'd	160	YES	YES	YES
Ammonium Chloride	Sat'd	160	YES	YES	YES
Ammonium Hydroxide 28%	120	YES	YES	YES	YES
Ammonium Hydroxide 10%	120	YES	YES	YES	YES
Ammonium Sulfate	Sat'd	160	YES	YES	YES
Ammonium Thiocyanate	Sat'd	160	YES	YES	YES
Amyl Alcohol	Any	90	YES	YES	YES
Arsenic Acids	Any	150	YES	YES	YES
Barium Sulfide	Sat'd	160	YES	YES	YES
Black Liquor	Sat'd	90	YES	YES	YES
Benzoic Acid	Sat'd	160	YES	YES	YES
Brass Plating Solution	Any	160	YES	YES	YES
Bromine Water	Sat'd	120	YES	YES	YES
Butyl Alcohol	Any	90	YES	YES	YES
Cadmium Plating Sol.	Any	150	YES	YES	YES
Cadmium Bisulfate	Any	150	YES	YES	YES
Calcium Chloride	Sat'd	160	YES	YES	YES
Calcium Hypochlorite	Sat'd	120	YES	YES	YES
Carbonic Acid	Sat'd	160	YES	YES	YES
Casein	Any	90	YES	YES	YES
Castor Oil	Any	90	YES	YES	YES
Caustic Soda	35%	120	YES	YES	YES
Caustic Soda	10%	150	YES	YES	YES
Caustic Potash	35%	120	YES	YES	YES
Caustic Potash	10%	150	YES	YES	YES
Chlorine Water	Sat'd	90	YES	YES	YES
Chromium Plating Sol.	Any	150	YES	YES	YES
Citric Acid	Sat'd	160	YES	YES	YES
Copper Chloride	Sat'd	160	YES	YES	YES
Copper Cyanide Plating Sol.	Any	160	YES	YES	YES
(High Speed)	Any	180	YES	YES	YES
(with Alkali Cyanides)	Sat'd	160	YES	YES	YES
Copper Sulfate	Sat'd	160	YES	YES	YES
Coconut Oil	Sat'd	90	YES	YES	YES
Cottonseed Oil	Sat'd	90	YES	YES	YES
Disodium Phosphate	Sat'd	160	YES	YES	YES
Ethyl Alcohol	Any	90	YES	YES	YES
Ethylene Glycol	Any	90	YES	YES	NO
Ferric Chloride	45%	120	YES	YES	YES
Ferrous Sulfate	Sat'd	150	YES	YES	YES
Fluoboric Acid	Any	150	YES	YES	YES
Formaldehyde	37%	120	YES	YES	YES
Formic Acid	85%	100	NO	NO	NO
Gallic Acid	Sat'd	150	YES	NO	NO
Glucose	Any	150	YES	YES	YES
Glycerine	Any	90	YES	YES	YES
Gold Plating Solution	Any	150	YES	YES	YES
Hydrochloric Acid	10%	120	YES	YES	YES
Hydrochloric Acid	21.5%	120	YES	YES	YES
Hydrochloric Acid	37.5%	120	YES	YES	NO
Hydrochloric Acid	37.5%	90	YES	YES	NO
Hydrofluoric Acid	4%	140	YES	YES	NO
Hydrofluoric Acid	10%	120	YES	YES	NO
Hydrofluoric Acid	48%	120	YES	YES	NO
Hydrogen Peroxide	30%	120	YES	YES	YES
Hydrogen Sulfide	Sat'd	120	YES	YES	YES
Hydroquinone	Any	90	YES	YES	YES
Indium Plating Solution	Any	150	YES	YES	YES

RECOMMENDED EXPOSURE

SOLUTIONS	CONC.	TEMP.	FUMES	SPLASH	IMMERSION
Lactic Acid 50%	120	YES	YES	YES	YES
Lactic Acid Any	90	YES	YES	YES	YES
Lead Plating Solution	Any	150	YES	YES	YES
Malic Acid	Any	90	YES	YES	YES
Methyl Alcohol	Any	90	YES	YES	YES
Mineral Oils Any	90	YES	YES	YES	YES
Nickel Acetate	Sat'd	160	YES	YES	YES
Nickel Plating Solution		160	YES	YES	YES
Nickel Salts	Sat'd	160	YES	YES	YES
Nitric Acid 35%	120	YES	YES	NO	NO
Nitric Acid 40%	90	YES	YES	NO	NO
Nitric Acid 60%	120	YES	YES	NO	NO
Nitric/Hydrofluoric Acid 15%/4%	140	YES	YES	YES	YES
Nitric Acid/Sodium Dichromate					
Water 16%/13%/71%	130	YES	YES	YE	YES
Oleic Acid	Any	90	YES	YES	YES
Oxalic Acid		90	YES	YES	YES
Phenol	Sat'd	120	NO	NO	NO
Phosphoric Acid	75%	150	YES	YES	YES
Phosphoric Acid	85%	120	YES	YES	YES
Potassium Acid Sulfate	Sat'd	150	YES	YES	YES
Potassium Antimonate	Sat'd	150	YES	YES	YES
Potassium Bisulfite	Sat'd	90	YES	YES	YES
Potassium Chloride	Sat'd	160	YES	YES	YES
Potassium Cuprocyanide	Sat'd	150	YES	YES	YES
Potassium Cyanide	Sat'd	160	YES	YES	YES
Potassium Dichromate	Sat'd	160	YES	YES	YES
Potassium Hypochlorate	Sat'd	90	YES	YES	NO
Potassium Sulfide	Sat'd	150	YES	YES	YES
Potassium Thiosulfate	Sat'd	150	YES	YES	YES
Propyl Alcohol	Sat'd	150	YES	YES	YES
Rhodium Plating Solution	Sat'd	150	YES	YES	YES
Silver Plating Solution	Sat'd	150	YES	YES	YES
Soaps	Any	90	YES	YES	YES
Sodium Acid Sulfate	Sat'd	160	YES	YES	YES
Sodium Antimonate	Sat'd	150	YES	YES	YES
Sodium Bicarbonate	Sat'd	160	YES	YES	YES
Sodium Bisulfite	Sat'd	90	YES	YES	YES
Sodium Chloride	Sat'd	160	YES	YES	YES
Sodium Cyanide	Sat'd	160	YES	YES	YES
Sodium Dichromate	Sat'd	160	YES	YES	YES
Sodium Hydroxide	10%	150	YES	YES	NO
Sodium Hydroxide	35%	120	YES	YES	NO
Sodium Hydroxide	73%	160	NO	NO	NO
Sodium Hypochlorite	Sat'd	90	YES	YES	NO
Sodium Hypochlorite	15%	120	YES	YES	NO
Sodium Sulfide	Sat'd	150	YES	YES	YES
Sodium Thiosulfate	Sat'd	150	YES	YES	YES
Sulfuric Acid	15%	120	YES	YES	YES
Sulfuric Acid	50%	120	YES	YES	YES
Sulfuric Acid	70%	90	YES	YES	NO
Sulfuric Acid	98%	100	YES	NO	NO
Sulfurous Acid	2%	120	YES	YES	NO
Sulfurous Acid	6%	120	YES	YES	NO
Tannic Acid	Sat'd	90	YES	YES	YES
Tartaric Acid	Sat'd	90	YES	YES	YES
Tin Chloride	Sat'd	150	YES	YES	YES
Tin Plating Solution	Sat'd	150	YES	YES	YES
Triethanolamine	Sat'd	150	YES	YES	YES
Trisodium Phosphate	Sat'd	150	YES	YES	YES
White Liquor	Sat'd	90	YES	YES	YES
Zinc Plating Solution		160	YES	YES	YES
Zinc Sulfate	Sat'd	160	YES	YES	YES

URETHANE INTERIOR COATING CHEMICAL RESISTANCE CHART

RECOMMENDED EXPOSURE

SOLUTIONS	CONC.	TEMP.	FUMES	SPLASH	IMMERSION
Acetic Acid	10%	75° F	YES	YES	NO
Acid Copper Plating Sol.	Any	75° F	YES	YES	NO
Alkaline Cleaners	Any	75° F	YES	YES	NO
Aluminum Chloride	Sat'd	75° F	YES	YES	NO
Aluminum Sulfate	Sat'd	75° F	YES	YES	NO
Alums	Sat'd	75° F	YES	YES	NO
Ammonium Chloride	Sat'd	75° F	YES	YES	NO
Ammonium Hydroxide	28%	75° F	YES	YES	NO
Ammonium Hydroxide	10%	75° F	YES	YES	NO
Ammonium Sulfate	Sat'd	75° F	YES	YES	NO
Ammonium Thiocyanate	Sat'd	75° F	YES	YES	NO
Amyl Alcohol	Sat'd	75° F	YES	YES	YES
Arsenic Acids	Any	75° F	YES	YES	NO
Barium Sulfide	Sat'd	75° F	YES	YES	NO
Black Liquor	Sat'd	75° F	YES	YES	NO
Benzoic Acid	Sat'd	75° F	YES	YES	NO
Brass Plating Solution	Sat'd	75° F	YES	YES	NO
Bromine Water	Sat'd	75° F	YES	YES	NO
Butyl Alcohol	Any	75° F	YES	YES	NO
Cadmium Plating Sol.	Any	75° F	YES	YES	NO
Cadmium Bisulfate	Any	75° F	YES	YES	NO
Calcium Chloride	Sat'd	75° F	YES	YES	NO
Calcium Hypochlorite	Sat'd	75° F	YES	YES	NO
Carbonic Acid	Sat'd	75° F	YES	YES	NO
Casein	Any	75° F	YES	YES	NO
Castor Oil	Any	75° F	YES	YES	YES
Caustic Soda	35%	75° F	YES	YES	NO
Caustic Soda	10%	75° F	YES	YES	NO
Caustic Potash	35%	75° F	YES	YES	NO
Caustic Potash	10%	75° F	YES	YES	NO
Chlorine Water	Sat'd	75° F	YES	YES	NO
Chromium Plating Sol.	Any	75° F	YES	YES	NO
Citric Acid	Sat'd	75° F	YES	YES	NO
Copper Chloride	Sat'd	75° F	YES	YES	NO
Copper Cyanide Plating Sol.	Any	75° F	YES	YES	NO
Copper Sulfate	Sat'd	75° F	YES	YES	NO
Coconut Oil	Sat'd	75° F	YES	YES	YES
Cottonseed Oil	Sat'd	75° F	YES	YES	YES
Disodium Phosphate	Sat'd	75° F	YES	YES	NO
Ethyl Alcohol	Any	75° F	YES	YES	NO
Ethylene Glycol	Any	75° F	YES	YES	YES
Ferrous Sulfate	Sat'd	75° F	YES	YES	NO
Fluoboric Acid	Any	75° F	YES	YES	NO
Formaldehyde	37%	75° F	YES	YES	NO
Formic Acid	85%	75° F	YES	YES	NO
Gallic Acid	Sat'd	75° F	YES	YES	NO
Glucose	Any	75° F	YES	YES	YES
Glycerine	Any	75° F	YES	YES	YES
Gold Plating Solution	Any	75° F	YES	YES	NO
Hydrochloric Acid	10%	75° F	YES	YES	NO
Hydrochloric Acid	21.5%	75° F	YES	YES	NO
Hydrochloric Acid	37.5%	75° F	YES	YES	NO
Hydrofluoric Acid	4%	75° F	YES	YES	NO
Hydrofluoric Acid	10%	75° F	YES	YES	NO
Hydrofluoric Acid	48%	75° F	YES	YES	NO
Hydrogen Peroxide	30%	75° F	YES	YES	NO
Hydroquinone	Any	75° F	YES	YES	NO
Indium Plating Solution	Any	75° F	YES	YES	NO
Lactic Acid	Any	75° F	YES	YES	NO
Lead Plating Solution	Any	75° F	YES	YES	NO

RECOMMENDED EXPOSURE

SOLUTIONS	TEMP.	CONC.	FUMES	SPLASH	IMMERSION
Malic Acid	Any	75° F	YES	YES	NO
Methyl Alcohol	Any	75° F	YES	YES	NO
Mineral Oils	Any	75° F	YES	YES	YES
Nickel Acetate	Sat'd	75° F	YES	YES	NO
Nickel Plating Solution	Any	75° F	YES	YES	NO
Nickel Salts	Sat'd	75° F	YES	YES	NO
Nitric Acid	35%	75° F	YES	YES	NO
Nitric Acid	40%	75° F	YES	YES	NO
Nitric Acid	60%	75° F	YES	YES	NO
Nitric/Hydrofluoric Acid	15%/4%	75° F	YES	YES	NO
Nitric Acid/Sodium Dichromate					
Water	16%/13%/71%	75° F	YES	YES	NO
Oleic Acid	Any	75° F	YES	YES	NO
Oxalic Acid	Any	75° F	YES	YES	NO
Phenol	Sat'd	75° F	YES	YES	NO
Phosphoric Acid	75%	75° F	YES	YES	NO
Phosphoric Acid	85%	75° F	YES	YES	NO
Potassium Acid Sulfate	Sat'd	75° F	YES	YES	NO
Potassium Antimonate	Sat'd	75° F	YES	YES	NO
Potassium Bisulfite	Sat'd	75° F	YES	YES	NO
Potassium Chloride	Sat'd	75° F	YES	YES	NO
Potassium Cuprocyanide	Sat'd	75° F	YES	YES	NO
Potassium Cyanide	Sat'd	75° F	YES	YES	NO
Potassium Dichromate	Sat'd	75° F	YES	YES	NO
Potassium Hypochlorate	Sat'd	75° F	YES	YES	NO
Potassium Sulfide	Sat'd	75° F	YES	YES	NO
Potassium Thiosulfate	Sat'd	75° F	YES	YES	NO
Propyl Alcohol	Sat'd	75° F	YES	YES	NO
Rhodium Plating Solution	Sat'd	75° F	YES	YES	NO
Silver Plating Solution	Sat'd	75° F	YES	YES	NO
Soaps	Any	75° F	YES	YES	NO
Sodium Acid Sulfate	Sat'd	75° F	YES	YES	NO
Sodium Antimonate	Sat'd	75° F	YES	YES	NO
Sodium Bicarbonate	Sat'd	75° F	YES	YES	NO
Sodium Bisulfite	Sat'd	75° F	YES	YES	NO
Sodium Chloride	Sat'd	75° F	YES	YES	NO
Sodium Cyanide	Sat'd	75° F	YES	YES	NO
Sodium Dichromate	Sat'd	75° F	YES	YES	NO
Sodium Hydroxide	10%	75° F	YES	YES	NO
Sodium Hydroxide	35%	75° F	YES	YES	NO
Sodium Hydroxide	73%	75° F	YES	YES	NO
Sodium Hypochlorite	Sat'd	75° F	YES	YES	NO
Sodium Hypochlorite	15%	75° F	YES	YES	NO
Sodium Sulfide	Sat'd	75° F	YES	YES	NO
Sodium Thiosulfate	Sat'd	75° F	YES	YES	NO
Sulfuric Acid	15%	75° F	YES	YES	NO
Sulfuric Acid	50%	75° F	YES	YES	NO
Sulfuric Acid	70%	75° F	YES	YES	NO
Sulfuric Acid	98%	75° F	YES	YES	NO
Sulfurous Acid	2%	75° F	YES	YES	NO
Sulfurous Acid	4%	75° F	YES	YES	NO
Tannic Acid	Sat'd	75° F	YES	YES	NO
Tartaric Acid	Sat'd	75° F	YES	YES	NO
Tin Chloride	Sat'd	75° F	YES	YES	NO
Tin Plating Solution	Sat'd	75° F	YES	YES	NO
Triethanolamine	Sat'd	75° F	YES	YES	NO
Trisodium Phosphate	Sat'd	75° F	YES	YES	NO
White Liquor	Sat'd	75° F	YES	YES	NO
Zinc Plating Solution	Sat'd	75° F	YES	YES	NO
Zinc Sulfate	Sat'd	75° F	YES	YES	NO

- A. The conduit shall be hot dipped galvanized inside and out with galvanized threads.
- B. The galvanized rigid conduit must be UL6 with both the PVC and underlying zinc listed as primary protection against corrosion without exception.
- C. The PVC coating on the conduit shall conform in all respects to the NEMA RN-1 standard.
- D. All fittings shall be UL® listed prior to coating.
- E. All fittings shall be supplied with stainless steel screws equipped with PVC encapsulated heads.
- F. All conduit and fittings shall have a 2 mil (.020") thick urethane coating on their interior surfaces. The bond of the interior coating shall be tested using the tape test method (ASTM D3359) and will show no trace of paint after an acetone wipe using test method (ASTM D1308).
- G. All male threads of elbows, nipples and factory offsets will be galvanized.
- H. All female threads will be protected by a urethane coating.
- I. All female threads will have a PVC flexible sleeve extending from them to facilitate complete coverage of the installed conduit. The length of the sleeve will be one pipe diameter but no more than 2".
- J. All conduit clamps will be oversized to fit the PVC coated conduit or will be made of stainless steel.
- K. The following test methods shall be used in evaluating Calbond conduit and fittings:
 - 1. ASTM D149 - 09 Standard test method for dielectric breakdown voltage and dielectric strength of solid electrical insulating materials at commercial power frequencies.
 - 2. ASTM D1735 - 08 Standard practice for testing water resistance of coatings using water fog apparatus.
 - 3. ASTM D2247 - 11 Standard practice for testing water resistance of coatings 100% relative humidity.
 - 4. ASTM D2240 - 05(2010) Standard test method for rubber property - durometer hardness.
 - 5. ASTM D1308 - 02(2007) Standard test method for effect of household chemicals on clear and pigmented organic finishes.
 - 6. ASTM D638 - 10 Standard test method for tensile properties of plastics.
 - 7. ASTM D746 -07 Standard test method for brittleness temperature of plastics and elastomers by impact.
 - 8. ASTM D1151 - 00(2006) Standard practice for effect of moisture and temperature on adhesive bonds.
 - 9. ASTM D870 - 09 Standard practice for testing water resistance of coatings using water immersion.
 - 10. ASTM G152 - 06 Standard practice for operating open flame carbon arc light apparatus for exposure of non-metallic materials.

CALBOND PRODUCT SPECIFICATIONS (cont.)

11. ASTM G153 - 04(2010) Standard practice for operating enclosed carbon arc light apparatus for exposure of non-metallic materials.
12. ASTM D3359 - 09e2 Standard test methods for measuring adhesion by tape test.
13. ASTM D4585 - 07 Standard practice for testing water resistance of coatings using controlled condensation.
14. ASTM B571 - 97(2008)e1 Standard practice for qualitative adhesion testings of metallic coatings.

FAQs

1. What are the applicable standards for PVC coated rigid steel conduit?

Three standards govern the design and performance of PVC-coated rigid steel conduit:

- American National Standards Institute (ANSI) C80.1
- Underwriters Laboratories UL6
- National Electrical Manufacturers Association (NEMA) RN-1

All three of these standards conform to the appropriate American Society for Testing and Materials (ASTM) standards and test methods.

2. What are the steps in determining the effectiveness of corrosion protection on products?

The first step requires an evaluation of the zinc-galvanized coating beneath the PVC coating and on threaded surfaces. The second step is to evaluate the adhesion of the PVC coating to the zinc.

3. Why is the effectiveness of corrosion protection on PVC coated conduit systems important?

In cases where the PVC protection is accidentally breached, due to cuts, scrapes, or other damage, it is important to have a second line of defense - a zinc or "galvanized" coating. This zinc coating will significantly slow the corrosion and allow more time for repairs.

4. What are the consequences of not having a proper coating of zinc coating?

Conduit systems without adequate zinc protection underneath the PVC coating are more likely to suffer catastrophic corrosion damage. This is why NEMA RN-1, section 3.1.1 requires the proper and correct treatment of galvanized conduit before it is PVC coated. The standard says, "The surface shall be cleaned in such a manner that the galvanized surface of the conduit is not harmed or eroded."

5. What tests are required to ensure compliance to NEMA RN-1, section 3.1.1?

The Preece test, which follows procedures set forth by ASTM A239, is the test recognized by UL 6, NEMA RN-1 and ANSI C80.1 to assess the adequacy of zinc protection for rigid steel conduit.

6. What is the Preece test?

The test is done to evaluate the zinc coating on galvanized rigid conduit to ensure adequate protection from corrosion per UL 6.2.2 by subjecting the coated product to four 60-second immersions in a copper sulfate solution. The test also determines if the surface of the conduit has been damaged as a result of the preparation for PVC coating.

7. If the PVC coating is UL® Listed as the primary corrosion protection, does that mean the conduit complies with NEMA RN-1?

No, if the zinc coating is not adequate, the conduit will not comply with NEMA RN-1.

8. Does Calbond offer this level of protection?

Yes. Calbond FULLY complies with NEMA RN-1, in all respects.

9. Do Calbond Fittings comply with the NEMA 4X standard?

Yes. Calbond Form 8 & Form 7 fittings comply with the NEMA 4X standard. In addition, Calbond GUA boxes comply with the NEMA 4X explosion proof standards.

10. What color is the interior urethane coating on Calbond PVC Coated Conduit Systems?

Calbond PVC Coated Conduit Systems feature a 2mil light gray urethane interior coating.

11. Where is Calbond manufactured?

Calbond is manufactured in the industry's newest, and state of the art, PVC coating factory located in Santa Paula, California.

FAQs (cont.)

12. Is Calbond product made in the USA?

Calbond PVC Coated Conduit Systems are fully manufactured in USA and completely ARRA, Buy America Act compliant.

13. Will you ship direct to the jobsite?

Yes we will. For convenience to our customers and their projects, we will ship our products wherever needed as soon as possible.

14. Can contractors or end-users buy direct from Calbond?

Calbond sells only to authorized electrical distributors. We will gladly assist you in locating a distributor in your area.

15. Who should I contact for pricing and general information?

Calbond has a national network of sales representatives serving customers across the USA. Feel free contact the sales representative closest to your location anytime. calbond.com/map/rep.html

16. What type of threads are used on your PVC Coated conduit?

Calbond's PVC Coated conduit threads are manufactured with standard NPT conduit threads and fully comply with UL6 specifications.

17. Is a coupling included with your conduit?

Yes. One PVC coated coupling with flexible overlapping sleeves is included with each length.

18. Do you offer elbows other than standard 90° & 45°?

Yes. Degree of bends available: 11-1/4°, 15°, 22-1/2°, 30°, 45°, 90° Large radius PVC coated elbows are also available upon request in 24", 36", 48" and 60"?

19. Is the GRC conduit used to make Calbond PVC Coated GRC, hot dipped galvanized?

Calbond PVC Coated GRC is produced using Galvanized Rigid Conduit GRC that meets UL6 standards. It is hot-dipped galvanized inside and outside, ensuring metal-to-metal contact and galvanic protection against corrosion.

20. What is the standard for Aluminum PVC Coated Conduit?

UL6A, Calpipe Industries UL® File Number is E230584.

TERMS & CONDITIONS

General

- a. Unless verified or modified in writing and signed by both parties by persons having authority to sign the same, the following terms and conditions shall form the basis of any contract between Calpipe Industries, Inc. (hereafter called Calpipe) and the Purchaser which may result from any order placed with Calpipe.
- b. Unless otherwise noted, any quotation is valid for a period of 10 days from the above date, after which it may be subject to review.

Orders

The placement of any orders upon Calpipe implies Purchaser's acceptance of these terms and conditions and takes precedence over any other terms and conditions written or oral.

Delivery

Time of delivery will be complied with wherever possible. It is not guaranteed and is subject to extensions to cover delays caused by strikes, vehicle breakdown, traffic delays, weather and any causes beyond Calpipe's control. The Purchaser shall not be entitled to be compensated for any loss or damage due to any of the above causes. All goods are FOB whether or not the shipper is nominated by Purchaser.

Passing of Title

Title of goods and materials to be supplied and or installed shall remain with Calpipe until the full purchase price has been paid. Upon default in payment, Calpipe reserves the right to enter your premises and recover such goods.

Warranty

Calpipe warrants the equipment manufactured to specification and to be free from defects in material and workmanship for 2 years from time of shipment or 5 years if installed by a certified installer. Calpipe will repair or replace at its option any product, which it determines to contain defective material and workmanship. Our warranty does not extend to "fair wear" and "tear" or negligent use of our product. This warranty is in lieu of all other warranties expressed or implied. Calpipe shall not be liable for any special indirect, incidental or consequent damages of any kind or nature. The Purchaser acknowledges and agrees with Calpipe that:

- a. That it is satisfied that the goods are suitable for its intended purpose;
- b. That in all matters relating to the goods, the Purchaser has relied and will rely entirely upon the Purchaser's own judgment;
- c. That no warranty as to the fitness for any particular purpose will apply to this contract.
- d. That any implied warranty or condition, whether Statutory or otherwise, and whether as to the quality, state, condition or fitness for any particular purpose or as to any other matter or thing whatsoever is hereby expressly excluded from this contract.

Good Faith

Any advice, recommendation, information, assistance or service provided by Calpipe staff in relation to goods sold or their use or application is given in good faith and is believed by Calpipe to be appropriate and reliable. The Purchaser acknowledges that such advice, recommendation, information, assistance or service are provided as an act of good faith and do not indicate any expertise peculiar to Calpipe and acknowledges that such advice, recommendation, information, assistance or service is provided without liability or responsibility on the part of Calpipe.

Returns

No material will be accepted without prior written authorization. Undamaged items in resalable condition will only be accepted with a restocking charge of 35% of the invoiced price. In some cases, for material shipped direct to a jobsite, as specified on the quote, all items are non-returnable. All returning freight must be prepaid and all claims will be subject to our confirmation of quantities and condition of material received. No material will be accepted after 90 days, unless written authorization has been obtained at the time the original purchase order was accepted. Warranty claim for defective material is 60 days from receipt of goods at destination. Approved returns must be received at Calbond's facility within 60 days of the issue date of RMA.

Why consider PVC coated aluminum conduit over PVC coated galvanized conduit?

- Coated RAC (Rigid Aluminum Conduit) is one-third the weight of RMC (Rigid Metal Conduit).
- Coated RAC provides users with easy field fabrication resulting in lower installation costs.
- Coated RAC provides extra protection in most corrosive and industrial environments.
- Coated RAC is non-sparking and meets all National Electrical code - Article 500 Hazardous Area Requirements, making it the ideal choice in explosion proof locations.
- Coated RAC is non-magnetic, providing protection for sensitive environments.
- Calbond coated RAC is UL6A and NEMA RN-1 compliant, without exceptions.
- All Calbond products are made in the USA.

A division of

CALPIPE INDUSTRIES™
Incorporated

INDUSTRIES SERVED

Food, Dairy & Beverage
Water & Wastewater Treatment Facilities
Mining
Marine & Coastal Facilities
Chemical Plants
Petrochemical
Steel Mills
Offshore Platforms
Breweries
Cooling Towers
Transportation & Infrastructure
Pharmaceuticals
Power Plants
Solar Farms
Pulp and Paper Mills
Fertilizer Plants
and other corrosive & harsh environments



USA Manufacturing Location
Keep America Working



Calpipe Industries
Corporate offices
19440 S. Dominguez Hills Dr.
Rancho Dominguez, CA 90220
(800) Calpipe
(310) 885-1890 fax

Calbond
Manufacturing Facility
923 Calpipe Rd.
Santa Paula, CA 93060
(562) 803-4388
(310) 885-1894 fax