

NuTone®

**Central Vacuum
Systems
and
Accessories**



April 2014



Unparalleled
power.

Unimaginable
quiet performance.

Table of Contents

- | | | | |
|-------|--|-------|---|
| 4-7 | Power Units
Choose from seven models – bagged or bagless cyclonic | 16-17 | Accessories
Additional accessories to complement the deluxe and standard tool sets |
| 8-9 | Automatic Dustpans | 18-21 | Hoses
A wide selection, including crushproof hoses |
| 10-11 | Power Brushes
For deep cleaning in homes with carpeting as the primary floor covering | 22-25 | Inlets
NuTone inlets bring “intelligence” to central cleaning |
| 12-14 | Tool Sets
Quality attachments packaged for traditional cleaning | 26-29 | System Planning & How to Choose |
| 15 | Garage Kits | 30-31 | Fittings |

Does your loud vacuum cleaner cause stress for you and your family? Do you feel you must sacrifice cleaning power for a quiet vacuum cleaner?

Not any longer!

NuTone's® Central Vacuum System is the quietest and most powerful cleaning system for doing more than just cleaning floors. It enhances your home's environment by improving indoor air quality and reducing noise while providing exceptionally clean carpets and other surfaces. Now cleaning can be accomplished while the baby is sleeping or the family is enjoying their favorite television show. NuTone's Central Vacuum System is a quick, effective and quiet way to remove dust and allergens from your home with minimal effort.

More Cleaning Power

Up to five times more powerful than upright and canister systems, NuTone central vacuum systems pull more dirt and dust out of the house and exhaust it outside of your home.

Better Dust Filtration

Dirt and dust are captured inside the Power Unit – away from living areas. With HEPA® filtration and anti-stick technology, dust and bacteria are trapped in the bag.

Built-in Convenience

The lightweight hose is all you have to carry upstairs or from room to room. No heavy canister or upright vacuum to lug around. And, the handy VacPan™ makes small clean ups in the kitchen a breeze.

Quiet Performance

The internal sound suppression system reduces noise disturbance. In addition, with the power unit mounted in the basement, garage or utility area, the noise is away from your living area.

Good Investment

Increase the resale value of your home without investing much more than the cost of a portable vacuum.



Redefining the Central Vac System



Accurate bag-full or tank-full lights.

Progressive status indicator lights tell you in a glance when to change the bag or empty the debris basin. Bagged models feature a true "bag-full" light and shut down automatically to avoid rupturing the bag.

Clean quietly.

Noise is suppressed better than ever before. Our revolutionary internal sound suppression system deadens sound. No external muffler is required! What's more, our quick-mount installation brackets minimize vibration.

Snap, drop, discard.

On bagless cyclonic models, remove the debris canister in just a few seconds. Undo the two snap closures and whisk it away. Filter cleaning and replacement is a breeze.

Convenient...

NuTone's Central Vac Power Units feature a sleek design allowing it to mount closely against the wall so you can make the most of your space. The revolutionary internal sound suppression system provides a much quieter performance. And, for added convenience, we've included a status light on the power unit which indicates when the VX™ unit's bag or canister is full and needs emptying.

Powerful...

Our motor designs have up to 5 times more cleaning power than conventional vacuums. Select the model that best fits your home size – with our single unit VX1000 providing enough power to clean a home up to 12,000 square feet. And with better filtration, you won't just be spreading the dust around. Microscopic dust particles are exhausted to the exterior of your home, unlike conventional vacuums.

Warranty...

NuTone offers one of the best in the industry. The VX475 models have a 2-year warranty, VX550 models a 4-year warranty and the VX1000 models come with a full 8-year warranty on the Power Unit.

Finally, don't discard your old attachments. Your current accessories can be used with our VX Power Units. Or, keep it as a spare kit close at hand in your workshop, hobby room or garage when you require those quick clean ups!



Convenient installation.

Left- or right-hand intake ports simplify new or retrofit installations. The slim profile lets the tank fit in tight corners.



Simplified bag removal and filter changing.

Just open the front-facing door panel and withdraw the full bag. Our easy-to-use bag change mechanism closes the opening immediately upon removal, so what goes in, stays in. Filters for bagless cyclonic models remove the same way. Tap the clean side of the filter and dirt stuck to it will fall into the debris pail – not onto the floor.

HEPA® filtration. Anti-stick technology.

Our high performance bags and filters feature HEPA® rated media and anti-stick technology. 99.97% of all particles, such as dust, dander and pollen, are trapped in the filter. Better than ever before.



NuTone® VX Power Units... Quality from Top to Bottom

Easy-to-clean cyclonic filter means an occasional tap on top of filter (easily accessible through door panel) returns it to new status

State-of-the-art control board gives timed fill indicators for cyclonic units (VX550C, VX1000C)

Motor baffle greatly reduces cooling fan noise, while optimizing cooling air flow

Easy access door for filter cleaning

Air filtration with HEPA® and anti-stick technology (VX550C, VX1000C)

Built in sound suppression greatly reduces motor noise

Left and right intake for flexible installation

Oval Shape for space saving mounting

Pail with easy on/off snap release

Integrated site glass in debris pail to check fill level



VX475, 550 and 1000 Vacuum Systems



VX475
Bagged Version Shown
(Cyclonic Version VX475C)
– 2-year warranty
– 4 gallon debris pail
– For homes < 4,000 sq. ft.



VX550C
Cyclonic Version Shown
(Bagged Version VX550)
– 4-year warranty
– 7 gallon debris pail
– Bag-full indicator light
– For homes < 8,000 sq. ft.



VX1000
Bagged Version Shown
(Cyclonic Version VX1000C)
– 8-year warranty
– 7 gallon debris pail
– Bag-full indicator light
– Two powerful 240 volt motors
– For homes < 12,000 sq. ft.

NuTone® CV400 Power Unit... Power in a Compact Package



The perfect fit for any apartment, condominium or home up to 2,200 sq. ft. This compact unit will add huge convenience to your life and value to your home. It is small enough to fit in a mud room, laundry room or even a closet. The unit operates quietly when it is mounted near your living area and virtually sound-free when mounted in a basement or garage.

CV400 Compact Power Unit



CV400

- 2-year warranty
- 6 gallon debris bucket with easy on/off snap release
- Single intake port
- On/off unit power switch
- Illuminated power indicator
- For homes < 2,200 sq. ft.



Automatic Dustpans

A “must” for the kitchen, pantry, laundry room, bathroom – anywhere you have a hard surface. NuTone Automatic Dustpans allow you to easily dispose of crumbs, glass fragments, pet hair – all the hard to pick up debris. Just sweep it into the inlet and activate the vacuum feature with light toe pressure.



CI365 VacPan™

Enjoy the convenience of this automatic inlet installed in a cabinet toekick or baseboard. Simply sweep the dirt to the VacPan™ and activate the vacuum system with flip of the toeswitch. It offers the ultimate convenience to sweep dirt away instantly. The perfect idea for any room with hard surface floors like kitchens, baths, laundry rooms and mud rooms.

- Rough-in dimensions: 6" w x 4" d x 1" h, not including tubing
- Available in two colors:
CI365W – White
CI365V – Ivory



CI366 Trim Plates

This Quick Trim finish plate is designed for front-entry access. Can be shortened to 3-1/2" or 3" on site. (For use with CI365 VacPan™ only)

- Overall size: 10-9/16" w x 4" h
- Available in colors to match VacPan™:
CI366W – White
- Use CF382XS Extra Short EII or CF382S Short EII when installing where height is limited



CI367 VacuSweep®

The short profile design of VacuSweep® allows it to be installed in tight kick space areas or within a 2" x 4" stud wall. Wiring is connected in mere seconds to spring loaded wire connectors.

- Available in two colors:
CI367IV – Ivory
CI367W – White



Treat your carpet to longer life with a wide selection of deep cleaning brushes.

The NuTone Electric Power Brushes save time and energy, while prolonging the life of your carpet. And, with easy-to-use touch-of-the-toe levers, you won't break your back bending to switch carpet heights and removing wands.

The turbine brushes use the airflow of the Central Vacuum System to remove dirt without the need for an electrical plug. They offer the perfect cleaning solution for light traffic areas like the dining room where you want routine touch ups.

In addition, NuTone offers a wide selection of cleaning accessories to enhance the versatility of your Central Vacuum System. From electric power nozzles for deep cleaning to standard tool sets with attachments for those hard to reach areas, we make all of your cleaning chores easier.

Put all of the NuTone power to work for you and get unparalleled cleaning performance.



Electric Power Brushes



CT700

CT700 – Deluxe Electric Power Brush

This deluxe electric 14" power brush provides greater cleaning coverage without the extra work.

Features:

- Exceptional soil removal
- Maximum maneuverability and ease of use
- Superior LED lighting
- Four position height adjustment
- Dual edge cleaning with protective bumper
- Non-marking, rubberized coated wheels for improved traction



The CT700 features convenient height adjustment and brush release pedal options along with a multi-directional steering element for those difficult to reach areas.



Turbine Brushes



CT350B

CT350B – Turbine Brush

Lightweight yet powerful, NuTone's® CT350B turbine removes up to 38% more embedded soil than other turbine brushes. This design features a suction shoe that allows 45 degree pivot while in use and a full 360 degree swivel neck. Features:

- Cog belt drive agitator brush
- Chevron pattern, nylon tufted agitator bristles
- Vacuum release valve opens and closes
- Rubber wheels

Brush Selection Chart

Model No.	Description	Color	Wands	Height Adjustment	Width	Headlamp	Belt Style	Edge-Cleaning
CT700	Deluxe Electric Power Brush	Gray	CT170 or CT175	4-position	14"	LED	Cogged	Dual
CT350B	Turbine Brush	Black	No	No	11"	No	Cogged	Dual

All Power Brushes are UL Listed and are designed for use with NuTone hoses, models CH515 and CH615.



Tool Sets

NuTone tool sets provide the convenience of quality attachments packaged to meet your traditional cleaning needs.



CK110 Basic Tool Set

Features all the most-often-used cleaning tools. The combo floor tool moves from floor to carpet with single pedal operation. Swivel neck allows a full range of motion. The nozzle has two lint strips for greater cleaning.

- Dusting brush
- Upholstery tool
- Crevice tool



CK120 Standard Tool Set

Meets your daily cleaning needs with convenience. Featuring the CT140G floor tool which offers dual wheels for even air flow, single pedal mechanism which adjusts to go from floor to carpet and baseplate with two lint strips for quick pick-up. The nozzle and dual action swivel neck offer easy maneuverability. Comes in a sleek, black finish.

- Two CT132G stainless steel wands lock securely with button-lock fit
- CT102G dusting brush and CT106G upholstery tools
- CT111G crevice tool
- Storage bag



CK230 Deluxe Tool Set

Quality accessories with prepackaged convenience. The CT150B lets you move easily from floor to carpeting without the need to adjust. Wheel design maintains even airflow, a soft bristle brush and lint strip that allows better pick-up of lint. The nozzle features a full-width air channel and the double swivel neck provides better maneuverability. Comes in a sleek, black finish.

- Ratcheting stainless steel wand extends from 22" to 39"
- 12-1/2" notched crevice tool provides continuous airflow
- Convertible upholstery tool and dusting brush
- Storage bag

Electric Tool Sets



CK355 (shown above) Deluxe Electric Kits

All the attachments you need to keep your living space dust free. With selections for carpeting, hard floors, draperies and furniture, this deluxe kit features the convenience of maximum power without the need for an electrical plug. Works with electrified inlets CI358 and CI390. (See page 23). The kit includes:

- CK230 deluxe tool set
- Electrified direct connect crushproof hose: CH615
- CT700 deluxe electric power brush
- CA130 hose sock
- CT175 adjustable-ratcheting wand



CK350 (shown above) Deluxe Electric Kits

Features all the time-saving attachments of the CK355 without the need for electrified inlets. With a six foot electric cord, it easily plugs into an outlet for maximum power. The kit includes:

- CK230 deluxe tool set
- Electrified crushproof hose: CH515
- CT700 deluxe electric power brush
- CA130 hose sock
- CT175 adjustable-ratcheting wand



CK250 (shown above) Air Turbine Kits

This kit offers cleaning power with non-motorized accessories. All these attachments work with the central vacuum's airflow. The kit includes:

- CK120 standard tool set
- Crushproof hose: CH235
- CT350B turbine brush
- CA130 hose sock



CK150 (shown above) Standard Tool Kit

The CK150 is ideal for homes with all hard surface floors. It also makes a perfect second set or starter kit. The kit includes:

- CK120 standard tool set
- CH235 low-voltage crushproof hose
- CA130 hose sock

*For use with VX1000 or VX550 series Power Units only.



Expand on the deluxe or standard tool sets with a NuTone Tool Kit which packages all the accessories necessary to comprise the complete cleaning package.

CK145 Ultra Deluxe Garage & Car Care Kit

Includes three versatile attachments that are perfect for those tough to get at areas. It's perfect as a starter set for the shop or garage or as a second set to help around the house. It includes:

- 50 ft. extra long crush-proof hose
- Round dusting brush with tough extra long bristles
- Upholstery tool
- Slide on upholstery brush with tough nylon bristles
- "Gulper" extra wide crevice tool
- Curved wand with cuff and full swivel
- Two 18" molded straight wands
- 14" extra wide floor tool with long lasting natural bristles
- Hose hanger
- See-thru mesh caddy bag for easy tool storage and retrieval



CK140 Deluxe Garage & Car Care Kit

This kit was designed for all those challenging demands found in the garage, utility areas and car. All tools are non-corrosive, molded in black and are designed to deliver optimal cleaning performance. The kit includes:

- 30 ft. crush-proof hose
- Round dusting brush with tough extra long nylon bristles
- Upholstery tool
- Slide on upholstery brush with tough bristles
- "Gulper" extra wide crevice tool
- Hose hanger
- See-thru mesh caddy bag for easy tool storage and retrieval



Accessories



CT102G – Dusting Brush

Soft natural bristles provide gentle cleaning for delicate surfaces. Fits onto all NuTone wands. Black.

CT106G – Upholstery Tool

Provides deep cleaning, with or without the slide on natural bristle brush. Fits onto all NuTone wands. Black.

CT111G – Crevice Tool

Gives you added reach to clean hard-to-reach areas. Clipped end provides continuous air flow. Fits onto all NuTone wands. Black.



CT132

Chrome Button Lock Wands. Set of two chrome plated steel wands feature secure button-lock fit.

CK135

Ratcheting Wand. One-piece ratcheting wand extends from 22" to 39" at one-inch intervals. Positive ratchet mechanism locks into place. Durable chrome plated steel with button locks.

CT170

Adjustable-Ratcheting Wand. Easily adjustable, one-piece ratcheting wand extends from 26" to 39" at one-inch intervals. Positive ratchet mechanism locks into place.

CT170: Use with CT700 power nozzle and 20" series hoses.

CT175

Adjustable-Ratcheting Wand. Easily adjustable, one-piece ratcheting wand extends from 26" to 39" at one-inch intervals. Positive ratchet mechanism locks into place.

CT175: Use with CT700 power nozzle and 15" series hoses.

CT140G – Standard Floor/Rug Tool

Pedal quickly adjusts as you move from hard surfaces to carpets. Features dual rear wheels. Wide 10-5/8" of edge to edge cleaning. Black.

CT143B – Universal Dusting Brush

Elongated universal dusting brush will change the way you dust. Features gentle, soft nylon bristles. Black.

CT150B – Deluxe Floor/Rug Tool

Moves from hard surface to carpet without adjustment. Front and rear wheels maintain air flow. Offers extra wide 11" of edge to edge cleaning. Black.

CT156B – Hard Surface Floor Tool

This 11-3/4" wide brush is ideal for hard flooring surfaces. Two rows of natural bristles pick up dust. Dual rubber wheels provide balance and even air flow. Swivel neck makes it easy to reach all surface areas.

CT157B – Extra Wide Hard Surface Floor Tool

This 14" wide brush cleans hard flooring surfaces. Two rows of natural bristles pick up dust. Dual rubber wheels provide balance and even air flow. Swivel neck makes it easy to reach all surface areas.

391/CF3918 & VX3916/VX3918

Two-ply electrostatically charged filter media captures particles down to .10 micron at 85% efficiency. Set of three bags. Suggested replacement about twice a year.

Available in two sizes:

Model 391: Six gallon bag – for use with CV350, CV352, CV353, CV400, CV450, CV653 and CV750

Model CF3918: Eight gallon bag – for CV850, suitable for CV400 and CV750

Two-ply electrostatically charged media captures particles down to .10 microns at 85% efficiency.

Model VX3916*: Six gallon bag with HEPA® filtration for VX475

Model VX3918*: Eight gallon bag with HEPA® filtration for VX550 and VX1000

Model VX3918STD: Eight gallon bag for VX550 and VX1000

*HEPA® filter media offers the ultimate with 99.97% filtration efficiency and superior air flow with minimum clogging.



Powered to reach everywhere you need to clean.

NuTone Current-Carrying hoses bring the power to wherever your vacuum reaches. We offer a wide selection of lightweight, flexible hoses including direct-connect options for use with electrified inlets. Current-Carrying hoses allow you to operate an electric power brush without using an additional cord set.

And, the comfortable handle design and fingertip controls on the handle grip add comfort and convenience to your cleaning. The large hose diameter provides better dirt removal. All NuTone hoses come with a convenient storage hanger.



Current-Carrying Hoses



Lightweight, Crushproof

CH615

This lightweight, Current-Carrying direct-connect hose springs back to retain original shape. Features a 3-position on-off switch. Available in dark gray.

- Recommended for use with NuTone CI358 and CI390 series electrified inlets
- For use with NuTone CT700 Deluxe Electric Power Brush
- UL approved



CH515

This lightweight, Current-Carrying corded hose springs back to retain original shape. Features a 3-position on-off switch and 6 ft. line cord. Available in dark gray.

- For use with NuTone CT700 Deluxe Electric Power Brush
- Includes patent pending Universal hose end which fits all NuTone and most other standard inlets
- UL approved

Low Voltage Hoses and Utility Hoses



372 Utility/Garage Hose

372 – Utility/Garage Hose

This crushproof hose springs back to retain original shape. Perfect durability for tough jobs in the garage. Rotary control on handle regulates vacuum.



CH230L Standard Hose

CH230L – Standard Hose

A dark gray standard hose features on-off switch and vinyl reinforced construction. The 42-foot length provides longer reach. Rotary control regulates vacuum. Includes patent pending Universal hose end which fits all NuTone and most other standard inlets.



CH235 Crushproof Hose

CH235 – Crushproof Hose

This crushproof, low voltage hose springs back to retain original shape. Includes on-off switch. Includes patent pending Universal hose end which fits all NuTone and most other standard inlets.

Hose Accessories



CA130

A hose sock can help prevent scratching corners of walls and marking furniture as you move from room to room while vacuuming.



1 Fit sock over tube end

2 Slide entire sock onto tube

3 Feed nozzle end through tube

4 Slide sock off tube onto hose; tie at handle

5 Slide sock off of tube to cover remainder of the hose

Hose Selection Chart

Model No.	Description	Hose Length	Inside Diameter	Power Head Switch	Power Unit Switch	Color
372	Low Voltage Utility/Garage Hose	32'	1-1/4"	No	No	Dark Gray
CH230L	Low Voltage Standard Hose	42'	1-3/8"	No	Yes	Dark Gray
CH235	Crushproof Low Voltage Hose	30'	1-3/8"	No	Yes	Dark Gray
CH515	Current-Carrying Crushproof Hose w/Status Indicator Light	30'	1-1/4"	Yes	Yes	Dark Gray
CH615	Direct-Connect Crushproof Hose w/Status Indicator Light	30'	1-1/4"	Yes	Yes	Dark Gray

Hose Accessories

Model No.	Description	Hose Length	Inside Diameter	Color
CA130	Hose Sock	30' – 32'	1" & 1-3/8" dia. Hoses	Gray

Plug into Power and Convenience with NuTone Inlets.

Turn to the source for power and intelligence. NuTone's line of central cleaning inlets include built-in low-voltage terminals where direct-connect hoses plug right into the inlet – alleviating the need for a power cord. The electrified inlets make it a simple one-step operation to plug in a current-carrying hose. The system turns on automatically when an unswitched hose is inserted or is ready for immediate activation with a switched hose.

NuTone's status indicator hoses and inlets allow for the bag-full or pail-full technology from your power unit for even more convenience. When the light on the power unit changes, indicating that it is time to change the bag or empty the pail, the light on the hose and inlet also changes color. And no additional wiring is needed.

NuTone inlets are the source of ease and convenience when working with a central vacuum system.



Electrified Direct Connect Inlets



Electrified Inlets make it a simple one-step operation to plug in a Current-Carrying hose – no 120V extension cord to carry around. Compatible with NuTone CH615.

CI390 Standard

The ElectraValve® Electrified Inlet operates on standard house wiring. It eliminates the need for the extension of electrical cords from the inlet to an electrical outlet. The molded power receptacle clips to a mounting plate and the housing wire is run to the nearest outlet box.

- UL listed Assembly
- Standard:
 - CI390W** – White
 - CI390V** – Ivory

CI395RK Rough-In Kit

The Electrified Inlet Rough-In Kit includes everything you need to install the CI390. Includes mounting plate, snap-in power receptacle, 6' of 12-gauge cable assembly, plaster guard, CF382S elbow and mounting screws for plaster guard.

CI358 Supervalves

The Supervalve Electrified Inlet operates on standard house wiring. Includes wall valve, rough-in plate with junction box and strain relief.

- UL listed assembly
- Standard:
 - CI358W** – White
 - CI358IV** – Ivory

HOSE-INLET COMPATIBILITY:

		Inlet Type					
		CI390	CI358	360	330	CF372	
Hose Type	Current Carrying	CH615	•	•		•	
		*CH515	◦	◦	•	•	
		372		◦	◦	•	
Low Voltage		CH235	◦	•	•	◦	
		CH230L	◦	◦	•	•	
Garage Kits		CK140		◦	◦	•	
		CK145		◦	◦	•	

* Includes 6 ft. line cord

◦ Limited Function (suction only/non-powered)

• Full Function

Standard Inlets

360 Series

Automatic on/off inlets can be installed in walls or floors. The variety of colors allows you to blend the outlets to any décor.

- Size: 3-3/4" w x 3" h x 5/8" d
- Installs with CF361 or CF361F mounting bracket or 395 or 3963 rough-in kits

360W – White

360IV – Ivory



White

CF372 Utility Inlet

Automatic on/off inlets have styrene snap-back protective cover.

- Size: 2-1/2" w x 2-7/8" h x 1-7/8" d
- Installs directly into exposed piping without the need for brackets or mounting plates

CF372 – White



Ivory

White

330 Series

Automatic on/off inlets have styrene snap-back protective cover.

- Size: 3" w x 5-3/16" h x 1/2" d
- Install with a CF329 mounting plate or CI3301RK or CI3303RK rough-in kits

330NIV – Ivory **330W** – White

326N Existing Home Inlet Kit

The Existing Home Inlet Kit assists with installing a central vacuum system after the home construction is complete. Ideal for tight areas where it is difficult to connect straight tubing to wall inlets.

- Includes 330NIV inlet and 8" length of Superflex tubing
- CF329 Mounting Plate, inlet frame and tubing guard also included

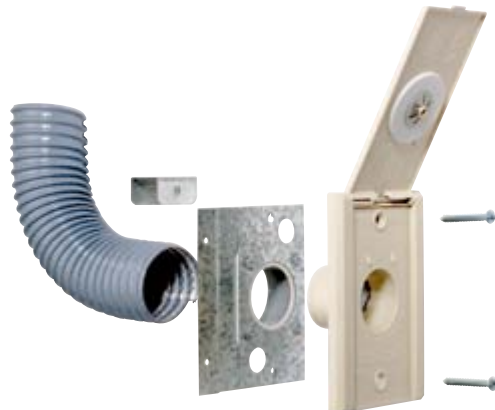

Browse NuTone choices to customize your home's central vacuum system.



Rough-In and Pre-Installation Packages

395	Inlet rough-in kit for use with 360 series inlets: Includes (1) mounting bracket, (1) 90° flange EII, (1) blank cover plate, a 24" pc 2" OD. PVC tubing and (1) 42" pc 18/2 wire taped to PVC tubing.
3963	Rough-in kit for 3-inlet installation for use with 360 series inlets: Includes (3) mounting brackets, (3) 90° flange EIIs, (1) 90° street EII, (1) 45° street EII, (1) 100' 18/2 UL wire, (6) nail Plates, (1) solvent cement, (6) 90° sweep EIIs, (2) tees, (3) 45° EIIs and (6) stop couplings.
CI3303RK	Rough-in kit for 3-inlet installation for use with 330 series inlets (See page 31 for details.)
CI3301RK	Rough-in kit for 1-inlet installation for use with 330 series inlets (See page 31 for details.)

System Planning – New or Existing Construction



Installation

Each NuTone Central Cleaning System comes packed with a Planning & Installing Guide. Whatever your home layout – multi-level, two-story or ranch – we have a system to meet your needs. As few as three or four inlets can take care of an average size home. Once you've determined the right system for you, a typical system can be installed in a day or less. Just choose whether you want to do-it-yourself or hire a professional installer.

For New Construction

Installation is simple! Plan the location of the power unit and inlets with your building or contractor. Tubing, inlets and electrical hook-up can be made before drywall, plaster or finished flooring is in place. You can even "pre-tube" your home, then select and install the power unit later!

For Existing Construction

Just determine the number and location of inlets and cutting through drywall can be kept to a minimum. Tubing can be run through cold air returns, closets and stairwells.

NOTE: NuTone Central Cleaning Systems are not designed for wet pick-up.



How to Choose

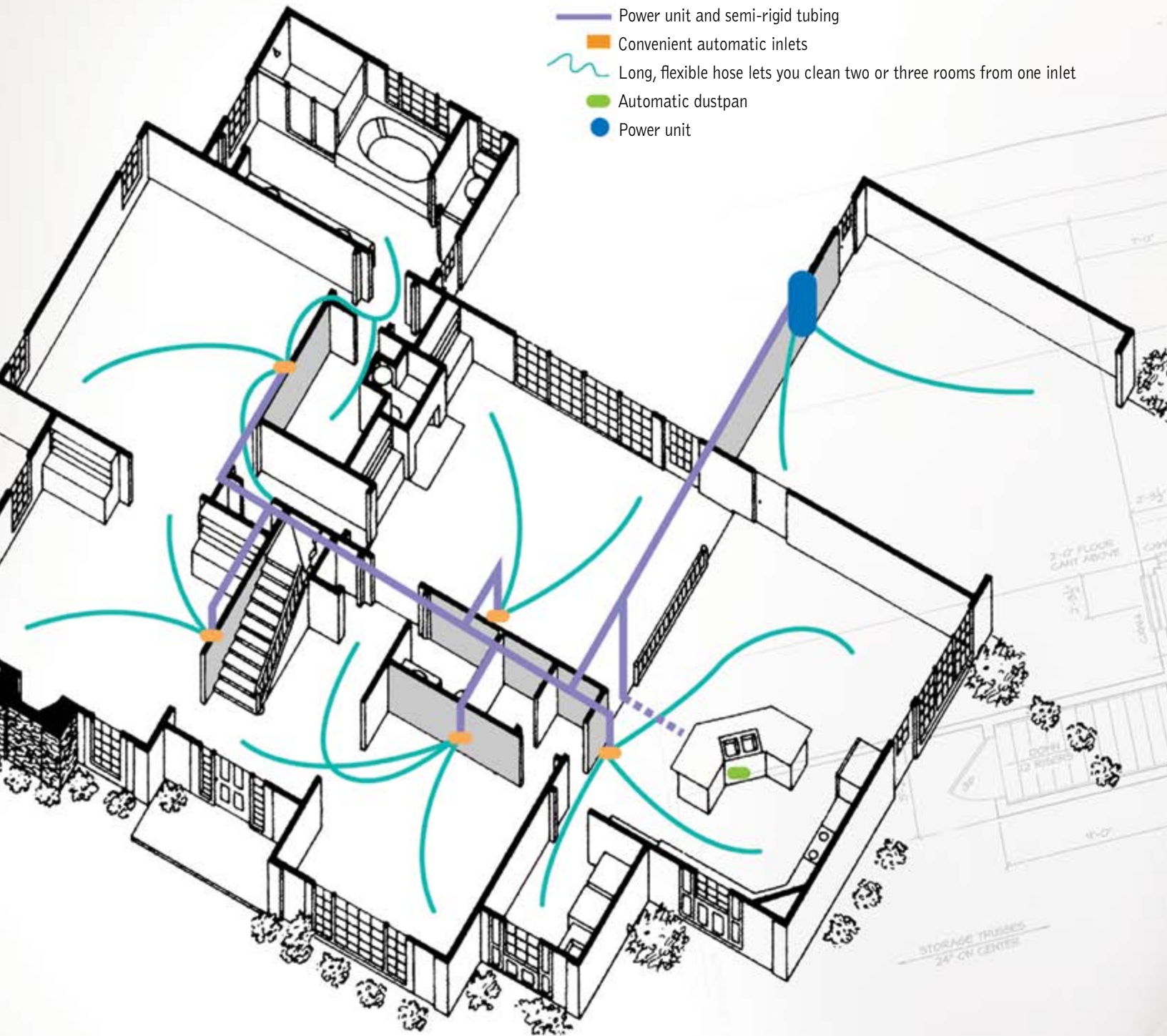

In other floor plans, the power unit may be located in the basement, laundry or utility room.

Average size 3 or 4-bedroom homes may be adequately serviced with 3 or 4 inlets plus the power unit. Utility inlets can also be used on patio or porch.

Let us help you with the basics.

1. What is your home size? Include all areas and floors to be serviced by your central vacuum system.

Home Size _____ sq. ft.

2. Based on your home size, choose your power unit from the three different Power Unit series indicated on page 30 selection chart.

Power Unit _____

3. Determine the number of wall inlets you will need. As a quick reference for estimating, we recommend using the relationship of 600 sq. ft. for each inlet. Based on the home square footage used above, divide that value by 600. Always round up for estimating purposes. For example, using a 2,800 sq. ft. home: Home Size of 2800 ÷ 600 = 4.6, round up to 5 inlets.

Your Home Size _____ ÷ 600 = _____, round up to _____ Inlets

Type of Wall Inlet Selected _____

Choice considerations:

Based on your interior décor, select the color and style wall inlet most suited for your needs as shown on pages 22-24.

If you selected a VX550 or VX1000 Series Power unit, we recommend you include VX™ Series Inlets in your system.

If you selected a VX™ Series Tool Kit or hose we recommend you select your wall inlet from the choice of inlets shown on page 23.

4. We strongly recommend including at least one VacPan™ or VacuSweep® for use in kitchens, pantries, laundry rooms or other locations, which have hard surface flooring. See page 9 to select the right VacPan™ for you.

VacPan™ or VacuSweep® _____ Qty _____

5. For determining the amount of tubing and fittings needed:
Typical installations require about 16 ft. of tubing for each Wall Inlet and VacPan™ used. To estimate the amount of tubing required, multiply the # of Inlets and VacPans™ _____ X 16 = _____ ft.

Based on the number of Wall Inlets in your system, select the series kit needed for your style Wall Inlet as shown on pages 22-24. _____

Congratulations... You have quickly and easily selected
all the basics for your Central Vacuum System!

CV400, VX475, VX550 AND VX1000 POWER UNITS SELECTION CHART

	2-Year Warranty			4-Year Warranty		8-Year Warranty	
	CV400	VX475	VX475C	VX550	VX550C	VX1000	VX1000C
Motor Performance Power (Air Watts)	400	475	475	550	550	1040	1040
Current Rating (Amps)	15	15	15	15	15	15	15
Voltage	120	120	120	120	120	240	240
Recommended Circuit (Amps)	20	20	20	20	20	20	20
Bag required for debris recovery	•	•		•		•	
Cyclonic bagless debris recovery			•		•		•
On/Off Indicator	•	•	•	•	•	•	•
Easy access door for convenient & cleaner dirt removal		•	•	•	•	•	•
Easy access door for maintenance of cyclonic filter			•		•		•
Easy-to-use bag change mechanism allows for simple & fast bag changing	•	•		•		•	
Easy-to-use bag change mechanism closes bag reducing loose dust & dirt				•		•	
Filter Bag Capacity (Gallons)	6	6		8		8	
"Bag Full" indicator with progressive fill indication				•		•	
Debris Pail Capacity (Gallons)			4		7		7
"Pail Full" indicator with progressive fill indication					•		•
HEPA® media with anti-stick technology				•	•	•	•
Unique oval shape for efficient cyclonic filtration			•		•		•
Built-in sound suppression system		•	•	•	•	•	•
For homes up to:							
2,200 square feet	•						
4,000 square feet		•	•				
8,000 square feet				•	•		
12,000 square feet						•	•

Dimensions: 475 Model 36 x 16.5 x 11.5, 550 and 1000 Models 39 x 17.5 x 11.5

Tubings



3808

NuTone's semi-rigid white PVC tubing has exceptional tensile strength. Lightweight and easy to handle, it can be cut with an ordinary saw. Its self-extinguishing properties will not support combustion making it extremely safe for your home's walls. Installs vertically or horizontally and is not affected by weather – won't rust or deteriorate.

- Conforms to all UL requirements
- Manufactured in conformity with ASTM F2158
- 2" OD x 8'; eight pieces – 64 feet

Tubing Guide

Number of Inlets	3	4	5	6	7
PVC Tubing Required	48'	64'	80'	100'	120'

Fittings, tubing and installation kits to meet every installation need – all from one source... NuTone.

Bulk packs available! Please check NuTone price sheet or packaging information.

Fittings

INSTALLATION COMPONENTS



METAL COMPONENTS – Zinc-coated/plated carbon steel for use in fire-walls to comply with fire codes.



CI3303RK Rough In – for 3-inlet installation includes:

- | | | |
|------------------------------|--------------------|-----------------------|
| 3 – Mounting Brackets | 1 – 90° Street EII | 3 – 90° Tee Wyes |
| 3 – Plaster Guards | 1 – 45° Street EII | 6 – Stop Couplings |
| 6 – Screws for Plaster Guard | 6 – Nail Guards | 1 – Solvent Cement |
| 3 – 90° Elbows | 6 – 90° Sweep Ells | 1 – 100' 18/2 UL Wire |
| | 2 – 45° Ells | |

CI3301RK Rough In – for 1-inlet installation includes:

- | | | |
|------------------------------|--------------------|--------------------|
| 1 – Mounting Bracket | 1 – 90° Elbow | 2 – 90° Sweep Ells |
| 1 – Plaster Guard | 1 – 90° Street EII | 1 – 45° EII |
| 2 – Screws for Plaster Guard | 1 – 45° Street EII | 1 – 90° Tee Wye |
| | 2 – Nail Guards | 2 – Stop Couplings |

NuTone® PVC fittings are manufactured in accordance with ASTM F2158.



NuTone® is America's leading brand of residential built-in convenience products including door chimes, central vacuum systems, intercom systems, ceiling fans, ironing centers and ventilation fans.

Broan® is America's leading brand of residential ventilation products including range hoods, ventilation fans, heater/fan/light combination units, balanced ventilation systems (IAQ), built-in heaters, whole-house fans, electric and solar-powered attic ventilators and trash compactors.

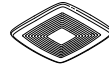

VENTILATION FANS



CHIMES



TRASH COMPACTORS

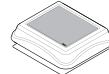

SOLAR-POWERED ATTIC VENTILATORS

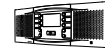

INTERCOMS



BALANCED VENTILATION SYSTEMS (IAQ)

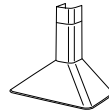

RANGE HOODS

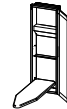

IRONING CENTERS



HEATERS



CEILING FANS



CENTRAL VACUUMS

Make yours a Broan-NuTone home.

NuTone®

NuTone.com

Broan-NuTone LLC, 926 W. State Street
Hartford, WI 53027 **888-336-3948**
In Canada call **877-896-1119**

America's Choice For Green Builders® Proud to be ENERGY STAR® partners.

