

SECTION

A



Straight Blade Receptacles

Table of contents

| | | | |
|---|----------------------|---------------------------------------|---------------------|
| Straight blade receptacle families | A-2 | Construction grade receptacles | A-17 |
| Straight blade specifiers' chart | A-3 | 2-pole, 3-wire | Rating |
| ArrowLink modular connectors | A-4 | 15A, 125V/AC | NEMA 5-15 A-18 |
| Tamper-resistant & weather resistant | A-6 | 20A, 125V/AC | NEMA 5-20 A-18 |
| Build-to-spec | A-6 | | |
| Hospital grade receptacles | A-7 | Commercial grade receptacles | A-19 |
| 2-pole, 3-wire | Rating | 2-pole, 3-wire | Rating |
| 15A, 125V/AC | NEMA 5-15 A-8, A-9 | 15A, 125V/AC | NEMA 5-15 A-19–A-23 |
| 20A, 125V/AC | NEMA 5-20 A-8, A-9 | 20A, 125V/AC | NEMA 5-20 A-19–A-21 |
| 15A, 250V/AC | NEMA 6-15 A-10 | 15A, 250V/AC | NEMA 6-15 A-23 |
| 20A, 250V/AC | NEMA 6-20 A-10 | 20A, 250V/AC | NEMA 6-20 A-23 |
| Industrial grade receptacles | A-11 | Straight blade power devices | A-24 |
| 2-pole, 3-wire | Rating | Specification information | A-26 |
| 15A, 125V/AC | NEMA 5-15 A-12–A-14 | | |
| 20A, 125V/AC | NEMA 5-20 A-12–A-14 | | |
| 15A, 250V/AC | NEMA 6-15 A-15, A-16 | | |
| 20A, 250V/AC | NEMA 6-20 A-15, A-16 | | |
| 15A, 277V/AC | NEMA 7-15 A-16 | | |
| 20A, 277V/AC | NEMA 7-20 A-16 | | |

Straight blade receptacle families

High performance receptacles for the most demanding of environments

Arrow Hart's offering of straight blade receptacles cover the full range of hospital, industrial, construction and commercial grades along with special solutions like corrosion resistant, severe duty insulated and watertight straight blade receptacles for complex environments



Hospital grade straight blade receptacles

Arrow Hart's feature rich line of hospital grade receptacles have been designed to meet and exceed the demanding requirements of UL498 and federal specification WC-596 to provide a consistent means of connectivity where downtime can be critical.



Industrial grade straight blade receptacles

Designed from the inside out, these receptacles meet and exceed the UL498 and federal specification WC-596 standards to withstand the most abusive environments and excel in applications that demand the highest levels of performance.



Commercial & construction grade straight blade receptacles

Engineered for safe, reliable performance, these UL498 and federal specification WC-596 listed devices provide maximum durability in a wide variety of applications while providing installation efficiency to help finish the job on time.



Industrial grade corrosion resistant straight blade receptacles

Built to defy the potentially damaging effects of moisture, humidity and other corrosive elements, Arrow Hart corrosion resistant devices are listed to UL498 and federal specification WC-596 to provide a dependable connection regardless of the application environment.

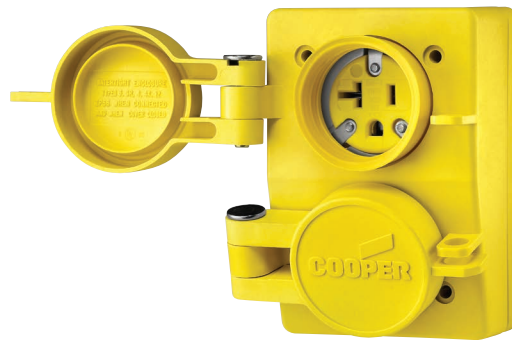

Industrial grade watertight straight blade receptacles

Listed to UL498, Arrow Hart watertight straight blade receptacles utilize advanced materials and innovative design features to make them the best choice for superior performance in harsh, wet location environments.

Arrow Hart straight blade specifiers' table

| Feature group | Premium hospital grade | Single premium hospital grade | Isolated ground premium hospital grade | Single isolated ground premium hospital grade | Hospital grade | Premium industrial grade | Premium industrial grade decorator | Single premium industrial grade | Isolated ground premium industrial grade | Single isolated ground premium industrial grade | Industrial grade | Industrial grade decorator | Const. grade |
|--|--|--------------------------------|---|---|-----------------------------------|--------------------------------------|------------------------------------|---------------------------------|--|---|------------------|----------------------------|--|
| Product line | AH8200 AH8300 AH8400 AH8600 8262 8362 | 8210 8310 8410∅ 8610∅ | IG8200 IG8300 IG8400∅ IG8262 IG8362 | IG8210 IG8310 | 8200 8300 TR8200 TR8300* | AH5262 AH5362 AH5462 AH5662 | 6262 6362 6462 6662 | 5261 5361 5461 5661 | AHIG5262 AHIG5362 AHIG5462 AHIG5662 | IG5261 IG5361 IG5461 IG5661 | AH5252 AH5352 | 6342 | 5262 5362 5462C 5662C TR5262* TR5362* TR6252* TR6362* |
| Contact design | | | | | | | | | | | | | |
| 5-leaf line contact | • | | • | | | • | • | | • | | • | | |
| Triple-wipe line contact | | • | | • | • | | | • | | • | | • | • |
| Strap materials | | | | | | | | | | | | | |
| Brass mounting strap | • | | | | | • | | | | | | | |
| Steel mounting strap | | • | • | • | • | | • | • | • | • | • | • | • |
| Grounding system | | | | | | | | | | | | | |
| 1-piece integral mounting strap | • | | | | | • | | | | | | | |
| Brass ground shunt | | | • | • | | | • | | • | • | • | | |
| Riveted ground contact | | • | | | • | | | • | | | | • | • |
| Body materials | | | | | | | | | | | | | |
| Impact & chemical resistant nylon face | • | • | • | • | • | • | • | • | • | • | • | • | • |
| Glass-filled nylon base | • | | • | | | • | • | • | • | • | • | | |
| Nylon base | • | • | • | • | | • | • | • | • | • | • | | |
| PVC base | | | | | • | | | | | | | • | • |
| Specialty features | | | | | | | | | | | | | |
| Screw terminal guards | • | | • | | | • | • | | • | | | • | |
| Back wire ground terminal | • | | • | | | • | • | | • | | | • | |
| Tri-combo screws | • | • | • | • | • | • | • | | • | • | • | • | • |
| Screw-catch feature | • | | • | | • | • | • | | • | | • | | • |
| *Tamper resistant | | | | | • | | | | | | | | • |
| Certifications | | | | | | | | | | | | | |
| cULus instead of UL and CSA | • | | • | | | • | | | • | | • | | |
| RoHS compliant | • | • | • | • | • | • | • | • | • | • | • | • | • |

*Tamper resistant receptacles are cULus, Fed Spec and NOM. ∅Not NOM certified. Compliances, specifications and availability are subject to change without notice.



Compliances, specifications and availability are subject to change without notice.

www.eaton.com
www.eaton.com/arrowhart

ArrowLink modular connectors

ArrowLink

Arrow Hart's factory terminated ArrowLink system revolutionizes device installation, unleashing ground breaking labor savings in installation and maintenance by eliminating traditional pigtailing, terminal connections and taping. Use ArrowLink on your next job to reduce labor costs, eliminate installation errors, save money and win!

Features & benefits

Color coded terminals for consistent, reliable connections

Durable polycarbonate housing

Terminal accommodation #12 - #14 AWG, solid only

Copper alloy contacts for superior wire retention and minimized heat rise

6", #12 AWG ground lead with ring terminal and captive ground screw

Color coded terminal screws guard caps

Color coded terminal screws

Terminal accommodation #12 - #14 AWG, solid or stranded

Cut-away of MCR300FTPI Push-in terminal

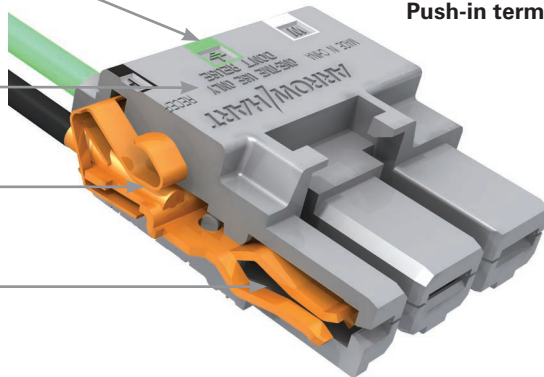

Cut-away of MCR300FTST Screw terminal

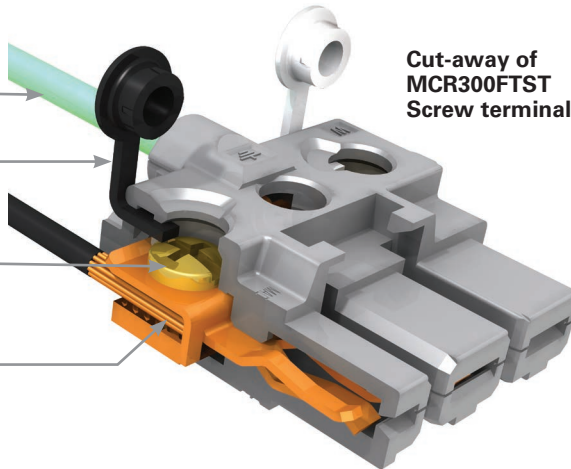

How to order

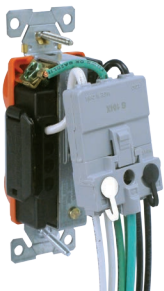

1. Select a device to ArrowLink enable. Catalog pages identify available products—simply add an "M" to the catalog number and the devices will be factory enabled with the ArrowLink device-side connection. (For GFCIs add "MOD" suffix)

2. Choose from leaded or unleaded ArrowLink connector versions in screw-down or push-in models.

3. Place your order and get your ArrowLink devices in bulk packed boxes, shipped within 5 days of receipt of order!

Compliances, specifications and availability are subject to change without notice.

ArrowLink SPD benefits

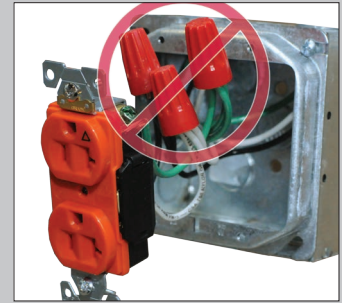

Ease of installation:
No more twist-on wire connectors

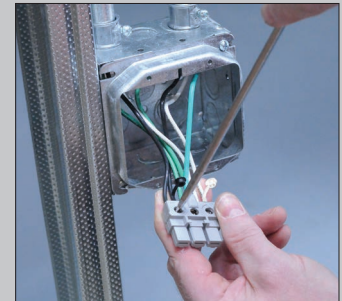

50% Time savings:
SPD accelerates both rough-in & trim out installation

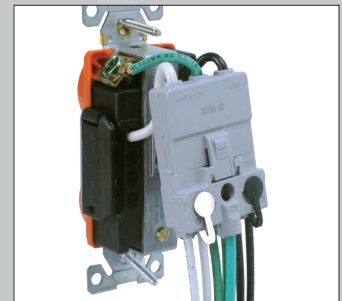

Efficient design:
Low profile connection with feed-through capability



30% Reduction
in wire volume inside the box

ArrowLink modular connectors

ArrowLink SPD comparative labor savings analysis

Traditional pigtail installation

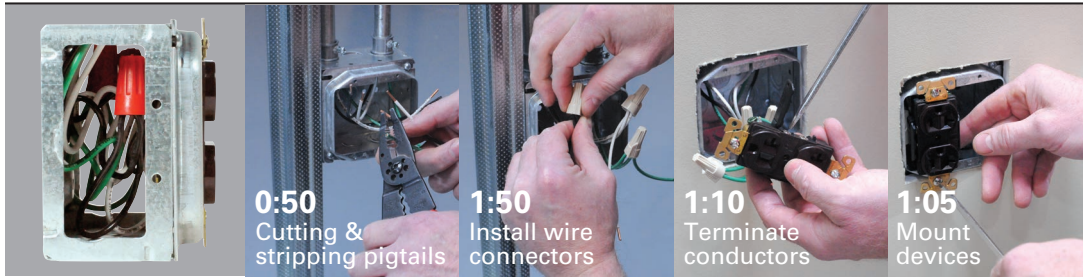

0:50
Cutting & stripping pigtails

1:50
Install wire connectors

1:10
Terminate conductors

1:05
Mount devices

4:55/Receptacle

Total time required to install 500 pigtail devices:
40.97 Hours

ArrowLink SPD installation

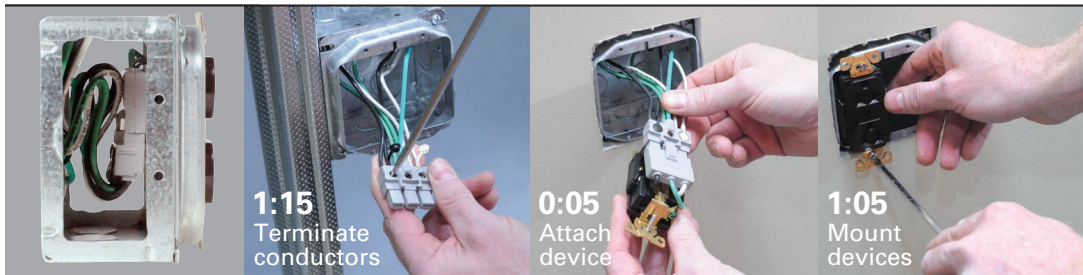

1:15
Terminate conductors

0:05
Attach device

1:05
Mount devices

2:25/Receptacle

Total time required to install 500 ArrowLink SPD devices:
20.13 Hours

Time saved with SPD
20.84 Hours

Leaded ArrowLink receptacle connectors

| Device type | Description | Catalog no. |
|-------------|----------------------------|------------------------------------|
| Receptacle | Solid wire leads – 125V | <input type="checkbox"/> MCR125SOL |
| | Stranded wire leads – 125V | <input type="checkbox"/> MCR125STR |
| | Solid wire leads – 250V | <input type="checkbox"/> MCR250SOL |
| | Stranded wire leads – 250V | <input type="checkbox"/> MCR250STR |

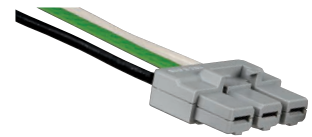

MCR125STR
Leaded ArrowLink connector

ArrowLink SPD receptacle connectors

| Device type | Description | Catalog no. |
|-------------|-------------------------------------|---------------------------------------|
| Receptacle | Screw terminal | <input type="checkbox"/> MCR300FTST |
| | Screw terminal, no ground conductor | <input type="checkbox"/> MCR300FTSTNG |
| | Push-in | <input type="checkbox"/> MCR300FTPI |
| | Push-in, no ground conductor | <input type="checkbox"/> MCR300FTPING |



MCR300FTST
Screw terminal



MCR300FTPI
Push-in terminal

ArrowLink accessories

| Device type | Description | Catalog no. |
|----------------|---|-----------------------------------|
| Circuit tester | Tests receptacle & ArrowLink connectors | <input type="checkbox"/> ALTESTER |



ALTESTER
Circuit tester

Compliances, specifications and availability are subject to change without notice.

www.eaton.com
www.eaton.com/arrowhart

Tamper resistant, weather resistant, and tamper & weather resistant receptacles

How the tamper resistant system works:

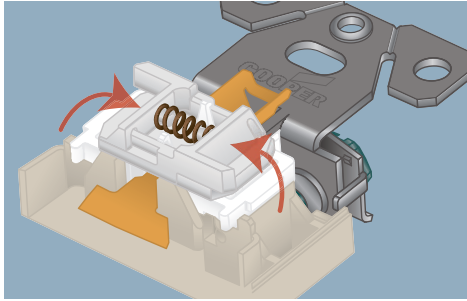

Shutters restrict access in closed position.

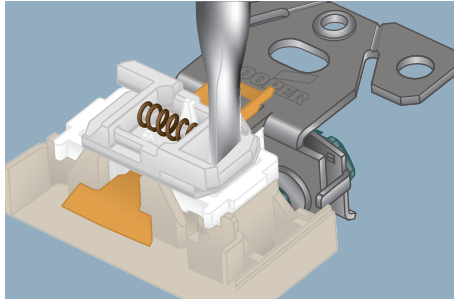

Insertion of object in any one side will not open shutters.

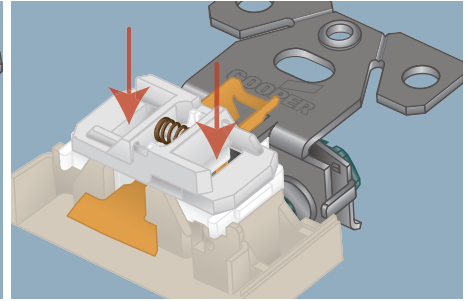

Insertion of two-bladed plug or grounding plug will open shutters.



"TR" mold mark provides quick visual confirmation of tamper resistance when installed.



"WR" identifier quickly indicates during inspections that a weather resistant receptacle has been installed.



Both the "TR" mold mark and "WR" identifier are clearly visible in the finished installation, indicating double-layer protection for maximum safety.

A) 2014 NEC – 517.18 (C) Pediatric locations

Receptacles located within the rooms, bathrooms, playrooms, activity rooms and patient care areas of pediatric wards shall be listed under tamper resistant or employ a listed tamper resistant cover.

B) 2014 NEC – 406.12 (B) TR for guest rooms and suites

All nonlocking type, 125V, 15- and 20-amp receptacles located in guest rooms and suites shall be listed tamper resistant receptacles.

C) 2014 NEC – 406.9 (A)(B) Receptacles in damp or wet locations

All 15- and 20-amp, 125- and 250-volt non-locking receptacles installed in wet or damp locations shall be weather resistant receptacles.

Build-to-spec

For receptacles, switches, GFCIs & SPD devices

Modified at the factory to improve efficiency and speed production at the job site. Arrow Hart's build-to-spec program provides customized device solutions to simplify your project and maximize your bottom line.

Build-to-spec sample number:
5362W

Note:
Arrow Hart 20A 125V NEMA 5-20 blue SPD surge protection receptacle, with wire leads and push-in connectors, without mounting screws, ears, or grounding clip.

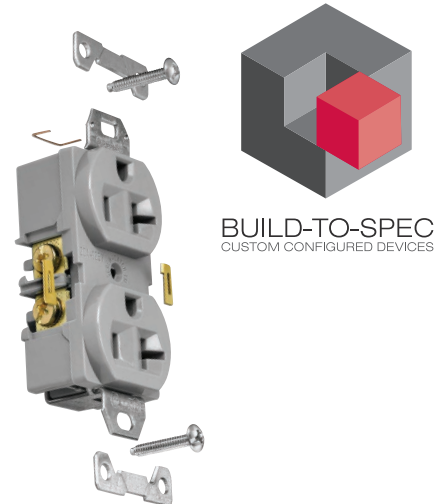
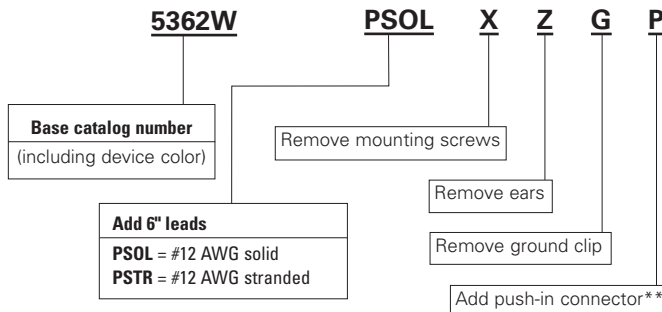

**For use with leaded devices only. Add "PSOL" to back of device catalog number for 6" of #12 AWG solid or "PSTR" for 6" of #12 AWG stranded. (Example: 8300BLSPSOL + build to spec options).

All devices are bulk packed 50 pieces per carton. Minimum order quantity is 100 pieces. Orders under 500 pieces ship within 5 days with larger quantities typically within 10 days.

Compliances, specifications and availability are subject to change without notice.

Hospital grade straight blade receptacles

Performance, longevity, reliability

In today's healthcare environment the power to save lives begins with the electrical system. Downtime is not an option and the right receptacle can make the difference in critical situations

Premium hospital grade AH8200, AH8300 series features & benefits

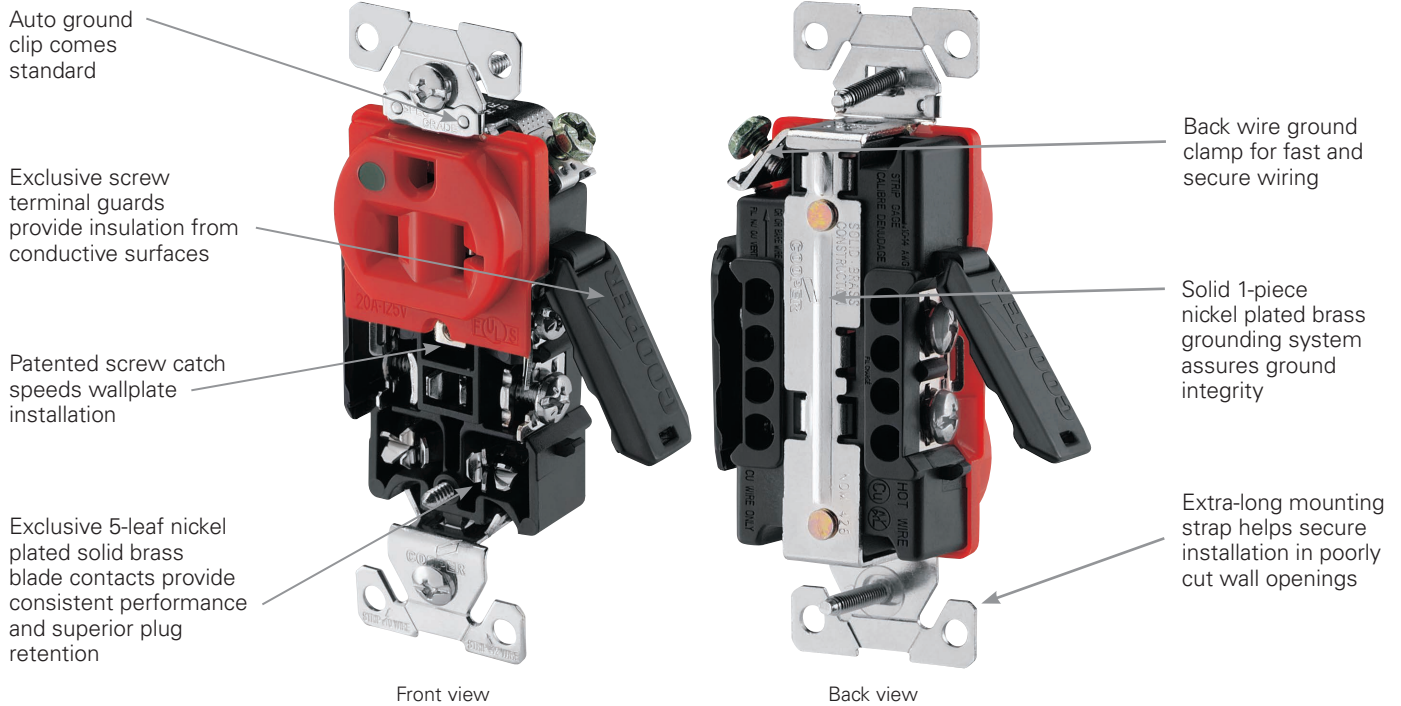

Additional features & benefits

- Available in 15A & 20A duplex & single configurations, including lighted, tamper resistant and ArrowLink modular styles
- Glass-filled nylon base provides superior strength and heat resistance
- Convenient built-in #10 and #12 AWG wire strippers
- High impact- and chemical-resistant nylon face holds structural integrity
- Tri-head combination brass terminal screws are backed out and ready to wire

Compliances, specifications and availability are subject to change without notice.

www.eaton.com
www.eaton.com/arrowhart

Hospital grade straight blade receptacles

Product description

2-pole, 3-wire grounding
 15A, 125V/AC; 20A, 125V/AC
 NEMA 5-15R, 5-20R

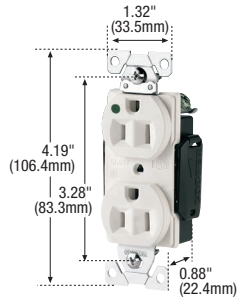
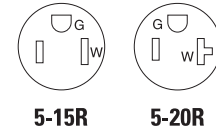

AH8200

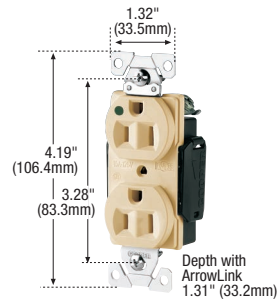

AH8200_M

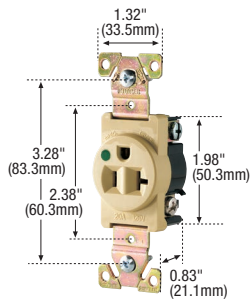

8310

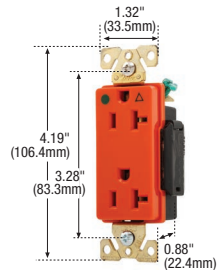

IG8362

Premium hospital grade receptacles

| Rating | A | V/AC | NEMA | Description | Color suffix | Catalog no. | | | | |
|--------|-----|-------|---|-------------|-------------------------|--------------|---|---|-----|------|
| 15 | 125 | 5-15R | Premium duplex receptacle, back & side wire | | B, BK, GY, RD, V, W | □ AH8200__ | ▶ | ◀ | USA | RoHS |
| | | | Premium illuminated duplex receptacle, back & side wire | | V, W | □ AH8200LT__ | ▶ | ◀ | USA | RoHS |
| | | | Premium single receptacle, back & side wire | | B, GY, V, W | □ 8210__ | ▶ | ◀ | USA | RoHS |
| 20 | 125 | 5-20R | Premium duplex receptacle, back & side wire | | B, BK, GY, LA, RD, V, W | □ AH8300__ | ▶ | ◀ | USA | RoHS |
| | | | Premium illuminated duplex receptacle, back & side wire | | RD, V | □ AH8300LT__ | ▶ | ◀ | USA | RoHS |
| | | | Premium single receptacle, back & side wire | | B, RD, V, W | □ 8310__ | ▶ | ◀ | USA | RoHS |

Premium decorator hospital grade receptacles

| Rating | A | V/AC | NEMA | Description | Color suffix | Catalog no. | | | | |
|--------|-----|-------|---|-------------|---------------------|-------------|---|---|-----|------|
| 15 | 125 | 5-15R | Premium decorator duplex receptacle, back & side wire | | GY, RD, V, W | □ 8262__ | ▶ | ◀ | USA | RoHS |
| | | | Premium decorator illuminated duplex receptacle, back & side wire | | V, W | □ 8262LT__ | ▶ | ◀ | USA | RoHS |
| 20 | 125 | 5-20R | Premium decorator duplex receptacle, back & side wire | | B, BK, GY, RD, V, W | □ 8362__ | ▶ | ◀ | USA | RoHS |
| | | | Premium decorator illuminated duplex receptacle, back & side wire | | RD, V, W | □ 8362LT__ | ▶ | ◀ | USA | RoHS |

Isolated ground premium hospital grade receptacles

| Rating | A | V/AC | NEMA | Description | Color suffix | Catalog no. | | | | |
|--------|-----|-------|--|-------------|------------------|-------------|---|---|-----|------|
| 15 | 125 | 5-15R | Premium IG duplex receptacle, back & side wire | | GY, RD, RN, V, W | □ IG8200__ | ▶ | ◀ | USA | RoHS |
| | | | Premium IG single receptacle, back & side wire | | RN | □ IG8210* | ▶ | ◀ | USA | RoHS |
| | | | Premium IG decorator duplex receptacle, back & side wire | | GY, RN, V, W | □ IG8262__ | ▶ | ◀ | USA | RoHS |
| 20 | 125 | 5-20R | Premium IG duplex receptacle, back & side wire | | GY, RD, RN, V, W | □ IG8300__ | ▶ | ◀ | USA | RoHS |
| | | | Premium IG single receptacle, back & side wire | | RN | □ IG8310* | ▶ | ◀ | USA | RoHS |
| | | | Premium IG decorator duplex receptacle, back & side wire | | GY, RN, V, W | □ IG8362__ | ▶ | ◀ | USA | RoHS |

*Not Fed Spec

Color ordering information:

For ordering devices, include Catalog no. followed by the Color suffix: B (Brown), BK (Black), GY (Gray), LA (Light Almond), RD (Red), RN (Orange), V (Ivory), W (White)



Specification information: Premium HG receptacles: A-26, Isolated ground premium HG receptacles: A-27, ArrowLink premium HG Receptacles: A-36

Compliances, specifications and availability are subject to change without notice.

▶ ArrowLink option available. Add "M" suffix to standard catalog number (example AH8300W, AH8300WM). For ordering information on ArrowLink & ArrowLink SPD connectors, see Page A-5

◀ Build-to-spec customizable devices - Page A-6

USA Indicates NAFTA compliant - Page Q-32

RoHS compliant - Page Q-32

Hospital grade receptacles

Hospital grade straight blade receptacles

Product description

2-pole, 3-wire grounding
15A, 125V/AC; 20A, 125V/AC
NEMA 5-15R, 5-20R

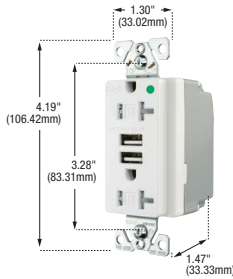
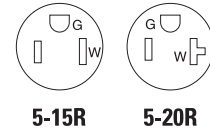

TR8355

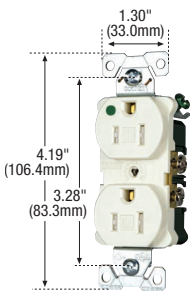

TR8200

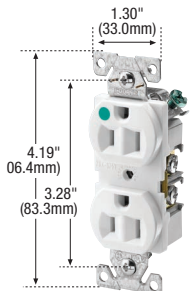

8200

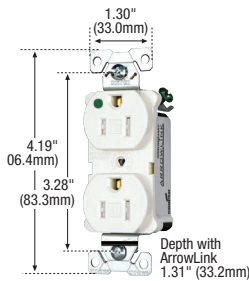

TR8200_M

Hospital grade combination USB charger



| Rating | | Description | | Color suffix | Catalog no. |
|--------|------|-------------|------|--|-----------------------------|
| A | V/AC | Amps | V/DC | | |
| 15 | 125 | 3.1 | 5 | USB charger with hospital grade tamper resistant duplex receptacle | GY, LA, RD, V, W □ TR8255__ |
| 20 | 125 | 3.1 | 5 | USB charger with hospital grade tamper resistant duplex receptacle | GY, LA, RD, V, W □ TR8355__ |

Tamper resistant hospital grade receptacles



| Rating | | Description | | Color suffix | Catalog no. | |
|--------|------|-------------|-------------------------------------|-----------------|-------------|---------|
| A | V/AC | NEMA | | | | |
| 15 | 125 | 5-15R | Duplex receptacle, back & side wire | GY, RD, V, W | □ TR8200__ | ▶ ● ● ● |
| 20 | 125 | 5-20R | Duplex receptacle, back & side wire | B, GY, RD, V, W | □ TR8300__ | ▶ ● ● ● |

Hospital grade receptacles



| Rating | | Description | | Color suffix | Catalog no. | |
|--------|------|-------------|-------------------------------------|---------------------|-------------|-----------|
| A | V/AC | NEMA | | | | |
| 15 | 125 | 5-15R | Duplex receptacle, back & side wire | B, GY, RD, V, W | □ 8200__ | ▶ ● ● ● ● |
| 20 | 125 | 5-20R | Duplex receptacle, back & side wire | B, GY, LA, RD, V, W | □ 8300__ | ▶ ● ● ● ● |

Panel-mount special use hospital grade single receptacles



| Rating | | Description | | Color suffix | Catalog no. | |
|--------|------|-------------|---|--------------|-------------|-------|
| A | V/AC | NEMA | | | | |
| 15 | 125 | 5-15R | Strap center to center spacing = 1.9375" (49.2mm), back & side wire | V | □ 8210MV | ▶ ● ● |
| 20 | 125 | 5-20R | Strap center to center spacing = 1.9375" (49.2mm), back & side wire | RD, V | □ 8310M__ | ▶ ● ● |

Accessories for hospital grade NEMA 5-15 & 5-20 receptacles

| Description | Color suffix | Catalog no. | |
|--|-----------------|-------------|-------|
| 2-Gang, standard size duplex receptacle pre-marked wallplate "emergency" | Stainless Steel | □ EM93102 | ▶ ● ● |
| 1-Gang, mid-size duplex receptacle wallplate, "GFCI protected" | V, W | □ PJ8GF__ | ▶ ● |
| 2-Gang, mid-size duplex receptacle pre-marked wallplate, "emergency" | RD | □ PJ82EMRD | ▶ ● |



Color ordering information:

For ordering devices, include Catalog no. followed by the Color suffix: B (Brown), GY (Gray), LA (Light Almond), RD (Red), V (Ivory), W (White)



Specification information: Tamper resistant HG receptacles: A-28, Panel mount HG receptacles: A-28, HG receptacles: A-28, HG USB receptacles: A-34, ArrowLink HG receptacles: A-36

Compliances, specifications and availability are subject to change without notice.

- ▶ ArrowLink option available. Add "M" suffix to standard catalog number (example AH8300W, AH8300WM). For ordering information on ArrowLink & ArrowLink SPD connectors, see Page A-5
- ▶ Build-to-spec customizable devices - Page A-6
- ▶ Indicates NAFTA compliant - Page Q-32
- ▶ Tamper resistant
- ▶ RoHS compliant - Page Q-32

Hospital grade straight blade receptacles

Product description

2-pole, 3-wire grounding
 15A, 250V/AC;
 20A, 250V/AC
 NEMA 6-15R, 6-20R

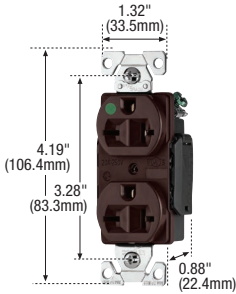
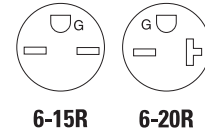



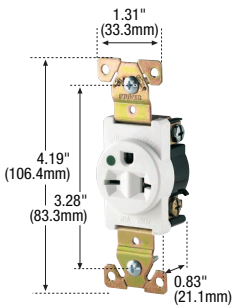

AH8400



8410



Premium hospital grade receptacles

| Rating | | | | | | | | | |
|--------|------|-------|---|-----------------|-----------------------------------|---|---|---|---|
| A | V/AC | NEMA | Description | Color suffix | Catalog no. |  |  |  |  |
| 15 | 250 | 6-15R | Premium duplex receptacle, back & side wire | V, W | <input type="checkbox"/> AH8600__ | • | • | • | • |
| | | | Premium single receptacle, back & side wire | V, W | <input type="checkbox"/> 8610__ | • | • | • | • |
| 20 | 250 | 6-20R | Premium duplex receptacle, back & side wire | B, GY, RD, V, W | <input type="checkbox"/> AH8400__ | • | • | • | • |
| | | | Premium single receptacle, back & side wire | B, RD, V, W | <input type="checkbox"/> 8410__ | • | • | • | • |

Isolated ground premium hospital grade receptacles

| Rating | | | | | | |
|--------|------|-------|--|-------|-----------------------------------|---|
| A | V/AC | NEMA | Description | Color | Catalog no. |   |
| 20 | 250 | 6-20R | Premium IG duplex receptacle, back & side wire | RN | <input type="checkbox"/> IG8400RN | • • |

Accessories for hospital grade NEMA 6-15 & 6-20 receptacles

| Description | Color suffix | Catalog no. |  |  |
|--|--------------------------------|---------------------------------|---|---|
| 1-Gang, standard size duplex receptacle nylon wallplate | A, B, BK, GY, LA, RD, V, W | <input type="checkbox"/> 5132__ | • • | |
| 1-Gang, mid-size duplex receptacle polycarbonate wallplate | A, B, BK, BL, GY, LA, RD, V, W | <input type="checkbox"/> PJ8__ | • | |



5132V



PJ8LA

Color ordering information:

For ordering devices, include Catalog no. followed by the Color suffix: A (Almond), B (Brown), BK (Black), BL (Blue), GY (Gray), LA (Light Almond), RD (Red), RN (Orange), V (Ivory), W (White)

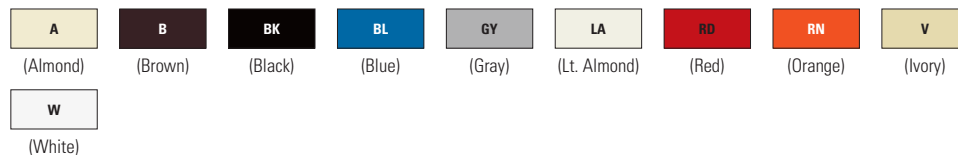

Specification information: Premium HG receptacles: A-26, ArrowLink premium HG receptacles: A-36, Isolated ground premium HG receptacles: A-27

Compliances, specifications and availability are subject to change without notice

 ArrowLink option available. Add "M" suffix to standard catalog number (example AH8300W, AH8300WM). For ordering information on ArrowLink & ArrowLink SPD connectors, see Page A-5

 Build-to-spec customizable devices - Page A-6

 Indicates NAFTA compliant - Page Q-32

 RoHS compliant - Page Q-32

Industrial grade receptacles

Arrow Hart industrial receptacles are best-in-class with unique features

These durable receptacles are designed from the inside out to provide innovative functionality throughout the product line and withstand the most abusive environments to provide a consistent means of reliable connectivity

Premium industrial grade AH5262, AH5362, AH5462, AH5662 features & benefits

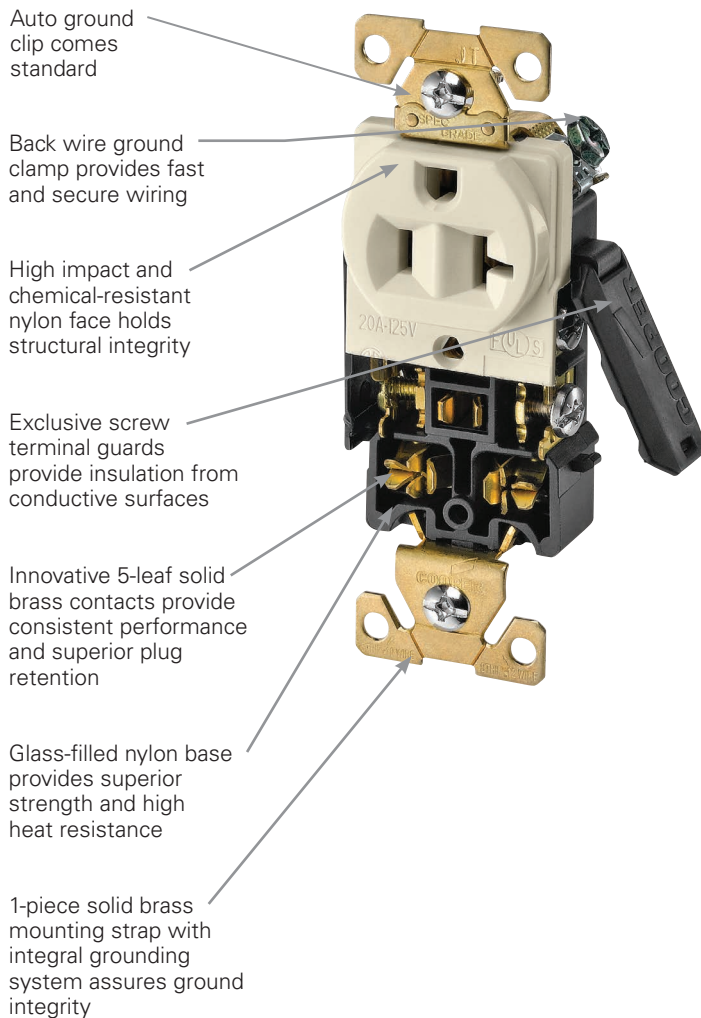

Industrial grade AH5252, AH5352 features & benefits

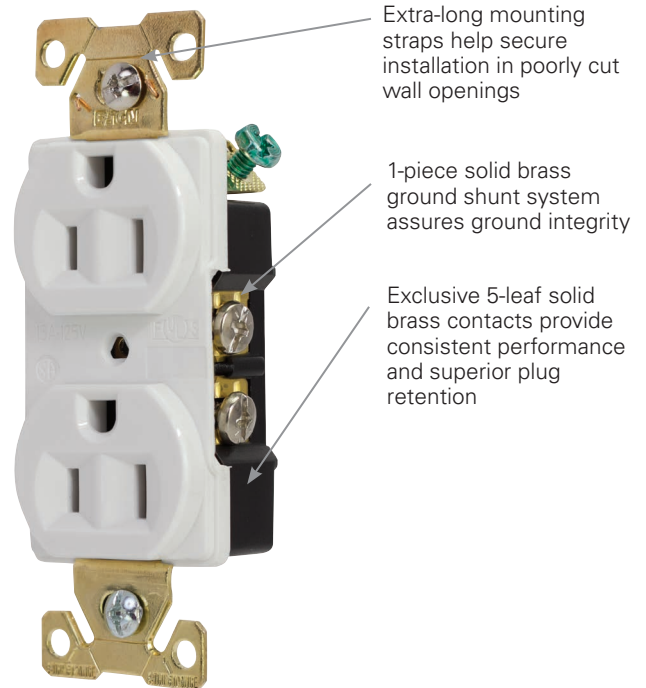

Additional features & benefits

- Patented screw catch speeds wallplate installation
- Convenient built-in #10 and #12 AWG wire strippers
- Tri-combination head brass terminal screws are backed out and ready to wire
- Available in 15A & 20A duplex & single configurations, including isolated ground and ArrowLink modular styles

Compliances, specifications and availability are subject to change without notice.

www.eaton.com
www.eaton.com/arrowhart

Industrial grade straight blade receptacles

Product description

2-pole, 3-wire grounding
 15A, 125V/AC;
 20A, 125V/AC
 NEMA 5-15R, 5-20R

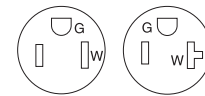

5-15R

5-20R

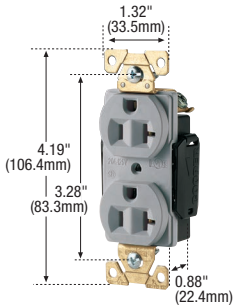

AH5362

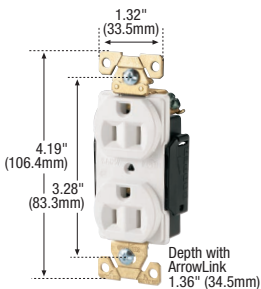

AH5262_M

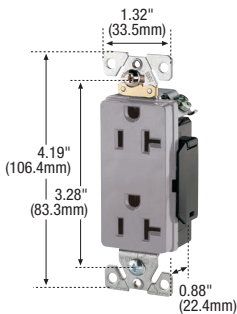

6362

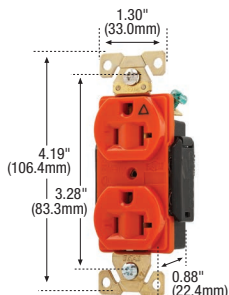

AHIG5362

Premium industrial grade receptacles

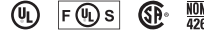

| Rating | | NEMA | Description | Color suffix | Catalog no. | |
|--------|------|-------|---|-------------------------|-----------------------------------|---------|
| A | V/AC | | | | | |
| 15 | 125 | 5-15R | Premium duplex receptacle, back & side wire | B, BK, GY, RD, V, W | <input type="checkbox"/> AH5262__ | • • • • |
| | | | Premium single receptacle, back & side wire | B, GY, RD, V, W | <input type="checkbox"/> 5261__ | • • • • |
| 20 | 125 | 5-20R | Premium duplex receptacle, back & side wire | B, BK, GY, LA, RD, V, W | <input type="checkbox"/> AH5362__ | • • • • |
| | | | Premium single receptacle, back & side wire | B, BK, GY, RD, V, W | <input type="checkbox"/> 5361__ | • • • • |

Premium decorator industrial grade receptacles



| Rating | | NEMA | Description | Color suffix | Catalog no. | |
|--------|------|-------|---|------------------|---------------------------------|---------|
| A | V/AC | | | | | |
| 15 | 125 | 5-15R | Premium decorator duplex receptacle, back & side wire | GY, RD, V, W | <input type="checkbox"/> 6262__ | • • • • |
| 20 | 125 | 5-20R | Premium decorator duplex receptacle, back & side wire | BK, GY, RD, V, W | <input type="checkbox"/> 6362__ | • • • • |

Isolated ground premium industrial grade receptacles



| Rating | | NEMA | Description | Color suffix | Catalog no. | |
|--------|------|-------|--|----------------------|-------------------------------------|---------|
| A | V/AC | | | | | |
| 15 | 125 | 5-15R | Premium IG duplex receptacle, back & side wire | GY, RD, RN, V, W | <input type="checkbox"/> AHIG5262__ | • • • • |
| | | | Premium IG single receptacle, back & side wire | RN | <input type="checkbox"/> IG5261RN | • • • • |
| 20 | 125 | 5-20R | Premium IG duplex receptacle, back & side wire | BK, GY, RD, RN, V, W | <input type="checkbox"/> AHIG5362__ | • • • • |
| | | | Premium IG single receptacle, back & side wire | RN, V | <input type="checkbox"/> IG5361__* | • • • • |

*Not Fed Spec

Color ordering information:

For ordering devices, include Catalog no. followed by the Color suffix: B (Brown), BK (Black), GY (Gray), LA (Light Almond), RD (Red), RN (Orange), V (Ivory), W (White)

| | | | | | | | |
|----------|-----------|-----------|--------------|-----------|-----------|----------|----------|
| B | BK | GY | LA | RD | RN | V | W |
| (Brown) | (Black) | (Gray) | (Lt. Almond) | (Red) | (Orange) | (Ivory) | (White) |

Specification information: Premium industrial receptacles: A-29, ArrowLink premium industrial receptacles: A-36, Premium decorator industrial receptacles: A-29, Isolated ground premium industrial receptacles: A-34, ArrowLink isolated ground premium industrial receptacles: A-31, A-36

Compliances, specifications and availability are subject to change without notice.

ArrowLink option available. Add "M" suffix to standard catalog number (example AH8300W, AH8300WM). For ordering information on ArrowLink & ArrowLink SPD connectors, see Page A-5

Build-to-spec customizable devices - Page A-6

Indicates NAFTA compliant - Page Q-32

RoHS compliant - Page Q-32

Industrial grade receptacles

Industrial grade straight blade receptacles

Product description

2-pole, 3-wire grounding
15A, 125V/AC;
20A, 125V/AC
NEMA 5-15R, 5-20R

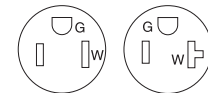

5-15R **5-20R**

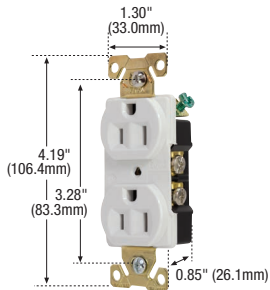

AH5252

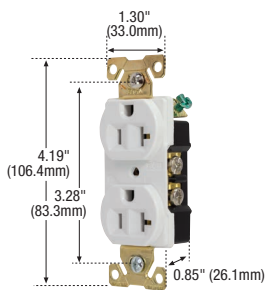

AH5352

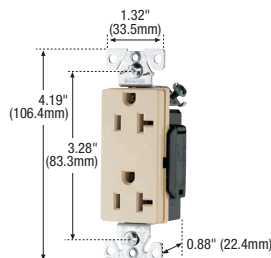

6342

Industrial grade receptacles

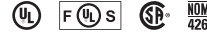

| Rating | A | V/AC | NEMA | Description | Color suffix | Catalog no. | ▶ | 🇺🇸 | 🇨🇦 | 🇩🇪 |
|--------|-----|-------|-------------------------------------|-----------------------------|--------------|-------------|---|----|----|----|
| 15 | 125 | 5-15R | Duplex receptacle, back & side wire | B, BK, BL, GY, LA, RD, V, W | □ AH5252__ | • | • | • | • | • |
| 20 | 125 | 5-20R | Duplex receptacle, back & side wire | B, BK, BL, GY, LA, RD, V, W | □ AH5352__ | • | • | • | • | • |

Decorator industrial grade receptacles



| Rating | A | V/AC | NEMA | Description | Color suffix | Catalog no. | ▶ | 🇺🇸 | 🇨🇦 | 🇩🇪 |
|--------|-----|-------|--|-------------|--------------|-------------|---|----|----|----|
| 20 | 125 | 5-20R | Decorator duplex receptacle, side wire | V, W | □ 6342__ | • | • | • | • | • |

Accessories for industrial grade NEMA 5-15 & 5-20 receptacles

| Description | Color suffix | Catalog no. | 🇺🇸 | 🇨🇦 | 🇩🇪 |
|---|----------------------------|-------------|----|----|----|
| 2-Gang mid-size decorator wallplate | A, B, BK, GY, LA, RD, V, W | □ PJ262__ | • | | |
| 1-Gang standard size duplex receptacle wallplate | Stainless steel | □ 93101 | • | • | |
| 1-Gang, stainless steel single receptacle wallplate | Stainless steel | □ 93091 | • | • | |



PJ262V



93101



93091

Color ordering information:

For ordering devices, include Catalog no. followed by the Color suffix: A (Almond), B (Brown), BK (Black), BL (Blue), GY (Gray), LA (Light Almond), RD (Red), V (Ivory), W (White)

| | | | | | | | | | |
|----------|----------|-----------|-----------|-----------|--------------|-----------|----------|----------|-------------------|
| A | B | BK | BL | GY | LA | RD | V | W | |
| (Almond) | (Brown) | (Black) | (Blue) | (Gray) | (Lt. Almond) | (Red) | (Ivory) | (White) | (Stainless Steel) |

Specification information: Duplex industrial receptacles: A-30, Decorator industrial receptacles: A-30, ArrowLink industrial receptacles: A-36, Single industrial receptacles: A-31

Compliances, specifications and availability are subject to change without notice.

- ▶ ArrowLink option available. Add "M" suffix to standard catalog number (example AH8300W, AH8300WM). For ordering information on ArrowLink & ArrowLink SPD connectors, see Page A-5
- 🇺🇸 Build-to-spec customizable devices - Page A-6
- 🇺🇸 Indicates NAFTA compliant - Page Q-32
- 🇩🇪 RoHS compliant - Page Q-32

Industrial grade straight blade receptacles

Product description

2-pole, 3-wire grounding
 15A, 125V/AC;
 20A, 125V/AC
 NEMA 5-15R, 5-20R

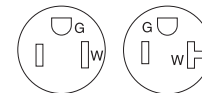

5-15R

5-20R

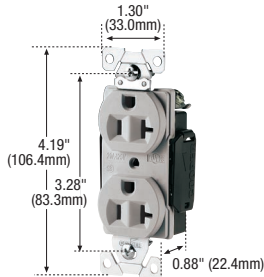

AH5362CR

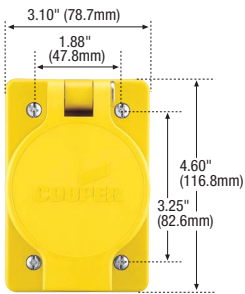

60W47

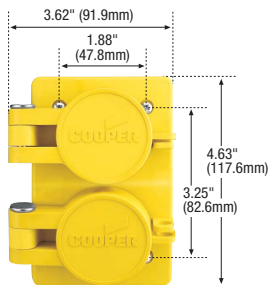

60W47DPLX

Special use panel-mount industrial single receptacles



| Rating | | NEMA | Description | Color | Catalog no. | |
|--------|------|-------|--|-------|-------------|-----|
| A | V/AC | | | | | |
| 15 | 125 | 5-15R | Brown, strap center-center spacing 1.9375" (49.2mm), back & side wire, short strap | B | □ 5284B | • • |

Corrosion resistant premium industrial grade receptacles

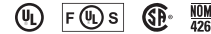

| Rating | | NEMA | Description | Color suffix | Catalog no. | |
|--------|------|-------|---|--------------|--------------|-----|
| A | V/AC | | | | | |
| 15 | 125 | 5-15R | Premium corrosion resistant duplex receptacle, back & side wire | GY, Y | □ AH5262CR__ | • • |
| 20 | 125 | 5-20R | Premium corrosion resistant duplex receptacle, back & side wire | GY, Y | □ AH5362CR__ | • • |

Watertight special use industrial grade receptacles



| Rating | | NEMA | Description | Color | Catalog no. | |
|--------|------|-------|---|-------|---------------|-----|
| A | V/AC | | | | | |
| 15 | 125 | 5-15R | Single watertight receptacle, back wire | Y | □ 60W47 | • • |
| | | | Single watertight receptacle, back wire | BK | □ 60W47BK | • • |
| | | | Duplex watertight receptacle, back wire | Y | □ 60W47DPLX | • • |
| | | | Duplex watertight receptacle, back wire | BK | □ 60W47DPLXBK | • • |
| 20 | 125 | 5-20R | Single watertight receptacle, back wire | Y | □ 60W33 | • • |
| | | | Single watertight receptacle, back wire | BK | □ 60W33BK | • • |
| | | | Duplex watertight receptacle, back wire | Y | □ 60W33DPLX | • • |
| | | | Duplex watertight receptacle, back wire | BK | □ 60W33DPLXBK | • • |

NOTE: See Complex Environment (Section D) for more information

Accessories for industrial grade NEMA 6-15 & 6-20 receptacles

| Description | Catalog no. | |
|--|-------------|-----|
| 1-Gang, cast aluminum outlet box, 3 hole 0.75" (19.05mm) | □ 1116 | • • |



1116

Color ordering information:

For ordering devices, include Catalog no. followed by the Color suffix: B (Brown), BK (Black), GY (Gray), Y (Yellow)

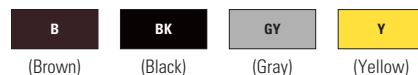

Specification information: Panel mount industrial receptacles: A-31, Corrosion resistant premium industrial receptacles: A-35, Watertight receptacles: A-35

Compliances, specifications and availability are subject to change without notice.

Build-to-spec customizable devices - Page A-6

Indicates NAFTA compliant - Page Q-32

RoHS compliant - Page Q-32

Industrial grade straight blade receptacles

Product description

2-pole, 3-wire grounding
 15A, 250V/AC;
 20A, 250V/AC
 NEMA 6-15R, 6-20R

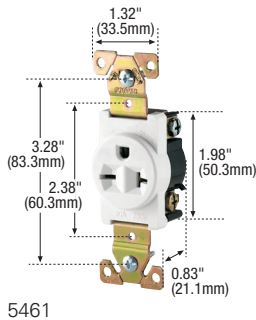
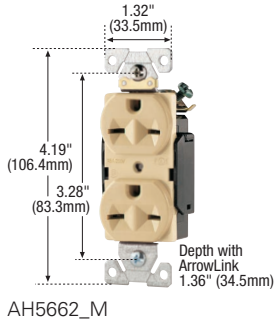
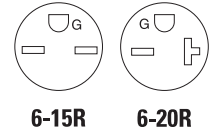

Premium industrial grade receptacles



| Rating | A | V/AC | NEMA | Description | Color suffix | Catalog no. | | | | |
|--------|-----|-------|---|-------------|--------------|-------------|---|---|---|---|
| 15 | 250 | 6-15R | Premium duplex receptacle, back & side wire | | B, V, W | □ AH5662__ | • | • | • | • |
| | | | Premium single receptacle, back & side wire | | B, V, W | □ 5661__ | • | • | • | • |
| 20 | 250 | 6-20R | Premium duplex receptacle, back & side wire | | B, GY, V, W | □ AH5462__ | • | • | • | • |
| | | | Premium single receptacle, back & side wire | | B, GY, V, W | □ 5461__ | • | • | • | • |

Premium decorator industrial grade receptacles



| Rating | A | V/AC | NEMA | Description | Color suffix | Catalog no. | | |
|--------|-----|-------|---|-------------|--------------|-----------------------|---|---|
| 15 | 250 | 6-15R | Premium decorator duplex receptacle, back & side wire | | V, W | □ 6662__ [†] | • | • |
| 20 | 250 | 6-20R | Premium decorator duplex receptacle, back & side wire | | V, W | □ 6462__ | • | • |

[†] Not NOM cert

Isolated ground premium industrial grade receptacles



| Rating | A | V/AC | NEMA | Description | Color | Catalog no. | | | |
|--------|-----|-------|--|-------------|-------|--------------|---|---|---|
| 15 | 250 | 6-15R | Premium IG duplex receptacle, back & side wire | | RN | □ AHIG5662RN | • | • | • |
| | | | Premium IG single receptacle, back & side wire | | RN | □ IG5661RN* | • | • | • |
| 20 | 250 | 6-20R | Premium IG duplex receptacle, back & side wire | | RN | □ AHIG5462RN | • | • | • |
| | | | Premium IG single receptacle, back & side wire | | RN | □ IG5461RN* | • | • | • |

* Not Fed Spec

Color ordering information:

For ordering devices, include Catalog no. followed by the Color suffix: B (Brown), GY (Gray), RN (Orange), V (Ivory), W (White)



Specification information: ArrowLink premium industrial receptacles: A-29, Premium industrial receptacles: A-29, Premium decorator industrial receptacles: A-29, Isolated ground premium industrial receptacles: A-30

Compliances, specifications and availability are subject to change without notice.

➤ ArrowLink option available. Add "M" suffix to standard catalog number (example AH8300W, AH8300WM). For ordering information on ArrowLink & ArrowLink SPD connectors, see Page A-5

➤ Build-to-spec customizable devices - Page A-6

🇺🇸 Indicates NAFTA compliant - Page Q-32

♻️ RoHS compliant - Page Q-32

Industrial grade straight blade receptacles

Product description

2-pole, 3-wire grounding
 15A, 250V/AC
 20A, 250V/AC
 NEMA 6-15R, 6-20R

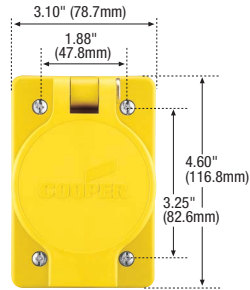
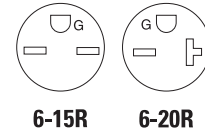

60W48

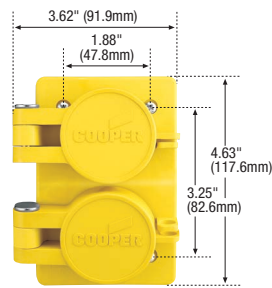

60W49DPLX

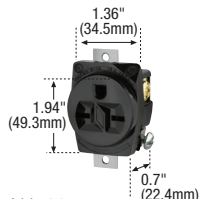

AH5684

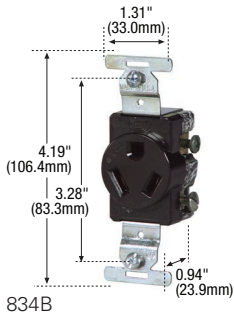

834B

Watertight special use industrial grade receptacles

| Rating | A | V/AC | NEMA | Description | Color | Catalog no. | |
|--------|-----|-------|---|-------------|---------------|-------------|--|
| 15 | 250 | 6-15R | Single watertight receptacle, back wire | Y | □ 60W49 | | |
| | | | Single watertight receptacle, back wire | BK | □ 60W49BK | | |
| | | | Duplex watertight receptacle, back wire | Y | □ 60W49DPLX | | |
| | | | Duplex watertight receptacle, back wire | BK | □ 60W49DPLXBK | | |
| 20 | 250 | 6-20R | Single watertight receptacle, back wire | Y | □ 60W48 | | |
| | | | Single watertight receptacle, back wire | BK | □ 60W48BK | | |
| | | | Duplex watertight receptacle, back wire | Y | □ 60W48DPLX | | |
| | | | Duplex watertight receptacle, back wire | BK | □ 60W48DPLXBK | | |

NOTE: See Complex Environments (Section D) for more information

Special use panel-mount industrial single receptacles

| Rating | A | V/AC | NEMA | Description | Color | Catalog no. | | |
|--------|-----|-------|--|-------------|-------|-------------|--|--|
| 15 | 250 | 6-15R | Strap center to center spacing 1.9375" (49.2mm), back & side wire, short strap | | B | □ AH5684 | | |

Industrial grade straight blade receptacles

Product description

2-pole, 3-wire grounding
 15A, 277V/AC
 20A, 277V/AC
 NEMA 7-15R, 7-20R

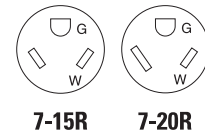

Industrial grade receptacles

| Rating | A | V/AC | NEMA | Description | Color | Catalog no. | | |
|--------|-----|-------|-------------------------------------|-------------|-------|----------------------|--|--|
| 15 | 277 | 7-15R | Duplex receptacle, back & side wire | | B | □ 5302B [†] | | |
| 20 | 277 | 7-20R | Single receptacle, side wire only | | B | □ 834B | | |

[†] UL only

Color information:

B (Brown), BK (Black), Y (Yellow)



Specification information: Panel mount industrial receptacles: A-31, Industrial receptacles: A-35, Watertight industrial receptacles: A-35

Compliances, specifications and availability are subject to change without notice.

Indicates NAFTA compliant - Page Q-32

RoHS compliant - Page Q-32

Construction grade receptacles

Combines safe, rugged, reliable performance with ease-of-installation

Arrow Hart construction grade receptacles are designed to provide a dependable, long lasting user experience while increasing the speed and efficiency of installation

Construction grade 5262 & 5362 series features & benefits

Automatic grounding system eliminates need for bonding jumper in grounded metal enclosures

Nylon face resists high impact and chemical abuse

Patented screw catch captures wallplate screw eliminating hand threading of screw, lost screws and cross-threading

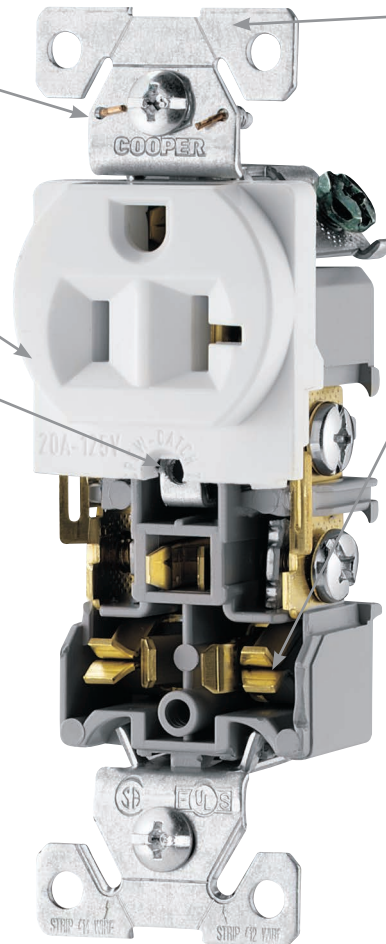

Extra long/wide mounting strap maintains assembly security and helps reach oversize cutouts

0.031" thick triple wiper brass line contacts minimize heat rise and maximize plug retention

Additional features & benefits

- Available in 15A & 20A duplex configurations, including tamper resistant and ArrowLink modular styles
- Convenient built-in #10 and #12 AWG wire strippers
- Tri-combo head terminal and mounting screws

Compliances, specifications and availability are subject to change without notice.

www.eaton.com
www.eaton.com/arrowhart

Construction grade receptacles

Construction grade straight blade receptacles

Product description

2-pole, 3-wire grounding
 15A, 125V/AC
 20A, 125V/AC
 NEMA 5-15R, 5-20R

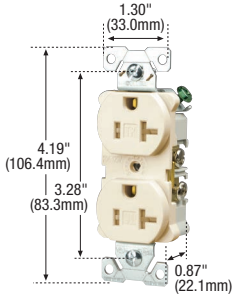
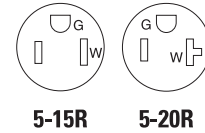

TR5362

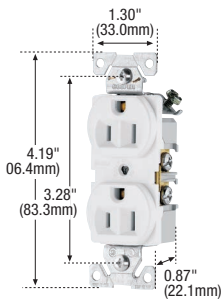

5262

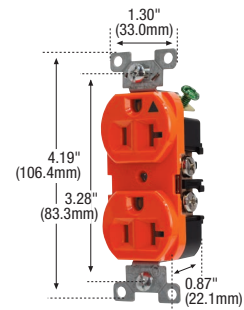

IG5362

Tamper resistant construction grade receptacles



| Rating | A | V/AC | NEMA | Description | Color suffix | Catalog no. | ▶ | 🇺🇸 | ✓ |
|--------|-----|-------|-------------------------------------|----------------------------|--------------|-------------|---|----|---|
| 15 | 125 | 5-15R | Duplex receptacle, back & side wire | A, B, BK, GY, LA, V, W | □ TR5262__ | • | • | • | • |
| 20 | 125 | 5-20R | Duplex receptacle, back & side wire | A, B, BK, GY, LA, RD, V, W | □ TR5362__ | • | • | • | • |

Construction grade receptacles



| Rating | A | V/AC | NEMA | Description | Color suffix | Catalog no. | ▶ | 🇺🇸 | ✓ |
|--------|-----|-------|-------------------------------------|-----------------------------|--------------|-------------|---|----|---|
| 15 | 125 | 5-15R | Duplex receptacle, back & side wire | B, GY, LA, V, W | □ 5262__ | • | • | • | • |
| 20 | 125 | 5-20R | Duplex receptacle, back & side wire | B, BK, BL, GY, LA, RD, V, W | □ 5362__ | • | • | • | • |

Construction grade straight blade receptacles

Product description

2-pole, 3-wire grounding
 15A, 250V/AC
 20A, 250V/AC
 NEMA 5-15R, 5-20R, 6-15R, 6-20R

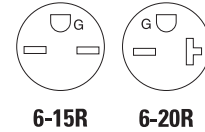

Construction grade receptacles



| Rating | A | V/AC | NEMA | Description | Color suffix | Catalog no. | ▶ | 🇺🇸 | ✓ |
|--------|-----|-------|-------------------------------------|-------------|------------------------|-------------|---|----|---|
| 15 | 250 | 6-15R | Duplex receptacle, back & side wire | B, V, W | □ 5662C__ [†] | • | • | • | • |
| 20 | 250 | 6-20R | Duplex receptacle, back & side wire | B, V, W | □ 5462C__ | • | • | • | • |

[†] Not NOM cert

Isolated ground, back wire & side wire



| Rating | A | V/AC | NEMA | Description | Color suffix | Catalog no. | ✓ |
|--------|-----|-------|----------------------|----------------------|--------------|-------------|---|
| 15 | 125 | 5-15R | IG duplex receptacle | GY, RD, RN, V, W | □ IG5262__ | • | • |
| 20 | 125 | 5-20R | IG duplex receptacle | BK, GY, RD, RN, V, W | □ IG5362__ | • | • |

Color ordering information:

For ordering devices, include Catalog no. followed by the Color suffix: A (Almond), B (Brown), BK (Black), BL (Blue), GY (Gray), LA (Light Almond), RD (Red), RN (Orange), V (Ivory), W (White)

| | | | | | | | | | |
|----------|----------|-----------|-----------|-----------|--------------|-----------|-----------|----------|----------|
| A | B | BK | BL | GY | LA | RD | RN | V | W |
| (Almond) | (Brown) | (Black) | (Blue) | (Gray) | (Lt. Almond) | (Red) | (Orange) | (Ivory) | (White) |

Specification information: Construction grade receptacles: A-31, ArrowLink construction grade receptacles: A-36, Tamper resistant construction grade receptacles: A-32

Compliances, specifications and availability are subject to change without notice.

▶ ArrowLink option available. Add "M" suffix to standard catalog number (example AH8300W, AH8300WM). For ordering information on ArrowLink & ArrowLink SPD connectors, see Page A-5

🇺🇸 Build-to-spec customizable devices - Page A-6

🇺🇸 Indicates NAFTA compliant - Page Q-32

TR Tamper resistant

✓ RoHS compliant - Page Q-32

Commercial grade receptacles

Commercial grade straight blade receptacles

Product description

2-pole, 3-wire grounding
 15A, 125V/AC
 20A, 125V/AC
 NEMA 5-15R, 5-20R

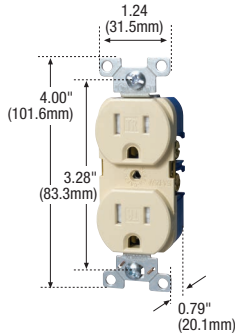
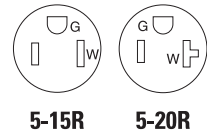

TRBR15

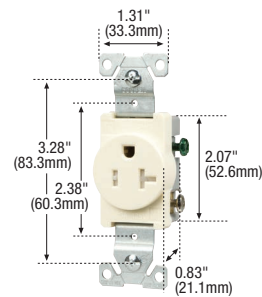

TR1877

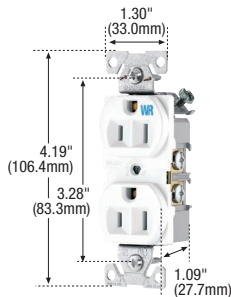

WRBR15

Tamper resistant commercial grade receptacles



| Rating | A | V/AC | NEMA | Description | Color suffix | Catalog no. | |
|--------|-----|-------|---|----------------------------|--------------|-------------|--|
| 15 | 125 | 5-15R | Duplex receptacle, back & side wire | A, B, BK, GY, LA, V, W | □ TRBR15__ | • • | |
| | | | Single receptacle, side wire | A, B, BK, LA, V, W | □ TR817__* | • • | |
| | | | Decorator duplex receptacle, back & side wire | LA, V, W | □ TR6252__ | • • | |
| | | | Decorator single receptacle, back & side wire | B, BK, V, W | □ TR6250__ | • • | |
| | | | Duplex receptacle, side wire | A, B, BK, GY, LA, V, W | □ TRCR15__* | | |
| 20 | 125 | 5-20R | Duplex receptacle, back & side wire | A, B, BK, GY, LA, RD, V, W | □ TRBR20__ | • • | |
| | | | Single receptacle, side wire | A, B, BK, LA, V, W | □ TR1877__* | • • | |
| | | | Decorator duplex receptacle, back & side wire | A, B, BK, GY, LA, V, W | □ TR6352__ | • • | |
| | | | Decorator single receptacle, side wire | LA, V, W | □ TR6350__* | • • | |
| | | | Duplex receptacle, side wire | A, B, BK, GY, LA, V, W | □ TRCR20__* | | |

* Not Fed Spec

Weather resistant commercial grade receptacles



| Rating | A | V/AC | NEMA | Description | Color suffix | Catalog no. | |
|--------|-----|-------|-------------------------------------|-------------|--------------|-------------|--|
| 15 | 125 | 5-15R | Duplex receptacle, back & side wire | B, V, W | □ WRBR15__ | • • | |
| 20 | 125 | 5-20R | Duplex receptacle, back & side wire | B, V, W | □ WRBR20__ | • • | |

Tamper & weather resistant commercial grade receptacles

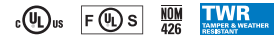

| Rating | A | V/AC | NEMA | Description | Color suffix | Catalog no. | |
|--------|-----|-------|-------------------------------------|-------------|--------------|-------------|--|
| 15 | 125 | 5-15R | Duplex receptacle, back & side wire | B, GY, V, W | □ TWRBR15__ | • • | |
| 20 | 125 | 5-20R | Duplex receptacle, back & side wire | B, V, W | □ TWRBR20__ | • • | |

Color ordering information:

For ordering devices, include Catalog no. followed by the Color suffix: A (Almond), B (Brown), BK (Black), GY (Gray), LA (Light Almond), RD (Red), V (Ivory), W (White)



Specification information: Tamper resistant commercial receptacles: A-32, Weather resistant commercial receptacles: A-32, Tamper & weather resistant commercial receptacles: A-32

Compliances, specifications and availability are subject to change without notice.

➤ ArrowLink option available. Add "M" suffix to standard catalog number (example AH8300W, AH8300WM). For ordering information on ArrowLink & ArrowLink SPD connectors, see Page A-5

Build-to-spec customizable devices - Page A-6

RoHS compliant - Page Q-32

TR Tamper resistant WWR Weather resistant TWR Tamper & weather resistant

Commercial grade straight blade receptacles

Product description

2-pole, 3-wire grounding
 15A, 125V/AC
 20A, 125V/AC
 NEMA 5-15R, 5-20R

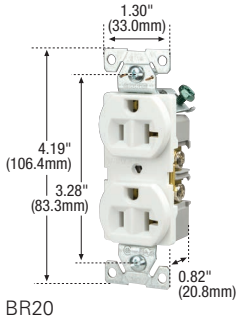
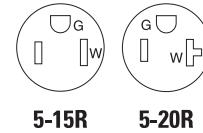

BR20

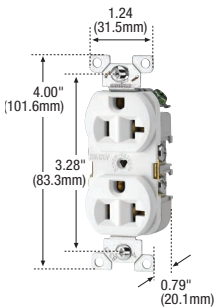

CR20

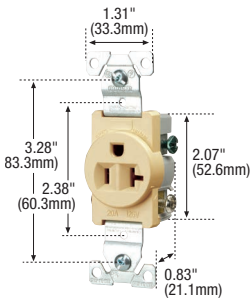

1877

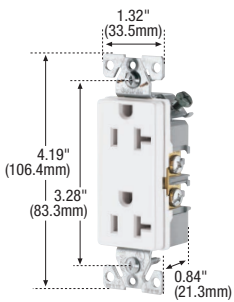

6352

Commercial grade receptacles



| Rating | A | V/AC | NEMA | Description | Color suffix | Catalog no. | | | |
|--------|-----|-------|------|-------------------------------------|----------------------------|-------------|---|---|---|
| 15 | 125 | 5-15R | | Duplex receptacle, back & side wire | A, B, BK, GY, LA, V, W | □BR15__ | • | • | • |
| | | | | Duplex receptacle, side wire | A, B, BK, GY, LA, V, W | □CR15__ | • | • | • |
| | | | | Single receptacle, side wire | B, BK, LA, V, W | □817__* | • | • | • |
| 20 | 125 | 5-20R | | Duplex receptacle, back & side wire | A, B, BK, GY, LA, RD, V, W | □BR20__ | • | • | • |
| | | | | Duplex receptacle, side wire | A, B, BK, GY, LA, V, W | □CR20__ | • | • | • |
| | | | | Single receptacle, side wire | A, B, BK, LA, V, W | □1877__* | • | • | • |

* Not Fed Spec

Decorator commercial grade receptacles



| Rating | A | V/AC | NEMA | Description | Color suffix | Catalog no. | | | |
|--------|-----|-------|------|-------------------------------------|------------------------|-------------|---|---|---|
| 15 | 125 | 5-15R | | Duplex receptacle, back & side wire | B, BK, GY, LA, V, W | □6252__† | • | • | • |
| | | | | Single receptacle, back & side wire | V, W | □6250__* | • | • | • |
| 20 | 125 | 5-20R | | Duplex receptacle, back & side wire | A, B, BK, GY, LA, V, W | □6352__† | • | • | • |
| | | | | Single receptacle, back & side wire | B, V, W | □6350__*† | • | • | • |

† Not NOM cert, * UL Listed & CSA certified

Accessories for construction grade 5-15 & 5-20 receptacles

| Description | Color suffix | Catalog no. | | |
|--|----------------------------|-------------|---|---|
| 2-Gang standard size duplex receptacle wallplate | A, B, BK, GY, LA, RD, V, W | □5150__ | • | • |
| 1-Gang mid-size single receptacle wallplate, 1.4" hole | A, B, BK, GY, LA, RD, V, W | □PJ7__ | • | • |



5150B



PJ7GY

Color ordering information:

For ordering devices, include Catalog no. followed by the Color suffix: A (Almond), B (Brown), BK (Black), GY (Gray), LA (Light Almond), RD (Red), V (Ivory), W (White)



Specification information: Commercial receptacles: A-33

Compliances, specifications and availability are subject to change without notice.

Build-to-spec customizable devices - Page A-6

Indicates NAFTA compliant - Page Q-32

RoHS compliant - Page Q-32

Commercial grade receptacles

Commercial grade straight blade receptacles

Product description

2-pole, 3-wire grounding
 15A, 125V/AC
 20A, 125V/AC
 NEMA 5-15R, 5-20R

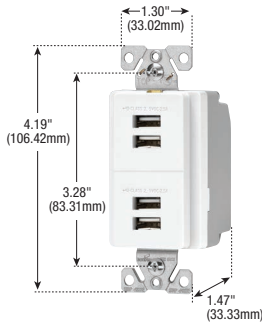
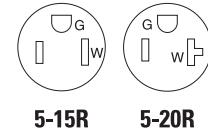

7750

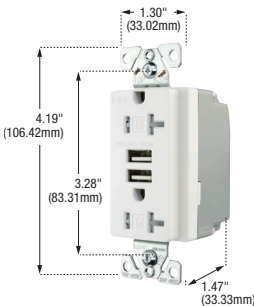

TR7756

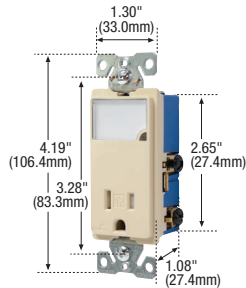

TR7735

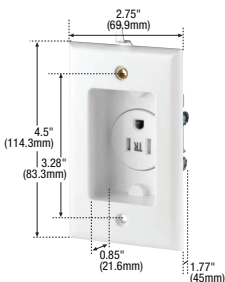

TR775

USB charging station



| USB rating | | Description | Color suffix | Catalog no. |
|------------|------|----------------------------------|--------------|-------------|
| A | V/DC | | | |
| 5.0 total | 5 | USB charging station, wire leads | BK, LA, V, W | □ 7750__ |

USB charger with tamper resistant receptacles



| Rating | | | | Description | Color suffix | Catalog no. |
|--------|------|------|------|---|------------------------|-------------|
| A | V/AC | Amps | V/DC | | | |
| 15 | 125 | 3.1 | 5 | USB charger with TR duplex receptacle, wire leads | A, B, BK, GY, LA, V, W | □ TR7755__ |
| 20 | 125 | 3.1 | 5 | USB charger with TR duplex receptacle, wire leads | A, B, BK, GY, LA, V, W | □ TR7756__ |

Tamper resistant combination LED wallbox nightlight with receptacle



| Rating | | | Description | Color suffix | Catalog no. |
|--------|------|-------|---|-----------------|-------------|
| A | V/AC | NEMA | | | |
| 15 | 125 | 5-15R | Nightlight with single receptacle, back & side wire | A, BK, LA, V, W | □ TR7735 |
| 20 | 125 | 5-20R | Nightlight with single receptacle, back & side wire | A, BK, LA, V, W | □ TR7736 |

Tamper resistant clock hanger receptacles



| Rating | | | Description | Color | Catalog No. | |
|--------|------|-------|---|-------|-------------|---|
| A | V/AC | NEMA | | | | |
| 15 | 125 | 5-15R | Single clock hanger receptacle side wire | W | □ TR775W | • |
| | | | Recessed duplex receptacle, push wire & side wire | W | □ TR780W | • |

Color ordering information:

For ordering devices, include Catalog no. followed by the Color suffix: A (Almond), B (Brown), BK (Black), GY (Gray), LA (Light Almond), V (Ivory), W (White)

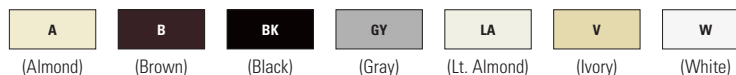

Specification information: USB commercial receptacles & USB charging station: A-34
Compliances, specifications and availability are subject to change without notice.



OEM panel mount & snap-in straight blade receptacles

Product description

2-pole, 3-wire grounding
15A, 125V/AC
NEMA 5-15R



5-15R

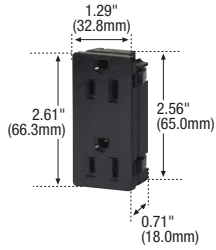

4070-6

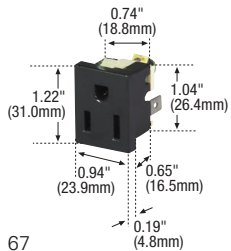

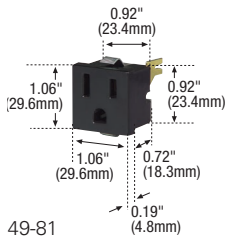

67





49-81

Snap-in receptacles

| Rating | | NEMA | Description | Color | Catalog no. |  |  |
|--------|------|-------|--|-------|-------------|---|---|
| A | V/AC | | | | | | |
| 15 | 125 | 5-15R | Single receptacle, plastic back & clips, quick connect with screw terminal grounding, large face | BK | □ 4067BK | • | • |
| | | | Single receptacle, fiber back & steel clips, quick connect with screw terminal grounding, large face | BK | □ 4067-01BK | • | • |
| | | | Duplex receptacle, plastic back & clips, solder connect, slotted terminals, large face | BK | □ 4070-6BK | • | • |
| | | | Single receptacle, plastic back & clips, quick connect with screw terminal grounding, rectangular | BK | □ 67BK | • | • |
| | | | Single receptacle, plastic back & clips, quick connect with screw terminal grounding, rectangular | W | □ 67W | • | • |
| | | | Single receptacle, plastic back & clips, quick connect with wire lead grounding, rectangular | BK | □ 67-2BK | • | • |
| | | | Single receptacle, plastic back & clips, quick connect with wire lead grounding, rectangular | W | □ 67-2W | • | • |
| | | | Plug, solder connect, slotted terminals, square | BK | □ 4049BK* | • | • |

*Not NOM cert

Snap-in receptacles

| Rating | | NEMA | Description | Color | Catalog no. |  |  |
|--------|------|-------|--|-------|-------------|--|--|
| A | V/AC | | | | | | |
| 15 | 125 | 5-15R | Single receptacle, fiber back & steel clips, quick connect with wire lead grounding, rectangular | BK | □ 67-31BK | • | • |
| | | | Plug, wire leads, square | BK | □ 4049-2BK* | • | • |
| | | | Single receptacle, fiber back & steel clips, quick connect with screw terminal grounding, square | BK, W | □ 49-01 | • | • |
| | | | Single receptacle, fiber back & steel clips, wire leads, square | BK | □ 49-21BK | • | • |
| | | | Single receptacle, fiber back & steel clips, 90° quick connect, square | BK | □ 49-81BK | • | • |
| | | | Single receptacle, plastic back & clips, quick connect with screw terminal grounding, square | BK | □ 49BK | • | • |
| | | | Single receptacle, plastic back & clips, quick connect with screw terminal grounding, square | W | □ 49W | • | • |
| | | | Single receptacle, plastic back & clips, parallel quick connect, square | BK | □ 49-7BK | • | • |
| | | | Single receptacle, plastic back & clips, 90° quick connect, square | BK | □ 49-8BK | • | • |
| | | | Single receptacle, plastic back & clips, wire leads, square | BK | □ 49-2BK | • | • |
| | | | Single receptacle, plastic back & clips, wire leads, square | W | □ 49-2W | • | • |

*Not NOM cert, For panel cutout dimensional data, see Q-Technical Reference

Color information:

BK (Black), W (White)



Specification information: Snap-in commercial receptacles: A-33

Compliances, specifications and availability are subject to change without notice.

 Indicates NAFTA compliant - Page Q-32

 RoHS compliant - Page Q-32

Commercial grade receptacles

Commercial grade straight blade receptacles

Product description

2-pole, 3-wire grounding
Dual voltage
15A, 125/250V/AC
NEMA 5-15R, 6-15R

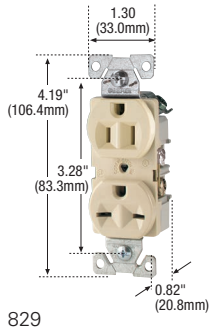
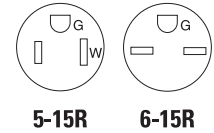

829

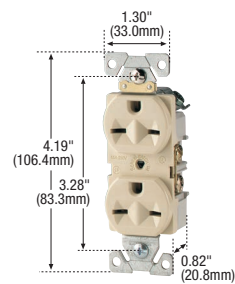

826

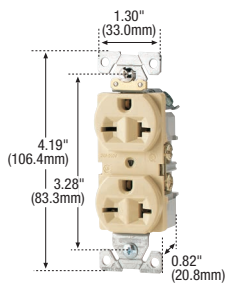

815

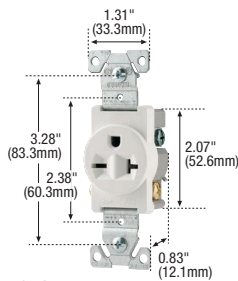

1876

Dual voltage commercial grade receptacle

| Rating | | NEMA | Description | Color | Catalog no. |  |
|--------|-------------|-----------------|---|-------|-------------|---|
| A | V/AC | | | | | |
| 15 | 125/ 250 | 5-15R/ 6-15R | Dual voltage duplex receptacle, side wire | V | □ 829V |  |





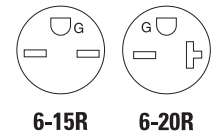

Commercial grade straight blade receptacles

Product description

2-pole, 3-wire grounding
15A, 250V/AC
20A, 250V/AC
NEMA 6-15R, 6-20R



Commercial grade receptacles

| Rating | | NEMA | Description | Color suffix | Catalog no. |    |
|--------|------|-------|------------------------------|--------------------|-------------|---|
| A | V/AC | | | | | |
| 15 | 250 | 6-15R | Duplex receptacle, side wire | B, V, W | □ 826_Δ |  |
| | | | Single receptacle, side wire | B, V, W | □ 816_ |  |
| 20 | 250 | 6-20R | Duplex receptacle, side wire | B, V, W | □ 815_Δ |  |
| | | | Single receptacle, side wire | A, B, BK, LA, V, W | □ 1876_ |  |

^Δ Fed Spec certified

Decorator commercial grade receptacle

| Rating | | NEMA | Description | Color | Catalog no. |    |
|--------|------|-------|-------------------------------------|-------|-------------|---|
| A | V/AC | | | | | |
| 20 | 250 | 6-20R | Single receptacle, back & side wire | W | □ 6450W |  |

Color ordering information:

For ordering devices, include Catalog no. followed by the Color suffix: A (Almond), B (Brown), BK (Black), LA (Light Almond), V (Ivory), W (White)



Specification information: Commercial receptacles: A-33

Compliances, specifications and availability are subject to change without notice.

 Build-to-spec customizable devices - Page A-6

 Indicates NAFTA compliant - Page Q-32

 RoHS compliant - Page Q-32

Straight blade power devices - 20, 30, 50 & 60A



| Rating: Amps V/AC | Receptacle/ plug NEMA configuration | Flush receptacles | Wallplates | Surface receptacles | Panel mount receptacles | Plugs | Angle plugs | Connectors | Flanged inlets | Adapters |
|-------------------------|---|----------------------|------------|------------------------|----------------------------|-------|-------------|------------|-------------------|----------|
|-------------------------|---|----------------------|------------|------------------------|----------------------------|-------|-------------|------------|-------------------|----------|

2-pole, 3-wire grounding

| | | | | | | | | | | | |
|---------------------|-------------------|---|--|--|--|---------------------------------------|---|---|---|--|--|
| 30A 125V | 5-30R 5-30P | Commercial: 1233 (Brown) Industrial: 5716N (Black) | Standard size: 39CH, 68, 2068, 2168, 93221, 93227 Mid-size: 5068, PJ703, PJ724 | | | Industrial: 5717N (Gray) | Commercial: S41 (Black) Industrial: 5717AN (Gray) | Industrial: 6716N (Gray & Black) | Industrial: 5717NFI (Gray) | | |
| 30A 125V | TT-30R TT-30P | Commercial: 1263 (Black) | | | Commercial: U1263 (Black) | | Commercial: 83 (Black) | | | Commercial: 1264 (Receptacle to NEMA 5-15/5-20 plug) (Black) | |
| 30A 250V | 6-30R 6-30P | Commercial: 1234 (Black) Industrial: 5700N (Black) | | | Commercial: 1232 (Black) | | Industrial: 5701N (Gray) | Commercial: S42 (Black) Industrial: 5701AN (Gray) | Industrial: 6700N (Gray & Black) | Industrial: 5701NFI (Gray) | |
| 30A 277V | 7-30R 7-30P | Industrial: 5795N (Black) | | | | | Industrial: 5703N (Gray) | Industrial: 5703AN (Gray) | Industrial: 6795N (Gray & Black) | Industrial: 5703NFI (Gray) | |
| 50A 125V | 5-50R 5-50P | Commercial: 1253 (Black) | | | Commercial: 1251 (Black) | | Industrial: 5712N (Gray) | Commercial: S41 (Black) Industrial: 5712AN (Gray) | Industrial: 6711N (Gray & Black) | Industrial: 5712NFI (Gray) | |
| 50A 250V | 6-50R 6-50P | Commercial: 1254 (Black) Industrial: 5709N (Black) | | | Commercial: 1252 (Black) | | Industrial: 5710N (Gray) | Commercial: S42 (Black) Industrial: 5710AN (Gray) | Industrial: 6709N (Gray & Black) | Industrial: 5710NFI (Gray) | |
| 50A 277V | 7-50R 7-50P | | | | | | Industrial: 5705N (Gray) | Industrial: 5705AN (Gray) | Industrial: 6796N (Gray & Black) | Industrial: 5705NFI (Gray) | |

3-pole, 3-wire non-grounding

| | | | | | | | | | | |
|-----------------------------------|-------------------|--|--|--------------------------------------|--|--|--|---|---|--|
| 20A 125/250V | 10-20R 10-20P | Commercial: 805 (Ivory) | | | | Industrial: 9151N (Gray) Commercial: 2836 (Armed PVC) (Yellow) | | | | |
| 30A 125/250V dryer | 10-30R 10-30P | Commercial: 38B (Brown) | Standard size: 39CH, 68, 2068, 2168, 93221, 93227 | Commercial: 125 (Black) | | Industrial: 9337N (Gray) | Commercial: S80 (Black) Industrial: 9352AN (Gray) | Industrial: 9341N (Gray & Black) | Industrial: 9337NFI (Gray) | |
| 50A 125/250V range | 10-50R 10-50P | Commercial: 32B (Brown) Industrial: 7985N (Black) | Mid-size: 5068, PJ703, PJ724 Standard Size: 192 | Commercial: 112 (Black) | | Industrial: 4524N (Gray) | Commercial: S80 (Black) Industrial: 7952AN (Gray) | Industrial: 4526N (Gray & Black) | Industrial: 4524NFI (Gray) | |

Power device dimensional information: B-20; Specification information: B-25-B-27
Compliances, specifications and availability are subject to change without notice.

All products on this page are RoHS compliant - Page Q-32

Straight blade power devices - 20, 30, 50 & 60A

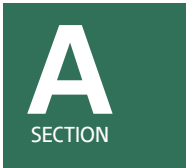

| Rating: Amps V/AC | Receptacle/ plug NEMA configuration | Flush receptacles | Wallplates | Surface receptacles | Panel mount receptacles | Plugs | Angle plugs |
|-------------------------|---|----------------------|------------|------------------------|-------------------------------|-------|-------------|
|-------------------------|---|----------------------|------------|------------------------|-------------------------------|-------|-------------|

3-pole, 4-wire grounding

| | | | | | | | |
|-----------------------|-------------------|--|---|---------------------------------------|--|---|--|
| 20A 125/250V | 14-20R 14-20P | Industrial: 5759 (Black) | | | | | |
| 30A 125/250V dryer | 14-30R 14-30P | Commercial: 1257 (Black) | Standard size: 39CH, 68, 2068, 2168, 93221, 93227 | Commercial: 1225 (Black) | | Industrial: 5746N (Gray) | Commercial: S21 (Black) |
| | | Industrial: 5744N (Black) | Mid-size: 5068, PJ703, PJ724 | | | | Industrial: 5732AN (Gray) |
| 30A 3Ø 250V | 15-30R 15-30P | Industrial: 8430N (Black) | Standard size: 69, 5169, 93223 | | | Industrial: 8432N (Gray) | Industrial: 8432AN (Gray) |
| 50A 125/250V range | 14-50R 14-50P | Commercial: 1258 (Black) | Standard size: 39CH, 68, 2068, 2168, 93221, 93227 | Commercial: 1212 (Black) | Commercial: 58 (Black) | Industrial: 5745N (Gray) | Commercial: S21 (Black) |
| | | Industrial: 5754N (Black) | Mid-size: 5068, PJ703, PJ724 | | | | Industrial: 5752AN (Gray) |
| 50A 3Ø 250V | 15-50R 15-50P | Industrial: 8450N (Black) | Standard size: 69, 5169, 93223 | | Industrial: 8450P (Black) | Industrial: 8452N (Gray) | Industrial: 8452AN (Gray) |
| 60A 125/250V | 14-60R 14-60P | Industrial: 9460N (Black) | Standard size: 69, 5169, 93223 | | Commercial: 60 (Black) | Industrial: 9462N (Gray) | Commercial: S20 (Black) |
| | | | | | | | Industrial: 9462AN (Gray) |
| 60A 3Ø 250V | 15-60R 15-60P | Industrial: 8460N (Black) | Standard size: 69, 5169, 93223 | | | Industrial: AH8462N (Gray) | Industrial: AH8462AN (Gray) |

4-pole, 4-wire non-grounding

| | | | | | | | |
|----------------------|-------------------|--|--|--|--|---------------------------------------|--|
| 30A 3ØY 120/208V | 18-30R 18-30P | | | | | Industrial: 8332N (Gray) | Industrial: 8332AN (Gray) |
| 50A 3ØY 120V/208V | 18-50R 18-50P | | | | | Industrial: 8352N (Gray) | Industrial: 8352AN (Gray) |
| 60A 3ØY 120/208V | 18-60R 18-60P | Industrial: 5515N (Black) | Standard size: 69, 5169, 93223 | | | Industrial: 5517N (Gray) | Commercial: S19 (Black) |
| | | | | | | | Industrial: 4516AN (Gray) |

Compliances, specifications and availability are subject to change without notice.

All products on this page are RoHS compliant - Page Q-32

Hospital grade receptacles specification & performance data

Hospital grade premium receptacles

Product description

2-pole, 3-wire grounding
 15A, 125V/AC; 15A, 250V/AC;
 20A, 125V/AC; 20A, 250V/AC
 NEMA 5-15, 6-15, 5-20, 6-20

| Device type | Hospital grade premium duplex receptacles: AH8200, AH8300, AH8400, AH8600 series | Hospital grade premium decorator duplex receptacles: 8262, 8362 series | Hospital grade premium single receptacles: 8210, 8310, 8410, 8610 series |
|--------------------------------------|---|--|--|
| Wiring type | Back & side wire | Back & side wire | Back & side wire |
| Testing & code compliance | <ul style="list-style-type: none"> Listed to UL498, file no. E15058 UL verified to Fed Spec WC-596G CSA certified to C22.2, no. 42, file no. 6914 (6233-01) NOM certified | <ul style="list-style-type: none"> Listed to UL498, file no. E15058 UL verified to Fed Spec WC-596G CSA certified to C22.2, no. 42, file no. 6914 (6233-01) NOM certified | <ul style="list-style-type: none"> Listed to UL498, file no. E15058 UL verified to Fed Spec WC-596G CSA certified to C22.2, no. 42, file no. 6914 (6233-01) NOM certified |
| Environmental specifications | <p>Flammability: Meets UL94 requirements; V2 rated</p> <p>Temperature rating: -20°C to 90°C (-4°F to 194°F)</p> | <p>Flammability: Meets UL94 requirements; V2 rated</p> <p>Temperature rating: -20°C to 70°C (-4°F to 158°F)</p> | <p>Flammability: Meets UL94 requirements; V2 rated</p> <p>Temperature rating: -20°C to 90°C (-4°F to 194°F)</p> |
| Electrical specifications | <p>Dielectric voltage: Withstands 2000V per UL498</p> <p>Current interrupting: Yes, at full-rated current</p> <p>Temperature rise: Max. 30°C (86°F) after 250 cycles of overload @ 200% of rated current (DC)</p> | <p>Dielectric voltage: Withstands 2000V per UL498</p> <p>Current interrupting: Yes, at full-rated current</p> <p>Temperature rise: Max. 30°C (86°F) after 250 cycles of overload @ 200% of rated current (DC)</p> | <p>Dielectric voltage: Withstands 2000V per UL498</p> <p>Current interrupting: Yes, at full-rated current</p> <p>Temperature rise: Max. 30°C (86°F) after 250 cycles of overload @ 200% of rated current (DC)</p> |
| Mechanical specifications | <p>Terminal accommodation: #14 - #10 AWG</p> <p>Voltage ratings: Permanently marked on device</p> | <p>Terminal accommodation: #14 - #10 AWG</p> <p>Voltage ratings: Permanently marked on device</p> | <p>Terminal accommodation: #14 - #10 AWG</p> <p>Voltage ratings: Permanently marked on device</p> |
| Materials | <p>Top housing: Nylon</p> <p>Bottom housing: Glass-filled nylon</p> <p>Strap: 0.05" thick brass, nickel plated</p> <p>Auto ground clip: Brass</p> <p>Line contacts: 0.031" thick 5-leaf brass, nickel plated</p> <p>Ground contact: Integral</p> <p>Terminal screws: #8-32 brass, neutral screw nickel plated</p> <p>Ground screw: #8-32 brass, green</p> <p>Screw terminal guards: PVC hinged doors</p> <p>Illuminated models: Long-life neon bulb</p> | <p>Top housing: Nylon</p> <p>Bottom housing: Glass-filled nylon</p> <p>Strap: 0.05" thick brass</p> <p>Auto ground clip: Brass</p> <p>Line contacts: 0.031" thick 5-leaf brass, nickel plated</p> <p>Ground contact: Integral</p> <p>Terminal screws: #8-32 brass, neutral screw nickel plated</p> <p>Ground screw: #8-32 brass, green</p> <p>Screw terminal guards: PVC hinged doors</p> <p>Illuminated models: Long-life neon bulb</p> | <p>Top housing: Nylon</p> <p>Bottom housing: Nylon</p> <p>Strap: 0.05" thick galvanized steel</p> <p>Auto ground clip: Phosphor bronze</p> <p>Line contacts: 0.037" thick triple-wipe brass</p> <p>Ground contact: Riveted</p> <p>Terminal screws: #8-32 steel, brass plated, neutral screw nickel plated</p> <p>Ground screw: #8-32 steel, green</p> <p>Screw terminal guards: N/A</p> <p>Illuminated models: N/A</p> |

Hospital grade premium isolated ground receptacles

Product description

2-pole, 3-wire grounding
 15A, 125V/AC;
 20A, 125V/AC; 20A, 250V/AC
 NEMA 5-15, 5-20, 6-20

| Device type | Hospital grade premium isolated ground duplex receptacles: IG8200, IG8300, IG8400 series | Hospital grade premium decorator isolated ground duplex receptacles: IG8262, IG8362 series | Hospital grade premium isolated ground single receptacles: IG8210, IG8310 series |
|--------------------------------------|--|--|---|
| Wiring type | Back & side wire | Back & side wire | Back & side wire |
| Testing & code compliance | <ul style="list-style-type: none"> Listed to UL498, file no. E15058 UL verified to Fed Spec WC-596G CSA certified to C22.2, no. 42, file no. 6914 (6233-01) NOM certified | <ul style="list-style-type: none"> Listed to UL498, file no. E15058 UL verified to Fed Spec WC-596G CSA certified to C22.2, no. 42, file no. 6914 (6233-01) NOM certified | <ul style="list-style-type: none"> Listed to UL498, file no. E15058 UL verified to Fed Spec WC-596G CSA certified to C22.2, no. 42, file no. 6914 (6233-01) NOM certified |
| Environmental specifications | <p>Flammability: Meets UL94 requirements; V2 rated</p> <p>Temperature rating: -20°C to 70°C (-4°F to 158°F)</p> | <p>Flammability: Meets UL94 requirements; V2 rated</p> <p>Temperature rating: -20°C to 70°C (-4°F to 158°F)</p> | <p>Flammability: Meets UL94 requirements; V2 rated</p> <p>Temperature rating: -40°C to 60°C (-40°F to 140°F)</p> |
| Electrical specifications | <p>Dielectric voltage: Withstands 2000V per UL498</p> <p>Current interrupting: Yes, at full-rated current</p> <p>Temperature rise: Max. 30°C (86°F) after 250 cycles of overload @ 200% of rated current (DC)</p> | <p>Dielectric voltage: Withstands 2000V per UL498</p> <p>Current interrupting: Yes, at full-rated current</p> <p>Temperature rise: Max. 30°C (86°F) after 250 cycles of overload @ 200% of rated current (DC)</p> | <p>Dielectric voltage: Withstands 2000V per UL498</p> <p>Current interrupting: Yes, at full-rated current</p> <p>Temperature rise: Max. 30°C (86°F) after 250 cycles of overload @ 200% of rated current (DC)</p> |
| Mechanical specifications | <p>Terminal accommodation: #14 - #10 AWG</p> <p>Voltage ratings: Permanently marked on device</p> | <p>Terminal accommodation: #14 - #10 AWG</p> <p>Voltage ratings: Permanently marked on device</p> | <p>Terminal accommodation: #14 - #10 AWG</p> <p>Voltage ratings: Permanently marked on device</p> |
| Materials | <p>Top housing: Nylon</p> <p>Bottom housing: Glass-filled nylon</p> <p>Strap: 0.05" thick galvanized steel, 1-piece isolated ground shunt</p> <p>Auto ground clip: Brass</p> <p>Line contacts: 0.031" thick 5-leaf brass</p> <p>Ground contact: 1-piece isolated ground shunt</p> <p>Terminal screws: #8-32 brass, neutral screw nickel plated</p> <p>Ground screw: #8-32 brass, green</p> <p>Screw terminal guards: PVC hinged doors</p> | <p>Top housing: Nylon</p> <p>Bottom housing: Glass-filled nylon</p> <p>Strap: 0.05" thick galvanized steel, 1-piece isolated ground shunt</p> <p>Auto ground clip: Brass</p> <p>Line contacts: 0.031" thick 5-leaf brass</p> <p>Ground contact: 1-piece isolated ground shunt</p> <p>Terminal screws: #8-32 brass, neutral screw nickel plated</p> <p>Ground screw: #8-32 brass, green</p> <p>Screw terminal guards: PVC hinged doors</p> | <p>Top housing: Nylon</p> <p>Bottom housing: Glass-filled nylon</p> <p>Strap: 0.05" thick galvanized steel, 1-piece isolated grounding shunt</p> <p>Auto ground clip: Phosphor bronze</p> <p>Line contacts: 0.037" thick triple-wipe brass</p> <p>Ground contact: 1-piece isolated ground shunt</p> <p>Terminal screws: #8-32 steel, brass plated, neutral screw nickel plated</p> <p>Ground screw: #8-32 steel, green</p> <p>Screw terminal guards: N/A</p> |

Compliances, specifications and availability are subject to change without notice.



 All products on this page are RoHS compliant - Page Q-32

Hospital grade receptacles specification & performance data

Hospital grade receptacles

Product description

2-pole, 3-wire grounding
 15A, 125V/AC;
 20A, 125V/AC
 NEMA 5-15, 5-20

| Device type | Hospital grade tamper resistant USB duplex receptacles: TR8255, TR8355 series  | Hospital grade tamper resistant duplex receptacles: TR8200, TR8300 series  | Hospital grade duplex receptacles: 8200, 8300 series | Hospital grade panel mount receptacles: 8210M, 8310M series |
|--------------------------------------|---|---|---|--|
| Wiring type | Wire leads | Back & side wire | Back & side wire | Back & side wire |
| Testing & code compliance | <ul style="list-style-type: none"> cULus Listed to UL498 and UL1310, file no. E15058 | <ul style="list-style-type: none"> Listed to UL498 file no. E1505 UL verified to Fed Spec WC-596G NOM certified | <ul style="list-style-type: none"> Listed to UL498, file no. E15058 UL verified to Fed Spec WC-596G CSA certified to C22.2, no. 42, file no. 6914 (6233-01) NOM certified | <ul style="list-style-type: none"> Listed to UL498 file no. E2369 UL verified to Fed Spec WC-596G CSA certified to C22.2, no. 42, file no. 6914 (6233-01) NOM certified |
| Environmental specifications | <p>Flammability: Meets UL94 requirements; V2 rated</p> <p>Temperature rating: -20°C to 60°C (-4°F to 140°F)</p> | <p>Flammability: Meets UL94 requirements; V2 rated</p> <p>Temperature rating: -20°C to 90°C (-4°F to 194°F)</p> | <p>Flammability: Meets UL94 requirements; V2 rated</p> <p>Temperature rating: -20°C to 90°C (-4°F to 194°F)</p> | <p>Flammability: Meets UL94 requirements; V2 rated</p> <p>Temperature rating: -40°C to 75°C (-40°F to 167°F)</p> |
| Electrical specifications | <p>Dielectric voltage - AC output: Receptacle withstands 2000V per UL498</p> <p>Current interrupting: Yes, at full-rated current</p> <p>Temperature rise - AC output: Receptacle - max. 30°C (86°F) after 100 cycles of overload @ 150% of rated current (DC)</p> <p>Switching frequency - DC output: Typical 140 kHz</p> <p>Output voltage - DC output: Nominal 5V (+/- 10%)</p> <p>Protection - DC output: Current limiting and thermal shutdown protection</p> <p>Output current - DC output: Constant current maximum 2.1A</p> | <p>Dielectric voltage: Withstands 2000V per UL498</p> <p>Current interrupting: Yes, at full-rated current</p> <p>Temperature rise: Max. 30°C (86°F) after 250 cycles of overload @ 200% of rated current (DC)</p> | <p>Dielectric voltage: Withstands 2000V per UL498</p> <p>Current interrupting: Yes, at full-rated current</p> <p>Temperature rise: Max. 30°C (86°F) after 250 cycles of overload @ 200% of rated current (DC)</p> | <p>Dielectric voltage: Withstands 2000V per UL498</p> <p>Current interrupting: Yes, at full-rated current</p> <p>Temperature rise: Max. 30°C (86°F) after 250 cycles of overload @ 200% of rated current (DC)</p> |
| Mechanical specifications | <p>Terminal accommodation: Device can be wired using #14 or #12 AWG wires, three 6" pre-stripped wire leads for line, neutral and ground, #14AWG for TR8245 and #12AWG for TR8345</p> <p>Voltage ratings: N/A</p> | <p>Terminal accommodation: #14 - #10 AWG</p> <p>Voltage ratings: Permanently marked on device</p> | <p>Terminal accommodation: #14 - #10 AWG</p> <p>Voltage ratings: Permanently marked on device</p> | <p>Terminal accommodation: #14 - #10 AWG</p> <p>Voltage ratings: Permanently marked on device</p> |
| Materials | <p>Top housing: PC</p> <p>Bottom housing: PC</p> <p>Strap: 0.045" thick steel, zinc plated</p> <p>Auto ground clip: Phosphor bronze</p> <p>Line contacts: 0.030" thick brass</p> <p>Ground contact: 0.014" thick brass</p> <p>Terminal screws: N/A</p> <p>Ground screw: N/A</p> <p>Screw terminal guards: N/A</p> <p>Tamper resistant shutters: Reliable Delrin® shutter assembly</p> | <p>Top housing: Nylon</p> <p>Bottom housing: PVC</p> <p>Strap: 0.05" thick steel, zinc plated</p> <p>Auto ground clip: Phosphor bronze</p> <p>Line contacts: 0.037" thick triple-wipe brass</p> <p>Ground contact: Riveted</p> <p>Terminal screws: #8-32 steel, neutral screw nickel plated</p> <p>Ground screw: #8-32 steel, green</p> <p>Screw terminal guards: N/A</p> <p>Tamper resistant shutters: Reliable Delrin® shutter assembly</p> | <p>Top housing: Nylon</p> <p>Bottom housing: PVC</p> <p>Strap: 0.045" thick steel, zinc plated</p> <p>Auto ground clip: Phosphor bronze</p> <p>Line contacts: 0.030" thick triple-wipe brass</p> <p>Ground contact: Riveted</p> <p>Terminal screws: #8-32 steel, brass plated, neutral screw nickel plated</p> <p>Ground screw: 8-32 brass, green</p> <p>Screw terminal guards: N/A</p> <p>Tamper resistant shutters: N/A</p> | <p>Top housing: Nylon</p> <p>Bottom housing: Nylon</p> <p>Strap: 0.05" thick nickel plated steel</p> <p>Auto ground clip: N/A</p> <p>Line contacts: 0.030" thick triple-wipe brass</p> <p>Ground contact: Riveted</p> <p>Terminal screws: #8-32 brass, neutral screw nickel plated</p> <p>Ground screw: #8-32 brass, green</p> <p>Screw terminal guards: N/A</p> <p>Tamper resistant shutters: N/A</p> |

Delrin® is a registered trademark of E.I. du Pont de Nemours

Compliances, specifications and availability are subject to change without notice.

 All products on this page are RoHS compliant - Page Q-32

Industrial grade receptacles

Product description

2-pole, 3-wire grounding
 15A, 125V/AC; 15A, 250V/AC
 20A, 125V/AC; 20A, 250V/AC
 NEMA 5-15, 6-15, 5-20, 6-20

| Device type | Industrial grade premium duplex receptacles: AH5262, AH5362, AH5462, AH5662 series | Industrial grade premium decorator duplex receptacles: 6262, 6362, 6462, 6662 series | Industrial grade premium single receptacles: 5261, 5361, 5461, 5661 series |
|--------------------------------------|--|---|---|
| Wiring type | Back & side wire | Back & side wire | Back & side wire |
| Testing & code compliance | <ul style="list-style-type: none"> Listed to UL498, file no. E15058 UL verified to Fed Spec WC-596G CSA certified to C22.2, no. 42, file no. 6914 (6233-01) NOM certified | <ul style="list-style-type: none"> Listed to UL498, file no. E15058 UL verified to Fed Spec WC-596G CSA certified to C22.2, no. 42, file no. 6914 (6233-01) NOM certified | <ul style="list-style-type: none"> Listed to UL498, file no. E15058 UL verified to Fed Spec WC-596G CSA certified to C22.2, no. 42, file no. 6914 (6233-01) NOM certified |
| Environmental specifications | Flammability: Meets UL94 requirements; V2 rated Temperature rating: -20°C to 70°C (-4°F to 158°F) | Flammability: Meets UL94 requirements; V2 rated Temperature rating: -20°C to 70°C (-4°F to 158°F) | Flammability: Meets UL94 requirements; V2 rated Temperature rating: -20°C to 60°C (-4°F to 140°F) |
| Electrical specifications | Dielectric voltage: Withstands 2000V per UL498 Current interrupting: Yes, at full-rated current Temperature rise: Max. 30°C (86°F) after 250 cycles of overload @ 200% of rated current (DC) | Dielectric voltage: Withstands 2000V per UL498 Current interrupting: Yes, at full-rated current Temperature rise: Max. 30°C (86°F) after 250 cycles of overload @ 200% of rated current (DC) | Dielectric voltage: Withstands 2000V per UL498 Current interrupting: Yes, at full-rated current Temperature rise: Max. 30°C (86°F) after 250 cycles of overload @ 200% of rated current (DC) |
| Mechanical specifications | Terminal accommodation: #14 - #10 AWG Voltage ratings: Permanently marked on device | Terminal accommodation: #14 - #10 AWG Voltage ratings: Permanently marked on device | Terminal accommodation: #14 - #10 AWG Voltage ratings: Permanently marked on device |
| Materials | Top housing: Nylon Bottom housing: Glass-filled nylon Strap: 0.05" thick brass Auto ground clip: Brass Line contacts: 0.031" thick 5-leaf brass Ground contact: Integral Terminal screws: #8-32 brass, neutral screw nickel plated Ground screw: #8-32 brass, green Screw terminal guards: PVC hinged doors | Top housing: Nylon Bottom housing: Glass-filled nylon Strap: 0.05" thick galvanized steel, 1-piece ground shunt Auto ground clip: Brass Line contacts: 0.031" thick 5-leaf brass Ground contact: 1-piece brass ground shunt Terminal screws: #8-32 brass, neutral screw nickel plated Ground screw: #8-32 brass, green Screw terminal guards: PVC hinged doors | Top housing: Nylon Bottom housing: Nylon Strap: 0.05" thick steel, zinc plated Auto ground clip: Phosphor bronze Line contacts: 0.037" thick triple wipe brass Ground contact: Riveted Terminal screws: #8-32 steel, brass plated, neutral screw nickel plated Ground screw: #8-32 steel, green Screw terminal guards: N/A |

Industrial grade receptacles

Product description

2-pole, 3-wire grounding
 15A, 125V/AC; 20A, 125V/AC; 15A, 250V/AC
 20A 250V/AC; 15A, 277V/AC
 NEMA 5-15, 5-20, 6-15, 6-20, 7-15

| Device type | Industrial grade premium isolated ground duplex receptacles: AHIG5262, AHIG5362, AHIG5462, AHIG5662 series | Industrial grade premium isolated ground single receptacles: IG5261, IG5361, IG5461, IG5661 series | Industrial grade duplex receptacles: AH5252, AH5352, 5302 | Industrial grade duplex & decorator duplex receptacles: 6342 |
|--------------------------------------|--|---|---|---|
| Wiring type | Back & side wire | Back & side wire | Back & side wire | Side wire only |
| Testing & code compliance | <ul style="list-style-type: none"> Listed to UL498, file no. E15058 UL verified to Fed Spec WC-596G CSA certified to C22.2, no. 42, file no. 6914 (6233-01) NOM certified | <ul style="list-style-type: none"> Listed to UL498, file no. E2369 CSA certified to C22.2, no. 42, file no. 6914 (6233-01) NOM certified | <ul style="list-style-type: none"> Listed to UL498, file no. E15058 UL verified to Fed Spec WC-596G CSA certified to C22.2, no. 42, file no. 6914 (6233-01) NOM certified | <ul style="list-style-type: none"> Listed to UL498, file no. E15058 UL verified to Fed Spec WC-596G CSA certified to C22.2, no. 42, file no. 6914 (6233-01) NOM certified |
| Environmental specifications | <p>Flammability: Meets UL94 requirements; V2 rated</p> <p>Temperature rating: -20°C to 70°C (-4°F to 158°F)</p> | <p>Flammability: Meets UL94 requirements; V2 rated</p> <p>Temperature rating: -20°C to 70°C (-4°F to 158°F)</p> | <p>Flammability: Meets UL94 requirements; V2 rated</p> <p>Temperature rating: -20°C to 70°C (-4°F to 158°F)</p> | <p>Flammability: Meets UL94 requirements; V2 rated</p> <p>Temperature rating: -20°C to 70°C (-4°F to 158°F)</p> |
| Electrical specifications | <p>Dielectric voltage: Withstands 2000V per UL498</p> <p>Current interrupting: Yes, at full-rated current</p> <p>Temperature rise: Max. 30°C (86°F) after 250 cycles of overload @ 200% of rated current (DC)</p> | <p>Dielectric voltage: Withstands 2000V per UL498</p> <p>Current interrupting: Yes, at full-rated current</p> <p>Temperature rise: Max. 30°C (86°F) after 250 cycles of overload @ 200% of rated current (DC)</p> | <p>Dielectric voltage: Withstands 2000V per UL498</p> <p>Current interrupting: Yes, at full-rated current</p> <p>Temperature rise: Max. 30°C (86°F) after 250 cycles of overload @ 200% of rated current (DC)</p> | <p>Dielectric voltage: Withstands 2000V per UL498</p> <p>Current interrupting: Yes, at full-rated current</p> <p>Temperature rise: Max. 30°C (86°F) after 250 cycles of overload @ 200% of rated current (DC)</p> |
| Mechanical specifications | <p>Terminal accommodation: #14 - #10 AWG</p> <p>Voltage ratings: Permanently marked on device</p> | <p>Terminal accommodation: #14 - #10 AWG</p> <p>Voltage ratings: Permanently marked on device</p> | <p>Terminal accommodation: #14 - #10 AWG</p> <p>Voltage ratings: Permanently marked on device</p> | <p>Terminal accommodation: #14 - #10 AWG</p> <p>Voltage ratings: Permanently marked on device</p> |
| Materials | <p>Top housing: Nylon</p> <p>Bottom housing: Glass-filled nylon</p> <p>Strap: 0.05" thick steel, 1-piece ground shunt</p> <p>Auto ground clip: Brass</p> <p>Line contacts: 0.031" thick 5-leaf brass</p> <p>Ground contact: 1-piece isolated ground shunt</p> <p>Terminal screws: #8-32 brass, neutral screw nickel plated</p> <p>Ground screw: #8-32 brass, green</p> <p>Screw terminal guards: PVC hinged doors</p> | <p>Top housing: Nylon</p> <p>Bottom housing: Nylon</p> <p>Strap: 0.05" thick steel</p> <p>Auto ground clip: Phosphor bronze</p> <p>Line contacts: Triple wipe brass</p> <p>Ground contact: 1-piece isolated ground shunt</p> <p>Terminal screws: #8-32 brass, neutral screw nickel plated</p> <p>Screw terminal guards: N/A</p> | <p>Top housing: Nylon</p> <p>Bottom housing: Nylon</p> <p>Strap: 0.05" thick galvanized steel, 1-piece ground shunt</p> <p>Auto ground clip: Brass</p> <p>Line contacts: 0.031" thick 5-leaf brass</p> <p>Ground contact: 1-piece ground shunt</p> <p>Terminal screws: #8-32 brass, neutral screw nickel plated</p> <p>Screw terminal guards: N/A</p> | <p>Top housing: Nylon</p> <p>Bottom housing: PVC</p> <p>Strap: 0.05" thick galvanized steel</p> <p>Auto ground clip: Brass</p> <p>Line contacts: Triple wipe brass</p> <p>Ground contact: Riveted</p> <p>Terminal screws: #8-32 steel, brass plated, neutral screw nickel plated</p> <p>Screw terminal guards: PVC hinged doors</p> |

Industrial & construction grade receptacles specification & performance data

Industrial & construction grade receptacles

Product description

2-pole, 3-wire grounding
15A, 125V/AC; 15A, 250V/AC;
20A, 125V/AC; 20A, 250V/AC
NEMA 5-15, 6-15, 5-20, 6-20

| Device type | Industrial grade single receptacles: 834 | Industrial grade panel mount receptacles: 5284, AH5684 | Construction grade duplex receptacles: 5262, 5362 | Construction grade duplex receptacles: 5462C, 5662C | Construction grade isolated ground duplex receptacles: IG5262, IG5362 |
|--------------------------------------|---|---|---|---|---|
| Wiring type | Side wire only | Back & side wire | Back & side wire | Back & side wire | Back & side wire |
| Testing & code compliance | <ul style="list-style-type: none"> Listed to UL498, file no. E21369 UL verified to Fed Spec WC-596G CSA certified to C22.2, no. 42, file no. 6914 (6233-01) NOM certified | <ul style="list-style-type: none"> Listed to UL498, file no. E21369 UL verified to Fed Spec WC-596G CSA certified to C22.2, no. 42, file no. 7087, except for 5484 and 5284 | <ul style="list-style-type: none"> Listed to UL498, file no. E15058 UL verified to Fed Spec WC-596G CSA certified to C22.2, no. 42, file no. 6914 (6233-01) NOM certified | <ul style="list-style-type: none"> Listed to UL498, file no. E15058 UL verified to Fed Spec WC-596G CSA certified to C22.2, no. 42, file no. 6914 (6233-01) NOM certified except 5662C | <ul style="list-style-type: none"> Listed to UL498, file no. E15058 UL verified to Fed Spec WC-596G CSA certified to C22.2, no. 42, file no. 6914 (6233-01) NOM certified |
| Environmental specifications | <p>Flammability: Meets UL94 requirements; V2 rated</p> <p>Temperature rating: -20°C to 70°C (-4°F to 158°F)</p> | <p>Flammability: Meets UL94 requirements; V2 rated</p> <p>Temperature rating: -20°C to 70°C (-4°F to 158°F)</p> | <p>Flammability: Meets UL94 requirements; V2 rated</p> <p>Temperature rating: -20°C to 70°C (-4°F to 158°F)</p> | <p>Flammability: Meets UL94 requirements; V2 rated</p> <p>Temperature rating: -20°C to 70°C (-4°F to 158°F)</p> | <p>Flammability: Meets UL94 requirements; V2 rated</p> <p>Temperature rating: -20°C to 70°C (-4°F to 158°F)</p> |
| Electrical specifications | <p>Dielectric voltage: Withstands 2000V per UL498</p> <p>Current interrupting: Yes, at full-rated current</p> <p>Temperature rise: Max. 30°C (86°F) after 250 cycles of overload @ 200% of rated current (DC)</p> | <p>Dielectric voltage: Withstands 2000V per UL498</p> <p>Current interrupting: Yes, at full-rated current</p> <p>Temperature rise: Max. 30°C (86°F) after 250 cycles of overload @ 200% of rated current (DC)</p> | <p>Dielectric voltage: Withstands 2000V per UL498</p> <p>Current interrupting: Yes, at full-rated current</p> <p>Temperature rise: Max. 30°C (86°F) after 250 cycles of overload @ 200% of rated current (DC)</p> | <p>Dielectric voltage: Withstands 2000V per UL498</p> <p>Current interrupting: Yes, at full-rated current</p> <p>Temperature rise: Max. 30°C (86°F) after 250 cycles of overload @ 200% of rated current (DC)</p> | <p>Dielectric voltage: Withstands 2000V per UL498</p> <p>Current interrupting: Yes, at full-rated current</p> <p>Temperature rise: Max. 30°C (86°F) after 250 cycles of overload @ 200% of rated current (DC)</p> |
| Mechanical specifications | <p>Terminal accommodation: #14 - #10 AWG</p> <p>Voltage ratings: Permanently marked on device</p> | <p>Terminal accommodation: #14 - #10 AWG</p> <p>Voltage ratings: Permanently marked on device</p> | <p>Terminal accommodation: #14 - #10 AWG</p> <p>Voltage ratings: Permanently marked on device</p> | <p>Terminal accommodation: #14 - #10 AWG</p> <p>Voltage ratings: Permanently marked on device</p> | <p>Terminal accommodation: #14 - #10 AWG</p> <p>Voltage ratings: Permanently marked on device</p> |
| Materials | <p>Top housing: Nylon</p> <p>Bottom housing: Nylon</p> <p>Strap: 0.05" thick galvanized steel</p> <p>Auto ground clip: Phosphor bronze</p> <p>Line contacts: 0.037" thick triple wipe brass</p> <p>Ground contact: Riveted</p> <p>Terminal screws: #8-32 steel, brass plated, neutral screw nickel plated</p> <p>Ground screw: #8-32 steel, green</p> | <p>Top housing: Nylon</p> <p>Bottom housing: Nylon</p> <p>Strap: 0.05" thick nickel plated steel</p> <p>Auto ground clip: N/A</p> <p>Line contacts: 0.031" thick 5-leaf Brass</p> <p>Ground contact: Riveted</p> <p>Terminal screws: #8-32 brass, neutral screw nickel plated</p> <p>Ground screw: #8-32 brass, green</p> | <p>Top housing: Nylon</p> <p>Bottom housing: PVC</p> <p>Strap: 0.05" thick galvanized steel</p> <p>Auto ground clip: Phosphor bronze</p> <p>Line contacts: 0.030" thick triple wipe brass</p> <p>Ground contact: Riveted</p> <p>Terminal screws: #8-32 steel, brass plated, neutral screw nickel plated</p> <p>Ground screw: #8-32 brass, green</p> | <p>Top housing: Nylon</p> <p>Bottom housing: PVC</p> <p>Strap: 0.05" thick galvanized steel</p> <p>Auto ground clip: Phosphor bronze</p> <p>Line contacts: 0.030" thick triple wipe brass</p> <p>Ground contact: Riveted</p> <p>Terminal screws: #8-32 steel, brass plated, neutral screw nickel plated</p> <p>Ground screw: #8-32 steel, green</p> | <p>Top housing: Nylon</p> <p>Bottom housing: Nylon</p> <p>Strap: 0.05" thick steel, 1-piece ground shunt</p> <p>Auto ground clip: Brass</p> <p>Line contacts: 0.03" thick brass</p> <p>Ground contact: 1-piece isolated ground shunt</p> <p>Terminal screws: #8-32 steel, brass plated</p> <p>Ground screw: #8-32 steel, zinc plated, green</p> |

Compliances, specifications and availability are subject to change without notice.





 All products on this page are RoHS compliant - Page Q-32

Construction and commercial grade receptacles specification & performance data

Construction & commercial grade receptacles

Product description

2-pole, 3-wire grounding
 15A, 125V/AC;
 20A, 125V/AC
 NEMA 5-15, 5-20

| Device type | Construction grade tamper resistant duplex & decorator duplex: TR5200, TR5300, TR6200, TR6300  | Commercial grade tamper resistant duplex: TRBR series TRCR series  | Commercial grade tamper resistant single receptacles: TR1877, TR817 series  | Commercial grade tamper & weather resistant duplex receptacles: TWRBR series  | Commercial grade weather resistant duplex receptacles: WRBR series  |
|--------------------------------------|--|---|---|---|---|
| Wiring type | Back & side wire | Back & side wire (TRBR) Side wire (TRCR) | Side wire only | Back & side wire | Back & side wire |
| Testing & code compliance | <ul style="list-style-type: none"> cULus Listed to UL498, file no. E15058 UL verified to Fed Spec WC-596/12-1 NOM/ANSI certified | <ul style="list-style-type: none"> cULus Listed to UL498, file no. E15058 UL verified to Fed Spec WC-596G (TRBR) NOM Listed | <ul style="list-style-type: none"> cULus Listed to UL498, file no. E15058 NOM/ANSI certified | <ul style="list-style-type: none"> cULus Listed to UL498, file no. E15058 UL verified to Fed Spec WC-596 NOM/ANSI certified | <ul style="list-style-type: none"> cULus Listed to UL498, file no. E15058 UL verified to Fed Spec WC-596G NOM/ANSI certified |
| Environmental specifications | Flammability: Meets UL94 requirements; V2 rated Temperature rating: -20°C to 70°C (-4°F to 158°F) | Flammability: Meets UL94 requirements; V2 rated Temperature rating: -20°C to 60°C (-4°F to 140°F) | Flammability: Meets UL94 requirements; V2 rated Temperature rating: -20°C to 70°C (-4°F to 158°F) | Flammability: Meets UL94 requirements; V2 rated Temperature rating: -20°C to 70°C (-4°F to 158°F) | Flammability: Meets UL94 requirements; V2 rated Temperature rating: -20°C to 70°C (-4°F to 158°F) |
| Electrical specifications | Dielectric voltage: Withstands 2000V per UL498 Current interrupting: Yes, at full-rated current Temperature rise: Max. 30°C (86°F) after 250 cycles of overload @ 200% of rated current (DC) | Dielectric voltage: Withstands 2000V per UL498 Current interrupting: Yes, at full-rated current Temperature rise: Max. 30°C (86°F) after 250 cycles of overload @ 200% of rated current (DC) | Dielectric voltage: Withstands 2000V per UL498 Current interrupting: Yes, at full-rated current Temperature rise: Max. 30°C (86°F) after 100 cycles of overload @ 150% of rated current (DC) | Dielectric voltage: Withstands 2000V per UL498 Current interrupting: Yes, at full-rated current Temperature rise: Max. 30°C (86°F) after 250 cycles of overload @ 200% of rated current (DC) | Dielectric voltage: Withstands 2000V per UL498 Current interrupting: Yes, at full-rated current Temperature rise: Max. 30°C (86°F) after 250 cycles of overload @ 200% of rated current (DC) |
| Mechanical specifications | Terminal accommodation: #14 - #10 AWG Voltage ratings: Permanently marked on device | Terminal accommodation: #14 - #10 AWG Voltage ratings: Permanently marked on device | Terminal accommodation: #14 - #10 AWG Voltage ratings: Permanently marked on device | Terminal accommodation: #14 - #10 AWG Voltage ratings: Permanently marked on device | Terminal accommodation: #14 - #10 AWG Voltage ratings: Permanently marked on device |
| Materials | Top housing: PVC Bottom housing: PVC Strap: 0.050" thick galvanized steel Auto ground clip: Phosphor bronze Line contacts: 0.037" thick triple wipe brass Ground contact: Riveted Terminal screws: Terminal: #8-32 brass, neutral screw nickel plated Ground screw: Ground: #8-32 brass, green Tamper resistant shutters: Reliable Delrin® shutter assembly | Top housing: PVC Bottom housing: PVC Strap: 0.040" thick galvanized steel Auto ground clip: Phosphor bronze Line contacts: 0.031" thick brass Ground contact: 0.031" thick, secured to strap via staking Terminal screws: Terminal: #8-32 brass, neutral screw nickel plated Ground screw: Ground: #8-32 brass, green Tamper resistant shutters: Reliable Delrin® shutter assembly | Top housing: PVC Bottom housing: PVC Strap: 0.040" thick galvanized steel Auto ground clip: Brass Line contacts: 0.03" thick triple wipe brass Ground contact: Riveted Terminal screws: Terminal: #8-32 brass, neutral screw nickel plated Ground screw: Ground: #8-32 brass, green Tamper resistant shutters: Reliable Delrin® shutter assembly | Top housing: Nylon Bottom housing: Nylon Strap: 0.050" thick steel, nickel plated Auto ground clip: Phosphor bronze Line contacts: 0.03" thick triple wipe brass Ground contact: Riveted Terminal screws: Terminal: #8-32 brass, neutral screw nickel plated Ground screw: Ground: #8-32 brass, green Tamper resistant shutters: Reliable Delrin® shutter assembly | Top housing: Nylon Bottom housing: PVC Strap: 0.050" thick steel, nickel plated Auto ground clip: Phosphor bronze Line contacts: 0.03" thick triple wipe brass Ground contact: Riveted Terminal screws: Terminal: #8-32 brass, neutral screw nickel plated Ground screw: Ground: #8-32 brass, green Tamper resistant shutters: N/A |

Commercial grade receptacles specification & performance data

Commercial grade receptacles

Product description

2-pole, 3-wire grounding
15A, 125V/AC;
20A, 125V/AC
NEMA 5-15, 5-20

| Device type | Commercial grade duplex and decorator duplex receptacles: BR, 6200, 6300, 6400 series | Commercial grade duplex receptacles CR series | Commercial grade receptacles: 800, 1800 series | Snap-in receptacles: 49, 67, 4049, 4067, 4070 series |
|--------------------------------------|---|--|---|--|
| Wiring type | Back & side wire | Side wire only | Side wire only | Wire leads & quick connect |
| Testing & code compliance | <ul style="list-style-type: none"> cULus Listed to UL498, file no. E15058 BR series only: UL verified to Fed Spec. WC-596G CSA certified to 22.2, no 42, file no. 6914 (6233-01) NOM/ANSI certified | <ul style="list-style-type: none"> cULus Listed to UL498 file no. E15058 UL verified to Fed Spec WC-596G NOM certified | <ul style="list-style-type: none"> Listed to UL498, file no. E15058 CSA certified to 22.2, no 42, file no. 6914 (6233-01) NOM/ANSI certified | <ul style="list-style-type: none"> UR (UL Recognized) CSA certified to C22.2, no. 42, file no. 6914 (6233-01) NOM certified |
| Environmental specifications | <p>Flammability: Meets UL94 requirements; V2 rated</p> <p>Temperature rating: -20°C to 70°C (-4°F to 158°F)</p> | <p>Flammability: Meets UL94 requirements; V2 rated</p> <p>Temperature rating: -20°C to 60°C (-4°F to 140°F)</p> | <p>Flammability: Meets UL94 requirements; V2 rated</p> <p>Temperature rating: -20°C to 70°C (-4°F to 158°F)</p> | <p>Flammability: Meets UL94 requirements; V2 rated</p> <p>Temperature rating: -20°C to 70°C (-4°F to 158°F)</p> |
| Electrical specifications | <p>Dielectric voltage: Withstands 2000V per UL498</p> <p>Current interrupting: Yes, at full-rated current</p> <p>Temperature rise: Max. 30°C (86°F) after 250 cycles of overload @ 200% of rated current (DC)</p> | <p>Dielectric voltage: Withstands 2000V per UL498</p> <p>Current interrupting: Yes, at full-rated current</p> <p>Temperature rise: Max. 30°C (86°F) after 250 cycles of overload @ 200% of rated current (DC)</p> | <p>Dielectric voltage: Withstands 2000V per UL498</p> <p>Current interrupting: Yes, at full-rated current</p> <p>Temperature rise: Max. 30°C (86°F) after 100 cycles of overload @ 150% of rated current (DC)</p> | <p>Dielectric voltage: Withstands 2000V per UL498</p> <p>Current interrupting: Yes, at full-rated current</p> <p>Temperature rise: Max. 30°C (86°F) after 100 cycles of overload @ 150% of rated current (DC)</p> |
| Mechanical specifications | <p>Terminal accommodation: #14 - #10 AWG</p> <p>Voltage ratings: Permanently marked on device</p> | <p>Terminal accommodation: #14 - #10 AWG</p> <p>Voltage ratings: Permanently marked on device</p> | <p>Terminal accommodation: #14 - #10 AWG</p> <p>Voltage ratings: Permanently marked on device</p> | <p>Terminal accommodation: #14 - #12 AWG</p> <p>Voltage ratings: Permanently marked on device</p> |
| Materials | <p>Top housing: Nylon</p> <p>Bottom housing: PVC</p> <p>Strap: 0.045" thick galvanized steel</p> <p>Auto ground clip: Phosphor bronze</p> <p>Line contacts: 0.03" thick brass</p> <p>Ground contact: Riveted</p> <p>Terminal screws: #8-32 steel, brass plated, neutral screw nickel plated</p> <p>Ground screw: #8-32 steel, green</p> | <p>Top housing: PVC</p> <p>Bottom housing: PVC</p> <p>Strap: 0.040" thick galvanized steel</p> <p>Auto ground clip: Phosphor bronze</p> <p>Line contacts: 0.03" thick brass</p> <p>Ground contact: Riveted</p> <p>Terminal screws: #8-32 brass plated, neutral screw nickel plated</p> <p>Ground screw: #8-32 steel, green</p> | <p>Top housing: Nylon</p> <p>Bottom housing: Nylon</p> <p>Strap: 0.045" thick galvanized steel</p> <p>Auto ground clip: Brass</p> <p>Line contacts: 0.03" thick brass</p> <p>Ground contact: Riveted</p> <p>Terminal screws: #8-32 steel, brass plated, neutral screw nickel plated</p> <p>Ground screw: #8-32 steel, green</p> | <p>Top housing: Urea</p> <p>Bottom housing: Polypropylene</p> <p>Strap: 0.030" thick steel</p> <p>Auto ground clip: N/A</p> <p>Line contacts: 0.032" thick brass</p> <p>Ground contact: Screw down</p> <p>Terminal screws: N/A</p> <p>Ground screw: #6-32 brass, green</p> |

Commercial grade receptacles specification & performance data

Commercial grade receptacles

Product description

2-pole, 3-wire grounding
 15A, 125V/AC;
 20A, 125V/AC
 NEMA 5-15, 5-20

| Device Type | Commercial grade USB duplex receptacle:  TR7755, TR7756 | Commercial grade USB charging station: 7750 |
|--------------------------------------|---|--|
| Wiring Type | Wire Leads | Wire leads |
| Testing & code compliance | • cULus Listed to UL498 and UL1310, File no. E15058 | • UL Listed to UL 1310, File no. E362460 |
| Environmental specifications | Flammability: Meets UL94 requirements; 5V rated Temperature rating: -20°C to 60°C (-4°F to 140°F) | Flammability: Meets UL94 requirements; 5V rated Temperature rating: -20°C to 60°C (-4°F to 140°F) |
| Electrical specifications | | |
| AC output | Dielectric voltage: Receptacle withstands 2000V per UL498 Current interrupting: Yes, at full-rated current Temperature rise: Receptacle - Max. 30°C (86°F) after 100 cycles of overload @ 150% of rated current (DC) | Dielectric voltage: N/A Current interrupting: N/A Temperature rise: N/A |
| DC output | Switching frequency: Typical 140 kHz Output voltage: Nominal 5V (+/- 10%) Protection: Current limiting Output current: Constant current maximum 2.1A | Switching frequency: Typical 1.8 kHz to > 25 kHz, load dependent Output voltage: Nominal 5V (+/- 5%) Protection: Current limiting Output current: Constant current maximum 2.5A per dual port |
| AC input | Input current: 120V/AC, 60Hz, 0.25A max | Input current: 120V/AC, 60Hz, 0.45A max |
| Mechanical specifications | Terminations: Device can be wired using #14 or #12 AWG wires, three 6" pre-stripped #14 AWG wire leads for line, neutral and #12 AWG ground Voltage ratings: Permanently marked on device | Terminations: Device can be wired using #14 or #12 AWG wires, three 6" pre-stripped #14 AWG wire leads for line, neutral and #12 AWG ground Voltage ratings: Permanently marked on device |
| Materials | Top housing: PC Bottom housing: PC Strap: 0.045" thick galvanized steel, zinc plated Auto ground clip: Phosphor bronze Line contacts: 0.03" thick brass Ground contact: Riveted Terminal screws: N/A Ground screw: N/A | Top housing: PC Bottom housing: PC Strap: 0.045" thick steel, zinc plated Auto ground clip: Phosphor bronze Line contacts: N/A Ground contact: N/A Terminal screws: N/A Ground screw: N/A |

Corrosion resistant & watertight devices specification & performance data

Industrial grade corrosion resistant & watertight receptacles

Product description

2-pole, 3-wire grounding
15A, 125V/AC; 15A, 250V/AC;
20A, 125V/AC; 20A, 250V/AC
NEMA 5-15, 6-15, 5-20, 6-20

| Device type | Corrosion resistant receptacles, straight blade: AH5262CR, AH5362CR | Watertight receptacles, straight blade: 60W47, 60W49, 60W33, 60W48 |
|--------------------------------------|--|--|
| Wiring type | Back & side wire | Back wire only |
| Testing & code compliance | <ul style="list-style-type: none"> Listed to UL498, file no. E15058 UL verified to Fed Spec WC-596G CSA certified to C22.2, no. 42, file no. 6914 (6233-01) NOM certified | <ul style="list-style-type: none"> Listed to UL498, file no. E2369 cUL Listed to CAN/CSA C22.2 no. 42-99 |
| Environmental specifications | <p>Flammability: Meets UL94 requirements; V2 rated Temperature rating: -20°C to 70°C (-4°F to 158°F) Protection: N/A High pressure water test: N/A</p> | <p>Flammability: Meets UL94 requirements; V2 rated Temperature rating: -40°C to 75°C (-40°F to 167°F) Protection: NEMA Type 3, 3R, 4, 4X, 12 & IP66 High pressure water test: 1000 psi spray (mated or closed)</p> |
| Electrical specifications | <p>Dielectric voltage: Withstands 2000V per UL498 Current interrupting: Yes, at full-rated current Temperature rise: Max. 30°C (86°F) after 100 cycles of overload</p> | <p>Dielectric voltage: Withstands 1554V per UL498 Current interrupting: Yes, at full-rated current Temperature rise: Max. 30°C (86°F) after 250 cycles of overload</p> |
| Mechanical specifications | <p>Terminal accommodation: #14 - #10 AWG Voltage ratings: Permanently marked on device</p> | <p>Terminal accommodation: #18 - #10 AWG Voltage ratings: Permanently marked on device</p> |
| Materials | <p>CR receptacle face: Nylon CR receptacle base: Glass-filled nylon WT receptacle flip lid cover & base: N/A WT receptacle cover spring: N/A WT receptacle lid liner & mounting gasket: N/A</p> <p>WT receptacle, interior body: N/A WT receptacle, terminal retainer: N/A Strap: 0.050" thick brass, nickel plated Auto ground clip: Brass, nickel plated Line contacts: .031" thick brass, nickel plated; 5-leaf Ground contact: Integral Terminal clamps: Steel, nickel plated Terminal screws: #8-32 brass, neutral screw nickel plated Ground screw: #8-32 steel, zinc plated, green Assembly/mounting screws: Steel Screw terminal guards: PVC hinged doors Receptacle mounting plate: N/A</p> | <p>CR receptacle face: N/A CR receptacle base: N/A WT receptacle flip lid cover & base: Glass-filled nylon WT receptacle cover spring: Stainless steel, self-closing WT receptacle lid liner & mounting gasket: Santoprene thermoplastic elastomeric WT receptacle, interior body: Glass-filled nylon WT receptacle, terminal retainer: Clear lexan Strap: N/A Auto ground clip: N/A Line contacts: .031" thick triple wipe brass, nickel plated Ground contact: Riveted Terminal clamps: Steel, nickel plated Terminal screws: #8-32 brass, neutral screw nickel plated Ground screw: #8-32 brass, green Assembly/mounting screws: Stainless steel Screw terminal guards: N/A Receptacle mounting plate: Stainless steel</p> |

Compliances, specifications and availability are subject to change without notice.

 All products on this page are RoHS compliant - Page Q-32

ArrowLink modular receptacles specification & performance data

Arrowlink plugs & connectors

Product description

2-pole, 3-wire grounding
 15A, 125V/AC; 15A, 250V/AC;
 20A, 125V/AC; 20A 250V/AC
 NEMA 5-15, 6-15, 5-20, 6-20

| Device type | ArrowLink plugs & connectors: MCR125 series, MCR250 series, MCR300 series |
|--------------------------------------|--|
| Wiring type | Integral wire leads, crimped & resistance welded |
| Testing & code compliance | • Plug & connector cULus Listed to UL2459 file no. E325188 |
| Environmental specifications | Flammability: Meets UL94 requirements; V2 rated Temperature rating: -20°C to 70°C (-4°F to 158°F) |
| Electrical specifications | Maximum working voltage 300V / AC Overload: 52.5A / AC for 10 cycles Temperature rise: Max. 50°C (122°F) while conducting 35A after 10 cycles of overload @ 52.5A / AC Dielectric voltage: Withstands 1600V per UL2459 Maximum continuous current: 20A Current interrupting: Limited cycles at full-rated current |
| Mechanical specifications | Wire Leads: #12 AWG Voltage ratings: Permanently marked on device |
| Materials | Polycarbonate Copper alloy Solid or stranded THHN #12 AWG |

