



Nothing but **HEAVY DUTY.**

ACCESSORIES

Milwaukee® offers a broad line of heavy duty cutting, drilling, fastening and material removing accessories to meet the needs of professional contractors.



SAWZALL® BLADE SELECTION GUIDE

- 1 Identify the material to be cut in the columns below
 - 2 Follow the column down to find **BEST PERFORMANCE** or **ACCEPTABLE PERFORMANCE**
 - 3 Follow the row to the left to identify the appropriate teeth per inch (TPI) or specialty blade
- Note: Fewer TPI cut faster but rougher, while more TPI cut smoother but slower

		WOOD WITH NAILS	PVC & PLASTICS	ALUMINUM & OTHER NON-FERROUS METALS	THICK METAL (1/4" - 3/8")	MEDIUM METAL (3/16" - 1/4")	THIN METAL (1/8" - 3/16")	SHEET METAL (UP TO 1/8")	CLEAN WOOD	TIMBER & GREEN WOOD	PLASTER/ DRYWALL	TILE	FIBERGLASS	BRICK	CAST IRON
WOOD CUTTING PG. 35	4/6 TPI	FASTER/ ROUGHER													
	5/8 TPI														
	6 TPI														
GENERAL PURPOSE PG. 35	8 TPI		FASTER/ ROUGHER	FASTER/ ROUGHER	FASTER/ ROUGHER										
	8/12 TPI	SLOWER/ SMOOTHER													
	10/14 TPI														
METAL CUTTING PG. 36	10 TPI		SLOWER/ SMOOTHER	SLOWER/ SMOOTHER											
	14 TPI				SLOWER/ SMOOTHER		FASTER/ ROUGHER								
	18 TPI					SLOWER/ SMOOTHER		FASTER/ ROUGHER							
	24 TPI						SLOWER/ SMOOTHER	SLOWER/ SMOOTHER							
SPECIALTY PG. 37	PRUNING														
	CLEAN WOOD														
	PLASTER														
	CARBIDE GRIT														
	DIAMOND GRIT														

- 4 Choose the Blade Length (Width of Material + 3" = Minimum Blade Length)

EXAMPLE

2x4

Schedule 40 PVC Pipe

Angle Iron



Width

Width

Width

CUTTING ACCESSORIES

5 Choose the Blade Profile

A) DEMOLITION BLADES:

MAXIMUM DURABILITY

- A thicker, more rigid blade body resists fracturing and bending

STRAIGHTER CUTS

- The 1" tall blade body reduces blade twisting for straighter, more accurate cuts



B) STANDARD BLADES:

- Traditional blade thickness and profile



C) SCROLL CUTTING BLADES:

- Low profile for tight contour cutting



WOOD CUTTING SAWZALL® BLADES

Optimized for best cutting performance in nail-embedded dimensional lumber, OSB, plywood and other engineered lumbers.



FAST CUTTING

- Precision forming process creates sharper teeth



EASY PLUNGING

- Full raker tooth on blade tip

Description	TPI	Length	Height	Width	5 Pack	25 Pack	50 Pack	Bulk Pack	Qty	Application
	6	6"	3/4"	0.050"	48-00-5035	-	48-01-6035	48-01-7035	100	
THE AX™	5/8	6"	1"	0.062"	48-00-5021	48-00-8021	-	48-01-7021	100	
	6	9"	3/4"	0.050"	48-00-5036	48-00-8036	48-01-6036	48-01-7036	100	
THE AX™	5/8	9"	1"	0.062"	48-00-5026	48-00-8026	-	48-01-7026	100	
	6	12"	3/4"	0.050"	48-00-5037	-	48-01-6037	48-01-7037	100	
THE AX™	5/8	12"	1"	0.062"	48-00-5027	48-00-8027	-	48-01-7027	100	

See the specialty SAWZALL® blade section for additional wood cutting options, including 4/6 TPI scrolling blades

GENERAL PURPOSE SAWZALL® BLADES

Designed for versatile cutting performance across the broadest selection of materials including nail-embedded wood, plastics, ferrous and non-ferrous metals.



LONG LIFE

- Double relief angle reduces tooth stress



FAST CUTTING

- Precision forming process creates sharper teeth

Description	TPI	Length	Height	Width	5 Pack	25 Pack	50 Pack	Bulk Pack	Qty	Application
	8/12	6"	3/4"	0.050"	48-00-5091	-	48-01-6091	48-01-7091	100	
	8/12	6"	3/4"	0.050"	48-00-4091	-	-	48-01-9091	50	
THE WRECKER™	8	6"	1"	0.062"	48-00-5701	48-00-8701	-	48-01-7701	100	
	8/12	8"	3/4"	0.050"	48-00-5093	48-00-8093	48-01-6093	48-01-7093	100	
	8/12	8"	3/4"	0.050"	48-00-4093	-	-	48-01-9093	50	
THE WRECKER™	8	9"	1"	0.062"	48-00-5706	48-00-8706	-	48-01-7706	100	
	8/12	12"	3/4"	0.050"	48-00-5094	-	48-01-6094	-	-	
THE WRECKER™	8	12"	1"	0.062"	48-00-5711	48-00-8711	-	48-01-7711	100	
	10/14	8"	5/8"	0.035"	48-00-5193	-	-	-	-	1/4" - 3/8"
	10/14	12"	5/8"	0.035"	48-00-5194	-	-	-	-	1/4" - 3/8"

For the Longest Life, Look For:



Up to 50% Longer Life

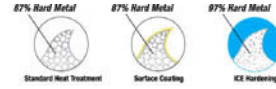

METAL CUTTING SAWZALL® BLADES

Optimized for best cutting performance in pipe, conduit, strut, threaded rod, angle iron, duct and other metal building materials.



LONG LIFE

- Double relief angle reduces tooth stress



FAST CUTTING

- Precision forming process creates sharper teeth

Description	TPI	Length	Height	Width	5 Pack	25 Pack	50 Pack	Bulk Pack	Qty	Application
	10	4"	3/4"	0.035"	48-00-5090	-	-	-	-	1/4" - 3/8"
	10	6"	3/4"	0.035"	48-00-5092	-	48-01-6092	48-01-7092	100	1/4" - 3/8"
THE TORCH™	10	6"	1"	0.042"	48-00-5712	48-00-8712	-	48-01-7712	100	1/4" - 3/8"
THE TORCH™	10	6"	1"	0.042"	48-00-4712	-	-	48-01-9712	50	1/4" - 3/8"
THE TORCH™	10	9"	1"	0.042"	48-00-5713	48-00-8713	-	48-01-7713	100	1/4" - 3/8"
THE TORCH™	10	9"	1"	0.042"	48-00-4713	-	-	48-01-9713	50	1/4" - 3/8"
THE TORCH™	10	12"	1"	0.042"	48-00-5714	-	-	-	-	1/4" - 3/8"
	14	4"	3/4"	0.035"	48-00-5181	-	-	-	-	3/16" - 1/4"
	14	6"	3/4"	0.035"	48-00-5182	48-00-8182	48-01-6182	48-01-7182	100	3/16" - 1/4"
	14	6"	5/8"	0.035"	48-00-5282	-	48-01-6282	48-01-7282	100	3/16" - 1/4"
	14	6"	3/4"	0.035"	48-00-4182	-	-	48-01-9182	50	3/16" - 1/4"
THE TORCH™	14	6"	1"	0.042"	48-00-5782	48-00-8782	-	48-01-7782	100	3/16" - 1/4"
THE TORCH™	14	6"	1"	0.042"	48-00-4782	-	-	48-01-9782	50	3/16" - 1/4"
	14	9"	3/4"	0.035"	48-00-5187	-	48-01-6187	48-01-7187	100	3/16" - 1/4"
	14	9"	3/4"	0.035"	48-00-4187	-	-	48-01-9187	50	3/16" - 1/4"
THE TORCH™	14	9"	1"	0.042"	48-00-5787	48-00-8787	-	48-01-7787	100	3/16" - 1/4"
THE TORCH™	14	9"	1"	0.042"	48-00-4787	-	-	48-01-9787	50	3/16" - 1/4"
THE TORCH™	14	12"	1"	0.042"	48-00-5794	-	-	-	-	3/16" - 1/4"
	18	4"	3/4"	0.035"	48-00-5183	-	-	-	-	1/8" - 3/16"
	18	6"	3/4"	0.035"	48-00-5184	48-00-8184	48-01-6184	48-01-7184	100	1/8" - 3/16"
	18	6"	5/8"	0.035"	48-00-5284	-	48-01-6284	48-01-7284	100	1/8" - 3/16"
	18	6"	3/4"	0.035"	48-00-4184	-	-	48-01-9184	50	1/8" - 3/16"
THE TORCH™	18	6"	1"	0.042"	48-00-5784	48-00-8784	-	48-01-7784	100	1/8" - 3/16"
THE TORCH™	18	6"	1"	0.042"	48-00-4784	-	-	48-01-9784	50	1/8" - 3/16"
	18	9"	3/4"	0.035"	48-00-5188	-	48-01-6188	48-01-7188	100	1/8" - 3/16"
	18	9"	3/4"	0.035"	48-00-4188	-	-	48-01-9188	50	1/8" - 3/16"
THE TORCH™	18	9"	1"	0.042"	48-00-5788	48-00-8788	-	48-01-7788	100	1/8" - 3/16"
THE TORCH™	18	9"	1"	0.042"	48-00-4788	-	-	48-01-9788	50	1/8" - 3/16"
	18	12"	3/4"	0.035"	48-00-5189	-	48-01-6189	48-01-7189	100	1/8" - 3/16"
	18	12"	3/4"	0.035"	48-00-4189	-	-	-	-	1/8" - 3/16"
THE TORCH™	18	12"	1"	0.042"	48-00-5789	48-00-8789	-	48-01-7789	100	1/8" - 3/16"
	24	4"	3/4"	0.035"	48-00-5185	-	-	-	-	Up to 1/8"
	24	6"	3/4"	0.035"	48-00-5186	48-00-8186	48-01-6186	48-01-7186	100	Up to 1/8"
	24	6"	5/8"	0.035"	48-00-5286	-	-	48-01-7286	100	Up to 1/8"
	24	6"	3/4"	0.035"	48-00-4186	-	-	48-01-9186	50	Up to 1/8"

See the specialty SAWZALL® blade section for additional metal cutting options, including scrolling blades



Nothing but **HEAVY DUTY**.®

SPECIALTY SAWZALL® BLADES

	Description	Special Features	TPI	Length	Height	Width	1 Pack	3 Pack	5 Pack	50 Pack	Bulk Pack	Qty	Application		
	PRUNING	<ul style="list-style-type: none"> Fast cutting Clean cutting Long life 	5	9"	3/4"	0.049"	-	-	48-00-1301	-	-	-			
			5	12"	3/4"	0.049"	-	-	48-00-1303	-	-	-	-		
	CLEAN WOOD	<ul style="list-style-type: none"> 25% faster cutting Clean cutting 	6	6"	3/4"	0.050"	-	-	48-00-5015	-	48-01-7015	100			
			6	9"	3/4"	0.050"	-	-	48-00-5016	-	48-01-7016	100			
			6	12"	3/4"	0.050"	-	-	48-00-5017	-	-	-	-		
	SCROLLING	<ul style="list-style-type: none"> Fast contour cutting Long life 	4/6	6"	1/2"	0.050"	-	-	48-00-5041	-	-	-			
			10	3-5/8"	5/16"	0.035"	-	-	48-00-5161	-	-	-	-	1/4" - 3/8"	
			14	3-5/8"	5/16"	0.035"	-	-	48-00-5162	-	-	-	-	3/16" - 1/4"	
	PLASTER	<ul style="list-style-type: none"> Fast cutting Clean cutting Easy plunging 	6	5"	3/4"	0.050"	-	-	48-00-5052	-	-	-			
			CARBIDE GRIT	<ul style="list-style-type: none"> Fast cutting Long life 	GRIT	6"	3/4"	0.032"	-	48-00-1420	-	48-01-6420	-	-	
					GRIT	9"	3/4"	0.032"	-	48-00-1430	-	48-01-6430	-	-	-
	DIAMOND GRIT THE TORCH™	<ul style="list-style-type: none"> 2X faster cutting 30X life* 	GRIT	6"	1"	0.042"	48-00-1440	-	-	-	-	-	-		
			GRIT	9"	1"	0.042"	48-00-1450	-	-	-	-	-	-	-	

* vs. carbide grit

SAWZALL® BLADE SETS

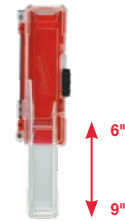

9 Pc Set 49-22-1145	12 Pc Set 49-22-1129	14 Pc Set 49-22-1131	Heavy Duty Case 48-55-0185
<ul style="list-style-type: none"> Up to 21% value vs. purchasing blades separately 	<ul style="list-style-type: none"> Up to 30% value vs. purchasing blades separately 	<ul style="list-style-type: none"> Up to 32% value vs. purchasing blades separately 	<ul style="list-style-type: none"> Innovative patent pending design Jobsite durable Adjusts to hold up to 9" blades
Includes: <ul style="list-style-type: none"> (3) 6" 24 TPI blades (3) 6" 14 TPI blades (2) 6" 6 TPI blades (1) 9" 6 TPI blade Heavy duty case 	Includes: <ul style="list-style-type: none"> (4) 6" 18 TPI The TORCH™ blades (2) 6" 8 TPI The WRECKER™ blades (2) 6" 5/8 TPI The AX™ blades (2) 9" 5/8 TPI The AX™ blades (2) 9" 14 TPI The TORCH™ blades Heavy duty case 	Includes: <ul style="list-style-type: none"> (4) 6" 14 TPI blades (4) 6" 18 TPI blades (2) 9" 10 TPI The TORCH™ blades (2) 9" 14 TPI The TORCH™ blades (2) 9" 18 TPI The TORCH™ blades Roll-up storage pouch 	

CUTTING ACCESSORIES

HACKZALL™ BLADES

Designed to optimize the cutting performance of HACKZALL™ recip saws.

EXTENDED RUN TIME

- Thin kerf design delivers up to 35% more cuts per charge

LONG LIFE

- Wear resistant bi-metal extends tooth life

ACCESSIBILITY

- Shorter blades allow access to tight spaces

Length	Part Number	Pkg Qty	Blade Application
3-1/2"	49-00-5310	5	Wood Scroll
3-1/2"	49-00-5324	5	Metal Scroll
4"	49-00-5400	3	Fiberglass
4"	49-00-5410	5	Multi-Material
4"	49-00-5414	5	PVC
4"	49-00-5418	5	EMT
4"	49-00-5424	5	Duct
4"	49-00-5460	5	Wood
4"	49-00-5461	5	Plaster & Drywall
6"	49-00-5614	5	PVC



10 Pc HACKZALL™ Blade Set 49-22-0220

- Includes:**
- (2) Wood blades
 - (2) Duct blades
 - (3) PVC blades
 - (3) EMT blades
 - Storage pouch

SAWZALL®/HACKZALL™ ACCESSORIES

Compatible with HACKZALL™ and SAWZALL® recip saws.

1-1/2" Scraper Blade 49-00-5463



3" Scraper Blade 49-00-5456



MAXIMUM DURABILITY

- High strength steel resists chipping and breaking

LONG LIFE

- Blade coating resists corrosion
- Resharpenable design

Carbide Grit Grout Removal Tool 49-00-5450



LONG LIFE

- Tungsten carbide grit resists wear

MAXIMUM CONTROL

- Rounded blade edge reduces bouncing

MAXIMUM DURABILITY

- High strength steel resists chipping and breaking

BAND SAW BLADE SELECTION GUIDE

- Identify the work piece thickness in the columns
- Follow the column down to find work piece type:

MOST SOLID MATERIALS or

VERY HARD SOLID MATERIALS (like stainless steel) or

INTERRUPTED CUTTING (like structurals and profiles)

- Follow the row to the left to identify the appropriate teeth per inch (TPI)

Note: Fewer TPI cut faster but rougher, while more TPI cut smoother but slower

		WORK PIECE THICKNESS			
		5/16" - 1/2"	3/16" - 5/16"	5/32" - 3/16"	UP TO 5/32"
BAND SAW BLADES	10 TPI	SOFTEST MATERIAL			
	14 TPI	HARDEST MATERIAL	SOFTEST MATERIAL		
	18 TPI		HARDEST MATERIAL	SOFTEST MATERIAL	
	24 TPI			HARDEST MATERIAL	
	10/14 TPI				
	14/18 TPI				

BI-METAL PORTABLE BAND SAW BLADES

MAXIMUM DURABILITY

- Matrix II high speed steel protects teeth from chipping and breaking

EXTENDED LIFE

- Alloy backing steel resists kinking and snapping

CLEAN CUTS

- Precision formed teeth cut quickly and smoothly

Deep Cut Blades

- Designed to maximize performance of any portable band saw that takes a 44-7/8" blade

Length	TPI	1 Pack	2 Pack	3 Pack	Bulk	Qty
44-7/8"	10	48-39-0500	-	48-39-0501	48-39-0502	100
44-7/8"	14	48-39-0510	48-39-0514	48-39-0511	48-39-0512	100
44-7/8"	18	48-39-0520	48-39-0524	48-39-0521	48-39-0522	100
44-7/8"	24	48-39-0530	48-39-0534	48-39-0531	48-39-0532	100
44-7/8"	10/14	48-39-0550	48-39-0554	48-39-0551	48-39-0552	100
44-7/8"	14/18	48-39-0560	-	48-39-0561	48-39-0562	100

Compact Blades

- Designed to maximize performance of Milwaukee® Compact Band Saws

Length	TPI	1 Pack	3 Pack	Bulk	Qty
35-3/8"	10	48-39-0508	48-39-0509	48-39-0507	100
35-3/8"	14	48-39-0518	48-39-0519	48-39-0517	100
35-3/8"	18	48-39-0528	48-39-0529	48-39-0527	100
35-3/8"	24	48-39-0538	48-39-0539	48-39-0537	100

HACK SAW BLADES

Bi-Metal Blades

- Lasts up to 3X longer than conventional blades

Part Number	Length	TPI	Set	Pkg Qty
48-43-0600	12"	14	Raker	10
48-43-0610	12"	18	Raker	10
48-43-0620	12"	24	Wavy	10
48-43-0630	12"	32	Wavy	10

Carbide Grit Blades

- Cuts cast iron, ceramic tile, fiberglass, slate, brick and marble

Part Number	Length	TPI	Set	Pkg Qty	Description
48-43-0200	12"	Carbide Grit	Med	1	Hack Saw
48-43-0250	12"	Carbide Grit	N/A	1	Rod Saw

DRY CUT METAL CIRCULAR SAW BLADES

LONG LIFE

- Micro ground carbide teeth stay sharper longer

ACCURATE CUTS

- Fully hardened, tensioned steel plate prevents warping

FAST CUTTING

- Extra thin kerf for faster, cleaner cuts



Diameter	Part Number	# of Teeth	Tooth Material	Arbor	Max RPM	Pkg Qty	Materials
6-1/2"	48-40-4005	60	Carbide	5/8"	4,200	1	Non-Ferrous
6-1/2"	48-40-4015	48	Carbide	5/8"	4,200	1	Ferrous
6-7/8"	48-40-4006	52	Carbide	20mm	4,200	1	Non-Ferrous
6-7/8"	48-40-4016	36	Carbide	20mm	4,200	1	Ferrous
8"	48-40-4515	42	Cermet	5/8"	5,000	1	Ferrous
8"	48-40-4520	50	Cermet	5/8"	5,000	1	Ferrous
8"	48-40-4530	60	Carbide	5/8"	5,000	1	Non-Ferrous
8"	48-40-4540	60	Carbide	5/8"	5,000	1	Non-Ferrous
14"	48-40-4505	72	Carbide	1"	1,800	1	Ferrous
14"	48-40-4510	90	Carbide	1"	1,800	1	Ferrous

CONSTRUCTION CIRCULAR SAW BLADES

Diameter	Part Number	# of Teeth	Tooth Material	Arbor	Max RPM	Pkg Qty	Materials
6-1/2"	48-40-4108	24	Carbide	5/8"	7,000	1	Framing
6-1/2"	48-40-4112	40	Carbide	5/8"	7,000	1	Trim
7-1/4"	48-40-4116	16	Carbide	5/8"	7,000	1	Framing
7-1/4"	48-40-4120	24	Carbide	5/8"	7,000	1	Ripping
7-1/4"	48-40-4123	24	Carbide	5/8"	7,000	25	Ripping
7-1/4"	48-40-4126	40	Carbide	5/8"	7,000	1	Trim
7-1/4"	48-40-4132	48	Carbide	5/8"	7,000	1	Non-Ferrous
7-1/4"	48-40-4138	140	Steel	5/8"	7,000	1	Plywood
7-1/4"	48-40-4140	-	Steel	5/8"	7,000	1	Ferrous
8-1/4"	48-40-4148	18	Carbide	5/8"	7,000	1	Framing
8-1/4"	48-40-4150	24	Carbide	5/8"	7,000	1	Ripping
8-1/4"	48-40-4152	40	Carbide	5/8"	7,000	1	Trim
10"	48-40-4160	24	Carbide	5/8"	6,000	1	Framing
10"	48-40-4162	40	Carbide	5/8"	6,000	1	Trim
10"	48-40-4164	60	Carbide	5/8"	6,000	1	Trim
10"	48-40-4166	80	Carbide	5/8"	6,000	1	Trim
10"	48-40-4168	80	Carbide	5/8"	6,000	1	Non-Ferrous
10-1/4"	48-40-4170	28	Carbide	5/8"	6,000	1	Ripping
10-1/4"	48-40-4172	40	Carbide	5/8"	6,000	1	Trim

JIG SAW BLADES

BI-METAL BLADES

- Combines high speed steel and high carbon steel for extreme versatility

HIGH SPEED STEEL BLADES

- Fully hardened blade for cutting ferrous and non-ferrous metals

HIGH CARBON STEEL BLADES

- Good for soft materials like wood and plastic

T-Shank



U-Shank



	Length	TPI	Part Number	Qty	Blade Material	Recommended Use	Shank	
GENERAL PURPOSE	4"	6	48-42-5300	5	Bi-Metal	Fast cutting, nail embedded wood	T-Shank	
	4"	10	48-42-5310	5	Bi-Metal	Fast cutting, nail embedded wood	T-Shank	
	3"	12	48-42-5390	5	Bi-Metal	Scroll cutting in wood & metal	T-Shank	
	4"	6	48-42-5200	5	High Carbon Steel	Very fast rough cutting, wood	T-Shank	
	4"	8	48-42-5220	5	High Carbon Steel	Fast straight cutting, wood	T-Shank	
	4"	6	48-42-2300	5	Bi-Metal	Fast cutting, nail embedded wood	U-Shank	
	4-1/8"	10	48-42-2310	5	Bi-Metal	Fast cutting, nail embedded wood	U-Shank	
	2-3/4"	12	48-42-2390	5	Bi-Metal	Scroll cutting in wood & metal	U-Shank	
	4"	6	48-42-0200	5	High Carbon Steel	Very fast rough cutting, wood	U-Shank	
	4"	8	48-42-0220	5	High Carbon Steel	Fast straight cutting, wood	U-Shank	
WOOD CUTTING	4"	6	48-42-5302	5	Bi-Metal	Very fast clean cutting	T-Shank	
	4"	10	48-42-5311	5	Bi-Metal	Fast clean cutting	T-Shank	
	3"	20	48-42-5385	5	Bi-Metal	Scroll cutting in wood & laminates	T-Shank	
	4"	6	48-42-5421	5	High Carbon Steel	Very fast rough cutting	T-Shank	
	4"	6	48-42-5500	5	High Carbon Steel	Very fast clean cutting	T-Shank	
	4"	6	48-42-5512	5	High Carbon Steel	Very fast, rough curve cutting	T-Shank	
	4"	10	48-42-5240	5	High Carbon Steel	Clean cutting	T-Shank	
	4"	10	48-42-5540	5	High Carbon Steel	Reverse tooth, no top splinters	T-Shank	
	3"	12	48-42-5640	5	High Carbon Steel	Clean scroll cutting	T-Shank	
	4"	6	48-42-2302	5	Bi-Metal	Very fast clean cutting	U-Shank	
	4"	10	48-42-2311	5	Bi-Metal	Fast clean cutting	U-Shank	
	2-3/4"	20	48-42-2385	5	Bi-Metal	Scroll cutting in wood & laminates	U-Shank	
	4"	6	48-42-0421	5	High Carbon Steel	Very fast rough cutting	U-Shank	
	4"	6	48-42-0500	5	High Carbon Steel	Very fast clean cutting	U-Shank	
	3-1/8"	8	48-42-0240	5	High Carbon Steel	Clean cutting	U-Shank	
	3-5/8"	10	48-42-0540	5	High Carbon Steel	Straight clean cutting	U-Shank	
	4"	10	48-42-0640	5	High Carbon Steel	Reverse tooth, no top splinters	U-Shank	
	2-3/4"	12	48-42-0650	5	High Carbon Steel	Clean scroll cutting	U-Shank	
	METAL CUTTING	4"	8	48-42-5850	5	Bi-Metal	Aluminum, non-ferrous metals	T-Shank
		3"	14	48-42-5190	5	Bi-Metal	Thick metal over 1/4 inch thick	T-Shank
5-1/4"		14	48-42-5192	5	Bi-Metal	Thick metal, tubing, etc.	T-Shank	
3"		18	48-42-5121	5	Bi-Metal	Metal over 1/8 inch thick	T-Shank	
3"		24	48-42-5161	5	Bi-Metal	Metal under 1/8 inch thick	T-Shank	
5-1/4"		24	48-42-5166	5	Bi-Metal	Thin metal under 1/8 inch thick	T-Shank	
3"		14	48-42-5101	5	High Speed Steel	Metal over 1/4 inch thick	T-Shank	
4"		8	48-42-0850	5	Bi-Metal	Aluminum, non-ferrous metals	U-Shank	
3-5/8"		14	48-42-2190	5	Bi-Metal	Thick metal over 1/4 inch thick	U-Shank	
5"		14	48-42-2192	5	Bi-Metal	Thick metal, tubing, etc.	U-Shank	
2-3/4"		18	48-42-2120	5	Bi-Metal	Metal over 1/8 inch thick	U-Shank	
2-3/4"		24	48-42-2160	5	Bi-Metal	Metal under 1/8 inch thick	U-Shank	
5"		24	48-42-2166	5	Bi-Metal	Thin metal under 1/8 inch thick	U-Shank	
2-3/4"		14	48-42-0101	5	High Speed Steel	Metal over 1/4 inch thick	U-Shank	
2-3/4"		18	48-42-0120	5	High Speed Steel	Metal over 1/8 inch thick	U-Shank	
2-3/4"		24	48-42-0140	5	High Speed Steel	Metal under 1/8 inch thick	U-Shank	
SPECIALTY		2-3/4"	GRIT	48-42-0801	5	Carbide-Tipped	Ceramics, tile	U-Shank

JIG SAW BLADE SETS

5 Pk T-Shank Blade Assortment 49-22-1178	5 Pk U-Shank Blade Assortment 49-22-1168
<p>Includes:</p> <ul style="list-style-type: none"> ▪ 48-42-5121 Metal cutting blade ▪ 48-42-5190 Metal cutting blade ▪ 48-42-5310 General purpose blade ▪ 48-42-5161 Metal cutting blade ▪ 48-42-5300 General purpose blade 	<p>Includes:</p> <ul style="list-style-type: none"> ▪ 48-42-2120 Metal cutting blade ▪ 48-42-2300 General purpose blade ▪ 48-42-2310 General purpose blade ▪ 48-42-2160 Metal cutting blade ▪ 48-42-2190 Metal cutting blade

HOLE SAW SELECTION GUIDE

- 1 Identify the material to be cut in the columns below
- 2 Follow the column down to find **RECOMMENDED** or **ACCEPTABLE**

		METAL	STAINLESS STEEL	ALUMINUM & OTHER NON-FERROUS METALS	WOOD WITH NAILS	CEILING TILE	PLASTER/ DRYWALL	PVC & PLASTICS	CLEAN WOOD	FIBERGLASS	CEMENT BOARD	TILE	CAST IRON	BRICK & BLOCK
HOLE SAWS Pg. 41	BI-METAL													
	CARBIDE TIPPED													
	CARBIDE GRIT													
	RECESSED LIGHT													
PILOT BITS Pg. 43	THUNDERBOLT®													
	CARBIDE TIPPED													

BI-METAL HOLE SAWS



LONG LIFE

- ICE HARDENED™ cryogenically treated for up to 50% longer life
- Bi-metal construction with 8% cobalt for increased wear resistance

FAST CUTTING

- Optimized tooth form for up to 2X faster cutting

EASY PLUG REMOVAL

- Wide, angled and offset slots for easy plug access

GENERAL PURPOSE CUTTING

- Designed for cutting machinable and non-ferrous metals, wood products and plastics



Size	Metric	Hanging Container	Shrink Wrap	Packaged with Arbor	Bulk Package		Conduit & Pipe	Pipe Tap	Copper Tube
					Item	Qty			
5/8"	16 mm	49-56-0012							1/4"
11/16"	18 mm	49-56-0017							3/8"
3/4"	19 mm	49-56-0023	49-56-9605		49-56-5090	25	3/8"	1/2"	1/2"
13/16"	21 mm	49-56-0027							
7/8"	22 mm	49-56-0032	49-56-9607		49-56-5100	25	1/2"	3/4"	5/8"
15/16"	24 mm	49-56-0037							
1"	25 mm	49-56-0043	49-56-9609	49-56-9662	49-56-5110	25			3/4"
1-1/16"	27 mm	49-56-0047							
1-1/8"	29 mm	49-56-0052	49-56-9611	49-56-9663	49-56-5120	25	3/4"	1"	
1-3/16"	30 mm	49-56-0057							
1-1/4"	32 mm	49-56-0062	49-56-9613	49-56-9664	49-56-5130	25			1"
1-5/16"	33 mm	49-56-0067							
1-3/8"	35 mm	49-56-0072	49-56-9615		49-56-5140	25	1"		
1-7/16"	37 mm	49-56-0077							
1-1/2"	38 mm	49-56-0082	49-56-9617	49-56-9665	49-56-5150	25		1-1/4"	1-1/4"
1-9/16"	40 mm	49-56-0087							
1-5/8"	41 mm	49-56-0092			49-56-5152	25			
1-11/16"	43 mm	49-56-0097							
1-3/4"	44 mm	49-56-0102	49-56-9621	49-56-9666	49-56-5155	25	1-1/4"	1-1/2"	1-1/2"
1-13/16"	46 mm	49-56-0107							
1-7/8"	48 mm	49-56-0112							
2"	51 mm	49-56-0117	49-56-9624	49-56-9667	49-56-5160	25	1-1/2"		
2-1/16"	52 mm	49-56-0122							
2-1/8"	54 mm	49-56-0127	49-56-9626	49-56-9668	49-56-5165	25			
2-1/4"	57 mm	49-56-0132			49-56-5167	25		2"	2"
2-5/16"	59 mm	49-56-0137							
2-3/8"	60 mm	49-56-0142	49-56-9630						
2-1/2"	64 mm	49-56-0147	49-56-9631	49-56-9669	49-56-5170	25	2"		
2-9/16"	65 mm	49-56-0153							
2-5/8"	67 mm	49-56-0158	49-56-9633		49-56-5175	16		2-1/2"	
2-3/4"	70 mm	49-56-0163	49-56-9635						
2-7/8"	73 mm	49-56-0167							
3"	76 mm	49-56-0173	49-56-9637	49-56-9670	49-56-5180	16	2-1/2"		2-1/2"
3-1/8"	79 mm	49-56-0177	49-56-9638						
3-1/4"	83 mm	49-56-0183	49-56-9639					3"	
3-3/8"	86 mm	49-56-0187							
3-1/2"	89 mm	49-56-0193	49-56-9641		49-56-5190	9			
3-5/8"	92 mm	49-56-0197	49-56-9642		49-56-5195	9	3"		
3-3/4"	95 mm	49-56-0203						3-1/2"	
3-7/8"	98 mm	49-56-0207							
4"	102 mm	49-56-0213	49-56-9645		49-56-5200	9			
4-1/8"	105 mm	49-56-0217	49-56-9646		49-56-5205	9	3-1/2"		3-1/2"
4-1/4"	108 mm	49-56-0223	49-56-9647					4"	4"
4-3/8"	111 mm	49-56-0227							
4-1/2"	114 mm	49-56-0233	49-56-9649				4"		
4-3/4"	121 mm	49-56-0237							
5"	127 mm	49-56-0243	49-56-9652						
5-1/2"	140 mm	49-56-0247					5"		5"
6"	152 mm	49-56-0253	49-56-9656						



Nothing but **HEAVY DUTY.**

BI-METAL HOLE SAW KITS



Contents	8 Pc General Purpose Kit 49-22-4005	13 Pc General Purpose Kit 49-22-4025	15 Pc General Purpose Kit 49-22-4175	28 Pc General Purpose Kit 49-22-4185	10 Pc Plumber's Kit 49-22-4145	18 Pc Plumber's Kit 49-22-4155	10 Pc Electrician's Kit 49-22-4095	19 Pc Electrician's Kit 49-22-4105	Door Lock Kit 49-22-4063
HOLE SAWS	3/4" 7/8" 1" 1-1/8" 1-1/2"	3/4" 7/8" 1-1/8" 1-3/8" 1-1/2" 1-3/4" 2" 2-1/8" 2-1/2"	3/4" 7/8" 1" 1-1/8" 1-3/8" 1-1/2" 1-3/4" 2" 2-1/8" 2-1/2"	3/4" 7/8" 1" 1-1/4" 1-3/8" 1-1/2" 2" 2-1/8" 2-1/2" 2-5/8" 3" 3-1/4" 3-3/8" 3-3/4" 4-1/8" 4-1/4" 4-1/2" 4-3/4"	3/4" 7/8" 1-1/8" 1-1/2" 1-3/4" 2-1/4"	3/4" 7/8" 1-1/8" 1-1/2" 2-1/4" 3" 3-1/2" 4" 4-1/4" 4-1/2"	7/8" 1-1/8" 1-3/8" 1-3/4" 2-5/8" 3-1/2" 2-1/2"	3/4" 7/8" 1-1/8" 1-3/8" 2" 2-1/4" 2-5/8" 3" 3-5/8" 4-1/8" 4-3/4"	1" 2-1/8"
ARBORS	49-56-7210 TRUST 49-56-8010	49-56-7010 49-56-7250	49-56-7010 49-56-9100	49-56-7000 49-56-7010 49-56-9100	49-56-7010 49-56-9100	49-56-7010 49-56-9100	49-56-7010 49-56-9100	49-56-7010 49-56-9100	49-56-7010
PILOT BITS	Additional 49-56-8010	(2) 49-56-8010	(2) Additional 49-56-8010	(3) Additional 49-56-8010	(2) Additional 49-56-8010	(3) Additional 49-56-8010	(2) Additional 49-56-8010	(3) Additional 49-56-8010	49-56-8010
OTHER	49-56-6560 Adapter 49-67-0120 Spacer 1/8" Hex Key		49-56-6560 Adapter 49-67-0120 Spacer		49-56-6560 Adapter 49-67-0120 Spacer	49-56-6560 Adapter 49-67-0120 Spacer	49-56-6560 Adapter 49-67-0120 Spacer	49-56-6560 Adapter 49-67-0120 Spacer	49-56-6560 Adapter 49-67-0120 Spacer

CARBIDE GRIT HOLE SAWS

SPECIALTY APPLICATIONS

- Designed for cutting abrasive materials such as brick, block, cement board, fiberglass and tile

FAST CUTTING

- Coarse grit and segmented edge for fast cutting

EASY PLUG REMOVAL

- Wide, angled and offset slots for easy plug access



Size	Metric	Individual Package	Conduit & Pipe	Copper Tube
3/4"	19 mm	49-56-0405	3/8"	1/2"
7/8"	22 mm	49-56-0409	1/2"	5/8"
1"	25 mm	49-56-0413		3/4"
1-1/8"	29 mm	49-56-0417	3/4"	
1-1/4"	32 mm	49-56-0422		1"
1-3/8"	35 mm	49-56-0426	1"	
1-3/4"	44 mm	49-56-0437	1-1/4"	1-1/2"
2"	51 mm	49-56-0444	1-1/2"	
2-1/4"	57 mm	49-56-0449		2"
2-1/2"	64 mm	49-56-0456	2"	

All sizes include carbide tipped pilot bit

CARBIDE TIPPED HOLE SAWS

SPECIALTY APPLICATIONS

- Designed for cutting cement board, ceramic tiles, fiberglass, cast iron and wood products such as fiberboard, flakeboard and plywood

LONG LIFE

- Tungsten carbide tipped for long life

FAST CUTTING

- Aggressive tooth form for fast cutting

EASY PLUG REMOVAL

- Wide, angled and offset slots for easy plug access



Size	Metric	Individual Package	Conduit & Pipe	Pipe Tap	Copper Tube
5/8"	16 mm	49-56-0623			
3/4"	19 mm	49-56-0753	3/8"	1/2"	1/2"
7/8"	22 mm	49-56-0873	1/2"	3/4"	5/8"
1"	25 mm	49-56-1003			3/4"
1-1/8"	29 mm	49-56-1123	3/4"	1"	
1-1/4"	32 mm	49-56-1253			1"
1-3/8"	35 mm	49-56-1373	1"		
1-1/2"	38 mm	49-56-1503		1-1/4"	1-1/4"
1-5/8"	41 mm	49-56-1623			
1-3/4"	44 mm	49-56-1753	1-1/4"	1-1/2"	1-1/2"
1-7/8"	48 mm	49-56-1873			
2"	51 mm	49-56-2003	1-1/2"		
2-1/8"	54 mm	49-56-2123			
2-1/4"	57 mm	49-56-2253		2"	2"
2-3/8"	60 mm	49-56-2373			
2-1/2"	64 mm	49-56-2503	2"		
2-5/8"	67 mm	49-56-2623		2-1/2"	
2-3/4"	70 mm	49-56-2753			
2-7/8"	73 mm	49-56-2873			
3"	76 mm	49-56-3003	2-1/2"		2-1/2"
3-1/4"	83 mm	49-56-3253		3"	
3-1/2"	89 mm	49-56-3503			
3-5/8"	92 mm	49-56-3623	3"		
3-3/4"	95 mm	49-56-3753		3-1/2"	
4"	102 mm	49-56-4003			
4-1/4"	108 mm	49-56-4253		4"	4"
4-1/2"	114 mm	49-56-4503	4"		
5"	127 mm	49-56-5003			
6"	152 mm	49-56-6003			

RECESSED LIGHT HOLE SAWS

SMOOTH CUTS

- Continuous grit edge for smooth cuts

ACCURATE HOLE SIZES

- Solid, welded construction provides accurately sized holes

EASY PLUG REMOVAL

- Open back for easy plug removal



Size	Metric	Individual Package
3-1/8"	79 mm	49-56-0296
4-3/8"	111 mm	49-56-0300
5-3/8"	137 mm	49-56-0303
6-3/8"	162 mm	49-56-0305
6-5/8"	168 mm	49-56-0310
6-7/8"	175 mm	49-56-0315

All sizes include pilot bit

DRILLING ACCESSORIES

ARBORS FOR HOLE SAWS

UNIVERSAL FIT

- Works with all major brands of hole saws
- Accepts any 1/4" straight or 3-flat shank pilot bit

DURABLE

- Made from hardened steel and alloy steel for greater durability

QUICK CHANGE ARBORS

- Tool-free operation
- Universal, quick change with all brands of hole saws
- No adapters required



TOOL FREE OPERATION



	49-56-7210	49-56-7010	49-56-7000	49-56-6950	49-56-7055	49-56-7040	49-56-9100	49-56-7250	49-56-7240
	Quick Change				Quick Change		Quick Change	Quick Change	Quick Change
Hole Saw Size Range	Up to 1-3/16"				1-1/4" & Larger				
Minimum Chuck Size	3/8"	3/8"	1/2"	1/4"	1/2"	3/8"	1/2"	3/8"	1/2"
Works with Pilot Bits	49-56-8000, 49-56-8010, 49-56-8005			49-56-8000, 49-56-8005		49-56-8000, 49-56-8010, 49-56-8005			

PILOT BITS FOR HOLE SAWS

DURABLE

- THUNDERBOLT® tapered web resists breaking

UNIVERSAL FIT

- Will work with most brands of arbors

STARTS ON CONTACT

- 135° split point for precision start and no walking

No SPIN **SECURE-GRIP™**

- 3-Flat shank won't slip in arbor or chuck on THUNDERBOLT® bits



Description	Length	Diameter	Individual Package	Bulk Package		For Use With
				Item	Qty	
HSS THUNDERBOLT® Bit	3-1/2"	1/4"	49-56-8010	49-56-8033	12	Metal, wood, drywall, plaster, plastics, fiberglass
HSS THUNDERBOLT® Bit	4"	1/4"	49-56-8000	49-56-8031	12	
Carbide Tipped Bit	4"	1/4"	49-56-8005			Fiberglass, cement board, tile, brick, block

Up To 10x Life

- Compression Forged Tip**
Ideal fit and reduces breakage
- Shock Zone Geometry****
Designed to flex with spring-like action
Reduces stress at the tip
- Custom Engineered Steel & Heat Treatment**
High shock resistance

* patent pending

SHOCKWAVE
IMPACT DUTY

IMPACT DRIVING STRESS COMPARISON
STANDARD BIT VS. SHOCKWAVE™ BIT

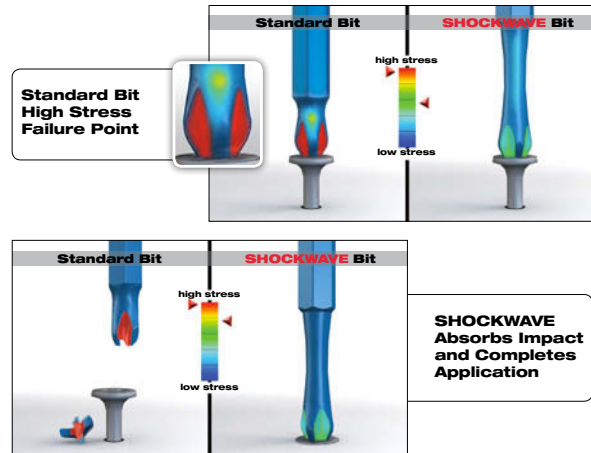

SHOCKWAVE™ INSERT BITS

PHILLIPS INSERT BITS



Description	Individual Part Number	Qty	Bulk Part Number	Qty
#1 Phillips SHOCKWAVE™ Insert Bit	48-32-4411	2		
#2 Phillips SHOCKWAVE™ Insert Bit	48-32-4412	2		
#2 Phillips SHOCKWAVE™ Insert Bit	48-32-4601	5	48-32-4712	25
#2 Phillips SHOCKWAVE™ Insert Bit 25 Pc Tic-Tac	48-32-4604	25		
#3 Phillips SHOCKWAVE™ Insert Bit	48-32-4413	2		
#2 Phillips Reduced Diameter SHOCKWAVE™ Insert Bit	48-32-4444	2		
#2 Phillips SHOCKWAVE™ 2" Power Bit	48-32-4462	1	48-32-4762	25
#2 Phillips SHOCKWAVE™ 2" Power Bit	48-32-4602	5		
#3 Phillips SHOCKWAVE™ 2" Power Bit	48-32-4463	1		
#2 Phillips SHOCKWAVE™ 3-1/2" Power Bit	48-32-4562	1	48-32-4791	25

SQUARE RECESS INSERT BITS



Description	Individual Part Number	Qty	Bulk Part Number	Qty
#1 Square Recess SHOCKWAVE™ Insert Bit	48-32-4421	2	48-32-4761	25
#2 Square Recess SHOCKWAVE™ Insert Bit	48-32-4422	2		
#2 Square Recess SHOCKWAVE™ Insert Bit	48-32-4605	5	48-32-4722	25
#2 Square Recess SHOCKWAVE™ Insert Bit 10 Pc Tic-Tac	48-32-4607	10		
#3 Square Recess SHOCKWAVE™ Insert Bit	48-32-4423	2		
#1 Square Recess SHOCKWAVE™ 2" Power Bit	48-32-4471	1		
#2 Square Recess SHOCKWAVE™ 2" Power Bit	48-32-4472	1	48-32-4772	25
#2 Square Recess SHOCKWAVE™ 2" Power Bit	48-32-4606	5		
#3 Square Recess SHOCKWAVE™ 2" Power Bit	48-32-4473	1		
#2 Square Recess SHOCKWAVE™ 3-1/2" Power Bit	48-32-4572	1	48-32-4795	25

BIT HOLDERS



Description	Individual Part Number	Qty	Bulk Part Number	Qty
SHOCKWAVE™ Compact Magnetic Bit Tip Holder (2.36")	48-32-4502	1	48-32-4504	10
SHOCKWAVE™ Magnetic Bit Tip Holder (3")	48-32-4503	1	48-32-4505	10

TORX® INSERT BITS



Description	Individual Part Number	Qty	Bulk Part Number	Qty
T15 Torx® SHOCKWAVE™ 2" Power Bit	48-32-4483	1		
T20 Torx® SHOCKWAVE™ 2" Power Bit	48-32-4484	1	48-32-4784	25
T25 Torx® SHOCKWAVE™ 2" Power Bit	48-32-4485	1	48-32-4785	25
T30 Torx® SHOCKWAVE™ 2" Power Bit	48-32-4487	1		

SHOCKWAVE IMPACT DUTY™ SET

- 29 Pc SHOCKWAVE™ Driver Bit Set 48-32-4401**
- Includes:**
- Phillips Bits: 1" - (1) P1, (7) P2, (2) P3; 2" Power - (2) P2, (1) P3
 - Square Bits: 1" - (1) SQ1, (4) SQ2, (1) SQ3; 2" Power - (2) SQ2
 - Torx® Bits: 1" - (1) T15, (1) T20, (1) T25; 2" Power - (1) T25
 - Magnetic nut drivers: (1) 1/4" Red, (1) 5/16" Amber, (1) 3/8" Blue
 - Magnetic bit holder
 - Case with bulk storage container



SHOCKWAVE™ SOCKETS AND ADAPTERS

IMPACT DUTY STEEL

- Chrome-molybdenum sockets

DEEP WELL, THIN WALL CONSTRUCTION

- Provides access in tight areas

6-PT RECESSED CORNERS

- Maximum surface contact on fastener

LASER ETCHED SIZE MARKINGS

- Easy identification, won't wear off



Description	Individual Part Number	Qty
1/4" Hex Shank to 1/4" SHOCKWAVE™ Socket Adapter	48-32-5030	1
1/4" Hex Shank to 3/8" SHOCKWAVE™ Socket Adapter	48-32-5031	1
1/4" Hex Shank to 1/2" SHOCKWAVE™ Socket Adapter	48-32-5032	1
3/8" Square x 1/4" SHOCKWAVE™ Hex Adapter	48-03-4405	1
1/2" Square x 1/4" SHOCKWAVE™ Hex Adapter	48-03-4410	1
5/16" SHOCKWAVE™ Deep Well, 3/8" Drive	49-66-4422	1
3/8" SHOCKWAVE™ Deep Well, Thin Wall, 3/8" Drive	49-66-4424	1
7/16" SHOCKWAVE™ Deep Well, 3/8" Drive	49-66-4425	1
1/2" SHOCKWAVE™ Deep Well, 3/8" Drive	49-66-4426	1
9/16" SHOCKWAVE™ Deep Well, 3/8" Drive	49-66-4427	1
5/8" SHOCKWAVE™ Deep Well, 3/8" Drive	49-66-4428	1
11/16" SHOCKWAVE™ Deep Well, 3/8" Drive	49-66-4429	1
3/4" SHOCKWAVE™ Deep Well, 3/8" Drive	49-66-4430	1
13/16" SHOCKWAVE™ Deep Well, 3/8" Drive	49-66-4431	1
7/8" SHOCKWAVE™ Deep Well, 3/8" Drive	49-66-4432	1
8 Pc 3/8" SHOCKWAVE™ Drive Deep Well Set (5/16", 3/8", 7/16", 1/2", 9/16", 5/8", 11/16", 3/4")	49-66-4419	8

SHOCKWAVE™ MAGNETIC NUT DRIVERS

COLOR CODED BANDS

- For fast, easy identification

CHAMFERED EDGE

- Better fit
- Reduced rounding of fasteners



Description	Individual Part Number	Qty	Bulk Part Number	Qty
1/4" x 1-7/8" SHOCKWAVE™ Magnetic Nut Driver	49-66-4502	1	49-66-4702	10
5/16" x 1-7/8" SHOCKWAVE™ Magnetic Nut Driver	49-66-4503	1	49-66-4703	10
3/8" x 1-7/8" SHOCKWAVE™ Magnetic Nut Driver	49-66-4505	1	49-66-4705	10
7/16" x 1-7/8" SHOCKWAVE™ Magnetic Nut Driver	49-66-4506	1	49-66-4706	10
1-7/8" SHOCKWAVE™ Magnetic Nut Driver Set (1/4", 5/16", 3/8")	49-66-4561	3		
1-7/8" SHOCKWAVE™ Magnetic Nut Driver Set (1/4", 5/16", 3/8", 7/16")	49-66-4562	4		
1/4" x 1-7/8" SHOCKWAVE™ Magnetic Nut Driver	49-66-4522	3	49-66-4732	10
5/16" x 1-7/8" SHOCKWAVE™ Magnetic Nut Driver	49-66-4523	3	49-66-4733	10
3/8" x 1-7/8" SHOCKWAVE™ Magnetic Nut Driver	49-66-4525	3	49-66-4735	10
7/16" x 1-7/8" SHOCKWAVE™ Magnetic Nut Driver	49-66-4526	3	49-66-4736	10
1/4" x 2-9/16" SHOCKWAVE™ Magnetic Nut Driver	49-66-4532	1		
5/16" x 2-9/16" SHOCKWAVE™ Magnetic Nut Driver	49-66-4533	1		
3/8" x 2-9/16" SHOCKWAVE™ Magnetic Nut Driver	49-66-4535	1		
7/16" x 2-9/16" SHOCKWAVE™ Magnetic Nut Driver	49-66-4536	1		

STANDARD DRIVING BIT SETS



21 Pc Driver Bit Set
48-32-0221



21 Pc Drive Guide Set
48-32-1700



38 Pc QUIK-LOK™ Drill and Drive Set
48-32-1500



40 Pc Drive Guide Set
48-32-1505

ADAPTERS



30° Off-Set Drive Adapter



Right Angle Drive Attachment

Description	Part Number
30° Off-Set Drive Adapter	48-32-2100
Right Angle Drive Attachment	49-22-8510
1/2" Square to 7/16" Hex Quick Change Impact Adapter	48-66-0061

METAL DRILLING SELECTION GUIDE

1 Identify the material to be cut in the columns below

2 Follow the column down to find the accessory with **BEST PERFORMANCE** or **ACCEPTABLE PERFORMANCE**

	CLEAN WOOD	PVC & PLASTICS	ALUMINUM & OTHER NON-FERROUS METALS	PLATE STEEL (1" - 2")	PLATE STEEL (1/2" - 1")	PLATE STEEL (1/4" - 1/2")	METAL (3/16" - 1/4")	METAL (1/8" - 3/16")	SHEET METAL (UP TO 1/8")	CAST IRON	STAINLESS STEEL	PLASTER/ DRYWALL	MILD STEEL	HIGH ALLOY STEEL
PG. 46	BLACK OXIDE													
PG. 48	TITANIUM													
PG. 48	COBALT													
PG. 49	STEP BITS													
PG. 51	CARBIDE TOOTH SHEET METAL CUTTERS													
PG. 51	CARBIDE TOOTH PLATE STEEL CUTTERS													
PG. 49	1" ANNULAR CUTTERS													
PG. 49	2" ANNULAR CUTTERS													
PG. 50	1 PC STEEL HAWG® CUTTER													
PG. 50	THREADED STEEL HAWG® CUTTER													
PG. 50	QUICK CHANGE TANG STEEL HAWG® CUTTER													

THUNDERBOLT® BLACK OXIDE DRILL BITS

LONG LIFE

- THUNDERBOLT® drill bits are designed with a thicker web, providing greater strength and longer life

EFFICIENT CHIP REMOVAL

- Parabolic flute clears chips fast

PRECISION STARTS, NO WALKING

- 135° split point geometry starts fast, on contact

CORROSION RESISTANT

- Black oxide coating provides lubricity and resists corrosion of the bit

NO SPIN SECURE-GRIP™

- 3-Flat shank holds bit secure in drill chuck



Size	Part Number	Qty/Card	Bulk Pack	Bulk Qty
1/16"	48-89-2710	2	48-89-2820	12
5/64"	48-89-2711	2	48-89-2821	12
3/32"	48-89-2712	2	48-89-2822	12
7/64"	48-89-2713	2	48-89-2823	12
1/8"	48-89-2714	2	48-89-2824	12
9/64"	48-89-2715	1	48-89-2825	12
5/32"	48-89-2716	1	48-89-2826	12
11/64"	48-89-2717	1	48-89-2827	12
3/16"	48-89-2718	1	48-89-2828	12
13/64"	48-89-2719	1	48-89-2829	12
7/32"	48-89-2720	1	48-89-2830	12
15/64"	48-89-2721	1	48-89-2831	12
1/4"	48-89-2722	1	48-89-2832	12
17/64"	48-89-2723	1	48-89-2833	6
9/32"	48-89-2724	1	48-89-2834	6
19/64"	48-89-2725	1	48-89-2835	6
5/16"	48-89-2726	1	48-89-2836	6
21/64"	48-89-2727	1	48-89-2837	6
11/32"	48-89-2728	1	48-89-2838	6
23/64"	48-89-2729	1	48-89-2839	6
3/8"	48-89-2730	1	48-89-2840	6
25/64"	48-89-2731	1	48-89-2841	6
13/32"	48-89-2732	1	48-89-2842	6
27/64"	48-89-2733	1	48-89-2843	6
7/16"	48-89-2734	1	48-89-2844	6
29/64"	48-89-2735	1	48-89-2845	6
15/32"	48-89-2736	1	48-89-2846	6
31/64"	48-89-2737	1	48-89-2847	6
1/2"	48-89-2738	1	48-89-2848	6



Nothing but **HEAVY DUTY**®

THUNDERBOLT® BLACK OXIDE DRILL BIT SETS



14 Pc THUNDERBOLT® Black Oxide Drill Bit Set 48-89-2800	15 Pc THUNDERBOLT® Black Oxide Drill Bit Set 48-89-2803	21 Pc THUNDERBOLT® Black Oxide Drill Bit Set 48-89-2801	29 Pc THUNDERBOLT® Black Oxide Drill Bit Set 48-89-2802
Includes: <ul style="list-style-type: none"> 1/16", 5/64", 3/32", 7/64", (2) 1/8", 9/64", 5/32", 3/16", 7/32", 1/4", 5/16", 3/8", 1/2" 	Includes: <ul style="list-style-type: none"> 1/16", 5/64", 3/32", 7/64", 1/8", 9/64", 5/32", 11/64", 3/16", 13/64", 7/32", 1/4", 9/32", 5/16", 3/8" 	Includes: <ul style="list-style-type: none"> (2) 1/16", (2) 5/64", 3/32", 7/64", (2) 1/8", 9/64", 5/32", 11/64", (2) 3/16", 13/64", 7/32", 15/64", (2) 1/4", 5/16", 3/8", 1/2" 	Includes: <ul style="list-style-type: none"> 1/16", 5/64", 3/32", 7/64", 1/8", 9/64", 5/32", 11/64", 3/16", 13/64", 7/32", 15/64", 1/4", 17/64", 9/32", 19/64", 5/16", 21/64", 11/32", 23/64", 3/8", 25/64", 13/32", 27/64", 7/16", 29/64", 15/32", 31/64", 1/2"

BLACK OXIDE S&D DRILL BITS



Size	Part Number	Qty/Card
17/32"	48-88-2739	1
9/16"	48-89-2740	1
19/32"	48-89-2741	1
5/8"	48-89-2742	1
21/32"	48-89-2743	1
11/16"	48-89-2744	1
23/32"	48-89-2745	1
3/4"	48-89-2746	1
25/32"	48-89-2747	1
13/16"	48-89-2748	1
27/32"	48-89-2749	1
7/8"	48-89-2750	1
29/32"	48-89-2751	1
15/16"	48-89-2752	1
31/32"	48-89-2753	1
1"	48-89-2754	1
1-1/16"	48-89-2755	1
1-1/8"	48-89-2756	1
1-3/16"	48-89-2757	1
1-1/4"	48-89-2758	1

BLACK OXIDE 12" AIRCRAFT LENGTH BITS



Size	Part Number	Qty/Card
1/8"	48-89-2770	1
3/16"	48-89-2771	1
1/4"	48-89-2772	1
5/16"	48-89-2773	1
3/8"	48-89-2774	1
7/16"	48-89-2775	1
1/2"	48-89-2776	1

SHOCKWAVE IMPACT DUTY™ HEX SHANK DRILL BITS



- LONG LIFE**
- THUNDERBOLT® drill bits are designed with a thicker web, providing greater strength and longer life
- EFFICIENT CHIP REMOVAL**
- Parabolic flute clears chips fast
- PRECISION STARTS, NO WALKING**
- 135° split point geometry starts fast, on contact
- QUICK CHANGE**
- 1/4" Hex power groove shank

Size	Part Number	Qty/Card
1/16"	48-89-4401	1
3/32"	48-89-4403	1
1/8"	48-89-4405	1
5/32"	48-89-4407	1
3/16"	48-89-4409	1
7/32"	48-89-4411	1
1/4"	48-89-4413	1

SHOCKWAVE IMPACT DUTY™ HEX SHANK DRILL BIT SET



SHOCKWAVE
IMPACT DUTY



7 Pc Impact Duty Hex Shank Drill Bit Set 48-89-4431
Includes: <ul style="list-style-type: none"> 1/16", 3/32", 1/8", 9/64", 5/32", 3/16", 7/32", 1/4",

THUNDERBOLT® TITANIUM DRILL BITS

LONG LIFE

- Titanium coating reduces heat build-up for up to 3X life

EFFICIENT CHIP REMOVAL

- Parabolic flute clears chips fast

PRECISION STARTS, NO WALKING

- 135° split point geometry starts fast, on contact

CORROSION RESISTANT

- Titanium coating provides added protection from heat build-up

NO SPIN SECURE-GRIP™

- 3-Flat shank holds bit secure in drill chuck



Size	Part Number	Qty/Card
1/16"	48-89-2201	2
5/64"	48-89-2202	2
3/32"	48-89-2203	2
7/64"	48-89-2204	2
1/8"	48-89-2205	2
9/64"	48-89-2206	1
5/32"	48-89-2207	1
11/64"	48-89-2208	1
3/16"	48-89-2209	1
13/64"	48-89-2210	1
7/32"	48-89-2211	1
1/4"	48-89-2213	1
17/64"	48-89-2214	1
5/16"	48-89-2217	1
21/64"	48-89-2218	1
11/32"	48-89-2219	1
3/8"	48-89-2221	1
13/32"	48-89-2223	1
7/16"	48-89-2225	1
1/2"	48-89-2229	1

THUNDERBOLT® TITANIUM DRILL BIT SETS



14 Pc THUNDERBOLT® Titanium Drill Bit Set 48-89-0011	20 Pc Titanium Drill Bit Set 48-89-1105	29 Pc THUNDERBOLT® Titanium Drill Bit Set 48-89-0012
Includes: <ul style="list-style-type: none"> ▪ 1/16", 5/64", 3/32", 7/64", (2) 1/8", 9/64", 5/32", 3/16", 7/32", 1/4", 5/16", 3/8", 1/2" 	Includes: <ul style="list-style-type: none"> ▪ (2) 1/16", (2) 5/64", (2) 3/32", (2) 7/64", (2) 1/8", 9/64", 5/32", 11/64, 3/16", 13/64", 7/32", 1/4", 5/16", 3/8", 1/2" 	Includes: <ul style="list-style-type: none"> ▪ 1/16", 5/64", 3/32", 7/64", 1/8", 9/64", 5/32", 11/64", 3/16", 13/64", 7/32", 15/64", 1/4", 17/64", 9/32", 19/64", 5/16", 21/64", 11/32", 23/64", 3/8", 25/64", 13/32", 27/64", 7/16", 29/64", 15/32", 31/64", 1/2"

THUNDERBOLT® COBALT DRILL BITS

LONG LIFE

- THUNDERBOLT® drill bits are designed with a thicker web, providing greater strength and longer life

EFFICIENT CHIP REMOVAL

- Parabolic flute clears chips fast

PRECISION STARTS, NO WALKING

NO SPIN SECURE-GRIP™

- 3-Flat Shank holds bit secure



THUNDERBOLT® COBALT DRILL BIT SET



Size	Part Number	Qty/Card
3/32"	48-89-2303	1
7/64"	48-89-2304	1
1/8"	48-89-2305	1
9/64"	48-89-2306	1
5/32"	48-89-2307	1
3/16"	48-89-2309	1
1/4"	48-89-2313	1
5/16"	48-89-2317	1
3/8"	48-89-2321	1
7/16"	48-89-2325	1
1/2"	48-89-2329	1

14 Pc THUNDERBOLT® Cobalt Drill Bit Set 48-89-0026
Includes: <ul style="list-style-type: none"> ▪ 1/16", 5/64", 3/32", 7/64", (2) 1/8", 9/64", 5/32", 3/16", 7/32", 1/4", 5/16", 3/8", 1/2"

STEP DRILL BITS

TRUE ROUND HOLES

- Single flute produces perfectly round holes

NO SPIN SECURE-GRIP™

- 3-Flat shank holds bit secure in drill chuck

EASY SIZE IDENTIFICATION

- Laser etched markings ensure fast size identification and won't wear off



Size	Part Number	Qty/Card	Description
MET-2	48-89-8955	1	6 Hole, 3/16" - 1/2" (1/16") Step Drill Bit
MET-5	48-89-8960	1	10 Hole, 1/4" - 1-3/8" (1/8") Step Drill Bit
MET-21	48-89-8965	1	10 Hole, 13/16" - 1-3/8" (1/16") Step Drill Bit, Hole Enlarging
MET-1	48-89-9100	1	13 Hole, 1/8" - 1/2" (1/32") Step Drill Bit
MET-3	48-89-9105	1	9 Hole, 1/4" - 3/4" (1/16") Step Drill Bit
MET-20	48-89-9110	1	8 Hole, 9/16" - 1" (1/16") Step Drill Bit, Hole Enlarging
MET-11	48-89-9115	1	Single Hole Size, 7/8" Step Drill Bit
MET-4	48-89-9130	1	12 Hole, 3/16" - 7/8" (1/16") Step Drill Bit
MET-9	48-89-9135	1	2 Hole 7/8" and 1-1/8" Step Drill Bit (1/2" and 3/4" Knock-Out)

STEP DRILL BIT SETS



2 Pc Set 48-89-9050	3 Pc Set 48-89-8990
<ul style="list-style-type: none"> 2 piece set - 13 hole and 9 hole step drill bits 	<ul style="list-style-type: none"> 3 piece set - 13 hole, 6 hole, 9 hole step drill bits
Includes: <ul style="list-style-type: none"> MET-1, MET-3, soft case 	Includes: <ul style="list-style-type: none"> MET-1, MET-2, MET-3, soft case

ANNULAR CUTTERS



FASTER CUTTING

- Thinner wall design for faster, more efficient cutting

LONG LIFE

- Proprietary steel, optimized for steel cutting

UNIVERSAL SHANK

- Fits directly into Milwaukee® compact magnetic drill press
- Works with 3/4" Weldon® style shank arbor

Size	1" Depth	2" Depth	Size	1" Depth	2" Depth
1/2"	49-59-0500	49-59-2050	1-5/16"	49-59-1312	49-59-2131
9/16"	49-59-0562	49-59-2056	1-3/8"	49-59-1375	49-59-2138
5/8"	49-59-0625	49-59-2063	1-7/16"	49-59-1437	49-59-2144
11/16"	49-59-0687	49-59-2069	1-1/2"	49-59-1500	49-59-2150
3/4"	49-59-0750	49-59-2075	1-9/16"	49-59-1562	49-59-2156
13/16"	49-59-0812	49-59-2081	1-5/8"	49-59-1625	49-59-2163
7/8"	49-59-0875	49-59-2089	1-11/16"	49-59-1687	49-59-2169
15/16"	49-59-0937	49-59-2094	1-3/4"	49-59-1750	49-59-2175
1"	49-59-1000	49-59-2100	1-13/16"	49-59-1812	49-59-2181
1-1/16"	49-59-1062	49-59-2106	1-7/8"	49-59-1875	49-59-2188
1-1/8"	49-59-1125	49-59-2113	1-15/16"	49-59-1937	49-59-2194
1-3/16"	49-59-1187	49-59-2119	2"	49-59-2000	49-59-2200
1-1/4"	49-59-1250	49-59-2125			

ANNULAR CUTTER SETS



6 Pc Annular Cutter Set (1" Depth) 49-22-8400	9 Pc Annular Cutter Set (2" Depth) 49-22-8410
Includes: <ul style="list-style-type: none"> 9/16", 5/8", 11/16", 13/16", 15/16", 1-1/16" and ejector pin 	Includes: <ul style="list-style-type: none"> 1/2", 9/16", 5/8", 11/16", 3/4", 13/16", 7/8", 15/16", 1-1/16" and (2) ejector pins

ANNULAR CUTTER ACCESSORIES

Description	Part Number
#3 Morse Taper To Weldon® Shank Arbor	49-56-0025
Arbor Wrench Set	49-96-0010
(2) 1" Ejector Pins	44-60-1720
(2) 2" Ejector Pins	44-60-1721
HAWG WASH® Lubricant (16 Oz Bottle)	49-32-0081
HAWG WASH® Hand Pump	44-46-0090
HAWG WASH® Hand Pump Oil Hose	43-75-0010

THREADED STEEL HAWG® CUTTERS

FAST CUTTING

- Alternating tooth geometry for up to 3X faster cutting

LONG LIFE

- Hardened carbide steel teeth provide longer life

2" CUTTING DEPTH



Size	Part Number	Size	Part Number
3/4"	49-57-0750	2-3/8"	49-57-2370
13/16"	49-57-0812	2-1/2"	49-57-2500
7/8"	49-57-0875	2-9/16"	49-57-2560
15/16"	49-57-0937	2-5/8"	49-57-2620
1"	49-57-1000	2-3/4"	49-57-2750
1-1/16"	49-57-1062	2-7/8"	49-57-2870
1-1/8"	49-57-1125	3"	49-57-3000
1-3/16"	49-57-1187	3-1/8"	49-57-3120
1-1/4"	49-57-1250	3-1/4"	49-57-3250
1-5/16"	49-57-1312	3-3/8"	49-57-3370
1-3/8"	49-57-1375	3-1/2"	49-57-3500
1-7/16"	49-57-1437	3-5/8"	49-57-3620
1-1/2"	49-57-1500	3-3/4"	49-57-3750
1-9/16"	49-57-1562	3-7/8"	49-57-3870
1-5/8"	49-57-1625	4"	49-57-4000
1-11/16"	49-57-1687	4-1/8"	49-57-4120
1-3/4"	49-57-1750	4-1/4"	49-57-4250
1-13/16"	49-57-1812	4-3/8"	49-57-4370
1-7/8"	49-57-1875	4-1/2"	49-57-4500
1-15/16"	49-57-1937	4-5/8"	49-57-4620
2"	49-57-2000	4-3/4"	49-57-4750
2-1/16"	49-57-2060	5"	49-57-5000
2-1/8"	49-57-2120	5-1/2"	49-57-5500
2-1/4"	49-57-2250	6"	49-57-6000
2-5/16"	49-57-2310		

ARBORS



#3 Morse Taper Arbor 49-57-0010	3/4" Shank Arbor 49-57-0030
<ul style="list-style-type: none"> ▪ Works with threaded STEEL HAWG® cutters ▪ Use with motors 4292-1 and 4297-1 	<ul style="list-style-type: none"> ▪ Works with threaded STEEL HAWG® cutters ▪ Use with 4262-1 motor
Includes: <ul style="list-style-type: none"> ▪ Oil hose and hand pump 	Includes: <ul style="list-style-type: none"> ▪ Oil hose and hand pump

QUICK CHANGE TANG STEEL HAWG® CUTTERS

FAST CUTTING

- Alternating tooth geometry for up to 3X faster cutting

LONG LIFE

- Hardened carbide steel teeth provide longer life

QUICK CHANGE

- Tool-free operation for fast changes

1" CUTTING DEPTH



Size	Part Number	Size	Part Number
1/2"	49-57-0251	1-5/16"	49-57-1314
9/16"	49-57-0564	1-3/8"	49-57-1377
5/8"	49-57-0626	1-7/16"	49-57-1439
11/16"	49-57-0689	1-1/2"	49-57-1502
3/4"	49-57-0752	1-9/16"	49-57-1564
13/16"	49-57-0814	1-5/8"	49-57-1627
7/8"	49-57-0877	1-11/16"	49-57-1689
15/16"	49-57-0939	1-3/4"	49-57-1752
1"	49-57-1002	1-13/16"	49-57-1814
1-1/16"	49-57-1064	1-7/8"	49-57-1877
1-1/8"	49-57-1127	1-15/16"	49-57-1939
1-3/16"	49-57-1189	2"	49-57-2002
1-1/4"	49-57-1252		

ARBORS



#3 Morse Taper Quick Change Arbor 49-57-0012	#3 Morse Taper Quick Change Arbor w/Chip Breaker 49-57-0013	3/4" Straight Shank Quick Change Arbor 49-57-0032
<ul style="list-style-type: none"> ▪ Works with quick-change tang STEEL HAWG® cutters ▪ Use with motors 4292-1 and 4297-1 	<ul style="list-style-type: none"> ▪ Works with quick-change tang STEEL HAWG® cutters ▪ Use with motors 4292-1 and 4297-1 	<ul style="list-style-type: none"> ▪ Works with quick-change tang STEEL HAWG® cutters ▪ Use with 4262-1 motor
Includes: <ul style="list-style-type: none"> ▪ Oil hose and hand pump 	Includes: <ul style="list-style-type: none"> ▪ Oil hose and hand pump 	Includes: <ul style="list-style-type: none"> ▪ Oil hose and hand pump

ONE PIECE STEEL HAWG® CUTTERS

1/2" CUTTING DEPTH

- Recommended for use with Milwaukee® electromagnetic drill presses or hand drill

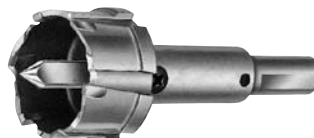

Size	Part Number
11/16"	49-57-8068
13/16"	49-57-8081
Pilot Bit	49-57-0038

CARBIDE TOOTH CUTTERS FOR SHEET METAL

CLEAN HOLES

- Drills burr-free holes
- Specifically designed for hand held applications to produce drill press quality holes

LONG LIFE

- Carbide tips stay sharper longer than high-speed steel or bi-metal cutters

VERSATILE

- For material up to 3/16" thick
- Ideal for stainless steel, structural steel studs and electrical boxes



Size	Metric	Part Number
3/4"	19 mm	49-57-8305
7/8"	22 mm	49-57-8309
1"	25 mm	49-57-8311
1-1/8"	29 mm	49-57-8315
1-7/32"	31 mm	49-57-8317
1-1/4"	32 mm	49-57-8319
1-5/16"	33 mm	49-57-8321
1-3/8"	35 mm	49-57-8323
1-7/16"	37 mm	49-57-8325
1-1/2"	38 mm	49-57-8327
1-3/4"	44 mm	49-57-8329
2"	51 mm	49-57-8331
2-1/8"	54 mm	49-57-8333
2-1/4"	57 mm	49-57-8335
2-3/8"	60 mm	49-57-8337
2-1/2"	64 mm	49-57-8339
2-5/8"	67 mm	49-57-8341
3"	76 mm	49-57-8343

SHEET METAL CARBIDE TOOTH CUTTER KITS



5 Pc Electrician's Kit 49-22-8300	7 Pc Electrician's Kit 49-22-8310
Includes: <ul style="list-style-type: none"> 7/8", 1-1/8", 1-3/8" carbide steel plate cutters Arbor with pilot bit and one additional pilot bit 	Includes: <ul style="list-style-type: none"> 7/8", 1-1/8", 1-3/8", 1-3/4" & 2" carbide sheet metal cutters Arbor with pilot bit and one additional pilot bit

CARBIDE TOOTH CUTTERS FOR STEEL PLATE

CLEAN HOLES

- Drills burr-free holes

LONG LIFE

- Carbide tips stay sharper longer than high-speed steel or bi-metal cutters

VERSATILE

- For material up to 1/2" thick
- Ideal for stainless steel, structural steel studs and electrical boxes



Size	Metric	Part Number
11/16"	18 mm	49-57-8201
3/4"	19 mm	49-57-8203
13/16"	21 mm	49-57-8205
7/8"	22 mm	49-57-8207
15/16"	24 mm	49-57-8209
1"	25 mm	49-57-8211
1-1/16"	27 mm	49-57-8213
1-1/8"	29 mm	49-57-8215
1-3/16"	30 mm	49-57-8217
1-1/4"	32 mm	49-57-8219
1-5/16"	33 mm	49-57-8221
1-3/8"	35 mm	49-57-8223
1-7/16"	37 mm	49-57-8225
1-1/2"	38 mm	49-57-8227

STEEL PLATE CARBIDE TOOTH CUTTER KITS



5 Pc Contractor's Kit 49-22-8200	7 Pc Contractor's Kit 49-22-8210
Includes: <ul style="list-style-type: none"> 11/16", 13/16" & 15/16" carbide steel plate cutters Arbor with pilot bit and one additional pilot bit 	Includes: <ul style="list-style-type: none"> 11/16", 13/16", 15/16", 1-1/8" & 1-3/8" carbide steel plate cutters Arbor with pilot bit and one additional pilot bit

ARBORS AND PILOT BITS FOR CARBIDE TOOTH CUTTERS

QUICK CHANGE ARBOR



Description	Part Number
Quick Change Arbor For All Carbide Cutters	49-57-0035
Pilot Bit For 49-57-0035 Quick Change Arbor	49-57-0038
Ejector Spring For 49-57-0035 Quick Change Arbor	40-50-8780

RETRACTABLE PIN ARBOR



Description	Part Number
Centering Pin Arbor With Detachable Drill Cap*	49-57-0037
Drill Cap For 49-57-0037 Quick Change Arbor*	42-52-1015

*Drill cap is for drilling a pilot hole if used in a hand held application

WOOD BORING SELECTION GUIDE

- Identify the material to be cut in the columns below
- Follow the column down to find **BEST PERFORMANCE** or **ACCEPTABLE PERFORMANCE**

	CLEAN WOOD	WOOD WITH NAILS	HOLE FINISH	FAST DRILLING	DRILLS POCKET HOLES	WIRE PULLING	IMPACT RATED
PG. 52 SELFEED BIT			ROUGH				
PG. 54 BIG HAWG®							
PG. 54 SHIP AUGER							
PG. 55 SPUR AUGER							
PG. 55 SPEED FEED™							
PG. 55 FLAT BORING							
PG. 56 BRAD POINT							
PG. 56 FORSTNER			FINE				
PG. 56 BELLHANGER							
PG. 56 CABLE							

SWITCHBLADE™ SELFEED BITS

LONG LIFE

- Cutting edge is replaceable, made with hardened steel to increase bit life

FAST DRILLING

- Aggressive feed screw design allows the bit to pull through the wood faster

EASY SIZE REFERENCE

- Bit and blades are engraved with quick and easy size identification

SWITCHBLADE™



Size	Part Number	Qty	Shank Type	Entrance For Pipe and Rigid Conduit	Entrance For Tubing
1-3/8"	48-25-5120	1	7/16" Hex	1"	1-1/4"
1-1/2"	48-25-5125	1	7/16" Hex		1-3/8"
2"	48-25-5135	1	7/16" Hex	1-1/2"	1-7/8"
2-1/8"	48-25-5140	1	7/16" Hex		2"
2-1/4"	48-25-5143	1	7/16" Hex		2-1/8"
2-9/16"	48-25-5150	1	7/16" Hex	2"	2-1/2"

SWITCHBLADE™ SELFEED BIT KIT



5 Pc SWITCHBLADE™ Plumber's Kit
49-22-5100

Includes:

- (1) Each SWITCHBLADE™ selffeed bits (1-3/8", 1-1/2", 2-1/8", 2-9/16")
- (1) 5-1/2" QUIK-LOK™ extension
- (1) Each replacement blades
- (4) Feed screws
- (4) Set screws
- (1) Hex wrench
- Case with bulk storage container

SWITCHBLADE™ REPLACEMENT BLADES

Size	Part Number	Qty	Size	Part Number	Qty
1-3/8"	48-25-5420	1	2-1/8"	48-25-5240	3*
1-1/2"	48-25-5425	1	2-9/16"	48-25-5250	3*
2"	48-25-5435	1	1-3/8"	48-25-5320	10*
2-1/8"	48-25-5440	1	1-1/2"	48-25-5325	10*
2-1/4"	48-25-5443	1	2"	48-25-5335	10*
2-9/16"	48-25-5450	1	2-1/8"	48-25-5340	10*
1-3/8"	48-25-5220	3*	2-9/16"	48-25-5350	10*
1-1/2"	48-25-5225	3*			
2"	48-25-5235	3*			

*Includes hex wrench and case



Replacement Feedscrew Pack
48-25-5275



SWITCHBLADE™ Accessory Service Kit
48-25-5280

STANDARD SELFEEED BITS

FAST DRILLING

- Aggressive feed design allows the bit to pull through the wood faster

CLEAN HOLES

- Alloy steel kerf cutters provide clean holes

RESHARPENABLE

- Cutting edge can be resharpened



Size	Part Number	Qty	Shank Type	Entrance For Pipe and Rigid Conduit	Entrance For Tubing	Package Type
1"	48-25-1001	1	7/16" Hex	1/2"	7/8"	Carton
1"	48-25-1002	1	7/16" Hex	1/2"	7/8"	Clamshell
1-1/8"	48-25-1121	1	7/16" Hex	1/2"	1"	Carton
1-1/8"	48-25-1122	1	7/16" Hex	1/2"	1"	Clamshell
1-1/4"	48-25-1251	1	7/16" Hex	3/4"	1-1/8"	Carton
1-1/4"	48-25-1252	1	7/16" Hex	3/4"	1-1/8"	Clamshell
1-3/8"	48-25-1371	1	7/16" Hex	1"	1-1/4"	Carton
1-3/8"	48-25-1372	1	7/16" Hex	1"	1-1/4"	Clamshell
1-1/2"	48-25-1501	1	7/16" Hex		1-3/8"	Carton
1-1/2"	48-25-1502	1	7/16" Hex		1-3/8"	Clamshell
1-3/4"	48-25-1751	1	7/16" Hex	1-1/4"	1-1/2"	Carton
1-3/4"	48-25-1752	1	7/16" Hex	1-1/4"	1-1/2"	Clamshell
2"	48-25-2001	1	7/16" Hex	1-1/2"	1-7/8"	Carton
2"	48-25-2002	1	7/16" Hex	1-1/2"	1-7/8"	Clamshell
2-1/8"	48-25-2121	1	7/16" Hex		2"	Carton
2-1/8"	48-25-2122	1	7/16" Hex		2"	Clamshell
2-1/4"	48-25-2251	1	7/16" Hex		2-1/8"	Carton
2-1/4"	48-25-2252	1	7/16" Hex		2-1/8"	Clamshell
2-9/16"	48-25-2561	1	7/16" Hex	2"	2-1/2"	Carton
2-9/16"	48-25-2562	1	7/16" Hex	2"	2-1/2"	Clamshell
3"	48-25-3001	1	3-Flat	2-1/2"	2-7/8"	Carton
3-5/8"	48-25-3621	1	3-Flat	3"	3-1/2"	Carton
4-1/8"	48-25-4125	1	3-Flat	3**		Carton
4-5/8"	48-25-4621	1	3-Flat	4"	4-1/2"	Carton

STANDARD SELFEEED BIT KITS

7 Pc Plumber's Kit 49-22-0065	7 Pc Contractor's Kit 49-22-0130	4 Pc Contractor's Kit 49-22-0135
Includes: <ul style="list-style-type: none"> (1) Each augers (7/8", 1-1/8", 1-1/4", 1-1/2") (1) Each selffeed bits (1-3/4", 2-1/8", 2-9/16") (1) 5-1/2" Hex key extension 	Includes: <ul style="list-style-type: none"> (2) Each augers (7/8", 1-1/8", 1-1/4", 1-1/2") (1) Each selffeed bits (1", 1-1/8", 1-1/4", 1-1/2", 1-3/4", 2-1/8", 2-9/16") (1) 5-1/2" Hex key extension 	Includes: <ul style="list-style-type: none"> (1) Each selffeed bits (1-3/8", 1-1/2", 2-1/8", 2-9/16") (1) 5-1/2" Hex key extension

STANDARD SELFEEED BIT ACCESSORIES

Small Standard Selffeed Bit Accessory Kit 48-25-6000	Coarse Thread Feed Screw for Selffeed Bit 48-28-6870	1/8" Hex Wrench for Selffeed Bit 49-96-0060
Includes set screws, feed screws and hex key for sizes: <ul style="list-style-type: none"> 1" - 2-9/16" 	Includes feed screw for sizes: <ul style="list-style-type: none"> 1" - 2-9/16" 	Includes hex wrench for sizes: <ul style="list-style-type: none"> 1" - 2-9/16"
Large Standard Selffeed Bit Accessory Kit 48-25-7000	Replacement Feed Screw for Selffeed Bit 48-28-6880	5/32" Hex Wrench for Selffeed Bit 49-96-0070
Includes set screws, feed screws and hex key for sizes: <ul style="list-style-type: none"> 3" - 4-5/8" 	Includes feed screw for sizes: <ul style="list-style-type: none"> 3" - 4-5/8" 	Includes hex wrench for sizes: <ul style="list-style-type: none"> 3" - 4-5/8"

EXTENSIONS

UNIVERSAL FIT

- All extensions work with all major brands

QUIK-LOK™ EXTENSIONS

- Fits any 1/4" or 7/16" hex shank product
- Impact rated for maximum durability
- Releases by hand for quick operation



HEX WRENCH



QUIK-LOK™

Part Number	Shank Size	Length	Type	Accepts Shank Size
48-28-1000	1/4"	3"	QUIK-LOK™	1/4"
48-28-1010	1/4"	6"	QUIK-LOK™	1/4"
48-28-1020	1/4"	12"	QUIK-LOK™	1/4"
48-28-4008	3/8"	12"	Hex Wrench	3/8"
48-28-1030	7/16"	5-1/2"	QUIK-LOK™	7/16"
48-28-1040	7/16"	12"	QUIK-LOK™	7/16"
48-28-1050	7/16"	18"	QUIK-LOK™	7/16"
48-28-1060	7/16"	24"	QUIK-LOK™	7/16"
48-28-4001	7/16"	5-1/2"	Hex Wrench	7/16"
48-28-4006	7/16"	12"	Hex Wrench	7/16"
48-28-4011	7/16"	18"	Hex Wrench	7/16"
48-28-4016	7/16"	24"	Hex Wrench	7/16"



Nothing but **HEAVY DUTY.**

BIG HAWG™ HOLE CUTTERS

FAST CUTTING

- Aggressive tooth geometry for up to 10X faster cutting than hole saws

LONG LIFE

- Cuts up to 600 holes in wood without needing to be resharpened

DURABLE

- Three hardened steel teeth provide maximum durability against unintended nail impacts

EASY PLUG REMOVAL

- Wide and deep gullets for easy plug removal

Size	Part Number	With Pilot Bit
1-3/8"	49-56-8995	49-56-9110
2-1/8"	49-56-9000	49-56-9120
2-1/4"	49-56-9005	-
2-9/16"	49-56-9010	49-56-9130
3"	49-56-9020	-
3-3/8"	49-56-9025	-

Size	Part Number	With Pilot Bit
3-5/8"	49-56-9030	-
4-1/4"	49-56-9045	-
4-5/16"	49-56-9047	-
4-5/8"	49-56-9050	-
5-1/4"	49-56-9055	-
6-1/4"	49-56-9065	-

BIGHAWG™



UP TO
10x
FASTER THAN
HOLE SAWS

UP TO
600
HOLES WITHOUT
RESHARPENING

BIG HAWG™ HOLE CUTTER KITS



7 Pc BIG HAWG™ Hole Cutter Kit 49-56-9075	8 Pc Plumbers BIG HAWG™ Hole Cutter Kit 49-56-9080	10 Pc BIG HAWG™ Hole Cutter Kit 49-56-9085
Includes: <ul style="list-style-type: none"> (1) Each BIG HAWG™ hole cutters (2-1/8", 2-9/16", 3-5/8") (1) Arbor with pilot bit (2) Additional pilot bits (1) Diamond file (1) Hex wrench 	Includes: <ul style="list-style-type: none"> (1) Each BIG HAWG™ hole cutters (2-1/8", 2-9/16", 3-5/8", 4-5/8") (1) Arbor with pilot bit (2) Additional pilot bits (1) Diamond file (1) Hex wrench 	Includes: <ul style="list-style-type: none"> (1) Each BIG HAWG™ hole cutters (2-1/8", 2-1/4", 2-9/16", 3", 3-5/8", 4-1/4") (1) Arbor with pilot bit (2) Additional pilot bits (1) Diamond file (1) Hex wrench

BIG HAWG™ HOLE CUTTER ACCESSORIES

Description	Part Number
BIG HAWG™ File	48-09-5055
BIG HAWG™ Pilot Bit	48-27-1401
BIG HAWG™ Hole Cutter Arbor	49-56-9105

SHIP AUGERS

DURABLE

- Hardened tip for added nail durability

FAST CHIP REMOVAL

- Coated flutes for fast chip removal

IMPACT RATED



Size	Part Number	Shank	Overall Length	Twist Length
3/8"	48-13-0373	5/16"	6"	3"
1/2"	48-13-0503	5/16"	6"	3"
5/8"	48-13-0623	7/16"	6"	3"
11/16"	48-13-0683	7/16"	6"	3"
3/4"	48-13-0753	7/16"	6"	3"
13/16"	48-13-0813	7/16"	6"	3"
7/8"	48-13-0873	7/16"	6"	3"
15/16"	48-13-0933	7/16"	6"	3"
1"	48-13-1003	7/16"	6"	3"
1-1/16"	48-13-1063	7/16"	6"	3"
1-1/8"	48-13-1123	7/16"	6"	3"
1-1/4"	48-13-1253	7/16"	6"	3"
1-3/8"	48-13-1373	7/16"	6"	3"
1-1/2"	48-13-1503	7/16"	6"	3"

Size	Part Number	Shank	Overall Length	Twist Length
3/8"	48-13-5500	5/16"	18"	15"
7/16"	48-13-5520	5/16"	18"	15"
1/2"	48-13-5540	5/16"	18"	15"
9/16"	48-13-5560	7/16"	18"	15"
5/8"	48-13-5620	7/16"	18"	15"
11/16"	48-13-5680	7/16"	18"	15"
3/4"	48-13-5750	7/16"	18"	15"
13/16"	48-13-5810	7/16"	18"	15"
7/8"	48-13-5870	7/16"	18"	15"
15/16"	48-13-5930	7/16"	18"	15"
1"	48-13-6000	7/16"	18"	15"
1-1/16"	48-13-6010	7/16"	18"	15"
1-1/8"	48-13-6120	7/16"	18"	15"
1-1/4"	48-13-6250	7/16"	18"	15"
1-3/8"	48-13-6370	7/16"	18"	15"
1-1/2"	48-13-6500	7/16"	18"	15"



SHIP AUGER SET

3 Pc Ship Auger Bit Set (18") 49-13-3000
Includes: <ul style="list-style-type: none"> 1/2", 3/4", 1"



DRILLING ACCESSORIES

SPUR AUGERS

CLEAN HOLES

- Double wing spurs for clean hole cutting



FAST CHIP REMOVAL

- Coated flutes for fast chip removal



IMPACT RATED

Size	Part Number	Shank	Overall Length	Twist Length
1/2"	48-13-0700	5/16"	6-1/2"	4"
5/8"	48-13-0725	7/16"	6-1/2"	4"
3/4"	48-13-0750	7/16"	6-1/2"	4"
7/8"	48-13-0870	7/16"	6-1/2"	4"
1"	48-13-1000	7/16"	6-1/2"	4"
1-1/8"	48-13-1120	7/16"	6-1/2"	4"
1-1/4"	48-13-1250	7/16"	6-1/2"	4"
1-3/8"	48-13-1370	7/16"	6-1/2"	4"
1-1/2"	48-13-1500	7/16"	6-1/2"	4"

SPUR AUGER SET



4 Pc Spur Auger Bit Set (6-1/2")
48-13-4000

Includes:

- 1/2", 3/4", 7/8", 1"

SPEED FEED™ SELF-FEEDING WOOD BITS

FAST CUTTING

- Up to 10X faster than flat boring bits

CLEAN HOLES

- Double wing spurs for clean hole cutting

FAST CHIP REMOVAL

- Coated flutes for fast chip removal



Size	Part Number
1/2"	48-13-0048
5/8"	48-13-0058
3/4"	48-13-0068
7/8"	48-13-0078
1"	48-13-0088
1-1/4"	48-13-0108

SPEED FEED™

SPEED FEED™ SELF-FEEDING WOOD BIT SET

4 Pc Speed Feed™ Self-Feeding Wood Bit Set
48-13-0400

Includes:

- 1/2", 5/8", 3/4", 1"

FLAT BORING BITS

FAST CUTTING

- Cutting edge designed for fast, easy wood boring

CLEAN HOLES

- Double wing spurs for clean hole cutting

Size	Part Number	Length
1/2"	48-27-0070	3-1/2"
5/8"	48-27-0075	3-1/2"
3/4"	48-27-0080	3-1/2"
7/8"	48-27-0085	3-1/2"
15/16"	48-27-0090	3-1/2"
1"	48-27-0095	3-1/2"
1-1/8"	48-27-0100	3-1/2"
1-1/4"	48-27-0200	3-1/2"
1-1/2"	48-27-0205	3-1/2"
1/4"	48-27-0251	6"
5/16"	48-27-0311	6"

Size	Part Number	Length
3/8"	48-27-0371	6"
7/16"	48-27-0441	6"
1/2"	48-27-0501	6"
9/16"	48-27-0561	6"
5/8"	48-27-0621	6"
11/16"	48-27-0681	6"
3/4"	48-27-0751	6"
13/16"	48-27-0811	6"
7/8"	48-27-0871	6"
15/16"	48-27-0941	6"
1"	48-27-1001	6"

Size	Part Number	Length
1-1/8"	48-27-1121	6"
1-1/4"	48-27-1251	6"
1-3/8"	48-27-1371	6"
1-1/2"	48-27-1501	6"
3/8"	48-27-0170	16"
1/2"	48-27-0175	16"
5/8"	48-27-0180	16"
3/4"	48-27-0185	16"
7/8"	48-27-0190	16"
1"	48-27-0195	16"



FLAT BORING BIT SETS



6 Pc Stubby Flat Boring Bit Set
(3-1/2")
49-22-0185

Includes:

- 3/4", 7/8", 15/16", 1", 1-1/8" and 6" QUIK-LOK™ extension



8 Pc Universal QUIK-LOK™
Flat Boring Set (6")
49-22-0175

Includes:

- 3/8", 1/2", 5/8", 3/4", 7/8", 1", 1-1/8", and 6" QUIK-LOK™ extension



6 Pc Flat Boring Bit Kit (6")
49-22-0071

Includes:

- 3/8", 1/2", 5/8", 3/4", 7/8", 1"

BELLHANGER BITS

VERSATILE

- Wire pulling hole for easy wire installation

FAST CHIP REMOVAL

- Coated flutes for fast chip removal

NO SPIN

- 3-Flat shank holds bit secure in drill chuck

Size	Part Number	Length
1/4"	48-13-7125	12"
5/16"	48-13-7131	12"
3/8"	48-13-7137	12"
3/16"	48-13-7218	18"
1/4"	48-13-7225	18"
5/16"	48-13-7231	18"
3/8"	48-13-7237	18"
7/16"	48-13-7243	18"
1/2"	48-13-7249	18"
1/4"	48-13-7325	24"
3/8"	48-13-7337	24"



CABLE BITS

FLEXIBLE

- Flexible steel shaft allows user to reach areas between or behind walls

VERSATILE

- Wire pulling holes at both ends for easy wire installation



Size	Part Number	Length
3/8"	48-13-8237	54"
1/2"	48-13-8250	54"
9/16"	48-13-8256	54"
3/4"	48-13-8275	54"
3/8"	48-13-8337	72"
1/2"	48-13-8350	72"
9/16"	48-13-8356	72"
3/4"	48-13-8375	72"

Placement Guide

48-08-0275



BRAD POINT BITS

EASY VISUAL REFERENCE

- 1/4" depth marks for easy identification

ACCURATE, CLEAN HOLES

- Brad point style tip for accurate hole placement

LONG LASTING

- Precision ground tip maintains a sharp cutting edge

Size	Part Number
1/8"	48-15-0125
3/16"	48-15-0185
1/4"	48-15-0250
5/16"	48-15-0312
3/8"	48-15-0375
7/16"	48-15-0437
1/2"	48-15-0500



FORSTNER BITS

ACCURATE HOLES

- Precision ground kerf cutters create accurate holes

CLEAN HOLE FINISH

- Polished surface finish makes very clean, flat holes

PRECISION CONTROL

- Round shank style reduces runout for more precise holes

Size	Part Number
3/8"	48-14-0376
1/2"	48-14-0501
5/8"	48-14-0626
3/4"	48-14-0751
1"	48-14-1001
1-3/8"	48-14-1374
35 mm	48-14-1376



FORSTNER BIT SET



4 Pc Forstner Bit Set
48-14-0004

Includes:

- 1/4", 1/2", 5/8", 3/4"

MASONRY DRILLING

HAMMER DRILL BITS

FASTER DRILLING

- Unique flute geometry provides efficient dust and debris removal

STARTS ON CONTACT

- Patented self-centering carbide tip maintains hole placement

NO SPIN

- 3-Flat shank holds bit secure in drill chuck

Useable Length

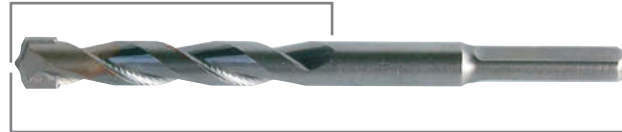

Overall Length

Size	Part Number	Useable Length	Overall Length	Pack Qty	Size	Part Number	Useable Length	Overall Length	Pack Qty
1/8"	48-20-8800	1-1/2"	3"	2	3/4"	48-20-8845	4"	6"	1
5/32"	48-20-8801	4"	6"	2	3/4"	48-20-8846	10"	12"	1
3/16"	48-20-8805	2"	4"	2	7/8"	48-20-8847	4"	6"	1
3/16"	48-20-8806	4"	6"	2	7/8"	48-20-8848	10"	12"	1
1/4"	48-20-8810	2"	4"	1	1"	48-20-8849	4"	6"	1
1/4"	48-20-8811	4"	6"	1	1"	48-20-8854	10"	12"	1
1/4"	48-20-8812	10"	12"	1	3/16"	48-20-8957	4"	6"	5
5/16"	48-20-8816	4"	6"	1	1/4"	48-20-8961	2"	4"	5
5/16"	48-20-8817	10"	12"	1	1/4"	48-20-8962	4"	6"	5
3/8"	48-20-8821	4"	6"	1	1/8"	48-20-8900	1-1/2"	3"	25
3/8"	48-20-8822	10"	12"	1	5/32"	48-20-8901	4"	6"	25
3/8"	48-20-8823	16"	18"	1	3/16"	48-20-8905	2"	4"	25
7/16"	48-20-8825	4"	6"	1	3/16"	48-20-8906	4"	6"	25
1/2"	48-20-8830	4"	6"	1	1/4"	48-20-8910	2"	4"	25
1/2"	48-20-8831	10"	12"	1	1/4"	48-20-8911	4"	6"	25
1/2"	48-20-8832	16"	18"	1	5/16"	48-20-8916	4"	6"	25
9/16"	48-20-8835	4"	6"	1	3/8"	48-20-8921	4"	6"	20
5/8"	48-20-8840	4"	6"	1	7/16"	48-20-8925	4"	6"	20
5/8"	48-20-8841	10"	12"	1	1/2"	48-20-8930	4"	6"	15
5/8"	48-20-8842	16"	18"	1	5/8"	48-20-8940	4"	6"	10

HAMMER DRILL BIT SETS

3 Pc 3-Flat SECURE-GRIP™ Hammer Drill Bit Set 48-20-8850	5 Pc 3-Flat SECURE-GRIP™ Hammer Drill Bit Set 48-20-8851
Includes: <ul style="list-style-type: none"> ■ 5/32" x 6" ■ 3/16" x 6" ■ 1/4" x 6" 	Includes: <ul style="list-style-type: none"> ■ 5/32" x 6" ■ 3/16" x 6" ■ 1/4" x 6" ■ 5/16" x 6" ■ 3/8" x 6"
6 Pc 3-Flat SECURE-GRIP™ Hammer Drill Bit Set 48-20-8856	7 Pc 3-Flat SECURE-GRIP™ Hammer Drill Bit Set 48-20-8852
Includes: <ul style="list-style-type: none"> ■ (2) 1/4" x 6" ■ 5/32" x 6" ■ 3/16" x 6" ■ 5/16" x 6" ■ 3/8" x 6" 	Includes: <ul style="list-style-type: none"> ■ (2) 3/16" x 6" ■ (2) 1/4" x 6" ■ 5/32" x 6" ■ 5/16" x 6" ■ 3/8" x 6"

SDS+ ROTARY HAMMER BITS

4-CUTTER PREMIUM MX4 SDS+ CARBIDE BITS

LONG LIFE

- 4-Cutter solid carbide tip for up to 3X life in rebar



ACCURATE HOLES

- Centering tip and 4-Cutter design drills more accurate holes for anchoring applications

Size	Useable Length	Overall Length	Individual Part Number	Bulk Part Number	Bulk Qty
3/16"	2"	4"	48-20-7310	-	-
3/16"	4"	6"	48-20-7311	48-20-7911	15
3/16"	6"	8"	48-20-7312	-	-
3/16"	8"	10"	48-20-7313	-	-
3/16"	10"	12"	48-20-7314	-	-
1/4"	2"	4"	48-20-7330	-	-
1/4"	4"	6"	48-20-7331	48-20-7931	15
1/4"	6"	8"	48-20-7332	-	-
1/4"	8"	10"	48-20-7334	-	-
1/4"	10"	12"	48-20-7335	-	-
5/16"	4"	6"	48-20-7341	-	-
3/8"	4"	6"	48-20-7351	48-20-7951	10
3/8"	10"	12"	48-20-7354	-	-
3/8"	16"	18"	48-20-7357	-	-
1/2"	4"	6"	48-20-7371	48-20-7971	10
1/2"	10"	12"	48-20-7374	-	-
1/2"	16"	18"	48-20-7377	-	-

4-CUTTER SDS+ BITS

DURABLE

- 4-Cutter design lasts longer when encountering small diameter rebar and mesh

ACCURATE STARTS

- Centering point ensures correct hole placement

FASTER DRILLING

- Unique face design directs dust through the 4 fluted spiral for faster drilling

Size	Part Number	Useable Length	Overall Length
5/8"	48-20-7200	6"	8"
5/8"	48-20-7203	10"	12"
5/8"	48-20-7206	16"	18"
3/4"	48-20-7210	6"	8"
3/4"	48-20-7215	10"	12"
3/4"	48-20-7220	16"	18"
7/8"	48-20-7225	6"	8"
7/8"	48-20-7230	10"	12"
7/8"	48-20-7236	16"	18"
1"	48-20-7240	8"	10"
1"	48-20-7246	16"	18"
1-1/8"	48-20-7250	8"	10"
1-1/8"	48-20-7256	16"	18"

SDS+ ROTARY HAMMER BITS

2-CUTTER SDS+ CARBIDE BITS

ACCURATE STARTS

- Centering point ensures correct hole placement

FAST DRILLING

- Chisel shaped head for fast drilling in hard materials
- High volume flute entrance quickly channels debris to the flute

4 FLUTED SPIRAL IN SMALL DIAMETERS

- Fast debris removal
- Minimizes bending and breaking
- Minimizes vibrations



Size	Useable Length	Overall Length	Individual Part Number	Bulk Part Number	Bulk Qty	Monster Pack Part Number	Qty
5/32"	2"	4-1/2"	48-20-7400	48-20-7500	25	-	-
5/32"	4"	6"	48-20-7401	48-20-7501	25	-	-
3/16"	2"	4-1/2"	48-20-7410	48-20-7510	25	48-20-7810	200
3/16"	4"	6"	48-20-7411	48-20-7511	25	48-20-7811	200
3/16"	6"	8"	48-20-7412	48-20-7512	25	-	-
3/16"	8"	10"	48-20-7413	48-20-7513	25	-	-
3/16"	10"	12"	48-20-7414	48-20-7514	25	-	-
3/16"	12"	14"	48-20-7415	48-20-7515	25	-	-
3/16"	14"	16"	48-20-7416	48-20-7516	25	-	-
7/32"	4"	6"	48-20-7421	48-20-7521	25	-	-
7/32"	6"	8"	48-20-7422	48-20-7522	25	-	-
7/32"	9"	11"	48-20-7424	48-20-7524	25	-	-
7/32"	12"	14"	48-20-7425	48-20-7525	25	-	-
7/32"	14"	16"	48-20-7426	48-20-7526	25	-	-
1/4"	2"	4-1/2"	48-20-7430	48-20-7530	25	48-20-7830	200
1/4"	4"	6"	48-20-7431	48-20-7531	25	48-20-7831	200
1/4"	6"	8"	48-20-7432	48-20-7532	25	-	-
1/4"	9"	11"	48-20-7434	48-20-7534	25	-	-
1/4"	12"	14"	48-20-7435	48-20-7535	25	-	-
1/4"	14"	16"	48-20-7436	48-20-7536	25	-	-
1/4"	18"	20"	48-20-7438	-	-	-	-
5/16"	4"	6"	48-20-7441	48-20-7541	25	48-20-7841	150
5/16"	10"	12"	48-20-7444	-	-	-	-
3/8"	4"	6"	48-20-7451	48-20-7551	20	48-20-7851	125
3/8"	6"	8"	48-20-7452	-	-	-	-
3/8"	8"	10"	48-20-7453	-	-	-	-
3/8"	10"	12"	48-20-7454	48-20-7554	20	-	-
3/8"	16"	18"	48-20-7457	-	-	-	-
3/8"	22"	24"	48-20-7459	-	-	-	-

Size	Useable Length	Overall Length	Individual Part Number	Bulk Part Number	Bulk Qty	Monster Pack Part Number	Qty
7/16"	4"	6"	48-20-7461	-	-	-	-
7/16"	10"	12-1/2"	48-20-7464	-	-	-	-
7/16"	16"	18"	48-20-7467	-	-	-	-
1/2"	4"	6"	48-20-7471	48-20-7571	15	48-20-7871	100
1/2"	8"	10"	48-20-7473	-	-	-	-
1/2"	10"	12"	48-20-7474	48-20-7574	15	-	-
1/2"	16"	18"	48-20-7477	-	-	-	-
1/2"	22"	24"	48-20-7479	-	-	-	-
9/16"	4"	6-1/2"	48-20-7481	-	-	-	-
9/16"	10"	12-1/2"	48-20-7484	-	-	-	-
9/16"	16"	18"	48-20-7487	-	-	-	-
5/8"	4"	6"	48-20-7601	-	-	-	-
5/8"	6"	8"	48-20-7602	48-20-7702	10	-	-
5/8"	10"	12"	48-20-7604	-	-	-	-
5/8"	16"	18"	48-20-7607	-	-	-	-
5/8"	22"	24"	48-20-7609	-	-	-	-
11/16"	6"	8"	48-20-7058	-	-	-	-
3/4"	6"	8"	48-20-7061	-	-	-	-
3/4"	8"	10"	48-20-7063	-	-	-	-
3/4"	10"	12"	48-20-7065	-	-	-	-
3/4"	16"	18"	48-20-7066	-	-	-	-
3/4"	22"	24"	48-20-7067	-	-	-	-
27/32"	6"	8"	48-20-7069	-	-	-	-
7/8"	6"	8"	48-20-7071	-	-	-	-
7/8"	10"	12"	48-20-7072	-	-	-	-
7/8"	16"	18"	48-20-7075	-	-	-	-
1"	8"	10"	48-20-7080	-	-	-	-
1"	16"	18"	48-20-7085	-	-	-	-

2-CUTTER SDS+ CARBIDE BIT SETS

5 Pc SDS+ Kit 48-20-7490	6 Pc SDS+ Kit 48-20-7495
Includes: <ul style="list-style-type: none"> 3/16" x 4-1/2" 1/4" x 6" 5/16" x 6" 3/8" x 6" 1/2" x 6" 	Includes: <ul style="list-style-type: none"> (2) 3/16" x 6" (2) 1/4" x 6" (1) 3/8" x 6" (1) 1/2" x 6"

2-CUTTER SDS+ BITS WITH HEX SHOULDER

- Fits hex 5/16" CONDRIVE™ sleeve for Tap-Con® screw system

Size	Useable Length	Overall Length	Individual Part Number	Bulk Part Number	Bulk Qty
5/32"	2"	5"	48-20-7090	-	-
5/32"	3"	6"	48-20-7096	48-20-7196	25
5/32"	4"	7"	48-20-7091	48-20-7191	25
3/16"	2"	5"	48-20-7097	-	-
3/16"	3"	6"	48-20-7098	48-20-7198	25
3/16"	4"	7"	48-20-7092	48-20-7192	25

SDS-MAX ROTARY HAMMER BITS

LONG LIFE

- Brazing formula optimizes drilling for up to 20% longer life

FAST DUST REMOVAL

- Unique flute geometry provides efficient dust removal

PRECISE ROUND HOLES

- Centering point and 4-Cutter design provide accurate and precise round holes



Size	Useable Length	Overall Length	2-Cutter Part Number	4-Cutter Part Number
1/2"	7-1/2"	13"	48-20-3902	-
1/2"	15-1/2"	21"	48-20-3904	-
9/16"	7-1/2"	13"	48-20-3910	-
9/16"	15-1/2"	21"	48-20-3912	-
5/8"	7-1/2"	13"	-	48-20-3916
5/8"	15-1/2"	21"	-	48-20-3918
5/8"	30-1/2"	36"	-	48-20-3922
11/16"	15-1/2"	21"	-	48-20-3926
3/4"	8"	13"	-	48-20-3930
3/4"	17"	21"	-	48-20-3932
3/4"	31"	36"	-	48-20-3936
13/16"	17"	21"	-	48-20-3938
7/8"	8"	13"	-	48-20-3944
7/8"	17"	21"	-	48-20-3946
1"	8"	13"	-	48-20-3952
1"	17"	21"	-	48-20-3954

Size	Useable Length	Overall Length	2-Cutter Part Number	4-Cutter Part Number
1"	31"	36"	-	48-20-3956
1-1/16"	18"	23"	-	48-20-3958
1-1/8"	12"	17"	-	48-20-3964
1-1/8"	17"	21"	-	48-20-3966
1-3/16"	18"	23"	-	48-20-3968
1-1/4"	10"	15"	-	48-20-3970
1-1/4"	18"	23"	-	48-20-3972
1-1/4"	31"	36"	-	48-20-3974
1-3/8"	18"	23"	-	48-20-3980
1-7/16"	18"	23"	-	48-20-3984
1-1/2"	18"	23"	-	48-20-3988
1-9/16"	18"	23"	-	48-20-3990
1-5/8"	18"	23"	-	48-20-3991
1-3/4"	18"	23"	-	48-20-3992
2"	18"	23"	-	48-20-3993

SPLINE ROTARY HAMMER BITS

LONG LIFE

- Brazing formula optimizes drilling for up to 20% longer life

FAST DUST REMOVAL

- Unique flute geometry provides efficient dust removal

ACCURATE PRECISE ROUND HOLES

- Centering point and 4-Cutter design provides accurate and precise round holes



Size	Useable Length	Overall Length	2-Cutter	4-Cutter
3/8"	5"	10"	48-20-4037	-
1/2"	5"	10"	48-20-4050	-
1/2"	11"	16"	48-20-4051	-
1/2"	17"	22"	48-20-4052	-
1/2"	22"	27"	48-20-4053	-
1/2"	31"	36"	48-20-4054	-
9/16"	5"	10"	48-20-4056	-
9/16"	18"	23"	48-20-4057	-
5/8"	5"	10"	48-20-4062	48-20-4300
5/8"	11"	16"	48-20-4063	48-20-4305
5/8"	17"	22"	48-20-4064	48-20-4310
5/8"	24"	29"	-	48-20-4315
5/8"	31"	36"	-	48-20-4320
11/16"	11"	16"	48-20-4068	48-20-4325
3/4"	5"	10"	48-20-4075	48-20-4330
3/4"	11"	16"	48-20-4076	48-20-4335
3/4"	17"	22"	48-20-4078	48-20-4340
3/4"	24"	29"	-	48-20-4345

Size	Useable Length	Overall Length	2-Cutter	4-Cutter
3/4"	31"	36"	-	48-20-4350
13/16"	11"	16"	48-20-4081	-
7/8"	11"	16"	48-20-4087	48-20-4360
7/8"	17"	22"	48-20-4088	48-20-4365
1"	11"	16"	48-20-4100	48-20-4370
1"	17"	22"	48-20-4101	48-20-4375
1"	31"	36"	-	48-20-4380
1-1/8"	11"	16"	48-20-4112	48-20-4385
1-1/8"	17"	22"	48-20-4113	48-20-4390
1-1/4"	11"	16"	48-20-4125	48-20-4395
1-1/4"	17"	22"	48-20-4126	48-20-4400
1-1/4"	31"	36"	-	48-20-4405
1-3/8"	11"	16"	48-20-4137	-
1-3/8"	17"	22"	48-20-4138	48-20-4410
1-1/2"	11"	16"	48-20-4150	-
1-1/2"	17"	22"	48-20-4151	48-20-4415
1-3/4"	18"	23"	-	48-20-4418
2"	18"	23"	-	48-20-4419

SDS+ THIN WALL CARBIDE TIPPED CORE BITS

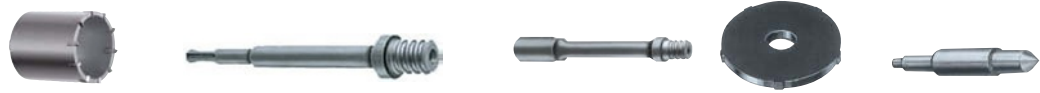

Size	Depth	Core Body w/ Guide Plate & Centering Pin*	8" SDS+ Adapter Shank	12" SDS+ Adapter Shank	7-1/2" Extension	Replacement Guide Plate	Replacement Centering Pin
1"	3-3/16"	48-20-5005*	48-03-3545	48-03-3551	48-95-6070	-	-
1-1/8"	3-3/16"	48-20-5010*	48-03-3545	48-03-3551	48-95-6070	-	-
1-1/4"	3-3/16"	48-20-5015	48-03-3545	48-03-3551	48-95-6070	48-20-6151	48-20-6150
1-3/8"	3-3/16"	48-20-5020	48-03-3545	48-03-3551	48-95-6070	48-20-6152	48-20-6150
1-1/2"	3-3/16"	48-20-5025	48-03-3545	48-03-3551	48-95-6070	48-20-6153	48-20-6150
1-3/4"	2-13/16"	48-20-5030	48-03-3555	48-03-3561	48-95-6075	48-20-6156	48-20-6155
2"	2-13/16"	48-20-5035	48-03-3555	48-03-3561	48-95-6075	48-20-6157	48-20-6155
2-1/2"	2-13/16"	48-20-5040	48-03-3555	48-03-3561	48-95-6075	48-20-6158	48-20-6155
3"	2-13/16"	48-20-5045	48-03-3555	48-03-3561	48-95-6075	48-20-6159	48-20-6155
3-1/2"	2-13/16"	48-20-5050	48-03-3555	48-03-3561	48-95-6075	48-20-6160	48-20-6155
4"	2-13/16"	48-20-5055	48-03-3555	48-03-3561	48-95-6075	48-20-6161	48-20-6155

*Guide plate and centering pin not included with 1" & 1-1/8" diameter core bits

SDS-MAX AND SPLINE THICK WALL CARBIDE TIPPED CORE BITS



	Size	Depth	Core Body w/ Guide Plate & Centering Pin	12" SPLINE Adapter Shank	18" SPLINE Adapter Shank	12" SDS-MAX Adapter Shank	18" SDS-MAX Adapter Shank	7-1/2" Extension	Replacement Guide Plate	Replacement Centering Pin
THICK WALL	1-1/2"	4-1/16"	48-20-5125	48-03-3564	48-03-3565	48-03-3572	48-03-3573	48-95-6085	48-20-5168	48-20-5199
	1-3/4"	4-1/16"	48-20-5130	48-03-3564	48-03-3565	48-03-3572	48-03-3573	48-95-6085	48-20-5169	48-20-5199
	2"	4-1/16"	48-20-5135	48-03-3564	48-03-3565	48-03-3572	48-03-3573	48-95-6085	48-20-5170	48-20-5199
	2-1/2"	4-1/16"	48-20-5140	48-03-3564	48-03-3565	48-03-3572	48-03-3573	48-95-6085	48-20-5171	48-20-5199
	3"	4-1/16"	48-20-5145	48-03-3564	48-03-3565	48-03-3572	48-03-3573	48-95-6085	48-20-5172	48-20-5199
	3-1/2"	4-1/16"	48-20-5150	48-03-3564	48-03-3565	48-03-3572	48-03-3573	48-95-6085	48-20-5173	48-20-5199
	4"	4-1/16"	48-20-5155	48-03-3564	48-03-3565	48-03-3572	48-03-3573	48-95-6085	48-20-5174	48-20-5199
	5"	4-1/16"	48-20-5160	48-03-3564	48-03-3565	48-03-3572	48-03-3573	48-95-6085	48-20-5175	48-20-5199
THIN WALL	5"	2-13/16"	48-20-5060	48-03-3540	-	48-03-3574	-	48-95-6075	48-20-6162	48-20-6155
	6"	2-13/16"	48-20-5065	48-03-3540	-	48-03-3574	-	48-95-6075	48-20-6163	48-20-6155

LHS SYSTEM

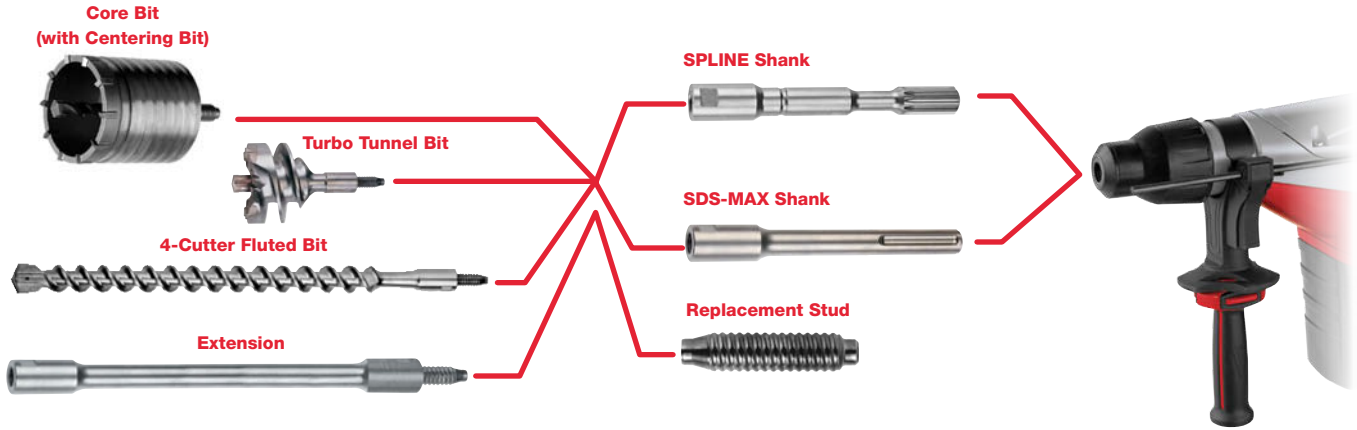

LHS 4-CUTTER FLUTED BITS



Size	Part Number	Depth
1-1/8"	48-20-5070	18"
1-1/4"	48-20-5071	18"

TURBO TUNNEL BITS

Size	Part Number	Depth
1-3/8"	48-20-5082	35 mm
1-1/2"	48-20-5083	40 mm
1-3/4"	48-20-5084	45 mm
2-1/8"	48-20-5085	55 mm
2-5/8"	48-20-5087	68 mm
3-1/8"	48-20-5089	80 mm



LHS REPLACEMENT PARTS

Description	Part Number
7" SPLINE Shank	48-20-5075
7-1/2" SDS-MAX Shank	48-20-5077
11" Extension	48-20-5079
2-1/2" Replacement Threaded Stud	48-20-5081

LHS THICK WALL CARBIDE-TIPPED CORE BITS

Size	Part Number	Depth	Metric
1-1/2"	48-20-5090	3"	40 mm
1-3/4"	48-20-5091	3"	45 mm
2-1/8"	48-20-5092	3"	55 mm
2-5/8"	48-20-5093	3"	68 mm
3-1/8"	48-20-5094	3"	80 mm
3-1/2"	48-20-5095	3"	90 mm
4"	48-20-5096	3"	100 mm
5"	48-20-5097	3"	120 mm
	48-20-5099	Replacement Centering Bit	



CARBIDE BIT ADAPTERS

Description	Part Number
SPLINE to "B" Taper Adapter	48-66-6503
SPLINE to "A" Taper Adapter	48-66-6502
SPLINE To SDS+ Bit Adapter	48-03-3015
SDS-MAX To SDS+ Bit Adapter	48-03-3025
SDS+ to 3-Jaw Chuck Adapter Kit	48-66-1370
SDS+ Dust Shield	48-03-3030

DEMOLITION HAMMER ACCESSORIES (SDS+, SDS-MAX, SPLINE, 3/4" HEX)

Type	Description	Size	SDS+			SDS-MAX (Slotted 18 mm Round)			SPLINE or Round Hex (3/4" Hex with 21/32" Round)			3/4" Hex		
			Individual Part Number	Bulk Part Number	Qty	Individual Part Number	Bulk Part Number	Qty	Individual Part Number	Bulk Part Number	Qty	Individual Part Number	Bulk Part Number	Qty
BULL POINT	Starts holes in concrete slabs, general chipping and breaking	10"	48-62-6010	48-62-6110	25	-	-	-	-	-	-	-	-	
		12"	-	-	-	48-62-4075	48-62-4175	25	48-62-2000	48-62-2100	25	48-62-3000	-	-
		18"	-	-	-	48-62-4077	48-62-4177	25	48-62-2010	48-62-2110	25	48-62-3005	-	-
FLAT CHISEL	General chipping and breaking	3/4" x 10"	48-62-6015	48-62-6115	25	-	-	-	-	-	-	-	-	
		1" x 12"	-	-	-	48-62-4079	48-62-4179	25	48-62-2020	48-62-2120	25	48-62-3010	48-62-3110	25
		1" x 18"	-	-	-	48-62-4081	48-62-4181	25	48-62-2030	48-62-2130	25	48-62-3015	-	-
SCALING CHISEL	Cleans concrete, scale, rust, cuts troughs and some asphalt	1-1/2" x 10"	48-62-6020	48-62-6120	25	-	-	-	-	-	-	-	-	
		1-1/2" x 12"	-	-	-	48-62-4082	-	-	48-62-2040	-	-	48-62-3020	-	-
		2" x 12"	-	-	-	48-62-4085	48-62-4185	25	48-62-2050	48-62-2150	25	48-62-3035	-	-
		3" x 12"	-	-	-	48-62-4087	48-62-4187	25	48-62-2055	48-62-2155	25	48-62-3030	48-62-3130	25
SCRAPING CHISEL	Scrapes surface rather than breaking material on top	2" x 12"	-	-	-	48-62-4089	-	-	48-62-2065	-	-	48-62-3025	-	-
SLOTTING TOOL	Breaks out the "web" between closely spaced drilled holes to make a large opening	1-1/4" x 15"	-	-	-	48-62-4073	-	-	-	-	-	-	-	
		1-1/2" x 12"	-	-	-	-	-	-	48-62-2060	-	-	-	-	
SEAM TOOL	Removes mortar between brick or block, cuts narrow channels	1" x 15"	-	-	-	48-62-4080	-	-	48-62-2080	-	-	-	-	
BUSHING TOOL - ONE PIECE	Removes excess concrete, produces exterior finish, roughens surface before surface coating	1-3/4" Sq. x 10-1/2"	-	-	-	48-62-4065	-	-	-	-	-	-	-	
		1-3/4" Sq. x 9-3/4"	-	-	-	-	-	-	48-62-2070	48-62-2170	15	48-62-3085	48-62-3185	15
ASPHALT CUTTER	Cuts asphalt or hard packed gravel (Do NOT use for concrete)	5" x 16-1/2"	-	-	-	48-62-4066	-	-	-	-	-	48-62-3090	-	
CLAY SPADE	Digging clay, hard packed gravel (Do NOT use for concrete)	4-1/2" x 16-5/8"	-	-	-	48-62-4068	48-62-4168	12	-	-	-	-	-	
		4-1/2" x 16-3/4"	-	-	-	-	-	-	48-62-2095	-	-	48-62-3040	48-62-3140	12
GROUND ROD DRIVER	Drives soft ground rods. Socket depth - 2-3/4", inner dia. - .906"	9-3/4"L - 5/8" & 3/4" Rod Dia.	-	-	-	48-62-4091	-	-	-	-	-	48-62-3070	-	
		10"L - 5/8" & 3/4" Rod Dia.	-	-	-	-	-	-	48-62-2046	-	-	-	-	
TAMPER PLATE SHANK	Used to mount tamper plate	12"	-	-	-	48-62-4092	-	-	48-62-2097	-	-	48-62-3065	-	
TAMPER PLATE	Compacts dirt, tamps asphalt	5" x 5"	-	-	-	48-62-3060	-	-	48-62-3060	-	-	48-62-3060	-	

DEMOLITION HAMMER ACCESSORIES (1-1/8" COLLARED HEX WITH NOTCH)

Type	Description	Size	Individual Part Number	Bulk Part Number	Qty
MOIL POINT	Starts holes in concrete slabs, general chipping and breaking	20"	48-62-4000	48-62-4100	8
NARROW CHISEL	General chipping and breaking	20-1/2"	48-62-4005	48-62-4105	8
CHISEL	Wide chisel with two 60° cutting angles cleans concrete, scale, rust, cuts troughs and some asphalt	3" x 20-1/2"	48-62-4010	48-62-4110	8
ASPHALT CUTTER	Cuts asphalt or hard ground (DO NOT use for concrete)	5" x 17-1/2"	48-62-4020	48-62-4120	6
CLAY SPADE	Digs clay, hard packed gravel, dirt (DO NOT use for concrete)	5-1/2" x 20"	48-62-4030	48-62-4130	5
SPIKE PIN DRIVER	Drives anchoring pins for concrete forms	14-1/2"	48-62-4040	-	-
GROUND ROD DRIVER	Drives ground rods	15-1/2" long / 3" Depth	48-62-4045	-	-
TAMPER PLATE	Compacts dirt, tamps asphalt. Use with 48-62-4060	6" x 6"	48-62-4050	-	-
		8" x 8"	48-62-4055	-	-
TAMPER SHANK	For use with 48-62-4050, 48-62-4055 and 48-62-4061	15-1/2"	48-62-4060	-	-
TENT STAKE DRIVER	Used to drive in large tent stakes. Use with 48-62-4060	5-1/2" L / 3-1/2" OD / 2-3/4" ID	48-62-4061	-	-

Demolition Accessory Set
48-20-4200

Includes: 48-20-4051, 48-20-4063, 48-20-4076, 48-62-2000, 48-62-2020

DIAMOND CORE BITS

Premium Series

- Designed to offer exceptional drilling life and speed in cured concrete with hard aggregate and medium steel reinforcement



Contractor Series

- Optimized to provide value for coring fewer holes in cured concrete with no reinforcement or with small diameter steel mesh and rebar



Pre-Stressed Series

- Designed specifically for the extra demands of drilling pre-stressed concrete



Size	Thread	Premium	Contractor	Pre-Stressed
3/4"	5/8" - 11	48-16-0756	-	-
7/8"	5/8" - 11	48-16-0876	-	-
1"	5/8" - 11	48-16-1006	-	48-16-1007
1-1/4"	5/8" - 11	48-16-1260	-	-
1-1/2"	5/8" - 11	48-16-1506	-	48-16-1507
2"	1-1/4" - 7	48-16-2013	48-16-2007	48-16-2014
2-1/2"	1-1/4" - 7	48-16-2513	48-16-2507	48-16-2514
2-3/4"	1-1/4" - 7	48-16-2756	-	-
3"	1-1/4" - 7	48-16-3013	48-16-3007	48-16-3014
3-1/2"	1-1/4" - 7	48-16-3511	48-16-3507	48-16-3512
4"	1-1/4" - 7	48-16-4013	48-16-4007	48-16-4014
4-1/4"	1-1/4" - 7	-	48-16-4257	-
4-1/2"	1-1/4" - 7	48-16-4506	-	48-16-4507
5"	1-1/4" - 7	48-16-5013	48-16-5007	48-16-5014
6"	1-1/4" - 7	48-16-6013	48-16-6007	48-16-6014
7"	1-1/4" - 7	48-16-7006	-	-
8"	1-1/4" - 7	48-16-8006	-	-
9"	1-1/4" - 7	48-16-9006	-	-
10"	1-1/4" - 7	48-16-9506	-	-
12"	1-1/4" - 7	48-16-9605	-	-
14"	1-1/4" - 7	48-16-9705	-	-

DIAMOND CORE BIT ACCESSORIES



Threaded Adaptor 48-04-0160	Copper Spindle Spacer 45-88-8565	3/16" Socket Wrench 49-96-0085	1-3/8" Open End Wrench 49-96-4700
<ul style="list-style-type: none"> Reduces 1-1/4"-7 threads to 5/8"-11 for diamond core bits and extensions 	<ul style="list-style-type: none"> Minimizes friction lock 	<ul style="list-style-type: none"> For mounting DYMODRILLS to cradle 	<ul style="list-style-type: none"> For use with DYMODRILLS. Also for threaded adaptors and bit extensions

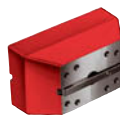

Spacer Assembly 49-67-0110	Spacer Assembly 49-67-0050	Spacer Assembly 49-67-0115
<ul style="list-style-type: none"> For use with models: 4125, 4130, and 4136 Mounts between cradle and DYMODRILL motor to increase DYMO-RIG bit capacity from 10" to 14" Net weight 3 lbs. Shipping weight 5 lbs 	<ul style="list-style-type: none"> For use with previous DYMO-RIG models 4104, 4114 and 4119 Spacer 1" thick, mounts between cradle and DYMODRILL motor Allows use of bits thru 10" diameter 	<ul style="list-style-type: none"> For use with models 4115, 4120, 4115-21, 4115-22, 4120-21 and 4120-22 to increase bit capacity from 10" to 14" Net weight 3-1/2 lbs. Shipping weight 5-1/2 lbs



9" Bit Extension 48-95-1500
<ul style="list-style-type: none"> Extension threaded on both ends with 1-1/4"-7 thread, for use with Diamond Core Bits over 2" diameter with 1-1/4"-4 thread Extension mounts directly to DYMODRILL – up to two can be coupled together for extended coring



10-1/2" Bit Extension 48-95-2100
<ul style="list-style-type: none"> Extension threaded on both ends with 5/8"-11 thread, for use with 1-1/4" and 1-1/2" diameter Diamond Core bits with 5/8"-11 thread Extension requires 48-04-0160 threaded adapter for mounting to DYMODRILLS – up to two can be coupled together for extended coring



Nothing but **HEAVY DUTY.**

MATERIAL REMOVAL



TYPE 1 CUT-OFF WHEELS

- Designed for fast cutting and long life
- Type 1 cut-off wheels are designed for cutting only



TYPE 27 DEPRESSED CENTER WHEELS

- Designed for fast cutting and long life

TYPE 27 GRINDING WHEELS

- Designed for grinding, blending and other general purpose applications



TYPE 27 DEPRESSED CENTER WHEELS WITH 5/8"-11 THREADED HUB

- Designed for grinding, blending and other general purpose applications

TYPE 1 PREMIUM ABRASIVE CUT-OFF WHEELS FOR CUT-OFF MACHINES

Size	Thickness	Arbor	Part Number	Abrasive Type	Abrasive Spec.	Application	Max RPM	Qty
FOR STATIONARY ABRASIVE CUT-OFF MACHINES (NOT INTENDED FOR USE ON HAND HELD CUT-OFF MACHINES)								
12"	3/32"	1"	49-94-1220	Aluminum Oxide	A36P	General Purpose - Metal	5,095	10
14"	3/32"	1"	49-94-1405	Aluminum Oxide	A36P	General Purpose - Metal (Double Reinforced)	4,365	5
14"	3/32"	1"	49-94-1410	Aluminum Oxide	A36P	Metal Stud	4,365	10
14"	3/32"	1"	49-94-1415	Aluminum Oxide	A36P	General Purpose - Metal (Center Reinforced)	4,365	5
FOR HAND HELD ABRASIVE CUT-OFF MACHINES (NOT INTENDED FOR USE ON STATIONARY CUT-OFF MACHINES)								
12"	1/8"	20mm	49-94-1270	Aluminum Oxide	A24R	General Purpose - Metal	6,360	10
12"	1/8"	1"	49-94-1275	Aluminum Oxide	A24R	General Purpose - Metal	6,360	10
12"	1/8"	20mm	49-94-1280	Silicon Carbide	C24T	Masonry	6,360	10
12"	1/8"	1"	49-94-1285	Silicon Carbide	C24T	Masonry	6,360	10
14"	1/8"	20mm	49-94-1470	Aluminum Oxide	A24R	General Purpose - Metal	5,400	10
14"	1/8"	1"	49-94-1475	Aluminum Oxide	A24R	General Purpose - Metal	5,400	10
14"	1/8"	20mm	49-94-1480	Silicon Carbide	C24T	Masonry	5,400	10
14"	1/8"	1"	49-94-1485	Silicon Carbide	C24T	Masonry	5,400	10

TYPE 1 AND TYPE 27 REINFORCED DEPRESSED CENTER WHEELS

Size	Thickness	Arbor	Part Number	Abrasive Spec.	Applications	Characteristics	Max RPM	Case Qty
TYPE 1 CUT-OFF WHEELS								
4-1/2"	0.045"	7/8"	49-94-4500	A60T	Metal/Stainless Cutting	Fast Cut/Long Life	13,580	25
5"	0.045"	7/8"	49-94-5000	A60T	Metal/Stainless Cutting	Fast Cut/Long Life	12,225	25
6"	0.045"	7/8"	49-94-6300	A60T	Metal/Stainless Cutting	Fast Cut/Long Life	10,185	25
7"	3/32"	5/8"	49-94-7050	A24R	General Purpose - Metal	Fast Cut/Long Life	8,730	25
7"	1/8"	5/8"	49-94-7055	C24T	Masonry Cutting	Fast Cut/Long Life	8,730	25
TYPE 27 CUT-OFF WHEELS								
4-1/2"	0.045"	7/8"	49-94-4505	A60T	Metal/Stainless Cutting	Fast Cut/Long Life	13,580	25
5"	0.045"	7/8"	49-94-5005	A60T	Metal/Stainless Cutting	Fast Cut/Long Life	12,225	25
6"	0.045"	7/8"	49-94-6305	A60T	Metal/Stainless Cutting	Fast Cut/Long Life	10,185	25
TYPE 27 GRINDING WHEELS								
4-1/2"	1/8"	7/8"	49-94-4510	A30S	Pipeline - Light Grinding/Cutting	Fast Cut	13,580	10
4-1/2"	1/4"	5/8"-11	49-94-4515	A24R	Metal/Stainless Grinding	Long Life	13,580	5
4-1/2"	1/4"	7/8"	49-94-4520	A24R	Metal/Stainless Grinding	Long Life	13,580	10
4-1/2"	1/8"	5/8"-11	49-94-4525	A30S	Pipeline - Light Grinding/Cutting	Fast Cut	13,580	5
4-1/2"	1/4"	7/8"	49-94-4570	C24T	Concrete Grinding	Aggressive Material Removal	13,580	10
4-1/2"	1/4"	7/8"	49-94-4580	ZA24R	Metal Grinding	Extra Long Life	13,580	10
4-1/2"	1/4"	5/8"-11	49-94-4585	ZA24R	Metal Grinding	Extra Long Life	13,580	5
5"	1/8"	7/8"	49-94-5010	A30S	Pipeline - Light Grinding/Cutting	Fast Cut	12,225	10
5"	1/4"	7/8"	49-94-5020	A24R	Metal/Stainless Grinding	Long Life	12,225	10
5"	1/4"	7/8"	49-94-5730	C24T	Concrete Grinding	Aggressive Material Removal	12,225	10
5"	1/8"	7/8"	49-94-5740	C24T	Concrete Grinding	Aggressive Material Removal	12,225	10
5"	1/4"	7/8"	49-94-5080	ZA24R	Metal/Stainless Cutting	Extra Long Life	12,225	10
6"	1/4"	5/8"-11	49-94-6330	A24R	Metal/Stainless Grinding	Long Life	10,185	5
6"	1/4"	7/8"	49-94-6340	A24R	Metal/Stainless Grinding	Long Life	10,185	10
6"	1/8"	5/8"-11	49-94-6360	A30S	Pipeline - Light Grinding/Cutting	Fast Cut	10,185	5
7"	1/8"	5/8"-11	49-94-7015	A30S	Pipeline - Light Grinding/Cutting	Fast Cut	8,600	5
7"	1/4"	7/8"	49-94-7020	A24R	Metal/Stainless Grinding	Long Life	8,600	10
7"	1/4"	5/8"-11	49-94-7025	A24R	Metal/Stainless Grinding	Long Life	8,600	5
7"	1/4"	5/8"-11	49-94-7735	C24T	Concrete Grinding	Aggressive Material Removal	8,600	5
7"	1/8"	5/8"-11	49-94-7075	ZA24R	Pipeline - Light Grinding/Cutting	Extra Long Life	8,600	5
7"	1/4"	5/8"-11	49-94-7085	ZA24R	Metal Grinding	Extra Long Life	8,600	5
9"	1/8"	5/8"-11	49-94-9015	A30S	Pipeline - Light Grinding/Cutting	Fast Cut	6,600	10
9"	1/4"	5/8"-11	49-94-9025	A24R	Metal/Stainless Grinding	Long Life	6,600	10
9"	1/4"	5/8"-11	49-94-9735	C24T	Concrete Grinding	Aggressive Material Removal	6,600	10
9"	1/4"	5/8"-11	49-94-9085	ZA24R	Metal Grinding	Extra Long Life	6,600	10
ALUMINUM OXIDE RESINOID BOND GRINDING WHEELS (FOR USE WITH STRAIGHT GRINDERS ONLY)								
2-1/2"	1/2"	3/8"	49-92-0200	60 Grit	For use with Straight Grinders	Long Life	21,000	1
2-1/2"	1/2"	3/8"	49-92-0250	36 Grit	For use with Straight Grinders	Long Life	21,000	1
3"	1/2"	3/8"	49-92-0500	36 Grit	For use with Straight Grinders	Long Life	18,000	1
3"	1/2"	3/8"	49-92-0510	60 Grit	For use with Straight Grinders	Long Life	18,000	1
5"	1"	5/8"	49-92-2240	24 Grit	For use with Straight Grinders	Long Life	7,260	1
6"	1"	5/8"	49-92-3260	24 Grit	For use with Straight Grinders	Long Life	6,000	1

*Includes diamond knockout

BACKING PAD ASSEMBLIES

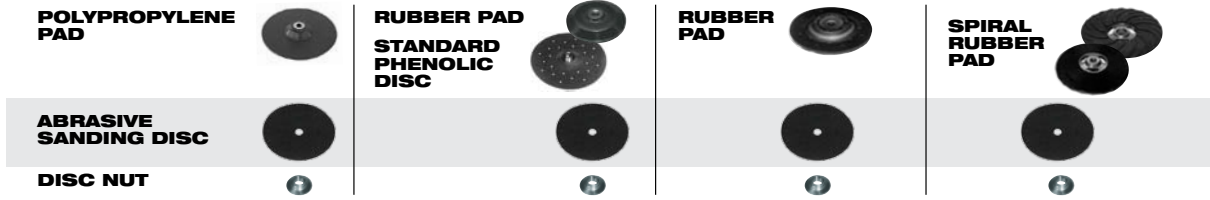

Part Number	Diameter	Thread	Max RPM
SPIRAL RUBBER PAD ASSEMBLIES (INCLUDES RUBBER PAD AND DISC NUT)			
49-36-3800	7"	5/8"-11	7,500
49-36-3850	9"	5/8"-11	6,000
49-40-0360	Disc Nut Only	5/8"-11	-
RUBBER PAD ASSEMBLIES (INCLUDES RUBBER PAD AND DISC NUT)			
49-36-3700	7"	5/8"-11	8,500
49-36-3750	9"	5/8"-11	7,500
49-40-0360	Disc Nut Only	5/8"-11	-
STANDARD PHENOLIC DISC ASSEMBLIES (INCLUDES RUBBER PAD AND DISC NUT)			
49-36-6000	7"	5/8"-11	7,000
49-36-6050	9"	5/8"-11	7,000
49-40-0350	Disc Nut Only	5/8"-11	-
PHENOLIC DISC ONLY (WHEN PURCHASED SEPARATELY)			
48-80-6000	7"	5/8"-11	7,000
48-80-6050	9"	5/8"-11	7,000
49-36-3500	Rubber Pad Only	-	7,000
49-40-0350	Disc Nut Only	5/8"-11	-

Part Number	Diameter	Thread	Max RPM
POLYPROPYLENE PAD KITS (INCLUDES BACKING PAD AND DISC NUT)			
49-36-3455	4-1/2"	5/8"-11	13,000
49-36-3450	4-1/2"	1/2"-13	13,000
49-36-3465	5"	5/8"-11	13,000
49-36-3460	5"	1/2"-13	13,000
POLYPROPYLENE PADS			
49-36-3452	4-1/2"	1/2"-13	13,000
49-36-3453	4-1/2"	5/8"-11	13,000
49-36-3462	5"	1/2"-13	13,000
49-36-3463	5"	5/8"-11	13,000
49-36-3900	7"	5/8"-11	10,000
49-36-3950	9"	5/8"-11	8,000
49-40-0350	Disc Nut	5/8"-11	-
49-40-0360	Disc Nut	5/8"-11	-
49-40-0370	Disc Nut	1/2"-13	-

RESIN BONDED ABRASIVE SANDING DISCS

Grit	4-1/2" 13,000 MAX RPM	5" 13,000 MAX RPM	7" 7,000 MAX RPM	9" 7,000 MAX RPM	Qty
ALUMINA ZIRCONIA RESIN FIBRE DISCS - FOR HEAVY WELD AND METAL GRINDING - IDEAL FOR ALL FERROUS METALS					
24	48-80-0681	48-80-0693	48-80-0705	48-80-0717	25
36	48-80-0683	48-80-0695	48-80-0707	48-80-0719	25
50	48-80-0685	48-80-0697	48-80-0709	48-80-0723	25
60	48-80-0687	48-80-0699	48-80-0713	48-80-0725	25
80	48-80-0689	48-80-0703	48-80-0715	48-80-0727	25
ALUMINUM OXIDE RESIN FIBRE DISCS - FOR ALUMINUM AND NON-FERROUS METALS, WOOD AND FIBERGLASS					
24	48-80-0622	48-80-0636	48-80-0652	-	5
24	48-80-0623	48-80-0637	48-80-0653	48-80-0667	25
36	48-80-0626	48-80-0642	48-80-0656	-	5
36	48-80-0627	48-80-0643	48-80-0657	48-80-0673	25
50	48-80-0632	48-80-0646	48-80-0662	-	5
50	48-80-0633	48-80-0647	48-80-0663	48-80-0677	25
CERAMIC RESIN FIBRE DISCS - FOR CARBON ALLOY APPLICATIONS ONLY - LONG LASTING AND SUPERIOR PERFORMANCE					
24	48-80-0770	48-80-0812	48-80-0820	48-80-0830	5
36	48-80-0780	48-80-0814	48-80-0822	48-80-0832	5
50	48-80-0790	48-80-0815	48-80-0824	48-80-0834	5
60	48-80-0800	48-80-0816	48-80-0826	48-80-0836	5
80	48-80-0810	48-80-0817	48-80-0828	48-80-0838	5
ALUMINUM OXIDE RESIN FIBRE DISCS - GENERAL PURPOSE - FOR RUST AND SCALE REMOVAL LIGHT GRINDING OF VARIOUS METALS					
ASSORT*	48-80-0501	48-80-0534	48-80-0572	-	5
16	-	-	48-80-0575	-	5
16	-	-	48-80-0576	48-80-0603	25
24	48-80-0504	48-80-0536	48-80-0579	-	5
24	48-80-0505	48-80-0537	48-80-0580	48-80-0605	25
36	48-80-0508	48-80-0542	48-80-0583	-	5
36	48-80-0509	48-80-0543	48-80-0584	48-80-0607	25
50	48-80-0514	48-80-0548	48-80-0587	-	5
50	48-80-0515	48-80-0549	48-80-0588	48-80-0609	25
60	48-80-0518	48-80-0554	48-80-0591	-	5
60	48-80-0519	48-80-0555	48-80-0592	48-80-0613	25
80	48-80-0524	48-80-0560	48-80-0595	-	5
80	48-80-0525	48-80-0561	48-80-0596	48-80-0615	25
120	48-80-0528	48-80-0566	48-80-0599	-	5
120	48-80-0529	48-80-0567	48-80-0601	48-80-0617	25

*Includes one each of: 36, 50, 60, 80 and 120 grit discs

DISC TRIMMER









Disc Trimmer
49-80-1000







Upper and Lower Blade Set
49-80-1155

WIRE BRUSHES

Description	Diameter	Thread	Wire Thickness	Max RPM	Carbon Steel	Stainless Steel
 KNOT WIRE CUP BRUSH	2-3/4"	5/8"-11	0.020"	12,000	48-52-5040	48-52-5050
	2-3/4"	1/2"-13	0.020"	12,000	48-52-1125	48-52-1130
	3-1/2"	5/8"-11	0.020"	13,000	48-52-5067	-
	4"	5/8"-11	0.020"	7,000	48-52-1350	-
	6"	5/8"-11	0.020"	6,000	48-52-1650	-
 CRIMPED WIRE CUP BRUSH	3"	5/8"-11	0.012"	12,000	48-52-5060	-
	3"	1/2"-13	0.012"	12,000	48-52-1135	-
	3-1/2"	5/8"-11	0.014"	12,000	48-52-5065	-
	4"	5/8"-11	0.014"	7,000	48-52-1300	-
	5"	5/8"-11	0.020"	8,000	48-52-1400	-
	6"	5/8"-11	0.014"	6,000	48-52-1600	-
 BEVEL KNOT BRUSH	4"	5/8"-11	0.014"	12,000	48-52-1280	48-52-1290
	4"	1/2"-13	0.014"	12,000	48-52-1285	48-52-1295
	4"	5/8"-11	0.020"	12,000	48-52-1305	48-52-1315
	4"	1/2"-13	0.020"	12,000	48-52-1310	48-52-1320
 BEVEL CRIMPED BRUSH	4"	5/8"-11	0.014"	12,000	48-52-1325	48-52-1335
	4"	1/2"-13	0.014"	12,000	48-52-1330	48-52-1340
 CRIMPED END WIRE BRUSHES	1/2"	-	0.014"	25,000	48-52-1000	-
	3/4"	-	0.014"	22,000	48-52-1010	-
	1"	-	0.014"	22,000	48-52-1015	-
	1"	-	0.020"	22,000	48-52-1020	-
	3/4"	-	0.006"	22,000	-	48-52-1022
	1"	-	0.006"	22,000	-	48-52-1025
	1"	-	0.010"	22,000	-	48-52-1027
 KNOT END WIRE BRUSHES	3/4"	-	0.014"	22,000	48-52-1030	-
	3/4"	-	0.020"	22,000	48-52-1035	-
	1-1/8"	-	0.014"	22,000	48-52-1040	-
	1-1/8"	-	0.020"	22,000	48-52-1045	48-52-1055
 CUP FLARED, END BRUSH	2-1/2"	-	0.014"	22,000	48-52-1050	-

WIRE WHEELS

Description	Diameter	Thread	Wire Thickness	Max RPM	Carbon Steel	Stainless Steel
 STRINGER BEAD WIRE WHEEL	4"	5/8"-11	0.020"	12,000	48-52-5010	48-52-5000
	4"	1/2"-13	0.020"	12,000	48-52-2220	48-52-1225
	5"	5/8"-11	0.020"	12,500	48-52-1700	48-52-1705
	6"	5/8"-11	0.020"	9,500	48-52-1715	48-52-1720
 FULL CABLE TWIST KNOT WIRE WHEEL	4"	5/8"-11	0.020"	12,000	48-52-5030	48-52-5020
	4"	1/2"-13	0.020"	12,000	48-52-1250	48-52-2225
	5"	5/8"-11	0.020"	12,500	48-52-1710	-
 RADIAL CRIMPED WIRE WHEEL	6"	5/8"-11	0.020"	9,500	48-52-1725	-
	4"	5/8"-11	0.014"	12,000	48-52-5070	-
 KNOT WIRE WHEEL - FOR USE WITH STRAIGHT GRINDERS ONLY	4"	1/2"-13	0.014"	12,000	48-52-1275	-
	3"	3/8"-1/2"	0.014"	25,000	48-52-2300	-
	5"	5/8"	0.014"	8,000	48-52-2310	-
	6"	1/2"-5/8"	0.014"	8,000	48-52-2510	-

THREADED ADAPTERS

Part Number	Description
48-03-1005	5/8"-11 - M10 x 1.25
48-03-1010	5/8"-11 - M10 x 1.50



Nothing but **HEAVY DUTY.**

HOOK AND LOOP FOAM PADS, BLENDED WOOL PADS, AND TWISTED, TUFTED WOOL PADS



49-48-0500



49-36-2175



49-36-0670



49-36-0600



49-36-2500

Diameter	Depth of Pile	Part Number	Description	Application
8"	2"	49-36-0650*	White Foam Polishing Pad	Removes swirls on clearcoat, gelcoat and most finishes. Produces medium to high gloss
8"	2"	49-36-1550*	Yellow Foam Compounding Pad	Compounding removes 1500-2000 sand scratches. Produces low to medium gloss
8"	2"	49-36-0670*	Red Foam Finishing Pad	Final finishing on clearcoat, gelcoat and most finishes. For applying waxes and polish/sealants, produces high gloss finish
7-1/2"	1-1/2"	49-36-0600*	Blended Wool Pad	For polishing clearcoat, gelcoat and most finishes. Produces medium gloss
7-1/2"	1-1/2"	49-36-0500**	Blended Wool Pad	For polishing clearcoat, gelcoat and most finishes. Produces medium gloss
9"	1-1/2"	49-36-0700**	Blended Wool Pad	For polishing clearcoat, gelcoat and most finishes. Produces medium gloss
7-1/2"	1-1/2"	49-36-1500*	Twisted, Tufted 100% Wool Pad	Deep cleaning and compounding removes 1200-1500 sand scratches on clearcoat, gelcoat and most finishes. Produces low gloss
7-1/2"	1-1/2"	49-36-1450**	Twisted, Tufted 100% Wool Pad	Deep cleaning and compounding removes 1200-1500 sand scratches on clearcoat, gelcoat and most finishes. Produces low gloss
7-1/2"	2"	49-36-1455**	Twisted, Tufted 100% Wool Pad	Deep cleaning and compounding removes 1200-1500 sand scratches on clearcoat, gelcoat and most finishes. Produces low gloss
9"	1-1/2"	49-36-1600**	Twisted, Tufted 100% Wool Pad	Deep cleaning and compounding removes 1200-1500 sand scratches on clearcoat, gelcoat and most finishes. Produces low gloss
7"	1-1/2"	48-48-0500**	Blended Wool Acrylic Pad (tie on)	For polishing clearcoat, gelcoat and most finishes. Produces medium gloss
9"	1-1/2"	48-48-1000**	Blended Wool Acrylic Pad (tie on)	For polishing clearcoat, gelcoat and most finishes. Produces medium gloss
6-1/4"	-	49-36-2175	Hook and Loop Molded Urethane Back Up Plate	Flexible molded urethane provides forgiving flexibility lowering risk of spot heating and finish burning (includes centering tool)
7"	-	49-36-2500	Molded Rubber Backing Pad	Specifically designed to bolt buffing/polishing pads onto 5460-6, 5540 and 5455 speed control polishers (nut and washer sold separately)
8-1/2"	-	49-36-2200	Molded Rubber Backing Pad	Specifically designed to bolt buffing/polishing pads onto 5460-6, 5540 and 5455 speed control polishers (nut and washer sold separately)
-	-	49-67-0130	Pad Centering Tool	

*Hook and loop attachment, no disc nut needed

**Traditional bolt-on and tie attachment, requires appropriate rubber backing pad (49-36-2500 or 49-36-2200)

FLAP DISCS



TYPE 27



TYPE 27 EXTRA THICK



TYPE 29

Size	Arbor	Part Number	Abrasive Spec.	Grit Spec.	Applications	Max RPM	Case Qty
TYPE 27							
4-1/2"	7/8"	48-80-8100	Zirconia Alumina	36	Stock removal, deburring, blending welds, edge chamfering	13,300	5
4-1/2"	7/8"	48-80-8101	Zirconia Alumina	60	Surface preparation, cleaning and finishing	13,300	5
4-1/2"	7/8"	48-80-8102	Zirconia Alumina	80	Surface preparation, cleaning and finishing	13,300	5
4-1/2"	5/8"-11	48-80-8110	Zirconia Alumina	36	Stock removal, deburring, blending welds, edge chamfering	13,300	5
4-1/2"	5/8"-11	48-80-8111	Zirconia Alumina	60	Surface preparation, cleaning and finishing	13,300	5
4-1/2"	5/8"-11	48-80-8112	Zirconia Alumina	80	Surface preparation, cleaning and finishing	13,300	5
TYPE 27 - EXTRA THICK							
4-1/2"	7/8"	48-80-8200	Zirconia Alumina	36	Stock removal, deburring, blending welds, edge chamfering	13,000	5
4-1/2"	7/8"	48-80-8201	Zirconia Alumina	60	Surface preparation, cleaning and finishing	13,000	5
4-1/2"	7/8"	48-80-8202	Zirconia Alumina	80	Surface preparation, cleaning and finishing	13,000	5
TYPE 29							
4-1/2"	7/8"	48-80-8000	Zirconia Alumina	36	Stock removal, deburring, blending welds, edge chamfering	13,300	5
4-1/2"	7/8"	48-80-8001	Zirconia Alumina	60	Surface preparation, cleaning and finishing	13,300	5
4-1/2"	7/8"	48-80-8002	Zirconia Alumina	80	Surface preparation, cleaning and finishing	13,300	5
4-1/2"	5/8"-11	48-80-8010	Zirconia Alumina	36	Stock removal, deburring, blending welds, edge chamfering	13,300	5
4-1/2"	5/8"-11	48-80-8011	Zirconia Alumina	60	Surface preparation, cleaning and finishing	13,300	5
4-1/2"	5/8"-11	48-80-8012	Zirconia Alumina	80	Surface preparation, cleaning and finishing	13,300	5
5"	7/8"	48-80-8020	Zirconia Alumina	36	Stock removal, deburring, blending welds, edge chamfering	12,000	5
5"	7/8"	48-80-8021	Zirconia Alumina	60	Surface preparation, cleaning and finishing	12,000	5
5"	7/8"	48-80-8022	Zirconia Alumina	80	Surface preparation, cleaning and finishing	12,000	5
7"	7/8"	48-80-8030	Zirconia Alumina	36	Stock removal, deburring, blending welds, edge chamfering	8,600	5
7"	7/8"	48-80-8031	Zirconia Alumina	60	Surface preparation, cleaning and finishing	8,600	5
7"	7/8"	48-80-8032	Zirconia Alumina	80	Surface preparation, cleaning and finishing	8,600	5
7"	5/8"-11	48-80-8040	Zirconia Alumina	36	Stock removal, deburring, blending welds, edge chamfering	8,600	5
7"	5/8"-11	48-80-8041	Zirconia Alumina	60	Surface preparation, cleaning and finishing	8,600	5
7"	5/8"-11	48-80-8042	Zirconia Alumina	80	Surface preparation, cleaning and finishing	8,600	5

TOOL BELTS AND STORAGE



33 Pocket / 3 Pc Tool Belt
49-17-0190



33 Pocket / 5 Pc Tool Belt
49-17-0195



Contractor Parts Organizer
49-17-0110



50 Pocket Bucket-Less Tool Organizer
49-17-0180

GLOVES



Size	General Purpose	Fingerless	Contractor	Cold Weather	Demolition
Medium	49-17-0111	49-17-0121	49-17-0131	49-17-0141	49-17-0151
Large	49-17-0112	49-17-0122	49-17-0132	49-17-0142	49-17-0152
X-Large	49-17-0113	49-17-0123	49-17-0133	49-17-0143	49-17-0153
XX-Large	49-17-0114	49-17-0124	49-17-0134	49-17-0144	49-17-0154

SHEAR AND NIBBLER ACCESSORIES

SHEAR ACCESSORIES

Description	Part Number	For Use With
14 Gauge Shear Blade Set	48-44-0112	6815
16 and 18 Gauge Shear Blade Set	48-44-0122	6805
Shear Blade Set	48-44-0070	-
Center Blade	48-44-0150	6852-20
Left Blade	48-44-0160	6852-20
Right Blade	48-44-0170	6852-20



Replacement Swivel Shear Head Assembly
48-08-0500

NIBBLER ACCESSORIES

Description	Part Number	For Use With
Replacement Punch	48-44-0260	6890
Replacement Punch	48-44-0265	6880
Replacement Die	48-44-0270	6890
Replacement Die	48-44-0275	6880