



GREENCREATIVE

Bringing You the Latest in LED Technology



2016 SPRING PRODUCT CATALOG



GREENCREATIVE

GREEN CREATIVE, founded in 2010, is a solid state lighting development and manufacturing company based in Silicon Valley, CA. The company offers a comprehensive line of high-performance LED lighting solutions which has been widely adopted by some of the largest companies in the world.



Bringing you the latest in LED technology

Anchored by strong integrated R&D capabilities and patented technology, GREEN CREATIVE innovation, performance and reliability have been recognized year after year by the Illuminating Engineering Society Progress Report, the LEDs Magazine Sapphire Awards and Lighting For Tomorrow.

A complete line with national & international distribution

GREEN CREATIVE's full product line of ENERGY STAR, DLC and CEC certified indoor retrofit and new construction lighting solutions serves the Retail, Hospitality, Food & Beverage, Office and Education industries through multiple distribution centers and sales networks across the USA.



SPRING 2016 TABLE OF CONTENTS

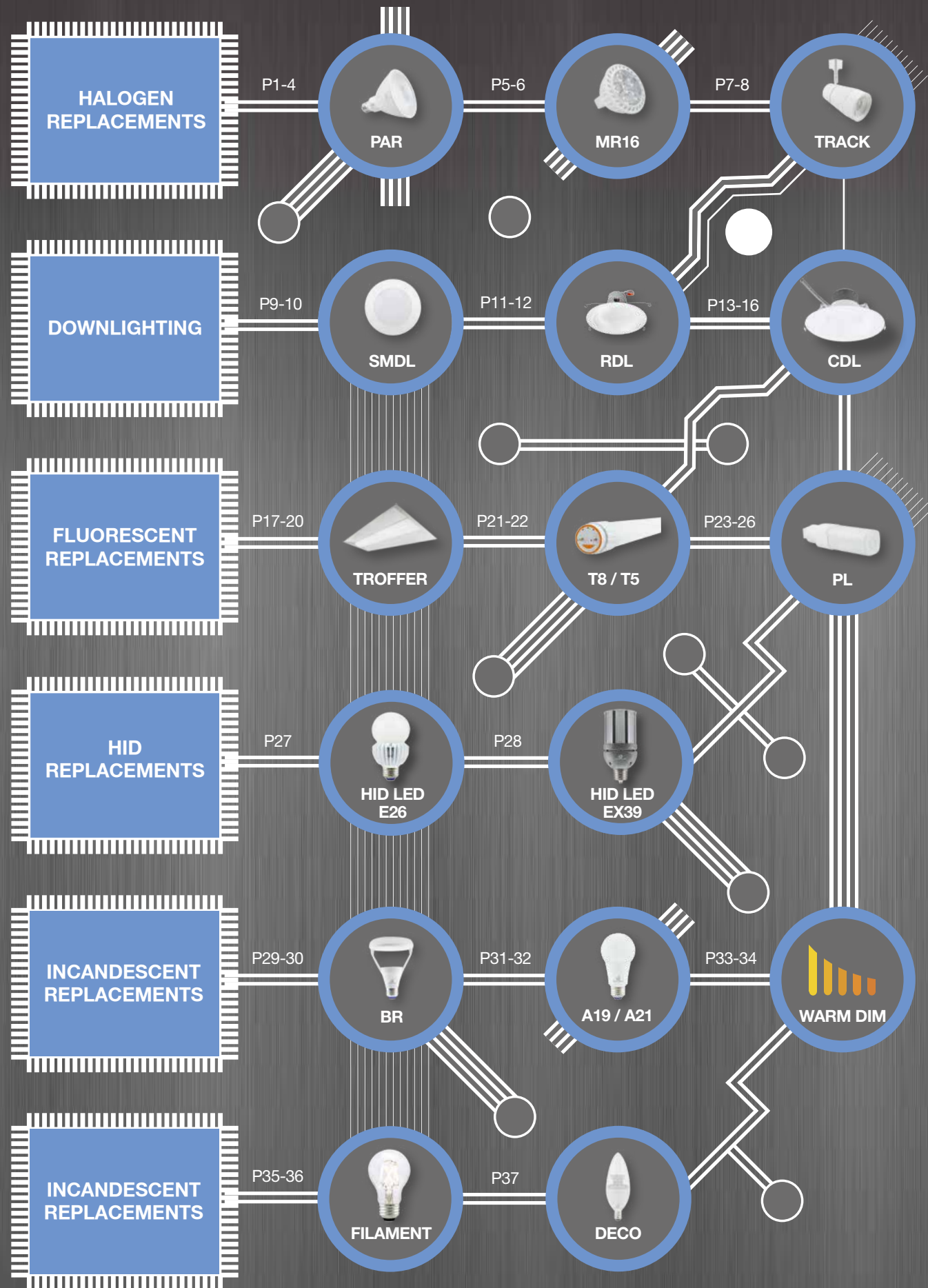

SPRING 2016 FEATURED PRODUCTS

NEW!
INNOFIT COMMERCIAL DL
 Adjustable lumen output
 For retrofit or new construction
 Universal housing compatibility
 P15-16

NEW!
T5 HO & HE
 Electronic ballast compatible
 Enclosed fixture rated
 Shatterproof
 P21

NEW!
PLS V HYB
 HYBRid installation
 Patent pending fully round design
 Replaces 13W CFL
 P24

NEW!
HID LED EX39
 Designed for use in post tops
 CoolSink technology
 Enclosed fixture rated
 P28

NEW!
WARM DIM
 A19, BR30 & Candle versions
 2700K-2200K CCT warm dimming
 Exceptional efficacy
 P33-34

NEW!
FILAMENT
 Fully dimmable
 Micro-designed driver
 No heatsink required
 P35-36



Patent Pending REFINE Optic



WATCH THE VIDEO

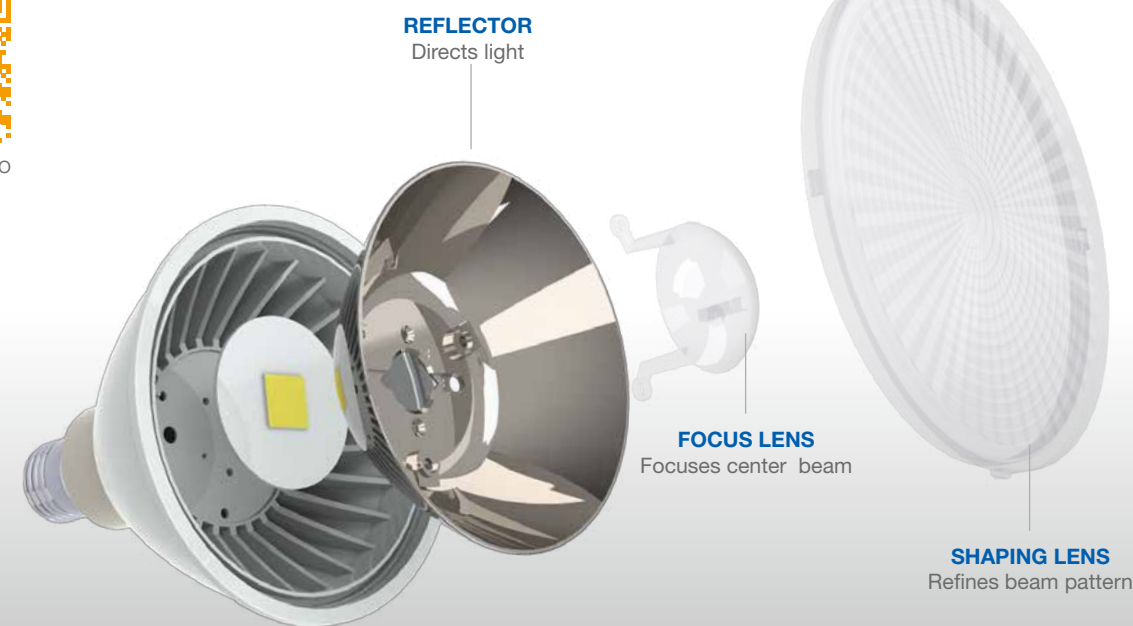

SPECIFICATIONS

Model	Product	CCT	Lumens (lm)	Equiv.	LPW	Beam Angle	CBCP (cd)	CRI (typ.)	Dim	Life (hrs)	Voltage	Encl.	Energy Star	
	18.5PAR38G4DIM/927SP15	16147	2700K	950	100W	51	15°	10,500	90	Yes	40,000	120V	Yes	✓
	18.5PAR38G4DIM/927NF25	16148	2700K	1105	120W	60	25°	5800	90	Yes	40,000	120V	Yes	✓
	17PAR38G4DIM/927FL40	16149	2700K	1105	120W	65	40°	2400	90	Yes	40,000	120V	Yes	✓
	18.5PAR38G4DIM/930SP15	16150	3000K	1000	100W	54	15°	11,000	90	Yes	40,000	120V	Yes	✓
	18.5PAR38G4DIM/930NF25	16151	3000K	1150	120W	62	25°	5900	90	Yes	40,000	120V	Yes	✓
	17PAR38G4DIM/930FL40	16152	3000K	1150	120W	68	40°	2500	90	Yes	40,000	120V	Yes	✓
	17PAR38G4DIM/940FL40	16155	4000K	1200	120W	71	40°	2650	90	Yes	40,000	120V	Yes	✓
	18.5PAR38G4DIM/930SP15/B •	16256	3000K	1000	100W	54	15°	11,000	90	Yes	40,000	120V	Yes	✓
	18.5PAR38G4DIM/930NF25/B •	16257	3000K	1150	120W	62	25°	5900	90	Yes	40,000	120V	Yes	✓
	17PAR38G4DIM/930FL40/B •	16258	3000K	1150	120W	68	40°	2500	90	Yes	40,000	120V	Yes	✓
	17PAR38G4/930FL40/277V	16161	3000K	1150	120W	68	40°	2500	90	No	40,000	120-277V	Yes	✓
	17PAR38G4/940FL40/277V	16164	4000K	1200	120W	71	40°	2650	90	No	40,000	120-277V	Yes	✓
	17PAR38G4DIM/927FL40/GU24	16303	2700K	1105	120W	65	40°	2400	90	Yes	40,000	120V	Yes	✓
	17PAR38G4DIM/930FL40/GU24	16306	3000K	1150	120W	68	40°	2500	90	Yes	40,000	120V	Yes	✓
	14.5PAR30G4DIM/927SP15	16111	2700K	725	75W	50	15°	6155	90	Yes	40,000	120V	Yes	✓
	12.5PAR30G4DIM/927NF25	16112	2700K	815	75W	65	25°	3350	90	Yes	40,000	120V	Yes	✓
	12.5PAR30G4DIM/927FL40	16113	2700K	815	75W	65	40°	1750	90	Yes	40,000	120V	Yes	✓
	14.5 PAR30G4DIM/930SP15	16114	3000K	760	75W	52	15°	6250	90	Yes	40,000	120V	Yes	✓
	12.5PAR30G4DIM/930NF25	16115	3000K	850	75W	68	25°	3600	90	Yes	40,000	120V	Yes	✓
	12.5PAR30G4DIM/930FL40	16116	3000K	850	75W	68	40°	1850	90	Yes	40,000	120V	Yes	✓
	12.5PAR30G4DIM/940FL40	16119	4000K	900	75W	72	40°	2050	90	Yes	40,000	120V	Yes	✓
	14.5PAR30G4DIM/930SP15/B •	16208	3000K	760	75W	52	15°	6250	90	Yes	40,000	120V	Yes	✓
	12.5PAR30G4DIM/930NF25/B •	16209	3000K	850	75W	68	25°	3600	90	Yes	40,000	120V	Yes	✓
	12.5PAR30G4DIM/930FL40/B •	16210	3000K	850	75W	68	40°	1850	90	Yes	40,000	120V	Yes	✓

* PAR38 models are suitable for use in wet locations
• Black finish

SPECIFICATIONS

Model	Product	CCT	Lumens (lm)	Equiv.	LPW	Beam Angle	CBCP (cd)	CRI (typ.)	Dim	Life (hrs)	Voltage	Encl.	Energy Star	
	12.5PAR30G4/930FL40/277V	16125	3000K	850	75W	68	40°	1850	90	No	40,000	120-277V	Yes	✓
	12.5PAR30G4/940FL40/277V	16128	4000K	900	75W	72	40°	2050	90	No	40,000	120-277V	Yes	✓
	12.5PAR30G4DIM/927FL40/GU24	16279	2700K	815	75W	65	40°	1750	90	Yes	40,000	120V	Yes	✓
	12.5PAR30G4DIM/930FL40/GU24	16282	3000K	850	75W	68	40°	1850	90	Yes	40,000	120V	Yes	✓
	14PAR30SNG4DIM/927SP15	16129	2700K	700	75W	50	15°	6155	90	Yes	40,000	120V	Yes	✓
	11PAR30SNG4DIM/927NF25	16130	2700K	705	75W	64	25°	2910	90	Yes	40,000	120V	Yes	✓
	11PAR30SNG4DIM/927FL40	16131	2700K	705	75W	64	40°	1400	90	Yes	40,000	120V	Yes	✓
	14PAR30SNG4DIM/930SP15	16132	3000K	725	75W	52	15°	6200	90	Yes	40,000	120V	Yes	✓
	11PAR30SNG4DIM/930NF25	16133	3000K	740	75W	67	25°	2910	90	Yes	40,000	120V	Yes	✓
	11PAR30SNG4DIM/930FL40	16134	3000K	740	75W	67	40°	1450	90	Yes	40,000	120V	Yes	✓
	11PAR30SNG4DIM/940FL40	16137	4000K	780	75W	71	40°	1500	90	Yes	40,000	120V	Yes	✓
	14PAR30SNG4DIM/930SP15/B •	16232	3000K	725	75W	52	15°	6200	90	Yes	40,000	120V	Yes	✓
11PAR30SNG4DIM/930NF25/B •	16233	3000K	740	75W	67	25°	2910	90	Yes	40,000	120V	Yes	✓	
11PAR30SNG4DIM/930FL40/B •	16234	3000K	740	75W	67	40°	1450	90	Yes	40,000	120V	Yes	✓	
	7PAR20G4DIM/927FL40	16108	2700K	460	50W	66	40°	600	90	Yes	40,000	120V	Yes	✓
	7PAR20G4DIM/930FL40	16109	3000K	480	50W	69	40°	650	90	Yes	40,000	120V	Yes	✓
	7PAR20G4DIM/940FL40	16110	4000K	505	50W	72	40°	700	90	Yes	40,000	120V	Yes	✓
	7PAR20G4DIM/930FL40/B •	16202	3000K	480	50W	69	40°	650	90	Yes	40,000	120V	Yes	✓

• Black finish



Designed for Track & Downlighting Applications

HID Replacement

250W Hal.
39W CMH
120-277V

- Universal voltage 120-277V – Not compatible with ballasts
- 10,000+ candela replaces 250W Hal. & 39W CMH
- Powerful light output 1775 lumens
- Exceptional efficacy 93 LPW in Warm White CCT

SPECIFICATIONS

Model	Product	CCT	Lumens (lm)	Equiv.	LPW	Beam Angle	CBCP (cd)	CRI (typ.)	Dim	Life (hrs)	Voltage	Encl.	Energy Star	
	NEW!													
PAR38 19W HO 277V	19PAR38HO/827NF25/277V	97769	2700K	1725	250W	91	25°	10,000	80	No	40,000	120-277V	No	✓
		97772	3000K	1775	250W	93	25°	10,200	80	No	40,000	120-277V	No	✓
		97778	4000K	1850	250W	97	25°	10,400	80	No	40,000	120-277V	No	✓



Economical Retrofit Solution

- Lightweight environmentally friendly construction
- Full-face optic: maximizes distribution, minimizes glare
- Smooth dimming on existing dimmers
- FL beam angle in Soft White & Warm White CCT

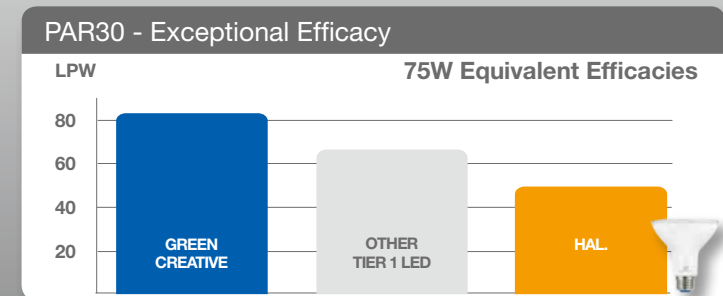

SPECIFICATIONS

Model	Product	CCT	Lumens (lm)	Equiv.	LPW	Beam Angle	CBCP (cd)	CRI (typ.)	Dim	Life (hrs)	Voltage	Encl.	Wet	Energy Star	
	NEW!														
PAR 38 14W	14PAR38DIM/827FL40	57807	2700K	1000	90W	71	40°	1900	80	Yes	25,000	120V	No	Yes	✓
		57809	3000K	1050	90W	75	40°	2000	80	Yes	25,000	120V	No	Yes	✓
PAR 30 8.5W	8.5PAR30DIM/827FL40	57795	2700K	650	75W	76	40°	1700	80	Yes	25,000	120V	No	Yes	✓
		57797	3000K	700	75W	82	40°	1750	80	Yes	25,000	120V	No	Yes	✓
PAR 20 5.5W	5.5PAR20DIM/827FL40	57789	2700K	450	50W	82	40°	750	80	Yes	25,000	120V	No	No	✓
		57791	3000K	500	50W	91	40°	800	80	Yes	25,000	120V	No	No	✓

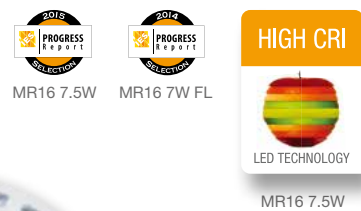

True 75W Halogen Replacement

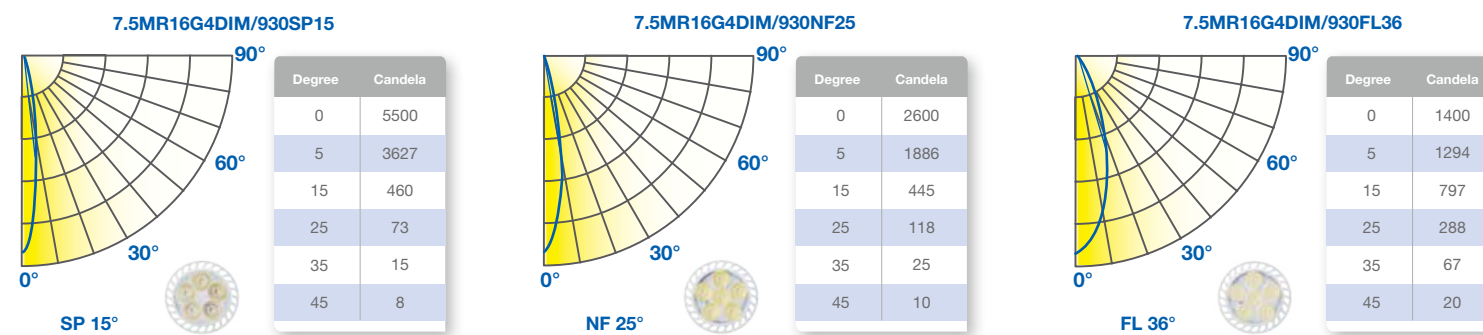

MR16 7.5W - High CRI

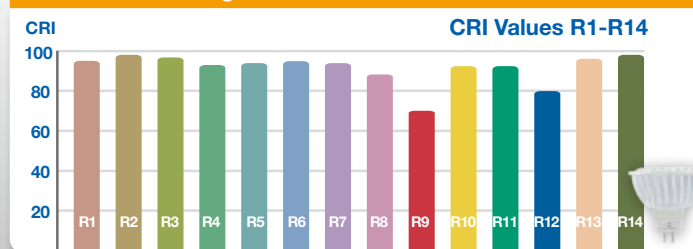

- Most efficient high CRI MR16 75W halogen replacement
- Exceptional color rendering CRI 92
- Richer reds and natural skin tones (R9 70, R13 96)
- Suitable for use in totally enclosed fixtures

SPECIFICATIONS

Model	Product	CCT	Lumens (lm)	Equiv.	LPW	Beam Angle	CBCP (cd)	CRI (typ.)	Dim	Life (hrs)	Voltage	Encl.	Energy Star	
MR16 7.5W	7.5MR16G4DIM/927SP15	40804	2700K	410	75W	55	15°	5500	92	Yes	25,000	12V	Yes	✓
	7.5MR16G4DIM/927NF25	40805	2700K	485	75W	63	25°	2600	92	Yes	25,000	12V	Yes	✓
	7.5MR16G4DIM/927FL36	40806	2700K	485	75W	63	36°	1400	92	Yes	25,000	12V	Yes	✓
	7.5MR16G4DIM/930SP15	40807	3000K	430	75W	57	15°	5500	92	Yes	25,000	12V	Yes	✓
	7.5MR16G4DIM/930NF25	40808	3000K	505	75W	66	25°	2600	92	Yes	25,000	12V	Yes	✓
	7.5MR16G4DIM/930FL36	40809	3000K	505	75W	66	36°	1400	92	Yes	25,000	12V	Yes	✓
	7.5MR16G4DIM/840SP15	40810	4000K	485	75W	65	15°	5700	82	Yes	25,000	12V	Yes	✓
	7.5MR16G4DIM/840NF25	40811	4000K	625	75W	81	25°	2800	82	Yes	25,000	12V	Yes	✓
	7.5MR16G4DIM/840FL36	40812	4000K	625	75W	81	36°	1600	82	Yes	25,000	12V	Yes	✓
MR16 7W	7MR16G3DIM/827NF25	95339	2700K	500	45W	71	25°	2325	80	Yes	25,000	12V	No	✓
	7MR16G3DIM/840NF25	95341	4000K	550	50W	79	25°	2400	80	Yes	25,000	12V	No	✓
MR16 7W	7MR16G4DIM/827FL36	40758	2700K	525	50W	75	36°	1255	80	Yes	25,000	12V	Yes	✓
	7MR16G4DIM/830FL36	40759	3000K	560	50W	80	36°	1265	80	Yes	25,000	12V	Yes	✓
	7MR16G4DIM/840FL36	40760	4000K	580	50W	83	36°	1285	80	Yes	25,000	12V	Yes	✓

SPECIFICATIONS

Model	Product	CCT	Lumens (lm)	Equiv.	LPW	Beam Angle	CBCP (cd)	CRI (typ.)	Dim	Life (hrs)	Voltage	Encl.	Energy Star	
MR16 6W	6MR16G4DIM/827FL36	40755	2700K	425	35W	71	36°	900	80	Yes	25,000	12V	Yes	✓
	6MR16G4DIM/830FL36	40756	3000K	450	35W	75	36°	925	80	Yes	25,000	12V	Yes	✓
GU10 6W	6GU10G4DIM/827FL36	40716	2700K	425	50W	71	36°	900	80	Yes	25,000	120V	Yes	✓
	6GU10G4DIM/830FL36	40717	3000K	450	50W	75	36°	925	80	Yes	25,000	120V	Yes	✓
PAR16 6W	6PAR16G4DIM/827FL36	40723	2700K	425	60W	71	36°	900	80	Yes	25,000	120V	Yes	✓
	6PAR16G4DIM/830FL36	40724	3000K	450	60W	75	36°	925	80	Yes	25,000	120V	Yes	✓
MR11 3W	3MR11G4/827NF30	40713	2700K	200	20W	67	30°	600	80	No	25,000	12V	Yes	N.A.
	3MR11G4/840NF30	40715	4000K	220	20W	73	30°	620	80	No	25,000	12V	Yes	N.A.

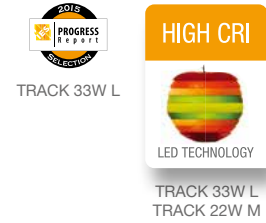

Interchangeable Lens Options (TRACK L & M)

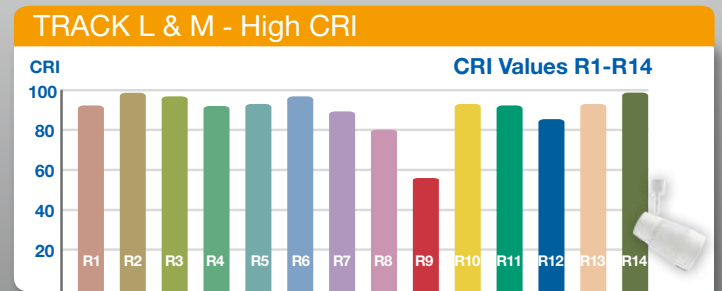
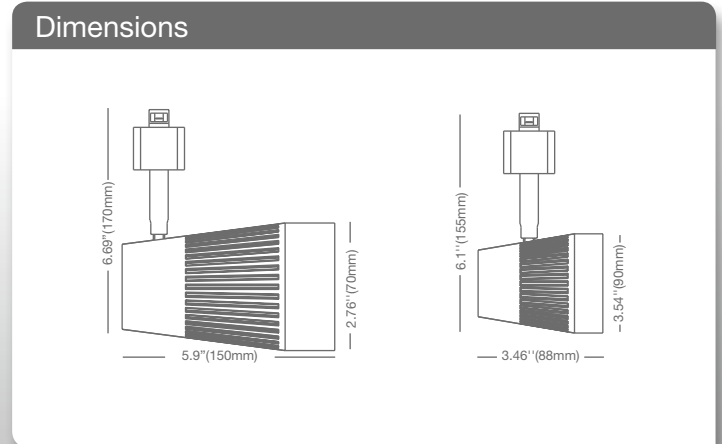
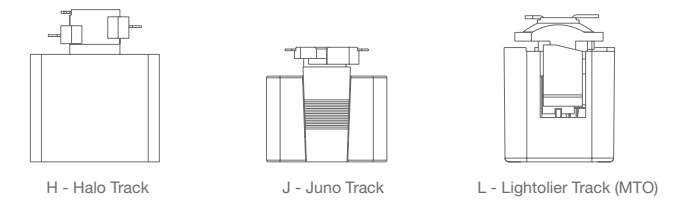
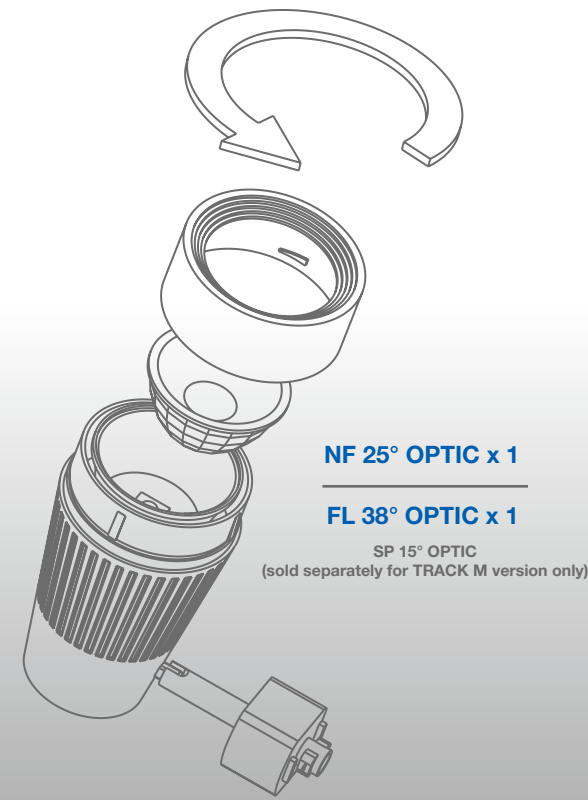

- Exceptional color rendering CRI 90
- Tight LED binning – 4-step Macadam ellipse
- Sleek design, integrated driver
- NF & FL optics ship with TRL & TRM versions

SPECIFICATIONS

	Model	Product	CCT	Lumens (lm)	Equiv.	LPW	Beam Angle	CBCP (cd)	CRI (typ.)	Dim	Life (hrs)	Voltage	ENERGY STAR
TRL 33W	33TRLG4DIM/927/W/H	97623	2700K	2200	39W HID	65	25°/38°	10,000/5150	90	Yes	40,000	120V	✓
	33TRLG4DIM/930/W/H	97629	3000K	2300	39W HID	68	25°/38°	10,350/5250	90	Yes	40,000	120V	✓
	33TRLG4DIM/927/W/J	97624	2700K	2200	39W HID	65	25°/38°	10,000/5150	90	Yes	40,000	120V	✓
	33TRLG4DIM/930/W/J	97630	3000K	2300	39W HID	68	25°/38°	10,350/5250	90	Yes	40,000	120V	✓
	33TRLG4DIM/927/B/H •	97626	2700K	2200	39W HID	65	25°/38°	10,000/5150	90	Yes	40,000	120V	✓
	33TRLG4DIM/930/B/H •	97632	3000K	2300	39W HID	68	25°/38°	10,350/5250	90	Yes	40,000	120V	✓
	33TRLG4DIM/927/B/J •	97627	2700K	2200	39W HID	65	25°/38°	10,000/5150	90	Yes	40,000	120V	✓
	33TRLG4DIM/930/B/J •	97633	3000K	2300	39W HID	68	25°/38°	10,350/5250	90	Yes	40,000	120V	✓
TRM 22W	22TRMG4DIM/927/W/H	97587	2700K	1200	20W HID	55	25°/38°/15°	6300/3250/12,200	90	Yes	40,000	120V	✓
	22TRMG4DIM/930/W/H	97599	3000K	1250	20W HID	57	25°/38°/15°	6700/3450/13,000	90	Yes	40,000	120V	✓
	22TRMG4DIM/927/W/J	97588	2700K	1200	20W HID	55	25°/38°/15°	6300/3250/12,200	90	Yes	40,000	120V	✓
	22TRMG4DIM/930/W/J	97600	3000K	1250	20W HID	57	25°/38°/15°	6700/3450/13,000	90	Yes	40,000	120V	✓
	22TRMG4DIM/927/B/H •	97590	2700K	1200	20W HID	55	25°/38°/15°	6300/3250/12,200	90	Yes	40,000	120V	✓
	22TRMG4DIM/930/B/H •	97602	3000K	1250	20W HID	57	25°/38°/15°	6700/3450/13,000	90	Yes	40,000	120V	✓
	22TRMG4DIM/927/B/J •	97591	2700K	1200	20W HID	55	25°/38°/15°	6300/3250/12,200	90	Yes	40,000	120V	✓
	22TRMG4DIM/930/B/J •	97603	3000K	1250	20W HID	57	25°/38°/15°	6700/3450/13,000	90	Yes	40,000	120V	✓

* The J and L type adaptors are compatible with single or two-circuit track types. The H type adaptor is only compatible with single-circuit track types
 • Black finish

SPECIFICATIONS

	Model	Product	CCT	Lumens (lm)	Equiv.	LPW	Beam Angle	CBCP (cd)	CRI (typ.)	Dim	Life (hrs)	Voltage	ENERGY STAR
TRS 8W	8TRSG4DIM/827NF30/W/H	16340	2700K	600	75W Hal	68	30°	1905	80	Yes	40,000	120V	✓
	8TRSG4DIM/830NF30/W/H	16346	3000K	625	75W Hal	71	30°	1950	80	Yes	40,000	120V	✓
	8TRSG4DIM/827NF30/W/J	16341	2700K	600	75W Hal	68	30°	1905	80	Yes	40,000	120V	✓
	8TRSG4DIM/830NF30/W/J	16347	3000K	625	75W Hal	71	30°	1950	80	Yes	40,000	120V	✓
	8TRSG4DIM/827NF30/B/H •	16343	2700K	600	75W Hal	68	30°	1905	80	Yes	40,000	120V	✓
	8TRSG4DIM/830NF30/B/H •	16349	3000K	625	75W Hal	71	30°	1950	80	Yes	40,000	120V	✓
	8TRSG4DIM/827NF30/B/J •	16344	2700K	600	75W Hal	68	30°	1905	80	Yes	40,000	120V	✓
	8TRSG4DIM/830NF30/B/J •	16350	3000K	625	75W Hal	71	30°	1950	80	Yes	40,000	120V	✓

* The J and L type adaptors are compatible with single or two-circuit track types. The H type adaptor is only compatible with single-circuit track types
 • Black finish



Dual Installation & High CRI



Seamless Installation

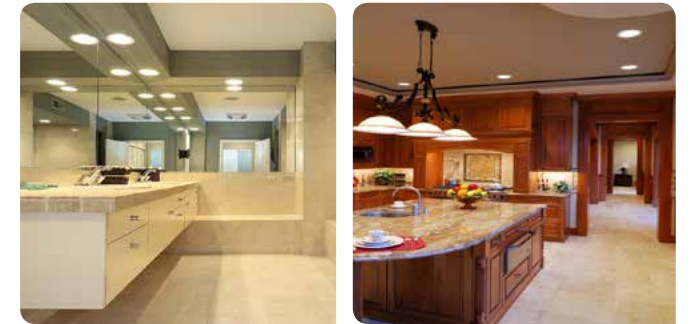

CLICK 6" - High CRI

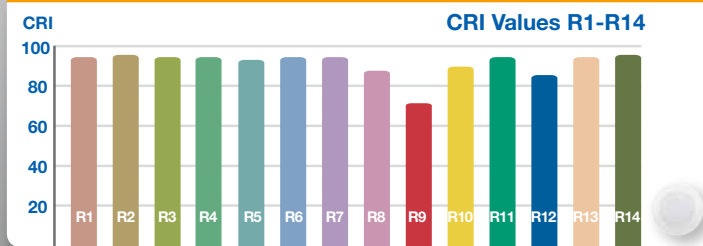

- Compatible with 4" J-boxes
- Also compatible with 5-6" recessed cans
- Installs in just minutes – No rewiring
- GU24 connector available

SPECIFICATIONS

Model	Product	CCT	Lumens (lm)	Equiv.	LPW	Beam Angle	CBCP (cd)	CRI (typ.)	Dim	Life (hrs)	Voltage	Encl.	Energy Star	
 SMDL 6" 14.5W	14.5SMDL6G4DIM/927	40842	2700K	950	85W	66	110°	N.A.	90	Yes	40,000	120V	No	✓
	14.5SMDL6G4DIM/930	40843	3000K	950	85W	66	110°	N.A.	90	Yes	40,000	120V	No	✓
	14.5SMDL6G4DIM/840	40847	4000K	1150	100W	79	110°	N.A.	80	Yes	40,000	120V	No	✓

INSTALLATION GUIDE

CLICK 6"

4" J-BOX FLUSHMOUNT

- Attach mounting bracket to J-box
- Click downlight into mounting bracket

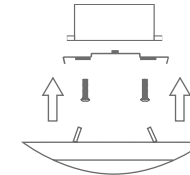

5-6" RECESSED CAN

- Connect E26 adapter to the LED adapter
- Squeeze mounting springs and push downlight up until flush with ceiling

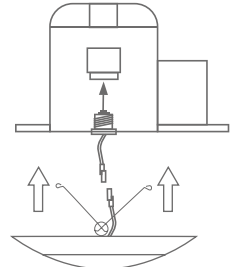

ACCESSORIES



6" Mounting Bracket



6" Mounting Springs



J-Box Screws



LED Adapter



E26 Adapter

* GU24 connector available



**T24
2013**

DL 6" 16W
DL 5-6" 12W
DL 4" 12W



DL 6" 16W
DL 5-6" 12W
DL 4" 12W

HIGH CRI



DL 6" 16W
DL 5-6" 12W
DL 4" 12W

Adjustable springs to fit 5-6" housings. High CRI versions rated for wet locations.

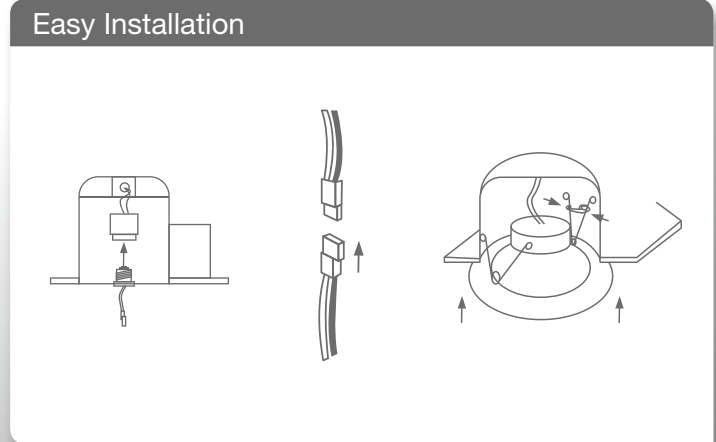

- Compatible with 5-6" and 4" housings
- Installs in just minutes – No rewiring
- High output 1150 lumen version
- High CRI versions rated for wet locations

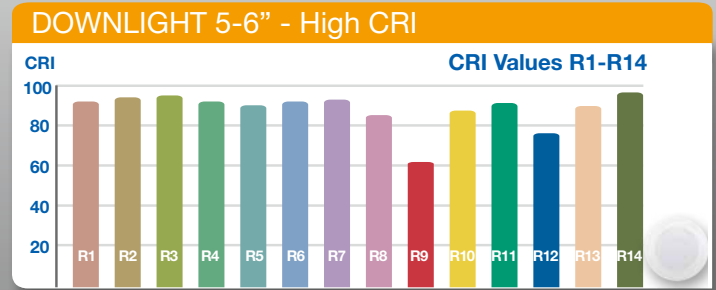

SPECIFICATIONS

Model	Product	CCT	Lumens (lm)	Equiv.	LPW	Beam Angle	CBCP (cd)	CRI (typ.)	Dim	Life (hrs)	Voltage	Wet		
DL 5-6" 17.5W	17.5DL6DIM/830	97760	3000K	1150	100W	65	100°	N.A.	80	Yes	35,000	120V	No	✓
	17.5DL6DIM/840	97761	4000K	1200	100W	68	100°	N.A.	80	Yes	35,000	120V	No	✓
DL 6" 16W	16DL6G3DIM/927	40710	2700K	800	75W	50	100°	N.A.	92	Yes	35,000	120V	No	✓
	16DL6G3DIM/930	40711	3000K	850	75W	53	100°	N.A.	92	Yes	35,000	120V	No	✓
DL 5-6" 12W	12DL6DIM/927	97765	2700K	720	65W	60	100°	N.A.	90	Yes	35,000	120V	Yes	✓
	12DL6DIM/930	97766	3000K	750	65W	63	100°	N.A.	90	Yes	35,000	120V	Yes	✓
DL 5-6" 10W	10DL6DIM/827	97756	2700K	700	65W	65	100°	N.A.	80	Yes	35,000	120V	No	✓
	10DL6DIM/830	97757	3000K	700	65W	65	100°	N.A.	80	Yes	35,000	120V	No	✓

* GU24 connector available

SPECIFICATIONS

Model	Product	CCT	Lumens (lm)	Equiv.	LPW	Beam Angle	CBCP (cd)	CRI (typ.)	Dim	Life (hrs)	Voltage	Wet		
DL 4" 12W	12DL4DIM/927	97762	2700K	600	50W	50	85°	N.A.	90	Yes	35,000	120V	Yes	✓
	12DL4DIM/930	97763	3000K	650	50W	54	85°	N.A.	90	Yes	35,000	120V	Yes	✓
DL 4" 12W	12DL4G3DIM/927	40712	2700K	600	50W	50	85°	N.A.	92	Yes	35,000	120V	No	✓

* GU24 connector available

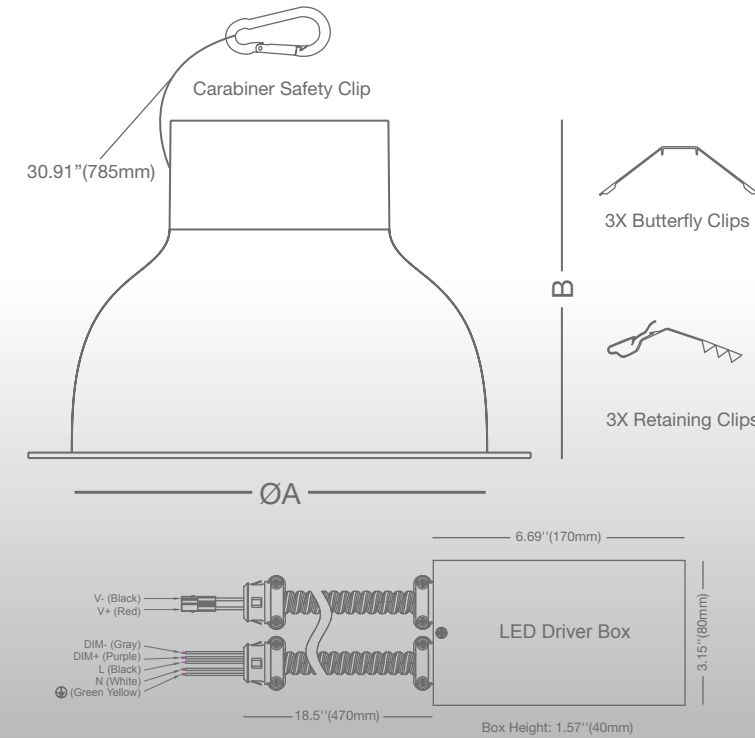

Dimensions		
Model No.:	A	B
48CDL9.5G4DIM/xxx/277V	9.25" (235mm)	6.50" (165mm)
32CDL8G4DIM/xxx/277V	7.80" (197mm)	5.90" (150mm)
22CDL6G4DIM/xxx/277V	6.02" (153mm)	5.39" (137mm)



- Fits existing architectural and commercial housing
- 0-10V dimming – Compatible with 120-277V circuits
- Easy installation – Quick connector and pre-wired conduit
- Superior savings and performance over CFL

SPECIFICATIONS

Model	Product	CCT	Lumens (lm)	Equiv.	LPW	Beam Angle	CBCP (cd)	CRI (typ.)	Dim	Life (hrs)	Voltage	Encl.		
	48CDL9.5G4DIM/830/277V	97706	3000K	3200	2 X 42W	67	90°	N.A.	80	Yes	40,000	120-277V	No	✓
	48CDL9.5G4DIM/835/277V	97707	3500K	3400	2 X 42W	71	90°	N.A.	80	Yes	40,000	120-277V	No	✓
	48CDL9.5G4DIM/840/277V	97708	4000K	3600	2 X 42W	75	90°	N.A.	80	Yes	40,000	120-277V	No	✓
	32CDL8G4DIM/830/277V	97696	3000K	2150	2 X 26W	67	90°	N.A.	80	Yes	40,000	120-277V	No	✓
	32CDL8G4DIM/835/277V	97697	3500K	2300	2 X 26W	72	90°	N.A.	80	Yes	40,000	120-277V	No	✓
	32CDL8G4DIM/840/277V	97698	4000K	2450	2 X 26W	77	90°	N.A.	80	Yes	40,000	120-277V	No	✓
	22CDL6G4DIM/830/277V	97686	3000K	1600	2 X 18W	73	90°	N.A.	80	Yes	40,000	120-277V	No	✓
	22CDL6G4DIM/835/277V	97687	3500K	1650	2 X 18W	75	90°	N.A.	80	Yes	40,000	120-277V	No	✓
	22CDL6G4DIM/840/277V	97688	4000K	1700	2 X 18W	77	90°	N.A.	80	Yes	40,000	120-277V	No	✓

INSTALLATION GUIDE

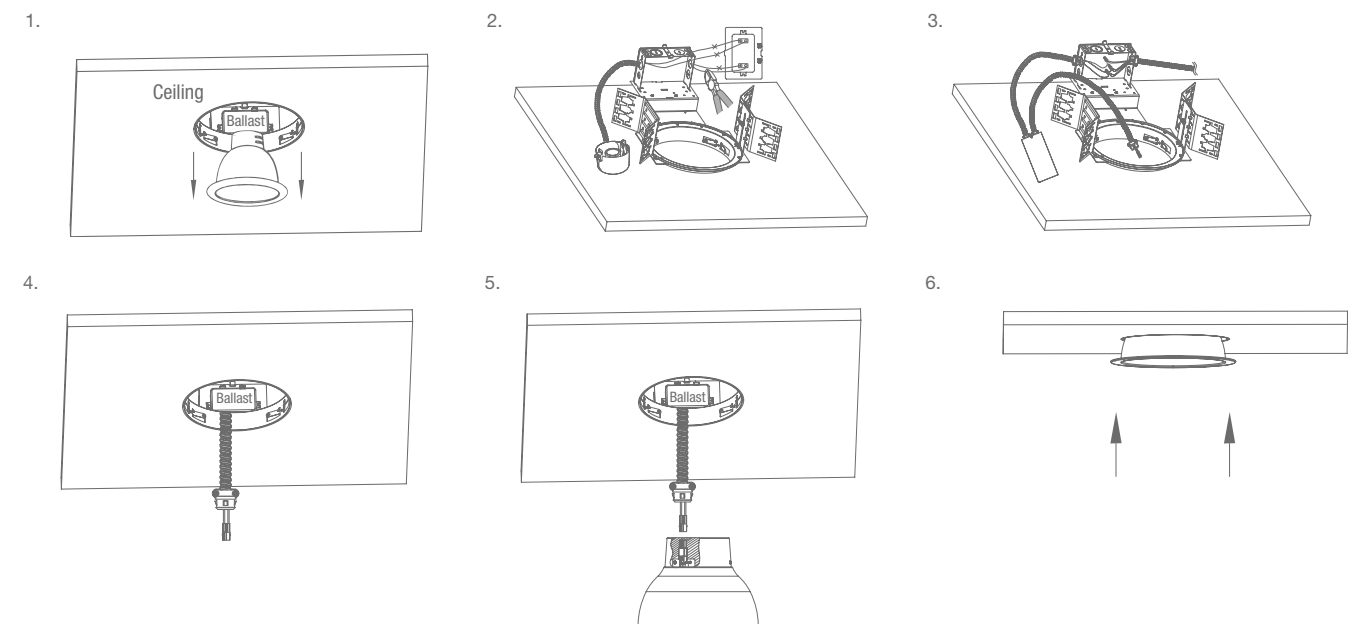



The adjustable housing clips allow for installation in a large range of commercial and architectural housings. These spring-action clips push up easily and fit securely for both retrofit and new construction installations.

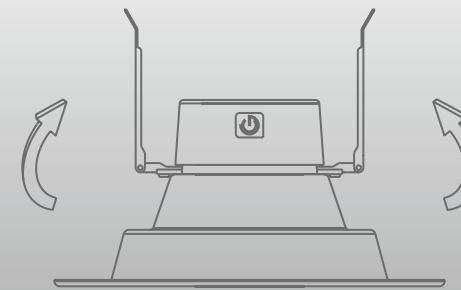
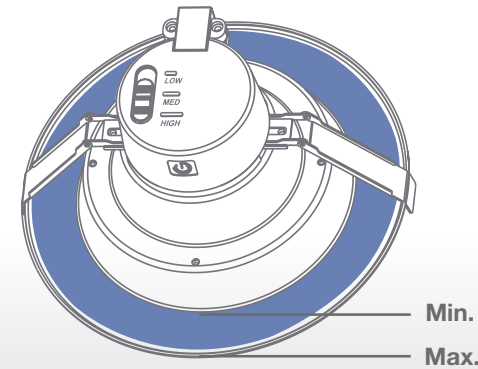

Housing Compatibility		
Model	Aperture Min.	Aperture Max.
9.5"	8.6" (220mm)	10.4" (265mm)
8"	7.6" (195mm)	9.4" (240mm)
6"	6.0" (153mm)	7.4" (190mm)
4"	3.9" (100mm)	5.1" (130mm)

Adjustable Lumen Output

- For retrofit or new construction installation
- Universal housing compatibility
- Adjustable lumen output – 3 defined light levels
- Easy fit installation – Spring-action housing clips

SPECIFICATIONS

Model	Product	CCT	Lumens (lm)	Equiv.	LPW	Beam Angle	CRI (typ.)	Dim	Life (hrs)	Voltage		
	45CDLA9.5/827/277V NEW!	57878	2700K	1860/2325/2975	23.5W - 1x42W/2x26W	79/73/76	110°	80	No	40,000	120-277V	Apr.
	45CDLA9.5/830/277V	57879	3000K	2000/2500/3200	32W - 1x57W/2x32W	85/78/71	110°	80	No	40,000	120-277V	Apr.
	45CDLA9.5/835/277V	57880	3500K	2000/2500/3200	45W - 2x42W	85/78/71	110°	80	No	40,000	120-277V	Apr.
	45CDLA9.5/840/277V	57881	4000K	2000/2500/3200		85/78/71	110°	80	No	40,000	120-277V	Apr.
	27CDLA8/827/277V NEW!	57873	2700K	930/1400/1860	12W - 1x26W/2x13W	78/74/69	110°	80	No	40,000	120-277V	✓
	27CDLA8/830/277V	57874	3000K	1000/1500/2000	19W - 1x32W/2x18W	83/79/74	110°	80	No	40,000	120-277V	✓
	27CDLA8/835/277V	57875	3500K	1000/1500/2000	27W - 1x42W/2x26W	83/79/74	110°	80	No	40,000	120-277V	✓
	27CDLA8/840/277V	57876	4000K	1000/1500/2000		83/79/74	110°	80	No	40,000	120-277V	✓
	21CDLA6/827/277V NEW!	57868	2700K	650/930/1400	8.5W - 1x18W	76/69/67	110°	80	No	40,000	120-277V	✓
	21CDLA6/830/277V	57869	3000K	700/1000/1500	13.5W - 1x26W/2x13W	82/74/71	110°	80	No	40,000	120-277V	✓
	21CDLA6/835/277V	57870	3500K	700/1000/1500	21W - 1x32W/2x18W	82/74/71	110°	80	No	40,000	120-277V	✓
	21CDLA6/840/277V	57871	4000K	700/1000/1500		82/74/71	110°	80	No	40,000	120-277V	✓
	14CDLA4/827/277V NEW!	57863	2700K	465/650/930	6W - 1x13W	78/72/66	110°	80	No	40,000	120-277V	Apr.
	14CDLA4/830/277V	57864	3000K	500/700/1000	9W - 1x18W	83/78/71	110°	80	No	40,000	120-277V	Apr.
	14CDLA4/835/277V	57865	3500K	500/700/1000	14W - 1x26W/2x13W	83/78/71	110°	80	No	40,000	120-277V	Apr.
	14CDLA4/840/277V	57866	4000K	500/700/1000		83/78/71	110°	80	No	40,000	120-277V	Apr.

SIMPLE RETROFIT OR ECONOMICAL NEW CONSTRUCTION INSTALLATION

Retrofit Installation

New Construction Installation

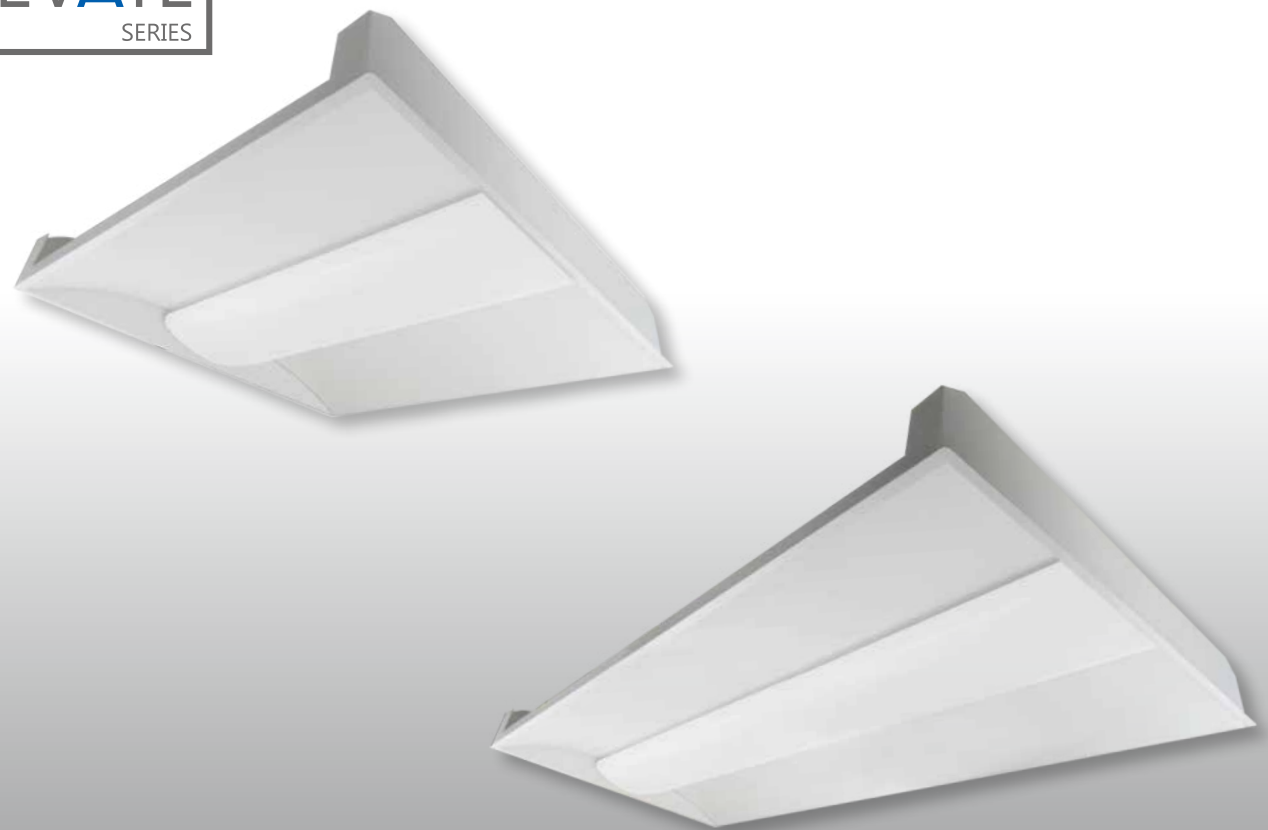

Easy Installation for New Construction or Retrofit

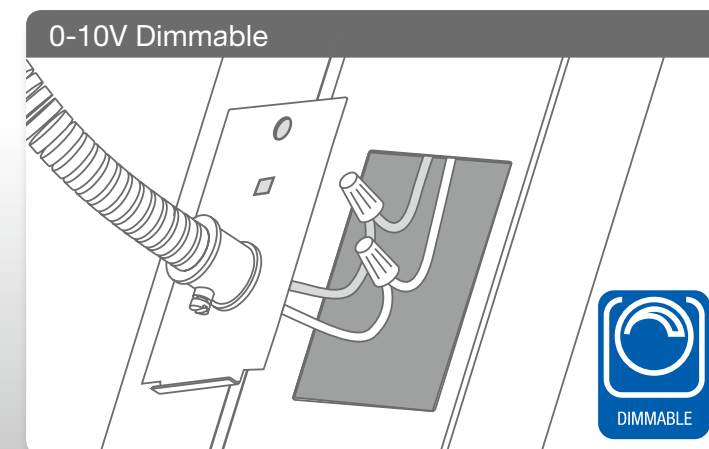
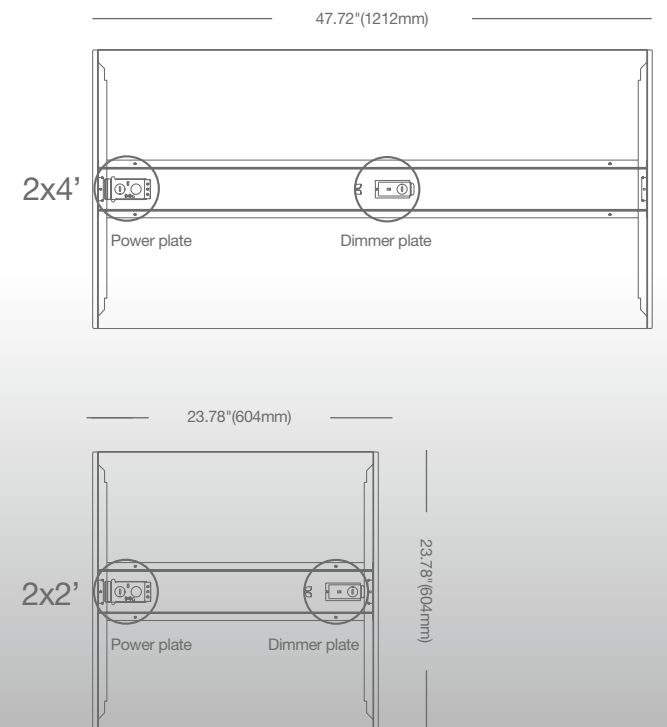

- Exceptional efficacy meets DLC Premium requirements
- 0-10V dimming – Compatible with 120-277V circuits
- High performance lighting distribution and low glare lens
- A practical solution for replacing fluorescent tubes

SPECIFICATIONS

Model	Product	CCT	Lumens (lm)	LPW	Beam Angle	CBCP (cd)	CRI (typ.)	Dim	Life (hrs)	Voltage	DLC LISTED	
TROFFER 2X4' 40W	40TROF24DIM/835/277V	97792	3500K	4400	111	120°	N.A.	80	Yes	50,000	120-277V	✓
	40TROF24DIM/840/277V	97793	4000K	4400	111	120°	N.A.	80	Yes	50,000	120-277V	✓
TROFFER 2X2' 32W	32TROF22DIM/835/277V	97788	3500K	3550	111	120°	N.A.	80	Yes	50,000	120-277V	✓
	32TROF22DIM/840/277V	97789	4000K	3550	111	120°	N.A.	80	Yes	50,000	120-277V	✓

INSTALLATION GUIDE

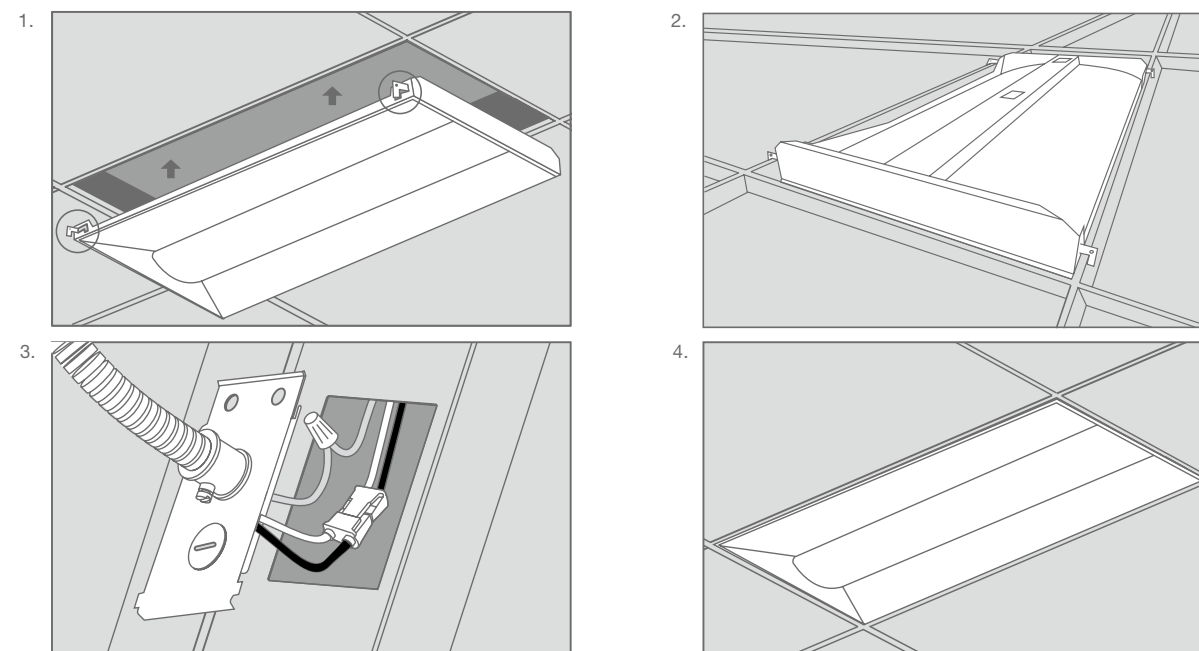



Universally compatible to upgrade 2x2' and 2x4' troffers and louvers while continuing to utilize the existing luminaire housing.

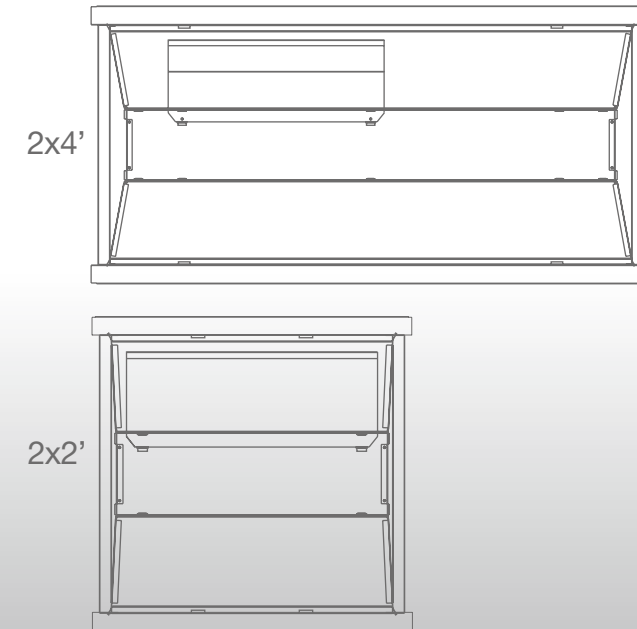

Housing	Retrofit Kit Dimensions (w/ brackets)	Retrofit Kit Dimensions (w/o brackets)
2x4'	47.83"x24.02"x2.76"(1215x610x70mm)	46.65"x20.59"x2.76"(1185x523x70mm)
2x2'	23.90"x23.90"x2.76"(607x607x70mm)	22.44"x20.59"x2.76"(570x523x70mm)

- Easy installation – Installs in 3-5 minutes
- Door retrofit kit upgrades troffers and louvers
- Exceptional efficacy meets DLC Premium requirements
- 0-10V dimming – Compatible with 120-277V circuits

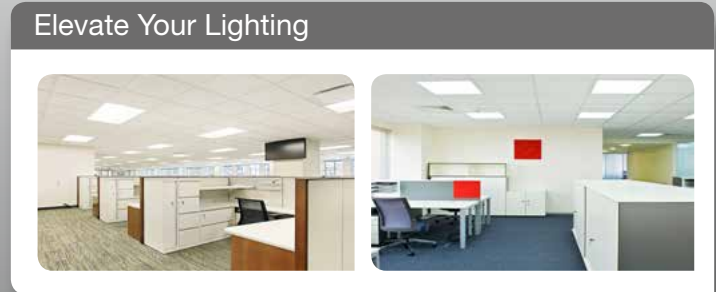

SPECIFICATIONS

Model	Product	CCT	Lumens (lm)	LPW	Beam Angle	CBCP (cd)	CRI (typ.)	Dim	Life (hrs)	Voltage	DLC	
TROFFER RETROFIT KIT 2X4' 36W	36TROFKIT24DIM/830/277V (MTO) NEW!	97799	3000K	4000	111	120°	N.A.	80	Yes	50,000	120-277V	✓
	36TROFKIT24DIM/835/277V	97800	3500K	4000	111	120°	N.A.	80	Yes	50,000	120-277V	✓
	36TROFKIT24DIM/840/277V	97801	4000K	4150	115	120°	N.A.	80	Yes	50,000	120-277V	✓
TROFFER RETROFIT KIT 2X2' 30W	30TROFKIT22DIM/830/277V (MTO) NEW!	97795	3000K	3330	111	120°	N.A.	80	Yes	50,000	120-277V	✓
	30TROFKIT22DIM/835/277V	97796	3500K	3330	111	120°	N.A.	80	Yes	50,000	120-277V	✓
	30TROFKIT22DIM/840/277V	97797	4000K	3330	111	120°	N.A.	80	Yes	50,000	120-277V	✓

INSTALLATION GUIDE

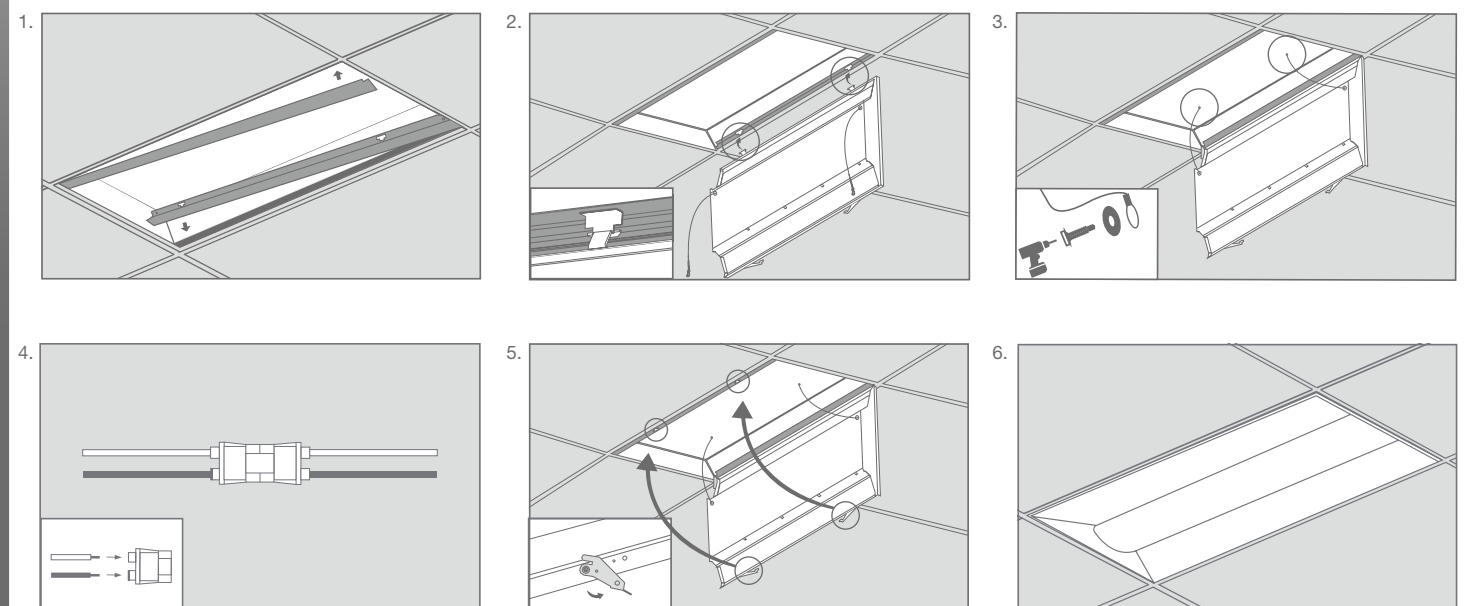



DIRect

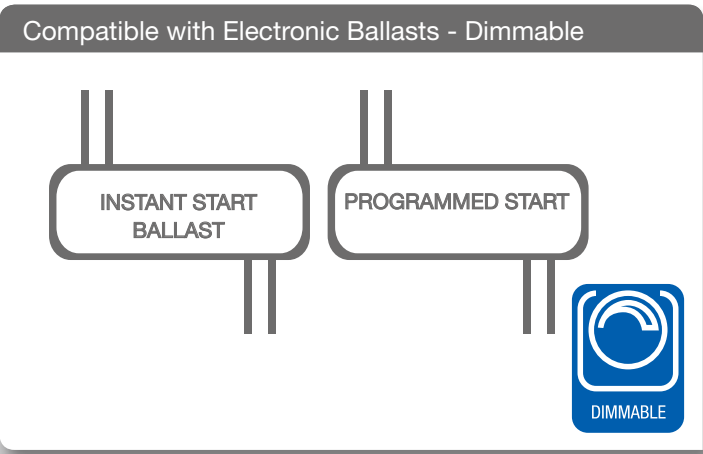

- Easy to install – Plug and Play Direct
- Instant Start & Programmed Start ballast compatible
- Suitable for use in totally enclosed fixtures
- Dimmable



BYPass

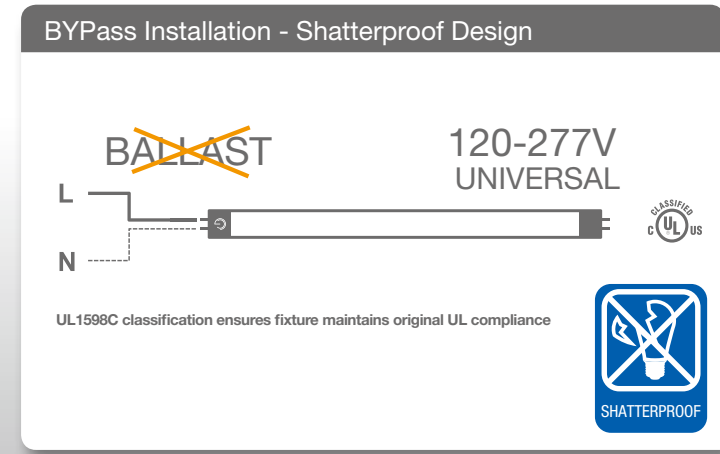

- Built-in universal voltage driver – Bypass installation
- Wide beam design 310° light emitting area
- Suitable for use in totally enclosed fixtures
- Shatterproof design – Meets NSF requirements

SPECIFICATIONS

Model	Product	CCT	Lumens (lm)	Equiv.	LPW	Beam Angle	CBCP (cd)	CRI (typ.)	Dim	Life (hrs)	Voltage	Encl.	DLC	
T8 15W 4FT. DIR	15T8/4F/840/DIR	97833	4000K	2050	32W	137	180°	N.A.	80	Yes	50,000	120-277V	Yes	✓
	15T8/4F/850/DIR	97834	5000K	2050	32W	137	180°	N.A.	80	Yes	50,000	120-277V	Yes	✓
T8 12W 4FT. DIR	12T8/4F/830/DIR	97737	3000K	1600	32W	133	180°	N.A.	80	Yes	50,000	120-277V	Yes	✓
	12T8/4F/835/DIR	97738	3500K	1600	32W	133	180°	N.A.	80	Yes	50,000	120-277V	Yes	✓
	12T8/4F/840/DIR	97739	4000K	1650	32W	138	180°	N.A.	80	Yes	50,000	120-277V	Yes	✓
	12T8/4F/850/DIR	97740	5000K	1650	32W	138	180°	N.A.	80	Yes	50,000	120-277V	Yes	✓
T8 10W 3FT. DIR	10T8/3F/830/DIR	57828	3000K	1100	25W	110	180°	N.A.	80	Yes	50,000	120-277V	Yes	N.A.
	10T8/3F/835/DIR	57829	3500K	1100	25W	110	180°	N.A.	80	Yes	50,000	120-277V	Yes	N.A.
	10T8/3F/840/DIR	57830	4000K	1150	25W	115	180°	N.A.	80	Yes	50,000	120-277V	Yes	N.A.
T8 8W 2FT. DIR	8T8/2F/830/DIR	97741	3000K	1050	17W	131	180°	N.A.	80	Yes	50,000	120-277V	Yes	✓
	8T8/2F/835/DIR	97742	3500K	1050	17W	131	180°	N.A.	80	Yes	50,000	120-277V	Yes	✓
	8T8/2F/840/DIR	97743	4000K	1100	17W	138	180°	N.A.	80	Yes	50,000	120-277V	Yes	✓
	10T8G4/2F/850/DIR	40803	5000K	1100	17W	110	140°	N.A.	80	No	50,000	120-277V	Yes	N.A.
T8 U-BENT 16W DIR	16T8U6G4/830/DIR	40707	3000K	1650	32W	103	160°	N.A.	80	No	50,000	120-277V	Yes	N.A.
	16T8U6G4/840/DIR	40848	4000K	1800	32W	113	160°	N.A.	80	No	50,000	120-277V	Yes	N.A.
	16T8U6G4/850/DIR	40849	5000K	1800	32W	113	160°	N.A.	80	No	50,000	120-277V	Yes	N.A.
T5 24W HO 4FT. DIR	24T5HO/4F/830/DIR	57836	3000K	3000	54W	107	120°	N.A.	80	Yes	50,000	120-277V	Yes	✓
	24T5HO/4F/835/DIR	57837	3500K	3000	54W	107	120°	N.A.	80	Yes	50,000	120-277V	Yes	✓
	24T5HO/4F/840/DIR	57838	4000K	3050	54W	109	120°	N.A.	80	Yes	50,000	120-277V	Yes	✓
	24T5HO/4F/850/DIR	57839	5000K	3200	54W	114	120°	N.A.	80	Yes	50,000	120-277V	Yes	✓
T5 15W HE 4FT. DIR	15T5HE/4F/830/DIR	57859	3000K	1700	28W	113	120°	N.A.	80	Yes	50,000	120-277V	Yes	N.A.
	15T5HE/4F/835/DIR	57860	3500K	1750	28W	117	120°	N.A.	80	Yes	50,000	120-277V	Yes	N.A.

* U-BENT and 10T8G4 DIR are non-dimmable and only compatible with Instant Start ballasts
 ** T8 DIR lamps are not shatterproof

SPECIFICATIONS

Model	Product	CCT	Lumens (lm)	Equiv.	LPW	Beam Angle	CBCP (cd)	CRI (typ.)	Dim	Life (hrs)	Voltage	Encl.	DLC	
T8 17.5W 4FT. BYP	17.5T8/4F/840/BYP	97829	4000K	2000	32W	114	160°	N.A.	80	No	50,000	120-277V	Yes	✓
	17.5T8/4F/850/BYP	97830	5000K	2000	32W	114	160°	N.A.	80	No	50,000	120-277V	Yes	✓
T8 14.5W 4FT. BYP	14.5T8/4F/830/BYP	97720	3000K	1600	32W	110	160°	N.A.	80	No	50,000	120-277V	Yes	✓
	14.5T8/4F/835/BYP	97721	3500K	1650	32W	114	160°	N.A.	80	No	50,000	120-277V	Yes	✓
	14.5T8/4F/840/BYP	97722	4000K	1700	32W	117	160°	N.A.	80	No	50,000	120-277V	Yes	✓
	14.5T8/4F/850/BYP	97723	5000K	1700	32W	117	160°	N.A.	80	No	50,000	120-277V	Yes	✓
T8 8.5W 2FT. BYP	8.5T8/2F/830/BYP	97724	3000K	900	17W	106	160°	N.A.	80	No	50,000	120-277V	Yes	✓
	8.5T8/2F/835/BYP	97725	3500K	950	17W	112	160°	N.A.	80	No	50,000	120-277V	Yes	✓
	8.5T8/2F/840/BYP	97726	4000K	1000	17W	118	160°	N.A.	80	No	50,000	120-277V	Yes	✓
	9T8G4/2F/850/BYP	40789	5000K	1000	17W	111	180°	N.A.	80	No	50,000	120-277V	Yes	✓
T8 17.5W 4FT. BYP	17.5T8/4F/GOLD/BYP	57840	N.A.	1100	32W	63	160°	N.A.	80	No	50,000	120-277V	Yes	N.A.

* T8 17.5W BYP GOLD is designed for clean room applications and protects against harmful UV rays
 ** 9T8G4 BYP lamps are not shatterproof and do not meet NSF requirements



Support Clip Included

Extra Wide Beam Design - Compact Driver Technology



Compatible with Electronic Ballasts - Dimmable



- Easy to install – Plug & Play Direct
- Instant Start & Programmed Start ballast compatible
- Suitable for use in totally enclosed fixtures
- 0-10V dimming

SPECIFICATIONS

Model	Product	CCT	Lumens (lm)	Equiv.	LPW	Beam Angle	CBCP (cd)	CRI (typ.)	Dim	Life (hrs)	Voltage	Encl.	
<p>PLL 17W DIR</p>	NEW! 17PLL/830/DIR	97745	3000K	2000	40W	118	120°	N.A.	80	Yes	50,000	120-277V	Yes
	17PLL/835/DIR	97746	3500K	2050	40W	121	120°	N.A.	80	Yes	50,000	120-277V	Yes
	17PLL/840/DIR	97747	4000K	2100	40W	124	120°	N.A.	80	Yes	50,000	120-277V	Yes
<p>PLL 14.5W DIR</p>	NEW! 14.5PLL/835/DIR	97750	3500K	1550	36W	107	120°	N.A.	80	Yes	50,000	120-277V	Yes

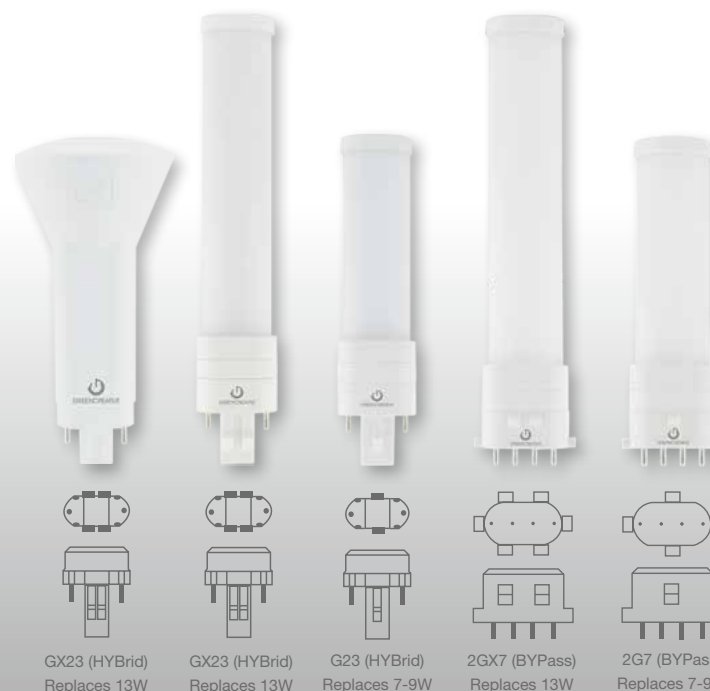

GX23 (HYBrid) Replaces 13W
 GX23 (HYBrid) Replaces 13W
 G23 (HYBrid) Replaces 7-9W
 2GX7 (BYPass) Replaces 13W
 2G7 (BYPass) Replaces 7-9W

- HYBrid installation versions - DIRect or BYPass
- BYPass installation versions require bypassing the ballast
- Suitable for use in totally enclosed fixtures
- Lasts 4 times longer than CFL

Extra Wide Beam Design - 180° Rotatable Base



PLS V GX23 - Designed for Vertical Applications



GREEN CREATIVE PLS V LED Lamp

Other PLS LED Lamp

SPECIFICATIONS

Model	Product	CCT	Lumens (lm)	Equiv.	LPW	Beam Angle	CBCP (cd)	CRI (typ.)	Dim	Life (hrs)	Voltage	Encl.	
<p>PLSV 7W HYB GX23</p>	NEW! 7PLSV/827/HYB/GX23	57931	2700K	550	13W	79	120°	N.A.	80	No	40,000	120-277V	No
	7PLSV/830/HYB/GX23	57932	3000K	550	13W	79	120°	N.A.	80	No	40,000	120-277V	No
	7PLSV/835/HYB/GX23	57933	3500K	560	13W	80	120°	N.A.	80	No	40,000	120-277V	No
<p>PLS 5.5W HYB GX23</p>	7PLSV/840/HYB/GX23	57934	4000K	570	13W	81	120°	N.A.	80	No	40,000	120-277V	No
	NEW! 5.5PLS/827/HYB/GX23	57820	2700K	450	13W	82	120°	N.A.	80	No	40,000	120-277V	Yes
	5.5PLS/830/HYB/GX23	57821	3000K	500	13W	91	120°	N.A.	80	No	40,000	120-277V	Yes
<p>PLS 5.5W BYP 2GX7</p>	5.5PLS/835/HYB/GX23	57822	3500K	500	13W	91	120°	N.A.	80	No	40,000	120-277V	Yes
	5.5PLS/840/HYB/GX23	57823	4000K	520	13W	95	120°	N.A.	80	No	40,000	120-277V	Yes
	NEW! 3.5PLS/835/HYB/G23	57814	3500K	300	7-9W	86	120°	N.A.	80	No	40,000	120-277V	Yes
<p>PLS 5.5W BYP 2GX7</p>	NEW! 5.5PLS/835/BYP/2GX7	57826	3500K	500	13W	91	120°	N.A.	80	No	40,000	120-277V	Yes
	NEW! 3.5PLS/835/BYP/2G7	57818	3500K	300	7-9W	86	120°	N.A.	80	No	40,000	120-277V	Yes

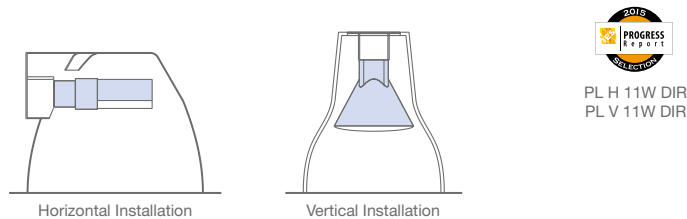

Patent Pending Design Patent Pending Design

High Performance - Ballast Smart Control		
Ballast Type	Lumens	Bare Lamp
13W	720	8W
18W	850	9.5W
26W	1000	11W



GREEN CREATIVE PL V LED Lamp Other PL V LED Lamp

- Easy to install – Plug & Play Direct
- For use with 13W, 18W, 26W, 32W & 42W electronic ballasts
- Ballast smart control technology
- Compatible with G24q/GX24q installations

SPECIFICATIONS													
	Model	Product	CCT	Lumens (lm)	Equiv.	LPW	Beam Angle	CBCP (cd)	CRI (typ.)	Dim	Life (hrs)	Voltage	Encl.
	11PLHG4/827/DIR	40817	2700K	850	26W	77	110°	N.A.	80	No	40,000	120-277V	No
	11PLHG4/830/DIR	40818	3000K	920	26W	84	110°	N.A.	80	No	40,000	120-277V	No
	11PLHG4/835/DIR	40819	3500K	950	26W	86	110°	N.A.	80	No	40,000	120-277V	No
	11PLHG4/840/DIR	40820	4000K	1000	26W	91	110°	N.A.	80	No	40,000	120-277V	No
	11PLHG4/850/DIR	40821	5000K	1000	26W	91	110°	N.A.	80	No	40,000	120-277V	No
	11PLHG4/930/DIR	40823	3000K	800	26W	73	110°	N.A.	90	No	40,000	120-277V	No
	11PLVG4/827/DIR	97669	2700K	875	26W	80	110°	N.A.	80	No	40,000	120-277V	No
	11PLVG4/830/DIR	97670	3000K	875	26W	80	110°	N.A.	80	No	40,000	120-277V	No
	11PLVG4/835/DIR	97671	3500K	900	26W	82	110°	N.A.	80	No	40,000	120-277V	No
	11PLVG4/840/DIR	97672	4000K	920	26W	84	110°	N.A.	80	No	40,000	120-277V	No
	11PLVG4/850/DIR	97673	5000K	940	26W	85	110°	N.A.	80	No	40,000	120-277V	No
	11PLVG4/930/DIR	97675	3000K	730	26W	66	110°	N.A.	90	No	40,000	120-277V	No

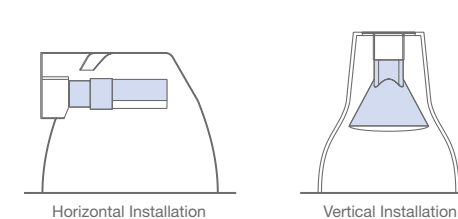

Patent Pending Design Patent Pending Design

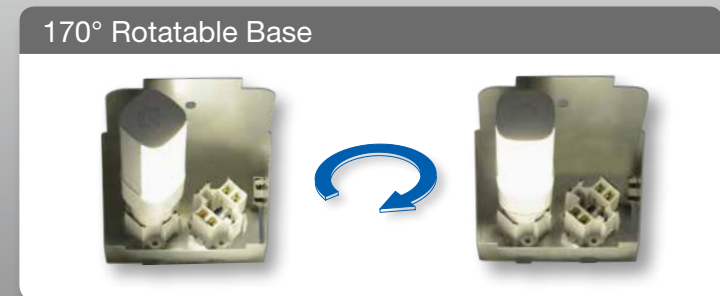
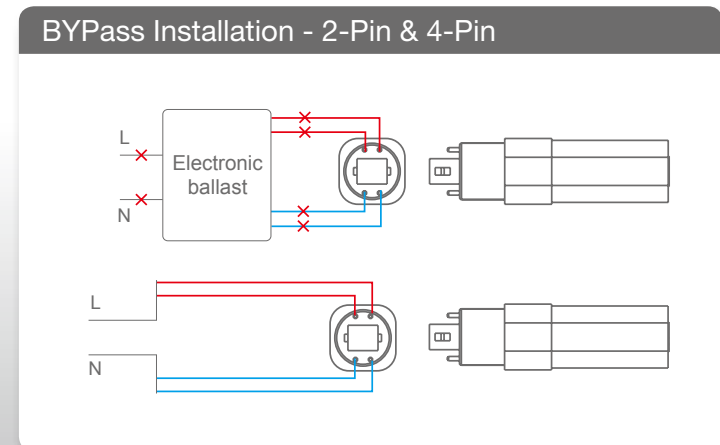

- Built-in universal voltage driver – Bypass installation
- Compatible with G24q/GX24q & G24d/GX24d installations
- High-quality diffuser for maximum light distribution
- Lasts 4 times longer than CFL

SPECIFICATIONS													
	Model	Product	CCT	Lumens (lm)	Equiv.	LPW	Beam Angle	CBCP (cd)	CRI (typ.)	Dim	Life (hrs)	Voltage	Encl.
	11PLHG4/835/BYP	40816	3500K	950	26W	86	110°	N.A.	80	No	40,000	120-277V	No
	11PLHG4/840/BYP	40826	4000K	1000	26W	91	110°	N.A.	80	No	40,000	120-277V	No
	11PLHG4/850/BYP	40827	5000K	1000	26W	91	110°	N.A.	80	No	40,000	120-277V	No
	11PLVG4/835/BYP	97681	3500K	900	26W	82	110°	N.A.	80	No	40,000	120-277V	No
	11PLVG4/840/BYP	97682	4000K	920	26W	84	110°	N.A.	80	No	40,000	120-277V	No



Optional Lamp Extender
Adds 1.30" (33mm) to lamp height
Dia. x MOL: 1.46"(37mm) x 2.36"(60mm)



Designed for Bollard & Post Top Applications

HID Replacement





**50-70W
HID**

120-277V

- Universal voltage 120-277V – Not compatible with ballasts
- ENERGY STAR® certified
- Optional lamp extender available for use in larger fixtures
- Suitable for use in totally enclosed fixtures

SPECIFICATIONS

Model	Product	CCT	Lumens (lm)	Equiv.	LPW	Beam Angle	CBCP (cd)	CRI (typ.)	Dim	Life (hrs)	Voltage	Encl.	ENERGY STAR	
 HID LED 18.5W HO 277V	18.5A21/830/277V	97734	3000K	2000	50-70W HID	108	330°	N.A.	80	No	40,000	120-277V	Yes	✓
	18.5A21/850/277V	97736	5000K	2050	50-70W HID	111	330°	N.A.	80	No	40,000	120-277V	Yes	✓
 E26 LAMP EXTENDER	E26 EXTENDER	16325	N.A.	N.A.	N.A.	N.A.	N.A.	N.A.	N.A.	N.A.	N.A.	N.A.	N.A.	N.A.



- Direct line voltage 120-277V – Not compatible with ballasts
- Designed for use in post top applications
- Compatible with EX39 & E39 sockets
- Suitable for use in totally enclosed fixtures

HID Replacement Values



LED	Lumen Output	MH	MV	HPS
120W	14,400	250W	400W	150W
80W	9600	175W	250W	100W
45W	5400	100W	175W	70W
27W	3200	70W	100W	50W

CoolSink Technology



The CoolSink passive cooling system allows air to flow freely through the lamp. This unique design helps to reduce the operating temperature of the LED and power supply, thus resulting in longer lamp life and lumen maintenance.

SPECIFICATIONS

Model	Product	CCT	Lumens (lm)	Equiv.	LPW	Beam Angle	CBCP (cd)	CRI (typ.)	Dim	Life (hrs)	Voltage	Encl.	DLC QUALIFIED	
 HID LED 120W	120HID/850/277V/EX39	57953	5000K	14,400	250-400W HID	120	320°	N.A.	80	No	50,000	120-277V	Yes	✓
	80HID/850/277V/EX39	57949	5000K	9600	175-250W HID	120	320°	N.A.	80	No	50,000	120-277V	Yes	✓
 HID LED 80W	45HID/830/277V/EX39	57938	3000K	5040	100-175W HID	112	320°	N.A.	80	No	50,000	120-277V	Yes	✓
	45HID/850/277V/EX39	57940	5000K	5400	100-175W HID	120	320°	N.A.	80	No	50,000	120-277V	Yes	✓
 HID LED 45W	27HID/830/277V/EX39	57935	3000K	3020	70-100W HID	112	320°	N.A.	80	No	50,000	120-277V	Yes	✓
	27HID/850/277V/EX39	57937	5000K	3200	70-100W HID	118	320°	N.A.	80	No	50,000	120-277V	Yes	✓



High CRI Version Available in E26 and GU24 Bases



Uses 35% Less Material than Previous Generation



- Revolutionary CLOUD design
- 60% lighter due to environmentally friendly construction
- BR30 high CRI & GU24 versions available
- Suitable for use in totally enclosed fixtures

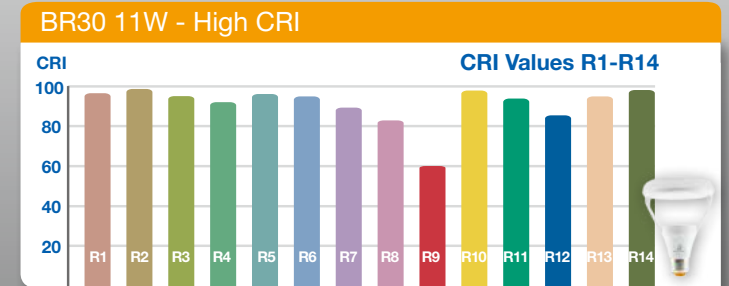

SPECIFICATIONS

Model	Product	CCT	Lumens (lm)	Equiv.	LPW	Beam Angle	CBCP (cd)	CRI (typ.)	Dim	Life (hrs)	Voltage	Encl.	Energy Star
BR40 14W	14BR40G4DIM/827	40636	2700K	1065	85W	76	110°	N.A.	82	Yes	25,000	120V	Yes ✓
	14BR40G4DIM/830	40637	3000K	1100	85W	79	110°	N.A.	82	Yes	25,000	120V	Yes ✓
BR40 9W	9BR40G4DIM/824	40626	2400K	650	65W	72	110°	N.A.	80	Yes	25,000	120V	Yes N.A.
	9BR40G4DIM/827	40627	2700K	700	65W	78	110°	N.A.	82	Yes	25,000	120V	Yes ✓
BR30 8W	8BR30G4DIM/824	40770	2400K	585	65W	73	110°	N.A.	80	Yes	25,000	120V	Yes N.A.
	8BR30G4DIM/827	40771	2700K	650	65W	81	110°	N.A.	82	Yes	25,000	120V	Yes ✓
	8BR30G4DIM/830	40772	3000K	685	65W	86	110°	N.A.	82	Yes	25,000	120V	Yes ✓
	8BR30G4DIM/840	40773	4000K	710	65W	89	110°	N.A.	82	Yes	25,000	120V	Yes ✓

SPECIFICATIONS

Model	Product	CCT	Lumens (lm)	Equiv.	LPW	Beam Angle	CBCP (cd)	CRI (typ.)	Dim	Life (hrs)	Voltage	Encl.	Energy Star
BR30 7.5W	7.5BR30G4/827	40774	2700K	650	65W	87	110°	N.A.	82	No	25,000	120V	Yes ✓
BR30 11W	11BR30G4DIM/927	40644	2700K	750	65W	68	110°	N.A.	92	Yes	25,000	120V	Yes ✓
BR30 11W GU24	11BR30G4DIM/927/GU24	40646	2700K	750	65W	68	110°	N.A.	92	Yes	25,000	120V	Yes ✓
R20 6.5W	6.5R20G4DIM/824	40611	2400K	450	45W	69	110°	N.A.	80	Yes	25,000	120V	Yes N.A.
	6.5R20G4DIM/827	40612	2700K	500	45W	77	110°	N.A.	82	Yes	25,000	120V	Yes ✓



Omnidirectional Lighting



A21 18.5W - High CRI

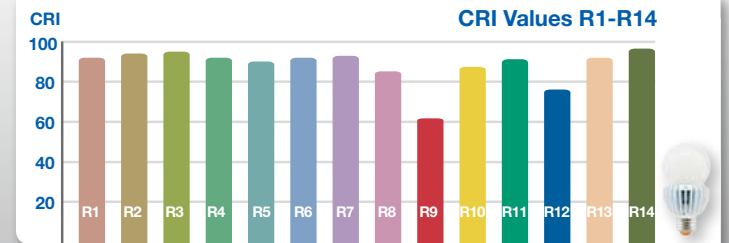

- A21 3-WAY with 3 defined lumen outputs
- GU24 base 100W & 60W replacements
- Enclosed fixture rated 100W & 75W replacements
- High CRI 100W & 75W replacements

SPECIFICATIONS

Model	Product	CCT	Lumens (lm)	Equiv.	LPW	Beam Angle	CBCP (cd)	CRI (typ.)	Dim	Life (hrs)	Voltage	Encl.	Energy Star	
A21 17W	17A21G4DIM/827	16179	2700K	1600	100W	94	330°	N.A.	80	Yes	25,000	120V	Yes	✓
	17A21G4DIM/830	16180	3000K	1650	100W	97	330°	N.A.	80	Yes	25,000	120V	Yes	✓
	17A21G4DIM/840	16181	4000K	1700	100W	100	330°	N.A.	80	Yes	25,000	120V	Yes	✓
A21 17W GU24	17A21DIM/827/GU24	16332	2700K	1600	100W	94	330°	N.A.	80	Yes	25,000	120V	Yes	✓
A19 12W	12A19G4DIM/827	16175	2700K	1100	75W	92	330°	N.A.	80	Yes	25,000	120V	Yes	✓
	12A19G4DIM/830	16176	3000K	1150	75W	96	330°	N.A.	80	Yes	25,000	120V	Yes	✓
	12A19G4DIM/840	16177	4000K	1180	75W	98	330°	N.A.	80	Yes	25,000	120V	Yes	✓
A19 8.5W	9A19G4DIM/824	40741	2400K	700	60W	78	300°	N.A.	80	Yes	25,000	120V	No	N.A.
	8.5A19DIM/827	57856	2700K	800	60W	94	330°	N.A.	80	Yes	25,000	120V	No	✓
	8.5A19DIM/830	57857	3000K	800	60W	94	330°	N.A.	80	Yes	25,000	120V	No	✓
	8.5A19DIM/840	57858	4000K	850	60W	100	330°	N.A.	80	Yes	25,000	120V	No	✓
A19 9W GU24	9A19DIM/827/GU24	57831	2700K	800	60W	84	300°	N.A.	80	Yes	25,000	120V	No	✓
	9A19DIM/830/GU24	57832	3000K	800	60W	84	300°	N.A.	80	Yes	25,000	120V	No	✓
	9A19DIM/840/GU24	57833	4000K	850	60W	89	300°	N.A.	80	Yes	25,000	120V	No	✓
A19 9.5W	9.5A19/827	97815	2700K	750	60W	79	160°	N.A.	80	No	25,000	120V	No	N.A.
A19 6W	6A19DIM/827	97731	2700K	450	40W	75	330°	N.A.	80	Yes	25,000	120V	No	✓
	6A19DIM/830	97732	3000K	450	40W	75	330°	N.A.	80	Yes	25,000	120V	No	✓

SPECIFICATIONS

Model	Product	CCT	Lumens (lm)	Equiv.	LPW	Beam Angle	CBCP (cd)	CRI (typ.)	Dim	Life (hrs)	Voltage	Encl.	Energy Star	
A21 18.5W	18.5A21DIM/927	16329	2700K	1600	100W	86	330°	N.A.	90	Yes	25,000	120V	Yes	✓
A21 3-WAY 5.5/10.5/17W	17A21G4/827/3WAY	16335	2700K	500	40W	91	330°	N.A.	80	No	25,000	120V	No	✓
				1600	100W	94								
A21 15W	15A21DIM/927	16326	2700K	1100	75W	73	330°	N.A.	90	Yes	25,000	120V	Yes	✓
A19 9W 277V	9A19G4/827/277V	40750	2700K	800	60W	89	300°	N.A.	80	No	25,000	120-277V	No	✓
	9A19G4/830/277V	40751	3000K	800	60W	89	300°	N.A.	80	No	25,000	120-277V	No	✓
	9A19G4/840/277V	40752	4000K	850	60W	94	300°	N.A.	80	No	25,000	120-277V	No	✓
A19 9W	9A19G4DIM/927	40746	2700K	800	60W	89	300°	N.A.	92	Yes	25,000	120V	No	✓
A19 11W GU24	11A19G4DIM/927/GU24	40739	2700K	800	60W	73	300°	N.A.	92	Yes	25,000	120V	No	✓



All Warm Dim Lamps Feature 2700K-2200K CCT Dimming

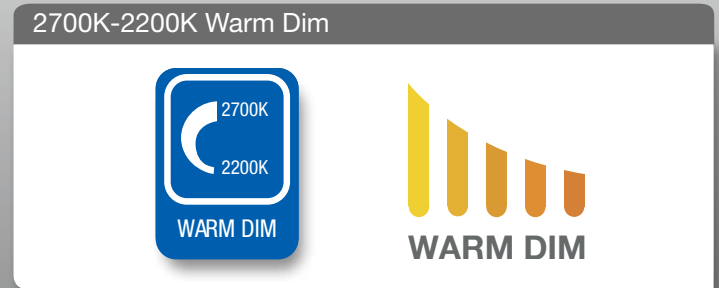
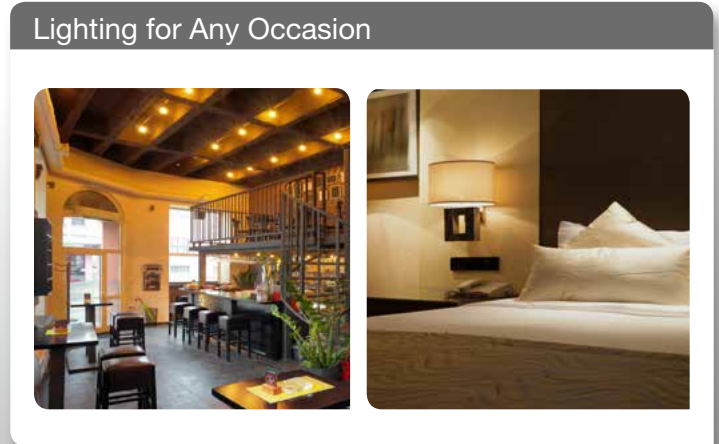

- ⌚ Smooth dimming from 2700K-2200K CCT
- ⌚ Traditional incandescent style dimming
- ⌚ Exceptional efficacy
- ⌚ Available in A19, BR & Candle lamps

SPECIFICATIONS

Model	Product	CCT	Lumens Equiv. (lm)	LPW	Beam Angle	CBCP (cd)	CRI (typ.)	Dim	Life (hrs)	Voltage	Encl.			
A19 9.5W WARM DIM	NEW! 9.5A19DIM/8CCTD	57883	2200K-2700K	800	60W	84	330°	N.A.	80	Yes	25,000	120V	Yes	✓
BR30 9W WARM DIM	NEW! 9BR30DIM/8CCTD	57885	2200K-2700K	650	65W	72	110°	N.A.	80	Yes	25,000	120V	Yes	✓
B11 5W WARM DIM	NEW! 5B11DIM/8CCTD	57834	2200K-2700K	300	40W	60	230°	N.A.	80	Yes	25,000	120V	Yes	✓

CREATE THE PERFECT AMBIENCE



These GREEN CREATIVE lamps feature 2700K-2200K CCT dimming designed to replicate the warm dimming effect of traditional incandescent light sources. As the lamp dims, its CCT gradually warms, helping to create the perfect ambience for all occasions.



Vintage Incandescent Lighting Effect



Micro-Designed Driver - Fully Dimmable



Eligible products meet ENERGY STAR requirements

Suitable for all Decorative Applications



- Fully omnidirectional beam angle
- Micro-designed driver – No heatsink required
- Comfortable warm diffused light
- Smooth dimming with existing installations





SPECIFICATIONS

Model	Product	CCT	Power (W)	Lumens (lm)	LPW	Beam Angle	CRI (typ.)	Dim	Life (hrs)	Voltage	Finish		
A19 7.5W	NEW! 7.5FA19DIM/827	57891	2700K	7.5	800	107	330°	80	Yes	15,000	120V	Clear	Apr.
A19 4.5W	NEW! 4.5FA19DIM/827/R	57971	2700K	4.5	450	100	330°	80	Yes	15,000	120V	Clear	May
A19 4.5W	NEW! 4.5FA19DIM/827	57889	2700K	4.5	450	100	330°	80	Yes	15,000	120V	Clear	N.A.
G40 5W	NEW! 5FG40DIM/827	57945	2700K	5	430	86	330°	80	Yes	15,000	120V	Clear	N.A.
G25 4.5W	NEW! 4.5FG25DIM/827	57893	2700K	4.5	450	100	330°	80	Yes	15,000	120V	Clear	✓
B10 3.5W	NEW! 3.5FB10DIM/827	57886	2700K	3.5	320	91	320°	80	Yes	15,000	120V	Clear	✓
B11 3.5W E26	NEW! 3.5FB11DIM/827/E26	57888	2700K	3.5	320	91	320°	80	Yes	15,000	120V	Clear	May

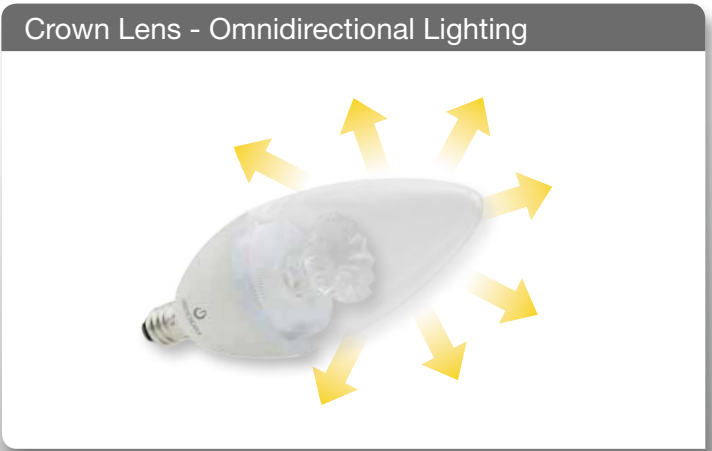
SPECIFICATIONS

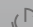
Model	Product	CCT	Power (W)	Lumens (lm)	LPW	Beam Angle	CRI (typ.)	Dim	Life (hrs)	Voltage	Finish		
ST19 5W	NEW! 5FST19DIM/824/A	57892	2400K	5	380	76	330°	80	Yes	15,000	120V	Amber	N.A.
A19 4.5W	NEW! 4.5FA19DIM/824/A	57890	2400K	4.5	380	84	330°	80	Yes	15,000	120V	Amber	N.A.
T10 5W	NEW! 5FT10DIM/824/A	57946	2400K	5	380	76	330°	80	Yes	15,000	120V	Amber	N.A.
G25 4.5W	NEW! 4.5FG25DIM/824/A	57894	2400K	4.5	380	84	330°	80	Yes	15,000	120V	Amber	N.A.
BA10 3.5W	NEW! 3.5FBA10DIM/824/FT/A	57887	2400K	3.5	280	80	320°	80	Yes	15,000	120V	Amber	N.A.
A19 7.5W	NEW! 7.5FA19DIM/827/SB	97825	2700K	7.5	700	93	N.A.	80	Yes	15,000	120V	Silver Bowl	N.A.
G25 4.5W	NEW! 4.5FG25DIM/827/SB	97826	2700K	4.5	400	89	N.A.	80	Yes	15,000	120V	Silver Bowl	N.A.



-  60W & 40W incandescent replacements
-  Innovative crown lens creates unique sparkling effect
-  Available in E12 & E26 bases
-  Smooth dimming with existing installations

SPECIFICATIONS

Model	Product	CCT	Lumens (lm)	Equiv.	LPW	Beam Angle	CBCP (cd)	CRI (typ.)	Dim	Life (hrs)	Voltage	Encl.		
 G25 6W	6G25DIM/827	97729	2700K	450	40W	75	275°	N.A.	80	Yes	25,000	120V	No	✓
 B11 5.5W E12 & E26	5.5B11DIM/827	97823	2700K	500	60W	91	230°	N.A.	80	Yes	25,000	120V	No	✓
	5.5B11DIM/827/E26	97824	2700K	500	60W	91	230°	N.A.	80	Yes	25,000	120V	No	✓
 B11 5W E12	5B11G4DIM/827/FR	40730	2700K	350	40W	70	275°	N.A.	82	Yes	25,000	120V	No	✓
 B11 4.5W E12	4.5B11DIM/827	97817	2700K	300	40W	64	230°	N.A.	80	Yes	25,000	120V	No	✓
 B11 4.5W E12 & E26	4.5B11G4DIM/824	40725	2400K	275	40W	61	275°	N.A.	83	Yes	25,000	120V	No	N.A.
	4.5B11G4DIM/827/E26	40728	2700K	315	40W	70	275°	N.A.	80	Yes	25,000	120V	No	✓

Bringing You the Latest in LED Technology





GREEN CREATIVE

1200 Bayhill Drive, Suite 220
San Bruno, CA 94066
Tel / Fax: (866) 774-5433
info@greencreative.com

www.greencreative.com



/ GREEN CREATIVE



/ GREENCREATIVELED



/ GClightingLED



GREENCREATIVE