

# ELECTRICAL FITTINGS

[www.orbitelectric.com](http://www.orbitelectric.com)



CATALOG NO. 35E

# Table of Contents

Quick Reference .....	i
About Us .....	ii
About Fittings .....	v
EMT Fittings .....	1
Flex Connectors .....	11
Cable Connectors .....	15
AC/MC Connectors .....	16
Liquid Tight Connectors .....	19
RIGID Fittings .....	25
Grounding .....	27
Handy Ells .....	33
Conduit Bodies .....	35
Straps, Clamps, and Hangers .....	47
Service Entrance .....	53
Hubs .....	54
K.O. Seals .....	55
Cord Grips .....	56
Conduit Nipples .....	57
Conduit Elbows .....	61
Bushings .....	63
Lock Nuts .....	65
Reducing Washers .....	66
Bar Hangers .....	67
Miscellaneous .....	69
Prefabrication .....	74

This catalog and its elements are the exclusive property of Orbit Industries, Inc. Any unauthorized or commercial use or reproduction of the pictures, drawings, arrangement, descriptions and part numbers contained in this catalog is strictly prohibited. Items are subject to change without notice and may differ from the items pictured.

# Quick Reference

## EMT Fittings



## Flex Connectors



## AC/MC Connectors



## Liquid Tight Connectors

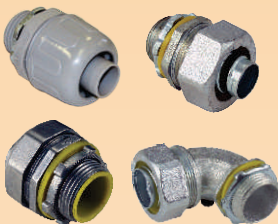

## Grounding



## Conduit Bodies



## Conduit Elbows



## and more...



## **Company History**

Orbit Industries has more than 250 years of combined experience in the electrical industry. As a result, Orbit has become one of the most diverse and creative electrical product manufacturers in the country. Our product line has grown from originally offering only one electrical receptacle to now offering thousands of steel products, NEMA enclosures, fittings and wiring products, ventilation fans, weatherproof products, and lighting products.

For almost two decades, Orbit has setup a nationwide network of representatives to spread knowledge of Orbit's high quality products and promote business with potential partners. They are backed by a strong in-house sales and customer service team that are experts in the electrical industry.

## **Technology and Manufacturing Centers**

Orbit's manufacturing center is one of the largest facilities for the production of electrical products. Our manufacturing and operations center has fully-automated, precision CNC equipment that produces top quality products with reliable consistency. Our machinery is maintained by trained personnel who are committed to meeting our goal of producing well-crafted products. In addition, Orbit's state-of-the-art technology center has a talented staff of CAD designers and engineers who utilize the latest 3D modeling programs for conceptualization of our products.

## **98.7% Fill Rate**

Headquartered within a 140,000 square-foot facility in Los Angeles, Orbit has thousands of electrical products in stock, with every popular model and size available on the market. In addition, Orbit maintains a nationwide network of warehouse facilities to serve our partners coast to coast.

Every item in our catalog, over 5400 products, is ready to ship. With this depth of inventory, Orbit is the only manufacturer that offers a 98.7% fill rate on all electrical products. All details are on our website: [www.orbitelectric.com](http://www.orbitelectric.com)

## **Commitment to Quality**

Product integrity is a priority at Orbit. From our earliest days, this commitment to quality has been evident in all of our products. Throughout the manufacturing process, Orbit uses only the highest quality raw material for our product lines. Our fittings use quality raw materials such as steel, zinc, die-cast aluminum, malleable iron and brass.

Our engineers and quality control team evaluate and then certify that all Orbit electrical products are designed and built to deliver a lifetime of sale performance, free from any defects. Orbit continues to ensure stringent quality control standards.

## **A Diverse Product Line**

With the diversity and depth of our 11 product lines, Orbit is the go-to source for all your electrical construction needs. From major commercial and industrial installations to projects such as retail and residential, Orbit has the fitting or fixture to complete any job with efficiency every step of the way.

## **Standards and Safety Certifications**

The certification of all raw materials at our plants is ensured through rigorous material standards and specification protocols. Advanced inspection and quality control procedures are an important part of our day-to-day operations and create trust in the Orbit brand name.

Orbit products meet or exceeded all ANSI/NFPA 70, U.S. National Electrical Code standards and are UL, ETL and cUL certified. Orbit is also recognized by NEMA, NEMRA, NAED and the General Service Administration.

## **The Advantages of Doing Business with Orbit**

With the products and services offered, a partnership with Orbit can lead to greater profitability. From our technically-advanced manufacturing center to our highly-efficient warehouse and shipping operations, Orbit has the tools to give your company an advantage in this quickly changing market. Orbit's innovative labor-saving products and quick-installation products help electrical contractors keep their bids more profitable. A partnership with Orbit pays off for the distributor and installer!

## Large Selection of Fittings

To meet all your conduit needs, Orbit offers one of the largest selections of fittings that are ready to ship at your convenience.

Orbit manufactures and stocks EMT fittings, flex connectors, cable connectors, AC/MC connectors, rigid connectors, grounding, conduit bodies, straps, bushings, nipples, elbows and more.

## Materials

In addition, our fittings are available in a variety of high quality materials.

### **STEEL, DIE CAST ZINC, MALLEABLE IRON, AND PVC.**



Steel



Die Cast Zinc



Malleable Iron



PVC

# Fittings Types

## COMPRESSION FITTINGS



## SET-SCREW FITTINGS



## INSULATED FITTINGS

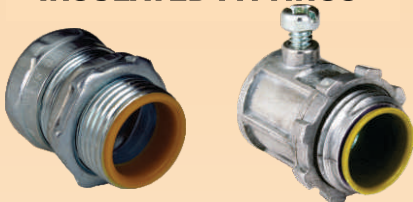

## RAIN-TIGHT FITTINGS



## LIQUID-TIGHT FITTINGS





# EMT Fittings

## STEEL EMT CONNECTORS SET-SCREW TYPE

### Features:

- Steel
- Electroplated Zinc
- Concrete-Tight when taped
- Suitable for applications above 600V

### Note:

- Sizes 2-1/2" to 4" are also listed for RIGID and IMC Conduits

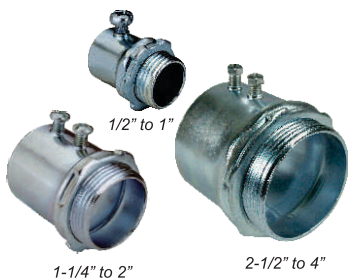

Cat. No.	Trade Size	Std. Pkg.	Master Ctn.
OF7701	1/2"	50	500
OF7702	3/4"	25	250
OF7703	1"	10	100
OF7704	1-1/4"	10	100
OF7705	1-1/2"	10	50
OF7706	2"	5	50
OF7707	2-1/2"	-	12
OF7708	3"	-	12
OF7709	3-1/2"	-	6
OF7710	4"	-	6

## STEEL INSULATED EMT CONNECTORS SET-SCREW TYPE

### Features

- Steel
- Electroplated Zinc
- With Insulated Throat
- Concrete-Tight when taped
- Suitable for applications above 600V

### Note:

- Sizes 2-1/2" to 4" are also listed for RIGID and IMC Conduits
- Insulated color may vary



Cat. No.	Trade Size	Std. Pkg.	Master Ctn.
OF7701-S	1/2"	50	500
OF7702-S	3/4"	25	250
OF7703-S	1"	10	100
OF7704-S	1-1/4"	10	100
OF7705-S	1-1/2"	10	50
OF7706-S	2"	5	50
OF7707-S	2-1/2"	-	12
OF7708-S	3"	-	12
OF7709-S	3-1/2"	-	6
OF7710-S	4"	-	6

# EMT Fittings

## STEEL EMT COUPLINGS SET-SCREW TYPE

### Features:

- Steel
- Electroplated Zinc
- Concrete-Tight when taped
- Suitable for applications above 600V

### Note:

- Sizes 2-1/2" to 4" are also listed for RIGID and IMC Conduits



Cat. No.	Trade Size	Std. Pkg.	Master Ctn.
OF7711	1/2"	50	500
OF7712	3/4"	25	250
OF7713	1"	10	100
OF7714	1-1/4"	10	100
OF7715	1-1/2"	10	50
OF7716	2"	5	50
OF7717	2-1/2"	-	12
OF7718	3"	-	12
OF7719	3-1/2"	-	6
OF7720	4"	-	6

## STEEL EMT CONNECTORS COMPRESSION TYPE

### Features

- Steel
- Electroplated Zinc
- Concrete-Tight
- Suitable for applications above 600V

### Note:

- Sizes 2-1/2" to 4" are also listed for RIGID and IMC Conduits



Cat. No.	Trade Size	Std. Pkg.	Master Ctn.
OF7601	1/2"	25	250
OF7602	3/4"	25	250
OF7603	1"	10	100
OF7604	1-1/4"	10	100
OF7605	1-1/2"	10	50
OF7606	2"	5	50
OF7607	2-1/2"	-	12
OF7608	3"	-	12
OF7609	3-1/2"	-	6
OF7610	4"	-	6

# EMT Fittings

## STEEL RAIN-TIGHT EMT CONNECTORS COMPRESSION TYPE

### Features:

- Steel
- Electroplated Zinc
- Concrete-Tight
- Suitable for applications above 600V

### Note:

- Sizes 2-1/2" to 4" are also listed for RIGID and IMC Conduits
- Compression Cap color may vary



Cat. No.	Trade Size	Std. Pkg.	Master Ctn.
OF7601-W	1/2"	25	250
OF7602-W	3/4"	25	250
OF7603-W	1"	10	100
OF7604-W	1-1/4"	10	100
OF7605-W	1-1/2"	10	50
OF7606-W	2"	5	50
OF7607-W	2-1/2"	-	12
OF7608-W	3"	-	12
OF7609-W	3-1/2"	-	6
OF7610-W	4"	-	6

## STEEL INSULATED RAIN-TIGHT EMT CONNECTORS COMPRESSION TYPE

### Features:

- Steel
- Electroplated Zinc
- With Insulated Throat
- Concrete-Tight
- Suitable for applications above 600V

### Note:

- Sizes 2-1/2" to 4" are also listed for RIGID and IMC Conduits
- Insulated and Compression Cap color may vary



Cat. No.	Trade Size	Std. Pkg.	Master Ctn.
OF7601-SW	1/2"	25	250
OF7602-SW	3/4"	25	250
OF7603-SW	1"	10	100
OF7604-SW	1-1/4"	10	100
OF7605-SW	1-1/2"	10	50
OF7606-SW	2"	5	50
OF7607-SW	2-1/2"	-	12
OF7608-SW	3"	-	12
OF7609-SW	3-1/2"	-	6
OF7610-SW	4"	-	6

# EMT Fittings

## STEEL INSULATED EMT CONNECTORS COMPRESSION TYPE

### Features

- Steel
- Electroplated Zinc
- With Insulated Throat
- Concrete-Tight
- Suitable for applications above 600V

### Note:

- Sizes 2-1/2" to 4" are also listed for RIGID and IMC Conduits
- Insulated color may vary



Cat. No.	Trade Size	Std. Pkg.	Master Ctn.
OF7601-S	1/2"	25	250
OF7602-S	3/4"	25	250
OF7603-S	1"	10	100
OF7604-S	1-1/4"	10	100
OF7605-S	1-1/2"	10	50
OF7606-S	2"	5	50
OF7607-S	2-1/2"	-	12
OF7608-S	3"	-	12
OF7609-S	3-1/2"	-	6
OF7610-S	4"	-	6

## STEEL EMT COUPLINGS COMPRESSION TYPE

### Features

- Steel
- Electroplated Zinc
- Concrete-Tight
- Suitable for applications above 600V

### Note:

- Sizes 2-1/2" to 4" are also listed for RIGID and IMC Conduits



Cat. No.	Trade Size	Std. Pkg.	Master Ctn.
OF7611	1/2"	25	250
OF7612	3/4"	25	250
OF7613	1"	10	100
OF7614	1-1/4"	10	100
OF7615	1-1/2"	10	50
OF7616	2"	5	50
OF7617	2-1/2"	-	12
OF7618	3"	-	12
OF7619	3-1/2"	-	6
OF7620	4"	-	6

# EMT Fittings

## STEEL RAIN-TIGHT EMT COUPLINGS COMPRESSION TYPE

### Features:

- Steel
- Electroplated Zinc
- Concrete-Tight
- Suitable for applications above 600V

### Note:

- Sizes 2-1/2" to 4" are also listed for RIGID and IMC Conduits
- Compression Cap color may vary



Cat. No.	Trade Size	Std. Pkg.	Master Ctn.
OF7611-W	1/2"	25	250
OF7612-W	3/4"	25	250
OF7613-W	1"	10	100
OF7614-W	1-1/4"	10	100
OF7615-W	1-1/2"	10	50
OF7616-W	2"	5	50
OF7617-W	2-1/2"	-	12
OF7618-W	3"	-	12
OF7619-W	3-1/2"	-	6
OF7620-W	4"	-	6

## ZINC DIE CAST EMT CONNECTORS SET-SCREW TYPE

### Features

- Zinc Die Cast
- Concrete-Tight when taped
- Combo-Head Set Screw
- Suitable for applications above 600V

### Note:

- Sizes 2-1/2" to 4" are also listed for RIGID and IMC Conduits



Cat. No.	Trade Size	Std. Pkg.	Master Ctn.
OF701	1/2"	100	1000
OF702	3/4"	50	500
OF703	1"	10	100
OF704	1-1/4"	10	100
OF705	1-1/2"	10	50
OF706	2"	5	50
OF707	2-1/2"	-	12
OF708	3"	-	12
OF709	3-1/2"	-	6
OF710	4"	-	6

# EMT Fittings

## ZINC DIE CAST INSULATED EMT CONNECTORS SET-SCREW TYPE

### Features:

- Zinc Die Cast
- With Insulated Throat
- Concrete-Tight when taped
- Combo-Head Set Screw
- Suitable for applications above 600V

### Note:

- Sizes 2-1/2" to 4" are also listed for RIGID and IMC Conduits
- Insulated color may vary



Cat. No.	Trade Size	Std. Pkg.	Master Ctn.
OF701-S	1/2"	50	500
OF702-S	3/4"	25	250
OF703-S	1"	10	100
OF704-S	1-1/4"	10	100
OF705-S	1-1/2"	10	50
OF706-S	2"	5	50
OF707-S	2-1/2"	-	12
OF708-S	3"	-	12
OF709-S	3-1/2"	-	6
OF710-S	4"	-	6

## ZINC DIE CAST EMT COUPLINGS SET-SCREW TYPE

### Features

- Zinc Die Cast
- Concrete-Tight when taped
- Combo-Head Set Screw
- Suitable for applications above 600V

### Note:

- Sizes 2-1/2" to 4" are also listed for RIGID and IMC Conduits

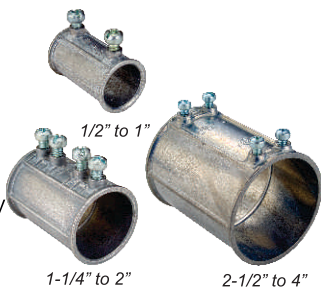

Cat. No.	Trade Size	Std. Pkg.	Master Ctn.
OF711	1/2"	50	500
OF712	3/4"	25	250
OF713	1"	10	100
OF714	1-1/4"	10	100
OF715	1-1/2"	10	50
OF716	2"	5	50
OF717	2-1/2"	-	12
OF718	3"	-	12
OF719	3-1/2"	-	6
OF720	4"	-	6

# EMT Fittings

## ZINC DIE CAST EMT CONNECTORS COMPRESSION TYPE

### Features:

- Zinc Die Cast
- Concrete-Tight
- Suitable for applications above 600V

### Note:

- Sizes 2-1/2" to 4" are also listed for RIGID and IMC Conduits



Cat. No.	Trade Size	Std. Pkg.	Master Ctn.
OF601	1/2"	50	500
OF602	3/4"	25	250
OF603	1"	10	100
OF604	1-1/4"	10	100
OF605	1-1/2"	10	50
OF606	2"	5	50
OF607	2-1/2"	-	12
OF608	3"	-	12
OF609	3-1/2"	-	6
OF610	4"	-	6

## ZINC DIE CAST RAIN-TIGHT EMT CONNECTORS COMPRESSION TYPE

### Features

- Zinc Die Cast
- Concrete-Tight
- Suitable for applications above 600V

### Note:

- Sizes 2-1/2" to 4" are also listed for RIGID and IMC Conduits
- Compression Cap color may vary



Cat. No.	Trade Size	Std. Pkg.	Master Ctn.
OF601-W	1/2"	50	500
OF602-W	3/4"	25	250
OF603-W	1"	10	100
OF604-W	1-1/4"	10	100
OF605-W	1-1/2"	10	50
OF606-W	2"	5	50
OF607-W <b>NEW</b>	2-1/2"	1	12
OF608-W <b>NEW</b>	3"	1	12
OF609-W <b>NEW</b>	3-1/2"	1	6
OF610-W <b>NEW</b>	4"	1	6

**NOW UP TO 4"!**

# EMT Fittings

## ZINC DIE CAST INSULATED EMT CONNECTORS COMPRESSION TYPE

### Features:

- Zinc Die Cast
- With Insulated Throat
- Concrete-Tight
- Suitable for applications above 600V

### Note:

- Sizes 2-1/2" to 4" are also listed for RIGID and IMC Conduits
- Insulated color may vary



Cat. No.	Trade Size	Std. Pkg.	Master Ctn.
OF601-S	1/2"	50	500
OF602-S	3/4"	25	250
OF603-S	1"	10	100
OF604-S	1-1/4"	10	100
OF605-S	1-1/2"	10	50
OF606-S	2"	5	50
OF607-S	2-1/2"	-	12
OF608-S	3"	-	12
OF609-S	3-1/2"	-	6
OF610-S	4"	-	6

## ZINC DIE CAST INSULATED RAIN-TIGHT EMT CONNECTORS COMPRESSION TYPE

### Features

- Zinc Die Cast
- With Insulated Throat
- Concrete-Tight
- Suitable for applications above 600V

### Note:

- Sizes 2-1/2" to 4" are also listed for RIGID and IMC Conduits
- Insulated and nut color may vary



Cat. No.	Trade Size	Std. Pkg.	Master Ctn.
OF601-SW	1/2"	50	500
OF602-SW	3/4"	25	250
OF603-SW	1"	10	100
OF604-SW	1-1/4"	10	100
OF605-SW	1-1/2"	10	50
OF606-SW	2"	5	50
OF607-SW <b>NEW</b>	2-1/2"	-	12
OF608-SW <b>NEW</b>	3"	-	12
OF609-SW <b>NEW</b>	3-1/2"	-	6
OF610-SW <b>NEW</b>	4"	-	6

**NOW UP TO 4"!**



# EMT Fittings

## ZINC DIE CAST EMT COUPLINGS COMPRESSION TYPE

### Features:

- Zinc Die Cast
- Concrete-Tight
- Suitable for applications above 600V

### Note:

- Sizes 2-1/2" to 4" are also listed for RIGID and IMC Conduits



Cat. No.	Trade Size	Std. Pkg.	Master Ctn.
OF611	1/2"	50	500
OF612	3/4"	25	250
OF613	1"	10	100
OF614	1-1/4"	10	100
OF615	1-1/2"	10	50
OF616	2"	5	50
OF617	2-1/2"	-	12
OF618	3"	-	12
OF619	3-1/2"	-	6
OF620	4"	-	6

## ZINC DIE CAST RAIN-TIGHT EMT COUPLINGS COMPRESSION TYPE

### Features

- Zinc Die Cast
- Concrete-Tight
- Suitable for applications above 600V

### Note:

- Sizes 2-1/2" to 4" are also listed for RIGID and IMC Conduits
- Compression Cap color may vary



Cat. No.	Trade Size	Std. Pkg.	Master Ctn.
OF611-W	1/2"	50	500
OF612-W	3/4"	25	250
OF613-W	1"	10	100
OF614-W	1-1/4"	10	100
OF615-W	1-1/2"	10	50
OF616-W	2"	5	50
OF617-W <b>NEW</b>	2-1/2"	1	12
OF618-W <b>NEW</b>	3"	1	12
OF619-W <b>NEW</b>	3-1/2"	1	6
OF620-W <b>NEW</b>	4"	1	6

**NOW UP TO 4"!**

# EMT Fittings

## EMT OFFSET CONNECTORS SET-SCREW TYPE

### Features:

- Zinc Die Cast
- Concrete-Tight when taped
- Combo-Head Set Screw
- Suitable for applications above 600V



Cat. No.	Trade Size	Std. Pkg.	Master Ctn.
OCS-50	1/2"	100	1000
OCS-75	3/4"	50	500

## EMT OFFSET CONNECTORS COMPRESSION TYPE

### Features:

- Zinc Die Cast
- Concrete-Tight
- Combo-Head Set Screw
- Suitable for applications above 600V



Cat. No.	Trade Size	Std. Pkg.	Master Ctn.
OCC-50	1/2"	100	1000
OCC-75	3/4"	50	500

## EMT INSIDE CORNER ELBOW SET-SCREW TYPE

### Features:

- Zinc Die Cast
- Combo-Head Set Screw
- Suitable for applications above 600V



Cat. No.	Trade Size	Std. Pkg.	Master Ctn.
ECS-50	1/2"	100	1000
ECS-75	3/4"	50	500

## ZINC DIE CAST EMT "FASTLOCK" CONNECTORS (NO LOCKNUT)

### Features:

- Zinc Die Cast
- Combo-Head Set Screw
- Suitable for dry location only

**NEW**



Cat. No.	Trade Size	Std. Pkg.	Master Ctn.
OF 1701	1/2"	50	500
OF 1702	3/4"	50	500

# FLEX Connectors

## FLEX CONNECTORS SCREW-IN TYPE

**Features:**

- Zinc Die Cast



Cat. No.	Trade Size	Std. Pkg.	Master Ctn.
OF671	3/8"	100	1000
OF672	1/2"	100	1000
OF673	3/4"	100	500
OF674	1"	25	250
OF675	1-1/4"	10	100
OF681	1-1/2"	5	50
OF682	2"	3	30

## INSULATED FLEX CONNECTORS SCREW-IN TYPE

**Features**

- Zinc Die Cast
- With Insulated Throat

**Note:**

- Insulated color may vary



Cat. No.	Trade Size	Std. Pkg.	Master Ctn.
OF671-S	3/8"	100	1000
OF672-S	1/2"	100	1000
OF673-S	3/4"	100	500
OF674-S	1"	25	250
OF675-S	1-1/4"	10	100
OF681-S	1-1/2"	5	50
OF682-S	2"	3	30

## FLEX COUPLINGS SCREW-IN TYPE

**Features:**

- Zinc Die Cast



Cat. No.	Trade Size	Std. Pkg.	Master Ctn.
OF676	1/2"	100	1000
OF677	3/4"	100	500
OF678	1"	25	250
OF679	1-1/4"	10	100
OF685	1-1/2"	5	50
OF686	2"	3	30

## FLEX BUSHINGS

**Features:**

- Steel
- Electroplated Zinc
- Used to insulate cut flex when the conduit is used for data cables without a junction box



*Shown Installed*

Cat. No.	Trade Size	Std. Pkg.	Master Ctn.
FB-50	1/2"	100	1000
FB-75	3/4"	100	500
FB-100	1"	25	250

# FLEX Connectors

## FLEX CONNECTORS

### SQUEEZE TYPE

#### Features

- Zinc Die Cast

#### Note:

- Sizes 3/8" & 1/2" are also for AC(BX)



3/8" to 2"

2-1/2" to 4"

Cat. No.	Trade Size	Std. Pkg.	Master Ctn.
OF730	3/8"	50	500
OF731	1/2"	25	250
OF732	3/4"	25	250
OF733	1"	10	100
OF734	1-1/4"	10	100
OF735	1-1/2"	5	50
OF736	2"	4	40
OF737	2-1/2"	2	6
OF738	3"	1	2
OF739	3-1/2"	1	2
OF740	4"	1	2

## INSULATED FLEX CONNECTORS

### SQUEEZE TYPE

#### Features

- Zinc Die Cast
- With Insulated Throat

#### Note:

- Sizes 3/8" & 1/2" are also for AC(BX)
- Insulated color may vary

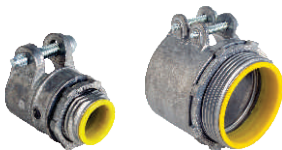

3/8" to 2"

2-1/2" to 4"

Cat. No.	Trade Size	Std. Pkg.	Master Ctn.
OF730-S	3/8"	50	500
OF731-S	1/2"	25	250
OF732-S	3/4"	25	250
OF733-S	1"	10	100
OF734-S	1-1/4"	10	100
OF735-S	1-1/2"	5	50
OF736-S	2"	4	40
OF737-S	2-1/2"	2	6
OF738-S	3"	1	2
OF739-S	3-1/2"	1	2
OF740-S	4"	1	2

## FLEX CONNECTORS

### SCREW-IN TYPE

#### Features:

- Zinc Die Cast
- Steel Screw
- For Steel FLEX only



Cat. No.	Trade Size	Std. Pkg.	Master Ctn.
OF654	1/2"	100	500
OF655	3/4"	75	375

# FLEX Connectors

## 90° ANGLE FLEX/AC(BX)/MC CONNECTORS SQUEEZE TYPE

**Features:**

- Zinc Die Cast



Cat. No.	Trade Size	Std. Pkg.	Master Ctn.
OF643	3/8"	25	250
OF644	1/2"	25	250
OF645	3/4"	25	250

## 90° ANGLE FLEX CONNECTORS SQUEEZE TYPE

**Features:**

- Zinc Die Cast

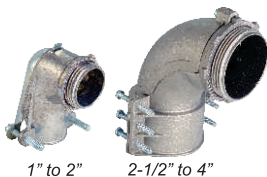

Cat. No.	Trade Size	Std. Pkg.	Master Ctn.
OF6463	1"	5	25
OF6464	1-1/4"	-	5
OF6465	1-1/2"	-	5
OF6466	2"	-	5
OF6467	2-1/2"	-	5
OF6468	3"	-	5
OF6469	3-1/2"	-	1
OF6470	4"	-	1

## EMT TO FLEX COUPLINGS COMPRESSION/SCREW-IN TYPE

**Features:**

- Zinc Die Cast



Cat. No.	Trade Size	Std. Pkg.	Master Ctn.
OF1611	1/2"	50	500
OF1612	3/4"	25	250
OF1613	1"	10	100

# FLEX Connectors

## EMT TO FLEX COUPLINGS SET-SCREW/SQUEEZE TYPE

**Features:**

- Zinc Die Cast



Cat. No.	EMT/FLEX	Std. Pkg.	Master Ctn.
OF530	1/2" to 3/8"	50	500
OF531	1/2" to 1/2"	25	250
OF532	3/4" to 3/4"	25	100
OF533	1" to 1"	10	40

## EMT TO FLEX COUPLINGS SET-SCREW/CLAMP TYPE

**Features:**

- Zinc Die Cast



Cat. No.	EMT/FLEX	Std. Pkg.	Master Ctn.
OF520	1/2" to 3/8"	50	500
OF521	1/2" to 1/2"	25	250
OF522	3/4" to 3/4"	25	250
OF523	1" to 1"	10	40

## FLEX CONNECTORS CLAMP TYPE

**Features:**

- Zinc Die Cast
- Combo-Head Set Screw



Cat. No.	Trade Size	Std. Pkg.	Master Ctn.
OF657	1/2"	25	50

1. VISIT **ORBIT WEBSITE**

[www.orbitelectric.com](http://www.orbitelectric.com)



2. FOLLOW  
**ORBIT INDUSTRIES**



3. EXPLORE  
**MORE ABOUT US!**

# Cable Connectors

## 90° ANGLE

### FLEX CONNECTORS

#### SCREW-IN TYPE

**Features:**

- Zinc Die Cast
- Sliding cover for easy wire pulls



Cat. No.	Trade Size	Std. Pkg.	Master Ctn.
OF9673	3/4"	15	150
OF9674	1"	10	100

## PVC NON-METALLIC (NM)

### CABLE CONNECTORS

**Features:**

- Heavy-Duty PVC



Cat. No.	For Use With	Trade Size	Std. Pkg.	Master Ctn.
NM-50	One or Two 14/2, 14/3, 12/2; One 12/3, 10/2, 10/3; One or Two 0.300" or 0.600" cords	1/2"	50	500

## NON-METALLIC CABLE CONNECTORS

### PUSH-IN TYPE

**Features:**

- Flame-Retardant Polypropylene
- Special gripping arrangement for easy cable insertion

**NEW**

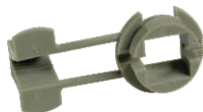

Cat. No.	For Use With	Trade Size	Std. Pkg.	Master Ctn.
NMP-50	One 10, 12, 14 AWG two-conductor cables with or without ground wire	1/2"	100	300

## NON-METALLIC CABLE CONNECTORS

**Features:**

- Zinc Die Cast

**Note:**

- Sizes 1" to 2" are also suitable for Service Entrance



Cat. No.	For Use With	Trade Size	Std. Pkg.	Master Ctn.
RX-50	(1) 14/2 to 10/2 NM, (2) 14/2 or (2) 12/2 NM 0.340" to 0.380" Dia. Flex Cord (Dry Location) 14/3, 16/2, and 16/3 SJO	1/2"	100	1000
RX-75	(2) 14/2 NM, AWG 0.340" to 0.515" Dia. Flex Cord (Dry Location) 14/3, 14/2 SJO	3/4"	25	250

### For Service Entrance

RX-100	(4) 14/2, (1) 8/3, 8/2, 6/2, 6/3, 4/2, 4/3 NM (1) 2 SE Cable	1"	10	100
RX-125	4/3 or 2/3 NM	1-1/4"	5	50
RX-150	3-2/0 or 3-4/0 NM	1-1/2"	5	50
RX-200	3-2/0 or 3-4/0 NM	2"	5	50

# AC/MC Connectors

## METAL CLAD(MC) CONNECTORS SADDLE TYPE

### Features:

- Zinc Die Cast
- With Insulated Throat
- Combo-Head Set Screw
- Suitable for dry location only

### Note:

- Insulated color may vary



Cat. No.	Description	Trade Size	Std. Pkg.	Master Ctn.
OF6231	AC & MC Interlocking Steel 0.450 to 0.590 Dia. AC & MC Interlocking AL 0.440 to 0.600 Dia. Round Corrugated AL, MC 0.574 or 12/4 Square Corrugated AL, MC 0.527, 0.254, 12/3 AL FMC, 3/8" Steel and RW FMC, 3/8" Steel	1/2"	100	500
OF6232	Interlocking Steel 0.661 to 0.711 Dia. Interlocking MC 0.775 to 0.825 Dia. AC, AL & Steel 0.650 to 0.810 Dia & Flex, 1/2" Steel	3/4"	50	250

## METAL CLAD(MC) & AC(BX) CONNECTORS SET-SCREW TYPE

### Features:

- Zinc Die Cast
- For Steel Only



Cat. No.	Description	Trade Size	Std. Pkg.	Master Ctn.
OF653	AC, Steel, 14/2 AWG and MC, Steel, 0.500 to 0.550 Dia.	1/2"	100	500

## METAL CLAD(MC) & AC(BX) CONNECTORS

### Features:

- Zinc Die Cast
- For Steel and Aluminum



Cat. No.	Description	Trade Size	Std. Pkg.	Master Ctn.
OF6620	AC(BX) 14/2 to 10/2, MC 14/2 to 10/3	1/2"	100	500

## METAL CLAD(MC) CONNECTORS CLAMP TYPE

### Features:

- Zinc Die Cast
- With Insulated Throat
- Suitable for dry location only

### Note:

- Insulated color may vary



Cat. No.	Trade Size	Std. Pkg.	Master Ctn.
MC-CL-100	1"	10	100
MC-CL-125	1-1/4"	25	100
MC-CL-150	1-1/2"	10	100
MC-CL-200	2"	10	100
MC-CL-250	2-1/2"	-	10
MC-CL-300	3"	-	5
MC-CL-350	3-1/2"	-	5



# AC/MC Connectors

## COMBINATION AC(BX) & NON-METALLIC(NM) CONNECTORS

**Features:**

- Zinc Die Cast



Cat. No.	Description	Trade Size	Std. Pkg.	Master Ctn.
<b>OF623</b>	14/2 AC(BX), 14/2 NM, 0.340 to 0.380 dia cord 14/3 & 14/3 SJO, 16/2 SO	1/2"	25	250

## DUPLEX AC(BX) FLEX/MC CONNECTORS

**Features:**

- Zinc Die Cast



Cat. No.	Description	Trade Size	Std. Pkg.	Master Ctn.
<b>MC-DX-50</b>	14/2 to 10/2 AC(BX), (2)14/2 to 10/2 AL & Steel for FMC 3/8"	1/2"	25	250

## STEEL "FASTLOCK" CONNECTORS

**Features:**

- Steel
- Electroplated Zinc
- Combo-Head Set Screw
- Saddle-Base Connector
- For AC, MCI, MCC, RWFMC



**Note:**

- Insulated color may vary

Cat. No.	Description	Trade Size	Std. Pkg.	Master Ctn.
<b>FLC-50</b>	Steel AC 14/2 (0.440) to 10/3 AL AC 14/2 (0.475) to 10/3 Steel MC Interlocking (MCI) 0.437" to 0.565" O.D. AL MC Interlocking (MCI) 0.525" to 0.629" O.D. AL Corrugated Continuous (MCC) 0.350" to 0.592" O.D. Steel & AL Flex RWFMC: 3/8"	1/2"	50	500

## STEEL "FASTLOCK" WIDE-THROAT CONNECTORS

**Features:**

- Steel
- Electroplated Zinc
- Combo-Head Set Screw
- Saddle-Base Connector
- For AC, MCI, RWFMC, ALFMC



**Note:**

- Insulated color may vary

Cat. No.	Description	Trade Size	Std. Pkg.	Master Ctn.
<b>FLC-50L</b>	Steel AC 10/4 (0.625) to 6/3 (0.842) AL AC 10/4 (0.625) to 8/4 (0.770) Steel MC Interlocking (MCI) 10/3 (0.594) to 6/2 (0.740) AL MC Interlocking (MCI) 10/3 (0.594) to 8/2 (0.650) Steel RWFMC, AL RWFMC, AL FMC: 1/2"	1/2"	50	500
<b>FLC-75L</b>	Steel AC 10/4 (0.625) to 6/3 (0.840) AL AC 10/4 (0.622) to 8/4 (0.760) Steel MC Interlocking (MCI) 10/3 (0.594) to 6/2 (0.746) AL MC Interlocking (MCI) 10/3 (0.582) to 8/2 (0.650) Steel RWFMC, AL RWFMC & AL FMC 1/2"	3/4"	25	250

# AC/MC Connectors

## STEEL "FASTLOCK" DUPLEX CONNECTORS

### Features:

- Steel
- Electroplated Zinc
- Combo-Head Set Screw
- For AC, MCI, RWFMC & ALFMC

### Note:

- Insulated color may vary



Cat. No.	Description	Trade Size	Std. Pkg.	Master Ctn.
<b>FLD-50</b>	Steel AC 14/2 (0.454) to 12/4 (0.556) Aluminum AC 14/2 (0.485) to 12/4 (0.565) Steel MC Interlocking (MCI) 14/2 (0.470) to 12/4 (0.520) Aluminum MC Interlocking (MCI) 14/2 (0.460) to 12/4 (0.590) Steel RWFMC 3/8 Aluminum RWFMC 3/8 Aluminum FMC 3/8	1/2"	25	250

## ANTI-SHORT BUSHINGS THERMOPLASTIC

### Features:

- High-Temperature Plastic
- Fits BX(AC) and Flex Conduits



Cat. No.	For Use With	Trade Size	Std. Pkg.	Master Ctn.
<b>ASB-516</b>	14/2, 14/3, 12/2	5/16"	35	3500
<b>ASB-38</b>	14/4, 12/3, 6/1, 4/1	3/8"	35	2100
<b>ASB-716</b>	12/4, 10/2, 10/3, 2/1	7/16"	35	700
<b>ASB-50</b>	10/4, 8/2, 8/3, 1/1	1/2"	20	400
<b>ASB-75</b>	8/4, 6/2, 4/2, 4/3, 6/4	3/4"	16	320

**VISIT OUR WEBSITE TO SEE  
OUR COMPLETE LINE OF  
FLOOR BOXES**



[www.orbitelectric.com](http://www.orbitelectric.com)



# Liquid Tight Connectors

## NON-METALLIC (PVC) STRAIGHT LIQUID TIGHT CONNECTORS

### Features:

- PVC Type-B
- Corrosion-Resistant
- Zinc Locknut



Cat. No.	Trade Size	Std. Pkg.	Master Ctn.
NMLT-38	3/8"	25	100
NMLT-50	1/2"	25	250
NMLT-75	3/4"	15	150
NMLT-100	1"	8	80
NMLT-125	1-1/4"	5	50
NMLT-150	1-1/2"	4	40
NMLT-200	2"	1	36

## NON-METALLIC (PVC) 90° ANGLE LIQUID TIGHT CONNECTORS

### Features:

- PVC Type-B
- Corrosion-Resistant
- Zinc Locknut



Cat. No.	Trade Size	Std. Pkg.	Master Ctn.
NMLT90-38	3/8"	10	100
NMLT90-50	1/2"	15	150
NMLT90-75	3/4"	10	100
NMLT90-100	1"	5	50
NMLT90-125	1-1/4"	4	40
NMLT90-150	1-1/2"	2	20
NMLT90-200	2"	1	10

## ZINC DIE CAST STRAIGHT LIQUID TIGHT CONNECTORS

### Features:

- Zinc Die Cast

### Note:

- Insulated color may vary



Cat. No.	Trade Size	Std. Pkg.	Master Ctn.
LT-38	3/8"	25	250
LT-50	1/2"	25	250
LT-75	3/4"	15	150
LT-100	1"	8	80
LT-125	1-1/4"	5	50
LT-150	1-1/2"	4	40
LT-200	2"	1	10
LT-250	2-1/2"	1	10
LT-300	3"	1	10
LT-350	3-1/2"	1	6
LT-400	4"	1	6

# Liquid Tight Connectors

## ZINC DIE CAST INSULATED STRAIGHT LIQUID TIGHT CONNECTORS

### Features:

- Zinc Die Cast
- With Insulated Throat

### Note:

- Insulated color may vary



Cat. No.	Trade Size	Std. Pkg.	Master Ctn.
LTI-38	3/8"	25	250
LTI-50	1/2"	25	250
LTI-75	3/4"	15	150
LTI-100	1"	8	80
LTI-125	1-1/4"	5	50
LTI-150	1-1/2"	4	40
LTI-200	2"	1	10
LTI-250	2-1/2"	1	10
LTI-300	3"	1	10
LTI-350	3-1/2"	1	6
LTI-400	4"	1	6

## ZINC DIE CAST 90° ANGLE LIQUID TIGHT CONNECTORS

### Features

- Zinc Die Cast

### Note:

- Insulated color may vary



Cat. No.	Trade Size	Std. Pkg.	Master Ctn.
LT90-38	3/8"	15	150
LT90-50	1/2"	15	150
LT90-75	3/4"	10	100
LT90-100	1"	5	50
LT90-125	1-1/4"	4	40
LT90-150	1-1/2"	2	20
LT90-200	2"	1	10
LT90-250	2-1/2"	1	10
LT90-300	3"	1	4
LT90-350	3-1/2"	1	3
LT90-400	4"	1	3

# Liquid Tight Connectors

## ZINC DIE CAST INSULATED 90° ANGLE LIQUID TIGHT CONNECTORS

### Features

- Zinc Die Cast
- With Insulated Throat

### Note:

- Insulated color may vary



Cat. No.	Trade Size	Std. Pkg.	Master Ctn.
LT190-38	3/8"	15	150
LT190-50	1/2"	15	150
LT190-75	3/4"	10	100
LT190-100	1"	5	50
LT190-125	1-1/4"	4	40
LT190-150	1-1/2"	2	20
LT190-200	2"	1	10
LT190-250	2-1/2"	1	10
LT190-300	3"	1	4
LT190-350	3-1/2"	1	3
LT190-400	4"	1	3

## MALLEABLE IRON STRAIGHT LIQUID TIGHT CONNECTORS

### Features:

- Malleable Iron
- Electroplated Zinc

### Note:

- Insulated color may vary



Cat. No.	Trade Size	Std. Pkg.	Master Ctn.
MLT-38	3/8"	25	250
MLT-50	1/2"	25	250
MLT-75	3/4"	15	150
MLT-100	1"	8	80
MLT-125	1-1/4"	5	50
MLT-150	1-1/2"	4	40
MLT-200	2"	1	20
MLT-250 <b>NEW</b>	2-1/2"	-	1
MLT-300 <b>NEW</b>	3"	-	1
MLT-350 <b>NEW</b>	3-1/2"	-	1
MLT-400 <b>NEW</b>	4"	-	1

**NOW UP TO 4"!**

# Liquid Tight Connectors

## MALLEABLE IRON INSULATED STRAIGHT LIQUID TIGHT CONNECTORS

### Features

- Malleable Iron
- Electroplated Zinc
- With Insulated Throat

### Note:

- Insulated color may vary



Cat. No.	Trade Size	Std. Pkg.	Master Ctn.
MLTI-38	3/8"	25	250
MLTI-50	1/2"	25	250
MLTI-75	3/4"	15	150
MLTI-100	1"	8	80
MLTI-125	1-1/4"	5	50
MLTI-150	1-1/2"	4	40
MLTI-200	2"	1	20
MLTI-250 <b>NEW</b>	2-1/2"	-	1
MLTI-300 <b>NEW</b>	3"	-	1
MLTI-350 <b>NEW</b>	3-1/2"	-	1
MLTI-400 <b>NEW</b>	4"	-	1

**NOW UP TO 4"!**

## MALLEABLE IRON 45° ANGLE LIQUID TIGHT CONNECTORS

### Features:

- Malleable Iron
- Electroplated Zinc

### Note:

- Insulated color may vary



Cat. No.	Trade Size	Std. Pkg.	Master Ctn.
MLT45-38	3/8"	25	150
MLT45-50	1/2"	25	150
MLT45-75	3/4"	10	100
MLT45-100	1"	5	50
MLT45-125	1-1/4"	5	40
MLT45-150	1-1/2"	4	20
MLT45-200	2"	1	15
MLT45-250 <b>NEW</b>	2-1/2"	-	1
MLT45-300 <b>NEW</b>	3"	-	1
MLT45-350 <b>NEW</b>	3-1/2"	-	1
MLT45-400 <b>NEW</b>	4"	-	1

**NOW UP TO 4"!**

# Liquid Tight Connectors

## MALLEABLE IRON INSULATED 45° ANGLE LIQUID TIGHT CONNECTORS

### Features

- Malleable Iron
- Electroplated Zinc
- With Insulated Throat

### Note:

- Insulated color may vary



Cat. No.	Trade Size	Std. Pkg.	Master Ctn.
MLTI45-38	3/8"	25	150
MLTI45-50	1/2"	25	150
MLTI45-75	3/4"	10	100
MLTI45-100	1"	5	50
MLTI45-125	1-1/4"	5	40
MLTI45-150	1-1/2"	4	20
MLTI45-200	2"	1	15
MLTI45-250 <b>NEW</b>	2-1/2"	-	1
MLTI45-300 <b>NEW</b>	3"	-	1
MLTI45-350 <b>NEW</b>	3-1/2"	-	1
MLTI45-400 <b>NEW</b>	4"	-	1

**NOW UP TO 4"!**

## MALLEABLE IRON 90° ANGLE LIQUID TIGHT CONNECTORS

### Features:

- Malleable Iron
- Electroplated Zinc

### Note:

- Insulated color may vary



Cat. No.	Trade Size	Std. Pkg.	Master Ctn.
MLT90-38	3/8"	25	150
MLT90-50	1/2"	25	150
MLT90-75	3/4"	10	100
MLT90-100	1"	5	50
MLT90-125	1-1/4"	5	40
MLT90-150	1-1/2"	4	20
MLT90-200	2"	1	15
MLT90-250 <b>NEW</b>	2-1/2"	-	1
MLT90-300 <b>NEW</b>	3"	-	1
MLT90-350 <b>NEW</b>	3-1/2"	-	1
MLT90-400 <b>NEW</b>	4"	-	1

**NOW UP TO 4"!**

# Liquid Tight Connectors

## MALLEABLE IRON INSULATED 90° ANGLE LIQUID TIGHT CONNECTORS

### Features

- Malleable Iron
- Electroplated Zinc
- With Insulated Throat

### Note:

- Insulated color may vary



Cat. No.	Trade Size	Std. Pkg.	Master Ctn.
MLTI90-38	3/8"	25	150
MLTI90-50	1/2"	25	150
MLTI90-75	3/4"	10	100
MLTI90-100	1"	5	50
MLTI90-125	1-1/4"	5	40
MLTI90-150	1-1/2"	4	20
MLTI90-200	2"	1	15
MLTI90-250 <b>NEW</b>	2-1/2"	-	1
MLTI90-300 <b>NEW</b>	3"	-	1
MLTI90-350 <b>NEW</b>	3-1/2"	-	1
MLTI90-400 <b>NEW</b>	4"	-	1

**NOW UP TO 4"!**

**VISIT OUR WEBSITE  
TO SEE OUR COMPLETE  
LINE OF FAN BOXES**  
[www.orbitelectric.com](http://www.orbitelectric.com)



# RIGID Fittings

## STEEL RIGID CONNECTORS SET-SCREW TYPE

### Features:

- Steel
- Electroplated Zinc
- For use in dry location



Cat. No.	Trade Size	Std. Pkg.	Master Ctn.
RS-50	1/2"	25	250
RS-75	3/4"	25	250
RS-100	1"	10	100
RS-125	1-1/4"	1	25
RS-150	1-1/2"	1	25
RS-200	2"	1	10

## STEEL RIGID COUPLINGS SET-SCREW TYPE

### Features:

- Steel
- Electroplated Zinc
- For use in dry location



Cat. No.	Trade Size	Std. Pkg.	Master Ctn.
RSC-50	1/2"	25	250
RSC-75	3/4"	25	250
RSC-100	1"	10	100
RSC-125	1-1/4"	1	25
RSC-150	1-1/2"	1	25
RSC-200	2"	1	10

## STEEL THREADLESS RIGID CONNECTORS COMPRESSION TYPE

### Features:

- Steel
- Electroplated Zinc
- Concrete-Tight



Cat. No.	Trade Size	Std. Pkg.	Master Ctn.
RT-50	1/2"	25	250
RT-75	3/4"	25	250
RT-100	1"	10	100
RT-125	1-1/4"	1	25
RT-150	1-1/2"	1	25
RT-200	2"	1	10

## STEEL THREADLESS RIGID COUPLINGS COMPRESSION TYPE

### Features:

- Steel
- Electroplated Zinc
- Concrete-Tight



Cat. No.	Trade Size	Std. Pkg.	Master Ctn.
RTC-50	1/2"	25	250
RTC-75	3/4"	25	250
RTC-100	1"	10	100
RTC-125	1-1/4"	1	25
RTC-150	1-1/2"	1	25
RTC-200	2"	1	10

# RIGID Fittings

## RIGID TO FLEX COUPLINGS

### SET-SCREW TYPE

**Features:**

- Zinc Die Cast
- For Steel FLEX only



Cat. No.	Trade Size	Std. Pkg.	Master Ctn.
OF694	1/2"	25	250
OF695	3/4"	25	250

## RIGID TO FLEX COUPLINGS

### CLAMP-TYPE

**Features:**

- Zinc Die Cast
- For Steel FLEX only



Cat. No.	Trade Size	Std. Pkg.	Master Ctn.
OF697	1/2"	25	250

## EMT BUSHINGS

**Features:**

- Plastic
- Fits and protects EMT Conduit
- Size 2-1/2" to 4" can be also used for Rigid, IMC and PVC conduit



**Note:**

- Color may vary

Cat. No.	Trade Size	Std. Pkg.	Master Ctn.
TPB-50	1/2"	100	1000
TPB-75	3/4"	100	1000
TPB-100	1"	50	500
TPB-125	1-1/4"	25	250
TPB-150	1-1/2"	25	250
TPB-200	2"	10	100
TPB-250	2-1/2"	10	100
TPB-300	3"	-	20
TPB-350	3-1/2"	-	20
TPB-400	4"	-	10

# Grounding

## GROUND BUSHINGS INSULATED WITH UNIVERSAL LAY-IN LUG

### Features:

- Zinc Die Cast
- 105°C Rated Throat Insulator



Cat. No.	Trade Size	Lug Range	Std. Pkg.	Master Ctn.
GBLL-50	1/2"	#14 - #4	50	500
GBLL-75	3/4"	#14 - #4	40	400
GBLL-100	1"	#14 - #4	15	150
GBLL-125	1-1/4"	#14 - #4	15	150
GBLL-150	1-1/2"	#14 - #4	10	100
GBLL-200	2"	#14 - #4	5	50
GBLL-250	2-1/2"	#6 - 250MCM	5	50
GBLL-300	3"	#6 - 250MCM	5	50
GBLL-350	3-1/2"	#6 - 250MCM	4	40
GBLL-400	4"	#6 - 250MCM	4	40
GBLL-500 <b>NEW</b>	5"	#6 - 250MCM	4	40
GBLL-600 <b>NEW</b>	6"	#6 - 250MCM	4	40

**NOW UP TO 6"!**

## MALLEABLE GROUND BUSHINGS INSULATED WITH UNIVERSAL LAY-IN LUG

### Features

- Malleable iron
- Full Machine-Cut Internal Threads
- Meets Federal Spec. A-A-50553

**NEW**



Cat. No.	Trade Size	Lug Range	Std. Pkg.	Master Ctn.
MGBLL-50	1/2"	#14 - #4	50	200
MGBLL-75	3/4"	#14 - #4	25	100
MGBLL-100	1"	#14 - #4	25	100
MGBLL-125	1-1/4"	#14 - #4	10	50
MGBLL-150	1-1/2"	#14 - #4	10	50
MGBLL-200	2"	#14 - #4	10	50
MGBLL-250	2-1/2"	#6 - 250MCM	5	25
MGBLL-300	3"	#6 - 250MCM	5	25
MGBLL-350	3-1/2"	#6 - 250MCM	-	5
MGBLL-400	4"	#6 - 250MCM	-	5

# Grounding

## ZINC DIE CAST BARE GROUND CLAMPS

**Features:**

- Steel Screws



Cat. No.	Trade Size	Ground Wire Range	Std. Pkg.	Master Ctn.
GCBZ-50/100	1/2" to 1"	#10 - #2	25	200

## BRONZE BARE GROUND CLAMPS

**Features:**

- Steel Screws



Cat. No.	Trade Size	Ground Wire Range	Std. Pkg.	Master Ctn.
GCB-50/100	1/2" to 1"	#10 - #2	25	200
GCB-125/200	1-1/4" to 2"	#10 - #2	10	80
GCB-250/400	2-1/2" to 4"	#10 - #2	-	15
GCB-450/600	4-1/2" to 6"	#10 - #2	-	5

## BRONZE BARE GROUND CLAMPS

**Features:**

- Brass Screws



Cat. No.	Trade Size	Ground Wire Range	Std. Pkg.	Master Ctn.
GCBR-50/100	1/2" to 1"	#10 - #2	25	200

## BRONZE ARMORED GROUND CLAMPS

**Features:**

- Steel Screws
- For use with #8, #6, #4 AWG Bare Wire or AC (BX) Armored Cable



Cat. No.	Trade Size	Ground Wire Range	Std. Pkg.	Master Ctn.
GCA-50/100	1/2" to 1"	#8 - #4	25	160
GCA-125/200	1-1/4" to 2"	#8 - #4	10	80
GCA-250/400	2-1/2" to 4"	#8 - #4	-	15
GCA-450/600	4-1/2" to 6"	#8 - #4	-	5

# Grounding

## GROUNDING (BONDING)

### RIGID LOCKNUTS

#### Features

- Steel
- Electroplated Zinc



Cat. No.	Trade Size	Std. Pkg.	Master Ctn.
GL-50	1/2"	50	200
GL-75	3/4"	25	100
GL-100	1"	25	100
GL-125	1-1/4"	10	50
GL-150	1-1/2"	10	50
GL-200	2"	10	50
GL-250	2-1/2"	5	25
GL-300	3"	5	25
GL-350	3-1/2"	-	5
GL-400	4"	-	5

### COPPER DIRECT BURIAL MECHANICAL LUGS

#### Features:

- Stainless Steel Screws

**NEW**



Cat. No.	Std. Pkg.	Master Ctn.	Wire Range
MLDB-14/10	50	400	#14 - #10
MLDB-14/6	50	400	#14 - #6
MLDB-14/4	25	200	#14 - #4
MLDB-6/100	10	80	#6 - #1/0

### COPPER DIRECT BURIAL LAY-IN LUGS

#### Features:

- Stainless Steel Screws

**NEW**



Cat. No.	Std. Pkg.	Master Ctn.	Wire Range
LLDB-14/4	25	250	#14 - #4

### COPPER TINNED DIRECT BURIAL LAY-IN LUGS

LLTDB-14/4	25	250	#14 - #4
------------	----	-----	----------

### COPPER TINNED DIRECT BURIAL LAY-IN LUGS FOR SOLAR PANELS

LLTDB-SP-14/4	25	250	#14 - #4
---------------	----	-----	----------

# Grounding

## BRONZE DIRECT BURIAL BARE GROUND CLAMPS



**Features:**

- Bronze Screws

Cat. No.	Trade Size	Ground Wire Range	Std. Pkg.	Master Ctn.
<b>GCCB-50/100</b>	1/2" to 1"	#10 - #2	25	200
<b>GCCB-125/200</b>	1-1/4" to 2"	#10 - #2	10	80

## BRONZE DIRECT BURIAL ARMORED GROUND CLAMPS



**Features:**

- Bronze Screws
- For #8, #6, #4 AWG Bare Wire or AC (BX) Armored Cable

Cat. No.	Trade Size	Ground Wire Range	Std. Pkg.	Master Ctn.
<b>G CAB-50/100</b>	1/2" to 1"	#8 - #4	25	200

## BRONZE GROUND CLAMPS *WITH ADAPTER*



**Features:**

- Steel Screws

Cat. No.	Trade Size	Ground Wire Range	Std. Pkg.	Master Ctn.
<b>GCAH-50/100</b>	1/2" to 1"	#8 - #4/0	10	80
<b>GCAH-125/200</b>	1-1/4" to 2"	#8 - #4/0	5	40

# Grounding

## HEAVY DUTY BRONZE DIRECT BURIAL FOR REBAR GROUND CLAMPS



**Features:**

- Brass Screws

Cat. No.	Trade Size	Ground Wire Range	Std. Pkg.	Master Ctn.
GCR-50/100	1/2" to 1"	#8 - #2	25	200

## BRONZE CONDUIT CLAMPS FOR RIGID CONDUIT

### WITH ADAPTER



**Features:**

- Steel Screws

Cat. No.	Water Pipe Size	Hub Size	Ground Wire Range	Std. Pkg.	Master Ctn.
GCH-50/100-50	1/2" to 1"	1/2"	#10 - #2/0	10	50
GCH-50/100-75	1/2" to 1"	3/4"	#10 - #2/0	10	50
GCH-50/100-100	1/2" to 1"	1"	#10 - #3/0	10	50

## BRONZE GROUND CLAMPS FOR RIGID CONDUIT

### WITH FLEXIBLE COPPER STRAP



**Features:**

- Steel Screws

Cat. No.	Water Pipe Size	Hub Size	Ground Wire Range	Std Pkg.
AGS-50	1/2" to 1"	1/2"	#10 - #4	50
AGS-75	1/2" to 1"	3/4"	#10 - #4	50
AGS-100	1/2" to 1"	1"	#10 - #4	50

## BRONZE CONDUIT HUB 360° SWING TYPE



**Features:**

- Steel Screws

Cat. No.	Pipe Size	Ground Wire Range	Std. Pkg.	Master Ctn.
H-50	1/2"	#10 - #2/0	25	200
H-75	3/4"	#10 - #2/0	25	200
H-100	1"	#10 - #3/0	20	160

# Grounding

## BRONZE DIRECT BURIAL GROUND ROD CLAMPS

**Features:**

- Bronze Screws



Cat. No.	Ground Rod Size	Ground Wire Range	Std. Pkg.	Master Ctn.
GRC-50	1/2"	#10 - #2/0	35	280
GRC-58	5/8"	#10 - #2/0	30	240
GRC-75	3/4"	#10 - #2/0	20	160

## SPLIT BOLT COPPER TO COPPER CONNECTORS

**Features:**

- Brass

**NEW**



Cat. No.	Ground Wire Range	Std. Pkg.	Master Ctn.
SBCC-8	#8 STR - #12 STR	25	200
SBCC-6	#6 SOL - #10 SOL	25	200
SBCC-4	#4 SOL - #8 SOL	25	200
SBCC-2	#2 STR - #6 SOL	10	80
SBCC-2S	#2 SOL - #6 SOL	10	80
SBCC-10	#1/0 STR - #4 SOL	10	80
SBCC-20	#2/0 STR - #2 SOL	5	40
SBCC-30	#3/0 STR - #2 SOL	5	40
SBCC-250	250 MCM - #1/0 SOL	5	40
SBCC-350	350MCM - #4/0 SOL	1	8
SBCC-500	500MCM - 250 MCM	1	8
SBCC-750	750 MCM - 350MCM	1	8

**VISIT OUR WEBSITE TO SEE  
OUR COMPLETE LINE OF  
PREFAB AND NEW INNOVATIONS**  
[www.orbitelectric.com](http://www.orbitelectric.com)

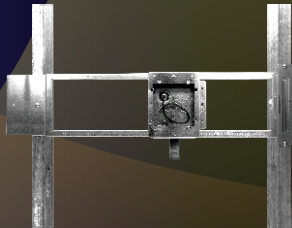
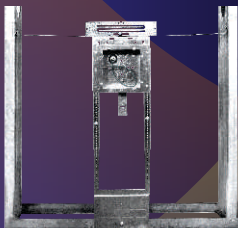



# Handy Ells

## RIGID TO BOX PULL ELBOWS *WITH GASKET*



**Features:**

- Zinc Die Cast
- Aluminum Cover

Cat. No.	Trade Size	Std. Pkg.	Master Ctn.
PEB-50	1/2"	10	100
PEB-75	3/4"	5	50
PEB-100	1"	-	25
PEB-125	1-1/4"	-	20

## RIGID TO RIGID PULL ELBOWS *WITH GASKET*



**Features:**

- Zinc Die Cast
- Aluminum Cover

Cat. No.	Trade Size	Std. Pkg.	Master Ctn.
PE-50	1/2"	10	100
PE-75	3/4"	5	50
PE-100	1"	-	25
PE-125	1-1/4"	-	20

## EMT TO BOX PULL ELBOWS SET-SCREW TYPE *WITH GASKET*



**Features:**

- Zinc Die Cast
- Aluminum Cover

Cat. No.	Trade Size	Std. Pkg.	Master Ctn.
SSPEB-G50	1/2"	10	100
SSPEB-G75	3/4"	5	50
SSPEB-G100	1"	-	25
SSPEB-G125	1-1/4"	-	20

**EMT TO BOX PULL ELBOWS**  
**SET-SCREW TYPE**  
***WITHOUT GASKET***



**Features:**

- Zinc Die Cast
- Aluminum Cover

<b>Cat. No.</b>	<b>Trade Size</b>	<b>Std. Pkg.</b>	<b>Master Ctn.</b>
<b>SSPEB-50</b>	1/2"	10	100
<b>SSPEB-75</b>	3/4"	5	50
<b>SSPEB-100</b>	1"	-	25
<b>SSPEB-125</b>	1-1/4"	-	20

**EMT TO EMT PULL ELBOWS**  
**SET-SCREW TYPE**  
***WITH GASKET***



**Features:**

- Zinc Die Cast
- Aluminum Cover

<b>Cat. No.</b>	<b>Trade Size</b>	<b>Std. Pkg.</b>	<b>Master Ctn.</b>
<b>SSPE-G50</b>	1/2"	10	100
<b>SSPE-G75</b>	3/4"	5	50
<b>SSPE-G100</b>	1"	-	25
<b>SSPE-G125</b>	1-1/4"	-	20

**EMT TO EMT PULL ELBOWS**  
**SET-SCREW TYPE**  
***WITHOUT GASKET***



**Features:**

- Zinc Die Cast
- Aluminum Cover

<b>Cat. No.</b>	<b>Trade Size</b>	<b>Std. Pkg.</b>	<b>Master Ctn.</b>
<b>SSPE-50</b>	1/2"	10	100
<b>SSPE-75</b>	3/4"	5	50
<b>SSPE-100</b>	1"	-	25
<b>SSPE-125</b>	1-1/4"	-	20

## CONDUIT BODIES AND COVERS

FOR EASY ACCESS TO PULLING, INSPECTING,  
AND MAINTAINING OF WIRES.

Available in either  
Die Cast Copper-Free Aluminum  
or Malleable Iron



Available in threaded version  
for use with rigid conduit and  
IMC or set screw for use with EMT



Available in configurations:  
LB, LL, LR, C, T, and SLB

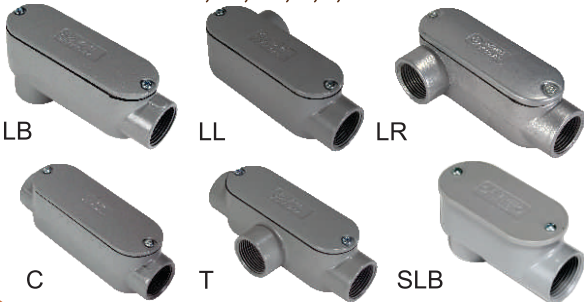

# Conduit Bodies Line Drawings

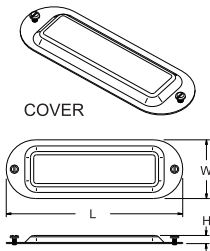
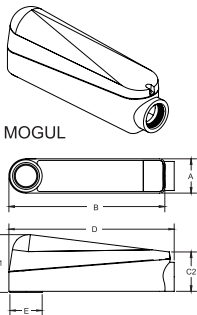
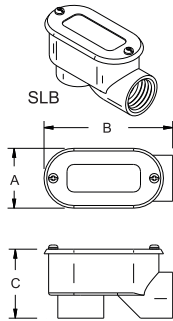
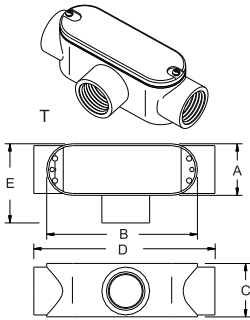
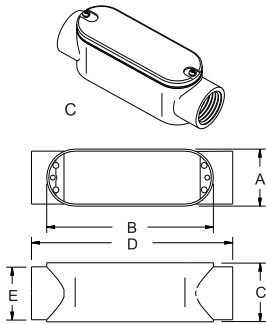
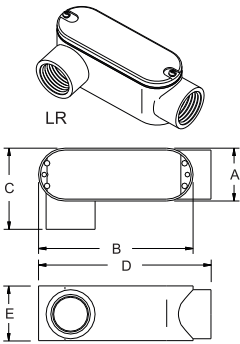
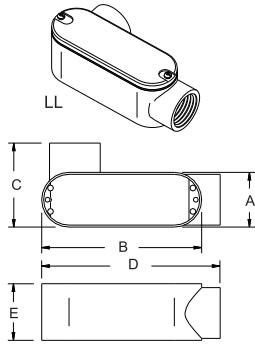
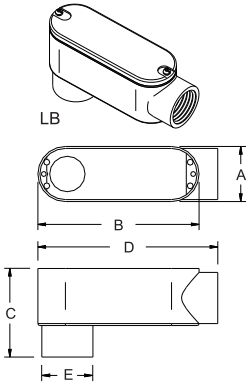

# Conduit Bodies

## THREADED CONDUIT BODIES

### “LB” SERIES

#### Features:

- Die Cast Copper-Free Aluminum
- With Die Cast Cover
- Neoprene Gasket



Cat. No.	Trade Size	DIMENSIONS - LB SERIES					Color	Std. Pkg.
		A	B	C	D	E		
LB-50A	1/2"	1-5/16"	3-7/8"	2-3/32"	4-5/16"	1-1/16"	Gray	10
LB-75A	3/4"	1-9/16"	4-11/16"	2-3/8"	5-3/32"	1-5/16"	Gray	10
LB-100A	1"	1-13/16"	5-3/8"	2-3/4"	5-29/32"	1-9/16"	Gray	5
LB-125A	1-1/4"	2-1/2"	7-5/16"	3-1/2"	7-13/16"	1-31/32"	Gray	2
LB-150A	1-1/2"	2-1/2"	7-5/16"	3-1/2"	7-13/16"	2-3/16"	Gray	2
LB-200A	2"	3-3/16"	9-1/2"	4-1/2"	10-1/16"	2-11/16"	Gray	1

## THREADED CONDUIT BODIES

### “LL” SERIES

#### Features:

- Die Cast Copper-Free Aluminum
- With Die Cast Cover
- Neoprene Gasket



Cat. No.	Trade Size	DIMENSIONS - LL SERIES					Color	Std. Pkg.
		A	B	C	D	E		
LL-50A	1/2"	1-5/16"	3-7/8"	2-1/32"	4-5/16"	1-3/8"	Gray	10
LL-75A	3/4"	1-9/16"	4-11/16"	2-5/16"	5-3/32"	1-5/8"	Gray	10
LL-100A	1"	1-13/16"	5-3/8"	2-11/16"	5-29/32"	1-7/8"	Gray	5
LL-125A	1-1/4"	2-1/2"	7-5/16"	3-1/2"	7-13/16"	2-1/2"	Gray	2
LL-150A	1-1/2"	2-1/2"	7-5/16"	3-1/2"	7-13/16"	2-1/2"	Gray	2
LL-200A	2"	3-3/16"	9-1/2"	4-9/32"	10-1/16"	3-3/8"	Gray	1

## THREADED CONDUIT BODIES

### “LR” SERIES

#### Features:

- Die Cast Copper-Free Aluminum
- With Die Cast Cover
- Neoprene Gasket



Cat. No.	Trade Size	DIMENSIONS - LR SERIES					Color	Std. Pkg.
		A	B	C	D	E		
LR-50A	1/2"	1-5/16"	3-7/8"	2-1/32"	4-5/16"	1-3/8"	Gray	10
LR-75A	3/4"	1-9/16"	4-11/16"	2-5/16"	5-3/32"	1-5/8"	Gray	10
LR-100A	1"	1-13/16"	5-3/8"	2-11/16"	5-29/32"	1-7/8"	Gray	5
LR-125A	1-1/4"	2-1/2"	7-5/16"	3-1/2"	7-13/16"	2-1/2"	Gray	2
LR-150A	1-1/2"	2-1/2"	7-5/16"	3-1/2"	7-13/16"	2-1/2"	Gray	2
LR-200A	2"	3-3/16"	9-1/2"	4-9/32"	10-1/16"	3-3/8"	Gray	1

# Conduit Bodies

## THREADED CONDUIT BODIES

### “C” SERIES

#### Features:

- Die Cast Copper-Free Aluminum
- With Die Cast Cover
- Neoprene Gasket



Cat. No.	Trade Size	DIMENSIONS - C SERIES					Color	Std. Pkg.
		A	B	C	D	E		
<b>C-50A</b>	1/2"	1-5/16"	3-7/8"	1-3/8"	4-5/16"	1-1/16"	Gray	10
<b>C-75A</b>	3/4"	1-9/16"	4-11/8"	1-5/8"	5-3/32"	1-5/16"	Gray	10
<b>C-100A</b>	1"	1-13/16"	5-3/8"	1-7/8"	5-29/32"	1-9/16"	Gray	5
<b>C-125A</b>	1-1/4"	2-1/2"	7-5/16"	2-1/2"	7-13/16"	1-31/32"	Gray	2
<b>C-150A</b>	1-1/2"	2-1/2"	7-5/16"	2-1/2"	7-13/16"	2-3/16"	Gray	2
<b>C-200A</b>	2"	3-3/16"	9-1/2"	3-3/8"	10-1/16"	2-11/16"	Gray	1

## THREADED CONDUIT BODIES

### “T” SERIES

#### Features:

- Die Cast Copper-Free Aluminum
- With Die Cast Cover
- Neoprene Gasket



Cat. No.	Trade Size	DIMENSIONS - T SERIES					Color	Std. Pkg.
		A	B	C	D	E		
<b>T-50A</b>	1/2"	1-5/16"	3-7/8"	1-3-8"	4-11/16"	2-1/32"	Gray	10
<b>T-75A</b>	3/4"	1-9/16"	4-11/16"	1-5/8"	5-1/2"	2-5/16"	Gray	10
<b>T-100A</b>	1"	1-13/16"	5-3/8"	1-7/8"	6-7/16"	2-11/16"	Gray	5
<b>T-125A</b>	1-1/4"	2-1/2"	7-5/16"	2-1/2"	8-3/8"	3-1/2"	Gray	2
<b>T-150A</b>	1-1/2"	2-1/2"	7-5/16"	2-1/2"	8-3/8"	3-1/2"	Gray	2
<b>T-200A</b>	2"	3-3/16"	9-1/2"	3-3/8"	10-9/16"	4-9/32"	Gray	1

## THREADED SERVICE ENTRANCE CONDUIT BODIES

### “SLB” SERIES

#### Features:

- Die Cast Copper-Free Aluminum
- With Die Cast Cover
- Neoprene Gasket



Cat. No.	Trade Size	DIMENSIONS - SLB SERIES			Color	Std. Pkg.
		A	B	C		
<b>SLB-50</b>	1/2"	3-9/32"	1-5/8"	1-3/8"	Gray	20
<b>SLB-75</b>	3/4"	3-19/32"	1-27/32"	1-9/16"	Gray	20
<b>SLB-100</b>	1"	4-5/16"	2-1/8"	1-31/32"	Gray	10
<b>SLB-125</b>	1-1/4"	5-9/16"	2-19/32"	2-7/16"	Gray	10
<b>SLB-150</b>	1-1/2"	6-1/4"	2-19/32"	2-5/8"	Gray	6
<b>SLB-200</b>	2"	6-3/4"	3-1/8"	3-1/8"	Gray	3

# Conduit Bodies

## THREADED CONDUIT BODIES

### “LB” SERIES

#### WITHOUT COVERS

#### Features:

- Die Cast Copper-Free Aluminum



Cat. No.	Trade Size	DIMENSIONS - LB SERIES					Color	Std. Pkg.
		A	B	C	D	E		
LB-50	1/2"	1-5/16"	3-7/8"	2-3/32"	4-5/16"	1-1/16"	Gray	10
LB-75	3/4"	1-9/16"	4-11/16"	2-3/8"	5-3/32"	1-5/16"	Gray	10
LB-100	1"	1-13/16"	5-3/8"	2-3/4"	5-29/32"	1-9/16"	Gray	5
LB-125	1-1/4"	2-1/2"	7-5/16"	3-1/2"	7-13/16"	1-31/32"	Gray	2
LB-150	1-1/2"	2-1/2"	7-5/16"	3-1/2"	7-13/16"	2-3/16"	Gray	2
LB-200	2"	3-3/16"	9-1/2"	4-1/2"	10-1/16"	2-11/16"	Gray	1
LB-250	2-1/2"	4-1/2"	12-1/16"	5-5/16"	12-13/16"	3-5/16"	Gray	1
LB-300	3"	4-1/2"	12-1/16"	5-29/32"	12-13/16"	3-15/16"	Gray	1
LB-350	3-1/2"	5-9/16"	15-1/16"	7-5/16"	15-5/8"	4-17/32"	Gray	1
LB-400	4"	5-9/16"	15-7/16"	7-5/16"	15-5/8"	4-31/32"	Gray	1

## THREADED CONDUIT BODIES

### “LL” SERIES

#### WITHOUT COVERS

#### Features:

- Die Cast Copper-Free Aluminum



Cat. No.	Trade Size	DIMENSIONS - LL SERIES					Color	Std. Pkg.
		A	B	C	D	E		
LL-50	1/2"	1-5/16"	3-7/8"	2-1/32"	4-5/16"	1-3/8"	Gray	10
LL-75	3/4"	1-9/16"	4-11/16"	2-5/16"	5-3/32"	1-5/8"	Gray	10
LL-100	1"	1-13/16"	5-3/8"	2-11/16"	5-29/32"	1-7/8"	Gray	5
LL-125	1-1/4"	2-1/2"	7-5/16"	3-1/2"	7-13/16"	2-1/2"	Gray	2
LL-150	1-1/2"	2-1/2"	7-5/16"	3-1/2"	7-13/16"	2-1/2"	Gray	2
LL-200	2"	3-3/16"	9-1/2"	4-9/32"	10-1/16"	3-3/8"	Gray	1
LL-250	2-1/2"	4-1/2"	12-1/16"	5-7/8"	12-13/16"	4"	Gray	1
LL-300	3"	4-1/2"	12-1/16"	5-7/8"	12-13/16"	4-1/2"	Gray	1
LL-400	4"	5-9/16"	15-1/16"	7-21/32"	15-3/8"	5-5/8"	Gray	1



FIND MORE  
ELECTRICAL PRODUCTS  
ON OUR WEBSITE  
[www.orbitelectric.com](http://www.orbitelectric.com)

# Conduit Bodies

## THREADED CONDUIT BODIES

### “LR” SERIES

#### WITHOUT COVERS



#### Features:

- Die Cast Copper-Free Aluminum

Cat. No.	Trade Size	DIMENSIONS - LR SERIES					Color	Std. Pkg.
		A	B	C	D	E		
LR-50	1/2"	1-5/16"	3-7/8"	2-1/32"	4-5/16"	1-3/8"	Gray	10
LR-75	3/4"	1-9/16"	4-11/16"	2-5/16"	5-3/32"	1-5/8"	Gray	10
LR-100	1"	1-13/16"	5-3/8"	2-11/16"	5-29/32"	1-7/8"	Gray	5
LR-125	1-1/4"	2-1/2"	7-5/16"	3-1/2"	7-13/16"	2-1/2"	Gray	2
LR-150	1-1/2"	2-1/2"	7-5/16"	3-1/2"	7-13/16"	2-1/2"	Gray	2
LR-200	2"	3-3/16"	9-1/2"	4-9/32"	10-1/16"	3-3/8"	Gray	1
LR-250	2-1/2"	4-1/2"	12-1/16"	5-7/8"	12-13/16"	4"	Gray	1
LR-300	3"	4-1/2"	12-1/16"	5-7/8"	12-13/16"	4-1/2"	Gray	1
LR-400	4"	5-9/16"	15-1/16"	7-21/32"	15-5/8"	5-5/8"	Gray	1

## THREADED CONDUIT BODIES

### “C” SERIES

#### WITHOUT COVERS



#### Features:

- Die Cast Copper-Free Aluminum

Cat. No.	Trade Size	DIMENSIONS - C SERIES					Color	Std. Pkg.
		A	B	C	D	E		
C-50	1/2"	1-5/16"	3-7/8"	1-3/8"	4-5/16"	1-1/16"	Gray	10
C-75	3/4"	1-9/16"	4-11/8"	1-5/8"	5-3/32"	1-5/16"	Gray	10
C-100	1"	1-13/16"	5-3/8"	1-7/8"	5-29/32"	1-9/16"	Gray	5
C-125	1-1/4"	2-1/2"	7-5/16"	2-1/2"	7-13/16"	1-31/32"	Gray	2
C-150	1-1/2"	2-1/2"	7-5/16"	2-1/2"	7-13/16"	2-3/16"	Gray	2
C-200	2"	3-3/16"	9-1/2"	3-3/8"	10-1/16"	2-11/16"	Gray	1
C-250	2-1/2"	4-1/2"	12-1/16"	4"	12-13/16"	3-5/16"	Gray	1
C-300	3"	4-1/2"	12-1/16"	4-1/2"	12-13/16"	3-15/16"	Gray	1
C-400	4"	5-9/16"	15-1/16"	5-5/8"	15-5/8"	4-31/32"	Gray	1





# Conduit Bodies

## THREADED CONDUIT BODIES "T" SERIES WITHOUT COVERS



### Features:

- Die Cast Copper-Free Aluminum

Cat. No.	Trade Size	DIMENSIONS - T SERIES					Color	Std. Pkg.
		A	B	C	D	E		
<b>T-50</b>	1/2"	1-5/16"	3-7/8"	1-3/8"	4-11/16"	2-1/32"	Gray	10
<b>T-75</b>	3/4"	1-9/16"	4-11/16"	1-5/8"	5-1/2"	2-5/16"	Gray	10
<b>T-100</b>	1"	1-13/16"	5-3/8"	1-7/8"	6-7/16"	2-11/16"	Gray	5
<b>T-125</b>	1-1/4"	2-1/2"	7-5/16"	2-1/2"	8-3/8"	3-1/2"	Gray	2
<b>T-150</b>	1-1/2"	2-1/2"	7-5/16"	2-1/2"	8-3/8"	3-1/2"	Gray	2
<b>T-200</b>	2"	3-3/16"	9-1/2"	3-3/8"	10-9/16"	4-9/32"	Gray	1
<b>T-250</b>	2-1/2"	4-1/2"	12-1/16"	4"	13-1/2"	5-7/8"	Gray	1
<b>T-300</b>	3"	4-1/2"	12-1/16"	4-1/2"	13-1/2"	5-7/8"	Gray	1
<b>T-400</b>	4"	5-9/16"	15-1/16"	5-5/8"	16-5/16"	7-21/32"	Gray	1

## COVERS with GASKETS

### Features:

- Die Cast Copper-Free Aluminum
- Neoprene Gasket



Cat. No.	Trade Size	DIMENSION			Color	Std. Pkg.
		L	W	H		
<b>CG-50</b>	1/2"	3-7/8"	1-5/16"	1/4"	Gray	100
<b>CG-75</b>	3/4"	4-11/16"	1-9/16"	1/4"	Gray	50
<b>CG-100</b>	1"	5-3/8"	1-3/4"	1/4"	Gray	50
<b>CG-125/150</b>	1-1/4" to 1-1/2"	7-5/16"	2-1/2"	1/4"	Gray	25
<b>CG-200</b>	2"	9-1/2"	3-1/8"	5/16"	Gray	10
<b>CG-250/300</b>	2-1/2" to 3"	12-1/16"	4-7/16"	3/8"	Gray	10
<b>CG-350/400</b>	3-1/2" to 4"	15-1/16"	5-9/16"	3/8"	Gray	5

## GASKETS

### Features:

- Neoprene Gasket
- For use with Cast Aluminum & Malleable Iron Conduit Bodies



Cat. No.	Trade Size	DIMENSION			Color	Std. Pkg.
		L	W	H		
<b>G-50</b>	1/2"	3-11/16"	1-3/8"	5/16"	Black	100
<b>G-75</b>	3/4"	4-1/4"	1-1/2"	5/16"	Black	100
<b>G-100</b>	1"	5"	1-3/4"	5/16"	Black	50
<b>G-125/150</b>	1-1/4" to 1-1/2"	6"	2-7/16"	5/16"	Black	50
<b>G-200</b>	2"	7"	3"	5/16"	Black	50
<b>G-250/300</b>	2-1/2" to 3"	9"	4-1/4"	9/16"	Black	25
<b>G-350/400</b>	3-1/2" to 4"	11"	5-1/4"	9/16"	Black	25

# Conduit Bodies

## MALLEABLE IRON THREADED CONDUIT BODIES “LB” SERIES

### Features:

- Malleable Iron
- Electroplated Zinc



Cat. No.	Trade Size	DIMENSIONS - LB SERIES					Std. Pkg.
		A	B	C	D	E	
MLB-50	1/2"	1-3/8"	4"	2-3/16"	4-5/8"	1-15/32"	10
MLB-75	3/4"	1-5/8"	4-21/32"	2-3/8"	5-3/8"	1-21/32"	10
MLB-100	1"	1-13/16"	5-3/8"	2-7/8"	6-1/4"	2"	5
MLB-125	1-1/4"	2-1/2"	7-7/32"	3-1/2"	8-1/8"	2-5/8"	2
MLB-150	1-1/2"	2-1/2"	7-7/32"	3-11/16"	8-3/32"	2-13/16"	2
MLB-200	2"	3-1/8"	9-1/2"	4-1/2"	10-1/2"	3-1/2"	1
MLB-250	2-1/2"	4-3/8"	12-1/4"	5-13/32"	13-3/4"	4"	1
MLB-300	3"	4-3/8"	12-1/4"	6-3/16"	13-13/16"	4-5/8"	1
MLB-350	3-1/2"	5-1/2"	15"	7-3/16"	16-5/8"	5-7/16"	1
MLB-400	4"	5-1/2"	15"	7-11/32"	16-23/32"	5-3/4"	1

## MALLEABLE IRON THREADED CONDUIT BODIES “LL” SERIES

### Features:

- Malleable Iron
- Electroplated Zinc



Cat. No.	Trade Size	DIMENSIONS - LL SERIES					Std. Pkg.	
		A	B	C	D	E		
MLL-50	1/2"	1-3/8"	4"	2-1/16"	4-11/16"	1-7/16"	10	
MLL-75	3/4"	1-5/8"	4-11/16"	2-1/4"	5-13/32"	1-21/32"	10	
MLL-100	1"	1-13/16"	5-3/8"	2-21/32"	6-1/4"	2"	5	
MLL-125	1-1/4"	2-1/2"	7-7/32"	3-7/16"	8-1/8"	2-19/32"	2	
MLL-150	1-1/2"	2-1/2"	7-7/32"	3-7/16"	8-1/8"	2-13/16"	2	
MLL-200	2"	3-1/8"	9-1/2"	4-3/16"	10-1/2"	3-17/32"	1	
MLL-250	2-1/2"	<b>NEW</b>	4-3/8"	12-1/4"	5-27/32"	13-3/4"	4"	1
MLL-300	3"	<b>NEW</b>	4-3/8"	12-1/4"	5-29/32"	13-13/16"	4-21/32"	1
MLL-350	3-1/2"	<b>NEW</b>	5-1/2"	15"	7-1/8"	16-5/8"	5-7/16"	1
MLL-400	4"	<b>NEW</b>	5-1/2"	15"	7-3/16"	16-5/8"	5-3/4"	1

**NOW UP TO 4"!**

# Conduit Bodies

## MALLEABLE IRON THREADED CONDUIT BODIES “LR” SERIES



### Features:

- Malleable Iron
- Electroplated Zinc

Cat. No.	Trade Size	DIMENSIONS - LR SERIES					Std. Pkg.	
		A	B	C	D	E		
MLR-50	1/2"	1-3/8"	4"	2-1/16"	4-11/16"	1-7/16"	10	
MLR-75	3/4"	1-9/16"	4-11/16"	2-1/4"	5-13/32"	1-21/32"	10	
MLR-100	1"	1-13/16"	5-3/8"	2-11/16"	6-9/32"	2"	5	
MLR-125	1-1/4"	2-1/2"	7-7/32"	3-3/8"	8-1/8"	2-19/32"	2	
MLR-150	1-1/2"	2-1/2"	7-7/32"	3-7/16"	8-1/8"	2-13/16"	2	
MLR-200	2"	3-5/32"	9-1/2"	4-1/8"	10-1/2"	3-1/2"	1	
MLR-250	2-1/2"	<b>NEW</b>	4-7/16"	12-1/4"	5-27/32"	13-3/4"	4"	1
MLR-300	3"	<b>NEW</b>	4-7/16"	12-1/4"	5-29/32"	13-13/16"	4-21/32"	1
MLR-350	3-1/2"	<b>NEW</b>	5-1/2"	15"	7-1/8"	16-5/8"	5-7/16"	1
MLR-400	4"	<b>NEW</b>	5-1/2"	15"	7-3/16"	16-5/8"	5-3/4"	1

**NOW UP TO 4"!**

## MALLEABLE IRON THREADED CONDUIT BODIES “C” SERIES



### Features:

- Malleable Iron
- Electroplated Zinc

Cat. No.	Trade Size	DIMENSIONS - C SERIES				Std. Pkg.	
		A	B	C	D		
MC-50	1/2"	1-3/8"	4"	5-7/16"	1-1/2"	10	
MC-75	3/4"	1-9/16"	4-11/16"	6-5/32"	1-21/32"	10	
MC-100	1"	1-13/16"	5-13/32"	7-5/32"	2"	5	
MC-125	1-1/4"	2-1/2"	7-7/32"	9-1/16"	2-19/32"	2	
MC-150	1-1/2"	2-1/2"	7-7/32"	9-1/16"	2-13/16"	2	
MC-200	2"	3-5/32"	9-1/2"	11-1.2"	3-1/2"	1	
MC-250	2-1/2"	<b>NEW</b>	4-7/16"	12-1/4"	15-5/16"	4"	1
MC-300	3"	<b>NEW</b>	4-7/16"	12-1/4"	15-13/32"	4-5/8"	1
MC-350	3-1/2"	<b>NEW</b>	5-1/2"	15"	18-5/16"	5-7/16"	1
MC-400	4"	<b>NEW</b>	5-1/2"	15"	18-5/16"	5-3/4"	1

**NOW UP TO 4"!**

# Conduit Bodies

## MALLEABLE IRON THREADED CONDUIT BODIES "T" SERIES

### Features:

- Malleable Iron
- Electroplated Zinc



Cat. No.	Trade Size	DIMENSIONS - T SERIES					Std. Pkg.
		A	B	C	D	E	
MT-50	1/2"	1-3/8"	4"	2-1/16"	5-13/32"	1-7/16"	10
MT-75	3/4"	1-5/8"	4-21/32"	2-9/32"	6-5/32"	1-21/32"	10
MT-100	1"	1-13/16"	5-3/8"	2-21/32"	7-5/32"	2"	5
MT-125	1-1/4"	2-1/2"	7-7/32"	3-13/32"	9"	2-11/16"	2
MT-150	1-1/2"	2-1/2"	7-7/32"	3-7/16"	9-1/16"	2-13/16"	2
MT-200	2"	3-5/32"	9-1/2"	4-1/8"	11-1/2"	3-1/2"	1
MT-250	2-1/2"	<b>NEW</b> 4-7/16"	12-1/4"	5-27/32"	15-9/32"	4"	1
MT-300	3"	<b>NEW</b> 4-7/16"	12-1/4"	5-29/32"	15-13/32"	4-21/32"	1
MT-350	3-1/2"	<b>NEW</b> 5-1/2"	15"	7-1/8"	18-9/32"	5-7/16"	1
MT-400	4"	<b>NEW</b> 5-1/2"	15"	7-3/16"	18-9/32"	5-3/4"	1

**NOW UP TO 4"!**

## RAISED DOME STEEL COVERS

### Features:

- Stamped Steel
- Stainless Steel Screws
- Gasket Not Included



Cat. No.	Trade Size	DIMENSION			Std. Pkg.
		L	W	H	
SC-50	1/2"	1-3/8"	4"	1/4"	100
SC-75	3/4"	2-9/16"	4-11/16"	5/16"	50
SC-100	1"	1-13/16"	5-3/8"	3/8"	50
SC-125/150	1-1/4" to 1-1/2"	2-1/2"	7-1/4"	13/32"	25
SC-200	2"	3-1/8"	9-1/2"	1/2"	10
SC-250/300	2-1/2" to 3"	4-7/16"	12-1/4"	3/4"	10
SC-350/400	3-1/2" to 4"	5-1/2"	15"	3/4"	5

## EXTRA-LARGE MOGUL THREADED CONDUIT BODIES "LB" SERIES

### Features:

- Copper-Free Aluminum Alloy
- Die Cast Aluminum Cover
- Fiber Gasket

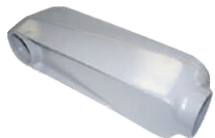

Cat. No.	Trade Size	DIMENSIONS - LB SERIES						Std. Pkg.	Master Ctn.
		A	B	C1	C2	D	E		
LBM-150	1-1/2"	3"	13-7/16"	5"	4"	14-1/4"	2-3/4"	-	1
LBM-200	2"	3"	13-7/16"	5"	4"	14-1/4"	2-3/4"	-	1

# Conduit Bodies

## EMT CONDUIT BODIES

### SET-SCREW TYPE

#### “LB” SERIES

##### Features:

- Copper-Free Aluminum Alloy
- Plated Steel Set-Screws



Cat. No.	Trade Size	DIMENSIONS - LB SERIES					Std. Pkg.	Master Ctn.
		A	B	C	D	E		
SSLB-50	1/2"	1-5/16"	3-15/16"	2-1/16"	4-3/8"	1/16"	10	100
SSLB-75	3/4"	1-17/32"	4-5/8"	2-11/32"	5-1/8"	1-5/16"	10	50
SSLB-100	1"	1-25/32"	5-11/32"	2-7/8"	6"	1-9/16"	5	25
SSLB-125	1-1/4"	2-1/2"	7-1/4"	3-6/16"	7-11/16"	2"	2	10
SSLB-150	1-1/2"	2-1/2"	7-1/4"	3-9/16"	7-11/16"	2-1/4"	2	10
SSLB-200	2"	3-1/8"	9-1/2"	4-11/32"	10"	2-11/16"	1	5
SSLB-250	2-1/2"	4-7/16"	12-1/8"	5-3/16"	12-23/32"	3-3/8"	-	1
SSLB-300	3"	4-7/16"	12-1/8"	5-3/4"	12-23/32"	4"	-	1
SSLB-350	3-1/2"	5-15/32"	15-1/16"	7-1/16"	15-9/16"	5"	-	1
SSLB-400	4"	5-15/32"	15-1/16"	7-1/16"	15-9/16"	5"	-	1

## EMT CONDUIT BODIES

### SET-SCREW TYPE

#### “LR” SERIES

##### Features:

- Copper-Free Aluminum Alloy
- Plated Steel Set-Screws



Cat. No.	Trade Size	DIMENSIONS - LR SERIES					Std. Pkg.	Master Ctn.
		A	B	C	D	E		
SSLR-50	1/2"	1-5/16"	3-15/16"	2"	4-3/8"	1-5/16"	10	100
SSLR-75	3/4"	1-17/32"	4-5/8"	2-1/4"	5-1/8"	1-19/32"	10	50
SSLR-100	1"	1-25/32"	5-11/32"	2-23/32"	6"	1-29/32"	5	25
SSLR-125	1-1/4"	2-1/2"	7-1/4"	3-13/32"	7-11/16"	2-1/2"	2	10
SSLR-150	1-1/2"	2-1/2"	7-1/4"	3-13/32"	7-11/16"	2-11/16"	2	10
SSLR-200	2"	3-1/8"	9-1/2"	4-3/16"	10"	3-3/8"	1	5

## EMT CONDUIT BODIES

### SET-SCREW TYPE

#### “LL” SERIES

##### Features:

- Copper-Free Aluminum Alloy
- Plated Steel Set-Screws



Cat. No.	Trade Size	DIMENSIONS - LL SERIES					Std. Pkg.	Master Ctn.
		A	B	C	D	E		
SLL-50	1/2"	1-5/16"	3-15/16"	2"	4-3/8"	1-5/16"	10	100
SLL-75	3/4"	1-17/32"	4-5/8"	2-1/4"	5-1/8"	1-19/32"	10	50
SLL-100	1"	1-25/32"	5-11/32"	2-23/32"	6"	1-29/32"	5	25
SLL-125	1-1/4"	2-1/2"	7-1/4"	3-13/32"	7-11/16"	2-1/2"	2	10
SLL-150	1-1/2"	2-1/2"	7-1/4"	3-13/32"	7-11/16"	2-11/16"	2	10
SLL-200	2"	3-1/8"	9-1/2"	4-3/16"	10"	3-3/8"	1	5

# Conduit Bodies

## EMT CONDUIT BODIES

### SET-SCREW TYPE

#### “C” SERIES

##### Features:

- Copper-Free Aluminum Alloy
- Plated Steel Set-Screws



Cat. No.	Trade Size	DIMENSIONS - C SERIES					Std. Pkg.	Master Ctn.
		A	B	C	D	E		
SSC-50	1/2"	1-5/16"	3-15/16"	1-5/16"	4-3/4"	1-3/32"	10	100
SSC-75	3/4"	1-17/32"	4-5/8"	1-19/32"	5-5/8"	1-5/16"	10	50
SSC-100	1"	1-25/32"	5-11/32"	1-29/32"	6-21/32"	1-1/2"	5	25
SSC-125	1-1/4"	2-1/2"	7-1/4"	2-1/2"	8-3/32"	2"	2	10
SSC-150	1-1/2"	2-1/2"	7-1/4"	2-11/16"	8-3/32"	2-1/4"	2	10
SSC-200	2"	3-1/8"	9-1/2"	3-3/8"	10-17/32"	2-3/4"	1	5

## EMT CONDUIT BODIES

### SET-SCREW TYPE

#### “T” SERIES

##### Features:

- Copper-Free Aluminum Alloy
- Plated Steel Set-Screws



Cat. No.	Trade Size	DIMENSIONS - T SERIES					Std. Pkg.	Master Ctn.
		A	B	C	D	E		
SST-50	1/2"	1-5/16"	3-15/16"	1-5/16"	4-3/4"	2"	10	100
SST-75	3/4"	1-17/32"	4-5/8"	1-19/32"	5-5/8"	2-1/4"	10	50
SST-100	1"	1-25/32"	5-11/32"	1-29/32"	6-21/32"	2-23/32"	5	25
SST-125	1-1/4"	2-1/2"	7-1/4"	2-7/16"	8-3/32"	3-13/32"	2	10
SST-150	1-1/2"	2-1/2"	7-1/4"	2-11/16"	8-3/32"	3-13/32"	2	10
SST-200	2"	3-1/8"	9-1/2"	3-3/8"	10-17/32"	4-3/16"	1	5

## ALUMINUM

### CONDUIT COVERS

##### Features:

- Stamped Aluminum



Cat. No.	Trade Size	DIMENSIONS			Std. Pkg.
		L	W	H	
AC-50	1/2"	3-15/16"	1-3/8"	1/4"	100
AC-75	3/4"	4-11/16"	1-1/2"	5/16"	50
AC-100	1"	5-3/8"	1-3/4"	3/8"	50
AC-125/150	1-1/4" to 1-1/2"	7-1/4"	2-1/2"	7/16"	25
AC-200	2"	9-1/2"	3-1/8"	1/2"	10
AC-250/300	2-1/2" to 3"	12-1/4"	4-7/16"	3/4"	10
AC-350/400	3-1/2" to 4"	15"	5-1/2"	3/4"	5

# Straps

## 1-HOLE RG6U CABLE STRAPS

### Features

- Stamped Steel
- Electroplated Zinc



Cat. No.	Trade Size	Std. Pkg.	Master Ctn.
<b>S1-25</b>	1/4"	100	1000

## 1-HOLE MC(BX) CABLE STRAPS

### Features

- Stamped Steel
- Electroplated Zinc
- Corrosion-Resistant



Cat. No.	Trade Size	Std. Pkg.	Master Ctn.
<b>S1-38</b>	3/8"	100	1000

## 1-HOLE EMT STRAPS

### Features:

- Stamped Steel
- Electroplated Zinc

### Note:

- Sizes 2-1/2" to 4" can be used for RIGID and IMC Conduits



SE1-50L



SE1-50 to SE1-200



SU1-250 to SU1-400

Cat. No.	Description	Trade Size	Std. Pkg.	Master Ctn.
<b>SE1-50L</b>	16GA, Standard Duty	1/2"	100	1000
<b>SE1-50</b>	14GA, Heavy-Duty	1/2"	100	1000
<b>SE1-75</b>	14GA, Heavy-Duty	3/4"	100	1000
<b>SE1-100</b>	14GA, Heavy-Duty	1"	100	500
<b>SE1-125</b>	12GA, Heavy-Duty	1-1/4"	100	500
<b>SE1-150</b>	12GA, Heavy-Duty	1-1/2"	50	500
<b>SE1-200</b>	12GA, Heavy-Duty	2"	50	500
<b>SU1-250</b>	9GA, Heavy-Duty	2-1/2"	25	100
<b>SU1-300</b>	9GA, Heavy-Duty	3"	25	100
<b>SU1-350</b>	7GA, Heavy-Duty	3-1/2"	25	100
<b>SU1-400</b>	7GA, Heavy-Duty	4"	25	100

# Straps

## 2-HOLE EMT STRAPS

### Features

- Stamped Steel
- Electroplated Zinc

### Note:

- Sizes 2-1/2" to 4" can be used for RIGID and IMC Conduits



Cat. No.	Description	Trade Size	Std. Pkg.	Master Ctn.
SE2-50	18GA, Heavy-Duty	1/2"	100	1000
SE2-75	18GA, Heavy-Duty	3/4"	100	1000
SE2-100	16GA, Heavy-Duty	1"	100	500
SE2-125	16GA, Heavy-Duty	1-1/4"	100	500
SE2-150	16GA, Heavy-Duty	1-1/2"	50	500
SE2-200	14GA, Heavy-Duty	2"	50	500
SU2-250	13GA, Heavy-Duty	2-1/2"	25	100
SU2-300	13GA, Heavy-Duty	3"	25	100
SU2-350	10GA, Heavy-Duty	3-1/2"	25	100
SU2-400	10GA, Heavy-Duty	4"	25	100

## 1-HOLE RIGID STRAPS

### Features:

- Stamped Steel
- Electroplated Zinc

### Note:

- Sizes 2-1/2" to 4" can be used for EMT and IMC Conduits



Cat. No.	Description	Trade Size	Std. Pkg.	Master Ctn.
SR1-50	14GA, Heavy-Duty	1/2"	100	1000
SR1-75	12GA, Heavy-Duty	3/4"	100	1000
SR1-100	12GA, Heavy-Duty	1"	100	500
SR1-125	12GA, Heavy-Duty	1-1/4"	100	500
SR1-150	10GA, Heavy-Duty	1-1/2"	50	500
SR1-200	10GA, Heavy-Duty	2"	50	500
SU1-250	9GA, Heavy-Duty	2-1/2"	25	100
SU1-300	9GA, Heavy-Duty	3"	25	100
SU1-350	7GA, Heavy-Duty	3-1/2"	25	100
SU1-400	7GA, Heavy-Duty	4"	25	100



# Straps

## 2-HOLE RIGID STRAPS

### Features

- Stamped Steel
- Electroplated Zinc

### Note:

- Sizes 2-1/2" to 4" can be used for EMT and IMC Conduits



Cat. No.	Description	Trade Size	Std. Pkg.	Master Ctn.
SR2-50	20GA, Heavy-Duty	1/2"	100	1000
SR2-75	20GA, Heavy-Duty	3/4"	100	1000
SR2-100	20GA, Heavy-Duty	1"	100	500
SR2-125	19GA, Heavy-Duty	1-1/4"	100	500
SR2-150	16GA, Heavy-Duty	1-1/2"	50	500
SR2-200	16GA, Heavy-Duty	2"	50	500
SU2-250	13GA, Heavy-Duty	2-1/2"	25	100
SU2-300	13GA, Heavy-Duty	3"	25	100
SU2-350	10GA, Heavy-Duty	3-1/2"	25	100
SU2-400	10GA, Heavy-Duty	4"	25	100

## NAIL STRAPS

### Features:

- Stamped Steel
- Electroplated Zinc
- Varies according to sizes



Cat. No.	EMT Size	FLEX/RIGID Size	Std. Pkg.	Master Ctn.
NS-50	1/2"	N/A	100	1000
NS-50/75	3/4"	1/2"	100	1000
NS-100	1"	3/4"	100	1000

## 1-HOLE MALLEABLE IRON RIGID STRAPS

### Features:

- Malleable Iron



Cat. No.	Trade Size	Std. Pkg.	Master Ctn.
SRM1-50	1/2"	100	1000
SRM1-75	3/4"	50	500
SRM1-100	1"	25	250
SRM1-125	1-1/4"	20	200
SRM1-150	1-1/2"	10	100
SRM1-200	2"	10	100
SRM1-250	2-1/2"	-	25
SRM1-300	3"	-	25
SRM1-350	3-1/2"	-	10
SRM1-400	4"	-	10

## MALLEABLE IRON CLAMP BACK SPACERS

### Features

- Malleable Iron



Cat. No.	Trade Size	Std. Pkg.	Master Ctn.
CBS-50	1/2"	25	250
CBS-75	3/4"	25	250
CBS-100	1"	25	250
CBS-125	1-1/4"	10	100
CBS-150	1-1/2"	10	100
CBS-200	2"	5	50
CBS-250	2-1/2"	-	25
CBS-300	3"	-	10
CBS-350	3-1/2"	-	10
CBS-400	4"	-	10

## UNIVERSAL STRUT CLAMPS

### Features:

- Steel
- Electroplated Zinc
- Listed for EMT, IMC and RIGID



Cat. No.	EMT/RIGID Size	Std. Pkg.
ST-50	1/2"	100
ST-75	3/4"	100
ST-100	1"	100
ST-125	1-1/4"	100
ST-150	1-1/2"	50
ST-200	2"	50
ST-250	2-1/2"	50
ST-300	3"	25
ST-350	3-1/2"	25
ST-400	4"	25



VISIT OUR WEBSITE  
TO SEE OUR COMPLETE LINE OF  
SWIVEL TYPE COVER PLATES

www.orbitelectric.com

# Straps

## STRUT CLAMP SADDLE TYPE

### Features:

- Steel
- Electro-Galvanized Zinc
- Single Screw-Tight Clamping Action



**NEW**

Cat. No.	Trade Size	EMT/RIGID Conduit Size	Std. Pkg.
STS-50	1/2"	5/16"-1/2"	100
STS-75	3/4"	3/4"	100
STS-100	1"	1"	100
STS-125	1-1/4"	1-1/4"	50
STS-150	1-1/2"	1-1/2"	50
STS-200	2"	2"	50
STS-250	2-1/2"	2-1/2"	25
STS-300	3"	3"	25
STS-350	3-1/2"	3-1/2"	25
STS-400	4"	4"	25

## STEEL 1-HOLE SERVICE ENTRANCE STRAPS

### Features:

- Stamped Steel
- Corrosion-Resistant



Cat. No.	Description	Std. Pkg.	Master Ctn.
SES1-50	3 - #8, #6, #4	100	500
SES1-75	3 - #3, #2	100	500
SES1-100	3 - #1, #1/0, #2/0	50	250
SES1-200	3 - #3/0, #4/0	25	250

## STEEL 2-HOLE SERVICE ENTRANCE STRAPS

### Features:

- Stamped Steel
- Corrosion-Resistant



Cat. No.	Description	Std. Pkg.	Master Ctn.
SES2-50	3 - #8, #6, #4	20	100
SES2-75	3 - #3, #2	20	100
SES2-100	3 - #1, #1/0, #2/0	20	100
SES2-200	3 - #3/0, #4/0	20	100

# Straps

## CONDUIT HANGERS

### WITH BOLT

#### Features:

- Steel
- Electroplated Zinc



Cat. No.	Trade Size	EMT Size	RIGID Size	Std. Pkg.	Master Ctn.
PH-50B	#0B	1/2"	3/8"&1/2"	50	500
PH-75B	#1B	3/4"	3/4"	50	500
PH-100B	#2B	1"	1"	25	250
PH-105B	#2-1/2B	1-1/4"	-	25	250
PH-125B	#3B	1-1/2"	1-1/4"	50	250
PH-150B	#4B	-	1-1/2"	50	250
PH-200B	#5B	2"	2"	20	100
PH-250B	#6B	2-1/2"	2-1/2"	10	50
PH-300B	#7B	3"	3"	10	50
PH-350B	#8B	3-1/2"	3-1/2"	10	50
PH-400B	#9B	4"	4"	5	25

**VISIT OUR WEBSITE  
TO SEE OUR COMPLETE  
LINE OF WIRING DEVICE**

[www.orbitelectric.com](http://www.orbitelectric.com)

**AND FOLLOW US**

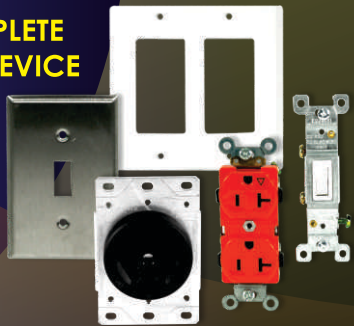

# Service Entrances

## SERVICE ENTRANCE CAPS CLAMP TYPE

### Features:

- Copper-Free Aluminum



Cat. No.	Trade Size	Std. Pkg.	Master Ctn.
EC-50	1/2"	15	90
EC-75	3/4"	10	60
EC-100	1"	7	42
EC-125	1-1/4"	5	30
EC-150	1-1/2"	4	24
EC-200	2"	4	8
EC-250	2-1/2"	1	3
EC-300	3"	1	3
EC-300L (Large Body)	3"	1	3
EC-350	3-1/2"	1	2
EC-400	4"	1	2

## PVC SERVICE ENTRANCE HEADS

### Features:

- Heavy-Duty PVC
- Snap-On Covers



Cat. No.	Trade Size	Std. Pkg.	Master Ctn.
ECP-50	1/2"	5	10
ECP-75	3/4"	2	10
ECP-100	1"	2	10
ECP-125	1-1/4"	-	5
ECP-150	1-1/2"	2	10
ECP-200	2"	2	10

## PVC SERVICE ENTRANCE CABLE CAPS

### Features:

- Heavy-Duty PVC
- Snap-On Covers



Cat. No.	Description	Std. Pkg.	Master Ctn.
ECCP-50	#8, #6, #4, #2	10	-
ECCP-100	#1/0, #2/0	10	-
ECCP-200	#3/0, #4/0	10	-

## PVC SILL PLATE

### Features:

- Heavy-Duty PVC



Cat. No.	Description	Std. Pkg.	Master Ctn.
SPP	3 - #4 thru #3/0	5	15

## WATERTIGHT HUBS

**Features:**

- Zinc Die Cast
- 105°C Rated Throat Insulator

**Note:**

- Insulated color may vary



Cat. No.	Trade Size	Std. Pkg.	Master Ctn.
WH-50	1/2"	25	125
WH-75	3/4"	25	125
WH-100	1"	25	125
WH-125	1-1/4"	10	50
WH-150	1-1/2"	10	50
WH-200	2"	10	50
WH-250	2-1/2"	5	25
WH-300	3"	2	10
WH-350	3-1/2"	2	10
WH-400	4"	2	10

## GROUNDING ZINC WATERTIGHT HUBS

**Features**

- Zinc Die Cast
- 105°C Rated Throat Insulator
- Grounding Post & Screw

**Note:**

- Insulated color may vary



Cat. No.	Trade Size	Std. Pkg.	Master Ctn.
WHG-50	1/2"	25	125
WHG-75	3/4"	25	125
WHG-100	1"	25	125
WHG-125	1-1/4"	10	50
WHG-150	1-1/2"	10	50
WHG-200	2"	10	50
WHG-250	2-1/2"	5	25
WHG-300	3"	2	10
WHG-350	3-1/2"	2	10
WHG-400	4"	2	10

## SNAP-IN KNOCKOUT SEALS

### Features:

- Stamped Steel
- Electroplated Zinc
- For capping unused knockout holes
- Held by spring tension



Cat. No.	Trade Size	Std. Pkg.	Master Ctn.
KO-50	1/2"	100	1000
KO-75	3/4"	100	1000
KO-100	1"	100	500
KO-125	1-1/4"	50	100
KO-150	1-1/2"	-	50
KO-200	2"	-	25

## 3-PIECE KNOCKOUT SEALS

### Features

- Stamped Steel
- Electroplated Zinc
- For capping unused knockout holes
- Embossed for quick self centering
- Installed using screw and back strap



Cat. No.	Trade Size	Std. Pkg.	Master Ctn.
KO3P-50	1/2"	100	500
KO3P-75	3/4"	50	500
KO3P-100	1"	25	500
KO3P-125	1-1/4"	25	250
KO3P-150	1-1/2"	10	300
KO3P-200	2"	10	300
KO3P-250	2-1/2"	10	100
KO3P-300	3"	10	100
KO3P-350	3-1/2"	10	100
KO3P-400	4"	10	100



**VISIT OUR WEBSITE  
TO SEE OUR COMPLETE  
LINE OF  
MASONRY BOXES**  
[www.orbitelectric.com](http://www.orbitelectric.com)

# Cord Grips

## STRAIN RELIEF CORD-GRIP CONNECTORS

### Features:

- Zinc Die Cast
- Watertight



Cat. No.	Trade Size	Clamping Range	Std. Pkg.	Master Ctn.
CG-50-190/260	1/2"	0.190" - 0.260"	25	100
CG-50-260/375	1/2"	0.260" - 0.375"	25	100
CG-50-375/500	1/2"	0.375" - 0.500"	25	100
CG-75-375/500	3/4"	0.375" - 0.500"	10	50
CG-75-500/625	3/4"	0.500" - 0.625"	10	50
CG-75-625/750	3/4"	0.625" - 0.750"	10	50
CG-100-375/500	1"	0.375" - 0.500"	10	50
CG-100-500/625	1"	0.500" - 0.625"	10	50
CG-100-625/750	1"	0.625" - 0.750"	10	50
CG-100-750/880	1"	0.750" - 0.880"	10	50
CG-100-880/985	1"	0.880" - 0.985"	10	50

## NYLON STRAIN RELIEF CORD-GRIP CONNECTORS

### Features

- Nylon
- Watertight

### Note:

- Lock Nut not included for 3/8"



Cat. No.	Trade Size	Clamping Range	Std. Pkg.	Master Ctn.
NGC-38-197/394	3/8"	0.197" - 0.394"	25	100
NGC-50-384/551	1/2"	0.394" - 0.551"	25	100
NGC-75-551/709	3/4"	0.551" - 0.709"	10	50
NGC100-709/984	1"	0.709" - 0.984"	10	50

## PLASTIC LOCKNUTS

### Features

- Nylon
- Full-Cut Internal Threads
- Meets Federal Spec. A-A-50553



Cat. No.	Trade Size	Std. Pkg.	Master Ctn.
PLN-38	3/8"	50	-

## BOX TO BOX CONNECTORS

### Features:

- Zinc Die Cast
- Meets Federal Spec. A-A-50553



Cat. No.	Trade Size	Std. Pkg.	Master Ctn.
OF781	1/2"	100	500



# Conduit Nipples

## INSULATED BOX TO BOX CONNECTORS

### Features

- Zinc Die Cast
- With Insulated Throat
- Meets Federal Spec. A-A-50553

### Note:

- Insulated color may vary

**NEW**



Cat. No.	Trade Size	Std. Pkg.	Master Ctn.
OF781-S	1/2"	100	500

## 3/4" OFFSET NIPPLES

### Features:

- Zinc Die Cast
- Meets Federal Spec. A-A-50553



Cat. No.	Trade Size	Std. Pkg.	Master Ctn.
ON-50	1/2"	25	250
ON-75	3/4"	20	200
ON-100	1"	10	100
ON-125	1-1/4"	5	50
ON-150	1-1/2"	5	50
ON-200	2"	3	30

## 1" LONG CONDUIT CHASE NIPPLES

### Features:

- Zinc Die Cast
- Meets Federal Spec. A-A-50553



Cat. No.	Trade Size	Std. Pkg.	Master Ctn.
CN-50L	1/2"	100	1000
CN-75L	3/4"	50	500
CN-100L	1"	25	250

## CONDUIT CHASE NIPPLES

### Features:

- Zinc Die Cast
- Meets Federal Spec. A-A-50553



Cat. No.	Trade Size	Std. Pkg.	Master Ctn.
CN-50	1/2"	100	1000
CN-75	3/4"	100	1000
CN-100	1"	50	500
CN-125	1-1/4"	25	250
CN-150	1-1/2"	25	250
CN-200	2"	15	90

# Conduit Nipples

## INSULATED CONDUIT CHASE NIPPLES

### Features

- Zinc Die Cast
- Meets Federal Spec. A-A-50553
- With Insulated Throat

### Note:

- Insulated color may vary



Cat. No.	Trade Size	Std. Pkg.	Master Ctn.
CNI-50	1/2"	100	1000
CNI-75	3/4"	100	1000
CNI-100	1"	50	500
CNI-125	1-1/4"	25	250
CNI-150	1-1/2"	25	250
CNI-200	2"	15	90
CNI-250	2-1/2"	2	10
CNI-300	3"	2	10
CNI-350	3-1/2"	-	5
CNI-400	4"	-	5

## RIGID CONDUIT NIPPLES

### Features:

- Galvanized Steel
- Meet UL 6 and ANSI C80.1
- NPT Thread



Cat. No.	Trade Size	Length	Std. Pkg.
RN-50-C	1/2"	1-1/8"	25
RN-50-150	1/2"	1-1/2"	25
RN-50-200	1/2"	2"	25
RN-50-250 <b>NEW</b>	1/2"	2-1/2"	25
RN-50-300	1/2"	3"	25
RN-50-350 <b>NEW</b>	1/2"	3-1/2"	25
RN-50-400	1/2"	4"	25
RN-50-500 <b>NEW</b>	1/2"	5"	25
RN-50-600	1/2"	6"	25
RN-50-800	1/2"	8"	25
RN-50-1000	1/2"	10"	25
RN-50-1200	1/2"	12"	25
RN-75-C	3/4"	1-3/8"	25
RN-75-150	3/4"	1-1/2"	25
RN-75-200	3/4"	2"	25
RN-75-250 <b>NEW</b>	3/4"	2-1/2"	25
RN-75-300	3/4"	3"	25
RN-75-350 <b>NEW</b>	3/4"	3-1/2"	25
RN-75-400	3/4"	4"	25

# Conduit Nipples

Cat. No.		Trade Size	Length	Std. Pkg.
RN-75-500	NEW	3/4"	5"	25
RN-75-600		3/4"	6"	25
RN-75-800		3/4"	8"	25
RN-75-1000		3/4"	10"	25
RN-75-1200		3/4"	12"	25
RN-100-C		1"	1-1/2"	25
RN-100-200		1"	2"	25
RN-100-250	NEW	1"	2-1/2"	25
RN-100-300		1"	3"	25
RN-100-350	NEW	1"	3-1/2"	25
RN-100-400		1"	4"	25
RN-100-500	NEW	1"	5"	25
RN-100-600		1"	6"	25
RN-100-800		1"	8"	25
RN-100-1000		1"	10"	25
RN-100-1200		1"	12"	25
RN-125-C		1-1/4"	1-5/8"	25
RN-125-200		1-1/4"	2"	25
RN-125-250	NEW	1-1/4"	2-1/2"	25
RN-125-300		1-1/4"	3"	25
RN-125-350	NEW	1-1/4"	3-1/2"	25
RN-125-400		1-1/4"	4"	25
RN-125-500	NEW	1-1/4"	5"	25
RN-125-600		1-1/4"	6"	25
RN-125-800		1-1/4"	8"	25
RN-125-1000		1-1/4"	10"	25
RN-125-1200		1-1/4"	12"	25
RN-150-C		1-1/2"	1-3/4"	25
RN-150-200		1-1/2"	2"	25
RN-150-250	NEW	1-1/2"	2-1/2"	25
RN-150-300		1-1/2"	3"	25
RN-150-350	NEW	1-1/2"	3-1/2"	25
RN-150-400		1-1/2"	4"	25
RN-150-500	NEW	1-1/2"	5"	25
RN-150-600		1-1/2"	6"	25
RN-150-800		1-1/2"	8"	25
RN-150-1000		1-1/2"	10"	25
RN-150-1200		1-1/2"	12"	25
RN-200-C		2"	2"	25
RN-200-250		2"	2-1/2"	25
RN-200-300		2"	3"	25
RN-200-350	NEW	2"	3-1/2"	25
RN-200-400		2"	4"	25
RN-200-500	NEW	2"	5"	25
RN-200-600		2"	6"	25
RN-200-800		2"	8"	25
RN-200-1000		2"	10"	25

# Conduit Nipples

Cat. No.	Trade Size	Length	Std. Pkg.
RN-200-1200	2"	12"	25
RN-250-C	2-1/2"	2-1/2"	30
RN-250-300	2-1/2"	3"	25
RN-250-350	2-1/2"	3-1/2"	15
RN-250-400	2-1/2"	4"	15
RN-250-500	2-1/2"	5"	15
RN-250-600	2-1/2"	6"	10
RN-250-800	2-1/2"	8"	5
RN-250-1000	2-1/2"	10"	5
RN-250-1200	2-1/2"	12"	5
RN-300-C	3"	2-5/8"	9
RN-300-300	3"	3"	9
RN-300-350	3"	3-1/2"	9
RN-300-400	3"	4"	9
RN-300-500	3"	5"	9
RN-300-600	3"	6"	9
RN-300-800	3"	8"	9
RN-300-1000	3"	10"	9
RN-300-1200	3"	12"	9
RN-350-C	3-1/2"	2-3/4"	9
RN-350-400	3-1/2"	4"	9
RN-350-500	3-1/2"	5"	9
RN-350-600	3-1/2"	6"	9
RN-350-800	3-1/2"	8"	9
RN-350-1000	3-1/2"	10"	9
RN-350-1200	3-1/2"	12"	9
RN-400-C	4"	2-7/8"	9
RN-400-400	4"	4"	9
RN-400-500	4"	5"	9
RN-400-600	4"	6"	9
RN-400-800	4"	8"	4
RN-400-1000	4"	10"	4
RN-400-1200	4"	12"	4
RN-500-C	5"	3"	4
RN-500-500	5"	5"	4
RN-500-600	5"	6"	4
RN-500-800	5"	8"	4
RN-500-1000	5"	10"	4
RN-500-1200	5"	12"	4
RN-600-C	6"	3-1/8"	4
RN-600-500	6"	5"	4
RN-600-600	6"	6"	4
RN-600-800	6"	8"	4
RN-600-1000	6"	10"	4
RN-600-1200	6"	12"	4

**NOW UP TO 6"!**



# Conduit Elbows

## 22.5° ANGLE EMT CONDUIT ELBOWS

### Features

- Galvanized Steel
- Meet UL797 and ANSI C80.3

**NEW**

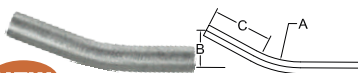

Cat. No.	Trade Size	DIMENSIONS			Std. Pkg.
		Min. UL Radius (A)	Offset (B)	Straight Length (C)	
EEL22-50	1/2"	4"	1-5/16"	2-5/8"	50
EEL22-75	3/4"	4-1/2"	1-7/16"	2-3/4"	50
EEL22-100	1"	5-3/4"	1-9/16"	2-7/8"	25
EEL22-125	1-1/4"	7-1/4"	1-3/4"	3-1/16"	20
EEL22-150	1-1/2"	8-1/4"	2"	3-1/2"	15
EEL22-200	2"	9-1/2"	2-5/16"	4-1/8"	10
EEL22-250	2-1/2"	10-1/2"	2-3/4"	5-1/16"	BULK
EEL22-300	3"	13"	3-1/4"	5-15/16"	BULK
EEL22-350	3-1/2"	15"	3-11/16"	6-11/16"	BULK
EEL22-400	4"	16"	3-15/16"	7"	BULK

## 45° ANGLE EMT CONDUIT ELBOWS

### Features

- Galvanized Steel
- Meet UL797 and ANSI C80.3

**NEW**

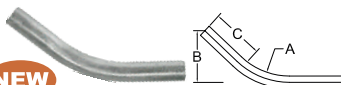

Cat. No.	Trade Size	DIMENSIONS			Std. Pkg.
		Min. UL Radius (A)	Offset (B)	Straight Length (C)	
EEL45-50	1/2"	4"	3-1/16"	2-11/16"	50
EEL45-75	3/4"	4-1/2"	3-1/4"	2-3/4"	50
EEL45-100	1"	5-3/4"	3-13/16"	3"	25
EEL45-125	1-1/4"	7-1/4"	4-7/16"	3-1/4"	20
EEL45-150	1-1/2"	8-1/4"	4-15/16"	3-1/2"	15
EEL45-200	2"	9-1/2"	5-13/16"	4-5/16"	10
EEL45-250	2-1/2"	10-1/2"	6-11/16"	5-1/8"	BULK
EEL45-300	3"	13"	8-1/8"	6-1/8"	BULK
EEL45-350	3-1/2"	15"	9-3/16"	6-3/4"	BULK
EEL45-400	4"	16"	9-3/4"	7-1/16"	BULK

## 90° ANGLE EMT CONDUIT ELBOWS

### Features

- Galvanized Steel
- Meet UL797 and ANSI C80.3

**NEW**

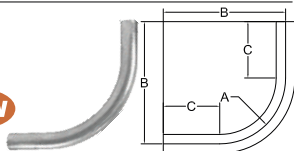

Cat. No.	Trade Size	DIMENSIONS			Std. Pkg.
		Min. UL Radius (A)	Offset (B)	Straight Length (C)	
EEL90-50	1/2"	4"	6-7/8"	2-7/8"	50
EEL90-75	3/4"	4-1/2"	7-7/16"	2-15/16"	50
EEL90-100	1"	5-3/4"	8-3/4"	3"	25
EEL90-125	1-1/4"	7-1/4"	10-9/16"	3-5/16"	20
EEL90-150	1-1/2"	8-1/4"	11-15/16"	3-5/8"	15
EEL90-200	2"	9-1/2"	13-3/4"	4-1/4"	10
EEL90-250	2-1/2"	10-1/2"	15-3/4"	5-1/4"	BULK
EEL90-300	3"	13"	19-1/8"	6-1/8"	BULK
EEL90-350	3-1/2"	15"	21-3/4"	6-3/4"	BULK
EEL90-400	4"	16"	23-1/8"	7-1/8"	BULK

**NOW UP TO 4"!**

# Conduit Elbows

## 22.5° ANGLE RIGID CONDUIT ELBOWS

### Features

- Galvanized Steel
- Meet UL 6 and ANSI C80.1
- NPT Thread

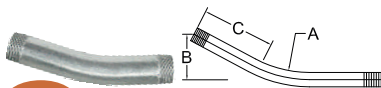

**NEW**

Cat. No.	Trade Size	DIMENSIONS			Std. Pkg.
		Min. UL Radius (A)	Offset (B)	Straight Length (C)	
REL22-50	1/2"	4"	1-5/16"	2-5/8"	50
REL22-75	3/4"	4-1/2"	1-7/16"	2-3/4"	50
REL22-100	1"	5-3/4"	1-9/16"	2-7/8"	25
REL22-125	1-1/4"	7-1/4"	1-3/4"	3-1/16"	20
REL22-150	1-1/2"	8-1/4"	2"	3-1/2"	15
REL22-200	2"	9-1/2"	2-5/16"	4-1/8"	10
REL22-250	2-1/2"	10-1/2"	2-3/4"	5-1/16"	BULK
REL22-300	3"	13"	3-1/4"	5-15/16"	BULK
REL22-350	3-1/2"	15"	3-11/16"	6-11/16"	BULK
REL22-400	4"	16"	3-15/16"	7"	BULK

## 45° ANGLE RIGID CONDUIT ELBOWS

### Features

- Galvanized Steel
- Meet UL 6 and ANSI C80.1
- NPT Thread

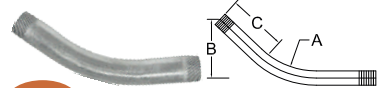

**NEW**

Cat. No.	Trade Size	DIMENSIONS			Std. Pkg.
		Min. UL Radius (A)	Offset (B)	Straight Length (C)	
REL45-50	1/2"	4"	3-1/16"	2-11/16"	50
REL45-75	3/4"	4-1/2"	3-1/4"	2-3/4"	50
REL45-100	1"	5-3/4"	3-13/16"	3"	25
REL45-125	1-1/4"	7-1/4"	4-7/16"	3-1/4"	20
REL45-150	1-1/2"	8-1/4"	4-15/16"	3-1/2"	15
REL45-200	2"	9-1/2"	5-13/16"	4-5/16"	10
REL45-250	2-1/2"	10-1/2"	6-11/16"	5-1/8"	BULK
REL45-300	3"	13"	8-1/8"	6-1/8"	BULK
REL45-350	3-1/2"	15"	9-3/16"	6-3/4"	BULK
REL45-400	4"	16"	9-3/4"	7-1/16"	BULK

## 90° ANGLE RIGID CONDUIT ELBOWS

### Features

- Galvanized Steel
- Meet UL 6 and ANSI C80.1
- NPT Thread

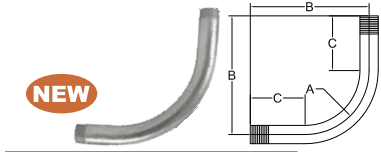

**NEW**

Cat. No.	Trade Size	DIMENSIONS			Std. Pkg.
		Min. UL Radius (A)	Offset (B)	Straight Length (C)	
REL90-50	1/2"	4"	6-7/8"	2-7/8"	50
REL90-75	3/4"	4-1/2"	7-7/16"	2-15/16"	50
REL90-100	1"	5-3/4"	8-3/4"	3"	25
REL90-125	1-1/4"	7-1/4"	10-9/16"	3-5/16"	20
REL90-150	1-1/2"	8-1/4"	11-15/16"	3-5/8"	15
REL90-200	2"	9-1/2"	13-3/4"	4-1/4"	10
REL90-250	2-1/2"	10-1/2"	15-3/4"	5-1/4"	BULK
REL90-300	3"	13"	19-1/8"	6-1/8"	BULK
REL90-350	3-1/2"	15"	21-3/4"	6-3/4"	BULK
REL90-400	4"	16"	23-1/8"	7-1/8"	BULK

**NOW UP TO 4"!**

# Bushings

## RIGID THREADED COUPLINGS

### Features:

- Cast Steel
- Electroplated Zinc

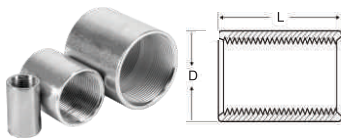

Cat. No.	Trade Size	DIMENSIONS		Std. Pkg.
		D	L	
RC-50	1/2"	1.012"	1.626"	100
RC-75	3/4"	1.252"	1.642"	50
RC-100	1"	1.524"	1.969"	30
RC-125	1-1/4"	1.87"	2.031"	20
RC-150	1-1/2"	2.154"	2.063"	20
RC-200	2"	2.65"	2.126"	20
RC-250 <b>NEW</b>	2-1/2"	3.252"	3.189"	24
RC-300 <b>NEW</b>	3"	3.87"	3.307"	16
RC-350 <b>NEW</b>	3-1/2"	4.5"	3.406"	12
RC-400 <b>NEW</b>	4"	4.874"	3.516"	10

**NOW UP TO 4"!**

## REDUCING BUSHINGS

### Features:

- Machined Steel
- Electroplated Zinc
- Meets Federal Spec. A-A-50553



Cat. No.	Trade Size	Std. Pkg.	Master Ctn.
RB-50/38	1/2" to 3/8"	100	500
RB-75/50	3/4" to 1/2"	100	500
RB-100/50	1" to 1/2"	50	250
RB-100/75	1" to 3/4"	50	250
RB-125/50	1-1/4" to 1/2"	20	100
RB-125/75	1-1/4" to 3/4"	20	100
RB-125/100	1-1/4" to 1"	20	100
RB-150/50	1-1/2" to 1/2"	10	50
RB-150/75	1-1/2" to 3/4"	10	50
RB-150/100	1-1/2" to 1"	10	50
RB-150/125	1-1/2" to 1-1/4"	10	50
RB-200/50	2" to 1/2"	10	50
RB-200/75	2" to 3/4"	10	50
RB-200/100	2" to 1"	10	50
RB-200/125	2" to 1-1/4"	10	50
RB-200/150	2" to 1-1/2"	10	50
RB-300/200	3" to 2"	10	50
RB-300/250	3" to 2-1/2"	10	50

# Bushings

## CONDUIT BUSHINGS

### Features:

- Zinc Die Cast
- Full Machine-Cut Internal Threads
- Meets Federal Spec. A-A-50553



Cat. No.	Trade Size	Std. Pkg.	Master Ctn.
<b>CB-50</b>	1/2"	100	1000
<b>CB-75</b>	3/4"	50	500
<b>CB-100</b>	1"	50	500

## INSULATED CONDUIT BUSHINGS

### Features

- Zinc Die Cast
- Full Machine-Cut Internal Threads
- Meets Federal Spec. A-A-50553
- With Insulated Throat



### Note:

- Insulated color may vary

Cat. No.	Trade Size	Std. Pkg.	Master Ctn.
<b>CBI-50</b>	1/2"	100	1000
<b>CBI-75</b>	3/4"	50	500
<b>CBI-100</b>	1"	50	500

## PLASTIC BUSHINGS

### Features

- PVC
- 105°C Rated
- Meets Federal Spec. A-A-50553



### Note:

- Insulated color may vary

Cat. No.	Trade Size	Std. Pkg.	Master Ctn.
<b>PB-50</b>	1/2"	100	1000
<b>PB-75</b>	3/4"	100	1000
<b>PB-100</b>	1"	50	500
<b>PB-125</b>	1-1/4"	25	250
<b>PB-150</b>	1-1/2"	25	250
<b>PB-200</b>	2"	10	100
<b>PB-250</b>	2-1/2"	10	100
<b>PB-300</b>	3"	-	20
<b>PB-350</b>	3-1/2"	-	20
<b>PB-400</b>	4"	-	10
<b>PB-500</b>	5"	-	10
<b>PB-600</b>	6"	-	10



# Lock Nuts

## CONDUIT LOCKNUTS

### Features:

- Zinc Die Cast
- Full-Cut Internal Threads
- Meets Federal Spec. A-A-50553



Cat. No.	Trade Size	Std. Pkg.	Master Ctn.
LN-50	1/2"	100	1000
LN-75	3/4"	100	1000
LN-100	1"	100	1000
LN-125	1-1/4"	50	500
LN-150	1-1/2"	50	500
LN-200	2"	25	250
LN-250	2-1/2"	10	100
LN-300	3"	5	50
LN-350	3-1/2"	5	50
LN-400	4"	-	25

## STEEL CONDUIT LOCKNUTS

### Features

- Steel
- Electroplated Zinc
- Full-Cut Internal Threads
- Meets Federal Spec. A-A-50553



Cat. No.	Trade Size	Std. Pkg.	Master Ctn.
SLN-50	1/2"	100	1000
SLN-75	3/4"	100	1000
SLN-100	1"	100	1000
SLN-125	1-1/4"	50	500
SLN-150	1-1/2"	50	500
SLN-200	2"	25	250
SLN-250	2-1/2"	10	100
SLN-300	3"	5	50
SLN-350	3-1/2"	5	50
SLN-400	4"	-	25
SLN-500	5"	-	10
SLN-600	6"	-	10

## STEEL SEALING LOCKNUTS

### Features

- Steel
- Electroplated Zinc
- Bonded with Molten Sealing Material
- Meets Federal Spec. A-A-50553



Cat. No.	Trade Size	Std. Pkg.	Master Ctn.
SSLN-50	1/2"	100	1000
SSLN-75	3/4"	100	1000
SSLN-100	1"	100	1000
SSLN-125	1-1/4"	50	500
SSLN-150	1-1/2"	50	500
SSLN-200	2"	25	250
SSLN-250	2-1/2"	10	100
SSLN-300	3"	5	50
SSLN-350	3-1/2"	5	50
SSLN-400	4"	-	25
SSLN-500	5"	-	10
SSLN-600	6"	-	10

# Reducing Washers

## STEEL REDUCING WASHERS

### Features:

- Galvanized Stamped Steel

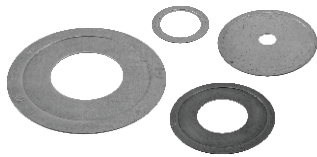

Cat. No.	Trade Size	Std. Pkg.	Master Ctn.
RW-75/50	3/4" to 1/2"	250	1000
RW-100/50	1" to 1/2"	250	1000
RW-100/75	1" to 3/4"	250	1000
RW-125/50	1-1/4" to 1/2"	100	400
RW-125/75	1-1/4" to 3/4"	100	400
RW-125/100	1-1/4" to 1"	100	400
RW-150/50	1-1/2" to 1/2"	-	100
RW-150/75	1-1/2" to 3/4"	-	100
RW-150/100	1-1/2" to 1"	-	100
RW-150/125	1-1/2" to 1-1/4"	-	100
RW-200/50	2" to 1/2"	-	50
RW-200/75	2" to 3/4"	-	50
RW-200/100	2" to 1"	-	50
RW-200/125	2" to 1-1/4"	-	50
RW-200/150	2" to 1-1/2"	-	50
RW-250/50	2-1/2" to 1/2"	25	100
RW-250/75	2-1/2" to 3/4"	25	100
RW-250/100	2-1/2" to 1"	25	100
RW-250/125	2-1/2" to 1-1/4"	25	100
RW-250/150	2-1/2" to 1-1/2"	25	100
RW-250/200	2-1/2" to 2"	25	100
RW-300/50	3" to 1/2"	-	25
RW-300/75	3" to 3/4"	-	25
RW-300/100	3" to 1"	-	25
RW-300/125	3" to 1-1/4"	-	25
RW-300/150	3" to 1-1/2"	-	25
RW-300/200	3" to 2"	-	25
RW-300/250	3" to 2-1/2"	-	25
RW-350/50	3-1/2" to 1/2"	-	10
RW-350/75	3-1/2" to 3/4"	-	10
RW-350/100	3-1/2" to 1"	-	10
RW-350/125	3-1/2" to 1-1/4"	-	10
RW-350/150	3-1/2" to 1-1/2"	-	10
RW-350/200	3-1/2" to 2"	-	10
RW-350/250	3-1/2" to 2-1/2"	-	10
RW-350/300	3-1/2" to 3"	-	10
RW-400/50	4" to 1/2"	-	10
RW-400/75	4" to 3/4"	-	10
RW-400/100	4" to 1"	-	10
RW-400/125	4" to 1-1/4"	-	10
RW-400/150	4" to 1-1/2"	-	10
RW-400/200	4" to 2"	-	10
RW-400/250	4" to 2-1/2"	-	10
RW-400/300	4" to 3"	-	10
RW-400/350	4" to 3-1/2"	-	10

# Bar Hangers

## FIXED BAR HANGERS

### Features:

- Steel
- Electroplated Zinc
- For Stud and T-Bar

Cat. No.	Description	Master Ctn.
BHT-1	24" T-Bar bracket for use with boxes 1-1/2" or 2-1/8" Deep	50
BHT-1A	24" T-Bar bracket - 8" height adjustable	50
BH-1	24" Straight bar hanger for mounting ceiling boxes, Slotted, Includes 2 Stove Bolt / Unit	50
BH-1C	24" Straight bar hanger for mounting ceiling boxes, with BH-C Box Clip	50
BH-1S	20" Straight bar hanger for mounting ceiling boxes, Slotted, Includes 2 Stove Bolt / Unit	50
BH-1SC	20" Straight bar hanger for mounting ceiling boxes, With Box Clip BH-C	50
BH-2	21" Offset (1-1/2") bar hanger for mounting boxes with ring, Includes 2 Stove Bolt / Unit	50
BH-2NC	21" Offset (1-1/2") bar hanger for mounting boxes with ring, Slotted	50
BH-C	Additional box clip & screw set for use with BH-1, BH-1S & BH-2NC	100
BH-3	Straight bracket for architectural recess lights 25-1/4" long with notches 24" apart for use on T-Bar	50
BHT-C	Additional box clip & set screw for use with BHT-1 & BHT-1A	100

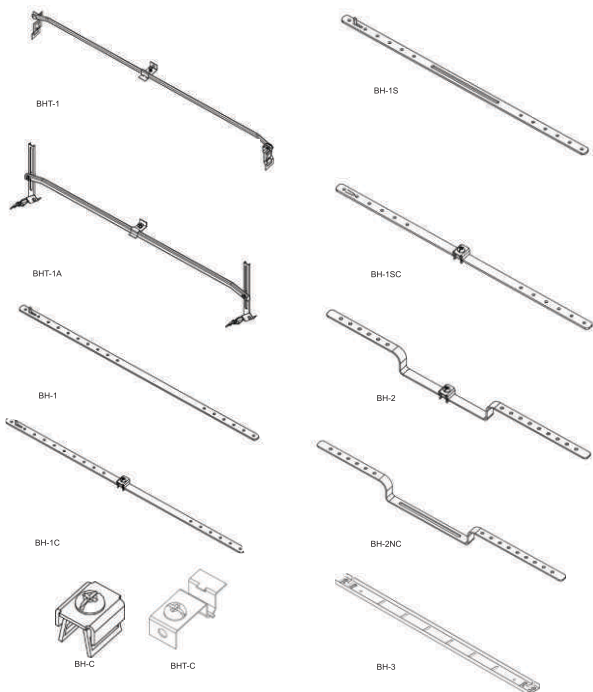

# Bar Hangers

## ADJUSTABLE BAR HANGERS

### Features:

- Steel
- Electroplated Zinc
- For Stud and T-Bar

Cat. No.	Description	Master Ctn.
<b>BHA-1</b>	Adjustable bar hanger with stud for joist spacing 16" to 24" with #3/8-18 NPS Threaded Stud	50
<b>BHA-1C</b>	Adjustable bar hanger with stud for joist spacing 16" to 24" with Box Clip	50
<b>BHA-16</b>	11" to 18" Adjustable box bracket - Mount Box with self-tapping screws on notches Ends bend and wrap around stud - Can be used with boxes 1-1/2" or 2-1/8" Deep	50
<b>BHA-24</b>	17" to 26" Adjustable box bracket - Mount Box with self-tapping screws on notches Ends bend and wrap around stud - Can be used with boxes 1-1/2" or 2-1/8" Deep	50
<b>ABS</b>	Far-Side Box Support for 1-1/2" & 2-1/8" Deep Boxes, For use with 4" Metal Studs	50
<b>ABS-6</b>	Far-Side Box Support for 1-1/2" & 2-1/8" Deep Boxes, For use with 6" Metal Studs	50
<b>OWG</b>	Clips and locks old-work steel boxes tightly to wall. 2 required per box.	100

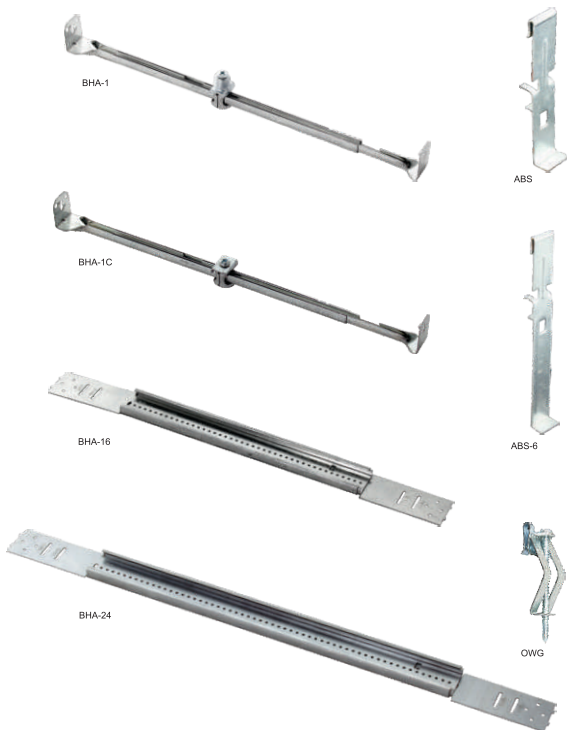

# Miscellaneous

## NAIL SAFETY PLATES

### Features:

- Provides protection from nail and screw penetration

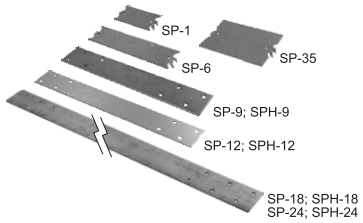

Cat. No.	Description	W"x L"	Std. Pkg.
<b>SP-1</b>	16GA Safety Plate with prongs	1.5" x 2.75"	100
<b>SP-1-500</b>	16GA Safety Plate with prongs	1.5" x 2.75"	500
<b>SP-35</b>	16GA Safety Plate with prongs	3" x 5"	50
<b>SP-6</b>	16GA Safety Plate with prongs	1.5" x 6"	100
<b>SP-9</b>	16GA Safety Plate with Nail Holes	1.5" x 9"	50
<b>SP-12</b>	16GA Safety Plate with Nail Holes	1.5" x 12"	50
<b>SP-18</b>	16GA Safety Plate with Nail Holes	1.5" x 18"	50
<b>SP-24</b>	16GA Safety Plate with Nail Holes	1.5" x 24"	50
<b>SPH-9</b>	12GA Safety Plate with Nail Holes	1.5" x 9"	50
<b>SPH-12</b>	12GA Safety Plate with Nail Holes	1.5" x 12"	50
<b>SPH-18</b>	12GA Safety Plate with Nail Holes	1.5" x 18"	50
<b>SPH-24</b>	12GA Safety Plate with Nail Holes	1.5" x 24"	50

## SWITCH BOX SUPPORT

### Features:

- Bendable Tabs



Cat. No.	Description	Std. Pkg.
<b>SBS</b>	20GA	100

## Orbit's Complete Product Line

The Universal Source for Electrical Products



**STEEL PRODUCTS**



**NEMA ENCLOSURES**



**WEATHERPROOF PRODUCTS**



**ELECTRICAL FITTINGS**



**WIRING DEVICES**



**EXIT SIGNS & EMERGENCY LIGHTS**



EXPLORE ONLINE FOR MORE ABOUT ORBIT INDUSTRIES



**LANDSCAPE LIGHTING**



**LED LIGHTING**



**CABLES & WIRES**



**H.I.D. LIGHTING**



**VENTILATION FANS**





# Miscellaneous

## ROOF JACKS

### Features:

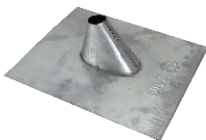
- 24GA Galvanized Steel
- Uninsulated
- For service entrance conduit or ventilation pipe
- Fits flat to 40°



Cat. No.	Trade Size	Std. Pkg.
RJ-50	1/2"	24
RJ-75	3/4"	24
RJ-100	1"	24
RJ-125	1-1/4"	24
RJ-150	1-1/2"	24
RJ-200	2"	24
RJ-300	3"	12
RJ-400	4"	12

## SCREW KITS, PLASTIC ANCHOR KIT & EASY ANCHOR KIT

### Features:

- In Plastic Partition Kits



KIT-832RH



KIT-632FH



KIT-632RH

Machine Screw Kits  
Screw Count



KIT-10PAK



KIT-8EZ



KIT-1032TC

Size	Qty.
3/4"	100
1"	75
1-1/4"	75
1-1/2"	50
2"	40
3"	30
<b>Total</b>	<b>370</b>

Cat. No.	Description	Trade Size	Screw Count/Kit	Std. Pkg.
KIT-632FH	6-32 Flat Head, 3/4" to 3", Slot	#6-32	370	10
KIT-632RH	6-32 Round Head, 3/4" to 3", Slot/Phillips	#6-32	370	10
KIT-832RH	8-32 Round Head, 3/4" to 3", Slot/Phillips	#8-32	370	10
KIT-10PAK	#10 x 1" Screws & Plastic Anchors, with Masonry Drill Bit	#10 x 1"	110	10
KIT-8EZ	#8 x 1-1/2" Zinc Dry Wall Easy Anchor Kit	#8 x 1-1/2"	50	10
KIT-1032TC	#10 x 1-1/4" Tri-Combo Screw (Hex/Phillips/Slot) Self-Tapping Screw & #8-10 x 1-1/4" Anchors (One 1/4" Masonry drill bit)	#10-32 x 1-1/4"	100	10

# Miscellaneous

## STEEL BEAM CLAMPS

### Features:

- Single Screw
- 2 Threaded Holes



Cat. No.	Description	Std. Pkg.	Master Ctn.
BC-25	1/4"-20 Tap, 3/4" Jaw, 100 lb. Load	50	250
BC-38	3/8"-16 Tap, 7/8" Jaw, 200 lb. Load	25	100

## MALLEABLE IRON BEAM CLAMPS

### Features:

- Single Screw
- 2 Threaded Holes



Cat. No.	Description	Std. Pkg.	Master Ctn.
BCM-25	1/4"-20 Tap, 3/4" Jaw, 125 lb. Load	50	250
BCM-38	3/8"-16 Tap, 7/8" Jaw, 300 lb. Load	25	100
BCM-50	1/2"-13 Tap, 1" Jaw, 600 lb. Load	10	50

## JACK CHAIN

### Features:

- Steel
- Electroplated Zinc
- 25 lb. max. load
- In Steel Reel



Cat. No.	Description	Length
JC-12	12GA	100'

## "S" HOOK

### Features:

- Steel
- Electroplated Zinc
- 25 lb. max. load



Cat. No.	Trade Size	Std. Pkg.	Master Ctn.
SH-2	12GA, 1-1/4"	100	1000

# Miscellaneous

## SINGLE HOLE HANGER SCREWS

### Features:

- Steel
- Wood Screw Thread



Cat. No.	Description	Trade Size	Std. Pkg.	Master Ctn.
<b>H-SCREW</b>	Flat Hanger Screws	1/4" x 3"	100	500

## FIXTURE HANGERS

### Features:

- Steel



Cat. No.	For Use with	Mount Position	Std. Pkg.	Master Ctn.
<b>FH-E</b>	2, 3, or 4 Light Fixtures	End Mount	100	500
<b>FH-S</b>	2, 3, or 4 Light Fixtures	Side Mount	100	500

## PORCELAIN WIRE HOLDERS

### Features:

- Porcelain & Galvanized Steel
- Varies According to Sizes



Cat. No.	Description	Trade Size	Std. Pkg.	Master Ctn.
<b>PWH-L</b>	With 2-1/4" Lag Bolt	2-3/4"	5	20
<b>PWH-M</b>	With Steel Clip for 1-1/4" to 3" Mast	1-1/4" to 3"	5	20

## TIE WIRE

### Features:

- Black Annealed Steel
- 16-1/2GA



Cat. No.	Wire Size/Length	Std. Pkg.
<b>TW</b>	16GA, 400'	20



# Miscellaneous

## RIGID FLOOR FLANGES

**Features:**

- Malleable Iron



Cat. No.	Trade Size	Std. Pkg.
FR-50	1/2"	50
FR-75	3/4"	50
FR-100	1"	50
FR-125	1-1/4"	25
FR-150	1-1/2"	25
FR-200	2"	25

## CONCRETE SLAB INSERT 90° ANGLE

**Features:**

- Malleable Iron

**NEW**



Cat. No.	Trade Size	Std. Pkg.	Master Ctn.
MCSI90-50	1/2"	10	100
MCSI90-75	3/4"	10	100
MCSI90-100	1"	10	50

## CONCRETE SLAB INSERT STRAIGHT

**Features:**

- Malleable Iron

**NEW**



Cat. No.	Trade Size	Std. Pkg.	Master Ctn.
MCSI-50	1/2"	10	100
MCSI-75	3/4"	10	100
MCSI-100	1"	10	50

## Orbit's Complete Product Line

The Universal Source for Electrical Products



EXPLORE ONLINE FOR MORE ABOUT ORBIT INDUSTRIES



# Introducing Innovative Prefabrication Solutions

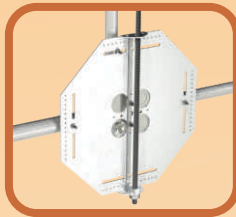

## Box and Conduit Hanger Support (BCCHS)

Orbit's BCCHS is a labor saving solution that reduces the amount of rods needed to install a hanging junction box. In addition, our support bracket requires no cutting, and can be easily preinstalled. Save time and money by choosing one of the three BCCHS plates Orbit has to offer.

### BCCHS-6

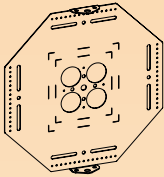

**Patent Pending**  
BCCHS-6 fits boxes up to **6x6** boxes and has bent tabs for **vertical mounting**.

### BCCHS-6S

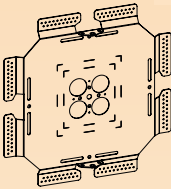

**Patent Pending**  
BCCHS-6S features flanges that enable the use of one-hold straps and fits up to **6x6** boxes. In addition, it has bent tabs for **vertical mounting**.

### BCCHS-12

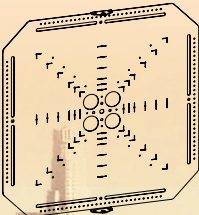

**Patent Pending**  
BCCHS-12 enables support of larger sizes up to **12x12** boxes and has bent tabs for **vertical mounting**.

## 4SDB-MKO-AR1G



**Patented**  
Orbit's Adjustable Back Support Boxes use several **labor saving accessories** for secure and easy installations.

## 5SDB-MC2-MS

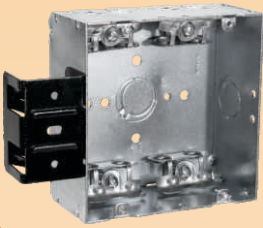

**Patented**  
Orbit's MC series boxes use "BX/MC" clamps to accommodate Metal Clad cables sizes #14-2 to #10-4.

## USB-4SDB-50/75-PT

**Patented**  
With universal applications, Orbit's Ultimate Support Brackets can be used for **stud mounting** or **kick plate applications**.



## EALB

**Patented**  
Unlike traditional boxes, Orbit's Easy Access Lighting Box requires only one person for **installation of hanging fixtures** for **half the labor costs**.



# Product Index

Cat.#	Page
ABS	68
ABS-6	68
AC-100	46
AC-125/150	46
AC-200	46
AC-250/300	46
AC-350/400	46
AC-50	46
AC-75	46
AGS-100	31
AGS-50	31
AGS-75	31
ASB-38	18
ASB-50	18
ASB-516	18
ASB-716	18
ASB-75	18
BC-25	71
BC-38	71
BCM-25	71
BCM-38	71
BCM-50	71
BH-1	67
BH-1C	67
BH-1S	67
BH-1SC	67
BH-2	67
BH-2NC	67
BH-3	67
BHA-1	68
BHA-16	68
BHA-1C	68
BHA-24	68
BH-C	67
BHT-1	67
BHT-1A	67
BHT-C	67
C-100	40
C-100A	38
C-125	40
C-125A	38
C-150	40
C-150A	38
C-200	40
C-200A	38

Cat.#	Page
C-250	40
C-300	40
C-400	40
C-50	40
C-50A	38
C-75	40
C-75A	38
CB-100	64
CB-50	64
CB-75	64
CBI-100	64
CBI-50	64
CBI-75	64
CBS-100	50
CBS-125	50
CBS-150	50
CBS-200	50
CBS-250	50
CBS-300	50
CBS-350	50
CBS-400	50
CBS-50	50
CBS-75	50
CG-100	41
CG-100-375/500	56
CG-100-500/625	56
CG-100-625/750	56
CG-100-750/880	56
CG-100-880/985	56
CG-125/150	41
CG-200	41
CG-250/300	41
CG-350/400	41
CG-50	41
CG-50-190/260	56
CG-50-260/375	56
CG-50-375/500	56
CG-75	41
CG-75-375/500	56
CG-75-500/625	56
CG-75-625/750	56
CN-100	57
CN-100L	57
CN-125	57
CN-150	57

Cat.#	Page
CN-200	57
CN-50	57
CN-50L	57
CN-75	57
CN-75L	57
CNI-100	58
CNI-125	58
CNI-150	58
CNI-200	58
CNI-250	58
CNI-300	58
CNI-350	58
CNI-400	58
CNI-50	58
CNI-75	58
EC-100	53
EC-125	53
EC-150	53
EC-200	53
EC-250	53
EC-300	53
EC-300L	53
EC-350	53
EC-400	53
EC-50	53
EC-75	53
ECCP-100	53
ECCP-200	53
ECCP-50	53
ECP-100	53
ECP-125	53
ECP-150	53
ECP-200	53
ECP-50	53
ECP-75	53
ECS-50	10
ECS-75	10
EEL22-100	61
EEL22-125	61
EEL22-150	61
EEL22-200	61
EEL22-250	61
EEL22-300	61
EEL22-350	61
EEL22-400	61

# Product Index

Cat.#	Page	Cat.#	Page	Cat.#	Page
EEL22-50	61	GBLL-125	27	H-100	31
EEL22-75	61	GBLL-150	27	H-50	31
EEL45-100	61	GBLL-200	27	H-75	31
EEL45-125	61	GBLL-250	27	H-SCREW	72
EEL45-150	61	GBLL-300	27	JC-12	71
EEL45-200	61	GBLL-350	27	KIT-1032TC	70
EEL45-250	61	GBLL-400	27	KIT-10PAK	70
EEL45-300	61	GBLL-50	27	KIT-632FH	70
EEL45-350	61	GBLL-500	27	KIT-632RH	70
EEL45-400	61	GBLL-600	27	KIT-832RH	70
EEL45-50	61	GBLL-75	27	KIT-8EZ	70
EEL45-75	61	GCA-125/200	28	KO-100	55
EEL90-100	61	GCA-250/400	28	KO-125	55
EEL90-125	61	GCA-450/600	28	KO-150	55
EEL90-150	61	GCA-50/100	28	KO-200	55
EEL90-200	61	GCAB-50/100	30	KO3P-100	55
EEL90-250	61	GCAH-125/200	30	KO3P-125	55
EEL90-300	61	GCAH-50/100	30	KO3P-150	55
EEL90-350	61	GCB-125/200	28	KO3P-200	55
EEL90-400	61	GCB-250/400	28	KO3P-250	55
EEL90-50	61	GCB-450/600	28	KO3P-300	55
EEL90-75	61	GCB-50/100	28	KO3P-350	55
FB-100	11	GCBB-125/200	30	KO3P-400	55
FB-50	11	GCBB-50/100	30	KO3P-50	55
FB-75	11	GCBR-50/100	28	KO3P-75	55
FH-E	72	GCBZ-50/100	28	KO-50	55
FH-S	72	GCH-50/100-100	31	KO-75	55
FLC-50	17	GCH-50/100-50	31	LB-100	39
FLC-50L	17	GCH-50/100-75	31	LB-100A	37
FLC-75L	17	GCR-50/100	31	LB-125	39
FLD-50	18	GCRL-38/100	30	LB-125A	37
FR-100	73	GCRLDB-38/100	30	LB-150	39
FR-125	73	GL-100	29	LB-150A	37
FR-150	73	GL-125	29	LB-200	39
FR-200	73	GL-150	29	LB-200A	37
FR-50	73	GL-200	29	LB-250	39
FR-75	73	GL-250	29	LB-300	39
G-100	41	GL-300	29	LB-350	39
G-125/150	41	GL-350	29	LB-400	39
G-200	41	GL-400	29	LB-50	39
G-250/300	41	GL-50	29	LB-50A	37
G-350/400	41	GL-75	29	LB-75	39
G-50	41	GRC-50	32	LB-75A	37
G-75	41	GRC-58	32	LBM-150	44
GBLL-100	27	GRC-75	32	LBM-200	44

# Product Index

Cat.#	Page	Cat.#	Page	Cat.#	Page
LL-100	39	LT-150	19	MC-200	43
LL-100A	37	LT-200	19	MC-250	43
LL-125	39	LT-250	19	MC-300	43
LL-125A	37	LT-300	19	MC-350	43
LL-150	39	LT-350	19	MC-400	43
LL-150A	37	LT-38	19	MC-50	43
LL-200	39	LT-400	19	MC-75	43
LL-200A	37	LT-50	19	MC-CL-100	16
LL-250	39	LT-75	19	MC-CL-125	16
LL-300	39	LT90-100	20	MC-CL-150	16
LL-400	39	LT90-125	20	MC-CL-200	16
LL-50	39	LT90-150	20	MC-CL-250	16
LL-50A	37	LT90-200	20	MC-CL-300	16
LL-75	39	LT90-250	20	MC-CL-350	16
LL-75A	37	LT90-300	20	MC-DX-50	17
LLDB-14/4	29	LT90-350	20	MCSI-100	73
LLTDB-14/4	29	LT90-38	20	MCSI-50	73
LLTDB-SP-14/4	29	LT90-400	20	MCSI-75	73
LN-100	65	LT90-50	20	MCSI90-100	73
LN-125	65	LT90-75	20	MCSI90-50	73
LN-150	65	LTI-100	20	MCSI90-75	73
LN-200	65	LTI-125	20	MGBLL-100	27
LN-250	65	LTI-150	20	MGBLL-125	27
LN-300	65	LTI-200	20	MGBLL-150	27
LN-350	65	LTI-250	20	MGBLL-200	27
LN-400	65	LTI-300	20	MGBLL-250	27
LN-50	65	LTI-350	20	MGBLL-300	27
LN-75	65	LTI-38	20	MGBLL-350	27
LR-100	40	LTI-400	20	MGBLL-400	27
LR-100A	37	LTI-50	20	MGBLL-50	27
LR-125	40	LTI-75	20	MGBLL-75	27
LR-125A	37	LTi90-100	21	MLB-100	42
LR-150	40	LTi90-125	21	MLB-125	42
LR-150A	37	LTi90-150	21	MLB-150	42
LR-200	40	LTi90-200	21	MLB-200	42
LR-200A	37	LTi90-250	21	MLB-250	42
LR-250	40	LTi90-300	21	MLB-300	42
LR-300	40	LTi90-350	21	MLB-400	42
LR-400	40	LTi90-38	21	MLB-50	42
LR-50	40	LTi90-400	21	MLB-75	42
LR-50A	37	LTi90-50	21	MLDB-14/10	29
LR-75	40	LTi90-75	21	MLDB-14/4	29
LR-75A	37	MC-100	43	MLDB-14/6	29
LT-100	19	MC-125	43	MLDB-6/100	29
LT-125	19	MC-150	43	MLL-100	42

# Product Index

Cat.#	Page	Cat.#	Page	Cat.#	Page
MLL-125	42	MLT90-250	23	MT-300	44
MLL-150	42	MLT90-300	23	MT-350	44
MLL-200	42	MLT90-350	23	MT-400	44
MLL-250	42	MLT90-38	23	MT-50	44
MLL-300	42	MLT90-400	23	MT-75	44
MLL-350	42	MLT90-50	23	NGC100-709/984	56
MLL-400	42	MLT90-75	23	NGC-38-197/394	56
MLL-50	42	MLTI-100	22	NGC-50-384/551	56
MLL-75	42	MLTI-125	22	NGC-75-551/709	56
MLR-100	43	MLTI-150	22	NM-50	15
MLR-125	43	MLTI-200	22	NMLT-100	19
MLR-150	43	MLTI-250	22	NMLT-125	19
MLR-200	43	MLTI-300	22	NMLT-150	19
MLR-250	43	MLTI-350	22	NMLT-200	19
MLR-300	43	MLTI-38	22	NMLT-38	19
MLR-350	43	MLTI-400	22	NMLT-50	19
MLR-400	43	MLTI45-100	23	NMLT-75	19
MLR-50	43	MLTI45-125	23	NMLT90-100	19
MLR-75	43	MLTI45-150	23	NMLT90-125	19
MLT-100	21	MLTI45-200	23	NMLT90-150	19
MLT-125	21	MLTI45-250	23	NMLT90-200	19
MLT-150	21	MLTI45-300	23	NMLT90-38	19
MLT-200	21	MLTI45-350	23	NMLT90-50	19
MLT-250	21	MLTI45-38	23	NMLT90-75	19
MLT-300	21	MLTI45-400	23	NMP-50	15
MLT-350	21	MLTI45-50	23	NS-100	49
MLT-38	21	MLTI45-75	23	NS-50	49
MLT-400	21	MLTI-50	22	NS-50/75	49
MLT45-100	22	MLTI-75	22	OCC-50	10
MLT45-125	22	MLTI90-100	24	OCC-75	10
MLT45-150	22	MLTI90-125	24	OCS-50	10
MLT45-200	22	MLTI90-150	24	OCS-75	10
MLT45-250	22	MLTI90-200	24	OF1611	13
MLT45-300	22	MLTI90-250	24	OF1612	13
MLT45-350	22	MLTI90-300	24	OF1613	13
MLT45-38	22	MLTI90-350	24	OF1701	10
MLT45-400	22	MLTI90-38	24	OF1702	10
MLT45-50	22	MLTI90-400	24	OF520	14
MLT45-75	22	MLTI90-50	24	OF521	14
MLT-50	21	MLTI90-75	24	OF522	14
MLT-75	21	MT-100	44	OF523	14
MLT90-100	23	MT-125	44	OF530	14
MLT90-125	23	MT-150	44	OF531	14
MLT90-150	23	MT-200	44	OF532	14
MLT90-200	23	MT-250	44	OF533	14

# Product Index

Cat.#	Page	Cat.#	Page	Cat.#	Page
OF601	7	OF613-W	9	OF677	11
OF601-S	8	OF614	9	OF678	11
OF601-SW	8	OF614-W	9	OF679	11
OF601-W	7	OF615	9	OF681	11
OF602	7	OF615-W	9	OF681-S	11
OF602-S	8	OF616	9	OF682	11
OF602-SW	8	OF616-W	9	OF682-S	11
OF602-W	7	OF617	9	OF685	11
OF603	7	OF617-W	9	OF686	11
OF603-S	8	OF618	9	OF694	26
OF603-SW	8	OF618-W	9	OF695	26
OF603-W	7	OF619	9	OF697	26
OF604	7	OF619-W	9	OF701	5
OF604-S	8	OF620	9	OF701-S	6
OF604-SW	8	OF620-W	9	OF702	5
OF604-W	7	OF623	17	OF702-S	6
OF605	7	OF6231	16	OF703	5
OF605-S	8	OF6232	16	OF703-S	6
OF605-SW	8	OF643	13	OF704	5
OF605-W	7	OF644	13	OF704-S	6
OF606	7	OF645	13	OF705	5
OF606-S	8	OF6463	13	OF705-S	6
OF606-SW	8	OF6464	13	OF706	5
OF606-W	7	OF6465	13	OF706-S	6
OF607	7	OF6466	13	OF707	5
OF607-S	8	OF6467	13	OF707-S	6
OF607-SW	8	OF6468	13	OF708	5
OF607-W	7	OF6469	13	OF708-S	6
OF608	7	OF6470	13	OF709	5
OF608-S	8	OF653	16	OF709-S	6
OF608-SW	8	OF654	12	OF710	5
OF608-W	7	OF655	12	OF710-S	6
OF609	7	OF657	14	OF711	6
OF609-S	8	OF6620	16	OF712	6
OF609-SW	8	OF671	11	OF713	6
OF609-W	7	OF671-S	11	OF714	6
OF610	7	OF672	11	OF715	6
OF610-S	8	OF672-S	11	OF716	6
OF610-SW	8	OF673	11	OF717	6
OF610-W	7	OF673-S	11	OF718	6
OF611	9	OF674	11	OF719	6
OF611-W	9	OF674-S	11	OF720	6
OF612	9	OF675	11	OF730	12
OF612-W	9	OF675-S	11	OF730-S	12
OF613	9	OF676	11	OF731	12



# Product Index

Cat.#	Page	Cat.#	Page	Cat.#	Page
OF731-S	12	OF7607-SW	3	OF7706-S	1
OF732	12	OF7607-W	3	OF7707	1
OF732-S	12	OF7608	2	OF7707-S	1
OF733	12	OF7608-S	4	OF7708	1
OF733-S	12	OF7608-SW	3	OF7708-S	1
OF734	12	OF7608-W	3	OF7709	1
OF734-S	12	OF7609	2	OF7709-S	1
OF735	12	OF7609-S	4	OF7710	1
OF735-S	12	OF7609-SW	3	OF7710-S	1
OF736	12	OF7609-W	3	OF7711	2
OF736-S	12	OF7610	2	OF7712	2
OF737	12	OF7610-S	4	OF7713	2
OF737-S	12	OF7610-SW	3	OF7714	2
OF738	12	OF7610-W	3	OF7715	2
OF738-S	12	OF7611	4	OF7716	2
OF739	12	OF7611-W	5	OF7717	2
OF739-S	12	OF7612	4	OF7718	2
OF740	12	OF7612-W	5	OF7719	2
OF740-S	12	OF7613	4	OF7720	2
OF7601	2	OF7613-W	5	OF781	56
OF7601-S	4	OF7614	4	OF781-S	57
OF7601-SW	3	OF7614-W	5	OF9673	15
OF7601-W	3	OF7615	4	OF9674	15
OF7602	2	OF7615-W	5	ON-100	57
OF7602-S	4	OF7616	4	ON-125	57
OF7602-SW	3	OF7616-W	5	ON-150	57
OF7602-W	3	OF7617	4	ON-200	57
OF7603	2	OF7617-W	5	ON-50	57
OF7603-S	4	OF7618	4	ON-75	57
OF7603-SW	3	OF7618-W	5	OWG	68
OF7603-W	3	OF7619	4	PB-100	64
OF7604	2	OF7619-W	5	PB-125	64
OF7604-S	4	OF7620	4	PB-150	64
OF7604-SW	3	OF7620-W	5	PB-200	64
OF7604-W	3	OF7701	1	PB-250	64
OF7605	2	OF7701-S	1	PB-300	64
OF7605-S	4	OF7702	1	PB-350	64
OF7605-SW	3	OF7702-S	1	PB-400	64
OF7605-W	3	OF7703	1	PB-50	64
OF7606	2	OF7703-S	1	PB-500	64
OF7606-S	4	OF7704	1	PB-600	64
OF7606-SW	3	OF7704-S	1	PB-75	64
OF7606-W	3	OF7705	1	PE-100	33
OF7607	2	OF7705-S	1	PE-125	33
OF7607-S	4	OF7706	1	PE-50	33

# Product Index

Cat.#	Page
PE-75	33
PEB-100	33
PEB-125	33
PEB-50	33
PEB-75	33
PH-100B	52
PH-105B	52
PH-125B	52
PH-150B	52
PH-200B	52
PH-250B	52
PH-300B	52
PH-350B	52
PH-400B	52
PH-50B	52
PH-75B	52
PLN-38	56
PWH-L	72
PWH-M	72
RB-100/50	63
RB-100/75	63
RB-125/100	63
RB-125/50	63
RB-125/75	63
RB-150/100	63
RB-150/125	63
RB-150/50	63
RB-150/75	63
RB-200/100	63
RB-200/125	63
RB-200/150	63
RB-200/50	63
RB-200/75	63
RB-300/200	63
RB-300/250	63
RB-50/38	63
RB-75/50	63
RC-100	63
RC-125	63
RC-150	63
RC-200	63
RC-250	63
RC-300	63
RC-350	63
RC-400	63

Cat.#	Page
RC-50	63
RC-75	63
REL22-100	62
REL22-125	62
REL22-150	62
REL22-200	62
REL22-250	62
REL22-300	62
REL22-350	62
REL22-400	62
REL22-50	62
REL22-75	62
REL45-100	62
REL45-125	62
REL45-150	62
REL45-200	62
REL45-250	62
REL45-300	62
REL45-350	62
REL45-400	62
REL45-50	62
REL45-75	62
REL90-100	62
REL90-125	62
REL90-150	62
REL90-200	62
REL90-250	62
REL90-300	62
REL90-350	62
REL90-400	62
REL90-50	62
REL90-75	62
RJ-100	70
RJ-125	70
RJ-150	70
RJ-200	70
RJ-300	70
RJ-400	70
RJ-50	70
RJ-75	70
RN-100-1000	59
RN-100-1200	59
RN-100-200	59
RN-100-250	59
RN-100-300	59

Cat.#	Page
RN-100-350	59
RN-100-400	59
RN-100-500	59
RN-100-600	59
RN-100-800	59
RN-100-C	59
RN-125-1000	59
RN-125-1200	59
RN-125-200	59
RN-125-250	59
RN-125-300	59
RN-125-350	59
RN-125-400	59
RN-125-500	59
RN-125-600	59
RN-125-800	59
RN-125-C	59
RN-150-1000	59
RN-150-1200	59
RN-150-200	59
RN-150-250	59
RN-150-300	59
RN-150-350	59
RN-150-400	59
RN-150-500	59
RN-150-600	59
RN-150-800	59
RN-150-C	59
RN-200-1000	59
RN-200-1200	60
RN-200-250	59
RN-200-300	59
RN-200-350	59
RN-200-400	59
RN-200-500	59
RN-200-600	59
RN-200-800	59
RN-200-C	59
RN-250-1000	60
RN-250-1200	60
RN-250-300	60
RN-250-350	60
RN-250-400	60
RN-250-500	60
RN-250-600	60

# Product Index

Cat.#	Page	Cat.#	Page	Cat.#	Page
RN-250-800	60	RN-600-500	60	RW-150/100	66
RN-250-C	60	RN-600-600	60	RW-150/125	66
RN-300-1000	60	RN-600-800	60	RW-150/50	66
RN-300-1200	60	RN-600-C	60	RW-150/75	66
RN-300-300	60	RN-75-1000	59	RW-200/100	66
RN-300-350	60	RN-75-1200	59	RW-200/125	66
RN-300-400	60	RN-75-150	58	RW-200/150	66
RN-300-500	60	RN-75-200	58	RW-200/50	66
RN-300-600	60	RN-75-250	58	RW-200/75	66
RN-300-800	60	RN-75-300	58	RW-250/100	66
RN-300-C	60	RN-75-350	58	RW-250/125	66
RN-350-1000	60	RN-75-400	58	RW-250/150	66
RN-350-1200	60	RN-75-500	59	RW-250/200	66
RN-350-400	60	RN-75-600	59	RW-250/50	66
RN-350-500	60	RN-75-800	59	RW-250/75	66
RN-350-600	60	RN-75-C	58	RW-300/100	66
RN-350-800	60	RS-100	25	RW-300/125	66
RN-350-C	60	RS-125	25	RW-300/150	66
RN-400-1000	60	RS-150	25	RW-300/200	66
RN-400-1200	60	RS-200	25	RW-300/250	66
RN-400-400	60	RS-50	25	RW-300/50	66
RN-400-500	60	RS-75	25	RW-300/75	66
RN-400-600	60	RSC-100	25	RW-350/100	66
RN-400-800	60	RSC-125	25	RW-350/125	66
RN-400-C	60	RSC-150	25	RW-350/150	66
RN-500-1000	60	RSC-200	25	RW-350/200	66
RN-500-1200	60	RSC-50	25	RW-350/250	66
RN-500-500	60	RSC-75	25	RW-350/300	66
RN-500-600	60	RT-100	25	RW-350/50	66
RN-500-800	60	RT-125	25	RW-350/75	66
RN-500-C	60	RT-150	25	RW-400/100	66
RN-50-1000	58	RT-200	25	RW-400/125	66
RN-50-1200	58	RT-50	25	RW-400/150	66
RN-50-150	58	RT-75	25	RW-400/200	66
RN-50-200	58	RTC-100	25	RW-400/250	66
RN-50-250	58	RTC-125	25	RW-400/300	66
RN-50-300	58	RTC-150	25	RW-400/350	66
RN-50-350	58	RTC-200	25	RW-400/50	66
RN-50-400	58	RTC-50	25	RW-400/75	66
RN-50-500	58	RTC-75	25	RW-75/50	66
RN-50-600	58	RW-100/50	66	RX-100	15
RN-50-800	58	RW-100/75	66	RX-125	15
RN-50-C	58	RW-125/100	66	RX-150	15
RN-600-1000	60	RW-125/50	66	RX-200	15
RN-600-1200	60	RW-125/75	66	RX-50	15

# Product Index

Cat.#	Page	Cat.#	Page	Cat.#	Page
RX-75	15	SLB-100	38	SRM1-125	49
S1-25	47	SLB-125	38	SRM1-150	49
S1-38	47	SLB-150	38	SRM1-200	49
SBCC-10	32	SLB-200	38	SRM1-250	49
SBCC-2	32	SLB-50	38	SRM1-300	49
SBCC-20	32	SLB-75	38	SRM1-350	49
SBCC-250	32	SLN-100	65	SRM1-400	49
SBCC-2S	32	SLN-125	65	SRM1-50	49
SBCC-30	32	SLN-150	65	SRM1-75	49
SBCC-350	32	SLN-200	65	SSC-100	46
SBCC-4	32	SLN-250	65	SSC-125	46
SBCC-500	32	SLN-300	65	SSC-150	46
SBCC-6	32	SLN-350	65	SSC-200	46
SBCC-750	32	SLN-400	65	SSC-50	46
SBCC-8	32	SLN-50	65	SSC-75	46
SBS	69	SLN-500	65	SSLB-100	45
SC-100	44	SLN-600	65	SSLB-125	45
SC-125/150	44	SLN-75	65	SSLB-150	45
SC-200	44	SP-1	69	SSLB-200	45
SC-250/300	44	SP-12	69	SSLB-250	45
SC-350/400	44	SP-1-500	69	SSLB-300	45
SC-50	44	SP-1-500P	69	SSLB-350	45
SC-75	44	SP-18	69	SSLB-400	45
SE1-100	47	SP-24	69	SSLB-50	45
SE1-125	47	SP-35	69	SSLB-75	45
SE1-150	47	SP-6	69	SSLL-100	45
SE1-200	47	SP-9	69	SSLL-125	45
SE1-50	47	SPH-12	69	SSLL-150	45
SE1-50L	47	SPH-18	69	SSLL-200	45
SE1-75	47	SPH-24	69	SSLL-50	45
SE2-100	48	SPH-9	69	SSLL-75	45
SE2-125	48	SPP	53	SSLN-100	65
SE2-150	48	SR1-100	48	SSLN-125	65
SE2-200	48	SR1-125	48	SSLN-150	65
SE2-50	48	SR1-150	48	SSLN-200	65
SE2-75	48	SR1-200	48	SSLN-250	65
SES1-100	51	SR1-50	48	SSLN-300	65
SES1-200	51	SR1-75	48	SSLN-350	65
SES1-50	51	SR2-100	49	SSLN-400	65
SES1-75	51	SR2-125	49	SSLN-50	65
SES2-100	51	SR2-150	49	SSLN-500	65
SES2-200	51	SR2-200	49	SSLN-600	65
SES2-50	51	SR2-50	49	SSLN-75	65
SES2-75	51	SR2-75	49	SSLR-100	45
SH-2	71	SRM1-100	49	SSLR-125	45

# Product Index

Cat.#	Page	Cat.#	Page	Cat.#	Page
SSLR-150	45	STS-75	51	WHG-100	54
SSLR-200	45	SU1-250	47	WHG-125	54
SSLR-50	45	SU1-300	47	WHG-150	54
SSLR-75	45	SU1-350	47	WHG-200	54
SSPE-100	34	SU1-400	47	WHG-250	54
SSPE-125	34	SU2-250	48	WHG-300	54
SSPE-50	34	SU2-300	48	WHG-350	54
SSPE-75	34	SU2-350	48	WHG-400	54
SSPEB-100	34	SU2-400	48	WHG-50	54
SSPEB-125	34	T-100	41	WHG-75	54
SSPEB-50	34	T-100A	38		
SSPEB-75	34	T-125	41		
SSPEB-G100	33	T-125A	38		
SSPEB-G125	33	T-150	41		
SSPEB-G50	33	T-150A	38		
SSPEB-G75	33	T-200	41		
SSPE-G100	34	T-200A	38		
SSPE-G125	34	T-250	41		
SSPE-G50	34	T-300	41		
SSPE-G75	34	T-400	41		
SST-100	46	T-50	41		
SST-125	46	T-50A	38		
SST-150	46	T-75	41		
SST-200	46	T-75A	38		
SST-50	46	TPB-100	26		
SST-75	46	TPB-125	26		
ST-100	50	TPB-150	26		
ST-125	50	TPB-200	26		
ST-150	50	TPB-250	26		
ST-200	50	TPB-300	26		
ST-250	50	TPB-350	26		
ST-300	50	TPB-400	26		
ST-350	50	TPB-50	26		
ST-400	50	TPB-75	26		
ST-50	50	TW	72		
ST-75	50	WH-100	54		
STS-100	51	WH-125	54		
STS-125	51	WH-150	54		
STS-150	51	WH-200	54		
STS-200	51	WH-250	54		
STS-250	51	WH-300	54		
STS-300	51	WH-350	54		
STS-350	51	WH-400	54		
STS-400	51	WH-50	54		
STS-50	51	WH-75	54		

# ORBIT PRODUCT LINES

The Universal Source for Electrical Products



STEEL PRODUCTS



NEMA ENCLOSURES



WEATHERPROOF PRODUCTS



ELECTRICAL FITTINGS

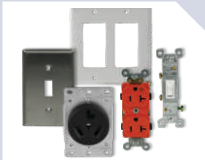

WIRING DEVICES



EXIT SIGNS & EMERGENCY LIGHTS



LANDSCAPE LIGHTING



LED LIGHTING



CABLES & WIRES



H.I.D. LIGHTING



VENTILATION FANS

**orbit**<sup>®</sup>  
Orbit Industries, Inc.

2100 S. Figueroa St., Los Angeles, CA 90007

Tel (213) 745-8884 Fax (213) 745-2015

Customer Service: 1-800-90-ORBIT

[www.orbitelectric.com](http://www.orbitelectric.com)

Copyright ©2013, Orbit Industries, Inc. All rights reserved.