



MP HUSKY™

WIRE MANAGEMENT BY **3E basor**



WIRE BASKET CABLE TRAYS



MP HUSKY
CABLE TRAY & CABLE BUS

CABLE TRAY SYSTEMS

Engineered to Support Powerful Reputations

MP Husky was founded in 1952 and originally began operations as Husky Products. Over the following 50+ years of leadership and service, MP Husky has gone through several transformations and mergers, including Husky/Burndy and Metal Products, thus leading to what is today MP Husky—***America's leading manufacturer of Cable Tray and Cable Bus Power Distribution Systems.***

Throughout these changes, one thing has remained constant—the “Husky” drive to be the most reliable, highest quality, cost effective and innovative manufacturer of Cable Support Systems and Cable Bus Power Distribution Systems. We have an unsurpassed commitment to customer satisfaction and service, and we are eager to earn your loyalty and trust. As we continue to build and strengthen our partnerships with our customers, we look forward to the next years of service and support.

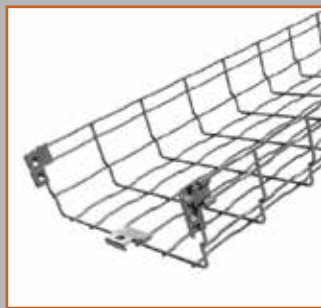

Aluminum Stainless Steel Galvannealed Fiberglass
Mill Galvanized Zinc Plate Hot Dipped

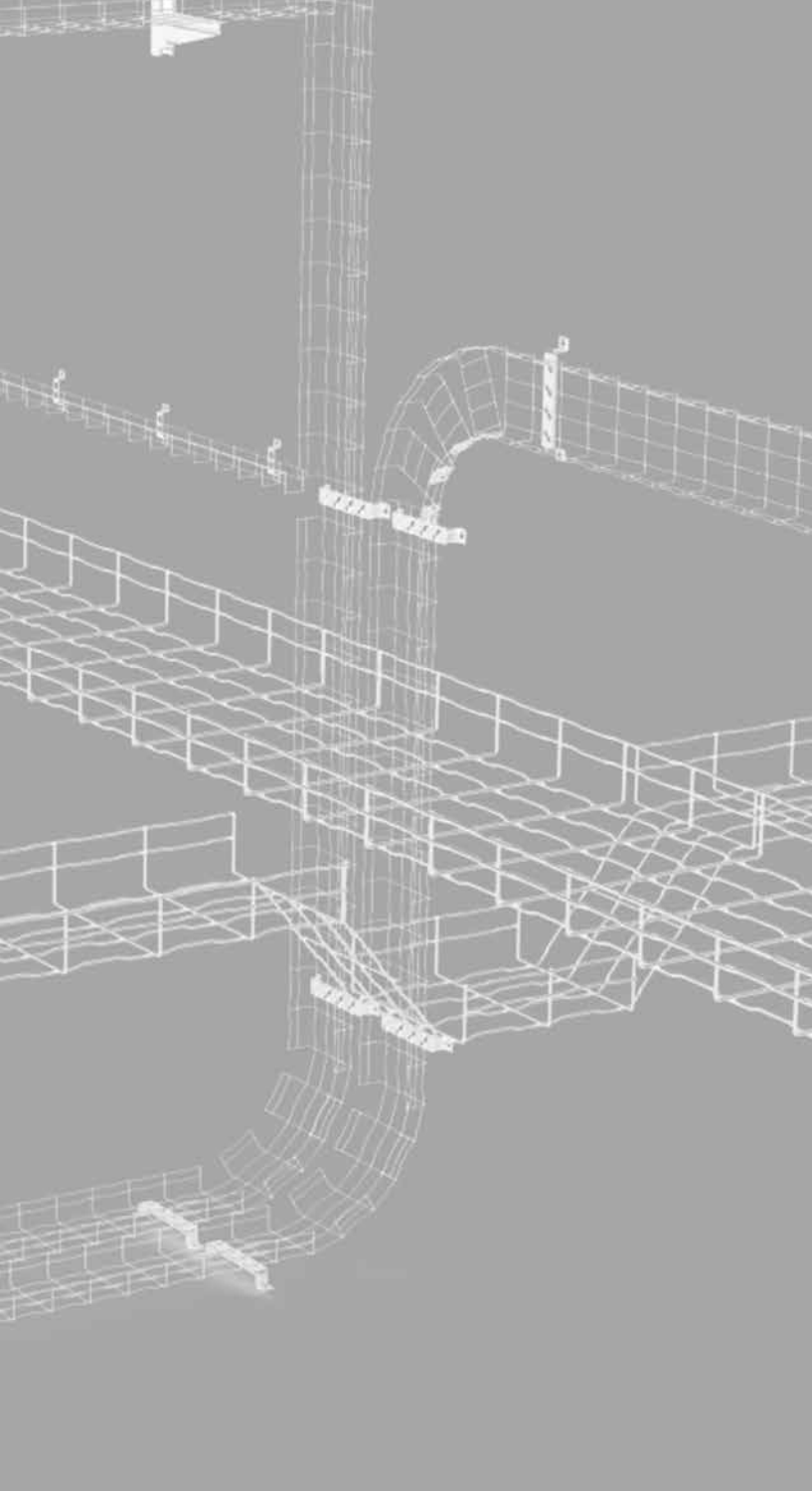

Wire Basket Cable Trays



MP HUSKY™

WIRE MANAGEMENT BY **3E basor**



Electroplated Zinc

Wire Basket

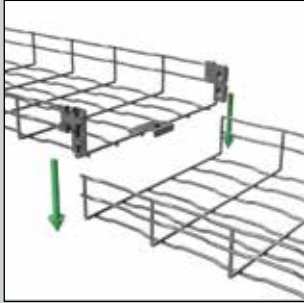

PATENT
9602521

- 1 Shipped with pre-attached splice plates, the BF2R Series offers a distinct advantage for installers. This system is designed for tool-less, quick installation.
- 2 The BF2R Series is UL Classified for use as an equipment ground conductor. No additional splice plates or bonding jumpers are required with pre-attached splice plates.
- 3 To avoid damage to cables or personnel, all MP Husky Wire Basket Cable Tray is manufactured with a safety edge.

CABLE CAPACITY (in ²)			
Width (in)	2" Deep Area (in ²)	4" Deep Area (in ²)	6" Deep Area (in ²)
2	3.57	-	-
4	7.29	13.1	-
6	11.63	20.94	-
8	15.81	28.83	44.33
12	24.34	45.11	68.2
16	32.86	61.38	92.07
18	36.86	69.38	104.07
20	41.39	77.66	115.94
24	49.91	93.93	139.81
36	-	-	207.39

2" DEEP, BF2R SELF COUPLING SYSTEM



L = 10 FT / 3 m

Description	Width, B (in)	SWL (lbs/ft)*	SWL (kg/m)*	Center Splices	EZ Part No.
2" Deep, 2" Wide	2	3	5	0	BF2R-02X2-EZ
2" Deep, 4" Wide	4	8	11	0	BF2R-04X2-EZ
2" Deep, 6" Wide	6	12	18	0	BF2R-06X2-EZ
2" Deep, 8" Wide	8	16	24	0	BF2R-08X2-EZ
2" Deep, 12" Wide	12	18	26	1	BF2R-12X2-EZ
2" Deep, 16" Wide	16	23	33	1	BF2R-16X2-EZ
2" Deep, 18" Wide	18	27	40	1	BF2R-18X2-EZ
2" Deep, 20" Wide	20	25	37	2	BF2R-20X2-EZ
2" Deep, 24" Wide	24	25	37	2	BF2R-24X2-EZ

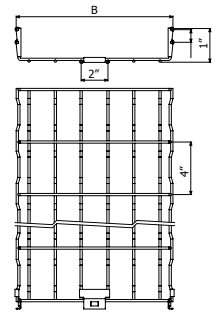

- 1.) BF2R available in electroplated zinc only.
- 2.) Splice plates come pre-installed on tray.

*Safe Working Load (SWL) based on 8 ft (2.43 m) span with a 1.5 safety factor.

4" DEEP, BF2R SELF COUPLING SYSTEM



L = 10 FT / 3 m

Description	Width, B (in)	SWL (lbs/ft)*	SWL (kg/m)*	Center Splices	EZ Part No.
4" Deep, 4" Wide	4	14	21	0	BF2R-04X4-EZ
4" Deep, 6" Wide	6	19	29	0	BF2R-06X4-EZ
4" Deep, 8" Wide	8	22	32	0	BF2R-08X4-EZ
4" Deep, 12" Wide	12	28	42	1	BF2R-12X4-EZ
4" Deep, 16" Wide	16	32	48	1	BF2R-16X4-EZ
4" Deep, 18" Wide	18	46	70	2	BF2R-18X4-EZ
4" Deep, 20" Wide	20	35	52	2	BF2R-20X4-EZ
4" Deep, 24" Wide	24	36	54	2	BF2R-24X4-EZ

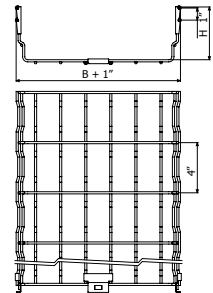

- 1.) BF2R available in electroplated zinc only.
- 2.) Splice plates come pre-installed on tray.

*Safe Working Load (SWL) based on 8 ft (2.43 m) span with a 1.5 safety factor.

6" DEEP, BFR SYSTEM



L = 10 FT / 3 m

Description	Width, B (in)	SWL (lbs/ft)*	SWL (kg/m)*	Center Splices Required (*)	EZ Part No.
6" Deep, 8" Wide	8	28.88	42.97	0	BFR-08X6-EZ
6" Deep, 12" Wide	12	59.31	88.25	1	BFR-12X6-EZ
6" Deep, 16" Wide	16	51	23	1	BFR-16X6-EZ
6" Deep, 18" Wide	18	**	**	2	BFR-18X6-EZ
6" Deep, 20" Wide	20	52.73	52.73	2	BFR-20X6-EZ
6" Deep, 24" Wide	24	65.23	97.06	2	BFR-24X6-EZ
6" Deep, 36" Wide	36	98	44	3	BFR-36X6-EZ

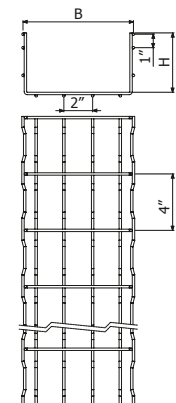

- 1.) Safe Working Load (SWL) includes 1.5 safety factor.
- 2.) To splice trays together, 2 Lateral Union Sets are required plus applicable number of Bolt-Staple Sets (*).

*Safe Working Load (SWL) based on 8 ft (2.43 m) span with a 1.5 safety factor.

** Consult factory. Speciality size.

Wire Basket Cable Tray listed above are available in a Powder Coated finish. To order, use the first 10 characters (includes dashes), followed by:

- | | | |
|-----------------|------------------|--------------------|
| i. PCB (Black) | iv. PCO (Orange) | vii. PCGY (Gray) |
| ii. PCBU (Blue) | v. PCW (White) | viii. PCY (Yellow) |
| iii. PCR (Red) | vi. PCG (Green) | ix. PCP (Purple) |



PATENT
9602521

- 1 The HDGAF BFR Series was designed to offer both optimal design and finish. MP Husky ensures that all HDGAF coatings are smooth and free of sharp edges that could cause harm to cables or installers.
- 2 The Stainless Steel BFR Series was designed to offer both optimal design and finish.
- 3 To avoid damage to cables or personnel, all MP Husky Wire Basket Cable Tray is manufactured with a safety edge.





CABLE CAPACITY (in ²)			
Width (in)	2" Deep Area (in ²)	4" Deep Area (in ²)	6" Deep Area (in ²)
2	3.57	-	-
4	7.29	-	-
6	11.63	-	-
8	15.81	28.83	44.33
12	24.34	45.11	68.2
16	32.86	61.38	92.07
18	36.86	69.38	104.07
20	41.39	77.66	115.94
24	49.91	93.93	139.81
36	-	-	207.39

2" DEEP, BFR SYSTEM

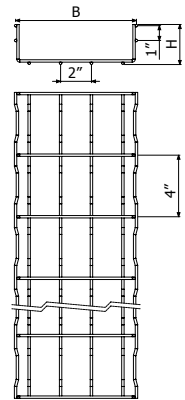

L = 10 FT / 3 m

Description	Width, B (in)	Center Splices Required (*)	HDGAF Part No.	SWL (lbs/ft)*	SS304 Part No.	SWL (lbs/ft)*
2" Deep, 2" Wide	2	0	BFR-02X2-HDG	3	BFR-02X2-4S	3
2" Deep, 4" Wide	4	0	BFR-04X2-HDG	8	BFR-04X2-4S	6
2" Deep, 6" Wide	6	0	BFR-06X2-HDG	12	BFR-06X2-4S	10
2" Deep, 8" Wide	8	0	BFR-08X2-HDG	16	BFR-08X2-4S	14
2" Deep, 12" Wide	12	1	BFR-12X2-HDG	18	BFR-12X2-4S	15
2" Deep, 16" Wide	16	1	BFR-16X2-HDG	23	BFR-16X2-4S	19
2" Deep, 18" Wide	18	2	BFR-18X2-HDG	27	BFR-18X2-4S	23
2" Deep, 20" Wide	20	2	BFR-20X2-HDG	25	BFR-20X2-4S	21
2" Deep, 24" Wide	24	2	BFR-24X2-HDG	25	BFR-24X2-4S	21



1.) To splice trays together, 2 Lateral Union Sets are required plus applicable number of Bolt-Staple Sets (*).
 2.) 316 Stainless Steel available upon request.
 *Safe Working Load (SWL) based on 8 ft (2.43m) span with a 1.5 safety factor.

4" DEEP, BFR SYSTEM



L = 10 FT / 3 m

Description	Width, B (in)	Center Splices Required (*)	HDGAF Part No.	SWL (lbs/ft)*	SS304 Part No.	SWL (lbs/ft)*
4" Deep, 4" Wide	4	0	BFR-04X4-HDG	14	BFR-04X4-4S	12
4" Deep, 6" Wide	6	0	BFR-06X4-HDG	19	BFR-06X4-6S	16
4" Deep, 8" Wide	8	0	BFR-08X4-HDG	22	BFR-08X4-4S	18
4" Deep, 12" Wide	12	1	BFR-12X4-HDG	28	BFR-12X4-4S	24
4" Deep, 16" Wide	16	1	BFR-16X4-HDG	32	BFR-16X4-4S	27
4" Deep, 18" Wide	18	2	BFR-18X4-HDG	46	BFR-18X4-4S	39
4" Deep, 20" Wide	20	2	BFR-20X4-HDG	35	BFR-20X4-4S	30
4" Deep, 24" Wide	24	2	BFR-24X4-HDG	36	BFR-24X4-4S	31

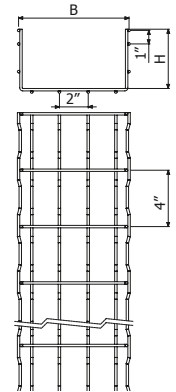

1.) To splice trays together, 2 Lateral Union Sets are required plus applicable number of Bolt-Staple Sets (*).
 2.) 316 Stainless Steel available upon request.
 *Safe Working Load (SWL) based on 8 ft (2.43m) span with a 1.5 safety factor.

6" DEEP, BFR SYSTEM



L = 10 FT / 3 m

Description	Width, B (in)	Center Splices Required (*)	HDGAF Part No.	SWL (lbs/ft)*	SS304 Part No.	SWL (lbs/ft)*
6" Deep, 8" Wide	8	0	BFR-08X6-HDG	28.88	BFR-08X6-4S	24.548
6" Deep, 12" Wide	12	1	BFR-12X6-HDG	59.31	BFR-12X6-4S	50.414
6" Deep, 16" Wide	16	1	BFR-16X6-HDG	**	BFR-16X6-4S	**
6" Deep, 18" Wide	18	2	BFR-18X6-HDG	**	BFR-18X6-4S	**
6" Deep, 20" Wide	20	2	BFR-20X6-HDG	35.44	BFR-20X6-4S	30.124
6" Deep, 24" Wide	24	2	BFR-24X6-HDG	65.23	BFR-24X6-4S	55.446
6" Deep, 36" Wide	36	3	BFR-36X6-HDG	**	**	**

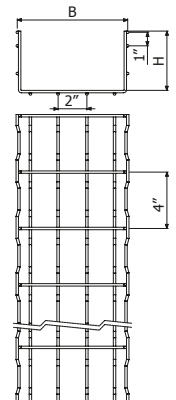

1.) To splice trays together, 2 Lateral Union Sets are required plus applicable number of Bolt-Staple Sets (*).
 2.) 316 Stainless Steel available upon request.
 *Safe Working Load (SWL) based on 8 ft (2.43m) span with a 1.5 safety factor.
 ** Consult factory. Speciality size.

Wire Basket Cable Tray listed above are available in a Powder Coated finish. To order, use the first 10 characters (includes dashes), followed by:

- | | | |
|-----------------|------------------|--------------------|
| i. PCB (Black) | iv. PCO (Orange) | vii. PCGY (Gray) |
| ii. PCBU (Blue) | v. PCW (White) | viii. PCY (Yellow) |
| iii. PCR (Red) | vi. PCG (Green) | ix. PCP (Purple) |

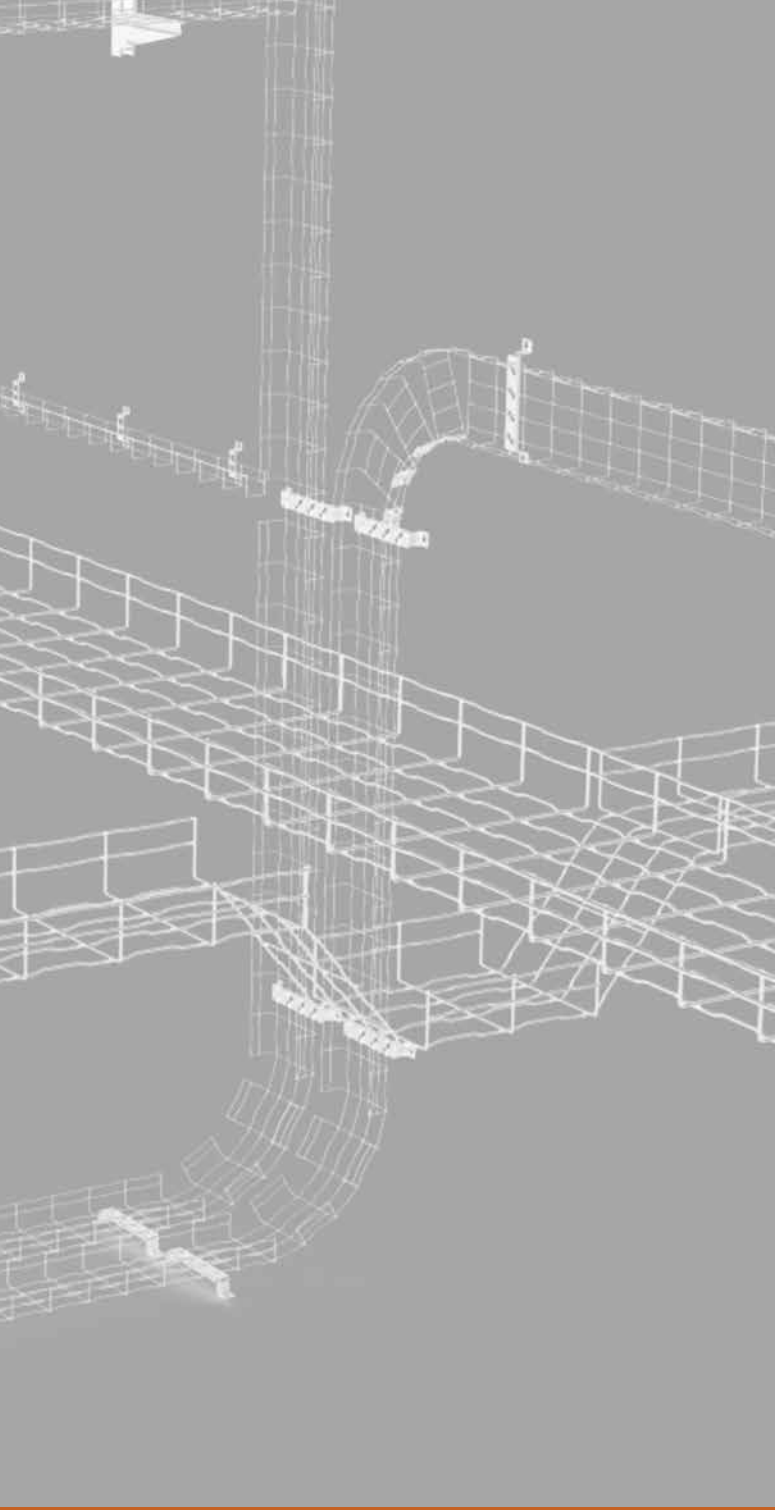

Fasteners & Accessories



MP HUSKY™

WIRE MANAGEMENT BY **3E basor**

DIVIDERS



Description	PG Part No.	SS304 Part No.	PG/SS304 Length (ft)	HDG Part No.	HDG Length (ft)
2" Divider	S2S-3M-BSR	42S-3M-BSR	10	G2S-3M-BSR	5
4" Divider	S4S-3M-BSR	44S-3M-BSR	10	G4S-3M-BSR	5
6" Divider	S6S-3M-BSR	46S-3M-BSR	10	G6S-3M-BSR	5

- 1.) Separators are secured to wire basket using a Staple and a B1 Bolt at 4 different locations.
- 2.) The following hardware is provided with Dividers:
 - a.) 4 B1 Bolts
 - b.) 4 Staples
 - c.) 1 Separator Splice
- 3.) 316 Stainless Steel available upon request.

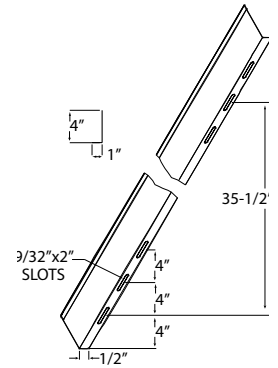

QUICK SPLICE



Description	EZ Part No.	HDGAF Part No.
Quick Splice Connector	QUICK-JOINT-EZ	QUICK-JOINT-HDG

- 1.) Quick connector for 2" deep and 4" deep wire basket.
- 2.) No hardware is required to secure quick connector to tray.
- 3.) Quick Splices are shipped in quantities of 50.

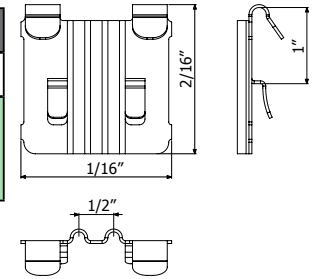

**FAST
COUPLING**

BOLT-STAPLE SET



Description	EZ Part No.	HDGAF Part No.	SS304 Part No.
Bolt-Staple Set	BOLT-STAPLE-SET-EZ	BOLT-STAPLE-SET-HDG	BOLT-STAPLE-SET-4S

- 1.) Bolt-Staple Set includes Bolt-Nut Set and Staple.
- 2.) Bolt-Staple Sets are shipped in quantities of 100.

**PATENT
9602521**

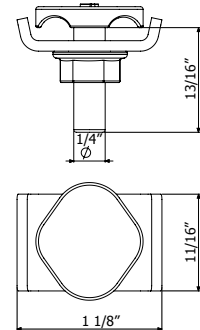

LATERAL UNION SET



Description	EZ Part No.	HDGAF Part No.	SS304 Part No.
Lateral Union Set	LATERAL-UNION-EZ	LATERAL-UNION-HDG	LATERAL-UNION-4S

- 1.) The Lateral Union Set consists of a Lateral Union Set and a Bolt-Nut Set.
- 2.) The Lateral Union Set is the recommended splice plate for BFR Series Wire Basket.
- 3.) Lateral Union Sets are shipped in quantities of 100.

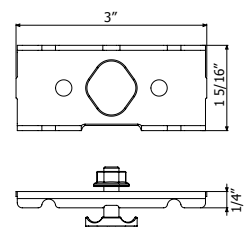

BOLT-NUT SET



Description	EZ Part No.	HDGAF Part No.	SS304 Part No.
Bolt-Nut Set	BOLT-NUT-SET-EZ	BOLT-NUT-SET-HDG	BOLT-NUT-SET-4S
1.) Bolt-Nut Set consists of a bolt and a nut. 2.) Bolt-Nut Sets are shipped in quantities of 100.			

**PATENT
9602521**

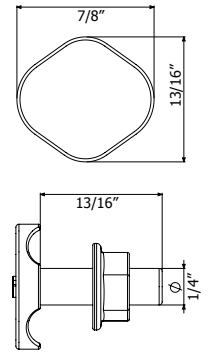

STAPLE



Description	EZ Part No.	HDGAF Part No.	SS304 Part No.
Staple	BF-STAPLE-EZ	BF-STAPLE-HDG	BF-STAPLE-4S
1.) Combined with B1 Bolt to mount separators to wire basket. 2.) Staples shipped in quantities of 100. 3.) 316 Stainless Steel available upon request.			

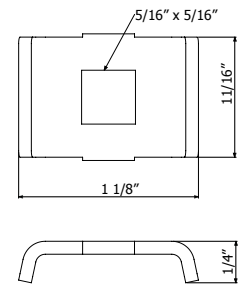

SSC HOLD DOWN



Description	EZ Part No.	HDGAF Part No.	SS304 Part No.
Hold Down	SSC-EZ	SSC-HDG	SSC-4S
1.) Combined with 1 Bolt-Nut Set, 2 SSC Hold Downs can be used to create an adjustable horizontal fitting or small radius fitting. 2.) Combined with threaded rod and nuts, 2 SSC Hold Downs can be used as a center hanger support for 4", 6", and 8" widths. 3.) Combined with a spring nut and bolt, SSC Hold Downs can be used to secure wire basket to strut. 4.) SSC Hold Downs are shipped in quantities of 50.			

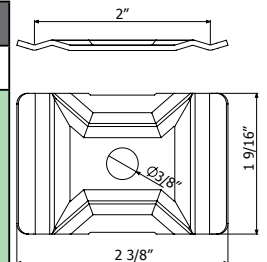

VERTICAL SPLICE PLATES

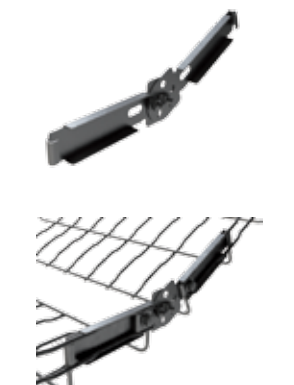

Description	PG Part No.
Vertical Splice Plates	JUA-BFR-PG
1.) 2 Vertical Splices Plates required to create vertical fitting. 2.) Secured to wire basket using Bolt-Staple Sets. 3.) Vertical Splice Plates include the following hardware: a.) 2 B1 Bolts	

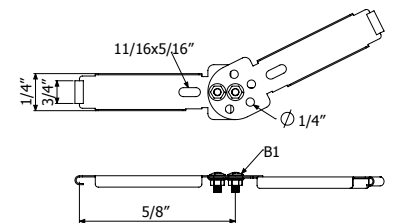

DROP-OUT PLATE



Description	PG Part No.	HDGAF Part No.
Drop-Out Plate	DROP-OUT-PG	DROP-OUT-HDG
1.) No hardware is required to secure Drop-Out Plate to wire basket.		

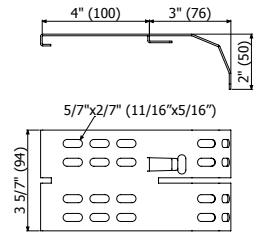

SMALL DROP-OUT PLATE



Description	PG Part No.	HDGAF Part No.
Small Drop-Out Plate	DROP-OUT-SM-PG	DROP-OUT-SM-HDG
1.) No hardware is required to secure Small Drop-Out Plate to wire basket.		

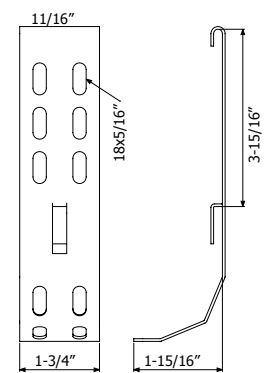

MULTI-UNION JOINT

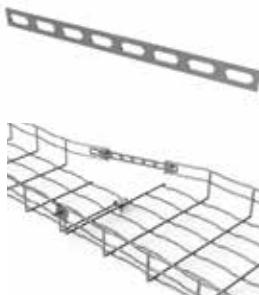

Description	PG Part No.	HDG Part No.
Multi-Union Joint	MULTI-UNION-PG	MULTI-UNION-HDG
1.) Multi purpose bracket used to field fabricate fittings. 2.) Secured to wire basket using Bolt-Staple Sets. 3.) Multi-Union Joints are shipped in quantities of 10.		

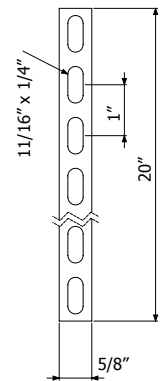

CONDUIT CLAMP



Description	PG Part No.
Conduit Clamp	CONDUIT-CLAMP-PG
1.) Conduit Clamp attached to wire basket using bendable tab. 2.) Conduit Clamp accommodates 1/2" to 2" U-bolts.	

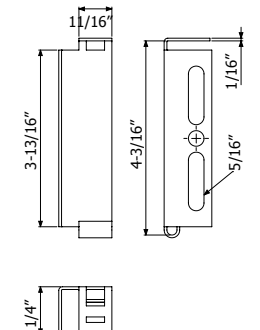

COVERS

Description	Width (in)	Length (ft)	PG Part No.	Self Weight (lbs/ud)	HDGAF Part No.	Self Weight (lbs/ud)
Cover for BFR/BF2R 2"D,2"W	2	5	COVER-H2-02-PG	1.74	COVER-H2-02-HDG	2.58
Cover for BFR/BF2R 2"D,4"W	4	10	COVER-H2-04-PG	4.70	COVER-H2-04-HDG	6.96
Cover for BFR/BF2R 2"D,6"W	6	10	COVER-H2-06-PG	6.55	COVER-H2-06-HDG	9.69
Cover for BFR/BF2R 2"D,8"W	8	10	COVER-H2H6-08-PG	8.41	COVER-H2H6-08-HDG	12.45
Cover for BFR/BF2R 2"D,12"W	12	10	COVER-H2H6-12-PG	12.11	COVER-H2H6-12-HDG	17.92
Cover for BFR/BF2R 2"D,16"W	16	10	COVER-H2H6-16-PG	15.81	COVER-H2H6-16-HDG	23.40
Cover for BFR/BF2R 2"D,20"W	20	10	COVER-H2H6-20-PG	22.30	COVER-H2H6-20-HDG	33.00
Cover for BFR/BF2R 2"D,24"W	24	10	COVER-H2H6-24-PG	26.53	COVER-H2H6-24-HDG	39.26
Cover for BFR/BF2R 4"D,8"W	8	10	COVER-H4-08-PG	9.07	COVER-H4-08-HDG	13.42
Cover for BFR/BF2R 4"D,12"W	12	10	COVER-H4-12-PG	12.77	COVER-H4-12-HDG	18.90
Cover for BFR/BF2R 4"D,16"W	16	10	COVER-H4-16-PG	16.48	COVER-H4-16-HDG	24.39
Cover for BFR/BF2R 4"D,20"W	20	10	COVER-H4-20-PG	23.06	COVER-H4-20-HDG	34.13
Cover for BFR/BF2R 4"D,24"W	24	10	COVER-H4-24-PG	27.29	COVER-H4-24-HDG	40.39

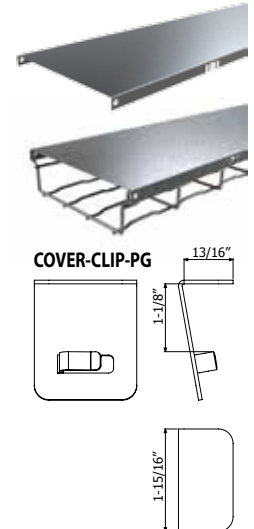

- Covers secured to wire basket using 4 Cover Clips.
- Cover Clips secured to wire basket using bendable tabs. No hardware required.

SOLID BOTTOM INSERTS

Description	Width (in)	Length (ft)	PG Part No.
Solid Bottom Insert, 4" Wide	4	10	SWB0SBI-4-3M-BSR
Solid Bottom Insert, 6" Wide	6	10	SWB0SBI-6-3M-BSR
Solid Bottom Insert, 8" Wide	8	10	SWB0SBI-8-3M-BSR
Solid Bottom Insert, 12" Wide	12	10	SWB0SBI-12-3M-BSR
Solid Bottom Insert, 16" Wide	16	10	SWB0SBI-16-3M-BSR
Solid Bottom Insert, 18" Wide	18	10	SWB0SBI-18-3M-BSR
Solid Bottom Insert, 20" Wide	20	10	SWB0SBI-20-3M-BSR
Solid Bottom Insert, 24" Wide	24	10	SWB0SBI-24-3M-BSR
Solid Bottom Insert, 36" Wide	36	10	SWB0SBI-36-3M-BSR



- Solid Bottom Inserts are secured to wire basket using an SSC Hold Down and a B1 Bolt at each hole location (2 holes).
- The following hardware is provided with Solid Bottom Inserts:
 - 2 SSC Hold Downs
 - 2 B1 Bolts

SIMPLE SL

Description	PG Part No.	HDGAF Part No.	SS304 Part No.
Simple SL	SIMPLE-SL-PG	SIMPLE-SL-HDG	SIMPLE-SL-4S

- Can be used to mount BFR/BF2R-04X2 and BFR/BF2R-02X2 to wall.
- Simple SL's can be used as side hanger supports on wire basket widths 8" and smaller.

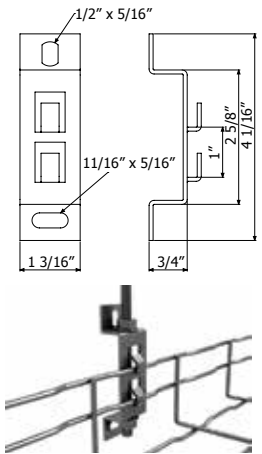

WALL SUPPORT

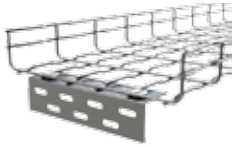

Description	PG Part No.
Wall Support	WALL-SUPPORT-PG
1.) Attached to wire basket using 2 Bolt-Staple Sets.	

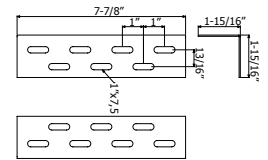

ADJUSTABLE SPLICES



Description	EZ Part No.	HDG Part No.	SS304 Part No.
Adjustable Splices	CU-BFR-PG	CU-BFR-HDG	CU-BFR-4S
1.) Used for field fabrication of fittings. Splices are adjustable to allow for more flexibility. 2.) Adjustable Splices are shipped in quantities of 100.			

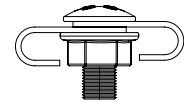
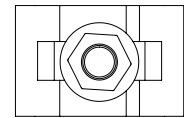

SIDE HANGER CLIP



Description	PG Part No.
Side Hanger Clip	SU-T-PG
1.) Acceptable for use on wire basket widths 8" and smaller. 2.) Side Hanger Clips are shipped in quantities of 25.	

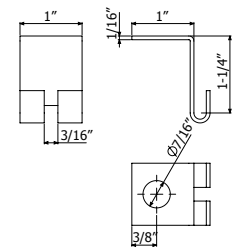

END PLATES/REDUCERS

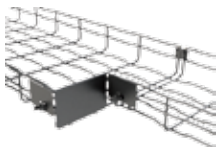

Description	PG Part No.	HDG Part No.	SS304 Part No.
2" Deep, 2" Wide	REER-2WX2H-PG	REER-2WX2H-HDG	REER-2WX2H-4S
2" Deep, 4" Wide	REER-4WX2H-PG	REER-4WX2H-HDG	REER-4WX2H-4S
4" Deep, 2" Wide	REER-2WX4H-PG	REER-2WX4H-HDG	REER-2WX4H-4S
4" Deep, 4" Wide	REER-4WX4H-PG	REER-4WX4H-HDG	REER-4WX4H-4S
6" Deep, 2" Wide	REER-2WX6H-PG	REER-2WX6H-HDG	REER-2WX6H-4S
6" Deep, 4" Wide	REER-4WX6H-PG	REER-4WX6H-HDG	REER-4WX6H-4S
1.) REERs can be used as end plates or reducers. 2.) 2 Bolt-Staple Sets are required to attach REERs to wire basket. 3.) REERs can be combined to create larger widths. If REERs are combined, a B1 Bolt is required to attach REERs together. 4.) REERs are shipped in quantities of 10.			

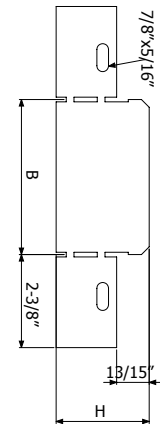

2" X 2" SUPPORT



Description	SS304 Part No.
2"X2" Support	PS-2X2-4S
1.) Used with 2" deep, 2" wide wire basket to allow for attachment of supports.	

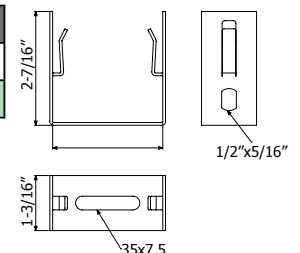

WALL PENETRATION SLEEVES

Description	Height (H)	Width (W)	PG Part No.
Wall Penetration Sleeve, 2" Deep, 4" Wide	2	4	PWPS-4-BF2R20
Wall Penetration Sleeve, 2" Deep, 6" Wide	2	6	PWPS-6-BF2R20
Wall Penetration Sleeve, 2" Deep, 8" Wide	2	8	PWPS-8-BF2R20
Wall Penetration Sleeve, 2" Deep, 12" Wide	2	12	PWPS-12-BF2R20
Wall Penetration Sleeve, 2" Deep, 16" Wide	2	16	PWPS-16-BF2R20
Wall Penetration Sleeve, 2" Deep, 18" Wide	2	18	PWPS-18-BF2R20
Wall Penetration Sleeve, 2" Deep, 20" Wide	2	20	PWPS-20-BF2R20
Wall Penetration Sleeve, 2" Deep, 24" Wide	2	24	PWPS-24-BF2R20
Wall Penetration Sleeve, 4" Deep, 4" Wide	4	4	PWPS-4-BF2R40
Wall Penetration Sleeve, 4" Deep, 6" Wide	4	6	PWPS-6-BF2R40
Wall Penetration Sleeve, 4" Deep, 8" Wide	4	8	PWPS-8-BF2R40
Wall Penetration Sleeve, 4" Deep, 12" Wide	4	12	PWPS-12-BF2R40
Wall Penetration Sleeve, 4" Deep, 16" Wide	4	16	PWPS-16-BF2R40
Wall Penetration Sleeve, 4" Deep, 18" Wide	4	18	PWPS-18-BF2R40
Wall Penetration Sleeve, 4" Deep, 20" Wide	4	20	PWPS-20-BF2R40
Wall Penetration Sleeve, 4" Deep, 24" Wide	4	24	PWPS-24-BF2R40
Wall Penetration Sleeve, 6" Deep, 8" Wide	6	8	PWPS-8-BFR60
Wall Penetration Sleeve, 6" Deep, 12" Wide	6	12	PWPS-12-BFR60
Wall Penetration Sleeve, 6" Deep, 16" Wide	6	16	PWPS-16-BFR60
Wall Penetration Sleeve, 6" Deep, 18" Wide	6	18	PWPS-18-BFR60
Wall Penetration Sleeve, 6" Deep, 20" Wide	6	20	PWPS-20-BFR60
Wall Penetration Sleeve, 6" Deep, 24" Wide	6	24	PWPS-24-BFR60
Wall Penetration Sleeve, 6" Deep, 36" Wide	6	36	PWPS-36-BFR60

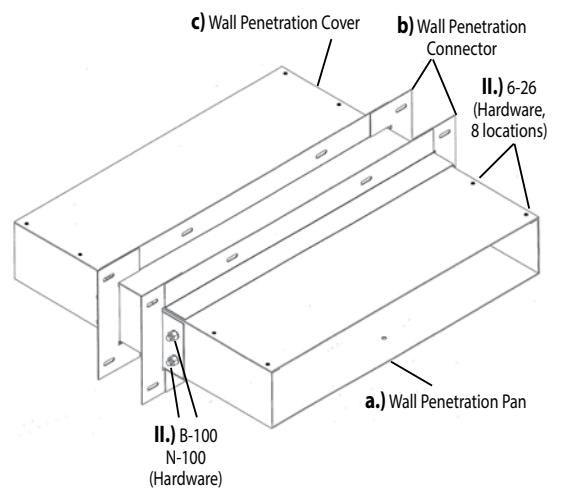
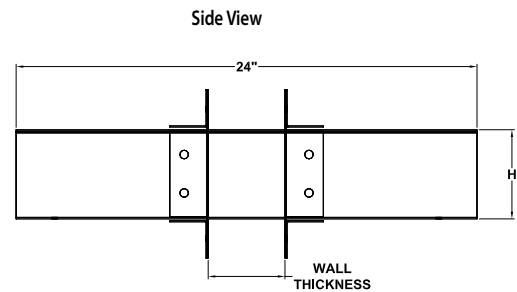
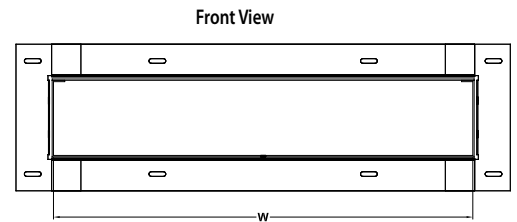

- I.) Wall Penetration Sleeve includes the following items:
- a.) 1 Wall Penetration Pan
 - b.) 2 Wall Penetration Connectors
 - c.) 1 Wall Penetration Pan Cover
- II.) Hardware included. Contact factory for specific counts per size.
- III.) *- For reference only.
- IV.) 316 Stainless Steel available upon request

FITTING KITS

Description	Part No.
Horizontal 90 Degree Kit	WB-90-K
1.) Horizontal 90 Degree Kit includes: a.) 1 Multi-Union Joint (MULTI-UNION-PG) b.) 1 Bolt-Nut Set (BOLT-NUT-SET-EZ) c.) 4 Bolt-Staple Sets (BOLT-STAPLE-SET-EZ) d.) 2 SSC Hold Downs (SSC-EZ)	

Description	Part No.
Tee Kit	WB-TEE-K
1.) Tee Kit includes: a.) 2 Multi-Union Joints (MULTI-UNION-PG) b.) 8 Bolt-Staple Sets (BOLT-STAPLE-SET-EZ)	

Description	Part No.
Vertical Kit	WB-VERT-K
1.) Vertical Kit includes: a.) 2 Vertical Splice Plates (JUA-BFR-PG) b.) 4 Bolt-Staple Sets (BOLT-STAPLE-SET-EZ)	

Description	Part No.
Splice Kit	WB-SPLICE-K
1.) Splice Kit includes: a.) 2 Lateral Union Sets (LATERAL-UNION-EZ) b.) 3 Bolt-Staple Sets (BOLT-STAPLE-SET-EZ)	



HOLD DOWN CLIP



Description	PG Part No.
Hold Down Clip	CLIP-FIL-PG
1.) A quick and inexpensive option for securing wire basket to strut. 2.) Shipped in quantities of 100	

CUTTING TOOL



Description	Part No.
Cutting Tool	WBCT
1.) Used for cutting wires for field modifications. 2.) This cutter is equipped with offset blades for more precise cutting. 3.) Handles are 17" long.	

ZINC RICH PAINT



Description	Part No.
Zinc Rich Paint	ZRP-740
1.) For optimum protection against corrosion, field cut ends should be coated with zinc rich paint.	

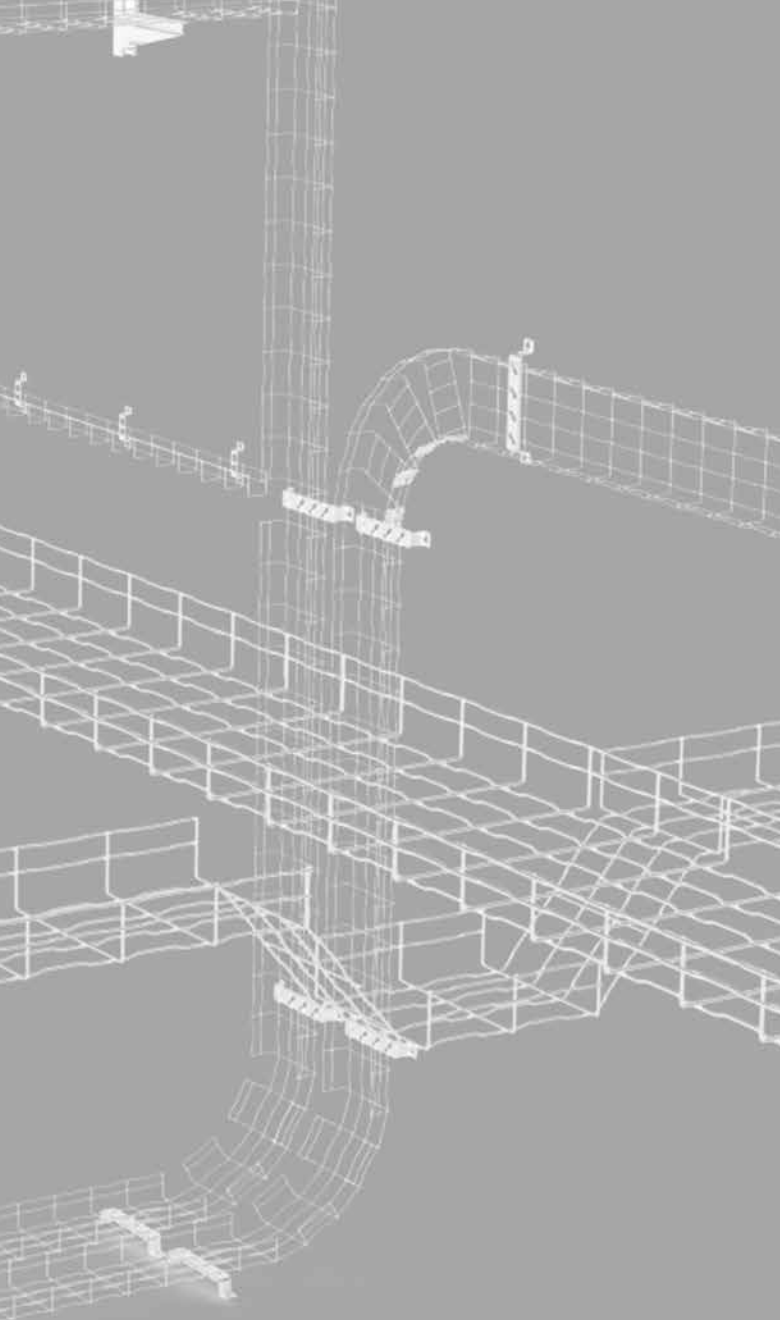

Supports & Grounding



MP HUSKY™

WIRE MANAGEMENT BY **3E basor**

L WALL BRACKET



Description	Width (in)	SWL (lb/ft)	PG Part No.	HDGAF Part No.	SS304 Part No.
4"/6" Bracket	6	198	CSHO-06-PG	CSHO-06-HDG	CSHO-06-4S
8"/12" Bracket	12	99	CSHO-12-PG	CSHO-12-HDG	CSHO-12-4S
Bracket Support			SHO-SHOT-PG	SHO-SHOT-HDG	SHO-SHOT-4S

1.) Wire basket secured to L Wall Bracket using bendable tab on bracket. No hardware required.
 2.) 1 Bracket Support is required with each L Wall Bracket.

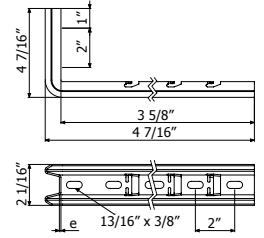

SHELF WALL BRACKET



Description	Width (in)	SWL (lb/ft)	PG Part No.	HDGAF Part No.	SS304 Part No.
4"/6" Bracket	6"	132	SRB-06-PG	SRB-06-HDG	SRB-06-4S
8"/12" Bracket	12"	132	SRB-12-PG	SRB-12-HDG	SRB-12-4S
16"/20" Bracket	20"	132	SRB-20-PG	SRB-20-HDG	SRB-20-4S
24" Bracket	24"	132	SRB-24-PG	SRB-24-HDG	SRB-24-4S

1.) Wire basket secured to Shelf Wall Bracket using bendable tab on bracket. No hardware required.

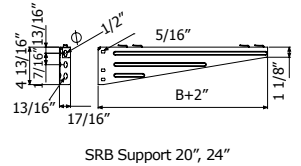
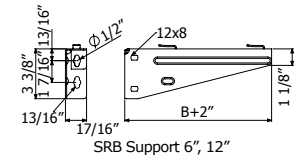

WALL BRACKET ADJUSTABLE SUPPORT



Description	PG Part No.
Wall Bracket Adjustable Support	WALL-BRACKET-PG

1.) Allows for Shelf Wall Bracket to be adjusted vertically for curved walls, etc.

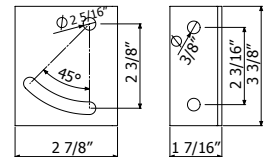

TRAPEZE HANGERS

CENTER HUNG



TRAPEZE



Description	Width (in)	SWL (lbs/ft)	PG Part No.	HDGAF Part No.
4"/6" Trapeze Hanger	6"	440	CSVO-06-PG	CSVO-06-HDG
8"/12" Trapeze Hanger	12"	517	CSVO-12-PG	CSVO-12-HDG
16"/18"/20" Trapeze Hanger	20"	253	CSVO-20-PG	CSVO-20-HDG
24" Trapeze Hanger	24"	191	CSVO-24-PG	CSVO-24-HDG
3M Trapeze Hanger	118 1/8"		CSVO-3M-PG	CSVO-3M-PG

- 1.) Wire basket secured to Trapeze Hanger using bendable tab on bracket. No hardware required.
- 2.) Designed for use with standard and center hung applications.
- 3.) For use with 1/4" threaded rod.

FAST COUPLING

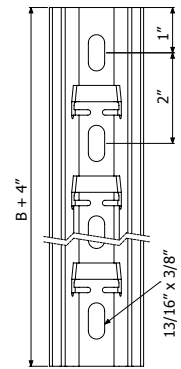
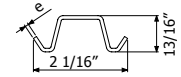

1 1/2" RAISED FLOOR SUPPORTS



6", 12"



20", 24"

Description	Width (in)	SWL (lbs/ft)	PG Part No.	HDGAF Part No.	SS304
4"/6" Raised Floor Support	6"	264	SV-06-PG	SV-06-HDG	SV-06-4S
8"/12" Raised Floor Support	12"	198	SV-12-PG	SV-12-HDG	SV-12-4S
16"/20" Raised Floor Support	20"	330	SV-20-PG	SV-20-HDG	—
24" Raised Floor Support	24"	396	SV-24-PG	SV-24-HDG	—

- 1.) Can be used to raise wire basket 1 1/2" off of floor.
- 2.) Can be used to secure wire basket to walls for vertical applications.
- 3.) 2 Bolt-Staple Sets are required to secure wire basket to support for 6" and 12" supports, and 4 Bolt-Staple Sets are required for 20" and 24" supports.

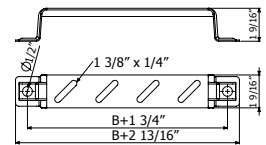

SV 6", 12"

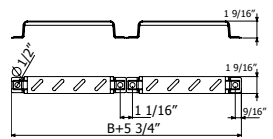

SV 20", 24"

2" RAISED FLOOR SUPPORTS



Description	PG Part No.	HDGAF Part No.
2" Raised Floor Supports	PBFR-2-PG	PBFR-2-HDG

- 1.) Used to raise wire basket 2' above finished floor.
- 2.) Wire basket secured to 2" Raised Floor Support using bendable tabs on support. No hardware required.

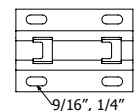

5.5" RAISED FLOOR SUPPORTS



Description	PG Part No.
4" Raised Floor Support	SFS-SUPPORT-PG
1.) When combined with a Underfloor Support Bracket, creates a raised floor wire basket system. 2.) Underfloor Support Bracket is secured to Raised Floor Support using 2 B1 Bolts.	

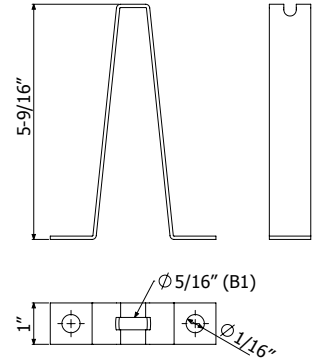

RAISED FLOOR KIT



Description	PG Part No.
Raised Floor Support Bracket	KIT-FS-PG
Raised Floor Cross Member	CSVO-UF-PG
1.) 1 Raised Floor Cross Member and 2 Raised Floor Support Brackets are required to secure wire basket to 2 raised floor support posts (customer supplied). 2 B1 Bolts are required to secure Raised Floor Cross Member to the 2 Raised Floor Support Brackets. No additional hold downs are required to secure wire basket to Raised Floor Cross Members.	

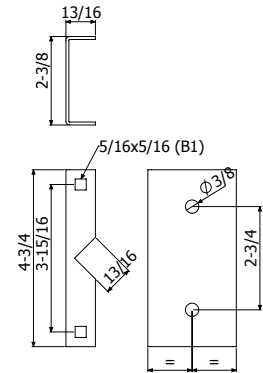

GROUNDING CONNECTORS



Description	Brass Part No.
Ground Clamp (#8 AWG STR - #2 AWG STR)	BGC-35
Ground Clamp (1/0 AWG STR - 4/0 AWG STR)	BGC-95

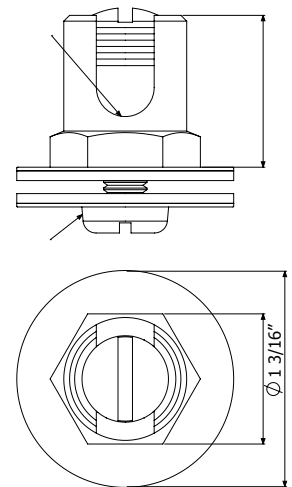

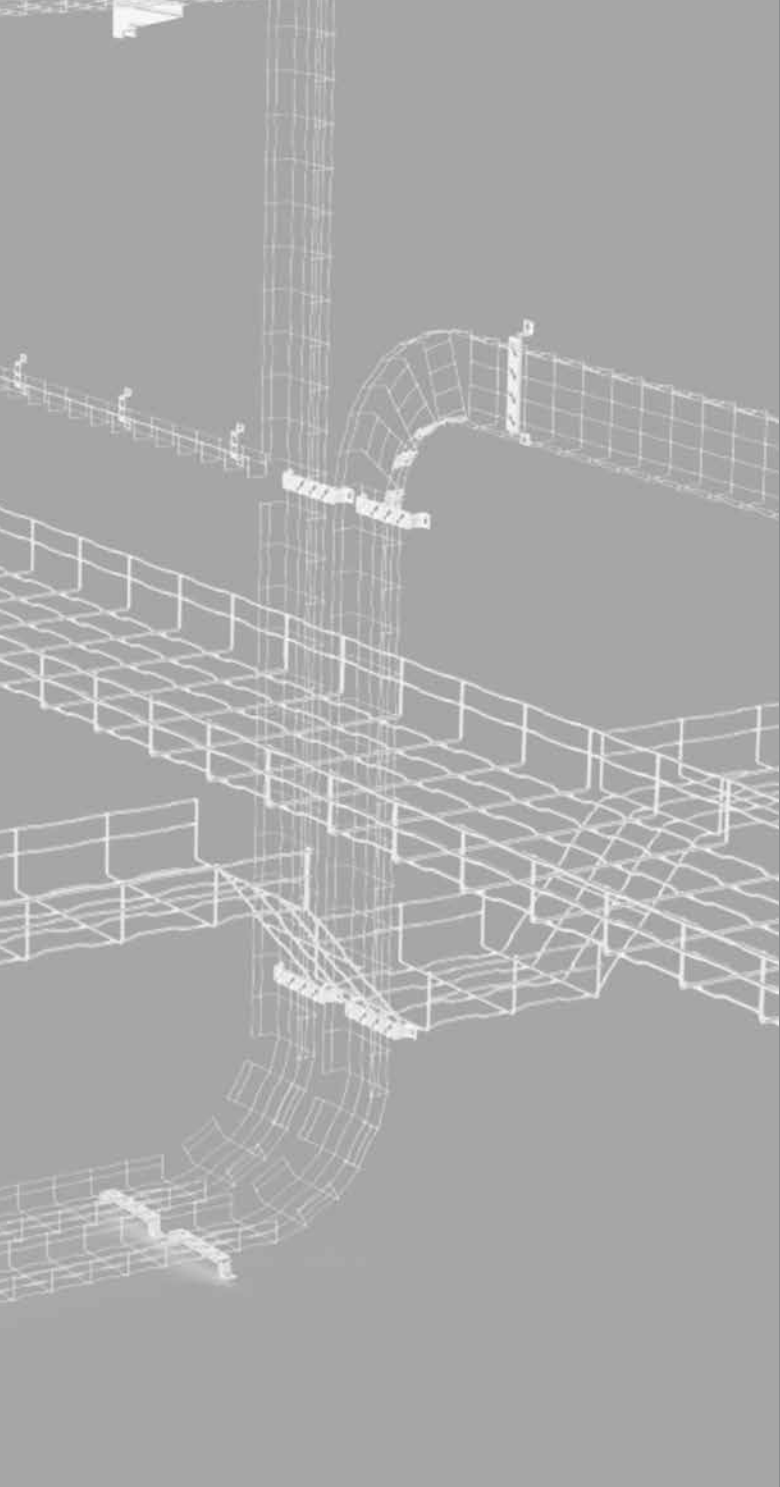

Assembly Instructions



MP HUSKY™

WIRE MANAGEMENT BY **3E basor**

HOW TO CUT

Always use wire cutters with offset blades.

Cut as close as you can to where horizontal and vertical rods cross each other, as shown.

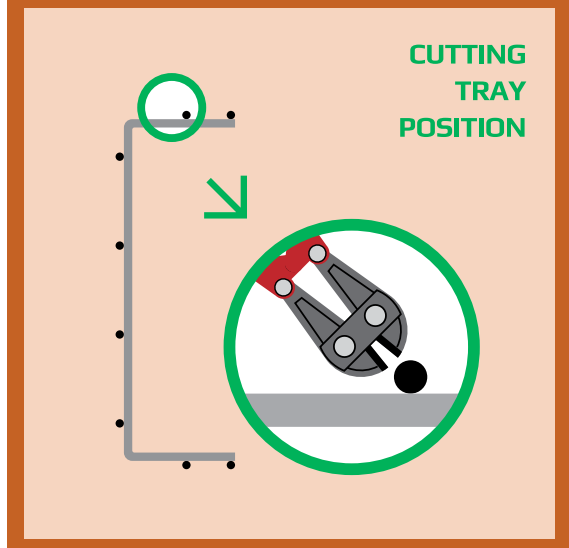
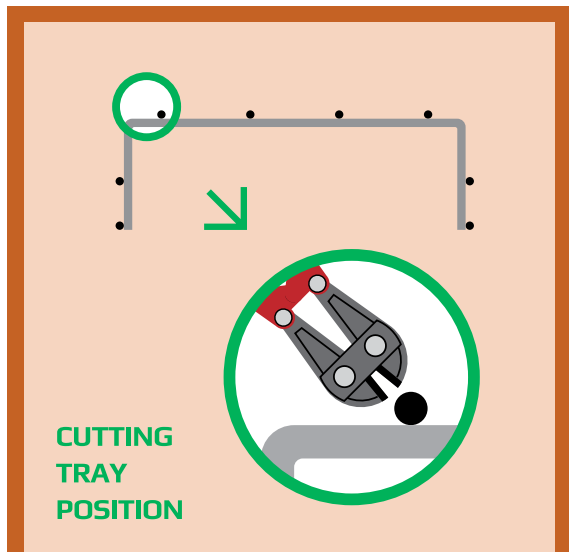
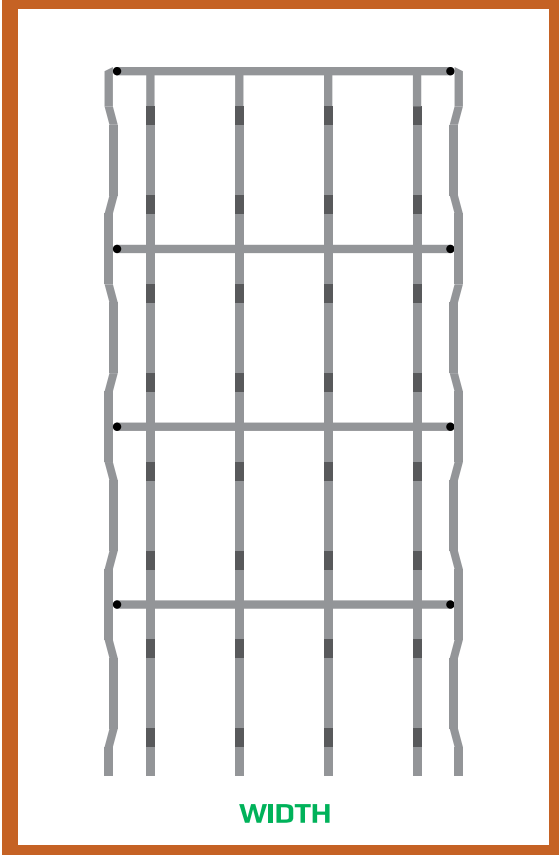
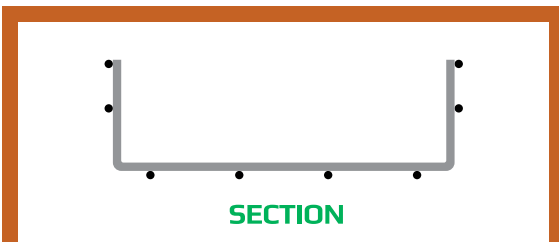
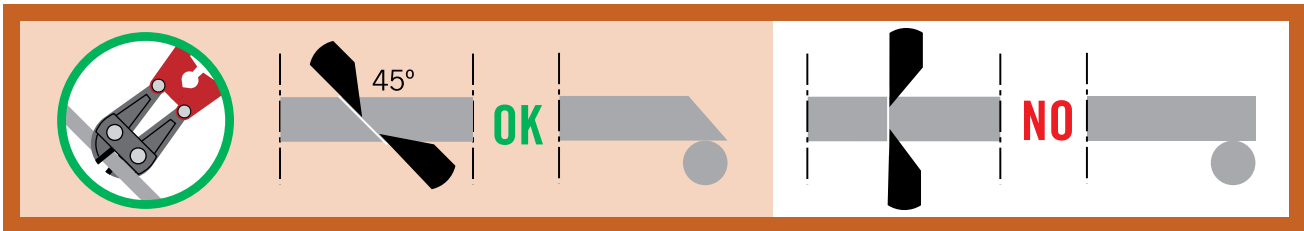
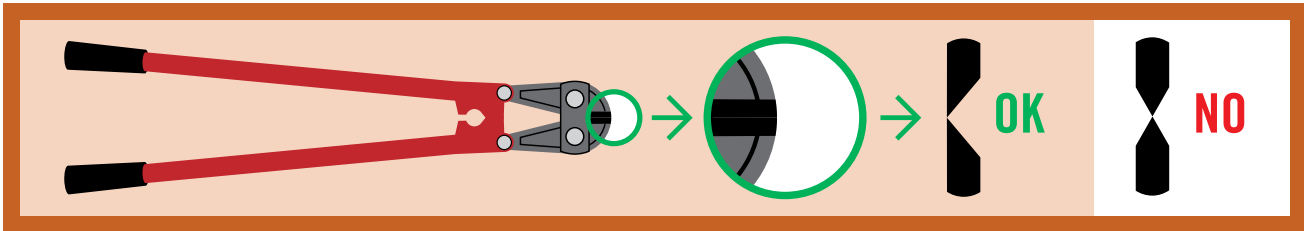

LARGE RADIUS HORIZONTAL BENDS - RIGHT ANGLE

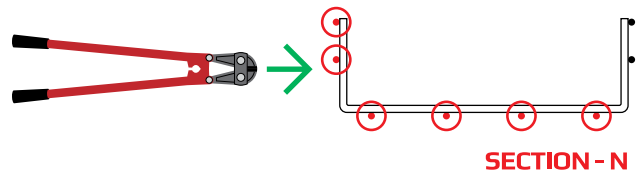
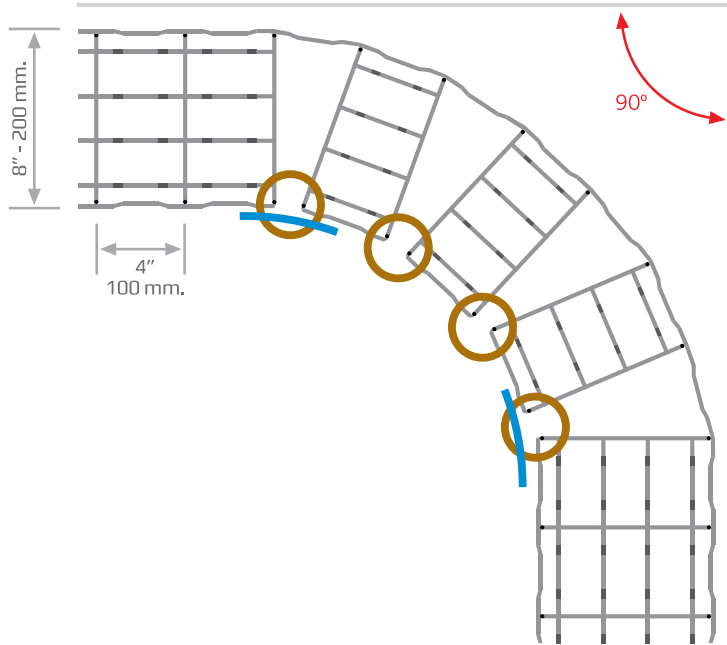
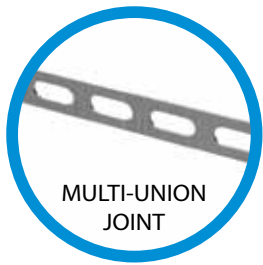
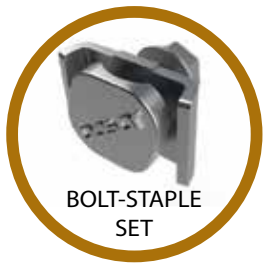

WIDTH (IN)	NO.	ACCESSORIES REQUIRED
2	2	4 Bolt-Staple Sets, 1 Multi-Union Joint
4	3	6 Bolt-Staple Sets, 1 Multi-Union Joint
6	4	8 Bolt-Staple Sets, 1 Multi-Union Joint
8	4	6 Bolt-Staple Sets, 2 Multi-Union Joints
12	6	8 Bolt-Staple Sets, 2 Multi-Union Joints
16	8	10 Bolt-Staple Sets, 2 Multi-Union Joints
18	8	10 Bolt-Staple Sets, 2 Multi-Union Joints
20	9	11 Bolt-Staple Sets, 2 Multi-Union Joints
24	11	12 Bolt-Staple Sets, 2 Multi-Union Joints

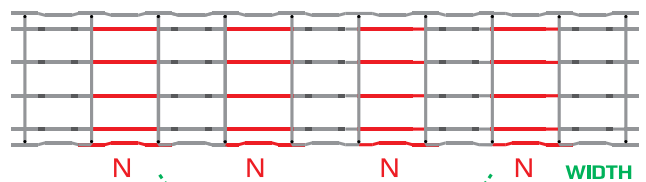
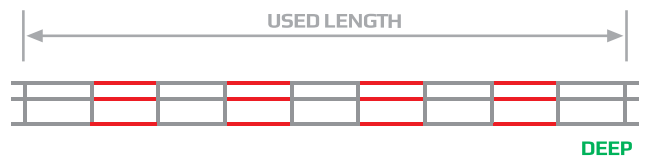

N = n° of rows to cut

LARGE RADIUS HORIZONTAL BENDS - RIGHT ANGLE

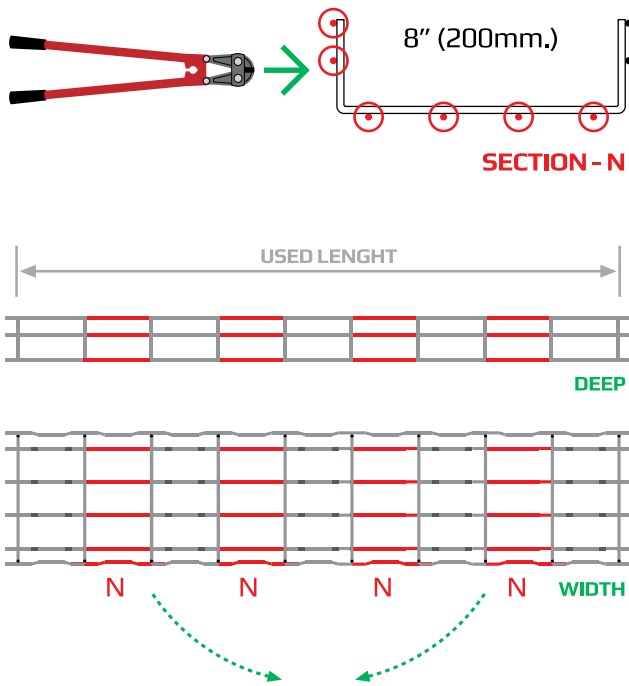
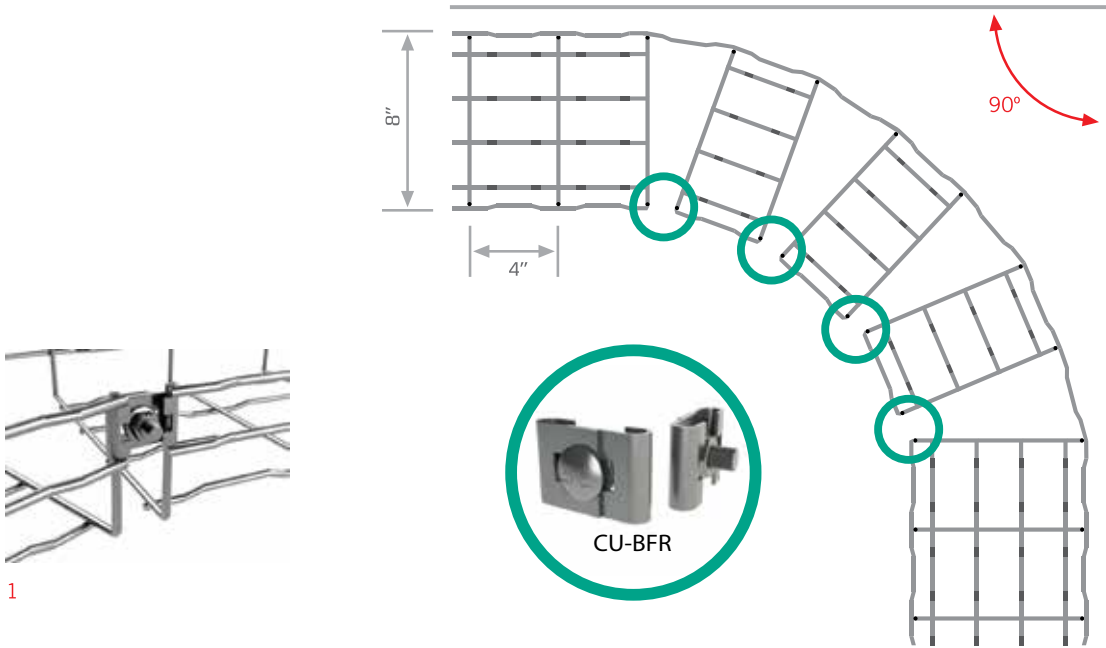

N = n° of rows to cut

WIDTH (IN)	NO.	ACCESSORIES REQUIRED
4	2	Adjustable Splices (Part#: CU-BFR)
6	4	Adjustable Splices (Part#: CU-BFR)
8	4	Adjustable Splices (Part#: CU-BFR)
12	6	Adjustable Splices (Part#: CU-BFR)
16	8	Adjustable Splices (Part#: CU-BFR)
18	8	Adjustable Splices (Part#: CU-BFR)
20	9	Adjustable Splices (Part#: CU-BFR)
24	11	Adjustable Splices (Part#: CU-BFR)

SMALL RADIUS HORIZONTAL BENDS - RIGHT ANGLE

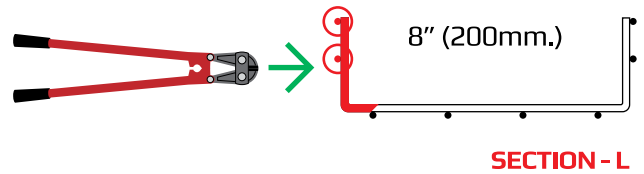
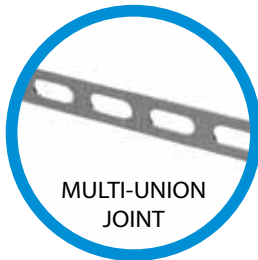
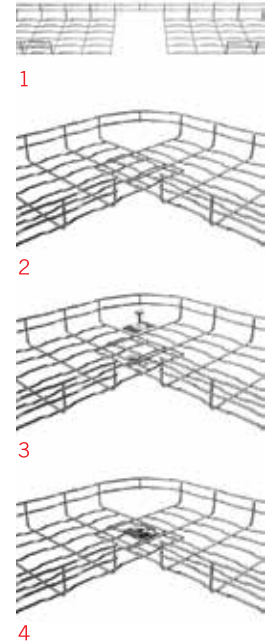
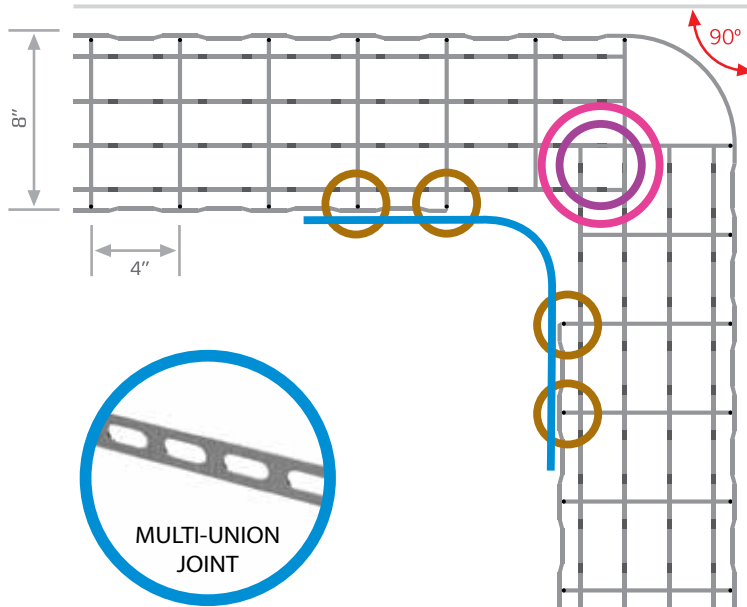
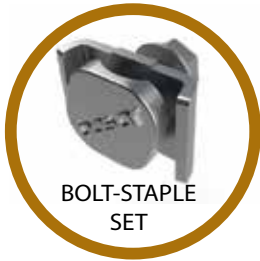

WIDTH (IN)	D	L	ACCESSORIES REQUIRED
2	-	1	1 Horizontal 90 Degree Kit (Part #: WB-90-Kit)
4	1	1+1	1 Horizontal 90 Degree Kit (Part #: WB-90-Kit)
6	1	1+1	1 Horizontal 90 Degree Kit (Part #: WB-90-Kit)
8	2	2+2	1 Horizontal 90 Degree Kit (Part #: WB-90-Kit)
12	2	2+2	1 Horizontal 90 Degree Kit (Part #: WB-90-Kit)
16	2	3+3	1 Horizontal 90 Degree Kit (Part #: WB-90-Kit)
18	2	4+4	1 Horizontal 90 Degree Kit (Part #: WB-90-Kit)
20	2	4+4	1 Horizontal 90 Degree Kit (Part #: WB-90-Kit)
24	2	5+5	1 Horizontal 90 Degree Kit (Part #: WB-90-Kit)

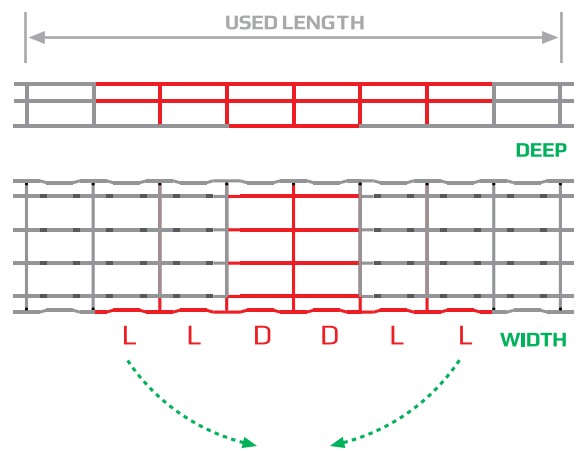

D and L = nº of rows to cut

T/CROSS - RIGHT ANGLE

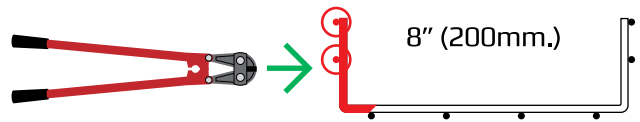
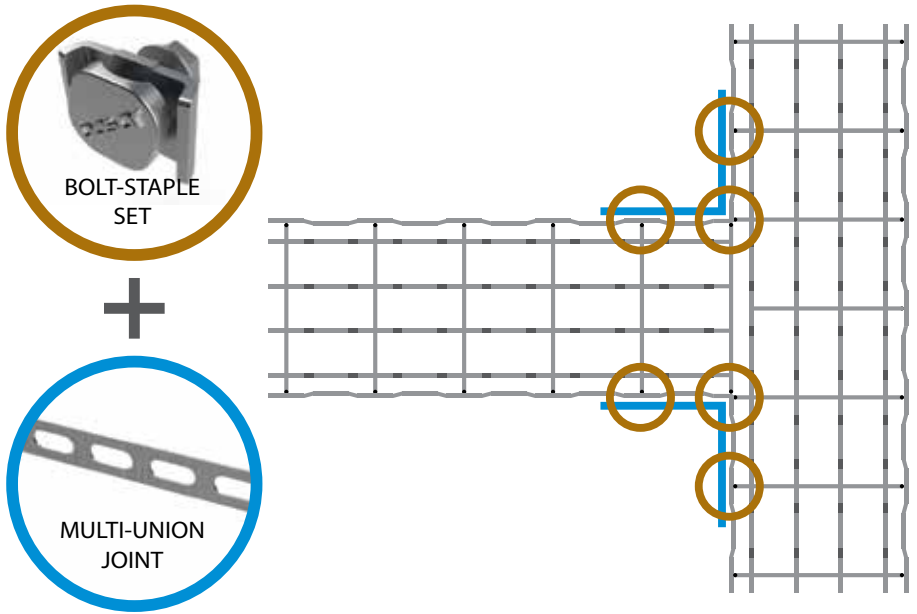

SECTION - L

WIDTH (IN)	L	ACCESSORIES REQUIRED (TEE)	ACCESSORIES REQUIRED (CROSS)
2	1	1 Tee Kit (Part #: WB-TEE-K)	2 Tee Kits (Part #: WB-TEE-K)
4	1	1 Tee Kit (Part #: WB-TEE-K)	2 Tee Kits (Part #: WB-TEE-K)
6	2	1 Tee Kit (Part #: WB-TEE-K)	2 Tee Kits (Part #: WB-TEE-K)
8	2	1 Tee Kit (Part #: WB-TEE-K)	2 Tee Kits (Part #: WB-TEE-K)
12	3	1 Tee Kit (Part #: WB-TEE-K)	2 Tee Kits (Part #: WB-TEE-K)
16	4	1 Tee Kit (Part #: WB-TEE-K)	2 Tee Kits (Part #: WB-TEE-K)
18	5	1 Tee Kit (Part #: WB-TEE-K)	2 Tee Kits (Part #: WB-TEE-K)
20	5	1 Tee Kit (Part #: WB-TEE-K)	2 Tee Kits (Part #: WB-TEE-K)
24	6	1 Tee Kit (Part #: WB-TEE-K)	2 Tee Kits (Part #: WB-TEE-K)

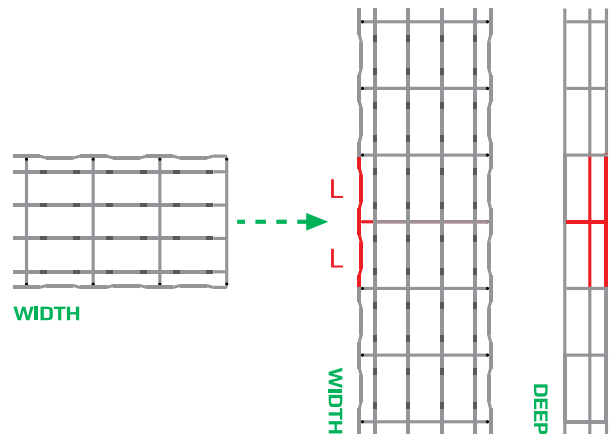

L = n° of rows to cut

REDUCING SIZE - 4"

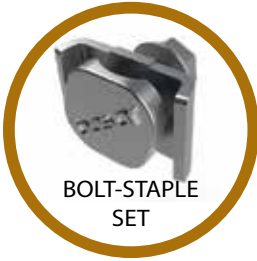
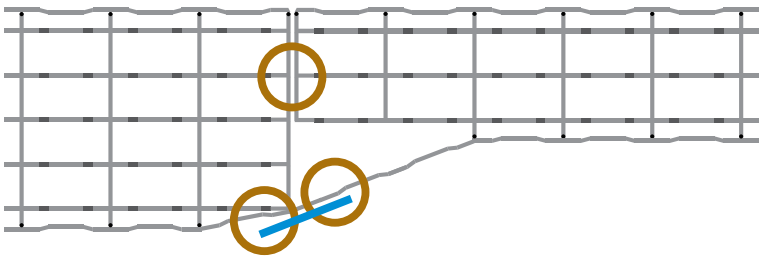

+

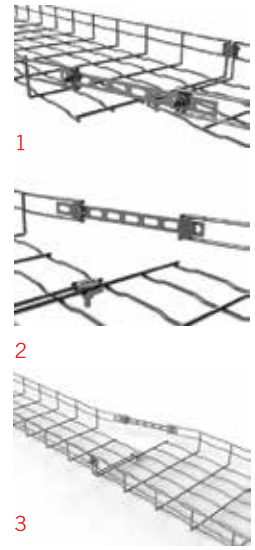
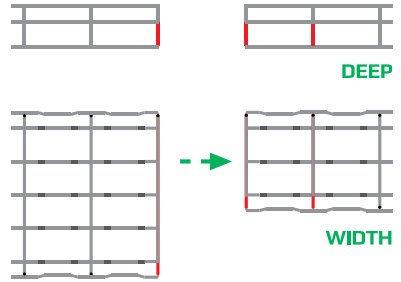

REDUCING SIZE - 8"

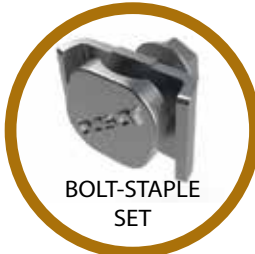
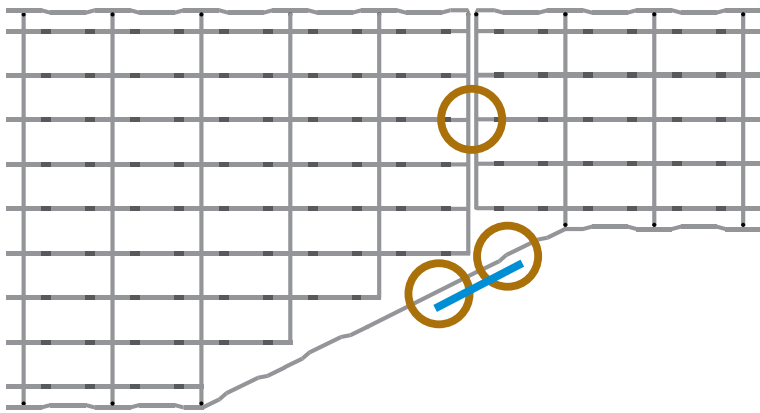

+

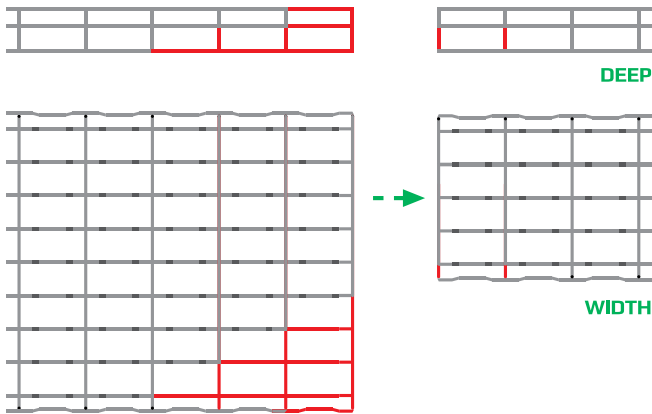
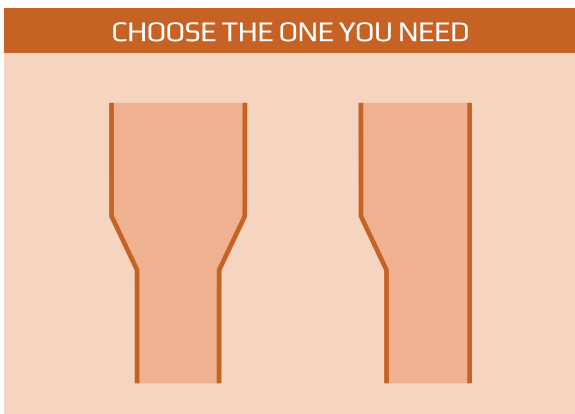
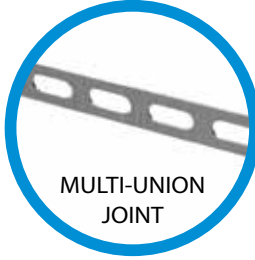

VERTICAL BENDS

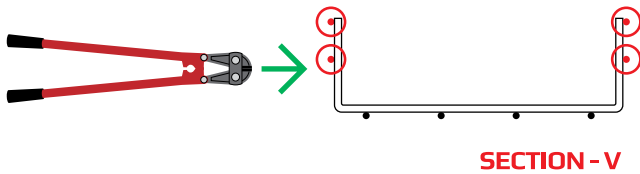
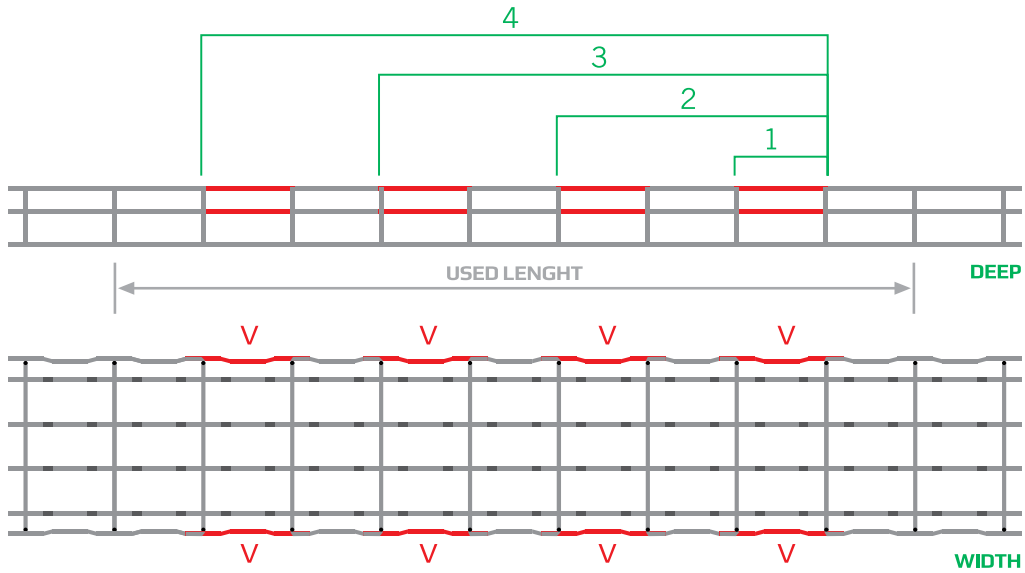

V = n° of rows to cut

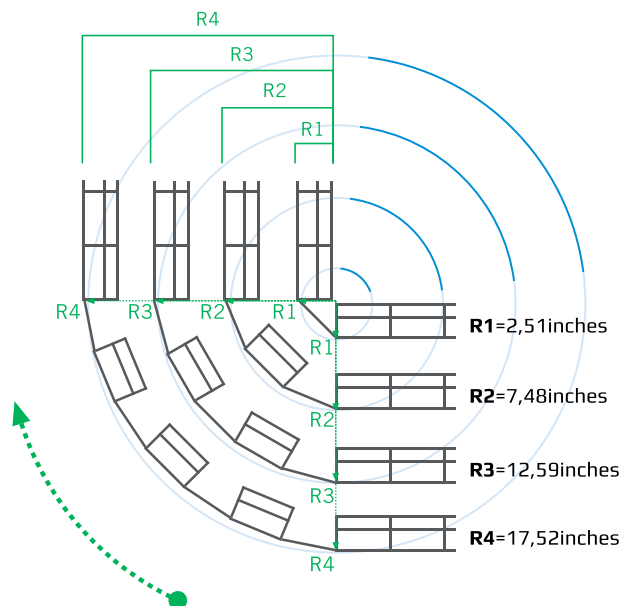
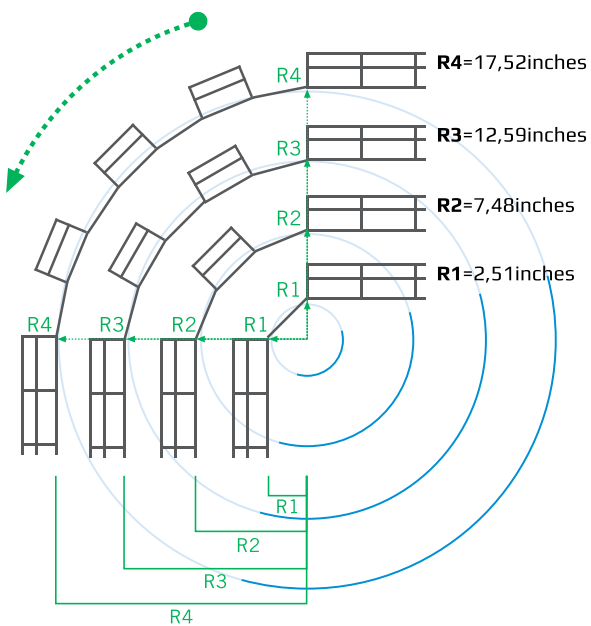

CHANGING LEVEL

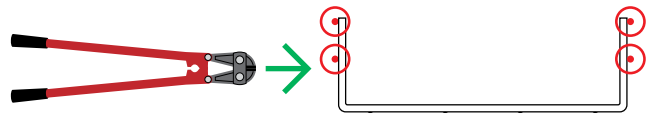
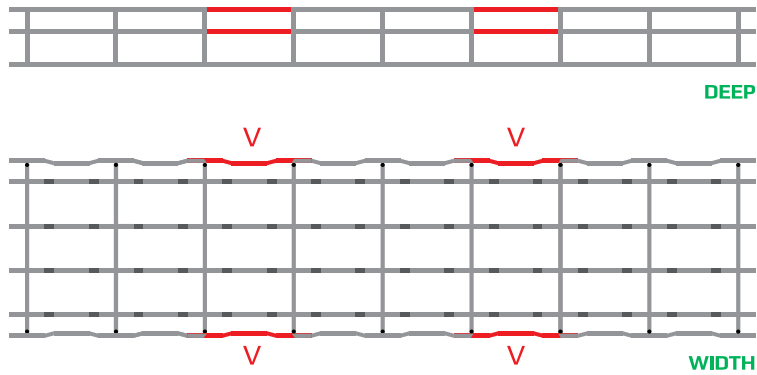

SECTION - V

$V = n^2$ of rows to cut

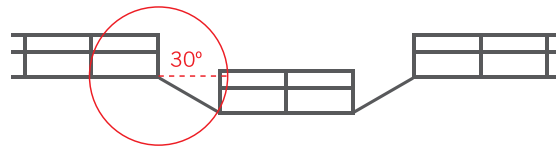
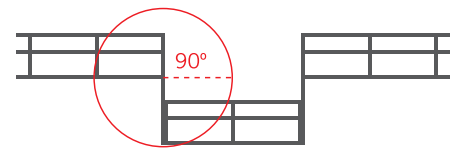
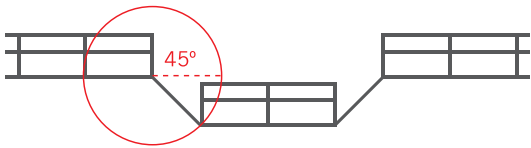

OTHER POSSIBILITIES

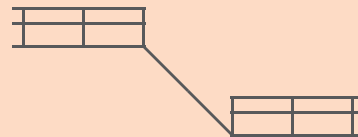
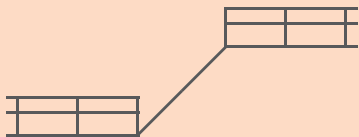
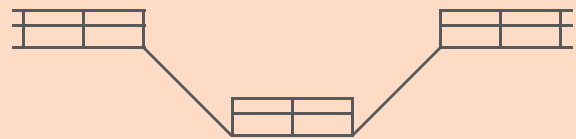
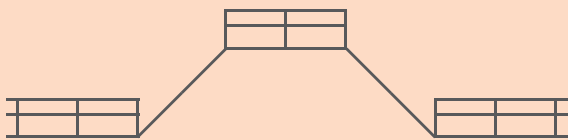

SPECIFICATIONS

1.0 Specification for Husky Wire Mesh Cable Support System

2.0 Manufacturer: MP Husky

3.0 BF2R Series, (2" and 4" Deep), Product Description: The BF2R Series Wire Basket Cable Tray is formed from high strength steel wire mesh. The mesh is fabricated using a 2"x4" pattern, with welds at all intersections. Wire size for each tray type is optimized for both quality and strength. The BF2R Series comes with pre-installed splice connectors that allow for easy installation without the use of tools.

3.1 Material: Standard tray finish shall be electroplated zinc (EZ). Other finish options available are as follows: Powder Coated (PC*).

3.2 Connectors: Wire Basket Cable Tray shall have pre-installed quick splice connectors (The BF2R Series is Classified by UL for use as an equipment grounding conductor).

3.3 Straight sections shall be supplied in 10' (3m/118-1/8") lengths.

3.4 Safety Edge: Wire Basket Cable Tray shall have a safety edge to prevent inadvertent damage to cables or installers.

4.0 BFR Series, (2", 4", and 6" deep), Product Description: BFR Series Wire Basket Cable Tray is formed from high strength steel wire mesh. The mesh is fabricated using a 2"x4" pattern, with welds at all intersections. Wire size for each tray type is optimized for quality and strength.

4.1 Material: Standard tray finish shall be electroplated zinc (EZ). Other finish options available are as follows: Hot Dip Galvanized After Fabrication (HDGAF), Stainless Steel 304 (SS304), Stainless Steel 316 (SS316), and Powder Coated (PC*).

4.2 Straight sections shall be supplied in 10' (3m/118-1/8") lengths.

4.3 Safety Edge: Wire Basket Cable Tray shall have a safety edge to prevent inadvertent damage to cables or installers.

5.0 Tray shall be UL Classified for use as an equipment ground conductor, when installed according to manufacturer's instructions.

6.0 Fittings: Fittings shall be field fabricated from straight sections, based on the needs of the installer. MP Husky recommends that wire basket is cut using a cutting tool with offset blades (WBCT). MP Husky offers a variety of different options for creating fittings and field modifications.

7.0 The Wire Basket Cable Tray shall be supplied by a member of NEMA VE-1 and installed in accordance with NEMA VE-2 "Cable Tray Installation Guidelines".

STANDARD FINISHES

Electroplated Zinc (EZ)

Electroplating is the process of applying a zinc coating to a product by electrolysis after the product has been fabricated. Electroplating requires that current be applied through the product, thereby attracting the zinc to the product. The Electroplated Zinc process creates a smooth, shiny finish that is capable of providing corrosion protection.

Hot Dip Galvanized After Fabrication (HDGAF)

Hot Dip Galvanizing After Fabrication is the process of applying a zinc coating by dipping the product in a bath of molten zinc after the part has been fabricated. While the steel is in the bath of molten zinc, the iron in the steel metallurgically reacts with the molten zinc to form a tightly-bonded alloy coating that provides superior corrosion protection to steel. Hot Dip Galvanized coating thicknesses vary depending on the thickness of the base metal, immersion rate, temperature of the bath, immersion period, and withdrawal rate. If the steel is exposed to the elements due to mechanical damage, the surrounding zinc corrodes sacrificially, protecting the underlying steel from corrosive attack.

Stainless Steel (SS304)

Stainless Steel 304 is steel alloyed with chromium and other elements to increase the corrosion protection of the steel. The chromium naturally reacts with the oxygen in the air, creating a chromium oxide layer that is resistant to corrosion.

Stainless Steel (SS316)

Stainless Steel 316 is similar to Stainless Steel 304, but alloyed with molybdenum. The molybdenum creates an additional layer of corrosion protection.

Powder Coated (PC)

Powder Coating is a process that begins with a dry powder and ends with a smooth, cured coating. The powder is electrostatically charged creating a positive attraction that draws the powder to the metal product. Powder is applied to the part, ensuring all areas are coated as evenly and thoroughly as possible. In order to cure the powder on the product, the product is then placed in an oven to allow the powder to melt and flow into an even coating.



MP HUSKY™

WIRE MANAGEMENT BY **3E basor**



MP HUSKY™

WIRE MANAGEMENT BY **3E basor**

204 Old Piedmont Hwy

Greenville, SC 29605

Phone: 864-234-4800

Fax: 864-234-4822

mphusky.com