



**HOT
DIP
GALVANIZED**

 **TOPAZ**[®]
Friendly Service... Powerful Solutions™

Topaz is proud to support the rebuilding of our nation's infrastructure by offering new Hot Dipped Galvanized products that meet the strict requirements for outdoor installation in a harsh environment.





Table of Contents

Mogul Conduit Bodies	4-9
Rigid Expansion Couplings	10
Conduit Body Covers & Gaskets.	12
Rigid Conduit Bodies	13-15
FS and FD Boxes and Covers	16-17
Rigid Cable Support & Cable Wedge	18
Rigid Connectors & Watertight Hubs	20
Rigid Couplings	21
Rigid Offset Nipples and Straps	22
EMT/Rigid Clamp Backs & Rigid Bushings	23
Insulated Grounding Bushings	24-25
Conduit Supports	26-27
U-Bolt.	27

All dimensions are in inches unless otherwise noted.

Mogul Conduit Bodies with Cover and Gasket

LB Type with Rollers

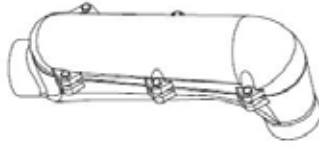

Conforms to finish thickness
ASTM A123/123M
UL listed
Fed. Spec. A-A-50563
NEMA FB 1
Meets Section 314.286x

Features

- Meets Section 314.28 rule for 6x the conduit trade size between hubs
- Built in cable pulling roller
- Threaded NPT tapered hubs for Rigid and IMC conduit
- Smooth and round integral hub bushings protect conductor insulation
- Access to wiring for maintenance and future changes
- Assembled with raised cover, gasket and stainless steel cover screws

Applications

- Use to pull straight or 90° angle turns or making taps and splices
- Provides long and large openings for pulling large conductors, splicing and taps
- Serve as a pull outlets for conductors that are stiff

Standard Material

- Body - Cast iron
- Gasket - Neoprene rubber
- Screws - Stainless steel

Standard Finish

- Hot dip galvanized

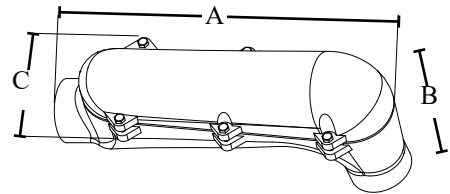

Catalog Number	UPC	Size	Max. Number	Max. Size	Internal Volume in ³	Ship Case	Weight/Case	Inches		
								A	B	C
MLBCG7	32131	2-1/2"	3	400 MCM	210	1	26	18.19	8.19	5.79
MLBCG8	32132	3"	3	750 MCM	345	1	34	21.26	10.35	5.79
MLBCG9	32133	3-1/2"	3	1000 MCM	500	1	74	24.60	10.59	6.39
MLBCG10	32134	4"	3	1000 MCM	740	1	74	27.68	13.03	7.01

Mogul Conduit Bodies with Cover and Gasket

LB Type with Rollers

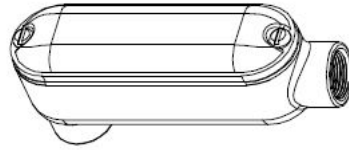

E195124

Conforms to finish thickness
ASTM A123/123M
UL listed
Fed. Spec. A-A-50563
NEMA FB 1



CSA Standard C22.2 No. 18.3
CSA Certified

Features

- Built in cable pulling roller
- Threaded NPT tapered hubs for Rigid and IMC conduit
- Smooth and round integral hub bushings protect conductor insulation
- Access to wiring for maintenance and future changes
- Assembled with raised cover, gasket and stainless steel cover screws

Applications

- Use to pull straight or 90° angle turns or making taps and splices
- Provides long and large openings for pulling large conductors, splicing and taps
- Serve as pull outlets for conductors that are stiff

Standard Material

- Body - Malleable iron
- Gasket - Neoprene rubber
- Screws - Stainless steel

Standard Finish

- Hot dip galvanized

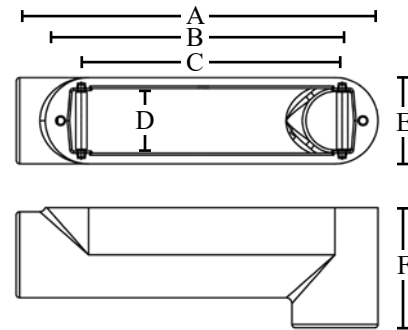

Catalog Number	UPC	Size	Max. Number	Max. Size	Internal Volume (in ³)	Ship Case	Weight/Case	Inches					
								A	B	C	D	E	F
MLB3CGHDG	00966	1"	3	4 AWG	19	1	4	8.62	5.98	---	1.71	2.19	2.81
MLB4CGHDG	00967	1-1/4"	3	2 AWG	25	1	5	8.62	5.98	---	1.71	2.19	3.25
MLB5CGHDG	00969	1-1/2"	3	1/0 AWG	57	1	9	12.72	10	9.17	2.26	3.03	3.63
MLB6CGHDG	00970	2"	3	4/0 MCM	75	1	13	12.72	10	9.17	2.26	3.03	4.23
MLB7CGHDG	00971	2-1/2"	3	300 MCM	163	1	22	16.93	15	10.86	3.41	4.27	5.22
MLB8CGHDG	00972	3"	3	350 MCM	211	1	38	16.93	15	10.86	3.41	4.27	6.02
MLB9CGHDG	00973	3-1/2"	3	500 MCM	375	1	48	22.20	19.96	15.08	4.28	5.31	6.71
MLB10CGHDG	00974	4"	3	500 MCM	439	1	59	22.20	19.96	15.08	4.28	5.31	7.19

Mogul Conduit Bodies with Cover and Gasket

C Type with Rollers



E195124

Conforms to finish thickness
ASTM A123/123M
UL listed
Fed. Spec. A-A-50563
NEMA FB 1



CSA Standard C22.2 No. 18.3
CSA Certified

Features

- Built in cable pulling roller
- Threaded NPT tapered hubs for Rigid and IMC conduit
- Smooth and round integral hub bushings protect conductor insulation
- Access to wiring for maintenance and future changes
- Assembled with raised cover, gasket and stainless steel cover screws

Applications

- Provides long and large openings for pulling large conductors, splicing and taps
- Serve as a pull outlets for conductors that are stiff

Standard Material

- Body - Malleable iron
- Gasket - Neoprene rubber
- Screws - Stainless steel

Standard Finish

- Hot dip galvanized

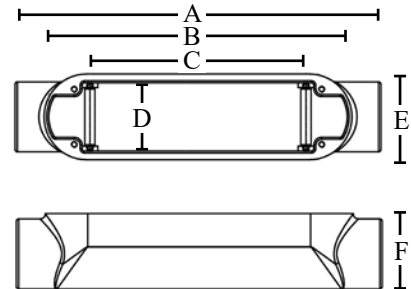

Catalog Number	UPC	Size	Max. Number	Max. Size	Internal Volume (in ³)	Ship Case	Weight/Case	Inches					
								A	B	C	D	E	F
MC3CGHDG	00956	1"	3	4 AWG	19	1	4	9.57	5.98	---	1.71	2.19	1.88
MC4CGHDG	00957	1-1/4"	3	2 AWG	25	1	6	9.57	5.98	---	1.71	2.19	2.13
MC5CGHDG	00958	1-1/2"	3	1/0 AWG	57	1	10	13.75	10	9.17	2.27	3.03	2.58
MC6CGHDG	00959	2"	3	4/0 MCM	75	1	14	13.75	10	9.17	2.27	3.03	3.17
MC7CGHDG	00960	2-1/2"	3	300 MCM	163	1	29	18.40	15	10.86	3.41	4.27	3.76
MC8CGHDG	00961	3"	3	300 MCM	211	1	38	18.40	15	10.86	3.41	4.27	4.57
MC9CGHDG	00965	3-1/2"	3	350 MCM	375	1	56	23.19	19.98	15.08	4.29	5.31	5.03
MC10CGHDG	00963	4"	3	350 MCM	439	1	65	23.19	19.98	15.08	4.29	5.31	5.52

Mogul Conduit Bodies with Cover and Gasket

T Type with Rollers

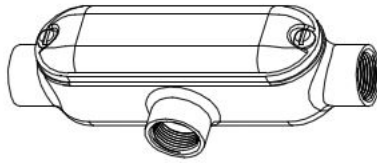

E195124
 Conforms to finish thickness
 ASTM A123/123M
 UL listed
 Fed. Spec. A-A-50563
 NEMA FB 1



CSA Standard C22.2 No. 18.3
 CSA Certified

Features

- Threaded NPT tapered hubs for Rigid and IMC conduit
- Smooth and round integral hub bushings protect conductor insulation
- Access to wiring for maintenance and future changes
- Assembled with raised cover, gasket and stainless steel cover screws

Applications

- Use to pull straight or 90° angle turns or making taps and splices
- Provides long and large openings for pulling large conductors, splicing and taps
- Serve as a pull outlets for conductors that are stiff

Standard Material

- Body - Malleable iron
- Gasket - Neoprene rubber
- Screws - Stainless steel

Standard Finish

- Hot dip galvanized

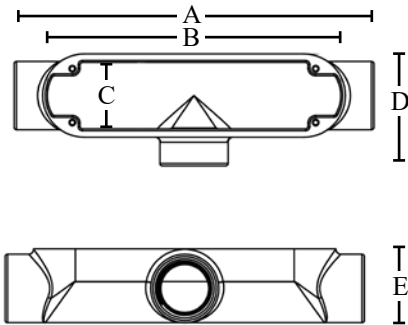

Catalog Number	UPC	Size	Max. Number	Max. Size	Internal Volume (in ³)	Ship Case	Weight/Case	Inches				
								A	B	C	D	E
MT3CGHDG	00976	1"	3	4 AWG	19	1	4	9.57	5.98	1.71	3.13	1.87
MT4CGHDG	00977	1-1/4"	3	2 AWG	25	1	6	9.57	5.98	1.71	3.13	2.31
MT5CGHDG	00978	1-1/2"	3	1/0 AWG	57	1	10	13.74	10	2.26	4.08	2.58
MT6CGHDG	00979	2"	3	4/0 MCM	75	1	14	13.74	10	2.26	4.08	3.17
MT7CGHDG	00980	2-1/2"	3	300 MCM	163	1	29	18.39	15	3.41	5.73	3.76
MT8CGHDG	00984	3"	3	300 MCM	211	1	38	18.39	15	3.41	5.73	4.57
MT9CGHDG	00982	3-1/2"	3	350 MCM	375	1	56	23.89	19.97	4.29	6.98	5.02
MT10CGHDG	00983	4"	3	350 MCM	439	1	65	23.89	19.97	4.29	6.98	5.51

Mogul Conduit Bodies with Cover and Gasket

LL Type with Rollers

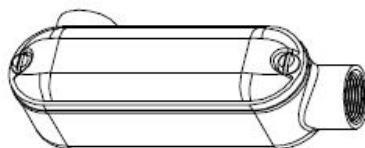

E195124

Conforms to finish thickness
ASTM A123/123M
UL listed
Fed. Spec. A-A-50563
NEMA FB 1



CSA Standard C22.2 No. 18.3
CSA Certified

Features

- Threaded NPT tapered hubs for Rigid and IMC conduit
- Smooth and round integral hub bushings protect conductor insulation
- Access to wiring for maintenance and future changes
- Assembled with raised cover, gasket and stainless steel cover screws

Applications

- Use to pull straight or 90° angle turns or making taps and splices
- Provides long and large openings for pulling large conductors, splicing and taps
- Serve as pull outlets for conductors that are stiff

Standard Material

- Body - Malleable iron
- Gasket - Neoprene rubber
- Screws - Stainless steel

Standard Finish

- Hot dip galvanized

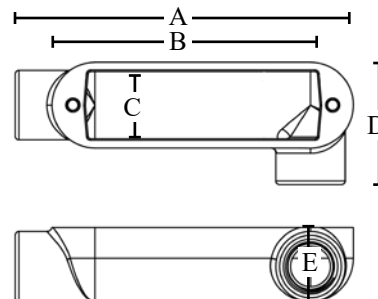

Catalog Number	UPC	Size	Max. Number	Max. Size	Internal Volume (in ³)	Ship Case	Weight/Case	Inches				
								A	B	C	D	E
MLL3CGHDG	00985	1"	3	4 AWG	19	1	4	8.62	5.98	1.71	3.12	1.87
MLL4CGHDG	00986	1-1/4"	3	2 AWG	25	1	6	8.62	5.98	1.71	3.12	2.31
MLL5CGHDG	00987	1-1/2"	3	1/0 AWG	57	1	10	12.72	10	2.26	4.08	2.58
MLL6CGHDG	00988	2"	3	4/0 AWG	75	1	14	12.72	10	2.26	4.08	3.17

Mogul Conduit Bodies with Cover and Gasket

LR Type

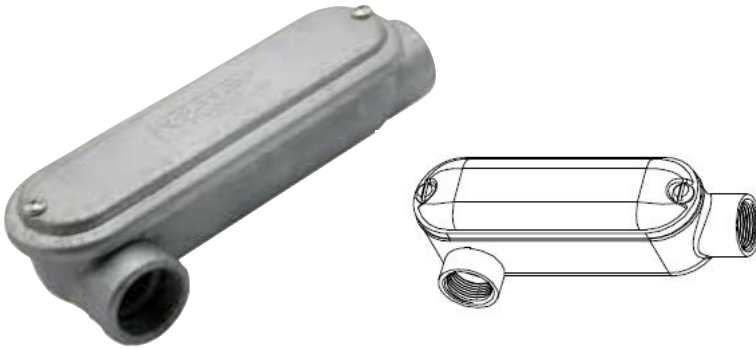

E195124

Conforms to finish thickness
ASTM A123/123M
UL listed
Fed. Spec. A-A-50563
NEMA FB 1



CSA Standard C22.2 No. 18.3
CSA Certified

Features

- Threaded NPT tapered hubs for Rigid and IMC conduit
- Smooth and round integral hub bushings protect conductor insulation
- Access to wiring for maintenance and future changes
- Assembled with raised cover, gasket and stainless steel cover screws

Applications

- Use to pull straight or 90° angle turns or making taps and splices
- Provides long and large openings for pulling large conductors, splicing and taps
- Serve as pull outlets for conductors that are stiff

Standard Material

- Body - Malleable iron
- Gasket - Neoprene rubber
- Screws - Stainless steel

Standard Finish

- Hot dip galvanized

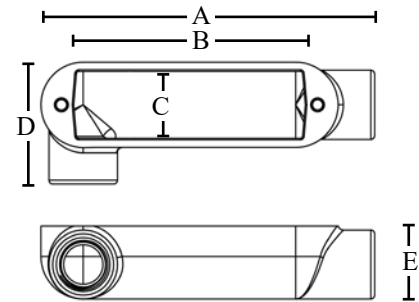

Catalog Number	UPC	Size	Max. Number	Max. Size	Internal Volume (in ³)	Ship Case	Weight/Case	Inches				
								A	B	C	D	E
MLR3CGHDG	00989	1"	3	4 AWG	19	1	4	8.62	5.98	1.71	3.12	1.87
MLR4CGHDG	00990	1-1/4"	3	2 AWG	25	1	6	8.62	5.98	1.71	3.12	2.31
MLR5CGHDG	00991	1-1/2"	3	1/0 AWG	57	1	10	12.72	10	2.26	4.08	2.58
MLR6CGHDG	00992	2"	3	4/0 AWG	75	1	14	12.72	10	2.26	4.08	3.17

Rigid Expansion Couplings



Conforms to finish thickness
 ASTM A123/123M
 UL 514B
 Wet location
 Fed. Spec. WF-408E
 NEMA FB 1

Features

- c(UL)us listed wet locations-concrete tight
- Internal grounding design prevents a need for external bonding jumpers and cables
- Internal bonding springs and metallic bushings
- Helps prevent conduit from buckling and ensuing circuit failures
- Hot dip galvanized finish provides superior protection against severe environmental factors
- For use with Rigid UL 6 Conduit

Applications

- Allows up to 4" of linear movement caused by thermal expansion and contraction. (2" in either direction on center)
- Weatherproof design is suitable for use on outdoor structures prone to movement like bridges, railroads, and buildings
- Use to join two sections of conduit subjected to longitudinal movement

Standard Material

- Body: Steel
- Reducer: Malleable Iron
- Packing: PTFE composite
- Washer & Bushing: Malleable Iron
- Gasket: PTFE composite
- Grounding Spring: Beryllium Bronze-electrogalvanized

Standard Finish

- Hot dip galvanized

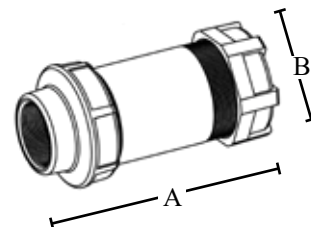

Catalog Number	UPC	Size	Ship Case	Weight/Case	Inches	
					A	B
TXJG14HDG	17788	1/2"	1	3	6.86	1.81
TXJG24HDG	15050	3/4"	1	4	7.14	2.16
TXJG34HDG	15067	1"	1	5	7.66	2.66
TXJG44HDG	15074	1-1/4"	1	8	7.96	3.17
TXJG54HDG	15081	1-1/2"	1	13	8.31	3.70
TXJG64HDG	15098	2"	1	20	8.71	4.43
TXJG74HDG	15104	2-1/2"	1	27	9.93	4.93
TXJG84HDG	15111	3"	1	30	10.01	5.44
TXJG94HDG	15128	3-1/2"	1	48	10.44	6.70
TXJG104HDG	15135	4"	1	52	10.44	6.70

Aluminum Elbows & Couplings



Rigid 45° and 90° Aluminum Elbows & Rigid Aluminum Couplings

Rigid Aluminum Elbows and Couplings provide lightweight, non-magnetic wiring solutions for dry, wet, exposed, concealed or hazardous locations and comply with the National Electrical Code® (NEC). With outstanding metallurgical properties, Aluminum Elbows and Couplings can be installed in areas like power plants, oil refineries and waste water treatment plants where corrosion resistance is required. Elbows are offered in 45 and 90 degree angles and available from 1/2" through 4" pipe size; couplings are available in 1/2" through 4" pipe size.

Conduit Body Covers

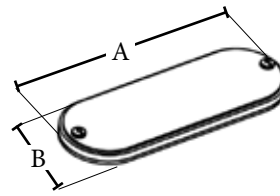

Conforms to finish thickness
ASTM A123/123M
UL 514A
Fed. Spec. A-A-50563
NEMA FB 1

Features

- Hot dip galvanized for added durability and corrosion protection, use with gasket for wet locations
- Includes screws

Applications

- Compatible with all Form 5 & Form 35 series conduit bodies
- For use with Topaz Conduit Bodies 1/2" - 4"

Standard Material

- Malleable iron
- Galvanized stainless steel screws

Standard Finish

- Hot dip galvanized

Catalog Number	UPC	Size	Unit Carton	Ship Case	Weight/Case	Inches	
						A	B
571MHDG	86663	1/2"	10	100	24	3.97	1.34
572MHDG	86664	3/4"	10	100	31	4.68	1.57
573MHDG	86665	1"	5	50	21	5.39	1.79
574MHDG	86666	1-1/4" - 1-1/2"	---	25	23	7.23	2.52
576MHDG	86667	2"	---	25	52	9.51	3.15
577MHDG	86668	2-1/2" - 3"	---	10	35	12.24	4.45
579MHDG	86669	3-1/2" - 4"	---	10	55	14.99	5.53

Conduit Body Gaskets

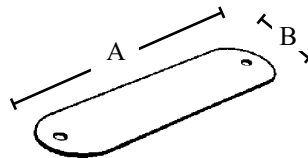

Features

- Provides dust proof seal between conduit body and cover to protect from hazardous elements
- Fits all Form 5 LB, LL, LR, C and T type conduit bodies and covers

Applications

- Compatible with all Form 5 & Form 35 series conduit bodies and covers
- For use with Topaz Conduit Bodies 1/2" - 4"

Standard Material

- Neoprene

Catalog Number	UPC	Size	Unit Carton	Ship Case	Weight/Case	Inches	
						A	B
581	15710	1/2"	50	500	1	3.935	1.36
582	15720	3/4"	50	500	1	4.60	1.55
583	15730	1"	25	500	2	5.37	1.76
584	15740	1-1/4" - 1-1/2"	25	500	2	7.25	2.50
586	15750	2"	25	250	2	9.50	3.07
587	15760	2-1/2" - 3"	10	100	2	12.125	4.355
589	15770	3-1/2" - 4"	5	50	2	14.812	5.40

Rigid Conduit Bodies

Threaded LB Type



Conforms to finish thickness ASTM A123/123M
UL 514A and UL 514B
Fed. Spec. A-A-50563
NEMA FB 1

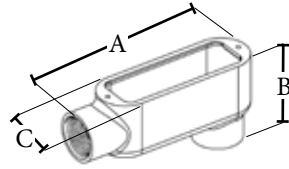

Features

- Hot dip galvanized finish provides superior protection against severe environmental factors

Applications

- Compatible with all Form 5 & Form 35 series conduit bodies and covers
- Provides taps for branch conduit runs
- Enables 90 degree bends in conduit runs

Standard Material

- Malleable iron

Standard Finish

- Hot dip galvanized

Catalog Number	UPC	Size	Wire Size		Internal Volume (in ³)	Ship Case	Weight/Case	Inches		
			Max. Number	Max. Size				A	B	C
LB1MHDG	86613	1/2"	---	---	4.5	10	7	4.69	2.18	1.36
LB2MHDG	86614	3/4"	3	6 AWG	7.5	10	9	5.42	2.36	1.57
LB3MHDG	86615	1"	3	4 AWG	12.5	5	6	6.28	2.86	1.79
LB4MHDG	86616	1-1/4"	3	2 AWG	32.3	5	12	8.12	3.49	2.52
LB5MHDG	86617	1-1/2"	3	1/0 AWG	35.3	2	11	8.15	3.69	2.52
LB6MHDG	86618	2"	3	4/0 AWG	73	1	6	10.53	4.52	3.15
LB7MHDG	86619	2-1/2"	3	300 MCM	142	1	10	13.76	5.39	4.45
LB8MHDG	86620	3"	3	400 MCM	173	1	13	13.82	6.18	4.45
LB9MHDG	86621	3-1/2"	3	500 MCM	300	1	22	16.65	7.19	5.53
LB10MHDG	86622	4"	3	500 MCM	328	1	24	16.65	7.36	5.53

Threaded LL Type



Conforms to finish thickness ASTM A123/123M
UL 514A and UL 514B
Fed. Spec. A-A-50563
NEMA FB 1

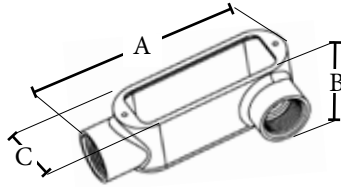

Features

- Hot dip galvanized finish provides superior protection against severe environmental factors

Applications

- Compatible with all Form 5 & Form 35 series conduit bodies and covers
- Provides taps for branch conduit runs
- Enables 90 degree bends in conduit runs

Standard Material

- Malleable iron

Standard Finish

- Hot dip galvanized

Catalog Number	UPC	Size	Wire Size		Internal Volume (in ³)	Ship Case	Weight/Case	Inches		
			Max. Number	Max. Size				A	B	C
LL1MHDG	86623	1/2"	---	---	4.5	10	7	4.69	1.46	2.08
LL2MHDG	86624	3/4"	3	6 AWG	7.5	10	10	5.42	1.65	2.31
LL3MHDG	86625	1"	3	4 AWG	12.5	5	6	6.28	1.98	2.68
LL4MHDG	86626	1-1/4"	3	2 AWG	32.3	5	13	8.12	2.60	3.41
LL5MHDG	86627	1-1/2"	3	1/0 AWG	35.3	2	6	8.15	2.80	3.45
LL6MHDG	86628	2"	3	4/0 AWG	73	1	6	10.53	3.52	4.15
LL7MHDG	86629	2-1/2"	3	300 MCM	142	1	10	13.76	3.98	5.86
LL8MHDG	86630	3"	3	350 MCM	173	1	13	13.82	4.65	5.92
LL9MHDG	86631	1/2"	3	350 MCM	300	1	22	16.65	5.43	7.14
LL10MHDG	86632	4"	3	350 MCM	330	1	24	16.65	5.74	7.19

Rigid Conduit Bodies

Threaded LR Type

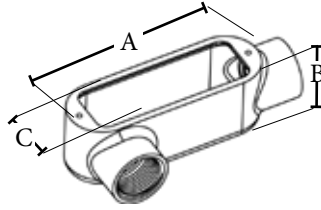

Conforms to finish thickness ASTM
A123/123M
UL 514A and UL 514B
Fed. Spec. A-A-50563
NEMA FB 1

Features

- Hot dip galvanized finish provides superior protection against severe environmental factors

Applications

- Compatible with all Form 5 & Form 35 series conduit bodies and covers
- Provides taps for branch conduit runs
- Enables 90 degree bends in conduit runs

Standard Material

- Malleable iron

Standard Finish

- Hot dip galvanized

Catalog Number	UPC	Size	Wire Size		Internal Volume (in ³)	Ship Case	Weight/Case	Inches		
			Max. Number	Max. Size				A	B	C
LR1MHDG	86633	1/2"	---	---	4.5	10	7	4.69	1.46	2.08
LR2MHDG	86634	3/4"	3	6 AWG	7.5	10	10	5.42	1.65	2.31
LR3MHDG	86635	1"	3	4 AWG	12.5	5	6	6.28	1.98	2.68
LR4MHDG	86636	1-1/4"	3	2 AWG	32.3	5	13	8.12	2.60	3.41
LR5MHDG	86637	1-1/2"	3	1/0 AWG	35.3	2	6	8.15	2.80	3.45
LR6MHDG	86638	2"	3	4/0 AWG	73	1	6	10.53	3.52	4.15
LR7MHDG	86639	2-1/2"	3	300 MCM	142	1	10	13.76	3.98	5.86
LR8MHDG	86640	3"	3	350 MCM	173	1	13	13.82	4.65	5.92
LR9MHDG	86641	3-1/2"	3	350 MCM	300	1	22	16.65	5.43	7.14
LR10MHDG	86642	4"	3	350 MCM	330	1	24	16.65	5.74	7.19

Threaded T Type

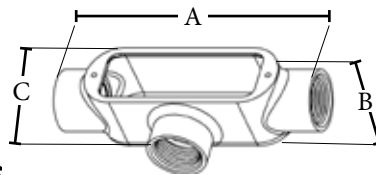

Conforms to finish thickness ASTM
A123/123M
UL 514A and UL 514B
Fed. Spec. A-A-50563
NEMA FB 1

Features

- Hot dip galvanized finish provides superior protection against severe environmental factors

Applications

- Compatible with all Form 5 & Form 35 series conduit bodies and covers
- Provides taps for branch conduit runs
- Enables 90 degree bends in conduit runs

Standard Material

- Malleable iron

Standard Finish

- Hot dip galvanized

Catalog Number	UPC	Size	Wire Size		Internal Volume (in ³)	Ship Case	Weight/Case	Inches		
			Max. Number	Max. Size				A	B	C
T1MHDG	86653	1/2"	---	---	4	10	9	5.35	1.31	2.02
T2MHDG	86654	3/4"	3	6 AWG	7	10	11	6	1.62	2.22
T3MHDG	86655	1"	3	4 AWG	12	5	8	7.06	1.88	2.56
T4MHDG	86656	1-1/4"	3	2 AWG	33	5	14	7.25	2.50	3.50
T5MHDG	86657	1-1/2"	3	1 AWG	36	2	6	9.25	2.67	3.50
T6MHDG	86658	2"	3	2/0 AWG	76	1	6	11.50	3.29	4.25
T7MHDG	86659	2-1/2"	3	300 MCM	146	1	12	15	3.94	5.72
T8MHDG	86660	3"	3	300 MCM	185	1	15	15.125	4.75	8.88
T9MHDG	86661	3-1/2"	3	350 MCM	300	1	27	18.125	5.20	6.81
T10MHDG	86662	4"	3	350 MCM	330	1	28	18.125	5.56	7.20

Rigid Conduit Bodies

Threaded C Type

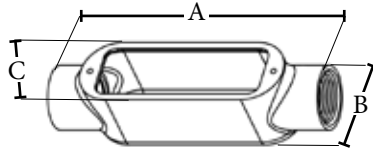

E195124

Conforms to finish thickness ASTM
A123/123M
UL 514A and UL 514B
Fed. Spec. A-A-50563
NEMA FB 1

Features

- Hot dip galvanized finish provides superior protection against severe environmental factors

Applications

- Compatible with all Form 5 & Form 35 series conduit bodies and covers
- Provides taps for branch conduit runs
- Enables 90 degree bends in conduit runs

Standard Material

- Malleable iron

Standard Finish

- Hot dip galvanized

Catalog Number	UPC	Size	Wire Size		Internal Volume (in ³)	Ship Case	Weight/Case	Inches		
			Max. Number	Max. Size				A	B	C
C1MHDG	86643	1/2"	---	---	4.5	10	6	5.43	1.46	1.36
C2MHDG	86644	3/4"	3	6 AWG	7.5	10	9	6.18	1.65	1.57
C3MHDG	86645	1"	3	4 AWG	12.5	5	6	7.16	1.98	1.79
C4MHDG	86646	1-1/4"	3	2 AWG	32.3	5	12	9	2.60	2.52
C5MHDG	86647	1-1/2"	3	1/0 AWG	35.3	2	6	9.07	2.80	2.52
C6MHDG	86648	2"	3	3/0 AWG	73	1	6	11.54	3.52	3.15
C7MHDG	86649	2-1/2"	3	250 MCM	138	1	10	15.28	3.98	4.45
C8MHDG	86650	3"	3	250 MCM	170	1	15	15.39	4.65	4.45
C9MHDG	86651	3-1/2"	3	350 MCM	300	1	27	18.30	5.43	5.53
C10MHDG	86652	4"	3	350 MCM	328	1	24	18.30	5.74	5.53

FS and FD Cast Device Single Gang Boxes

Single Hub - Heavy Duty



Conforms to finish thickness
ASTM A123/123M
UL 514A
Fed. Spec. A-A-50563
CSA C22.2 No. 18.3
NEMA FB-1

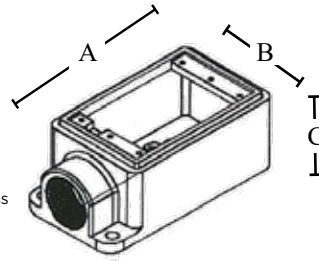

Features

- Suitable for use in concrete
- Tapered threaded hubs-NPT
- Internal grounding screw
- Suitable for wet locations when used with cover and neoprene gasket

Applications

- For use in areas where boxes are exposed to harsh locations
- Provides opening for making splices
- Serves as a pull box for conductors
- Allows connection for branch conduit runs

Standard Material

- Malleable iron

Standard Finish

- Hot dip galvanized

Catalog Number	UPC	Size	Ship Case	Weight/Case	Inches		
					A	B	C
FS TYPE							
FS1MHDG	01799	1/2"	10	24	6.07	2.93	2.20
FS2MHDG	01800	3/4"	10	25	6.07	2.93	2.20
FS3MHDG	01804	1"	10	25	6.07	2.93	2.20
FD TYPE - DEEP							
FD1MHDG	01805	1/2"	10	28	6.09	2.97	2.90
FD2MHDG	01806	3/4"	10	29	6.09	2.97	2.90
FD3MHDG	01811	1"	10	29	6.09	2.97	2.90

Dual Hub - Heavy Duty



Conforms to finish thickness
ASTM A123/123M
UL 514A
Fed. Spec. A-A-50563
NEMA FB-1
CSA C22.2 No. 18.3

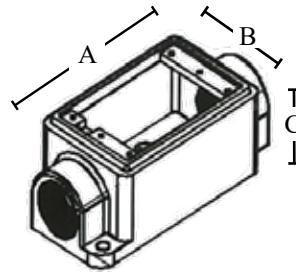

Features

- Suitable for use in concrete
- Tapered threaded hubs-NPT
- Internal grounding screw
- Suitable for wet locations when used with cover and neoprene gasket

Applications

- For use in areas where boxes are exposed to harsh locations
- Provides opening for making splices
- Serves as a pull box for conductors
- Allows connection for branch conduit runs

Standard Material

- Malleable iron

Standard Finish

- Hot dip galvanized

Catalog Number	UPC	Size	Ship Case	Weight/Case	Inches		
					A	B	C
FSC TYPE							
FSC1MHDG	01826	1/2"	10	26	6.08	2.94	2.20
FSC2MHDG	01813	3/4"	10	26	6.08	2.94	2.20
FSC3MHDG	01814	1"	10	26	6.08	2.94	2.20
FDC TYPE - DEEP							
FDC1MHDG	01815	1/2"	10	31	6.11	2.97	2.90
FDC2MHDG	01817	3/4"	10	31	6.11	2.97	2.90
FDC3MHDG	01819	1"	10	32	6.11	2.97	2.90

FS and FD Cast Device Double Gang Boxes

Dual Hub - Heavy Duty



Conforms to finish thickness
ASTM A123/123M
UL 514A
NEMA FB-1
Fed. Spec. A-A-50563
CSA C22.2 No. 18.3

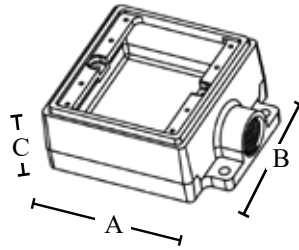

Features

- Suitable for use in concrete
- Tapered threaded hubs-NPT
- Internal grounding screw
- Suitable for wet locations when used with cover and neoprene gasket

Applications

- For use in areas where boxes are exposed to harsh locations
- Provides opening for making splices
- Serves as a pull box for conductors
- Allows connection for branch conduit runs

Standard Material

- Malleable iron

Standard Finish

- Hot dip galvanized

Catalog Number	UPC	Size	Ship Case	Weight/Case	Inches		
					A	B	C
FSC TYPE							
FSC21MHDG	01820	1/2"	10	34	5.32	4.71	2.20
FSC22MHDG	01821	3/4"	10	34	5.32	4.71	2.20
FSC23MHDG	01828	1"	10	37	5.32	4.71	2.20
FDC TYPE - DEEP							
FDC21MHDG	01822	1/2"	10	38	5.31	4.70	2.90
FDC22MHDG	01824	3/4"	10	39	5.31	4.70	2.90
FDC23MHDG	01825	1"	10	40	5.31	4.70	2.90

FS and FD Cast Device Single Gang Box Covers

Blank - Duplex - Guarded Square Switch



Features

- Each cover assembled with captive screws; FSBCM raintight if used with neoprene gasket

Applications

- For use with all Topaz FS and FD series boxes

Standard Material

- Malleable iron

Standard Finish

- Zinc plated

Catalog Number	UPC	Ship Case	Weight/Case
FSBCM	17557	25	14
FSDRM	17559	25	14
FSGSM	17558	25	16

Rigid Cable Support Body



Conforms to finish thickness ASTM
A123/123M
UL 514B
RoHS
Fed. Spec. A-A-50553
NEMA FB 1

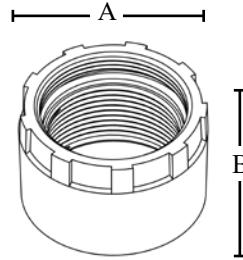

Features

- Threaded for Rigid Conduit and IMC
- Tapered inside surface is knurled to grip cable
- For two or more wires
- Cable Support Wood Chock is sold separately
- For use with threadless conduit or EMT, when used with male end threadless connector
- Use with all types of insulations at 600V

Applications

- Used to support non-armored electrical cables in vertical conduit risers

Standard Material

- Malleable Iron

Standard Finish

- Hot Dip Galvanized

Catalog Number	UPC	Size	Ship Case	Weight/ Case	Inches	
					A	B
CSB5	01865	1-1/2"	20	20	2.60	2.19
CSB6	01866	2"	10	17	3.19	2.36
CSB7	87171	2-1/2"	10	19	3.61	2.57
CSB8	87172	3"	10	25	4.30	2.78
CSB9	87173	3-1/2"	5	19	4.96	3.11
CSB10	87174	4"	5	25	5.51	3.36

Wood Cable Wedge Cable Support Wood Chock



Made in USA



Features

- One piece design
- Sand-Grip in grooves of wedge allow maximum support to the cable
- Will not be supplied undrilled

Applications

- For use with cable support bodies
- Must be purchased with cable support bodies (CSB5-CSB10)

Standard Material

- Impregnated hardwood

Standard Finish

- Black lacquer paint with sandy grit grooves

Catalog Number	UPC	Size	Ship Case	Weight/ Case	Max. Number of Cables	Inches	
						Diameter	Height
CS53	01879	1-1/2"	1	.4	3	1.75	1.77
CS54	01880	1-1/2"	1	.4	4	1.75	1.77
CS63	01881	2"	1	.4	3	2.14	2.11
CS64	01883	2"	1	.4	4	2.14	2.11
CS73	87217	2-1/2"	1	.4	3	2.754	3.012
CS74	87218	2-1/2"	1	.4	4	2.754	3.012
CS83	87219	3"	1	.5	3	3.251	3.012
CS84	87220	3"	1	.5	4	3.251	3.012
CS93	87221	3-1/2"	1	.6	3	3.758	3.014
CS94	87222	3-1/2"	1	.6	4	3.758	3.014
CS103	87223	4"	1	.7	3	4.251	3.014
CS104	87224	4"	1	.7	4	4.251	3.014

* Custom made wood chocks are non-returnable

** Wood chocks are sold with stamped cable diameter

Steel Boxes & Covers



Steel Boxes and Covers

Topaz's expanding line of UL Listed Steel Boxes and Covers are used to support a variety of Electrical applications. Choose from a vast assortment of Square, Octagon, Handy, Switch & Fan Boxes with a large array of UL listed covers designed specifically to fit each size box. Steel Boxes are offered with multiple KO's, depths, NM & MC clamps, brackets and adjustable ears for any project big or small. UL Listed and Made from durable galvanized steel, all boxes and covers are compatible with major brands.

Rigid Connectors

Set Screw Type



Conforms to finish thickness
ASTM A 123/123M
UL 514B
RoHS
Fed. Spec. A-A-50553
NEMA FB 1

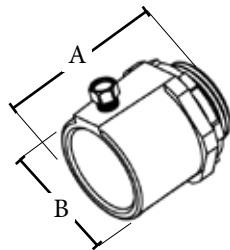

Features

- Hot dip galvanized for added durability and corrosion protection
- Concrete tight when taped
- Assembled with a die cast locknut

Applications

- Use to join unthreaded Rigid or IMC to box or enclosure

Standard Material

- Malleable iron
- Galvanized steel screw

Standard Finish

- Hot dip galvanized

Catalog Number	UPC	Size	Unit Carton	Ship Case	Weight/Case	Inches	
						A	B
671MHDG	86725	1/2"	25	250	51	1.51	1.17
672MHDG	86726	3/4"	---	25	7	1.75	1.39
673MHDG	86727	1"	---	25	11	1.98	1.66
674MHDG	86728	1-1/4"	5	50	33	2.22	2.01
675MHDG	86729	1-1/2"	5	50	41	2.44	2.25
676MHDG	86730	2"	---	20	22	2.52	2.75

Rigid Watertight Hubs



Conforms to finish thickness ASTM
A123/123M
UL467 and UL514B
RoHS
Fed. Spec. A-A-50552
NEMA FB 1

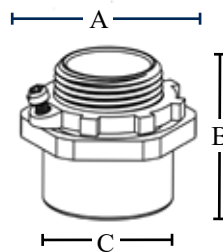

Features

- Flame-retardant insulated throat
- Male hub thread-NPT
- Female thread for Rigid conduit and IMC-NPT
- Recessed o-ring assures watertight and dust tight connections
- Type NHUB with insulated throat and bonding locknut is suitable for service entrance applications

Applications

- Indoor or outdoor use
- Use to connect Rigid or IMC conduit to a load center or other metal enclosure where a watertight joint is required at knockouts or slip-fit holes

Standard Material

- Malleable iron

Standard Finish

- Hot dip galvanized

Catalog Number	UPC	Size	Unit Carton	Ship Case	Weight/Case	Inches		
						A	B	C
201MHDG	00488	1/2"	25	250	58	1.36	1.54	1.09
202MHDG	00490	3/4"	10	100	34	1.50	1.77	1.30
203MHDG	00491	1"	10	100	52	1.77	2.15	1.59
204MHDG	00492	1-1/4"	2	20	17	1.93	2.50	1.94
205MHDG	00494	1-1/2"	2	20	21	1.97	3.01	2.20
206MHDG	00495	2"	---	10	15	2.05	3.35	2.68
207MHDG	00496	2-1/2"	---	5	14	2.76	3.92	3.25
208MHDG	00497	3"	---	5	19	2.99	4.74	3.92
209MHDG	00498	3-1/2"	---	5	24	3.09	5.39	4.46
210MHDG	00499	4"	---	1	8	3.31	5.91	4.82
210AMHDG	01862	5"	---	1	8	7.36	3.46	6.10
210BMHDG	01863	6"	---	1	11	8.39	3.62	7.25

Rigid Couplings

Set Screw Type



Conforms to finish thickness ASTM
A123/123M
UL 514B
RoHS
Fed. Spec. A-A-50553
NEMA FB 1

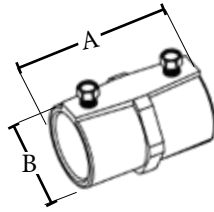

Features

- Set screw type coupling
- Concrete tight when taped
- Hot dip galvanized for added durability and corrosion protection

Applications

- Use to join two unthreaded lengths of Rigid conduit or IMC

Standard Material

- Malleable iron
- Galvanized steel screw

Standard Finish

- Hot dip galvanized

Catalog Number	UPC	Size	Unit Carton	Ship Case	Weight/Case	Inches	
						A	B
681MHDG	83222	1/2"	---	25	7	1.77	1.17
682MHDG	83223	3/4"	---	25	10	1.96	1.39
683MHDG	83225	1"	---	25	16	2.69	1.66
684MHDG	83227	1-1/4"	5	50	41	2.73	2.01
685MHDG	83229	1-1/2"	4	40	42	3.19	2.25
686MHDG	83231	2"	---	20	28	3.40	2.75

Three Piece Type



Conforms to finish thickness ASTM
A123/123M
UL 514B
RoHS
Fed. Spec. A-A-50553
NEMA FB 1

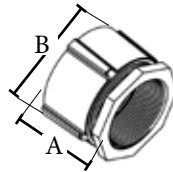

Features

- For threaded Rigid and IMC conduit
- Hot dip galvanized for superior protection against corrosion

Applications

- Use to join two lengths of threaded conduit or IMC when neither can be rotated

Standard Material

- Malleable iron

Standard Finish

- Hot dip galvanized

Catalog Number	UPC	Size	Unit Carton	Ship Case	Weight/Case	Inches	
						A	B
851HDG	83190	1/2"	20	200	24	1.36	1.31
852HDG	83191	3/4"	10	100	30	1.41	1.57
853HDG	83192	1"	5	50	23	1.62	1.87
854HDG	83193	1-1/4"	5	50	55	1.83	2.28
855HDG	83194	1-1/2"	3	30	44	1.94	2.59
856HDG	83195	2"	2	20	44	2.23	3.14
857HDG	83197	2-1/2"	---	10	37	3.09	3.72
858HDG	83199	3"	---	5	20	3.19	4.37
859HDG	83201	3-1/2"	---	5	28	3.37	4.90
860HDG	83204	4"	---	2	18	3.45	5.44
860AHDG	83205	5"	---	1	9	4.38	7
860BHDG	83206	6"	---	1	11	4.38	8.25

Rigid Offset Nipples

3/4" Offset



E148716

Conforms to finish thickness ASTM
A123/123M
UL 514B
RoHS
Fed. Spec. A-A-50553
NEMA FB 1

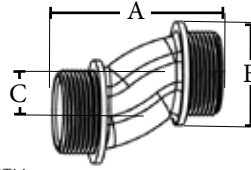

Features

- NPSM thread: Smooth inside surface to facilitate wire pulling free of damage

Applications

- Indoor or outdoor use
- Use as an offset connector between two enclosures
- Offsets the axis of the raceways by 3/4"

Standard Material

- Malleable iron

Standard Finish

- Hot dip galvanized

Catalog Number	UPC	Size	Unit Carton	Ship Case	Weight/Case	A	Inches B	C
111MHDG	83207	1/2"	10	100	20	2.81	1.02	.75
112MHDG	83208	3/4"	10	100	29	2.75	1.25	.75
113MHDG	83209	1"	10	100	39	2.87	1.56	.75
114MHDG	83211	1-1/4"	5	50	32	3.13	2	.75
115MHDG	83213	1-1/2"	5	50	40	3.13	2.31	.75
116MHDG	83215	2"	2	20	21	3.06	2.76	.75
117MHDG	83217	2-1/2"	---	2	3	3.97	3.26	.75
118MHDG	83219	3"	---	2	5	4.43	3.81	.75
119MHDG	83221	3-1/2"	---	1	4	4.82	4.38	.75
119AMHDG	86724	4"	---	1	4	5.04	4.96	.75

Rigid Straps

One Hole



E174011

Conforms to finish thickness ASTM A123/123M
UL 2239
Fed. Spec. A-A-50553
NEMA FB 1

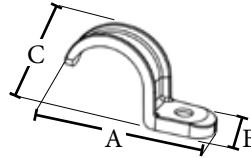

Features

- Hot dip galvanized for added durability and corrosion protection

Applications

- Use to secure Rigid or IMC conduit to wood, masonry or similar surfaces where greater load bearing is required

Standard Material

- Malleable iron

Standard Finish

- Hot dip galvanized

Catalog Number	UPC	Size	Unit Carton	Ship Case	Weight/Case	A	Inches B	C
561HDG	86589	1/2"	100	1000	40	1.98	.67	.97
562HDG	86590	3/4"	50	500	25	2.37	.76	1.10
563HDG	86591	1"	25	250	20	2.90	.82	1.44
564HDG	86592	1-1/4"	20	250	25	3.12	.82	1.77
565HDG	86593	1-1/2"	10	200	32	3.90	1.05	2.06
566HDG	86594	2"	---	100	36	4.77	1.36	2.59
567HDG	86595	2-1/2"	---	25	17	5.45	1.36	3.05
568HDG	86596	3"	---	25	25	6.74	1.54	3.77
569HDG	86597	3-1/2"	---	25	38	7.72	1.91	4.24
570HDG	86598	4"	---	10	23	8.13	2.07	4.98
570AHDG	86599	5"	---	10	34	10.94	2.55	6.22
570BHDG	86600	6"	---	10	40	12.71	2.91	7.45

EMT/Rigid Clamp Backs



Conforms to finish thickness ASTM
A123/123M
UL 2239
RoHS
Fed. Spec. A-A-50553
NEMA FB 1

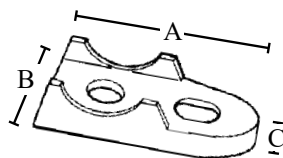

Features

- Hot dip galvanized for added durability and corrosion protection

Applications

- For use in wet or dry locations in conjunction with malleable Rigid conduit straps to create space between conduit and mounting surface

Standard Material

- Malleable iron

Standard Finish

- Hot dip galvanized

Catalog Number	UPC	Size	Unit Carton	Ship Case	Weight/Case	A	B Inches	C
481HDG	86601	1/2"	25	250	15	2.06	1.01	.44
482HDG	86602	3/4"	25	250	23	2.44	1.20	.48
483HDG	86603	1"	25	250	35	2.92	1.31	.56
484HDG	86604	1-1/4"	10	100	21	3.41	1.49	.67
485HDG	86605	1-1/2"	10	100	27	3.78	1.52	.76
486HDG	86606	2"	5	50	22	4.73	1.92	.80
487HDG	86607	2-1/2"	---	25	14	5.48	2.42	.80
488HDG	86608	3"	---	10	9	6.66	2.63	.83
489HDG	86609	3-1/2"	---	12	10	7.12	2.87	1.03
489AHDG	86610	4"	---	18	21	8.43	3.12	1.09
489BHDG	86611	5"	---	10	21	10.78	3.68	1.30
489CHDG	86612	6"	---	10	29	12.68	3.96	1.89

Rigid Bushings

Insulated - 105°C Thermoplastic Liner



E148716
Conforms to finish thickness
ASTM A123/123M
UL 514A
Fed. Spec. A-A-50563
CSA C22.2 No. 18.3
NEMA FB-1

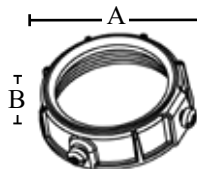

Features

- Liner is rated flame retardant to 105°C

Applications

- Indoor or outdoor use
- Use with locknut to terminate Rigid or IMC conduit to an outlet box
- Plastic liner prevents damage to wire insulation

Standard Material

- Malleable iron
- Plastic insulator

Standard Finish

- Hot dip galvanized

Catalog Number	UPC	Size	Unit Carton	Ship Case	Weight/Case	A	B
311MHDG	02332	1/2"	40	400	29	1.08	.57
312MHDG	02333	3/4"	40	400	35	1.31	.57
313MHDG	02334	1"	25	250	31	1.61	.65
314MHDG	02310	1-1/4"	20	200	29	1.91	.71
315MHDG	02311	1-1/2"	10	100	23	2.16	.73
316MHDG	02312	2"	10	100	25	2.72	.73
317MHDG	02313	2-1/2"	5	50	24	3.23	.94
318MHDG	02314	3"		25	13	3.88	.94
319MHDG	02315	3-1/2"		10	7	4.43	.94
320MHDG	02318	4"		10	8	4.89	.94

Insulated Metallic Grounding Bushings With Aluminum Lay-In Lug

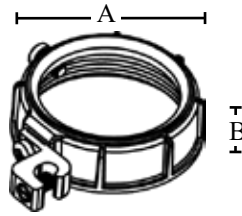

E195122

Conforms to finish thickness ASTM
A123/123M
UL 514B and UL 467
RoHS
Fed. Spec. A-A-50553
NEMA FB 1

Features

- Hot dip galvanized for superior protection against corrosion
- Tin plated aluminum alloy 6061-T6 rated for AL and CU conductor
- Liner is rated flame retardant to 105°C
- UL listed for use with copper or aluminum grounding conductor

Applications

- Use to provide a means of grounding Rigid or IMC conduit
- Indoor or outdoor use (aluminum lug)
- Use with locknut to terminate service conduit to a cabinet
- Lug provided for bonding jumper to a neutral bus bar
- Round surface of bushing prevents damage to wire insulation
- Plastic liner prevents damage to wire insulation

Standard Material

- Body - Malleable iron
- Plastic insulator
- Lug - Aluminum
- Clamping screw - Steel
- Set screws - Steel

Standard Finish

- Hot dip galvanized

Catalog Number	UPC	Size	Grounding Lug Wire Size		Unit Carton	Ship Case	Weight/Case	Inches	
			Min.	Max.				A	B
331MHDG	86684	1/2"	14	4	50	500	45	1.08	.57
332MHDG	86685	3/4"	14	4	50	500	50	1.31	.57
333MHDG	86686	1"	14	4	25	250	32	1.61	.65
334MHDG	86688	1-1/4"	14	4	20	200	36	1.91	.71
335MHDG	86690	1-1/2"	14	4	10	100	25	2.16	.73
336MHDG	86692	2"	14	4	10	100	30	2.72	.73
337MHDG	86693	2-1/2"	14	1/0	5	50	25	3.23	.94
338MHDG	86695	3"	14	1/0	---	25	18	3.88	.94
339MHDG	86697	3-1/2"	14	1/0	---	10	20	4.43	.94
340MHDG	86699	4"	14	1/0	---	10	24	4.89	.94
340ALMHDG	86701	5"	6	250 MCM	---	10	27	6.10	1.14
340BLMHDG	86702	6"	6	250 MCM	---	10	32	7.15	1.14

Insulated Metallic Grounding Bushings With Copper Lay-In Lug

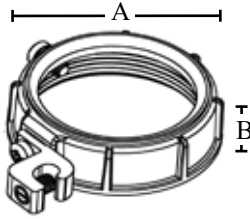

Conforms to finish thickness ASTM
A123/123M
UL 514B and UL 467
RoHS
Fed. Spec. A-A-50553
NEMA FB 1

Features

- Hot dip galvanized for superior protection against corrosion
- Copper lay in lug
- Liner is rated flame retardant to 105°C
- UL listed for use with copper or aluminum grounding conductor

Applications

- Use to provide a means of grounding Rigid or IMC conduit
- Indoor or outdoor use
- Use with locknut to terminate service conduit to a cabinet
- Lug provided for bonding jumper to a neutral bus bar
- Round surface of bushing prevents damage to wire insulation
- Plastic liner prevents damage to wire insulation

Standard Material

- Body - Malleable iron
- Plastic insulator
- Lug - copper
- Clamping screw - steel
- Set screws - steel

Standard Finish

- Body -Hot dip galvanized

Catalog Number	UPC	Size	Grounding Lug Wire Size		Unit Carton	Ship Case	Weight/Case	A	B
			Min.	Max.					
331CMHDG	02319	1/2"	14	4	25	250	32	1.08	.57
332CMHDG	02320	3/4"	14	4	25	250	35	1.31	.57
333CMHDG	02321	1"	14	4	20	200	35	1.61	.65
334CMHDG	02322	1-1/4"	14	4	15	150	30	1.91	.71
335CMHDG	02323	1-1/2"	14	4	10	100	28	2.16	.73
336CMHDG	02324	2"	14	4	10	100	29	2.72	.73
337CMHDG	02325	2-1/2"	14	4	5	50	27	3.23	.94
338CMHDG	02326	3"	14	4	---	25	14	3.88	.94
339CMHDG	02327	3-1/2"	14	4	---	10	7	4.43	.94
340CMHDG	02328	4"	14	4	---	10	8	4.89	.94

Right Angle Conduit Support



E174011

Conforms to finish thickness
ASTM A123/123M
UL 2239
RoHS
Fed. Spec. A-A-50553
NEMA FB1

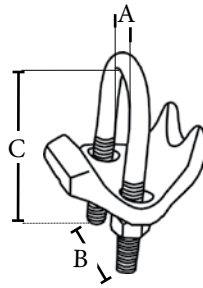

Features

- Hot dip galvanized for added durability and corrosion protection
- Provides a secure connection and tight clamping action capable of withstanding heavy load

Applications

- Right angle conduit clamps are used to mount EMT or Rigid conduit across or perpendicular to beam, channel or angle supports

Standard Material

- Malleable iron
- Galvanized steel hardware

Standard Finish

- Hot dip galvanized

Catalog Number	UPC	Size	Ship Case	Weight/ Case	Inches		
					A	B	C
1551HDG	86579	1/2"	50	20	.97	1.24	2.46
1552HDG	86580	3/4"	50	22	1.15	1.43	2.76
1553HDG	86581	1"	50	24	1.42	1.70	3.01
1554HDG	86582	1-1/4"	50	27	1.79	2.07	3.16
1555HDG	86583	1-1/2"	50	29	2.04	2.32	3.52
1556HDG	86584	2"	25	22	2.49	2.83	4.39
1557HDG	86585	2-1/2"	25	27	3.06	3.39	4.75
1558HDG	86586	3"	25	28	3.65	3.98	5.38
1559HDG	86587	3-1/2"	25	32	4.21	4.55	5.76
1559AHDG	86588	4"	25	35	4.69	5.03	6.27

Parallel Conduit Support



E174011

Conforms to finish thickness
ASTM A123/123M
UL 2239
RoHS
Fed. Spec. A-A-50553
NEMA FB1

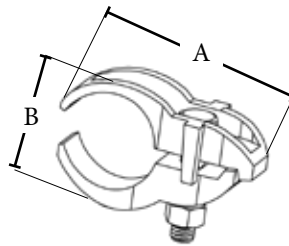

Features

- Hot dip galvanized for added durability and corrosion protection
- Provides a secure connection and tight clamping action capable of withstanding heavy loads

Applications

- Parallel conduit supports are used to mount EMT, Rigid or IMC conduit parallel to a beam, channel or angle support

Standard Material

- Malleable iron
- Galvanized steel hardware

Standard Finish

- Hot dip galvanized

Catalog Number	UPC	Size	Ship Case	Weight/ Case	Inches	
					A	B
1561HDG	83233	1/2"	50	29	2.80	1.42
1562HDG	83235	3/4"	50	32	2.99	1.47
1563HDG	83236	1"	50	35	3.19	1.54
1564HDG	86554	1-1/4"	25	18	3.39	2.01
1565HDG	86555	1-1/2"	25	24	3.62	2.01
1566HDG	86556	2"	25	25	4.37	2.87
1567HDG	86557	2-1/2"	10	14	5.12	3.23
1568HDG	86558	3"	10	16	5.79	4.06
1569HDG	86559	3-1/2"	10	19	6.26	4.53
1570HDG	86560	4"	10	22	6.46	4.61

Edge Type Conduit Support



E174011
 Conforms to finish thickness
 ASTM A123/123M
 UL 2239
 RoHS
 Fed. Spec. A-A-50553
 NEMA FB1

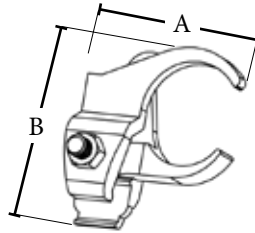

Features

- Hot dip galvanized for added durability and corrosion protection
- Provides a secure connection and tight clamping action capable of withstanding heavy loads

Applications

- Edge type conduit supports are used to mount EMT or Rigid conduit perpendicular to a beam, channel or angle supports

Standard Material

- Malleable iron
- Galvanized steel hardware

Standard Finish

- Hot dip galvanized

Catalog Number	UPC	Size	Ship Case	Weight/Case	Inches	
					A	B
1571HDG	86561	1/2"	50	34	2.10	2.72
1572HDG	86562	3/4"	50	36	2.44	3.01
1573HDG	86563	1"	50	43	2.57	3.23
1574HDG	86564	1-1/4"	25	23	2.96	3.47
1575HDG	86565	1-1/2"	25	29	3.27	3.65
1576HDG	86566	2"	25	34	3.85	4.36
1577HDG	86567	2-1/2"	10	19	4.40	5.05
1578HDG	86568	3"	10	23	5.08	5.41

RMC U-Bolt with Hex Nuts



UL 2239

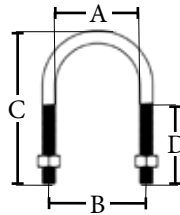

Features

- For use with EMT/Rigid/IMC
- Heavy duty hex nuts included
- Engineered to withstand high stress applications

Applications

- Safely run and support conduit in electrical systems

Standard Material

- Steel

Standard Finish

- Mechanical galvanized

Catalog Number	UPC	Size	Unit Carton	Ship Case	Weight/Case	Inches			
						A	B	C	D
761HDG	86569	1/2"	25	250	13	.97	1.24	2.46	1.50
762HDG	86570	3/4"	25	250	16	1.15	1.43	2.76	1.50
763HDG	86571	1"	25	250	16	1.42	1.70	3.01	1.50
764HDG	86572	1-1/4"	---	20	16	1.79	2.07	3.16	1.50
765HDG	86573	1-1/2"	---	20	19	2.04	2.32	3.52	1.50
766HDG	86574	2"	---	20	31	2.49	2.83	4.39	1.96
767HDG	86575	2-1/2"	---	20	31	3.06	3.39	4.75	1.96
768HDG	86576	3"	---	20	38	3.65	3.98	5.38	1.96
769HDG	86577	3-1/2"	---	20	41	4.21	4.55	5.76	1.96
770HDG	86578	4"	---	20	43	4.69	5.03	6.27	1.96



NY Office

925 Waverly Avenue
Holtsville, NY 11742
800.666.2852
Fax | 631.654.1261

CA Office

225 Parkside Drive
San Fernando, CA 91340
888.551.2852 or 818.838.3123
Fax | 888.690.2852 or 818.838.3102

FL Office

3850 20th Street, Suite 600
Vero Beach, FL 32960
800.338.2852
Fax | 772.778.5386

info@topaz-usa.com | www.topaz-usa.com