

### INSTALLATION SHEET

#### Series 33 Fire Rated Pathway

ZIS1003

Rev. 03/2014

#### GENERAL - READ COMPLETELY BEFORE INSTALLING

This product allows for several optional installation methods. Available methods for walls are shown here. The pathway device consists of an enclosed heavy gauge galvanized steel channel with a detachable lid. Depending on the type ordered, mounting plates and gaskets are either included or may be ordered separately. Mounting plates are designed to accommodate single, double, or triple device installations. Component requirements will vary according to the method of installation chosen. See Table B for additional information.

NOTE: WALL INSTALLATIONS REQUIRE THIS DEVICE TO BE INSTALLED WITH THE TOP (LID) FACING UPWARD. The lid may be identified by the BARRIER GAUGE stamping. WALL PLATES ARE ASYMMETRICAL and are marked with the word TOP.

### CREATING THE OPENING

#### Gypsum Board Walls (Square Openings):

1. Locate suitable area of the wall to penetrate making sure that there are no studs, wires, pipes or other obstructions located within wall.
2. Mark a square or rectangular opening as dimensioned in Table A. Make sure opening is square and plumb. The inside opening of the mounting plates can be used as a template (See Fig. 1).
3. Using a keyhole saw, cut wall board (See Fig. 2). Cutting to the outside of the line will produce a slightly over-sized opening. Mark and cut opposite side of the wall, exercising care to align both openings. Insert pathway and check for fit. Remove pathway.
4. Install device per instructions below.

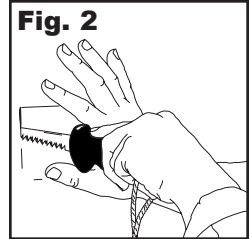
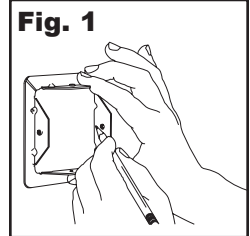

#### Concrete or Masonry Walls (Square or Round Openings):

1. Cut or form a square or rectangular opening or core drill a round opening per dimensions listed in Table A.

### INSTALLING PATHWAY USING WALL PLATES

#### Prior to Pulling Cables

Device is installed through wall and attached using wall plates to sandwich the wall. No mechanical attachment to wall itself is required.

1. If necessary, pre-install required set screws in mounting plates using Allen wrench (provided). NOTE: When installing a single wall plate and pathway, two set screws positioned and tightened at 90 degrees to each other in both plates will adequately hold device (See Fig. 3). Multiple devices in a ganged installation using double (Cat No. EZP233W) or triple mounting plates (EZP333W) require EVERY set screw to be installed.
2. Install a mounting plate around pathway making sure that set screw flanges are facing towards the end of the device. NOTE: Position plate so that the word TOP stamped on the plate aligns with the lid of the pathway. Use gauge marks located on lid of pathway to adjust plate to thickness of wall (See Fig. 4). This will center pathway within the wall. When properly adjusted, tighten set screws to lock plate onto pathway.
3. Place one of two provided gaskets around opposite end of pathway and carefully slide it back to fit snugly against back side (wall side) of plate.
4. Insert pathway device through wall (with TOP facing upwards) using previously installed mounting plate and gasket as a stop (See Fig. 5).
5. Moving to the opposite side of the wall, install remaining gasket around pathway and slide toward wall.
6. Install remaining mounting plate around pathway (TOP up) and slide it toward wall surface. While pulling pathway toward you, push wall plate and gasket tightly to wall and tighten set screws. Check device for excessive play. If device appears to be loose or can easily be moved, readjust mounting plates as necessary to tighten device firmly against wall.

CONFIGURATION	SINGLE	DOUBLE	TRIPLE
<b>Square or Rectangular Using Mounting Plates - Gypsum Board or Masonry</b>			
Opening Height	3-1/8" (79 mm)	3-1/8" (79 mm)	3-1/8" (79 mm)
Opening Width	3-1/8" (79 mm)	6-1/8" (156 mm)	9-1/8" (232 mm)
<b>Square (Using Sealant - No Mounting Plates) - Gypsum Board or Masonry</b>			
Opening Height	3-1/8" (79 mm)	N/A	N/A
Opening Width	3-1/8" (79 mm)	N/A	N/A
<b>Round (Using Sealant - No Mounting Plates) - Masonry</b>			
Opening Diameter	4" (102 mm)	N/A	N/A

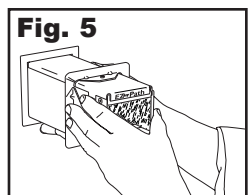
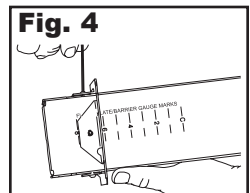
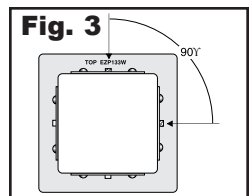

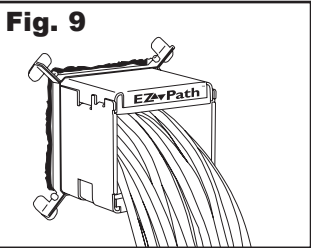
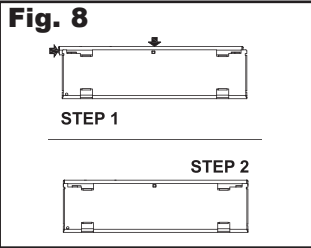
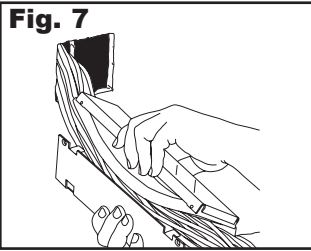
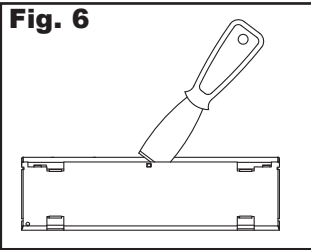

## Old Work Installations (Cables Already Installed):

**IMPORTANT NOTE: This installation applies to the use of SINGLE devices only.**

1. Remove the pathway lid by unscrewing the two screws and sliding the lid out of the channel attachment tabs (on opposite side). If the device does not contain two screws, locate the side of the device with a rectangular lock and insert a small flat head screw driver or steel spatula into the seam between the lid and the channel (See Figure 6). Slide the lid away from the channel.
2. Cut and remove elastic band wrapped around intumescent pads.
3. Place pathway channel around the cables (See Fig. 7).
4. If the device does not contain screws, align the tabs in the lid and the channel (See Figure 8). Replace the lid and reinstall the screws, if necessary. Continue to install per the following steps for New Cable Installation.

**TABLE B: Required Components**

**New Cable Installations Using Mounting Plates**

	Pathway Kit (All components included)	Pathway	Mounting Plate Kits	Positioning Clamp Kit
Single Pathway	(1) EZDP33FWS	(1) EZD33FWS	(1) EZP133W	N/A
Double Pathway	(1) EZDP233GK	(2) EZD33FWS	(1) EZP233W	N/A
Triple Pathway	(1) EZDP333GK	(3) EZD33FWS	(1) EZP333W	N/A

**New/Existing Cable Installations Using Sealant**

Single Pathway	N/A	(1) EZD33FWS	N/A	(1) EZP133PC
----------------	-----	--------------	-----	--------------

### New or Existing Cable Installation

1. With fastening screw removed, install optional Positioning Clamp (Cat No. EZP133PC) around cable bundle and slide over pathway making sure that the flat feet of clamp are facing towards wall surface. Use gauge marks located on pathway to adjust clamp to thickness of wall. When properly adjusted, lock clamp in place by installing and tightening fastening screw.
2. Slide device into properly sized opening and center within wall (See Fig. 9).
3. Moving to opposite side of wall, install second clamp around pathway and snug tightly to wall. Tighten clamp securely.
4. Caulk using approved sealant (SpecSeal® Series SSS, LCI, LC, or SIL300 Sealants). Apply sealant to a depth of 5/8" (16 mm) within annulus on both sides of wall. Apply a 3/8" (9.6 mm) crown bead at areas of point contact.

## INSTALLING or PULLING CABLES

A resilient liner provides an adjustable seal within the pathway device. Liner must be protected from damage while adding or removing cables. Wrap cable ends with a suitable low friction tape before inserting into the pathway. Where cable lubricants are used, low solids, water-based products are recommended. This device is designed to be fully functional at all cable loadings from completely empty to visually filled, and cables should easily slide through the pathway using minimal effort. **IF RESISTANCE IS ENCOUNTERED, DO NOT FORCE CABLES OR CABLE BUNDLES THROUGH THE PATHWAY. DAMAGE MAY RESULT.** Upper curved liner may be depressed when inserting cables, if necessary, using a flat, smooth implement and then removing it after cables are installed. The rectangular shape of the loading area coupled with gentle pressure exerted by resilient liners will naturally distribute the cables at a relatively uniform height across the width of the device. The use of a cable dressing/combining instrument to straighten and organize cables may help to maximize usable space within the pathway device.

## GROUNDING

At the option of the installer, this device may be grounded. After device(s) has been installed, insert ground screws where indicated (See Fig. 10). For installations using single, double, or triple mounting plates, or optional positioning clamps, two ground screws are required and are included in these kits.

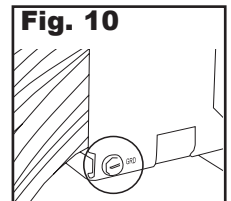

## WALL LABELING

Wall labels are provided with the pathway device as well as mounting plate kits. Larger orange colored label is intended to be used to identify the pathway's installer as well as to provide applicable UL System information. Smaller secondary labels are included with double and triple mounting plates as an optional method for identifying or marking cable types, uses, or trades. Two sets of labels are provided for marking both sides of wall.

## MAINTENANCE

No maintenance of the pathway is normally required. Interior of device should be inspected before and after any modifications to cable bundle. If any damage to intumescent pads lining top and bottom of the pathway is found, contact the factory to determine if replacement is required.

**LIMITED WARRANTY:** STI warrants that its products will be free of defects for one year from the date of purchase. In the event a product does not conform to this warranty, the sole and exclusive remedy is, at STI's option, replacement of the product or refund of the purchase price. The warranty provided herein shall be void and of no effect in the event that the product is not installed in accordance with STI's published instructions, listed systems and applicable building and safety codes. THIS WARRANTY IS IN LIEU OF ALL OTHER REPRESENTATIONS AND EXPRESSED OR IMPLIED WARRANTIES (including the implied warranties of merchantability or fitness for a particular use) AND UNDER NO CIRCUMSTANCES SHALL STI BE LIABLE FOR ANY DIRECT, INDIRECT, SPECIAL, INCIDENTAL OR CONSEQUENTIAL DAMAGES OR LOSSES, INCLUDING, WITHOUT LIMITATION, ANY LOSS OF REVENUE, PROFIT OR USE. Prior to use, the user shall determine the suitability of the product for its intended use, and the user assumes all risks and liability for subsequent use. No person other than an officer of STI is authorized to bind STI to any other warranty for any product for which this warranty is issued.

MADE IN USA • PRINTED IN USA – COPYRIGHT © 2014 SPECIFIED TECHNOLOGIES INC.



Somerville, NJ 08876 USA  
Phone: (800) 992-1180 • Fax: (908) 526-9623  
www.stifirestop.com