

## MaxLite® LED Wall Packs (Cutoff & Standard)

### General Safety Information

- To reduce the risk of death, personal injury or property damage from fire, electric shock, falling parts, cuts/abrasions, and other hazards read all warnings and instructions included with and on the fixture box and all fixture labels.
- Before installing, servicing, or performing routine maintenance upon this equipment, follow these general precautions.
- Commercial installation, service and maintenance of luminaires should be performed by a qualified licensed electrician.
- For Residential installation: If you are unsure about the installation or maintenance of the luminaires, consult a qualified licensed electrician and check your local electrical code.
- **DO NOT INSTALL DAMAGED PRODUCT!**
- This fixture is intended to be connected to a properly installed and grounded UL listed junction box.

#### **WARNING:**

##### **RISK OF ELECTRICAL SHOCK**

- Turn off electrical power at fuse or circuit breaker box before wiring fixture to the power supply.
- Turn off the power when you perform any maintenance.
- Verify that supply voltage is correct by comparing it with the luminaire label information.
- Make all electrical and grounded connections in accordance with the National Electrical Code and any applicable local code requirements.
- All wiring connections should be capped with UL approved wire connectors.

#### **CAUTION:**

##### **RISK OF INJURY**

- Wear gloves and safety glasses at all times when removing luminaire from carton, installing, servicing or performing maintenance.
- Avoid direct eye exposure to the light source while it is on.
- Account for small parts and destroy packing material, as these may be hazardous to children.

#### **CAUTION:**

##### **RISK OF FIRE**

- Keep combustible and other materials that can burn away from luminaire and lamp/lens
- MIN 90°C SUPPLY CONDUCTORS.

**WPS20AU50XXXXX** 120-277V 50/60 Hz  
**WPS30AU50XXXXX** 120-277V 50/60 Hz  
**WPCS20AU50BXXXXX** 120-277V 50/60 Hz  
**WPCS30AU50BXXXXX** 120-277V 50/60 Hz  
**WPCL40AU50BXXXXX** 120-277V 50/60 Hz  
**WPCL55AU50BXXXXX** 120-277V 50/60 Hz  
**WPS20AU50BXXXXX** 120-277V 50/60 Hz  
**WPS30AU50BXXXXX** 120-277V 50/60 Hz  
**WPL40AU50BXXXXX** 120-277V 50/60 Hz  
**WPL55AU50BXXXXX** 120-277V 50/60 Hz

**WPL80AU50B** 120-277V 50/60 Hz  
**WPS20A350XXXXX** 347V 50/60 Hz  
**WPS30A350XXXXX** 347V 50/60 Hz  
**WPCS20A350XXXXX** 347V 50/60 Hz  
**WPCS30A350XXXXX** 347V 50/60 Hz  
**WPL55AH50XXXXX** 347-480V 50/60 Hz  
**WPL40AH50XXXXX** 347-480V 50/60 Hz  
**WPCL40AH50XXXXX** 347-480V 50/60 Hz  
**WPCL55AH50XXXXX** 347-480V 50/60 Hz

#### **Model options:**

- If **XXXX** = **PC12**, voltage input 120V 50/60 Hz  
If **XXXX** = **PC27**, voltage input 208-277V 50/60 Hz  
If **XXX** = **MS4**, voltage input 120-277V 50/60 Hz  
If **XXX** = **IBB**, voltage input 120-277V 50/60 Hz

**WPCS20 / WPCS30**



**WPS20 / WPS30**



**WPCL40 / WPCL55**



**WPL40 / WPL55 / WPL80**



Picture is for illustration purposes only. Your model may vary.

## MaxLite® LED Wall Packs (Cutoff & Standard)

### General Wiring Diagram

CAUTION: Turn off electrical power at fuse or circuit breaker box before wiring fixture to the power supply.

Connecting panels to AC source supply:

All units must be individually connected to the AC supply. (see page 1 for voltage by model)

Black = Line

White = Neutral

Green = Ground

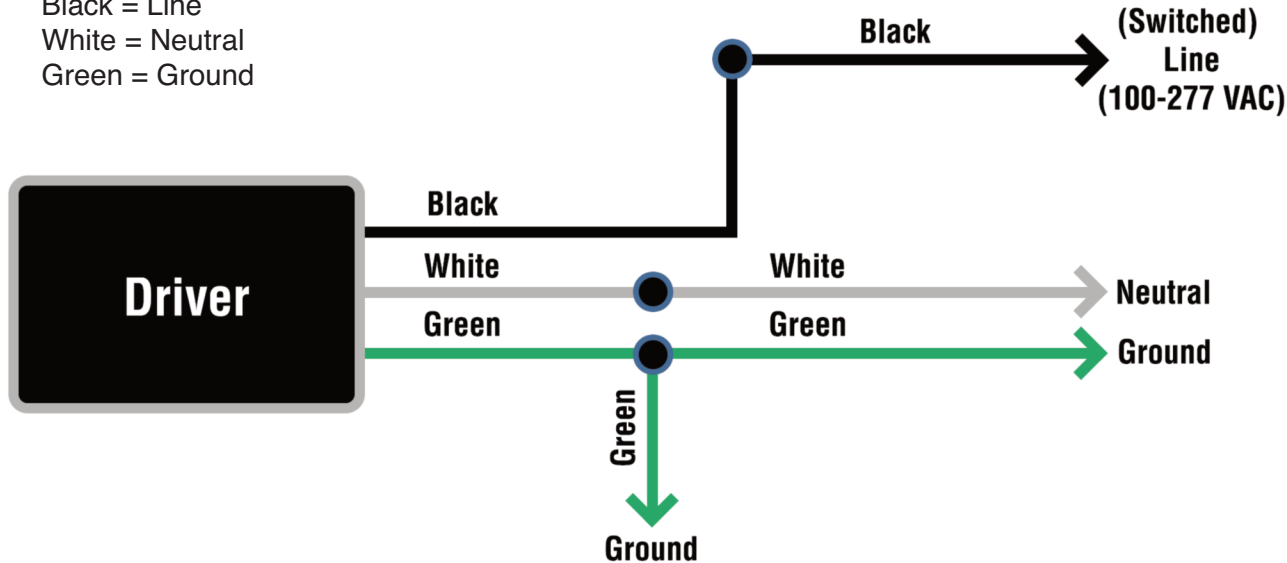

### AC Wiring Instructions

1. Feed wires through wire way and secure using connector (not supplied).
2. Connect supply wires to quick connect originating from INPUT side of driver. Black/Hot supply to quick connect with black wire. White/Neutral supply to quick connect with white wire. Be sure to confirm connections are secure.
3. Connect ground wire to quick connect with green wire. Be sure to confirm grounding connection is secure.

### WPL80 Wiring Instructions

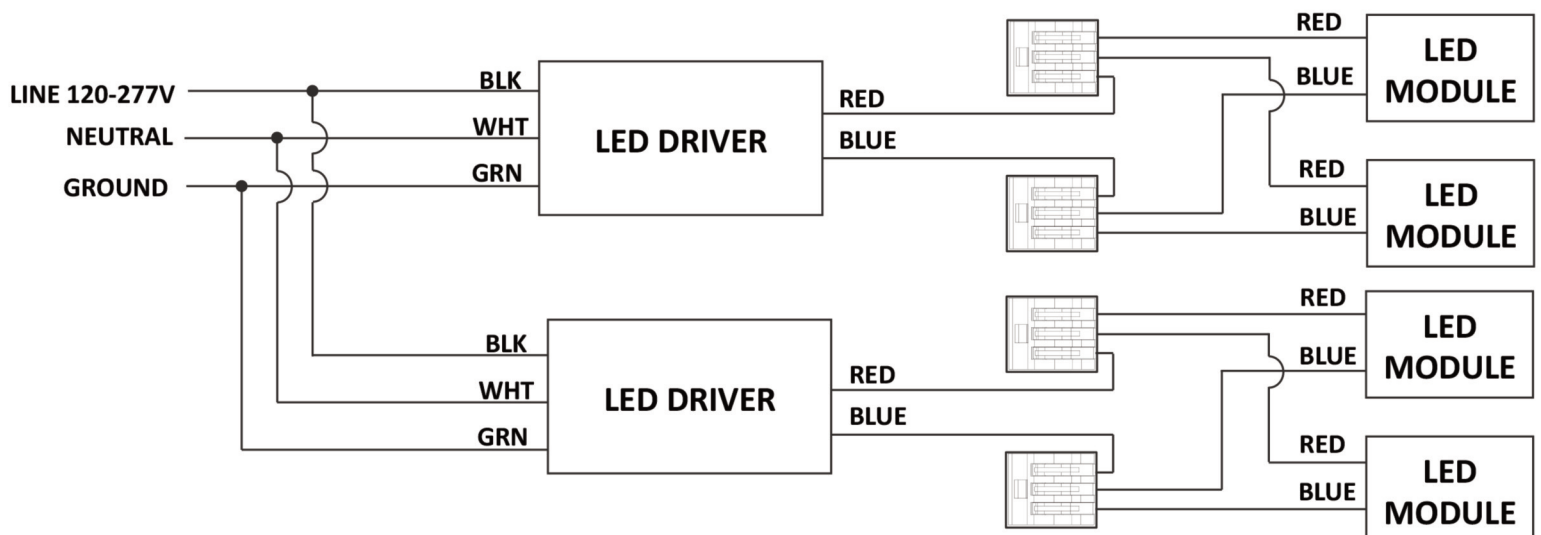

## MaxLite® LED Wall Packs (Cutoff & Standard)

### Installation & Operation

#### ⚠ WARNING

**Disconnect the power by turning off the circuit breaker or by removing the appropriate fuse at the fuse box. Turning the power off using the light switch is not sufficient to prevent electrical shock.**

1. Drill three mounting holes into mounting surface using a 3/8" drill bit. Use template to locate mounting holes.
2. Use a screwdriver to loosen (2) screws securing fixture door. Remove fixture rear housing from fixture.
3. Use a flat head screw driver to remove appropriate wire way covering from back plate of housing.
4. Take care to avoid damaging driver, wires and quick connectors and drill holes through castings over fixture mounting holes.
5. Affix fixture to mounting surface by installing anchors (not supplied) through fixture mounting holes into holes drilled into the mounting surface. Be sure to use an anchor appropriate for the mounting surface in which the fixture is installed.
6. Add 1/4" bead of exterior grade silicone sealant around the perimeter of the wall pack on the wall to inhibit any moisture from attachment screws. Remove the pull-through plugs from the two weep holes at the bottom of the fixture front housing to reduce condensation buildup and avoid water buildup within the fixture. **(see photo on right)**
7. Reattach fixture front to fixture rear housing.
8. Connect driver OUTPUT leads to quick connect originating from LED array. Red output to quick connect with red wires, black output to quick connect with black wires.
9. Reattach fixture using two screws removed in installation step 2.

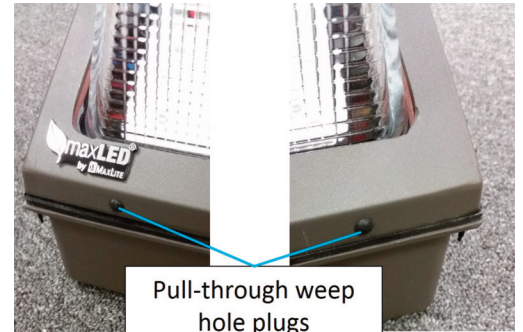

#### WPS & WPCS Series:

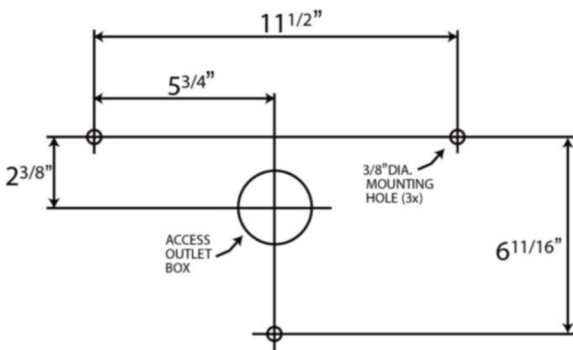

#### WPL & WPCL Series:

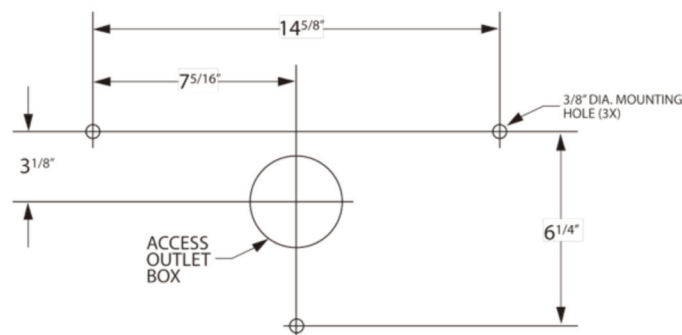

### MS4 (Daylight/Motion Sensor) Option: Wiring Diagram

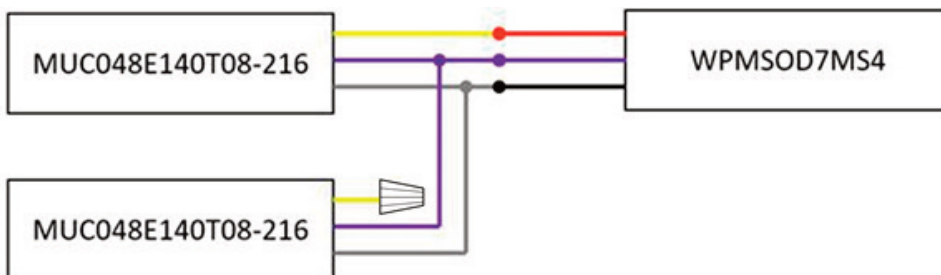

Be sure that the unused second yellow wire is capped.

### MaxLite® LED Wall Packs (Cutoff & Standard)

#### MS4 (Daylight/Motion Sensor) Option: Function Definitions

- 2 MOTION TIME DELAY**  
The length of time the motion sensor will keep the lights on and at maximum level after it last detects motion.
- 4 TEST & BLINK-BACK MODE**  
**AUTO SET-POINT**  
Photocell calibration procedure for detecting optimum lighting control level.  
**BLINK-BACK MODE**  
The type of visual feedback that is provided when programming via the push-button; i.e. entire fixture will blink or just sensor LED will blink.  
**TEST MODE**  
Disables Minimum On Time, sets Occupancy Time Delay to 30 sec, and shortens all photocell transition and dimming rates. Mode will expire after 10 min or if function 4 is changed.
- 5 TEN'S DIGIT OF SET-POINT**  
The ten's digit of the target light level that is to be maintained by the device (in foot-candles).
- 6 ONE'S DIGIT OF SET-POINT**  
The one's digit of the target light level that is to be maintained by the device (in foot-candles).
- 7 SUNLIGHT DISCOUNT FACTOR**  
Value used to improve the tracking accuracy of a photocell during periods of high daylight. Decreasing the value will lower the controlled levels of the lights.
- 8 INCREMENTAL SET-POINT ADJUSTMENT**  
Alters the target light level that is to be maintained by the device (in foot-candles).
- 9 RESTORE FACTORY DEFAULTS**  
Returns the sensor to its default settings.
- 11 PHOTOCELL CONTROL**  
Indicates what mode of photocell operation, if any, is enabled.
- 12 RAMP UP RATE**  
Time period from when motion is detected to when lights are at high trim level.
- 13 FADE DOWN RATE**  
Time period from when motion time delay expires to when lights are at low trim level.
- 15 MAXIMUM LEVEL (HIGH TRIM)**  
The output level (0-10 VDC) of the sensor after motion is detected.
- 16 MINIMUM LEVEL (LOW TRIM)**  
The output level (0-10 VDC) of the sensor after the fade down time has elapsed.
- 21 PHOTOCELL TRANSITION OFF TIME**  
The time period after the photocell measures a light level above the set-point (plus the deadband) that it will turn the lights off (or dim them to min level).
- 22 PHOTOCELL TRANSITION ON TIME**  
The time period after the photocell measures a light level below the set-point that it will turn lights on.

## MaxLite® LED Wall Packs (Cutoff & Standard)

### MS4 (Daylight/Motion Sensor) Option: Programming Instructions

Please read all 3 steps before programming

1. Enter a programming function by pressing button the number of times as the desired function number from the tables below. (e.g. press twice for function 2, motion time delay).
2. LED will flash back the selected function's current setting (e.g. 3 flashes for 5 minute time delay). To change setting, proceed to step 3 before flash back sequence repeats 3 times. To exit the current function or to change to a different function, wait for the sequence to repeat 3 times then return to step 1.
3. Press button the number of times indicated in the particular function's detailed table for the NEW desired setting (e.g. press 5 times for 10 min). As confirmation of setting change, LED flashes back the NEW setting 3 times before exiting.

### Programming Functions

2	Motion Time Delay	11	Photocell Operation
4	Test & Blink-Back Mode	12	Ramp Up Rate
5	Ten's Digit of Set-Point	13	Fade Down Rate
6	One's Digit of Set-Point	15	Maximum Level (High Trim)
7	Sunlight Discount Factor	16	Minimum Level (Low Trim)
8	Incremental Set-Point Adjustment	21	Photocell Transition Off Time
9	Restore Factory Defaults	22	Photocell Transition On Time

### Detailed Function Tables (\* Default Setting)

#### 2 = Motion Time Delay

1	30 sec	4	7.5 min	7	15.0 min
2	2.5 min	5	10.0 min	8	17.5 min
3	5.0 min*	6	12.5 min	9	20.0 min

#### 4 = Test & Blink-Back Mode

1	Blink Light & LED*	5	Blink Set-Point <sup>1</sup>
2	Blink LED only	6	Test Mode <sup>2</sup>
4	Auto-Setpoint		

<sup>1</sup> The LED will blink back the ten's digit, then pause, then blink back the one's digit. For a "0" the LED will blink very rapidly. The sequence is repeated 3 times.

<sup>2</sup> Test Mode will set Occupancy Time Delay to 30 sec, and shorten all photocell transitions and dimming rates. Mode will expire after 10 min or if function 4 is set back to previous setting.

#### 5 = Ten's Digit of Set-Point

1	10 fc	4	40 fc	7	200 fc
2	20 fc	5	50 fc	10	0 fc*
3	30 fc	6	100 fc		

#### 6 = One's Digit of Set-Point

1	1 fc	4	4 fc	7	7 fc	10	0 fc
2	2 fc	5	5 fc*	8	8 fc		
3	3 fc	6	6 fc	9	9 fc		

#### 7 = Sunlight Discount Factor

1	x/1*	4	x/4	7	x/7	10	x/10
2	x/2	5	x/5	8	x/8		
3	x/3	6	x/6	9	x/9		

#### 8 = Incremental Set-Point Adjustment

1	Decrease 1 fc	2	Increase 1 fc
---	---------------	---	---------------

#### 9 = Restore Factory Defaults

1	Keep Current*	2	Restore Factory Defaults
---	---------------	---	--------------------------

#### 11 = Photocell Operation

1	High/Off*	2	High/Low	3	Disabled
---	-----------	---	----------	---	----------

#### 12 = Ramp Up Rate

1	Instant	4	3 sec*	7	15 sec	10	1 min
2	1 sec	5	5 sec	8	20 sec		
3	2 sec	6	10 sec	9	30 sec		

#### 13 = Fade Down Rate

1	Instant	4	5 min*	7	15 min	10	1 hr
2	30 sec	5	7.5 min	8	20 min		
3	2.5 min	6	10 min	9	30 min		

#### 15 = Maximum Level (High Trim)

1	Off	4	3 Volt	7	6 Volt	10	9 Volt
2	1 Volt	5	4 Volt	8	7 Volt	11	10 Volts*
3	2 Volt	6	5 Volt	9	8 Volt		

#### 16 = Minimum Level (Low Trim)<sup>3</sup>

1	Off	4	3 Volt	7	6 Volt	10	9 Volt
2	1 Volt	5	4 Volt	8	7 Volt	11	10 Volts*
3	2 Volt	6	5 Volt	9	8 Volt		

<sup>3</sup> Default Setting is determined by last digits in unit model number. eg. 3V = 3 Volts.

#### 21 = Photocell Transition Off Time

1	45 sec	3	5 min*	5	15 min	10	25 min
2	2 min	4	10 min	6	20 min		

#### 22 = Photocell Transition On Time

1	45 sec*	3	5 min*	5	15 min	10	25 min
2	2 min	4	10 min	6	20 min		



### MaxLite® LED Wall Packs (Cutoff & Standard)

#### Warranty Information

MaxLite Inc. warrants its products for a minimum period of **FIVE (5)** years from the date of original purchase from MaxLite or its authorized distributor/dealer (the "Warranty Period"), as follows: If a Product fails to operate during the Warranty Period as a result of defects in materials or workmanship, MaxLite will, at its option, repair it, replace it with the same or like Product.

Please refer to Maxlite's website (at <http://maxlite.com/resources/warranties>) for the complete terms and conditions of our warranty.

#### Limitation of Liability

THE FOREGOING WARRANTY IS EXCLUSIVE, AND IS THE SOLE REMEDY FOR ANY AND ALL CLAIMS, WHETHER IN CONTRACT, IN TORT OR OTHERWISE ARISING FROM THE FAILURE OF PRODUCT AND IS IN LIEU OF ALL OTHER WARRANTIES, EXPRESS OR IMPLIED, INCLUDING ALL WARRANTIES OF MERCHANTABILITY OR FITNESS FOR A PARTICULAR PURPOSE, WHICH WARRANTIES ARE HEREBY EXPRESSLY DISCLAIMED TO THE EXTENT PERMITTED BY LAW AND, IN ANY EVENT, SHALL BE LIMITED TO THE WARRANTY PERIOD SPECIFIED ABOVE. THE LIABILITY OF MAXLITE SHALL BE LIMITED TO THE TERMS OF THE EXPRESS WARRANTY SET FORTH HEREIN. IN NO EVENT WILL MAXLITE BE LIABLE FOR ANY SPECIAL, INCIDENTAL OR CONSEQUENTIAL DAMAGES INCLUDING, WITHOUT LIMITATION, DAMAGES RESULTING FROM LOSS OF USE, PROFITS, BUSINESS OR GOODWILL, LABOR COSTS, REMOVAL OR INSTALLATION COSTS, DECREASE IN THE LIGHT OUTPUT OF THE LAMP, AND/OR DETERIORATION IN THE LAMP'S PERFORMANCE, WHETHER OR NOT MAXLITE HAS BEEN ADVISED OF THE POSSIBILITY THEREOF. UNDER NO CIRCUMSTANCES SHALL MAXLITE'S ENTIRE LIABILITY FOR A DEFECTIVE PRODUCT EXCEED THE PURCHASE PRICE OF THAT PRODUCT. WARRANTY SERVICES PROVIDED UNDER THESE TERMS AND CONDITIONS DO NOT ENSURE THE UNINTERRUPTED OPERATION OF PRODUCTS; MAXLITE SHALL NOT BE LIABLE FOR DAMAGES CAUSED BY ANY DELAYS INVOLVING WARRANTY SERVICE.

This Limited Warranty gives you specific legal rights and you may also have other rights that may vary from state to state. Because some states or jurisdictions do not allow the exclusion or limitation of liability for consequential or incidental damages, this limitation may not apply to you.