

READ AND FOLLOW ALL SAFETY INSTRUCTIONS!
SAVE THESE INSTRUCTIONS AND DELIVER TO OWNER AFTER INSTALLATION

IMPORTANT SAFETY INSTRUCTIONS

- To reduce the risk of death, personal injury or property damage from fire, electric shock, falling parts, cuts/abrasions, and other hazards please read all warnings and instructions included with and on the fixture box and all fixture labels.
- Before installing, servicing, or performing routine maintenance upon this equipment, follow these general precautions.
- Installation and service of luminaries should be performed by a **qualified licensed electrician**.
- Maintenance of the luminaries should be performed by person(s) familiar with the luminaires construction and operation and any hazards involved. Regular fixture maintenance programs are recommended.
- It will occasionally be necessary to clean the outside of the refractor/lens. Frequency of cleaning will depend on ambient dirt level and minimum light output which is acceptable to user. Refractor/lens should be washed in a solution of warm water and any mild, non-abrasive household detergent, rinsed with clean water and wiped dry. Should optical assembly become dirty on the inside, wipe refractor/lens and clean in above manner, replacing damaged gaskets as necessary.
- **DO NOT INSTALL DAMAGED PRODUCT!** This luminaire has been properly packed so that no parts should have been damaged during transit. Inspect to confirm. Any part damaged or broken during or after assembly should be replaced.
- Recycle: For information on how to recycle LED electronic products, please visit www.epa.gov.

These instructions do not purport to cover all details or variations in equipment nor to provide every possible contingency to meet in connection with installation, operation, or maintenance. Should further information be desired or should particular problems arise which are not covered sufficiently for the purchaser's or owner's purposes, this matter should be referred to Acuity Brands Lighting, Inc.



WARNING - RISK OF ELECTRIC SHOCK

- * Disconnect or turn off power before installation or servicing.
- * Verify that supply voltage is correct by comparing it with the luminaire label information.
- * Make all electrical and grounded connections in accordance with the National Electrical Code (NEC) and any applicable local code requirements.
- * All wiring connections should be capped with UL approved recognized wire connectors.



WARNING - RISK OF BURN

- * Allow LED board/fixture to cool before handling. Do not touch enclosure or light source.
- * Do not exceed maximum wattage marked on luminaire label.
- * Follow all manufacturer's warnings recommendations and restrictions for: driver type, burning position, mounting locations/methods, replacement and recycling.

SAVE THESE INSTRUCTIONS

 **CAUTION - RISK OF INJURY**

- * Wear gloves and safety glasses at all times when removing luminaire from carton, installing, servicing or performing maintenance.
- * Avoid direct eye exposure to the light source while it is on.

 **CAUTION - RISK OF FIRE**

- * Keep combustible and other materials that can burn away from lamp/lens.
- * Do not operate in close proximity to persons, combustible materials or substances affected by heat or drying.

 **CAUTION - RISK OF PRODUCT DAMAGE**

- * Never connect components under load.
- * Do not mount or support these fixtures in a manner that can cut the outer jacket or damage wire insulation.
- * Never connect an LED product directly to a dimmer pack. LED fixtures must be powered directly off a switched circuit.
- * Unless individual product specifications deem otherwise: Allow for some volume of airspace around fixture. Avoid covering LED fixtures with insulation, foam, or other material that will prevent convection or conduction cooling.
- * Unless individual product specifications deem otherwise: Maximum ambient temperature is 90 C. Do not operate fixture at temperatures higher than this.
- * Unless individual product specifications deem otherwise: Never mount in places where fixture will be exposed to rain, high humidity, extreme temperature changes or restricted ventilation.
- * LED products are Polarity Sensitive. Ensure proper Polarity before installation.
- * Electrostatic Discharge (ESD): ESD can damage LED fixtures. Personal grounding equipment must be worn during all installation or servicing of the unit.
- * Do not touch individual electrical components as this can cause ESD, shorten lamp life, or alter performance.
- * There are no user serviceable parts inside the unit. Do not rewire, reconfigure, or modify the unit or attempt any repairs yourself. Additionally, field replacement of the LED assembly or lamps is not allowed by UL standards at this time. In the unlikely event your unit may require service, stop using the unit immediately and contact an ABL representative.

device complies with Part 15 of the FCC Rules. Operation is subject to the following two conditions:

(1) This device may not cause harmful interference

(2) This device must accept any interference received, including interference that may cause undesired operation.

This device complies with Part 18 of the FCC Rules but may cause interference with cordless and cell phones, radios, televisions, and other electronic devices.

To correct the problem move the device away from the luminaire or plug into a different outlet.

This product may cause interference to radio equipment and should not be installed near maritime safety communications equipment or other critical navigation or communications equipment operating between 0.45-30MHz.

Failure to follow any of these instructions could void product warranties. For a complete listing of product Terms and Conditions, please visit www.acuitybrands.com

Page 2 of 6

VAP INSTALLATION INSTRUCTIONS

INSTALLATION OF THIS FIXTURE IN ANY OTHER MANNER THAN WHAT IS INDICATED WITHIN THE SUPPLIED INSTRUCTIONS WILL VOID ALL WARRANTIES.

These instructions are for NORMAL On/Off operations.

Remove fixture from packaging. Ensure proper voltage will be supplied to the fixture. Check the fixture label on the carton for fixture voltage.

IF THE FIXTURE WAS NOT ORDERED WITH A FACTORY INSTALLED WLF OPTION, A UL LISTED WET LOCATION FITTING MUST BE USED. FIXTURE MUST BE GOUNDED BEFORE USE.

VAP WLF INSTALLATION INSTRUCTIONS

Stem mounting (Distance between stems is 47" on center)

1. If field installing wet location fittings, remove diffuser, lamps and channel cover. Drill out two (2) holes on the back of fixture housing using 7/8" hole saw and remove KO's from channel (Fig 1, 47" on center).
2. Install wet location fitting per Fig 2.
3. Thread 1/2" rigid conduit into wet location fittings.
- 4 Make wiring connections in accordance with local codes.
5. Reinstall channel cover, lamps and diffuser as necessary.

Installing wet location fitting on end of fixture housing.

1. Remove diffuser, lamps, channel cover and socket bracket.
2. Install wet location fitting per Fig 3 using a 7/8" hole saw and removing KO from end of channel..
3. Re-install socket bracket, channel cover, lamps and diffuser.

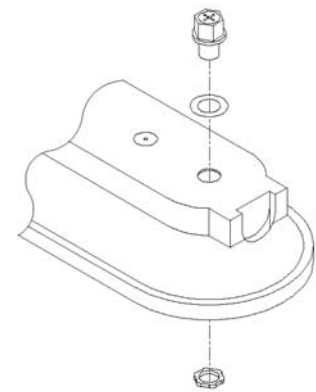

Fig 2

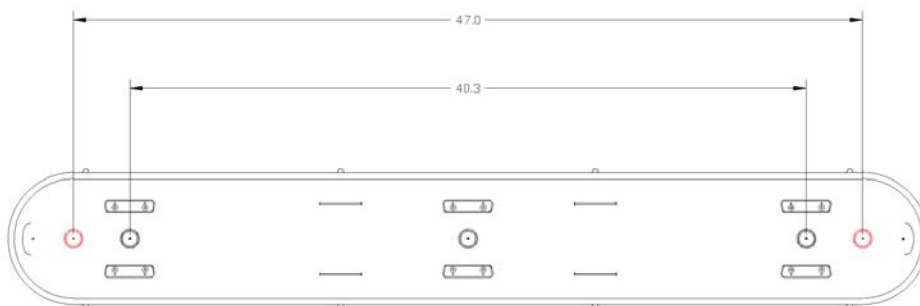

Fig 1

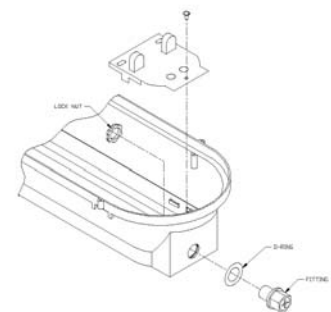

Fig 3

VAP SMB INSTALLATION INSTRUCTIONS

1. Remove diffuser, channel cover and lamps. Using a 7/8" hole saw drill out desired entrance hole in the fixture housing for electrical connection (end or top of fixture). Remove KO from channel.
2. Attach steel mounting bracket to ceiling (Fig 4) (hardware provided by others).
3. Install one side of housing in bracket (Fig 5)
4. Rotate up and snap the other side of the housing into the bracket (Fig 6).
5. Make electrical connections and re-install the channel cover, lamps and diffuser once the fixture is securely installed with bracket.

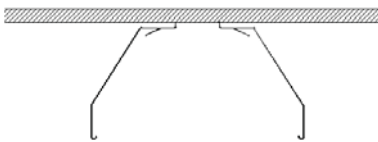

Fig 4

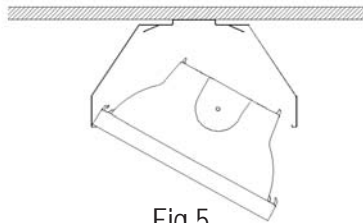

Fig 5

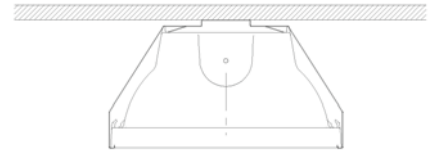

Fig 6

VAP QUICK-MOUNT BRACKET (QMB) INSTALLATION

1. Attach two (2) steel mounting brackets (Fig 7) to ceiling (hardware provided by others). The distance between brackets is 40.3" on center.
2. Remove diffuser, lamps and channel cover. Using a 7/8" hole saw drill out access hole in the fixture housing for electrical connection. Remove KO from channel.
3. If field installing snap bracket mounting, attach four (4) brackets to fixture housing (Fig 8) (maximum 25 inch-pounds torque on screws).
4. Push fixture housing up into surface brackets until the surface bracket snaps locking it into place (Fig 9).
5. Make electrical connections and re-install the channel cover, lamps and diffuser.



Fig 7

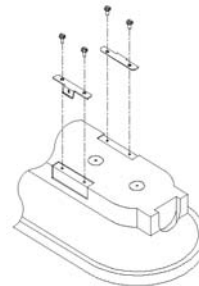

Fig 8

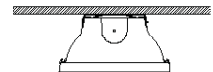
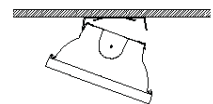

Fig 9

VAP JUNCTION BOX SNAP BRACKET (JSB) INSTALLATION

1. Attach JSB bracket (Fig 10) to junction box.(hardware provided by others). Remove protective film from gasket (included with JSB) and attach adhesive side to the JSB.
2. If field installing, remove diffuser, lamps and channel cover. Using a 7/8" hole saw drill out access hole in the center of the fixture housing for electrical connection. Remove KO from channel. If JSB option is ordered in fixture nomenclature, then the wires will already be pulled through the center of the fixture.
3. If field installing the JSB bracket mounting, attach two (2) brackets to fixture housing as shown in Fig 11 (maximum 25 inch-pounds torque on screws).
4. Attach on side of fixture bracket to JSB, rotate fixture up until it snaps into the JSB. Secure JSB to fixture using the screw provided (Fig 12).
5. Make electrical connections and re-install the channel cover, lamps and diffuser.



Fig 10

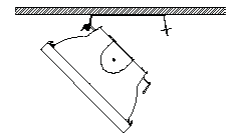
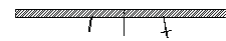

Fig 12

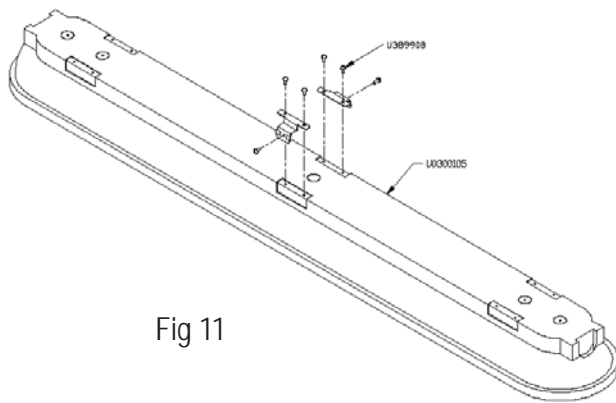
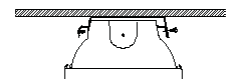

Fig 11

MOTION SENSOR (MSI##) INSTALLATION INSTRUCTIONS

1. Install wet location fitting in end of fixture.
2. Thread extension adapter for sensor into the wet location fitting.
3. Wire sensor into the fixture as shown in Fig 13.

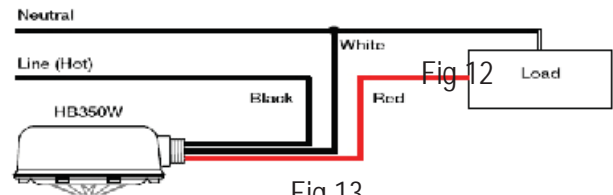

Fig 13

VAP CHAIN MOUNT BRACKET (CMB) INSTALLATION

1. If field installing chain hanger, remove diffuser, lamps and channel cover. Using a 7/8" hole saw drill out desired entrance hole in the fixture housing for electrical connection (end or top of fixture). Remove KO from channel.
2. Install brackets on each end of the fixture as shown in Fig 14 (maximum 25 inch-pounds torque on screws).
3. Attach HC36 to bracket on fixture and secure other end of chain to the building structure (provided by others)
- 4 Make wiring connections in accordance with local codes.
5. Reinstall channel cover, lamps and diffuser as necessary.

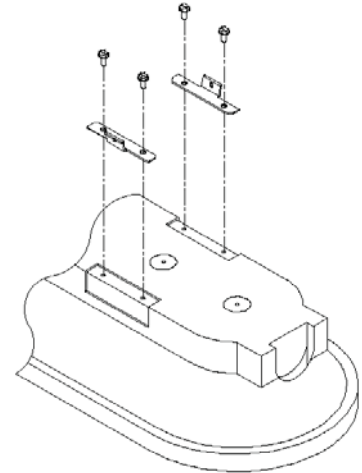

Fig 14

VAP LIGHT CONTROL FILM (ASY or SYM) INSTALLATION

1. If field installing the light control film, remove any protective film from lens.
2. Remove diffuser and attach the film to tabs on inside of lens (near both ends of lens cover). Secure film with (8) washers provided. Ensure that the smooth side of the film is away from the lens and the notched corner is towards the outside of the lens (Fig 15).
3. Reinstall lens on the fixture.

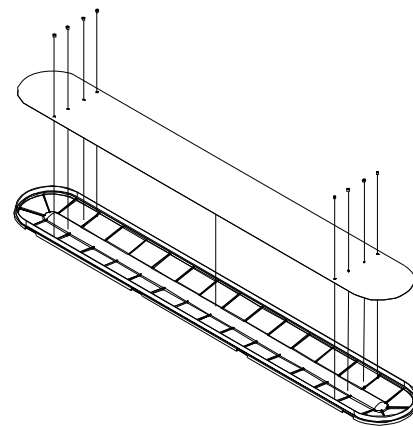

Fig 15