

LMLS-MB1/MB2

Digital Lighting Management (DLM) Photosensor Mounting Brackets

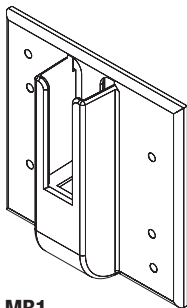

LMLS-MB1

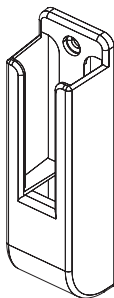

LMLS-MB2

SPECIFICATIONS

Material: ABS, UL 94 5V
..... Flame Retardant Material
..... Indoor Use Only

Mounting Options:

LMLS-MB1 4-Square J-Box
..... 2-Gang J-Box
LMLS-MB2 Screw to Wall
..... Tape to wall with double sided tape

WattStopper®

Installation Instructions

DESCRIPTION

The LMLS-MB1 and LMLS-MB2 mounting brackets provide the flexibility to mount the LMLS-400 and LMLS-500 Photosensors to walls, skylight wells or J-Boxes. They are specifically designed to be used in conjunction with these Photosensors.

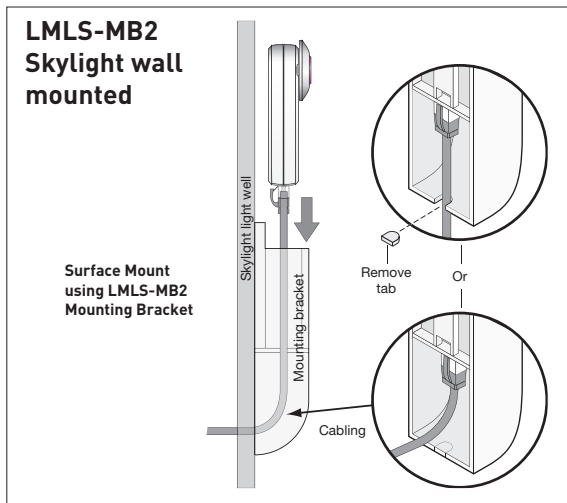
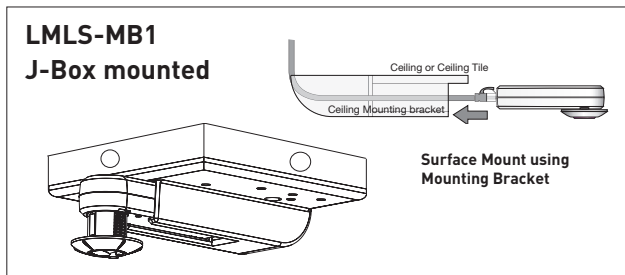

Call 800.879.8585 for Technical Support

LMLS-MB1 MOUNTING OPTIONS

The LMLS-MB1 is designed to be able to mount to a standard 4" square junction box as well as a 2-gang junction box.

Using a small screwdriver, punch out the holes for the corresponding junction box. Holes are clearly marked on the rear side of mounting plate.

Mounting plate
back view

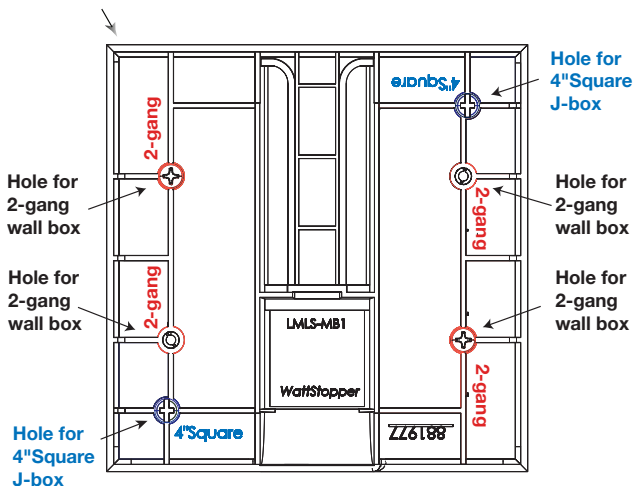

LMLS-MB1 MOUNTING INSTRUCTIONS

After punching out the holes, use the provided screws to mount the LMLS-MB1 to the corresponding junction box as shown.

Mounting to a
4" square J-box

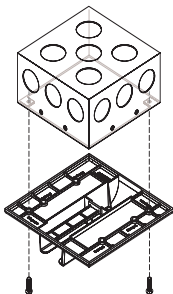

4 square J-box
2 screws

Mounting to a
2 gang wall box

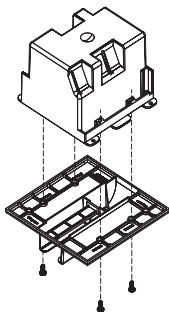

2-gang
4 screws

CONNECTING THE RJ-45 CABLE

Run RJ-45 cable through J-box.

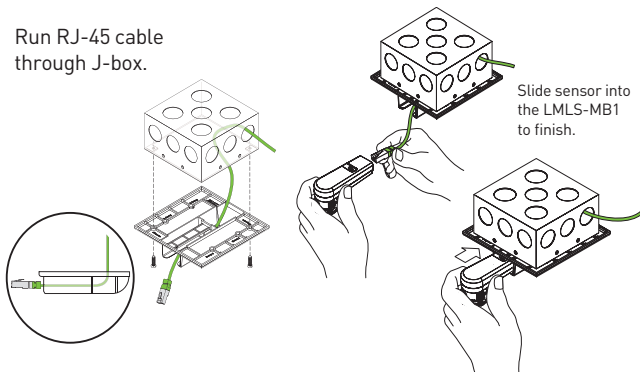

Connect RJ-45 cable and photosensor as shown.

Call 800.879.8585 for Technical Support

LMLS-MB2 MOUNTING OPTIONS

The LMLS-MB2 can be mounted to a wall with the provided screws or by using the double-sided tape. Using the provided template, marking the wall with appropriate hole spacings is made easy. The LMLS-MB2 has a small break-away tab at the bottom of the bracket for use when running the RJ-45 cable on the wall surface if desired.

For the screw holes, use a #40 drill gauge bit size to drill a 0.098" pilot hole. If drilling through a wall the recommended hole size diameter to drill for the cable is 0.875".

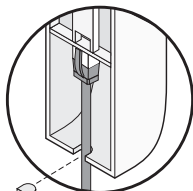

Break-away
tab

MOUNTING WITH SCREWS

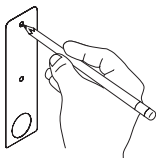

1. Use template to mark wall with appropriate hole spacings.

2. Drill screw pilot holes using #40 drill bit.

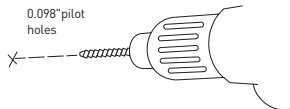

Hole size diameter to drill for cable is 0.875"

3. Use provided screws to mount the LMLS-MB2 to the wall.

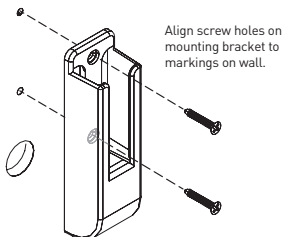

LMLS-MB2 PLACEMENT EXAMPLE

Mounting when running the RJ-45 cable through wall.

Mounting when running the RJ-45 cable on the wall surface.

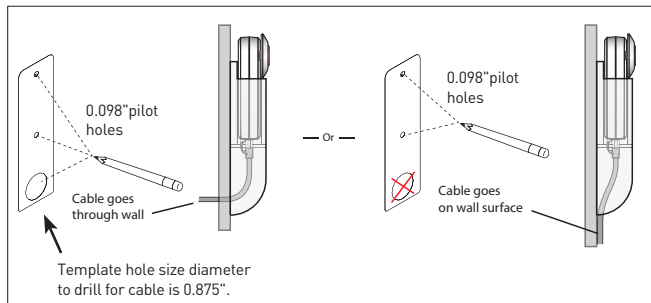

WIRING DETAIL

Connect RJ-45 cable and photosensor as shown.

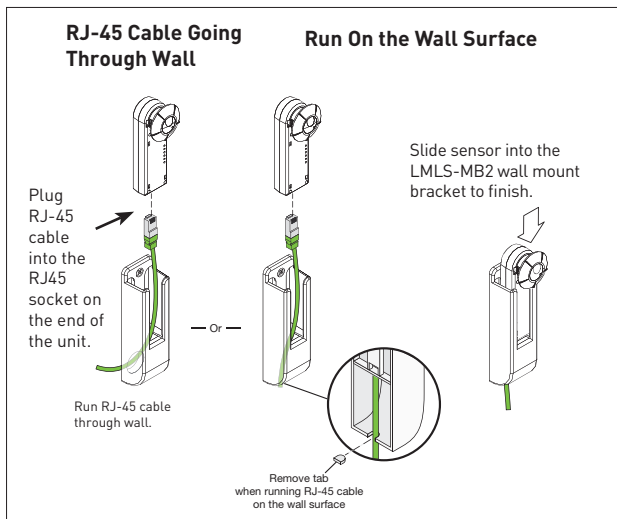

Call 800.879.8585 for Technical Support

LMLS-MB2 MOUNTING OPTIONS

MOUNTING WITH DOUBLE-SIDED TAPE

The LMLS-MB2 can be mounted to a wall using the double-sided tape. Using the provided template, mark the wall with the appropriate hole spacings. The LMLS-MB2 has a small break-away tab at the bottom of the bracket for use when running the RJ-45 cable on the wall surface if desired.

Use template to mark wall with appropriate hole spacings.

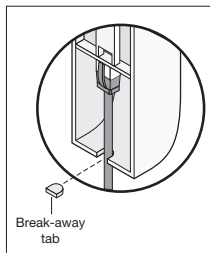
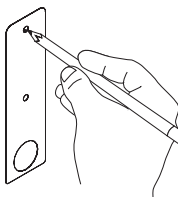

PLACEMENT EXAMPLE

Mounting when running the RJ-45 cable through wall.

Mounting when running the RJ-45 cable on the wall surface.

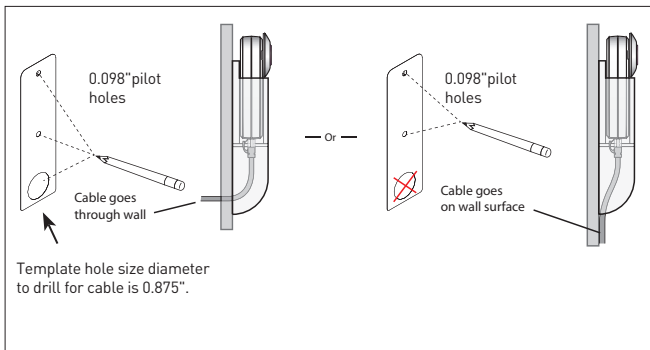

MOUNTING INSTRUCTIONS

Apply tape to rear recess as shown.

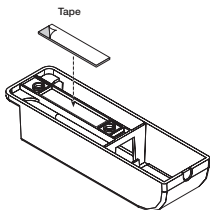

Visually align to markers on wall, then press on wall.

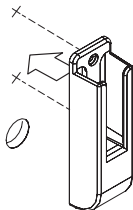

WIRING DETAIL

RJ-45 Cable Going Through Wall

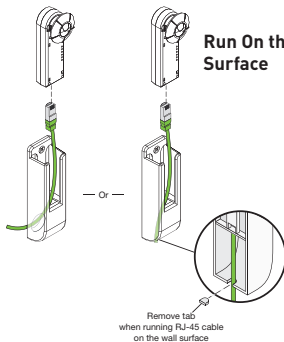

Run On the Wall Surface

Slide sensor into the LMLS-MB2 wall mount bracket to finish.

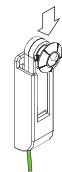

Connect RJ-45 cable and photosensor as shown.

WattStopper®

2800 De La Cruz Boulevard, Santa Clara, CA 95050

800.879.8585 • www.wattstopper.com

14677 r1 06/11

REV	ECO #	
1	C04592	

TITLE BOX PAGE
DO NOT MAKE FILM • D



- Material: White 80g/m² (prefer recycled stock)
- Final trim size: 16" (W)
- Four (4) fold. 2 sided.
- Final folded size: 4" (V)
- Ink Color: CYMK

IF YOU HAVE ANY QUESTIONS REGARDING S
 ADDITIONAL FILE FORMATTING, PLEASE CO

All information in this drawing is the property of W
 copied or used without the written approva

Drawn by:	ROBERTSON:	Wa
PLM:	DT	
Tech Writing:	CR	
Eng:	AF	
QA		
TITLE BOX PG.	Scale: 1 : 1	Title: LMLS Instructions
		Drawing #: 14677

NT	REV DATE	APPROVED
CR	6/30/2011	CG

**ONLY.
DO NOT PRINT**

sq. uncoated
)
Wide) x 6" (High).

Wide) x 6" (High).

SPECIFICATIONS OR REQUIRE
CONTACT Engineering.

WattStopper and cannot be
al of WattStopper.

WattStopper

-MB1 and LMLS-MB2 Installation

Original Drwg. Date: 09 JUN 11	Rev #: 1
Rev. Date: 30 JUN 11	