

**LOW VOLTAGE ELECTRONIC TRANSFORMER**

**MODEL EN-1260-R-AR**

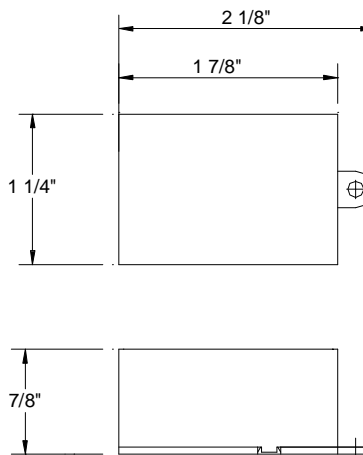

**Ordering Matrix**

Model	Finish	Accessories
<input type="text"/>	<input type="text"/>	
EN-1260-R-AR	BK	See table below

Ordering Example (model-finish) : EN-1260-R-AR-BK

**Product Details**

<b>Description:</b>	Low Voltage electronic transformer designed to be used as a replacement part for factory installed transformers or installed in a properly listed enclosure.
<b>Catalog Number:</b>	EN = Advanced electronic circuitry 1260 = 12volt , 60watt R = Replacement AR = Auto-Reset
<b>Input:</b>	120V (50/60Hz)
<b>Output:</b>	12V
<b>Min Load:</b>	20W
<b>Max Load:</b>	60W
<b>Max Input Amp:</b>	0.53A (@ 120V)
<b>Frequency:</b>	20 khz.
<b>Dimming:</b>	Dimmable with electronic low voltage dimmers. Dimmers should always be installed on the primary side of the transformer.
<b>Listing:</b>	U.L. recognized component part, File Number E204239.
<b>Accessories:</b>	METB – Enclosure and connection box MTB-01 – Multiple Terminal Block

**Specification Features**

- U.L. 2108 listed electronic low voltage transformer.
- Built-in auto reset, soft start, short and overload circuit protection features. The soft start delayed start feature extends lamp life by delaying the abrupt inrush current to the lamp.
- In the case of a system overload or short circuit the transformer will revert to a "hold" position and then automatically reset the system when the problem is solved. System protection is designed to last several hours.
- True RMS meter is required to read the high frequency output.
- 5 year W.A.C. Lighting product warranty.