

MIRO

Premium Specular Industrial Fluorescent models come standard with labor-saving pre-wired flip-up socket bars.

Project _____

Catalog Number _____

Type _____

Date _____

HOUSING Die-formed heavy gauge steel with high-gloss, baked white enamel finish over rust inhibiting phosphate coat. 7/8" knock outs for easy installation.

REFLECTOR Specular reflector manufactured from MIRO 4 aluminum in 4' sections to maximize light output and control beam spread. 95% reflectance.

ELECTRICAL Fully wired Universal 120-277V, 50-60Hz operation with thermally protected, automatic resetting Class P, sound rated A ballast as standard unless otherwise specified.

MOUNTING Ceiling surface mount (HO and VHO units must be suspended at least 6" from ceiling for cooler operation and longer ballast life), spacing available with Snapper Bracket (SN), CA24 chain kit or stem mount individual or continuous row. AC aligner clips available for continuous runs.

LISTINGS C-UL-US Listed damp location.

WARRANTY 1 year limited warranty.

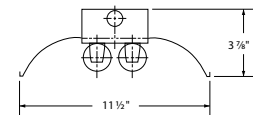

MIE Industrial Configuration

SERIES	# LAMPS	LAMPS*	REFLECTOR OPTIONS	OPTIONS	BALLAST*	SWITCHING	VOLTAGE
MIE	1	28 = 28W 46" T5	<i>Solid is standard</i> A = Aperture 12% uplight	ELS1 = Emergency Lighting (T8 500 lm, T5 700 lm) ELS2 = Emergency Lighting (T8 700 lm, T5 700 lm) ELS3 = Emergency Lighting (T8 1400 lm, T5 1400 lm)	B5 = Electronic T12 HOB = High Output Electronic T12 B11 = Electronic T8 B11HP(x) = HP T8 HOB11 = High Output Electronic B12 = Electronic T12 HO = High Output VHO = Very High Output CS = Customer Supplied B9 = Customer Specified	<i>For 2 lamp units:</i> Blank = One 2-lamp ballast 2/1L = Two 1-lamp ballasts <i>For 3 & 4 lamp units:</i> Blank = (1) 1-lamp ballast and (1) 2-lamp ballast 3L = (1) 3-lamp ballast 4L = (1) 2-lamp and (1) 4-lamp ballast	UNV = 120-277V 120 = 120V 277 = 277V
	2	32 = 32 W48" T8					
	3	48 = 48" Slimline 96 = 96" Slimline					
	21 = Tandem, 2 lamps 22 = Tandem, 4 lamps 23 = Tandem, 6 lamps	<i>High Output</i> 48 = 48" HO 54 = 54W 46" T5HO 96 = 96" HO (1 or 2 lamp only) <i>Very High Output</i> 48 = 48" VHO (1 or 2 lamp only) 96 = 96" VHO (1 or 2 lamp only)					

*CEE listed T8; specify (L)ow, (N)ormal, or (H)igh ballast factor. Contact factory for NEMA Premium.

ACCESSORIES

- SN** = Snapper brackets
- CA24** = Chain Hanger assembly (24" total drop)
- CS24** = "S" Hook (4) Chain Hanger assembly (24" total drop)
- HKSC** = Hook & Chain assembly (24" total drop; 4' fixtures only)
- LG48** = 48" wire guard
- AC** = aligner Clip
- CHJ** = Housing Joiner

Dimensions

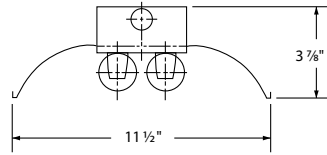

HO Models are 5" Deep

