

PHILIPS
bodine

Emergency Drivers

LED

BSL17C-C2



Emergency LED Driver
Listed for field installation
Class 2 output
7 Watts output power

Product order number: BSL17CC2T1U (metal case with conduit on both ends)
See back page for additional model configurations and order numbers

Project:

Type:

Model No:

Qty:

Date:

Notes:

Specifications

ETL Listed

For Field or Factory Installation
(Indoor and Damp)

UL Component Recognized

For Factory Installation
(Indoor and Damp)

Illumination Time

90 Minutes

Full Warranty

5 Years (NOT pro-rata)

Universal Input Voltage

120-277 VAC, 60 Hz

AC Input Current

45 mA

AC Input Power Rating

2.75 W

Output Voltage

15.0 - 50.0 VDC

Output Power

7.0 W (Maximum),

Test Switch/Charging Indicator Light

2 W - ITS (2-Wire illuminated test switch)

Battery

High-Temperature, Maintenance-Free
Nickel-Cadmium Battery
7- to 10-Year Life Expectancy

Battery Charging Current

180 mA

Recharge Time

24 Hours

Temperature Rating

Ambient : 0°C to +50°C (32°F to 122°F)
Case: Tc (max): 65°C

Dimensions

12.0" x 2.4" x 1.5"
(304 mm x 60 mm x 38 mm)
Mounting Center 11.5" (292 mm)

Weight

4.3 lbs. (1.95 kg)

Benefits:

- Listed for field installation - UL 924 and CSA C22.2 No. 141 Emergency Lighting Compliant
- Class 2 output - UL 1310 Certified, CSA 22.2 No 223-M91 compliant
- Controlled power for predictable discharge
- 15 - 50 VDC for wide range of LED loads
- Universal input (120 through 277 VAC, 50/60 Hz)
- RoHS Compliant

Dimensions

12.0" x 2.4" x 1.5" (mounting center - 11.5")

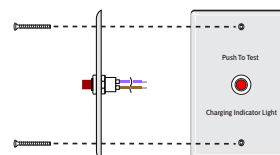
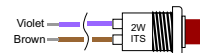
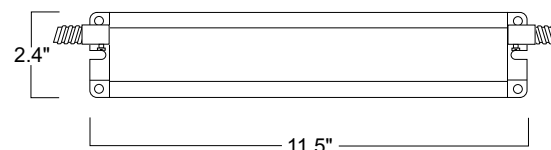
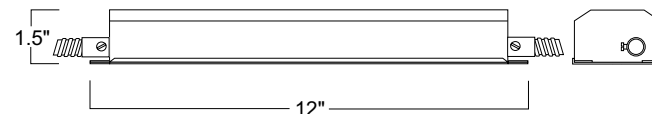

A Test/Monitor Plate with an illuminated test switch/charging indicator light is provided.



BSL17C-C2

Emergency LED Driver, Class 2 Output, 7 Watts Output Power

APPLICATION

The BSL17xxx is ETL Listed for factory or field installation and allows the same LED luminaire to be used for normal and emergency operation. The BSL17xxxx emergency LED driver works in conjunction with an AC LED driver that has an output current not to exceed 1.5 A, to convert new or existing LED fixtures into emergency lighting. The emergency driver consists of a high-temperature nickel-cadmium battery, charger and electronic circuitry in one compact case. The BSL17xxxx can be used with an LED lighting load of up to 7.0 Watts. If used in an emergency-only fixture, no AC driver is necessary. The BSL17xxxx is suitable for indoor and damp locations and for sealed & gasketed fixtures, including fixtures rated for wet locations. Neither the BSL17-C2 nor the BSL17C-C2 is suitable for air handling heated air outlets and wet or hazardous locations. For more information about specific LED and AC driver compatibility, please call the factory.

OPERATION

When AC power fails, the BSL17xxxx immediately switches to the emergency mode, operating the LEDs at a reduced lumen output for a minimum of 90 minutes. When AC power is restored, the emergency driver automatically returns to the charging mode.

INSTALLATION

The BSL17xxxx does not affect normal fixture operation and may be used with either a switched or unswitched fixture. If a switched fixture is used, an unswitched hot lead must be connected to the emergency driver. The emergency driver must be fed from the same branch circuit as the AC driver. This series may be installed inside (BSL17-C2 only) or on top of (both models) the fixture. Installation is not recommended with fixtures where the ambient temperature may fall below 0° C.

CODE COMPLIANCE

For detailed information regarding standards and code compliance for emergency lighting see product page or the Codes and Standards section on the web site.

EMERGENCY ILLUMINATION

The BSL17xxxx operates an LED load of up to 7.0 Watts.

SPECIFICATION

Emergency lighting shall be provided by using an LED fixture equipped with a Philips Bodine BSL17xxxx emergency driver. This emergency driver shall consist of a high-temperature, maintenance-free nickel-cadmium battery, charger and electronic circuitry contained in

one 12" x 2 3/8" x 1 1/2" metal case. The BSL17xxx comes with an illuminated test switch (ITS) to monitor charger and battery and installation hardware shall be provided. The emergency driver shall be capable of delivering up to 7 Watts to an LED load (15-50VDC) for a minimum of 90 minutes. The BSL17xxxx shall have 3 Watts of input power and a 15.0 Watt-hour battery capacity and shall comply with emergency standards set forth by the current NEC. The emergency driver shall be ETL Listed for field or factory installation and UL Component Recognized CUS for factory installation.

INSTALLATION OPTIONS AND ORDERING CODES

The BSL17xxxx models can be ordered in several mounting configurations and test switch/LED kits. Please see the ordering codes below to determine which configuration best meet your requirements.

WARRANTY

Model BSL17xxxx is warranted for five (5) full years from date of purchase. Please see detailed warranty information on our web site.

Optional Configurations (with order numbers)

BSL17-C2 (Order Number BSL17C2U)
Includes Loose 2W-ITS Parts Kit

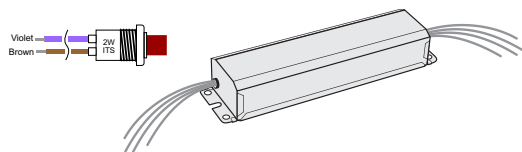

BSL17C-C2 Type 1 (Order Number BSL17CC2SF)
Includes Loose 2W-ITS Parts Kit

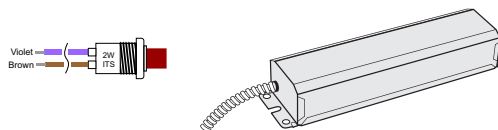

BSL17C-C2 Type 1 Option 6 (Order Number BSL17CC2T106U4W)
Includes 4W-ITS exiting through conduit

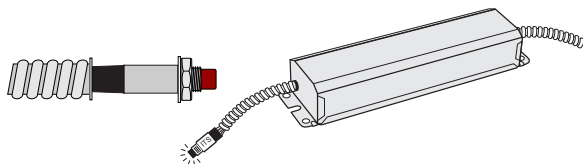

4 W-ITS exits through conduit adaptor. All other wires through the other conduit.

BSL17C-C2 Type 1 Option 7 (Order Number BSL17CC2T107)
Includes 2W-ITS through conduit adaptor

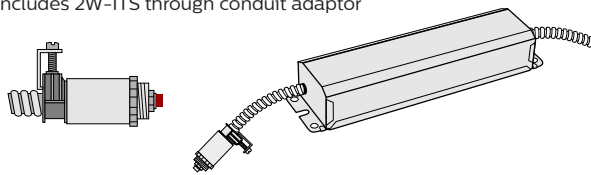

ITS exits unit through conduit adaptor. All other wires through the other conduit.

BSL17C-C2 Type 2 (Order Number BSL17CC2T2U)
Includes 2W-ITS on Wall Plate

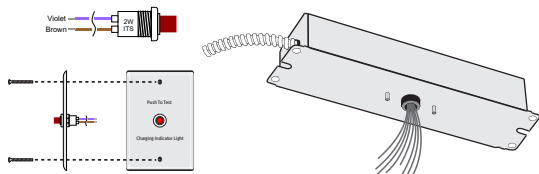

BSL17C-C2 Type 2 Option 7 (Order Number BSL17CC2T207)
Includes 2W-ITS through conduit adaptor

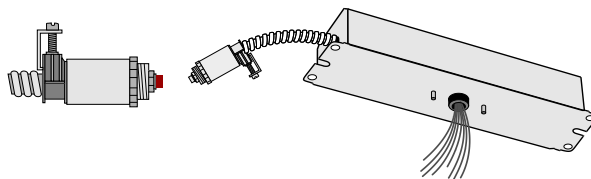

2W-ITS exits through conduit adaptor. All other wires through lid. Studs are threaded so unit can be mounted on a J-box plate.

© 2016 Philips Lighting Holding B.V. All rights reserved. Philips reserves the right to make changes in specifications and/or to discontinue any product at any time without notice or obligation and will not be liable for any consequences resulting from the use of this publication.

Document order number: L2300223 16.00614



Philips Emergency Lighting
236 Mt. Pleasant Rd.
Collierville, TN 38017
Tech Support: 888.263.4638
Sales: 800.223.5728

philips.com/bodine