

## STAINLESS STEEL LOCKNUTS



### Features:

- Made from Type 316 stainless steel for increased corrosion resistance
- Polished with standard "brite" finish to increase corrosion resistance and aesthetic appearance
- No package qty. required

### Certifications and Complies:

- UL514B approved
- File # E308159
- All Locknuts are intended to be installed in accordance with ANSI/NFPA 70, "National Electrical Code" (NEC)

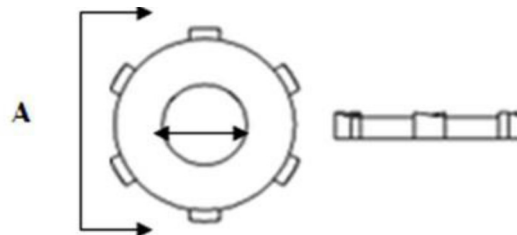

### Applications:

Used to connect threaded conduit or connector to a threadless opening in a box, enclosure or fitting. Heavy stock thickness and specially designed tabs tighten securely and will not easily loosen even in the most severe applications.

### Industries Commonly Served:

- Food & Beverage Production
- Marine & Coastal Facilities
- Chemical Plants
- Water & Wastewater Treatment
- Pharmaceuticals & Cosmetics
- Refining & Extraction Sites
- Petrochemical Operations
- Pulp & Paper Mills
- Along with other corrosive environments

Part Number	Size	A	Inside Diameter	Wall Thickness	Weight each per lb
S60500LN00	1/2"	1.250"	0.760"	0.138"	0.02
S60700LN00	3/4"	1.450"	0.975"	0.173"	0.03
S61000LN00	1"	1.820"	1.210"	0.200"	0.06
S61200LN00	1-1/4"	2.200"	1.570"	0.216"	0.07
S61500LN00	1-1/2"	2.450"	1.810"	0.216"	0.08
S62000LN00	2"	2.930"	2.300"	0.233"	0.10
S62500LN00	2-1/2"	3.560"	2.760"	0.233"	0.16
S63000LN00	3"	4.220"	3.410"	0.235"	0.20
S64000LN00	4"	5.260"	4.410"	0.236"	0.25

*All dimensions are for informational purposes only \*Tolerances +/- 5%*