

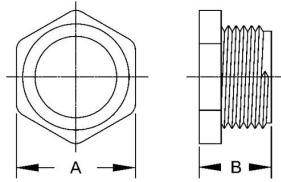

**NIPPLES**

**Uninsulated Chase Nipples Die Cast Zinc**

**B90**



Catalog #: 1670

**APPLICATIONS**

For use with a conduit coupling to connect conduit to a box, or with a locknut to connect two boxes.  
N/A

**PRODUCT FEATURES**

Rugged metallic construction

**UL LISTED**

Standard 514B, File E195969

**CSA**

C22.2 No. 18

**COMPLIANCES**

MSDS  
[www.hubbell-rtb.com/certifications/Hubbell-RACO\\_MSDS\\_for\\_WP\\_Boxes\\_and\\_Fittings,January\\_2015.pdf](http://www.hubbell-rtb.com/certifications/Hubbell-RACO_MSDS_for_WP_Boxes_and_Fittings,January_2015.pdf)

**GENERAL PRODUCT INFORMATION**

Trade Size: 2-1/2 in.

**DRAWING DIMENSIONS**

Dimension A: 3-7/32 in.  
Dimension B: 1-7/16 in.

**PACKAGING**

Package Type: Carton  
Std. Pkg.: 10  
Ship Carton Qty.: 40  
Product UPC-A Labeled: No  
Weight (Lbs. Per/C): 41.20  
Ship Carton Length (in.): 24.21  
Ship Carton Width (in.): 11.14  
Ship Carton Height (in.): 6.29  
Ctn Weight (Lbs.): 16.48  
UPC Number: 050169016701  
I2of5: 50050169016706