



Standard

STANDARD LPL59TPI

Available for many fluorescent lamp types sold today, including Preheat, Rapid Start, 2-pin CFL, Slimline, High Output, Very High Output and Circline. Magnetic ballasts can be used in any application where these lamps are used.

Product data

| General Information | |
|--------------------------|----------------------|
| Lamp Type | CFQ9W/G23 |
| Number Of Lamps | 1 piece/unit |
| Lamp Footage | - |
| Ballast Type | Magnetic Fluorescent |
| Base Model | LPL59TP |
| Suitable For Outdoor Use | Yes |
| Automatic Restart | Yes |

| Operating and Electrical | |
|-------------------------------|---------|
| Input Voltage | 120 V |
| Input Frequency | 60 Hz |
| Total Harmonic Distortion USA | 15 % |
| Power (Rated) (Nom) | 9 W |
| Ignition Method | Preheat |
| Crestfactor (Nom) | 1.5 |
| Ignition Time (Nom) | 1 s |
| Input Current (Open Circuit) | 0 |
| Input Current (Starting) | 0.19 |
| Ballast Factor (Nom) | 0.88 |
| Power Factor (Nom) | 0.56 |
| Input Current (Nom) | 0.14 A |
| Input Power (Nom) | 9 W |

| | |
|------------------|------|
| Rated Lamp Power | 9W W |
|------------------|------|

| Wiring | |
|--|----------------|
| Wire Striplength | 0.50/0.375 mm |
| Lamp Connection | Series |
| Wire Length By Color | See data sheet |
| Wire Gauge (Nom) | 18AWG mm |
| Wire Type | Solid |
| Remote Wiring Configuration Allowed | Yes |
| Tandem Wiring Configuration Allowed | No |
| Through Wiring Configuration Allowed | No |
| Max Ballast-Lamp Distance Remote Wiring | 30' |
| Max Ballast-Lamp Distance Tandem Wiring | - |
| Max Ballast-Lamp Distance Through Wiring | - |

| Mechanical and Housing | |
|------------------------|-----------------------|
| Housing Material | Metal |
| Housing | X1 |
| Housing Dimensions | 2.38" x 1.38" x 1.38" |

| Approval and Application | |
|--------------------------|------------------|
| EMC Immunity Standard | FCC Non-Consumer |
| Hum And Noise Level | A |

Standard

| | |
|---------------------|-------------------|
| UL Recognized | No |
| Product Data | |
| Order product name | STANDARD LPL59TPI |
| EAN/UPC - Product | 781087113929 |
| Order code | 913710350701 |

| | |
|---------------------------------|--------------|
| Numerator - Quantity Per Pack | 1 |
| Numerator - Packs per outer box | 12 |
| Material Nr. (12NC) | 913710350701 |
| Net Weight (Piece) | 168.000 g |

Dimensional drawing

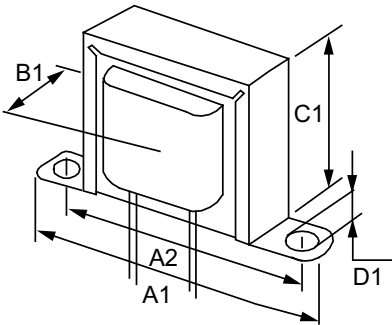

MAG BALLAST (1) F8T5 PH 120V

| Product | A1 | A2 | B1 | C1 | D1 |
|-------------------|---------|------|---------|---------|---------|
| STANDARD LPL59TPI | 2.38 in | 2 in | 1.59 in | 1.38 in | 0.19 in |

