



**CATALOG NUMBER: BALU100-HX/V4**

**100W S54**

**High Pressure Sodium Lamp Ballast**  
**60 Hz HX-HPF**

**3X4CORE - HX,CWA & CWI UNITS**

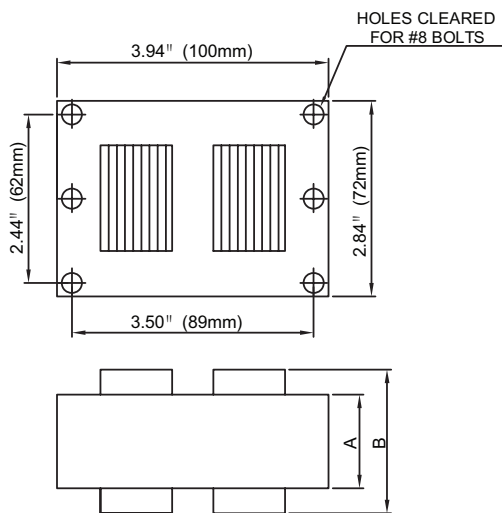

Input Volts		120	208	240	277
Circuit Type	HX-HPF				
<b>REGULATION</b>					
Line Volts	±5%				
Lamp Watts	±10%				
<b>LINE CURRENT( Amps )</b>					
Operating		1.10	0.60	0.55	0.45
Open Circuit		2.10	1.20	1.05	0.90
Starting		0.90	0.55	0.45	0.40
<b>RECOMMENDED FUSE (Amps)</b>					
		6	3	3	3
<b>TEMPERATURE RATINGS</b>					
Insulation Class		H	H	H	H
Coil Temperature Code		A	A	A	A
Benchtop Coil Rise					
Power Factor (Min)	90%				
Input Watts	126 W				
Current Crest Factor	1.50				
<b>NOM. OPEN CIRCUIT VOLTAGE</b>					
	130				
<b>INPUT VOLTAGE AT LAMP DROPOUT</b>					
		90	160	180	210
<b>MIN AMBIENT STARTING TEMP</b>					
	-20°F/-30°C				
<b>60 HZ TEST PROCEDURES</b>					
<b>High Potential Test (Volts)</b>					
1 Minute		2,000 V			
1 Second		2,500 V			
<b>Open Circuit Voltage Test (V)</b>					
		115 - 145			
<b>Short Circuit Current Test (A)</b>					
	Min	2.50			
	Max	2.80			
	Min		0.70	0.40	0.35
	Max		1.00	0.60	0.50
				0.35	0.30
				0.45	
<b>CORE and COIL Specifications</b>					
Dimension A (in)		2.00			
Dimension B (in)		3.45			
Weight (lbs)		5.9			
Lead Lengths (in)		12			
<b>CAPACITOR REQUIREMENT</b>					
Microfarads		10.0 uf			
Volts (Min)		280 V			

**Capacitor:**

Microfarads: 10.0 uf  
Volts (Max): 330 V  
Case Temp(Max): 100°C  
D: 1.65 in  
L: 2.56 in  
A: 0.63 in

**Ignitor:**

Temp: 105 °C  
BTL : 2 ft

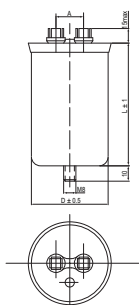

Oil-Filled Capacitor

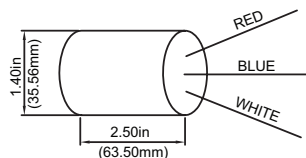

**Wiring Diagram:**

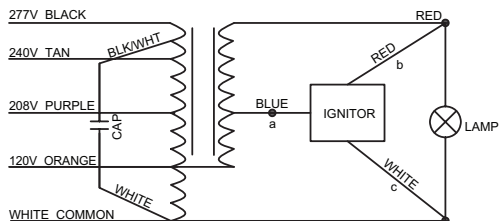

Data is based upon tests performed by Plusrite in a controlled environment and is representative of relative performance. Actual performance can vary depending on operating conditions. Specifications are subject to change without notice.

Coil material: Cu/Al