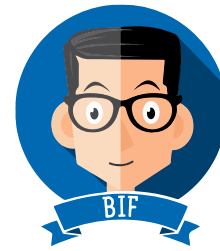

Project Name:

Part Number:

**BIF****LED - BUILT IN FRAME**

407-478-3759  
www.ilp-inc.com

**FEATURES**

- Upgrade Any 2x2 or 2x4 Fluorescent Troffer To LED With Modern
- Architectural Styling
- 24 LEDs per module spaced 3/4" apart results in low pixilation
- No tools required for easy installation into the existing fixture housing
- Average install time: 5 Minutes
- 0-10V Dimmable Driver (100% - 10%)
- Available In 4000K
- 5 Yr. Warranty
- DesignLights Consortium® Qualified Luminaire

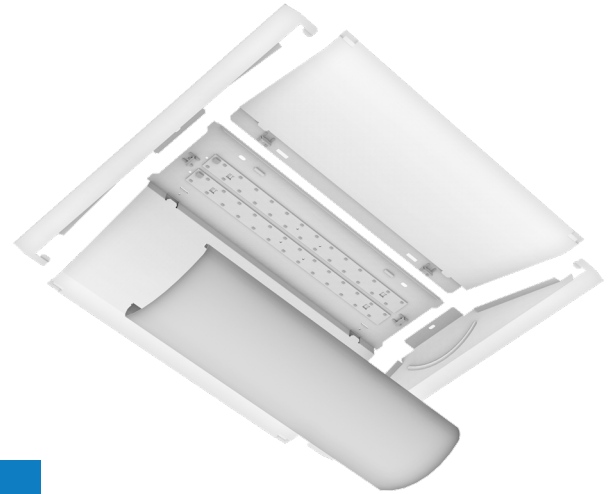
**SUITABLE APPLICATIONS**

- 2x2's
- 2x4's
- Parabolic Louvers
- Prismatic Lenses

**ORDERING GUIDE:**

PART NO.	WATTS	LUMENS	Lm/W	L70	CRI
BIF22-25WLED-UNIV-40	23	3,000	130	>100	>80
BIF22-30WLED-UNIV-40	30	3,600	120	>100	>80
BIF24-30WLED-UNIV-40	30	3,600	120	>100	>80
BIF24-37WLED-UNIV-40	36	4,752	132	>100	>80
BIF24-43WLED-UNIV-40	44	5,160	117	>100	>80

**OPTIONS:**

- ILBCP05** Field Installed 5W LED Battery Backup
- ILBCP07** Field Installed 7W LED Battery Backup
- ILBCP10** Field Installed 10W LED Battery Backup
- ILBCP12** Field Installed 12W LED Battery Backup
- WIRExx** Additional L/N Length
- QDCW** Wago QDC

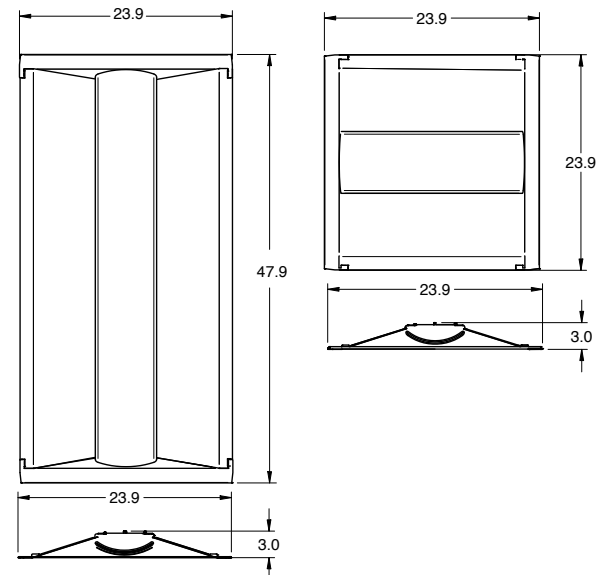

-BB PERFORMANCE DATA AVAILABLE ON FIELD INSTALLED LED BB SHEET

# INSTALL INSTRUCTIONS

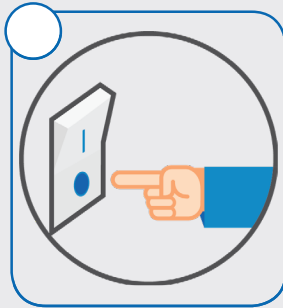

## •STEP 1

- Shut off or disconnect power to the fixture.

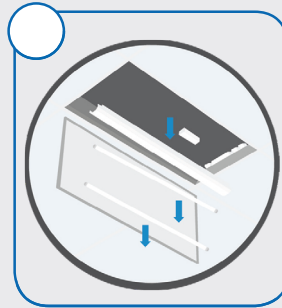

## •STEP 2

- Remove existing fluorescent lamps and components, then disconnect existing connections to the fluorescent ballast.

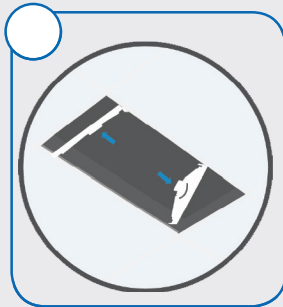

## •STEP 3

- Gently lift the original housing and insert the brackets between the housing and the T-grid.

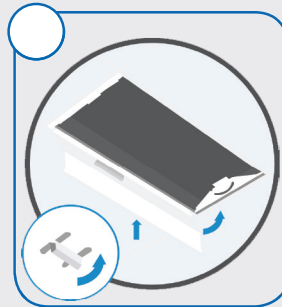

## •STEP 4

- Install the gear panel by first hooking the slots into the respective tabs in the end panels. Rotate the fasteners to secure in place.

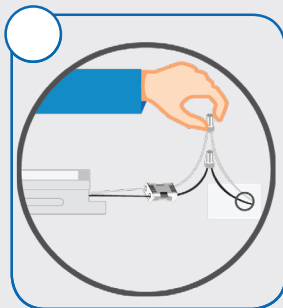

## •STEP 5

- Connect the BIF to AC power and ground.

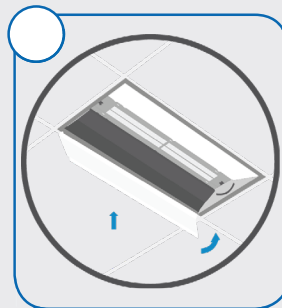

## •STEP 6

- Install the side panel by first hooking the slots into the respective tabs in the end panels. Rotate the fasteners to secure in place.

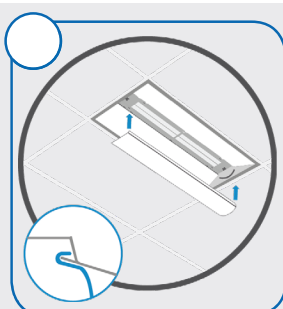

## •STEP 7

- Install the lens by hooking onto the tabs on the gear panel and the side panel.

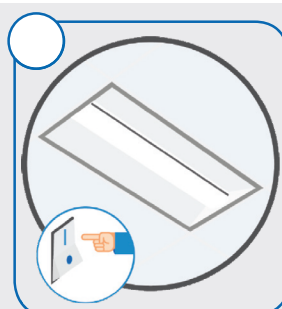

## •STEP 8

- Turn on or reconnect power to the fixture to complete the installation.