

OVERVIEW

The nLight ECLYPSE provides time-based control of an nLight and/or XPoint Wireless network as well as acting as the IP interface for SensorView software. Consisting of a server module, power supply module, nLight network interface module, the nLight ECLYPSE expands the capacity and functionality of the Series 2 nLight Gateway with a native BACnet interface (optional) that is BACnet Technology Laboratories (BTL) listed as a BACnet Building Controller (B-BC).

FEATURES

- BACnet Testing Laboratories (BTL) listed as a BACnet Building Controller (B-BC)
- Native BACnet MS/TP and IP (optional)
- Communicates over IP Local Area Network (LAN) with SensorView, Distech ECLYPSE, XPoint Wireless bridges and nADR devices
- Manages forwarding of global control channels across bridge devices and other nLight ECLYPSE gateways
- Extra security provided by HTTPS Server
- HTML5 management visualization through ENVYISION
- Powered by Android OS
- Wi-Fi client access point - hot spot or mesh capability
- Discovers and commissions nLight and Xpoint Wireless devices
- Provides system time-clock
- Stores time-based and input active profiles
- On-demand profile forwarding between gateways
- Remotely upgradeable
- Automated email notifications of system status and alarms
- Over-voltage and over-current protection - field replaceable fuse

Warranty

Three-year limited warranty. Complete warranty terms located at:

www.acuitybrands.com/CustomerResources/Terms_and_conditions.aspx

Note: Actual performance may differ as a result of end-user environment and application. Specifications subject to change without notice.



BACnet is a registered trademark of ASHRAE. ASHRAE does not endorse, approve or test products for compliance with ASHRAE standards. Compliance of listed products to the requirements of ASHRAE Standard 135 is the responsibility of BACnet International (BI). BTL is a registered trademark of BI.

AcuityControls™

nLight®

nLight ECLYPSE IP & Building Management Interface for nLight Networks



ORDERING INFORMATION

NECY				Example: NECY 120			
Series		Voltage		BACnet/IP		Visualization Software	
nECY	nLight ECLYPSE	120	120 VAC	[blank]	Disabled	[blank]	Viewer Only
		24	24 VAC	BAC	Enabled	SVS¹	Enhanced Visualization

Notes

1. Must specify BAC.

SPECIFICATIONS

Control Module

Size:	4.74" H x 3.57" W x 2.31" D (12.03 cm x 9.07 cm x 5.86 cm)
Mounting:	DIN rail mounted inside NEMA Type 1 enclosure
Ports:	Ethernet: (2) switched RJ-45 Ethernet ports USB Connections: 2 x USB 2.0 ports; 1 x Micro-USB 2.0 port RS-485 Serial Communications: Screw terminals Subnet: RJ-45
Enclosure*:	FR/ABS UL94-V0 flammability rating; Plenum rated
Environmental*:	Operating Temperature: 32°F to 122°F (0 to 50°C) Storage Temperature: -22°F to 158°F (-30 to 70°C) Relative Humidity: 0 to 90% non-condensing Ingress Protection Rating: IP20

nLight Network Interface Module

Size:	4.74" H x 3.20" W x 2.31" D (12.03 cm x 8.12 cm x 5.86 cm)
Mounting:	DIN rail mounted inside NEMA Type 1 enclosure
Ports:	3 nLight bus ports (RJ-45)

Power Supply Module (24V, 100-240VAC)

Size:	24V: 4.74" H x 2.85" W x 2.31" D (12.03 cm x 7.24 cm x 5.86 cm) 100-240VAC: 4.74" H x 4.08" W x 2.31" D (12.03 cm x 10.37 cm x 5.86 cm)
Enclosure/Mounting:	24V & 100-240VAC: DIN rail mounted 13.19" H x 10" W x 4.5" D (33.5 cm x 25.4 cm x 11.4cm)
Operating Voltage:	24V: 24VAC/DC; $\pm 15\%$; Class 2 100-240VAC: 100 to 240 VAC Universal; $+10\%/-15\%$
Output Voltage,	
Rated Current & Power:	24V: 18VDC regulated, 0-1.6A, 30W max 100-240VAC: 18VDC regulated, 0-2A, 40W max

*Requires Third Party NEMA Type 1 Enclosure for 100-240 VAC version

COMMUNICATION

Ethernet Connection Speed:	10/100 Mbps
Addressing:	IPv4 or Hostname
BACnet Profile:	BACnet Building Controller (B-BC), AMEV Certified (AS-A profile)
BACnet Listing:	BTL, WSP B-BC
BACnet Interconnectivity:	BBMD forwarding capabilities BACnet/IP to BACnet MS/TP routing
BACnet Transport Layer:	MS/TP & IP (optional)
Web Server Protocol:	HTML5
Web Server Application Interface:	REST API

Supported BACnet MS/TP and TCP Connectivity:

- BACnet MS/TP or 1 \times RS-485 serial communications ports
- Each RS-485 port supports one communication protocol at a time
- RS-485 Wiring - 1-pair + Common/shield
- RS-485 EOL Resistor - Built-in
- RS-485 Baud Rates - 9600, 19 200, 38 400, or 76 800 bps
- RS-485 Addressing - Controller's Web Configuration Interface

Supported Wireless Connectivity:

- Wireless Adapter - Optional, USB Port Connection
- Wi-Fi Communication Protocol - IEEE 802.11b/g/n and 802.11s
- Wi-Fi Network Types - Client, Access Point, Hotspot, Mesh
- Wi-Fi Mesh Max. - 30 devices on a single channel

SYSTEM ARCHITECTURE

The nLight ECLYPSE serves as the backbone for nLight and XPoint Wireless networked luminaires and controls. The nLight ECLYPSE provides both nLight and XPoint Wireless devices with schedule management and software programming interface. The backbone also provides support for system-wide controls such as master override switches, automated demand response, and BACnet integration. One nLight ECLYPSE is capable of handling up to 1500 total devices and up to 128 channels for the entire network. The nLight ECLYPSE is compatible with other Distech ECLYPSE products offering a full suite of BAS capabilities.

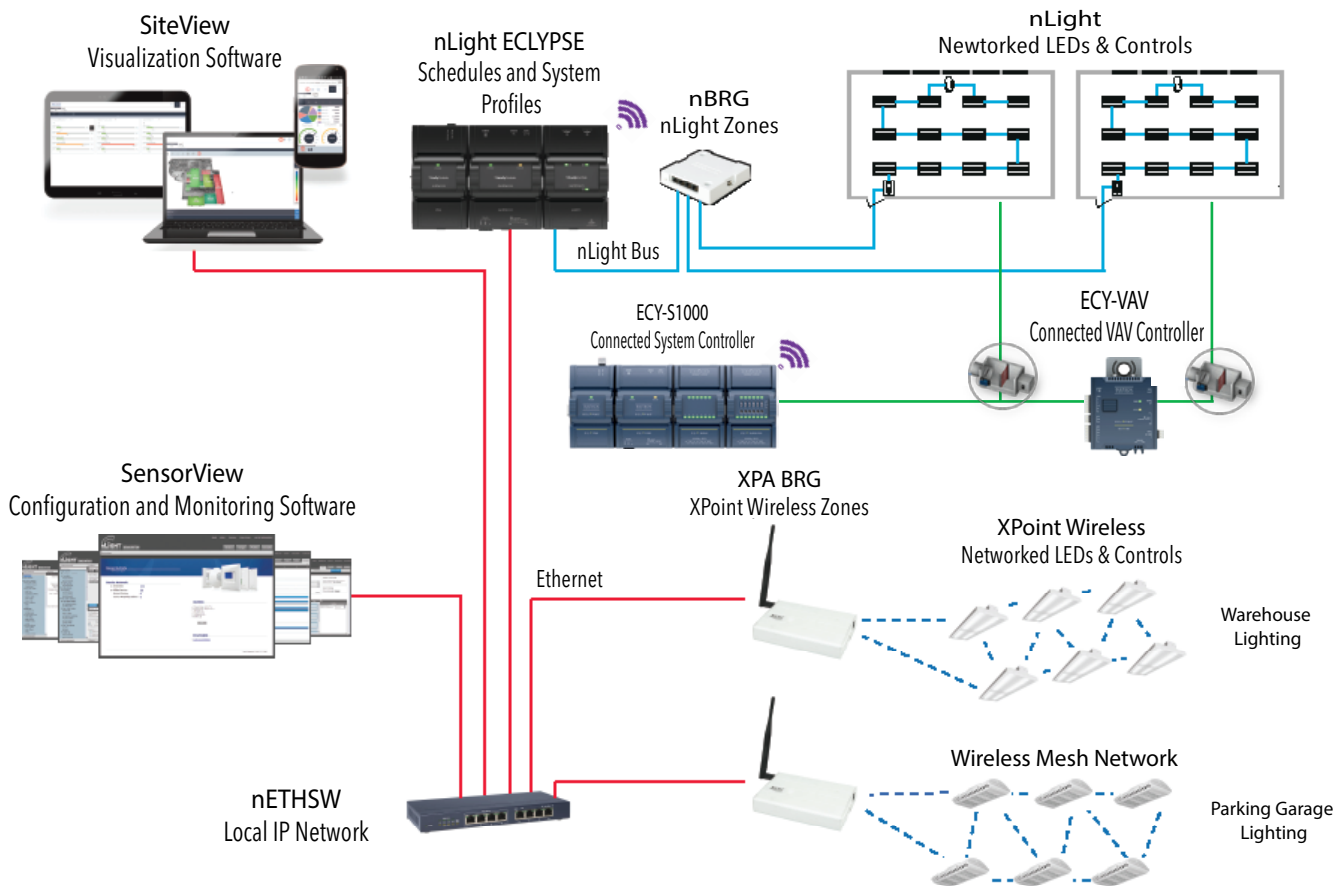

Compatible Distech ECLYPSE Products: ECY-VAV Series, ECY-303 Series, ECY-S1000*
*Only available through Distech Systems Integrators