

**PHILIPS**  
**bodine**

Emergency Drivers

LED

BSL26 / BSL26C



Project: \_\_\_\_\_  
 Type: \_\_\_\_\_  
 Model No: \_\_\_\_\_ Qty: \_\_\_\_\_  
 Date: \_\_\_\_\_  
 Notes: \_\_\_\_\_

**Emergency LED Driver**  
**Up to 5.1 Watts output power**

Product order number: BSL26 (metal case)  
 See back page for additional model configurations

**Specifications**

**UL RECOGNIZED/CSA Certified**  
 Factory Installation only (Indoor and Damp)  
 Output LVLE Compliant

**Illumination Time**  
 90 Minutes

**Full Warranty**  
 5 Years (NOT pro-rata)

**Dual Input Voltage**  
 120/277 VAC, 60 Hz

**AC Input Current**  
 280 mA

**AC Input Power Rating**  
 3.0 W

**Output Voltage**  
 3.0 to 30 VDC (Maximum)

**Output Current**  
 265 mA (Maximum)

**Output Power**  
 5.1 W (Maximum),  
 measured at nominal battery voltage

**Test Switch/Charging Indicator Light**  
 Illuminated Test Switch

**Battery**  
 High-Temperature, Maintenance-Free  
 Nickel-Cadmium Battery  
 7- to 10-Year Life Expectancy

**Battery Charging Current**  
 250 mA

**Recharge Time**  
 24 Hours

**Temperature Rating (Ambient)**  
 0°C to +50°C (32°F to 122°F)

**Dimensions**  
 9.4" x 2.4" x 1.5" (238 mm x 60 mm x 38 mm)  
 Mounting Center 8.9" (226 mm)

**Weight**  
 BSL26 - 2.0 lbs. (0.91 kg)  
 BSL26C Type 1 - 3.0 lbs. (1.4 kg)

**Benefits:**

- Emergency Illumination for Lower Wattage LED fixtures
- For Indoor or Damp Locations

**Dimensions**

9.4" x 2.4" x 1.5" (mounting center - 8.9")

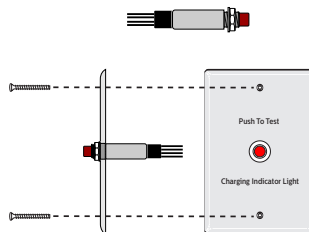
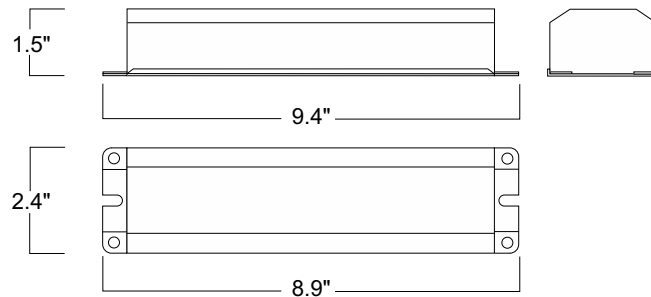

A Test/Monitor Plate with an illuminated test switch/charging indicator light is provided.



# BSL26/BSL26C

## Emergency LED Driver, Class 2 Output, 7 Watts Output Power

### Application

The BSL26 emergency LED driver works in conjunction with an AC LED driver that has an output current not to exceed 2.8 ADC Continuous to convert LED fixtures into emergency lighting. The emergency driver consists of a high-temperature nickel-cadmium battery, charger and electronic circuitry in one compact red case. The BSL26 can be used with an LED lighting load of up to 5.1 Watts measured at nominal battery voltage at rated current of 265 mA for 90 minutes. If used in an emergency-only fixture, no AC driver is necessary. The BSL26 is suitable for indoor and damp locations and for sealed & gasketed fixtures, including fixtures rated for wet locations. The BSL26C is suitable for indoor and damp locations. Neither the BSL26 nor the BSL26C is suitable for air handling heated air outlets and wet or hazardous locations. For more information about specific LED and AC driver compatibility, please call the factory.

### Operation

When AC power fails, the BSL26 immediately switches to the emergency mode, operating the LEDs at a reduced lumen output for a minimum of 90 minutes. When AC power is restored, the emergency driver automatically returns to the charging mode.

### Installation

The BSL26 does not affect normal fixture operation and may be used with either a switched or unswitched fixture. If a switched fixture is used, an unswitched hot lead must be connected to the emergency driver. The emergency driver must be fed from the same branch circuit as the AC driver. Installation is not recommended with fixtures where the ambient temperature may fall below 0° C.

### Emergency Illumination

The BSL26 operates an LED load of up to 5.1 W measured at nominal battery voltage at rated current (265 mA) for a minimum of 90 minutes.

### Specification

Emergency lighting shall be provided by using a LED fixture equipped with a Philips Bodine BSL26 emergency driver. This emergency driver shall consist of a high-temperature, maintenance-free nickel-cadmium battery, charger and electronic circuitry contained in one 9 3/8" x 2 3/8" x 1 1/2" red metal case. (The BSL26C comes with 2' length(s) of flexible conduit.) An illuminated test switch (ITS) to monitor charger and battery and installation hardware shall be provided.

The emergency driver shall be capable of operating an LED load of up to 5.1 Watts at a maximum rated current (265 mA) for a minimum of 90 minutes. It is suitable for indoor and damp locations and for sealed & gasketed fixtures (BSL26 only). The BSL26 shall have 3 Watts of input power and a 14.4 Watt-hour battery capacity and shall comply with emergency standards set forth by the current NEC. The emergency driver shall be UL Recognized and CSA Certified for factory installation only.

### Installation Options and Ordering Codes

The BSL26 can be ordered in several mounting configurations and with different test switch/LED options. Please see the Ordering Codes below to determine which configuration best meet your requirements.

### Warranty

Model BSL23/BSL23C is warranted for five (5) full years from date of purchase. Please see detailed warranty information on our web site.

### Optional models:

BSL26 (Order Number BSL26)  
Includes Loose 4-wire ITS Parts Kit

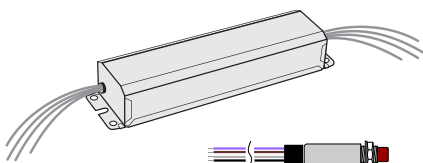

BSL26 - 2.0 lbs. (0.91 kg)

BSL26C Type 1 (Order Number BSL26C)  
Includes 4-wire ITS on Wall Plate

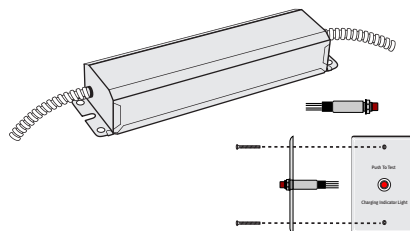

BSL26C Type 1 - 3.0 lbs. (1.4 kg)

BSL26C Type 1 Option 6 (Order Number BSL26CT1O6B)  
Includes ITS on the conduit

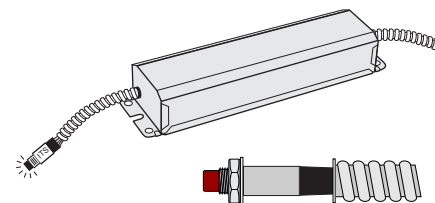

BSL26C Type 1 option 6 - 2.9 lbs. (1.3 kg)

BSL26C Type 1 Option 6B (Order Number BSL26CT1O6B)  
Includes ITS on the conduit

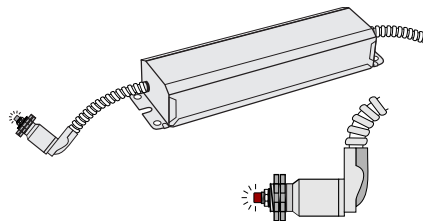

BSL26C Type 2 (Order Number BSL26CT2)  
Includes ITS on the conduit

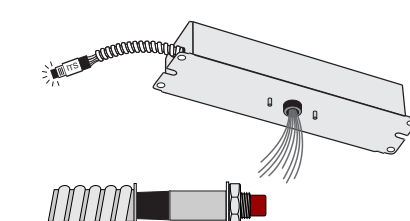

BSL26C Type 2 - 2.6 lbs. (1.2 kg)

BSL26C Type 2 Option 6 (Order Number BSL26CT2O6)  
Includes 4-wire ITS on Wall Plate

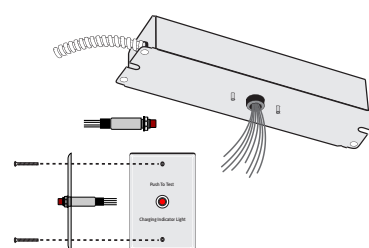

BSL26C Type 2 option 6 - 2.5 lbs. (1.1 kg)

© 2016 Philips Lighting Holding B.V. All rights reserved. Philips reserves the right to make changes in specifications and/or to discontinue any product at any time without notice or obligation and will not be liable for any consequences resulting from the use of this publication.



Philips Emergency Lighting  
236 Mt. Pleasant Rd.  
Collierville, TN 38017  
Tech Support: 888.263.4638  
Sales: 800.223.5728