



Core & Coil (71A) HPS ~LT~ 200W

CORE & COIL HID 71A8142001D

The basic ballast is the open core and coil which is most often used as a component within a lighting luminaire. The core and coil also forms the nucleus of Philips Advance's five other ballast configurations.

Product data

General Information	
ANSI Code	S55
Lamp Type	150W HPS
Number Of Lamps	1 piece/unit
Circuit Type	HX-HPF
Ballast Type	Magnetic HID
Base Model	71A8142
Core Size	3 X 4 (2 coil)
Suitable For Outdoor Use	Yes
Ignitor Catalog Number	LI551-H4
Ignitor Temperature Rating	105°C
Capacitor Value	14 MFD
Capacitor Catalog Number	7C140M30RA
Capacitor Requirements	280V
Capacitor Temperature Rating	105°C
Capacitor Diameter/Oval Dimensions	1.65 in
Capacitor Height	2.75 in
Automatic Restart	No

Operating and Electrical	
Input Voltage	480 V
Input Frequency	60 Hz
Power (Rated) (Nom)	150 W
Input Current (Open Circuit)	0.7 A
Input Current (Starting)	0.5 A
Input Current (Short Circuit)	0.3-0.45 A
Secondary Short Circuit Current	3.95-4.85 A
Constant Wattage Deviation	Within Trapezoid
Ballast Factor (Nom)	1
Power Factor (Nom)	0.90
Open Circuit Voltage	120 V
Input Current (Nom)	0.42 A A
Input Power (Nom)	188 W
Rated Lamp Power	150W W

Wiring	
Wire Striplength	0.5 mm
Wire Length By Color	12"
Wire Type	Stranded

Core & Coil (71A) HPS ~LT~ 200W

Remote Wiring Configuration Allowed	Yes
Max Ballast-Lamp Distance Remote Wiring	2'
Recommended Fuse Value	2 A

Approval and Application

Open Circuit Voltage Test (Volts)	110-130 V
Approval Marks	ULR CSA certificate RoHS Compliant
Temperature Marking	E
UL Recognized	Yes
Hipot Test (1 Minute)	2000 V
Hipot Test (2 Seconds)	2500 V
UL Insulation Class	H(180°C)

UL Temperature Code	1029E
---------------------	-------

Product Data

Order product name	CORE & COIL HID 71A8142001D
EAN/UPC - Product	781087814215
Order code	913700538509
Numerator - Quantity Per Pack	1
Numerator - Packs per outer box	1
Material Nr. (12NC)	913700538509
Net Weight (Piece)	4.500 kg

Dimensional drawing

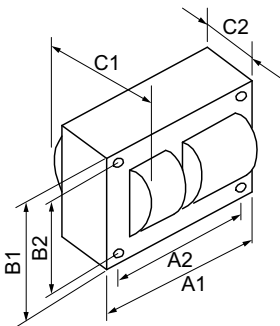

HPS BAL 150W S55 480V KIT

Product	C1	C2	A1	A2	B1	B2
---------	----	----	----	----	----	----

