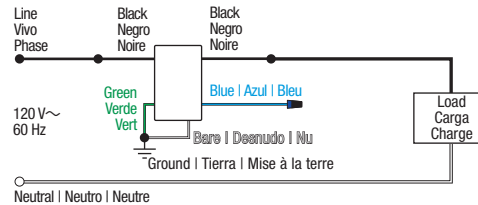
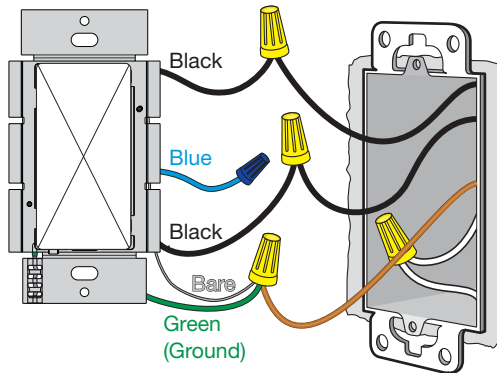

Image #11 — Switch with Two Black Wires and One Blue Wire in a Single Pole Application



Note: Only a sensor switch will have the second bare ground wire. Sensor switch must be grounded for the sensor to operate.

Not sure this is the correct wiring for your Lutron product?

For more information, refer to the Lutron [DIY Wiring Tool](#) or visit the [Lutron Support Center](#).