

Catalog Number	Wire Size	Maximum Rated Pull Load per Cable (LBS) Copper & Aluminum Wire			Maximum Rated Pull Load per Cable (LBS) Copper & Aluminum Wire				Minimum Wire Strip Length (IN)
		Copper (Concentric Compact) Wire	Aluminum (Concentric Compact) Wire	Dieless Tools Y / PAT644 (# Crimps)	Copper (Concentric Compact) Wire ONLY	Copper (Compact) Wire ONLY	Aluminum (Concentric Compact) Wire	Y / PAT750 Y / PAT46 (# Crimps)	
YCP25L-	#6 AWG	200	200	Y / PAT644 (1)	NA	NA	NA	NA	2.50"
	#4 AWG	300	300	Y / PAT644 (1)					2.50"
	#3 AWG	400	400	Y / PAT644 (1)					2.50"
	#2 AWG	500	400	Y / PAT644 (1)					2.50"
	#1 AWG	1,200	400	Y / PAT644 (1)					2.50"
YCP28L-	1/0 AWG	1,200	400	Y / PAT644 (1)	1,200	550 LBS	400	U25RT (1)	2.50"
	2/0 AWG	1,200	400	Y / PAT644 (2)	NA	NA	NA	NA	3.00"
	3/0 AWG	2,000	750	Y / PAT644 (2)	NA	NA	NA	NA	3.00"
YCP31L-	4/0 AWG	2,000	1,000	Y / PAT644 (2)	2,000	1,000	1,000	U28RT (2)	3.00"
	250 KCMIL	2,000	1,200	Y / PAT644 (3)	NA	NA	NA	NA	3.25"
	300 KCMIL	4,000	1,500	Y / PAT644 (3)	NA	NA	NA	NA	3.25"
YCP34L-	350 KCMIL	4,000	1,800	Y / PAT644 (3)	4,000	1,400	1,800	U31RT (3)	3.25"
	400 KCMIL	4,000	2,000	Y / PAT644 (3)	NA	NA	NA	NA	3.25"
	450 KCMIL	5,000	2,400	Y / PAT644 (3)	NA	NA	NA	NA	3.25"
YCP39L-	500 KCMIL	5,000	2,700	Y / PAT644 (3)	5,000	2,200	2,700	U34RT (3)	3.25"
	550 KCMIL	5,000	3,600	Y / PAT644 (3)	NA	NA	NA	NA	3.25"
	600 KCMIL	5,000	3,600	Y / PAT644 (3)					3.25"
	650 KCMIL	5,000	3,600	Y / PAT644 (3)					3.25"
700 KCMIL	5,000	3,600	Y / PAT644 (3)	3.25"					
YCP44L-	750 KCMIL	5,000	3,600	Y / PAT644 (3)	5,000	2,200	3,600	U39RT (3)	3.25"
	900 KCMIL	5,000	3,600	Y / PAT644 (3)	NA	NA	NA	NA	3.25"
	1,000 KCMIL	5,000	5,000	Y / PAT644 (3)	5,000	2,200	5,000	U44XRT (3)	3.25"

REV	DATE	DESCRIPTION	ECO	BY	CHK
D	06/28/18	UPDATED AS PER REQUEST	49394	YR	VS

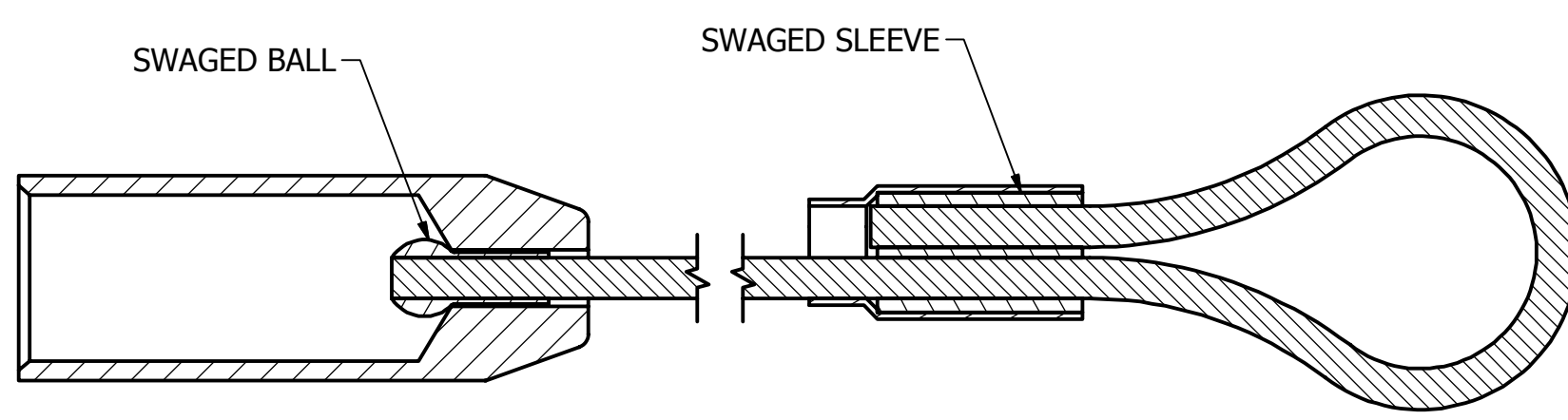
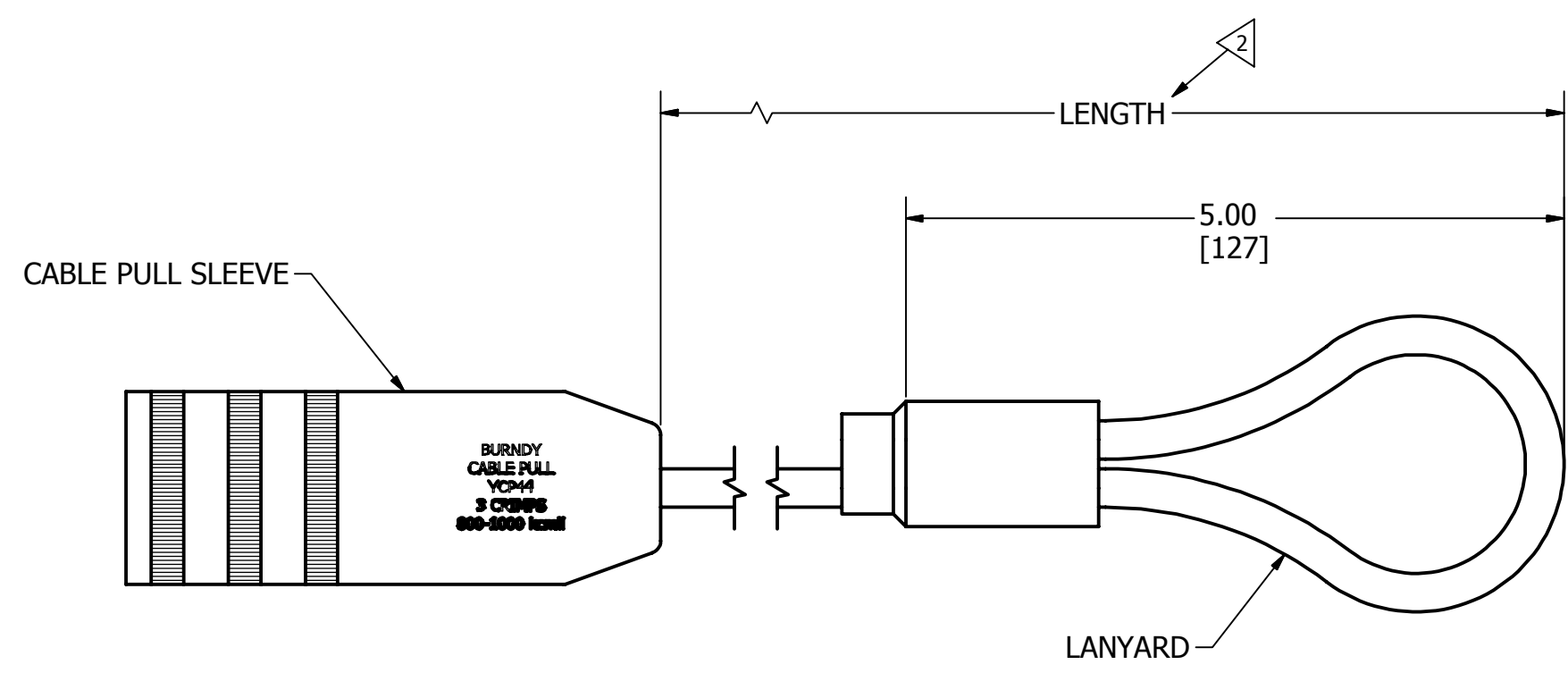

SECTIONAL VIEW

NOTES:

- DIMENSIONS IN BRACKETS [] ARE IN MILLIMETERS ROUNDED OFF TO THE NEAREST MILLIMETER, UNLESS OTHERWISE SPECIFIED AND ARE FOR REFERENCE ONLY.
- CABLE PULLS AVAILABLE IN THE FOLLOWING LENGTHS: 13", 20", 27", 34", AND 41" LENGTH SUFFIX IS ADDED TO END OF CATALOG NUMBER IN TABLE, E.G. YCP25L13

TO ORDER BURNDY® PRODUCTS CALL		CABLE PULL	
UNITED STATES 1-800-346-4175 (LONDONDERRY, NH)		ITEM NO: SEE TABLE	
CANADA: 1-800-361-6975 (QUEBEC) 1-800-387-6487 (ALL OTHER PROVINCES)		CAT. NO: SEE TABLE	
FOR PRODUCT INFO: http://www.burndy.com		DRAWN BY: D.DHANASEKARAN 11/18/2015	
		CHECKER: G.RUGGIERO 1/20/2016	
		DSN APRVL: G.RUGGIERO 1/20/2016	
		MFG APRVL: --	
		QA APRVL: C.KOWALCZYK 1/21/2016	
		MKT APRVL: B.MICHAUD 1/19/2016	
		PROD FAM: --	
		PROJECT #: --	
		DOCUMENT TYPE: SALES	
		REL LEVEL: Released	
		DRAWING NO	
		50065870	
		REV	
		D	
		SHEET 1 OF 1	